

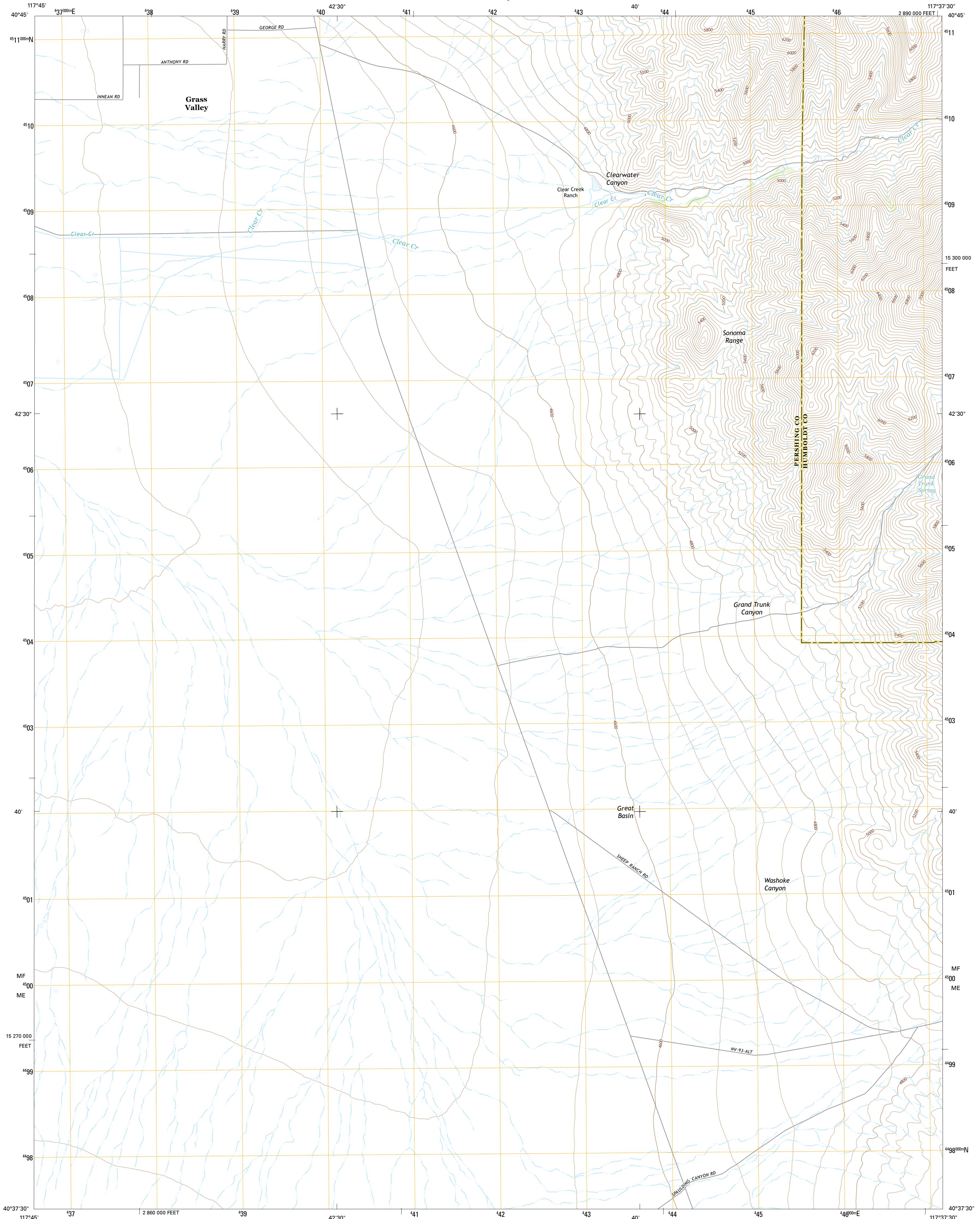

U.S. DEPARTMENT OF THE INTERIOR
U.S. GEOLOGICAL SURVEY



CLEAR CREEK RANCH QUADRANGLE
NEVADA
7.5-MINUTE SERIES



Produced by the United States Geological Survey
North American Datum of 1983 (NAD83)
World Geodetic System of 1984 (WGS84). Projection and
1 000-meter grid: Universal Transverse Mercator, Zone 11T
10 000-foot ticks: Nevada Coordinate System of 1983 (west
zone)
This map is not a legal document. Boundaries may be
generalized for this map scale. Private lands within government
reservations may not be shown. Obtain permission before
entering private lands.
Imagery.....NAIP, July 2013
Roads.....HERE, ©2013
Names.....GNIS, 2013
Hydrography.....National Hydrography Dataset, 2013
Contours.....National Elevation Dataset, 1999
Boundaries.....Multiple sources; see metadata file 1972 - 2014
Public Land Survey System.....BLM, 2011

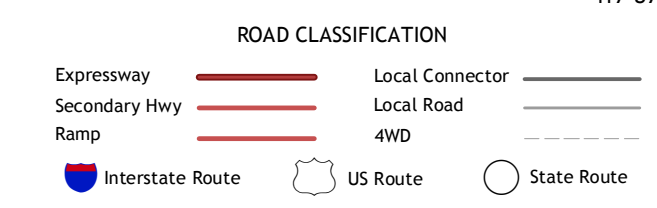
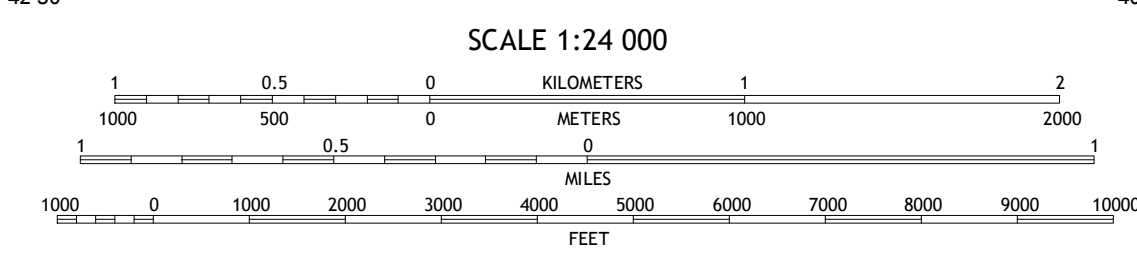
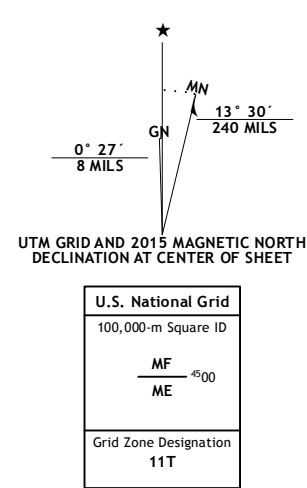

1	2	3
4	5	6
7	8	

ADJOINING QUADRANGLES

- 1 Rose Creek Mountain
- 2 Sonoma Canyon
- 3 Adelaide
- 4 Natchez Pass
- 5 Sheep Ranch Canyon
- 6 Lee Peak
- 7 Leach Hot Springs
- 8 Panther Canyon

CLEAR CREEK RANCH, NV
2015