

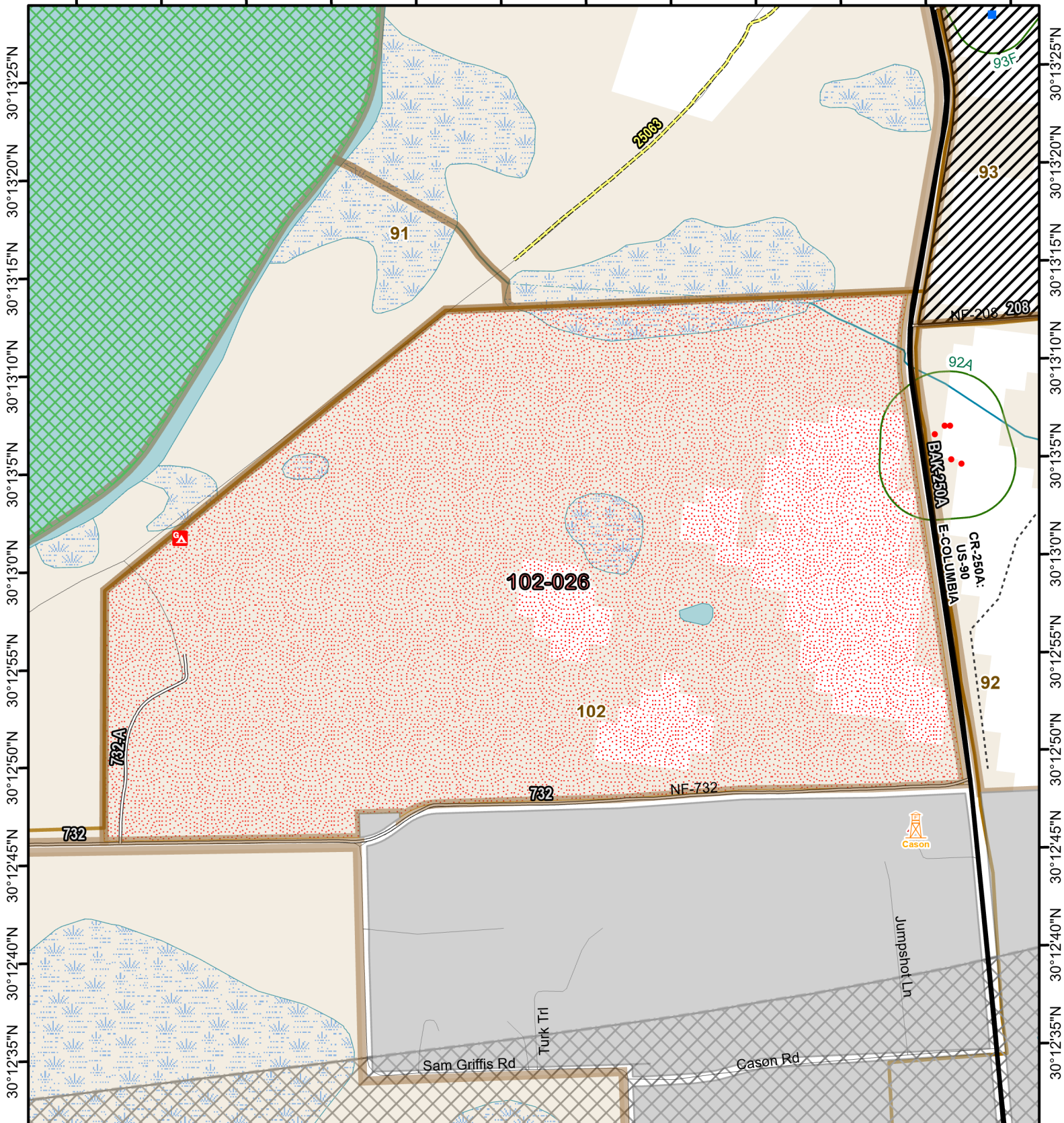

# Osceola National Forest Prescribed Fire - RxBurn Map



82°25'30"W 82°25'25"W 82°25'20"W 82°25'15"W 82°25'10"W 82°25'5"W 82°25'0"W 82°24'55"W 82°24'50"W 82°24'45"W 82°24'40"W 82°24'35"W



**Burn Unit: 102-026**  
Last Burn Date: 3/10/2008  
FACTS Acres: 226  
SUID: 080504PF04Y24102026

- FY 24 Planned Rx Burn Unit
- FY24 Completed Rx Burn
- Burn Unit
- Burn Unit Exclusion
- Inholding
- Forest Mgt. Compartment
- Smoke Sensitive Buffer
- RCW Cluster
- RCW Tree Prep
- RCW Tree No Prep
- Aviation\_Firetowers
- Towers (FAA)
- Not burned 1994-2021
- Burned >=1x 1994-2021



3/14/2024

0 0.15 0.3 Miles

[https://ftp.wildfire.gov/public/incident\\_specific\\_data/Fuels/FL\\_FNF/OSC/](https://ftp.wildfire.gov/public/incident_specific_data/Fuels/FL_FNF/OSC/)



Maps Lie,  
Trust But Verify

1:8,000



Osceola National Forest