

# Thor Contract Area Map

## Bend Fort Rock Ranger District

### Deschutes National Forest

#### Cutting Unit Boundary

Representation: CuttingUnitBdy\_Rep

● Sale Area Boundary and Cutting Unit Boundary, BT1.1, BT2.3

● Cutting Unit Boundary, BT1.1, BT2.3

Representation: FenceType\_Rep

PI — X — Protect Improvements - Fence, BT6.22

Representation: PowerlineType\_Rep

— ■ — Protect Improvement Powerline, BT6.221

#### Roads

Representation: RoadType\_Rep

— Existing Road, CT5.31#

— ■ — Road Construction, AT7, BT5.2

— ■ — Road Reconstruction, AT7, BT5.2

— X — Hauling Prohibited, CT5.12#

— R — Hauling Restricted, CT5.12#

— KO — Keep Road Open, BT6.22

— RO — Temp Road, Remain Open, BT6.631

— P — Use Prohibited, CT5.12#

— U — Unsuitable for Hauling, CT5.12#

Representation: SaleAreaBdy\_Rep

— ■ — Sale Area Boundary, BT1.1

#### Streams

Representation: StreamType\_Rep

— — — — — Streams

— ■ — Protect Streamcourse - BT6.5

Representation: TrailType\_Rep

— PI — Protect Improvements - Trails, BT6.22

Representation: TrailType\_Rep

— PI — Protect Improvements - Trails, BT6.22

#### Ownership

##### OWNERSHIP

■ Deschutes National Forest

■ Other National Forests

■ BLM Lands

■ State Lands

■ BIA Lands

■ Private Lands

This product is reproduced from geospatial information prepared by the U.S. Department of Agriculture, Forest Service. The Forest Service cannot assure the reliability or suitability of this information if used for a purpose other than which it was created. Original data elements were compiled from various sources. Spatial information may not meet national map accuracy standards. The information may be updated, corrected, or otherwise modified without notification. For additional information about this data, contact the Deschutes National Forest.



T:\FS\FNS\Deschutes\Project\BFR\imp\TSLoki2012\GIS\MXD\Loki\_TS\_8\_2013.mxd  
Map Created 8/2013 mldurrant

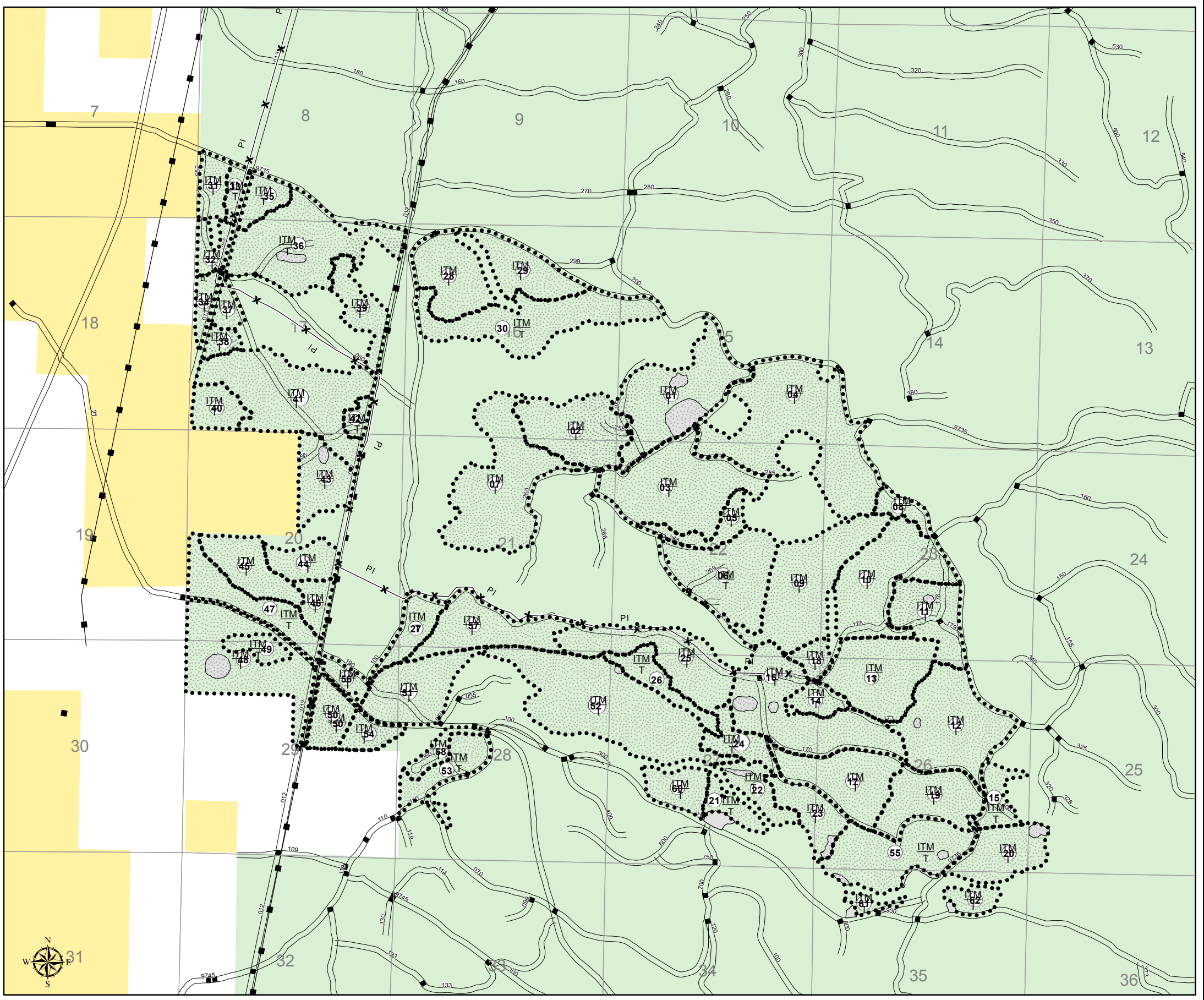
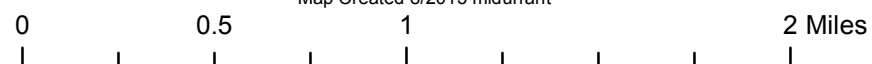

two inches = one mile