

148°7'W 148°6.5'W 148°6.01'W 148°5.5'W 64°57'N

Murphy Structure Protection Group



Perfect Perch Subd
AK-FAS-911319
06/30/2019



64°57'N

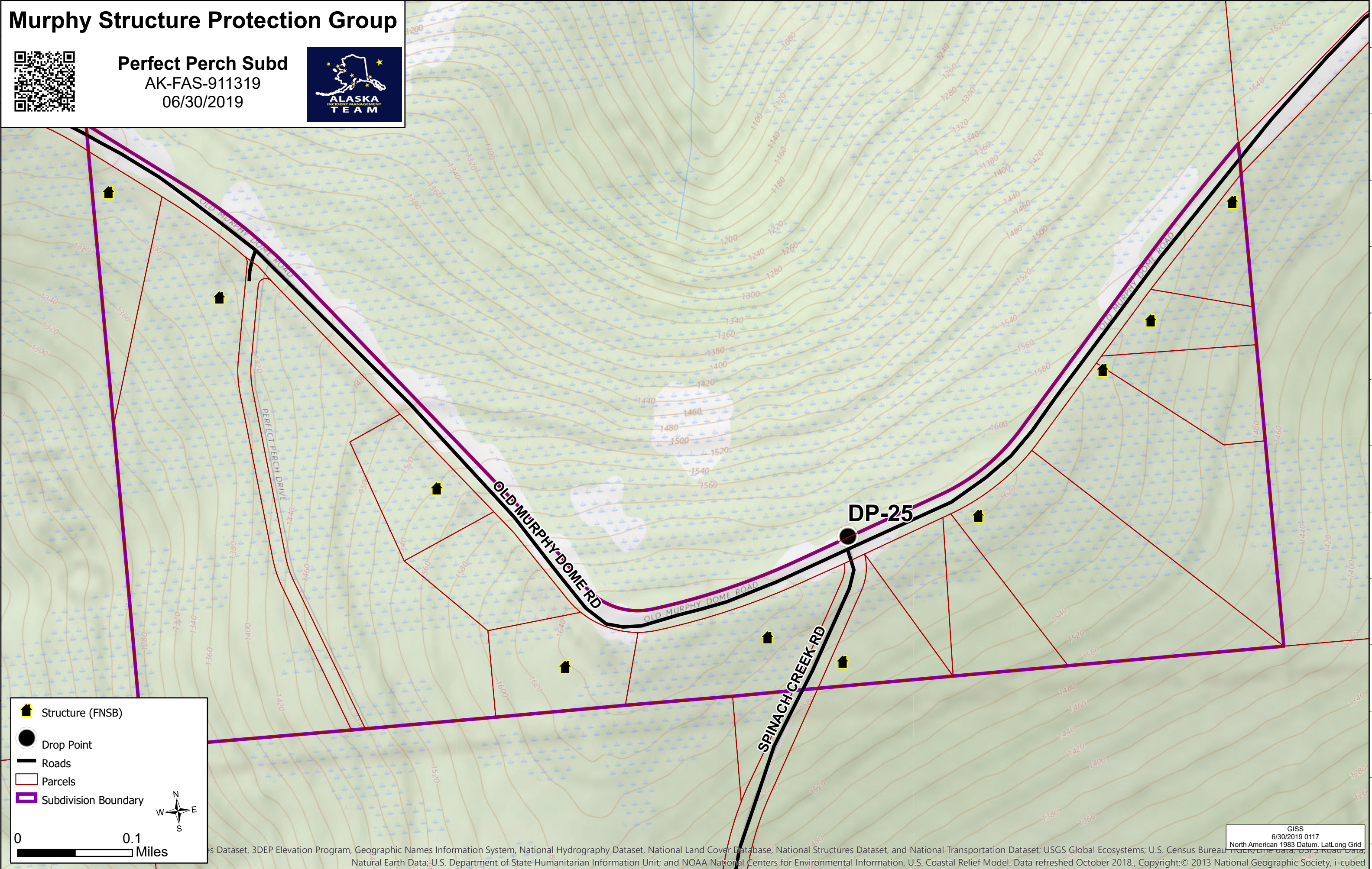

64°57'N

- Structure (FNSB)
- Drop Point
- Roads
- Parcels
- Subdivision Boundary

0 0.1 Miles

GIS Data, 3DEP Elevation Program, Geographic Names Information System, National Hydrography Dataset, National Land Cover Database, National Structures Dataset, and National Transportation Dataset; USGS Global Ecosystems; U.S. Census Bureau TIGER/Line data, USFS Road Data, National Earth Data; U.S. Department of State Humanitarian Information Unit; and NOAA National Centers for Environmental Information, U.S. Coastal Relief Model. Data refreshed October 2018., Copyright:© 2013 National Geographic Society, i-cubed

148°7'W 148°6.5'W 148°6.01'W 148°5.5'W 148°5'W