

149°12'W

149°11'W





64°21'N

64°21'N

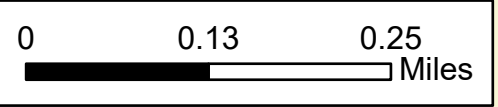
IAP Map
 Clear Fire
 AKFAS211346
 06/28/2022 - Day
 9,555 acres at 06/26/2022 @ 1500





-  Incident Command Post
-  Drop Point
-  Water Source
-  Structure

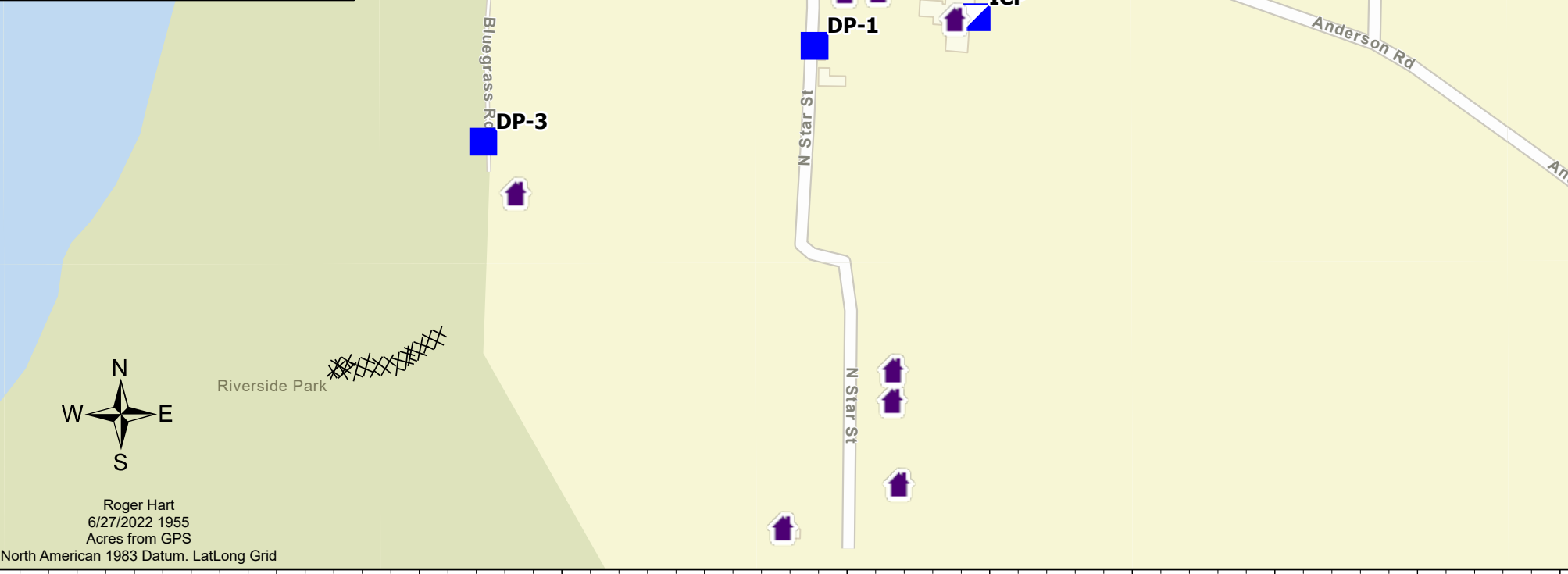

Page 6



Roger Hart
 6/27/2022 1955
 Acres from GPS
 North American 1983 Datum. LatLong Grid

149°12'W

149°11'W