

*Corrected*  
**DAY INCIDENT**

**CA-LMU-003472**

***OPERATIONAL PERIOD***

**August 5 - 6, 2014**

**0700-0700**







<b>INCIDENT OBJECTIVES</b>	<b>1. INCIDENT NAME DAY</b>	<b>2. DATE</b> 8/4/14	<b>3. TIME</b> 1900
----------------------------	---------------------------------	--------------------------	------------------------

**4. OPERATIONAL PERIOD (DATE/TIME)**  
8/5/14 - 8/6/14 0700 – 0700

- 5. MANAGEMENT OBJECTIVES**
- Provide for firefighter and public safety.
  - Establish and maintain positive relationships with cooperating agencies and the public.
  - Provide timely and accurate incident information.
  - Protect economic and watershed values with safe and aggressive firefighting efforts.
  - Keep costs commensurate with values at risk.
- 6. GENERAL CONTROL OBJECTIVES**
- Keep the fire:
    - North of County Road 94 and Widow Valley
    - East of Day Road
    - West of County Road 91
    - South of County Road 95

**7. WEATHER FORECAST FOR OPERATIONAL PERIOD**

The low pressure area will remain almost stationary over northeastern California today. Cloudy skies and scattered showers will continue with occasional thunderstorms embedded in these showers, especially in the afternoon through early evening.

**8. GENERAL SAFETY MESSAGE**

Slow down and use caution when driving on wet roads.  
Maintain 2:1 work/rest ratio and ensure hydration.

- 9. Attachments (☑ if attached)**
- |   |   |  |  |
|---|---|--|--|
| <input checked="" type="checkbox"/> Organization List (ICS 203) | <input checked="" type="checkbox"/> Air Operations 220            | <input checked="" type="checkbox"/> Finance Message          | <input type="checkbox"/> Demob Plan                    |
| <input checked="" type="checkbox"/> Weather Forecast            | <input checked="" type="checkbox"/> Communications Plan (ICS 205) | <input checked="" type="checkbox"/> Training Message         | <input type="checkbox"/> Traffic Plan                  |
| <input checked="" type="checkbox"/> Fire Behavior Forecast      | <input checked="" type="checkbox"/> Medical Plan (ICS 206)        | <input checked="" type="checkbox"/> Archaeologist<br>Message | <input checked="" type="checkbox"/> Facility Map       |
| <input checked="" type="checkbox"/> Safety Message              | <input checked="" type="checkbox"/> ICP Phone List                | <input type="checkbox"/> Training Message                    | <input checked="" type="checkbox"/> Water Usage Report |
| <input checked="" type="checkbox"/> Assignment List (ICS 204)   | <input type="checkbox"/> Camp Rules                               | <input type="checkbox"/> Suppression                         | <input checked="" type="checkbox"/> Unit Log 214       |
|   | <input type="checkbox"/> Information                              | <input type="checkbox"/> Repair Plan                         | <input type="checkbox"/> _____                         |

**10. PREPARED BY (PLANNING SECTION CHIEF)**  
Pam Linstedt *PJ*

**11. APPROVED BY (INCIDENT COMMANDERS)**  
Robert Michael *R*







# INCIDENT Weather Forecast



FORECAST NO:

NAME OF FIRE: Day

PREDICTION FOR: DAY and NIGHT SHIFT

UNIT:

SHIFT DATE: Tuesday Aug 5, 2014

SIGNED: *Frederic Bunnag*

TIME AND DATE

Incident Meteorologist

FORECAST ISSUED: Aug 4, 2014 1900 PDT

**WEATHER DISCUSSION:** ...FIRE WEATHER WATCH FOR THUNDERSTORMS THIS MORNING...  
A few showers will linger through mid morning before drying. However with the low pressure still remaining nearby, there is still enough moisture and instability for scattered showers to develop in the afternoon. A few of these showers may develop into a thunderstorm cell.

### **WEATHER FORECAST: DAY SHIFT**

**WEATHER:** A few showers in the morning, then clearing. Chance of showers again in the afternoon.  
Slight chance of afternoon and evening thunderstorms.

**TEMPERATURES:** 80-83 valleys...73-78 mid slopes and ridges.

**HUMIDITY:** Minimum of 30%

**20 FT WINDS:** \*\*\*Winds will be gusty and erratic near thunderstorms\*\*\*

RIDGETOP - West 10-15 mph.

SLOPE/VALLEY - Variable 5-7 mph until 1400, then Southwest 8-10 mph.

**HAINES INDEX:** 3 (Low)

**LIGHTNING ACTIVITY LEVEL:** 1...occasionally 2 after 1500.

### **WEATHER FORECAST: NIGHT SHIFT**

**WEATHER:** Scattered evening showers...otherwise partly cloudy.

**TEMPERATURES:** Lows 55 to 60.

**HUMIDITY:** Maximum 60%.

**20 FT WINDS:**

RIDGETOP - West wind 10-15 mph.

SLOPE/VALLEY - Southwest 10-15 mph in the evening...then becoming light downslope.

**HAINES INDEX:** 3 (Low)

**LIGHTNING ACTIVITY LEVEL:** 1.

**OUTLOOK FOR WEDNESDAY:** Partly cloudy. Highs 80-85. Min RH 25% West wind 10-12 mph.



## **FIRE BEHAVIOR FORECAST**

### **Day Fire**

FORECAST NUMBER: 4	TYPE OF FIRE: Wildland Fire
FIRE NAME: Day Fire	OPERATIONAL PERIOD: 8/5/2014 0700-0700
DATE ISSUED: 8/4/2014	TIME ISSUED: 2000 Hrs.
UNIT: LMU – CAL FIRE Lassen-Modoc	SIGNED: typed/printed: Chris Waters FBAN

#### **INPUTS**

**WEATHER SUMMARY:** *RED FLAG WARNING FOR THUNDERSTORMS CONTINUES TODAY.*

Moisture and instability will be over the fire area today into the evening hours. Expect thunderstorms to begin developing around noon and continue over night. Thunderstorms will be wet with the potential rainfall.  
**Expect Lighting.**

#### **OUTPUTS**

##### **FIRE BEHAVIOR:**

Fire behavior has dropped off significantly with aggressive suppression operations and the cooperation of the weather. Mop up operations will continue over the next several days. The major wild card for today will be the development of thunderstorms over the fire area. All hazards associated with thunderstorms will be over the fire with potential for down bursts, rainfall, and lightning. All of these may occur alone or together as the day wears on. Be prepared for any situation.

The fire continues interior burn out and numerous hot spots remain in close enough proximity to control lines to cause spotting or isolated runs from downdrafts. Remember, parts of the fire remain active as the fire continues to be wind tested.

**Fuels:** The Day Fire is burning primarily in commercial mixed conifer timber stands actively managed for timber production. Light to moderate slash accumulations as well as piles can be found throughout the fire area. All live fuels are under drought stress with live fuel moisture values at levels well below normal.

**Topography:** Topography ranges from moderately steep to flat with most of the fire area generally dominated by mild slopes.

##### **SPECIFIC:**

Mop up operations are in full force across most of the fire. This is the phase of the operation where most injuries tend to occur. Watch out for Fire damaged trees and hot stump holes.

Divisions C, H, & S: Fire suppression operations are in the final stages and these were the last areas with active fire. This will be the area with the highest potential for control issues as the thunderstorms develop, mature, and collapse.

Divisions V, W, X, & A: Low intensity fire behavior is expected in these divisions. Remember thunderstorm collapse can cause even the quietest fire to come to life.

##### **AIR OPERATIONS:**

Smoky conditions will hamper Air operations all morning and will not completely clear out until around noon.

##### **SAFETY:**

**Monitor the fire area for the development of thunderstorms after 1200 hrs. Downdrafts and all the other hazards related to thunderstorm development will be over the fire. Watch out for fire damaged trees, hot stump holes, and spot fires outside the line.**





# CAL FIRE INCIDENT MANAGEMENT TEAM 3



<b>SAFETY MESSAGE</b>	<b>1. INCIDENT NAME:</b>	<b>2. DATE PREPARED:</b>	<b>3. TIME PREPARED:</b>
	DAY	August 4, 2014	1400
<b>4. PREPARED BY:</b>	<b>5. LEADER NAME:</b>		<b>6. OPERATIONAL PERIOD:</b>
Curtis Brown	Curtis Brown SOF1		8-5-2014 0700 TO 8-6-2014 0700

# SAFETY MESSAGE

## com·pla·cen·cy

1. a feeling of security, often while unaware of some potential danger, defect, or the like; self-satisfaction with an existing situation, condition, etc.

- Watch for sudden windshifts, rain, lightning, or hail due to Thunderstorm activity.
- There's no glory in getting hurt during mop up, keep your safety and the safety of your crews as a top priority.
- Stay at least 100 feet away from the train tracks.
- Be aware of what is happening around you (SA) and adapt your exit strategy accordingly.
- Trees are weakened due to fire activity. Look Up, Down, and Around for tree hazards.
- Wetting rain WILL cause the roadways to become slick. DRIVE SLOW!
- Establish COMMUNICATIONS and report any coverage issues to your line supervisor.
- Document 2:1 rest and hydration on 214's. Take frequent breaks!!!
- Beware of stump-holes, steep slopes, trip hazards, and loose footing.

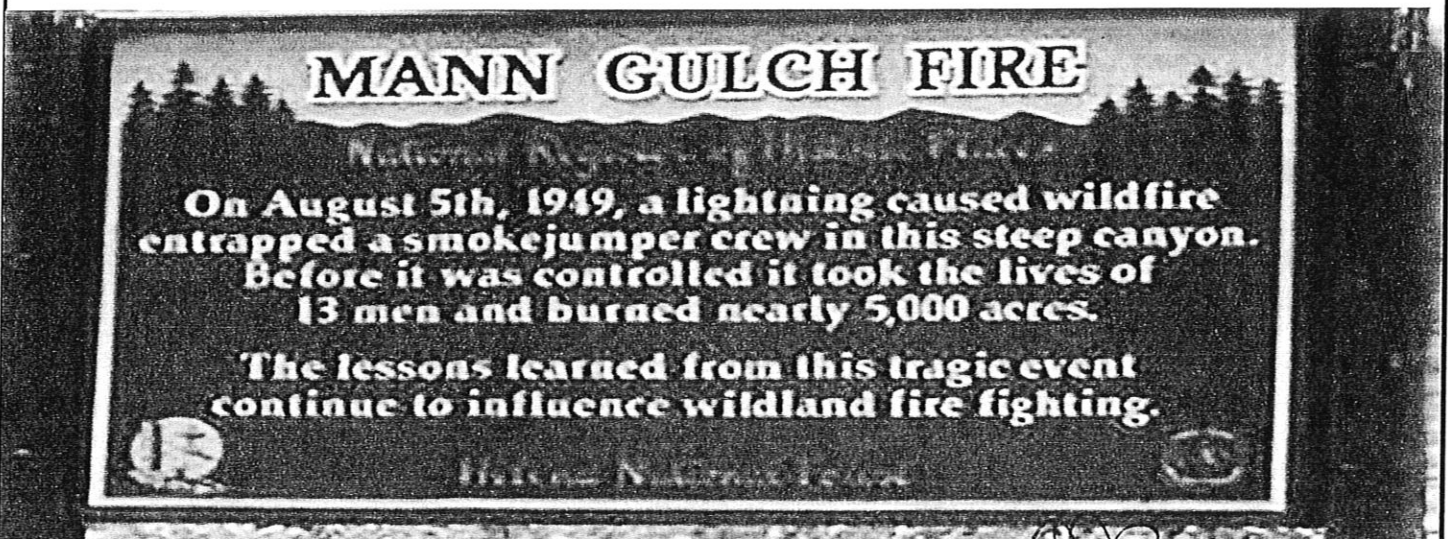

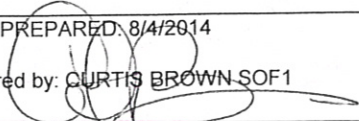

**INCIDENT RISK ANALYSIS (ICS 215A)**

DIV	HAZARDOUS ACTIONS / CONDITIONS	MITIGATIONS/WARNINGS/REMEDIES
ALL	DRIVING HAZARDS/ ROADS	<ul style="list-style-type: none"> <li>• Drive defensively! SLOW DOWN!!!!</li> <li>• Increase following distances on dusty roads. Slow down when you meet opposing traffic. Be alert for construction work on Highway 299.</li> <li>• Drive with headlights on.</li> <li>• Be alert for wildlife, heavy trucks, &amp; high speed opposing traffic crossing into your lane.</li> <li>• Check traffic approaching behind you when making left turns.</li> <li>• Maintain Situational Awareness.</li> </ul>
ALL	FATIGUE	<ul style="list-style-type: none"> <li>• Be alert for signs of fatigue and take breaks as necessary.</li> <li>• Maintain 2:1 work/rest ratio.</li> <li>• Monitor incoming resources for level of fatigue.</li> </ul>
ALL	RED FLAG WARNING	<ul style="list-style-type: none"> <li>• Ensure situational awareness</li> <li>• Establish LCES</li> </ul>
ALL	SNAGS/ FIRE-WEAKENED TREE HAZARDS	<ul style="list-style-type: none"> <li>• Follow Hazard Tree Safety Guidelines (IRPG p. 20 (RED)).</li> <li>• Many of the trees within the fire area are weakened due to fire activity.</li> <li>• Be especially alert around snags during wind events.</li> </ul>
ALL	TRAINS	<ul style="list-style-type: none"> <li>• Stay 100' away from track at all times.</li> <li>• Use caution when crossing track. LOOK both ways.</li> </ul>
ALL	MEDIVAC	<ul style="list-style-type: none"> <li>• Assign personnel with Advanced Life Support capability on the line.</li> <li>• Cache emergency equipment (backboards etc.) in various locations on line.</li> <li>• Maintain ALS ambulance at DROP POINT 23.</li> <li>• Keep line personnel informed of this issue. Safety briefings to stress that extra care should be taken with high-risk tasks (i.e. tree falling, chainsaw use, etc.).</li> <li>• Supervisors insure that personnel with severe reaction to bee sting, etc. have "epi-kits" or consider leaving such individuals in camp.</li> </ul>
ALL	THUNDERSTORM/ FLASH FLOODING	<ul style="list-style-type: none"> <li>• Follow Thunderstorm Safety Precautions in IAP</li> </ul>
ALL	MOP UP	<ul style="list-style-type: none"> <li>• Conduct thorough briefing for all personnel (inside rear cover IRPG).</li> <li>• Use all required PPE, including eye protection.</li> <li>• Maintain proper spacing and overhead clearance.</li> <li>• Be alert for stump holes and root cavities.</li> <li>• Minimize exposure to smoke, and rotate personnel into clean as practical.</li> <li>• Evaluate unburned islands/Increase situational awareness.</li> </ul>
Incident Name  <b>DAY</b>  ICS 215A	DATE PREPARED: 8/4/2014  Prepared by:  <b>CURTIS BROWN-SOF1</b>	OPERATIONAL PERIOD 0700-0700 8/5-6/2014



# DEMOB SAFETY MESSAGE

## DAY INCIDENT

On Behalf of the IMT3 we would like to thank you for your assistance. We wish you safe travels home or to your next assignment. Below are a few reminders to make your trip safer:

- ✓ Conduct walk around before driving
- ✓ Check and secure all loose items (ie: tools, hose, and packs)
- ✓ Wear seat belts at all times
- ✓ Monitor all drivers for fatigue
  - Switch drivers regularly if possible, if not find a safe place to stop, exit the vehicle and stretch
  - If all else fails, stop and take a short rest to revitalize
- ✓ Obey Posted Speed Limits
- ✓ Ensure personnel have adequate nutrition and hydration for the trip
- ✓ Be prepared to go to the next incident

Thank you again for your hard work!

Curtis Brown SOF1

Dave Sargenti SOF1(T)

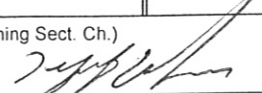

DIVISION ASSIGNMENT LIST			1. Branch I		2. Division/Group A (1 of 2)		
3. Incident Name <b>DAY</b>			4. Operational Period Date: <b>8/5/14-8/6/14</b> Time: <b>0700-0700</b>				
5. Operations Personnel							
Operations Chief		<b>Nick Truax</b>		Division/Group Supervisor		<b>Jeffrey Reyes</b> ✓	
Branch Director		<b>Abdul Ahmad</b> ✓		Branch Safety		<b>Brian Cordeiro</b> ✓	
6. Resources Assigned this Period							
Strike Team/Task Force/ Resource Designator	Leader	Number Persons	Trans. Needed	Drop Off PT./Time	Pick Up PT./Time		
STC LNU 9142C ✓	Jim Robbins	20		DP-10 @ 0900	0900		
STC XCA 4054C ✓	Scott Mullins	18		DP-10 @ 0900	0900		
ENG LNU 2267 ✓	Adam Cassarang	4		DP-10 @ 0900	0900		
STG CZU 9175G ✓	Mike Harris	33		DP-10 @ 0900	0900		
CRW LMU INT 4 ✓	Keith Evans	15		DP-10 @ 0900	0900		
DOZ PVT E-74 ✓	Kyle Kiser	2		DP-10 @ 0900	0900		
DOZ PVT E-88 ✓	Bob Cameron	1		DP-10 @ 0900	0900		
W/T PVT E-2 ✓	John Hay	2		DP-10 @ 0900	0900		
W/T PVT E-90 ✓	Jack Duncan	2		DP-10 @ 0900	0900		
W/T PVT E-91 ✓	Kyle Mendine	2		DP-10 @ 0900	0900		
W/T PVT E-95 ✓	Dan Brady	2		DP-10 @ 0900	0900		
W/T PVT E-96 ✓	Ron Belion	2		DP-10 @ 0900	0900		
7. Control Operations							
<b>Mop up and patrol for 300' inside the line.</b> <b>Patrol for spot fires in the green.</b> <b>Backhaul all trash.</b>							
8. Special Instructions							
<b>SOFRs are assigned throughout the Branch.</b> <b>Branches will be working for 12 hours only.</b> <b>A designated DIVS will assume branch coverage at night.</b>							
<i>*FOBS may be working throughout the division. FOBS shall check in &amp; out with DIVS as they enter or leave the division.</i>							
9. Division/Group Communication Summary							
Function	Frequency	System	Channel	Function	Frequency	System	Channel
Command	RX 168.0750 TX 170.4250		NIFC CMD 3 TONE 3	Air to Ground	RX/TX 159.3525		CDF TAC 25
Tactical Div/Group	RX/TX 154.2875		VFIRE 25	Air Guard	RX/TX 168.6250		AIR GUARD
Prepared by (Resource Unit Leader) Shane Sherwood 			Approved by (Planning Sect. Ch.) Jeff Adams 		Date 8/4/14		Time 2300

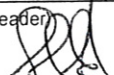
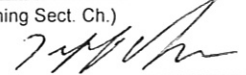
DIVISION ASSIGNMENT LIST			1. Branch I		2. Division/Group A (2 of 2)			
3. Incident Name DAY			4. Operational Period Date: <b>8/5/14-8/6/14</b> Time: <b>0700-0700</b>					
5. Operations Personnel								
Operations Chief		Nick Truax		Division/Group Supervisor		Jeffrey Reyes		
Branch Director		Abdul Ahmad		Branch Safety		Brian Cordeiro		
6. Resources Assigned this Period								
Strike Team/Task Force/ Resource Designator	Leader		Number Persons	Trans. Needed	Drop Off PT./Time		Pick Up PT./Time	
W/T PVT E-257 ✓	Nathan Orsi		2		DP-10 @ 0900		0900	
DOZB O-156 ✓	Curtis Nagel		1		DP-10 @ 0900		0900	
7. Control Operations Mop up and patrol for 300' inside the line. Patrol for spot fires in the green. Backhaul all trash.								
8. Special Instructions *See FOBS note SOFRs are assigned throughout the Branch. Branches will be working for 12 hours only. A designated DIVS will assume branch coverage at night.								
9. Division/Group Communication Summary								
Function	Frequency	System	Channel		Function	Frequency	System	Channel
Command	RX 168.0750 TX 170.4250		NIFC CMD 3 TONE 3		Air to Ground	RX/TX 159.3525		CDF TAC 25
Tactical Div/Group	RX/TX 154.2875		VFIRE 25		Air Guard	RX/TX 168.6250		AIR GUARD
Prepared by (Resource Unit Leader) Shane Sherwood 			Approved by (Planning Sect. Ch.) Jeff Adams 			Date 8/4/14		Time 2300

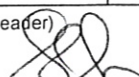
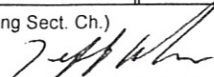

DIVISION ASSIGNMENT LIST				1. Branch <b>I</b>		2. Division/Group <b>C</b>	
3. Incident Name <b>DAY</b>				4. Operational Period Date: <b>8/5/14-8/6/14</b> Time: <b>0700-0700</b>			
5. Operations Personnel							
Operations Chief		<b>Nick Truax</b>		Division/Group Supervisor		<b>Dave Munch</b> ✓	
Branch Director		<b>Abdul Ahmad</b>		Branch Safety		<b>Brian Cordeiro</b>	
6. Resources Assigned this Period							
Strike Team/Task Force/ Resource Designator	Leader	Number Persons	Trans. Needed	Drop Off PT./Time	Pick Up PT./Time		
STC XNE 4102C ✓	Clint Carson	20		DP-13 @ 0900	0900		
STC X CZ 2326C ✓	Jim Delucchi	20		DP-13 @ 0900	0900		
STC TCU 9440C ✓	Landon Haack	17		DP-13 @ 0900	0900		
STG LNU 9146G ✓	Mike Crosby	34		DP-13 @ 0900	0900		
STG LNU 9147G ✓	John Layton	29		DP-13 @ 0900	0900		
W/T PVT E-94 ✓	Cody Penry	2		DP-13 @ 0900	0900		
W/T PVT E-97 ✓	Robbie Keene	2		DP-13 @ 0900	0900		
W/T PVT E-101 ✓	John Hill	2		DP-13 @ 0900	0900		
W/T LOO E-213 ○	Al Warden	1		DP-13 @ 0900	0900		
FEMP O-285 ✓	Dave Martinelli	1		DP-13 @ 0900	0900		
FEMT O-90 ✓	Carlos Munoz	1		DP-13 @ 0900	0900		
7. Control Operations							
<b>Mop up and patrol for 300' inside the line.</b> <b>Patrol for spot fires in the green.</b> <b>Backhaul all trash.</b>							
8. Special Instructions <i>* See FOBS note</i>							
<b>SOFRs are assigned throughout the Branch.</b> <b>Branches will be working for 12 hours only.</b> <b>A designated DIVS will assume branch coverage at night.</b>							
9. Division/Group Communication Summary							
Function	Frequency	System	Channel	Function	Frequency	System	Channel
Command	RX 168.0750 TX 170.4250		NIFC CMD 3 TONE 3	Air to Ground	RX/TX 159.3525		CDF TAC 25
Tactical Div/Group	RX/TX 154.2725		VFIRE 24	Air Guard	RX/TX 168.6250		AIR GUARD
Prepared by (Resource Unit Leader) Shane Sherwood <i>SS</i>		Approved by (Planning Sect. Ch.) Jeff Adams <i>JA</i>			Date 8/4/14		Time 2300

DIVISION ASSIGNMENT LIST		1. Branch I		2. Division/Group H			
3. Incident Name <b>DAY</b>		4. Operational Period Date: <b>8/5/14-8/6/14</b> Time: <b>0700-0700</b>					
5. Operations Personnel							
Operations Chief	Nick Truax		Division/Group Supervisor	Tim Cordero ✓			
Branch Director	Abdul Ahmad		Branch Safety	Brian Cordeiro			
6. Resources Assigned this Period							
Strike Team/Task Force/ Resource Designator	Leader	Number Persons	Trans. Needed	Drop Off PT./Time	Pick Up PT./Time		
STC MMU 9420C ✓	Michael Surber	19		DP-25 @ 0900	0900		
STC 9260C ✓	<b>SCOTT TAVALERO</b>	<b>19</b>		DP-25 @ 0900	0900		
STC CZU 9171C ✓	Aldo Gonzalez	20		DP-25 @ 0900	0900		
STC XSC 2310C ✓	Gary Cocroft	22		DP-25 @ 0900	0900		
STG LMU 9221G ✓	Jeff Lee	36		DP-25 @ 0900	0900		
W/T PVT E-99 ✓	Robert Ferde	2		DP-25 @ 0900	0900		
W/T PVT E-100 ✓	Charles Rainey	2		DP-25 @ 0900	0900		
W/T PVT E-105 ✓	Randy May	2		DP-25 @ 0900	0900		
W/T PVT E-254 ✓	Josh heller	2		DP-25 @ 0900	0900		
W/T PVT E-258 ○	Doug Graham	1		DP-25 @ 0900	0900		
FALM <b>0-369</b> ✓	<b>JASON DAUGHERTY</b>	<b>2</b>		DP-25 @ 0900	0900		
FEMT O-178 ✓	Eric Jones	1		DP-25 @ 0900	0900		
FEMT O-300 ✓	Jeremy Wright	1		DP-25 @ 0900	0900		
7. Control Operations <b>* See FOBS note</b> <b>Mop up and patrol for 300' inside the line.</b> <b>Patrol for spot fires in the green.</b> <b>Backhaul all trash.</b>							
8. Special Instructions <b>SOFRs are assigned throughout the Branch.</b> <b>Branches will be working for 12 hours only.</b> <b>A designated DIVS will assume branch coverage at night.</b>							
9. Division/Group Communication Summary							
Function	Frequency	System	Channel	Function	Frequency	System	Channel
Command	RX 168.0750 TX 170.4250		NICF CMD 3 TONE 3	Air to Ground	RX/TX 159.3525		CDF TAC 25
Tactical Div/Group	RX/TX 154.3025		VFIRE 26	Air Guard	RX/TX 168.6250		AIR GUARD
Prepared by (Resource Unit Leader) Shane Sherwood 		Approved by (Planning Sect. Ch.) Jeff Adams 		Date 8/4/14		Time 2300	

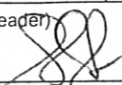
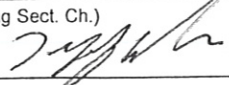

<b>DIVISION ASSIGNMENT LIST</b>			1. Branch <b>II</b>		2. Division/Group <b>S (1 of 2)</b>			
3. Incident Name <b>DAY</b>			4. Operational Period Date: <b>8/5/14-8/6/14</b> Time: <b>0700-0700</b>					
<b>5. Operations Personnel</b>								
Operations Chief		<b>Nick Truax</b>		Division/Group Supervisor		<b>Dennis Nolan</b> ✓		
Branch Director		<b>Jeffrey Johnson</b> ✓ <b>Josh Campbell (T)</b> ✓		Branch Safety		<b>John Strickland</b> ✓		
<b>6. Resources Assigned this Period</b>								
Strike Team/Task Force/ Resource Designator	Leader		Number Persons	Trans. Needed	Drop Off PT./Time		Pick Up PT./Time	
STC XPL 9128C ✓	Darren Mcmillin		22		DP-25 @ 0900		0900	
STC XGL 3050C ✓	Scott Blake		17		DP-25 @ 0900		0900	
STG TGU 9257G ✓	Jeff Gowan		37		DP-25 @ 0900		0900	
STG LAC 1184G ✓	Patrick Sprengel		33		DP-25 @ 0900		0900	
DOV PVT E-57 ✓	Wayne Norris		2		DP-25 @ 0900		0900	
W/T PVT E-92 ✓	Marty Learn		2		DP-25 @ 0900		0900	
W/T PVT E-98 ✓	Bruce Thomas		2		DP-25 @ 0900		0900	
W/T PVT E-252 ✓	Ron Ron		2		DP-25 @ 0900		0900	
W/T PVT E-255 ✓	Jim Godby		2		DP-25 @ 0900		0900	
<b>7. Control Operations</b>								
<b>Mop up and patrol for 300' inside the line.</b>								
<b>Patrol for spot fires in the green.</b>								
<b>Backhaul all trash.</b>								
<b>8. Special Instructions * See FOBS note</b>								
<b>SOFRs are assigned throughout the Branch.</b>								
<b>Branches will be working for 12 hours only.</b>								
<b>A designated DIVS will assume branch coverage at night.</b>								
<b>9. Division/Group Communication Summary</b>								
Function	Frequency	System	Channel		Function	Frequency	System	Channel
Command	RX 168.0750 TX 170.4250		NIFC CMD 3 TONE 3		Air to Ground	RX/TX 159.3525		CDF TAC 25
Tactical Div/Group	RX/TX 151.1375		VTAC 11		Air Guard	RX/TX 168.6250		AIR GUARD
Prepared by (Resource Unit Leader) <b>Shane Sherwood</b> 			Approved by (Planning Sect. Ch.) <b>Jeff Adams</b> 			Date <b>8/4/14</b>		Time <b>2300</b>

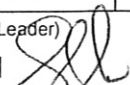
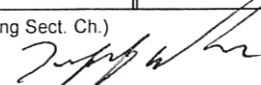
DIVISION ASSIGNMENT LIST			1. Branch <b>II</b>		2. Division/Group <b>S (2 of 2)</b>			
3. Incident Name <b>DAY</b>			4. Operational Period Date: <b>8/5/14-8/6/14</b> Time: <b>0700-0700</b>					
5. Operations Personnel								
Operations Chief		<b>Nick Truax</b>		Division/Group Supervisor		<b>Dennis Nolan</b>		
Branch Director		<b>Jeffrey Johnson Josh Campbell (T)</b>		Branch Safety		<b>John Strickland</b>		
6. Resources Assigned this Period								
Strike Team/Task Force/ Resource Designator	Leader		Number Persons	Trans. Needed	Drop Off PT./Time		Pick Up PT./Time	
<b>FALM 0-370</b>	<b>RICHARD KERSH</b>		<b>2</b>		<b>DP-25 @ 0900</b>		<b>0900</b>	
<b>FEMP O-286</b> ✓	<b>Kevin Berkery</b>		<b>1</b>		<b>DP-25 @ 0900</b>		<b>0900</b>	
<b>FEMT O-298</b> ✓	<b>Daniel Park</b>		<b>1</b>		<b>DP-25 @ 0900</b>		<b>0900</b>	
7. Control Operations <b>Mop up and patrol for 300' inside the line.</b> <b>Patrol for spot fires in the green.</b> <b>Backhaul all trash.</b>								
8. Special Instructions <b>* See FOBS note</b> <b>SOFRs are assigned throughout the Branch.</b> <b>Branches will be working for 12 hours only.</b> <b>A designated DIVS will assume branch coverage at night.</b>								
9. Division/Group Communication Summary								
Function	Frequency	System	Channel		Function	Frequency	System	Channel
Command	<b>RX 168.0750 TX 170.4250</b>		<b>NIFC CMD 3 TONE 3</b>		Air to Ground	<b>RX/TX 159.3525</b>		<b>CDF TAC 25</b>
Tactical Div/Group	<b>RX/TX 151.1375</b>		<b>VTAC 11</b>		Air Guard	<b>RX/TX 168.6250</b>		<b>AIR GUARD</b>
Prepared by (Resource Unit Leader) <b>Shane Sherwood</b> 			Approved by (Planning Sect. Ch.) <b>Jeff Adams</b> 			Date <b>8/4/14</b>		Time <b>2300</b>

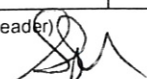
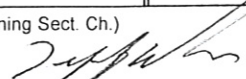

DIVISION ASSIGNMENT LIST			1. Branch <b>II</b>		2. Division/Group <b>V</b>			
3. Incident Name <b>DAY</b>			4. Operational Period Date: <b>8/5/14-8/6/14</b> Time: <b>0700-0700</b>					
5. Operations Personnel								
Operations Chief		<b>Nick Truax</b>		Division/Group Supervisor		<b>Ken Kuykendall</b> ✓		
Branch Director		<b>Jeffrey Johnson</b> <b>Josh Campbell (T)</b>		Branch Safety		<b>John Strickland</b>		
6. Resources Assigned this Period								
Strike Team/Task Force/ Resource Designator	Leader		Number Persons	Trans. Needed	Drop Off PT./Time		Pick Up PT./Time	
STC XSA 4156C ✓	Ken Kuykendall		22		DP-23 @ 0900		0900	
STG NEU 9231G ✓	Bryan Farrell		33		DP-23 @ 0900		0900	
W/T ADI 4730 ✓	Paul Lemke		2		DP-23 @ 0900		0900	
W/T PVT E-293 ✓	Brain Sampson		3		DP-23 @ 0900		0900	
FEMT O-302 ✓	Brain Solidum		1		DP-23 @ 0900		0900	
FEMT O-304 ✓	Bill Clark		1		DP-23 @ 0900		0900	
7. Control Operations								
<b>Mop up and patrol for 300' inside the line.</b> <b>Patrol for spot fires in the green.</b> <b>Backhaul all trash.</b>								
8. Special Instructions <i>* See FOBS note</i>								
<b>SOFRs are assigned throughout the Branch.</b> <b>Branches will be working for 12 hours only.</b> <b>A designated DIVS will assume branch coverage at night.</b>								
9. Division/Group Communication Summary								
Function	Frequency	System	Channel		Function	Frequency	System	Channel
Command	RX 168.0750 TX 170.4250		NIFC CMD 3 TONE 3		Air to Ground	RX/TX 159.3525		CDF TAC 25
Tactical Div/Group	RX/TX 154.2950		VFIRE 23		Air Guard	RX/TX 168.6250		AIR GUARD
Prepared by (Resource Unit Leader) Shane Sherwood <i>SS</i>			Approved by (Planning Sect. Ch.) Jeff Adams <i>JA</i>			Date 8/4/14		Time 2300

DIVISION ASSIGNMENT LIST			1. Branch <b>II</b>		2. Division/Group <b>W/X</b>			
3. Incident Name <b>DAY</b>			4. Operational Period Date: <b>8/5/14-8/6/14</b> Time: <b>0700-0700</b>					
5. Operations Personnel								
Operations Chief		Nick Truax		Division/Group Supervisor		Don Lacy ✓		
Branch Director		Jeffrey Johnson Josh Campbell (T)		Branch Safety		John Strickland		
6. Resources Assigned this Period								
Strike Team/Task Force/ Resource Designator	Leader		Number Persons	Trans. Needed	Drop Off PT./Time		Pick Up PT./Time	
STC XSH 3151C ✓	Don Lacy		18		DP-23 @ 0900		0900	
STG TCU 9476G ✓	Adam Ambriz		35		DP-23 @ 0900		0900	
W/T PVT E-256 ✓	Jeremy Fisher		2		DP-23 @ 0900		0900	
W/T PVT E-104 ✓	Randy Auker		2		DP-23 @ 0900		0900	
7. Control Operations <b>Mop up and patrol for 300' inside the line.</b> <b>Patrol for spot fires in the green.</b> <b>Backhaul all trash.</b>								
8. Special Instructions <i>* See FOBS note</i> <b>SOFRs are assigned throughout the Branch.</b> <b>Branches will be working for 12 hours only.</b> <b>A designated DIVS will assume branch coverage at night.</b>								
9. Division/Group Communication Summary								
Function	Frequency	System	Channel		Function	Frequency	System	Channel
Command	RX 168.0750 TX 170.4250		NIFC CMD 3 TONE 3		Air to Ground	RX/TX 159.3525		CDF TAC 25
Tactical Div/Group	RX/TX 154.4525		VTAC 12		Air Guard	RX/TX 168.6250		AIR GUARD
Prepared by (Resource Unit Leader) Shane Sherwood 			Approved by (Planning Sect. Ch.) Jeff Adams 			Date 8/4/14		Time 2300

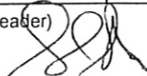
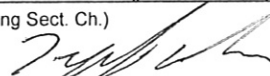

DIVISION ASSIGNMENT LIST			1. Branch	2. Division/Group <b>FIRE SUPPRESSION REPAIR (1 of 2)</b>			
3. Incident Name <b>DAY</b>			4. Operational Period Date: <b>8/5/14-8/6/14</b> Time: <b>0700-0700</b>				
5. Operations Personnel							
Operations Chief	<b>Nick Truax</b>		Group Supervisor		<b>Don Schroeder (T)</b> <b>MIKE ROSAN</b>		
Branch Director			Branch Safety				
6. Resources Assigned this Period							
Strike Team/Task Force/ Resource Designator	Leader	Number Persons	Trans. Needed	Drop Off PT./Time	Pick Up PT./Time		
DOZ PVT E-82* ✓	John Hertzig	2		0900	0900		
DOZ PVT E-168* ✓	Brian Forker	2		0900	0900		
DOZ PVT E-173* ✓	Mark Garner	2		0900	0900		
DOZ PVT E-176* ✓	Angelo Cattaneo	2		0900	0900		
DOZ PVT E-181* ✓	Sunny Moore	2		0900	0900		
W/T PVT E-1* ✓	Wes Hutchens	2		0900	0900		
W/T PVT E-93* ✓	Bryan Troedez	2		0900	0900		
W/T PVT E-102* ✓	Doug Hill	2		0900	0900		
W/T PVT E-103* ✓	Jeff Graham	2		0900	0900		
7. Control Operations							
<b>Fire suppression repair to be done per the Fire Suppression Repair Plan.</b> <i>Check in and out with DIVS as you enter and leave divisions.</i>							
8. Special Instructions							
<b>*Denotes a 12 hour resource</b> <i>Ene</i>							
9. Division/Group Communication Summary							
Function	Frequency	System	Channel	Function	Frequency	System	Channel
Command	RX 168.0750 TX 170.4250		NIFC CMD 3 TONE 3	Air to Ground	RX/TX 159.3525		CDF TAC 25
Tactical Div/Group	RX/TX 158.7375		VTAC 13	Air Guard	RX/TX 168.6250		AIR GUARD
Prepared by (Resource Unit Leader) Shane Sherwood <i>SS</i>			Approved by (Planning Sect. Ch.) Jeff Adams <i>JA</i>		Date 8/4/14		Time 2300

DIVISION ASSIGNMENT LIST			1. Branch	2. Division/Group <b>FIRE SUPPRESSION REPAIR (2 of 2)</b>			
3. Incident Name <b>DAY</b>			4. Operational Period Date: <b>8/5/14-8/6/14</b> Time: <b>0700-0700</b>				
5. Operations Personnel							
Operations Chief		<b>Nick Truax</b>		Group Supervisor		<b>Don Schroeder (T)</b> <b>MIKE ROSAN</b>	
Branch Director				Branch Safety			
6. Resources Assigned this Period							
Strike Team/Task Force/ Resource Designator	Leader	Number Persons	Trans. Needed	Drop Off PT./Time	Pick Up PT./Time		
FOBS (T) O-313* ✓	Joshua Potter	1		0900	0900		
FOBS O-172* ✓	Gary Whitson	1		0900	0900		
<del>FOBS O-122*</del>	<del>Keith Dietz</del>	1		0900	0900		
FOBS O-171* ✓	Mike Rosan	1		0900	0900		
FOBS O-120* ✓	Emma Lauriston	1		0900	0900		
FOBS (T) O-229* ✓	Joshua Block	1		0900	0900		
<b>FOBS O-121*</b>	<b>JOHN CLARK</b>	<b>1</b>					
7. Control Operations <b>Fire suppression repair to be done per the Fire Suppression Repair Plan.</b> <b>O-122 Assigned to SITL</b> <b>Check in and out with DIVS as you enter and leave divisions</b>							
8. Special Instructions <b>*Denotes a 12 hour resource</b>							
9. Division/Group Communication Summary							
Function	Frequency	System	Channel	Function	Frequency	System	Channel
Command	RX 168.0750 TX 170.4250		NIFC CMD 3 TONE 3	Air to Ground	RX/TX 159.3525		CDF TAC 25
Tactical Div/Group	RX/TX 158.7375		VTAC 13	Air Guard	RX/TX 168.6250		AIR GUARD
Prepared by (Resource Unit Leader) Shane Sherwood 			Approved by (Planning Sect. Ch.) Jeff Adams 		Date 8/4/14		Time 2300



# AIR OPERATIONS SUMMARY 220

PREPARED BY: Matt Stanford

DATE: 8/04/2014

<b>1. INCIDENT NAME:</b> Day <b>3. REMARKS</b> (Safety Notes, Flight-Hazards, Other Hazards, Air Operations, and Special Equipment, etc.): Smokey Conditions *Numerous fires in the area *Joint helibase at Fall River Airport 1 frequency *All helos lat/long and report dip sites and gals. *Use travel routes established for each fire. * MET Towers (see 2 <sup>nd</sup> page). Fall River Unicom 122.8.	<b>2. OPERATIONAL DATE:</b> 08/05/2014 <b>4. AIR RESCUE AIRCRAFT:</b> H-202 Day time <i>Activation Instructions:</i> CANG H-826 Available 24/7 @ Redding Airport. Order rescue helicopter through communications. They will relay to Susanville ECC.	<b>SUNRISE:</b> 0700 <b>SUNSET:</b> 1952 <b>5. TFR/91.137:</b> Radius: <b>NM</b> Altitude: <b>MSL</b> Center Point: Latitude: Longitude:	
Helibase(s) Name: Fall River      Lat./Long: 41 02.5      121 26.05 Lat./Long:		<b>3b. Helispots:</b> Burney SO Sub Station 40 53.112 X 121 40.158 T-3 only	
<b>3a. Water Points:</b> See Page 2			
<b>6. PERSONNEL</b>			
	Name	Telephone	Cellular
AOBD	John Richardson		805-9033403
ASGS	Matt Stanford		951-5458205
ASGS	Shem Hawkins (T)		650-2451717
ATGS	TBD		
ATGS (Relief)	Greg Bertelli/J Collins		858-3536261
HEBM			
HELCO			
DECK			
TOLC			
AGENCY AIRCRAFT DISPATCH OFFICE			
AGENCY AVIATION MILITARY LIAISON	Tim Stepanovich		323-8195369
CANG	Alex Lujan		530-9250934
<b>8. PERSONNEL ON ORDER:</b>			
<b>SEE INCIDENT RADIO COMMUNICATIONS PLAN (205) FOR ALL OTHER FREQUENCIES!</b>			
<b>9. FIXED WING:</b>			
Leadplane(s):	Identifier	Base	
Tanker(s): 2			
I:		Type	
II:		Helitanker(s):	
III:		I: 3	Guard 821, 822, 833
IV:		II: 1	202
		III: 1	Guard 00,
		IV:	
<b>10. ROTOR WING:</b>			
<b>11. SPECIAL ASSIGNED EQUIPMENT:</b>			
AIRCRAFT RESCUE FIRE FIGHTERS 1, on site at Fall River helibase(s). Helibase dust abatement Water Tender(s) 2-Fall River at helibase(s).			
<b>12. EQUIPMENT ON ORDER:</b>			
ICS-220A (January 2001)			

13. TASKS/MISSION ASSIGNMENT (Type/Function includes: Air Tactical, Helicopter Coordinator, Fixed Wing: Retardant, Rotor Wing: Helitanker: Retardant/Foam, Rotor Wing: Retardant and or Foam, Personnel & Cargo Transport, Dip Site Locations and Names, Initial Attack and Air Rescue Helicopters, and Other.				
TYPE/FUNCTION	NAME OF PERSONNEL AND/OR CARGO INCLUDING INSTRUCTIONS FOR TACTICAL AIRCRAFT	MISSION START	FLY FROM	FLY TO
Air Tactical	Available upon request	0800	0800	1952
Helicopter Coordinator	Available with Guard ships 00	0900		
Fixed Wing: Retardant	Request through ATGS From RDD Chalk Mt. Then direct to the fire. IP: 40 59.47 X 121 48.51	0900	0900	1952
Helitanker: Retardant/Foam		0900		
Rotor Wing: Retardant/Foam	Request Water dropping R/W through Helibase or HLCO	0900		
Recon/Plans	All flights need to be requested through the AOB or ASGS. Try to combine flights.	0900		
Personnel Transport	Request through Helibase			
Cargo Transport	Request through Helibase			
Dip Site Names and Locations	Helicopter pilots, ATGS, and Helicos need to keep track of gallons taken and location South Dip: 41 13.26 x 121 22. 95 Taylor Dip 41 13.75 X 121 11.64 Roberts Dip 41 14:02 X 121 08.40			
Initial Attack Helicopter	Contact helibase and requests assets.			
Air Rescue Helicopter	H 202.. There will be a CANG helicopter for night rescues starting 8/2 available at RDD			
Other:	FAA Tower at Fall River Airport. **LARGE MET TOWERS-196' LOCATED NEAR EAGLE LAKE. #1 Slate Mt. #2 Sheepshead Mt., #3 Harvey They are not lit. Brief location at AAB and Helibase.			

ICS-220B (January 2001)



# INCIDENT RADIO COMMUNICATIONS PLAN

INCIDENT RADIO COMMUNICATIONS PLAN		Incident Name		Day Incident		Date/Time Prepared		Operational Period Date/Time			
Ch #	Function	Channel Name/Trunked Radio System Talkgroup	Assignment	RX Freq	N or W	RX Tone/NAC	TX Freq	N or W	TX Tone/NAC	Mode A, D or M	Remarks
1	Command	NIFC CMD 3	All Divisions	168.0750	N		170.4250	N	131.8 (3)	A	TONE 3
2											
3	Tactical	VFIRE 23	Div V	154.2950	N	156.7 (6)	154.2950	N	156.7 (6)	A	
4	Tactical	VFIRE 24	Div C	154.2725	N	156.7 (6)	154.2725	N	156.7 (6)	A	
5	Tactical	VFIRE 25	Div A	154.2875	N	156.7 (6)	154.2875	N	156.7 (6)	A	
6	Tactical	VFIRE 26	Div H	154.3025	N	156.7 (6)	154.3025	N	156.7 (6)	A	
7	Tactical	VTAC 11	Div S	151.1375	N	156.7 (6)	151.1375	N	156.7 (6)	A	
8	Tactical	VTAC 12	Div W / X	154.4525	N	156.7 (6)	154.4525	N	156.7 (6)	A	
9	Tactical	VTAC 13	Fire Sup Repair	158.7375	N	156.7 (6)	158.7375	N	156.7 (6)	A	
10	Tactical	VTAC 14	As Needed	159.4725	N	156.7 (6)	159.4725	N	156.7 (6)	A	
11	Air To Ground	CDF TAC 25	All Divisions	159.3525	N	192.8 (16)	159.3525	N	192.8 (16)	A	
12	Tactical	VFIRE 21	Unassigned	154.2800	N	156.7 (6)	154.2800	N	156.7 (6)	A	
13	Tactical	CALCORD	All Divisions	156.0750	N	156.7 (6)	156.0750	N	156.7 (6)	A	EMS ON INCIDENT
14											
15											
16	Emergency	Air Guard	All Branches	168.6250	N		168.6250	N	110.9 (1)	A	EMERGENCIES ONLY
17											
18											
19											
20	Emergency	Air Guard	All Branches	168.6250	N		168.6250	N	110.9 (1)	A	EMERGENCIES ONLY

Prepared By (Communications Unit)

*Kyle Johnson*

KYLE JOHNSON - COML TEAM 3

Incident Location

County Lassen & Modoc State CA Latitude N Longitude W

The convention calls for frequency lists to show four digits after the decimal place, followed by either an "N" or a "W", depending on whether the frequency is narrow or wide band. Mode refers to either "A" or "D" indicating analog or digital (e.g. Project 25) or "M" indicating mixed mode. All channels are shown as if programmed in a control station, mobile or portable radio. Repeater and base stations must be programmed with the Rx and Tx reversed.

<b>MEDICAL PLAN</b> <b>ICS 206</b>	1. INCIDENT NAME <b>Day Incident</b>	2. DATE PREPARED 08/04/2014	3. TIME PREPARED 1740	4. OPERATIONAL PERIOD 0700-0700 08/05/2014- 08/06/2014
---------------------------------------	---	--------------------------------	--------------------------	--

**5. INCIDENT MEDICAL AID STATIONS**

MEDICAL AID STATIONS	LOCATION	PARAMEDICS	
		YES	NO
Medical Unit	ICP Room 3		X

**6. TRANSPORTATION**

**A. AMBULANCE SERVICES**

NAME	LOCATION	PHONE	PARAMEDICS	
			YES	NO
Ground Amb. – Mayers 1	43563 Hwy 299E, Fall River Mills	530-336-5151	X	
Air Amb. – PHI Med	5900 Old Oregon Trail, Redding, CA 96002	800-597-9571	X	
Air Amb.–Mountain Life Flight	710 Ash St., Susanville, CA 96130	530-257-2444	X	

**B. INCIDENT AMBULANCES**

NAME	LOCATION	PARAMEDICS	
		YES	NO
Mayers 2 Ambulance	Drop Point 23/Widow Staging	X	

**7. HOSPITALS**

NAME	ADDRESS	TRAVEL TIME		PHONE	HELIPAD		BURN CENTER	
		AIR	GRND		YES	NO	YES	NO
Med Net Channel								
Mayers Memorial	43563 Hwy 299E, Fall River Mills	8 Min	20 Min	530-336-5511 x1144	X			X
Mercy Medial Center	2175 Rosaline Ave, Redding, CA	38 Min	75 Min.	530-225-7214	X			X
UC Davis Med Cnt	2315 Stockton Blvd. Sacramento	90 Min	4 Hr	916-734-3636	X		X	

**8. MEDICAL EMERGENCY PROCEDURES**

**LINE EMERGENCY:**

Crew Supervisor will contact **Division Supervisor** with patient complaint/condition and location.

- **Division/Group Supervisor contacts:**
  1. Closest EMS resource
  2. Communications Unit
- **Communications Unit contacts:**
  1. Ground or Air ambulance as requested
  2. Operations
  3. Safety
- **Division Supervisor or designee** will serve as point of contact and run medical emergency on assigned channel.
  1. **CALCORD** shall be used as the tactical frequency for IWI and only for duration of need.
- Communications Unit will clear command channel for emergency traffic as needed and only for duration of need.

**INJURY REPORTING PROCEDURES**

NATURE OF INJURY \_\_\_\_\_  
 LOCATION OF PATIENT \_\_\_\_\_  
 POINT OF CONTACT \_\_\_\_\_  
 TRANSPORTATION REQUESTED BY: AIR \_\_\_ GROUND \_\_\_  
 POINT OF PICKUP \_\_\_\_\_  
 LAT \_\_\_\_\_ LONG \_\_\_\_\_  
 PATIENT UNIT ID \_\_\_\_\_  
 IS AN EMT WITH PATIENT: YES \_\_\_ NO \_\_\_  
 AGE \_\_\_\_\_  
 SEX: MALE \_\_\_ FEMALE \_\_\_

**START RESOURCES EARLY – DON'T WAIT**

**ALL EMERGENCIES---Secure the area and identify witnesses for later investigation. Keep an accurate log of events.**

**ICS 206**  
(Rev 03/12)

9. PREPARED BY: (Medical Unit Leader)  
  
 Jorge H. Segura MEDL/Jeff Whitaker MEDL(T)

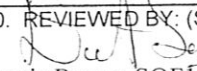
10. REVIEWED BY: (Safety Officer)  
  
 Curtis Brown SOFI/David Sargenti SOFI(T)



**COMMUNICATIONS UNIT**

<b>INCIDENT NAME:</b>	DAY
<b>INCIDENT NUMBER:</b>	CA-LMU-003472

**DATE:** 08/05/2014

COMMUNICATIONS	LINE 1	LINE 2	LINE 3	LINE 4	FAX
COM 24	(530) 262-2372	(530) 262-2985	(530) 949-6816	(530) 949-6817	(530) 355-2181
LMU EXPANDED	(530) 257-6424	(530) 257-6417			
LMU ECC DUTY OFFICER	(530) 310-2207				
LMU LINE OFFICER	(530) 310-2236				

UNIT	ROOM	LINE 1	LINE 1	LINE 1	FAX
SITUATION	17	(530) 335-4007			
CHECK-IN/DEMOB	16	(530) 335-2432			
RESOURCES		(530) 335-4862			
LIAISON		(530) 335-4896	(530) 335-3749		
SAFETY (24 HOURS)		(530) 335-6019	(707) 217-9278		
COST/TIME	18	(530) 355-5212			
FINANCE		(530) 335-3294			
PROCUREMENT		(530) 335-4210			
SUPPLY					(831) 265-4390
HELIBASE		(858) 353-6261			
AGENCY	NAME	LINE 1			FAX
SPI	Herb Baldwin	(530) 378-8111			

# **DAY FIRE**

## **Training Specialist Message**

### **08/05/14**

Incident Trainees; to document your progress on this assignment as a Trainee, please make sure you check in with us and also check out during demobilization. We are here to help you with your questions and documentation as it relates to USFS PMS 310-1, California CICC, and CAL FIRE HB4039.

According to our records the following identified trainees have not checked-in yet with the Training Specialist:

Bowden, Anthony  
Carroll, Chuck  
Cocroft, Gary  
Evans, Keith  
Kimpton, Jason

Lewis, Janet  
Manfred, Brent  
McMillin, Darren  
Meyer, Jeff  
Rueckheim, Matt

Walker, Brett  
Wallace, Ryan  
Wiley, Diondray  
Ybarra, Damian

If your name is on this list in error, please let us know.

**Mike Wink**  
**(707) 889-4225**  
**[mike.wink@fire.ca.gov](mailto:mike.wink@fire.ca.gov)**

**Rob Scott-Trainee**  
**(949)292-3207**  
**[Rob.Scott@lacity.org](mailto:Rob.Scott@lacity.org)**

TNSP is located in the back of room 16. Please feel free to contact us if you cannot come by in person.



OVERHEAD PARKING

P10



GISS CLERICAL COM RADIOS DES/MED

OPS/AIR OPS

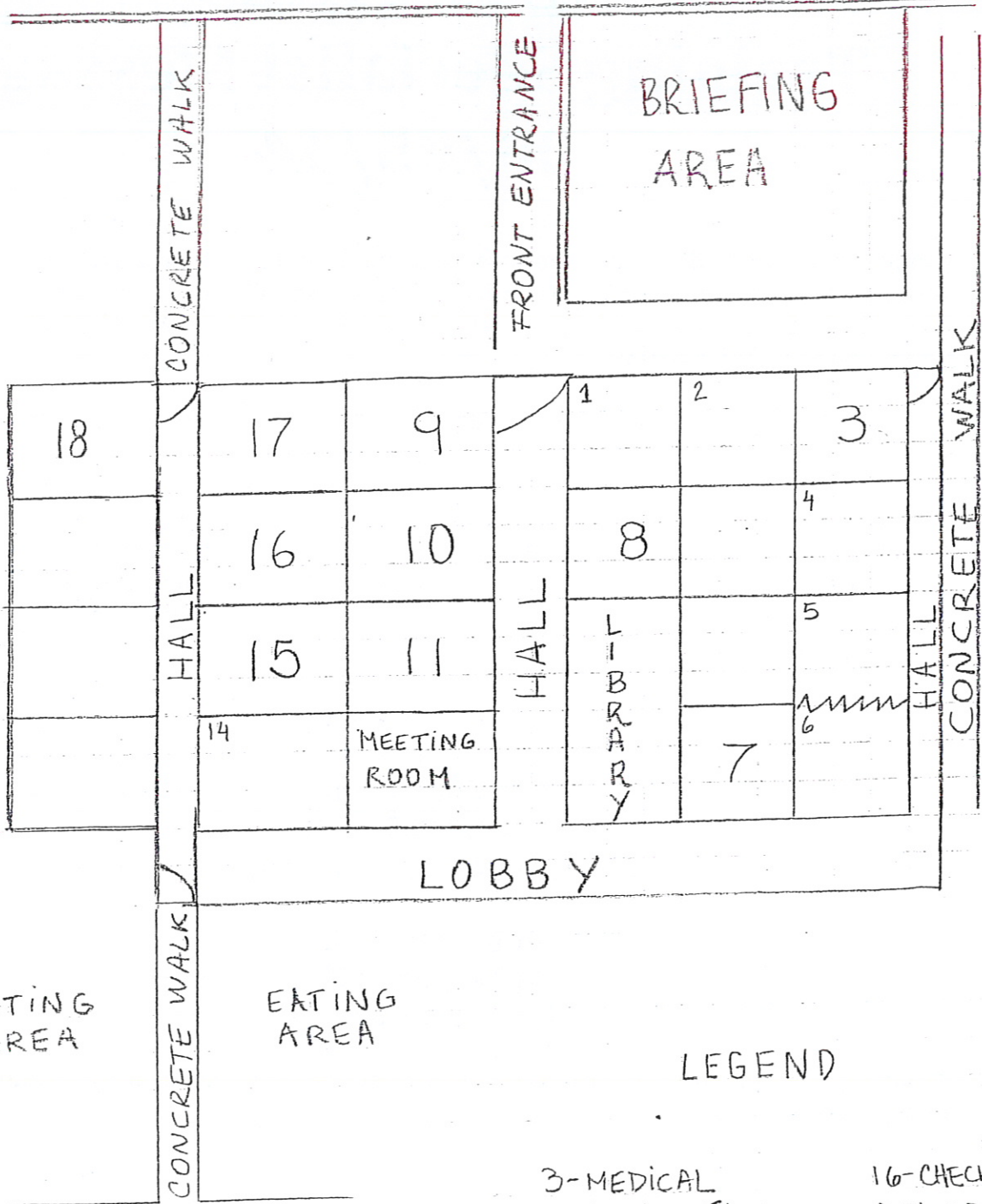

LEGEND

- 3-MEDICAL
- 7-LOGS-FACL
- 8-IC
- 9-SAFETY
- 10-DES REP-LIASON
- 11-PROC-FINANCE
- 15-MOTELS
- 16-CHECK-IN
- DEMOb-PLAN
- TRAINING
- RESOURCES
- 17-SIT-FBAN
- NICS
- 18-TIME-COST-EQ

MKU

NOT TO SCALE

## **Archaeological and Historic Properties Fireline Guidance for the Day Fire Modoc County, CA**

*Do not compromise safety for the protection and preservation of archaeological and historic properties. When possible and prudent:*

1. Be on the lookout for prehistoric archaeological sites. These sites may include seasonal camps marked by the presence of obsidian and/or basalt flakes and village sites that also include dark midden soils and perhaps circular housepit depressions. The Native American group living in the area at time of historic contact was the Achomawi.
2. Be on the lookout for historic archaeological sites. These sites may include old homesteads now marked by the presence of foundations, wells, and can dumps, early sawmill sites, abandoned ditches, and stacked rock foundation remains.
3. Look for these prehistoric and historic sites in flat areas, especially adjacent to streams and springs.
4. If you observe artifacts, features, or sites attempt to avoid if possible. If you can't avoid, minimize ground disturbance as much as possible, only clearing the surface to as minimal a depth as necessary. Try to go around sites with dozers rather than through them. Flag new sites if possible.
5. If you find artifacts leave them in place. Some artifacts may have been intentionally placed for religious or ceremonial reasons.
6. Note locations of discovered artifacts, features, and/or sites on a map. Better yet take a GPS reading if possible. Leave information for the archaeologist with the Plans Unit so that the sites can be relocated and protected during Fire Suppression Repair.
7. If you encounter a burial or other human remains, cease work in the area and contact Division immediately.



# FINANCE SECTION



## MESSAGE

**8/5/14**

**Please make sure hired equipment shift tickets are completed and dropped off in the Time Unit by agency personnel / line supervisors only.**

**Please report all injuries and suppression damage to the Comp / Claims Unit, no matter how minor. For fire suppression damage, please include photos (if possible), a location address and / or Lat / Long and a brief description.**

**Please use the water use forms included in the IAP and turn into Situation Unit.**

**All off site feeding charged to the incident must be pre-approved by the Logistics Section and/or Finance Section Chief. The Motel Tech Spec will have information on this.**

**ROGER RAINES, FSC1  
TERRY EASTWOOD, DEP. FSC1**

# SHIFT TICKET EXAMPLE

EMERGENCY SHIFT TICKET and EVALUATION FORM					Contractor Name		
The responsible Government Officer will complete this form each shift					Fireline Builders		
Incident or Project Name <b>Robbers</b>		Incident Number <b>CANEU 015060</b>	Request Number <b>E or S # Here</b>		Operator #1 <b>Bob Smith</b>	Operator #2 <b>Jeff Smith</b>	
Agreement Number <b>Obtain from vendor's agreement</b>					Operator Furnished By: <input checked="" type="checkbox"/> Contractor <input type="checkbox"/> Government		
Equipment Make <b>CAT</b>		Equipment Model / Type <b>D6H</b>			Operating Supplies Furnished By: <input checked="" type="checkbox"/> Contractor <input type="checkbox"/> Government		
Serial Number <b>6LN3344</b>		Licence Number				Equipment Status <input checked="" type="checkbox"/> Inspected <input checked="" type="checkbox"/> Under Agreement	
Equipment Use							
Date		(Circle) Hours / Days / Miles		Remarks/Comments **			
Mo / Day	Start	Stop	Work	Assignment			
7/18	0600	2400	16	Division B			
7/19	0001	0600	8	Division B			
Vendor Rating							
Poor*		Avg.	Good	Exc.	N/A		
Met Performance Expectations				Govt. Rep. Name and Position - PRINT <b>Mike Weber</b>			
Equipment in Safe Working Condition				Govt. Rep. Signature <i>Mike Weber</i>			
Operator Skill Level				Contractor Signature <i>Bob Smith</i>			
Operates Safely				Date <b>07/19/12</b>			
Operator's Cooperation Level				Time <b>0600</b>			
Overall Performance				CALFIRE 297 (Rev 3-2011)			
* NOTE: Any rating of POOR requires an explanation in Comment Section. **Final evaluation or for more documentation, use an ICS Form 230 or equivalent.							
Pink - Finance		Blue - Home Unit HE Coordinator		Yellow - Vendor		White - Govt Representative	

EMERGENCY SHIFT TICKET and EVALUATION FORM					Contractor Name		
The responsible Government Officer will complete this form each shift					Fireline Builders		
Incident or Project Name <b>Robbers</b>		Incident Number <b>CANEU 015060</b>	Request Number <b>E or S # Here</b>		Operator #1 <b>Bob Smith</b>	Operator #2	
Agreement Number <b>Obtain from vendor's agreement</b>					Operator Furnished By: <input checked="" type="checkbox"/> Contractor <input type="checkbox"/> Government		
Equipment Make <b>CAT</b>		Equipment Model / Type <b>D6H</b>			Operating Supplies Furnished By: <input checked="" type="checkbox"/> Contractor <input type="checkbox"/> Government		
Serial Number <b>6LN3344</b>		Licence Number				Equipment Status <input checked="" type="checkbox"/> Inspected <input checked="" type="checkbox"/> Under Agreement	
Equipment Use							
Date		(Circle) Hours / Days / Miles		Remarks/Comments **			
Mo / Day	Start	Stop	Work	Assignment			
7/18	0001	600	6	Off Shift			
7/18	0600	1800	12	Division B			
7/18	1800	2400	6	Off Shift			
Vendor Rating							
Poor*		Avg.	Good	Exc.	N/A		
Met Performance Expectations				Govt. Rep. Name and Position - PRINT <b>Mike Weber</b>			
Equipment in Safe Working Condition				Govt. Rep. Signature <i>Mike Weber</i>			
Operator Skill Level				Contractor Signature <i>Bob Smith</i>			
Operates Safely				Date <b>07/19/12</b>			
Operator's Cooperation Level				Time <b>0600</b>			
Overall Performance				CALFIRE 297 (Rev 3-2011)			
* NOTE: Any rating of POOR requires an explanation in Comment Section. **Final evaluation or for more documentation, use an ICS Form 230 or equivalent.							
Pink - Finance		Blue - Home Unit HE Coordinator		Yellow - Vendor		White - Govt Representative	

**Turn shift tickets into Finance.**

Contact Andy Whitlock for questions: 707-498-7545



## Fire Suppression Repair

### **Roads**

- Install waterbars where waterbars previously existed.
- Install new waterbars where needed.
- Install or maintain rolling dips where a rolling dip previously existed.
- Re-establish existing berms where applicable.
- Remove berms created by suppression activities to allow adequate drainage.
- Clean culverts plugged with debris and soil by suppression activities.
- Water roads for dust abatement.

### **Hand Lines and Dozer Lines**

Install waterbars as described in the guidelines below. Waterbars are designed to intercept, slow and spread precipitation run-off, reduce sediment transport and soil erosion. The intent is to move water off the fireline before it can build up enough energy to erode and transport sediment.

### **Waterbar Guidelines**

The following spacing distances should be used as a guide. Judgment should be used in locating waterbars to minimize erosion potential. It may not be necessary to place waterbars in rock areas. Install waterbars at the following recommended minimum intervals.

<u>Fireline and Road Gradient (%):</u>	<u>0-25</u>	<u>26-50</u>	<u>&gt;50</u>
<u>Hand Line Waterbreak Spacing</u>	<u>100'</u>	<u>75'</u>	<u>50'</u>
<u>Road &amp; Dozer Waterbreak Spacing</u>	<u>150'</u>	<u>75'</u>	<u>50'</u>

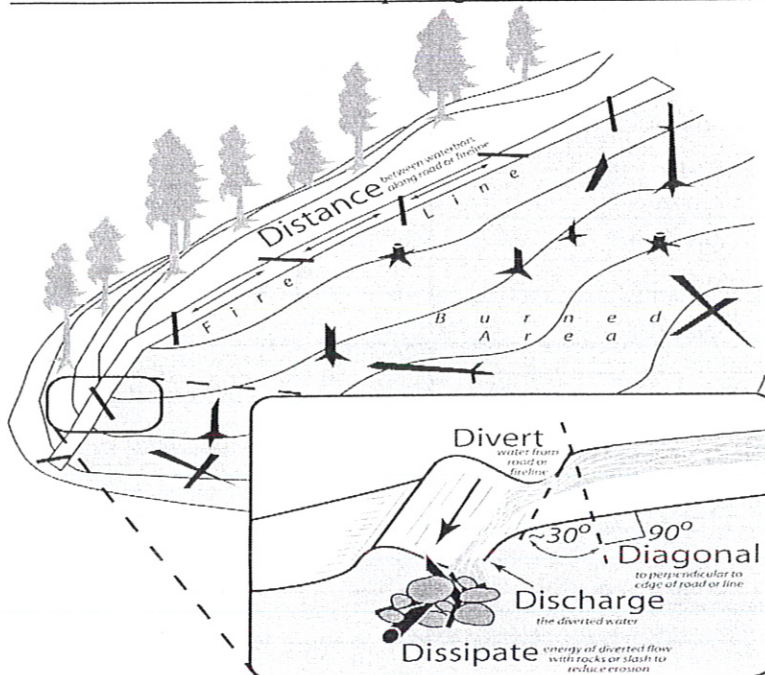



# CAL FIRE INCIDENT MANAGEMENT TEAM 3 WATER USAGE PLAN



## *California Drought Emergency*

The following shall be considered and implemented by all fire resources as a means to provide maximum efficiencies when utilizing water resources, while minimizing the impacts to private and public water supplies. Accountability shall be maintained for all water supplies that are utilized and care should be applied to ensure proper replacement and/or reimbursement to the supplier/owner.

### **Fireline personnel-** (During mop up operations)

- Use Pencil Hose and Garden Nozzles with Shut-Offs.
- Use Back pumps.
- Use Dry Mop-up and consolidation of heavy fuels to areas where they can burn out safely.
- Locate/Relocate Firelines to lighter fuels or natural barriers when safe.
- Set up and use portable tanks in anticipation of longer transport times for Water Tenders.
- Use of foams, gels and other water enhancers.
- Evaluate need to mop up in excess of 200 feet from fireline.

### **Road Maintenance and Repair-**

- Monitor and water roads only when and where needed.
- Water when most effective (evening and nights).
- Use chemical treatments when available (Magchloride, Omni bind etc.).
- Consider use of tertiary or treated water.

### **Aviation Operations-**

- Consider use of Gels, Foams and Retardants. Set up portable plants.
- Consider using Blivits and Pencil Hose for interior mop up operations as opposed to numerous bucket drops.
- Establish and use pre-use agreements for existing and known water sources.
- Use large watershed dip sites when able. Minimize use of small, static ponds and lakes.
- Maintain accountability of water used and locations of dip sites.
- Evaluate need for interior bucket drops.

### **Private Water Supplies-**

- Notify property owner as early as possible.
- Minimize usage and develop alternative water supplies when and where appropriate.
- Track usage (meter, ICS-214, IMT3 Water Usage Reports) and develop a plan to replace water.
- Make arrangements for reimbursement and damage claims if needed.

### **Public/Municipal Water Supplies-**

- Notify Agency as soon as possible and request a representative to the incident.
- Identify fill areas and request metering devices. Note locations on incident map.
- Use alternative or reclaimed water sources when available. Note locations on incident map.
- Make arrangements for reimbursement and damage claims if needed.

### **Management and Supervision-**

- Use leaders intent and establish Water Conservation as a Management Objective.
- Consider complexity of water use on incidents. Establish a Water Supply Group Supervisor to coordinate additional resources to support the incident needs.
- Complete the Water Usage Report daily and turn in to Situation Unit.
- Review this check list and brief daily.









