

*Corrected*  
**DAY INCIDENT**

***CA-LMU-003472***

***OPERATIONAL PERIOD***

**August 7 - 8, 2014**

**0700-0700**

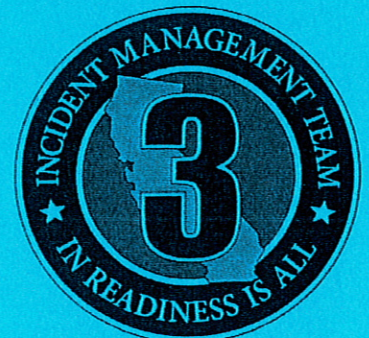



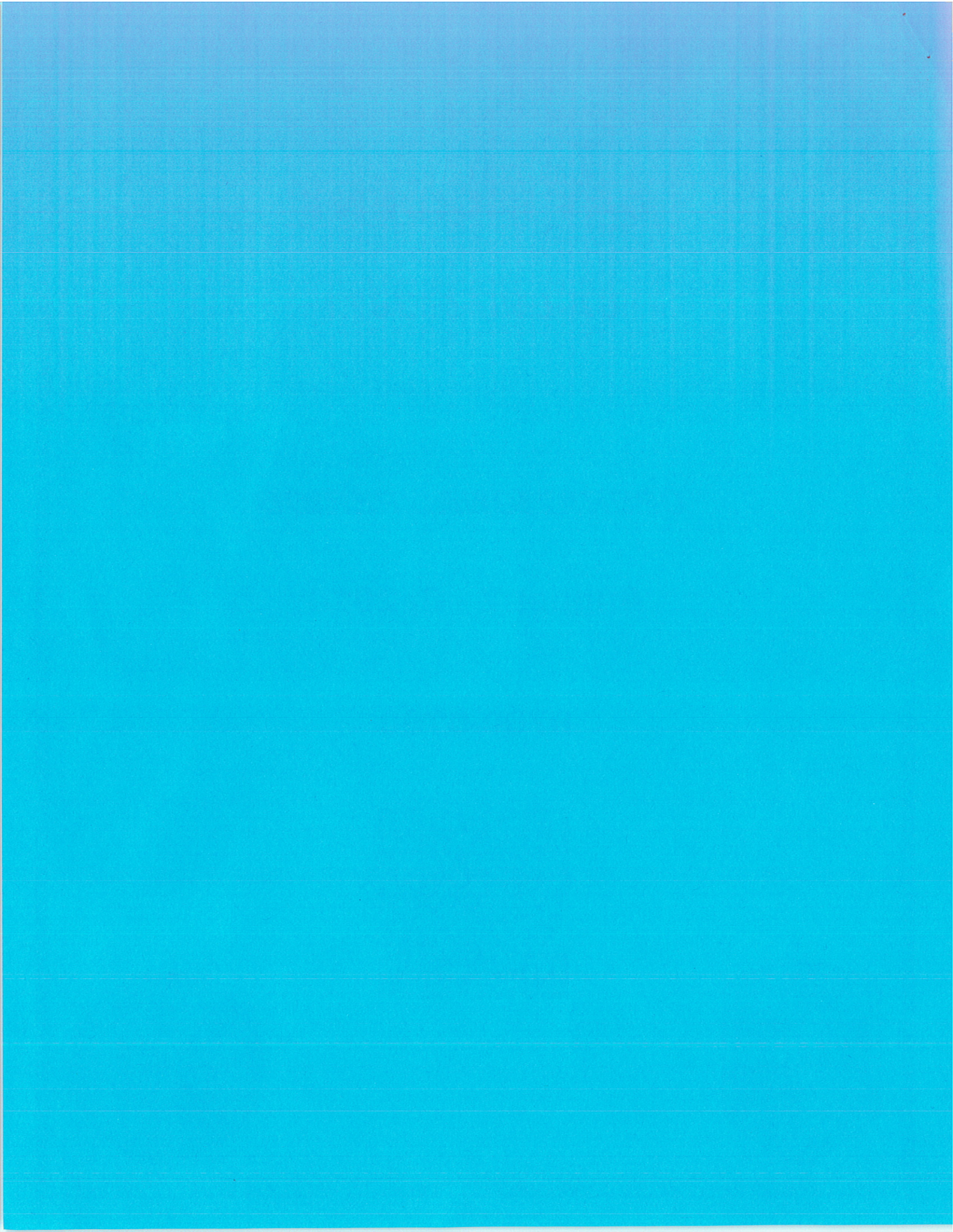

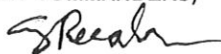

<b>INCIDENT OBJECTIVES</b>	<b>1. INCIDENT NAME DAY</b>	<b>2. DATE</b> 8/6/14	<b>3. TIME</b> 1900																								
<b>4. OPERATIONAL PERIOD (DATE/TIME)</b> 8/7/14 - 8/8/14 0700 – 0700																											
<b>5. MANAGEMENT OBJECTIVES</b> <ul style="list-style-type: none"> <li>• Provide for firefighter and public safety.</li> <li>• Establish and maintain positive relationships with cooperating agencies and the public.</li> <li>• Provide timely and accurate incident information.</li> <li>• Keep costs commensurate with values at risk.</li> <li>• Provide for a safe and effective demobilization process.</li> </ul> <b>6. GENERAL CONTROL OBJECTIVES</b> <ul style="list-style-type: none"> <li>• Keep the fire within established control lines.</li> </ul>																											
<b>7. WEATHER FORECAST FOR OPERATIONAL PERIOD</b> The air mass over the fire area will turn progressively warmer and drier today, with temperatures about 5 degrees warmer and humidity about 5 percent lower than yesterday. Winds will be mainly slope and terrain driven.																											
<b>8. GENERAL SAFETY MESSAGE</b> This is day 9 of the incident; keep your safety and the safety of your crews as the top priority. Watch for traffic on the roadways and be respectful of other drivers. SLOW DOWN!																											
<b>9. Attachments (<input checked="" type="checkbox"/> if attached)</b> <table style="width: 100%; border: none;"> <tr> <td><input checked="" type="checkbox"/> Organization List (ICS 203)</td> <td><input checked="" type="checkbox"/> Air Operations 220</td> <td><input checked="" type="checkbox"/> Finance Message</td> <td><input checked="" type="checkbox"/> Demob Plan</td> </tr> <tr> <td><input checked="" type="checkbox"/> Weather Forecast</td> <td><input checked="" type="checkbox"/> Communications Plan (ICS 205)</td> <td><input checked="" type="checkbox"/> Training Message</td> <td><input type="checkbox"/> Traffic Plan</td> </tr> <tr> <td><input checked="" type="checkbox"/> Fire Behavior Forecast</td> <td><input checked="" type="checkbox"/> Medical Plan (ICS 206)</td> <td><input checked="" type="checkbox"/> Archaeologist Message</td> <td><input checked="" type="checkbox"/> Facility Map</td> </tr> <tr> <td><input checked="" type="checkbox"/> Safety Message</td> <td><input checked="" type="checkbox"/> ICP Phone List</td> <td><input checked="" type="checkbox"/> Suppression</td> <td><input checked="" type="checkbox"/> Water Usage Report</td> </tr> <tr> <td><input checked="" type="checkbox"/> Assignment List (ICS 204)</td> <td><input type="checkbox"/> Camp Rules</td> <td><input type="checkbox"/> Repair Instructions</td> <td><input checked="" type="checkbox"/> Unit Log 214</td> </tr> <tr> <td></td> <td><input type="checkbox"/> Information</td> <td></td> <td><input type="checkbox"/> _____</td> </tr> </table>				<input checked="" type="checkbox"/> Organization List (ICS 203)	<input checked="" type="checkbox"/> Air Operations 220	<input checked="" type="checkbox"/> Finance Message	<input checked="" type="checkbox"/> Demob Plan	<input checked="" type="checkbox"/> Weather Forecast	<input checked="" type="checkbox"/> Communications Plan (ICS 205)	<input checked="" type="checkbox"/> Training Message	<input type="checkbox"/> Traffic Plan	<input checked="" type="checkbox"/> Fire Behavior Forecast	<input checked="" type="checkbox"/> Medical Plan (ICS 206)	<input checked="" type="checkbox"/> Archaeologist Message	<input checked="" type="checkbox"/> Facility Map	<input checked="" type="checkbox"/> Safety Message	<input checked="" type="checkbox"/> ICP Phone List	<input checked="" type="checkbox"/> Suppression	<input checked="" type="checkbox"/> Water Usage Report	<input checked="" type="checkbox"/> Assignment List (ICS 204)	<input type="checkbox"/> Camp Rules	<input type="checkbox"/> Repair Instructions	<input checked="" type="checkbox"/> Unit Log 214		<input type="checkbox"/> Information		<input type="checkbox"/> _____
<input checked="" type="checkbox"/> Organization List (ICS 203)	<input checked="" type="checkbox"/> Air Operations 220	<input checked="" type="checkbox"/> Finance Message	<input checked="" type="checkbox"/> Demob Plan																								
<input checked="" type="checkbox"/> Weather Forecast	<input checked="" type="checkbox"/> Communications Plan (ICS 205)	<input checked="" type="checkbox"/> Training Message	<input type="checkbox"/> Traffic Plan																								
<input checked="" type="checkbox"/> Fire Behavior Forecast	<input checked="" type="checkbox"/> Medical Plan (ICS 206)	<input checked="" type="checkbox"/> Archaeologist Message	<input checked="" type="checkbox"/> Facility Map																								
<input checked="" type="checkbox"/> Safety Message	<input checked="" type="checkbox"/> ICP Phone List	<input checked="" type="checkbox"/> Suppression	<input checked="" type="checkbox"/> Water Usage Report																								
<input checked="" type="checkbox"/> Assignment List (ICS 204)	<input type="checkbox"/> Camp Rules	<input type="checkbox"/> Repair Instructions	<input checked="" type="checkbox"/> Unit Log 214																								
	<input type="checkbox"/> Information		<input type="checkbox"/> _____																								
<b>10. PREPARED BY (PLANNING SECTION CHIEF)</b> Pam Linstedt 		<b>11. APPROVED BY (INCIDENT COMMANDERS)</b> Steve Reeder 																									

ORGANIZATION ASSIGNMENT LIST		9. Operations Section <i>GREG BERTELLI (CT)</i>	
1. Incident Name		Day Ops	Nick Truax, Mark Higgins (T)
DAY		Deputy	Sean Norman, Scott Hale (T)
2. Date Prepared	3. Time Prepared	Night Ops	Jeff Ohs
8/6/14	1900	Staging Area Manager	
4. Operational Period		Line Safety Officer	Brian Cordeiro ✓
8/7/14 - 8/8/14 0700 - 0700			
5. Incident Commander and Staff		a. Branch I - Division/Groups	
Incident Commander	Robert Michael	Branch Director	Mike Inman ✓
Deputy IC	Joe Tyler, Steve Reeder (T)	Deputy	
Safety Officer	Curtis Brown, Dave Sargenti (T)	Division/Group A	Jeffrey Reyes ✓
Public Information Officer	Mike Smith, Richard Cordova (T)	Division/Group C/H	Dave Munch ✓
Liaison Officer	Dennis Carreiro, Scott Henry (T)	Division/Group	
Law Enforcement Liaison	Sven Miller, Phil Fontanetta	Division/Group	
		Branch Safety Officer	
6. Agency Representative		b. Branch II - Division/Groups	
Agency/Organization	Name	Branch Director	Jeffrey Johnson ✓
BLM	Michael Dolan	Deputy	
CAL OES	John Clary	Division/Group S	Dennis Nolan ✓
CCC	Dylan Thomas	Division/Group V	Ken Kuykendall ST4156C ✓
CDCR	Ernie Madrid	Division/Group W/X	Tim Cordero ✓
Modoc SO	Mike Poindexter	Fire Suppression Repair	Ivan Houser ✓, Don Schroeder (T) ✓
USFS	Amanda McAdams	Branch Safety Officer	
		c. Branch III - Division/Groups	
7. Planning Section		Branch Director	
Chief	Pam Linstedt	Deputy	
Deputy	Jeff Adams, Rob Daugherty (T)	Division/Group	
Resources Unit	Chris Sauer, Jeff Dapper (T)	Division/Group	
Resources Unit	Shane Sherwood (T), Al Klem (T)	Division/Group	
Situation Unit	David Shy, Keith Tsudama (T)	Division/Group	
Documentation Unit	Susan Hudson	d. Air Operations Branch	
Demobilization Unit	Steve DeBenedet, Kevin Morris (T)	Air Ops. Branch Director	John Richardson
Fire Behavior Analyst	Chris Waters	Air Attack Supervisor	
Incident Meteorologist	Frederic Bunnag	Air Support Group Sup.	Matt Stanford, Shem Hawkins (T)
Training Specialist	Mike Wink, Rob Scott (T)	Helibase Manager	Jared Collins
GISS	Todd Tuggle, Chris Ingram	AAML	
Display Processor	Claudia Soiza	Air Tanker Coordinator	
8. Logistics Section		10. Finance Section	
Chief	Pete Gallegos	Chief	Rich Browne
Deputy	Geoff Pemberton	Deputy	Terry Eastwood
Support Branch Director		Time Unit	Rick Giubbini, Patrick Aguada (T)
Supply Unit	Tim Stewart, Amber Henderson (T)	Procurement Unit	Jack Franklin, Mara Zaver
Facilities Unit	Ernie Solis	Comp / Claims Unit	Laura Germany, Janet Lews (T)
Ground Support Unit	Steve Langston, John Ruedy (T)	Cost Unit	John Forsberg, Matt Rueckheim (T)
Accommodations	Brian Washington	Hired Equipment Tech Spec	Andy Whitlock
Service Branch Director			
Communications Unit	Kyle Johnson		
Medical Unit	Jorge Segura, <i>JEFF W</i>		
Food Unit	David Dayton	Prepared by (Resource Unit Leader)	
Ordering Manager	Mike Stebok, Andy Doyle	Chris Sauer <i>CS</i>	
Security Unit			





**INCIDENT Weather Forecast**



FORECAST NO: 06

NAME OF FIRE: Day

PREDICTION FOR: DAY and NIGHT SHIFT

UNIT: N/A

SHIFT DATE: Thursday Aug 7, 2014

SIGNED: *Frederic Bunnag*  
Incident Meteorologist

TIME AND DATE  
FORECAST ISSUED: Aug 6, 2014 1900 PDT

**WEATHER DISCUSSION:**

The air mass over the fire area will turn progressively warmer and drier each day. Temperatures today will be about 5 degrees warmer than yesterday with humidity about 5 percent lower. Winds will be mainly slope driven with ridge winds westerly during the day and northeasterly at night. Nighttime recovery will be coming down as well.

**WEATHER FORECAST: DAY SHIFT**

**WEATHER:** Partly cloudy. Cumulus build-up by 1400. Chance of showers after 1600.

**TEMPERATURES:** 85-89 valleys... 82-85 mid slopes and ridges.

**HUMIDITY:** Minimum of 23-28%

**20 FT WINDS:**

**RIDGETOP -** Northeast 5 to 7 mph until 0900, then turning West and increasing to 8 to 10 mph after 1500.

**SLOPE/VALLEY -** Upslope wind 5 to 8 mph.

**HAINES INDEX:** 4 (Low)

**LIGHTNING ACTIVITY LEVEL:** 1.

**WEATHER FORECAST: NIGHT SHIFT**

**WEATHER:** Chance of showers until 20 00... then partly cloudy.

**TEMPERATURES:** Lows 55 to 60.

**HUMIDITY:** Maximum 50%.

**20 FT WINDS:**

**RIDGETOP -** West wind 8-10 mph until 2200, then turning Northeast 5-7 mph.

**SLOPE/VALLEY -** West wind 6-8 mph in the evening, then light downslope.

**HAINES INDEX:** 3 (Very Low)

**LIGHTNING ACTIVITY LEVEL:** 1.

**OUTLOOK FOR FRIDAY AND SATURDAY:** Warmer and drier each day. Highs 85-90 Friday. Min RH 15-20% Friday. Southwest wind around 10 mph.



**FIRE BEHAVIOR FORECAST**  
**Day Fire**

FORECAST NUMBER: 6	TYPE OF FIRE: Wildland Fire
FIRE NAME: Day Fire	OPERATIONAL PERIOD: 8/7/2014 0700-0700
DATE ISSUED: 8/6/2014	TIME ISSUED: 2000 Hrs.
UNIT: LMU – CAL FIRE Lassen-Modoc-Plumas	SIGNED: 

**INPUTS**

**WEATHER SUMMARY:**

Expect the weather to become progressively warmer and drier over the next several days. Expect nighttime relative humidity recovery to drop as well. Winds will be slope driven with ridge winds out of the west in the afternoon and northeasterly at night.

*See Attached Incident Weather Forecast*

**OUTPUTS**

**FIRE BEHAVIOR:**

No appreciable fire behavior expected today. The fire received a two day wind test without a significant fire behavior related incident. Weather continues to support mop up operations with lower temperatures and higher relative humidity. Expect the trend to change today. Warming will begin today and continue through the weekend.

**Fuels:** The Day Fire is burning primarily in commercial mixed conifer timber stands actively managed for timber production. Light to moderate slash accumulations as well as piles can be found throughout the fire area. All live fuels are under drought stress with live fuel moisture values at levels well below normal.

**Topography:** Topography ranges from moderately steep to flat with most of the fire area generally dominated by mild slopes.

**SPECIFIC:**

Mop up operations are in full force across the fire. Active fire has ceased; however the coming warming trend could bring parts of the fire back to life. The primary driver of fire spread for this fire was spotting.

All Divisions: No active fire expected today, however anticipate the weather change and its effect on fire behavior. Expect to see new and previously undetected hot spots as the weather warms up. Monitor control lines for potential short range spotting activity as the southwest winds and warmer weather returns to the area.

**AIR OPERATIONS:**

No air operations are planned for the Day Fire. In the event aircraft become necessary for an escape or a new fire, smoke from the other two fires in the area may impair visibility and aircraft access to the Day Fire.

**SAFETY:**

Stump holes and fire damaged trees continue to be a significant hazard. Active fire behavior is not expected however continue to monitor the fire area for isolated flare ups. Warmer and drier conditions will potentially allow new hot spots to flare up.





# CAL FIRE INCIDENT MANAGEMENT TEAM 3



<b>SAFETY MESSAGE</b>	1. INCIDENT NAME: DAY	2. DATE PREPARED: August 6, 2014	3. TIME PREPARED: 1400
	4. PREPARED BY: David Sargenti	5. LEADER NAME: David Sargenti SOF1 (T)	6. OPERATIONAL PERIOD: 8-7-2014 0700 TO 8-8-2014 0700

# SAFETY MESSAGE

## ac·count·abil·i·ty

1. an obligation or willingness to accept responsibility or to account for ones actions.

- Watch for traffic on the roadways and be respectful of other drivers. SLOW DOWN!
- There's no glory in getting hurt during mop up, wear all PPE and pace yourself through the shift.
- Stay at least 100 feet away from the train tracks.
- Be aware of what is happening around you (SA) and adapt your exit strategy accordingly.
- Trees are weakened due to fire activity. Look Up, Down, and Around for tree hazards.
- While conducting mop up operations beware of stump holes, trip hazards and uneven terrain.
- Establish COMMUNICATIONS and report any coverage issues to your line supervisor.
- Document 2:1 rest and hydration on 214's. Take frequent breaks!!!
- This is day 9 of the incident, keep your safety and the safety of your crews as the top priority.

## CAUTION!

## ATTENTION!

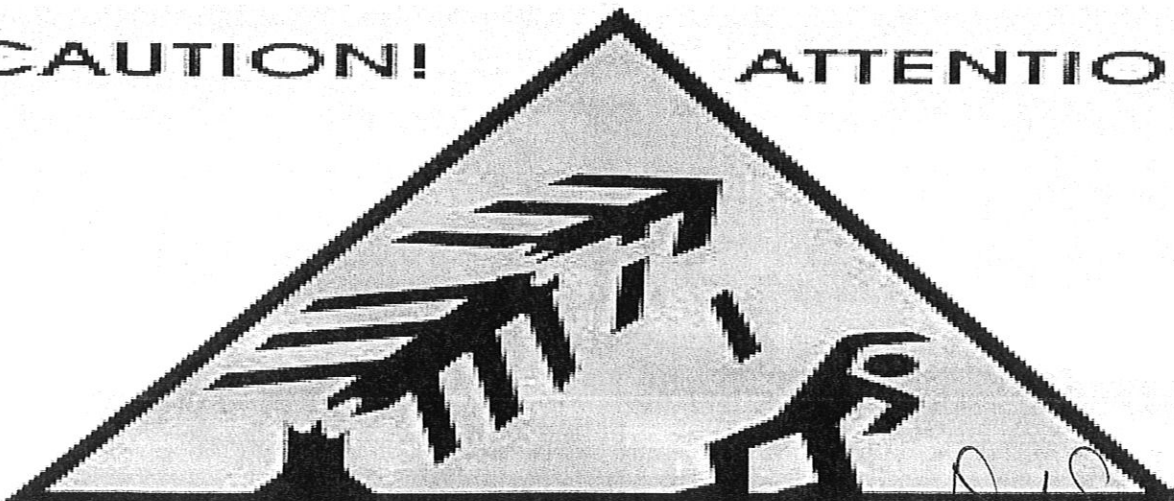





## INCIDENT RISK ANALYSIS (ICS 215A)

DIV	HAZARDOUS ACTIONS / CONDITIONS	MITIGATIONS/WARNINGS/REMEDIES	
ALL	DRIVING HAZARDS/ ROADS	<ul style="list-style-type: none"> <li>• Drive defensively! SLOW DOWN!!!!</li> <li>• Increase following distances on dusty roads. Slow down when you meet opposing traffic. Be alert for construction work on Highway 299.</li> <li>• Drive with headlights on.</li> <li>• Be alert for wildlife, heavy trucks, and high speed opposing traffic crossing into your lane.</li> <li>• Check traffic approaching behind you when making left turns.</li> </ul>	
ALL	FATIGUE	<ul style="list-style-type: none"> <li>• Be alert for signs of fatigue and take breaks as necessary.</li> <li>• Maintain 2:1 work/rest ratio.</li> <li>• Monitor incoming resources for level of fatigue.</li> </ul>	
ALL	SNAGS/ FIRE-WEAKENED TREE HAZARDS	<ul style="list-style-type: none"> <li>• Follow Hazard Tree Safety Guidelines (IRPG p. 20 (RED)).</li> <li>• Many of the trees within the fire area are weakened due to fire activity.</li> <li>• Be especially alert around snags during wind events.</li> </ul>	
ALL	COMMUNICATIONS	<ul style="list-style-type: none"> <li>• Be sure that all radios are cloned to the current frequency load.</li> <li>• Report any communication issues to your line supervisor</li> </ul>	
ALL	TRAINS	<ul style="list-style-type: none"> <li>• Stay 100' away from tracks at all times.</li> <li>• Use caution when crossing tracks. LOOK both ways.</li> </ul>	
ALL	MEDICAL TRANSPORT	<ul style="list-style-type: none"> <li>• Assign personnel with Advanced Life Support capability on the line.</li> <li>• Cache emergency equipment (backboards etc.) in various locations on line.</li> <li>• Maintain ALS ambulance at DROP POINT 23.</li> <li>• Keep line personnel informed of this issue. Safety briefings to stress that extra care should be taken with high-risk tasks (i.e. tree falling, chainsaw use, etc.).</li> <li>• Supervisors insure that personnel with severe reaction to bee sting, etc. have "epi-kits" or consider leaving such individuals in camp.</li> </ul>	
ALL	MOP UP	<ul style="list-style-type: none"> <li>• Conduct thorough briefing for all personnel (inside rear cover IRPG).</li> <li>• Use all required PPE, including eye protection.</li> <li>• Maintain proper spacing and overhead clearance.</li> <li>• Be alert for stump holes and root cavities.</li> <li>• Minimize exposure to smoke, and rotate personnel into clean air as practical.</li> </ul>	
Incident Name <div style="text-align: center; font-weight: bold;">DAY</div> ICS 215A		DATE PREPARED: 8/6/2014  Prepared by: DAVID SARGENT <i>David Sargent</i>	OPERATIONAL PERIOD 0700-0700 8/7-8/2014



DIVISION ASSIGNMENT LIST			1. Branch I		2. Division/Group A		
3. Incident Name <b>DAY</b>			4. Operational Period Date: <b>8/7/14-8/8/14</b> Time: <b>0700-0700</b>				
5. Operations Personnel							
Operations Chief		Nick Truax		Division/Group Supervisor		Jeffrey Reyes ✓	
Branch Director		Michael Inman* ✓		Safety		Brian Cordeiro ✓	
6. Resources Assigned this Period							
Strike Team/Task Force/ Resource Designator	Leader	Number Persons	Trans. Needed	Drop Off PT./Time	Pick Up PT./Time		
STC MMU 9420C ✓	Michael Surber	19		DP-10 @ 0900	0900		
STG LMU 9225G ✓	Pat Benninghoven	37		DP-10 @ 0900	0900		
W/T PVT E-90 ○	Jack Duncan	2		DP-10 @ 0900	0900		
W/T PVT E-91 ✓	Kyle Mendine	2		DP-10 @ 0900	0900		
W/T PVT E-95 ✓	Dan Brady	2		DP-10 @ 0900	0900		
W/T PVT E-96 ✓	Ron Belion	2		DP-10 @ 0900	0900		
FEMP O-286 ✓	Kevin Berkery	1		DP-10 @ 0900	0900		
FEMT O-298 ✓	Daniel Park	1		DP-10 @ 0900	0900		
7. Control Operations <b>Mop up and patrol for 300' inside the line.</b> <b>Patrol for spot fires in the green.</b> <b>Backhaul all trash.</b>							
8. Special Instructions <b>*Denotes a 12 hour resource.</b> <b>SOFR is assigned to both Branches.</b> <b>FOBS may be working throughout the division.</b> <b>FOBS shall check in and out with DIVS as they enter or leave the division.</b> <b>Branches will be working for 12 hours only.</b> <b>A designated DIVS will assume Branch coverage at night.</b>							
9. Division/Group Communication Summary							
Function	Frequency	System	Channel	Function	Frequency	System	Channel
Command	RX 168.0750 TX 170.4250		NIFC CMD 3 TONE 3	Air to Ground	RX/TX 159.3525		CDF TAC 25
Tactical Div/Group	RX/TX 154.2875		VFIRE 25	Air Guard	RX/TX 168.6250		AIR GUARD
Prepared by (Resource Unit Leader) Jeff Dapper		Approved by (Planning Sect. Ch.) Pam Linstedt <i>PL</i>			Date 8/6/14		Time 2300



DIVISION ASSIGNMENT LIST			1. Branch <b>I</b>		2. Division/Group <b>C/H</b>		
3. Incident Name <b>DAY</b>			4. Operational Period Date: <b>8/7/14-8/8/14</b> Time: <b>0700-0700</b>				
5. Operations Personnel							
Operations Chief		Nick Truax		Division/Group Supervisor		Dave Munch	
Branch Director		Michael Inman*		Safety		Brian Cordeiro	
6. Operations Personnel							
Strike Team/Task Force/ Resource Designator	Leader	Number Persons	Trans. Needed	Drop Off PT./Time		Pick Up PT./Time	
STC TCU 9440C ✓	Landon Haack	17		DP-25 @ 0900		0900	
STC LNU 9142C ✓	Jim Robbins	20		DP-25 @ 0900		0900	
<del>CRW LMU DVG 4</del>	<del>Robert Veverka</del>	<del>15</del>		<del>DP-25 @ 0900</del>		<del>0900</del>	
<del>CRW LMU DVG 5</del>	<del>Kevin Fleming</del>	<del>15</del>		<del>DP-25 @ 0900</del>		<del>0900</del>	
STG LNU 9146G ✓	Mike Crosby	34		DP-25 @ 0900		0900	
W/T PVT E-2 ✓	John Hay	2		DP-25 @ 0900		0900	
W/T PVT E-94 ✓	Cody Penry	2		DP-25 @ 0900		0900	
W/T PVT E-97 ✓	Robbie Keene	2		DP-25 @ 0900		0900	
W/T PVT E-101 ✓	John Hill	2		DP-25 @ 0900		0900	
FALM O-370* ✓	Richard Kersh	2		DP-25 @ 0900		1900	
FEMT O-178 ✓	Eric Jones	1		DP-25 @ 0900		0900	
FEMT O-300 ✓	Jeremy Wright	1		DP-25 @ 0900		0900	
7. Control Operations Mop up and patrol for 300' inside the line. Patrol for spot fires in the green. Backhaul all trash. <b>STG 1184G PATRICK SPRENGEL 29</b>							
8. Special Instructions *Denotes a 12 hour resource. SOFR is assigned to both Branches. FOBS may be working throughout the division. FOBS shall check in and out with DIVS as they enter or leave the division. Branches will be working for 12 hours only. A designated DIVS will assume Branch coverage at night.							
9. Division/Group Communication Summary							
Function	Frequency	System	Channel	Function	Frequency	System	Channel
Command	RX 168.0750 TX 170.4250		NIFC CMD 3 TONE 3	Air to Ground	RX/TX 159.3525		CDF TAC 25
Tactical Div/Group	RX/TX 154.2725		VFIRE 24	Air Guard	RX/TX 168.6250		AIR GUARD
Prepared by (Resource Unit Leader) Jeff Dapper			Approved by (Planning Sect. Ch.) Pam Linstedt <i>PL</i>		Date 8/6/14		Time 2300



DIVISION ASSIGNMENT LIST			1. Branch <b>II</b>		2. Division/Group <b>S</b>		
3. Incident Name <b>DAY</b>			4. Operational Period Date: <b>8/7/14-8/8/14</b> Time: <b>0700-0700</b>				
5. Operations Personnel							
Operations Chief		Nick Truax		Division/Group Supervisor		Dennis Nolan	
Branch Director		Jeffrey Johnson*		Safety		Brian Cordeiro	
Strike Team/Task Force/ Resource Designator	Leader	Number Persons	Trans. Needed	Drop Off PT./Time		Pick Up PT./Time	
STC SKU 9260C ✓	Scott Tavalero	20		DP-25 @ 0900		0900	
STC XSH 3151C* ✓	Don Lacy	18		DP-25 @ 0900		<b>1900</b> <del>0900</del>	
STG TGU 9257 G ✓	Jeff Gowan	37		DP-25 @ 0900		0900	
STG LNU 9147G ✓	John Layton	29		DP-25 @ 0900		0900	
W/T PVT E-92 ✓	Marty Learn	2		DP-25 @ 0900		0900	
W/T PVT E-98 ✓	Bruce Thomas	2		DP-25 @ 0900		0900	
W/T PVT E-99 ✓	Robert Ferde	2		DP-25 @ 0900		0900	
W/T PVT E-252 ✓	Ron Ron	2		DP-25 @ 0900		0900	
W/T PVT E-255 ✓	Jim Godby	2		DP-25 @ 0900		0900	
W/T PVT E-257 ✓	Nathan Orsi	2		DP-25 @ 0900		0900	
FALM O-369* ✓	Jason Daugherty	1		DP-25 @ 0900		1900	
FEMP O-285 ✓	Dave Martinelli	1		DP-25 @ 0900		0900	
FEMT O-90 ✓	Carlos Munoz	1		DP-25 @ 0900		0900	
7. Control Operations							
<b>Mop up and patrol for 300' inside the line.</b>							
<b>Patrol for spot fires in the green.</b>							
<b>Backhaul all trash.</b>							
8. Special Instructions <b>DIVS NOLAN WILL ASSUME DIV V @ 1900.</b>							
*Denotes a 12 hour resource.							
SOFR is assigned to both Branches.							
FOBS may be working throughout the division.							
FOBS shall check in and out with DIVS as they enter or leave the division.							
Branches will be working for 12 hours only.							
A designated DIVS will assume Branch coverage at night.							
9. Division/Group Communication Summary							
Function	Frequency	System	Channel	Function	Frequency	System	Channel
Command	RX 168.0750 TX 170.4250		NIFC CMD 3 TONE 3	Air to Ground	RX/TX 159.3525		CDF TAC 25
Tactical Div/Group	RX/TX 151.1375		VTAC 11	Air Guard	RX/TX 168.6250		AIR GUARD
Prepared by (Resource Unit Leader) Jeff Dapper			Approved by (Planning Sect. Ch.) Pam Linstedt <i>PL</i>		Date 8/6/14		Time 2300







DIVISION ASSIGNMENT LIST			1. Branch <b>II</b>		2. Division/Group <b>W/X</b>			
3. Incident Name <b>DAY</b>			4. Operational Period Date: <b>8/7/14-8/8/14</b> Time: <b>0700-0700</b>					
5. Operations Personnel								
Operations Chief		Nick Truax		Division/Group Supervisor		Tim Cordero		
Branch Director		Jeffrey Johnson*		Safety		Brian Cordeiro		
Strike Team/Task Force/ Resource Designator		Leader		Number Persons	Trans. Needed	Drop Off PT./Time	Pick Up PT./Time	
STC CZU 9171C ✓		Aldo Gonzalez		<del>22</del>	18	DP-23 @ 0900	0900	
STG CZU 9175G ✓		Mike Harris		<del>33</del>	34	DP-23 @ 0900	0900	
W/T PVT E-100 ✓		Charles Rainey		2		DP-23 @ 0900	0900	
W/T PVT E-105 ✓		Randy May		2		DP-23 @ 0900	0900	
7. Control Operations <b>Mop up and patrol for 300' inside the line.</b> <b>Patrol for spot fires in the green.</b> <b>Backhaul all trash.</b>								
8. Special Instructions <b>*Denotes a 12 hour resource.</b> <b>SOFR is assigned to both Branches.</b> <b>FOBS may be working throughout the division.</b> <b>FOBS shall check in and out with DIVS as they enter or leave the division.</b> <b>Branches will be working for 12 hours only.</b> <b>A designated DIVS will assume Branch coverage at night.</b>								
9. Division/Group Communication Summary								
Function	Frequency	System	Channel		Function	Frequency	System	Channel
Command	RX 168.0750 TX 170.4250		NIFC CMD 3 TONE 3		Air to Ground	RX/TX 159.3525		CDF TAC 25
Tactical Div/Group	RX/TX 154.4525		VTAC 12		Air Guard	RX/TX 168.6250		AIR GUARD
Prepared by (Resource Unit Leader) Jeff Dapper			Approved by (Planning Sect. Ch.) Pam Linstedt <i>[Signature]</i>			Date 8/6/14		Time 2300



DIVISION ASSIGNMENT LIST			1. Branch	2. Division/Group <b>FIRE SUPPRESSION REPAIR (1 of 2)</b>		
3. Incident Name <b>DAY</b>			4. Operational Period Date: <b>8/7/14-8/8/14</b> Time: <b>0700-0700</b>			
5. Operations Personnel						
Operations Chief		Nick Truax		Group Supervisor		Ivan Houser Don Schroeder (T)
Branch Director				Safety		Brian Cordeiro
6. Resources Assigned this Period						
Strike Team/Task Force/ Resource Designator	Leader	Number Persons	Trans. Needed	Drop Off PT./Time	Pick Up PT./Time	
<del>STG LAC 1184 G</del>	<del>Patrick Sprengel</del>	<del>33</del>		0900	1900	
STG LAC 1185 G ✓	Jason Toshack	31		0900	1900	
STG LAC 1186 G ✓	Jack Haynes	33		0900	1900	
DOZ PVT E-82 ✓	John Hertzig	21		0900	1900	
DOZ PVT E-168 ✓	Brian Forker	21		0900	1900	
DOZ PVT E-173 ✓	Mark Garner	21		0900	1900	
DOZ PVT E-176 ✓	Angelo Cattaneo	21		0900	1900	
DOZ PVT E-181 ✓	Sunny Moore	21		0900	1900	
W/T PVT E-1 ✓	Wes Hutchens	21		0900	1900	
7. Control Operations <b>Fire suppression repair to be done per the Fire Suppression Repair Plan. Check in and out with DIVS as you enter and leave divisions.</b>						
8. Special Instructions <b>All resources assigned to Fire Suppression Repair are working a 12 hour shift.</b>						
9. Division/Group Communication Summary						
Function	Frequency	System	Channel	Function	Frequency	System Channel
Command	RX 168.0750 TX 170.4250		NIFC CMD 3 TONE 3	Air to Ground	RX/TX 159.3525	CDF TAC 25
Tactical Div/Group	RX/TX 158.7375		VTAC 13	Air Guard	RX/TX 168.6250	AIR GUARD
Prepared by (Resource Unit Leader) Jeff Dapper		Approved by (Planning Sect. Ch.) Pam Linstedt <i>PL</i>		Date 8/6/14	Time 2300	



DIVISION ASSIGNMENT LIST				1. Branch	2. Division/Group <b>FIRE SUPPRESSION REPAIR (2 of 2)</b>			
3. Incident Name <b>DAY</b>				4. Operational Period Date: <b>8/7/14-8/8/14</b> Time: <b>0700-0700</b>				
5. Operations Personnel								
Operations Chief		Nick Truax		Group Supervisor		Ivan Houser Don Schroeder (T)		
Branch Director				Safety		Brian Cordeiro		
6. Resources Assigned this Period								
Strike Team/Task Force/ Resource Designator	✓	Leader	Number Persons	Trans. Needed	Drop Off PT./Time	Pick Up PT./Time		
W/T PVT E-93	✓	Bryan Troedez	21		0900	1900		
W/T PVT E-102	✓	Doug Hill	21		0900	1900		
W/T PVT E-103	✓	Jeff Graham	21		0900	1900		
W/T PVT E-258	✓	Doug Graham	1		0900	1900		
FOBS (T) O-24	✓	David Wade	1		0900	1900		
FOBS O-119	✓	Edwin Simpson	1		0900	1900		
FOBS O-121	✓	John Clark	1		0900	1900		
<del>FOBS O-122</del>		<del>Keith Dietz</del>	<del>1</del>		0900	1900		
<del>FOBS O-126</del>		<del>Matt Brady</del>	<del>1</del>		0900	1900		
FOBS O-172	✓	Gary Whitson	1		0900	1900		
FOBS O-313	✓	Joshua Potter	1		0900	1900		
7. Control Operations <b>Fire suppression repair to be done per the Fire Suppression Repair Plan. Check in and out with DIVS as you enter and leave divisions.</b>								
8. Special Instructions <b>All resources assigned to Fire Suppression Repair are working a 12 hour shift.</b>								
9. Division/Group Communication Summary								
Function	Frequency	System	Channel	Function	Frequency	System	Channel	
Command	RX 168.0750 TX 170.4250		NIFC CMD 3 TONE 3	Air to Ground	RX/TX 159.3525		CDF TAC 25	
Tactical Div/Group	RX/TX 158.7375		VTAC 13	Air Guard	RX/TX 168.6250		AIR GUARD	
Prepared by (Resource Unit Leader) Jeff Dapper			Approved by (Planning Sect. Ch.) Pam Linstedt PJ			Date 8/6/14	Time 2300	



# AIR OPERATIONS SUMMARY 220

PREPARED BY: Matt Stanford

DATE: 8/06/2014

<b>1. INCIDENT NAME:</b> Day		<b>2. OPERATIONAL DATE:</b> 08/07/2014		<b>SUNRISE:</b> 0700		<b>SUNSET:</b> 1950		
<b>3. REMARKS (Safety Notes, Flight-Hazards, Other Hazards, Air Operations, and Special Equipment, etc.):</b> Smokey Conditions *Numerous fires in the area. Copter 202 will operate out of Bieber. Order H-202 through communications.				<b>4. AIR RESCUE AIRCRAFT:</b> H-202 Day time <i>Activation Instructions:</i> CANG H-826 Available 24/7 @ Redding Airport. Order rescue helicopter through communications. They will relay to Susanville ECC.				<b>5. TFR/91.137:</b> Radius: NM Altitude: MSL Center Point: Latitude: Longitude:
Helibase(s) Name: Lat./Long: Lat./Long:								
<b>3b. Helispots:</b>								
<b>6. PERSONNEL</b>	Name	Telephone	Cellular	Pager	Fax	<b>7. FREQUENCY</b>	AM FM	
AOBD	John Richardson		805-9033403			AIR/AIR FW:		
ASGS	Matt Stanford		951-5458205			AIR/AIR RW:		
ASGS	Shem Hawkins (T)		650-2451717			AIR/GROUND:	CDF T-25 T-16	
ATGS (Relief)						COMMAND: (Simplex)	RX168.0750 TX170.4250	
HEBM	Jared Collins					COMMAND RPT:	NIFC CMD-3 T-3 131.8	
HELCO						DECK:		
DECK						TOLC:		
TOLC								
AGENCY AIRCRAFT DISPATCH OFFICE AGENCY AVIATION MILITARY LIAISON CANG								
<b>8. PERSONNEL ON ORDER:</b>								
<b>SEE INCIDENT RADIO COMMUNICATIONS PLAN (205) FOR ALL OTHER FREQUENCIES!</b>								
<b>9. FIXED WING:</b>		Identifier		Base		10. ROTOR WING:		
Leadplane(s):						Helitanker(s):		
Tanker(s):						I: 202		
I:						II: 1		
II:						III:		
III:						IV:		
IV:								
<b>11. SPECIAL ASSIGNED EQUIPMENT:</b>								
AIRCRAFT RESCUE FIRE FIGHTERS Helibase dust abatement Water Tender(s)								
<b>12.: EQUIPMENT ON ORDER:</b>								
ICS-220A (January 2001)								

, on site at \_\_\_\_\_ at helibase(s).  
 \_\_\_\_\_ helibase(s).



INCIDENT RADIO COMMUNICATIONS PLAN		Incident Name			Date/Time Prepared			Operational Period Date/Time			
		Day Incident			8/6/2014 1740			8/7/14 0700 - 8/8/14 0700			
Ch #	Function	Channel Name/Trunked Radio System Talkgroup	Assignment	RX Freq	N or W	RX Tone/NAC	TX Freq	N or W	TX Tone/NAC	Mode A, D or M	Remarks
1	Command	NIFC CMD 3	All Divisions	168.0750	N		170.4250	N	131.8 (3)	A	TONE 3
2		BLANK									
3	Tactical	VFIRE 23	Div V	154.2950	N	156.7 (6)	154.2950	N	156.7 (6)	A	
4	Tactical	VFIRE 24	Div C/H	154.2725	N	156.7 (6)	154.2725	N	156.7 (6)	A	
5	Tactical	VFIRE 25	Div A	154.2875	N	156.7 (6)	154.2875	N	156.7 (6)	A	
6		BLANK									
7	Tactical	VTAC 11	Div S	151.1375	N	156.7 (6)	151.1375	N	156.7 (6)	A	
8	Tactical	VTAC 12	Div W/X	154.4525	N	156.7 (6)	154.4525	N	156.7 (6)	A	
9	Tactical	VTAC 13	Fire Sup Repair	158.7375	N	156.7 (6)	158.7375	N	156.7 (6)	A	
10	Tactical	VTAC 14	Unassigned	159.4725	N	156.7 (6)	159.4725	N	156.7 (6)	A	
11	Air To Ground	CDF TAC 25	All Divisions	159.3525	N	192.8 (16)	159.3525	N	192.8 (16)	A	
12		BLANK									
13	Tactical	CALCORD	All Divisions	156.0750	N	156.7 (6)	156.0750	N	156.7 (6)	A	EMS ON INCIDENT
14		BLANK									
15		BLANK									
16	Emergency	Air Guard	All Branches	168.6250	N		168.6250	N	110.9 (1)	A	EMERGENCIES ONLY
17		BLANK									
18		BLANK									
19		BLANK									
20	Emergency	Air Guard	All Branches	168.6250	N		168.6250	N	110.9 (1)	A	EMERGENCIES ONLY

Prepared By (Communications Unit) *Kyle Johnson*  
 KYLE JOHNSON - COMIL TEAM 3  
 Incident Location  
 County Lassen & Modoc State CA Latitude Longitude W

The convention calls for frequency lists to show four digits after the decimal place, followed by either an "N" or a "W", depending on whether the frequency is narrow or wide band. Mode refers to either "A" or "D" indicating analog or digital (e.g. Project 25) or "M" indicating mixed mode. All channels are shown as if programmed in a control station, mobile or portable radio. Repeater and base stations must be programmed with the Rx and Tx reversed.



<b>MEDICAL PLAN</b> <b>ICS 206</b>	1. INCIDENT NAME <b>Day Incident</b>	2. DATE PREPARED 08/06/2014	3. TIME PREPARED 1700	4. OPERATIONAL PERIOD 0700-0700 08/07/2014- 08/08/2014
---------------------------------------	---	--------------------------------	--------------------------	--

5. INCIDENT MEDICAL AID STATIONS			
MEDICAL AID STATIONS	LOCATION	PARAMEDICS	
		YES	NO
Medical Unit	ICP Room 3		X

6. TRANSPORTATION			
A. AMBULANCE SERVICES			
NAME	LOCATION	PHONE	PARAMEDICS
			YES NO
Ground Amb. – Mayers 1	43563 Hwy 299E, Fall River Mills	530-336-5151	X
Air Amb. – PHI Med	5900 Old Oregon Trail, Redding, CA 96002	800-597-9571	X
Air Amb.–Mountain Life Flight	710 Ash St., Susanville, CA 96130	530-257-2444	X

B. INCIDENT AMBULANCES			
NAME	LOCATION	PARAMEDICS	
		YES	NO
Mayers 2 Ambulance	Drop Point 25	X	

7. HOSPITALS								
NAME	ADDRESS	TRAVEL TIME		PHONE	HELIPAD		BURN CENTER	
		AIR	GRND		YES	NO	YES	NO
Med Net Channel								
Mayers Memorial	43563 Hwy 299E, Fall River Mills	8 Min	20 Min	530-336-5511 x1144	X			X
Mercy Medial Center	2175 Rosaline Ave, Redding, CA	38 Min	75 Min.	530-225-7214	X			X
UC Davis Med Cnt	2315 Stockton Blvd. Sacramento	90 Min	4 Hr	916-734-3636	X		X	

**8. MEDICAL EMERGENCY PROCEDURES**

**LINE EMERGENCY:**  
 Crew Supervisor will contact **Division Supervisor** with patient complaint/condition and location.

- **Division/Group Supervisor contacts:**
  1. Closest EMS resource
  2. Communications Unit
- **Communications Unit contacts:**
  1. Ground or Air ambulance as requested
  2. Operations
  3. Safety
- **Division Supervisor or designee** will serve as point of contact and run medical emergency on assigned channel.
  1. **CALCORD** shall be used as the tactical frequency for IWI and only for duration of need.
- Communications Unit will clear command channel for emergency traffic as needed and only for duration of need.

**INJURY REPORTING PROCEDURES**

NATURE OF INJURY \_\_\_\_\_  
 LOCATION OF PATIENT \_\_\_\_\_  
 POINT OF CONTACT \_\_\_\_\_  
 TRANSPORTATION REQUESTED BY: AIR \_\_\_ GROUND \_\_\_  
 POINT OF PICKUP \_\_\_\_\_  
 LAT \_\_\_\_\_ LONG \_\_\_\_\_  
 PATIENT UNIT ID \_\_\_\_\_  
 IS AN EMT WITH PATIENT: YES \_\_\_ NO \_\_\_  
 AGE \_\_\_\_\_  
 SEX: MALE \_\_\_ FEMALE \_\_\_

**START RESOURCES EARLY – DON'T WAIT**

**ALL EMERGENCIES---Secure the area and identify witnesses for later investigation. Keep an accurate log of events.**

<b>ICS 206</b> (Rev 03/12)	9. PREPARED BY: (Medical Unit Leader)  Jorge H. Segura MEDL/Jeff Whitaker MEDL(T)	10. REVIEWED BY: (Safety Officer)  Curtis Brown SOFI/David Sargenti SOFI(T)
-------------------------------	---	---

# COMMUNICATIONS UNIT

<b>INCIDENT NAME:</b>	DAY	
<b>INCIDENT NUMBER:</b>	CA-LMU-003472	

**DATE:** 08/07/2014

COMMUNICATIONS	LINE 1	LINE 2	LINE 3	LINE 4	FAX
COM 24	(530) 339-0009	(530) 524-1465	(530) 949-6816	(530) 949-6817	(530) 335-2181
LMU EXPANDED	(530) 257-6424	(530) 257-6417			
LMU ECC DUTY OFFICER	(530) 310-2207				
LMU LINE OFFICER	(530) 310-2236				

UNIT	ROOM	LINE 1	LINE 1	LINE 1	FAX
SITUATION	17	(530) 335-4007			
CHECK-IN/DEMOB	16	(530) 335-2432			
RESOURCES		(530) 335-4862			
PIO		(951) 232-4049			
ORDERING		(562) 307-7045			
LIAISON		(530) 335-4896	(530) 335-3749		
SAFETY (24 HOURS)		(530) 335-6019	(707) 217-9278		
COST/TIME	18	(530) 355-5212			
FINANCE		(530) 335-3294			
PROCUREMENT		(530) 335-4210			
SUPPLY					(831) 265-4390
HELIBASE		(858) 353-6261			
DAY FIRE INFO		(530) 638-3614			
EILER FIRE INFO		(530) 225-2510			
BALD FIRE INFO		(530) 336-6553			
AGENCY	NAME	LINE 1			FAX
SPI	Herb Baldwin	(530) 378-8111			





# FINANCE SECTION

## MESSAGE

8/7/14



**Please make sure hired equipment shift tickets are completed and dropped off in the Time Unit by agency personnel / line supervisors only.**

**Please report all injuries and suppression damage to the Comp / Claims Unit, no matter how minor. For fire suppression damage, please include photos (if possible), a location address and / or Lat / Long and a brief description.**

**Please use the water use forms included in the IAP and turn into Situation Unit.**

**All off site feeding charged to the incident must be pre-approved by the Logistics Section and/or Finance Section Chief. The Motel Tech Spec will have information on this.**

**ROGER RAINES, FSC1  
TERRY EASTWOOD, DEP. FSC1**

# SHIFT TICKET EXAMPLE

EMERGENCY SHIFT TICKET and EVALUATION FORM					Contractor Name	
The responsible Government Officer will complete this form each shift					Fireline Builders	
Incident or Project Name <b>Incident Name</b>		Incident Number <b>Incident Number</b>	Request Number <b>E or S # Here</b>		Operator #1 <b>Bob Smith</b>	Operator #2 <b>Jeff Smith</b>
Agreement Number <b>XXX - 000000 - 00</b>					Operator Furnished By: <input checked="" type="checkbox"/> Contractor <input type="checkbox"/> Government	
Equipment Make <b>CAT</b>		Equipment Model / Type <b>D6H Type</b>			Operating Supplies Furnished By: <input checked="" type="checkbox"/> Contractor <input type="checkbox"/> Government	
Serial Number <b>6LN3344</b>		Licence Number			Equipment Status <input checked="" type="checkbox"/> Inspected <input checked="" type="checkbox"/> Under Agreement	
Equipment Use (Circle) Hours / Days / Miles					Released by Government	
Date Mo / Day	Start	Stop	Work	Assignment	Withdrawn by Contractor	
8/13	0001	2400	24	Division B	Remarks/Comments ** <b>2 Operators NO DAMAGE/ NO CLAIMS</b>	
Vendor Rating					Govt. Rep. Name and Position - PRINT <b>Mike Weber</b>	
		Poor*	Avg.	Good	Exc.	N/A
Met Performance Expectations		<b>Vendor Rating must be done.</b>			Govt. Rep. Signature <i>Mike Weber</i>	
Equipment in Safe Working Condition					Contractor Signature <i>Bob Smith</i>	
Operator Skill Level					Date <b>08/19/14</b>	
Operates Safely					Time <b>0700</b>	
Operator's Cooperation Level					CALFIRE 297 (Rev 3-2011)	
Overall Performance						
* NOTE: Any rating of POOR requires an explanation in Comment Section.						
**Final evaluation or for more documentation, use an ICS Form 230 or equivalent.						
Pink - Finance		Blue - Home Unit HE Coordinator		Yellow - Vendor		White - Govt Representative

EMERGENCY SHIFT TICKET and EVALUATION FORM					Contractor Name	
The responsible Government Officer will complete this form each shift					Fireline Builders	
Incident or Project Name <b>Incident Name</b>		Incident Number <b>Incident Number</b>	Request Number <b>E or S # Here</b>		Operator #1 <b>Bob Smith</b>	Operator #2
Agreement Number <b>Obtain from vendor's agreement</b>					Operator Furnished By: <input checked="" type="checkbox"/> Contractor <input type="checkbox"/> Government	
Equipment Make <b>Year Peterbilt</b>		Equipment Model / Type <b>Model # Wheels</b>			Operating Supplies Furnished By: <input checked="" type="checkbox"/> Contractor <input type="checkbox"/> Government	
Serial Number <b>1XP3ESMP14239012</b>		Licence Number <b>9P54457</b>			Equipment Status <input checked="" type="checkbox"/> Inspected <input checked="" type="checkbox"/> Under Agreement	
Equipment Use (Circle) Hours / Days / Miles					Released by Government	
Date Mo / Day	Start	Stop	Work	Assignment	Withdrawn by Contractor	
8/18	0001	0700	7	Off Shift	Remarks/Comments ** <b>1 Operator NO DAMAGE/ NO CLAIMS</b>	
8/18	0701	1900	12	Division B		
8/18	1901	2400	5	Off Shift		
Vendor Rating					Govt. Rep. Name and Position - PRINT <b>Mike Weber</b>	
		Poor*	Avg.	Good	Exc.	N/A
Met Performance Expectations		<b>Vendor Rating must be done.</b>			Govt. Rep. Signature <i>Mike Weber</i>	
Equipment in Safe Working Condition					Contractor Signature <i>Bob Smith</i>	
Operator Skill Level					Date <b>08/19/14</b>	
Operates Safely					Time <b>0700</b>	
Operator's Cooperation Level					CALFIRE 297 (Rev 3-2011)	
Overall Performance						
* NOTE: Any rating of POOR requires an explanation in Comment Section.						
**Final evaluation or for more documentation, use an ICS Form 230 or equivalent.						
Pink - Finance		Blue - Home Unit HE Coordinator		Yellow - Vendor		White - Govt Representative

**Turn shift tickets into Finance.**

Contact Andy Whitlock for questions: 707-498-7545





# DAY FIRE

## Training Specialist Message

### 08/07/14

All Day Incident Trainees and Trainers:  
Unless you are otherwise notified, all open training assignments on the Day Incident must be "closed out" with the TNSP by 0900 hours on Friday, August 8<sup>th</sup>.

*In order to receive documented credit for your training assignment – you must close out with the Training Specialist before you complete the demobilization process*

If as much work as possible has been completed in the position task book, Trainees may close their assignment with the TNSP prior to the demobilization process.

Please bring the following to the "exit interview"

- *Your Position Task Book*
- *A completed and signed ICS 225 or 226 Performance Evaluation\**
- *A completed Trainee Exit Interview Form\**

*\*Forms are available at the Training Specialist Table*

Mike Wink  
(707) 889-4225  
[mike.wink@fire.ca.gov](mailto:mike.wink@fire.ca.gov)

Rob Scott-Trainee  
(949)292-3207  
[Rob.Scott@lacity.org](mailto:Rob.Scott@lacity.org)

TNSP is located in the back of room 16. Please feel free to contact us if you cannot come by in person.

## **Archaeological and Historic Properties Fireline Guidance for the Day Fire Modoc County, CA**

*Do not compromise safety for the protection and preservation of archaeological and historic properties. When possible and prudent:*

1. Be on the lookout for prehistoric archaeological sites. These sites may include seasonal camps marked by the presence of obsidian and/or basalt flakes and village sites that also include dark midden soils and perhaps circular housepit depressions. The Native American group living in the area at time of historic contact was the Achomawi.
2. Be on the lookout for historic archaeological sites. These sites may include old homesteads now marked by the presence of foundations, wells, and can dumps, early sawmill sites, abandoned ditches, and stacked rock foundation remains.
3. Look for these prehistoric and historic sites in flat areas, especially adjacent to streams and springs.
4. If you observe artifacts, features, or sites attempt to avoid if possible. If you can't avoid, minimize ground disturbance as much as possible, only clearing the surface to as minimal a depth as necessary. Try to go around sites with dozers rather than through them. Flag new sites if possible.
5. If you find artifacts leave them in place. Some artifacts may have been intentionally placed for religious or ceremonial reasons.
6. Note locations of discovered artifacts, features, and/or sites on a map. Better yet take a GPS reading if possible. Leave information for the archaeologist with the Plans Unit so that the sites can be relocated and protected during Fire Suppression Repair.
7. If you encounter a burial or other human remains, cease work in the area and contact Division immediately.



## Fire Suppression Repair

### Roads:

- Install waterbars where waterbars previously existed.
- Install new waterbars where needed.
- Install or maintain rolling dips where a rolling dip previously existed.
- Re-establish existing berms where applicable.
- Clean culverts plugged with soil and rock resulting from fire road use.
- Dip out stream crossings and stabilize if filled with dirt.
- Remove all slash and debris from culvert inlets/outlets.
- Water roads for dust abatement.

### Hand Lines and Dozer Lines

Install waterbars as described in the guidelines below. Waterbars are designed to Intercept, slow and spread precipitation run-off to reduce sediment transport and soil erosion. The intent is to move water off the fireline before it can build up enough energy to erode and transport sediment.

### Waterbar Guidelines:

These spacing distances should be used as a **guide**. Judgment should be used in locating waterbars to minimize erosion potential. It may not be possible or necessary to place waterbars in steep or rocky areas. Install waterbars at the following recommended minimum intervals:

<u>% Slope</u>	<u>0-25</u>	<u>26-50</u>	<u>≥50</u>
Hand Line	100'	75'	50'
Road /Dozer	150'	75'	50'

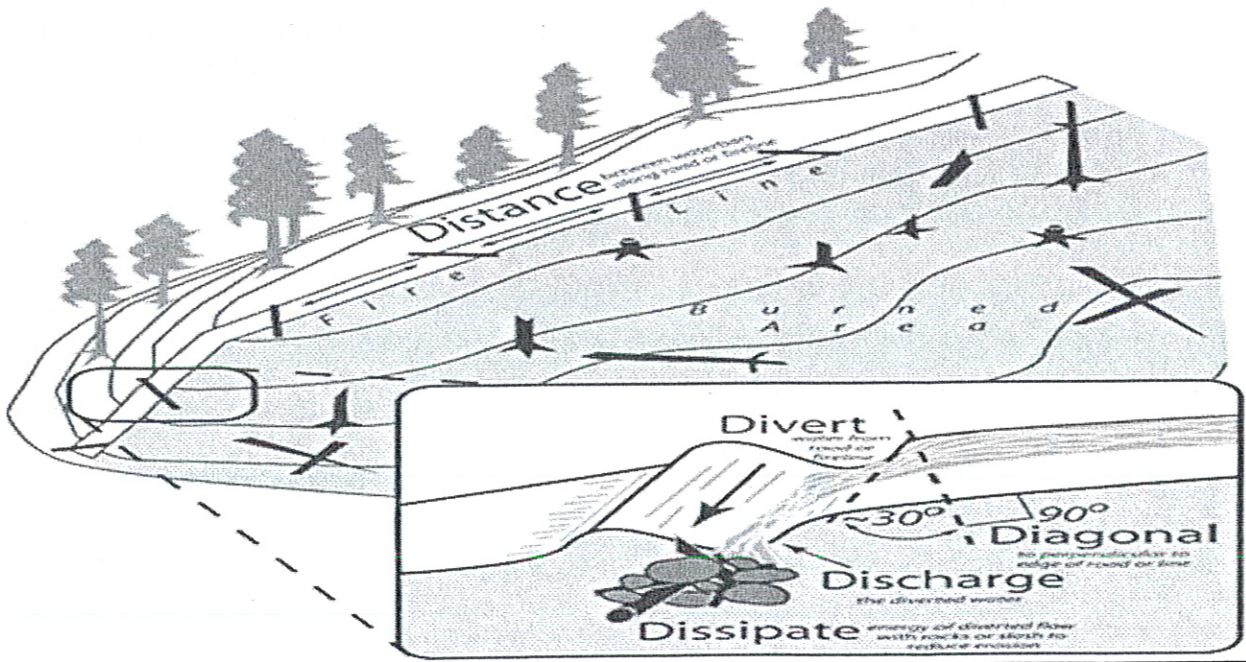

# OVERHEAD PARKING

P10



GISS CLERICAL COM RADIOS DES/MED

OPS/AIR OPS

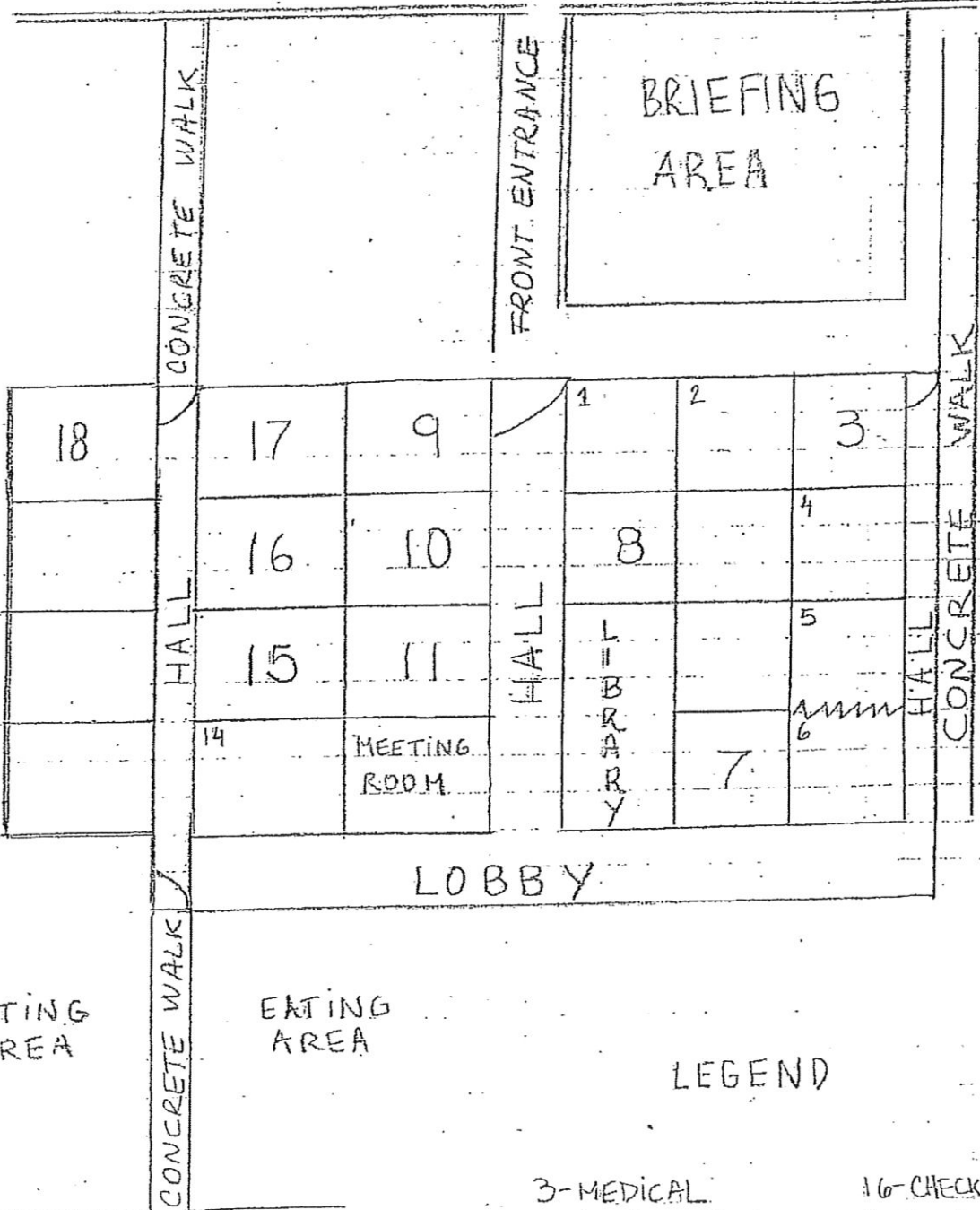

## LEGEND

- 3-MEDICAL
- 7- LOGS - FACIL
- 8- I.C
- 9- SAFETY
- 10- DES REP- LIAS ON
- 11- PROC- FINANCE
- 15- MOTELS
- 16- CHECK-IN
- DEM OB- PLAN
- TRAINING
- RESOURCES
- 17- SIT- FBAN
- NICS
- 18- TIME- COST- EQ

MKU

NOT TO SCALE





## INCIDENT MANAGEMENT TEAM 3



### DEMOBILIZATION PLAN - SUMMARY

Day Incident  
CA-LMU-003472

#### GENERAL INFORMATION

The Demobilization Plan is developed to facilitate the orderly removal and checkout of resources on the incident. By definition, surplus personnel are available for release if they have rested for a minimum of 8 hours, are cleaned up, outfitted and have a vehicle ready to depart to their next destination.

#### GENERAL GUIDELINES

- NO RESOURCES WILL LEAVE THE INCIDENT UNTIL AUTHORIZED TO DO SO BY THE DEMOBILIZATION UNIT.
- Efforts will be made to ensure that all released personnel arrive at their destination prior to 2200 hours. Resources not able to arrive at their destination by 2200 hours may need to arrange to rest over night.
- All government and hired vehicles leaving the incident will have a safety inspection.
- All trainees are to keep their time up to date and report to the Training Specialist with their task books and evaluations prior to completion of the demobilization process.
- All incident personnel will receive and read the Demob Safety Message before departing.

#### RESPONSIBILITIES

Unit Leaders will declare resources excess to their Section Chief. Section Chiefs will declare excess resources to the Planning Section Chief through the Resources Unit Leader. This should be done 36 hours in advance of anticipated release. Use the Declaration of Excess Resources Form or General Message Form (ICS-213) to list all excess resources. Include the Request #, ICS position, name/ID, date and time of declared excess, and time in which the resource will be eligible to leave. Send to the RESOURCES UNIT where the resource will be determined to be surplus to the incident. Surplus resources will then be able to report to the DEMOBILIZATION UNIT, receive a Demobilization Checkout Form (ICS 221), get the appropriate ICS 221 signatures, and then return the completed ICS 221 to the DEMOB UNIT prior to final release or reassignment.

#### RELEASE PRIORITIES

1. Organized fire departments
2. OES engines
3. Hired personnel and equipment
4. Other agencies (USFS, BLM, etc.)
5. Out of region CAL FIRE forces
6. Within Region CAL FIRE Forces
7. Unit CAL FIRE Forces



# CAL FIRE INCIDENT MANAGEMENT TEAM 3 WATER USAGE PLAN



## *California Drought Emergency*

The following shall be considered and implemented by all fire resources as a means to provide maximum efficiencies when utilizing water resources, while minimizing the impacts to private and public water supplies. Accountability shall be maintained for all water supplies that are utilized and care should be applied to ensure proper replacement and/or reimbursement to the supplier/owner.

### **Fireline personnel-** (During mop up operations)

- Use Pencil Hose and Garden Nozzles with Shut-Offs.
- Use Back pumps.
- Use Dry Mop-up and consolidation of heavy fuels to areas where they can burn out safely.
- Locate/Relocate Firelines to lighter fuels or natural barriers when safe.
- Set up and use portable tanks in anticipation of longer transport times for Water Tenders.
- Use of foams, gels and other water enhancers.
- Evaluate need to mop up in excess of 200 feet from fireline.

### **Road Maintenance and Repair-**

- Monitor and water roads only when and where needed.
- Water when most effective (evening and nights).
- Use chemical treatments when available (Magchloride, Omni bind etc.).
- Consider use of tertiary or treated water.

### **Aviation Operations-**

- Consider use of Gels, Foams and Retardants. Set up portable plants.
- Consider using Blivits and Pencil Hose for interior mop up operations as opposed to numerous bucket drops.
- Establish and use pre-use agreements for existing and known water sources.
- Use large watershed dip sites when able. Minimize use of small, static ponds and lakes.
- Maintain accountability of water used and locations of dip sites.
- Evaluate need for interior bucket drops.

### **Private Water Supplies-**

- Notify property owner as early as possible.
- Minimize usage and develop alternative water supplies when and where appropriate.
- Track usage (meter, ICS-214, IMT3 Water Usage Reports) and develop a plan to replace water.
- Make arrangements for reimbursement and damage claims if needed.

### **Public/Municipal Water Supplies-**

- Notify Agency as soon as possible and request a representative to the incident.
- Identify fill areas and request metering devices. Note locations on incident map.
- Use alternative or reclaimed water sources when available. Note locations on incident map.
- Make arrangements for reimbursement and damage claims if needed.

### **Management and Supervision-**

- Use leaders intent and establish Water Conservation as a Management Objective.
- Consider complexity of water use on incidents. Establish a Water Supply Group Supervisor to coordinate additional resources to support the incident needs.
- Complete the Water Usage Report daily and turn in to Situation Unit.
- Review this check list and brief daily.









