

DAY INCIDENT

CA-LMU-003472

OPERATIONAL PERIOD

August 7 - 8, 2014

0700-0700

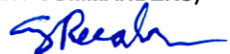

INCIDENT OBJECTIVES	1. INCIDENT NAME DAY	2. DATE 8/6/14	3. TIME 1900																								
4. OPERATIONAL PERIOD (DATE/TIME) 8/7/14 - 8/8/14 0700 – 0700																											
5. MANAGEMENT OBJECTIVES <ul style="list-style-type: none"> • Provide for firefighter and public safety. • Establish and maintain positive relationships with cooperating agencies and the public. • Provide timely and accurate incident information. • Keep costs commensurate with values at risk. • Provide for a safe and effective demobilization process. 6. GENERAL CONTROL OBJECTIVES <ul style="list-style-type: none"> • Keep the fire within established control lines. 																											
7. WEATHER FORECAST FOR OPERATIONAL PERIOD The air mass over the fire area will turn progressively warmer and drier today, with temperatures about 5 degrees warmer and humidity about 5 percent lower than yesterday. Winds will be mainly slope and terrain driven.																											
8. GENERAL SAFETY MESSAGE This is day 9 of the incident; keep your safety and the safety of your crews as the top priority. Watch for traffic on the roadways and be respectful of other drivers. SLOW DOWN!																											
9. Attachments (☑ if attached) <table border="0" style="width: 100%;"> <tr> <td><input checked="" type="checkbox"/> Organization List (ICS 203)</td> <td><input checked="" type="checkbox"/> Air Operations 220</td> <td><input checked="" type="checkbox"/> Finance Message</td> <td><input checked="" type="checkbox"/> Demob Plan</td> </tr> <tr> <td><input checked="" type="checkbox"/> Weather Forecast</td> <td><input checked="" type="checkbox"/> Communications Plan (ICS 205)</td> <td><input checked="" type="checkbox"/> Training Message</td> <td><input type="checkbox"/> Traffic Plan</td> </tr> <tr> <td><input checked="" type="checkbox"/> Fire Behavior Forecast</td> <td><input checked="" type="checkbox"/> Medical Plan (ICS 206)</td> <td><input checked="" type="checkbox"/> Archaeologist</td> <td><input checked="" type="checkbox"/> Facility Map</td> </tr> <tr> <td><input checked="" type="checkbox"/> Safety Message</td> <td><input checked="" type="checkbox"/> ICP Phone List</td> <td>Message</td> <td><input checked="" type="checkbox"/> Water Usage Report</td> </tr> <tr> <td><input checked="" type="checkbox"/> Assignment List (ICS 204)</td> <td><input type="checkbox"/> Camp Rules</td> <td><input checked="" type="checkbox"/> Suppression</td> <td><input checked="" type="checkbox"/> Unit Log 214</td> </tr> <tr> <td></td> <td><input type="checkbox"/> Information</td> <td>Repair Instructions</td> <td><input type="checkbox"/> _____</td> </tr> </table>				<input checked="" type="checkbox"/> Organization List (ICS 203)	<input checked="" type="checkbox"/> Air Operations 220	<input checked="" type="checkbox"/> Finance Message	<input checked="" type="checkbox"/> Demob Plan	<input checked="" type="checkbox"/> Weather Forecast	<input checked="" type="checkbox"/> Communications Plan (ICS 205)	<input checked="" type="checkbox"/> Training Message	<input type="checkbox"/> Traffic Plan	<input checked="" type="checkbox"/> Fire Behavior Forecast	<input checked="" type="checkbox"/> Medical Plan (ICS 206)	<input checked="" type="checkbox"/> Archaeologist	<input checked="" type="checkbox"/> Facility Map	<input checked="" type="checkbox"/> Safety Message	<input checked="" type="checkbox"/> ICP Phone List	Message	<input checked="" type="checkbox"/> Water Usage Report	<input checked="" type="checkbox"/> Assignment List (ICS 204)	<input type="checkbox"/> Camp Rules	<input checked="" type="checkbox"/> Suppression	<input checked="" type="checkbox"/> Unit Log 214		<input type="checkbox"/> Information	Repair Instructions	<input type="checkbox"/> _____
<input checked="" type="checkbox"/> Organization List (ICS 203)	<input checked="" type="checkbox"/> Air Operations 220	<input checked="" type="checkbox"/> Finance Message	<input checked="" type="checkbox"/> Demob Plan																								
<input checked="" type="checkbox"/> Weather Forecast	<input checked="" type="checkbox"/> Communications Plan (ICS 205)	<input checked="" type="checkbox"/> Training Message	<input type="checkbox"/> Traffic Plan																								
<input checked="" type="checkbox"/> Fire Behavior Forecast	<input checked="" type="checkbox"/> Medical Plan (ICS 206)	<input checked="" type="checkbox"/> Archaeologist	<input checked="" type="checkbox"/> Facility Map																								
<input checked="" type="checkbox"/> Safety Message	<input checked="" type="checkbox"/> ICP Phone List	Message	<input checked="" type="checkbox"/> Water Usage Report																								
<input checked="" type="checkbox"/> Assignment List (ICS 204)	<input type="checkbox"/> Camp Rules	<input checked="" type="checkbox"/> Suppression	<input checked="" type="checkbox"/> Unit Log 214																								
	<input type="checkbox"/> Information	Repair Instructions	<input type="checkbox"/> _____																								
10. PREPARED BY (PLANNING SECTION CHIEF) Pam Linstedt 		11. APPROVED BY (INCIDENT COMMANDERS) Steve Reeder 																									

ORGANIZATION ASSIGNMENT LIST		9. Operations Section	
1. Incident Name DAY		Day Ops	Nick Truax, Mark Higgins (T)
		Deputy	Sean Norman, Scott Hale (T)
2. Date Prepared 8/6/14	3. Time Prepared 1900	Night Ops	Jeff Ohs
4. Operational Period 8/7/14 - 8/8/14 0700 - 0700		Staging Area Manager	
		Line Safety Officer	Brian Cordeiro
5. Incident Commander and Staff		a. Branch I - Division/Groups	
Incident Commander	Robert Michael	Branch Director	Mike Inman
Deputy IC	Joe Tyler, Steve Reeder (T)	Deputy	
Safety Officer	Curtis Brown, Dave Sargenti (T)	Division/Group A	Jeffrey Reyes
Public Information Officer	Mike Smith, Richard Cordova (T)	Division/Group C/H	Dave Munch
Liaison Officer	Dennis Carreiro, Scott Henry (T)	Division/Group	
Law Enforcement Liaison	Sven Miller, Phil Fontanetta	Division/Group	
		Branch Safety Officer	
6. Agency Representative		b. Branch II - Division/Groups	
Agency/Organization	Name	Branch Director	Jeffrey Johnson
BLM	Michael Dolan	Deputy	
CAL OES	John Clary	Division/Group S	Dennis Nolan
CCC	Dylan Thomas	Division/Group V	Ken Kuykendall ST4156C
CDCR	Ernie Madrid	Division/Group W/X	Tim Cordero
Modoc SO	Mike Poindexter	Fire Suppression Repair	Ivan Houser, Don Schroeder (T)
USFS	Amanda McAdams	Branch Safety Officer	
		c. Branch III - Division/Groups	
7. Planning Section		Branch Director	
		Deputy	
Chief	Pam Linstedt	Division/Group	
Deputy	Jeff Adams, Rob Daugherty (T)	Division/Group	
Resources Unit	Chris Sauer, Jeff Dapper (T)	Division/Group	
Resources Unit	Shane Sherwood (T), Al Klem (T)	Division/Group	
Situation Unit	David Shy, Keith Tsudama (T)	Division/Group	
Documentation Unit	Susan Hudson	d. Air Operations Branch	
Demobilization Unit	Steve DeBenedet, Kevin Morris (T)	Air Ops. Branch Director	John Richardson
Fire Behavior Analyst	Chris Waters	Air Attack Supervisor	
Incident Meteorologist	Frederic Bunnag	Air Support Group Sup.	Matt Stanford, Shem Hawkins (T)
Training Specialist	Mike Wink, Rob Scott (T)	Helibase Manager	Jared Collins
GISS	Todd Tuggle, Chris Ingram	AAML	
Display Processor	Claudia Soiza	Air Tanker Coordinator	
8. Logistics Section		10. Finance Section	
Chief	Pete Gallegos	Chief	Rich Browne
Deputy	Geoff Pemberton	Deputy	Terry Eastwood
Support Branch Director		Time Unit	Rick Giubbini, Patrick Aguada (T)
Supply Unit	Tim Stewart, Amber Henderson (T)	Procurement Unit	Jack Franklin, Mara Zaver
Facilities Unit	Ernie Solis	Comp / Claims Unit	Laura Germany, Janet Lews (T)
Ground Support Unit	Steve Langston, John Ruedy (T)	Cost Unit	John Forsberg, Matt Rueckheim (T)
Accommodations	Brian Washington	Hired Equipment Tech Spec	Andy Whitlock
Service Branch Director			
Communications Unit	Kyle Johnson		
Medical Unit	Jorge Segura		
Food Unit	David Dayton	Prepared by (Resource Unit Leader)	
Ordering Manager	Mike Stebok, Andy Doyle	Chris Sauer CS	
Security Unit			



INCIDENT Weather Forecast



FORECAST NO: 06

NAME OF FIRE: Day

PREDICTION FOR: DAY and NIGHT SHIFT

UNIT: N/A

SHIFT DATE: Thursday Aug 7, 2014

SIGNED: *Frederic Bunnag*

TIME AND DATE

Incident Meteorologist

FORECAST ISSUED: Aug 6, 2014 1900 PDT

WEATHER DISCUSSION:

The air mass over the fire area will turn progressively warmer and drier each day. Temperatures today will be about 5 degrees warmer than yesterday with humidity about 5 percent lower. Winds will be mainly slope driven with ridge winds westerly during the day and northeasterly at night. Nighttime recovery will be coming down as well.

WEATHER FORECAST: DAY SHIFT

WEATHER: Partly cloudy. Cumulus build-up by 1400. Chance of showers after 1600.

TEMPERATURES: 85-89 valleys...82-85 mid slopes and ridges.

HUMIDITY: Minimum of 23-28%

20 FT WINDS:

RIDGETOP - Northeast 5 to 7 mph until 0900, then turning West and increasing to 8 to 10 mph after 1500.

SLOPE/VALLEY - Upslope wind 5 to 8 mph.

HAINES INDEX: 4 (Low)

LIGHTNING ACTIVITY LEVEL: 1.

WEATHER FORECAST: NIGHT SHIFT

WEATHER: Chance of showers until 20 00...then partly cloudy.

TEMPERATURES: Lows 55 to 60.

HUMIDITY: Maximum 50%.

20 FT WINDS:

RIDGETOP - West wind 8-10 mph until 2200, then turning Northeast 5-7 mph.

SLOPE/VALLEY - West wind 6-8 mph in the evening, then light downslope.

HAINES INDEX: 3 (Very Low)

LIGHTNING ACTIVITY LEVEL: 1.

OUTLOOK FOR FRIDAY AND SATURDAY: Warmer and drier each day. Highs 85-90 Friday. Min RH 15-20% Friday. Southwest wind around 10 mph.

FIRE BEHAVIOR FORECAST
Day Fire

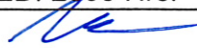
FORECAST NUMBER: 6	TYPE OF FIRE: Wildland Fire
FIRE NAME: Day Fire	OPERATIONAL PERIOD: 8/7/2014 0700-0700
DATE ISSUED: 8/6/2014	TIME ISSUED: 2000 Hrs.
UNIT: LMU – CAL FIRE Lassen-Modoc-Plumas	SIGNED: 

INPUTS

WEATHER SUMMARY:

Expect the weather to become progressively warmer and drier over the next several days. Expect nighttime relative humidity recovery to drop as well. Winds will be slope driven with ridge winds out of the west in the afternoon and northeasterly at night.

See Attached Incident Weather Forecast

OUTPUTS

FIRE BEHAVIOR:

No appreciable fire behavior expected today. The fire received a two day wind test without a significant fire behavior related incident. Weather continues to support mop up operations with lower temperatures and higher relative humidity. Expect the trend to change today. Warming will begin today and continue through the weekend.

Fuels: The Day Fire is burning primarily in commercial mixed conifer timber stands actively managed for timber production. Light to moderate slash accumulations as well as piles can be found throughout the fire area. All live fuels are under drought stress with live fuel moisture values at levels well below normal.

Topography: Topography ranges from moderately steep to flat with most of the fire area generally dominated by mild slopes.

SPECIFIC:

Mop up operations are in full force across the fire. Active fire has ceased; however the coming warming trend could bring parts of the fire back to life. The primary driver of fire spread for this fire was spotting.

All Divisions: No active fire expected today, however anticipate the weather change and its effect on fire behavior. Expect to see new and previously undetected hot spots as the weather warms up. Monitor control lines for potential short range spotting activity as the southwest winds and warmer weather returns to the area.

AIR OPERATIONS:

No air operations are planned for the Day Fire. In the event aircraft become necessary for an escape or a new fire, smoke from the other two fires in the area may impair visibility and aircraft access to the Day Fire.

SAFETY:

Stump holes and fire damaged trees continue to be a significant hazard. Active fire behavior is not expected however continue to monitor the fire area for isolated flare ups. Warmer and drier conditions will potentially allow new hot spots to flare up.



CAL FIRE INCIDENT MANAGEMENT TEAM 3



SAFETY MESSAGE	1. INCIDENT NAME:	2. DATE PREPARED:	3. TIME PREPARED:
	DAY	August 6, 2014	1400
4. PREPARED BY:	5. LEADER NAME:	6. OPERATIONAL PERIOD:	
David Sargenti	David Sargenti SOF1 (T)	8-7-2014 0700 TO 8-8-2014 0700	

SAFETY MESSAGE

ac·count·abil·i·ty

1. an obligation or willingness to accept responsibility or to account for ones actions.

- Watch for traffic on the roadways and be respectful of other drivers. SLOW DOWN!
- There's no glory in getting hurt during mop up, wear all PPE and pace yourself through the shift.
- Stay at least 100 feet away from the train tracks.
- Be aware of what is happening around you (SA) and adapt your exit strategy accordingly.
- Trees are weakened due to fire activity. Look Up, Down, and Around for tree hazards.
- While conducting mop up operations beware of stump holes, trip hazards and uneven terrain.
- Establish COMMUNICATIONS and report any coverage issues to your line supervisor.
- Document 2:1 rest and hydration on 214's. Take frequent breaks!!!
- This is day 9 of the incident, keep your safety and the safety of your crews as the top priority.

CAUTION!

ATTENTION!





INCIDENT RISK ANALYSIS (ICS 215A)

DIV	HAZARDOUS ACTIONS / CONDITIONS	MITIGATIONS/WARNINGS/REMEDIES	
ALL	DRIVING HAZARDS/ ROADS	<ul style="list-style-type: none"> • Drive defensively! SLOW DOWN!!!! • Increase following distances on dusty roads. Slow down when you meet opposing traffic. Be alert for construction work on Highway 299. • Drive with headlights on. • Be alert for wildlife, heavy trucks, and high speed opposing traffic crossing into your lane. • Check traffic approaching behind you when making left turns. 	
ALL	FATIGUE	<ul style="list-style-type: none"> • Be alert for signs of fatigue and take breaks as necessary. • Maintain 2:1 work/rest ratio. • Monitor incoming resources for level of fatigue. 	
ALL	SNAGS/ FIRE-WEAKENED TREE HAZARDS	<ul style="list-style-type: none"> • Follow Hazard Tree Safety Guidelines (IRPG p. 20 (RED)). • Many of the trees within the fire area are weakened due to fire activity. • Be especially alert around snags during wind events. 	
ALL	COMMUNICATIONS	<ul style="list-style-type: none"> • Be sure that all radios are cloned to the current frequency load. • Report any communication issues to your line supervisor 	
ALL	TRAINS	<ul style="list-style-type: none"> • Stay 100' away from tracks at all times. • Use caution when crossing tracks. LOOK both ways. 	
ALL	MEDICAL TRANSPORT	<ul style="list-style-type: none"> • Assign personnel with Advanced Life Support capability on the line. • Cache emergency equipment (backboards etc.) in various locations on line. • Maintain ALS ambulance at DROP POINT 23. • Keep line personnel informed of this issue. Safety briefings to stress that extra care should be taken with high-risk tasks (i.e. tree falling, chainsaw use, etc.). • Supervisors insure that personnel with severe reaction to bee sting, etc. have "epi-kits" or consider leaving such individuals in camp. 	
ALL	MOP UP	<ul style="list-style-type: none"> • Conduct thorough briefing for all personnel (inside rear cover IRPG). • Use all required PPE, including eye protection. • Maintain proper spacing and overhead clearance. • Be alert for stump holes and root cavities. • Minimize exposure to smoke, and rotate personnel into clean air as practical. 	
Incident Name <b style="text-align: center;">DAY ICS 215A		DATE PREPARED: 8/6/2014 Prepared by: DAVID SARGENT (SOE) <i>David Sargent</i>	OPERATIONAL PERIOD 0700-0700 8/7-8/2014

DIVISION ASSIGNMENT LIST			1. Branch I		2. Division/Group A			
3. Incident Name DAY			4. Operational Period Date: 8/7/14-8/8/14 Time: 0700-0700					
5. Operations Personnel								
Operations Chief		Nick Truax		Division/Group Supervisor		Jeffrey Reyes		
Branch Director		Michael Inman*		Safety		Brian Cordeiro		
6. Resources Assigned this Period								
Strike Team/Task Force/ Resource Designator		Leader		Number Persons	Trans. Needed	Drop Off PT./Time	Pick Up PT./Time	
STC MMU 9420C		Michael Surber		19		DP-10 @ 0900	0900	
STG LMU 9225G		Pat Benninghoven		37		DP-10 @ 0900	0900	
W/T PVT E-90		Jack Duncan		2		DP-10 @ 0900	0900	
W/T PVT E-91		Kyle Mendine		2		DP-10 @ 0900	0900	
W/T PVT E-95		Dan Brady		2		DP-10 @ 0900	0900	
W/T PVT E-96		Ron Belion		2		DP-10 @ 0900	0900	
FEMP O-286		Kevin Berkery		1		DP-10 @ 0900	0900	
FEMT O-298		Daniel Park		1		DP-10 @ 0900	0900	
7. Control Operations Mop up and patrol for 300' inside the line. Patrol for spot fires in the green. Backhaul all trash.								
8. Special Instructions *Denotes a 12 hour resource. SOFR is assigned to both Branches. FOBS may be working throughout the division. FOBS shall check in and out with DIVS as they enter or leave the division. Branches will be working for 12 hours only. A designated DIVS will assume Branch coverage at night.								
9. Division/Group Communication Summary								
Function	Frequency	System	Channel		Function	Frequency	System	Channel
Command	RX 168.0750 TX 170.4250		NIFC CMD 3 TONE 3		Air to Ground	RX/TX 159.3525		CDF TAC 25
Tactical Div/Group	RX/TX 154.2875		VFIRE 25		Air Guard	RX/TX 168.6250		AIR GUARD
Prepared by (Resource Unit Leader) Jeff Dapper			Approved by (Planning Sect. Ch.) Pam Linstedt <i>PL</i>			Date 8/6/14		Time 2300

DIVISION ASSIGNMENT LIST		1. Branch I		2. Division/Group C/H			
3. Incident Name DAY		4. Operational Period Date: 8/7/14-8/8/14 Time: 0700-0700					
5. Operations Personnel							
Operations Chief	Nick Truax	Division/Group Supervisor		Dave Munch			
Branch Director	Michael Inman*	Safety		Brian Cordeiro			
Strike Team/Task Force/ Resource Designator	Leader	Number Persons	Trans. Needed	Drop Off PT./Time	Pick Up PT./Time		
STC TCU 9440C	Landon Haack	17		DP-25 @ 0900	0900		
STC LNU 9142C	Jim Robbins	20		DP-25 @ 0900	0900		
CRW LMU DVG 4	Robert Veverka	15		DP-25 @ 0900	0900		
CRW LMU DVG 5	Kevin Fleming	15		DP-25 @ 0900	0900		
STG LNU 9146G	Mike Crosby	34		DP-25 @ 0900	0900		
W/T PVT E-2	John Hay	2		DP-25 @ 0900	0900		
W/T PVT E-94	Cody Penry	2		DP-25 @ 0900	0900		
W/T PVT E-97	Robbie Keene	2		DP-25 @ 0900	0900		
W/T PVT E-101	John Hill	2		DP-25 @ 0900	0900		
FALM O-370*	Richard Kersh	2		DP-25 @ 0900	1900		
FEMT O-178	Eric Jones	1		DP-25 @ 0900	0900		
FEMT O-300	Jeremy Wright	1		DP-25 @ 0900	0900		
7. Control Operations Mop up and patrol for 300' inside the line. Patrol for spot fires in the green. Backhaul all trash.							
8. Special Instructions *Denotes a 12 hour resource. SOFR is assigned to both Branches. FOBS may be working throughout the division. FOBS shall check in and out with DIVS as they enter or leave the division. Branches will be working for 12 hours only. A designated DIVS will assume Branch coverage at night.							
9. Division/Group Communication Summary							
Function	Frequency	System	Channel	Function	Frequency	System	Channel
Command	RX 168.0750 TX 170.4250		NIFC CMD 3 TONE 3	Air to Ground	RX/TX 159.3525		CDF TAC 25
Tactical Div/Group	RX/TX 154.2725		VFIRE 24	Air Guard	RX/TX 168.6250		AIR GUARD
Prepared by (Resource Unit Leader) Jeff Dapper		Approved by (Planning Sect. Ch.) Pam Linstedt <i>PJ</i>		Date 8/6/14		Time 2300	

DIVISION ASSIGNMENT LIST		1. Branch II		2. Division/Group S			
3. Incident Name DAY		4. Operational Period Date: 8/7/14-8/8/14 Time: 0700-0700					
5. Operations Personnel							
Operations Chief	Nick Truax	Division/Group Supervisor	Dennis Nolan				
Branch Director	Jeffrey Johnson*	Safety	Brian Cordeiro				
Strike Team/Task Force/ Resource Designator	Leader	Number Persons	Trans. Needed	Drop Off PT./Time	Pick Up PT./Time		
STC SKU 9260C	Scott Tavalero	20		DP-25 @ 0900	0900		
STC XSH 3151C	Don Lacy	18		DP-25 @ 0900	0900		
STG TGU 9257 G	Jeff Gowan	37		DP-25 @ 0900	0900		
STG LNU 9147G	John Layton	29		DP-25 @ 0900	0900		
W/T PVT E-92	Marty Learn	2		DP-25 @ 0900	0900		
W/T PVT E-98	Bruce Thomas	2		DP-25 @ 0900	0900		
W/T PVT E-99	Robert Ferde	2		DP-25 @ 0900	0900		
W/T PVT E-252	Ron Ron	2		DP-25 @ 0900	0900		
W/T PVT E-255	Jim Godby	2		DP-25 @ 0900	0900		
W/T PVT E-257	Nathan Orsi	2		DP-25 @ 0900	0900		
FALM O-369*	Jason Daugherty	1		DP-25 @ 0900	1900		
FEMP O-285	Dave Martinelli	1		DP-25 @ 0900	0900		
FEMT O-90	Carlos Munoz	1		DP-25 @ 0900	0900		
7. Control Operations Mop up and patrol for 300' inside the line. Patrol for spot fires in the green. Backhaul all trash.							
8. Special Instructions *Denotes a 12 hour resource. SOFR is assigned to both Branches. FOBS may be working throughout the division. FOBS shall check in and out with DIVS as they enter or leave the division. Branches will be working for 12 hours only. A designated DIVS will assume Branch coverage at night.							
9. Division/Group Communication Summary							
Function	Frequency	System	Channel	Function	Frequency	System	Channel
Command	RX 168.0750 TX 170.4250		NIFC CMD 3 TONE 3	Air to Ground	RX/TX 159.3525		CDF TAC 25
Tactical Div/Group	RX/TX 151.1375		VTAC 11	Air Guard	RX/TX 168.6250		AIR GUARD
Prepared by (Resource Unit Leader) Jeff Dapper		Approved by (Planning Sect. Ch.) Pam Linstedt <i>PL</i>		Date 8/6/14		Time 2300	

DIVISION ASSIGNMENT LIST		1. Branch II		2. Division/Group V			
3. Incident Name DAY		4. Operational Period Date: 8/7/14-8/8/14 Time: 0700-0700					
5. Operations Personnel							
Operations Chief	Nick Truax	Division/Group Supervisor		Ken Kuykendall			
Branch Director	Jeffrey Johnson*	Safety		Brian Cordeiro			
Strike Team/Task Force/ Resource Designator	Leader	Number Persons	Trans. Needed	Drop Off PT./Time	Pick Up PT./Time		
STC XSA 4156C	Ken Kuykendall	22		DP-23 @ 0900	0900		
W/T PVT E-293	Brian Sampson	3		DP-23 @ 0900	0900		
FEMT O-302	Brian Solidum	1		DP-23 @ 0900	0900		
FEMT O-304	Bill Clark	1		DP-23 @ 0900	0900		
7. Control Operations Mop up and patrol for 300' inside the line. Patrol for spot fires in the green. Backhaul all trash.							
8. Special Instructions *Denotes a 12 hour resource. SOFR is assigned to both Branches. FOBS may be working throughout the division. FOBS shall check in and out with DIVS as they enter or leave the division. Branches will be working for 12 hours only. A designated DIVS will assume Branch coverage at night.							
9. Division/Group Communication Summary							
Function	Frequency	System	Channel	Function	Frequency	System	Channel
Command	RX 168.0750 TX 170.4250		NIFC CMD 3 TONE 3	Air to Ground	RX/TX 159.3525		CDF TAC 25
Tactical Div/Group	RX/TX 154.2950		VFIRE 23	Air Guard	RX/TX 168.6250		AIR GUARD
Prepared by (Resource Unit Leader) Jeff Dapper		Approved by (Planning Sect. Ch.) Pam Linstedt <i>PL</i>		Date 8/6/14		Time 2300	

DIVISION ASSIGNMENT LIST		1. Branch II		2. Division/Group W/X																																																																									
3. Incident Name DAY		4. Operational Period Date: 8/7/14-8/8/14 Time: 0700-0700																																																																											
5. Operations Personnel																																																																													
Operations Chief	Nick Truax		Division/Group Supervisor	Tim Cordero																																																																									
Branch Director	Jeffrey Johnson*		Safety	Brian Cordeiro																																																																									
<table border="1"> <thead> <tr> <th>Strike Team/Task Force/Resource Designator</th> <th>Leader</th> <th>Number Persons</th> <th>Trans. Needed</th> <th>Drop Off PT./Time</th> <th>Pick Up PT./Time</th> </tr> </thead> <tbody> <tr> <td>STC CZU 9171C</td> <td>Aldo Gonzalez</td> <td>22</td> <td></td> <td>DP-23 @ 0900</td> <td>0900</td> </tr> <tr> <td>STG CZU 9175G</td> <td>Mike Harris</td> <td>33</td> <td></td> <td>DP-23 @ 0900</td> <td>0900</td> </tr> <tr> <td>W/T PVT E-100</td> <td>Charles Rainey</td> <td>2</td> <td></td> <td>DP-23 @ 0900</td> <td>0900</td> </tr> <tr> <td>W/T PVT E-105</td> <td>Randy May</td> <td>2</td> <td></td> <td>DP-23 @ 0900</td> <td>0900</td> </tr> <tr> <td></td> <td></td> <td></td> <td></td> <td></td> <td></td> </tr> <tr> <td></td> <td></td> <td></td> <td></td> <td></td> <td></td> </tr> <tr> <td></td> <td></td> <td></td> <td></td> <td></td> <td></td> </tr> <tr> <td></td> <td></td> <td></td> <td></td> <td></td> <td></td> </tr> <tr> <td></td> <td></td> <td></td> <td></td> <td></td> <td></td> </tr> <tr> <td></td> <td></td> <td></td> <td></td> <td></td> <td></td> </tr> <tr> <td></td> <td></td> <td></td> <td></td> <td></td> <td></td> </tr> </tbody> </table>						Strike Team/Task Force/Resource Designator	Leader	Number Persons	Trans. Needed	Drop Off PT./Time	Pick Up PT./Time	STC CZU 9171C	Aldo Gonzalez	22		DP-23 @ 0900	0900	STG CZU 9175G	Mike Harris	33		DP-23 @ 0900	0900	W/T PVT E-100	Charles Rainey	2		DP-23 @ 0900	0900	W/T PVT E-105	Randy May	2		DP-23 @ 0900	0900																																										
Strike Team/Task Force/Resource Designator	Leader	Number Persons	Trans. Needed	Drop Off PT./Time	Pick Up PT./Time																																																																								
STC CZU 9171C	Aldo Gonzalez	22		DP-23 @ 0900	0900																																																																								
STG CZU 9175G	Mike Harris	33		DP-23 @ 0900	0900																																																																								
W/T PVT E-100	Charles Rainey	2		DP-23 @ 0900	0900																																																																								
W/T PVT E-105	Randy May	2		DP-23 @ 0900	0900																																																																								
<p>7. Control Operations</p> <p>Mop up and patrol for 300' inside the line.</p> <p>Patrol for spot fires in the green.</p> <p>Backhaul all trash.</p>																																																																													
<p>8. Special Instructions</p> <p>*Denotes a 12 hour resource.</p> <p>SOFR is assigned to both Branches.</p> <p>FOBS may be working throughout the division.</p> <p>FOBS shall check in and out with DIVS as they enter or leave the division.</p> <p>Branches will be working for 12 hours only.</p> <p>A designated DIVS will assume Branch coverage at night.</p>																																																																													
9. Division/Group Communication Summary																																																																													
Function	Frequency	System	Channel	Function	Frequency	System	Channel																																																																						
Command	RX 168.0750		NIFC CMD 3 TONE 3	Air to Ground	RX/TX		CDF TAC 25																																																																						
	TX 170.4250				159.3525																																																																								
Tactical Div/Group	RX/TX 154.4525		VTAC 12	Air Guard	RX/TX 168.6250		AIR GUARD																																																																						
Prepared by (Resource Unit Leader) Jeff Dapper		Approved by (Planning Sect. Ch.) Pam Linstedt		Date 8/6/14		Time 2300																																																																							

DIVISION ASSIGNMENT LIST			1. Branch	2. Division/Group FIRE SUPPRESSION REPAIR (1 of 2)			
3. Incident Name DAY			4. Operational Period Date: 8/7/14-8/8/14 Time: 0700-0700				
5. Operations Personnel							
Operations Chief		Nick Truax		Group Supervisor		Ivan Houser Don Schroeder (T)	
Branch Director				Safety		Brian Cordeiro	
6. Resources Assigned this Period							
Strike Team/Task Force/ Resource Designator	Leader	Number Persons	Trans. Needed	Drop Off PT./Time	Pick Up PT./Time		
STG LAC 1184 G	Patrick Sprengel	33		0900	1900		
STG LAC 1185 G	Jason Toshack	31		0900	1900		
STG LAC 1186 G	Jack Haynes	33		0900	1900		
DOZ PVT E-82	John Hertzig	2		0900	1900		
DOZ PVT E-168	Brian Forker	2		0900	1900		
DOZ PVT E-173	Mark Garner	2		0900	1900		
DOZ PVT E-176	Angelo Cattaneo	2		0900	1900		
DOZ PVT E-181	Sunny Moore	2		0900	1900		
W/T PVT E-1	Wes Hutchens	2		0900	1900		
7. Control Operations Fire suppression repair to be done per the Fire Suppression Repair Plan. Check in and out with DIVS as you enter and leave divisions.							
8. Special Instructions All resources assigned to Fire Suppression Repair are working a 12 hour shift.							
9. Division/Group Communication Summary							
Function	Frequency	System	Channel	Function	Frequency	System	Channel
Command	RX 168.0750 TX 170.4250		NIFC CMD 3 TONE 3	Air to Ground	RX/TX 159.3525		CDF TAC 25
Tactical Div/Group	RX/TX 158.7375		VTAC 13	Air Guard	RX/TX 168.6250		AIR GUARD
Prepared by (Resource Unit Leader) Jeff Dapper		Approved by (Planning Sect. Ch.) Pam Linstedt <i>PL</i>			Date 8/6/14		Time 2300

DIVISION ASSIGNMENT LIST			1. Branch	2. Division/Group FIRE SUPPRESSION REPAIR (2 of 2)			
3. Incident Name DAY			4. Operational Period Date: 8/7/14-8/8/14 Time: 0700-0700				
5. Operations Personnel							
Operations Chief		Nick Truax		Group Supervisor		Ivan Houser Don Schroeder (T)	
Branch Director				Safety		Brian Cordeiro	
6. Resources Assigned this Period							
Strike Team/Task Force/ Resource Designator	Leader	Number Persons	Trans. Needed	Drop Off PT./Time	Pick Up PT./Time		
W/T PVT E-93	Bryan Troedez	2		0900	1900		
W/T PVT E-102	Doug Hill	2		0900	1900		
W/T PVT E-103	Jeff Graham	2		0900	1900		
W/T PVT E-258	Doug Graham	1		0900	1900		
FOBS (T) O-24	David Wade	1		0900	1900		
FOBS O-119	Edwin Simpson	1		0900	1900		
FOBS O-121	John Clark	1		0900	1900		
FOBS O-122	Keith Dietz	1		0900	1900		
FOBS O-126	Matt Brady	1		0900	1900		
FOBS O-172	Gary Whitson	1		0900	1900		
FOBS O-313	Joshua Potter	1		0900	1900		
7. Control Operations Fire suppression repair to be done per the Fire Suppression Repair Plan. Check in and out with DIVS as you enter and leave divisions.							
8. Special Instructions All resources assigned to Fire Suppression Repair are working a 12 hour shift.							
9. Division/Group Communication Summary							
Function	Frequency	System	Channel	Function	Frequency	System	Channel
Command	RX 168.0750 TX 170.4250		NIFC CMD 3 TONE 3	Air to Ground	RX/TX 159.3525		CDF TAC 25
Tactical Div/Group	RX/TX 158.7375		VTAC 13	Air Guard	RX/TX 168.6250		AIR GUARD
Prepared by (Resource Unit Leader) Jeff Dapper		Approved by (Planning Sect. Ch.) Pam Linstedt <i>PJ</i>			Date 8/6/14		Time 2300

AIR OPERATIONS SUMMARY 220

PREPARED BY: Matt Stanford

DATE: 8/06/2014

1. INCIDENT NAME: Day		2. OPERATIONAL DATE: 08/07/2014		SUNRISE: 0700		SUNSET: 1950			
3. REMARKS (Safety Notes, Flight-Hazards, Other Hazards, Air Operations, and Special Equipment, etc.): Smokey Conditions *Numerous fires in the area. Copter 202 will operate out of Bieber. Order H-202 through communications.				4. AIR RESCUE AIRCRAFT: H-202 Day time <i>Activation Instructions:</i> CANG H-826 Available 24/7 @ Redding Airport. Order rescue helicopter through communications. They will relay to Susanville ECC.				5. TFR/91.137: Radius: NM Altitude: MSL Center Point: Latitude: Longitude:	
Helibase(s) Name: Lat./Long: Lat./Long:									
3a. Water Points:									
3b. Helispots:									
6. PERSONNEL		Telephone		Cellular		Pager			
AOBD		John Richardson		805-9033403					
ASGS		Matt Stanford		951-5458205					
ASGS		Shem Hawkins (T)		650-2451717					
ATGS									
ATGS (Relief)									
HEBM		Jared Collins							
HELCO									
DECK									
TOLC									
AGENCY AIRCRAFT DISPATCH OFFICE									
AGENCY AVIATION MILITARY LIAISON									
CANG									
8. PERSONNEL ON ORDER:									
SEE INCIDENT RADIO COMMUNICATIONS PLAN (205) FOR ALL OTHER FREQUENCIES!									
9. FIXED WING:		Identifier		Base		Type			
Leadplane(s):						Helitanker(s):			
Tanker(s):						I: 1 II: 1 III: IV:			
I:						202			
II:									
III:									
IV:									
11. SPECIAL ASSIGNED EQUIPMENT:									
AIRCRAFT RESCUE FIRE FIGHTERS									
Helibase dust abatement Water Tender(s)									
12. : EQUIPMENT ON ORDER:									
ICS-220A (January 2001)									

, on site at _____ at helibase(s).
 _____ helibase(s).

INCIDENT RADIO COMMUNICATIONS PLAN		Incident Name				Date/Time Prepared			Operational Period Date/Time		
INCIDENT RADIO COMMUNICATIONS PLAN		Day Incident				8/6/2014 1740			8/7/14 0700 - 8/8/14 0700		
Ch #	Function	Channel Name/Trunked Radio System Talkgroup	Assignment	RX Freq	N or W	RX Tone/NAC	TX Freq	N or W	Tx Tone/NAC	Mode A, D or M	Remarks
1	Command	NIFC CMD 3	All Divisions	168.0750	N		170.4250	N	131.8 (3)	A	TONE 3
2		BLANK									
3	Tactical	VFIRE 23	Div V	154.2950	N	156.7 (6)	154.2950	N	156.7 (6)	A	
4	Tactical	VFIRE 24	Div C/H	154.2725	N	156.7 (6)	154.2725	N	156.7 (6)	A	
5	Tactical	VFIRE 25	Div A	154.2875	N	156.7 (6)	154.2875	N	156.7 (6)	A	
6		BLANK									
7	Tactical	VTAC 11	Div S	151.1375	N	156.7 (6)	151.1375	N	156.7 (6)	A	
8	Tactical	VTAC 12	Div W/X	154.4525	N	156.7 (6)	154.4525	N	156.7 (6)	A	
9	Tactical	VTAC 13	Fire Sup Repair	158.7375	N	156.7 (6)	158.7375	N	156.7 (6)	A	
10	Tactical	VTAC 14	Unassigned	159.4725	N	156.7 (6)	159.4725	N	156.7 (6)	A	
11	Air To Ground	CDF TAC 25	All Divisions	159.3525	N	192.8 (16)	159.3525	N	192.8 (16)	A	
12		BLANK									
13	Tactical	CALCORD	All Divisions	156.0750	N	156.7 (6)	156.0750	N	156.7 (6)	A	EMS ON INCIDENT
14		BLANK									
15		BLANK									
16	Emergency	Air Guard	All Branches	168.6250	N		168.6250	N	110.9 (1)	A	EMERGENCIES ONLY
17		BLANK									
18		BLANK									
19		BLANK									
20	Emergency	Air Guard	All Branches	168.6250	N		168.6250	N	110.9 (1)	A	EMERGENCIES ONLY

Incident Location

County Lassen & Modoc State CA Latitude N Longitude W

Kyle Johnson

Prepared By (Communications Unit) **KYLE JOHNSON - COML TEAM 3**

The convention calls for frequency lists to show four digits after the decimal place, followed by either an "N" or a "W", depending on whether the frequency is narrow or wide band. Mode refers to either "A" or "D" indicating analog or digital (e.g. Project 25) or "M" indicating mixed mode. All channels are shown as if programmed in a control station, mobile or portable radio. Repeater and base stations must be programmed with the Rx and Tx reversed.

MEDICAL PLAN ICS 206	1. INCIDENT NAME Day Incident	2. DATE PREPARED 08/06/2014	3. TIME PREPARED 1700	4. OPERATIONAL PERIOD 0700-0700 08/07/2014- 08/08/2014
---------------------------------------	---	--------------------------------	--------------------------	--

5. INCIDENT MEDICAL AID STATIONS

MEDICAL AID STATIONS	LOCATION	PARAMEDICS	
		YES	NO
Medical Unit	ICP Room 3		X

6. TRANSPORTATION

A. AMBULANCE SERVICES

NAME	LOCATION	PHONE	PARAMEDICS	
			YES	NO
Ground Amb. – Mayers 1	43563 Hwy 299E, Fall River Mills	530-336-5151	X	
Air Amb. – PHI Med	5900 Old Oregon Trail, Redding, CA 96002	800-597-9571	X	
Air Amb.–Mountain Life Flight	710 Ash St., Susanville, CA 96130	530-257-2444	X	

B. INCIDENT AMBULANCES

NAME	LOCATION	PARAMEDICS	
		YES	NO
Mayers 2 Ambulance	Drop Point 25	X	

7. HOSPITALS

NAME Med Net Channel	ADDRESS	TRAVEL TIME		PHONE	HELIPAD		BURN CENTER	
		AIR	GRND		YES	NO	YES	NO
Mayers Memorial	43563 Hwy 299E, Fall River Mills	8 Min	20 Min	530-336-5111 x1144	X			X
Mercy Medial Center	2175 Rosaline Ave, Redding, CA	38 Min	75 Min.	530-225-7214	X			X
UC Davis Med Cnt	2315 Stockton Blvd. Sacramento	90 Min	4 Hr	916-734-3636	X		X	

8. MEDICAL EMERGENCY PROCEDURES

LINE EMERGENCY:

Crew Supervisor will contact **Division Supervisor** with patient complaint/condition and location.

- **Division/Group Supervisor contacts:**
 1. Closest EMS resource
 2. Communications Unit
- **Communications Unit contacts:**
 1. Ground or Air ambulance as requested
 2. Operations
 3. Safety
- **Division Supervisor or designee** will serve as point of contact and run medical emergency on assigned channel.
 1. **CALCORD** shall be used as the tactical frequency for IWI and only for duration of need.
- Communications Unit will clear command channel for emergency traffic as needed and only for duration of need.

INJURY REPORTING PROCEDURES

NATURE OF INJURY _____
 LOCATION OF PATIENT _____
 POINT OF CONTACT _____
 TRANSPORTATION REQUESTED BY: AIR ___ GROUND ___
 POINT OF PICKUP _____
 LAT _____ LONG _____
 PATIENT UNIT ID _____
 IS AN EMT WITH PATIENT: YES ___ NO ___
 AGE _____
 SEX: MALE ___ FEMALE ___

START RESOURCES EARLY – DON'T WAIT

ALL EMERGENCIES---Secure the area and identify witnesses for later investigation. Keep an accurate log of events.

ICS 206
(Rev 03/12) FR

9. PREPARED BY: (Medical Unit Leader)

 Jorge H. Segura MEDL/Jeff Whitaker MEDL(T)

10. REVIEWED BY: (Safety Officer)

 Curtis Brown SOF1/David Sargenti SOF1(T)

COMMUNICATIONS UNIT

INCIDENT NAME:	DAY
INCIDENT NUMBER:	CA-LMU-003472

DATE: 08/07/2014

COMMUNICATIONS	LINE 1	LINE 2	LINE 3	LINE 4	FAX
COM 24	(530) 339-0009	(530) 524-1465	(530) 949-6816	(530) 949-6817	(530) 335-2181
LMU EXPANDED	(530) 257-6424	(530) 257-6417			
LMU ECC DUTY OFFICER	(530) 310-2207				
LMU LINE OFFICER	(530) 310-2236				

UNIT	ROOM	LINE 1	LINE 1	LINE 1	FAX
SITUATION	17	(530) 335-4007			
CHECK-IN/DEMOB	16	(530) 335-2432			
RESOURCES		(530) 335-4862			
PIO		(951) 232-4049			
ORDERING		(562) 307-7045			
LIAISON		(530) 335-4896	(530) 335-3749		
SAFETY (24 HOURS)		(530) 335-6019	(707) 217-9278		
COST/TIME	18	(530) 355-5212			
FINANCE		(530) 335-3294			
PROCUREMENT		(530) 335-4210			
SUPPLY					(831) 265-4390
HELIBASE		(858) 353-6261			
DAY FIRE INFO		(530) 638-3614			
EILER FIRE INFO		(530) 225-2510			
BALD FIRE INFO		(530) 336-6553			
AGENCY	NAME	LINE 1	LINE 1	LINE 1	FAX
SPI	Herb Baldwin	(530) 378-8111			



FINANCE SECTION

MESSAGE

8/7/14



Please make sure hired equipment shift tickets are completed and dropped off in the Time Unit by agency personnel / line supervisors only.

Please report all injuries and suppression damage to the Comp / Claims Unit, no matter how minor. For fire suppression damage, please include photos (if possible), a location address and / or Lat / Long and a brief description.

Please use the water use forms included in the IAP and turn into Situation Unit.

All off site feeding charged to the incident must be pre-approved by the Logistics Section and/or Finance Section Chief. The Motel Tech Spec will have information on this.

ROGER RAINES, FSC1
TERRY EASTWOOD, DEP. FSC1

SHIFT TICKET EXAMPLE

EMERGENCY SHIFT TICKET and EVALUATION FORM					Contractor Name	
The responsible Government Officer will complete this form each shift					Fireline Builders	
Incident or Project Name Incident Name		Incident Number Incident Number	Request Number E or S # Here		Operator #1 Bob Smith	Operator #2 Jeff Smith
Agreement Number XXX - 000000 - 00					Operator Furnished By: <input checked="" type="checkbox"/> Contractor <input type="checkbox"/> Government	
Equipment Make CAT		Equipment Model / Type D6H Type			Operating Supplies Furnished By: <input checked="" type="checkbox"/> Contractor <input type="checkbox"/> Government	
Serial Number 6LN3344		Licence Number			Equipment Status <input checked="" type="checkbox"/> Inspected <input checked="" type="checkbox"/> Under Agreement	
Equipment Use					Released by Government	
(Circle) Hours / Days / Miles					Withdrawn by Contractor	
Date Mo / Day	Start	Stop	Work	Assignment		
8/13	0001	2400	24	Division B		
Vendor Rating					Remarks/Comments **	
Govt. Rep. Name and Position - PRINT					Mike Weber	
Govt. Rep. Signature					Mike Weber	
Contractor Signature					Bob Smith	
Date					Time	
08/19/14					0700	
* NOTE: Any rating of POOR requires an explanation in Comment Section.					CALFIRE 297	
**Final evaluation or for more documentation, use an ICS Form 230 or equivalent.					(Rev 3-2011)	
Pink - Finance		Blue - Home Unit HE Coordinator		Yellow - Vendor		White - Govt Representative

EMERGENCY SHIFT TICKET and EVALUATION FORM					Contractor Name	
The responsible Government Officer will complete this form each shift					Fireline Builders	
Incident or Project Name Incident Name		Incident Number Incident Number	Request Number E or S # Here		Operator #1 Bob Smith	Operator #2
Agreement Number Obtain from vendor's agreement					Operator Furnished By: <input checked="" type="checkbox"/> Contractor <input type="checkbox"/> Government	
Equipment Make Year Peterbilt		Equipment Model / Type Model # Wheels			Operating Supplies Furnished By: <input checked="" type="checkbox"/> Contractor <input type="checkbox"/> Government	
Serial Number 1XP3ESMP14239012		Licence Number 9P54457			Equipment Status <input checked="" type="checkbox"/> Inspected <input checked="" type="checkbox"/> Under Agreement	
Equipment Use					Released by Government	
(Circle) Hours / Days / Miles					Withdrawn by Contractor	
Date Mo / Day	Start	Stop	Work	Assignment		
8/18	0001	0700	7	Off Shift		
8/18	0701	1900	12	Division B		
8/18	1901	2400	5	Off Shift		
Vendor Rating					Remarks/Comments **	
Govt. Rep. Name and Position - PRINT					Mike Weber	
Govt. Rep. Signature					Mike Weber	
Contractor Signature					Bob Smith	
Date					Time	
08/19/14					0700	
* NOTE: Any rating of POOR requires an explanation in Comment Section.					CALFIRE 297	
**Final evaluation or for more documentation, use an ICS Form 230 or equivalent.					(Rev 3-2011)	
Pink - Finance		Blue - Home Unit HE Coordinator		Yellow - Vendor		White - Govt Representative

Turn shift tickets into Finance.

Contact Andy Whitlock for questions: 707-498-7545



DAY FIRE

Training Specialist Message

08/07/14

All Day Incident Trainees and Trainers:
Unless you are otherwise notified, all open training assignments on the Day Incident must be “closed out” with the TNSP by 0900 hours on Friday, August 8th.

In order to receive documented credit for your training assignment – you must close out with the Training Specialist before you complete the demobilization process

If as much work as possible has been completed in the position task book, Trainees may close their assignment with the TNSP prior to the demobilization process.

Please bring the following to the “exit interview”

- **Your Position Task Book**
- **A completed and signed ICS 225 or 226 Performance Evaluation***
- **A completed Trainee Exit Interview Form***

**Forms are available at the Training Specialist Table*

Mike Wink
(707) 889-4225
mike.wink@fire.ca.gov

Rob Scott-Trainee
(949)292-3207
Rob.Scott@lacity.org

TNSP is located in the back of room 16. Please feel free to contact us if you cannot come by in person.

Archaeological and Historic Properties Fireline Guidance for the Day Fire Modoc County, CA

Do not compromise safety for the protection and preservation of archaeological and historic properties. When possible and prudent:

1. Be on the lookout for prehistoric archaeological sites. These sites may include seasonal camps marked by the presence of obsidian and/or basalt flakes and village sites that also include dark midden soils and perhaps circular housepit depressions. The Native American group living in the area at time of historic contact was the Achomawi.
2. Be on the lookout for historic archaeological sites. These sites may include old homesteads now marked by the presence of foundations, wells, and can dumps, early sawmill sites, abandoned ditches, and stacked rock foundation remains.
3. Look for these prehistoric and historic sites in flat areas, especially adjacent to streams and springs.
4. If you observe artifacts, features, or sites attempt to avoid if possible. If you can't avoid, minimize ground disturbance as much as possible, only clearing the surface to as minimal a depth as necessary. Try to go around sites with dozers rather than through them. Flag new sites if possible.
5. If you find artifacts leave them in place. Some artifacts may have been intentionally placed for religious or ceremonial reasons.
6. Note locations of discovered artifacts, features, and/or sites on a map. Better yet take a GPS reading if possible. Leave information for the archaeologist with the Plans Unit so that the sites can be relocated and protected during Fire Suppression Repair.
7. If you encounter a burial or other human remains, cease work in the area and contact Division immediately.

Fire Suppression Repair

Roads:

- Install waterbars where waterbars previously existed.
- Install new waterbars where needed.
- Install or maintain rolling dips where a rolling dip previously existed.
- Re-establish existing berms where applicable.
- Clean culverts plugged with soil and rock resulting from fire road use.
- Dip out stream crossings and stabilize if filled with dirt.
- Remove all slash and debris from culvert inlets/outlets.
- Water roads for dust abatement.

Hand Lines and Dozer Lines

Install waterbars as described in the guidelines below. Waterbars are designed to intercept, slow and spread precipitation run-off to reduce sediment transport and soil erosion. The intent is to move water off the fireline before it can build up enough energy to erode and transport sediment.

Waterbar Guidelines:

These spacing distances should be used as a **guide**. Judgment should be used in locating waterbars to minimize erosion potential. It may not be possible or necessary to place waterbars in steep or rocky areas. Install waterbars at the following recommended minimum intervals:

<u>% Slope</u>	<u>0-25</u>	<u>26-50</u>	<u>>50</u>
Hand Line	100'	75'	50'
Road /Dozer	150'	75'	50'

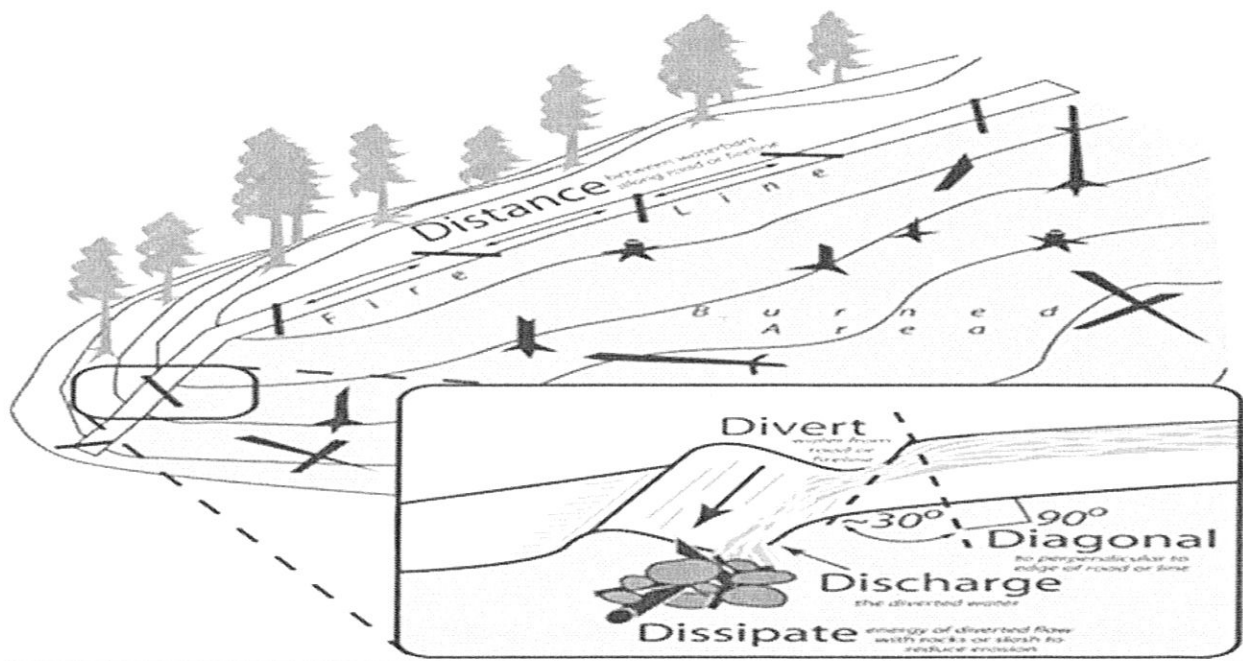

OVERHEAD PARKING

P10



GISS CLERICAL COM RADIOS DES/MED

OPS/AIR OPS

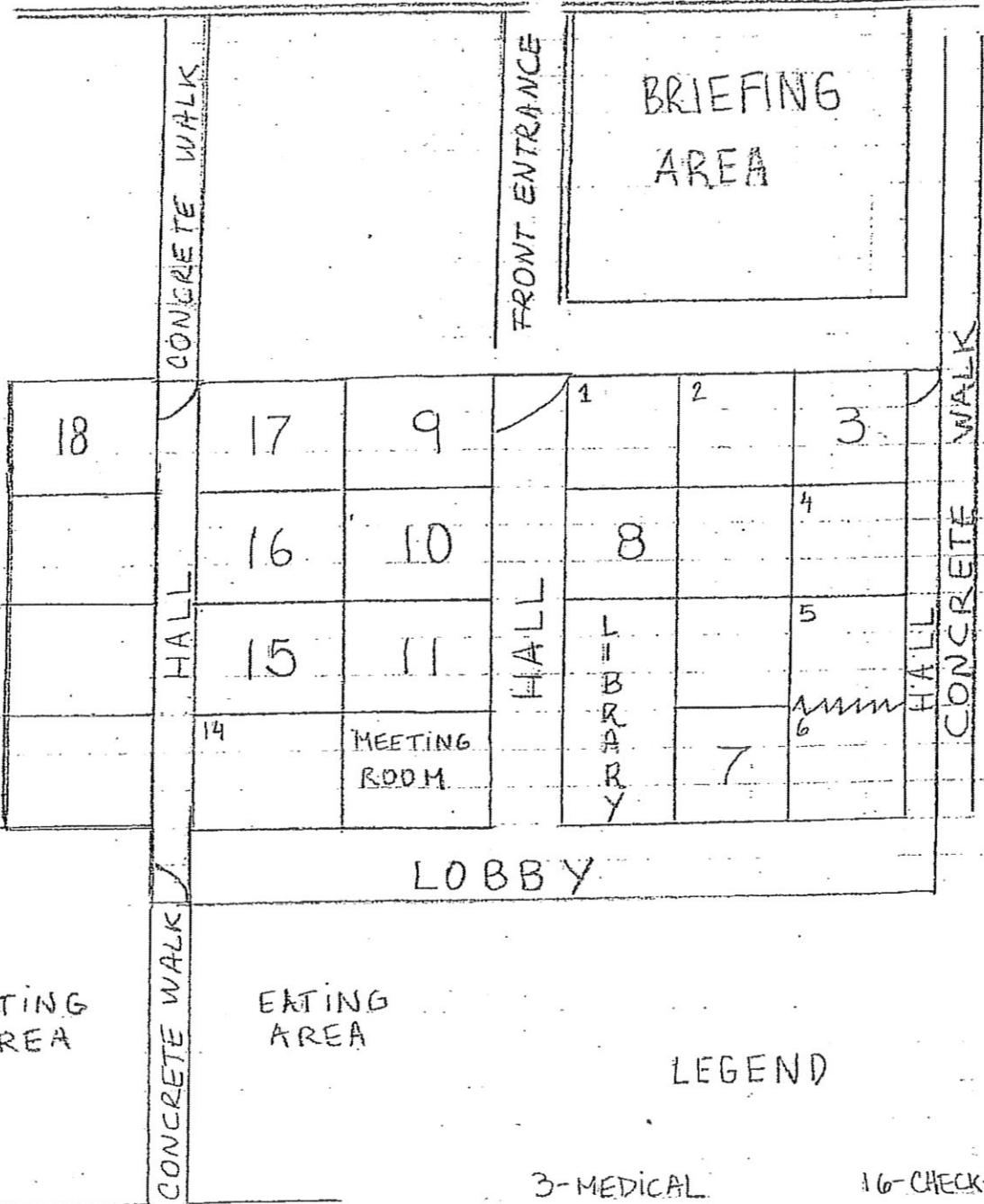

EATING AREA

EATING AREA

LEGEND

- 3-MEDICAL
- 7-LOGS-FACI
- 8-IC
- 9-SAFETY
- 10-DES REP-LIASON
- 11-PROC-FINANCE
- 15-MOTELS
- 16-CHECK-IN
- DEMOB-PLAN
- TRAINING
- RESOURCES
- 17-SIT-PLAN
- NICS
- 18-TIME-COST-EQ

MKV

NOT TO SCALE



INCIDENT MANAGEMENT TEAM 3



DEMOBILIZATION PLAN - SUMMARY

Day Incident
CA-LMU-003472

GENERAL INFORMATION

The Demobilization Plan is developed to facilitate the orderly removal and checkout of resources on the incident. By definition, surplus personnel are available for release if they have rested for a minimum of 8 hours, are cleaned up, outfitted and have a vehicle ready to depart to their next destination.

GENERAL GUIDELINES

- **NO RESOURCES WILL LEAVE THE INCIDENT UNTIL AUTHORIZED TO DO SO BY THE DEMOBILIZATION UNIT.**
- Efforts will be made to ensure that all released personnel arrive at their destination prior to 2200 hours. Resources not able to arrive at their destination by 2200 hours may need to arrange to rest over night.
- All government and hired vehicles leaving the incident will have a safety inspection.
- All trainees are to keep their time up to date and report to the Training Specialist with their task books and evaluations prior to completion of the demobilization process.
- All incident personnel will receive and read the Demob Safety Message before departing.

RESPONSIBILITIES

Unit Leaders will declare resources excess to their Section Chief. Section Chiefs will declare excess resources to the Planning Section Chief through the Resources Unit Leader. This should be done 36 hours in advance of anticipated release. Use the Declaration of Excess Resources Form or General Message Form (ICS-213) to list all excess resources. Include the Request #, ICS position, name/ID, date and time of declared excess, and time in which the resource will be eligible to leave. Send to the RESOURCES UNIT where the resource will be determined to be surplus to the incident. Surplus resources will then be able to report to the DEMOBILIZATION UNIT, receive a Demobilization Checkout Form (ICS 221), get the appropriate ICS 221 signatures, and then return the completed ICS 221 to the DEMOB UNIT prior to final release or reassignment.

RELEASE PRIORITIES

1. Organized fire departments
2. OES engines
3. Hired personnel and equipment
4. Other agencies (USFS, BLM, etc.)
5. Out of region CAL FIRE forces
6. Within Region CAL FIRE Forces
7. Unit CAL FIRE Forces



CAL FIRE

INCIDENT MANAGEMENT TEAM 3

WATER USAGE PLAN



California Drought Emergency

The following shall be considered and implemented by all fire resources as a means to provide maximum efficiencies when utilizing water resources, while minimizing the impacts to private and public water supplies. Accountability shall be maintained for all water supplies that are utilized and care should be applied to ensure proper replacement and/or reimbursement to the supplier/owner.

Fireline personnel- (During mop up operations)

- Use Pencil Hose and Garden Nozzles with Shut-Offs.
- Use Back pumps.
- Use Dry Mop-up and consolidation of heavy fuels to areas where they can burn out safely.
- Locate/Relocate Firelines to lighter fuels or natural barriers when safe.
- Set up and use portable tanks in anticipation of longer transport times for Water Tenders.
- Use of foams, gels and other water enhancers.
- Evaluate need to mop up in excess of 200 feet from fireline.

Road Maintenance and Repair-

- Monitor and water roads only when and where needed.
- Water when most effective (evening and nights).
- Use chemical treatments when available (Magchloride, Omni bind etc.).
- Consider use of tertiary or treated water.

Aviation Operations-

- Consider use of Gels, Foams and Retardants. Set up portable plants.
- Consider using Blivits and Pencil Hose for interior mop up operations as opposed to numerous bucket drops.
- Establish and use pre-use agreements for existing and known water sources.
- Use large watershed dip sites when able. Minimize use of small, static ponds and lakes.
- Maintain accountability of water used and locations of dip sites.
- Evaluate need for interior bucket drops.

Private Water Supplies-

- Notify property owner as early as possible.
- Minimize usage and develop alternative water supplies when and where appropriate.
- Track usage (meter, ICS-214, IMT3 Water Usage Reports) and develop a plan to replace water.
- Make arrangements for reimbursement and damage claims if needed.

Public/Municipal Water Supplies-

- Notify Agency as soon as possible and request a representative to the incident.
- Identify fill areas and request metering devices. Note locations on incident map.
- Use alternative or reclaimed water sources when available. Note locations on incident map.
- Make arrangements for reimbursement and damage claims if needed.

Management and Supervision-

- Use leaders intent and establish Water Conservation as a Management Objective.
- Consider complexity of water use on incidents. Establish a Water Supply Group Supervisor to coordinate additional resources to support the incident needs.
- Complete the Water Usage Report daily and turn in to Situation Unit.
- Review this check list and brief daily.



INCIDENT MANAGEMENT TEAM 3



WATER USAGE REPORT

DATE: _____

Division / Group: _____

RESOURCE / VENDOR ID: _____

REQUEST # _____

I.e.. Strike Team 1110C, Acme Water Tenders

WATER SOURCE LOCATION	Source (Hydrant, Pond, Tank, Other)	Gallons Used	Property Owner / Contact Number**

TURN INTO SITUATION UNIT DAILY

****Please note PROPERTY OWNER AND CONTACT NUMBER! (Use reverse side if needed.)**

The intent of this document is to track, record and validated the amount of water used on a incident. It's not intended to review the performance of equipment using the water on an incident.

UNIT LOG		1. Incident Name	2. Date Prepared	3. Time Prepared
4. Unit Name/Designators		5. Unit Leader (Name and Position)		6. Operational Period
7. Personnel Roster Assigned				
Name		ICS Position		Home Base
9. Prepared by (Name and Position)				

TIME	MAJOR EVENTS
9. Prepared by (Name and Position)	