

APPLEGATE INCIDENT INCIDENT ACTION PLAN



UNIFIED COMMAND

OCTOBER 10, 2014 0700

TO

OCTOBER 11, 2014 0700

CA-NEU-023454



**THIS PAGE
INTENTIONALLY
LEFT BLANK**

INCIDENT OBJECTIVES (ICS 202)

1. Incident Name: APPLGATE INCIDENT CA-NEU-023454	2. Operational Period: Date From: 10/10/2014 Date To: 10/11/2014 Time From: 0700 hours Time To: 0700 hours															
3. Objective(s): Management Objectives <ul style="list-style-type: none"> Provide for first responder, public, and assisting agencies safety through strict adherence to LCES and standard policies, and procedures. Provide for the timely and accurate release of current and predicted fire information to the media, public, and government agencies. Develop a plan to ensure communication and coordination with appropriate stakeholders and assisting agencies. Assure funds expended by CAL FIRE are cost effective to the values at risk. Minimize damage to the natural resource areas. Control Objectives <ul style="list-style-type: none"> Contain and control the fire to: <ol style="list-style-type: none"> 1. NORTH of: Applegate Road 2. SOUTH of: Pondersoa Road 3. EAST of: Interstate 80 4. West of: the American River 																
4. General Weather Conditions: WEATHER: Sunny TEMPERATURES: 80-85 deg HUMIDITY: 17-22% 20 FT WINDS: RIDGETOP - Light E drainage becoming WNW 6-12 mph. SLOPE/VALLEY - Light drainage/E 3-6 mph early, becoming WNW/Up-drainage 4-8 mph gust 12. HAINES INDEX: N/A STABILITY/INVERSION: Inversion lifting by 10 am. Afternoon Mixing Heights rising to near 1500 ft.																
General Situational Awareness and Safety: <ul style="list-style-type: none"> MAINTAIN L.C.E.S. AT ALL TIMES. Safety zones and escape routes are mandatory. Ensure all personnel have good situational awareness. Your safe vehicle operation is as critical as your safe firefighting operations. Keep your hydration up by drinking water and Gatorade or other electrolyte beverages. Avoid energy drinks. Maintain good communications with your supervisors, adjacent forces and crew members. Maintain awareness around marijuana crops. Report confrontations with growers immediately. 																
5. Site Safety Plan Required? Yes <input type="checkbox"/> No <input type="checkbox"/> Approved Site Safety Plan(s) Located at:																
6. Incident Action Plan (the items checked below are included in this Incident Action Plan): <table style="width: 100%; border: none;"> <tr> <td><input checked="" type="checkbox"/> ICS 203</td> <td><input checked="" type="checkbox"/> ICS 215A</td> <td><input checked="" type="checkbox"/> Health and Safety Message</td> </tr> <tr> <td><input checked="" type="checkbox"/> ICS 204</td> <td><input checked="" type="checkbox"/> ICS 220</td> <td><input checked="" type="checkbox"/> Finance Message</td> </tr> <tr> <td><input checked="" type="checkbox"/> ICS 205</td> <td><input checked="" type="checkbox"/> Incident Map</td> <td><input type="checkbox"/> Training Message</td> </tr> <tr> <td><input checked="" type="checkbox"/> ICS 206</td> <td><input checked="" type="checkbox"/> Fire Weather Forecast</td> <td><input checked="" type="checkbox"/> Fire Area/Travel Map</td> </tr> <tr> <td><input checked="" type="checkbox"/> ICS 214</td> <td><input checked="" type="checkbox"/> Fire Behavior Forecast</td> <td><input checked="" type="checkbox"/> Facilities Map</td> </tr> </table>		<input checked="" type="checkbox"/> ICS 203	<input checked="" type="checkbox"/> ICS 215A	<input checked="" type="checkbox"/> Health and Safety Message	<input checked="" type="checkbox"/> ICS 204	<input checked="" type="checkbox"/> ICS 220	<input checked="" type="checkbox"/> Finance Message	<input checked="" type="checkbox"/> ICS 205	<input checked="" type="checkbox"/> Incident Map	<input type="checkbox"/> Training Message	<input checked="" type="checkbox"/> ICS 206	<input checked="" type="checkbox"/> Fire Weather Forecast	<input checked="" type="checkbox"/> Fire Area/Travel Map	<input checked="" type="checkbox"/> ICS 214	<input checked="" type="checkbox"/> Fire Behavior Forecast	<input checked="" type="checkbox"/> Facilities Map
<input checked="" type="checkbox"/> ICS 203	<input checked="" type="checkbox"/> ICS 215A	<input checked="" type="checkbox"/> Health and Safety Message														
<input checked="" type="checkbox"/> ICS 204	<input checked="" type="checkbox"/> ICS 220	<input checked="" type="checkbox"/> Finance Message														
<input checked="" type="checkbox"/> ICS 205	<input checked="" type="checkbox"/> Incident Map	<input type="checkbox"/> Training Message														
<input checked="" type="checkbox"/> ICS 206	<input checked="" type="checkbox"/> Fire Weather Forecast	<input checked="" type="checkbox"/> Fire Area/Travel Map														
<input checked="" type="checkbox"/> ICS 214	<input checked="" type="checkbox"/> Fire Behavior Forecast	<input checked="" type="checkbox"/> Facilities Map														
7. Prepared by: Name: P. FLIGIEL _____ Position/Title: PSC, CAL FIRE IMT 1 Signature:																
8. Approved by Incident Commander: Name: K. ZOMBRO, CAL FIRE IMT 1 Signature:																
ICS 202	IAP Page _____	Date/Time: 10/09/2014 2000 hours														

ORGANIZATION ASSIGNMENT LIST (ICS 203)

1. Incident Name: APPLEGATE INCIDENT CA-NEU-023454		2. Operational Period: Date From: 10/10/2014 Time From: 0700		Date To: 10/11/2014 Time To: 0700	
3. Incident Commander(s) and Command Staff:			7. Operations Section:		
IC/UCs	K. ZOMBRO / K. BORDEN / S. CURELY(T)	Chief	S. SPINHARNEY	C. TODD	
Deputy	W. DARNELL	Chief	T. BROWNELL(T)		
		Deputy	N. TRUAX		
Safety Officer	K. CALLISON / D. LAWS(T) B. CARTER(T)	Staging Area			
Public Info. Officer	S. McLAIN	Branch	N/A		
Liaison Officer	D. SCHLOSS(T) / M. HARDY(T)	Branch Director	N/A		
Law Liaison	J. McCAMMON / R. DIGGINS	Deputy	N/A		
4. Agency/Organization Representatives:		Division/Group	A / G		K. OHLAU
Agency/Organization	Name	Division/Group	F		R. AVILA
Placer County OES	R. RODRIGUEZ	Division/Group	Y		D. LUIS
CAL OES	G. HUMPHREY	Staging	Pondersoa		R. LEMOS
PG&E	S. HOLMQUIST	Division/Group			
CCC	S. DONNELLY	Branch			
Placer County SO	T. CONNERS	Branch Director			
CDCR	C. DeSENA	Deputy			
5. Planning Section:		Division/Group			
Chief	P. FLIGIEL / M. PETRO(T)	Division/Group			
Deputy	J. TAYLOR / V. O'NEAL(T)	Division/Group			
Resources Unit	P. CARLOS / J. LOVIE	Division/Group			
Situation Unit	E. SCOVEL R. WONVEBERGER(T)	Division/Group			
Situation Unit	D. LANGE(T) / K. OSBURN(T)	Branch			
Demobilization Unit	J. KLOSEK / D. HERNDON	Branch Director			
GISS	T. WERLE	Deputy			
FBAN	D. BOURSIER	Division/Group			
IMET	B. NEWMERZHYCKY	Division/Group			
Training Tech. Spec.	M. WINK	Division/Group			
6. Logistics Section:		Division/Group			
Chief	S. ERNEST	Division/Group			
Deputy	P. GALLEGOS	Air Operations Branch			
Support Branch		Air Ops Branch Dir.	D. LOPEZ		
Supply Unit	L. STORY	Air Support Gp Sup.	D. JUNETTE		
Facilities Unit	M. REICH / L. PONTES(T)	Heli-Base Manager	T. STEPANOVICH		
Ground Support Unit	R. TOOKER	8. Finance/Administration Section:			
Ordering Manager	R. DRAGOO/C. RICHINS/E. SIMPSON(T)	Chief	R. BROWNE		
Equipment Tech. Spec.	D. GRANDBOIS	Deputy	A. O'LEARY		
Service Branch		Time Unit	A. McADAMS		
Director	N/A	Procurement Unit	J. FRANKLIN / B. COUNTS		
Communications Unit	T. WEBB	Comp/Claims Unit	S. CAIN		
Medical Unit	J. WINNEN	Cost Unit	P. ROYER		
9. Prepared by: Name: P. FLIGIEL Position/Title: PSC 1, CAL FIRE IMT 1 Signature:					
ICS 203		IAP Page _____		Date/Time: 10/09/2014 2015 Hours	



INCIDENT Weather Forecast



FORECAST NO:1

NAME OF FIRE:Applegate

PREDICTION FOR:DAYSHIFT

UNIT:Nevada-Yuba=Placer

SHIFT DATE:Friday October 10th 2014

SIGNED: *Basil Newmerzhycky*

TIME AND DATE

Incident Meteorologist – Basil Newmerzhycky

FORECAST ISSUED:1700 Thursday Oct 9th

WEATHER DISCUSSION:

Weak low pressure over Nrn CA will be giving way to a strengthening Pacific High Pressure Ridge over the next few days. Today's temperatures and humidity will be similar to yesterday, with light easterly morning winds becoming WNW at speeds also similar to yesterday. Significant pattern change for this weekend as the prevailing winds become more NW to NE. These winds are not expected to be overly strong, but do tend to increase late at night thru the morning hours and typically produce poor overnight humidity recoveries. It will be getting warmer over the next few days with afternoon temperatures approaching 90 deg. (about 10 deg above normal). Sharp change early next week to cooler, windier conditions (SW winds).

WEATHER FORECAST:

WEATHER:Sunny

TEMPERATURES:80-85 deg

HUMIDITY:17-22%

20 FT WINDS:

RIDGETOP -Light E drainage becoming WNW 6-12 mph.

SLOPE/VALLEY -Light drainage/E 3-6 mph early, becoming WNW/Up-drainage 4-8 mph gust 12

HAINES INDEX:N/A

STABILITY/INVERSION:Inversion lifting by 10 am. Afternoon Mixing Heights rising to near 1500 ft.

OUTLOOK FOR SATURDAY:

Sunny.. Max temps 84-89 deg. Min RH 13-18%.Winds ENE 3-6 mph early, becoming NW 4-8 mph gusts 12 mph by afternoon.

OUTLOOK FOR SUNDAY:

Sunny. Max temp 86-91 deg, Min RH 10-15%. Wind N to NE 5-10 mph gust 15 mph.

EXTENDED FORECAST:

Monday Mostly Sunny.Cooler and Breezy. SW Winds increasing to 7-12 mph gusts 17 mph.

FIRE BEHAVIOR FORECAST

FORECAST NUMBER: 01	TYPE OF FIRE: Wildfire
FIRE NAME: Applegate	OPERATIONAL PERIOD: 10/10/2014;0700-0700
DATE ISSUED: 10/9/14	TIME ISSUED: 1700
UNIT: NEU	SIGNED: Don Boursier, FBAN

INPUTS

WEATHER SUMMARY:

Friday: High Temps: Sunny/Clear; Max. Temp. 80-85 degrees; **Min RH:** 17-22%;
Winds: ENE 3-6 mph early becoming WNW 4-8 mph with gust to 12 mph.

Friday night: Clear; Min. Temps: 58-63 degrees; Max RH: 40-45%; Winds downslope 1-4 mph.

OUTPUTS

FIRE BEHAVIOR

GENERAL: * Anticipate an Increase in Fire Behavior as Inversion Breaks, Approx. 1000 hrs*****

Fire is fuels and topography driven burning in older growth Timber Litter/Understory and Chaparral. FDFM predicted 4% for 1 hr and 5% for 10 hr fuels. Live Fuel Moisture is roughly 71%. Aligned head Fire ROS up to 100 chains/hr and flanking 1-2 chains/hr. Aligned head fire flame lengths >12' and flanking/backing <4'. Spotting from torching trees ¼ to ½ mile. Probability of Ignition: 76% in unshaded fuels. Energy Release Component (ERC): 78. Burning Index (BI): 89.

SPECIFIC:

Divisions A/G: Alignment with prevailing Southwest winds will challenge containment efforts. Anticipate smoldering with possibility of torching activity contributing to spots across the line. Winds may create smokier conditions for crews mopping up.

Divisions F: Surface spread activity will continue in interior areas. With increase in winds above 5 mph surface fire can transition to group torching with flame lengths >30'. This will contribute to spot fire opportunities towards Jefferson Canyon.

Division Y: Creeping/Backing/Smoldering activity during daylight hours. Evening downslope winds may provide opportunities to push embers over containment lines.

AIR OPERATIONS:

Inversion over fire area until 1000 hours hampering visibility.
Mixing height 1500'agl.; transport winds WNW 6 mph
Sunrise: 0710 hrs Sunset: 1836hrs

SAFETY

Continued drought conditions have contributed to increased rates of spread in heavier fuels that you would ordinarily expect the fire to slow down in. (Grass ROS=Brush ROS)

SAFETY MESSAGE

INCIDENT NAME
APPLEGATE

Date
Prepared:
10/09/14

Time
Prepared:
1800

OPERATIONAL PERIOD:
10/10-10/11/2014 0700-0700

- **Wear ALL of your Personnel Protective Equipment.**
- **Prevent dehydration by drinking water frequently. Plan ahead, don't allow water to run out. Take water with you!**
- **Down Power lines! Treat all lines as energized. Identify, notify, and isolate; Utilizing "3 stripes you're out" protocol.**
- **Mineshafts are in the area and can be hidden by vegetation.**
- **Watch for Trains, look before you cross!**
- **Maintain attentiveness; don't be deceived by the fire's passive appearance.**
- **Drive with your headlights on at all times, follow all speed limits and traffic laws.**
- **Be cautious of fire weakened or partially burnt hazard trees, falling trees have been reported. Identify and Isolate.**
- **Remember when following LCES, post enough lookouts to have a good vantage of the entire hazard area.**
- **Watch your footing on the fire line, maintain adequate crew spacing. There is very steep terrain on portions of the fire.**
- **Brief your crews on all the components of the IAP.**

**Ensure firefighters have good anchor points, escape routes, and safety zones.
Remember LCES.**



Lookout(s), Communication(s), Escape routes and Safety zone(s)

Prepared By:
D.LAWS

Approved By (Safety Officer) K. CALLISON



INCIDENT ACTION PLAN SAFETY ANALYSIS (ICS 215A)

1. Incident Name: APPLEGATE INCIDENT		2. Incident Number: CA-NEU-023454	
3. Date/Time Prepared: Date: 10/09/14 Time: 1800		4. Operational Period: Date From: 10/10/14 Date To: 10/11/14 Time From: 0700 Time To: 0700	
5. Branch Division	6. Hazardous Actions/Conditions	7. Mitigations/Warnings/Remedies	
ALL	FIRE BEHAVIOR POTENTIAL	Monitor all weather conditions and forecasts. Make sure ALL personnel receive a thorough briefing every shift. Maintain adequate escape routes and safety zones. Avoid complacency Adhere to the 10 Standard Fire Fighting Orders and mitigate 18 Watch Out Situations. Maintain situational awareness and be heads up for spotting potential	
ALL	DOWN POWERLINES	Identify any down power lines- Isolate entry (3 Stripes) Communicate to all personnel in the area and PG&E	
ALL	DRIVING HAZARDS	Drive defensively and use seatbelts! Expect the unexpected around every curve. Slow down; drive with headlights on, use chock blocks, look before backing and use backers whenever available. Increase following distances on dusty roads.	
ALL	MINESHAFTS	Mineshafts are in the area and may be hidden by vegetation. Identify and Isolate using (3 Stripes)	
ALL	COMMUNICATIONS	Use the approved IAP communication plan only. Clone radios if necessary Be clear and concise with your instructions. Use human repeaters when necessary	
ALL	MARIJUANA GROWS	Maintain situational awareness when working around grows, report confrontations immediately	
ALL	AIRCRAFT OPERATIONS	Use air-to-ground frequency to communicate with aircraft. Keep personnel out of the drop zones when bucket work is in progress. Keep others clear of the bucket operation.	
ALL	LINE IMPROVEMENT, AND MOP UP	Conduct thorough briefings for all personnel. Ensure LCES is in place prior to the engagement. Adhere to the 10 Standard Fire Fighting Orders, mitigate 18 Watch Out Situations.	
ALL	STEEP TERRAIN	Watch your footing; take your time; ensure adequate spacing between crew members; watch for overhead hazards and post lookouts to warn of rolling rocks and debris. Mine shafts are in the area	
ALL	HYDRATION / FATIGUE	Drink water before, during, and after shifts. Have a hydration plan. No energy drinks. Take breaks, utilize shade when available.	
A/G & Y	TRAIN TRAFFIC	Look before you cross No Transports across W. Paoli, use Weimar crossing to Ponderosa	
A/G & Y	GAS PIPELINE	No heavy equipment within 100' of the Railway	
8. Prepared by (Safety Officer): Name: <u>D. LAWS</u>		Signature: 	
Prepared by (Plans Section Chief): Name: <u>P. FLIGIEL</u>		Signature: 	
ICS 215A		Date/Time: 10/09/14 1800	

ASSIGNMENT LIST (ICS 204)

1. Incident Name: APPLEGATE CA-NEU-023454		2. Operational Period: Date From: 10/10/2014 Date To: 10/11/2014 Time From: 0700 Time To: 0700		3. Branch: Division: A/G Group: Staging Area:													
4. Operations Personnel: Operations Section Chief: S. Spinharney (Day) <div style="text-align: center;"> T. Brownell (Trainee) C. Todd (Night) </div> Safety Officer: M. Keegan Division/Group Supervisor: K. Ohlau			<u>Contact Number</u> Radio Radio Radio														
5. Resources Assigned:		# of Persons	Contact (e.g., phone, pager, radio frequency, etc.)	Reporting Location, Special Equipment and Supplies, Remarks, Notes, Information													
Resource Identifier	Leader			West Paoli Exit at the Campora Propane Lot													
STC LNU 9142 C	Newberry	19		West Paoli Exit at the Campora Propane Lot													
STC AEU 9270 C	Bohall	16		West Paoli Exit at the Campora Propane Lot													
CRW TNF American River IHC	Leyba	19		West Paoli Exit at the Campora Propane Lot													
CRW TNF Tahoe IHC	Rice	20		West Paoli Exit at the Campora Propane Lot													
W/T E-96		2		West Paoli Exit at the Campora Propane Lot													
FALC TBD		3		West Paoli Exit at the Campora Propane Lot													
6. Work Assignments: Hold and improve control line. Mop up 100 feet in from the perimeter. Mop up and patrol around structures.																	
7. Special Instructions: **Beware of Train Traffic **No Low Boys across West Paoli use Weimer crossing to Ponderosa Way. **Beware of buried GAS PIPELINE and no heavy equipment within 100 feet of railroad right away.																	
8. Communications (radio and/or phone contact numbers needed for this assignment): <table style="width: 100%; border-collapse: collapse;"> <tr> <td style="width: 30%;"><u>Name/Function</u></td> <td style="width: 30%;"><u>Primary Contact: indicate cell, pager, or radio (frequency/system/channel)</u></td> </tr> <tr> <td>CDF C2 /Command</td> <td>Radio (151.2650RX 159.3300TX) Tone 5</td> </tr> <tr> <td>VTAC 14 /Tactical</td> <td>Radio (159.4725 RX/TX) Tone 6</td> </tr> <tr> <td>CDF TAC 22 /Air to Ground</td> <td>Radio (159.4050 RX/TX) Tone 16</td> </tr> <tr> <td>CALCORD /Transportation</td> <td>Radio (156.0750 RX/TX) Tone 6</td> </tr> <tr> <td>AIR GUARD /Emergency Use</td> <td>Radio (168.6250 RX/TX) Tone 1</td> </tr> </table>						<u>Name/Function</u>	<u>Primary Contact: indicate cell, pager, or radio (frequency/system/channel)</u>	CDF C2 /Command	Radio (151.2650RX 159.3300TX) Tone 5	VTAC 14 /Tactical	Radio (159.4725 RX/TX) Tone 6	CDF TAC 22 /Air to Ground	Radio (159.4050 RX/TX) Tone 16	CALCORD /Transportation	Radio (156.0750 RX/TX) Tone 6	AIR GUARD /Emergency Use	Radio (168.6250 RX/TX) Tone 1
<u>Name/Function</u>	<u>Primary Contact: indicate cell, pager, or radio (frequency/system/channel)</u>																
CDF C2 /Command	Radio (151.2650RX 159.3300TX) Tone 5																
VTAC 14 /Tactical	Radio (159.4725 RX/TX) Tone 6																
CDF TAC 22 /Air to Ground	Radio (159.4050 RX/TX) Tone 16																
CALCORD /Transportation	Radio (156.0750 RX/TX) Tone 6																
AIR GUARD /Emergency Use	Radio (168.6250 RX/TX) Tone 1																
9. Prepared by: Name: <u>Jon Lovie</u> Position/Title: RESL Signature:																	
ICS 204	IAP Page _____	Date/Time: 10.9.14/1900															

ASSIGNMENT LIST (ICS 204)

1. Incident Name: APPLEGATE CA-NEU-023454		2. Operational Period: Date From: 10/10/2014 Date To: 10/11/2014 Time From: 0700 Time To: 0700		3. Branch: Division: F Group: Staging Area:													
4. Operations Personnel: Operations Section Chief: S. Spinharney (Day) <div style="text-align: center;"> T. Brownell (Trainee) C. Todd (Night) </div> Safety Officer: M. Keegan Division/Group Supervisor: R. Avila			<table border="1" style="width: 100%; border-collapse: collapse;"> <tr> <th style="text-align: left; padding: 2px;"><u>Contact Number</u></th> </tr> <tr> <td style="padding: 2px;">Radio</td> </tr> <tr> <td style="padding: 2px;">Radio</td> </tr> <tr> <td style="padding: 2px;">Radio</td> </tr> </table>			<u>Contact Number</u>	Radio	Radio	Radio								
<u>Contact Number</u>																	
Radio																	
Radio																	
Radio																	
5. Resources Assigned:		# of Persons	Contact (e.g., phone, pager, radio frequency, etc.)	Reporting Location, Special Equipment and Supplies, Remarks, Notes, Information													
Resource Identifier	Leader																
W/T E-102		2		Report DP2													
W/T E-180		2		Report DP2													
W/T E-182		2		Report DP2													
HEQB Kidwell		1		Report DP2													
FEMP Matcham		1		Report DP2													
FALC Volcano		3		Report DP2													
SOFR Turner		1		Report DP2													
6. Work Assignments: Construct and hold control lines. Mop up 100 feet in from perimeter. Mop up and Patrol around Structures.																	
7. Special Instructions: **Low boys use Ponderosa Way via Weimer																	
8. Communications (radio and/or phone contact numbers needed for this assignment): <table style="width: 100%; border-collapse: collapse;"> <tr> <td style="width: 30%; border-bottom: 1px solid black;">Name/Function</td> <td style="border-bottom: 1px solid black;">Primary Contact: indicate cell, pager, or radio (frequency/system/channel)</td> </tr> <tr> <td>CDF C2 /Command</td> <td>Radio (151.2650 RX 159.3300 TX) Tones 5</td> </tr> <tr> <td>VTAC 13 /Tactical</td> <td>Radio (158.7375 RX/TX) Tone 6</td> </tr> <tr> <td>CDF TAC 22 /Air to Ground</td> <td>Radio (159.4050 RX/TX) Tone 16</td> </tr> <tr> <td>CALCORD /Transportation</td> <td>Radio (156.0750 RX/TX)</td> </tr> <tr> <td>AIR GUARD /Emergency Use</td> <td>Radio (168.6250 RX/TX) Tone 1</td> </tr> </table>						Name/Function	Primary Contact: indicate cell, pager, or radio (frequency/system/channel)	CDF C2 /Command	Radio (151.2650 RX 159.3300 TX) Tones 5	VTAC 13 /Tactical	Radio (158.7375 RX/TX) Tone 6	CDF TAC 22 /Air to Ground	Radio (159.4050 RX/TX) Tone 16	CALCORD /Transportation	Radio (156.0750 RX/TX)	AIR GUARD /Emergency Use	Radio (168.6250 RX/TX) Tone 1
Name/Function	Primary Contact: indicate cell, pager, or radio (frequency/system/channel)																
CDF C2 /Command	Radio (151.2650 RX 159.3300 TX) Tones 5																
VTAC 13 /Tactical	Radio (158.7375 RX/TX) Tone 6																
CDF TAC 22 /Air to Ground	Radio (159.4050 RX/TX) Tone 16																
CALCORD /Transportation	Radio (156.0750 RX/TX)																
AIR GUARD /Emergency Use	Radio (168.6250 RX/TX) Tone 1																
9. Prepared by: Name: <u>Jon Lovie</u> Position/Title: RESL Signature:																	
ICS 204	IAP Page _____	Date/Time: 10.9.14/1900															

ASSIGNMENT LIST (ICS 204)

1. Incident Name: APPLEGATE CA-NEU-023454		2. Operational Period: Date From: 10/10/2014 Date To: 10/11/2014 Time From: 0700 Time To: 0700		3. Branch: Division: Y Group: Staging Area:																			
4. Operations Personnel: Operations Section Chief: S. Spinharney (Day) <div style="text-align: center;"> T. Brownell (Trainee) C. Todd (Night) </div> Safety Officer: M. Keegan Division/Group Supervisor: D. Luis			<table border="1" style="width: 100%; border-collapse: collapse;"> <tr> <th style="text-align: left; padding: 5px;"><u>Contact Number</u></th> </tr> <tr> <td style="padding: 5px;">Radio</td> </tr> <tr> <td style="padding: 5px;">Radio</td> </tr> <tr> <td style="padding: 5px;">Radio</td> </tr> </table>			<u>Contact Number</u>	Radio	Radio	Radio														
<u>Contact Number</u>																							
Radio																							
Radio																							
Radio																							
5. Resources Assigned:		# of Persons	Contact (e.g., phone, pager, radio frequency, etc.)	Reporting Location, Special Equipment and Supplies, Remarks, Notes, Information																			
Resource Identifier	Leader																						
STC OES 4105 C	Bierwagen	19		I-80 @ Applegate																			
STC NEU Applegate 1	Nelson			I-80 @ Applegate																			
STC MNF 3646 C	Combs	26		I-80 @ Applegate																			
STG Applegate 3	Madsen	34		I-80 @ Applegate																			
STG Applegate 4	Evers	34		I-80 @ Applegate																			
CRW NEU War 5	Heard	15		I-80 @ Applegate																			
W/T 57		2		I-80 @ Applegate																			
W/T 73		2		I-80 @ Applegate																			
FALC TBD		3		I-80 @ Applegate																			
6. Work Assignments: Hold and Improve control lines. Mop-up 100 feet from Perimeter. Mop and Patrol around Structures.																							
7. Special Instructions: **Beware of Train Traffic **No Low Boys across West Paoli use Weimer crossing to Ponderosa Way. **Beware of buried GAS PIPELINE and no heavy equipment within 100 feet of railroad right away.																							
8. Communications (radio and/or phone contact numbers needed for this assignment): <table style="width: 100%; border-collapse: collapse;"> <tr> <td style="width: 30%;">Name/Function</td> <td style="width: 30%;">Primary Contact: indicate cell, pager, or radio (frequency/system/channel)</td> <td style="width: 40%;"></td> </tr> <tr> <td>CDF C2 /Command</td> <td>Radio (151.2650 RX 159.3300 TX) Tones 5</td> <td></td> </tr> <tr> <td>VFIRE 24 /Tactical</td> <td>Radio (154.2725 RX/TX) Tone 6</td> <td></td> </tr> <tr> <td>CDF TAC 22 /Air to Ground</td> <td>Radio (159.4050 RX/TX) Tone 16</td> <td></td> </tr> <tr> <td>CALCORD /Transportation</td> <td>Radio (156.0750 RX/TX)</td> <td></td> </tr> <tr> <td>AIR GUARD /Emergency Use</td> <td>Radio (168.6250 RX/TX) Tone 1</td> <td></td> </tr> </table>						Name/Function	Primary Contact: indicate cell, pager, or radio (frequency/system/channel)		CDF C2 /Command	Radio (151.2650 RX 159.3300 TX) Tones 5		VFIRE 24 /Tactical	Radio (154.2725 RX/TX) Tone 6		CDF TAC 22 /Air to Ground	Radio (159.4050 RX/TX) Tone 16		CALCORD /Transportation	Radio (156.0750 RX/TX)		AIR GUARD /Emergency Use	Radio (168.6250 RX/TX) Tone 1	
Name/Function	Primary Contact: indicate cell, pager, or radio (frequency/system/channel)																						
CDF C2 /Command	Radio (151.2650 RX 159.3300 TX) Tones 5																						
VFIRE 24 /Tactical	Radio (154.2725 RX/TX) Tone 6																						
CDF TAC 22 /Air to Ground	Radio (159.4050 RX/TX) Tone 16																						
CALCORD /Transportation	Radio (156.0750 RX/TX)																						
AIR GUARD /Emergency Use	Radio (168.6250 RX/TX) Tone 1																						
9. Prepared by: Name: <u>Jon Lovie</u> Position/Title: RESL Signature:																							
ICS 204	IAP Page ____	Date/Time: 10.9.14/1900																					

ASSIGNMENT LIST (ICS 204)

1. Incident Name: APPLEGATE CA-NEU-023454		2. Operational Period: Date From: 10/10/2014 Date To: 10/11/2014 Time From: 0700 Time To: 0700		3. Branch: Staging: Ponderosa Group: Staging Area:																																																						
4. Operations Personnel: Operations Section Chief: S. Spinharney (Day) <div style="text-align: center;">T. Brownell (Trainee)</div> <div style="text-align: center;">C. Todd (Night)</div> Safety Officer: M. Keegan Staging Area Manager: R. Lemos			<u>Contact Number</u> Radio Radio Radio																																																							
5. Resources Assigned:		# of Persons	Contact (e.g., phone, pager, radio frequency, etc.)	Reporting Location, Special Equipment and Supplies, Remarks, Notes, Information																																																						
Resource Identifier	Leader			<table border="1" style="width: 100%; border-collapse: collapse;"> <tr><td>STC XPL 4135 C</td><td>McMillim</td><td>16</td><td></td><td>1680 Ponderosa way</td></tr> <tr><td>STL LNU 9143 L</td><td>DeGraffenreid</td><td>3</td><td></td><td>1680 Ponderosa way</td></tr> <tr><td>STL BTU 9211L</td><td>Edson</td><td>7</td><td></td><td>1680 Ponderosa way</td></tr> <tr><td>STL AEU 9278 L</td><td>Love</td><td>3</td><td></td><td>1680 Ponderosa way</td></tr> <tr><td>DOZ NEU 2340</td><td></td><td></td><td></td><td>1680 Ponderosa way</td></tr> <tr><td>DOZ NEU 2342</td><td>Minor</td><td>2</td><td></td><td>1680 Ponderosa way</td></tr> <tr><td>DOZ PVT E-34</td><td>Robinson</td><td>1</td><td></td><td>1680 Ponderosa way</td></tr> <tr><td>DOZ PVT E-60</td><td>Ridge</td><td>1</td><td></td><td>1680 Ponderosa way</td></tr> <tr><td>DOZ PVT E-61</td><td>Maders</td><td>1</td><td></td><td>1680 Ponderosa way</td></tr> <tr><td>DOZ PVT E-63</td><td>Parks</td><td>1</td><td></td><td>1680 Ponderosa way</td></tr> <tr><td>DOZ PVT E-95</td><td>Browning</td><td>2</td><td></td><td>1680 Ponderosa way</td></tr> </table>		STC XPL 4135 C	McMillim	16		1680 Ponderosa way	STL LNU 9143 L	DeGraffenreid	3		1680 Ponderosa way	STL BTU 9211L	Edson	7		1680 Ponderosa way	STL AEU 9278 L	Love	3		1680 Ponderosa way	DOZ NEU 2340				1680 Ponderosa way	DOZ NEU 2342	Minor	2		1680 Ponderosa way	DOZ PVT E-34	Robinson	1		1680 Ponderosa way	DOZ PVT E-60	Ridge	1		1680 Ponderosa way	DOZ PVT E-61	Maders	1		1680 Ponderosa way	DOZ PVT E-63	Parks	1		1680 Ponderosa way	DOZ PVT E-95	Browning	2
STC XPL 4135 C	McMillim	16		1680 Ponderosa way																																																						
STL LNU 9143 L	DeGraffenreid	3		1680 Ponderosa way																																																						
STL BTU 9211L	Edson	7		1680 Ponderosa way																																																						
STL AEU 9278 L	Love	3		1680 Ponderosa way																																																						
DOZ NEU 2340				1680 Ponderosa way																																																						
DOZ NEU 2342	Minor	2		1680 Ponderosa way																																																						
DOZ PVT E-34	Robinson	1		1680 Ponderosa way																																																						
DOZ PVT E-60	Ridge	1		1680 Ponderosa way																																																						
DOZ PVT E-61	Maders	1		1680 Ponderosa way																																																						
DOZ PVT E-63	Parks	1		1680 Ponderosa way																																																						
DOZ PVT E-95	Browning	2		1680 Ponderosa way																																																						
6. Work Assignments: Maintain 3 min response time.																																																										
7. Special Instructions: ** Reporting Location for Staging is 1680 Ponderosa Way.																																																										
8. Communications (radio and/or phone contact numbers needed for this assignment): <table style="width: 100%; border-collapse: collapse;"> <tr> <td style="border-bottom: 1px solid black;">Name/Function</td> <td style="border-bottom: 1px solid black;">Primary Contact: indicate cell, pager, or radio (frequency/system/channel)</td> </tr> <tr> <td>CDF C2 /Command</td> <td>Radio (151.2650 RX 159.3300 TX) Tones 5</td> </tr> <tr> <td>CDF TAC 22 /Air to Ground</td> <td>Radio (159.4050 RX/TX) Tone 16</td> </tr> <tr> <td>CALCORD /Transportation</td> <td>Radio (156.0750 RX/TX)</td> </tr> <tr> <td>AIR GUARD /Emergency Use</td> <td>Radio (168.6250 RX/TX) Tone 1</td> </tr> </table>						Name/Function	Primary Contact: indicate cell, pager, or radio (frequency/system/channel)	CDF C2 /Command	Radio (151.2650 RX 159.3300 TX) Tones 5	CDF TAC 22 /Air to Ground	Radio (159.4050 RX/TX) Tone 16	CALCORD /Transportation	Radio (156.0750 RX/TX)	AIR GUARD /Emergency Use	Radio (168.6250 RX/TX) Tone 1																																											
Name/Function	Primary Contact: indicate cell, pager, or radio (frequency/system/channel)																																																									
CDF C2 /Command	Radio (151.2650 RX 159.3300 TX) Tones 5																																																									
CDF TAC 22 /Air to Ground	Radio (159.4050 RX/TX) Tone 16																																																									
CALCORD /Transportation	Radio (156.0750 RX/TX)																																																									
AIR GUARD /Emergency Use	Radio (168.6250 RX/TX) Tone 1																																																									
9. Prepared by: Name: <u>Jon Lovie</u> Position/Title: RESL Signature:																																																										
ICS 204		IAP Page <u> </u>		Date/Time: 10.9.14/1900																																																						

ASSIGNMENT LIST (ICS 204)

1. Incident Name: APPLEGATE CA-NEU-023454		2. Operational Period: Date From: 10/10/2014 Date To: 10/11/2014 Time From: 0700 Time To: 0700		3. Branch: Staging: Ponderosa Group: Staging Area:											
4. Operations Personnel: Operations Section Chief: S. Spinharney (Day) <div style="text-align: center;"> T. Brownell (Trainee) C. Todd (Night) </div> Safety Officer: M. Keegan Staging Area Manager: R. Lemos			<table border="1" style="width: 100%; border-collapse: collapse;"> <tr> <th style="text-align: left; padding: 2px;">Contact Number</th> </tr> <tr> <td style="padding: 2px;">Radio</td> </tr> <tr> <td style="padding: 2px;">Radio</td> </tr> <tr> <td style="padding: 2px;">Radio</td> </tr> </table>		Contact Number	Radio	Radio	Radio							
Contact Number															
Radio															
Radio															
Radio															
5. Resources Assigned:		# of Persons	Contact (e.g., phone, pager, radio frequency, etc.)	Reporting Location, Special Equipment and Supplies, Remarks, Notes, Information											
Resource Identifier	Leader														
DOZ PVT E-97	Humphrey	2			1680 Ponderosa Way										
DOZ PVT E-98	Neverkovec	2			1680 Ponderosa Way										
W/T PVT E-24	Lawler	2			1680 Ponderosa Way										
W/T PVT E-25	Wallace	2			1680 Ponderosa Way										
W/T PVT E-27	Rodgers	2			1680 Ponderosa Way										
W/T PVT E-28	Haycraft	2			1680 Ponderosa Way										
W/T PVT E-29	Gomez	2			1680 Ponderosa Way										
W/T PVT E-31	Reyes	1			1680 Ponderosa Way										
W/T PVT E-32	Bruner	2			1680 Ponderosa Way										
FALC TBD		3			1680 Ponderosa Way										
FALC TBD		3			1680 Ponderosa Way										
6. Work Assignments: Maintain 3 min response time.															
7. Special Instructions: ** Reporting Location for Staging is 1680 Ponderosa Way.															
8. Communications (radio and/or phone contact numbers needed for this assignment): <table style="width: 100%; border-collapse: collapse;"> <tr> <td style="width: 30%; border-bottom: 1px solid black;">Name/Function</td> <td style="border-bottom: 1px solid black;">Primary Contact: indicate cell, pager, or radio (frequency/system/channel)</td> </tr> <tr> <td>CDF C2 /Command</td> <td>Radio (151.2650 RX 159.3300 TX) Tones 5</td> </tr> <tr> <td>CDF TAC 22 /Air to Ground</td> <td>Radio (159.4050 RX/TX) Tone 16</td> </tr> <tr> <td>CALCORD /Transportation</td> <td>Radio (156.0750 RX/TX)</td> </tr> <tr> <td>AIR GUARD /Emergency Use</td> <td>Radio (168.6250 RX/TX) Tone 1</td> </tr> </table>						Name/Function	Primary Contact: indicate cell, pager, or radio (frequency/system/channel)	CDF C2 /Command	Radio (151.2650 RX 159.3300 TX) Tones 5	CDF TAC 22 /Air to Ground	Radio (159.4050 RX/TX) Tone 16	CALCORD /Transportation	Radio (156.0750 RX/TX)	AIR GUARD /Emergency Use	Radio (168.6250 RX/TX) Tone 1
Name/Function	Primary Contact: indicate cell, pager, or radio (frequency/system/channel)														
CDF C2 /Command	Radio (151.2650 RX 159.3300 TX) Tones 5														
CDF TAC 22 /Air to Ground	Radio (159.4050 RX/TX) Tone 16														
CALCORD /Transportation	Radio (156.0750 RX/TX)														
AIR GUARD /Emergency Use	Radio (168.6250 RX/TX) Tone 1														
9. Prepared by: Name: <u>Jon Lovie</u> Position/Title: RESL Signature:															
ICS 204	IAP Page <u> </u>	Date/Time: 10.9.14/1900													

INCIDENT RADIO COMMUNICATIONS PLAN			Incident Name Applegate Incident				Date/Time Prepared 10/9/14 @ 2000			Operational Period Date/Time 10/10-11 2014 0700-0700	
Ch #	Function	Channel Name/Trunked Radio System Talkgroup	Assignment	RX Freq	N or W	RX Tone/NAC	TX Freq	N or W	Tx Tone/NAC	Mode A, D or M	Remarks
1	Command	CDF C2	Command	151.2650		103.5	159.3300		OST	A	Tone 5 Pilot Peak
2	Command	NEU West	Initial Attack	151.3250		131.8	159.3600		OST	A	Grass Valley ECC
3	Command	PCF West	Initial Attack	154.3550		107.2	158.8950		OST	A	Place County Fire Dispatch
4	Tactical	VTAC 11	Unassigned	151.1375		156.7	151.1375		156.7	A	Tone 6
5	Tactical	VTAC 12	Unassigned	154.4525		156.7	154.4525		156.7	A	Tone 6
6	Tactical	VTAC 13	DIV F	158.7375		156.7	158.7375		156.7	A	Tone 6
7	Tactical	VTAC 14	DIV A/G	159.4725		156.7	159.4725		156.7	A	Tone 6
8	Tactical	VFIRE 21	Camp Tac	154.2800		156.7	154.2800		156.7	A	Tone 6
9	Tactical	VFIRE 23	Unassigned	154.2950		156.7	154.2950		156.7	A	Tone 6
10	Tactical	VFIRE 24	DIV Y	154.2725		156.7	154.2725		156.7	A	Tone 6
11	Tactical	VFIRE 25	Unassigned	154.2875		156.7	154.2875		156.7	A	Tone 6
12	Tactical	VFIRE 26	Unassigned	154.3025		156.7	154.3025		156.7	A	Tone 6
13	Air To Ground	CDF TAC 22	Air To Ground	159.4050		192.8	159.4050		192.8	A	Tone 16
14	Air Guard	Air Guard	All Divisions	168.6250		CSQ	168.6250		110.9	A	Tone 1 Emergency Use only
15	Tactical	CALCORD	Medical TAC	156.0750		156.7	156.0750		156.7	A	Tone 6 Medical Emergency Use
16	Air Guard	Air Guard	All Divisions	168.6250		CSQ	168.6250		110.9	A	Tone 1 Emergency Use only
17											
18											
19											
20	Air Guard	Air Guard	All Divisions	168.625		CSQ	168.625		110.9	A	Tone 1 Emergency Use only
Prepared By (Communications Unit) Tom Webb COML						Incident Location: Applegate County Placer State CA Latitude 39 00 14N Longitude 120 59 36 W					

The convention calls for frequency lists to show four digits after the decimal place, followed by either an "N" or a "W", depending on whether the frequency is narrow or wide band. Mode refers to either "A" or "D" indicating analog or digital (e.g. Project 25) or "M" indicating mixed mode. All channels are shown as if programmed in a control station, mobile or portable radio. Repeater and base stations must be programmed with the Rx and Tx reversed.

AIR OPERATIONS SUMMARY (ICS 220)

1. Incident Name: Applegate Incident CA-NEU-23454		2. Operational Period: Date From: 10/10/2014 Date To: 10/11/2014 Time From: 0700 Time To: 0700			3. Sunrise: 07:08 Sunset: 18:33		
4. Remarks Hazards: Power Lines Retardant: Report any retardant dropped in or within 300 ft of a river or stream to OSC & AOBD Placer County Copter "Falcon One" Available for night hoist rescue. Request through Applegate Communications. 19:00-07:00 Pilot: Van Bogardus Crew: Mark Bracco Crew: Kris Ulshoffer			5. Ready Alert Aircraft: Medivac: C404 (Day Time Hoist) New Incident: As available		6. Temporary Flight Restriction Number: Altitude: 4 NM Freq. 127.625 Center Point: 39 01' 03.36" x 120 57' 25.35"		
			8. Frequencies:		AM	FM	9. Fixed-Wing (category/kind/type, make/model, N#, base): (1) Air Attack 09:00 Start
			Air/Air Fixed-Wing			168.7375	
7. Personnel:		Name:	Phone Number:	Air/Air Rotary-Wing – Flight Following	127.625	(1) Lead Plane 09:00 Start	
Air Operations Branch Director	Dave Lopez	714-713-5679	Air/Ground		CDF T22 Tone 16	(2) Type II Tankers 09:00 Start	
Air Support Group Supervisor	Dave Junette	530-310-2201	Command		CDF-CMD 7 Tone 8		
Air Tactical Group Supervisor	Jake Sjongen	530-277-2308	Deck Coordinator	168.350			
Helicopter Coordinator	Mike Deacon	530-412-1509	Take-Off & Landing Coordinator	123.025			
Helibase Manager	Tim Stepanovich	323-819-5369	Air Guard		168.625		
10. Helicopters (use additional sheets as necessary):							
FAA N#	Category/Kind/Type	Base	FAA#	Category/Kind/Type	Base	Remarks	
2CH	1 Restricted	Blue Cyn. Airport	514	2 Agency	Blue Cyn. Airport		
699	1 Restricted	Blue Cyn. Airport	516	2 Agency	Blue Cyn. Airport		
73U	1 Restricted	Blue Cyn. Airport	32CH	2 CWN	Blue Cyn. Airport		
6BH	1 Restricted	Blue Cyn. Airport	205	2 Agency	Blue Cyn. Airport		
917	1 Restricted	Blue Cyn. Airport	404	2 Agency	Blue Cyn. Airport		
781	1 Restricted	Blue Cyn. Airport	84H	3 Standard	Blue Cyn. Airport		
54A	1 Restricted	Blue Cyn. Airport	301	3 Standard	Blue Cyn. Airport		
512	2 Agency	Blue Cyn. Airport					
11. Prepared by: Name: D. Lopez		Position/Title: AOBD		Signature: 			
ICS 220, Page 1		Date/Time: 10/09/2014 6:01 PM					

MEDICAL PLAN (ICS 206)

1. Incident Name: APPLEGATE INCIDENT		2. Operational Period: Date From: 10/10/14 Time From: 07:00		Date To: 10/11/14 Time To: 07:00			
3. Medical Aid Stations:							
Name	Location	Contact Number(s)/Frequency	Paramedics on Site?				
MERT	BASE CAMP	530-310-4511	PA, RN, LVN				
4. Transportation (indicate air or ground):							
Ambulance Service	Location	Contact Number(s)/Frequency	Level of Service				
FOREST HILL FD.MEDIC 89 GROUND	FIRE STATION 86	530-906-3803	XXX ALS <input type="checkbox"/> BLS				
AMR GROUND	BASE CAMP	530-477-0641 (ECC)	XXX ALS <input type="checkbox"/> BLS				
CALSTAR (AIR)	AUBURN CALFIRE STATION	800-252-5050	2 FLIGHT NURSES				
5. Hospitals:							
Hospital Name	Address, Latitude & Longitude if Helipad	Contact Number(s)/ Frequency	Travel Time		Trauma Center	Burn Center	Helipad
			Air	Ground			
AUBURN FAITH	11815 EDUCATION ST, AUBURN N38 56.70 W121 05.90	530-888-4500	5	10	NO	No	Yes
SUTTER ROSEVILLE	1 MEDICAL PLAZA DR, ROSEVILLE N 38 45.90 W121 14.80	916-781-1000	10	25	XX Yes Level: <u>2</u>	NO	Yes
UC DAVIS	2315 STOCKTON BLVD N 38 33.17 W121 27.18	916-734-2011	15	45	XX Yes Level: <u>1</u>	Yes	Yes
6. Special Medical Emergency Procedures: LINE EMERGENCY: Crew Supervisor to contact Division Supervisor with patient complaint/condition and location. <ul style="list-style-type: none"> • Division Supervisor contacts: <ol style="list-style-type: none"> 1. Line EMT at nearest Drop Point 2. Communications Unit • Communications Unit contacts: <ol style="list-style-type: none"> 1. Ground EMS resource on Fire Line 2. Operations 3. Safety 4. Medical Unit • Division Supervisor or designee will serve as point of contact and run medical emergency utilizing CALCORD for IWI and only for duration needed. • Communication Unit will clear command channel for emergency traffic as needed and only for time needed. BASE CAMP EMERGENCY Contact Medical Unit with patient complaint/condition and location. Medical Staff will respond to stabilize incident: <ul style="list-style-type: none"> • Medical Unit contacts: <ol style="list-style-type: none"> 1. Communications 2. Safety 3. Logistics 4. Operations 5. Crew Supervisor 6. Comps/Claims 				INJURY REPORTING PROCEDURES NATURE OF INJURY _____ LOCATION OF PATIENT _____ TRANSPORT REQUEST BY: AIR ___ GROUND ___ DIVISION _____ CREW _____ POINT OF PICKUP _____ LAT _____ LONG _____ IS EMT WITH THE PATIENT: YES ___ NO ___ AGE _____ SEX: MALE ___ FEMALE ___ ALL EMERGENCIES Secure the area and identify witnesses for later investigation. Keep an accurate log of events.			
XX <input type="checkbox"/> Check box if aviation assets are utilized for rescue. If assets are used, coordinate with Air Operations.							
7. Prepared by (Medical Unit Leader): Name: J. Winmen				Signature:			
8. Approved by (Safety Officer): Name: K. Callison				Signature:			
ICS 206	IAP Page _____	Date/Time: 10/09/2014 15:30					



FINANCE MESSAGE

DATE: 10/10/2014

TIME UNIT

- Please come by the Time Unit and start your FC-33
- Vendor drop off your agreements to the Time Unit
- Shift Tickets need to be completed by line supervisor and turned in at the end of each shift.
- A Federal Time Keeper is on order

COMP / CLAIMS

- Report all injuries
- Property Damage must be reported to and documented
- Please report any Vehicle Damage

PROCUREMENT UNIT

- Offsite feeding must have prior approval of the Finance and Logistic Section Chiefs
- Water usage report

INCIDENT BILLING INFORMATION

NEU – Nevada/Yuba/Placer Unit
13760 Lincoln Way.
Auburn, Ca. 95603-3236

Index Code: 2300
Billing Code: 013859
PCA Code: 00900
Federal P Code PNJFK9

Rich Browne and Abby O'Leary
IMT-1 Finance Section Chief's

CAL FIRE

INCIDENT MANAGEMENT TEAM

WATER USAGE PLAN

California Drought Emergency

The following shall be considered and implemented by all fire resources as a means to provide maximum efficiencies when utilizing water resources, while minimizing the impacts to private and public water supplies. Accountability shall be maintained for all water supplies that are utilized and care should be applied to ensure proper replacement and/or reimbursement to the supplier/ owner.

Fireline personnel- (During mop up operations)

- Use of Pencil Hose and Garden Nozzles with Shut-Offs.
- Use of Back pumps.
- Dry Mop-up and consolidation of heavy fuels to areas where they can burn out safely
- Locate/ Relocate Firelines to lighter fuels or natural barriers when safe.
- Set up and use portable tanks in anticipation of longer transport times for Water Tenders.
- Use of foams, gels and other water enhancers.
- Evaluate need to mop up in excess of 200 feet from fireline

Road Maintenance and Repair-

- Monitor and water roads only when and where needed.
- Water when most effective (evening and nights).
- Use chemical treatments when available (Magchloride, Omni bind ect).
- Consider use of tertiary or treated water (sp)

Aviation Operations-

- Use of Gels, Foams and Retardants. Set up portable plants.
- Consider Blivits and Pencil hose for interior mop up operations as opposed to numerous bucket drops.
- Establish and use pre-use agreements for existing and known water sources.
- Use large watershed dip sites when able. Minimize use of small, static ponds and lakes.
- Maintain accountability of water used and locations of dip sites.
- Evaluate need for interior bucket drops

Private Water Supplies-

- Notify property owner as early as possible.
- Minimize usage and develop alternative water supplies when and where appropriate.
- Track usage (meter, 214 form) and develop a plan to replace water.
- Make arrangements for reimbursement and damage claims if needed.

Public/ Municipal Water Supplies-

- Notify Agency as soon as possible and request a representative to the incident.
- Identify fill areas and request metering devices. Place on incident map.
- Use alternative or reclaimed water sources when available. Place on incident map.
- Make arrangements for reimbursement and damage claims if needed.

Management and Supervision-

- Use leaders intent and establish Water Conservation as an Management Objective.
- Consider complexity of water use on incidents. Establish a Water Supply Group Supervisor to coordinate additional resources to support the incident needs.
- Complete the Water Usage Report daily and turn in to Finance
- Review this check list and brief daily.



FIRING OPERATION CHECKLIST

Location: _____

Date: _____ Time: _____

Firing Supervisor _____

1. Personnel Briefing

- Objectives
- Conditions (fire environment)
- Resource assignments identified
 - Firing personnel
 - Holding forces
 - Lookouts
- Ignition plan/sequence
- Communication Plan
- Contingency Plan
- Safety issues

2. Go / No-Go

- All personnel briefed
- Weather forecast reviewed
- Resources in place
- Lookouts posted as needed
- Anchor and termination firing points identified
- Communications systems in place
- Fire behavior forecast reviewed
- Escape routes and safety zones established and made known
- Adjoining forces/Air Attack notified

3. Approval Prior To Firing

- Division Supervisor
- Branch Director
- Operations

4. Other Notifications

- Other: _____
- Other: _____

Attach Firing Operations Checklist to ICS-214

Instructions for Use of CDF 101 Property Certification of Location or Damage

Document Number: for use as a local number system or when attached to a FC-40 document.

Location / Incident Name: Enter the CDF facility property is assigned to. If submitting to an incident base, enter the Incident Name.

Incident Number: Enter the appropriate incident number

Unit: Enter the Unit the property is assigned to. If submitting to an incident base, enter the request number of the person certifying damage example E-320, C-14 or O-355.

Region: Enter the CDF Region where the property was assigned. If submitting to an incident base, enter the CDF Region responsible for the incident.

Date: Enter the date the P.L. or D. was completed.

The following items were: Enter either 'Broken', 'Left on Line', 'Damaged' or other status of the property.

Reminder, this form cannot be used in place of the STD-152 to certify Lost, Stolen, Worn Out or Damaged beyond repair property.

Date of Occurrence: Enter the date the property was broken, left on line or damaged.

Quantity: Enter the quantity for the line item.

Unit of Measure: Enter the unit of measure for the line item (example ea = each).

CDF Stock Number: Enter the PIN or stock number.

Description: Enter the description of the line item, indicate size, make, model and type. Clearly describe the item and provide adequate data to effectively identify equipment or property.

Property Number: Enter the CDF property number assigned to the line item, Capitalized or sensitive property must have their property number entered here.

Location of Items: Where is the property now (example, left on Division B night shift 8/1/04, Drop Point 2). A GPS coordinate, Station 22 or Unit Service Center may also be used to describe Location.

Remarks: Enter specific remarks here, how was the property damaged, what specifically is wrong with it.

Signature of Person Certifying Occurrence as Described:

Signature: The CDF Employee certifying the occurrence must sign.

Printed Name: Enter the printed name of the signature.

Title: Enter the title of the signature.

Date: Enter the date of the signature.

Unit Supervisors Approval:

If submitted on an incident this section must be completed by the supervisor of the property custodian. This may be the Strike Team Leader, Division Supervisor, Receiving and Distribution Manager, Supply Unit Leader, Logistics Section Chief, Agency Representative or Incident Commander.

If submitted at the home Unit this section must also be completed by the supervisor of the property custodian. This may be a Battalion or Division Chief.

Comments: Supervisors may enter comments of approval or disapproval.

Signature of Unit Administrator: Signature of Unit Supervisor reviewing the certification described.

Title: Title of the signature.

Date: Date of the signature.

Notes:

This document is NOT required if exchanging property at an incident base with the exception of capitalized or sensitive property assigned a CDF property number.

This document is required as certification when submitting an MRT to your local Service Center for replacement of property.

An OF-315 (Incident Replacement Requisition) is required as authorization to purchase fire replacement items at your local Unit. This document is required when submitting an MRT to you local Service Center for fire replacement items. A CDF-101 and/or A STD-152 are required for the certification of the status of property being requisitioned for replacement.

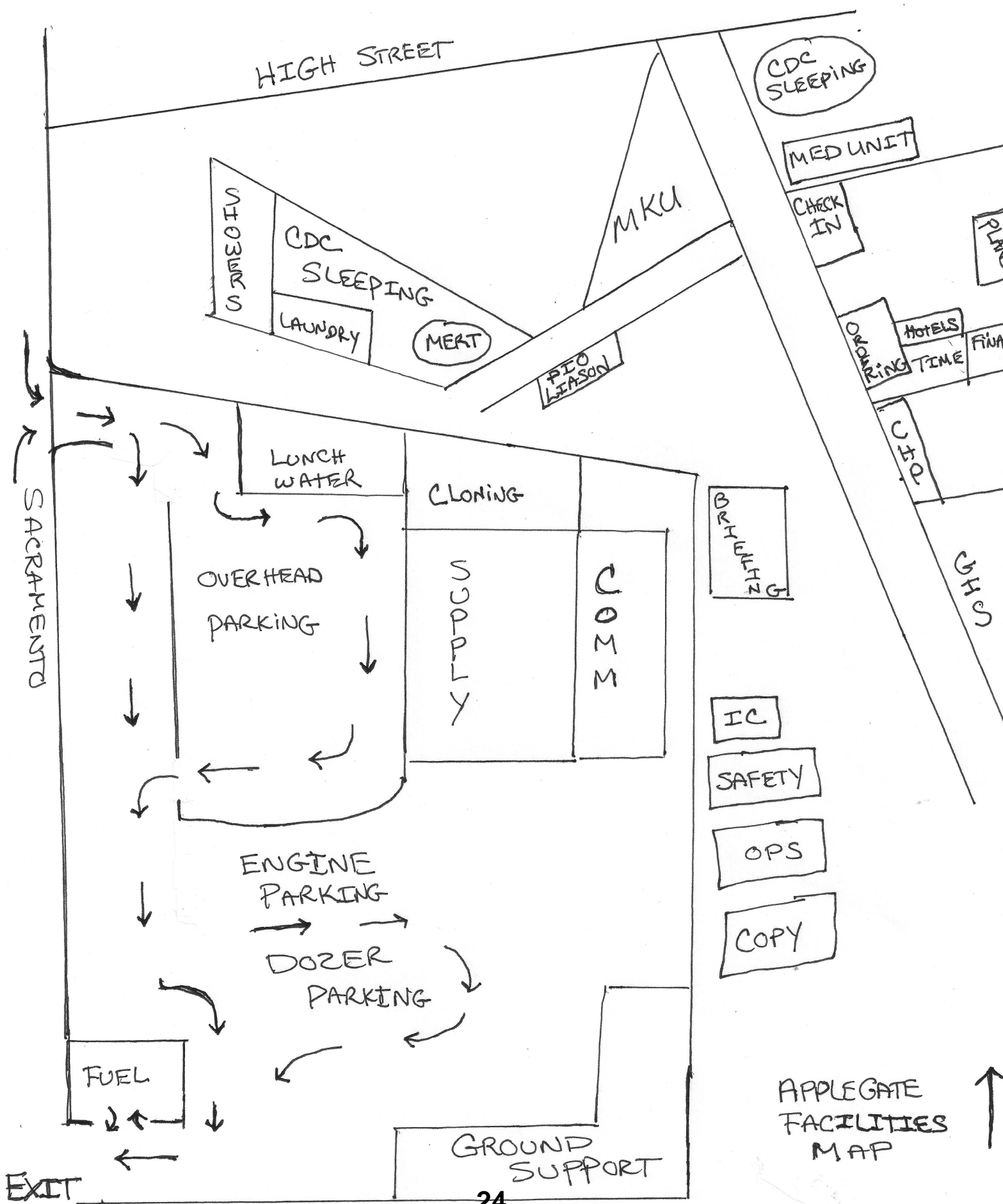

APPLGATE
 FACILITIES
 MAP

FIRE AREA MAP

Applegate Incident

CA-NEU-023454

10/10/2014



0 0.25 0.5 1 Miles

