

* CORRECTED *

Bully Incident

CASHU 006248



Incident Action Plan

Saturday, July 12, 2012

Operational Period: 0700-0700 hrs

INCIDENT OBJECTIVES	1. Incident Name Bully CASHU 006248	2. Date July 11, 2014	3. Time 2300									
4. Operational Period July 12, 2014 0700-0700												
5. General Control Objectives for the Incident (include alternatives) <p>Management Objectives :</p> <ol style="list-style-type: none"> 1. Provide for firefighter and public safety at all times 2. Protect watershed values and recognize the importance of protecting natural resources. 3. Maintain and foster relationships with cooperators and the public. 4. Utilize resources effectively according to incident needs and release excess resources promptly. 5. Maintain effective cost management based on incident needs and ensure all documentation is complete. <p>Control Objectives :</p> <p>Keep the fire within the following box:</p> <ul style="list-style-type: none"> North of Roaring Creek South of County line East of Ditch Fork of Duncan Creek West of Jerusalem Creek 												
6. Weather Forecast for Period See Attached Forecast												
7. General Safety Message SEE SAFETY MESSAGE <ul style="list-style-type: none"> ▪ WEAR YOUR <u>PPE!</u> ▪ HYDRATE, HYDRATE, HYDRATE! Avoid Heat Related Injuries - Drink Plenty of Fluids 												
8. Attachments (mark if attached)												
<table border="0"> <tr> <td><input checked="" type="checkbox"/> Organization List - ICS 203</td> <td><input checked="" type="checkbox"/> Medical Plan - ICS 206</td> <td><input type="checkbox"/> (Other)</td> </tr> <tr> <td><input checked="" type="checkbox"/> Div. Assignment Lists - ICS 204</td> <td><input checked="" type="checkbox"/> Incident Map</td> <td><input type="checkbox"/></td> </tr> <tr> <td><input checked="" type="checkbox"/> Communications Plan - ICS 205</td> <td><input checked="" type="checkbox"/> Traffic Plan</td> <td><input type="checkbox"/></td> </tr> </table>				<input checked="" type="checkbox"/> Organization List - ICS 203	<input checked="" type="checkbox"/> Medical Plan - ICS 206	<input type="checkbox"/> (Other)	<input checked="" type="checkbox"/> Div. Assignment Lists - ICS 204	<input checked="" type="checkbox"/> Incident Map	<input type="checkbox"/>	<input checked="" type="checkbox"/> Communications Plan - ICS 205	<input checked="" type="checkbox"/> Traffic Plan	<input type="checkbox"/>
<input checked="" type="checkbox"/> Organization List - ICS 203	<input checked="" type="checkbox"/> Medical Plan - ICS 206	<input type="checkbox"/> (Other)										
<input checked="" type="checkbox"/> Div. Assignment Lists - ICS 204	<input checked="" type="checkbox"/> Incident Map	<input type="checkbox"/>										
<input checked="" type="checkbox"/> Communications Plan - ICS 205	<input checked="" type="checkbox"/> Traffic Plan	<input type="checkbox"/>										
9. Prepared by (Planning Section Chief) Gabe Schultz 		10. Approved by (Incident Commander)										

ORGANIZATION ASSIGNMENT LIST		Food Unit	
1. Incident Name Bully, SHU-6248			
2. Date July 11, 2014	3. Time 2330	9. Operations Section	
4. Operational Period July 12, 2014 0700-0700		Chief	Keith White
		Deputy	
Position		a. Branch I - Division/Groups	
Name		Branch Director	
5. Incident Commander and Staff		Deputy	
Incident Commander	Mark Kendall	Division/Group	A
Deputy		Division/Group	C
Safety Officer		Division/Group	F
Information Officer			Joe Roberson
Liaison Officer			
6. Agency Representative		b. Branch II - Division/Groups	
Agency	Name	Branch Director	
Shasta Co Sheriff		Deputy	
CHP		Division/Group	S
SPI	Herb Baldwin	Division/Group	W
			Dennis Lange
			Rick Valles
			Y
7. Planning Section		c. Bully Staging	
Chief	Gabe Schultz	Staging Area Manager	Jim Davis
Deputy	Bruce Beck	d. Air Operations Branch	
Resources Unit		Air Operations Branch Director	Scott Packwood
Situation Unit	Dan Dresselhaus	Air Attack Supervisor	
Documentation Unit		Air Support Supervisor	
Demobilization Unit		Helicopter Coordinator	
Technical Specialists		Air Tanker Coordinator	
Human Resources		10. Finance Section	
Training		Chief	Harper Keene
		Deputy	
		Time Unit	
		Procurement Unit	
		Compensation/Claims Unit	
		Cost Unit	
8. Logistics Section		Prepared by (Resource Unit Leader)	
Chief	Colleen Sykes	Gabe Schultz	
Deputy	Allen Carroll		
Supply Unit			
Facilities Unit			
Ground Support Unit	Jason Rodgers		
Communications Unit			
Medical Unit			
Security Unit			

DIVISION ASSIGNMENT LIST		1. Branch 1		2. Division/Group A			
3. Incident Name Bully		4. Operational Period Date: 7/12/2014-7/13/2014 Time: 0700-0700					
5. Operations Personnel							
Operations Chief	Keith White	Division/Group Supervisor	Dan Dennet (A/Y)				
Branch Director	Eric Johnson ✓	Air Attack Supervisor No.					
6. Resources Assigned this Period							
Strike Team/Task Force/ Resource Designator	Leader	Number Persons	Trans. Needed	Drop Off PT./Time			
ST 9260 C ✓				Yolla Bully Rd/Platina Rd/0800			
ST 9220 G ✓				Yolla Bully Rd/Platina Rd/0800			
W/T E-76 ✓				Yolla Bully Rd/Platina Rd/0800			
W/T E-81 ✓				Yolla Bully Rd/Platina Rd/0800			
7. Control Operations Hold line and mop-up 100 feet minimum.							
8. Special Instructions							
9. Division/Group Communication Summary							
Function	Frequency	System	Channel	Function	Frequency	System	Channel
Command	Shasta Command Tone 4	King	Rx 154.4300 Tx 159.0150	Logistics		King	
Tactical Div./Group	CDF Tac 1	King	Rx 154.1450 Tx 154.1450	Air to Ground	CDF A/G	King	Rx 159.315 Tx 159.315
Prepared by (Resource Unit Ldr.)		Approved by (Planning Sect. Ch.) <i>ACB</i>		Date 7/12/14		Time 0500	

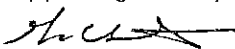
DIVISION ASSIGNMENT LIST			1. Branch I		2. Division/Group C		
3. Incident Name Bully			4. Operational Period Date: 7/12/2014-7/13/2014 Time: 0700-0700				
5. Operations Personnel							
Operations Chief		Keith White		Division/Group Supervisor			
Branch Director		Eric Johnson		Air Attack Supervisor No.			
6. Resources Assigned this Period							
Strike Team/Task Force/ Resource Designator	Leader		Number Persons	Trans. Needed	Drop Off PT./Time		
ST 9222 C ✓							
STC 9143C ✓							
ST 9142 G ✓							
STG 9232 G ✓							
DOZ							
DOZ							
W/T E-74 ✓							
W/T E-77 ✓							
Safety Officer							
7. Control Operations Finish direct fire line along Graves Ranch Road.							
8. Special Instructions							
9. Division/Group Communication Summary							
Function	Frequency	System	Channel	Function	Frequency	System	Channel
Command	Shasta Command Tone 4	King	Rx 154.4300 Tx 159.0150	Logistics		King NIFC	
Tactical Div./Group	CDF Tac 1	King	Rx 154.1450 Tx 154.1450	Air to Ground	CDF A/G	King	Rx 159.315 Tx 159.315
Prepared by (Resource Unit Ldr.)		Approved by (Planning Sect. Ch.) 			Date 7/12/14		Time 0300

5

DIVISION ASSIGNMENT LIST			1. Branch I		2. Division/Group F			
3. Incident Name Bully			4. Operational Period Date: 7/12/2014-7/13/2014 Time: 0700-0700					
5. Operations Personnel								
Operations Chief		Keith White		Division/Group Supervisor		Joe Roberson ✓		
Branch Director		Eric Johnson		Air Attack Supervisor No.				
6. Resources Assigned this Period								
Strike Team/Task Force/ Resource Designator	Leader		Number Persons	Trans. Needed	Drop Off PT./Time			
ST 9110 C ✓					Graves Ranch/0800			
ST 9223 G ✓					Graves Ranch/0800			
ST 9261 G ✓					Graves Ranch/0800			
DOZ E-66 -					Graves Ranch/0800			
DOZ E-68 -					Graves Ranch/0800			
W/T E-73 ✓					Graves Ranch/0800			
W/T					Graves Ranch/0800			
Safety Officer					Graves Ranch/0800			
DOZ E-71 -								
STL 9231 L ✓								
7. Control Operations Continue to build direct fire line and provide for structure protection.								
8. Special Instructions								
9. Division/Group Communication Summary								
Function	Frequency	System	Channel		Function	Frequency	System	Channel
Command	Shasta Command Tone 4	King	Rx 154.4300 Tx 159.0150		Logistics		King NIFC	
Tactical Div/Group	VFire 24	King	Rx 154.2725 Tx 154.2725		Air to Ground	CDF A/G	King	Rx 159.315 Tx 159.315
Prepared by (Resource Unit Ldr.)		Approved by (Planning Sect. Ch.) <i>[Signature]</i>			Date 7/12/14		Time 0800	

DIVISION ASSIGNMENT LIST			1. Branch II		2. Division/Group W		
3. Incident Name Bully			4. Operational Period Date: 7/12/2014-7/13/2014 Time: 0700-0700				
5. Operations Personnel							
Operations Chief		Keith White		Division/Group Supervisor		Rick Valles ✓	
Branch Director		Darin Quigley		Air Attack Supervisor No.			
6. Resources Assigned this Period							
Strike Team/Task Force/ Resource Designator	Leader		Number Persons	Trans. Needed	Drop Off PT./Time		
ST 3151 C ✓					Platina/Old Ono Station/0800		
ST 9252 G ✓					Platina/Old Ono Station/0800		
STG Ø					Platina/Old Ono Station/0800		
DOZ E-25					Platina/Old Ono Station/0800		
DOZ E-26					Platina/Old Ono Station/0800		
W/T					Platina/Old Ono Station/0800		
W/T					Platina/Old Ono Station/0800		
Safety Officer					Platina/Old Ono Station/0800		
7. Control Operations Finish direct line. Mop-up and hold.							
8. Special Instructions							
9. Division/Group Communication Summary							
Function	Frequency	System	Channel	Function	Frequency	System	Channel
Command	Shasta Command Tone 4	King	Rx 154.4300 Tx 159.0150	Logistics		King NIFC	
Tactical Div/Group	VFire 25	King	Rx 154.2875 Tx 154.2875	Air to Ground	CDF A/G	King	Rx 159.315 Tx 159.315
Prepared by (Resource Unit Ldr.)		Approved by (Planning Sect. Ch.) <i>[Signature]</i>		Date 7/12/14		Time 0300	

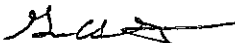
DIVISION ASSIGNMENT LIST			1. Branch II		2. Division/Group S			
3. Incident Name Date			4. Operational Period Date: 7/6/2012-7/7/2012 Time: 0700-0700					
5. Operations Personnel								
Operations Chief		Keith White		Division/Group Supervisor		Dennis Lange ✓		
Branch Director		Darin Quigley ✓		Air Attack Supervisor No.				
6. Resources Assigned this Period								
Strike Team/Task Force/ Resource Designator		Leader		Number Persons	Trans. Needed	Drop Off PT./Time		
STC 9144C ✓						Bully Choop/0800		
ST 9112 G ✓						Bully Choop/0800		
ST 9111 G ✓						Bully Choop/0800		
ST 9256 G ✓						Bully Choop/0800		
DOZ E-70 ✓						Bully Choop/0800		
DOZ E-65 ✓						Bully Choop/0800		
W/T						Bully Choop/0800		
W/T						Bully Choop/0800		
Safety Officer						Bully Choop/0800		
DOZ E-64 ✓								
DOZ E-69 ✓								
DOZ E-67 ✓								
7. Control Operations Complete direct fire line construction.								
8. Special Instructions								
9. Division/Group Communication Summary								
Function	Frequency	System	Channel		Function	Frequency	System	Channel
Command	Shatsa Command Tone 4	King	Rx 154.4300 Tx 159.0150		Logistics		King NIFC	
Tactical Div/Group	VFIRE 25	King	Rx 154.2875 Tx 154.2875		Air to Ground	CDF A/G	King	Rx 159.315 Tx 159.315
Prepared by (Resource Unit Ldr.)			Approved by (Planning Sect. Ch.) 			Date 7/12/14		Time 0300

DIVISION ASSIGNMENT LIST				1. Branch II		2. Division/Group Y	
3. Incident Name Dale				4. Operational Period Date: 7/12/2014-7/13/2014 Time: 0700-0700			
5. Operations Personnel							
Operations Chief		Keith White		Division/Group Supervisor		Dan Dennet (A/Y)	
Branch Director		Darin Quigley		Air Attack Supervisor No.			
6. Resources Assigned this Period							
Strike Team/Task Force/ Resource Designator	Leader	Number Persons	Trans. Needed	Drop Off PT./Time			
STC 9230C ✓				Yolo Bully/Roaring Crk/ 0800			
ST 9221 G ✓				Yolo Bully/Roaring Crk/ 0800			
ST 9140 G ✓				Yolo Bully/Roaring Crk/ 0800			
W/T Anderson WT46 ✓				Yolo Bully/Roaring Crk/ 0800			
W/T E-78 -				Yolo Bully/Roaring Crk/ 0800			
W/T E-72 -				Yolo Bully/Roaring Crk/ 0800			
7. Control Operations Hold line and mop-up.							
8. Special Instructions							
9. Division/Group Communication Summary							
Function	Frequency	System	Channel	Function	Frequency	System	Channel
Command	Shasta Command Tone 4	King	Rx 154.4300 Tx 159.0150	Logistics		King NIFC	
Tactical Div/Group	VFire 26	King	Rx 154.3025 Tx 154.3025	Air to Ground	CDF A/G	King	Rx 159.315 Tx 159.315
Prepared by (Resource Unit Ldr.)		Approved by (Planning Sect. Ch.) <i>[Signature]</i>		Date 7/12/14		Time 0300	

SAFETY MESSAGE	INCIDENT NAME	DATE PREPARED	TIME PREPARED
	Bully CA SHU 006248	7/12/14	0130 hours

OPERATIONAL PERIOD: 7/12, 2014 0700 – 0700

Drink water before, during and after shifts. Insure crews stay hydrated and have adequate breaks.

Concerns for Firefighters:

- **SITUATIONAL AWARENESS** -remain mindful of what is going on around you and adapt your exit strategy accordingly.
- Conduct thorough briefing of all personnel. Ensure LCES is in place. Establish adequate **Safety Zones**, IRPG p. 7.
- Beware of stump holes, trip hazards, and loose footing. Heads up for loose debris. Maintain spacing.
- Post lookouts. Know what your fire is doing at all times! Base all actions on current and expected behavior of the fire.
- Roads are narrow, dusty and there are blind curves ...**Drive Defensively!**
- Downhill Fireline construction is Hazardous. Utilize the Downhill Checklist in the IRPG p. 8
- Large scale Illicit Marijuana Operations in fire area – personal safety is paramount
- Be alert for Snags - utilize the Hazard Tree Safety Guideline IRPG p. 80

Prepared By: Gabriel Schultz		Approved By (Safety Officer, IMT #5)
---------------------------------	---	--------------------------------------

Weather July 12-13, 2014

FIRE WEATHER PLANNING FORECAST FOR INTERIOR NORTHERN CALIFORNIA
NATIONAL WEATHER SERVICE SACRAMENTO CA
247 PM PDT FRI JUL 11 2014

.DISCUSSION...

UPPER HIGH BUILDING WEST OVER THE WEEKEND WILL BRING DRY
CONDITIONS AND WARMER TEMPERATURES. WINDS WILL GENERALLY BE LIGHT
EXCEPT A FEW GUSTS TO 20 MPH OVER SIERRA DURING THE AFTERNOON
HOURS. MONSOON MOISTURE WILL SPREAD OVER THE SOUTHERN SIERRA LATE
MONDAY WITH ISOLATED THUNDERSTORMS POSSIBLE.

CAZ215-122200-

NORTHERN SACRAMENTO VALLEY TO SOUTHERN TEHAMA COUNTY LINE BELOW
1000 FT-

247 PM PDT FRI JUL 11 2014

.SATURDAY...

* SKY/WEATHER.....SUNNY.
* MAX TEMPERATURE.....98-105.
* 24 HR TREND.....5 DEGREES WARMER.
* MIN HUMIDITY.....11-16 PERCENT.
* 24 HR TREND.....8 PERCENT DOWN.
* 20-FOOT WINDS.....VARIABLE WINDS LESS THAN 5 MPH BECOMING
SOUTH UP TO 7 MPH IN THE AFTERNOON.
* LAL.....1.
* CWR.....0 PERCENT.

.SATURDAY NIGHT...

* SKY/WEATHER.....MOSTLY CLEAR.
* MIN TEMPERATURE.....66-73.
* MAX HUMIDITY.....45-60 PERCENT.
* 20-FOOT WINDS.....SOUTH WINDS 4 TO 9 MPH SHIFTING TO THE
NORTH UP TO 7 MPH AFTER MIDNIGHT.
* LAL.....1.
* CWR.....0 PERCENT.

.SUNDAY...

* SKY/WEATHER.....SUNNY.
* MAX TEMPERATURE.....100-108.
* MIN HUMIDITY.....12-21 PERCENT.
* 20-FOOT WINDS.....SOUTH WINDS UP TO 8 MPH.
* LAL.....1.
* CWR.....0 PERCENT.

AIR OPERATIONS SUMMARY

(Expanded Form for Large Operations)

OPERATIONAL PERIOD DATE: DAY SHIFT DATE: 07/12/2014

START: 0700 END: 0700

1. INCIDENT NAME: BULLY	2. PREPARED BY: S. Packwood	PREPARED DATE/TIME: 7/12/14 01:00	3.
4. REMARKS (Safety Notes, Hazards, Air Operations Special Equipment, etc.):			
SUNRISE: 05:59 SUNSET : 20:41 CUTOFF: 20:11			
5. TFR: 4 / 9654 A # 23 Altitude: 7000' MSL Freq. 123.1750 NOTAM			

*All GPS data to be collected (degrees, minutes & decimal minutes)

**Avoid aerial application of retardant or foam within 300' of waterways, bodies of water. If retardant is dropped within these areas, notify AOB/D with Lat & Long, est. of gallons, and a map.

***Redding AAB for Air Tanker reloading

***TRACK RETARDANT DROP LOCATIONS

6. PERSONNEL		Phone	FREQUENCIES	AM	FM	8. FIXED-WING # Avail / Type/ Make-Model / FAA N# / Base(s)
AOBD:	Scott Packwood	530-310-2236	AIR/AIR FW:	123.1750	166.8500	
ATGS:			AIR/AIR RW:			AA-
HLCO:			AIR/GROUND:		159.315	L-
HLCO:			DECK:		CDF Tac 17	L-
ASGS:	Tom Swanson		COMD			2 Type III on at 08:00
HEBM:	Scott Corn		AIR GUARD			T-94
HEBM:			TOLC			T-95
HEBM:						Other:
Redding Tanker Base		530 226-2795		123.025		

9. HELICOPTERS (Use Additional Sheets As Necessary)

FAA N#	TY	A # / MODEL	BASE	AVAIL	START	REMARKS	FAA N#	TY	MAKE/MODEL	BASE	AVAIL	START	REMARKS
N988B	3					Helco / Recon							
N9030I	3					Helco / Recon							
C102	2	A-11 UHH		0800		Bucket / crew shuttle							
C205	2	A-7 UHH		0800		Bucket/short haul							
C506	2	A-4		0800		Bucket / crew shuttle							
17HX	2	A-12		0800		Bucket / crew shuttle							
	2					Bucket / Sling							
	2												
715HT	1	A-8		0800									
	1												

10. TASK/MISSION/ASSIGNMENT (Use ICS-220a if additional space needed; Type/Function includes: Air Tactical, Retardant, Recon, Personnel Transport, Water Dropping, etc.)

TYPE/FUNCTION	NAME OF PERSONNEL OR CARGO (if applicable) OR INSTRUCTIONS FOR TACTICAL AIRCRAFT	MISSION START	8FLY FROM	FLY TO
Air Tactical	Direct A/C operations, coordinate with Ops.			
Bucket support	HELICOPTERS. SUPPORT CREWS ON THE LINE.			
PAX/Cargo	SLING LOADS NEED TO BE ORDERED BY 1400 HRS. ORDER THROUGH COMMUNICATIONS			
Medevac	See Medical Plan for instructions			
Recon	IC, OSC, and SUL as requested			
Helispot Construction	Once helispot established/approved/numbered, notify Air Ops with Lat Long			
Helitack	When on fireline, be sure to follow LCES, 10s and 18s. Use Lookouts and Decision Points.			
Communications				

11. Helispot, Dip Site Portable Retardant Base and Sling Spot Information-

HELI- SPOTS #	DIP SITES	SLING SPOT #	DIVISION	LATITUDE	LONGITUDE	REMARKS
Helibase						
H-				o	o	
H-				o	o	
				o	o	
				o	o	
				o	o	
				o	o	
				o	o	
				o	o	
				o	o	

INCIDENT RADIO COMMUNICATIONS PLAN

1. Incident Name: Bully
 2. Date/Time Prepared: 7/12/14
 0032hrs
 3. Operational Period Date/Time: 7/12/14-7/13/14
 0700-0700

4. Basic Radio Channel Utilization

Radio Type/Cache	Channel	Function	Frequency/Tone	Assignment	Remarks
King	Shasta Command Tone 4	Command	Rx 154.4300 Tx 159.0150	All	
King	CDF Tac 1	Tactical	Rx 154.1450 Tx 154.1450	Division A, C	
King	VFire24	Tactical	Rx 154.2725 Tx 154.2725	Division F	HT Group 24
King	VFire25	Tactical	Rx 154.2875 Tx 154.2875	Division, S, W	HT Group 24
King	VFire26	Tactical	Rx 154.3025 Tx 154.3025	Division Y	HT Group 24
King	CDF A/G	Tactical	Rx 159.315 Tx 159.315	All	CDF TAC 17

5. Prepared by (Communications Unit)
 Bruce Beck

9

MEDICAL PLAN (ICS 206)

1. Incident Name: Bully		2. Operational Period: July 12, 2014 0700-0700					
3. Medical Aid Stations:							
Name	Location	Contact Number(s)/Frequency	Paramedics on Site?				
Assigned Agency Engines	At Incident		<input type="checkbox"/> Yes <input type="checkbox"/> No				
			<input type="checkbox"/> Yes <input type="checkbox"/> No				
			<input type="checkbox"/> Yes <input type="checkbox"/> No				
			<input type="checkbox"/> Yes <input type="checkbox"/> No				
			<input type="checkbox"/> Yes <input type="checkbox"/> No				
			<input type="checkbox"/> Yes <input type="checkbox"/> No				
4. Transportation (indicate air or ground):							
Ambulance Service	Location	Contact Number(s)/Frequency	Level of Service				
AMR		ECC	<input checked="" type="checkbox"/> ALS <input type="checkbox"/> BLS				
Mercy		ECC	<input checked="" type="checkbox"/> ALS <input type="checkbox"/> BLS				
Reach 5		ECC	<input checked="" type="checkbox"/> ALS <input type="checkbox"/> BLS				
			<input type="checkbox"/> ALS <input type="checkbox"/> BLS				
5. Hospitals:							
Hospital Name	Address, Latitude & Longitude if Helipad	Contact Number(s)/Frequency	Travel Time		Trauma Center	Burn Center	Helipad
			Air	Ground			
Mercy	2175 Rosaline Ave	225-7214	5 min	10 min	<input checked="" type="checkbox"/> Yes Level: 2	<input type="checkbox"/> Yes <input checked="" type="checkbox"/> No	<input checked="" type="checkbox"/> Yes <input type="checkbox"/> No
Shasta Regional	1100 Butte Street	243-4042	5 min	20 min	<input checked="" type="checkbox"/> Yes Level: 3	<input type="checkbox"/> Yes <input checked="" type="checkbox"/> No	<input checked="" type="checkbox"/> Yes <input type="checkbox"/> No
UC Med Center	2315 Stockton Blvd., Sac	916-734-2011	1 hrs	2.5 hrs	<input checked="" type="checkbox"/> Yes Level: 1	<input checked="" type="checkbox"/> Yes <input type="checkbox"/> No	<input checked="" type="checkbox"/> Yes <input type="checkbox"/> No
Mayer Memorial		336-7524			<input type="checkbox"/> Yes Level: _____	<input type="checkbox"/> Yes <input type="checkbox"/> No	<input type="checkbox"/> Yes <input type="checkbox"/> No
					<input type="checkbox"/> Yes Level: _____	<input type="checkbox"/> Yes <input type="checkbox"/> No	<input type="checkbox"/> Yes <input type="checkbox"/> No
6. Special Medical Emergency Procedures:							
Report all injuries to DIVS. DIVS will coordinate with ECC any request for air or ground transport.							
<input type="checkbox"/> Check box if aviation assets are utilized for rescue. If assets are used, coordinate with Air Operations.							
7. Prepared by (Medical Unit Leader): Name: <u>Gabe Schultz</u> Signature:							
8. Approved by (Safety Officer): Name: _____ Signature: _____							
ICS 206	IAP Page _____	Date/Time: July 11, 2014					

SHASTA DISTRICT FAIR

WEST PARKING LOT

9

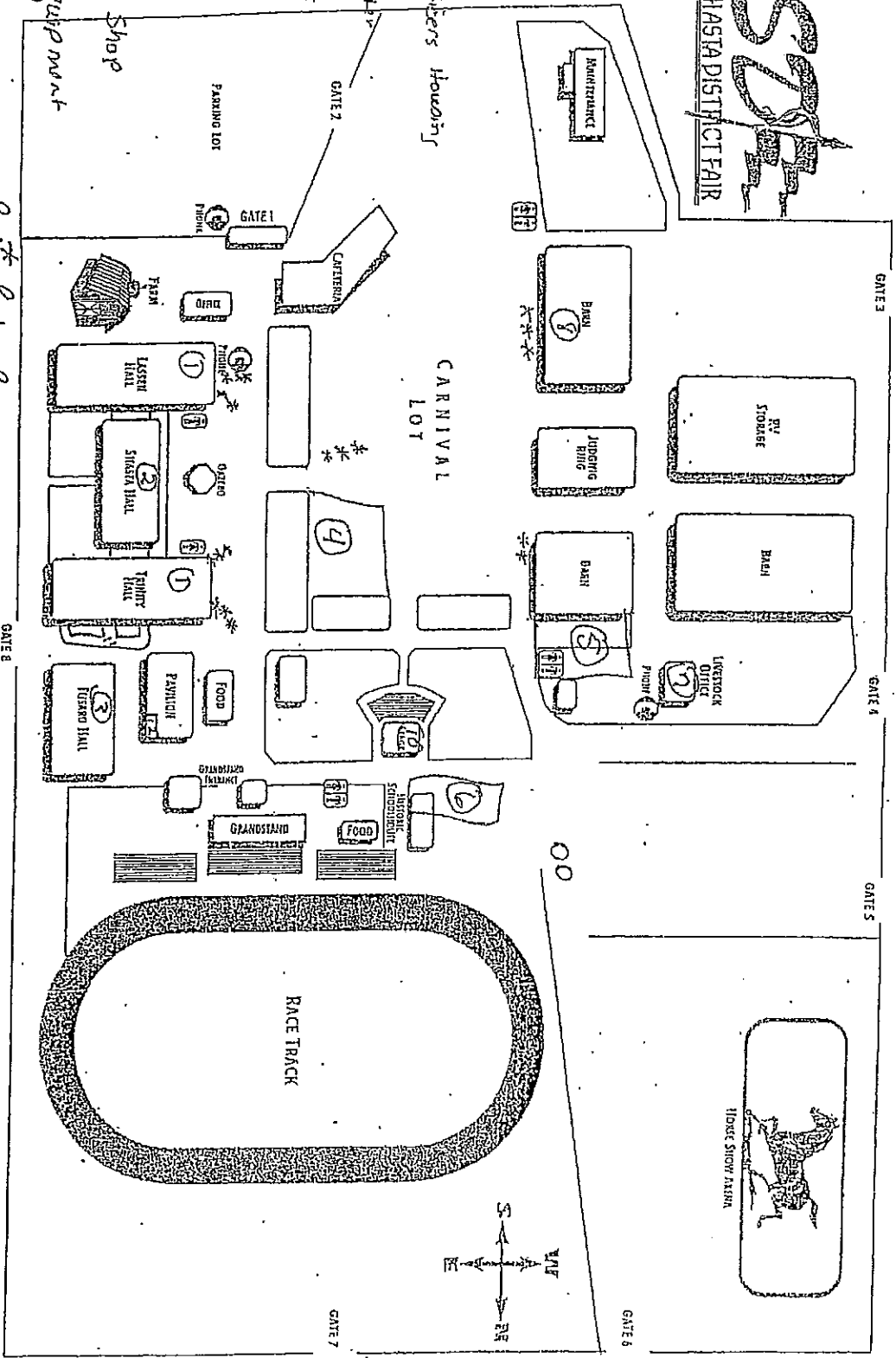

- 1) Prisoner Housing
- 2) Correction officers Housing
- 3) Command Center
- 4) Shower Units
- 5) Kitchen
- 6) Kitchen Crew Housing
- 7) Operations
- 8) Mechanical Shop
- 9) Truck + Equipment Parking

- 10) Morning Briefings
- 11) Clerical Tailors
- 12) Park along Tripping Area
- 13) COP Communications Van
- 14) Trash Dumpsters
- 15) Port a Potties

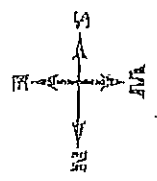

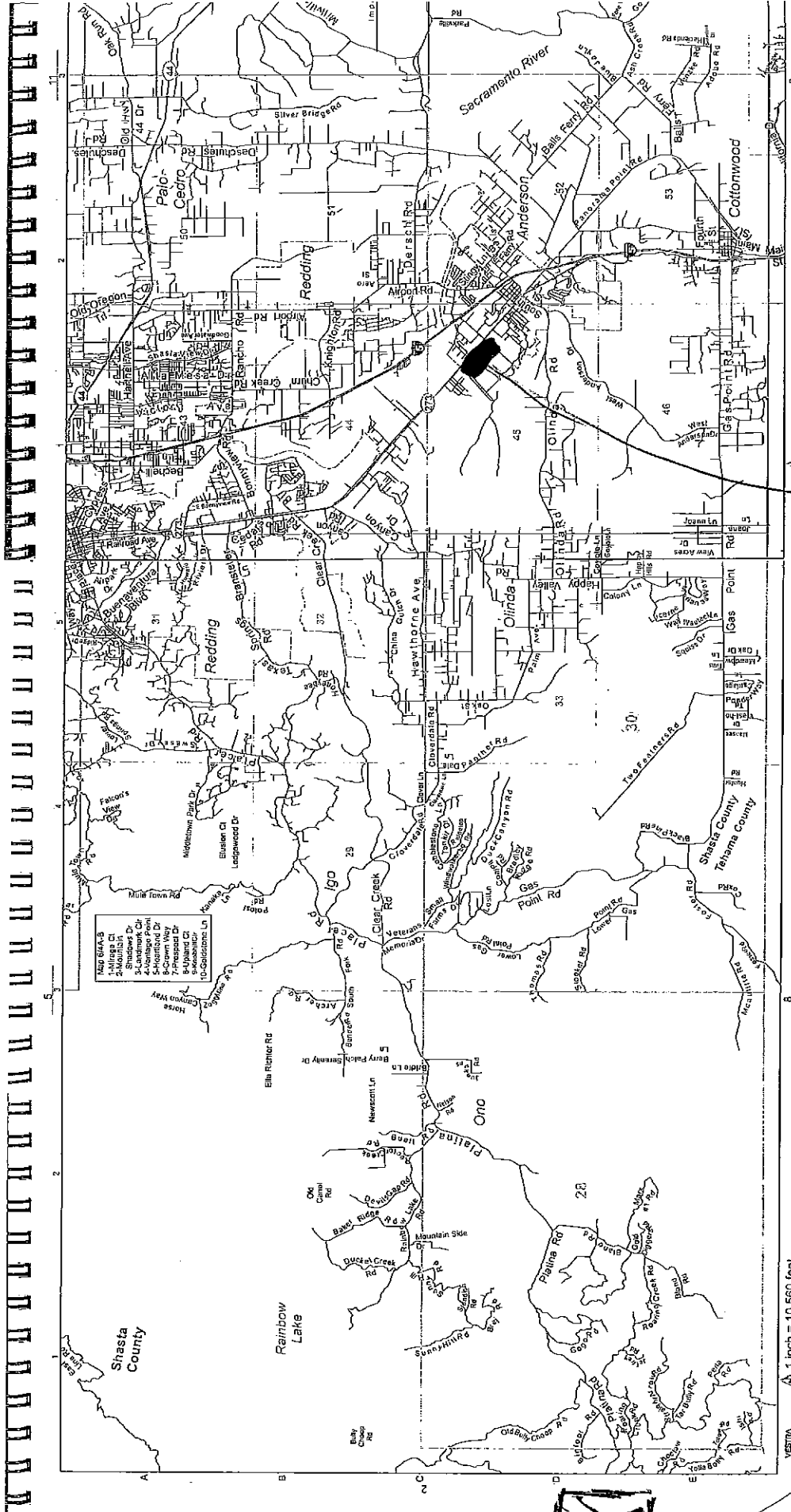

- 1-Map 64A-B
- 2-Mountain Ln
- 3-Shadows Dr
- 4-Landmark Cir
- 5-Hospital Dr
- 6-Crown Way
- 7-Prosper Dr
- 8-Maple Dr
- 9-Maple Dr
- 10-Galentine Ln

1 inch = 10,560 feet

1 inch = 10,560 feet

Fairgrounds

Incident

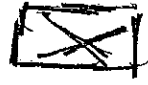

18

273 — market R CYCROSS