

*** CORRECTED IAP ***

Eiler Incident

CA-SHU-006933

Operational Period

August 7-8, 2014

0700-0700



INCIDENT OBJECTIVES	1. INCIDENT NAME Eiler	2. DATE PREPARED 8-6-2014	3. TIME PREPARED 22:45
4. OPERATIONAL PERIOD (DATE/TIME) 8-7-14 thru 8-8-14 0700-0700			
5. GENERAL CONTROL OBJECTIVES FOR THE INCIDENT (INCLUDE ALTERNATIVES) Management Objectives: <ul style="list-style-type: none"> • Identify hazardous conditions and apply mitigations to provide for responder and public safety. • Protect the values at risk: Private Timber Lands, Natural Gas Lines, Power Lines, Hydro Electric Plant, Communities in the fire area and the Thousand Lakes Wilderness. • Cooperative collaboration between the multiple agencies involved. • Reduce the potential for impacts to natural and cultural resources, utilize M.I.S.T Tactics where appropriate. • Maintain costs commensurate with values at risk. • Collect and validate intelligence to ensure internal and external information is coordinated for accuracy. Control Objectives: <ul style="list-style-type: none"> • Keep fire North of Highway 44 • Keep fire South of Highway 299 • Keep fire East of Burney Creek • Keep fire West of Road 36N18 and 34N34 			
6. WEATHER FORECAST FOR OPERATIONAL PERIOD <ul style="list-style-type: none"> • *See attached spot weather forecast* 			
7. GENERAL SAFETY MESSAGE <ul style="list-style-type: none"> • Provide proper work rest cycles for all personnel while ensuring hydration takes place throughout the operational period. Ensure that all personnel receive an operational briefing. 			
8. ATTACHMENTS (X IF ATTACHED) <input checked="" type="checkbox"/> ORGANIZATION LIST (ICS 203) <input checked="" type="checkbox"/> MEDICAL PLAN (ICS 206) <input type="checkbox"/> <input checked="" type="checkbox"/> ASSIGNMENT LIST (ICS 204) <input type="checkbox"/> INCIDENT MAP <input type="checkbox"/> <input checked="" type="checkbox"/> COMMUNICATIONS PLAN (ICS 205) <input type="checkbox"/> TRAFFIC PLAN <input type="checkbox"/>			
9. PREPARED BY (PLANNING SECTION CHIEF) Steven Ward, PSC1	10. APPROVED BY (INCIDENT COMMANDER) Kevin Smith, ICT1  DICT1		



INCIDENT Weather Forecast



FORECAST NO: 2

NAME OF FIRE: Eiler Incident

PREDICTION FOR: DAY SHIFT

UNIT: Lassen N.F.

SHIFT DATE: 8/7/2014

SIGNED: *[Signature]*

TIME AND DATE 2000 local 8/6/2014
FORECAST ISSUED:

Incident Meteorologist: Pam Szatanek

WEATHER DISCUSSION: Muggy conditions expected through the remainder of the week. Expecting a warming trend with the chance for afternoon thunderstorms for the remainder of the week. Another Pacific system will move out of the Gulf of Alaska and into northern CA later this week. Remain confident that RH recovery will be moderate at night. As the week unfolds...expecting temperatures to return to normal for August.

WEATHER FORECAST:

WEATHER: Mostly sunny to partly cloudy with areas of smoke. Isolated thunderstorms in the afternoon.

TEMPERATURES: MAX 73-83 F MIN 58-62 F

MINIMUM HUMIDITY: 40 to 55 percent.

20 FT WINDS:

RIDGETOP - Southwest 10 to 15 MPH.

SLOPE/VALLEY - Light and variable in the morning...southwest 5 to 8 MPH in the afternoon.

CHANCE OF WETTING RAINS: 10%

LAL (Lightning Activity Level): 1 becoming 2 by 1300.

MIXING HEIGHT: 4,000 to 5,000 feet.

OUTLOOK FOR FRIDAY: Partly cloudy. Isolated showers and thunderstorms in the afternoon. 20 to 30 probability of precipitation. LAL 2. High Temperatures 78 to 88 F with lows 60 to 65 F.

EXTENDED FORECAST: A stagnant pattern expected for the ensuing 96 hr period. Hot and humid. The upper level trof will reside over the western U.S. which will result in southwest flow.

FIRE BEHAVIOR FORECAST

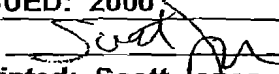
FORECAST NUMBER: 4	TYPE OF FIRE: Wildland Fire
FIRE NAME: Eiler	OPERATIONAL PERIOD: 08/07 (0700-0700)
DATE ISSUED: 08/06/2014	TIME ISSUED: 2000
UNIT: SHU	SIGNED: 
	Typed/printed: Scott Jones

INPUTS

WEATHER SUMMARY:

Expect a warming trend with chance of afternoon thunderstorms for the remainder of the week
 Mostly Sunny (patchy clouds and smoke) – Max Temp 73 - 83 RH 40% - 55% LAL 1 until 1300, becoming LAL 2
 20ft Wind –
 Slope/Valley – Light and variable in the morning. Southwest 5 to 8 MPH in the afternoon
 Ridgetop Wind – Southwest 10 to 15

OUTPUTS

FIRE BEHAVIOR

GENERAL:

Fire behavior (FB) significantly reduced with the rain activity Mon - Tue. Any moisture from this system will quickly be nullified with the increasing temperatures and solar radiation. Yesterday's operational period did not record any perimeter growth. The fire activity remains limited to an extensive amount of heavy down fuels and tree roots. These fuels continue to smolder, during exposure to direct sun light the flame production does increase.

Fire Behavior for Optimal Alignment

Fuel Type	ROS FWD	ROS LAT	FL (Ft)	P(i)G
Brush	20 - 50 ft/min	6 - 8 ft/min	8 - 12	50%
Timber Litter	4 - 8 ft/min	1 - 2 ft/min	2 - 8	50%

Expect Extreme Fire Behavior During any Thunderstorm Event

SPECIFIC:

Fire weakened landscape will continue to create rolling materials (large rocks / stumps / logs). Watch out for snags as cat faces continue to smolder and root bases may still be smoldering. There is the opportunity for thunderstorms to develop in the afternoon as breaks in the cloud coverage heat the surface. If the surface has an opportunity to heat up there is sufficient residual moisture to trigger thunderstorms.

Branch I – DIV F/I will have the greatest chance for an increase in fire activity as unburned or partially burned fuels (dirty burn) will be in alignment with the predicted wind pattern.

Branch II – The 1000 Lakes Wilderness Area due to the unknown natural fuel loading and the Minimal Impact Suppression Tactics (MIST) provides the best opportunity for any increased fire behavior.

During the initial operational periods the ERC's (RAWS – 40630) were at a 10 yr high 93%. Due to the rain ERC's dropped to a 10 yr low of 50% WED and are forecasted to spike to mid 70% by the start of the weekend. Crews should not assume that the rain received will have a lasting effect on short term fire behavior.



AIR OPERATIONS:

Morning smoke and residual haze throughout the day should not inhibit air operations.

SAFETY

Previous and current suppression efforts have the potential to further weaken terrain creating fire line hazards; rolling material, hot ash root cavities and snags.

8/7/2014

ICS 204 Special Instructions All Divisions

Thunderstorms are predicted throughout the fire area today. Review and follow **Thunderstorm Safety**, pg. 21 in your IRPG.

Take frequent hydration and nutrition breaks; document your breaks in your ICS214.



EILER HEALTH AND SAFETY MESSAGE



We Are ALL accountable for SAFE behaviors

INCIDENT: Eiler Incident

DATE: August 7, 2014 TIME: 0700-0700

Major Hazards and Risks: Hazard Trees, Thunderstorms, Drought Stricken Fuels, Fatigue, Heat, Narrow Roads, Terrain, Limited Resources.

PPE: Wear the appropriate PPE for the assignment you are given; don't become complacent.

Fire Behavior: Fuels are drought stricken and are receptive to fire spread. As the weather pattern changes with increased temperatures and decreasing RH anticipate changes in fire behavior and plan accordingly. Consider P.A.C.E and know your L.C.E.S.

Hazard Trees: Survey your work areas for hazard trees, flag and restrict access, use only qualified personnel for tree felling. Review and follow **Hazard Tree Safety**, pg. 22-23 in your IRPG.

Driving: Roads are opened to the public, be alert for traffic. Park off roadways and use warning lights/flaggers as necessary. Keep your speeds down on all roads. Watch out for loose, dusty roads, unstable shoulders and fire debris. Wear your seatbelts!

Heat / Fatigue: Take frequent nutrition and hydration breaks throughout the day. Hydrate with a 2 waters to 1 electrolyte drink ratio. Utilize the buddy system and monitor for excessive fatigue.

Thunderstorms are possible in the area today. Review and follow **Thunderstorm Safety**, pg. 21 in your IRPG.

Review your ICS 206 and know what to do in the event of a medical emergency

Lookouts, Communication, Escape routes, Safety zones

Hazard Tree Safety

Hazard tree indicators:

- Trees burning for any period of time
- Dead broken or burning tops and limbs overhead, leaning or hung-up
- Numerous downed trees

Hazard Tree Control:

- Eliminate the hazard trees with qualified sawyers
- Avoid high risk areas
- Post lookouts to secure high risk areas
- Keep clear of air drops near trees/snags
- Take breaks out of hazard tree locations
- Follow *Hazard Tree Safety*, pg. 22-23 in your IRPG

Tailgate Safety

- **Accountability:** everyone checks in and everyone checks out. Supervisors know where their crews are at all times
- **Communication:** everyone knows the com-plan
- **Briefing:** everyone knows the game plan, everyone knows the contingency plan
- **Safety gear:** everyone has the appropriate safety gear and in good working condition
- **LCES:** they are clear and made known to everyone
- **Medical:** follow the medical procedures found on the ICS206 in the IAP

Incident Safety Officer: Scott Hansen *[Signature]*

Incident Commander: Billy See *[Signature]*



EILER INCIDENT RISK ANALYSIS (ICS 215a)



DIV	HAZARDOUS ACTIONS / CONDITIONS	MITIGATIONS/WARNINGS/REMEDIES
ALL	THUNDERSTORMS	<ul style="list-style-type: none"> Brief all personnel on <i>Thunderstorm Safety</i> (IRPG pg. 21). Anticipate outflow winds and plan accordingly (LCES and PACE).
ALL	DRIVING HAZARDS	<ul style="list-style-type: none"> Use caution operating near re-opened roadways. Park off the roadway when possible. Use warning devices when operating near traffic. Drive defensively! Expect the unexpected around every curve. Drive with headlights and seatbelts on. Slow Down! Narrow dirt roads with limited passing room. Coordinate your movements on one lane roads. Increase following distances. Maintain Situational Awareness.
ALL	EXTREME FIRE BEHAVIOR POTENTIAL	<ul style="list-style-type: none"> Know your LCES and maintain Situational Awareness. Use experienced look outs. Adhere to the downhill line construction guidelines. Monitor weather for changes in the wind, temp, and RH. Expect rapid rates of spread with long range spotting, have a contingency plan (PACE) with established decision points and safety zones.
ALL	FATIGUE/HEAT/DEHYDRATION	<ul style="list-style-type: none"> Be alert for signs of fatigue and take breaks as necessary. Monitor incoming resources for level of fatigue. Drink water before, during and after shifts, up to 1.5 gal. per shift. Be alert for signs of heat stress in yourself and others; use the buddy system. Eat small meals often and when possible. Drink electrolyte drinks at a 2 water to one sport drink ratio.
ALL	COMPLACENCY	<ul style="list-style-type: none"> Ensure clear leaders intent is understood by all. Maintain high standards and provide performance feedback to counteract complacency. Don't let your guard down near the end of the mission, remain focused.
ALL	AIRCRAFT OPERATIONS	<ul style="list-style-type: none"> Keep personnel out of drop zones. Use air-to-ground freq. to communicate with aircraft. Use clear, concise statements when directing aircraft. Use clock directions from pilot's perspective. Avoid "heli-mopping". Eliminate unnecessary pilot exposure.
ALL	POWER LINES	<ul style="list-style-type: none"> Follow <i>Power Line Safety</i>, pg. 24 in your IRPG. Communicate power line hazards to immediate supervisor and hazard flag accordingly. Flag area around downed power lines and deny access. Treat all downed power lines as energized.
ALL	TACTICAL HAZARDS	<ul style="list-style-type: none"> Follow 10's and 18's. Complete Go no Go checklist for firing operations. Follow the Downhill Checklist. Know your LCES.
ALL	DOZER SAFETY	<ul style="list-style-type: none"> Watch for rolling material. Monitor safe working distances. Avoid working below Dozer. Utilize communication with the operator (radio or hand signals)
ALL	HAZARD TREES	<ul style="list-style-type: none"> Identify and isolate the area to provide for the safety of others. Flag and make proper notifications. Do Not Fall trees out of your certification level. Follow <i>Hazard Tree Safety</i>, pg. 22-23 in your IRPG
ALL	COMMUNICATIONS	<ul style="list-style-type: none"> Ensure instructions are clear and understood. Clearly communicate the leader's intent. Use human repeaters or relays whenever possible. Brief others as needed, ask if you don't know. Communicate hazards to others. Utilize assigned frequencies only; know the communications plan (ICS 205).
Incident Name: EILER CA-SHU-006933		DATE PREPARED: August 6, 2014 1800hrs
ICS 215a		Prepared by: Scott Hansen, SOF1-T <i>SA</i>
		OPERATIONAL PERIOD August 7, 2014 0700-0700

DIVISION ASSIGNMENT LIST		1. Branch I	2. Division/Group D				
3. Incident Name EILER		4. Operational Period Date: 8/7/14 - 8/8/14 Time: 0700-0700					
5. Operations Personnel							
Incident Commander	Kevin Smith / Jay Kurth	Operations	Mike Olivarria (D) / Rich Drozen (N)				
Branch Director	Nicholas Schuler ✓ Nicholas Schuler	Division/Group Supervisor	Martin Gill / John Wiseman (T)				
6. Resources Assigned this Period							
Strike Team/Task Force Resource Designator	Leader	Number Persons	Trans. Needed	Drop Off PT.	Pick Up PT.	On Line	Off Line
ST XOR 1421C ✓	T. Butler	21		DP 51		<input type="checkbox"/>	<input type="checkbox"/>
ST XSL 1471C ✓				DP 51		<input type="checkbox"/>	<input type="checkbox"/>
STG				DP 51		<input type="checkbox"/>	<input type="checkbox"/>
CRWT1				DP 51		<input type="checkbox"/>	<input type="checkbox"/>
W/T E34 NORTHSTATE ✓				DP 51		<input type="checkbox"/>	<input type="checkbox"/>
W/T E263 AAA EQUIPT ✓				DP 51		<input type="checkbox"/>	<input type="checkbox"/>
FALC	T. Porter	2		DP 51		<input type="checkbox"/>	<input type="checkbox"/>
FELB	N. Hale ✓	1		DP 51		<input type="checkbox"/>	<input type="checkbox"/>
SOFR	K. Hill ✓	1		DP 51		<input type="checkbox"/>	<input type="checkbox"/>
FEMP	B. Rambaud ✓	1		DP 51		<input type="checkbox"/>	<input type="checkbox"/>
FEMT	K. Busby ✓	1		DP 51		<input type="checkbox"/>	<input type="checkbox"/>
STC FKU 9430C Fitzgerald		17		DP 51	R+R	<input type="checkbox"/>	<input type="checkbox"/>
						<input type="checkbox"/>	<input type="checkbox"/>
						<input type="checkbox"/>	<input type="checkbox"/>
7. Control Operations -Construct control line. -Mop up 200 feet.							
8. Special Instructions -Thunderstorms are predicted throughout the fire area today. Review and follow Thunderstorm Safety, pg. 21 in your IRPG. -Avoid ground disturbing activities in sensitive areas marked with one strip of red and one strip of white flagging.							
9. Division/Group Communication Summary							
Function	Frequency	System	Channel	Function	Frequency	System	Channel
Command GDF/GMD 9 Tone 9	Rx:151.1750 N Tx:159.4500 N	Rx:103.5 Tx:100.0	1	Command GDF/GMD 9 Tone 14	Rx:151.1750 N Tx:159.4500 N	Rx:103.5 Tx:151.4	2
Tactical GDF/Tac 21	Rx:159.3900 N Tx:159.3900 N	Rx:192.8 Tx:192.8	6	At-to-Ground GDF/Tac 24	Rx:151.3175 N Tx:151.3175 N	Rx:192.8 Tx:192.8	15
Prepared by (Resource Unit Ldr.) James Lopez, RES	Approved by (Planning Sect. Ch.) Paul Saba, PSC1 (T)		Date 8/6/14	Time 2330			

DIVISION ASSIGNMENT LIST	1. Branch I	2. Division/Group F
--------------------------	----------------	------------------------

3. Incident Name EILER	4. Operational Period Date: 8/7/14 - 8/8/14 Time: 0700-0700
---------------------------	-------------------------------------------------------------------

5. Operations Personnel

Incident Commander	Kevin Smith / Jay Kurth	Operations	Mike Olivarria (D) / Rich Drozen (N)
Branch Director	Nicholas Schuler	Division/Group Supervisor	Merrick Fields PAT Williams

6. Resources Assigned this Period

Strike Team/Task Force Resource Designator	Leader	Number Persons	Trans. Needed	Drop Off PT.	Pick Up PT.	On Line	Off Line
ST LMU 9224C ✓	S. DELACOUR	18		DP 40		<input type="checkbox"/>	<input type="checkbox"/>
ST TGU 9252C ✓	M. SMITH	20		DP 40		<input type="checkbox"/>	<input type="checkbox"/>
ST CDF 9550C ✓	L. SHALHOOB	16		DP 40		<input type="checkbox"/>	<input type="checkbox"/>
ST SLU 9394G ✓	J. ELMORE	33		DP 40		<input type="checkbox"/>	<input type="checkbox"/>
ST MMU 9429L	G. DULCICH	5		DP 40		<input type="checkbox"/>	<input type="checkbox"/>
W/T BDF-51	T. NORWOOD	2		DP 40		<input type="checkbox"/>	<input type="checkbox"/>
W/T E-35 NORTH STATE ✓		2		DP 40		<input type="checkbox"/>	<input type="checkbox"/>
W/T E-190 PACKWAY 1 ✓	R. HATHAWAY	1		DP 40		<input type="checkbox"/>	<input type="checkbox"/>
W/T E-191 PACKWAY 2 ✓	R. HATHAWAY	1		DP 40		<input type="checkbox"/>	<input type="checkbox"/>
W/T E-191(L) BURNEY FIRE				DP 40		<input type="checkbox"/>	<input type="checkbox"/>
HEQB	J. GILLIS	1		DP 40		<input type="checkbox"/>	<input type="checkbox"/>
W/T E-2104 Dirtworks		2				<input type="checkbox"/>	<input type="checkbox"/>
						<input type="checkbox"/>	<input type="checkbox"/>
						<input type="checkbox"/>	<input type="checkbox"/>

7. Control Operations
 -Construct line.
 -Mop up 200 feet.
 -Back haul trash.

8. Special Instructions
 -Thunderstorms are predicted throughout the fire area today. Review and follow Thunderstorm Safety, pg. 21 in your IRPG.
 -Avoid ground disturbing activities in sensitive areas marked with one strip of red and one strip of white flagging.

9. Division/Group Communication Summary

Function	Frequency	System	Channel	Function	Frequency	System	Channel
Command CDF-CMD-9 Tone 9	Rx:151.1750 N Tx:159.4500 N	Rx:103.5 Tx:100.0	1	Command CDF-CMD-9 Tone 14	Rx:151.1750 N Tx:159.4500 N	Rx:103.5 Tx:151.4	2
Tactical VTAC-13	Rx:151.1375 N Tx:151.1375 N	Rx:156.7 Tx:156.7	7	Air to Ground CDF-Tac-24	Rx:151.3175 N Tx:151.3175 N	Rx:192.8 Tx:192.8	15

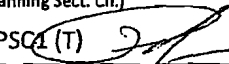
Prepared by (Resource Unit Ldr.) James Lopez, RES 	Approved by (Planning Sect. Ch.) Paul Saba, PSC1 (T) 	Date 8/6/2014	Time 2330
------------------------------------------------------------------------------------------------------------------------------------------	---------------------------------------------------------------------------------------------------------------------------------------------	------------------	--------------

DIVISION ASSIGNMENT LIST	1. Branch	2. Division/Group
	I	I

3. Incident Name EILER	4. Operational Period Date: 8/7/14 - 8/8/14 Time: 0700-0700
---------------------------	-------------------------------------------------------------------

5. Operations Personnel

Incident Commander	Kevin Smith / Jay Kurth	Operations	Mike Olivarria (D) / Rich Drozen (N)
Branch Director	Nicolas Schuler	Division/Group Supervisor	Jacob Keown ✓

6. Resources Assigned this Period

Strike Team/Task Force Resource Designator	Leader	Number Persons	Trans. Needed	Drop Off PT.	Pick Up PT.	On Line	Off Line
ST RVC 6001A ✓	C. Dehart	17		DP 40		<input type="checkbox"/>	<input type="checkbox"/>
ST XSH 3152C ✓	E. Olson	22		DP 40		<input type="checkbox"/>	<input type="checkbox"/>
ST ORC 9328C ✓	D. Phillips	17		DP 40		<input type="checkbox"/>	<input type="checkbox"/>
ENG PNF E22 ✓	T. Brenzovich	5		DP 40		<input type="checkbox"/>	<input type="checkbox"/>
ENG PNF 5131 NPS E 1130 ✓	S. Gonzales	4		DP 40		<input type="checkbox"/>	<input type="checkbox"/>
ST BEU 9489G ✓	J. Kimpton	33		DP 40		<input type="checkbox"/>	<input type="checkbox"/>
STG				DP 40		<input type="checkbox"/>	<input type="checkbox"/>
ST AEU 9278L ✓	S. Love	4		DP 40		<input type="checkbox"/>	<input type="checkbox"/>
ST SHU 9245L	D. Gyves	4		DP 40		<input type="checkbox"/>	<input type="checkbox"/>
HEQB ✓	J. Washburn	1		DP 40		<input type="checkbox"/>	<input type="checkbox"/>
SOFR ✓	B. Evans	1		DP 40		<input type="checkbox"/>	<input type="checkbox"/>
SOFR(T) ✓	C. Thompson	1		DP 40		<input type="checkbox"/>	<input type="checkbox"/>
CRW Tas Tanana Chiefs		21				<input type="checkbox"/>	<input type="checkbox"/>
						<input type="checkbox"/>	<input type="checkbox"/>

7. Control Operations
 -Construct Line
 -Mop up 200 feet

8. Special Instructions
 -Thunderstorms are predicted throughout the fire area today. Review and follow Thunderstorm Safety, pg. 21 in your IRPG.
 -Avoid ground disturbing activities in sensitive areas marked with one strip of red and one strip of white flagging.

9. Division/Group Communication Summary

Function	Frequency	System	Channel	Function	Frequency	System	Channel
Command GDF/CMP 9 Tone 9	Rx:151.1750 N Tx:159.4500 N	Rx:103.5 Tx:100.0	1	Command GDF/CMP 9 Tone 14	Rx:151.1750 N Tx:159.4500 N	Rx:103.5 Tx:151.4	2
Tactical MTAC 12	Rx:154.4525 N Tx:154.4525 N	Rx:156.7 Tx:156.7	8	Air to Ground GDF-Tac 24	Rx:151.3175 N Tx:151.3175 N	Rx:192.8 Tx:192.8	15

Prepared by (Resource Unit Ldr.) James Lopez, RESL	Approved by (Planning Sect. Ch.) Paul Saba, PSC1 (T)	Date 8/6/14	Time 2330
-------------------------------------------------------	---------------------------------------------------------	----------------	--------------

DIVISION ASSIGNMENT LIST		1. Branch I	2. Division/Group R/T				
3. Incident Name EILER		4. Operational Period Date: 8/7/14 - 8/8/14 Time: 0700-0700					
5. Operations Personnel							
Incident Commander	Kevin Smith / Jay Kurth	Operations	Mike Olivarria (D) / Rich Drozen (N)				
Branch Director	Nicholas Schuler	Division/Group Supervisor	Jeffrey Burrow ✓				
6. Resources Assigned this Period							
Strike Team/Task Force Resource Designator	Leader	Number Persons	Trans. Needed	Drop Off PT.	Pick Up PT.	On Une	Off Line
ST OES 6841A ✓	M. BERTRAND	22		EILER STAGING		<input type="checkbox"/>	<input type="checkbox"/>
ST OES 5804A R+R	J. MCLAUGHLIN	24		EILER STAGING		<input type="checkbox"/>	<input type="checkbox"/>
ST OES 4805A ✓	E. DEHART	16		EILER STAGING		<input type="checkbox"/>	<input type="checkbox"/>
ST MEU 9113C ✓	M. MAYNARD	23		EILER STAGING		<input type="checkbox"/>	<input type="checkbox"/>
ST-SLU 9395G ✓	N. HERRING	21		EILER STAGING		<input type="checkbox"/>	<input type="checkbox"/>
W/T E-9013 DANNY OILAR ✓	E-2 ✓ D. OILAR	2		EILER STAGING		<input type="checkbox"/>	<input type="checkbox"/>
W/T E-222 OILAR AG ✓	J. MARCIGAN	2		EILER STAGING		<input type="checkbox"/>	<input type="checkbox"/>
FALC ✓	DEAN PIERCY	2		EILER STAGING		<input type="checkbox"/>	<input type="checkbox"/>
FELB ✓	S. ROGERS	1		EILER STAGING		<input type="checkbox"/>	<input type="checkbox"/>
						<input type="checkbox"/>	<input type="checkbox"/>
						<input type="checkbox"/>	<input type="checkbox"/>
						<input type="checkbox"/>	<input type="checkbox"/>
						<input type="checkbox"/>	<input type="checkbox"/>
						<input type="checkbox"/>	<input type="checkbox"/>
						<input type="checkbox"/>	<input type="checkbox"/>
						<input type="checkbox"/>	<input type="checkbox"/>
						<input type="checkbox"/>	<input type="checkbox"/>
						<input type="checkbox"/>	<input type="checkbox"/>
						<input type="checkbox"/>	<input type="checkbox"/>
						<input type="checkbox"/>	<input type="checkbox"/>
						<input type="checkbox"/>	<input type="checkbox"/>
						<input type="checkbox"/>	<input type="checkbox"/>
						<input type="checkbox"/>	<input type="checkbox"/>
						<input type="checkbox"/>	<input type="checkbox"/>
						<input type="checkbox"/>	<input type="checkbox"/>
						<input type="checkbox"/>	<input type="checkbox"/>

7. Control Operations
 -Construct line.
 -Mop up 200 feet.
 -Back haul trash.
 -Fall Hazard trees.

8. Special Instructions
 -Thunderstorms are predicted throughout the fire area today. Review and follow Thunderstorm Safety, pg. 21 in your IRPG.
 -Avoid ground disturbing activities in sensitive areas marked with one strip of red and one strip of white flagging.

9. Division/Group Communication Summary

Function	Frequency	System	Channel	Function	Frequency	System	Channel
Command GDF CMD 9 Tone 9	Rx:151.1750 N Tx:159.4500 N	Rx:103.5 Tx:100.0	1	Command GDF CMD 9 Tone 14	Rx:151.1750 N Tx:159.4500 N	Rx:103.5 Tx:151.4	2
Tactical VTAC 13	Rx:158.7375 N Tx:158.7375 N	Rx:156.7 Tx:156.7	9	Air to Ground GDF Tac 24	Rx:151.3175 N Tx:151.3175 N	Rx:192.8 Tx:192.8	15

Prepared by (Resource Unit Ldr.) James Lopez, RESL	Approved by (Planning Sect. Ch.) Paul Saba, PSC1 (T)	Date 8/6/14	Time 2330
-------------------------------------------------------	---------------------------------------------------------	----------------	--------------

DIVISION ASSIGNMENT LIST	1. Branch II	2. Division/Group A
---------------------------------	------------------------	-------------------------------

3. Incident Name EILER	4. Operational Period Date: 8/7/14 – 8/8/14	Time: 0700-0700
----------------------------------	-------------------------------------------------------	------------------------

5. Operations Personnel

Incident Commander	Kevin Smith / Jay Kurth	Operations	Mike Olivarria (D) / Rich Drozen (N)
Branch Director	Felix Berbena ✓	Division/Group Supervisor	Zac Cogle

6. Resources Assigned this Period

Strike Team/Task Force Resource Designator	Leader	Number Persons	Trans. Needed	Drop Off PT.	Pick Up PT.	On Line	Off Line
ST ANF 1611C				Spike		<input type="checkbox"/>	<input type="checkbox"/>
CRW SAN JUAN IHC	J. GODSON	20		Spike		<input type="checkbox"/>	<input type="checkbox"/>
CRW FEATHER RIVER IHC	R. DANIELS	20		Spike		<input type="checkbox"/>	<input type="checkbox"/>
CRW BIG BEAR IHC				Spike		<input type="checkbox"/>	<input type="checkbox"/>
CRW CTS #1 ✓	C. RENSHAW	22		Spike		<input type="checkbox"/>	<input type="checkbox"/>
CRW PAS #3 ✓	F. LUKASEVICH	20		Spike		<input type="checkbox"/>	<input type="checkbox"/>
CREW 510		16		Spike		<input type="checkbox"/>	<input type="checkbox"/>
SOFR	J. JONES	1		Spike		<input type="checkbox"/>	<input type="checkbox"/>
FEMP	C. SCHUETZ	1		Spike		<input type="checkbox"/>	<input type="checkbox"/>
FEMT	A. BOCANEGRA	1		Spike		<input type="checkbox"/>	<input type="checkbox"/>
						<input type="checkbox"/>	<input type="checkbox"/>
						<input type="checkbox"/>	<input type="checkbox"/>
						<input type="checkbox"/>	<input type="checkbox"/>
						<input type="checkbox"/>	<input type="checkbox"/>

7. Control Operations
-Construct control line.

8. Special Instructions
-Thunderstorms are predicted throughout the fire area today. Review and follow Thunderstorm Safety, pg. 21 in your IRPG.
-Avoid ground disturbing activities in sensitive areas marked with one strip of red and one strip of white flagging.
-All resources will spike on Division

9. Division/Group Communication Summary

Function	Frequency	System	Channel	Function	Frequency	System	Channel
Command GDF-CMD 9 Tone 9	Rx:151.1750 N Tx:159.4500 N	Rx:103.5 Tx:100.0	1	Command GDF-CMD 9 Tone 14	Rx:151.1750 N Tx:159.4500 N	Rx:103.5 Tx:151.4	2
Tactical VFIRE 26	Rx:154.3025 N Tx:154.3025 N	Rx:156.7 Tx:156.7	13	Air to Ground GDF-Tac 24	Rx:151.3175 N Tx:151.3175 N	Rx:192.8 Tx:192.8	15

Prepared by (Resource Unit Ldr.) James Lopez, RESL 	Approved by (Planning Sect. Ch.) Paul Saba, PSC1 (T) 	Date 8/6/2014	Time 2330
-------------------------------------------------------------------------------------------------------------------------------------------	---------------------------------------------------------------------------------------------------------------------------------------------	------------------	--------------

DIVISION ASSIGNMENT LIST				1. Branch II		2. Division/Group B			
3. Incident Name EILER				4. Operational Period Date: 8/7/14 - 8/8/14 Time: 0700-0700					
5. Operations Personnel									
Incident Commander		Kevin Smith / Jay Kurth		Operations		Mike Olivarria (D) / Rich Drozen (N)			
Branch Director		Felix Berbena		Division/Group Supervisor		David Nicolson / Gabriel Huck (T)			
6. Resources Assigned this Period									
Strike Team/Task Force Resource Designator		Leader		Number Persons	Trans. Needed	Drop Off PT.	Pick Up PT.	On Line	Off Line
ST XSL 1477C 1471C		S. HALLET		18		DP 51		<input type="checkbox"/>	<input type="checkbox"/>
ST XSB 1521C ✓		R. BERTRAM		22		DP 51		<input type="checkbox"/>	<input type="checkbox"/>
STG						DP 51		<input type="checkbox"/>	<input type="checkbox"/>
W/T OES 41 ✓		B. WARREN		2		DP 51		<input type="checkbox"/>	<input type="checkbox"/>
W/T OES 42 ✓		N. MENTH		1		DP 51		<input type="checkbox"/>	<input type="checkbox"/>
SOFR ✓		D. BAKER		1		DP 51		<input type="checkbox"/>	<input type="checkbox"/>
FEMP ✓		C. WELLS		1		DP 51		<input type="checkbox"/>	<input type="checkbox"/>
FEMT ✓		L. AHLERS		1		DP 51		<input type="checkbox"/>	<input type="checkbox"/>
FALC 0.350		A Cut Above				DPSO		<input type="checkbox"/>	<input type="checkbox"/>
FALC 0.351		A Cut Above				DPSO		<input type="checkbox"/>	<input type="checkbox"/>
FALC 0.369		Cut Wright				DPSO		<input type="checkbox"/>	<input type="checkbox"/>
								<input type="checkbox"/>	<input type="checkbox"/>
								<input type="checkbox"/>	<input type="checkbox"/>
								<input type="checkbox"/>	<input type="checkbox"/>
7. Control Operations -Construct line. -Mop up 200 feet. -Back haul trash.									
8. Special Instructions -Thunderstorms are predicted throughout the fire area today. Review and follow Thunderstorm Safety, pg. 21 in your IRPG. -Avoid ground disturbing activities in sensitive areas marked with one strip of red and one strip of white flagging.									
9. Division/Group Communication Summary									
Function	Frequency	System	Channel	Function	Frequency	System	Channel		
Command GDF/GMD-9 Tone 9	Rx:151.1750 N Tx:159.4500 N	Rx:103.5 Tx:100.0	1	Command GDF/GMD-9 Tone 14	Rx:151.1750 N Tx:159.4500 N	Rx:103.5 Tx:151.4	2		
Tactical MAG-14	Rx:159.4725 N Tx:159.4725 N	Rx:156.7 Tx:156.7	10	Air to Ground GDF-Tac-24	Rx:151.3175 N Tx:151.3175 N	Rx:192.8 Tx:192.8	15		
Prepared by (Resource Unit Ldr.) James Lopez, RESI				Approved by (Planning Sect. Ch.) Paul Saba, PSC1 (T)		Date 8/6/2014		Time 2330	

DIVISION ASSIGNMENT LIST	1. Branch II	2. Division/Group U
---------------------------------	------------------------	-------------------------------

3. Incident Name EILER	4. Operational Period Date: 8/7/14 – 8/8/14 Time: 0700-0700
----------------------------------	------------------------------------------------------------------------------

5. Operations Personnel

Incident Commander	Kevin Smith / Jay Kurth	Operations	Mike Olivarria (D) / Rich Drozen (N)
Branch Director	Felix Berbena	Division/Group Supervisor	Chuck Ray ✓

6. Resources Assigned this Period

Strike Team/Task Force Resource Designator	Leader	Number Persons	Trans. Needed	Drop Off PT.	Pick Up PT.	On Line	Off Line	
ST SHU 9248C ✓		18		DP 65		<input type="checkbox"/>	<input type="checkbox"/>	
TF 1 EILER ✓				DP 65		<input type="checkbox"/>	<input type="checkbox"/>	
ST SHU 9247G ✓	C. WILSON	34		DP 65		<input type="checkbox"/>	<input type="checkbox"/>	
ST FKU 9475G ✓				DP 65		<input type="checkbox"/>	<input type="checkbox"/>	
STG				DP 65		<input type="checkbox"/>	<input type="checkbox"/>	
SOFR ✓	J. STRICKLAND	1		DP 65		<input type="checkbox"/>	<input type="checkbox"/>	
FEMP ✓	N. CHAPIN	1		DP 65		<input type="checkbox"/>	<input type="checkbox"/>	
FEMT ✓	L. BENNET	1		DP 65		<input type="checkbox"/>	<input type="checkbox"/>	
WT E-266 Fireline #							<input type="checkbox"/>	<input type="checkbox"/>
						<input type="checkbox"/>	<input type="checkbox"/>	
						<input type="checkbox"/>	<input type="checkbox"/>	
						<input type="checkbox"/>	<input type="checkbox"/>	
						<input type="checkbox"/>	<input type="checkbox"/>	
						<input type="checkbox"/>	<input type="checkbox"/>	

7. Control Operations
-Construct line.

8. Special Instructions
-Thunderstorms are predicted throughout the fire area today. Review and follow Thunderstorm Safety, pg. 21 in your IRPG.
-Avoid ground disturbing activities in sensitive areas marked with one strip of red and one strip of white flagging.

9. Division/Group Communication Summary

Function	Frequency	System	Channel	Function	Frequency	System	Channel
Command CDF-CMD 9 TA Tone 9	Rx:151.1750 N Tx:159.4500 N	Rx:103.5 Tx:100.0	1	Command CDF-CMD 9 Tone 14	Rx:151.1750 N Tx:159.4500 N	Rx:103.5 Tx:151.4	2
Tactical VFIRE 24	Rx:154.2725 N Tx:154.2725 N	Rx:156.7 Tx:156.7	11	Air to Ground CDF-Tac 24	Rx:151.3175 N Tx:151.3175 N	Rx:192.8 Tx:192.8	15

Prepared by (Resource Unit Ldr.) James Lopez, RESL 	Approved by (Planning Sect. Ch.) Paul Saba, PS01 (T) 	Date 8/6/14	Time 2330
-------------------------------------------------------------------------------------------------------------------------------------------	---------------------------------------------------------------------------------------------------------------------------------------------	----------------	--------------

DIVISION ASSIGNMENT LIST	1. Branch II	2. Division/Group W	PG 1 OF 2
---------------------------------	------------------------	-------------------------------	-----------

3. Incident Name EILER	4. Operational Period Date: 8/7/14 - 8/8/14 Time: 0700-0700
----------------------------------	------------------------------------------------------------------------------

5. Operations Personnel

Incident Commander	Kevin Smith / Jay Kurth	Operations	Mike Olivarria (D) / Rich Drozen (N)
Branch Director	Felix Berbena	Division/Group Supervisor	Brian Noel ✓

6. Resources Assigned this Period

Strike Team/Task Force Resource Designator	Leader	Number Persons	Trans. Needed	Drop Off PT.	Pick Up PT.	On Line	Off Line
ST OES 2807A ✓	D. MCCOUN	22		DP 65		<input type="checkbox"/>	<input type="checkbox"/>
ST KRN 9320C ✓	J. APPLETON	22		DP 65		<input type="checkbox"/>	<input type="checkbox"/>
ST XAL 2004F ✓	K. GOTRO	18		DP 65		<input type="checkbox"/>	<input type="checkbox"/>
ST MVU 9386G ✓	E. WINKLER	37		DP 65		<input type="checkbox"/>	<input type="checkbox"/>
STG				DP 65		<input type="checkbox"/>	<input type="checkbox"/>
CRW BECKWOURTH - <i>Spiked</i>				DP 65		<input type="checkbox"/>	<input type="checkbox"/>
DOZ ANF 1 ✓	D. GALLANT	2		DP 65		<input type="checkbox"/>	<input type="checkbox"/>
DOZ LPF 3 ✓	B. BAXTER	4		DP 65		<input type="checkbox"/>	<input type="checkbox"/>
DOZ BTU 2140	G. HURLEY	1		DP 65		<input type="checkbox"/>	<input type="checkbox"/>
DOZ E-20 GREEN VLY				DP 65		<input type="checkbox"/>	<input type="checkbox"/>
DOZ E-28 SUNRISE				DP 65		<input type="checkbox"/>	<input type="checkbox"/>
W/T E-97 OILAR ✓				DP 65		<input type="checkbox"/>	<input type="checkbox"/>
W/T E-242 BENDALLS ✓	JOHN BENDALLS	1		DP 65		<input type="checkbox"/>	<input type="checkbox"/>

7. Control Operations
 -Construct line.
 -Mop up 200 feet. *12 Hour*
 -Back haul trash.
 -Fall hazard trees.

8. Special Instructions
 -Thunderstorms are predicted throughout the fire area today. Review and follow Thunderstorm Safety, pg. 21 in your IRPG.
 -Avoid ground disturbing activities in sensitive areas marked with one strip of red and one strip of white flagging.
 *Dozers are 12 hour resources.

9. Division/Group Communication Summary

Function	Frequency	System	Channel	Function	Frequency	System	Channel
Command CDF GMD9 Tone 9	Rx:151.1750 N Tx:159.4500 N	Rx:103.5 Tx:100.0	1	Command CDF GMD9 Tone 4	Rx:151.1750 N Tx:159.4500 N	Rx:103.5 Tx:151.4	2
Tactical VFIRE 25	Rx:154.2875 N Tx:154.2875 N	Rx:156.7 Tx:156.7	12	Air to Ground CDF TAG 24	Rx:151.3175 N Tx:151.3175 N	Rx:192.8 Tx:192.8	15

Prepared by (Resource Unit Ldr.) James Lopez, RESL <i>[Signature]</i>	Approved by (Planning Sect. Ch.) Paul Saba, PSC1 (T) <i>[Signature]</i>	Date 8/6/2014	Time 2330
--------------------------------------------------------------------------	----------------------------------------------------------------------------	------------------	--------------

DIVISION ASSIGNMENT LIST	1. Branch II	2. Division/Group W	PG 2 OF 2
---------------------------------	------------------------	-------------------------------	-----------

3. Incident Name EILER	4. Operational Period Date: 8/7/14 – 8/8/14 Time: 0700-0700
----------------------------------	---------------------------------------------------------------------------------

5. Operations Personnel

Incident Commander	Kevin Smith / Jay Kurth	Operations	Mike Olivarria (D) / Rich Drozen (N)
Branch Director	Felix Berbena	Division/Group Supervisor	Brian Noel

6. Resources Assigned this Period

Strike Team/Task Force Resource Designator	Leader	Number Persons	Trans. Needed	Drop Off PT.	Pick Up PT.	On Line	Off Line
FELB ✓	D. DAVIS	1		DP 65		<input type="checkbox"/>	<input type="checkbox"/>
FALC ✓	LONE PINE CUTTING			DP 65		<input type="checkbox"/>	<input type="checkbox"/>
FALC HODGSON FALLS - 0-349 ✓				DP 65		<input type="checkbox"/>	<input type="checkbox"/>
HEQB	S. DYER	1		DP 65		<input type="checkbox"/>	<input type="checkbox"/>
FEMP ✓	J. NICASIO	1		DP 65		<input type="checkbox"/>	<input type="checkbox"/>
FEMT ✓	J. IRVIN	1		DP 65		<input type="checkbox"/>	<input type="checkbox"/>
KAKUKI - T2 IAV ✓						<input type="checkbox"/>	<input type="checkbox"/>
						<input type="checkbox"/>	<input type="checkbox"/>
						<input type="checkbox"/>	<input type="checkbox"/>
						<input type="checkbox"/>	<input type="checkbox"/>
						<input type="checkbox"/>	<input type="checkbox"/>
						<input type="checkbox"/>	<input type="checkbox"/>
						<input type="checkbox"/>	<input type="checkbox"/>
						<input type="checkbox"/>	<input type="checkbox"/>
						<input type="checkbox"/>	<input type="checkbox"/>

7. Control Operations
 -Construct line.
 -Mop up 200 feet.
 -Back haul trash.
 -Fall hazard trees.

8. Special Instructions
 -Thunderstorms are predicted throughout the fire area today. Review and follow Thunderstorm Safety, pg. 21 in your IRPG.
 -Avoid ground disturbing activities in sensitive areas marked with one strip of red and one strip of white flagging.
 *Dozers are 12 hour resources.

9. Division/Group Communication Summary

Function	Frequency	System	Channel	Function	Frequency	System	Channel
Command GDF/GMD9 Tone 9	Rx:151.1750 N Tx:159.4500 N	Rx:103.5 Tx:100.0	1	Command GDF/GMD9 Tone 14	Rx:151.1750 N Tx:159.4500 N	Rx:103.5 Tx:151.4	2
Tactical VHRE 25	Rx:154.2875 N Tx:154.2875 N	Rx:156.7 Tx:156.7	12	Air to Ground GDF/Tac 24	Rx:151.3175 N Tx:151.3175 N	Rx:192.8 Tx:192.8	15

Prepared by (Resource Unit Ldr.) James Lopez, RES	Approved by (Planning Sect. Ch.) Paul Saba, PSC1 (T)	Date 8/6/2014	Time 2330
------------------------------------------------------	---------------------------------------------------------	------------------	--------------

3. Incident Name EILER	4. Operational Period Date: 8/7/14 - 8/8/14 Time: 0700-0700		
----------------------------------	------------------------------------------------------------------------------	--	--

5. Operations Personnel

Incident Commander	Kevin Smith / Jay Kurth	Operations	Mike Olivarria (D) / Rich Drozen (N)
Branch Director		Division/Group Supervisor	Ben Rowe / Matt Staudacher

6. Resources Assigned this Period

Strike Team/Task Force Resource Designator	Leader	Number Persons	Trans. Needed	Drop Off PT.	Pick Up PT.	On Line	Off Line
STG				Eiler Staging		<input type="checkbox"/>	<input type="checkbox"/>
STG				Eiler Staging		<input type="checkbox"/>	<input type="checkbox"/>
DOZ E-22 DADCO				Eiler Staging		<input type="checkbox"/>	<input type="checkbox"/>
DOZ E-25 65102768 Henthorn J. HENTHORN		2		Eiler Staging		<input type="checkbox"/>	<input type="checkbox"/>
DOZ E-27 INDEPENDENT	J. LANGUM	1		Eiler Staging		<input type="checkbox"/>	<input type="checkbox"/>
DOZ E-29 SUNRISE				Eiler Staging		<input type="checkbox"/>	<input type="checkbox"/>
DOZ E-135 NEESE CONST	✓ D. NEESE			Eiler Staging		<input type="checkbox"/>	<input type="checkbox"/>
DOZ E-208 DIAMOND	✓ J. BRITTEN	4		Eiler Staging		<input type="checkbox"/>	<input type="checkbox"/>
W/T E-267 Fireline	✓			Eiler Staging		<input type="checkbox"/>	<input type="checkbox"/>
W/T E-268 Fireline	✓			Eiler Staging		<input type="checkbox"/>	<input type="checkbox"/>
EXCAVATOR				Eiler Staging		<input type="checkbox"/>	<input type="checkbox"/>
EXCAVATOR				Eiler Staging		<input type="checkbox"/>	<input type="checkbox"/>
GRADER				Eiler Staging		<input type="checkbox"/>	<input type="checkbox"/>
READ ✓	C. ENGELHART	1		Eiler Staging		<input type="checkbox"/>	<input type="checkbox"/>

7. Control Operations
-Evaluate needs.

8. Special Instructions
-Thunderstorms are predicted throughout the fire area today. Review and follow Thunderstorm Safety, pg. 21 in your IRPG.
-Avoid ground disturbing activities in sensitive areas marked with one strip of red and one strip of white flagging.

9. Division/Group Communication Summary

Function	Frequency	System	Channel	Function	Frequency	System	Channel
Command GDF-CMD-9 Tone 9	Rx:151.1750 N Tx:159.4500 N	Rx:103.5 Tx:100.0	1	Command GDF-CMD-9 Tone 14	Rx:151.1750 N Tx:159.4500 N	Rx:103.5 Tx:151.4	2
Tactical GDF-Tac-13	Rx:151.4750 N Tx:151.4750 N	Rx:192.8 Tx:192.8	5	Air to Ground GDF-Tac-24	Rx:151.3175 N Tx:151.3175 N	Rx:192.8 Tx:192.8	15

Prepared by (Resource Unit Ldr.) James Lopez, RESL	Approved by (Planning Sect. Ch.) Paul Saba, PSC1 (T)	Date 8/6/2014	Time 2330
-------------------------------------------------------	---------------------------------------------------------	------------------	--------------

3. Incident Name EILER	4. Operational Period Date: 8/7/14 - 8/8/14 Time: 0700-0700
----------------------------------	------------------------------------------------------------------------------

5. Operations Personnel

Incident Commander	Kevin Smith / Jay Kurth	Operations	Mike Olivarria (D) / Rich Drozen (N)
Branch Director		Division/Group Supervisor	Ben Rowe / Matt Staudacher

6. Resources Assigned this Period

Strike Team/Task Force Resource Designator	Leader	Number Persons	Trans. Needed	Drop Off PT.	Pick Up PT.	On Line	Off Line
READ ✓	M. REED	1		Eiler Staging		<input type="checkbox"/>	<input type="checkbox"/>
READ ✓	Z. MONDRY	1		Eiler Staging		<input type="checkbox"/>	<input type="checkbox"/>
FOBS ✓	R. CARR	1		Eiler Staging		<input type="checkbox"/>	<input type="checkbox"/>
FOBS ✓	B. DARLEY	1		Eiler Staging		<input type="checkbox"/>	<input type="checkbox"/>
FOBS ✓	L. TITUS	1		Eiler Staging		<input type="checkbox"/>	<input type="checkbox"/>
FOBS ✓	H. BERRYMAN	1		Eiler Staging		<input type="checkbox"/>	<input type="checkbox"/>
RESP	M. BOONE	1				<input type="checkbox"/>	<input type="checkbox"/>
						<input type="checkbox"/>	<input type="checkbox"/>
						<input type="checkbox"/>	<input type="checkbox"/>
						<input type="checkbox"/>	<input type="checkbox"/>
						<input type="checkbox"/>	<input type="checkbox"/>
						<input type="checkbox"/>	<input type="checkbox"/>
						<input type="checkbox"/>	<input type="checkbox"/>
						<input type="checkbox"/>	<input type="checkbox"/>
						<input type="checkbox"/>	<input type="checkbox"/>
						<input type="checkbox"/>	<input type="checkbox"/>
						<input type="checkbox"/>	<input type="checkbox"/>

7. Control Operations
-Evaluate needs.

8. Special Instructions
-Thunderstorms are predicted throughout the fire area today. Review and follow Thunderstorm Safety, pg. 21 in your IRPG.
-Avoid ground disturbing activities in sensitive areas marked with one strip of red and one strip of white flagging.

9. Division/Group Communication Summary

Function	Frequency	System	Channel	Function	Frequency	System	Channel
Command CDF-CMD-9 Tone 9	Rx:151.1750 N Tx:159.4500 N	Rx:103.5 Tx:100.0	1	Command CDF-CMD-9 Tone 14	Rx:151.1750 N Tx:159.4500 N	Rx:103.5 Tx:151.4	2
Tactical CDF-Tac-19	Rx:151.4750 N Tx:151.4750 N	Rx:192.8 Tx:192.8	5	Alert Ground CDF-Tac-24	Rx:151.3175 N Tx:151.3175 N	Rx:192.8 Tx:192.8	15

Prepared by (Resource Unit Ldr.) James Lopez, RESL	Approved by (Planning Sect. Ch.) Paul Saba, PSC1 (T)	Date 8/6/2014	Time 2330
-------------------------------------------------------	---------------------------------------------------------	------------------	--------------

AIR OPERATIONS SUMMARY

PREPARED BY: Frank Podesta

PREPARED DATE/TIME: 08/06/14 / 2000hrs

1. INCIDENT NAME: EILER	2. OPERATIONAL PERIOD DATE: 08/07/14	START TIME: 0600 END TIME: 2000 SUNRISE: 0605 SUNSET: 2018
-------------------------	--------------------------------------	---------------------------------------------------------------

3. REMARKS (Safety Notes, Hazards, Air Operations Special Equipment,, etc.): 1) Keep track of amount of water pulled out of dip site and which dip site used. 2) Ensure ground personnel are working with aviation assets when conducting water drops. 3) All Lat and Long locations are to be in Degrees, Minutes and Decimal Minutes. 4) Watch for meteorological towers. Give Lat and Long to Helibase Manager Helibase at Whitmore Cal Fire Station 40 37.80 x 121 53.80 <u>Use Thunderstorm Safety Precautions</u>	4. MEDEVAC A/C: Cal Fire 202 Guard Copter 826 (See Medical Plan)	5. TFR: #4/8809 N41 03.00' x W121 21.15' N40 55.30' x W121 09.00' N40 38.00' x W 121 32.30' N40 50.20 x W 121 48.00' Ceiling: 10,000 MSL TFR Frequency: 118.575
-----------------------------------------------------------------------------------------------------------------------------------------------------------------------------------------------------------------------------------------------------------------------------------------------------------------------------------------------------------------------------------------------------------------------------------------------------------------------------------------------------------------------------------------------	--------------------------------------------------------------------------------------	-----------------------------------------------------------------------------------------------------------------------------------------------------------------------------------------------

6. PERSONNEL	Phone	7. FREQUENCIES	AM	FM	8. FIXED-WING	# Avail / Type/ Make-Model / FAA N# / Base(s)
AOBD: Frank Podesta	209-419-4408	AIR/AIR FW:		168.5000	Airtankers	Order as needed 2 - Type 1 2 - Type 3
ATGS:		AIR/AIR RW:	118.650		Leadplanes	Order as needed
HLCO: Stacy Hamilton Dan Hicky		AIR/GROUND:		151.3175	Base FAX #:	
ASGS: Jon Chln	760-250-6230	COMMAND:	CDF Command 9 Tone 9/14		ATGS Aircraft	AA240, AA140, AA503
HEBM: Dave Ito	530-391-6583	COMMAND RPT	Rx:151.175 Tx:159.450		Other	
ATB MGR:		DECK FREQ:		163.100		
		TOLC FREQ:	123.025			

9. HELICOPTERS (Use Additional Sheets As Necessary)

FAA N#	TY	MAKE/MODEL	BASE	AVAIL	START	REMARKS	FAA N#	TY	MAKE/MODEL	BASE	AVAIL	START	REMARKS
212HP	2	Bell 212HP	Whit		0800	A-6	801	1	CH-47	Whit		1000	A-2
205GH	2	Bell 205++	Whit		0800	A-7	802	1	CH-47	Whit		1000	A-3
							803	1	CH-47	Whit		1000	A-4
62HP	3	Bell 206	Whit		0800	A-8	804	1	CH_47	Whit		1000	A-5
00	3	UH-72	Whit		0800	A-9 HLCO							
02	3	UH-72	Whit		0800	A-20 HLCO							

INCIDENT RADIO COMMUNICATIONS PLAN			Incident Name EILER			Date/Time Prepared 8/6/2014 1800 hrs			Operational Period Date/Time 8/7/2014 0700 hrs - 8/8/2014 0700 Hrs	
Ch #	Function	Channel Name/Trunked Radio System Talkgroup	Assignment	RX Freq N or W	RX Tone/NAC	TX Freq N or W	Tx Tone/NAC	Mode A, D or M	Remarks	
1	COMMAND	CDF C9 T9	ALL DIVISIONS	151.1750 N	103.5	159.4500 N	100.0	A	TONE 9 - HATCHET MTN.	
2	COMMAND	CDF C9 T14	ALL DIVISIONS	151.1750 N	103.5	159.4500 N	151.4	A	TONE 14 - WEST PROSPECT	
3	COMMAND	CDF C9 T13	ALL DIVISIONS	151.1750 N	103.5	159.4500 N	141.3	A	TONE 13 - BURNEY MTN.	
4	COMMAND	NIFC C40	UNASSIGNED	171.4125 N		169.1625 N	146.2	A	T-5 UNASSIGNED / FUTURE	
5	TACTICAL	CDF T13	SUPPRESSION	151.4750 N	192.8	151.4750 N	192.8	A	FIRE SUPPRESSION / REPAIR	
6	TACTICAL	CDF T21	DIVISION D	159.3900 N	192.8	159.3900 N	192.8	A		
7	TACTICAL	VTAC 11	DIVISION F	151.1375 N	156.7	151.1375 N	156.7	A		
8	TACTICAL	VTAC 12	DIVISION I	154.4525 N	156.7	154.4525 N	156.7	A		
9	TACTICAL	VTAC 13	DIVISION R / T	158.7375 N	156.7	158.7375 N	156.7	A		
10	TACTICAL	VTAC 14	DIVISION B	159.4725 N	156.7	159.4725 N	156.7	A		
11	TACTICAL	VFIRE 24	DIVISION U	154.2725 N	156.7	154.2725 N	156.7	A		
12	TACTICAL	VFIRE 25	DIV W / STAGING	154.2875 N	156.7	154.2875 N	156.7	A	DIV W / EILER STAGING	
13	TACTICAL	VFIRE 26	DIVISION A	154.3025 N	156.7	154.3025 N	156.7	A		
14	MEDICAL	CALCORD	ALL DIVISIONS	156.0750 N		156.0750 N	156.7	A	MEDICAL	
15	AIR/GROUND	CDF T24	ALL DIVISIONS	151.3175 N	192.8	151.3175 N	192.8	A	TONE 16 - AIR TO GROUND	
16	EMERGENCY	GUARD	ALL DIVISIONS	168.6250 N		168.6250 N	110.9	A	AIR GUARD - EMERGENCY	
17										
18										
19										
20	EMERGENCY	GUARD	ALL DIVISIONS	168.6250 N		168.6250 N	110.9	A	AIR GUARD - EMERGENCY	
Prepared By (Communications Unit) KEN PARKER 					Incident Location: SHU County Shasta Co. State CA Latitude N Longitude W					

The convention calls for frequency lists to show four digits after the decimal place, followed by either an "N" or a "W", depending on whether the frequency is narrow or wide band. Mode refers to either "A" or "D" indicating analog or digital (e.g. Project 25) or "M" indicating mixed mode. All channels are shown as if programmed in a control station, mobile or portable radio. Repeater and base stations must be programmed with the Rx and Tx reversed.

INCIDENT RADIO COMMUNICATIONS PLAN			Incident Name	Date/Time Prepared				Operational Period Date/Time		
			BALD CA-LNF-003479	08/06/14 2000				DAY SHIFT 08-07-14		
Only frequencies listed on this 205 are authorized for use on this incident.				Hand programmers accept all responsibility for the use of unauthorized frequencies.						
Ch #	Function	Channel Name	Assignment	RX Freq N or W	RX Tone	TX Freq N or W	TX Tone	Mode	Remarks	
1	NIFC CMD 1	CMD 1	ALL DIVISIONS	168.7000N		170.9750N	T11,114.8	A		
2	NIFC CMD 8	CMD 8	ALL DIVISIONS	169.5375N		164.7125N	T11,114.8	A		
3	NIFC CMD ?	BLANK	UNASSIGNED	???N		???N		A	Possible future expansion	
4	TACTICAL	NIFC T-1	DIVISION A	168.0500N		168.0500N		A		
5	TACTICAL	NIFC T-3	DIVISION C	168.6000N		168.6000N		A		
6	TACTICAL	NIFC T-5	DIVISION B	166.7250N		166.7250N		A		
7	TACTICAL	NIFC T-6	DIVISION D	166.7750N		166.7750N		A		
8	TACTICAL	NIFC T-7	DIVISION L	168.2500N		168.2500N		A		
9	TACTICAL	FS R5 T4	DIVISION M	166.5500N		166.5500N		A		
10	TACTICAL	FS R5 T5	REPAIR GROUP	167.1125N		167.1125N		A		
11		A/G 1	UNASSIGNED	169.4000N		169.4000N		A	Not authorized for use	
12		A/G 2	UNASSIGNED	169.8250N		169.8250N		A	Not authorized for use	
13	AIR TO GROUND	A/G 3	ALL DIVISIONS	166.6750N		166.6750N		A		
14	SIFC	SIFC	SUSANVILLE DISPATCH	172.2250N		171.4750N	T3, 131.8	A	IF BALD CMD FAILS COMPLETELY	
15	CALCORD	CALCORD	MED HELO CONTACT	156.0750N		156.0750N	T6, 156.7	A		
16	URGENT AIR CONTACT	AIR GUARD	ALL DIVISIONS	168.6250N		168.6250N	T1, 110.9	A	USE ONLY FOR URGENT AIRCRAFT CONTACT IF HAND PROGRAMMING USE TONE 1	

MEDICAL PLAN ICS 206 "IMT 5"	1. INCIDENT NAME Eiler Incident	2. DATE PREPARED 08/06/14	3. TIME PREPARED 1730	4. OPERATIONAL PERIOD 08/07/14 0700 - 0700
	5. INCIDENT MEDICAL AID STATIONS			

MEDICAL AID STATIONS	LOCATION	PARAMEDICS	
		YES	NO
I.C.P. Medical Unit	(Anderson Fairgrounds) 1890 Briggs St., Anderson, CA		X

6. TRANSPORTATION

A. AMBULANCE SERVICES				
NAME	LOCATION	PHONE	PARAMEDICS	
			YES	NO
Mayers Memorial Ambulance	43563 Hwy 299E, Fall River Mills, CA	(530) 243-1434	X	
Burney Fire Department Ambulance	37072 Hwy 299, Burney, CA	(530) 243-1434	X	
Air Ambulance	Redding, CA	(530) 243-1434	X	
Cal-Fire H.C. 202 (Daytime Hoist)	Helibase, Burney, CA	(530) 294-5251		X
C.N.G. Guard 826 (24 Hour Hoist)	Redding Airport, Redding CA	(530) 243-1434	X	

B. INCIDENT AMBULANCES

NAME	LOCATION	PARAMEDICS	
		YES	NO
Burney Fire Department A 217 (0700-1900)	37072 Hwy 299, Burney, CA	X	

7. HOSPITALS

NAME Med Net Channel	ADDRESS	TRAVEL TIME		PHONE	HELIPAD		BURN CENTER	
		AIR	GRND		YES	NO	YES	NO
Mayer's Hospital	43563 Hwy 299E, Fall River Mills, CA	5 Min	20 Min	(530) 336-5511	X			X
Mercy Medical Center (Trauma)	2175 Rosalina Ave., Redding, CA	25Min	1.5 Hrs	(530) 225-6000	X			X
Shasta Regional Medical (Trauma)	1100 Butte, Redding, CA	25Min	1.5 Hrs	(530) 244-5353	X			X
UC Davis Trauma/Burn	2315 Stockton Blvd., Sacramento, CA	65Min	3.5 Hrs	(916) 734-3636	X		X	

8. MEDICAL EMERGENCY PROCEDURES

EMERGENCY FREQUENCY:

LINE EMERGENCY:
Crew Supervisor will contact Division Supervisor with patient complaint/condition and location.

- Division/Group Supervisor contacts:
 - Closest EMS resource
 - Communications Unit
- Communications Unit contacts:
 - Ground or Air ambulance as requested
 - Operations
 - Safety
 - Medical Unit
- Division Supervisor or designee will serve as point of contact and run medical emergency on assigned channel.
 - A pre-assigned tactical frequency (i.e. CALCORD) should be used for IWI and only for duration of need.
- Communications Unit will clear command channel for emergency traffic as needed and only for duration of need.

CAMP EMERGENCY:
Contact Medical Unit with patient complaint/condition and location. Medical Staff will respond to stabilize incident.

- Medical Unit contacts:
 - Communications
 - Safety
 - Logistics
 - Operations
 - Crew Supervisor
 - Comps/Claims

INJURY REPORTING PROCEDURES

NATURE OF INJURY _____
 LOCATION OF PATIENT _____
 POINT OF CONTACT _____
 TRANSPORTATION REQUESTED BY: AIR ___ GROUND ___
 POINT OF PICKUP _____
 LAT _____ LONG _____
 PATIENT UNIT ID _____
 IS AN EMT WITH PATIENT: YES ___ NO ___
 AGE _____
 SEX: MALE ___ FEMALE ___

ALL EMERGENCIES---Secure the area and identify witnesses for later investigation. Keep an accurate log of events.

ICS 206 (Rev 03/12)	9. PREPARED BY: (Medical Unit Leader)	10. REVIEWED BY: (Safety Officer)
		

CAL FIRE INCIDENT MANAGEMENT TEAM 5



Division / Group Supervisor Operational Period Expectations



Your participation as a Division Group Supervisor is a key component of the success of Incident Management Team 5. While serving as a member of this team we expect you to meet the following expectations.

- Provide Leadership and Supervision
- Implement and think safety at all times
- Maintain situational awareness at all times
- Be Creative and look for solutions to problems
- Attend briefings
- Obtain a thorough briefing from a team member of the Operations Section
- Complete and turn in your ICS-215 information by 1400 each day
- Complete shift tickets for all hired equipment.
- Participate and debrief daily with the finance unit when in Cost Apportionment
- Debrief with the plans section after each operational period.
- Provide accountability for all line personnel
- If available provide GPS data to the Situation Unit by established deadlines.
- Monitor work progress
- Backhaul all trash and supplies
- Release resources as the job is completed.

IMT-5 FINANCE MESSAGE

EILER FIRE INCIDENT

CA-SHU-006933

ALL PERSONNEL

Don't wait! ...make sure to stop by the Time Unit and update or complete your eFC-33 and CTR's.

LOCAL GOVERNMENT RESOURCES

Check in with OES to start your F-42 Paperwork.

ALL HIRED EQUIPMENT

The "Shift Tickets" for hired equipment need to be signed and turned in to Equipment Time by **Line Supervisors**. *Also, make sure the evaluations are completed on the tickets.*

PROPERTY DAMAGE or INJURIES

Report any property damage caused by suppression activities and/or injuries to the COMP/CLAIMS Unit Leader.

WATER USAGE PLAN

Please review the incident "Water Management Plan" in the IAP. *When applicable, please complete the Water Usage Report and turn it into the Finance Section at the end of the day.*

COST APPORTIONMENT

Division Supervisors must check in with Cost Apportionment after each "Operational Period". Be prepared to verify assigned resources and to report work activities, which occurred during the work shift.

PERSONNEL ACCOMMODATIONS

All motel accommodations must be tracked and approved through the Motel Unit. *The Motel Unit is located in the Finance Section Area.*

STEVE HAWKS

FINANCE SECTION CHIEF

CAL FIRE

INCIDENT MANAGEMENT TEAM 5

WATER USAGE PLAN

California Drought Emergency

The following shall be considered and implemented by all fire resources as a means to provide maximum efficiencies when utilizing water resources, while minimizing the impacts to private and public water supplies. Accountability shall be maintained for all water supplies that are utilized and care should be applied to ensure proper replacement and/or reimbursement to the supplier/ owner.

Fireline personnel- (During mop up operations)

- Use of Pencil Hose and Garden Nozzles with Shut-Offs.
- Use of Back pumps.
- Dry Mop-up and consolidation of heavy fuels to areas where they can burn out safely
- Locate/ Relocate Firelines to lighter fuels or natural barriers when safe.
- Set up and use portable tanks in anticipation of longer transport times for Water Tenders.
- Use of foams, gels and other water enhancers.
- Evaluate need to mop up in excess of 200 feet from fireline

Road Maintenance and Repair-

- Monitor and water roads only when and where needed.
- Water when most effective (evening and nights).
- Use chemical treatments when available (Magchloride, Omni bind ect).
- Consider use of tertiary or treated water (sp)

Aviation Operations-

- Use of Gels, Foams and Retardants. Set up portable plants.
- Consider Blivits and Pencil hose for interior mop up operations as opposed to numerous bucket drops.
- Establish and use pre-use agreements for existing and known water sources.
- Use large watershed dip sites when able. Minimize use of small, static ponds and lakes.
- Maintain accountability of water used and locations of dip sites.
- Evaluate need for interior bucket drops

Private Water Supplies-

- Notify property owner as early as possible.
- Minimize usage and develop alternative water supplies when and where appropriate.
- Track usage (meter, 214 form) and develop a plan to replace water.
- Make arrangements for reimbursement and damage claims if needed.

Public/ Municipal Water Supplies-

- Notify Agency as soon as possible and request a representative to the incident.
- Identify fill areas and request metering devices. Place on incident map.
- Use alternative or reclaimed water sources when available. Place on incident map.
- Make arrangements for reimbursement and damage claims if needed.

Management and Supervision-

- Use leaders intent and establish Water Conservation as an Management Objective.
- Consider complexity of water use on incidents. Establish a Water Supply Group Supervisor to coordinate additional resources to support the incident needs.
- Complete the Water Usage Report daily and turn in to Finance
- Review this check list and brief daily.

Archaeological and Historic Properties: Fireline Guidance for the Eiler Incident, Shasta County, CA

Do not compromise safety for the protection and preservation of archaeological and historic properties. When possible and prudent:

1. Be on the lookout for prehistoric archaeological sites. These sites may include seasonal camps marked by the presence of obsidian and/or basalt flakes and village sites that also include dark midden soils and perhaps circular housepit depressions. The Native American groups living in the area at time of historic contact was the Achomawi in the northern fire area and Atsugewi in the south..
2. Be on the lookout for historic archaeological sites. These sites may include old homesteads now marked by the presence of foundations, wells, and can dumps, early sawmill sites, abandoned ditches, and stacked rock foundation remains.
3. Look for these prehistoric and historic sites in flat areas, especially adjacent to streams and springs.
4. Known sites will be marked with ribbons of solid red and solid white plastic flagging tape. Note that much of the area has never been surveyed for archaeological resources and many sites out there have yet to be discovered.
5. If you observe archaeological resources, flagged or unflagged, attempt to avoid with ground disturbing activities altogether.
6. If avoidance is not possible, minimize ground disturbance. Use a hand crew rather than a dozer to remove fuels from control lines that must cross site areas if possible.
7. Note locations of discovered artifacts, features, and/or sites on a map. Better yet take a GPS reading if possible. Leave information for the archaeologist with the Plans Unit so that the sites can be relocated and protected during Fire Suppression Repair.
8. If you find artifacts leave them in place. Some artifacts may have been intentionally placed for religious or ceremonial reasons.
9. If you encounter a burial or other human remains, cease work in the area and contact Division immediately. Division in turn should report the discovery to the archaeologist.

Your help preserving California's non-renewable cultural resources is appreciated.

Richard Jenkins
CAL FIRE Northern Region Archaeologist
Cell Phone: (530) 949-8822

Fire Suppression Repair

It is time to begin planning for the fire suppression repair efforts. A fire suppression repair plan will be developed for the SHU Bully Incident. To accomplish our goals we need to identify problem areas, prescribe the needed work, and ensure that the work is completed.

In an effort to identify problem areas we have created the attached form for use by the Branches and Divisions. As noted on the form, items to consider include: fences and gates damaged during the incident; road and watercourse crossings repairs; culverts and watercourses needing cleanout; fire breaks in need of waterbarring; trash and equipment pickup.

Use the attached form(s) to document locations where repair work may be necessary. Use maps to show locations. Return forms to the Suppression Repair Unit at the end of your shift.

Fire Suppression Repair Checklist

CA-SHU-006248-006933

Fire Name: Eiler, SHU 006933 Form Preparer _____

Division _____ Date Prepared _____

Work Needed

Location

(T./R./S.)

Fence/Gate Repair _____

Waterbars _____

Road Repair _____

Watercourse Cleanout _____

Culvert Cleanout and Repair _____

Seeding/Mulching Watercourse Crossing _____

Trash Pickup _____

Other _____

NOTE: List type of material/equipment/personnel needed (e.g., fencing materials, tools, dozer, backhoe, stakeside, handcrew, etc.)

TRAINING SPECIALIST MESSAGE

A Training Specialist is now on the incident.

All assigned trainees
working on position task books will need to
register with the Incident Training Specialist in
order to receive proper credit for your
assignment.

**The Training Specialist is available immediately
following the morning Operations Briefing to
1800.**

Cory Cisneros

Training Specialist

Cell-(909)224-1640

2 operator, 24 hour shift

EMERGENCY SHIFT TICKET and EVALUATION FORM					Contractor Name	
The responsible Government Officer will complete this form each shift					Fireline Builders	
Incident or Project Name	Incident Number	Request Number	Operator #1	Operator #2		
Wild	CALNU 123456	E-59	Jim Smith	John Jones		
Agreement Number <p style="text-align: center;">LNU01234567</p>			Operator Furnished By: <input checked="" type="checkbox"/> Contractor <input type="checkbox"/> Government			
Equipment Make <p style="text-align: center;">CAT</p>		Equipment Model / Type <p style="text-align: center;">Dozer D6H</p>		Operating Supplies Furnished By: <input checked="" type="checkbox"/> Contractor <input type="checkbox"/> Government		
Serial Number <p style="text-align: center;">6LN3344</p>		Licence Number		Equipment Status <input type="checkbox"/> Inspected <input checked="" type="checkbox"/> Under Agreement		
Equipment Use						
Date		(Circle) <u>Hours</u> Days / Miles		Released by Government		
Mo / Day	Start	Stop	Work	Assignment		
7/16	1300	1500	2	Travel In		
7/16	1500	2400	9	Division B		
7/17	0001	0800	8	Division B		
Vendor Rating				Govt. Rep. Name and Position - PRINT		
	Poor*	Avg.	Good	Exc.	N/A	
Vendor Rating must be done.				Mike Brown, Div B		
				Govt. Rep. Signature <i>Mike Brown</i>		
				Contractor Signature <i>Jim Smith</i>		
				Date 07/17/12		
				Time 0800		
Met Performance Expectations				Govt. Rep. Signature		
Equipment in Safe Working Condition				Contractor Signature		
Operator Skill Level				Date		
Operator Safety				Time		
Operator's Cooperation Level				07/17/12		
Overall Performance				0800		
* NOTE: Any rating of POOR requires an explanation in Comment Section. **Final evaluation or for more documentation, use an ICS Form 230 or equivalent.					CALFIRE 297 (Rev 3-2011)	

Pink - Finance Blue - Home Unit HE Coordinator Yellow - Vendor White - Govt Representative

Transport held on

EMERGENCY SHIFT TICKET and EVALUATION FORM					Contractor Name		
<small>The responsible Government Officer will complete this form each shift.</small>					Fireline Builders		
Incident or Project Name		Incident Number	Request Number		Operator #1	Operator #2	
Wild		CALNU 123456	E-60		Dave Clark	Doug Floyd	
Agreement Number					Operator Furnished By:		
LNU76543210					<input checked="" type="checkbox"/> Contractor	<input type="checkbox"/> Government	
Equipment Make		Equipment Model / Type			Operating Supplies Furnished By:		
Peterbilt		Transport			<input checked="" type="checkbox"/> Contractor	<input type="checkbox"/> Government	
Serial Number		Licence Number				Equipment Status	
S18934789		7C27948				<input type="checkbox"/> Inspected	<input checked="" type="checkbox"/> Under Agreement
Equipment Use							
Date	Start	Stop	Work	(Circle) Hours	Days / Miles	Assignment	
Mo / Day							
7/16	1300	1500	2			Travel In	
7/16	1500	2400	9			Division B	
7/17	0001	0800	8			Division B	
Vendor Rating							
	Poor*	Avg.	Good	Exo.	N/A		
Met Performance Expectations						Govt. Rep. Name and Position - PRINT	
Equipment In Safe Working Condition						Jeff Thompson	
Operator Skill Level						Govt. Rep. Signature	
Operates Safely						Jeff Thompson	
Operator's Cooperation Level						Contractor Signature	
Overall Performance						Doug Floyd	
						Date	
						Time	
						07/17/12	
						0800	

2 Operators
Hauled in dozer E-59. Transport
held on per OPS.

Vendor Rating
must be done.

* NOTE: Any rating of POOR requires an explanation in Comment Section.
 **Final evaluation or for more documentation, use an ICS Form 230 or equivalent.

Pink - Finance Blue - Home Unit HE Coordinator Yellow - Vendor White - Govt Representative

EMERGENCY SHIFT TICKET and EVALUATION FORM					Contractor Name		
The responsible Government Officer will complete this form each shift					Water Haulers		
Incident or Project Name		Incident Number		Request Number		Operator #1	Operator #2
Wild		CALNU 123456		E-64		Sean Rodgers	Wayne Rodgers
Agreement Number					Operator Furnished By:		
LNU22223333					<input checked="" type="checkbox"/> Contractor <input type="checkbox"/> Government		
Equipment Make			Equipment Model / Type		Operating Supplies Furnished By:		
Peterbilt			4000 Gallon		<input checked="" type="checkbox"/> Contractor <input type="checkbox"/> Government		
Serial Number			Licence Number		Equipment Status		
11343N			6A256483		<input type="checkbox"/> Inspected <input checked="" type="checkbox"/> Under Agreement <input checked="" type="checkbox"/> Released by Government <input type="checkbox"/> Withdrawn by Contractor		
Equipment Use					Remarks/Comments ** <div style="text-align: center; font-size: 1.2em; font-weight: bold;"> 2 Operators Released @ 1600 </div>		
Date	Mo / Day	Start	Stop	(Circle) Hours / Days / Miles			Assignment
7/18		0800	1600	8			Division B
7/18		1600	2000	2			Demob / Travel Out
Vendor Rating					Govt. Rep. Name and Position - PRINT		
					Matt Sullivan, HETS		
Met Performance Expectations					Govt. Rep. Signature		
Equipment in Safe Working Condition					<i>Matt Sullivan</i>		
Operator Skill Level					Contractor Signature		
Operates Safely					<i>Wayne Rodgers</i>		
Operator's Cooperation Level					Date		
Overall Performance					07/18/08 1800		
* NOTE: Any rating of POOR requires an explanation in Comment Section. **Final evaluation or for more documentation, use an ICS Form 230 or equivalent.					CALFIRE 287 (Rev 3-2011)		

Pink - Finance

Blue - Home Unit HE Coordinator

Yellow - Vendor

White - Govt Representative

Transport released

EMERGENCY SHIFT TICKET and EVALUATION FORM					Contractor Name		
The responsible Government Officer will complete this form each shift					Fireline Builders		
Incident or Project Name		Incident Number	Request Number		Operator #1	Operator #2	
Wild		CALNU 123456	E-60		Jim Smith	John Jones	
Agreement Number					Operator Furnished By:		
LNU76543210					<input checked="" type="checkbox"/> Contractor	<input type="checkbox"/> Government	
Equipment Make		Equipment Model / Type			Operating Supplies Furnished By:		
Peterbilt		Transport			<input checked="" type="checkbox"/> Contractor	<input type="checkbox"/> Government	
Serial Number		Licence Number				Equipment Status	
S18934789		7C27948				<input type="checkbox"/> Inspected	<input checked="" type="checkbox"/> Under Agreement
Equipment Use					<input checked="" type="checkbox"/> Released by Government		
(Circle) <u>Hours</u> Days / Miles					<input type="checkbox"/> Withdrawn by Contractor		
Date	Start	Stop	Work	Assignment			
Mo / Day							
7/16	1300	1500	2	Travel In			
7/16	1500	1700	2	Travel Out			
					Remarks/Comments **		
					2 Operators NA Hauled in dozer E-59 and was released.		
Vendor Rating					Govt. Rep. Name and Position - PRINT		
					Mike Brown, Div B		
Govt. Rep. Signature					Mike Brown		
Contractor Signature					Jim Smith		
Date					Time		
					07/16/12	1500	
* NOTE: Any rating of POOR requires an explanation in Comment Section.					CALFIRE 287		
**Final evaluation or for more documentation, use an ICS Form 230 or equivalent.					(Rev 3-2011)		

Pink - Finance

Blue - Home Unit HE Coordinator

Yellow - Vendor

White - Govt Representative

Safety
OES

- Operations

- Incident Command

- Comm/Dispatch

- Plans Meeting

- Liaison

- Copy Trailer

- Morning Briefing

- Kitchen Support

- Logs

- Handwash

- Medical

- Crew H2O Hill Station

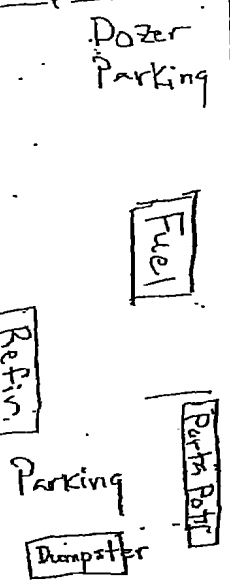

Porta Pott

PARKING LOT #2

Limited Vehicle Access

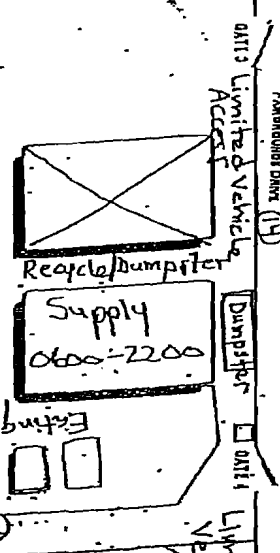

Ground Support

Kitchen

Supply
0600-2200

Recycle/Dumpster

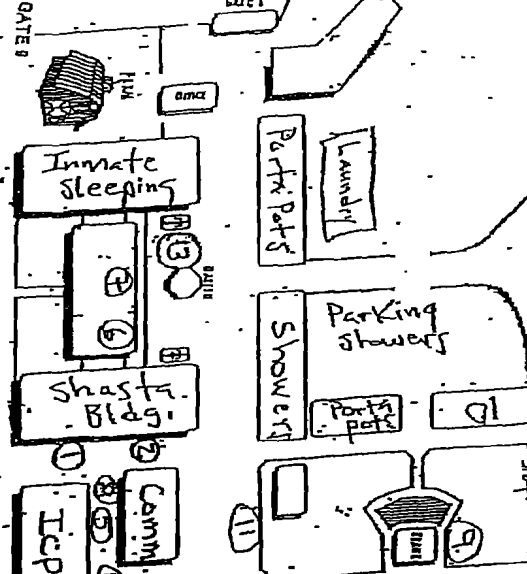

Inmate sleeping

Showers

Porta Pott

Laundry

Shower

Comm

ICP

Lighting

HM

Gate 8

Gate 9

Gate 10

Gate 11

Gate 12

Gate 13

Gate 14

Gate 15

Gate 16

Gate 17

Gate 18

Gate 19

Gate 20

Gate 21

Gate 22

Gate 23

Gate 24

Gate 25

Gate 26

Gate 27

Gate 28

Gate 29

Gate 30

Gate 31

Gate 32

Gate 33

Gate 34

Gate 35

Gate 36

Gate 37

Gate 38

Gate 39

Gate 40

Gate 41

Gate 42

Gate 43

Gate 44

Gate 45

Gate 46

Gate 47

Gate 48

Gate 49

Gate 50

Gate 51

Gate 52

Gate 53

Gate 54

Gate 55

Gate 56

Gate 57

Gate 58

Gate 59

Gate 60

Gate 61

Gate 62

Gate 63

Gate 64

Gate 65

Gate 66

Gate 67

Gate 68

Gate 69

Gate 70

Gate 71

Gate 72

Gate 73

Gate 74

Gate 75

Gate 76

Gate 77

Gate 78

Gate 79

Gate 80

Gate 81

Gate 82

Gate 83

Gate 84

Gate 85

Gate 86

Gate 87

Gate 88

Gate 89

Gate 90

Gate 91

Gate 92

Gate 93

Gate 94

Gate 95

Gate 96

Gate 97

Gate 98

Gate 99

Gate 100

Gate 101

Gate 102

Gate 103

Gate 104

Gate 105

Gate 106

Gate 107

Gate 108

Gate 109

Gate 110

Gate 111

Gate 112

Gate 113

Gate 114

Gate 115

Gate 116

Gate 117

Gate 118

Gate 119

Gate 120

Gate 121

Gate 122

Gate 123

Gate 124

Gate 125

Gate 126

Gate 127

Gate 128

Gate 129

Gate 130

Gate 131

Gate 132

Gate 133

Gate 134

Gate 135

Gate 136

Gate 137

Gate 138

Gate 139

Gate 140

Gate 141

Gate 142

Gate 143

Gate 144

Gate 145

Gate 146

Gate 147

Gate 148

Gate 149

Gate 150

Gate 151

Gate 152

Gate 153

Gate 154

Gate 155

Gate 156

Gate 157

Gate 158

Gate 159

Gate 160

Gate 161

Gate 162

Gate 163

Gate 164

Gate 165

Gate 166

Gate 167

Gate 168

Gate 169

Gate 170

Gate 171

Gate 172

Gate 173

Gate 174

Gate 175

Gate 176

Gate 177

Gate 178

Gate 179

Gate 180

Gate 181

Gate 182

Gate 183

Gate 184

Gate 185

Gate 186

Gate 187

Gate 188

Gate 189

Gate 190

Gate 191

Gate 192

Gate 193

Gate 194

Gate 195

Gate 196

Gate 197

Gate 198

Gate 199

Gate 200

Gate 201

Gate 202

Gate 203

Gate 204

Gate 205

Gate 206

Gate 207

Gate 208

Gate 209

Gate 210

Gate 211

Gate 212

Gate 213

Gate 214

Gate 215

Gate 216

Gate 217

Gate 218

Gate 219

Gate 220

Gate 221

Gate 222

Gate 223

Gate 224

Gate 225

Gate 226

Gate 227

Gate 228

Gate 229

Gate 230

Gate 231

Gate 232

Gate 233

Gate 234

Gate 235

Gate 236

Gate 237

Gate 238

Gate 239

Gate 240

Gate 241

Gate 242

Gate 243

Gate 244

Gate 245

Gate 246

Gate 247

Gate 248

Gate 249

Gate 250

Gate 251

Gate 252

Gate 253

Gate 254

Gate 255

Gate 256

Gate 257

Gate 258

Gate 259

Gate 260

Gate 261

Gate 262

Gate 263

Gate 264

Gate 265

Gate 266

Gate 267

Gate 268

Gate 269

Gate 270

Gate 271

Gate 272

Gate 273

Gate 274

Gate 275

Gate

