

**SCOTTS
INCIDENT**

CA-MEU-006376

IAP

***Master Corrected
Electronic Copy***

9/12 - 9/13/2012

0700-0700

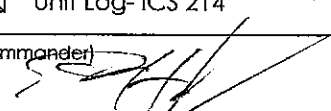
INCIDENT OBJECTIVES	1. Incident Name SCOTTS	2. Date 9-11-12	3. Time 2000
4. Operational Period September 12-13, 2012 0700-0700			
5. General Control Objectives for the Incident (Include alternatives) Management Objectives <ul style="list-style-type: none"> • Provide for Firefighter and Public Safety • Maintain positive communication and relationships with cooperating agencies and the public • Protect natural and cultural resources • Maintain effective cost management while meeting the needs of the incident • Provide for a safe and efficient demobilization Control Objectives <ul style="list-style-type: none"> • Keep fire within constructed lines 			
6. Weather Forecast for Period <ul style="list-style-type: none"> • Max temperature: 91-97° F • Min humidity: 4-17% • 20' WINDS: Valley – upslope up to 5 mph, becoming southeast up to 8 mph Ridges/Upper slopes: E up to 8 mph 			
7. General Safety Message <ul style="list-style-type: none"> • Continually monitor your personnel for signs and symptoms of dehydration; water to electrolyte enhanced drink is a 2 to 1 ratio. • Be cautious of rattlesnakes, hornets and wasps. • Be alert for fire weakened trees and snags. • Drive defensively. 			
8. Attachments (mark if attached)			
<input checked="" type="checkbox"/> Organization List - ICS 203 <input checked="" type="checkbox"/> Div. Assignment Lists - ICS 204 <input checked="" type="checkbox"/> Communications Plan - ICS 205 <input checked="" type="checkbox"/> Medical Plan - ICS 206	<input checked="" type="checkbox"/> Safety Message <input checked="" type="checkbox"/> Weather <input checked="" type="checkbox"/> Finance Message <input checked="" type="checkbox"/> Archaeology Message	<input checked="" type="checkbox"/> Fire Suppression Repair Guidelines <input checked="" type="checkbox"/> Shift Ticket Example <input checked="" type="checkbox"/> Travel Map <input checked="" type="checkbox"/> Unit Log- ICS 214	
9. Prepared by (Planning Section Chief) Pam Linstedt	10. Approved by (Incident Commander) Eric Hoffmann 		

ORGANIZATION ASSIGNMENT LIST IGS-203		1. INCIDENT NAME SCOTTS INCIDENT	2. DATE PREPARED 9/11/12	3. TIME PREPARED 1900
4. OPERATIONAL PERIOD (DATE/TIME)		9/12/12-9/13/12 0700-0700		
5. INCIDENT COMMANDER AND STAFF		9. OPERATIONS SECTION		
POSITION	NAME	DAY/NIGHT	DAVE RUSSELL/MARK KENDALL	
INCIDENT COMMANDER	ERIC HOFFMANN	DEPUTY DAY/NIGHT	JIM FERGUSON	
DEPUTY	MIKE HEBRARD			
SAFETY OFFICER	KEITH CALLISON 530-598-2612			
INFORMATION OFFICER	MIKE CARR	a. BRANCH I - DIVISIONS/GROUPS		
LIAISON OFFICER	SCOTT LINDGREN	BRANCH DIRECTOR	TONY BROWNELL (DAY)	
6. AGENCY REPRESENTATIVES			TOD PATTEN (NIGHT)	
AGENCY	NAME	DIVISION	Z	KEVIN ENGLER
CDC	ROY ULATAN 707-357-2447	DIVISION	A	MATT SISNEROS
MA	JOHN CLARY 925-381-5526	DIVISION	B/D	TY LABELLE
BLM	JEFF TUNNELL 707- 299-899 / GARY SHARPE	DIVISION		
CHP	SARGENT STARKE			
PG&E	SCOTT HOLMQUIST			
MENDOCINO CO. SHERIFF	SARGENT SCOTT			
LAKE CO. SHERIFF	CAPTAIN MACEDO / SARGENT STEVE BROOKS			
CCC	DUANE WILSON			
7. PLANNING SECTION		b. BRANCH II - DIVISIONS/GROUPS		
CHIEF	PAM LINSTEDT	BRANCH DIRECTOR		TOD PATTEN
DEPUTY	JON LOVIE			
RESOURCE UNIT	RALPH GLADWIN/ JAKE SJOLUND			
SITUATION UNIT	ERIC SCOVEL/MONTE SMITH(T)	DIVISION	M/P/Q	CHRIS PAULUS
DEMOBILIZATION UNIT	BROOK DARLEY	DIVISION	Y	GORDON DULCICH
DOCUMENTATION UNIT	REGINA SCRIVEN	DIVISION		
FIRE BEHAVIOR ANALYST	BILL BAXTER 209-601-1017	DIVISION		
HIRED EQUIP. TECH SPEC.	MATT SULLY			
COMPUTER TECH SPEC.	JOHN USREY			
CREW TECH SPEC.	KEVIN KEENE	FIRE SUPPRESSION REPAIR		LEN NIELSON
GIS TECHNICAL SPEC.	ELSA HUCKS			LUCAS TITUS (T)
GIS TECHNICAL SPEC.	ALBERT LAU			
TRAINING TECH SPEC.	JIM MOBLEY			
INCINET ADMINISTRATOR	ROY NAKAGAKI/MARK ROITZELL			
INCIDENT METEROROLOGIST	RYAN WALBRUN			
8. LOGISTICS SECTION		e. AIR OPERATIONS BRANCH		
CHIEF	KEN LOWE 530-448-2412	AIR OPERATIONS BR. DIR.	CHRIS AVINA	
DEPUTY	BREANNA BUCHANAN			
a. SUPPORT BRANCH		AIR TACTICAL SUPERVISOR		
SUPPLY UNIT	JIM VIERRA	AIR SUPPORT SUPERVISOR	MARK GRADEK	
FACILITIES UNIT	GARRETT RADOVICH	HELICOPTER COORDINATOR	WARREN PARISH	
GROUND SUPPORT UNIT	DAVE McKOY	AIR TANKER COORDINATOR		
ORDERING	KAREN VILLALOBOS			
b. SERVICE BRANCH		10. FINANCE/ADMINISTRATION SECTION		
CHIEF		CHIEF	VANCE MOULTON	
COMMUNICATIONS UNIT	KYLE JOHNSON	TIME UNIT	LESLIE MARG	
MEDICAL UNIT	FRED ORSBORN	PROCUREMENT UNIT	EVELYN GLENN	
FOOD UNIT	JESSE HANSCHILD	COMPENSATION/CLAIMS UNIT	JOE TAPIA	
MOTEL UNIT	RANDY FORD	COST UNIT	MARA ZAVER	

IGS 203

PREPARED BY (PLANS CHIEF) PAM LINSTEDT



Scotts Incident Weather Forecast



FORECAST NO: 2

NAME OF FIRE: Scotts

PREDICTION FOR: 0700-0700

UNIT: CA-MEU-006376

SHIFT DATE: 9/12-9/13/2012

SIGNED: Ryan Walbrun

TIME AND DATE

FORECAST ISSUED: 2000 9/11/2012

Incident Meteorologist

WEATHER DISCUSSION: No significant weather changes forecast today but much of northern California remains under a **critical fire weather pattern** with hot temperatures and low humidity. A thermal trough is over the coastal range which will keep winds from the east-southeast over the ridges this morning and through about 1 pm. By this afternoon ridge winds will turn west-southwest with some gusts 15-20 mph. Temperatures will remain above normal for mid September with daytime highs approaching 90 degrees while RH readings fall into the teens. Westerly winds will ease after sunset and then turn light easterly overnight. Temperatures will remain mild...in the 60s over the mid and upper slopes tonight with poor RH recovery...generally less than 30%. Reminder that fuels remain at or near record dry levels and the absence of night time humidity recovery will keep probability of ignition high for any potential spotting, roll out or new starts.

WEATHER FORECAST For Wednesday:

WEATHER: Sunny...continued hot and dry.

HIGH TEMPERATURES: Afternoon highs 86-92 degrees.

MIN HUMIDITY: Starting out around 35%...then lowering 12-19% in the afternoon.

20 FT WINDS:

RIDGETOP - Southeast 5 mph in the morning turning West 6-12 mph gusts 15-18 mph afternoon

SLOPE/VALLEY - Light and variable turning upslope 3-6 mph in the afternoon with gusts 8-10 mph.

STABILITY/INVERSION: Weak morning inversion over the fire will mix out by 10 am.

Forecast for Wednesday Night:

WEATHER: Clear and mild with poor RH recovery over most of the fire site.

MIN TEMPERATURES: 61-66 over most of the fire...upper 50s lowest drainages.

MAX HUMIDITY: Less than 25% through sunset then slowly recovering 35-40% by morning.

20 FT WINDS:

RIDGETOP - West 6-12 mph in the evening...turning East to Southeast 5 mph by morning.

SLOPE/VALLEY - Evening upslope 3-5 mph until sunset...then downslope 0-3 mph overnight.

STABILITY/INVERSION: Weak inversion setting up over the fire after sunset.

OUTLOOK FOR Thursday through Saturday: No significant weather changes forecast through the end of the week with high pressure over the region. If anything expect a few degrees of warming and drying each day. Winds will generally be light and from the East at night along the ridges...turning Westerly 5-10 mph in the afternoon. Afternoon highs mid 80s to lower 90s. Afternoon RH to around 15% with poor night time recovery only around 30-40% for a few hours each morning. Gentle cooling possible by Saturday.

SAFETY MESSAGE/PLAN

1. Incident Name: SCOTTS INCIDENT CA-MEU-006376	2. Operational Period: Date From:09/12/2012 Date To:09/13/2012 Time From: 0700 Time To: 0700	
3. Safety Message: <ul style="list-style-type: none">• Remember the incident's first Management Objective: Firefighter and public safety.• In order to have confidence in your Personal Protective Equipment, you need to be wearing it!• Preplan escape routes, providing enough time for firefighters to move to Safety Zones or Temporary Refuge Areas.• Maintain awareness of rattlesnakes, hornets and wasps.• Be cautious of fire weakened or partially burned trees.• Drive with your headlights on at all times, follow all speed limits and traffic laws.• Be aware of road hazards specifically plastic culverts burned out under the road.• Just as a reminder: Uphill traffic has the right away.• Always use a backer and chock your vehicles.• Prevent dehydration by drinking frequently throughout each working hour. Drink plenty of water with meals; continue replacing fluids while off shift. Plan ahead and don't allow water to run out before resupplying.• Pay close attention to the fatigue levels. Get rest and drink plenty of water!		
Lookout(s), Communication(s), Escape routes and Safety zone(s)		
5. Prepared by: Name: Felix Berbena SOFR1(T) Approved By Safety Officer: 		
ICS 208	IAP Page 5	Date/Time: 09/11/2012 1800 hours

INCIDENT ACTION PLAN SAFETY ANALYSIS										Incident Name		Operational Period Date / Time					
										SCOTTS		09/12/12- 09/13/12 0700-0700					
LCES* Analysis of Tactical Applications Lookouts Communications Escape routes Safety zones																	
Division/Group	Downhill Fireline	Underslung Fireline	Indirect Fireline	Midslope Fireline	Frontal Assault	Anchor Points	Extreme Conditions (Spotting, Wind-driven)	Unburned Area	Snags	Narrow Dusty Roads	LCES Mitigations	Transportation 1 HR +	Communications	Structure Protection	Multi-Aircraft	Culvert Damage	Other Risk Mitigations
BRN I											Look Outs, Escape Routes, Safety Zones						
Z	X	X	X				X	X			Stay informed of changes,	X			X	Check in & out of Division	
A	X	X	X				X	X		X	Situational Awareness, Communicate Hazards	X			X	Drive Defensively	
B/D	X	X	X				X	X		X						Identify and Mark	
BRN II																	
M/P/Q	X	X	X							X	Narrow steep road brief						
Y			X	X						X							
Supres. Repair										X							Brief on unfamiliar equipment
Prepared by (Name and Position)											Date and Time:						
Felix Berben SOFR1(T)											09/11/12 1900						

Felix M. Berben

DIVISION ASSIGNMENT LIST			1. Branch I	2. Division/Group Z	Latitude/ Longitude		
3. Incident Name SCOTTS			4. Operational Period Date: 9/12/12 – 9/13/12 Time: 0700-0700				
5. Operations Personnel							
Operations Chief	Dave Russell (Day) Mark Kendall (Night)		Branch		Tony Brownell (Day) Tod Patten (Night)		
Deputy	Jim Ferguson						
Safely Officer	Micheal Keegan/Pete Davis (T)		Division/Group Supervisor		Kevin Engler		
6. Resources Assigned this Period							
Strike Team/Task Force/ Resource Designator	Leader	Number Persons	Trans. Needed	Drop Off PT./Time	Pick Up PT./Time	On Line	Off Line
STC LNU 9148C	Mike Wink	18	N	DP-10/0800	DP-10/0800	<input type="checkbox"/>	<input type="checkbox"/>
STG LNU 9141G	Robin Bloom	33	N	↓	↓	<input type="checkbox"/>	<input type="checkbox"/>
STG TGU 9256G	Dan Chartier	32	N	↓	↓	<input type="checkbox"/>	<input type="checkbox"/>
EXC PVT E-217 Oferrall	Travis Oferrall	1	N	↓	↓	<input type="checkbox"/>	<input type="checkbox"/>
						<input type="checkbox"/>	<input type="checkbox"/>
						<input type="checkbox"/>	<input type="checkbox"/>
						<input type="checkbox"/>	<input type="checkbox"/>
						<input type="checkbox"/>	<input type="checkbox"/>
						<input type="checkbox"/>	<input type="checkbox"/>
						<input type="checkbox"/>	<input type="checkbox"/>
						<input type="checkbox"/>	<input type="checkbox"/>
						<input type="checkbox"/>	<input type="checkbox"/>
						<input type="checkbox"/>	<input type="checkbox"/>
						<input type="checkbox"/>	<input type="checkbox"/>
						<input type="checkbox"/>	<input type="checkbox"/>
7. Control Operations Hold existing line. Mop up 500 feet and patrol.							
8. Special Instructions Bold resources are on 12 hour shifts. Backhaul garbage to drop points. Maintain positive contact with public and local residents. FOBS will be working in all branches. Utilize back-pumps where appropriate for mop up. Break apart and mop up dozer piles. Evaluate and identify hoselays for removal.							
9. Division/Group Communication Summary							
Function	Frequency	System	Channel	Function	Frequency	System	Channel
Command	CDF COMMAND 2 TONE 1,7,12,16	King NIFC	151.2650 Rx 159.3300 Tx	Logistics		King NIFC	
Tactical Div/Group	VFIRE 26	King NIFC	154.3025 Rx 154.3025 Tx	Air to Ground	CDF TAC 14	King NIFC	159.2250 Rx 159.2250 Tx
Prepared by (Resource Unit Ldr.) Ralph Gladwin			Approved by (Planning Sect. Ch.) Jon Lovie		Date 9/11/12	Time 1900	

DIVISION ASSIGNMENT LIST			1. Branch I	2. Division/Group A	Latitude/ Longitude		
3. Incident Name SCOTTS			4. Operational Period Date: 9/12/12 – 9/13/12 Time: 0700-0700				
5. Operations Personnel							
Operations Chief	Dave Russell (Day) Mark Kendall (Night)			Branch	Tony Brownell (Day) Tod Patten (Night)		
Deputy	Jim Ferguson						
Safety Officer	Michael Keegan/Pete Davis (T)			Division/Group Supervisor	Matt Sisneros		
6. Resources Assigned this Period							
Strike Team/Task Force/ Resource Designator	Leader	Number Persons	Trans. Needed	Drop Off PT./Time	Pick Up PT./Time	On Line	Off Line
STC SLU 9340C	Phil Veneris	16	N	DP-1/0800	DP-1/0800	<input type="checkbox"/>	<input type="checkbox"/>
STC OES2 2870C	Jim Martin	22	N			<input type="checkbox"/>	<input type="checkbox"/>
STG LMU 9220G	Dennis Nolan	38	N			<input type="checkbox"/>	<input type="checkbox"/>
STG HUU 9121G	Robert Murias	33	N			<input type="checkbox"/>	<input type="checkbox"/>
STG HUU 9122G	Kurt McCray	32	N			<input type="checkbox"/>	<input type="checkbox"/>
STG HUU 9126G	John Lentz	30	N			<input type="checkbox"/>	<input type="checkbox"/>
CRW MRN Tamalpais	Timothy Walsh	13	N			<input type="checkbox"/>	<input type="checkbox"/>
DOZ TGU 2542	Kevin Oliver	3	N			<input type="checkbox"/>	<input type="checkbox"/>
WT PVT E-38 Rosco	Ross Mayfield	2	N			<input type="checkbox"/>	<input type="checkbox"/>
WT PVT E-107 Wildfire	Ryan Braun	1	N			<input type="checkbox"/>	<input type="checkbox"/>
WT PVT E-151 Stuart	Mark Stuart	1	N			<input type="checkbox"/>	<input type="checkbox"/>
WT PVT E-152 Algerine	Greg Riedel	1	N			<input type="checkbox"/>	<input type="checkbox"/>
EXC PVT E-216 Giacomini	Grant Yates	1	N			<input type="checkbox"/>	<input type="checkbox"/>
7. Control Operations Hold existing line. Mop up 500 feet and patrol.							
8. Special Instructions Bold resources are on 12 hour shifts. Backhaul garbage to drop points. Maintain positive contact with public and local residents. FOBS will be working in all branches. Utilize back-pumps where appropriate for mop up. Break apart and mop up dozer piles. Evaluate and identify hoselays for removal.							
9. Division/Group Communication Summary							
Function	Frequency	System	Channel	Function	Frequency	System	Channel
Command	CDF COMMAND 2 TONES 1, 7, 12, 16	King NIFC	151.2650 Rx 159.3300 Tx	Logistics		King NIFC	
Tactical Div/Group	CDF TAC 1	King NIFC	151.1450 Rx 151.1450 Tx	Air to Ground	CDF TAC 14	King NIFC	159.2250 Rx 159.2250 Tx
Prepared by (Resource Unit Ldr.) Ralph Gladwin		Approved by (Planning Sect. Ch.) Jon Lovie			Date 9/11/12		Time 1900

DIVISION ASSIGNMENT LIST			1. Branch I	2. Division/Group A	Latitude/ Longitude		
3. Incident Name SCOTTS			4. Operational Period Date: 9/12/12 - 9/13/12 Time: 0700-0700				
5. Operations Personnel							
Operations Chief	Dave Russell (Day) Mark Kendall (Night)			Branch	Tony Brownell (Day) Tod Patten (Night)		
Deputy	Jim Ferguson						
Safety Officer	Micheal Keegan/Pete Davis (T)			Division/Group Supervisor	Matt Sisnerors		
6. Resources Assigned this Period							
Strike Team/Task Force/ Resource Designator	Leader	Number Persons	Trans. Needed	Drop Off PT./Time	Pick Up PT./Time	On Line	Off Line
AMB North Shore	Pat Brown	1	N	DP-1/0800	DP-1/0800	<input type="checkbox"/>	<input type="checkbox"/>
FEMT (Day)	Robert Karnow	1	N	↓	↓	<input type="checkbox"/>	<input type="checkbox"/>
						<input type="checkbox"/>	<input type="checkbox"/>
						<input type="checkbox"/>	<input type="checkbox"/>
						<input type="checkbox"/>	<input type="checkbox"/>
						<input type="checkbox"/>	<input type="checkbox"/>
						<input type="checkbox"/>	<input type="checkbox"/>
						<input type="checkbox"/>	<input type="checkbox"/>
						<input type="checkbox"/>	<input type="checkbox"/>
						<input type="checkbox"/>	<input type="checkbox"/>
						<input type="checkbox"/>	<input type="checkbox"/>
						<input type="checkbox"/>	<input type="checkbox"/>
						<input type="checkbox"/>	<input type="checkbox"/>
7. Control Operations Hold existing line. Mop up 500 feet and patrol.							
8. Special Instructions Bold resources are on 12 hour shifts. Backhaul garbage to drop points. Maintain positive contact with public and local residents. FOBS will be working in all branches. Utilize back-pumps where appropriate for mop up. Break apart and mop up dozer piles. Evaluate and identify hoselays for removal.							
9. Division/Group Communication Summary							
Function	Frequency	System	Channel	Function	Frequency	System	Channel
Command	CDF COMMAND 2 TONES 1, 7, 12, 16	King NIFC	151.2650 Rx 159.3300 Tx	Logistics		King NIFC	
Tactical Div/Group	CDF TAC 1	King NIFC	151.1450 Rx 151.1450 Tx	Air to Ground	CDF TAC 14	King NIFC	159.2250 Rx 159.2250 Tx
Prepared by (Resource Unit Ldr.) Ralph Gladwin		Approved by (Planning Sect. Ch.) Jon Lovie			Date 9/11/12	Time 1900	

DIVISION ASSIGNMENT LIST		1. Branch I	2. Division/Group B/D	Latitude/ Longitude			
3. Incident Name SCOTTS		4. Operational Period Date: 9/12/12 - 9/13/12 Time: 0700-0700					
5. Operations Personnel							
Operations Chief	Dave Russell (Day) Mark Kendall (Night)		Branch		Tony Brownell (Day) Tod Patten (Night)		
Deputy	Jim Ferguson						
Safety Officer	Micheal Keegan/Pete Davis (T)		Division/Group Supervisor		Ty Labelle		
6. Resources Assigned this Period							
Strike Team/Task Force/ Resource Designator	Leader	Number Persons	Trans. Needed	Drop Off PT./Time	Pick Up PT./Time	On Line	Off Line
STC AEU 9270C	Michael Webb	16	N	DP-2/0800	DP-2/0800	<input type="checkbox"/>	<input type="checkbox"/>
STC XSA 4161C	Dennis Wycoff	22	N			<input type="checkbox"/>	<input type="checkbox"/>
STG NEU 9231G	Dave Hurd	32	N			<input type="checkbox"/>	<input type="checkbox"/>
CRW LNU Konocti 4	Richard Lawler	16	N			<input type="checkbox"/>	<input type="checkbox"/>
CRW LNU Konocti 5	Kevin Ryan	15	N			<input type="checkbox"/>	<input type="checkbox"/>
DOZ PVT E-57 Tehama	Toby Adams	2	N			<input type="checkbox"/>	<input type="checkbox"/>
WT PVT E-17 Orsi	Tony Orsi	2	N			<input type="checkbox"/>	<input type="checkbox"/>
WT PVT E-101 Alans	Alan Wharff	2	N			<input type="checkbox"/>	<input type="checkbox"/>
WT PVT E-102 All Star	Greg Sandling	2	N			<input type="checkbox"/>	<input type="checkbox"/>
WT PVT E-105 Marymee	Jack Marymee	2	N			<input type="checkbox"/>	<input type="checkbox"/>
						<input type="checkbox"/>	<input type="checkbox"/>
						<input type="checkbox"/>	<input type="checkbox"/>
						<input type="checkbox"/>	<input type="checkbox"/>
						<input type="checkbox"/>	<input type="checkbox"/>
7. Control Operations Hold existing line. Mop up 500 feet and patrol.							
8. Special Instructions Bold resources are on 12 hour shifts. Backhaul garbage to drop points. Maintain positive contact with public and local residents. FOBS will be working in all branches. Utilize back-pumps where appropriate for mop up. Break apart and mop up dozer piles. Evaluate and identify hoselays for removal.							
9. Division/Group Communication Summary							
Function	Frequency	System	Channel	Function	Frequency	System	Channel
Command	CDF COMMAND 2 TONES 1, 7,12,16	King NIFC	151.2650 Rx 159.3300 Tx	Logistics		King NIFC	
Tactical Div/Group	VFIRE 24	King NIFC	154.2725 Rx 154.2725 Tx	Air to Ground	CDF TAC 14	King NIFC	159.2250 Rx 159.2250 Tx
Prepared by (Resource Unit Ldr.) Ralph Gladwin		Approved by (Planning Sect. Ch.) Jon Lovie			Date 9/11/12		Time 1900

DIVISION ASSIGNMENT LIST		1. Branch II	2. Division/Group M/P/Q	Latitude/ Longitude			
3. Incident Name SCOTTS		4. Operational Period Date: 9/12/12 - 9/13/12				Time: 0700-0700	
5. Operations Personnel							
Operations Chief	Dave Russell (Day) Mark Kendall (Night)		Branch	Tod Patten			
Deputy	Jim Ferguson						
Safety Officer	Alan Sherer/Jeff Martin (T)		Division/Group Supervisor	Chris Paulus			
6. Resources Assigned this Period							
Strike Team/Task Force/ Resource Designator	Leader	Number Persons	Trans. Needed	Drop Off PT./Time	Pick Up PT./Time	On Line	Off Line
STC SKU 9260C	Darryl Laws	18	N	DP-4,DP-7/0800	DP-4,DP-7/0800	<input type="checkbox"/>	<input type="checkbox"/>
STC BEU 9461C	Matt Johnson	16	N			<input type="checkbox"/>	<input type="checkbox"/>
STG AEU 9273G	Robert Neal	34	N			<input type="checkbox"/>	<input type="checkbox"/>
WT PVT E-104 Tehama	Al Torres	2	N			<input type="checkbox"/>	<input type="checkbox"/>
WT PVT E-106 Gamma	Mark Williams	2	N			<input type="checkbox"/>	<input type="checkbox"/>
WT PVT E-172 All Agency	John Hill	2	N			<input type="checkbox"/>	<input type="checkbox"/>
						<input type="checkbox"/>	<input type="checkbox"/>
						<input type="checkbox"/>	<input type="checkbox"/>
						<input type="checkbox"/>	<input type="checkbox"/>
						<input type="checkbox"/>	<input type="checkbox"/>
						<input type="checkbox"/>	<input type="checkbox"/>
						<input type="checkbox"/>	<input type="checkbox"/>
						<input type="checkbox"/>	<input type="checkbox"/>
7. Control Operations Hold existing line. Mop up 500 feet and patrol.							
8. Special Instructions Bold resources are on 12 hour shifts. Backhaul garbage to drop points. Maintain positive contact with public and local residents. FOBS will be working in all branches. Utilize back-pumps where appropriate for mop up. Break apart and mop up dozer piles. Evaluate and identify hoselays for removal.							
9. Division/Group Communication Summary							
Function	Frequency	System	Channel	Function	Frequency	System	Channel
Command	CDF COMMAND 2 TONE 1,7,12,16	King NIFC	151.2650 Rx 159.3300 Tx	Logistics		King NIFC	
Tactical Div/Group	VFIRE 25	King NIFC	154.2875 Rx 154.2875 Tx	Air to Ground	CDF TAC 14	King NIFC	159.2250 Rx 159.2250 Tx
Prepared by (Resource Unit Ldr.) Ralph Gladwin			Approved by (Planning Sect. Ch.) Jon Lovie		Date 9/11/12		Time 1900

DIVISION ASSIGNMENT LIST		1. Branch II	2. Division/Group Y	Latitude/ Longitude			
3. Incident Name SCOTTS		4. Operational Period Date: 9/12/12 – 9/13/12 Time: 0700-0700					
5. Operations Personnel							
Operations Chief	Dave Russell (Day) Mark Kendall (Night)		Branch	Tod Patten			
Deputy	Jim Ferguson						
Safety Officer	Alan Sherer/Jeff Martin (T)		Division/Group Supervisor	Gordon Dulcich			
6. Resources Assigned this Period							
Strike Team/Task Force/ Resource Designator	Leader	Number Persons	Trans. Needed	Drop Off PT./Time	Pick Up PT./Time	On Line	Off Line
STC BEU 9460C	Brian Nichols	17	N	DP-7/0800	DP-7/0800	<input type="checkbox"/>	<input type="checkbox"/>
STG LAC 1171G	Ernest Valera	32	N	↓	↓	<input type="checkbox"/>	<input type="checkbox"/>
STL SKU 9262L	Kurt Ohlau	5	N			<input type="checkbox"/>	<input type="checkbox"/>
WT PVT E-171 All Agency	Doug Hill	2	N			<input type="checkbox"/>	<input type="checkbox"/>
WT PVT E-98 49er	Bob Mergl	2	N			<input type="checkbox"/>	<input type="checkbox"/>
EXC PVT E-218 Simpson	Steve Perez	1	N	↓	↓	<input type="checkbox"/>	<input type="checkbox"/>
						<input type="checkbox"/>	<input type="checkbox"/>
						<input type="checkbox"/>	<input type="checkbox"/>
						<input type="checkbox"/>	<input type="checkbox"/>
						<input type="checkbox"/>	<input type="checkbox"/>
						<input type="checkbox"/>	<input type="checkbox"/>
						<input type="checkbox"/>	<input type="checkbox"/>
7. Control Operations Hold existing line. Mop up 500 feet and patrol.							
8. Special Instructions Bold resources are on 12 hour shifts. Backhaul garbage to drop points. Maintain positive contact with public and local residents. FOBS will be working in all branches. Utilize back-pumps where appropriate for mop up. Break apart and mop up dozer piles. Evaluate and identify hoselays for removal.							
9. Division/Group Communication Summary							
Function	Frequency	System	Channel	Function	Frequency	System	Channel
Command	CDF COMMAND 2 TONE 1,7,12,16	King NIFC	151.2650 Rx 159.3300 Tx	Logistics		King NIFC	
Tactical Div/Group	CDF TAC 20	King NIFC	159.3750 Rx 159.3750 Tx	Air to Ground	CDF TAC 14	King NIFC	159.2250 Rx 159.2250 Tx
Prepared by (Resource Unit Ldr.) Ralph Gladwin			Approved by (Planning Sect. Ch.) Jon Lovie		Date 9/11/12		Time 1900

DIVISION ASSIGNMENT LIST			1. Branch	2. Division/Group Suppression Repair	Latitude/ Longitude		
3. Incident Name SCOTTS			4. Operational Period Date: 9/12/12 – 9/13/12 Time: 0700-0700				
5. Operations Personnel							
Operations Chief	Dave Russell (Day) Mark Kendall (Night)			Branch			
Deputy	Jim Ferguson						
Safety Officer	Alan Sherer/ Jeff Martin (T)			Division/Group Supervisor		Len Nielson/Lucas Titus (T)	
6. Resources Assigned this Period							
Strike Team/Task Force/ Resource Designator	Leader	Number Persons	Trans. Needed	Drop Off PT./Time	Pick Up PT./Time	On Line	Off Line
DOZ PVT E-22 Redwood	Mel Ford	2	N	TBA/0800	TBA/2000	<input type="checkbox"/>	<input type="checkbox"/>
DOZ PVT E-25 Ingram	Bruce Ingram	1	N			<input type="checkbox"/>	<input type="checkbox"/>
DOZ PVT E-54 Wylatti	Brian Hurt	2	N			<input type="checkbox"/>	<input type="checkbox"/>
DOZ PVT E-55 Fireline	Dan LaRue	2	N			<input type="checkbox"/>	<input type="checkbox"/>
DOZ PVT E-58 Milsaps	Mike Milsaps	2	N			<input type="checkbox"/>	<input type="checkbox"/>
WT PVT E-16 Floodgate	Butch Paula	2	N			<input type="checkbox"/>	<input type="checkbox"/>
WT PVT E-96 Beebe	Don Hunt	1	N			<input type="checkbox"/>	<input type="checkbox"/>
WT PVT E-97 49er	Dick Sasser	2	N			<input type="checkbox"/>	<input type="checkbox"/>
WT PVT E-99 49er	Jess Sander	2	N			<input type="checkbox"/>	<input type="checkbox"/>
WT PVT E-100 Big R	Richard Garrett	2	N			<input type="checkbox"/>	<input type="checkbox"/>
WT PVT E-153 T&S	Bob Fordy	3	N			<input type="checkbox"/>	<input type="checkbox"/>
WT PVT E-154 Lenahans	Dee Holmes	2	N			<input type="checkbox"/>	<input type="checkbox"/>
7. Control Operations Repair damage caused by suppression activities and mitigate possible adverse effects.							
8. Special Instructions Notify Division Supervisor when entering and leaving Divisions. Backhaul garbage to drop points. Maintain positive contact with public and local residents. FOBS will be working in all branches.							
9. Division/Group Communication Summary							
Function	Frequency	System	Channel	Function	Frequency	System	Channel
Command	CDF COMMAND 2 TONES 1, 7, 12, 16	King NIFC	151.2650 Rx 159.3300 Tx	Logistics		King NIFC	
Tactical Div/Group	VTAC 14	King NIFC	159.4725 Rx 159.4725 Tx	Air to Ground	CDF TAC 14	King NIFC	159.2250 Rx 159.2250 Tx
Prepared by (Resource Unit Ldr.) Ralph Gladwin		Approved by (Planning Sect. Ch.) Jon Lovie			Date 9/11/2012	Time 1900	

DIVISION ASSIGNMENT LIST			1. Branch	2. Division/Group Suppression Repair	Latitude/ Longitude		
3. Incident Name SCOTTS			4. Operational Period Date: 9/12/12 – 9/13/12 Time: 0700-0700				
5. Operations Personnel							
Operations Chief	Dave Russell (Day) Mark Kendall (Night)			Branch			
Deputy	Jim Ferguson						
Safety Officer	Alan Sherer/ Jeff Martin (T)			Division/Group Supervisor		Len Nielson/Lucas Titus (T)	
6. Resources Assigned this Period							
Strike Team/Task Force/ Resource Designator	Leader	Number Persons	Trans. Needed	Drop Off PT./Time	Pick Up PT./Time	On Line	Off Line
WT PVT E-161 Lenahans	Chuck Hughes	2	N	TBA/0800	TBA/2000	<input type="checkbox"/>	<input type="checkbox"/>
GRD PVT E-169 Lemuel	Logan Pearson	1	N			<input type="checkbox"/>	<input type="checkbox"/>
GRD PVT E-227 Parmeter	Wes Parmeter	1	N			<input type="checkbox"/>	<input type="checkbox"/>
EXC PVT E-218 Simpson	Steve Perez	1	N			<input type="checkbox"/>	<input type="checkbox"/>
DOZB	Jason Bondshu	1	N			<input type="checkbox"/>	<input type="checkbox"/>
DOZB	Natthan Baxter (T)	1	N			<input type="checkbox"/>	<input type="checkbox"/>
DOZB	Angelo Prandini	1	N			<input type="checkbox"/>	<input type="checkbox"/>
DOZB	Darren Beaty	1	N			<input type="checkbox"/>	<input type="checkbox"/>
FSRS	Nathan Opie	1	N			<input type="checkbox"/>	<input type="checkbox"/>
FSRS	Justin Peterson	1	N			<input type="checkbox"/>	<input type="checkbox"/>
FSRS	Brian Wilson	1	N			<input type="checkbox"/>	<input type="checkbox"/>
FSRS	Alison Hesterly	1	N			<input type="checkbox"/>	<input type="checkbox"/>
7. Control Operations Repair damage caused by suppression activities and mitigate possible adverse effects.							
8. Special Instructions Notify Division Supervisor when entering and leaving Divisions. Backhaul garbage to drop points. Maintain positive contact with public and local residents. FOBS will be working in all branches.							
9. Division/Group Communication Summary							
Function	Frequency	System	Channel	Function	Frequency	System	Channel
Command	CDF COMMAND 2 TONES 1, 7,12,16	King NIFC	151.2650 Rx 159.3300 Tx	Logistics		King NIFC	
Tactical Div/Group	VTAC 14	King NIFC	159.4725 Rx 159.4725 Tx	Air to Ground	CDF TAC 14	King NIFC	159.2250 Rx 159.2250 Tx
Prepared by (Resource Unit Ldr.) Ralph Gladwin		Approved by (Planning Sect. Ch.) Jon Lovie			Date 9/11/2012		Time 1900

AIR OPERATIONS SUMMARY

(Expanded Form for Large Operations)

OPERATIONAL PERIOD DATE: DAY SHIFT DATE: 09/12/2012

START: 0830 END: 1856

1. INCIDENT NAME: Scotts	2. PREPARED BY: C. Avina	3. PREPARED DATE/TIME: 09/11/2012 1800 Hrs
4. REMARKS (Safety Notes, Hazards, Air Operations Special Equipment, etc.): SUNRISE: 0653 SUNSET : 1926 **Avoid aerial application of retardant or foam within 300' of waterways, bodies of water. If retardant is dropped within these areas, notify AOB/D with Lat & Long, est. of gallons, and a map. Lampson Field closed to General Aviation. Hazards: Towers at ridge top on the South end of fire. Power line west of Blue Lakes *LAMPSON FIELD IS OPEN TO ALL GENERAL AVIATION AT 0800*		

6. PERSONNEL	Phone	7. FREQUENCIES	AM	FM	8. FIXED-WING # Avail / Type/Make-Model / FAA N# / Base(s)
AOBD: Garrett Sjlound (T)	916 747-3119	AIR/AIR FW:	119.4250	167.1500	Air Tactical
AOBD: Chris Avina	916 261-2942	AIR/AIR RW:	119.4250		Lead planes
HLCO: Burrough, Aaron	916-949-9868	AIR/GROUND:		159.2250CDF Tac 14/ Tn 16	Airtankers
ASGS: Gradek, Mark	707-696-3579	DECK:	163.100		Other : Scott Helibase 4581 Highland Springs
HEBM: Bradshaw Greg	949-887-2841	COMMAND RPT	Command 2/ Tone 7		38 59.323 122 53.687
HEMB		Air Guard	168.625		
		TOLC	Unicom 122.8		

9. HELICOPTERS (Use Additional Sheets As Necessary)

FAA N#	TY	MAKE/MODL	BASE	AVAIL	START	REMARKS	FAA N#	TY	MAKE/MODL	BASE	AVAIL	START	REMARKS
901	2	Super Huey	Scotts	0800	0830	Medivac/Short Haul							
205SJ	2	Huey	Scotts	0800	0830								
209PJ	2	Huey	Scotts	0800	0830								
915G	3	Jet Ranger	Scotts	0800	0830								

INCIDENT RADIO COMMUNICATIONS PLAN

INCIDENT RADIO COMMUNICATIONS PLAN		Incident Name		SCOTTS		Date/Time Prepared		9/11/2012 1630		Operational Period Date/Time		9/12/12 - 9/13/12 0700 - 0700	
Ch #	Function	Channel Name/Trunked Radio System Talkgroup	Assignment	RX Freq	N or W	RX Tone/NAC	TX Freq	N or W	Tx Tone/NAC	Mode	A, D or M	Remarks	
1	Command	CDF C2	All Branches	151.2650	N	103.5 (8)	159.3300	N	110.9 (1)	A		Tone 1	
2	Command	CDF C2	All Branches	151.2650	N	103.5 (8)	159.3300	N	167.9 (7)	A		Tone 7	
3	Command	CDF C2	All Branches	151.2650	N	103.5 (8)	159.3300	N	192.8 (16)	A		Tone 16	
4	Command	CDF C2	All Branches	151.2650	N	103.5 (8)	159.3300	N	127.3 (12)	A		Tone 12	
5	Alt. Command	NIFC C4	All Branches	166.6125	N		168.4000	N	107.2 (10)	A			
6	Tactical	VFIRE 26	Branch I Div Z	154.3025	N		154.3025	N	156.7 (6)	A			
7	Tactical	CDF Tac 1	Branch I Div A	151.1450	N	192.8 (16)	151.1450	N	192.8 (16)	A			
8													
9	Tactical	VFIRE 24	Branch I Div B/D	154.2725	N		154.2725	N	156.7 (6)	A			
10	Tactical	VTAC 14	All Branches	159.4725	N		159.4725	N	156.7 (6)	A		Fire Suppression Repair	
11													
12	Tactical	VFIRE 25	Branch II Div M/P/Q	154.2875	N		154.2875	N	156.7 (6)	A			
13	Tactical	CDF Tac 20	Branch II Div Y	159.3750	N	192.8 (16)	159.3750	N	192.8 (16)	A			
14	Air to Ground	CDF Tac 14	All Branches	159.2250	N	192.8 (16)	159.2250	N	192.8 (16)				
15	EMS	CALCORD	All Branches	156.0750	N		156.0750	N		A		EMS on Incident	
16	Emergency	Air Guard	All Branches	168.6250	N		168.6250	N	110.9 (1)	A		EMERGENCIES ONLY	
17													
18													
19													
20	Emergency	Air Guard	All Branches	168.6250	N		168.6250	N	110.9 (1)	A		EMERGENCIES ONLY	

Prepared By (Communications Unit) *Wade Johnson COM*

Incident Location
 County Lake State CA Latitude N Longitude W

The convention calls for frequency lists to show four digits after the decimal place, followed by either an "N" or a "W", depending on whether the frequency is narrow or wide band. Mode refers to either "A" or "D" indicating analog or digital (e.g. Project 25) or "M" indicating mixed mode. All channels are shown as if programmed in a control station, mobile or portable radio. Repeater and base stations must be programmed with the Rx and Tx reversed.

MEDICAL PLAN ICS 206	1. INCIDENT NAME SCOTTS FIRE	2. DATE PREPARED 9/11/2012	3. TIME PREPARED 1900	4. OPERATIONAL PERIOD 9/12/2012 – 9/13/2012 0700-0700
---------------------------------------	--	-------------------------------	--------------------------	---

5. INCIDENT MEDICAL AID STATIONS

MEDICAL AID STATIONS	LOCATION	Nurse	
		YES	NO
MERT	Incident Base Camp	X	

6. TRANSPORTATION

A. AMBULANCE SERVICES

NAME	LOCATION	PHONE	PARAMEDICS	
			YES	NO
CAL STAR (AIR)	Ukiah	800-252-5050	X	
Reach (AIR)	Lakeport	800-338-4045	X	
Lakeport Fire Dept.	Lakeport	707-263-4396	X	
Kelseyville Ambulance	Kelseyville	707-279-4268	X	

B. INCIDENT AMBULANCES

NAME	LOCATION	PARAMEDICS	
		YES	NO
Medic 8011	DP-1	X	
Medic 5514	DP-7 /Kelly Camp Ground	X	

7. HOSPITALS

NAME Med Net Channel	ADDRESS	TRAVEL TIME		PHONE	HELIPAD		BURN CENTER	
		AIR	GRND		YES	NO	YES	NO
Sutter Lakeside Hospital	5176 Hill Rd. East Lakeport	2	15	707-262-5000	X			
Santa Rosa Memorial	1165 Montgomery Drive	20	90	707-546-3210	X			
UC Davis Med Center	2315 Stockton Blvd. Sacramento	25	150	916-734-2011	X		X	
St.Helena Clearlake	15630 18 th Avenue Clearlake,CA	15	35	707-994-6486	X			

8. MEDICAL EMERGENCY PROCEDURES

EMERGENCY FREQUENCY: CALCORD

LINE EMERGENCY:
Crew Supervisor will contact Division Supervisor with patient complaint/condition and location.

- Division/Group Supervisor contacts:
 - Closest EMS resource
 - Communications Unit
- Communications Unit contacts:
 - Ground or Air ambulance as requested
 - Operations
 - Safety
 - Medical Unit
- Division Supervisor or designee will serve as point of contact and run medical emergency on assigned channel.
 - A pre-assigned tactical frequency (i.e. CALCORD) should be used for IWI and only for duration of need.
- Communications Unit will clear command channel for emergency traffic as needed and only for duration of need.

CAMP EMERGENCY:
Contact Medical Unit with patient complaint/condition and location. Medical Staff will respond to stabilize incident:

- Medical Unit contacts:
 - Communications
 - Safety
 - Logistics
 - Operations
 - Crew Supervisor
 - Comps/Claims

INJURY REPORTING PROCEDURES

NATURE OF INJURY _____
 LOCATION OF PATIENT _____
 POINT OF CONTACT _____
 TRANSPORTATION REQUESTED BY: AIR ___ GROUND ___
 POINT OF PICKUP _____
 LAT _____ LONG _____
 PATIENT UNIT ID _____
 IS AN EMT WITH PATIENT: YES ___ NO ___
 AGE _____
 SEX: MALE ___ FEMALE ___

**ALL EMERGENCIES---Secure the area
and identify witnesses for later
investigation. Keep an accurate log of
events.**

ICS 206 (Rev 03/12) FR	9. PREPARED BY: (Medical Unit Leader) Fred Orsborn	10. REVIEWED BY: (Safety Officer) <i>Scott W. Callahan</i>
----------------------------------	--	---

A message from the Training Specialist

Thank you for registering as a trainee! Now please keep up the good work by giving me periodic progress reports and starting your trainee evaluation process. You can start your evaluation well in advance of incident demobilization so don't delay start today. I will be located in the Check – In Building from 0730 to 1900 hours.

You may also call me at:

Jim Mobley 530-941-2129

Thank you for helping me to help you!!!



**Archaeological and Historic Properties:
Fireline Guidance for the Scotts Creek Fire
Lake County**

**Do not compromise safety for the protection and preservation of archaeological and historic properties.
When possible and prudent:**

1. Be on the lookout for prehistoric and historic archaeological sites. These sites typically occur adjacent to streams and springs but can occur in other areas as well. The most common indicators of prehistoric sites in this area are scatters of shiny black obsidian flakes from tool making activities and dark midden soils. Historic sites include homesteads that contain foundations, rock chimneys, and stone / brick-lined wells. Historic mining sites are possible as well.
2. Known sites will be flagged with red plastic flagging tape. Note, that much of the area has never been surveyed for archaeological resources and many sites out there have yet to be discovered.
3. If you observe archaeological resources, flagged or unflagged, attempt to avoid with ground disturbing activities altogether.
4. If avoidance is not possible, minimize ground disturbance. Use a hand crew rather than a dozer to remove fuels from control lines that must cross site areas if possible.
5. Leave all artifacts in place as some may have been intentionally placed for religious or ceremonial reasons.
6. Note locations of discovered resources on a map. Better yet take site coordinates with a GPS. Leave information for the archaeologist with the Plans Unit so that the sites can be relocated and protected during Fire Suppression Repair. Flag the site in red if possible.
7. If you encounter a burial or other human remains, cease work in that area and contact the archaeologist immediately.

Your help preserving California's non-renewable cultural resources is appreciated.

Richard Jenkins
CAL FIRE Northern Region Archaeologist
Cell Phone: (530) 949-8822

Christopher Lloyd
BLM Ukiah Field Office
Archaeologist
Office Phone: (707) 468-4075

"Scotts" Incident Fire Suppression Repair Plan

I. Objectives

The objective of the Suppression Repair Plan is to mitigate possible adverse effects to resources resulting from fire suppression activities on the Scotts Fire in a manner which does not compromise firefighter safety. The mitigations described within this plan have been developed to apply to constructed fire lines, watercourse crossings, access roads, drop points, heli-spots and any other locations disturbed by fire suppression activities. A Repair Specialist will be assigned to ensure that work is done as required and according to the Emergency Fire Suppression Repair Plan. Additional specialists or equipment may be used if the need arises. Specialists will release equipment from the area when their work is completed.

II. General Repair Guidelines

A. Helispots/Staging Areas/Safety Zones

- 1) Re-contour to the original slope as requested by the Repair Specialist.
- 2) Remove soil, and/or breach berms so that runoff can be dissipated. Cross drain these areas to effectively dissipate water runoff.
- 3) Place disturbed vegetation, brush and trees, piled during line construction, on the surface of safety zones and open areas. This may be done with equipment or hand crews.

B. Roads

- 1) Re-establish existing berms where applicable.
- 2) Breach berms to facilitate drainage, where applicable.
- 3) Clean culverts plugged with soil and rock resulting from fire suppression activities.
- 4) Blading or grading of roads may be necessary.

C. Firelines; Hand and Dozer

Install waterbars as needed. Waterbars are designed to intercept, slow and spread the precipitation run-off in order to reduce sediment transport and soil erosion. The idea is to move water off the fireline before it can build up enough energy to erode and transport sediment. Re-establish waterbars and rolling dips using pre-fire locations. Flatten berms along fire lines to match natural contours. Utilize cut vegetation for erosion control on steep dozer and hand lines.

Water Bar or cross drain spacing				
Fireline or Road Gradient (%)	0-10%	11-25%	26-50%	>50%
Spacing	200'	150'	100'	75'

D. Watercourses

- 1) Watercourse crossings shall be dipped to original configuration. Waterbreaks shall be installed on each side of channel to divert flow off of trails prior to entering watercourse channel.
- 2) Remove all soil and debris that was placed in any stream channel. A Repair Specialist will review the site for acceptability. If all foreign material cannot be removed with heavy equipment, the material shall be removed by hand. The approaches to the crossing may be sloped back to prevent future stream bank failure.

E. Other Repair Concerns

- 1) Remove all trash from fire lines and other affected areas.
- 2) Repair, broken, damaged fences, and/or gates damaged as the result of the fire control operations will be repaired. (Note: Extent and condition of damage should be documented prior to repairs.)

Prepared by:



Len Nielson, Emergency Fire Line Repair Technical Specialist

SCOTTS INCIDENT - BASE CAMP PHONE LIST

OPERATIONS	707-263-3864
RESOURCES	707-263-3485
DEMOB	707-263-3258
INFORMATION - PIO	707-263-3568
TRAINING SPECIALIST	707-263-3376
FINANCE	707-263-3324
SUPPLY	916-205-4419
GROUND SUPPORT	530-708-2750
COMMUNICATIONS	530-949-6816
COMMUNICATIONS - FAX	707-263-3349
OFFSITE ACCOMMODATIONS	707-263-3568
OES	707-263-3526
ORDERING	707-263-3357

Shift Ticket Examples

EMERGENCY SHIFT TICKET and EVALUATION FORM					Contractor Name	
The responsible Government Officer will complete this form each shift					Fireline Builders	
Incident or Project Name Scott		Incident Number CAMEU006376	Request Number E or S # Here		Operator #1 John Smith	Operator #2 Joe Smith
Agreement Number Obtain from vendor's agreement					Operator Furnished By: <input checked="" type="checkbox"/> Contractor <input type="checkbox"/> Government	
Equipment Make CAT		Equipment Model / Type D6H			Operating Supplies Furnished By: <input checked="" type="checkbox"/> Contractor <input type="checkbox"/> Government	
Serial Number 6LN3344		Licence Number			Equipment Status <input checked="" type="checkbox"/> Inspected <input checked="" type="checkbox"/> Under Agreement	
Equipment Use (Circle) Hours / Days / Miles					Released by Government <input type="checkbox"/>	
Date Mo / Day	Start	Stop	Work	Assignment	Withdrawn by Contractor <input type="checkbox"/>	
8/17	0600	2400	16	Division B	Remarks/Comments ** 2 Operators 24 hour shift	
8/18	0001	0600	8	Division B		
Vendor Rating					Govt. Rep. Name and Position - PRINT Steve Smith	
	Poor*	Avg.	Good	Exc.	N/A	Govt. Rep. Signature <i>Steve Smith</i>
Met Performance Expectations		Vendor Rating must be done.				Contractor Signature <i>Bob Smith</i>
Equipment in Safe Working Condition					Date 09/09/12	Time 0600
Operator Skill Level						
Operates Safely						
Operator's Cooperation Level						
Overall Performance						
* NOTE: Any rating of POOR requires an explanation in Comment Section.					CALFIRE 297	
**Final evaluation or for more documentation, use an ICS Form 230 or equivalent.					(Rev 3-2011)	
Pink - Finance		Blue - Home Unit HE Coordinator		Yellow - Vendor		White - Govt Representative

EMERGENCY SHIFT TICKET and EVALUATION FORM					Contractor Name	
The responsible Government Officer will complete this form each shift					Fireline Builders	
Incident or Project Name Scotts		Incident Number CAMEU 006376	Request Number E or S # Here		Operator #1 John Smith	Operator #2
Agreement Number Obtain from vendor's agreement					Operator Furnished By: <input checked="" type="checkbox"/> Contractor <input type="checkbox"/> Government	
Equipment Make CAT		Equipment Model / Type D6H			Operating Supplies Furnished By: <input checked="" type="checkbox"/> Contractor <input type="checkbox"/> Government	
Serial Number 6LN3344		Licence Number			Equipment Status <input checked="" type="checkbox"/> Inspected <input checked="" type="checkbox"/> Under Agreement	
Equipment Use (Circle) Hours / Days / Miles					Released by Government <input type="checkbox"/>	
Date Mo / Day	Start	Stop	Work	Assignment	Withdrawn by Contractor <input type="checkbox"/>	
8/17	0001	0600	6	Off Shift	Remarks/Comments ** 1 Operator 12 hour shift	
8/17	0600	1800	12	Division B		
8/17	1800	2400	6	Off Shift		
Vendor Rating					Govt. Rep. Name and Position - PRINT Steve Smith	
	Poor*	Avg.	Good	Exc.	N/A	Govt. Rep. Signature <i>Steve Smith</i>
Met Performance Expectations		Vendor Rating must be done.				Contractor Signature <i>Bob Smith</i>
Equipment in Safe Working Condition					Date 09/09/12	Time 1800
Operator Skill Level						
Operates Safely						
Operator's Cooperation Level						
Overall Performance						
* NOTE: Any rating of POOR requires an explanation in Comment Section.					CALFIRE 297	
**Final evaluation or for more documentation, use an ICS Form 230 or equivalent.					(Rev 3-2011)	
Pink - Finance		Blue - Home Unit HE Coordinator		Yellow - Vendor		White - Govt Representative

Scotts Incident

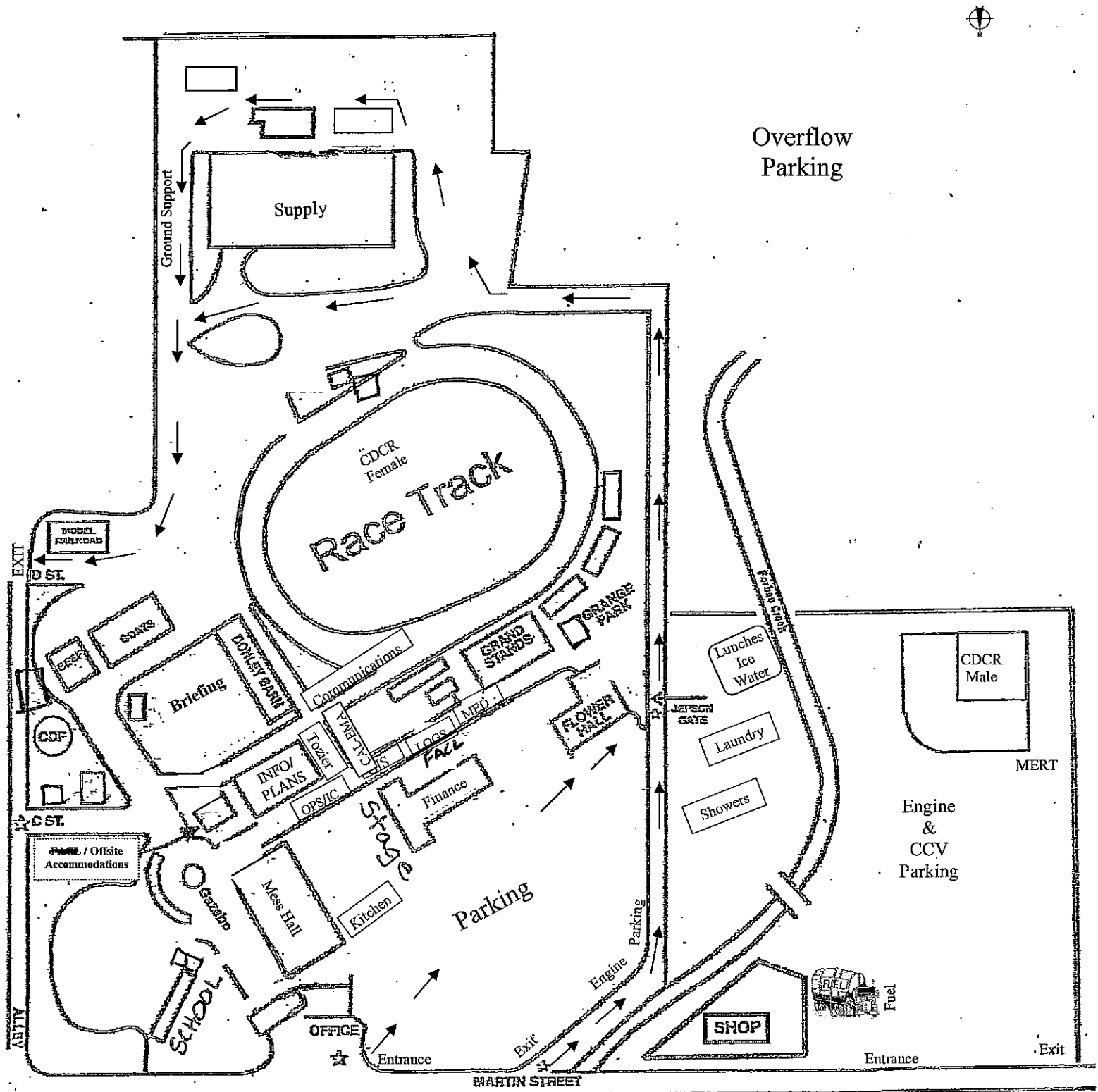

Not to scale

