

**SCOTTS
INCIDENT**

CA-MEU-006376

IAP

***Master Corrected
Electronic Copy***

9/13 - 9/14/2012

0700-0700

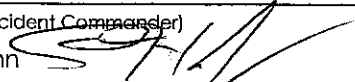
INCIDENT OBJECTIVES	1. Incident Name SCOTTS	2. Date 9-12-12	3. Time 2000
4. Operational Period September 13-14, 2012 0700-0700			
5. General Control Objectives for the Incident (include alternatives) Management Objectives <ul style="list-style-type: none"> • Provide for Firefighter and Public Safety • Maintain positive communication and relationships with cooperating agencies and the public • Protect natural and cultural resources • Maintain effective cost management while meeting the needs of the incident • Provide for a safe and efficient demobilization Control Objectives <ul style="list-style-type: none"> • Keep fire within constructed lines 			
6. Weather Forecast for Period <ul style="list-style-type: none"> • Max temperature: 87-93° F • Min humidity: 14-19% • 20' WINDS: <i>Ridges/Upper slopes:</i> SE 5-10 mph, becoming SW 6-12 mph, gusts 17-22 mph in afternoon <i>Slope/Valley</i> – light, variable, turning upslope 3-6 mph in afternoon with gusts 8-10 mph 			
7. General Safety Message <ul style="list-style-type: none"> • Continually monitor your personnel for signs and symptoms of dehydration; water to electrolyte enhanced drink is a 2 to 1 ratio. • Be cautious of rattlesnakes, hornets and wasps. • Drive defensively. Watch out for road hazards. • Most injuries on wildland fires occur in the mop up phase. Implement your training. 			
8. Attachments (mark if attached)			
<input checked="" type="checkbox"/> Organization List - ICS 203 <input checked="" type="checkbox"/> Div. Assignment Lists - ICS 204 <input checked="" type="checkbox"/> Communications Plan - ICS 205 <input checked="" type="checkbox"/> Medical Plan - ICS 206	<input checked="" type="checkbox"/> Safety Message <input checked="" type="checkbox"/> Weather <input checked="" type="checkbox"/> Finance Message <input checked="" type="checkbox"/> Archaeology Message	<input checked="" type="checkbox"/> Fire Suppression Repair Guidelines <input checked="" type="checkbox"/> Shift Ticket Example <input checked="" type="checkbox"/> Travel Map <input checked="" type="checkbox"/> Unit Log- ICS 214	
9. Prepared by (Planning Section Chief) Pam Linstedt	10. Approved by (Incident Commander) Eric Hoffmann 		

ORGANIZATION ASSIGNMENT LIST ICS 203		1. INCIDENT NAME	2. DATE PREPARED	3. TIME PREPARED
		SCOTTS INCIDENT	9/12/12	1900
5. INCIDENT COMMANDER AND STAFF		4. OPERATIONAL PERIOD (DATE/TIME)		
		9/13/12-9/14/12 0700-0700		
POSITION NAME		9. OPERATIONS SECTION		
INCIDENT COMMANDER	ERIC HOFFMANN	DAY	DAVE RUSSELL/ERIC JOHNSON(T)	
DEPUTY	MIKE HEBRARD	NIGHT	MARK KENDALL	
SAFETY OFFICER	KEITH CALLISON 530-598-2612	DEPUTY DAY/NIGHT	JIM FERGUSON	
INFORMATION OFFICER	MIKE CARR	a. BRANCH I - DIVISIONS/GROUPS		
LIAISON OFFICER	SCOTT LINDGREN	BRANCH DIRECTOR	TONY BROWNELL	
6. AGENCY REPRESENTATIVES				
AGENCY	NAME	DIVISION	Z	KEVIN DIXON
CDC	ROY ULATAN 707-357-2447	DIVISION	A/B/D	MARK HIGGINS
OES	JOHN CLARY 925-381-5526			MATT FURTADO(T)
BLM	JEFF TUNNELL 707- 299-8995 / GARY SHARPE			
CHP	SGT STARKE			
PG&E	SCOTT HOLMQUIST			
MENDOCINO CO. SHERIFF	SGT SCOTT			
LAKE CO. SHERIFF	CAPTAIN MACEDO SGT BROOKS			
CCC	DUANE WILSON			
7. PLANNING SECTION				
CHIEF	PAM LINSTEDT	b. BRANCH II - DIVISIONS/GROUPS		
DEPUTY	JON LOVIE	BRANCH DIRECTOR		IAN LARKIN
RESOURCE UNIT	RALPH GLADWIN/ JAKE SJOLUND			
SITUATION UNIT	ERIC SCOVEL/MONTY SMITH(T)	DIVISION	M/P/Q/Y	STEVE HEWLETT
DEMOBILIZATION UNIT	BROOK DARLEY			
DOCUMENTATION UNIT	REGINA SCRIVEN			
FIRE BEHAVIOR ANALYST				
HIRED EQUIP. TECH SPEC.	MATT SULLY			
COMPUTER TECH SPEC.				
CREW TECH SPEC.	KEVIN KEENE	FIRE SUPPRESSION REPAIR		LEN NIELSON
GIS TECHNICAL SPEC.	ELSA HUCKS			LUCAS TITUS (T)
GIS TECHNICAL SPEC.	ALBERT LAU			
TRAINING TECH SPEC.	JIM MOBLEY			
INCINET ADMINISTRATOR	ROY NAKAGAKI/MARK ROITZELL			
RESOURCE ADVISOR	DAVE BATES			
8. LOGISTICS SECTION				
CHIEF	KEN LOWE 530-448-2412			
DEPUTY	BREANNA BUCHANAN	e. AIR OPERATIONS BRANCH		
a. SUPPORT BRANCH		AIR OPERATIONS BR. DIR.	CHRIS AVINA	
SUPPLY UNIT	JIM VIERRA	AIR TACTICAL SUPERVISOR		
FACILITIES UNIT	GARRETT RADOVICH	AIR SUPPORT SUPERVISOR	MARK GRADEK	
GROUND SUPPORT UNIT	DAVE MCKOY	HELICOPTER COORDINATOR	WARREN PARISH	
ORDERING	KAREN VILLALOBOS	AIR TANKER COORDINATOR		
		10. FINANCE/ADMINISTRATION SECTION		
b. SERVICE BRANCH		CHIEF	VANCE MOULTON	
COMMUNICATIONS UNIT	KYLE JOHNSON	TIME UNIT	LESLIE MARG	
MEDICAL UNIT	FRED ORSBORN	PROCUREMENT UNIT	EVELYN GLENN	
FOOD UNIT	JESSE HANSCHILD	COMPENSATION/CLAIMS UNIT	JOE TAPIA	
MOTEL UNIT	RANDY FORD	COST UNIT	MARA ZAVER	
ICS 203	PREPARED BY (PLANS CHIEF) PAM LINSTEDT			



Scotts Incident Weather Forecast



FORECAST NO: 3

NAME OF FIRE: Scotts

PREDICTION FOR: 0700-0700

UNIT: CA-MEU-006376

SHIFT DATE: 9/13-9/14/2012

SIGNED: Ryan Walbrun

TIME AND DATE

FORECAST ISSUED: 2000 9/12/2012

Incident Meteorologist

WEATHER DISCUSSION: Another sunny...hot and dry day is forecast over the Scotts Incident. Temperatures will start out mild in the 70s and quickly warm into the upper 80s and lower 90s. Winds will remain from a Southeast direction over the fire for much of the day before turning Southwest after 2 pm. Humidity values will once again start out around 30% and then lower to around 15% during the afternoon hours. The overall trend should be slightly warmer and drier which is a **Watch Out** situation. Westerly winds will ease after sunset with another mild and dry night in store for those staying out on the line for a 24 hour shift. Be aware that increasing Southerly wind flow is expected along the ridges in the pre-dawn hours of Friday...which represents a **change** in the weather from previous days. Remember that much of Northern California remains under a Fuels and Fire Behavior Advisory due to critically dry fuels.

WEATHER FORECAST For Thursday:

WEATHER: Sunny...continued hot and dry. Trend will be slightly warmer and drier.

HIGH TEMPERATURES: Afternoon highs 87-93 degrees.

MIN HUMIDITY: Starting out around 30%...then lowering 14-19% in the afternoon.

20 FT WINDS:

RIDGETOP - Southeast 5-10-mph thru midday then Southwest 6-12 mph gusts 17-22 mph afternoon

SLOPE/VALLEY - Light and variable turning upslope 3-6 mph in the afternoon with gusts 8-10 mph.

STABILITY/INVERSION: Weak morning inversion over the fire will mix out by 10 am.

Forecast for Thursday Night:

WEATHER: Clear and mild with poor RH recovery over most of the fire site.

MIN TEMPERATURES: 61-66 over most of the fire...upper 50s lowest drainages.

MAX HUMIDITY: Less than 25% through sunset then slowly recovering 35-40% by morning.

20 FT WINDS:

RIDGETOP - Southwest 6-12 mph thru sunset...then Southerly overnight...**gusts to 20 mph.**

SLOPE/VALLEY - Evening upslope 3-5 mph until sunset...then downslope 1-4 mph overnight.

STABILITY/INVERSION: Weak inversion setting up over the fire after sunset.

OUTLOOK FOR Friday through Sunday: Slightly stronger Southwest Ridgetop winds on Friday as a trough moves to our North. Temperatures may cool a few degrees but no big changes. High pressure stays in place through the weekend with highs generally in the mid 80s...lows in the upper 50s. RH 20% in the afternoon...recovering to 40% at night. Ridge winds Southeast to Southwest 6-12 mph.

SAFETY MESSAGE/PLAN

1. Incident Name:

SCOTTS INCIDENT CA-MEU-006376

2. Operational Period:

Date From: 09/13/2012 Date To: 09/14/2012

Time From: 0700

Time To: 0700

3. Safety Message:

- Remember the incident's first Management Objective: Firefighter and public safety.
- Most injuries on wildland fires occur in the mop up phase. Remain vigilant and remember your training.
- In order to have confidence in your Personal Protective Equipment, you need to be wearing it!
- Maintain awareness of rattlesnakes, hornets and wasps.
- Be cautious of fire weakened or partially burned trees.
- Drive with your headlights on at all times, follow all speed limits and traffic plans.
- When fueling your vehicle, take the time to ensure your windshield is clean.
- Always use a backer and chock your vehicles.
- Be aware of road hazards specifically plastic culverts burned out under the road.
- Prevent dehydration by drinking frequently throughout each working hour. Drink plenty of water with meals; continue replacing fluids while off shift. Plan ahead and don't allow water to run out before resupplying.
- Pay close attention to fatigue levels. Get rest and drink plenty of water!

Lookout(s). Communication(s). Escape routes and Safety zone(s)

5. Prepared by: Name: Felix Berbena SOFR1(T)

Approved By Safety Officer:



ICS 208

Date/Time: 09/12/2012 1800 hours

INCIDENT ACTION PLAN SAFETY ANALYSIS

Incident Name

SCOTTS

Operational Period Date / Time

09/13/12 - 09/14/12 0700-0700

LCES* Analysis of Tactical Applications
Lookouts Communications Escape routes Safety Zones

Other Risk Analysis

Division/Group	Downhill Fireline	Underslung Fireline	Indirect Fireline	Midslope Fireline	Frontal Assault	Anchor Points	Extreme Conditions (Spotting , Wind-driven)	Unburned Area	Snags	Narrow Dusty Roads	LCES Mitigations	Transportation 1 HR +	Communications	Structure Protection	Multi-Aircraft	Culvert Damage	Other Risk Mitigations
BRN I																	
Z							X	X			Look Outs, Escape Routes, Safety Zones					X	Check in & out of Division
A/B/D							X				Stay informed of changes, Situational Awareness, Communicate Hazards	X			X		Drive Defensively Identify and Mark
BRN II																	
M/P/Q/Y							X				Brief - narrow steep roads						
Suppres. Repair										X		X					Brief on unfamiliar equipment

Prepared by (Name and Position)
Felix Berbera SOFR1 (T)

Felix Berbera

Date and Time:
09/12/12 1900

DIVISION ASSIGNMENT LIST		1. Branch I	2. Division/Group Z	Latitude/ Longitude			
3. Incident Name SCOTTS		4. Operational Period Date: 9/13/12 - 9/14/12 Time: 0700-0700					
5. Operations Personnel							
Operations Chief	Dave Russell/Eric Johnson(T) (Day) Mark Kendall (Night)		Branch		Tony Brownell		
Deputy	Jim Ferguson						
Safety Officer	Mike Watner		Division/Group Supervisor		Kevin Dixon		
6. Resources Assigned this Period							
Strike Team/Task Force/ Resource Designator	Leader	Number Persons	Trans. Needed	Drop Off PT./Time	Pick Up PT./Time	On Line	Off Line
STC HUU 9122C	Thomas Nix	17	N	DP-10/0800	DP-10/0800	<input type="checkbox"/>	<input type="checkbox"/>
ENG MEU 1167	Michael Aiello	3	N	DP-10/0800	DP-10/2000	<input type="checkbox"/>	<input type="checkbox"/>
ENG MEU 1182	Eric Bettger	3	N	DP-10/0800	DP-10/2000	<input type="checkbox"/>	<input type="checkbox"/>
ENG MEU 1192	Carl Logan	3	N	DP-10/0800	DP-10/2000	<input type="checkbox"/>	<input type="checkbox"/>
ENG LNU 1471	Joe Petersen	5	N	DP-10/0800	DP-10/2000	<input type="checkbox"/>	<input type="checkbox"/>
ENG LNU 1481	Garrett White	3	N	DP-10/0800	DP-10/2000	<input type="checkbox"/>	<input type="checkbox"/>
STG TGU 9256G	Dan Chartier	32	N	DP-10/0800	DP-10/2000	<input type="checkbox"/>	<input type="checkbox"/>
						<input type="checkbox"/>	<input type="checkbox"/>
						<input type="checkbox"/>	<input type="checkbox"/>
						<input type="checkbox"/>	<input type="checkbox"/>
						<input type="checkbox"/>	<input type="checkbox"/>
						<input type="checkbox"/>	<input type="checkbox"/>
						<input type="checkbox"/>	<input type="checkbox"/>
						<input type="checkbox"/>	<input type="checkbox"/>
						<input type="checkbox"/>	<input type="checkbox"/>
7. Control Operations Hold existing line. Mop up 500 feet and patrol.							
8. Special Instructions Bold resources are on a 24 hour shift. LNU E1471 report to Helibase by 0800 for dust abatement then continue to Division. Backhaul garbage to drop points. Maintain positive contact with public and local residents. FOBS will be working in all branches.							
9. Division/Group Communication Summary							
Function	Frequency	System	Channel	Function	Frequency	System	Channel
Command	CDF COMMAND 2 TONES 1, 7, 12, 16	King NIFC	151.2650 Rx 159.3300 Tx	Logistics		King NIFC	
Tactical Div/Group	VFIRE 26	King NIFC	154.3025 Rx 154.3025 Tx	Air to Ground	CDF TAC 14	King NIFC	159.2250 Rx 159.2250 Tx
Prepared by (Resource Unit Ldr.) Ralph Gladwin		Approved by (Planning Sect. Ch.) Jon Lovie			Date 9-12-2012		Time 1900

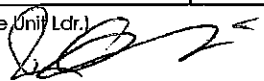
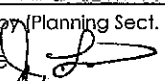
DIVISION ASSIGNMENT LIST			1. Branch I	2. Division/Group A/B/D	Latitude/ Longitude		
3. Incident Name SCOTTS			4. Operational Period Date: 9/13/12 - 9/14/12 Time: 0700-0700				
5. Operations Personnel							
Operations Chief	Dave Russell/Eric Johnson(T)(Day) Mark Kendall (Night)			Branch	Tony Brownell		
Deputy	Jim Ferguson						
Safety Officer	Mike Watner			Division/Group Supervisor	Mark Higgins/Matt Furtado(T)		
6. Resources Assigned this Period							
Strike Team/Task Force/ Resource Designator	Leader	Number Persons	Trans. Needed	Drop Off PT./Time	Pick Up PT./Time	On Line	Off Line
STC BTU 9212C	Rob Sonsteng	20	N	DP-1/0800	DP-1/0800	<input type="checkbox"/>	<input type="checkbox"/>
STG AEU 9274G	Micheal Gundry	36	N	DP-1/0800	DP-1/0800	<input type="checkbox"/>	<input type="checkbox"/>
STG HUU 9121G	Robert Murias	33	N	DP-1/0800	DP-1/2000	<input type="checkbox"/>	<input type="checkbox"/>
STG NEU 9231G	Dave Hurd	32	N	DP-1/0800	DP-1/2000	<input type="checkbox"/>	<input type="checkbox"/>
STL SKU 9262L	Kurt Ohlau	5	N	DP-1/0800	DP-1/0800	<input type="checkbox"/>	<input type="checkbox"/>
WT PVT E-98 49er	Bob Mergl	2	N	DP-1/0800	DP-1/0800	<input type="checkbox"/>	<input type="checkbox"/>
WT PVT E-105 Marymee	Jack Marymee	2	N	DP-1/0800	DP-1/0800	<input type="checkbox"/>	<input type="checkbox"/>
						<input type="checkbox"/>	<input type="checkbox"/>
						<input type="checkbox"/>	<input type="checkbox"/>
						<input type="checkbox"/>	<input type="checkbox"/>
						<input type="checkbox"/>	<input type="checkbox"/>
						<input type="checkbox"/>	<input type="checkbox"/>
						<input type="checkbox"/>	<input type="checkbox"/>
7. Control Operations Hold existing line. Mop up 500 feet and patrol.							
8. Special Instructions Radio identifier will be "Division Alpha". Bold resources are on a 24 hour shift. Backhaul garbage to drop points. Maintain positive contact with public and local residents. FOBS will be working in all branches.							
9. Division/Group Communication Summary							
Function	Frequency	System	Channel	Function	Frequency	System	Channel
Command	CDF COMMAND 2 TONE 1,7,12,16	King NIFC	151.2650 Rx 159.3300 Tx	Logistics		King NIFC	
Tactical Div/Group	VFIRE 24	King NIFC	154.2725 Rx 154.2725 Tx	Air to Ground	CDF TAC 14	King NIFC	159.2250 Rx 159.2250 Tx
Prepared by (Resource Unit Ldr.) Ralph Gladwin 			Approved by (Planning Sect. Ch.) Jon Lovie 		Date 9-12-2012	Time 1900	

DIVISION ASSIGNMENT LIST		1. Branch II	2. Division/Group M/P/Q/Y	Latitude/ Longitude			
3. Incident Name SCOTTS		4. Operational Period Date: 9/13/12 – 9/14/12 Time: 0700-0700					
5. Operations Personnel							
Operations Chief	Dave Russell/Eric Johnson(T)(Day) Mark Kendall (Night)		Branch	Ian Larkin			
Deputy	Jim Ferguson						
Safety Officer	Mike Watner		Division/Group Supervisor	Steven Hewlett			
6. Resources Assigned this Period							
Strike Team/Task Force/ Resource Designator	Leader	Number Persons	Trans. Needed	Drop Off PT./Time	Pick Up PT./Time	On Line	Off Line
STC NEU 9232C	Doug Rinella	16	N	DP-4 or 7/0800	DP-4 or 7/0800	<input type="checkbox"/>	<input type="checkbox"/>
STG HUU 9124G	Orlando Payne	34	N	DP-4 or 7/0800	DP-4 or 7/0800	<input type="checkbox"/>	<input type="checkbox"/>
						<input type="checkbox"/>	<input type="checkbox"/>
						<input type="checkbox"/>	<input type="checkbox"/>
						<input type="checkbox"/>	<input type="checkbox"/>
						<input type="checkbox"/>	<input type="checkbox"/>
						<input type="checkbox"/>	<input type="checkbox"/>
						<input type="checkbox"/>	<input type="checkbox"/>
						<input type="checkbox"/>	<input type="checkbox"/>
						<input type="checkbox"/>	<input type="checkbox"/>
						<input type="checkbox"/>	<input type="checkbox"/>
						<input type="checkbox"/>	<input type="checkbox"/>
						<input type="checkbox"/>	<input type="checkbox"/>
						<input type="checkbox"/>	<input type="checkbox"/>
						<input type="checkbox"/>	<input type="checkbox"/>
						<input type="checkbox"/>	<input type="checkbox"/>
7. Control Operations Hold existing line. Mop up 500' and patrol.							
8. Special Instructions Radio Identifier will be "Division Mike". Bold resources are on a 24 hour shift. Backhaul garbage to drop points. Maintain positive contact with public and local residents. FOBS will be working in all branches.							
9. Division/Group Communication Summary							
Function	Frequency	System	Channel	Function	Frequency	System	Channel
Command	CDF COMMAND 2 TONE 1,7,12,16	King NIFC	151.2650 Rx 159.3300 Tx	Logistics		King NIFC	
Tactical Div/Group	VFIRE 25	King NIFC	154.2875 Rx 154.2875 Tx	Air to Ground	CDF TAC 14	King NIFC	159.2250 Rx 159.2250 Tx
Prepared by (Resource Unit Ldr.) Ralph Gladwin			Approved by (Planning Sect. Ch.) Jon Lovie		Date 9-12-2012		Time 1900

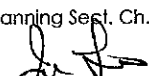
DIVISION ASSIGNMENT LIST			1. Branch	2. Division/Group Suppression Repair	Latitude/ Longitude Page 1 of 2			
3. Incident Name SCOTTS			4. Operational Period Date: 9/13/12 – 9/14/12				Time: 0700-0700	
5. Operations Personnel								
Operations Chief	Dave Russell/Eric Johnson(T) (Day) Mark Kendall (Night)			Branch				
Deputy	Jim Ferguson							
Safety Officer	Mike Watner			Division/Group Supervisor		Len Nielson/Lucas Titus (T)		
6. Resources Assigned this Period								
Strike Team/Task Force/ Resource Designator	Leader	Number Persons	Trans. Needed	Drop Off PT./Time	Pick Up PT./Time	On Line	Off Line	
DOZ PVT E-22 Redwood	Mel Ford	1	N	TBA/0800	TBA/2000	<input type="checkbox"/>	<input type="checkbox"/>	
DOZ PVT E-25 Ingram	Bruce Ingram	1	N			<input type="checkbox"/>	<input type="checkbox"/>	
DOZ PVT E-54 Wylatti	Brian Hurt	1	N			<input type="checkbox"/>	<input type="checkbox"/>	
DOZ PVT E-55 Fireline	Dan LaRue	1	N			<input type="checkbox"/>	<input type="checkbox"/>	
DOZ PVT E-58 Milsaps	Mike Milsaps	1	N			<input type="checkbox"/>	<input type="checkbox"/>	
WT PVT E-16 Floodgate	Butch Paula	1	N			<input type="checkbox"/>	<input type="checkbox"/>	
WT PVT E-96 Beebe	Don Hunt	1	N			<input type="checkbox"/>	<input type="checkbox"/>	
WT PVT E-97 49er	Dick Sasser	1	N			<input type="checkbox"/>	<input type="checkbox"/>	
WT PVT E-99 49er	Jess Sander	1	N			<input type="checkbox"/>	<input type="checkbox"/>	
WT PVT E-100 Big R	Richard Garrett	1	N			<input type="checkbox"/>	<input type="checkbox"/>	
WT PVT E-154 Lenahans	Dee Holmes	1	N			<input type="checkbox"/>	<input type="checkbox"/>	
WT PVT E-161 Lenahans	Chuck Hughes	1	N			<input type="checkbox"/>	<input type="checkbox"/>	
7. Control Operations Repair damage caused by suppression activities and mitigate possible adverse effects of same.								
8. Special Instructions All resources are on a 12 hour shift. Notify Division Supervisor when entering and leaving Divisions. Backhaul garbage to drop points. Maintain positive contact with public and local residents.								
9. Division/Group Communication Summary								
Function	Frequency	System	Channel	Function	Frequency	System	Channel	
Command	CDF COMMAND 2 TONES 1, 7, 12, 16	King NIFC	151.2650 Rx 159.3300 Tx	Logistics		King NIFC		
Tactical Div/Group	VTAC 14	King NIFC	159.4725 Rx 159.4725 Tx	Air to Ground	CDF TAC 14	King NIFC	159.2250 Rx 159.2250 Tx	
Prepared by (Resource Unit, dr.) Ralph Gladwin 				Approved by (Planning Sect. Ch.) Jon Lovie 		Date 9-12-2012		
						Time 1900		

DIVISION ASSIGNMENT LIST			1. Branch	2. Division/Group Suppression Repair	Latitude/ Longitude Page 2 of 2		
3. Incident Name SCOTTS			4. Operational Period Date: 9/13/12 – 9/14/12 Time: 0700-0700				
5. Operations Personnel							
Operations Chief	Dave Russell/Eric Johnson(T) (Day) Mark Kendall (Night)			Branch			
Deputy	Jim Ferguson						
Safety Officer	Mike Watner			Division/Group Supervisor	Len Nielson/Lucas Titus (T)		
6. Resources Assigned this Period							
Strike Team/Task Force/ Resource Designator	Leader	Number Persons	Trans. Needed	Drop Off PT./Time	Pick Up PT./Time	On Line	Off Line
GRD PVT E-227 Parmeter	Wes Parmeter	1	N	TBA/0800	TBA/2000	<input type="checkbox"/>	<input type="checkbox"/>
EXC PVT E-215 Simpson	Steve Perez	1	N			<input type="checkbox"/>	<input type="checkbox"/>
EXC PVT E-216 Giacomini	Grant Yates	1	N			<input type="checkbox"/>	<input type="checkbox"/>
EXC PVT E-217 OFerrall	Travis OFerrall	1	N			<input type="checkbox"/>	<input type="checkbox"/>
DOZB	Angelo Prandini	1	N			<input type="checkbox"/>	<input type="checkbox"/>
FSRS	Nathan Opie	1	N			<input type="checkbox"/>	<input type="checkbox"/>
FSRS	Justin Peterson	1	N			<input type="checkbox"/>	<input type="checkbox"/>
FSRS	Brian Wilson	1	N			<input type="checkbox"/>	<input type="checkbox"/>
FSRS	Alison Hesterly	1	N	↓	↓	<input type="checkbox"/>	<input type="checkbox"/>
						<input type="checkbox"/>	<input type="checkbox"/>
						<input type="checkbox"/>	<input type="checkbox"/>
						<input type="checkbox"/>	<input type="checkbox"/>
						<input type="checkbox"/>	<input type="checkbox"/>
7. Control Operations Repair damage caused by suppression activities and mitigate possible adverse effects of same.							
8. Special Instructions All resources are on a 12 hour shift. Notify Division Supervisor when entering and leaving Divisions. Backhaul garbage to drop points. Maintain positive contact with public and local residents.							
9. Division/Group Communication Summary							
Function	Frequency	System	Channel	Function	Frequency	System	Channel
Command	CDF COMMAND 2 TONES 1, 7,12, 16	King NIFC	151.2650 Rx 159.3300 Tx	Logistics		King NIFC	
Tactical Div/Group	VTAC 14	King NIFC	159.4725 Rx 159.4725 Tx	Air to Ground	CDF TAC 14	King NIFC	159.2250 Rx 159.2250 Tx
Prepared by (Resource Unit Ldr.) Ralph Gladwin			Approved by (Planning Sect. Ch.) Jon Lovie			Date 9-12-2012	Time 1900

AIR OPERATIONS SUMMARY

(Expanded Form for Large Operations)

OPERATIONAL PERIOD DATE: DAY SHIFT DATE: 09/13/2012

START: 0830 END: 1856

1. INCIDENT NAME: Scotts	2. PREPARED BY: C. Avina	PREPARED DATE/TIME: 09/12/2012 1800 Hrs	3.
4. REMARKS (Safety Notes, Hazards, Air Operations Special Equipment, etc.): For bucket requests go through Incident Communications on Command 2 and copter will report to the assigned Division. Hazards: Towers at ridge top on the South end of fire. Power line west of Blue Lakes *LAMPSON FIELD IS OPEN TO ALL GENERAL AVIATION*			
			5. IFR CANCELLED

6. PERSONNEL	Phone	7. FREQUENCIES	AM	FM	8. FIXED-WING # Avail / Type/ Make-Model / FAA N# / Base(s)
		AIR/AIR FW:	122.925	167.1500	Air Tactical
AOBD: Chris Avina	916 261-2942	AIR/AIR RW:			Lead planes
HICO:		AIR/GROUND:		159.2250CDF Tac 14/ Tn 16	
ASGS: Mark Gratek	707-696-3579	DECK:	163.100		Airtankers
HEBM:		COMMAND RPT	Command 2/ Tone 7		
HEMB		Air Guard	168.625		Other :
CWN Manager: Justin Galvan	707-349-1978	TOLC			

9. HELICOPTERS (Use Additional Sheets As Necessary)

FAA N#	TY	MAKE/MODL	BASE	AVAIL	START	REMARKS	FAA N#	TY	MAKE/MODL	BASE	AVAIL	START	REMARKS
209 PJ	2	Huey	BOGGS	0800	0830	Restricted							

INCIDENT RADIO COMMUNICATIONS PLAN

Incident Name		SCOTT'S		Date/Time Prepared		9/12/2012 1716		Operational Period Date/Time		9/13/12 - 9/14/12 0700 - 0700	
Ch #	Function	Channel Name/Trunked Radio System Talkgroup	Assignment	RX Freq	N or W	RX Tone/NAC	TX Freq	N or W	TX Tone/NAC	Mode A, D or M	Remarks
1	Command	CDF C2	All Branches	151.2650 N		103.5 (8)	159.3300 N		110.9 (1)	A	Tone 1
2	Command	CDF C2	All Branches	151.2650 N		103.5 (8)	159.3300 N		167.9 (7)	A	Tone 7
3	Command	CDF C2	All Branches	151.2650 N		103.5 (8)	159.3300 N		192.8 (16)	A	Tone 16
4	Command	CDF C2	All Branches	151.2650 N		103.5 (8)	159.3300 N		127.3 (12)	A	Tone 12
5	Alt. Command	NIFC C4	All Branches	166.6125 N			168.4000 N		107.2 (10)	A	
6	Tactical	VFIRE 26	Branch I Div Z	154.3025 N			154.3025 N		156.7 (6)	A	
7											
8											
9	Tactical	VFIRE 24	Branch I Div A/B/D	154.2725 N			154.2725 N		156.7 (6)	A	
10	Tactical	VTAC 14	All Branches	159.4725 N			159.4725 N		156.7 (6)	A	Fire Suppression Repair
11											
12	Tactical	VFIRE 25	Branch II Div M/P/Q/Y	154.2875 N			154.2875 N		156.7 (6)	A	
13											
14	Air to Ground	CDF Tac 14	All Branches	159.2250 N		192.8 (16)	159.2250 N		192.8 (16)		
15	EMS	CALCORD	All Branches	156.0750 N			156.0750 N			A	EMS on Incident
16	Emergency	Air Guard	All Branches	168.6250 N			168.6250 N		110.9 (1)	A	EMERGENCIES ONLY
17											
18											
19											
20	Emergency	Air Guard	All Branches	168.6250 N			168.6250 N		110.9 (1)	A	EMERGENCIES ONLY

Prepared By (Communications Unit)

Neil R. Johnson COM

Incident Location

County	Lake	State	CA	Latitude	N	Longitude	W
--------	------	-------	----	----------	---	-----------	---

The convention calls for frequency lists to show four digits after the decimal place, followed by either an "N" or a "W", depending on whether the frequency is narrow or wide band. Mode refers to either "A" or "D" indicating analog or digital (e.g. Project 25) or "M" indicating mixed mode. All channels are shown as if programmed in a control station, mobile or portable radio. Repeater and base stations must be programmed with the Rx and Tx reversed.

MEDICAL PLAN

ICS 206

1. INCIDENT NAME
SCOTTS FIRE

2. DATE PREPARED
9/12/2012

3. TIME PREPARED
1900

4. OPERATIONAL PERIOD
9/13/2012 – 9/14/2012
0700-0700

5. INCIDENT MEDICAL AID STATIONS

MEDICAL AID STATIONS	LOCATION	Nurse	
		YES	NO
MERT	Incident Base Camp	X	

6. TRANSPORTATION

A. AMBULANCE SERVICES

NAME	LOCATION	PHONE	PARAMEDICS	
			YES	NO
CAL STAR (AIR)	Ukiah	800-252-5050	X	
Reach (AIR)	Lakeport	800-338-4045	X	
Lakeport Fire Dept.	Lakeport	707-263-4396	X	
Kelseyville Ambulance	Kelseyville	707-279-4268	X	

B. INCIDENT AMBULANCES

NAME	LOCATION	PARAMEDICS	
		YES	NO
Medic 8011	DP-1	X	
Medic 5514	DP-7 /Kelly Camp Ground	X	

7. HOSPITALS

NAME Med Net Channel	ADDRESS	TRAVEL TIME		PHONE	HELIPAD		BURN CENTER	
		AIR	GRND		YES	NO	YES	NO
Sutter Lakeside Hospital	5176 Hill Rd. East Lakeport	2	15	707-262-5000	X			
Santa Rosa Memorial	1165 Montgomery Drive	20	90	707-546-3210	X			
UC Davis Med Center	2315 Stockton Blvd. Sacramento	25	150	916-734-2011	X		X	
St.Helena Clearlake	15630 18 th Avenue Clearlake,CA	15	35	707-994-6486	X			

8. MEDICAL EMERGENCY PROCEDURES

EMERGENCY FREQUENCY: CALCORD

LINE EMERGENCY:

Crew Supervisor will contact Division Supervisor with patient complaint/condition and location.

- Division/Group Supervisor contacts:
 1. Closest EMS resource
 2. Communications Unit
- Communications Unit contacts:
 1. Ground or Air ambulance as requested
 2. Operations
 3. Safety
 4. Medical Unit
- Division Supervisor or designee will serve as point of contact and run medical emergency on assigned channel.
 1. A pre-assigned tactical frequency (i.e. CALCORD) should be used for IWI and only for duration of need.
- Communications Unit will clear command channel for emergency traffic as needed and only for duration of need.

CAMP EMERGENCY:

Contact Medical Unit with patient complaint/condition and location. Medical Staff will respond to stabilize incident:

- Medical Unit contacts:
 1. Communications
 2. Safety
 3. Logistics
 4. Operations
 5. Crew Supervisor
 6. Comps/Claims

INJURY REPORTING PROCEDURES

NATURE OF INJURY _____
 LOCATION OF PATIENT _____
 POINT OF CONTACT _____
 TRANSPORTATION REQUESTED BY: AIR ___ GROUND ___
 POINT OF PICKUP _____
 LAT _____ LONG _____
 PATIENT UNIT ID _____
 IS AN EMT WITH PATIENT: YES ___ NO ___
 AGE _____
 SEX: MALE ___ FEMALE ___

ALL EMERGENCIES---Secure the area and identify witnesses for later investigation. Keep an accurate log of events.

ICS 206
(Rev 03/12) FR

9. PREPARED BY: (Medical Unit Leader)
Fred Orsborn

10. REVIEWED BY: (Safety Officer)

Felix M. Blunt

A message from the Training Specialist

Today will be my last on the Scotts Incident. Please stop by and see me to close out your trainee evaluations as soon as possible. I will be available in the Check – In Building until I have made positive contact with everyone who is registered as a trainee.

You may also call me at:

Jim Mobley 530-941-2129

Thank you for helping me to help you!!!



**Archaeological and Historic Properties:
Fireline Guidance for the Scotts Creek Fire
Lake County**

**Do not compromise safety for the protection and preservation of archaeological and historic properties.
When possible and prudent:**

1. Be on the lookout for prehistoric and historic archaeological sites. These sites typically occur adjacent to streams and springs but can occur in other areas as well. The most common indicators of prehistoric sites in this area are scatters of shiny black obsidian flakes from tool making activities and dark midden soils. Historic sites include homesteads that contain foundations, rock chimneys, and stone / brick-lined wells. Historic mining sites are possible as well.
2. Known sites will be flagged with red plastic flagging tape. Note, that much of the area has never been surveyed for archaeological resources and many sites out there have yet to be discovered.
3. If you observe archaeological resources, flagged or unflagged, attempt to avoid with ground disturbing activities altogether.
4. If avoidance is not possible, minimize ground disturbance. Use a hand crew rather than a dozer to remove fuels from control lines that must cross site areas if possible.
5. Leave all artifacts in place as some may have been intentionally placed for religious or ceremonial reasons.
6. Note locations of discovered resources on a map. Better yet take site coordinates with a GPS. Leave information for the archaeologist with the Plans Unit so that the sites can be relocated and protected during Fire Suppression Repair. Flag the site in red if possible.
7. If you encounter a burial or other human remains, cease work in that area and contact the archaeologist immediately.

Your help preserving California's non-renewable cultural resources is appreciated.

Richard Jenkins
CAL FIRE Northern Region Archaeologist
Cell Phone: (530) 949-8822

Christopher Lloyd
BLM Ukiah Field Office
Archaeologist
Office Phone: (707) 468-4075

"Scotts" Incident Fire Suppression Repair Plan

I. Objectives

The objective of the Suppression Repair Plan is to mitigate possible adverse effects to resources resulting from fire suppression activities on the Scotts Fire in a manner which does not compromise firefighter safety. The mitigations described within this plan have been developed to apply to constructed fire lines, watercourse crossings, access roads, drop points, heli-spots and any other locations disturbed by fire suppression activities. A Repair Specialist will be assigned to ensure that work is done as required and according to the Emergency Fire Suppression Repair Plan. Additional specialists or equipment may be used if the need arises. Specialists will release equipment from the area when their work is completed.

II. General Repair Guidelines

A. Helispots/Staging Areas/Safety Zones

- 1) Re-contour to the original slope as requested by the Repair Specialist.
- 2) Remove soil, and/or breach berms so that runoff can be dissipated. Cross drain these areas to effectively dissipate water runoff.
- 3) Place disturbed vegetation, brush and trees, piled during line construction, on the surface of safety zones and open areas. This may be done with equipment or hand crews.

B. Roads

- 1) Re-establish existing berms where applicable.
- 2) Breach berms to facilitate drainage, where applicable.
- 3) Clean culverts plugged with soil and rock resulting from fire suppression activities.
- 4) Blading or grading of roads may be necessary.

C. Firelines; Hand and Dozer

Install waterbars as needed. Waterbars are designed to intercept, slow and spread the precipitation run-off in order to reduce sediment transport and soil erosion. The idea is to move water off the fireline before it can build up enough energy to erode and transport sediment. Re-establish waterbars and rolling dips using pre-fire locations. Flatten berms along fire lines to match natural contours. Utilize cut vegetation for erosion control on steep dozer and hand lines.

Water Bar or cross drain spacing				
Fireline or Road Gradient (%)	0-10%	11-25%	26-50%	>50%
Spacing	200'	150'	100'	75'

D. Watercourses

- 1) Watercourse crossings shall be dipped to original configuration. Waterbreaks shall be installed on each side of channel to divert flow off of trails prior to entering watercourse channel.
- 2) Remove all soil and debris that was placed in any stream channel. A Repair Specialist will review the site for acceptability. If all foreign material cannot be removed with heavy equipment, the material shall be removed by hand. The approaches to the crossing may be sloped back to prevent future stream bank failure.

E. Other Repair Concerns

- 1) Remove all trash from fire lines and other affected areas.
- 2) Repair, broken, damaged fences, and/or gates damaged as the result of the fire control operations will be repaired. (Note: Extent and condition of damage should be documented prior to repairs.)

Prepared by:



Len Nielson, Emergency Fire Line Repair Technical Specialist

SCOTTS INCIDENT - BASE CAMP PHONE LIST

OPERATIONS	707-263-3864
RESOURCES	707-263-3485
DEMOB	707-263-3258
INFORMATION - PIO	707-263-3568
TRAINING SPECIALIST	707-263-3376
FINANCE	707-263-3324
SUPPLY	916-205-4419
GROUND SUPPORT	530-708-2750
COMMUNICATIONS	530-949-6816
COMMUNICATIONS - FAX	707-263-3349
OFFSITE ACCOMMODATIONS	707-263-3568
OES	707-263-3526
ORDERING	707-263-3357

Shift Ticket Examples

EMERGENCY SHIFT TICKET and EVALUATION FORM					Contractor Name		
The responsible Government Officer will complete this form each shift					Fireline Builders		
Incident or Project Name Scott		Incident Number CAMEU006376	Request Number E or S # Here		Operator #1 John Smith	Operator #2 Joe Smith	
Agreement Number Obtain from vendor's agreement					Operator Furnished By: <input checked="" type="checkbox"/> Contractor <input type="checkbox"/> Government		
Equipment Make CAT		Equipment Model / Type D6H			Operating Supplies Furnished By: <input checked="" type="checkbox"/> Contractor <input type="checkbox"/> Government		
Serial Number 6LN3344		Licence Number				Equipment Status <input checked="" type="checkbox"/> Inspected <input checked="" type="checkbox"/> Under Agreement	
Equipment Use					Released by Government <input type="checkbox"/>		
(Circle) Hours / Days / Miles					Withdrawn by Contractor <input type="checkbox"/>		
Date Mo / Day	Start	Stop	Work	Assignment			
8/17	0600	2400	16	Division B			
8/18	0001	0600	8	Division B			
Vendor Rating					Govt. Rep. Name and Position - PRINT Steve Smith		
Poor* Avg. Good Exc. N/A					Govt. Rep. Signature <i>Steve Smith</i>		
Met Performance Expectations					Contractor Signature <i>Bob Smith</i>		
Equipment in Safe Working Condition					Date 09/09/12		
Operator Skill Level					Time 0600		
Operates Safely					Remarks/Comments ** 2 Operators 24 hour shift		
Operator's Cooperation Level					CALFIRE 297		
Overall Performance					(Rev 3-2011)		
* NOTE: Any rating of POOR requires an explanation in Comment Section.							
**Final evaluation or for more documentation, use an ICS Form 230 or equivalent.							
Pink - Finance		Blue - Home Unit HE Coordinator		Yellow - Vendor		White - Govt Representative	

EMERGENCY SHIFT TICKET and EVALUATION FORM					Contractor Name		
The responsible Government Officer will complete this form each shift					Fireline Builders		
Incident or Project Name Scotts		Incident Number CAMEU 006376	Request Number E or S # Here		Operator #1 John Smith	Operator #2	
Agreement Number Obtain from vendor's agreement					Operator Furnished By: <input checked="" type="checkbox"/> Contractor <input type="checkbox"/> Government		
Equipment Make CAT		Equipment Model / Type D6H			Operating Supplies Furnished By: <input checked="" type="checkbox"/> Contractor <input type="checkbox"/> Government		
Serial Number 6LN3344		Licence Number				Equipment Status <input checked="" type="checkbox"/> Inspected <input checked="" type="checkbox"/> Under Agreement	
Equipment Use					Released by Government <input type="checkbox"/>		
(Circle) Hours / Days / Miles					Withdrawn by Contractor <input type="checkbox"/>		
Date Mo / Day	Start	Stop	Work	Assignment			
8/17	0001	0600	6	Off Shift			
8/17	0600	1800	12	Division B			
8/17	1800	2400	6	Off Shift			
Vendor Rating					Govt. Rep. Name and Position - PRINT Steve Smith		
Poor* Avg. Good Exc. N/A					Govt. Rep. Signature <i>Steve Smith</i>		
Met Performance Expectations					Contractor Signature <i>Bob Smith</i>		
Equipment in Safe Working Condition					Date 09/09/12		
Operator Skill Level					Time 1800		
Operates Safely					Remarks/Comments ** 1 Operator 12 hour shift		
Operator's Cooperation Level					CALFIRE 297		
Overall Performance					(Rev 3-2011)		
* NOTE: Any rating of POOR requires an explanation in Comment Section.							
**Final evaluation or for more documentation, use an ICS Form 230 or equivalent.							
Pink - Finance		Blue - Home Unit HE Coordinator		Yellow - Vendor		White - Govt Representative	

Scotts Incident

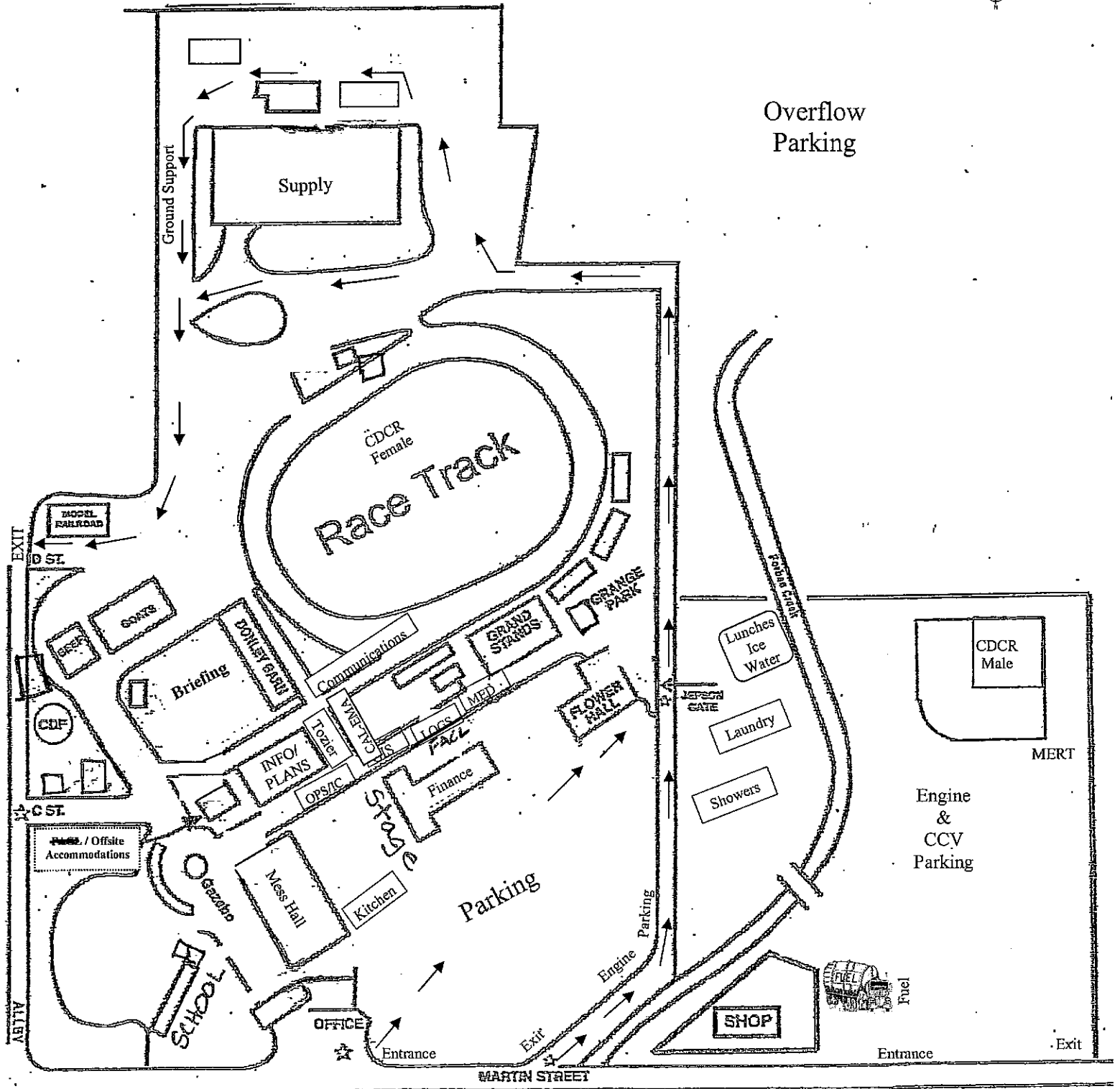

Not to scale

THIS PAGE INTENTIONALLY LEFT BLANK

