

Scotts Incident

CA MEU006376

We will never forget...

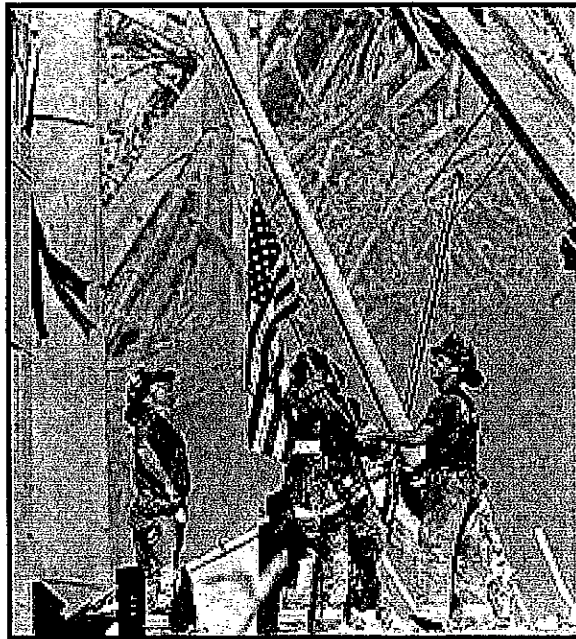

Operational Period
9/11 - 9/12/2012

0700-0700

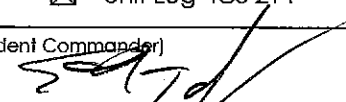

INCIDENT OBJECTIVES	1. Incident Name SCOTTS	2. Date 9-10-12	3. Time 2000
4. Operational Period September 11-12, 2012 0700-0700			
5. General Control Objectives for the Incident (include alternatives) <p>Management Objectives</p> <ul style="list-style-type: none"> • Provide for Firefighter and Public Safety • Maintain communication and relationships with cooperating agencies and the public • Protect natural and cultural resources • Maintain effective cost management while meeting the needs of the incident <p>Control Objectives</p> <ul style="list-style-type: none"> • Keep fire North Eightmile Valley/Eightmile Glade • Keep fire South of Highway 20 • Keep fire East of Mill Creek drainage to Vichy Springs to Highway 20 • Keep fire West of Scotts Valley Road 			
6. Weather Forecast for Period <ul style="list-style-type: none"> • Max temperature: 85-89° F • Min humidity: 15-20% • Winds (20'): Valley - variable, 4-8 mph • Ridgetop winds: W 5-10 mph 			
7. General Safety Message <ul style="list-style-type: none"> • Preplan escape routes, providing enough time for firefighters to move to safety zones or temporary refuge areas. • Continually monitor your personnel for signs and symptoms of dehydration; water to electrolyte enhanced drink is a 2 to 1 ratio. • Be cautious of rattlesnakes, hornets and wasps. • Be alert for fire weakened trees and snags. • Drive defensively. 			
8. Attachments (mark if attached)			
<input checked="" type="checkbox"/> Organization List - ICS 203	<input checked="" type="checkbox"/> Safety Message	<input checked="" type="checkbox"/> Fire Suppression Repair Guidelines	
<input checked="" type="checkbox"/> Div. Assignment Lists - ICS 204	<input checked="" type="checkbox"/> Weather	<input checked="" type="checkbox"/> Shift Ticket Example	
<input checked="" type="checkbox"/> Communications Plan - ICS 205	<input checked="" type="checkbox"/> Finance Message	<input checked="" type="checkbox"/> Travel Map	
<input checked="" type="checkbox"/> Medical Plan - ICS 206	<input checked="" type="checkbox"/> Archaeology Message	<input checked="" type="checkbox"/> Unit Log- ICS 214	
9. Prepared by (Planning Section Chief) Pam Linstedt	10. Approved by (Incident Commander) Eric Hoffmann 		

ORGANIZATION ASSIGNMENT LIST IGS 203		1. INCIDENT NAME	2. DATE PREPARED	3. TIME PREPARED
		SCOTTS INCIDENT	9/10/12	2100
5. INCIDENT COMMANDER AND STAFF		4. OPERATIONAL PERIOD (DATE/TIME)		
		9/11/12-9/12/12 0700-0700		
POSITION NAME		9. OPERATIONS SECTION		
INCIDENT COMMANDER	ERIC HOFFMANN	DAY/NIGHT	DAVE RUSSELL/MARK KENDALL	
DEPUTY	MIKE HEBRAD	DEPUTY DAY/NIGHT	JIM FERGUSON	
SAFETY OFFICER	KEITH CALLISON 530-598-2612			
INFORMATION OFFICER	MIKE CARR	a. BRANCH I - DIVISIONS/GROUPS		
LIAISON OFFICER	SCOTT LINDGREN	BRANCH DIRECTOR		ERIC JOHNSON
6. AGENCY REPRESENTATIVES		DEPUTY		
AGENCY	NAME	DIVISION	Z	STEVEN HEWLETT
CDC	ROY ULATAN 707-357-2447	DIVISION	A	MARK HIGGINS
OES	JOHN CLARY 925-381-5526	DIVISION	B	KEVIN DIXON
BLM	JEFF TUNNELL 707- 299-899 / GARY SHARPE	DIVISION	D	GORDON DULCICH
CHP	SARGENT STARKE	ROADS GROUP		ANGELO PRANDINI
PG&E	SCOTT HOLMQUIST			
MENDOCINO CO. SHERIFF	SARGENT SCOTT			
LAKE CO. SHERIFF	CAPTAIN MACEDO SARGENT STEVE BROOKS			
CCC	DUANE WILSON			
7. PLANNING SECTION				
CHIEF	PAM LINSTEDT	b. BRANCH II - DIVISIONS/GROUPS		
DEPUTY	JON LOVIE	BRANCH DIRECTOR		ERICH SCHWAB
RESOURCE UNIT	RALPH GLADWIN/ JAKE SJOLUND	DEPUTY		
SITUATION UNIT	ERIC SCOVEL/MONTE SMITH(T)	DIVISION	M	RANDY CASTRO
DEMOBILIZATION UNIT	BROOK DARLEY	DIVISION	P/Q	JARROD CLINKENBEARD
DOCUMENTATION UNIT	REGINA SCRIVEN	DIVISION		STEVIE LONG (T)
FIRE BEHAVIOR ANALYST	BILL BAXTER 209-601-1017	DIVISION	Y	IAN LARKIN
HIRED EQUIP. TECH SPEC.	MATT SULLY/LEN NIELSON	DIVISION		MATT FURTADO (T)
COMPUTER TECH SPEC.	JOHN USREY			
CREW TECH SPEC.	KEVIN KEENE			
GIS TECHNICAL SPEC.	ELSA HUCKS			
GIS TECHNICAL SPEC.	ALBERT LAU			
TRAINING TECH SPEC.	JIM MOBLEY			
INCINET ADMINISTRATOR	ROY NAKAGAKI/MARK ROITZELL			
INCIDENT METEROROLOGIST	RYAN WALBRUN			
8. LOGISTICS SECTION				
CHIEF	KEN LOWE 530-448-2412			
DEPUTY	BREANNA BUCHANAN	e. AIR OPERATIONS BRANCH		
a. SUPPORT BRANCH		AIR OPERATIONS BR. DIR.	CHRIS AVINA	
SUPPLY UNIT	JIM VIERRA	AIR TACTICAL SUPERVISOR		
FACILITIES UNIT	GARRETT RADAVIDICH	AIR SUPPORT SUPERVISOR	MARK GRADEK	
GROUND SUPPORT UNIT	DAVE MCKOY	HELICOPTER COORDINATOR	WARREN PARISH	
ORDERING	KAREN VILLALOBOS	AIR TANKER COORDINATOR		
		10. FINANCE/ADMINISTRATION SECTION		
b. SERVICE BRANCH		CHIEF	VANCE MOULTON	
COMMUNICATIONS UNIT	KYLE JOHNSON	TIME UNIT	LESLIE MARG	
MEDICAL UNIT	BRIAN ROBBINS	PROCUREMENT UNIT	EVELYN GLENN	
FOOD UNIT	JESSE HANSCHILD	COMPENSATION/CLAIMS UNIT	JOE TAPIA	
MOTEL UNIT	RANDY FORD	COST UNIT	MARA ZAVER	



INCIDENT Weather Forecast



FORECAST NO: 1

NAME OF FIRE: Scotts

PREDICTION FOR: 0700-0700

UNIT: CA-MEU-006376

SHIFT DATE: 9/11-9/12/2012

SIGNED:

TIME AND DATE

FORECAST ISSUED: 2000 9/10/2012

Incident Meteorologist

WEATHER DISCUSSION: A thermal trough over the coastal range will produce light easterly winds over the fire site this morning...pushing any residual smoke towards Ukiah. By early afternoon winds will switch to westerly along the ridges with generally light slope winds dominating over the lower and mid slopes of Div A and Z. Main concerns will be warm to hot temperatures along with low humidity values that will impact fire behavior and bring hydration concerns into play for the crews. Westerly winds will ease by sunset with main concern tonight being thermal belts that will develop above 2500 feet with mild night time temperatures in the 60s and poor humidity recovery hovering between 30-40% most of the night.

WEATHER FORECAST For Tuesday:

WEATHER: Patchy smoke in the morning otherwise sunny. Continued hot and dry.

HIGH TEMPERATURES: Afternoon highs 85-90 degrees.

MIN HUMIDITY: Starting out around 30-40%...then lowering 15-20% in the afternoon.

20 FT WINDS:

RIDGETOP - Northeast to East 5 mph in the morning turning West 5-10 mph in the afternoon

SLOPE/VALLEY - Light and variable turning upslope 2-5 mph in the afternoon with gusts 8 mph.

STABILITY/INVERSION: Weak morning inversion over the fire will mix out by 11 am.

Forecast for Tuesday Night:

WEATHER: Patchy smoke. Otherwise clear and mild with poor RH recovery over most of the fire site.

MIN TEMPERATURES: Temperatures falling into the upper 50s lowest drainages to mid 60s on mid and upper slopes.

MAX HUMIDITY: Less than 30% through sunset then slowly recovering 35-40% by morning.

20 FT WINDS:

RIDGETOP - West 5-10 mph in the evening...turning North to Northeast 5 mph by morning.

SLOPE/VALLEY - Evening upslope 3-5 mph until sunset...then downslope 0-3 mph overnight.

STABILITY/INVERSION: Weak inversion setting up over the fire after sunset.

OUTLOOK FOR Wednesday through Friday: No significant weather changes forecast through the end of the week with high pressure over the region. If anything expect a few degrees of warming and drying each day. Winds will generally be light and from the East/Northeast at night along the ridges...turning Westerly 5-10 mph in the afternoon. Afternoon highs mid 80s to lower 90s. Afternoon RH to around 15% with poor night time recovery only around 30-40% for a few hours each morning.

FIRE BEHAVIOR FORECAST

FORECAST NUMBER: 3	TYPE OF FIRE: Wildland
FIRE NAME: Scotts	OPERATIONAL PERIOD: 9/11-12/2012 0700 to 0700
DATE ISSUED: 9/10/12	TIME ISSUED: 1900 Hours
UNIT: Mendocino	Crystal Henson FBAN-T

INPUTS

WEATHER SUMMARY: See Attached Spot Weather Forecast

- Max Temps 85-90
- Min RH's 15-20%
- Winds: Day time – Valley winds variable 4-8 mph. Ridgetop winds west 5-10 mph.
- Night Weather: Min Temps 58-65. Max RH 50% Valleys, 30% Ridgetops. Winds: Valley - West 3-8 mph becoming light and variable. Ridgetop - Northwest 5-10 becoming Southeast 4-8 mph.

GENERAL:

- The fuel bed will start out the day very dry due to the poor overnight RH recovery.
- The probability of ignition at the heat of the day will be 90%.
- The up-canyon winds in Scotts Creek Canyon will reduce the likelihood of the fire from pushing further south in the canyon (favorable wind conditions).
- Expect some of the unburned islands to burnout during the heat of the day.
- The fire will be mostly fuels/topography driven. Expect upslope hooking actions to advance the fire down into Scotts Creek Canyon.
- Anticipate the potential of mid-slope ignitions due to rollout.
- All fuels will be available to burn at peak (near historic ERC) conditions.
- The following chart represents calculated fire behavior parameters for current fuel conditions during peak burning conditions:

	(Rate of Spread)			(Flame Length)		
	Head Fire	Flanking	Backing	Head	Flanking	Backing
Grass/Oak-Woodland	60 ft/min	30 ft/min	3 ft/min	7-10 feet	6 feet	2 feet
Chaparral	120 ft/min	60 ft/min	8 ft/min	25-30 feet	20 feet	7 feet

- Expect poor nighttime RH recovery to continue with a possibility of active fire throughout the night in the upper half of the ridges.

SPECIFIC FIRE BEHAVIOR:

All Divisions except A & Z: Minimum fire active as aggressive mop-up continues.
 Div A & Z: Favorable wind conditions in the bottom of Scott Creek Canyon. Hooking action could create fuels/topography driven runs to the top of the ridge.

AIR OPERATIONS: No inversions expected. No limitations for aircraft.

SAFETY

The fuels are extremely dry and there are a number of unburned islands. Continue to have a heightened level of awareness especially when cutting line down hill. Always have an out.

SAFETY MESSAGE/PLAN

1. Incident Name:
SCOTTS INCIDENT CA-MEU-006376

2. Operational Period: Date From:09/11/2012 Date To:09/12/2012
Time From: 0700 Time To: 0700

3. Safety Message:

- Brief your crews on all the components of the IAP.
- Wear all of your Personnel Protective Equipment.
- Preplan escape routes, providing enough time for firefighters to move to Safety Zones.
- Drive with your headlights on at all times, follow all speed limits and traffic laws.
- Be aware of road conditions due to plastic culverts burned out under the road.
- Just as a reminder: uphill traffic has the right away.
- Always use a backer when backing emergency vehicles.
- Prevent dehydration by drinking frequently throughout each working hour. Drink plenty of water with meals; continue replacing fluids while off shift. Plan ahead: don't allow water to run out before resupplying.
- Fatigue - get adequate rest, proper hydration and nourishment.
- Maintain awareness of rattlesnakes, hornets and wasps.
- Be cautious of fire weakened or partially burned trees.

Remember LCES.

Lookout(s), Communication(s), Escape routes and Safety zone(s)

5. Prepared by: Name: Felix Berbena SOFR1(T)

Approved By Safety Officer:

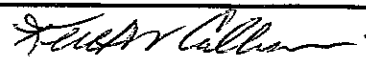

ICS 208

IAP Page 5

Date/Time: 09/10/2012 1800 hours

INCIDENT ACTION PLAN SAFETY ANALYSIS										Incident Name		Operational Period Date / Time					
										SCOTTS		09/11/12- 09/12/12 0700-0700					
Division/Group	LCES* Analysis of Tactical Applications Lookouts Communications Escape routes Safety zones								Other Risk Analysis								
	Downhill Fireline	Underslung Fireline	Indirect Fireline	Midslope Fireline	Frontal Assault	Anchor Points	Extreme Conditions (Spotting, Wind-driven)	Unburned Area	Snags	Narrow Dusty Roads	LCES Mitigations	Transportation 1 HR +	Communications	Structure Protection	Multi-Aircraft	Gardens	Other Risk Mitigations
BRN I																	
Z	X	X	X				X			Look Outs, Escape Routes, Safety Zones				X			Check in & out of Division
A	X	X	X				X	X		Stay informed of changes, Use FELB for for snags, Flag for avoidance	X			X			Drive Defensively
B		X					X		X	Situational Awareness, Communicate Hazards	X						
D										Roads Identified	X						Reduce Speed, Public Traffic
Roads									X								
BRN II																	
M								X	X	Fire weakened oaks							
P/Q		X	X				X			LCES				X			Briefings for Aircraft
Y			X						X	Cold Trail Islands							
Prepared by (Name and Position)										Date and Time:							
Felix Berbera SOFR1 (T)										09/10/12 1900							

Felix m Berbera

DIVISION ASSIGNMENT LIST			1. Branch I	2. Division/Group Z	Latitude/ Longitude		
3. Incident Name SCOTTS			4. Operational Period Date: 9/11/12 - 9/12/12 Time: 0700-0700				
5. Operations Personnel							
Operations Chief	Dave Russell (Day) Mark Kendall (Night)			Branch	Eric Johnson		
Deputy	Jim Ferguson						
Safety Officer	Alan Sherer			Division/Group Supervisor	Steven Hewlett		
6. Resources Assigned this Period							
Strike Team/Task Force/ Resource Designator	Leader	Number Persons	Trans. Needed	Drop Off PT./Time	Pick Up PT./Time	On Line	Off Line
STC SCU 9162C	Mike Martin	17	N	DP-10/0800	DP-10/0800	<input type="checkbox"/>	<input type="checkbox"/>
STC XSO 2350C	Jeff Ryder	20	N			<input type="checkbox"/>	<input type="checkbox"/>
STC XCC 2040C	Sean Perkins	20	N			<input type="checkbox"/>	<input type="checkbox"/>
STG TGU 9255G	Don Graham	36	N			<input type="checkbox"/>	<input type="checkbox"/>
STG TUU 9472G	Frankie Villani	33	N			<input type="checkbox"/>	<input type="checkbox"/>
STG TCU 9481G	Sam Cousins	31	N			<input type="checkbox"/>	<input type="checkbox"/>
STL LNU 9149L	Sheply Schroth-Cary	6	N			<input type="checkbox"/>	<input type="checkbox"/>
STL TGU 9250L	Jason Morris	5	N			<input type="checkbox"/>	<input type="checkbox"/>
STL FKU 9438L	William Schaal	5	N			<input type="checkbox"/>	<input type="checkbox"/>
WT PVT E-101 Alans	Alan Wharff	2	N			<input type="checkbox"/>	<input type="checkbox"/>
WT PVT E-102 All Star	Greg Sandling	2	N			<input type="checkbox"/>	<input type="checkbox"/>
EXC TBA			N			<input type="checkbox"/>	<input type="checkbox"/>
EXC TBA			N			<input type="checkbox"/>	<input type="checkbox"/>
7. Control Operations Complete direct line around islands. Hold existing line. Mop up 300 feet and patrol.							
8. Special Instructions Backhaul garbage to drop points. Maintain positive contact with public and local residents. FOBS will be working in all branches. Utilize back-pumps where appropriate for mop up.							
9. Division/Group Communication Summary							
Function	Frequency	System	Channel	Function	Frequency	System	Channel
Command	CDF COMMAND 2 TONE 1,7,16	King NIFC	151.2650 Rx 159.3300 Tx	Logistics		King NIFC	
Tactical Div/Group	VFIRE 26	King NIFC	154.3025 Rx 154.3025 Tx	Air to Ground	CDF TAC 14	King NIFC	159.2250 Rx 159.2250 Tx
Prepared by (Resource Unit Ldr.) Ralph Gladwin			Approved by (Planning Sect. Ch.) Jon Lovie <i>JL</i>		Date 9/10/12		Time 2100

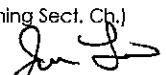
DIVISION ASSIGNMENT LIST		1. Branch I	2. Division/Group A	Latitude/ Longitude					
3. Incident Name SCOTTS		4. Operational Period Date: 9/11/12 - 9/12/12 Time: 0700-0700							
5. Operations Personnel									
Operations Chief	Dave Russell (Day) Mark Kendall (Night)		Branch		Eric Johnson				
Deputy	Jim Ferguson								
Safely Officer	Alan Sherer		Division/Group Supervisor		Mark Higgins				
6. Resources Assigned this Period									
Strike Team/Task Force/ Resource Designator	Leader	Number Persons	Trans. Needed	Drop Off PT./Time		Pick Up PT./Time		On Line	Off Line
STC SLU 9341C	James Tully	16	N	DP-1/0800		DP-1/0800		<input type="checkbox"/>	<input type="checkbox"/>
STC XSN 2382C	Jeff Holden	21	N					<input type="checkbox"/>	<input type="checkbox"/>
STC XMR 2142C	Brian McCarthy	20	N					<input type="checkbox"/>	<input type="checkbox"/>
STG BDU 9373G	David Nish	33	N					<input type="checkbox"/>	<input type="checkbox"/>
STG AEU 9274G	Michael Gundry	36	N					<input type="checkbox"/>	<input type="checkbox"/>
STG TGU 9258G	Stacer Hartshorn	35	N					<input type="checkbox"/>	<input type="checkbox"/>
STL SLU 9347L	Charlie Miller	6	N					<input type="checkbox"/>	<input type="checkbox"/>
DOZ TGU 2542	Kevin Oliver	3	N					<input type="checkbox"/>	<input type="checkbox"/>
DOZ PVT E-55 Fireline	Dan Larue	2	N					<input type="checkbox"/>	<input type="checkbox"/>
WT PVT E-38 Rosco	Ross Mayfield	2	N					<input type="checkbox"/>	<input type="checkbox"/>
WT PVT E-107 Wildfire	Ryan Braun	1	N					<input type="checkbox"/>	<input type="checkbox"/>
WT PVT E-151 Stuart	Mark Stuart	1	N					<input type="checkbox"/>	<input type="checkbox"/>
WT PVT E-152 Algerine	Greg Riedel	1	N					<input type="checkbox"/>	<input type="checkbox"/>
7. Control Operations Construct direct handline around islands. Hold existing line. Mop up 300 feet and patrol.									
8. Special Instructions Bold resources are on 12 hour shifts. Backhaul garbage to drop points. Maintain positive contact with public and local residents. FOBS will be working in all branches. Utilize back-pumps where appropriate for mop up.									
9. Division/Group Communication Summary									
Function	Frequency	System	Channel	Function	Frequency	System	Channel		
Command	CDF COMMAND 2 TONES 1, 7, 16	King NIFC	151.2650 Rx 159.3300 Tx	Logistics		King NIFC			
Tactical Div/Group	CDF TAC 1	King NIFC	151.1450 Rx 151.1450 Tx	Air to Ground	CDF TAC 14	King NIFC	159.2250 Rx 159.2250 Tx		
Prepared by (Resource Unit Ldr.) Ralph Gladwin		Approved by (Planning Sect. Ch.) Jon Lovie 			Date 9/10/12		Time 2100		

DIVISION ASSIGNMENT LIST		1. Branch I	2. Division/Group A	Latitude/ Longitude			
3. Incident Name SCOTTS		4. Operational Period Date: 9/11/12 - 9/12/12				Time: 0700-0700	
5. Operations Personnel							
Operations Chief	Dave Russell (Day) Mark Kendall (Night)		Branch		Eric Johnson		
Deputy	Jim Ferguson						
Safety Officer	Alan Sherer		Division/Group Supervisor		Mark Higgins		
6. Resources Assigned this Period							
Strike Team/Task Force/ Resource Designator	Leader	Number Persons	Trans. Needed	Drop Off PT./Time	Pick Up PT./Time	On Line	Off Line
DOZB	Jason Bondshu	1	N	DP-1/0800	DP-1/0800	<input type="checkbox"/>	<input type="checkbox"/>
DOZB	Natthan Baxter (T)	1	N			<input type="checkbox"/>	<input type="checkbox"/>
FALC	Michael Moen	1	N			<input type="checkbox"/>	<input type="checkbox"/>
FALC	Colter Holleman	1	N			<input type="checkbox"/>	<input type="checkbox"/>
FALC	Don Keck	1	N			<input type="checkbox"/>	<input type="checkbox"/>
						<input type="checkbox"/>	<input type="checkbox"/>
						<input type="checkbox"/>	<input type="checkbox"/>
						<input type="checkbox"/>	<input type="checkbox"/>
						<input type="checkbox"/>	<input type="checkbox"/>
						<input type="checkbox"/>	<input type="checkbox"/>
						<input type="checkbox"/>	<input type="checkbox"/>
						<input type="checkbox"/>	<input type="checkbox"/>
						<input type="checkbox"/>	<input type="checkbox"/>
						<input type="checkbox"/>	<input type="checkbox"/>
8. Control Operations Construct direct handline around islands. Hold existing line. Mop up 300 feet and patrol.							
8. Special Instructions Backhaul garbage to drop points. Maintain positive contact with public and local residents. FOBS will be working in all branches. Utilize back-pumps where appropriate for mop up.							
9. Division/Group Communication Summary							
Function	Frequency	System	Channel	Function	Frequency	System	Channel
Command	CDF COMMAND 2 TONES 1, 7, 16	King NIFC	151.2650 Rx 159.3300 Tx	Logistics		King NIFC	
Tactical Div/Group	CDF TAC 1	King NIFC	151.1450 Rx 151.1450 Tx	Air to Ground	CDF TAC 14	King NIFC	159.2250 Rx 159.2250 Tx
Prepared by (Resource Unit Ldr.) Ralph Gladwin		Approved by (Planning Sect. Ch.) Jon Lovie			Date 9/10/12		Time 2100

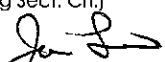
DIVISION ASSIGNMENT LIST		1. Branch I	2. Division/Group B	Latitude/ Longitude			
3. Incident Name SCOTTS		4. Operational Period Date: 9/11/12 - 9/12/12 Time: 0700-0700					
5. Operations Personnel							
Operations Chief	Dave Russell (Day) Mark Kendall (Night)		Branch		Eric Johnson		
Deputy	Jim Ferguson						
Safety Officer	Alan Sherer		Division/Group Supervisor		Kevin Dixon		
6. Resources Assigned this Period							
Strike Team/Task Force/ Resource Designator	Leader	Number Persons	Trans. Needed	Drop Off PT./Time	Pick Up PT./Time	On Line	Off Line
STC MVU 9330C	Nicholas Schuler	17	N	DP-1/0800	DP-1/0800	<input type="checkbox"/>	<input type="checkbox"/>
STC XYO 4277C	Gary Seabold	18	N			<input type="checkbox"/>	<input type="checkbox"/>
STG LAC 1173G	Bernard Deyo	31	N			<input type="checkbox"/>	<input type="checkbox"/>
CRW LNU KON 1	Rion Allbaugh	13	N			<input type="checkbox"/>	<input type="checkbox"/>
STL LNU 9142L	Paul Franklin	4	N			<input type="checkbox"/>	<input type="checkbox"/>
DOZ PVT E-54 Wylatti	Brain Hurt	2	N			<input type="checkbox"/>	<input type="checkbox"/>
DOZ PVT E-57 Tehama		2	N			<input type="checkbox"/>	<input type="checkbox"/>
DOZ PVT E-58 Milsaps	Mike Milsaps	2	N			<input type="checkbox"/>	<input type="checkbox"/>
DOZ PVT E-22 RVG	Mel Ford	2	N			<input type="checkbox"/>	<input type="checkbox"/>
WT PVT E-16 Floodgate	Butch Paula	2	N			<input type="checkbox"/>	<input type="checkbox"/>
WT PVT E-17 Orsi Fire	Tony Orsi	2	N			<input type="checkbox"/>	<input type="checkbox"/>
WT PVT E-105 Marymee	Jack Marymee	2	N			<input type="checkbox"/>	<input type="checkbox"/>
WT PVT E-171 All Agency	Doug Hill	2	N			<input type="checkbox"/>	<input type="checkbox"/>
EXC TBA			N			<input type="checkbox"/>	<input type="checkbox"/>
7. Control Operations Construct direct handline around islands. Hold existing line. Mop up 300 feet and patrol.							
8. Special Instructions Backhaul garbage to drop points. Maintain positive contact with public and local residents. FOBS will be working in all branches. Utilize back-pumps where appropriate for mop up.							
9. Division/Group Communication Summary							
Function	Frequency	System	Channel	Function	Frequency	System	Channel
Command	CDF COMMAND 2 TONES 1, 7, 16	King NIFC	151.2650 Rx 159.3300 Tx	Logistics		King NIFC	
Tactical Div/Group	CDF TAC 4	King NIFC	151.1900 Rx 151.1900 Tx	Air to Ground	CDF TAC 14	King NIFC	159.2250 Rx 159.2250 Tx
Prepared by (Resource Unit Ldr.) Ralph Gladwin		Approved by (Planning Sect. Ch.) Jon Lovie 			Date 9/10/12		Time 2100

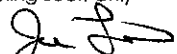
DIVISION ASSIGNMENT LIST		1. Branch I	2. Division/Group D	Latitude/ Longitude			
3. Incident Name SCOTTS		4. Operational Period Date: 9/11/12 - 9/12/12 Time: 0700-0700					
5. Operations Personnel							
Operations Chief	Dave Russell (Day) Mark Kendall (Night)		Branch		Eric Johnson		
Deputy	Jim Ferguson						
Safety Officer	Alan Sherer		Division/Group Supervisor		Gordon Dulcich		
6. Resources Assigned this Period							
Strike Team/Task Force/ Resource Designator	Leader	Number Persons	Trans. Needed	Drop Off PT./Time	Pick Up PT./Time	On Line	Off Line
STC XAL 2007C	Ronnie Oatis	22	N	DP-2/0800	DP-2/0800	<input type="checkbox"/>	<input type="checkbox"/>
WT PVT E-100 Big R	Richard Garrett	2	N	DP-2/0800	DP-2/0800	<input type="checkbox"/>	<input type="checkbox"/>
						<input type="checkbox"/>	<input type="checkbox"/>
						<input type="checkbox"/>	<input type="checkbox"/>
						<input type="checkbox"/>	<input type="checkbox"/>
						<input type="checkbox"/>	<input type="checkbox"/>
						<input type="checkbox"/>	<input type="checkbox"/>
						<input type="checkbox"/>	<input type="checkbox"/>
						<input type="checkbox"/>	<input type="checkbox"/>
						<input type="checkbox"/>	<input type="checkbox"/>
						<input type="checkbox"/>	<input type="checkbox"/>
						<input type="checkbox"/>	<input type="checkbox"/>
						<input type="checkbox"/>	<input type="checkbox"/>
7. Control Operations Hold existing line. Mop up 300 feet and patrol.							
8. Special Instructions Backhaul garbage to drop points. Maintain positive contact with public and local residents. FOBS will be working in all branches.							
9. Division/Group Communication Summary							
Function	Frequency	System	Channel	Function	Frequency	System	Channel
Command	CDF COMMAND 2 TONES 1, 7, 16	King	151.2650 Rx	Logistics		King	
		NIFC	159.3300 Tx			NIFC	
Tactical Div/Group	VFIRE 24	King	154.2725 Rx	Air to Ground	CDF TAC 14	King	159.2250 Rx
		NIFC	154.2725 Tx			NIFC	159.2250 Tx
Prepared by (Resource Unit Ldr.) Ralph Gladwin		Approved by (Planning Sect. Ch.) Jon Lovie 			Date 9/10/12		Time 2100

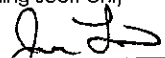
DIVISION ASSIGNMENT LIST		1. Branch I	2. Division/Group Roads Group	Latitude/ Longitude			
3. Incident Name SCOTTS		4. Operational Period Date: 9/11/12 - 9/12/12 Time: 0700-0700					
5. Operations Personnel							
Operations Chief	Dave Russell (Day) Mark Kendall (Night)		Branch		Eric Johnson		
Deputy	Jim Ferguson						
Safety Officer	Alan Sherer		Division/Group Supervisor		Angelo Prandini		
6. Resources Assigned this Period							
Strike Team/Task Force/ Resource Designator	Leader	Number Persons	Trans. Needed	Drop Off PT./Time	Pick Up PT./Time	On Line	Off Line
GRD PVT E-169 Lemuel	Logan Pearson	1	N	Mill Creek/Gravel Road/0800	Mill Creek/Gravel Road/0800	<input type="checkbox"/>	<input type="checkbox"/>
WT PVT E-96 Beebe	Don Hunt	1	N	↓	↓	<input type="checkbox"/>	<input type="checkbox"/>
WT PVT E-161 Lenahans	Chuck Hughes	2	N	↓	↓	<input type="checkbox"/>	<input type="checkbox"/>
WT PVT E-154 Lenahans	Dee Holmes	2	N	↓	↓	<input type="checkbox"/>	<input type="checkbox"/>
WT PVT E-153 T&S	Bob Fordy	3	N	↓	↓	<input type="checkbox"/>	<input type="checkbox"/>
						<input type="checkbox"/>	<input type="checkbox"/>
						<input type="checkbox"/>	<input type="checkbox"/>
						<input type="checkbox"/>	<input type="checkbox"/>
						<input type="checkbox"/>	<input type="checkbox"/>
						<input type="checkbox"/>	<input type="checkbox"/>
						<input type="checkbox"/>	<input type="checkbox"/>
						<input type="checkbox"/>	<input type="checkbox"/>
						<input type="checkbox"/>	<input type="checkbox"/>
7. Control Operations Repair Mill Creek Road from BLM station to Drop Point 1 in Branch I.							
8. Special Instructions Bold resources are on 12 hour shifts. Notify Division Supervisor when entering and leaving Divisions. Backhaul garbage to drop points. Maintain positive contact with public and local residents. FOBS will be working in all branches.							
9. Division/Group Communication Summary							
Function	Frequency	System	Channel	Function	Frequency	System	Channel
Command	CDF COMMAND 2 TONES 1, 7, 16	King NIFC	151.2650 Rx 159.3300 Tx	Logistics		King NIFC	
Tactical Div/Group	VTAC 14	King NIFC	159.4725 Rx 159.4725 Tx	Air to Ground	CDF TAC 14	King NIFC	159.2250 Rx 159.2250 Tx
Prepared by (Resource Unit Ldr.) Ralph Gladwin		Approved by (Planning Sect. Ch.) Jon Lovie 			Date 9/10/2012		Time 2100

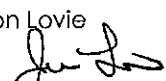
DIVISION ASSIGNMENT LIST		1. Branch II	2. Division/Group M	Latitude/ Longitude			
3. Incident Name SCOTTS		4. Operational Period Date: 9/11/12 - 9/12/12				Time: 0700-0700	
5. Operations Personnel							
Operations Chief	Dave Russell (Day) Mark Kendall (Night)		Branch		Erich Schwab		
Deputy	Jim Ferguson						
Safely Officer	Mike Watner		Division/Group Supervisor		Randy Castro		
6. Resources Assigned this Period							
Strike Team/Task Force/ Resource Designator	Leader	Number Persons	Trans. Needed	Drop Off PT./Time	Pick Up PT./Time	On Line	Off Line
STC XNE 4104C	Clint Carson	16	N	DP-4/0800	DP-4/0800	<input type="checkbox"/>	<input type="checkbox"/>
ENG LNU 1471	Joe Petersen	5	N			<input type="checkbox"/>	<input type="checkbox"/>
ENG LNU 1481	Garrett White	3	N			<input type="checkbox"/>	<input type="checkbox"/>
ENG MEU 1167	Michael Aiello	3	N			<input type="checkbox"/>	<input type="checkbox"/>
ENG MEU 1182	Eric Bettger	3	N			<input type="checkbox"/>	<input type="checkbox"/>
ENG MEU 1192	Carl Logan	3	N			<input type="checkbox"/>	<input type="checkbox"/>
WT PVT E-99 49er	Jess Sander	2	N			<input type="checkbox"/>	<input type="checkbox"/>
WT PVT E-172 All Agency	John Hill	2	N			<input type="checkbox"/>	<input type="checkbox"/>
FEMT	Robert Karnow	1	N	↓	↓	<input type="checkbox"/>	<input type="checkbox"/>
						<input type="checkbox"/>	<input type="checkbox"/>
						<input type="checkbox"/>	<input type="checkbox"/>
						<input type="checkbox"/>	<input type="checkbox"/>
7. Control Operations Hold existing line. Mop up 300 feet and patrol.							
8. Special Instructions Bold resource is on a 12 hour shift. Backhaul garbage to drop points. Maintain positive contact with public and local residents. FOBS will be working in all branches.							
9. Division/Group Communication Summary							
Function	Frequency	System	Channel	Function	Frequency	System	Channel
Command	CDF COMMAND 2 TONE 1,7,16	King NIFC	151.2650 Rx 159.3300 Tx	Logistics		King NIFC	
Tactical Div/Group	VTAC 13	King NIFC	158.7375 Rx 158.7375 Tx	Air to Ground	CDF TAC 14	King NIFC	159.2250 Rx 159.2250 Tx
Prepared by (Resource Unit Ldr.) Ralph Gladwin			Approved by (Planning Sect. Ch.) Jon Lovie 		Date 9/10/12		Time 2100

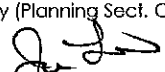
DIVISION ASSIGNMENT LIST		1. Branch II	2. Division/Group P/Q	Latitude/ Longitude			
3. Incident Name SCOTTS		4. Operational Period Date: 9/11/12 - 9/12/12 Time: 0700-0700					
5. Operations Personnel							
Operations Chief	Dave Russell (Day) Mark Kendall (Night)		Branch	Erich Schwab			
Deputy	Jim Ferguson						
Safety Officer	Mike Watner		Division/Group Supervisor	Jarrod Clinkenbeard / Stevie Long (T)			
6. Resources Assigned this Period							
Strike Team/Task Force/ Resource Designator	Leader	Number Persons	Trans. Needed	Drop Off PT./Time	Pick Up PT./Time	On Line	Off Line
STC XSN 2383C	Rick Blackmon	16	N	DP-7/0800	DP-7/0800	<input type="checkbox"/>	<input type="checkbox"/>
STC XSJ 4177C	Terry Pinheiro	17	N			<input type="checkbox"/>	<input type="checkbox"/>
STG HUU 9126G	John Lentz	30	N			<input type="checkbox"/>	<input type="checkbox"/>
STG AEU 9275G	Kevin Bohall	34	N			<input type="checkbox"/>	<input type="checkbox"/>
STL SKU 9262L	Kurt Ohlau	5	N			<input type="checkbox"/>	<input type="checkbox"/>
DOZ PVT E-25 Ingram		2	N			<input type="checkbox"/>	<input type="checkbox"/>
WT PVT E-103 Pro Dump	Charles Claybon	2	N			<input type="checkbox"/>	<input type="checkbox"/>
WT PVT E-104 Tehama	Al Torres	2	N			<input type="checkbox"/>	<input type="checkbox"/>
WT PVT E-106 Gamma	Mark Williams	2	N			<input type="checkbox"/>	<input type="checkbox"/>
						<input type="checkbox"/>	<input type="checkbox"/>
						<input type="checkbox"/>	<input type="checkbox"/>
						<input type="checkbox"/>	<input type="checkbox"/>
						<input type="checkbox"/>	<input type="checkbox"/>
7. Control Operations Construct direct handline around islands. Hold and improve existing line. Mop up 300 feet and patrol.							
8. Special Instructions Bold resource is on a 12 hour shift. Backhaul garbage to drop points. Maintain positive contact with public and local residents. FOBS will be working in all branches.							
9. Division/Group Communication Summary							
Function	Frequency	System	Channel	Function	Frequency	System	Channel
Command	CDF COMMAND 2 TONE 1,7,16	King NIFC	151.2650 Rx 159.3300 Tx	Logistics		King NIFC	
Tactical Div/Group	VFIRE 25	King NIFC	154.2875 Rx 154.2875 Tx	Air to Ground	CDF TAC 14	King NIFC	159.2250 Rx 159.2250 Tx
Prepared by (Resource Unit Ldr.) Ralph Gladwin			Approved by (Planning Sect. Ch.) Jon Lovie 		Date 9/10/12	Time 2100	

DIVISION ASSIGNMENT LIST			1. Branch II	2. Division/Group Y	Latitude/ Longitude		
3. Incident Name SCOTTS			4. Operational Period Date: 9/11/12 - 9/12/12 Time: 0700-0700				
5. Operations Personnel							
Operations Chief		Dave Russell (Day) Mark Kendall (Night)		Branch		Erich Schwab	
Deputy		Jim Ferguson					
Safety Officer		Mike Watner		Division/Group Supervisor		Ian Larkin / Matt Furtado (T)	
6. Resources Assigned this Period							
Strike Team/Task Force/ Resource Designator	Leader	Number Persons	Trans. Needed	Drop Off PT./Time	Pick Up PT./Time	On Line	Off Line
STC HUU 9120C	Kevan Fox	17	N	DP-7/0800	DP-7/0800	<input type="checkbox"/>	<input type="checkbox"/>
STC XLK 2101C	James Dowdy	16	N			<input type="checkbox"/>	<input type="checkbox"/>
STG HUU 9122G	Kurt McCray	32	N			<input type="checkbox"/>	<input type="checkbox"/>
WT PVT E-97 49er	Dick Sasser	2	N			<input type="checkbox"/>	<input type="checkbox"/>
WT PVT E-98 49er	Bob Mergl	2	N			<input type="checkbox"/>	<input type="checkbox"/>
						<input type="checkbox"/>	<input type="checkbox"/>
						<input type="checkbox"/>	<input type="checkbox"/>
						<input type="checkbox"/>	<input type="checkbox"/>
						<input type="checkbox"/>	<input type="checkbox"/>
						<input type="checkbox"/>	<input type="checkbox"/>
						<input type="checkbox"/>	<input type="checkbox"/>
						<input type="checkbox"/>	<input type="checkbox"/>
						<input type="checkbox"/>	<input type="checkbox"/>
7. Control Operations Hold existing line. Mop up 300 feet and patrol.							
8. Special Instructions Backhaul garbage to drop points. Maintain positive contact with public and local residents. FOBS will be working in all branches.							
9. Division/Group Communication Summary							
Function	Frequency	System	Channel	Function	Frequency	System	Channel
Command	CDF COMMAND 2 TONE 1,7,16	King NIFC	151.2650 Rx 159.3300 Tx	Logistics		King NIFC	
Tactical Div/Group	CDF TAC 20	King NIFC	159.3750 Rx 159.3750 Tx	Air to Ground	CDF TAC 14	King NIFC	159.2250 Rx 159.2250 Tx
Prepared by (Resource Unit Ldr.) Ralph Gladwin			Approved by (Planning Sect. Ch.) Jon Lovie 		Date 9/10/12	Time 2100	

AIR OPERATIONS SUMMARY

(Expanded Form for Large Operations)

OPERATIONAL PERIOD DATE: DAY SHIFT DATE: 09/11/2012

START: 0830 END: 1856

1. INCIDENT NAME: Scotts		2. PREPARED BY: C. Avina		PREPARED DATE/TIME: 09/10/2012 1800 Hrs		3.	
4. REMARKS (Safety Notes, Hazards, Air Operations Special Equipment, etc.):							
**Avoid aerial application of retardant or foam within 300' of waterways, bodies of water. If retardant is dropped within these areas, notify AOBBD with Lat & Long, est. of gallons, and a map. Lampton Field closed to General Aviation. Hazards: Towers at ridge top on the South end of fire. Power line west of Blue Lakes							
5. TFR 7 NM				Altitude 8000 MSL			
39 08.30				123 03.00			

6. PERSONNEL	Phone	7. REQUENCIES	AM	FM	8. FIXED-WING # Avail / Type/ Make-Model / FAA N# / Base(s)
AOBD: Garrett Sjound (T)	916 747-3119	AIR/AIR FW:	119.4250	167.1500	Air Tactical
AOBD: Chris Avina	916 261-2942	AIR/AIR RW:	119.4250		Lead planes
HICO: Burrough, Aaron	916-949-9868	AIR/GROUND:		159.2250CDF Tac 14/ Tn 16	
ASGS: Gradek, Mark	707-696-3579	DECK:	163.100		Airtankers
HEBM: Bradshaw Greg	949-887-2841	COMMAND RPT	Command 2/ Tone 7		
HEMB		Air Guard	Unicom 122.8	168.625	Other : Scott Helibase 4581 Highland Springs
		TOLC			38 59.323 122 53.687

9. HELICOPTERS (Use Additional Sheets As Necessary)

FAA N#	TY	MAKE/MODL	BASE	AVAIL	START	REMARKS	FAA N#	TY	MAKE/MODL	BASE	AVAIL	START	REMARKS
68U	2	S-58	Scotts	0800	0830		92CH	1	BV-107	Scotts	0800	0830	
102/902	2	Super Huey	Scotts	0800	0830	Medivac/Short Haul							
209PJ	2	Huey	Scotts	0800	0830								
205SJ	2	Huey	Scotts	0800	0830								
88B	3	Jet Ranger	Scotts	0800	0830								
91SG	3	Jet Ranger	Scotts	0800	0830								

INCIDENT RADIO COMMUNICATIONS PLAN

Incident Name		Date/Time Prepared		Operational Period Date/Time					
SCOTTS		9/10/2012 2000		9/11/12 - 9/12/12 0700 - 0700					
Ch #	Function	Channel Name/Trunked Radio System Talkgroup	Assignment	RX Freq N or W	RX Tone/NAC	TX Freq N or W	Tx Tone/NAC	Mode A, D or M	Remarks
1	Command	CDF C2	All Branches	151.2650 N	103.5 (8)	159.3300 N	110.9 (1)	A	Tone 1
2	Command	CDF C2	All Branches	151.2650 N	103.5 (8)	159.3300 N	167.9 (7)	A	Tone 7
3	Command	CDF C2	All Branches	151.2650 N	103.5 (8)	159.3300 N	192.8 (16)	A	Tone 16
4									
5	Alt. Command	NIFC C4	All Branches	166.6125 N		168.4000 N	107.2 (10)	A	
6	Tactical	VFIRE 26	Branch I Div Z	154.3025 N		154.3025 N	156.7 (6)	A	
7	Tactical	CDF Tac 1	Branch I Div A	151.1450 N	192.8 (16)	151.1450 N	192.8 (16)	A	
8	Tactical	CDF Tac 4	Branch I Div B	151.1900 N	192.8 (16)	151.1900 N	192.8 (16)	A	
9	Tactical	VFIRE 24	Branch I Div D	154.2725 N		154.2725 N	156.7 (6)	A	
10	Tactical	VTAC 14	Branch I	159.4725 N		159.4725 N	156.7 (6)	A	Road Group
11	Tactical	VTAC 13	Branch II Div M	158.7375 N		158.7375 N	156.7 (6)	A	
12	Tactical	VFIRE 25	Branch II Div P/Q	154.2875 N		154.2875 N	156.7 (6)	A	
13	Tactical	CDF Tac 20	Branch II Div Y	159.3750 N	192.8 (16)	159.3750 N	192.8 (16)	A	
14	Air to Ground	CDF Tac 14	All Branches	159.2250 N	192.8 (16)	159.2250 N	192.8 (16)		
15	EMS	CALCORD	All Branches	156.0750 N		156.0750 N		A	EMS on Incident
16	Emergency	Air Guard	All Branches	168.6250 N		168.6250 N	110.9 (1)	A	EMERGENCIES ONLY
17									
18									
19									
20	Emergency	Air Guard	All Branches	168.6250 N		168.6250 N	110.9 (1)	A	EMERGENCIES ONLY

Prepared By (Communications Unit) *Paul R. Johnson COM*

Incident Location
 County Lake State CA Latitude N Longitude W

The convention calls for frequency lists to show four digits after the decimal place, followed by either an "N" or a "W", depending on whether the frequency is narrow or wide band. Mode refers to either "A" or "D" indicating analog or digital (e.g. Project 25) or "M" indicating mixed mode. All channels are shown as if programmed in a control station, mobile or portable radio. Repeater and base stations must be programmed with the Rx and Tx reversed.

MEDICAL PLAN ICS 206	1. INCIDENT NAME SCOTTS FIRE	2. DATE PREPARED 9/9/2012	3. TIME PREPARED 1900	4. OPERATIONAL PERIOD 9/10/2012 – 9/11/2012 0700-0700
---------------------------------------	--	------------------------------	--------------------------	---

5. INCIDENT MEDICAL AID STATIONS

MEDICAL AID STATIONS	LOCATION	Nurse	
		YES	NO
MERT	Incident Base Camp	X	

6. TRANSPORTATION

A. AMBULANCE SERVICES

NAME	LOCATION	PHONE	PARAMEDICS	
			YES	NO
CAL STAR (AIR)	Ukiah	800-252-5050	X	
Reach (AIR)	Lakeport	800-338-4045	X	
Lakeport Fire Dept.	Lakeport	707-263-4396	X	
Kelseyville Ambulance	Kelseyville	707-279-4268	X	

B. INCIDENT AMBULANCES

NAME	LOCATION	PARAMEDICS	
		YES	NO
Medic 8011	DP-1	X	
Medic 5514	DP-7 /Kelly Camp Ground	X	

7. HOSPITALS

NAME	ADDRESS	TRAVEL TIME		PHONE	HELIPAD		BURN CENTER	
		AIR	GRND		YES	NO	YES	NO
Med Net Channel								
Sutter Lakeside Hospital	5176 Hill Rd. East Lakeport	2	15	707-262-5000	X			
Santa Rosa Memorial	1165 Montgomery Drive	20	90	707-546-3210	X			
UC Davis Med Center	2315 Stockton Blvd. Sacramento	25	150	916-734-2011	X		X	
St.Helena Clearlake	15630 18 th Avenue Clearlake,CA	15	35	707-994-6486	X			

8. MEDICAL EMERGENCY PROCEDURES

EMERGENCY FREQUENCY: CALCORD

LINE EMERGENCY:
Crew Supervisor will contact Division Supervisor with patient complaint/condition and location.

- Division/Group Supervisor contacts:
 - Closest EMS resource
 - Communications Unit
- Communications Unit contacts:
 - Ground or Air ambulance as requested
 - Operations
 - Safety
 - Medical Unit
- Division Supervisor or designee will serve as point of contact and run medical emergency on assigned channel.
 - A pre-assigned tactical frequency (i.e. CALCORD) should be used for IWI and only for duration of need.
- Communications Unit will clear command channel for emergency traffic as needed and only for duration of need.

CAMP EMERGENCY:
Contact Medical Unit with patient complaint/condition and location. Medical Staff will respond to stabilize incident:

- Medical Unit contacts:
 - Communications
 - Safety
 - Logistics
 - Operations
 - Crew Supervisor
 - Comps/Claims

INJURY REPORTING PROCEDURES

NATURE OF INJURY _____
 LOCATION OF PATIENT _____
 POINT OF CONTACT _____
 TRANSPORTATION REQUESTED BY: AIR ___ GROUND ___
 POINT OF PICKUP _____
 LAT _____ LONG _____
 PATIENT UNIT ID _____
 IS AN EMT WITH PATIENT: YES ___ NO ___
 AGE _____
 SEX: MALE ___ FEMALE ___

**ALL EMERGENCIES---Secure the area
and identify witnesses for later
investigation. Keep an accurate log of
events.**

ICS 206 (Rev 03/12)	9. PREPARED BY: (Medical Unit Leader) Fred Orsborn	10. REVIEWED BY: (Safety Officer) 
-------------------------------	---	---

A message from the Training Specialist

Please DO NOT wait until the end of the incident to complete your training paperwork. If you are a trainee or you have been mentoring a trainee please stop by and see me in the Check-In Building as soon as possible.

You may also call me at:

Jim Mobley 530-941-2129

Thank you for helping me to help you!!!



**Archaeological and Historic Properties:
Fireline Guidance for the Scotts Creek Fire
Lake County**

**Do not compromise safety for the protection and preservation of archaeological and historic properties.
When possible and prudent:**

1. Be on the lookout for prehistoric and historic archaeological sites. These sites typically occur adjacent to streams and springs but can occur in other areas as well. The most common indicators of prehistoric sites in this area are scatters of shiny black obsidian flakes from tool making activities and dark midden soils. Historic sites include homesteads that contain foundations, rock chimneys, and stone / brick-lined wells. Historic mining sites are possible as well.
2. Known sites will be flagged with red plastic flagging tape. Note, that much of the area has never been surveyed for archaeological resources and many sites out there have yet to be discovered.
3. If you observe archaeological resources, flagged or unflagged, attempt to avoid with ground disturbing activities altogether.
4. If avoidance is not possible, minimize ground disturbance. Use a hand crew rather than a dozer to remove fuels from control lines that must cross site areas if possible.
5. Leave all artifacts in place as some may have been intentionally placed for religious or ceremonial reasons.
6. Note locations of discovered resources on a map. Better yet take site coordinates with a GPS. Leave information for the archaeologist with the Plans Unit so that the sites can be relocated and protected during Fire Suppression Repair. Flag the site in red if possible.
7. If you encounter a burial or other human remains, cease work in that area and contact the archaeologist immediately.

Your help preserving California's non-renewable cultural resources is appreciated.

Richard Jenkins
CAL FIRE Northern Region Archaeologist
Cell Phone: (530) 949-8822

Christopher Lloyd
BLM Ukiah Field Office
Archaeologist
Office Phone: (707) 468-4075

"Scotts" Incident Fire Suppression Repair Plan

I. Objectives

The objective of the Suppression Repair Plan is to mitigate possible adverse effects to resources resulting from fire suppression activities on the Scotts Fire in a manner which does not compromise firefighter safety. The mitigations described within this plan have been developed to apply to constructed fire lines, watercourse crossings, access roads, drop points, heli-spots and any other locations disturbed by fire suppression activities. A Repair Specialist will be assigned to ensure that work is done as required and according to the Emergency Fire Suppression Repair Plan. Additional specialists or equipment may be used if the need arises. Specialists will release equipment from the area when their work is completed.

II. General Repair Guidelines

A. Helispots/Staging Areas/Safety Zones

- 1) Re-contour to the original slope as requested by the Repair Specialist.
- 2) Remove soil, and/or breach berms so that runoff can be dissipated. Cross drain these areas to effectively dissipate water runoff.
- 3) Place disturbed vegetation, brush and trees, piled during line construction, on the surface of safety zones and open areas. This may be done with equipment or hand crews.

B. Roads

- 1) Re-establish existing berms where applicable.
- 2) Breach berms to facilitate drainage, where applicable.
- 3) Clean culverts plugged with soil and rock resulting from fire suppression activities.
- 4) Blading or grading of roads may be necessary.

C. Firelines; Hand and Dozer

Install waterbars as needed. Waterbars are designed to intercept, slow and spread the precipitation run-off in order to reduce sediment transport and soil erosion. The idea is to move water off the fireline before it can build up enough energy to erode and transport sediment. Re-establish waterbars and rolling dips using pre-fire locations. Flatten berms along fire lines to match natural contours. Utilize cut vegetation for erosion control on steep dozer and hand lines.

Water Bar or cross drain spacing				
Fireline or Road Gradient (%)	0-10%	11-25%	26-50%	>50%
Spacing	200'	150'	100'	75'

D. Watercourses

- 1) Watercourse crossings shall be dipped to original configuration. Waterbreaks shall be installed on each side of channel to divert flow off of trails prior to entering watercourse channel.
- 2) Remove all soil and debris that was placed in any stream channel. A Repair Specialist will review the site for acceptability. If all foreign material cannot be removed with heavy equipment, the material shall be removed by hand. The approaches to the crossing may be sloped back to prevent future stream bank failure.

E. Other Repair Concerns

- 1) Remove all trash from fire lines and other affected areas.
- 2) Repair, broken, damaged fences, and/or gates damaged as the result of the fire control operations will be repaired. (Note: Extent and condition of damage should be documented prior to repairs.)

Prepared by: 

Len Nielson, Emergency Fire Line Repair Technical Specialist

SCOTTS INCIDENT - BASE CAMP PHONE LIST

OPERATIONS	707-263-3864
RESOURCES	707-263-3485
DEMOB	707-263-3258
INFORMATION - PIO	707-263-3568
TRAINING SPECIALIST	707-263-3376
FINANCE	707-263-3324
SUPPLY	916-205-4419
GROUND SUPPORT	530-708-2750
COMMUNICATIONS	530-949-6816
COMMUNICATIONS - FAX	707-263-3349
OFFSITE ACCOMMODATIONS	707-263-3568
OES	707-263-3526
ORDERING	707-263-3357

Shift Ticket Examples

EMERGENCY SHIFT TICKET and EVALUATION FORM					Contractor Name	
The responsible Government Officer will complete this form each shift					Fireline Builders	
Incident or Project Name Scott		Incident Number CAMEU006376	Request Number E or S # Here		Operator #1 John Smith	Operator #2 Joe Smith
Agreement Number Obtain from vendor's agreement					Operator Furnished By: <input checked="" type="checkbox"/> Contractor <input type="checkbox"/> Government	
Equipment Make CAT		Equipment Model / Type D6H			Operating Supplies Furnished By: <input checked="" type="checkbox"/> Contractor <input type="checkbox"/> Government	
Serial Number 6LN3344		Licence Number			Equipment Status <input checked="" type="checkbox"/> Inspected <input checked="" type="checkbox"/> Under Agreement	
Equipment Use (Circle) Hours / Days / Miles					Released by Government <input type="checkbox"/>	
Date Mo / Day	Start	Stop	Work	Assignment	Withdrawn by Contractor <input type="checkbox"/>	
8/17	0600	2400	16	Division B	Remarks/Comments ** 2 Operators 24 hour shift	
8/18	0001	0600	8	Division B		
Vendor Rating					Govt. Rep. Name and Position - PRINT Steve Smith	
	Poor*	Avg.	Good	Exc.	N/A	
Met Performance Expectations		Vendor Rating must be done.			Govt. Rep. Signature <i>Steve Smith</i>	
Equipment in Safe Working Condition					Contractor Signature <i>Bob Smith</i>	
Operator Skill Level					Date 09/09/12	
Operates Safely					Time 0600	
Operator's Cooperation Level					CALFIRE 297 (Rev 3-2011)	
Overall Performance						
* NOTE: Any rating of POOR requires an explanation in Comment Section.						
**Final evaluation or for more documentation, use an ICS Form 230 or equivalent.						
Pink - Finance		Blue - Home Unit HE Coordinator		Yellow - Vendor		White - Govt Representative

EMERGENCY SHIFT TICKET and EVALUATION FORM					Contractor Name	
The responsible Government Officer will complete this form each shift					Fireline Builders	
Incident or Project Name Scotts		Incident Number CAMEU 006376	Request Number E or S # Here		Operator #1 John Smith	Operator #2
Agreement Number Obtain from vendor's agreement					Operator Furnished By: <input checked="" type="checkbox"/> Contractor <input type="checkbox"/> Government	
Equipment Make CAT		Equipment Model / Type D6H			Operating Supplies Furnished By: <input checked="" type="checkbox"/> Contractor <input type="checkbox"/> Government	
Serial Number 6LN3344		Licence Number			Equipment Status <input checked="" type="checkbox"/> Inspected <input checked="" type="checkbox"/> Under Agreement	
Equipment Use (Circle) Hours / Days / Miles					Released by Government <input type="checkbox"/>	
Date Mo / Day	Start	Stop	Work	Assignment	Withdrawn by Contractor <input type="checkbox"/>	
8/17	0001	0600	6	Off Shift	Remarks/Comments ** 1 Operator 12 hour shift	
8/17	0600	1800	12	Division B		
8/17	1800	2400	6	Off Shift		
Vendor Rating					Govt. Rep. Name and Position - PRINT Steve Smith	
	Poor*	Avg.	Good	Exc.	N/A	
Met Performance Expectations		Vendor Rating must be done.			Govt. Rep. Signature <i>Steve Smith</i>	
Equipment in Safe Working Condition					Contractor Signature <i>Bob Smith</i>	
Operator Skill Level					Date 09/09/12	
Operates Safely					Time 1800	
Operator's Cooperation Level					CALFIRE 297 (Rev 3-2011)	
Overall Performance						
* NOTE: Any rating of POOR requires an explanation in Comment Section.						
**Final evaluation or for more documentation, use an ICS Form 230 or equivalent.						
Pink - Finance		Blue - Home Unit HE Coordinator		Yellow - Vendor		White - Govt Representative

Scotts Incident

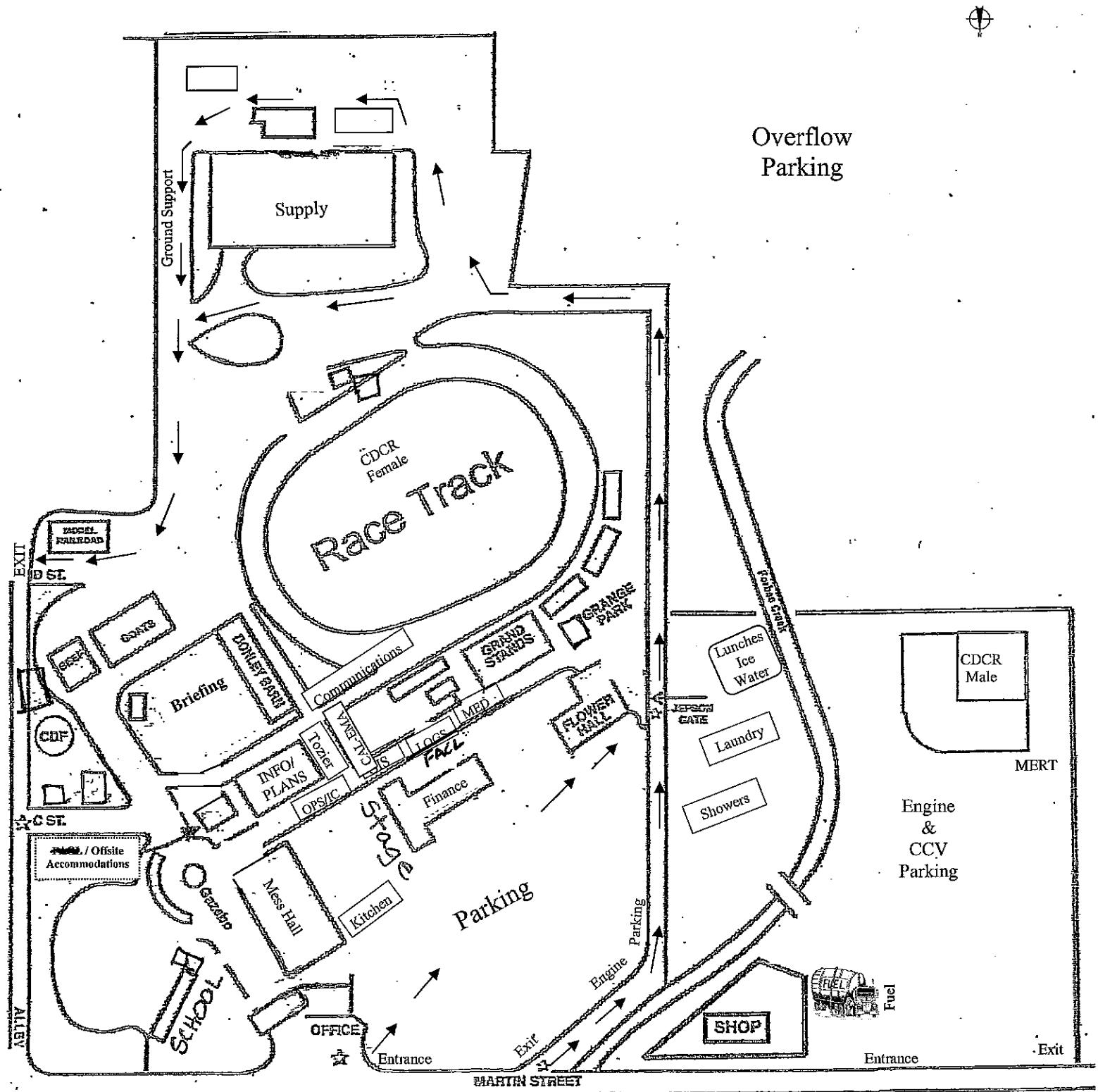

Not to scale

