

Carr INCIDENT

#CA-SHU-007808

INCIDENT ACTION PLAN



OPERATIONAL PERIOD

8/3/2018

to

8/4/2018

1948

1948

1948

1948

1948

1948

1948

1948

1948

1948

1948

1948

INCIDENT OBJECTIVES (ICS 202)

1. Incident Name: <p style="text-align: center;">Carr</p>	2. Operational Period:	Date From: 8/3/2018 Time From: 0700	Date To: 8/4/2018 Time To: 0700
--	-------------------------------	--	------------------------------------

3. Objective(s):

Management Objectives

- Provide for public and emergency personnel safety at all times
- Provide for timely and accurate release of incident information to the public, media, first responders, agency administrators and cooperators
- Protect and defend property, improvements, infrastructure; economic, natural, cultural, and heritage resources in the fire area
- Identify, process, and coordinate the safe repopulation and re-entry of affected communities in an efficient and timely manner
- Foster and maintain relationships; ensure coordination and communication with all stakeholders, adjoining jurisdictions and cooperating agencies
- Manage the incident in a cost-efficient manner

Control Objectives

- Keep the fire North of Cottonwood Creek to Highway 36
- Keep the fire South of Dog Creek Rd
- Keep the fire East of Deer Lick Springs Rd to Highway 3 to Highway 299 to Trinity Dam Blvd
- Keep the fire West of Interstate 5

General Situational Awareness:

-ENSURE AND MAINTAIN EFFECTIVE COMMUNICATIONS WITH CARR COMMUNICATION AT ALL TIMES INCLUDING USING PROPER NAMING CONVENTION.

- Steep and rugged terrain, critically dry and receptive fuel beds.
- Critical fire weather conditions continue again for today due to hot, dry unstable weather conditions including locally gusty winds.
- Hydration/ Nutrition/ Fatigue: drink water, eat, and rest when necessary and appropriate.
- Re-energized power transmission lines: Be aware that lines may be live.

5. Site Safety Plan Required? Yes No

Approved Site Safety Plan(s) Located at:

6. Incident Action Plan

<input checked="" type="checkbox"/> ICS 203	<input checked="" type="checkbox"/> ICS 215A	<input type="checkbox"/> Phone List	<input type="checkbox"/> Fire Suppression Repair Plan
<input checked="" type="checkbox"/> ICS 204	<input checked="" type="checkbox"/> ICS 220	<input checked="" type="checkbox"/> Training Message	<input checked="" type="checkbox"/> POI Message
<input checked="" type="checkbox"/> ICS 205	<input checked="" type="checkbox"/> Incident Map	<input checked="" type="checkbox"/> Travel Map	<input checked="" type="checkbox"/> OES Message
<input checked="" type="checkbox"/> ICS 206	<input checked="" type="checkbox"/> Weather Forecast	<input checked="" type="checkbox"/> Demob Plan	<input checked="" type="checkbox"/> NIFC FTP access path to maps
<input checked="" type="checkbox"/> ICS 208	<input checked="" type="checkbox"/> Fire Behavior	<input checked="" type="checkbox"/> Finance Message	<input checked="" type="checkbox"/> ICS 214

7. Prepared By: Mike Petro	Position/Title: PSC	Signature:
8. Approved by Incident Commander:	Mike Van Loben Sels	Signature:

ICS 202

ORGANIZATION ASSIGNMENT LIST (ICS 203)

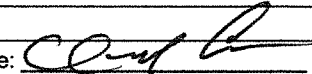
1. Incident Name: Carr		2. Operational Period: Date From: 8/3/2018 Time From: 0700		Date To: 8/4/2018 Time To: 0700	
3. Incident Commander(s) and Command Staff:			7. Operation Section:		
IC/UC's	B.Gouvea/ T.Pechota/ C.Kreider/G. Bertelli (T)		Chief	T. Brownell/ A. McBath (T) (Day)	
Deputy	M. Van Loben Sels/ S.Spinharney (T)		Deputy	S. Crawford/ M. Wink (T)	
Safety Officer	B. Carter/ A. Stornetta (T)		Night Ops	F. Berbena	
Information Officer	R. Brocchini/ C. Bulivac/ B. Mercado (T)		Staging Area	Anderson	S.Bidwell (T)/ J.Price (T)
	J. Clingingsmith (T)		Branch	I	J. Topoleski
Liaison Officer	D.Schloss/ T.Crawford/ S.McCabe		Division/Group	S/T/U	S. Raley/ R. Valles (T)
	M. Hardey/ B.Smith (T)/ R. Ingels (T)		Division/Group	V/X	C. Swensen
4. Agency/Organization Representatives:			Division/Group		
Trinity County SO	M.Mandolfo		Division/Group		
Sierra Pacific Industries	N.Kroncki		Division/Group		
Shasta County SO	A.Bertain		Branch	II	L. Turman
County Roads Dept.	(530) 225-5661		Division/Group	Y	S. Griffis
Cal OES AREP	P.Titus		Division/Group	A	H. Niederberger
PG&E	M.Weaver		Division/Group	B	J. Wenger
CDCR	M.Ahlin		Division/Group	C	M. Hildebrand/ D. Ferguson
CCC	K. McDonald/ S. Borowski		Division/Group		
CSP	A. Wright		Branch	III	B. Noel
CHP	S. Fredrick		Division/Group	D	J. Collins
Red Cross	R. Yoder		Division/Group	F	D. Bakken
WAPA	B. Adams		Division/Group	H	J. Keown/ C. Reginatto
BLM	J. Mata		Division/Group	West Group	D. Russell
			Division/Group		
5. Planning Section:			Branch	IV	J. Campbell/ D. Davis
Chief	M. Petro		Division/Group	M / O	D. Boic/ J. Barrios
Deputy	C. Carrera		Division/Group	P	D. Laws
Resource Unit	Carlos/Corey/Reneau/Weber(T)/Elward(T)		Division/Group		
Situation Unit	E. Scovel / R. DeCamp		Branch	North Cont	J. Brunk
Documentation Unit	J.Patterson		Division/Group	Shasta	J. Reglin
Demobilization Unit	T. Shevenell/ S. Spear (T)		Division/Group	Trinity	P. Bell
GISS	T. Werle/ E. Tumbleson (T)/ K. Towers		Division/Group		
FBAN	D.Boursier		Branch		
IMET	A. Hoon/ R. Fliehman (T)		Division/Group	Supp. Repair	B. Rowe
Training Tech Spec	D. Randolph/ C. Piccaro (T)		Division/Group		
Hired Equipment Tech	D. Grandbois		Division/Group		
6. Logistics Section			Air Operations Branch		Director: T. Stepanovich
Chief	J.Morris		Air Support Grp Sup		M.Hill/ T. Smith (T)
Deputy	C. White		Helibase Manager		P. York
Supply Unit	L. Story/ M. Brabo (T)				
Facilities Unit	J. Guerra/ S. Burris		8. Finance/Administration Section:		
Ground Support Unit	P. Mock		Chief	J. Franklin	
Communications Unit	T. Webb		Deputy	B. Counts	
Medical Unit	J. Winnen		Time Unit	S.Thompson	
Motel Tech Spec	S. Vaquero		Procurement Unit	C. Craig/ T. Meyers	
Ordering Manager	A. Gettman/ J. Tompkins		Comp/Claims Unit	M. Boone	
Food Unit	M. Mondragon		Cost Unit	S. Cain	
Prepared By: Name:	Chris Carrera	Position/Title:	PSC	Signature: 	
ICS 203		Date/Time:	8/2/2018 2216 hrs		



Fire Weather Forecast

FORECAST NO: 9
PREDICTION FOR: DAY/NIGHT SHIFT
SHIFT DATE: August 3, 2018
TIME/DATE ISSUED: August 2, 2018 2000 PDT

NAME OF FIRE: Carr
UNIT: CA-SHU
SIGNED: Alex Hoon / Ryan Flieman
Incident Meteorologist / IMET (t)

**WEATHER DISCUSSION: ...RED FLAG WARNING THROUGH SATURDAY 9PM
FOR GUSTY NORTH WINDS AND DRY CONDITIONS...**

Weather models continue to indicate another night of North winds for tonight leading to a critical fire weather period for the incident. Gusty North winds will be present through 1000 today. During the day we continue with the hot, dry, and unstable conditions. Transitioning to the overnight period, the north winds mentioned before will start to pick up. With north winds for two nights in a row (Thursday and Friday nights) coupled with hot and unstable conditions for the daytime period, we will be in a prolonged period of critical fire weather conditions. Poor humidity recoveries are expected for the next few days.

WEATHER FORECAST FOR FRIDAY: ...HOT WITH LESS SMOKE...

WEATHER: Sunny, breezy winds early. Better visibility for much of the incident.

MAX TEMPERATURES: 92-98°F.... around 101°F near Redding. **LITTLE CHANGE**

MIN HUMIDITY: 8-15%. **LITTLE CHANGE**

EYE-LEVEL WIND: North 7-15 gusting to 20 mph in the AM, becoming Updrainage 5-9 mph in the afternoon.

20-FOOT WIND: ...NORTH WINDS EARLY, BATTLING WINDS IN UPPER DRAINAGES AFTER 1300...

SLOPE/VALLEY - North 15-20 mph gust 30 mph in the morning, especially in North to South drainages. Becoming Southwest 5-10 mph in the afternoon with gusts to 15 mph.

RIDGETOP- North 20-25 mph gusts 35 mph in the morning, then Southwest 10-15 mph gusts 20 mph.

HAINES INDEX: 6 (in clean air)

FRIDAY NIGHT: ...GUSTY NORTH WINDS TONIGHT WITH POOR RECOVERY...

WEATHER: Clear and smokey.

MIN TEMPERATURES: 68-76°F. **LITTLE CHANGE**

MAX HUMIDITY: 18-28% near 18% above 3000 feet. **LITTLE CHANGE**

EYE-LEVEL WIND: **Becoming North-Northwest** 7-15 mph with gusts to 20 mph after 2100.

20-FOOT WIND:

SLOPE/VALLEY - Becoming North-Northwest 15-20 mph with gusts to 30 mph after 2100. **Gusts up to 35 mph in N-S aligned drainages.**

RIDGETOP - Northwest, then North 20-25 mph with gusts to 35 mph.

EXTENDED FORECAST: ...RED FLAG WARNING THROUGH SATURDAY EVENING...

SATURDAY AND SUNDAY: Sunny. Max temps...90-99°F. Min RH 10-15%. West 5-10 mph, then North 10-15 mph gusting to 20 mph after 9pm Saturday night through Sunday morning.

MONDAY AND TUESDAY: Sunny. Max temps...94-102°F. Min RH 12-19%. South-Southeast 5-10 mph with gusts to 15 mph.

FIRE BEHAVIOR FORECAST

FORECAST NUMBER: 9	TYPE OF FIRE: Wildland Fire
FIRE NAME: CARR	OPERATIONAL PERIOD: 24hr 8/3 (0700-0700)
DATE ISSUED: 08/2	TIME ISSUED: 2100
UNIT: SHU	SIGNED: D. Boursier FBAN/LTAN

INPUTS

WEATHER SUMMARY

RED FLAG FOR NNW WINDS AND LOW RH
See Weather Forecast in IAP.

OUTPUTS

GENERAL: ****Conditions exist for Plume Dominated Fire Behavior****

Critically dry fuels with significant grass fuel loading will contribute to ember production and spotting.

Few places in the fire area offer lee wind protection to reduce fire flow rates enough for tactical advantage or safety considerations.

In the absence of weather conditions outside the forecast or extreme fire behavior conditions expect:

	Max. Flame Length	Max. Rate of Spread	Spotting	Probability of Ignition
Grass	< 10'	150 ch/hr	< ½ mile	100%
Grass/Shrub Mfx	< 12'	80 ch/hr	< ½ mile	100%
Timber Understory	< 15'	20 ch/hr	< ¾ mile	100%
Timber Litter	< 8'	12 ch/hr	< ¼ mile	100%

****minimum safety zone size for brush fuels is ¾ acre for a Strike Team of Engines.**

SPECIFIC:

Branch I

Smoldering with pockets of activity possible. Keep alert to structural hazards, ash pots and fire weakened trees.

Branch II

Daytime SW winds will have fire backburning with occasional upslope runs. Torching and short crown runs may occur. At night fire may move rapidly with NNW winds to the south, expect the largest growth to occur overnight as winds increase. Fuel types convert to lighter and flashier grasses to the south. Dormant heat areas may flare with air movement. Roll-out and spotting potential across established lines.

Branch III

Downslope movement to the West during the day. Expect roll-out and subsequent runs with crown fire up drainages. Keep alert to spot fires below in multiple directions due to variable winds.

Branch IV

Fire spread with torching/crown runs could occur with increased spotting distances during the day and night. Keep alert to a 90-degree shift in winds from NNW to SW to NNW. Look for areas of fuels treatment, timber harvest or previous fire activity for safety or control objectives. Areas closer to the Sacramento River could see previously dormant heat areas become very active with wind and decreased RH. Roll-out and spotting potential across established lines.

AIR OPERATIONS:

East/West Ridges may have increased winds and turbulence over Divisions B, C, and P.
Mixing height: 9,500 ft., Transport winds: SWS 10-15mph, Sunrise 0607, Sunset 2026.

SAFETY

Communicate during crew tailboard briefings what YOUR definition of "Extreme Fire Behavior" is so everyone is on the same page thus reducing confusion.

ASSIGNMENT LIST (ICS 204)

1. Incident Name: Carr		2. Operational Period: Date From: 08/03/18 Date To: 08/04/18 Time From: 0700 Time To: 0700				3. Branch: II Div/Group: Y Yankee Page 1 of 2	
4. Operations Personnel: Operations Section Chief: T. Brownell/ A. McBath (T) (Day) Night Ops: F. Berbena Branch Director: L. Turman Branch Safety: M. Todd/ M. Weidner (T) Division/Group Supervisor: S. Griffis (9231C)							
5. Resources Assigned:		** Resources Below in Bold are 12 Hour **				Reporting Location, Special Equipment, Remarks, Notes, and Information Time Location	
Resource Identifier	ALS	Leader	Personnel	Request #			
STA OES5 5805A		Alcorn, Billy	22	E-425	0700-0700	DP 17	
STC NEU 9231C		Griffis, Sean	16	E-211	0700-0700	DP 17	
STF CARR #9		Flores, Jason	17	E-9048	0700-1900	DP 17	
T/F CARR #15		Seymour, Ron E	25	E-9062	0700-1900	DP 17	
ENG T6 A-1 16		Klotz, Skip	3	E-239	0700-1900	DP 17	
ENG T6 SSP E307		Tingle, Terry	4	E-479	0700-1900	DP 17	
ENG T6 GAR BRUSH 114		Baxley, Ashley	3	E-814	0700-1900	DP 17	
STG TGU 9255G		Smith, Phillip	33	C-45	0700-0700	DP 17	
CRW NPX SAMOA 61		Lee, Andrew	21	C-123	0700-0700	DP 17	
CRW CNA TFC		Haynes, Steve	109		0700-1900	DP 17	
DOZ SHU 2440		Flournoy, Aaron	2	E-310	0700-0700	DP 17	
DOZ SHU 2444		Kane, Jason	2	E-328	0700-0700	DP 17	
DOZ SRF 4		Cedar, Hayes	4	E-34	0700-0700	DP 17	
DOZ ENF 3		Stark, Daniel	4	E-38	0700-1900	DP 17	
DOZ KNF 1		Murieen, Jason	4	E-39	0700-1900	DP 17	
DOZ PVT E-243		Darr, Chris	2	E-243	0700-0700	DP 17	
DOZ PVT E-244		Dills, Evan	2	E-244	0700-0700	DP 17	
DOZ PVT E-408		Thurman, Brian	2	E-408	0700-0700	DP 17	
6. Work Assignments: Construct control lines as direct as possible. Plan secondary control lines, begin if possible. Prepare indirect control lines for possible firing operations. Fall hazard trees that will threaten control lines. Fall hazard trees. Insert hose lay to support firing operation.							
7. Special Instructions: ***ALL OUT OF STATE ENGINES ARE TO REPORT TO TEHAMA CAMP FOLLOWING SHIFT.*** Identify for backhaul any unneeded hose and equipment in the fire perimeter.							
8. Communications (radio and/or phone contact numbers needed for this assignment):							
Name	Ch	Function	Rx Freq	Rx Tone	Tx Freq	Tx Tone	Notes
SHA CMD	1	COMMAND	154.4300	136.5	159.0150	123.0 (T2)	(T2) BASS MTN
VFIRE 25	9	TACTICAL	154.2875	156.7 (T6)	154.2875	156.7 (T6)	
CALCORD	15	MEDICAL	156.0750	156.7 (T6)	156.0750	156.7 (T6)	MEDICAL
A/G	6	A/G	159.3150	192.8	159.3150	192.8	AIR TO GROUND IS CDF TAC 17
GUARD	16	EMERGENCY	168.6250		168.6250	110.9	EMERGENCY USE ONLY
9. Prepared by: Name: B.J. Corey		Pos/Title: RESL		Signature:			
ICS 204		Date/Time: 8/2/2018		2216 hrs			

ASSIGNMENT LIST (ICS 204)

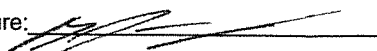
1. Incident Name: Carr		2. Operational Period: Date From: 08/03/18 Date To: 08/04/18 Time From: 0700 Time To: 0700				3. Branch: II Div/Group: A Alpha	
4. Operations Personnel: Operations Section Chief: T. Brownell/ A. McBath (T) (Day) Night Ops: F. Berbena Branch Director: L. Turman Branch Safety: M. Todd/ M. Weidner (T) Division/Group Supervisor: H. Niederberger							
5. Resources Assigned: ** Resources Below in Bold are 12 Hour **							
Resource Identifier	ALS	Leader	Personnel	Request #	Reporting Location, Special Equipment, Remarks, Notes, and Information Time Location		
STC LNU 9140C		Lovie, Jon	16	E-74	0700-0700	DP 55	
STC XSB 1521C		Widling, Alan	22	E-427	0700-0700	DP 55	
CRW PVT C-33		Rocha, Federico	20	C-33	0700-1900	DP 55	
DOZ PVT E-96		Gilbert, Bruce	2	E-96	0700-0700	DP 55	
DOZ PVT E-343		Wolfe, Larry	2	E-343	0700-0700	DP 55	
DOZ PVT E-401		Jones, Robert	2	E-401	0700-0700	DP 55	
DOZ PVT E-402		Briskt, Dale	2	E-402	0700-0700	DP 55	
DOZ PVT E-403		Smith, Dade	2	E-403	0700-0700	DP 55	
DOZ PVT E-405		Gill, Levi	2	E-405	0700-0700	DP 55	
DOZ PVT E-740		Boauer, Paul	2	E-740	0700-0700	DP 55	
DOZ PVT E-745		Baugh, Gary	2	E-745	0700-0700	DP 55	
W/T HVF 44		Busher, Chris	2	E-26	0700-0700	DP 55	
W/T PVT E-391		Hasanbasic, Dino	2	E-391	0700-0700	DP 55	
W/T PVT E-759		Cleer, Dana	2	E-759	0700-0700	DP 55	
W/T PVT E-891		Kotterman, Dustin	2	E-891	0700-0700	DP 55	
W/T PVT E-1102		Baron, Frank	2	E-1102	0700-0700	DP 55	
GRD PVT E-1101		Baron, Frank	1	E-1101	0700-0700	DP 55	
HEQB MELLOR O-548		Mellor, James	1	O-548	0700-0700	DP 55	
HEQB MATHER (T) O-560		Mather, Ian	1	O-560	0700-0700	DP 55	
FEMP SMART O-208		Smart, Ryan	1	O-208	0700-0700	DP 55	
FEMT BRYANT O-215		Bryant, Kendall	1	O-215	0700-0700	DP 55	
6. Work Assignments: Construct control lines as direct as possible. Prepare indirect control lines for possible firing operations. Construct safety islands. Fall hazard trees that will threaten control lines. Insert hose lay to support firing operation.							
7. Special Instructions: ***ALL OUT OF STATE ENGINES ARE TO REPORT TO TEHAMA CAMP FOLLOWING SHIFT.*** Identify for backhaul any unneeded hose and equipment in the fire perimeter.							
8. Communications (radio and/or phone contact numbers needed for this assignment):							
Name	Ch	Function	Rx Freq	Rx Tone	Tx Freq	Tx Tone	Notes
SHA CMD	1	COMMAND	154.4300	136.5	159.0150	123.0 (T2)	(T2) BASS MTN
VFIRE 26	10	TACTICAL	154.3025	156.7 (T6)	154.3025	156.7 (T6)	
CALCORD	15	MEDICAL	156.0750	156.7 (T6)	156.0750	156.7 (T6)	MEDICAL
A/G	6	A/G	159.3150	192.8	159.3150	192.8	AIR TO GROUND IS CDF TAC 17
GUARD	16	EMERGENCY	168.6250		168.6250	110.9	EMERGENCY USE ONLY
9. Prepared by: Name: B.J. Corey Pos/Title: RESL Signature: 							
ICS 204		Date/Time: 8/2/2018		2216 hrs			

ASSIGNMENT LIST (ICS 204)

1. Incident Name: Carr		2. Operational Period: Date From: 08/03/18 Date To: 08/04/18 Time From: 0700 Time To: 0700				3. Branch: II Div/Group: C Charlie	
4. Operations Personnel: Operations Section Chief: T. Brownell/ A. McBath (T) (Day) Night Ops: F. Berbena Branch Director: L. Turman Branch Safety: M. Todd/ M. Weidner (T) Division/Group Supervisor: M. Hildebrand/ D. Ferguson							
5. Resources Assigned:		** Resources Below in Bold are 12 Hour **				Reporting Location, Special Equipment, Remarks, Notes, and Information Time Location	
Resource Identifier	ALS	Leader	Personnel	Request #			
STC SCU 9161C		Anderson, Anthony	17	E-213	0700-0700	SEE SPECIAL	
STC BTU 9212C		Reid, Bill	16	E-279	0700-0700	SEE SPECIAL	
STC NEU 9230C		Wallen, Matt	19	E-79	0700-0700	SEE SPECIAL	
STG TGU 9258G		Pederson, Travis	35	C-19	0700-0700	SEE SPECIAL	
CRW PNF PLUMAS IHC		Sherman, Mike	20	C-9	0700-1900	SEE SPECIAL	
DOZ PVT E-407		Ingram, Brad	3	E-407	0700-0700	SEE SPECIAL	
DOZ PVT E-842		Landingham, Darrell	2	E-842	0700-0700	SEE SPECIAL	
W/T SHF 16		Obst, Isaac	2	E-11	0700-1900	SEE SPECIAL	
W/T SHS 55		Wyckoff, Fred	3	E-25	0700-1900	SEE SPECIAL	
W/T PVT E-353		Douglas, Jason	2	E-353	0700-0700	SEE SPECIAL	
W/T PVT E-397		Lopez, Frankie	2	E-397	0700-0700	SEE SPECIAL	
FEMP ROBERTS O-207	ALS	Roberts, Brent	1	O-207	0700-0700	SEE SPECIAL	
FEMT WALKER O-216		Walker, James	1	O-216	0700-0700	SEE SPECIAL	
6. Work Assignments: Prepare indirect control lines for possible firing operations. Prepare for firing operations. Prepare Firing Plan.							
7. Special Instructions: ***ALL OUT OF STATE ENGINES ARE TO REPORT TO TEHAMA CAMP FOLLOWING SHIFT.*** Identify for backhaul any unneeded hose and equipment in the fire perimeter. Report to Buckhorn Summit Rd. x Hwy 299.							
8. Communications (radio and/or phone contact numbers needed for this assignment):							
Name	Ch	Function	Rx Freq	Rx Tone	Tx Freq	Tx Tone	Notes
SHA CMD	1	COMMAND	154.4300	136.5	159.0150	123.0 (T2)	(T2) BASS MTN
CDF T26	7	TACTICAL	159.2925	192.8 (T16)	159.2925	192.8 (T16)	
CALCORD	15	MEDICAL	156.0750	156.7 (T6)	156.0750	156.7 (T6)	MEDICAL
A/G	6	A/G	159.3150	192.8	159.3150	192.8	AIR TO GROUND IS CDF TAC 17
GUARD	16	EMERGENCY	168.6250		168.6250	110.9	EMERGENCY USE ONLY
9. Prepared by: Name: B.J. Corey		Pos/Title: RESL		Signature:			
ICS 204		Date/Time: 8/2/2018		2216 hrs			

ASSIGNMENT LIST (ICS 204)

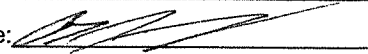
1. Incident Name: Carr		2. Operational Period: Date From: 08/03/18 Date To: 08/04/18 Time From: 0700 Time To: 0700			3. Branch: III Div/Group: D Delta Page 2 of 3		
4. Operations Personnel: Operations Section Chief: T. Brownell/ A. McBath (T) (Day) Night Ops: F. Berbena Branch Director: B. Noel Branch Safety: K. Margrott/ B. Yendrey (T) Division/Group Supervisor: J. Collins							
5. Resources Assigned:		** Resources Below in Bold are 12 Hour **			Reporting Location, Special Equipment, Remarks, Notes, and Information		
Resource Identifier	ALS	Leader	Personnel	Request #	Time	Location	
DOZ PVT E-845		Berlogar, Cam	2	E-845	0700-0700	DP 56	
DOZ PVT E-851		Rue, Kantor	2	E-851	0700-0700	DP 56	
DOZ PVT E-860		Williams, Brandon	2	E-860	0700-0700	DP 56	
DOZ PVT E-863		Thompson, Zachery	2	E-863	0700-0700	DP 56	
DOZ PVT E-864		Miller, Harold	2	E-864	0700-0700	DP 56	
DOZ PVT E-866		Davis, Leland	2	E-866	0700-0700	DP 56	
DOZ PVT E-869		Gibson, Jeff	2	E-869	0700-0700	DP 56	
DOZ PVT E-879		Klauer, Jim	2	E-879	0700-0700	DP 56	
DOZ PVT E-881		Miles, Daniel	2	E-881	0700-0700	DP 56	
W/T SHS 33		Ron Smith	2	E-44	0700-1900	DP 56	
W/T PVT E-135		Oilar, Danny	2	E-135	0700-0700	DP 56	
W/T PVT E-207		Strother, Thomas	2	E-207	0700-0700	DP 56	
W/T PVT E-352			2	E-352	0700-0700	DP 56	
W/T PVT E-357		Ed	2	E-357	0700-0700	DP 56	
W/T PVT E-392		Funes, Anthony	2	E-392	0700-0700	DP 56	
W/T PVT E-393		Troedel, Bryan	1	E-393	0700-0700	DP 56	
W/T PVT E-394		Troedel, Bryan	2	E-394	0700-1900	DP 56	
W/T PVT E-395		Smith, Rockie	2	E-395	0700-0700	DP 56	
6. Work Assignments: Construct contingency line from Hwy 299 to Hoadley Peak. Prepare indirect control lines for possible firing operations. Improve and hold control lines. Mop up 300 feet or 100%. Prepare Structure Defense Plan. Prepare structures for defensive actions.							
7. Special Instructions: ***ALL OUT OF STATE ENGINES ARE TO REPORT TO TEHAMA CAMP FOLLOWING SHIFT.*** Identify for backhaul any unneeded hose and equipment in the fire perimeter.							
8. Communications (radio and/or phone contact numbers needed for this assignment):							
Name	Ch	Function	Rx Freq	Rx Tone	Tx Freq	Tx Tone	Notes
SHA CMD	1	COMMAND	154.4300	136.5	159.0150	123.0 (T2)	(T2) BASS MTN
CDF T27	8	TACTICAL	159.3075	192.8 (T16)	159.3075	192.8 (T16)	
CALCORD	15	MEDICAL	156.0750	156.7 (T6)	156.0750	156.7 (T6)	MEDICAL
A/G	6	A/G	159.3150	192.8	159.3150	192.8	AIR TO GROUND IS CDF TAC 17
GUARD	16	EMERGENCY	168.6250		168.6250	110.9	EMERGENCY USE ONLY
9. Prepared by: Name: B.J. Corey		Pos/Title: RESL		Signature: 			
ICS 204		Date/Time: 8/2/2018		2216 hrs			

ASSIGNMENT LIST (ICS 204)

1. Incident Name: Carr		2. Operational Period: Date From: 08/03/18 Date To: 08/04/18 Time From: 0700 Time To: 0700			3. Branch: III Div/Group: H Hotel		
4. Operations Personnel: Operations Section Chief: T. Brownell/ A. McBath (T) (Day) Night Ops: F. Berbena Branch Director: B. Noel Branch Safety: K. Margrott/ B. Yendrey (T) Division/Group Supervisor: J. Keown/ C. Reginatto					Page 1 of 2		
5. Resources Assigned:		** Resources Below in Bold are 12 Hour **			Reporting Location, Special Equipment, Remarks, Notes, and Information Time Location		
Resource Identifier	ALS	Leader	Personnel	Request #			
STC HUU 9120C		Mclaughlin, Ron	15	E-13	0700-0700	DP 21	
STC MRN 9150C	ALS	Pierce, Jeremy	18	E-210	0700-0700	DP 21	
STG TGU 9254G		Sheffield, Brennen	33	C-36	0700-0700	DP 21	
DOZ TGU 2540		Oliver, Kevin	3	E-47	0700-0700	DP 21	
DOZ PVT E-54		Edwards, Rob	2	E-54	0700-0700	DP 21	
DOZ PVT E-89		Saltens, Mike	3	E-89	0700-0700	DP 21	
DOZ PVT E-93		Miller, Bruce	2	E-93	0700-0700	DP 21	
DOZ PVT E-95		Owen, Mitchell	2	E-95	0700-0700	DP 21	
DOZ PVT E-339		Coughlin, Steve	2	E-339	0700-0700	DP 21	
DOZ PVT E-340		Oilar, Pat	2	E-340	0700-0700	DP 21	
DOZ PVT E-341		Oilar, Pat	2	E-341	0700-0700	DP 21	
DOZ PVT E-344		Lassen, Steven	2	E-344	0700-0700	DP 21	
DOZ PVT E-741		Moore, Jake	2	E-741	0700-0700	DP 21	
DOZ PVT E-847		Funes, Anthony	2	E-847	0700-0700	DP 21	
DOZ PVT E-848		Schott, Chris	2	E-848	0700-0700	DP 21	
DOZ PVT E-849		Newby, Randy	2	E-849	0700-0700	DP 21	
DOZ PVT E-854		Nye, Kevin	2	E-854	0700-0700	DP 21	
DOZ PVT E-867		Snyder, Jeff	2	E-867	0700-0700	DP 21	
6. Work Assignments: Construct contingency line from County Line Rd. to Trinity Dam. Construct contingency line from Trinity Mtn. Rd. out to 34N30 to Trinity Lake.							
7. Special Instructions: ***ALL OUT OF STATE ENGINES ARE TO REPORT TO TEHAMA CAMP FOLLOWING SHIFT.*** Identify for backhaul any unneeded hose and equipment in the fire perimeter. Trinity Lake T/F Contact Info: Travis Gee / State Parks (24 Hour Resource) Cell Primary: (530) 990-8501 / Cell Secondary: (530) 370-8180 / SAT Phone: 881621411613							
8. Communications (radio and/or phone contact numbers needed for this assignment):							
Name	Ch	Function	Rx Freq	Rx Tone	Tx Freq	Tx Tone	Notes
SHA CMD	1	COMMAND	154.4300	136.5	159.0150	123.0 (T2)	(T2) BASS MTN
CDF T29	10	TACTICAL	151.3475	192.8 (T16)	151.3475	192.8 (T16)	
CALCORD	15	MEDICAL	156.0750	156.7 (T6)	156.0750	156.7 (T6)	MEDICAL
A/G	6	A/G	159.3150	192.8	159.3150	192.8	AIR TO GROUND IS CDF TAC 17
GUARD	16	EMERGENCY	168.6250		168.6250	110.9	EMERGENCY USE ONLY
9. Prepared by: Name: B.J. Corey		Pos/Title: RESL		Signature:			
ICS 204		Date/Time: 8/2/2018		2216 hrs			

ASSIGNMENT LIST (ICS 204)

1. Incident Name: Carr		2. Operational Period: Date From: 08/03/18 Date To: 08/04/18 Time From: 0700 Time To: 0700				3. Branch: III Div/Group: H Hotel Page 2 of 2	
4. Operations Personnel: Operations Section Chief: T. Brownell/ A. McBath (T) (Day) Night Ops: F. Berbena Branch Director: B. Noel Branch Safety: K. Margrott/ B. Yendrey (T) Division/Group Supervisor: J. Keown/ C. Reginatto							
5. Resources Assigned:		** Resources Below in Bold are 12 Hour **				Reporting Location, Special Equipment, Remarks, Notes, and Information Time Location	
Resource Identifier	ALS	Leader	Personnel	Request #			
DOZ PVT E-871		Kirkland, Shane	1	E-871	0700-0700	DP 21	
DOZ PVT E-872		Cecil, Ray	2	E-872	0700-0700	DP 21	
W/T PVT E-356		Miller, Tony	2	E-356	0700-0700	DP 21	
W/T PVT E-361		Debois, Scott	2	E-361	0700-0700	DP 21	
W/T PVT E-639		John Traumiller	2	E-639	0700-0700	DP 21	
EXC PVT E-899		Mccutcheon, Derick	1	E-899	0700-1900	DP 21	
MAS PVT E-761		Gram, Clayton	1	E-761	0700-0700	DP 21	
MAS PVT E-762		Evans, Skyler	1	E-762	0700-0700	DP 21	
MAS PVT E-897		Gregory, Stephenie	1	E-897	0700-1900	DP 21	
GRD PVT E-192		Stenberg, Mike	1	E-192	0700-1900	DP 21	
FELB PVT E-828		Watt, Dale	1	E-828	0700-1900	DP 21	
FELB PVT E-830		Warner, Paul	1	E-830	0700-1900	DP 21	
FELB PVT E-831		Alcuna, Eddie	2	E-831	0700-1900	DP 21	
TRINITY LAKE T/F		Sgt. Gee			0700-1900	DP 21	
FEMP MARQUARDT O-74		Marquardt, Michael	1	O-74	0700-1900	DP 21	
FEMT BALAO O-73		Balao, Daryle	1	O-73	0700-1900	DP 21	
6. Work Assignments: Construct contingency line from County Line Rd. to Trinity Dam. Construct contingency line from Trinity Mtn. Rd. out to 34N30 to Trinity Lake.							
7. Special Instructions: ***ALL OUT OF STATE ENGINES ARE TO REPORT TO TEHAMA CAMP FOLLOWING SHIFT.*** Identify for backhaul any unneeded hose and equipment in the fire perimeter. Trinity Lake T/F Contact Info: Travis Gee / State Parks (24 Hour Resource) Cell Primary: (530) 990-8501 / Cell Secondary: (530) 370-8180 / SAT Phone: 881621411613							
8. Communications (radio and/or phone contact numbers needed for this assignment):							
Name	Ch	Function	Rx Freq	Rx Tone	Tx Freq	Tx Tone	Notes
SHA CMD	1	COMMAND	154.4300	136.5	159.0150	123.0 (T2)	(T2) BASS MTN
CDF T29	10	TACTICAL	151.3475	192.8 (T16)	151.3475	192.8 (T16)	
CALCORD	15	MEDICAL	156.0750	156.7 (T6)	156.0750	156.7 (T6)	MEDICAL
A/G	6	A/G	159.3150	192.8	159.3150	192.8	AIR TO GROUND IS CDF TAC 17
GUARD	16	EMERGENCY	168.6250		168.6250	110.9	EMERGENCY USE ONLY
9. Prepared by: Name: B.J. Corey Pos/Title: RESL Signature:							
ICS 204		Date/Time: 8/2/2018		2216 hrs			

ASSIGNMENT LIST (ICS 204)

1. Incident Name: Carr		2. Operational Period: Date From: 08/03/18 Date To: 08/04/18 Time From: 0700 Time To: 0700			3. Branch: IV Div/Group: M / O Mike Page 1 of 3		
4. Operations Personnel: Operations Section Chief: T. Brownell/ A. McBath (T) (Day) Night Ops: F. Berbena Branch Director: J. Campbell/ D. Davis Branch Safety: S. Wilson / S. Link (T) Division/Group Supervisor: D. Boic/ J. Barrios							
5. Resources Assigned:		** Resources Below in Bold are 12 Hour **			Reporting Location, Special Equipment, Remarks, Notes, and Information Time Location		
Resource Identifier	ALS	Leader	Personnel	Request #			
STC HUU 9121C		Bryant, Erik	17	E-681	0700-0700	WHITNEY STAGING	
STC XTR 3275C		Alvord, Scott	18	E-75	0700-0700	WHITNEY STAGING	
STC LNF 3615C		Nickey, John	27	E-78	0700-1900	WHITNEY STAGING	
STC SHF 3675C		Smyth, Keith	27	E-164	0700-1900	WHITNEY STAGING	
T/F CARR #4		Nelson, Darin	19	E-9057	0700-1900	WHITNEY STAGING	
ENG T3 SHU 2466		Abercrombie, Todd	3	E-250	0700-0700	WHITNEY STAGING	
ENG T3 SHU 2475		Gyves, Dusty	5	E-252	0700-0700	WHITNEY STAGING	
ENG T3 SHU 2477		Anderson, Danny	3	E-251	0700-0700	WHITNEY STAGING	
ENG T3 SHU 2482		Haker, Jeromy	4	E-983	0700-0700	WHITNEY STAGING	
ENG T3 XLS 824		Stout, Tim	3	E-283	0700-0700	WHITNEY STAGING	
STG SHU 9242G		Lange, Dennis	33	C-28	0700-0700	WHITNEY STAGING	
CRW SQF 5		Sartin, jason	21	C-120	0700-1900	WHITNEY STAGING	
CRW PVT C-31		Moreno, Anselmo	20	C-31	0700-1900	WHITNEY STAGING	
CRW PVT C-34		Duran, Ernesto	20	C-34	0700-1900	WHITNEY STAGING	
DOZ PVT E-52		Cattaneo, Angelo	2	E-52	0700-0700	WHITNEY STAGING	
DOZ PVT E-56		Caton, Jamie	2	E-56	0700-0700	WHITNEY STAGING	
DOZ PVT E-87		White, Dusty	2	E-87	0700-0700	WHITNEY STAGING	
DOZ PVT E-88		Obrien, Mike	2	E-88	0700-0700	WHITNEY STAGING	
6. Work Assignments: Improve and hold control lines. Hold completed control lines. Mop up 300 feet or 100%.							
7. Special Instructions: ***ALL OUT OF STATE ENGINES ARE TO REPORT TO TEHAMA CAMP FOLLOWING SHIFT.*** Identify for backhaul any unneeded hose and equipment in the fire perimeter.							
8. Communications (radio and/or phone contact numbers needed for this assignment):							
Name	Ch	Function	Rx Freq	Rx Tone	Tx Freq	Tx Tone	Notes
SHA CMD	1	COMMAND	154.4300	136.5	159.0150	123.0 (T2)	(T2) BASS MTN
CDF T30	11	TACTICAL	151.3925	192.8 (T16)	151.3925	192.8 (T16)	
CALCORD	15	MEDICAL	156.0750	156.7 (T6)	156.0750	156.7 (T6)	MEDICAL
A/G	6	A/G	159.3150	192.8	159.3150	192.8	AIR TO GROUND IS CDF TAC 17
GUARD	16	EMERGENCY	168.6250		168.6250	110.9	EMERGENCY USE ONLY
9. Prepared by: Name: B.J. Corey		Pos/Title: RESL		Signature:			
ICS 204		Date/Time: 8/2/2018		2216 hrs			

ASSIGNMENT LIST (ICS 204)

1. Incident Name: Carr		2. Operational Period: Date From: 08/03/18 Date To: 08/04/18 Time From: 0700 Time To: 0700				3. Branch: IV Div/Group: M / O Mike Page 2 of 3	
4. Operations Personnel: Operations Section Chief: T. Brownell/ A. McBath (T) (Day) Night Ops: F. Berbena Branch Director: J. Campbell/ D. Davis Branch Safety: S. Wilson / S. Link (T) Division/Group Supervisor: D. Boic/ J. Barrios							
5. Resources Assigned:		** Resources Below in Bold are 12 Hour **				Reporting Location, Special Equipment, Remarks, Notes, and Information Time Location	
Resource Identifier	ALS	Leader	Personnel	Request #			
DOZ PVT E-342		Leland, Ward	2	E-342	0700-0700	WHITNEY STAGING	
DOZ PVT E-346		Looper, John	2	E-346	0700-0700	WHITNEY STAGING	
DOZ PVT E-753		Vicini, Merv	2	E-753	0700-0700	WHITNEY STAGING	
DOZ PVT E-859		Bay, Sean	2	E-851	0700-0700	WHITNEY STAGING	
DOZ PVT E-865		Murphy, Frank	2	E-865	0700-1900	WHITNEY STAGING	
DOZ PVT E-870		Kirkland, Shane	3	E-870	0700-0700	WHITNEY STAGING	
DOZ PVT E-880		Browning, Pat	2	E-880	0700-0700	WHITNEY STAGING	
DOZ PVT E-1100		Baron, Frank	2	E-1100	0700-0700	WHITNEY STAGING	
W/T PVT E-124		Presidio, Linn	2	E-124	0700-0700	WHITNEY STAGING	
W/T PVT E-126		Hudson, Ken	2	E-126	0700-0700	WHITNEY STAGING	
W/T PVT E-127		Mayberry, Steve	2	E-127	0700-0700	WHITNEY STAGING	
W/T PVT E-128		Korbly, Eric	2	E-128	0700-0700	WHITNEY STAGING	
W/T PVT E-129		Dunne, Nick	2	E-129	0700-0700	WHITNEY STAGING	
W/T PVT E-130		Scovil, Peter	2	E-130	0700-0700	WHITNEY STAGING	
W/T PVT E-131		Stanford, Brad	2	E-131	0700-0700	WHITNEY STAGING	
W/T PVT E-134		Anderson, Sandra	2	E-134	0700-0700	WHITNEY STAGING	
W/T PVT E-150		Pini, Tony	1	E-150	0700-0700	WHITNEY STAGING	
SKD PVT E-894		Yokoyama, Paul	1	E-894	0700-1900	WHITNEY STAGING	
6. Work Assignments: Improve and hold control lines. Hold completed control lines. Mop up 300 feet or 100%.							
7. Special Instructions: ***ALL OUT OF STATE ENGINES ARE TO REPORT TO TEHAMA CAMP FOLLOWING SHIFT.*** Identify for backhaul any unneeded hose and equipment in the fire perimeter.							
8. Communications (radio and/or phone contact numbers needed for this assignment):							
Name	Ch	Function	Rx Freq	Rx Tone	Tx Freq	Tx Tone	Notes
SHA CMD	1	COMMAND	154.4300	136.5	159.0150	123.0 (T2)	(T2) BASS MTN
CDF T30	11	TACTICAL	151.3925	192.8 (T16)	151.3925	192.8 (T16)	
CALCORD	15	MEDICAL	156.0750	156.7 (T6)	156.0750	156.7 (T6)	MEDICAL
A/G	6	A/G	159.3150	192.8	159.3150	192.8	AIR TO GROUND IS CDF TAC 17
GUARD	16	EMERGENCY	168.6250		168.6250	110.9	EMERGENCY USE ONLY
9. Prepared by: Name: B.J. Corey		Pos/Title: RESL		Signature:			
ICS 204		Date/Time: 8/2/2018 2216 hrs					

ASSIGNMENT LIST (ICS 204)

1. Incident Name: Carr		2. Operational Period: Date From: 08/03/18 Date To: 08/04/18 Time From: 0700 Time To: 0700				3. Branch: IV Div/Group: P Papa	
4. Operations Personnel: Operations Section Chief: T. Brownell/ A. McBath (T) (Day) Night Ops: F. Berbena Branch Director: J. Campbell/ D. Davis Branch Safety: S. Wilson / S. Link (T) Division/Group Supervisor: D. Laws							
5. Resources Assigned:		** Resources Below in Bold are 12 Hour **				Reporting Location, Special Equipment, Remarks, Notes, and Information Time Location	
Resource Identifier	ALS	Leader	Personnel	Request #			
STC SKU 9262C		Hood, Patty	22	E-255	0700-0700	DP 43	
STC XTB 4229C	ALS	Reid, Jim	17	E-421	0700-0700	DP 43	
STG LMU 9224G		Steele, Mark	33	C-46	0700-0700	DP 43	
CRW CNA TFD		Rodney, Jared	82		0700-1900	DP 43	
STL LMU 9222L		Cox, Christopher	7	E-21	0700-0700	DP 43	
DOZ PVT E-92		Rhoades, Steven	2	E-92	0700-0700	DP 43	
DOZ PVT E-94		Bruce Miller	2	E-94	0700-0700	DP 43	
DOZ PVT E-241		Larue, Clint	2	E-241	0700-0700	DP 43	
DOZ PVT E-242		Drue, Gangbin	2	E-242	0700-0700	DP 43	
DOZ PVT E-349		Darrah, Keith	2	E-349	0700-0700	DP 43	
DOZ PVT E-404		Montz, John	3	E-404	0700-0700	DP 43	
DOZ PVT E-744		Boggs, Steve	2	E-744	0700-0700	DP 43	
DOZ PVT E-749		Parmeter, Doug	2	E-749	0700-0700	DP 43	
DOZ PVT E-750		Parmeter, Wes	2	E-750	0700-0700	DP 43	
DOZ PVT E-752		Perry, Brett	4	E-752	0700-0700	DP 43	
FEMP TRGOVAC O-536	ALS	Trgovac, Tucker	1	O-536	0700-0700	DP 43	
FEMT WALKER O-344		Walker, Adam	1	O-344	0700-0700	DP 43	
6. Work Assignments: Improve and hold control lines. Hold completed control lines. Mop up 300 feet or 100%.							
7. Special Instructions: ***ALL OUT OF STATE ENGINES ARE TO REPORT TO TEHAMA CAMP FOLLOWING SHIFT.*** Identify for backhaul any unneeded hose and equipment in the fire perimeter.							
8. Communications (radio and/or phone contact numbers needed for this assignment):							
Name	Ch	Function	Rx Freq	Rx Tone	Tx Freq	Tx Tone	Notes
SHA CMD	1	COMMAND	154.4300	136.5	159.0150	123.0 (T2)	(T2) BASS MTN
NIFC T6	13	TACTICAL	166.7750	131.8 (T3)	166.7750	131.8 (T3)	
CALCORD	15	MEDICAL	156.0750	156.7 (T6)	156.0750	156.7 (T6)	MEDICAL
A/G	6	A/G	159.3150	192.8	159.3150	192.8	AIR TO GROUND IS CDF TAC 17
GUARD	16	EMERGENCY	168.6250		168.6250	110.9	EMERGENCY USE ONLY
9. Prepared by: Name:		B.J. Corey		Pos/Title: RESL		Signature:	
ICS 204		Date/Time: 8/2/2018		2216 hrs			

ASSIGNMENT LIST (ICS 204)

1. Incident Name: Carr		2. Operational Period: Date From: 08/03/18 Date To: 08/04/18 Time From: 0700 Time To: 0700			3. Branch: North Cont Div/Group: Shasta Page 1 of 2			
4. Operations Personnel: Operations Section Chief: T. Brownell/ A. McBath (T) (Day) Night Ops: F. Berbena Branch Director: J. Brunk Branch Safety: E. D'amico (12hr)/ B. Steinberg (12hr) Division/Group Supervisor: J. Reglin								
5. Resources Assigned:		** Resources Below in Bold are 12 Hour **					Reporting Location, Special Equipment, Remarks, Notes, and Information Time Location	
Resource Identifier	ALS	Leader	Personnel	Request #				
CRW PVT C-200000		Campbell, Brandon	20	C-200000	0700-1900	LAKESHORE STA.		
CRW PVT C-200001		Campbell, Jason	20	C-200001	0700-1900	LAKESHORE STA.		
CRW SRF UKONOM		Berg, Joel	19	C-200004	0700-1900	LAKESHORE STA.		
DOZ SHF 79		Rivers, Victor	3	E-200000	0700-1900	LAKESHORE STA.		
DOZ MDF 4		St John, Perry	2	E-200001	0700-1900	LAKESHORE STA.		
DOZ PVT E-200007		Clark, Steve	2	E-200007	0700-1900	LAKESHORE STA.		
DOZ PVT E-200008		Johnson, Bob	2	E-200008	0700-1900	LAKESHORE STA.		
DOZ PVT E-200008		Johnson, Bob	2	E-200008	0700-1900	LAKESHORE STA.		
DOZ PVT E-200010		Humphrey, Ronald	2	E-200010	0700-1900	LAKESHORE STA.		
DOZ PVT E-200011		Furtado, Shawn	2	E-200011	0700-1900	LAKESHORE STA.		
MAS PVT E-200004					0700-1900	LAKESHORE STA.		
MAS PVT E-200028		Gleim, Chad	2	E-200028	0700-1900	LAKESHORE STA.		
TFLD ANDERSON O-200000		Anderson, Mike	1	O-200000	0700-1900	LAKESHORE STA.		
TFLD BORLAUG O-200030		Borlaug, Erik	1	O-200030	0700-1900	LAKESHORE STA.		
TFLD (T) MENAGO		Menago, Matt	1		0700-1900	LAKESHORE STA.		
HEQB (T) GREGORY O-200049		Gregory, Michael	1	O-200049	0700-1900	LAKESHORE STA.		
FALM O-200098		North Zone Fallers	1	O-200098	0700-1900	LAKESHORE STA.		
FALM O-200101			2	O-200101	0700-1900	LAKESHORE STA.		
6. Work Assignments: Reopen and prepare existing dozer lines on Backbone Ridge from Shasta Lake to Dog Creek Mtn. Prepare Road 35N77 from Dog Creek Mtn south to Road 35N38 to Schell Mtn. Reopen and prepare existing dozer lines from Schell Mtn south to Wild Cow Mtn. Establish dozer line from Wild Cow Mtn to Trinity Mtn Road.								
7. Special Instructions: ***ALL OUT OF STATE ENGINES ARE TO REPORT TO TEHAMA CAMP FOLLOWING SHIFT.*** Identify for backhaul any unneeded hose and equipment in the fire perimeter.								
8. Communications (radio and/or phone contact numbers needed for this assignment):								
Name	Ch	Function	Rx Freq	Rx Tone	Tx Freq	Tx Tone	Notes	
SHA CMD	1	COMMAND	154.4300	136.5	159.0150	123.0 (T2)	(T2) BASS MTN	
NIFC T6	12	TACTICAL	166.7750	131.8 (T3)	166.7750	131.8 (T3)		
CALCORD	15	MEDICAL	156.0750	156.7 (T6)	156.0750	156.7 (T6)	MEDICAL	
A/G	6	A/G	159.3150	192.8	159.3150	192.8	AIR TO GROUND IS CDF TAC 17	
GUARD	16	EMERGENCY	168.6250		168.6250	110.9	EMERGENCY USE ONLY	
9. Prepared by: Name: B.J. Corey Pos/Title: RESL Signature: 								
ICS 204		Date/Time: 8/2/2018		2216 hrs				

ICS 205 - INCIDENT RADIO COMMUNICATIONS PLAN

CONTROLLED UNCLASSIFIED
INFORMATION//BASIC

1. Incident Name: Carr Branches I, II, and Cont.	2. Date/Time Prepared Date: 08/02/2018 Time: 1830	3. Operational Period: Date To: 08/04/18 Time To: 0700
---	--	---

4. Communications									
Ch#	Function	Name	Assigned To	Rx Freq	Rx Tone	Tx Freq	Tx Tone	Notes	
1	COMMAND	SHA CMD	ALL DIVISIONS	154.4300	136.5	159.0150	123.0 (T2)	(T2) BASS MTN	
2	COMMAND	SHA CMD T4	ALL DIVISIONS	154.4300	136.5	159.0150	136.5 (T4)	(T4) INSKIP MTN	
3	COMMAND	SHA CMD T14	ALL DIVISIONS	154.4300	136.5	159.0150	151.4 (T14)	(T14) HOADLEY MTN	
4	COMMAND	SHA CMD T15	ALL DIVISIONS	154.4300	136.5	159.0150	162.2 (T15)	(T15) SUGARLOAF MTN	
5	COMMAND	CALAW1	ALL DIVISIONS	154.9200	0	154.9200	0	LE INTEROPERABILITY	
6	A/G	A/G	ALL DIVISIONS	159.3150	192.8	159.3150	192.8	AIR TO GROUND IS CDF TAC 17	
7	TACTICAL	VFIRE 23	DIV S / T / U	154.2950	156.7 (T6)	154.2950	156.7 (T6)		
8	TACTICAL	VFIRE 24	DIV V / X	154.2725	156.7 (T6)	154.2725	156.7 (T6)		
9	TACTICAL	VFIRE 25	DIV Y	154.2875	156.7 (T6)	154.2875	156.7 (T6)		
10	TACTICAL	VFIRE 26	DIV A	154.3025	156.7 (T6)	154.3025	156.7 (T6)		
11	TACTICAL	NIFC T5	DIV B	166.7250	131.8 (T3)	166.7250	131.8 (T3)		
12	TACTICAL	NIFC T6	UNASSIGNED	166.7750	131.8 (T3)	166.7750	131.8 (T3)		
13	TACTICAL	NIFC T7	NORTH CONT	168.2500	131.8 (T3)	168.2500	131.8 (T3)		
14	TACTICAL	CDF T32	WEST	151.2425	192.8 (T16)	151.2425	192.8 (T16)		
15	MEDICAL	CALCORD	ALL DIVISIONS	156.0750	156.7 (T6)	156.0750	156.7 (T6)	MEDICAL	
16	EMERGENCY	GUARD	ALL DIVISIONS	168.6250		168.6250	110.9	EMERGENCY USE ONLY	
17									
18									
19									
20	EMERGENCY	GUARD	ALL DIVISIONS	168.6250		168.6250	110.9	EMERGENCY USE ONLY	

5. Special Instructions	
6. Prepared by (Communications Unit Leader): Name: Tom Webb	
	Signature:
	Date/Time: 08/02/18 1830

ICS 205 - INCIDENT RADIO COMMUNICATIONS PLAN

1. Incident Name: Carr Branches III and IV	2. Date/Time Prepared Date: 08/02/2018 Time: 1830	3. Operational Period: Date To: 08/04/18 Time To: 0700
---	--	---

4. Communications									
Ch#	Function	Name	Assigned To	Rx Freq	Rx Tone	Tx Freq	Tx Tone	Notes	
1	COMMAND	SHA CMD	ALL DIVISIONS	154.4300	136.5	159.0150	123.0 (T2)	(T2) BASS MTN	
2	COMMAND	SHA CMD T4	ALL DIVISIONS	154.4300	136.5	159.0150	136.5 (T4)	(T4) INSKIP MTN	
3	COMMAND	SHA CMD T14	ALL DIVISIONS	154.4300	136.5	159.0150	151.4 (T14)	(T14) HOADLEY MTN	
4	COMMAND	SHA CMD T15	ALL DIVISIONS	154.4300	136.5	159.0150	162.2 (T15)	(T15) SUGARLOAF MTN	
5	COMMAND	CALAW1	ALL DIVISIONS	154.9200	0	154.9200	0	LE INTEROPERABILITY	
6	A/G	A/G	ALL DIVISIONS	159.3150	192.8	159.3150	192.8	AIR TO GROUND IS CDF TAC 17	
7	TACTICAL	CDF T26	DIV C	159.2925	192.8 (T16)	159.2925	192.8 (T16)		
8	TACTICAL	CDF T27	DIV D	159.3075	192.8 (T16)	159.3075	192.8 (T16)		
9	TACTICAL	CDF T28	DIV F	151.1825	192.8 (T16)	151.1825	192.8 (T16)		
10	TACTICAL	CDF T29	DIV H	151.3475	192.8 (T16)	151.3475	192.8 (T16)		
11	TACTICAL	CDF T30	DIV M / O	151.3925	192.8 (T16)	151.3925	192.8 (T16)		
12	TACTICAL	CDF T32	WEST	151.2425	192.8 (T16)	151.2425	192.8 (T16)		
13	TACTICAL	NIFC T6	DIV P	166.7750	131.8 (T3)	166.7750	131.8 (T3)		
14	TACTICAL	NIFC T7	NORTH CONT	168.2500	131.8 (T3)	168.2500	131.8 (T3)		
15	MEDICAL	CALCORD	ALL DIVISIONS	156.0750	156.7 (T6)	156.0750	156.7 (T6)	MEDICAL	
16	EMERGENCY	GUARD	ALL DIVISIONS	168.6250		168.6250	110.9	EMERGENCY USE ONLY	
17									
18									
19									
20	EMERGENCY	GUARD	ALL DIVISIONS	168.6250		168.6250	110.9	EMERGENCY USE ONLY	

5. Special Instructions

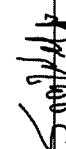
6. Prepared by (Communications Unit Leader): Name: Tom Webb	Signature: 
ICS 205 - CONTROLLED UNCLASSIFIED INFORMATION//BASIC	Date/Time: 08/02/18 1830

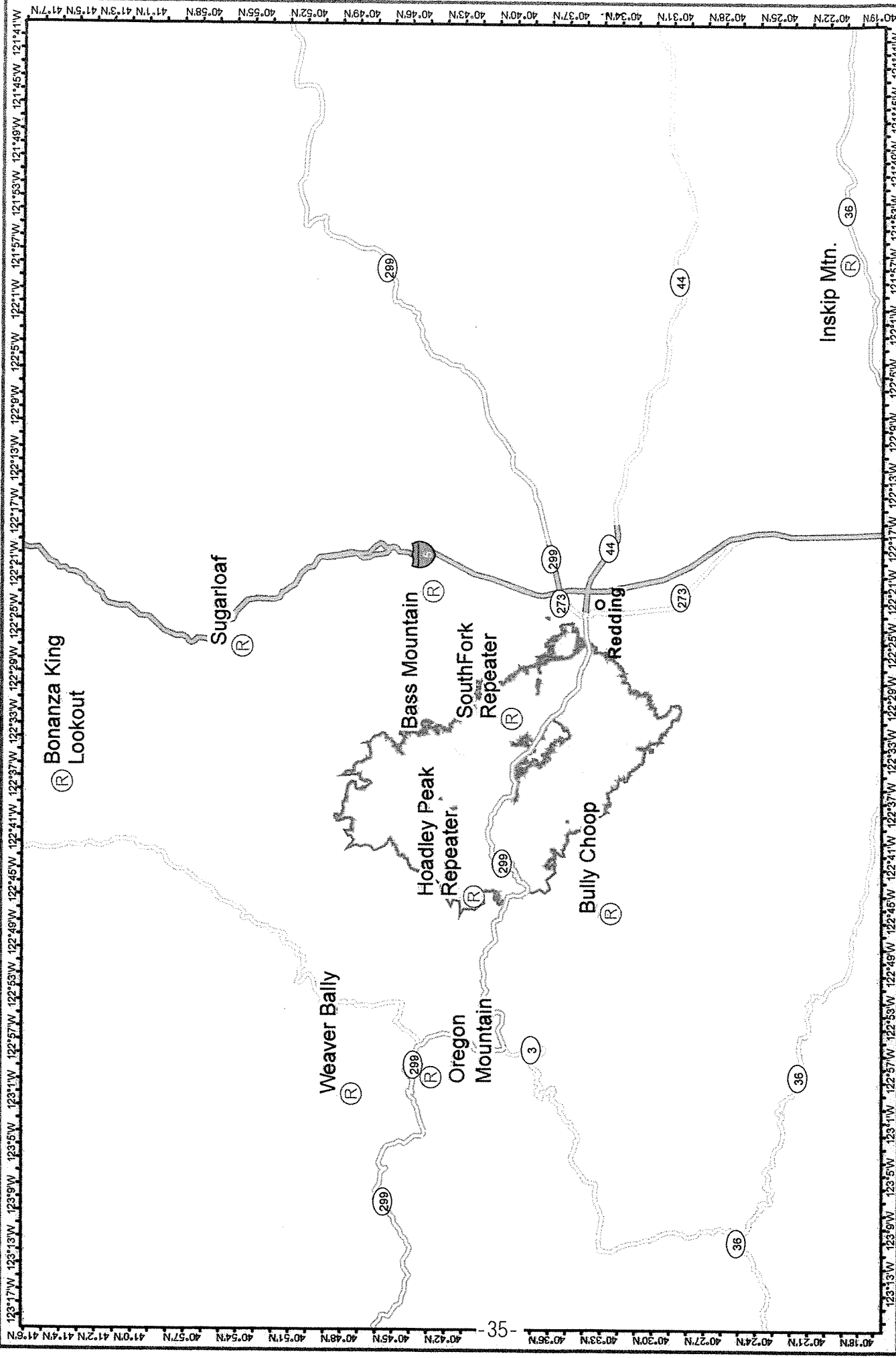

- Camp
- Incident Command
- Post
- Drop Point

Communication Map
Carr Fire
 CA-SHU-007808

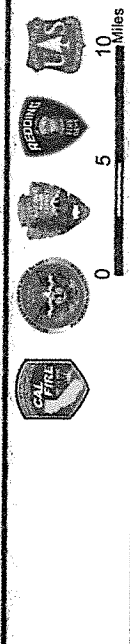

Carr Fire
 CA-SHU-007808
COMMS
 Aug 3, 2018

SAFETY MESSAGE/PLAN (ICS 208)

INCIDENT NAME: CARR FIRE CA-SHU-007808	Operational Period: Date From: 8/3/18 Date to: 8/4/18 Time From: 0700 Time to: 0700
---	--

MAJOR HAZARDS AND RISKS

- **REPOPULATION: Be aware and respectful of the public returning to their homes.**
- **RE-ENERGIZED POWER TRANSMISSION LINES: Be aware that lines may be live.**

HYDRATION/NUTRITION/FATIGUE

Drink plenty of fluids throughout the day and eat accordingly. Address dehydration and fatigue concerns immediately upon symptom onset. Keep up on personal hygiene. Balance electrolyte intake.

HAZARDOUS TREES AND SNAGS

Be alert of snags due to tree mortality and drought. Crews are working in a very hazardous area with numerous dead trees, stay diligent and flag hazardous areas. Avoid taking breaks under trees.

DRIVING

Steep, narrow, dusty roads throughout fire area. Maintain safe following distances and appropriate speed when traversing roads. Flag unstable roads and other hazards that may be encountered while driving.

RESOURCE ACCOUNTABILITY

Maintain prompt communications with your forces, your supervisor and adjoining forces. Give clear instructions and ensure they are understood.

COMMUNICATIONS

Confirm all personnel have latest clone, test prior to going to line. Utilize human repeaters as necessary. Try alternative channels if unsuccessful with primary. Receive a good briefing, at the end of your briefing you should be able to understand the **TASK-PURPOSE** and **END STATE** of your assignment. If not clear ask questions

FIRE BEHAVIOR/WEATHER

Watch for winds to increase throughout the day and switch direction to come out of the NW. Maintain Situational Awareness and develop Decision Points for when to change your tactics. In Red Flag.

BOAT/WATER SAFETY

A briefing on the watercraft shall occur prior to departure, PFD's will be worn within 10' of the water line, no watercraft transportation after dark, a weather forecast shall be obtained prior to launching, follow manufacturer recommendations for safe operation.

MARIJUANA GROWS

As fire personnel enter into Branch II, III and IV beware of large marijuana grows and chemicals in the area. If chemicals catch fire take appropriate actions to stay a safe distance away. Flag these areas to prevent accidental entry by fire personnel.

Prepared By: Anthony Stornetta Position/Title: SOF1(T)
Signature: _____ *A. Stornetta*

ICS 208	IAP Page	Date/Time: 8/2/18 1850 hrs.
---------	----------	-----------------------------

MEDICAL PLAN (ICS 206)

1. Incident Name: CARR INCIDENT		2. Operational Period: Date From: 08/03/2018 Time From: 07:00		Date To: 08/04/2018 Time To: 07:00			
3. Medical Aid Stations:		MEDICAL UNIT LEADER: (408) 710-7196		COMMUNICATIONS UNIT: (530) 949-6816			
Name	Location	Contact Number(s)/Frequency	Paramedics on Site?				
MERT	BASE CAMP (BY CDC SLEEPING AREA)	(530) 310-0716	RN & PA				
EXPEDITORS	ANDERSON FAIRGROUNDS (NEAR BRIEFING)	---	NONE				
FRONTLINE MEDICAL	RED BLUFF FAIRGROUNDS	(530) 604-8380	PARAMEDICS				
4. Transportation (indicate air or ground):							
Ambulance Service	Location	Contact Number(s)/Frequency	Level of Service				
AMR 145	HWY 299 X MAGNOLIA & BASE CAMP	SHASTA COMMAND	ALS				
MERCY 115	HWY 299 X MAGNOLIA AVE & BASE CAMP	SHASTA COMMAND	ALS				
TRINITY MEDIC 8	FAIRVIEW MARINA, TRINITY COUNTY	SHASTA COMMAND	ALS				
REACH AIRSHIP 5	1524 East St. Redding	(877) 939-6300	RN				
PHI AIR MED	5900 Old Oregon Trail Redding	(800) 597-9571	RN				
CHP 14 & 16 (HOIST)	2651 Gold Street (Benton Airpark), Redding	(530) 225-2040	ALS/HOIST				
NATIONAL GUARD 840	REDDING MUNI HELIBASE	CDF COMMAND 2 T14	24 HOUR HOIST				
5. Hospitals:							
Hospital Name	Address, Latitude & Longitude if Helipad	Contact Number(s)/ Frequency	Travel Time		Trauma Center	Burn Center	Helipad
			Air	Ground			
SHASTA REG MED CTR MED 2	1100 BUTTE ST, REDDING 40° 35.106'N, 122° 23.268'W	(530) 244-5400 468.025 Tx, 468.025 Rx PL 5	10 MIN	29 MIN	YES LEVEL: 3	NO	YES
MERCY MED CTR MED 4	2175 ROSALINE AVE, REDDING 40° 34.332'N, 122° 23.796'W	(530) 225-7201 468.075 Tx, 463.000 Rx PL 5	10 MIN	29 MIN	YES LEVEL: 2	NO	YES
UC DAVIS MED 8	2315 STOCKTON BLVD SACRAMENTO 38° 33.360'N, 121° 27.330'W	(916) 734-2011 446.525 Tx, 203.5 Rx	1.25 HOUR	3.5 HOUR	YES Level: 1	YES	YES
TRINITY HOSPITAL WEAVERVILLE	60 EASTER AVENUE WEAVERVILLE N40° 44.275' W122°56.359'	(530)623-5541 x1	20 MIN	45 MIN	NO	NO	YES
6. Special Medical Emergency Procedures:			BASE CAMP EMERGENCY:				
LINE EMERGENCY:			CONTACT COMMUNICATIONS UNIT AT: (530) 949-6816				
Crew Supervisor to contact Division Supervisor with patient complaint/condition, location, and resource needs.			report patient complaint/condition and location. Medical Staff will respond to stabilize incident				
<ul style="list-style-type: none"> • Division Supervisor contacts and gives report on conditions, complaint/condition, and resource needs to: <ol style="list-style-type: none"> 1. Nearest Line FEMT/FEMP 2. Communications Unit • Emergency or Priority traffic received: Communication Unit will clear the command channel for emergency traffic only, for the duration of the MAJOR IWI • Communications Unit will make proper notifications • OPERATIONS can declare a MAJOR IWI based on the report on conditions from the division supervisor • Division Supervisor or designee will serve as point of contact (IWI SUPERVISOR) and run the emergency utilizing the COMMAND CHANNEL and CALCORD for the tac net during the IWI 			<ul style="list-style-type: none"> • COMMUNICATIONS Unit contacts: <ol style="list-style-type: none"> 1. Operations 2. Medical 3. Safety 4. Logistics 				
<p>**ALL EMERGENCIES: Secure the area and identify witnesses for later investigation. Keep an accurate log of events**</p> <p style="text-align: center;">***START 20 MINUTE TIMER IF IWI***</p>			<p>INJURY REPORTING PROCEDURES</p> <p>CHIEF COMPLAINT _____</p> <p>LOCATION OF PATIENT _____</p> <p>TRANSPORT REQUEST BY: AIR ___ GROUND ___</p> <p>DIVISION _____ CREW _____</p> <p>POINT OF PICKUP _____</p> <p>LAT _____ LONG _____</p> <p>IS EMT WITH THE PATIENT: YES ___ NO ___</p> <p>AGE _____</p> <p>SEX: MALE ___ FEMALE ___</p> <p>**Pre-determined rendezvous location for transfer from rescue helicopter to ground ambulance or air ambulance: SKY RANCH HELIBASE**</p> <p style="text-align: center;">N 40°29.49 W 122°22.27 7400 MARKET ST REDDING, 96003</p>				
7. Prepared by (Medical Unit Leader): Name: JESSE WINNEN			Signature: _____				
8. Approved by (Safety Officer): ANTHONY STORNETTA			Signature: _____				
ICS 206	IAP Page _____	Date/Time: 08/02/2018 1800					



STRUCTURE DEFENSE GUIDE

STRUCTURE TRIAGE DECISION PROCESS (S-FACTS)

SURVIVAL

- Initial Assessment: can you survive here? **If not, LEAVE NOW!**
- Is there a Safety Zone nearby? **If not, LEAVE NOW! (IRPG)**
- Do you have a viable Escape Route?
- What is the decision point at which you will leave based on fire behavior and rate of spread?
- Is there a Temporary Refuge Area (TRA) on site? **If not, LEAVE NOW!**
 - Preplanned area for immediate, temporary refuge
 - Use of fire shelter should not be necessary
 - Is there a viable Escape Route to the TRA or Safety Zone?
- Is "Prep and Go" tactic an option?
- Do you have communications with your supervisor and adjoining forces?
- If safety issues cannot be mitigated, **LEAVE NOW!**

FIRE ENVIRONMENT

- Can you survive based on current and expected fire behavior? **If not, LEAVE NOW!**
- Look up, Look Down, Look Around Indicators:
 - Fuels (characteristics, moisture, temperature)
 - What will the intensity of the fire be when it arrives?
 - How long will it take to consume the fuels?
 - Wind
 - Current speed/direction
 - Expect changing winds
 - Terrain
 - Are you in a chute, chimney, or saddle? **If yes, LEAVE NOW!**
 - Is wind in alignment with topography?
 - What is your position relative to topography?
 - Are you mid slope or on top of a ridge?
 - Atmospheric Stability
 - Fire Behavior (requires constant monitoring)
 - Spotting, crowning, sheeting, rate of spread?
 - Flame length and height?
- Other weather considerations:
 - What is the current relative humidity?
 - Is there an expected change?
 - Are thunderstorms forecasted?

ACCESS

- Is access compatible with time and distance factors necessary to utilize as an Escape Route to a Safety Zone?
 - Road surface adequate for speed necessary?
 - Adequate width?
 - Turnaround/turnouts?
 - Bridges within limits for fire apparatus?
 - Drainage ditches/culverts?
 - Steep grades?
 - Is there a safe place to spot apparatus?

CONSTRUCTION/CLEARANCE

- Does the structure have adequate defensible space, based on topography, fuels, and current and expected fire behavior?
- Can defensible space problems be mitigated quickly?
- Will building materials and yard clutter compromise safety?
- Is the construction wood siding or shake shingle roof?
- Are there vent openings, open eaves, large glass windows facing fire front, decks with vegetation below?
 - Will ember intrusion through attic or foundation vents be a problem?
- What are the contents in the garage and outbuildings?
- Are there hazardous materials present?
- Are there propane tanks, fuel tanks, or power lines?
- Is there an adequate water supply nearby?
- Are additional resources needed to mitigate issues?
- Consider "Prep and Go" or "Prep and Defend" tactics

TIME CONSTRAINTS

- Is there time for an adequate size up of the structure defense problem?
- Is there time to mitigate safety concerns?
- Is there time and adequate resources to properly prepare and defend the structure?
- Is there time to escape, utilizing Escape Routes, to a Safety Zone? **If not, LEAVE NOW!**

STAY OR GO

- Tactical decision based on the S-FACTS
- Is it safe to stay? If no, utilize "Check and Go" tactic
- Is there time to prepare the structure for defense and what will the fire behavior be when the fire gets here?
- "Prep and Go" or "Fire Front Following" tactics should be used when it is not safe to "Prep and Defend"

STRUCTURE TRIAGE CATEGORIES

Not-Threatened

- Safety Zone nearby and TRA present at structure
- Construction features/defensible space make the structure unlikely to ignite
- Residents may/may not have evacuated

Threatened Defensible

- Safety Zone nearby and TRA present at structure
- Construction features/defensible space require structure defense tactics during fire front impact
- Residents may/may not have evacuated

Threatened non-Defensible

- Lack of adequate Safety Zone nearby
- Structure cannot be safely defended
- Residents must be evacuated

ENTRAPMENT AVOIDANCE

- Are you adhering to the **10 Standard Firefighting Orders?** (IRPG)
- Have you considered the **18 Situations that Shout Watch Out?**
- Have you considered the **Common Denominators of Fire Behavior on Tragedy Fires?** (IRPG)
- Are you maintaining **LCES?** (IRPG)
- Look Up, Look Down, Look Around (IRPG)
- Have Decision Points ("Trigger Points") been established?
- Conduct Risk Management (IRPG)
 - Situational Awareness – Hazard Assessment – Hazard Control – Decision Point – Evaluate

FIRING OPERATION CHECKLIST

Location: _____

Date: _____ Time: _____

Firing Supervisor _____

1. Personnel Briefing

- Objectives
- Conditions (fire environment)
- Resource assignments identified
 - Firing personnel
 - Holding forces
 - Lookouts
- Ignition plan/sequence
- Communication Plan
- Contingency Plan
- Safety issues

2. Go / No-Go

- All personnel briefed
- Weather forecast reviewed
- Resources in place
- Lookouts posted as needed
- Anchor and termination firing points identified
- Communications systems in place
- Fire behavior forecast reviewed
- Escape routes and safety zones established and made known
- Adjoining forces/Air Attack notified

3. Approval Prior To Firing

- Division Supervisor
- Branch Director
- Operations

4. Other Notifications

- Other: _____
- Other: _____

Attach Firing Operations Checklist to ICS-214



CARR FIRE

CA-SHU-007808

FINANCE MESSAGE

- Finance Section is located in Fusaro Building
 - Please come by the Time Unit and start your and update your FC-33
 - Vendors please drop off your agreements to the Time Unit
 - Shift Tickets need to be completed by line supervisor and turned in at the end of each shift.
 - All injuries need to be reported to the COMP / CLAIMS Unit
 - All property Damage must be reported and documented
 - Please report any Vehicle Damage this includes Rental Vehicles
 - Local Government please check in with OES
 - Federal Time: Timekeeper on site.
 - **OFF-SITE FEEDING IS NOT APPROVED**
 - Water usage report needs to be turned in daily to the COMP / CLAIMS Unit
-
- **This fire is under Cost Apportionment**
 - **All DIVS, OPBD, STAM need to debrief with the Cost Apportionment Team Daily**
 - Cost Apportionment is located in the trailer directly across from Fusaro Hall

INCIDENT BILLING INFORMATION

CAL FIRE – SHASTA / TRINITY UNIT

875 CYPRESS AVE.
Redding Ca. 96001

Index Code: 2400

E-fund Billing Code: 013860

Federal P Code: PPL1A6 (1502) [P]

STATE OF CALIFORNIA
 DEPARTMENT OF FORESTRY AND FIRE PROTECTION
PROPERTY CERTIFICATION OF LOCATION OR DAMAGE
CERTIFICATE OF RESPONSIBILITY FOR INCIDENT OCCURRENCE
 CAL FIRE-101 page 1 of 2 (1/07)

NOTE: This form must not be used to certify lost, stolen or worn out property. A STD 152 Property Survey Report must be completed.

DOC. NUMBER:

LOCATION / INCIDENT NAME:	INCIDENT NUMBER:	UNIT:	REGION:	DATE:
THE FOLLOWING ARTICLES WERE: (broken, left on line, damaged, or other)				DATE OF OCCURRENCE:

QUANTITY	UNIT OF MEAS.	CAL FIRE STOCK NUMBER (COMPLETE WHENEVER ASSIGNED)	DESCRIPTION (INDICATE SIZE, MAKE, MODEL, TYPE, ETC., TO CLEARLY DESCRIBE THE ITEM, PROVIDE ADEQUATE DATA TO EFFECTIVELY IDENTIFY EQUIPMENT OR PROPERTY.)	PROPERTY NUMBER

LOCATION OF ITEMS:

REMARKS:

SIGNATURE OF PERSON CERTIFYING OCCURRENCE AS DESCRIBED			
SIGNATURE:	PRINTED NAME:	TITLE:	DATE:

UNIT SUPERVISOR'S APPROVAL

COMMENTS:

SIGNATURE OF UNIT ADMINISTRATOR:	TITLE:	DATE:
----------------------------------	--------	-------



WATER USAGE REPORT

DATE: _____

Division / Group: _____

AGENCY ID / VENDOR: _____

I.e.. Strike Team 1110C, Acme Water Tenders

REQUEST # _____

TURN INTO FINANCE DAILY

WATER SOURCE LOCATION	Hydrant	Open source i.e. pond	Tank	Gallons Used	Property Owner / Contact Number if known **

****Please note if you made contact with property owner and their contact.
(Use reverse side if needed.)**

Information: _____

The intent of this document is intended to track, record and validated the amount of water used on a incident. It's not intended to review the performance of equipment using the water on an incident.

SHIFT TICKET EXAMPLE

EMERGENCY SHIFT TICKET and EVALUATION FORM						Contractor Name			
Incident or Project Name LILAC INC			Incident Number CAMVU024612		Request Number E#		DOZER DUDE		
Agreement Number XXX - 000000 - 00						Operator #1 BOB SMITH		Operator #2 TOM SMITH	
Equipment Make CAT			Equipment Model / Type D6XM			Operator Furnished By: <input checked="" type="checkbox"/> Contractor <input type="checkbox"/> Government			
Serial Number FULL VIN#			Licence Number 1234567			Operating Supplies Furnished By: <input checked="" type="checkbox"/> Contractor <input type="checkbox"/> Government			
Equipment Use						Equipment Status			
(Circle) Hours Days / Miles						<input checked="" type="checkbox"/> Inspected <input type="checkbox"/> Under Agreement			
Date						Released by Government			
Mo / Day Start Stop Work Assignment						Withdrawn by Contractor			
12/8 0700 2400 17 DIV M						2 OPERATORS			
12/9 0001 0700 7 DIV M									
Vendor Rating						Govt. Rep. Name and Position - PRINT			
Poor* Avg. Good Exc. N/A						Mike Weber			
Met Performance Expectations						Govt. Rep. Signature			
Equipment in Safe Working Condition						<i>Mike Weber</i>			
Operator Skill Level						Contractor Signature			
Operates Safely						<i>Bob Smith</i>			
Operator's Cooperation Level						Date Time			
Overall Performance						08/04/15 0800			
* NOTE: Any rating of POOR requires an explanation in Comment Section.						CALFIRE 297			
**Final evaluation or for more documentation, use an ICS Form 230 or equivalent.						(Rev 3-2011)			
Pink - Finance		Blue - Home Unit HE Coordinator		Yellow - Vendor		White - Govt Representative			

EMERGENCY SHIFT TICKET and EVALUATION FORM						Contractor Name				
The responsible Government Officer will complete this form each shift						DUDE TRANSPORT				
Incident or Project Name LILAC INC			Incident Number CAMVU 024612		Request Number E #		BOB SMITH		TOM SMITH	
Agreement Number XXX - 000000 - 00						Operator Furnished By: <input checked="" type="checkbox"/> Contractor <input type="checkbox"/> Government				
Equipment Make TRANSPORT/ KENWORTH			Equipment Model / Type COZAD TRAILER /26 WHEELS			Operating Supplies Furnished By: <input checked="" type="checkbox"/> Contractor <input type="checkbox"/> Government				
Serial Number 1XP3ESMP14239012			Licence Number 9999999			Equipment Status				
Equipment Use						<input checked="" type="checkbox"/> Inspected <input type="checkbox"/> Under Agreement				
(Circle) Hours Days / Miles						Released by Government				
Date						Withdrawn by Contractor				
Mo / Day Start Stop Work Assignment						2 OPERATORS				
12/8 0700 2400 17 DIV M										
12/9 0001 0700 7 DIV M										
Vendor Rating						Govt. Rep. Name and Position - PRINT				
Poor* Avg. Good Exc. N/A						Mike Weber				
Met Performance Expectations						Govt. Rep. Signature				
Equipment in Safe Working Condition						<i>Mike Weber</i>				
Operator Skill Level						Contractor Signature				
Operates Safely						<i>Bob Smith</i>				
Operator's Cooperation Level						Date Time				
Overall Performance						08/04/15 0800				
* NOTE: Any rating of POOR requires an explanation in Comment Section.						CALFIRE 297				
**Final evaluation or for more documentation, use an ICS Form 230 or equivalent.						(Rev 3-2011)				
Pink - Finance		Blue - Home Unit HE Coordinator		Yellow - Vendor		White - Govt Representative				

Turn shift tickets into Finance.

SHIFT TICKET EXAMPLE

EMERGENCY SHIFT TICKET and EVALUATION FORM						Contractor Name H2O DUDE							
Incident or Project Name LILAC INC		Incident Number CAMVU 024612		Request Number E or S # Here		Operator #1 BOB SMITH	Operator #2						
Agreement Number XXX - 000000 - 00						Operator Furnished By: <input checked="" type="checkbox"/> Contractor <input type="checkbox"/> Government							
Equipment Make FREIGHTLINER		Equipment Model / Type WATER TENDER 2500+ TYPE 1				Operating Supplies Furnished By: <input checked="" type="checkbox"/> Contractor <input type="checkbox"/> Government							
Serial Number LAST 8 OF VIN#		Licence Number 55555555				Equipment Status <input checked="" type="checkbox"/> Inspected <input checked="" type="checkbox"/> Under Agreement							
Equipment Use (Circle) Hours Days / Miles						Released by Government <input type="checkbox"/> Withdrawn by Contractor <input type="checkbox"/>							
Date Mo / Day	Start	Stop	Work	Assignment		Remarks/Comments ** ONE OPERATOR							
12/8	0001	0700	7	OFF SHIFT									
12/8	0700	1900	12	BASE CAMP									
12/8	1900	2400	5	OFFSHIFT									
Vendor Rating						Govt. Rep. Name and Position - PRINT Mike Weber							
<table border="1"> <tr> <td>Poor*</td> <td>Avg.</td> <td>Good</td> <td>Exc.</td> <td colspan="2">N/A</td> </tr> </table>						Poor*	Avg.	Good	Exc.	N/A		Govt. Rep. Signature Mike Weber	
Poor*	Avg.	Good	Exc.	N/A									
Met Performance Expectations						Contractor Signature Bob Smith							
Equipment in Safe Working Condition						Date 08/04/15							
Operator Skill Level						Time 0800							
Operates Safely						<p>* NOTE: Any rating of POOR requires an explanation in Comment Section.</p> <p>**Final evaluation or for more documentation, use an ICS Form 230 or equivalent.</p>							
Operator's Cooperation Level						CALFIRE 297 (Rev 3-2011)							
Overall Performance						<p>Pink - Finance Blue - Home Unit HE Coordinator Yellow - Vendor White - Govt Representative</p>							

EMERGENCY SHIFT TICKET and EVALUATION FORM						Contractor Name WATER GUY							
The responsible Government Officer will complete this form each shift						Operator #1 BOB SMITH							
Incident or Project Name LILAC INC		Incident Number CAMVU 024612		Request Number E OR S # Here		Operator #2 BILL SMITH							
Agreement Number XXX - 000000 - 00						Operator Furnished By: <input checked="" type="checkbox"/> Contractor <input type="checkbox"/> Government							
Equipment Make PETERBUILT		Equipment Model / Type WATER TENDER 2500 + TYPE 1				Operating Supplies Furnished By: <input checked="" type="checkbox"/> Contractor <input type="checkbox"/> Government							
Serial Number LAST 8 OF VIN#		Licence Number 99999999				Equipment Status <input checked="" type="checkbox"/> Inspected <input checked="" type="checkbox"/> Under Agreement							
Equipment Use (Circle) Hours Days / Miles						Released by Government <input type="checkbox"/> Withdrawn by Contractor <input type="checkbox"/>							
Date Mo / Day	Start	Stop	Work	Assignment		Remarks/Comments ** 2 OPERATORS							
12/8	0700	2400	17	DIV M									
12/9	0001	0700	7	DIV M									
Vendor Rating						Govt. Rep. Name and Position - PRINT Mike Weber							
<table border="1"> <tr> <td>Poor*</td> <td>Avg.</td> <td>Good</td> <td>Exc.</td> <td colspan="2">N/A</td> </tr> </table>						Poor*	Avg.	Good	Exc.	N/A		Govt. Rep. Signature Mike Weber	
Poor*	Avg.	Good	Exc.	N/A									
Met Performance Expectations						Contractor Signature Bob Smith							
Equipment in Safe Working Condition						Date 08/04/15							
Operator Skill Level						Time 0800							
Operates Safely						<p>* NOTE: Any rating of POOR requires an explanation in Comment Section.</p> <p>**Final evaluation or for more documentation, use an ICS Form 230 or equivalent.</p>							
Operator's Cooperation Level						CALFIRE 297 (Rev 3-2011)							
Overall Performance						<p>Pink - Finance Blue - Home Unit HE Coordinator Yellow - Vendor White - Govt Representative</p>							

Turn shift tickets into Finance.



PUBLIC INFORMATION SECTION

Incident Information Line: (530) 225-2510

Incident Media Line: (530) 448-2466

Email Updates (sign-up):

www.tinyurl.com/carrfire



STATUS	
Incident Start Date: 7/23/2018	Incident Start Time: 1:15 PM
Cause: Mechanical Failure of Vehicle	Acres:
Containment:	Total Personnel:

MEDIA – The California State Penal Code Section 409.5(d) allows the news media to enter scenes of disaster, riot or civil disturbance. Properly identified members of the news media should not be restricted from entering locations specified within the code. However, this does not include crime scenes, private property and does not imply that the news media may interfere with incident operations while they are in the areas of concern. More information can be found [here](#).



CAL FIRE SOCIAL MEDIA POLICY – When assigned to a CAL FIRE incident, you will adhere to the CAL FIRE Social Media Policy, Section 0691. You can find further information about the CAL FIRE Social Media Policy [here](#).



PHOTOGRAPHS AND VIDEOS OF INCIDENT – We are in a new era of media. Media no longer means news/broadcast industry, but now refers to anyone that has the capability to shoot video, photographs and post them onto social media sites in a matter of minutes. Unfortunately, we have seen some instances of photographs or videos that have depicted unsafe, unprofessional or embarrassing circumstances which are a serious breach of ethics. When this happens, it reflects poorly on all that are attached to this incident. Posting an inappropriate video, photo or blog comment could expose oneself to unwanted ramifications. It may be unsafe to shoot photos or video and a firefighter who is concentrating on a camera loses their situational awareness.

The Public Information Office would like copies of the video and pictures that you safely took while not in an emergency situation, fire suppression activity or in an overhead assignment. Bring your video and pictures to the Public Information trailer; they will be reviewed and possibly uploaded to our many CAL FIRE social media sites. Remember, we don't want photographs or videos that depict unsafe, unprofessional or embarrassing circumstances, which are a serious breach of ethics.

LOST AND FOUND – The Information Section will manage lost and found items for the incident. If you have lost an item please leave your contact information and what you have lost at the Information Section. If you have found an item on the incident, bring the item to the Information Section with your contact information as well.

MAIL SERVICE – The Information Section can assist you with sending and receiving mail. The address is Shasta District Fairgrounds 1890 Briggs St. Anderson CA. 96007

DEMOBILIZATION INSTRUCTIONS

CARR

CA-SHU-007808

DEMOB PROCEDURES

- CHECK THE DEMOB LIST EACH MORNING. YOU CAN FIND THE DEMOB LIST THROUGH THE “QR” CODE ON THE I.A.P. COVER OR ON LISTS POSTED THROUGHOUT CAMP. **ONLY REPORT TO DEMOB AT YOUR SCHEDULED TIME.** EARLY ADMITTANCE WILL NOT BE ALLOWED.
- REPORT TO DEMOB AT APPOINTMENT TIME TO RECEIVE A CHECKOUT FORM (ICS-221), THEN GO TO THE FOLLOWING UNITS TO OBTAIN THE NECESSARY SIGNATURES:
 - ✓ SUPPLY UNIT
 - ✓ COMMUNICATIONS UNIT
 - ✓ GROUND SUPPORT/VEHICLE INSPECTION***
 - ✓ DOCUMENTATION UNIT
 - ✓ TIME UNIT
 - ✓ TRAINING UNIT (IF APPLICABLE)
 - ✓ ACCOMMODATIONS (IF APPLICABLE)

***VEHICLE INSPECTION:

- THE DEMOB UNIT WILL INFORM YOU IF THE VEHICLE NEEDS TO BE INSPECTED.
- YOU MUST HAVE THE ICS-221 DEMOB FORM WITH YOU AT VEHICLE INSPECTION.
- A VEHICLE INSPECTION TIME WILL BE PROVIDED WHEN YOU INITIALLY ARRIVE TO THE DEMOBILIZATION UNIT.
- **DO NOT REPORT FOR VEHICLE INSPECTION PRIOR TO YOUR APPOINTMENT**

HAVE YOUR EQUIPMENT INVENTORY CARD READY WHEN HEADING TO VEHICLE INSPECTION.

RETURN THE COMPLETED ICS-221 FORM TO THE DEMOB UNIT AND TRAVEL HOME SAFE!





Training Specialist Message

The following is a list of trainees that need to check in with the Training Specialist in Fusaro Hall next to Check-In. Let us help you document your experience as a trainee.

C-122.2	Finister, Brandon	C-122.3	Jennings, Robert James
E-39.4	Grotting, Ben	E-164.7	Means, Ryan
E-425.9	England, Thomas	E-270.1	Cardosi, Steve
E-681.7	Murphy, Allison J	E-438.1	Deurloo, Nate
E-79.7	Woody, Jon	O-388	Peters, Christine
O-286	Noyes, Colin J	O-598	Stirton, Bill
O-557	Kelley, Sean Patrick	O-660	Welch, Anthony
O-580	Meyer, Paul	O-721	Montoya, Mark D
O-735	Reed, David M	O-777	Ruiz, Jennifer L
O-769	Johnson, Richard B	O-781	Lanzas, Isaiah A
O-840	Little, Brian	O-782	Olascuaga, Marc A
O-843	Yendrey, Bennett Joseph	O-798	Orton, Steve

TNSP Dave Randolph (805) 857-4820

TNSP (T) Charlie Piccaro (310) 529-5844

Peer Support Team Message:

CARR INCIDENT PEER SUPPORT: (916) 591-9004

The gravity of this event is large. Many of us have been impacted by the events that have occurred as well as past incidents.

A peer support team has been assembled and Peers are available at the ICP. The Peer Support contact number is (916)-591-9004, which is available 24/7.

Some of the signs and symptoms you may be experiencing include, but are not limited to:

Irritability, lack of sleep, quick to anger, withdrawal, above average tobacco use, an increase in negative coping mechanisms such as excessive alcohol and/or substance abuse. You might experience lack of appetite, isolate yourself, and various other unexplained responses to normal every day events.

You may not be experiencing these symptoms now or during this fire incident. However, you may find yourself experiencing them when you return to your home or unit. You may find yourself being triggered by a past event that has impacted you, while assigned to future incidents. A sight, sound, smell, or touch could trigger a memory that previously existed, but you may not have been aware of.

If you find yourself in this situation and need to talk to someone contact your Employee Assistance Program (EAP). EAP programs are here to help. It is important to be able to talk to someone and get stuff off your chest vs carrying this around for your career.

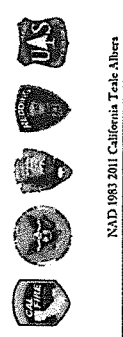
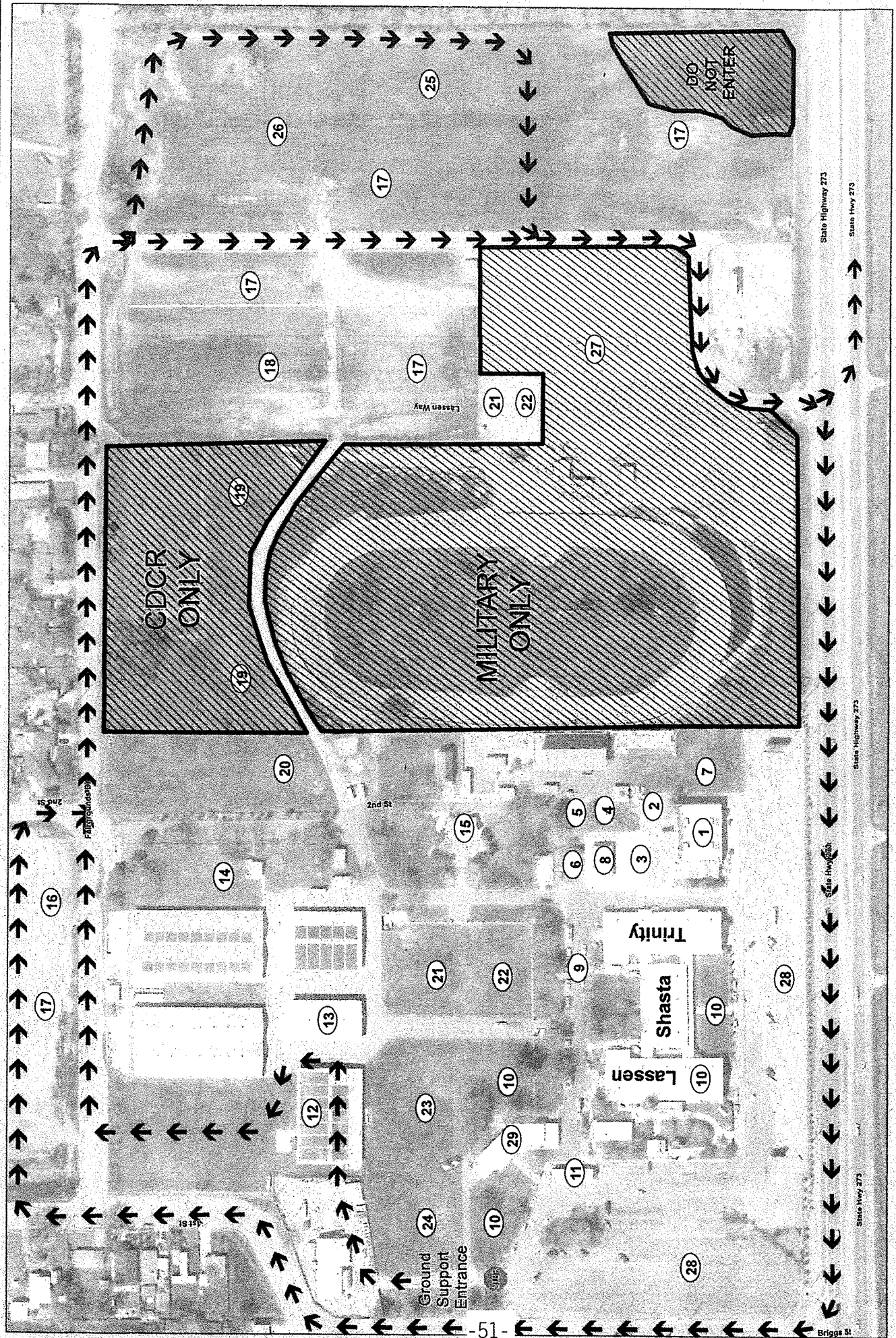

Facilities Map
CARR INCIDENT
CA-SHU-7808

1. Check-In/Finance 6. IC 11. PIO 16. Lunches/Water/Ice 21. Laundry 26. Transport Parking
 2. Logistics-Facilities 7. GIS 12. Ground Support 17. Engine Parking 22. Showers 27. CNG
 3. Communications 8. Accomadations 13. Supply 18. CDCR Parking 23. Mobile Sleepers 28. Overhead Parking
 4. Safety/OPS 9. OES 14. Kitchen 19. CDCR 24. CCC Sleeping 29. Rehab Lounge
 5. Liason 10. Crew Sleeping 15. Briefing 20. MERT 25. Fuel *Laundry/Showers Available to All.



LEGEND
 RR Rest Room
 ● Hydrant
 ○ Propane Tank

Datum: NAD83
 0 0.025 0.05 0.1
 0 100 200 400 Feet Miles

Map Data: ESRI World Imagery July 2016 P2523
 NAD 1983 California Teale Albers

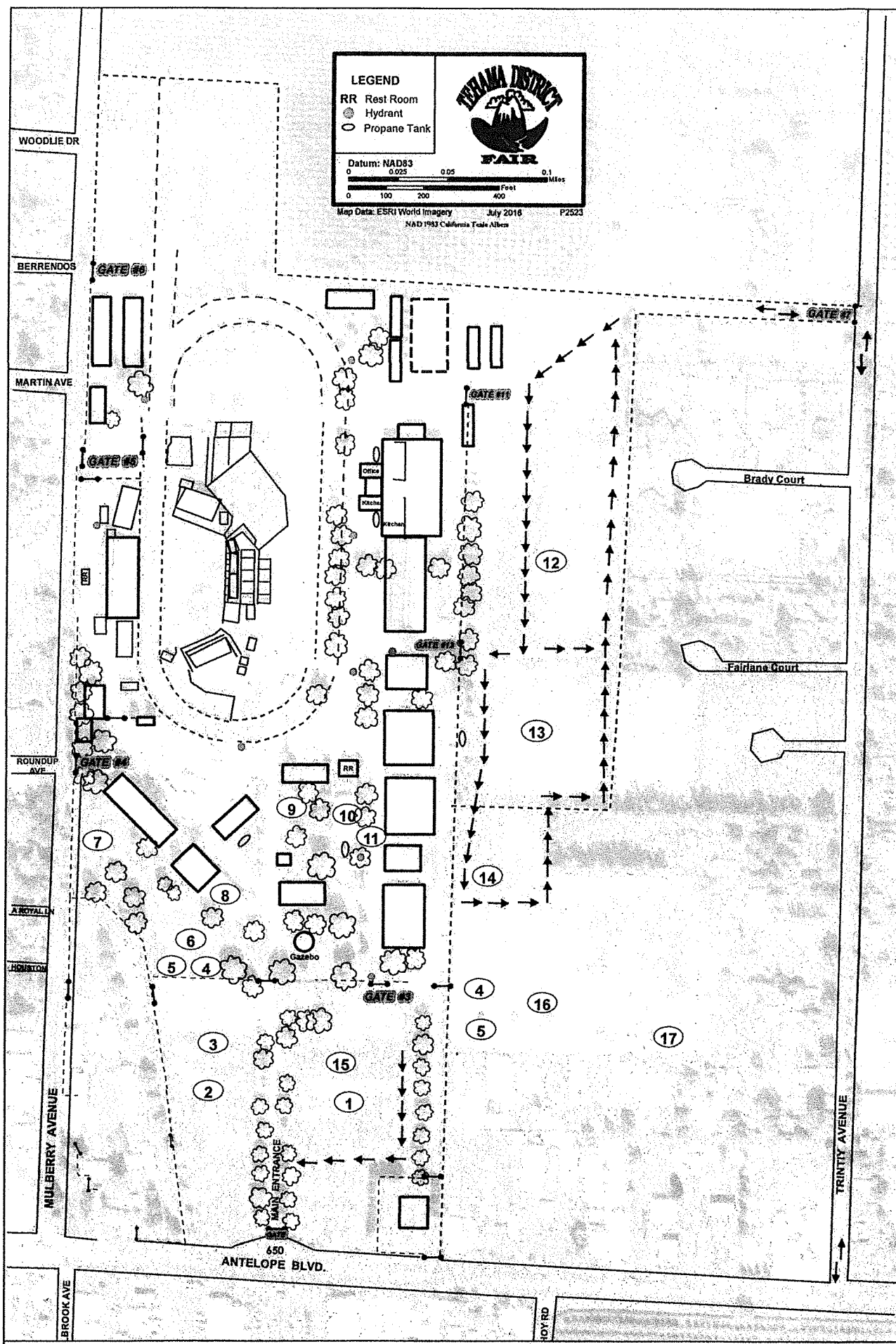
- 1. Engine Fuel
- 2. Engine Overhead Parking
- 3. Ice/Water/Lunches
- 4. Laundry
- 5. Showers
- 6. Tent W/AC Sleeping
- 7. Personnel Tents
- 8. LOGS
- 9. Food
- 10. Supply
- 11. Medical
- 12. National Guard Fuel
- 13. National Guard Parking
- 14. Kitchen
- 15. Engine Parking
- 16. Tents
- 17. Smaller Trailers
- *Laundry/Showers Available to All

Facilities Map
 CA-52- NCIDENT
 CA-SHU-7808



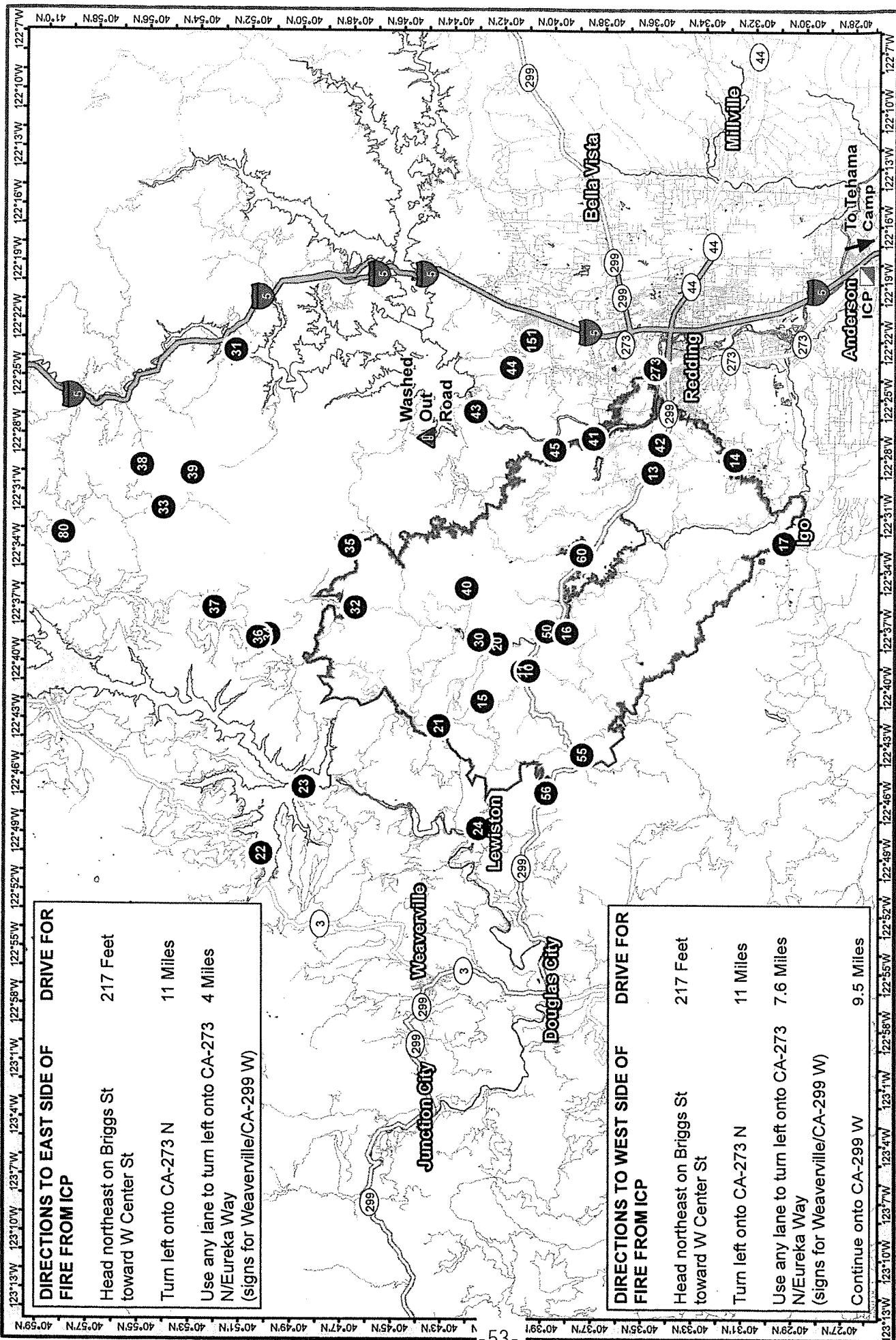

DIRECTIONS TO EAST SIDE OF FIRE FROM ICP

DRIVE FOR

Head northeast on Briggs St toward W Center St 217 Feet

Turn left onto CA-273 N 11 Miles

Use any lane to turn left onto CA-273 N/Eureka Way (signs for Weaverville/CA-299 W) 4 Miles

DIRECTIONS TO WEST SIDE OF FIRE FROM ICP

DRIVE FOR

Head northeast on Briggs St toward W Center St 217 Feet

Turn left onto CA-273 N 11 Miles

Use any lane to turn left onto CA-273 N/Eureka Way (signs for Weaverville/CA-299 W) 7.6 Miles

Continue onto CA-299 W 9.5 Miles

Transportation Map

Carr Fire

CA-SHU-007808

Wildfire Daily Fire Perimeter

Camp

Incident Command Post

Drop Point

NAD83 1:360,000

UAS

CA FIRE

0 5 10 Miles

0 5 10 Miles

CA-SHU-007808 TRANSPORTATION MAP

Aug 03, 2018

Document Path: X:\2018_Incidents\2018_CARR_CASHU007808\project\Transportation_Map_Letter-Land_Carr_CASHU007808.mxd 8/1/2018 @ 04:39

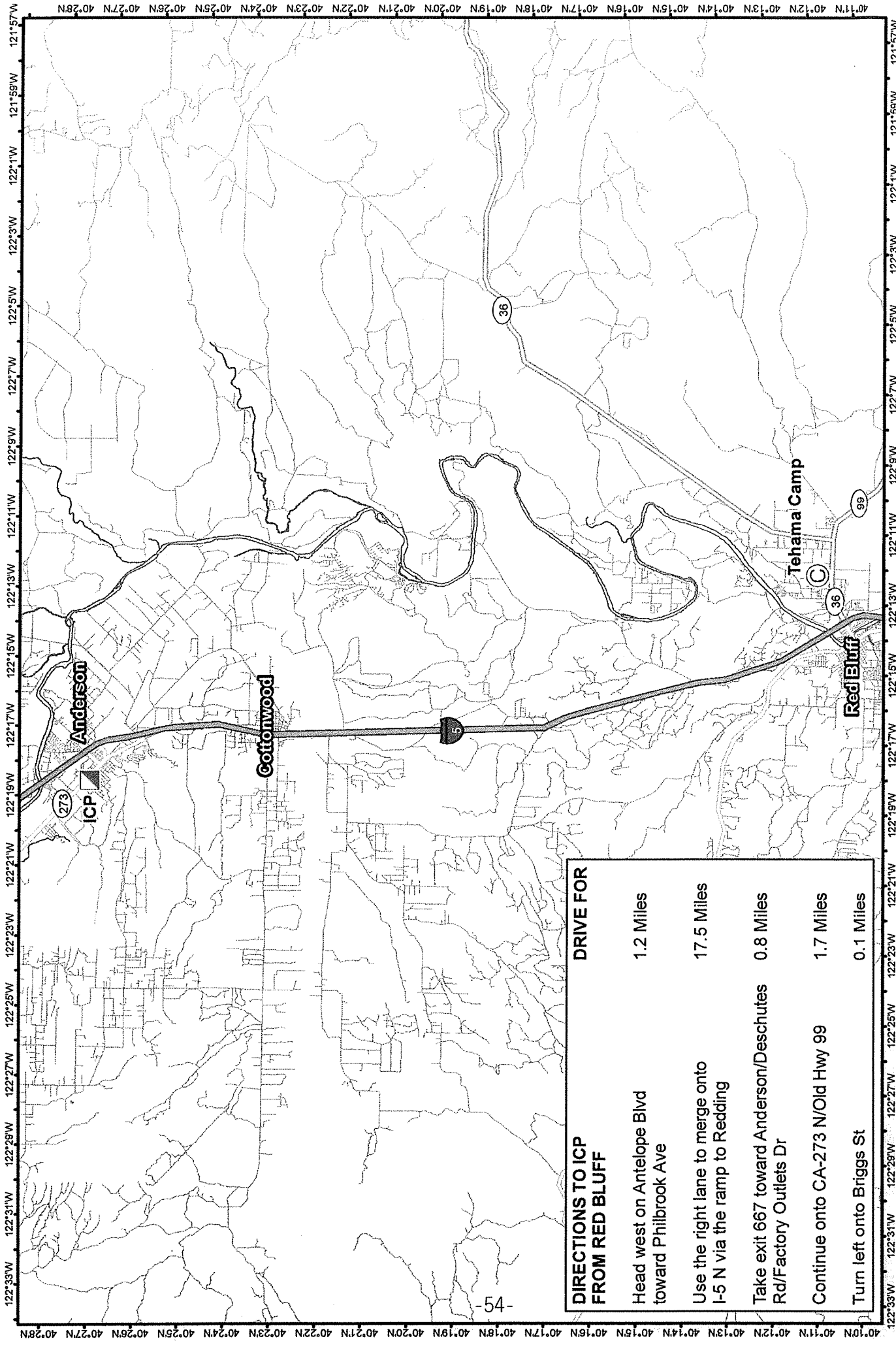

DIRECTIONS TO ICP FROM RED BLUFF	
Head west on Antelope Blvd toward Philbrook Ave	1.2 Miles
Use the right lane to merge onto I-5 N via the ramp to Redding	17.5 Miles
Take exit 667 toward Anderson/Deschutes Rd/Factory Outlets Dr	0.8 Miles
Continue onto CA-273 N/Old Hwy 99	1.7 Miles
Turn left onto Briggs St	0.1 Miles

Transportation Map
Tehama Camp to ICP
 650 Antelope Blvd. Red Bluff CA, 96080







DRIVE FOR

 Camp
 Incident Command Post
 Drop Point

 NAD83 1:200,000







Carri Fire
 CA-SHU-007808
 TRANSPORTATION
 MAP



CARR INCIDENT



SERVICES SCHEDULE

MKU: Breakfast:	0500-1000
Dinner:	1700-2200
Sack Lunch Distribution:	0500-2100
Laundry Service:	0500-2300
Supply:	0600-2200
Saw Shop:	0600-2200
Showers:	0600-2300
Fuel:	24hr Service



CARR INCIDENT

HYDRATION REFER LOCATIONS

- DP 30
- Lewiston Plug and Jug
- DP 55
- DP 17 – IGO ONO Elementary School
- Hydration refer trucks all carry Ice, Water, Gatorade

FUEL TRUCK LOCATIONS

- Interstate Oil – Incident Base
- Cross Petroleum – Incident Base
- SST Oil Truck #1 – Red Bluff
- Mean Gene Gas – Red Bluff
- Redding Oil – 4811 Trinity Dam Blvd. – Lewiston
- SST Oil Truck #2 – DP 30 (French Gulch)
- Ed Staubs and Son – DP 33 (Dog Creek)

