

# Carr INCIDENT

#CA-SHU-007808

## INCIDENT ACTION PLAN



### OPERATIONAL PERIOD

7/30/2018

to

7/31/2018



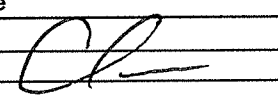

## ORGANIZATION ASSIGNMENT LIST (ICS 203)

<b>1. Incident Name:</b>		<b>2. Operational Period: Date From:</b> 7/30/2018		<b>Date To:</b> 7/31/2018	
Carr		Time From: 0700		Time To: 0700	
<b>3. Incident Commander(s) and Command Staff:</b>			<b>7. Operation Section:</b>		
IC/UC's	Gouvea/ Young/ Bertelli (T)/ Spinharney (T)		Chief	Derrick Davis	
Deputy	Mike Van Loben Sels		Deputy	Mike Wink (T)	
Safety Officer	B. Carter/ A. Stornetta (T)		Night Ops	Tony Brownell	
Information Officer	R. Brocchini/ C. Bulivac/ B. Mercado (T)		Staging Area	Anderson	Scott Bidwell (T)/ Jim Price (T)
	J. Larusso (T)/ J. Clingingsmith (T)		Branch	I	L. Turman/ J. Taylor (T)
Liaison Officer	Dave Schloss/ Brandon Smith (T)		Division/Group	V	Clint Swensen
	Todd Crawford/ Sean McCabe		Division/Group	X	Shawn Raley
<b>4. Agency/Organization Representatives:</b>			Division/Group	Y	Ross Miller
Agency/Organization	Name	Division/Group	County Line Cont	Jesse Brunk	
Sierra Pacific Industries	Nick Kroncki	Division/Group	Southwest Cont		
Shasta County SO	Anthony Bertain	Branch	II	Brian Noel	
County Roads Dept.	(530) 225-5661	Division/Group	C	Matt Wallen (9230C)	
Cal OES AREP	Patrick Titus	Division/Group	F	Jason Collins	
PG&E	Mike Weaver	Division/Group	H	Jacob Keown	
CDCR	Mark Ahlin	Division/Group			
NPS	Patrick Gubbins	Division/Group			
CCC	Kenneth McDonald	Branch	III	Josh Campbell	
CSP	Aaron Wright	Division/Group	M	Dennis Boic	
CHP	Scott Fredrick	Division/Group	O	Darren Bakken	
Red Cross	Richard Yoder	Division/Group	P	Darryl Laws	
WAPA	Brian Adams	Division/Group			
BLM	Jennifer Mata	Division/Group			
USFS	Alex McBeth	Branch	IV	Merrick Fields	
<b>5. Planning Section:</b>			Division/Group	S	Donald Davis
Chief	Mike Petro		Division/Group	T	Eric Mattson
Deputy	Chris Burch		Division/Group	U	Rik Valles
Resource Unit	Carlos / Corey/ Reneau/ Matye/ Weber/ Elward		Division/Group		
Situation Unit	E. Scovel / R. DeCamp/ D. Dresselhaus		Division/Group		
Documentation Unit	Jason Patterson		Branch	North Cont	Mario Gomez
Demobilization Unit	T. Shevenell/ S. Spear (T)		Division/Group	Shasta Group	Pat Bell/ Justin Reglin
GISS	T. Werle/ E. Tumbleson (T)/ K. Towers		Division/Group		
FBAN	Velin/ Bousier/ Pangburn (T)		Division/Group		
IMET	Alex Hoon		Branch	Utility/ Restoration	
Training Tech Spec	Dave Randolph/ Charlie Piccaro (T)		Division/Group		
Hired Equipment Tech	Doug Grandbois		<b>Air Operations Branch</b>		Director: Tim Stepanovich
<b>6. Logistics Section</b>			Air Support Grp Sup		Matt Hill
Chief	Craig White		Helibase Manager		Peter York/ Thomas Smith (T)
Deputy	Alex Long				
Supply Unit	Lon Story/ Matt Brabo (T)		<b>8. Finance/Administration Section:</b>		
Facilities Unit	Jacob Guerra/ Shawn Burris		Chief	Jack Franklin	
Ground Support Unit	Pete Mock		Deputy	Bob Counts	
Communications Unit	Tom Webb		Time Unit	Shannon Thompson	
Medical Unit	Jessie Winnen		Procurement Unit	Casey Craig	
Motel Tech Spec	Stephen Vaquero		Comp/Claims Unit	Matt Boone	
Ordering Manager	A. Gettman/ J. Tompkins/ M. Heyfron		Cost Unit	Suzi Cain	
<b>Prepared By: Name:</b>	Chris Burch	<b>Position/Title:</b>	PSC	<b>Signature:</b>	
<b>ICS 203</b>		<b>Date/Time:</b>	7/29/2018 2216 hrs		



**Fire Weather Forecast**

**FORECAST NO:** 5  
**PREDICTION FOR:** DAY/NIGHT SHIFT  
**SHIFT DATE:** July 30, 2018  
**TIME/DATE ISSUED:** July 29, 2018 2000 PDT

**NAME OF FIRE:** Carr  
**UNIT:** CA-SHU  
**SIGNED:** Alex Hoon  
**Incident Meteorologist**

**WEATHER DISCUSSION: ...HOT...DRY...AND UNSTABLE CONDITIONS...**

Hot, dry, and unstable conditions expected again for today. Heavy smoke inversion will continue over the fire area for the next several days, keeping temperatures cooler and providing shading for fuels. The atmosphere remains primed for unstable conditions (Haines 6) for plume dominated fire if there is any clear air—along with alignment with fuels and topography. If a plume develops, the fire can produce it's own weather, including strong localized winds and whirlwinds. Northwest winds will kick in this evening and continue into the early morning hours with north winds (drainage) by sunrise, coming out of the drainages. Similar weather for the next 7 days.

**WEATHER FORECAST FOR MONDAY: ...SMOKE INVERSION WITH LIMITED CLEARING...**

**WEATHER:** Sunny, smokey. Smoke heaviest in the AM for Branch 1&4. Heaviest for Branch 2&3 in the PM.

**MAX TEMPERATURES:** 95-102°F. **LITTLE CHANGE**

**MIN HUMIDITY:** 10-15%. **LITTLE CHANGE**

**EYE-LEVEL WIND:** Down-drainage 2-5 mph in the morning, becoming Updrainage 3-6 mph in the afternoon.

**20-FOOT WIND:**

**SLOPE/VALLEY** - North 4-8 mph in the morning with gusts up to 15 mph, then becoming Southeast 5-10 mph in the afternoon with gusts to 15 mph.

**RIDGETOP-** Northwest 10-15 mph gusts 25 mph in the morning, then Southeast 5-10 gusts 15 mph.

**HAINES INDEX:** 6

**MONDAY NIGHT: ...BREEZY EVENING NORTHWEST WINDS WITH POOR RECOVERY...**

**WEATHER:** Clear and smokey.

**MIN TEMPERATURES:** 70-78°F. **LITTLE CHANGE**

**MAX HUMIDITY:** 25-35% near 70% on valley floor. **LITTLE CHANGE**

**EYE-LEVEL WIND:** **Northwest** 4-8 mph with gusts to 12 mph in the evening, becoming North 2-5 mph after 0200.

**20-FOOT WIND:**

**SLOPE/VALLEY** - West to Northwest 10-15 mph with gusts to 20 mph in the evening, becoming North 10 mph with gusts to 18 mph after 0200.

**RIDGETOP** - Northwest 10 to 15 mph with gusts 25-30 mph.

**EXTENDED FORECAST: ...HOT AND DRY THROUGH THE WEEK...**

**TUESDAY:** Mostly cloudy Monday then Sunny Tuesday. Max T... 100-105°F. Min RH 14-17%. Southeast 5-10 mph.

**WEDNESDAY AND THURSDAY:** Sunny. Max temps...99-103°F. Min RH 12-16%. Southeast 5-10 mph.

# FIRE BEHAVIOR FORECAST

<b>FORECAST NUMBER: 5</b>	<b>TYPE OF FIRE: Wildland Fire</b>
<b>FIRE NAME: CARR</b>	<b>OPERATIONAL PERIOD: 24hr 7/30 (0700-0700)</b>
<b>DATE ISSUED: 07/29</b>	<b>TIME ISSUED: 2100</b>
<b>UNIT: SHU</b>	<b>SIGNED: D. Boursier FBAN/LTAN</b>

## INPUTS

### WEATHER SUMMARY

Shifting winds with very hot and dry with poor humidity recovery overnight.  
See Weather Forecast in IAP.

## OUTPUTS

**GENERAL:                   \*\*Conditions exist for Plume Dominated Fire Behavior\*\***

Fuels in the area range from grass in the lower elevations (cured), decadent brush in mid elevations (nearing critical), and stands of grey pine in the upper elevations and on the Northern aspects. All critically dry.

The topography in the fire area is steep and rugged. The drainages can be narrow and will funnel predominant winds. Ridgetops are also narrow, expect slop overs and spots on fire challenged ridgetops.

In the absence of weather conditions outside the forecast or extreme fire behavior conditions expect:

	Max. Flame Length	Max. Rate of Spread	Spotting	Probability of Ignition
Grass	< 8'	110 ch/hr	< ¼ mile	98%
Grass/Shrub Mix	< 8'	50 ch/hr	< ¼ mile	98%
Timber Understory	< 12'	20 ch/hr	< ½ mile	98%
Timber Litter	< 5'	12 ch/hr	< ¼ mile	98%

**\*\*minimum safety zone size for brush fuels is ½ acre for a Strike Team of Engines.**

### SPECIFIC:

#### Branch I

As the fire moves southward it will enter the "Arbuckle Wind" corridor. Anticipate more free air conditions from the west/northwest starting approximately 1700-1100. Fire is established in the Clear Creek Drainage and will may move with down canyon winds to the south, expect the largest growth to occur overnight as down canyon winds increase. Fuel types convert to lighter and flashier grasses to the south.

#### Branch II

The fire will follow terrain and move to the West towards Hoadley Peak and County Line Road. Solar heating with upslope/up canyon winds may test established lines to the west. Evening West winds will change conditions to downslope backburning and remove smoke shading.

#### Branch III

Growth to the North will see a fuel type conversion into timber and heavy slash models. The Sheep fire of 1999 will have heavier timber litter slowing rates of spread. Torching could occur contributing to increased spotting distances.

#### Branch IV

Smoldering with pockets of activity possible. Keep alert to structural hazards and ash pots.

### AIR OPERATIONS:

Best chances for clear air will be on the West side of the fire. Late in the afternoon may bring chances of clear air on the South side of the fire.

Mixing height: 3-5,000 ft., Transport winds: SSW 10mph, Sunrise 0604, Sunset 2039.

## SAFETY

Increase situational awareness when traveling mid-slope roads.  
Continually reevaluate escape route time based on changing fire behavior.

## ASSIGNMENT LIST (ICS 204)

<b>1. Incident Name:</b> Carr		<b>2. Operational Period:</b> Date From: 07/30/18      Date To: 07/31/18 Time From: 0700      Time To: 0700				<b>3.</b> Branch: I Div/Group: V Victor Page 1 of 2	
<b>4. Operations Personnel:</b> Operations Section Chief: <b>Derrick Davis</b> Night Ops: <b>Tony Brownell</b> Branch Director: <b>L. Turman/ J. Taylor (T)</b> Branch Safety: <b>Jeffrey Reyes,</b> Division/Group Supervisor: <b>Clint Swensen</b> <b>Robert Fisher</b>							
<b>5. Resources Assigned:</b>		<b>** Resources Below are 24 hour resources unless stated **</b>				Reporting Location, Special Equipment, Remarks, Notes, and Information Time      Location	
Resource Identifier	ALS	Leader	Personnel	Request #			
STA OES 1471A		Harris, Randy	21	E-638	0700-0700	Iron Mt Rd x Hwy 299	
STA XSB 1501A		Mccoy, James	22	E-637	0700-0700	Iron Mt Rd x Hwy 299	
STA XCC 2020A	ALS	Mcnamara, Daniel	22	E-611	0700-0700	Iron Mt Rd x Hwy 299	
STA TBD					-	Iron Mt Rd x Hwy 299	
STB TCR XTE 3250B		Barber, Raymond	16	E-36	0700-0700	Iron Mt Rd x Hwy 299	
STC SCU 9161C		Anderson, Anthony	17	E-213	0700-0700	Iron Mt Rd x Hwy 299	
STC BTU 9212C		Reid, Bill J	16	E-279	0700-0700	Iron Mt Rd x Hwy 299	
STC OES 4077C		Lohan, Paul	18	E-208	0700-0700	Iron Mt Rd x Hwy 299	
STF CARR # 8		Walker, Chris	18	E-9046	0700-0700	Iron Mt Rd x Hwy 299	
STF TBD					-	Iron Mt Rd x Hwy 299	
STF TBD					-	Iron Mt Rd x Hwy 299	
STF TBD					-	Iron Mt Rd x Hwy 299	
STG TBD					-	Iron Mt Rd x Hwy 299	
STG TBD					-	Iron Mt Rd x Hwy 299	
STG TBD					-	Iron Mt Rd x Hwy 299	
STG TBD					-	Iron Mt Rd x Hwy 299	
STG TBD					-	Iron Mt Rd x Hwy 299	
STG TBD					-	Iron Mt Rd x Hwy 299	
STG TBD					-	Iron Mt Rd x Hwy 299	
STG TBD					-	Iron Mt Rd x Hwy 299	
STG TBD					-	Iron Mt Rd x Hwy 299	
STG TBD					-	Iron Mt Rd x Hwy 299	
<b>6. Work Assignments:</b> Construct control lines as direct as possible. Improve and hold control lines. Mop up 300 feet or 100%.							
<b>7. Special Instructions:</b> ***ALL OUT OF STATE ENGINES ARE TO REPORT TO TEHAMA CAMP FOLLOWING SHIFT.*** REMS will be available from DP 55.							
<b>8. Communications</b> (radio and/or phone contact numbers needed for this assignment):							
Name	Ch	Function	Rx Freq	Rx Tone	Tx Freq	Tx Tone	Notes
SHA CMD T2	1	COMMAND	154.4300	136.5	159.0150	123.0 (T2)	BASS MTN
VFIRE 24	8	TACTICAL	154.2725	156.7 (T6)	154.2725	156.7 (T6)	
CALCORD	15	MEDICAL	156.0750	156.7 (T6)	156.0750	156.7 (T6)	MEDICAL
A/G	6	A/G	159.3150	192.8	159.3150	192.8	AIR TO GROUND IS CDF TAC 17
GUARD	16	EMERGENCY	168.6250		168.6250	110.9	EMERGENCY USE ONLY
<b>9. Prepared by: Name:</b> B.J. Corey		<b>Pos/Title:</b> RESL		<b>Date/Time:</b> 7/29/2018 2216 hrs		<b>Signature:</b>	
ICS 204							

## ASSIGNMENT LIST (ICS 204)

<b>1. Incident Name:</b> Carr		<b>2. Operational Period:</b> Date From: 07/30/18      Date To: 07/31/18 Time From: 0700      Time To: 0700			<b>3.</b>  Branch: <b>I</b>  Div/Group: <b>V</b>  <b>Victor</b> <b>Page 2 of 2</b>		
<b>4. Operations Personnel:</b> Operations Section Chief: <b>Derrick Davis</b> Night Ops: <b>Tony Brownell</b> Branch Director: <b>L. Turman/ J. Taylor (T)</b> Branch Safety: <b>Jeffrey Reyes,</b> Division/Group Supervisor: <b>Clint Swensen</b> <b>Robert Fisher</b>							
<b>5. Resources Assigned:</b>		<b>** Resources Below are 24 hour resources unless stated **</b>			Reporting Location, Special Equipment, Remarks, Notes, and Information Time      Location		
Resource Identifier	ALS	Leader	Personnel	Request #			
STL TBD					-	Iron Mt Rd x Hwy 299	
DOZ SHF 29		Brown, Dave	3	E-77	0700-1900	Iron Mt Rd x Hwy 299	
DOZ PVT E-96		Gilbert, Bruce	2	E-96	0700-0700	Iron Mt Rd x Hwy 299	
DOZ PVT E-343		Wolfe, Larry	2	E-343	0700-0700	Iron Mt Rd x Hwy 299	
DOZ PVT E-401		Jones, Robert	2	E-401	0700-0700	Iron Mt Rd x Hwy 299	
DOZ PVT E-402		Briskt, Dale	2	E-402	0700-0700	Iron Mt Rd x Hwy 299	
DOZ PVT E-403		Smith, Dade	2	E-403	0700-0700	Iron Mt Rd x Hwy 299	
DOZ PVT E-405		Levi Gill	2	E-405	0700-0700	Iron Mt Rd x Hwy 299	
DOZ PVT E-406		Shankles, Daryl	2	E-406	0700-0700	Iron Mt Rd x Hwy 299	
W/T PVT E-202		Gold, Rich	2	E-202	0700-0700	Iron Mt Rd x Hwy 299	
W/T PVT E-203		Kiser, Kyle	2	E-203	0700-0700	Iron Mt Rd x Hwy 299	
W/T PVT E-204		Hughes, Jack	2	E-204	0700-0700	Iron Mt Rd x Hwy 299	
W/T PVT E-205		Vanlandingham, Mike	2	E-205	0700-0700	Iron Mt Rd x Hwy 299	
HEQB TBD					-	Iron Mt Rd x Hwy 299	
HEQB TBD					-	Iron Mt Rd x Hwy 299	
<b>6. Work Assignments:</b> Construct control lines as direct as possible. Improve and hold control lines. Mop up 300 feet or 100%.							
<b>7. Special Instructions:</b> <b>***ALL OUT OF STATE ENGINES ARE TO REPORT TO TEHAMA CAMP FOLLOWING SHIFT.***</b> REMS will be available from DP 55.							
<b>8. Communications</b> (radio and/or phone contact numbers needed for this assignment):							
Name	Ch	Function	Rx Freq	Rx Tone	Tx Freq	Tx Tone	Notes
SHA CMD T2	1	COMMAND	154.4300	136.5	159.0150	123.0 (T2)	BASS MTN
VFIRE 24	8	TACTICAL	154.2725	156.7 (T6)	154.2725	156.7 (T6)	
CALCORD	15	MEDICAL	156.0750	156.7 (T6)	156.0750	156.7 (T6)	MEDICAL
A/G	6	A/G	159.3150	192.8	159.3150	192.8	AIR TO GROUND IS CDF TAC 17
GUARD	16	EMERGENCY	168.6250		168.6250	110.9	EMERGENCY USE ONLY
<b>9. Prepared by: Name:</b> B.J. Corey		Pos/Title: RESL		Signature:			
ICS 204		Date/Time: 7/29/2018 2216 hrs					



## ASSIGNMENT LIST (ICS 204)

<b>1. Incident Name:</b> <p style="text-align: center;"><b>Carr</b></p>	<b>2. Operational Period:</b> Date From: 07/30/18      Date To: 07/31/18 Time From: 0700      Time To: 0700	<b>3.</b>  Branch: <b>I</b>  Div/Group: <b>X</b>  <p style="text-align: center;"><b>X-ray</b></p>
<b>4. Operations Personnel:</b> Operations Section Chief: <b>Derrick Davis</b> Night Ops: <b>Tony Brownell</b> Branch Director: <b>L. Turman/ J. Taylor (T)</b> Branch Safety: <b>Jeffrey Reyes, Robert Fisher</b> Division/Group Supervisor: <b>Shawn Raley</b>		Page 1 of 2

5. Resources Assigned:		** Resources Below are 24 hour resources unless stated **				Reporting Location, Special Equipment, Remarks, Notes, and Information	
Resource Identifier	ALS	Leader	Personnel	Request #	Time	Location	
STA OES 3802A	ALS	Daley, Pete	21	E-269	0700-0700	Iron Mt Rd x Hwy 299	
STC HUU 9120C		Mclaughlin, Ron	15	E-13	0700-0700	Iron Mt Rd x Hwy 299	
STC LNU 9140C		Lovie, Jon	16	E-74	0700-0700	Iron Mt Rd x Hwy 299	
STC MRN 9150C		Pierce, Jeremy	18	E-210	0700-0700	Iron Mt Rd x Hwy 299	
STC BTU 9211C		Tapia, Joe	16	E-84	0700-0700	Iron Mt Rd x Hwy 299	
<b>STC TBD</b>					-	<b>Iron Mt Rd x Hwy 299</b>	
ENG T/F T3 1870		Cooke, Nathan	22	E-602	0700-0700	Iron Mt Rd x Hwy 299	
STG CZU 9175 G		Petersen, Justin	40	C-18	0700-0700	Iron Mt Rd x Hwy 299	
STG LMU 9223 G		Veverka, Robert	37	C-47	0700-0700	Iron Mt Rd x Hwy 299	
<b>STG TBD</b>					-	<b>Iron Mt Rd x Hwy 299</b>	
<b>CRW 1 TBD</b>					-	<b>Iron Mt Rd x Hwy 299</b>	
<b>CRW 1 TBD</b>					-	<b>Iron Mt Rd x Hwy 299</b>	
DOZ SHU 2440		Flournoy, Aaron	2	E-310	0700-0700	Iron Mt Rd x Hwy 299	
DOZ SHU 2444		Flournoy, Aaron	2	E-23	0700-0700	Iron Mt Rd x Hwy 299	
DOZ SRF 4		Cedar, Hayes	4	E-34	0700-1900	Iron Mt Rd x Hwy 299	
DOZ ENF 3		Stark, Daniel	4	E-38	0700-1900	Iron Mt Rd x Hwy 299	
DOZ KNF 1		Murieen, Jason	4	E-39	0700-1900	Iron Mt Rd x Hwy 299	
W/T RDN 7		Smith, Tim	2	E-12	0700-0700	Iron Mt Rd x Hwy 299	

**6. Work Assignments:**  
 Construct control lines as direct as possible.  
 Improve and hold control lines.  
 Mop up 300 feet or 100%.

**7. Special Instructions:**  
**\*\*\*ALL OUT OF STATE ENGINES ARE TO REPORT TO TEHAMA CAMP FOLLOWING SHIFT.\*\*\***  
 REMS will be available from DP 55.

**8. Communications** (radio and/or phone contact numbers needed for this assignment):

Name	Ch	Function	Rx Freq	Rx Tone	Tx Freq	Tx Tone	Notes
SHA CMD T2	1	COMMAND	154.4300	136.5	159.0150	123.0 (T2)	BASS MTN
VFIRE 23	7	TACTICAL	154.2950	156.7 (T6)	154.2950	156.7 (T6)	
CALCORD	15	MEDICAL	156.0750	156.7 (T6)	156.0750	156.7 (T6)	MEDICAL
A/G	6	A/G	159.3150	192.8	159.3150	192.8	AIR TO GROUND IS CDF TAC 17
GUARD	16	EMERGENCY	168.6250		168.6250	110.9	EMERGENCY USE ONLY

**9. Prepared by: Name:** B.J. Corey      **Pos/Title:** RESL      **Signature:**

**ICS 204**      **Date/Time:** 7/29/2018 2216 hrs

## ASSIGNMENT LIST (ICS 204)

<b>1. Incident Name:</b> <p style="text-align: center;">Carr</p>	<b>2. Operational Period:</b> Date From: 07/30/18      Date To: 07/31/18 Time From: 0700              Time To: 0700	<b>3.</b>  Branch: I Div/Group: X X-ray <b>Page 2 of 2</b>
<b>4. Operations Personnel:</b> Operations Section Chief: <b>Derrick Davis</b> Night Ops: <b>Tony Brownell</b> Branch Director: <b>L. Turman/ J. Taylor (T)</b> Branch Safety: <b>Jeffrey Reyes, Robert Fisher</b> Division/Group Supervisor: <b>Shawn Raley</b>		

5. Resources Assigned:		** Resources Below are 24 hour resources unless stated **			Reporting Location, Special Equipment, Remarks, Notes, and Information	
Resource Identifier	ALS	Leader	Personnel	Request #	Time	Location
W/T SHS 55		Wyckoff, Fred	3	E-25	0700-0700	Iron Mt Rd x Hwy 299
W/T PVT E-125		Richison, Walton	2	E-125	0700-0700	Iron Mt Rd x Hwy 299
W/T PVT E-136		Torres, Bill	2	E-136	0700-0700	Iron Mt Rd x Hwy 299
W/T PVT E-391		Hasanbasic, Dino	2	E-391	0700-0700	Iron Mt Rd x Hwy 299
W/T PVT E-759		Cleer, Dana	2	E-759	0700-0700	Iron Mt Rd x Hwy 299
HEQB DRUMMOND O-284		Drummond, James	1	O-284	0700-0700	Iron Mt Rd x Hwy 299
HEQB TBD					-	Iron Mt Rd x Hwy 299

**6. Work Assignments:**  
 Construct control lines as direct as possible.  
 Improve and hold control lines.  
 Mop up 300 feet or 100%.

**7. Special Instructions:**  
**\*\*\*ALL OUT OF STATE ENGINES ARE TO REPORT TO TEHAMA CAMP FOLLOWING SHIFT.\*\*\***  
 REMS will be available from DP 55.

**8. Communications** (radio and/or phone contact numbers needed for this assignment):

Name	Ch	Function	Rx Freq	Rx Tone	Tx Freq	Tx Tone	Notes
SHA CMD T2	1	COMMAND	154.4300	136.5	159.0150	123.0 (T2)	BASS MTN
VFIRE 23	7	TACTICAL	154.2950	156.7 (T6)	154.2950	156.7 (T6)	
CALCORD	15	MEDICAL	156.0750	156.7 (T6)	156.0750	156.7 (T6)	MEDICAL
A/G	6	A/G	159.3150	192.8	159.3150	192.8	AIR TO GROUND IS CDF TAC 17
GUARD	16	EMERGENCY	168.6250		168.6250	110.9	EMERGENCY USE ONLY

**9. Prepared by: Name:** B.J. Corey      Pos/Title: RESL      Signature:   
**ICS 204**      Date/Time: 7/29/2018 2216 hrs

## ASSIGNMENT LIST (ICS 204)

<b>1. Incident Name:</b> Carr		<b>2. Operational Period:</b> Date From: 07/30/18    Date To: 07/31/18 Time From: 0700    Time To: 0700				<b>3.</b>  Branch: I Div/Group: Y  Yankee Page 1 of 2		
<b>4. Operations Personnel:</b> Operations Section Chief: <b>Derrick Davis</b> Night Ops: <b>Tony Brownell</b> Branch Director: <b>L. Turman/ J. Taylor (T)</b> Branch Safety: <b>Jeffrey Reyes, Robert Fisher</b> Division/Group Supervisor: <b>Ross Miller</b>								
<b>5. Resources Assigned:</b>		<b>** Resources Below are 24 hour resources unless stated **</b>				Reporting Location, Special Equipment, Remarks, Notes, and Information Time                      Location		
Resource Identifier	ALS	Leader	Personnel	Request #				
STC NEU 9231C		Griffis, Sean	16	E-211	0700-0700	Iron Mt Rd x Hwy 299		
STC XYU 3300C		Webb, Rich	17	E-423	0700-0700	Iron Mt Rd x Hwy 299		
STC LNF 3615C		Nickey, John	27	E-78	0700-0700	Iron Mt Rd x Hwy 299		
STC XTB 4229C		Reid, Jim	17	E-421	0700-0700	Iron Mt Rd x Hwy 299		
STC XTB 4230C	ALS	Zlendick, Brad	17	E-209	0700-0700	Iron Mt Rd x Hwy 299		
STC TBD					-	Iron Mt Rd x Hwy 299		
CRW 1 TBD					-	Iron Mt Rd x Hwy 299		
CRW 1 TBD					-	Iron Mt Rd x Hwy 299		
STG TGU 9258G		Pederson, Travis	35	C-19	0700-0700	Iron Mt Rd x Hwy 299		
STG TGU 9255G		Smith, Phillip	33	C-45	0700-0700	Iron Mt Rd x Hwy 299		
STG TGU 9254G		Sheffield, Brennen	33	C-36	0700-0700	Iron Mt Rd x Hwy 299		
STG TBD					-	Iron Mt Rd x Hwy 299		
STG TBD					-	Iron Mt Rd x Hwy 299		
STG TBD					-	Iron Mt Rd x Hwy 299		
CRW BLM WHISKEYTOWN WFM		Winkler, Rob	7	O-180	0700-1900	Iron Mt Rd x Hwy 299		
DOZ TGU 2540		Oliver, Kevin	3	E-47	0700-0700	Iron Mt Rd x Hwy 299		
DOZ PVT E-407		Ingram, Brad	3	E-407	0700-0700	Iron Mt Rd x Hwy 299		
DOZ PVT E-408		Thurman, Brian	2	E-408	0700-0700	Iron Mt Rd x Hwy 299		
<b>6. Work Assignments:</b> Construct control lines as direct as possible. Improve and hold control lines. Mop up 300 feet or 100%. Construct safety zones.								
<b>7. Special Instructions:</b> ***ALL OUT OF STATE ENGINES ARE TO REPORT TO TEHAMA CAMP FOLLOWING SHIFT.*** REMS will be available from DP 55.								
<b>8. Communications</b> (radio and/or phone contact numbers needed for this assignment):								
Name	Ch	Function	Rx Freq	Rx Tone	Tx Freq	Tx Tone	Notes	
SHA CMD T2	1	COMMAND	154.4300	136.5	159.0150	123.0 (T2)	BASS MTN	
VFIRE 25	9	TACTICAL	154.2875	156.7 (T6)	154.2875	156.7 (T6)		
CALCORD	15	MEDICAL	156.0750	156.7 (T6)	156.0750	156.7 (T6)	MEDICAL	
A/G	6	A/G	159.3150	192.8	159.3150	192.8	AIR TO GROUND IS CDF TAC 17	
GUARD	16	EMERGENCY	168.6250		168.6250	110.9	EMERGENCY USE ONLY	
<b>9. Prepared by: Name:</b> B.J. Corey		Pos/Title: RESL		Date/Time: 7/29/2018 2216 hrs		Signature:		
ICS 204								

## ASSIGNMENT LIST (ICS 204)

<b>1. Incident Name:</b> <p style="text-align: center;">Carr</p>	<b>2. Operational Period:</b> Date From: 07/30/18      Date To: 07/31/18 Time From: 0700      Time To: 0700	<b>3.</b>  Branch: <span style="float: right;">I</span>  Div/Group: <span style="float: right;">Y</span>  <p style="text-align: center;"><b>Yankee</b></p> <p style="text-align: right;"><b>Page 2 of 2</b></p>
<b>4. Operations Personnel:</b> Operations Section Chief: <b>Derrick Davis</b> <b>Night Ops: Tony Brownell</b> Branch Director: <b>L. Turman/ J. Taylor (T)</b> Branch Safety: Jeffrey Reyes, Robert Fisher Division/Group Supervisor: <b>Ross Miller</b>		

5. Resources Assigned:	** Resources Below are 24 hour resources unless stated **				Reporting Location, Special Equipment, Remarks, Notes, and Information	
Resource Identifier	ALS	Leader	Personnel	Request #	Time	Location
DOZ PVT E-409		Morrison, Matthew	2	E-409	0700-0700	Iron Mt Rd x Hwy 299
DOZ PVT E-419		Waterman, Tim	3	E-419	0700-0700	Iron Mt Rd x Hwy 299
DOZ PVT E-739		Jensen, Devin	2	E-739	0700-0700	Iron Mt Rd x Hwy 299
DOZ PVT E-740		Boauer, Paul	2	E-740	0700-0700	Iron Mt Rd x Hwy 299
DOZ PVT E-745		Baugh, Gary	2	E-745	0700-0700	Iron Mt Rd x Hwy 299
DOZ PVT E-746		Harris, Gary	2	E-746	0700-0700	Iron Mt Rd x Hwy 299
DOZ PVT E-748		Burnam, Mason	2	E-748	0700-0700	Iron Mt Rd x Hwy 299
W/T PVT E-206		Holden, Jesse	2	E-206	0700-0700	Iron Mt Rd x Hwy 299
W/T PVT E-886		Newberry, Scott	2	E-886	0700-0700	Iron Mt Rd x Hwy 299
W/T PVT E-887		Tallon, Lowell	2	E-887	0700-0700	Iron Mt Rd x Hwy 299
<b>BOAT 8845 E-617</b>		<b>Grinnell, Sean</b>	<b>2</b>	<b>E-617</b>	<b>0700-1900</b>	<b>Iron Mt Rd x Hwy 299</b>
<b>FALM HODGECON O-94</b>		<b>Hodgecon, Russell</b>	<b>2</b>	<b>O-94</b>	<b>0700-1900</b>	<b>Iron Mt Rd x Hwy 299</b>
<b>HEQB TBD</b>					-	<b>Iron Mt Rd x Hwy 299</b>
FEMP DALEY O-203	ALS	Daley, John	1	O-203	0700-0700	Iron Mt Rd x Hwy 299
FEMT RUSTICE O-211		Rustice, James	1	O-211	0700-0700	Iron Mt Rd x Hwy 299

**6. Work Assignments:**  
 Construct control lines as direct as possible.  
 Improve and hold control lines.  
 Mop up 300 feet or 100%.  
 Construct safety zones.

**7. Special Instructions:**  
**\*\*\*ALL OUT OF STATE ENGINES ARE TO REPORT TO TEHAMA CAMP FOLLOWING SHIFT.\*\*\***  
 REMS will be available from DP 55.

**8. Communications** (radio and/or phone contact numbers needed for this assignment):

Name	Ch	Function	Rx Freq	Rx Tone	Tx Freq	Tx Tone	Notes
SHA CMD T2	1	COMMAND	154.4300	136.5	159.0150	123.0 (T2)	BASS MTN
VFIRE 25	9	TACTICAL	154.2875	156.7 (T6)	154.2875	156.7 (T6)	
CALCORD	15	MEDICAL	156.0750	156.7 (T6)	156.0750	156.7 (T6)	MEDICAL
A/G	6	A/G	159.3150	192.8	159.3150	192.8	AIR TO GROUND IS CDF TAC 17
GUARD	16	EMERGENCY	168.6250		168.6250	110.9	EMERGENCY USE ONLY

<b>9. Prepared by: Name:</b>	B.J. Corey	Pos/Title:	RESL	Signature:
<b>ICS 204</b>		Date/Time:	7/29/2018 2216 hrs	





## ASSIGNMENT LIST (ICS 204)

<b>1. Incident Name:</b> Carr		<b>2. Operational Period:</b> Date From: 07/30/18      Date To: 07/31/18 Time From: 0700              Time To: 0700			<b>3.</b> Branch: <b>II</b> Div/Group: <b>C</b> <b>Charlie</b> <b>Page 1 of 2</b>		
<b>4. Operations Personnel:</b> Operations Section Chief: <b>Derrick Davis</b> Night Ops: <b>Tony Brownell</b> Branch Director: <b>Brian Noel</b> Branch Safety: <b>Mark Todd,</b> Division/Group Supervisor: <b>Matt Wallen (9230C)</b> <b>Mike Weidner (T)</b>							
<b>5. Resources Assigned:</b>		<b>** Resources Below are 24 hour resources unless stated **</b>			Reporting Location, Special Equipment, Remarks, Notes, and Information Time                      Location		
Resource Identifier	ALS	Leader	Personnel	Request #			
STC NEU 9230C		Wallen, Matt	19	E-79	0700-0700	DP 55	
STC SHU 9241C		Faulkner, Joshua	20	E-787	0700-0700	DP 55	
STC XSO 2350C	ALS	Schindler, Dan	21	E-422	0700-0700	DP 55	
ENG T3 SHU 2466		Abercrombie, Todd	3	E-250	0700-0700	DP 55	
ENG T3 SHU 2465		Houston, Matthew	4	E-785	0700-0700	DP 55	
ENG T3 SHU 2477		Anderson, Danny	3	E-251	0700-0700	DP 55	
ENG T3 XLS 824		Stout, Tim	3	E-283	0700-0700	DP 55	
STF CARR #9		Flores, Jason	17	E-9048	0700-0700	DP 55	
T/F XMN 6180		Smith, Colin	11	E-604	0700-0700	DP 55	
CRW SHF TRINITY IHC		Reposa III, Richard	19	C-4	0700-1900	DP 55	
CRW TMU TALLAC IHC		Betty, Kyle	19	C-12	0700-1900	DP 55	
CRW ENF EL DORADO IHC		Humphrey, Aaron	20	C-35	0700-1900	DP 55	
STG TBD					-	DP 55	
STG TBD					-	DP 55	
STG TBD					-	DP 55	
DOZ PVT E-744		Boggs, Steve	2	E-744	0700-0700	DP 55	
DOZ PVT E-749		Parmeter, Doug	2	E-749	0700-0700	DP 55	
DOZ PVT E-750		Parmeter, Wes	2	E-750	0700-0700	DP 55	
<b>6. Work Assignments:</b> Construct control lines as direct as possible. Mop up slopovers. Prep County Line Rd. for firing.							
<b>7. Special Instructions:</b> ***ALL OUT OF STATE ENGINES ARE TO REPORT TO TEHAMA CAMP FOLLOWING SHIFT.*** REMS will be available from DP 55.							
<b>8. Communications</b> (radio and/or phone contact numbers needed for this assignment):							
Name	Ch	Function	Rx Freq	Rx Tone	Tx Freq	Tx Tone	Notes
SHA CMD T2	1	COMMAND	154.4300	136.5	159.0150	123.0 (T2)	BASS MTN
NIFC T5	11	TACTICAL	166.7250	131.8 (T3)	166.7250	131.8 (T3)	
CALCORD	15	MEDICAL	156.0750	156.7 (T6)	156.0750	156.7 (T6)	MEDICAL
A/G	6	A/G	159.3150	192.8	159.3150	192.8	AIR TO GROUND IS CDF TAC 17
GUARD	16	EMERGENCY	168.6250		168.6250	110.9	EMERGENCY USE ONLY
<b>9. Prepared by: Name:</b> B.J. Corey		<b>Pos/Title:</b> RESL		<b>Date/Time:</b> 7/29/2018 2216 hrs		<b>Signature:</b>	
<b>ICS 204</b>							

## ASSIGNMENT LIST (ICS 204)

<b>1. Incident Name:</b> Carr		<b>2. Operational Period:</b> Date From: 07/30/18    Date To: 07/31/18 Time From: 0700    Time To: 0700				<b>3.</b>  Branch: <b>II</b>  Div/Group: <b>C</b>  <b>Charlie</b> <b>Page 2 of 2</b>	
<b>4. Operations Personnel:</b> Operations Section Chief: <b>Derrick Davis</b> Night Ops: <b>Tony Brownell</b> Branch Director: <b>Brian Noel</b> Branch Safety: <b>Mark Todd,</b> Division/Group Supervisor: <b>Matt Wallen (9230C)</b> <b>Mike Weidner (T)</b>							
<b>5. Resources Assigned:</b>		<b>** Resources Below are 24 hour resources unless stated **</b>				Reporting Location, Special Equipment, Remarks, Notes, and Information Time                      Location	
Resource Identifier	ALS	Leader	Personnel	Request #			
DOZ PVT E-839		Emerson, Mel	2	E-839	0700-0700	DP 55	
DOZ PVT E-840		O'connell, Brandon	2	E-840	0700-0700	DP 55	
DOZ PVT E-841		Jensen, Dave	2	E-841	0700-0700	DP 55	
DOZ PVT E-842		Landingham, Darrell	2	E-842	0700-0700	DP 55	
DOZ PVT E-843		Olivolo, Chris	2	E-843	0700-0700	DP 55	
<b>DOZ TBD</b>					-	<b>DP 55</b>	
W/T PVT E-126		Hudson, Ken	2	E-126	0700-0700	DP 55	
W/T PVT E-397		Lopez, Frankie	2	E-397	0700-0700	DP 55	
W/T PVT E-398		Craig, Davis	2	E-398	0700-0700	DP 55	
W/T PVT E-890		Kotterman, Dustin	2	E-890	0700-0700	DP 55	
<b>FALM COTTONWOOD O-96</b>					<b>0700-1900</b>	<b>DP 55</b>	
<b>FALM SCOTTS TIMBER O-669</b>					<b>0700-1900</b>	<b>DP 55</b>	
<b>FALM TREE WORX O-670</b>					<b>0700-1900</b>	<b>DP 55</b>	
<b>FALM CLABORN O-672</b>					<b>0700-1900</b>	<b>DP 55</b>	
HEQB MELLOR O-548		Mellor, James S	1	O-548	0700-0700	DP 55	
HEQB MATHER O-560		Mather, Ian Thomas	1	O-560	0700-0700	DP 55	
FEMP ROBERTS O-207	ALS	Roberts, Brent	1	O-207	0700-0700	DP 55	
FEMT WALKER O-216		Walker, James	1	O-216	0700-0700	DP 55	
<b>6. Work Assignments:</b> Construct control lines as direct as possible. Mop up slopovers. Prep County Line Rd. for firing.							
<b>7. Special Instructions:</b> <b>***ALL OUT OF STATE ENGINES ARE TO REPORT TO TEHAMA CAMP FOLLOWING SHIFT.***</b> REMS will be available from DP 55.							
<b>8. Communications</b> (radio and/or phone contact numbers needed for this assignment):							
Name	Ch	Function	Rx Freq	Rx Tone	Tx Freq	Tx Tone	Notes
SHA CMD T2	1	COMMAND	154.4300	136.5	159.0150	123.0 (T2)	BASS MTN
NIFC T5	11	TACTICAL	166.7250	131.8 (T3)	166.7250	131.8 (T3)	
CALCORD	15	MEDICAL	156.0750	156.7 (T6)	156.0750	156.7 (T6)	MEDICAL
A/G	6	A/G	159.3150	192.8	159.3150	192.8	AIR TO GROUND IS CDF TAC 17
GUARD	16	EMERGENCY	168.6250		168.6250	110.9	EMERGENCY USE ONLY
<b>9. Prepared by: Name:</b> B.J. Corey                      Pos/Title:    RESL                      Signature:							
<b>ICS 204</b>		Date/Time: 7/29/2018		2216 hrs			



## ASSIGNMENT LIST (ICS 204)

<b>1. Incident Name:</b> Carr		<b>2. Operational Period:</b> Date From: 07/30/18    Date To: 07/31/18 Time From: 0700    Time To: 0700				<b>3.</b>  Branch: <b>II</b>  Div/Group: <b>F</b>  <b>Foxtrot</b> <b>Page 1 of 2</b>	
<b>4. Operations Personnel:</b> Operations Section Chief: <b>Derrick Davis</b> <b>Night Ops: Tony Brownell</b> Branch Director: <b>Brian Noel</b> Branch Safety: Mark Todd, Division/Group Supervisor: <b>Jason Collins</b> Mike Weidner (T)							
<b>5. Resources Assigned:</b>		<b>** Resources Below are 24 hour resources unless stated **</b>				Reporting Location, Special Equipment, Remarks, Notes, and Information Time                      Location	
Resource Identifier	ALS	Leader	Personnel	Request #			
STC SHU 9244C		Gyves, Dusty	21	E-437	0700-0700	DP 55	
STC CZU 9171 C		Dellamonica, Jake	18	E-305	0700-0700	DP 55	
<b>STC CARR #10</b>		<b>Peake, Perry Anthony</b>	<b>19</b>	<b>E-9050</b>	<b>0700-1900</b>	<b>DP 55</b>	
STC AEU 9270C		Mackwood, Brian	17	E-256	0700-0700	DP 55	
<b>STF TBD</b>					-	<b>DP 55</b>	
T/F CARR #4		Nelson, Darin	38	E-9044	0700-0700	DP 55	
STG NEU 9234G		Nelson, Todd	33	C-21	0700-0700	DP 55	
<b>STG TBD</b>					-	<b>DP 55</b>	
<b>CRW 1 TBD</b>					-	<b>DP 55</b>	
DOZ PVT E-742		Sherer, Jim	2	E-742	0700-0700	DP 55	
DOZ PVT E-743		Ulsh, Dale	2	E-743	0700-0700	DP 55	
DOZ PVT E-747		Corckrell, Weston	2	E-747	0700-0700	DP 55	
DOZ PVT E-754		Klaseen, Sven	2	E-754	0700-0700	DP 55	
DOZ PVT E-845		Berlogar, Cam	2	E-845	0700-0700	DP 55	
<b>DOZ TBD</b>					-	<b>DP 55</b>	
<b>DOZ TBD</b>					-	<b>DP 55</b>	
<b>DOZ TBD</b>					-	<b>DP 55</b>	
<b>DOZ TBD</b>					-	<b>DP 55</b>	
<b>6. Work Assignments:</b> Construct control lines as direct as possible. Mop up slopovers. Prep County Line Rd. for firing.							
<b>7. Special Instructions:</b> <b>***ALL OUT OF STATE ENGINES ARE TO REPORT TO TEHAMA CAMP FOLLOWING SHIFT.***</b> CRITICAL INFRASTRUCE: AT&T Microwave facility at 601 Lewiston Turnpike Rd. REMS will be available from DP 55.							
<b>8. Communications</b> (radio and/or phone contact numbers needed for this assignment):							
Name	Ch	Function	Rx Freq	Rx Tone	Tx Freq	Tx Tone	Notes
SHA CMD T2	1	COMMAND	154.4300	136.5	159.0150	123.0 (T2)	BASS MTN
CDF T32	14	TACTICAL	151.2425	192.8 (T16)	151.2425	192.8 (T16)	
CALCORD	15	MEDICAL	156.0750	156.7 (T6)	156.0750	156.7 (T6)	MEDICAL
A/G	6	A/G	159.3150	192.8	159.3150	192.8	AIR TO GROUND IS CDF TAC 17
GUARD	16	EMERGENCY	168.6250		168.6250	110.9	EMERGENCY USE ONLY
<b>9. Prepared by: Name:</b>		B.J. Corey	<b>Pos/Title:</b> RESL		Signature:		
<b>ICS 204</b>			Date/Time: 7/29/2018    2216 hrs				

## ASSIGNMENT LIST (ICS 204)

<b>1. Incident Name:</b> Carr		<b>2. Operational Period:</b> Date From: 07/30/18    Date To: 07/31/18 Time From: 0700    Time To: 0700				<b>3.</b>  Branch: <b>II</b>  Div/Group: <b>F</b>  <b>Foxtrot</b> <b>Page 2 of 2</b>	
<b>4. Operations Personnel:</b> Operations Section Chief: <b>Derrick Davis</b> Night Ops: <b>Tony Brownell</b> Branch Director: <b>Brian Noel</b> Branch Safety: <b>Mark Todd,</b> Division/Group Supervisor: <b>Jason Collins</b> <b>Mike Weidner (T)</b>							
<b>5. Resources Assigned:</b>		<b>** Resources Below are 24 hour resources unless stated **</b>				Reporting Location, Special Equipment, Remarks, Notes, and Information Time                      Location	
Resource Identifier	ALS	Leader	Personnel	Request #			
W/T SHF 16		Elliot, Groo	2	E-11	0700-1900	DP 55	
W/T SHS 33		Ron Smith	2	E-44	0700-0700	DP 55	
W/T PVT E-135		Oilar, Danny	2	E-135	0700-0700	DP 55	
W/T PVT E-395		Smith, Rockie	2	E-395	0700-0700	DP 55	
W/T PVT E-399		Hubbard, Warren	2	E-399	0700-0700	DP 55	
W/T PVT E-641		Hubbard, Tom	2	E-641	0700-0700	DP 55	
W/T PVT E-892		Bales, Cody	3	E-892	0700-0700	DP 55	
W/T PVT E-893		Vargas, Richie	2	E-893	0700-0700	DP 55	
HEQB TBD					-	DP 55	
HEQB TBD					-	DP 55	
HEQB TBD					-	DP 55	
HEQB TBD					-	DP 55	
FEMP SMART O-208	ALS	Smart, Ryan	1	O-208	0700-0700	DP 55	
FEMT BRYANT O-215		Bryant, Kendall	1	O-215	0700-0700	DP 55	
<b>6. Work Assignments:</b> Construct control lines as direct as possible. Mop up slopovers. Prep County Line Rd. for firing.							
<b>7. Special Instructions:</b> <b>***ALL OUT OF STATE ENGINES ARE TO REPORT TO TEHAMA CAMP FOLLOWING SHIFT.***</b> CRITICAL INFRASTRUCE: AT&T Microwave facility at 601 Lewiston Turnpike Rd. REMS will be available from DP 55.							
<b>8. Communications</b> (radio and/or phone contact numbers needed for this assignment):							
Name	Ch	Function	Rx Freq	Rx Tone	Tx Freq	Tx Tone	Notes
SHA CMD T2	1	COMMAND	154.4300	136.5	159.0150	123.0 (T2)	BASS MTN
CDF T32	14	TACTICAL	151.2425	192.8 (T16)	151.2425	192.8 (T16)	
CALCORD	15	MEDICAL	156.0750	156.7 (T6)	156.0750	156.7 (T6)	MEDICAL
A/G	6	A/G	159.3150	192.8	159.3150	192.8	AIR TO GROUND IS CDF TAC 17
GUARD	16	EMERGENCY	168.6250		168.6250	110.9	EMERGENCY USE ONLY
<b>9. Prepared by: Name:</b> B.J. Corey		Pos/Title: RESL		Signature:			
ICS 204		Date/Time: 7/29/2018		2216 hrs			

## ASSIGNMENT LIST (ICS 204)

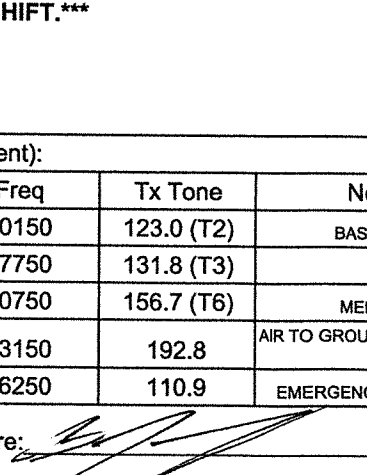
<b>1. Incident Name:</b> Carr		<b>2. Operational Period:</b> Date From: 07/30/18      Date To: 07/31/18 Time From: 0700              Time To: 0700			<b>3.</b>  Branch: II Div/Group: H Hotel Page 1 of 2		
<b>4. Operations Personnel:</b> Operations Section Chief: <b>Derrick Davis</b> Night Ops: <b>Tony Brownell</b> Branch Director: <b>Brian Noel</b> Branch Safety: <b>Mark Todd,</b> Division/Group Supervisor: <b>Jacob Keown</b> <b>Mike Weidner (T)</b>							
<b>5. Resources Assigned:</b>		<b>** Resources Below are 24 hour resources unless stated **</b>			Reporting Location, Special Equipment, Remarks, Notes, and Information Time                      Location		
Resource Identifier	ALS	Leader	Personnel	Request #			
ENG T3 SHU 2475		Gyves, Dusty	5	E-252	0700-0700	DP 50	
XSK - T/F - 1		Duncan, Johnathan	15	E-37	0700-0700	DP 50	
ENG T3 A3S 317FR		Farrell, Paul	3	E-228	0700-0700	DP 50	
ENG T3 SWR 8430		Rakestraw, Mark	4	E-315	0700-0700	DP 50	
ENG T6 PBC B7	ALS	Graham, Phillip	3	E-459	0700-1900	DP 50	
ENG T6 PBC B1		Battin, Daniel	3	E-460	0700-1900	DP 50	
ENG T6 LAX BRUSH 14		Mccann, Robert	3	E-561	0700-1900	DP 50	
STG TBD					-	DP 50	
STG TBD					-	DP 50	
STG TBD					-	DP 50	
STG TBD					-	DP 50	
STG TBD					-	DP 50	
STG TBD					-	DP 50	
DOZ PVT E-243		Darr, Chris	2	E-243	0700-0700	DP 50	
DOZ PVT E-344		Lassen, Steven	2	E-344	0700-0700	DP 50	
DOZ PVT E-400		Wurlitzer, George	3	E-400	0700-0700	DP 50	
DOZ PVT E-741		Moore, Jake	2	E-741	0700-0700	DP 50	
DOZ PVT E-844		Howard, Jeff	2	E-844	0700-0700	DP 50	
<b>6. Work Assignments:</b> Construct line on the County Line Rd. from DIV M to DIV F. Identify and construct secondary line from County Line Rd. to Trinity River.							
<b>7. Special Instructions:</b> ***ALL OUT OF STATE ENGINES ARE TO REPORT TO TEHAMA CAMP FOLLOWING SHIFT.*** REMS will be available from DP 55.							
<b>8. Communications</b> (radio and/or phone contact numbers needed for this assignment):							
Name	Ch	Function	Rx Freq	Rx Tone	Tx Freq	Tx Tone	Notes
SHA CMD T2	1	COMMAND	154.4300	136.5	159.0150	123.0 (T2)	BASS MTN
NIFC T6	12	TACTICAL	166.7750	131.8 (T3)	166.7750	131.8 (T3)	
CALCORD	15	MEDICAL	156.0750	156.7 (T6)	156.0750	156.7 (T6)	MEDICAL
A/G	6	A/G	159.3150	192.8	159.3150	192.8	AIR TO GROUND IS CDF TAC 17
GUARD	16	EMERGENCY	168.6250		168.6250	110.9	EMERGENCY USE ONLY
<b>9. Prepared by: Name:</b> B.J. Corey		<b>Pos/Title:</b> RESL		<b>Signature:</b> 			
<b>ICS 204</b>		<b>Date/Time:</b> 7/29/2018 2216 hrs					

## ASSIGNMENT LIST (ICS 204)

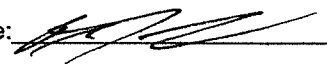
<b>1. Incident Name:</b> Carr		<b>2. Operational Period:</b> Date From: 07/30/18    Date To: 07/31/18 Time From: 0700    Time To: 0700				<b>3.</b>  Branch: <b>II</b>  Div/Group: <b>H</b>  <b>Hotel</b>	
<b>4. Operations Personnel:</b> Operations Section Chief: <b>Derrick Davis</b> Night Ops: <b>Tony Brownell</b> Branch Director: <b>Brian Noel</b> Branch Safety: <b>Mark Todd,</b> Division/Group Supervisor: <b>Jacob Keown</b> <b>Mike Weidner (T)</b>						<b>Page 2 of 2</b>	
<b>5. Resources Assigned:</b>		<b>** Resources Below are 24 hour resources unless stated **</b>				Reporting Location, Special Equipment, Remarks, Notes, and Information Time                      Location	
Resource Identifier	ALS	Leader	Personnel	Request #			
DOZ PVT E-847		Funes, Anthony	2	E-847	0700-0700	DP 50	
DOZ TBD					-	DP 50	
DOZ TBD					-	DP 50	
W/T PVT E-130		Scovil, Peter	2	E-130	0700-0700	DP 50	
W/T PVT E-131		Stanford, Brad	2	E-131	0700-0700	DP 50	
W/T PVT E-308		Wharff, Steve	1	E-308	0700-1900	DP 50	
W/T PVT E-359		Hinkle, John	1	E-359	0700-1900	DP 50	
W/T PVT E-639		John Traumiller	2	E-639	0700-0700	DP 50	
W/T PVT E-640		Bendall, John	2	E-640	0700-0700	DP 50	
HEQB TBD					-	DP 50	
HEQB TBD					-	DP 50	
HEQB TBD					-	DP 50	
FEMP MARTIN O-204	ALS	Martin, Drake	1	O-204	0700-0700	DP 50	
FEMT GRANT O-217		Grant, Justin	1	O-217	0700-0700	DP 50	
<b>6. Work Assignments:</b> Construct line on the County Line Rd. from DIV M to DIV F. Identify and construct secondary line from County Line Rd. to Trinity River.							
<b>7. Special Instructions:</b> <b>***ALL OUT OF STATE ENGINES ARE TO REPORT TO TEHAMA CAMP FOLLOWING SHIFT.***</b> REMS will be available from DP 55.							
<b>8. Communications</b> (radio and/or phone contact numbers needed for this assignment):							
Name	Ch	Function	Rx Freq	Rx Tone	Tx Freq	Tx Tone	Notes
SHA CMD T2	1	COMMAND	154.4300	136.5	159.0150	123.0 (T2)	BASS MTN
NIFC T6	12	TACTICAL	166.7750	131.8 (T3)	166.7750	131.8 (T3)	
CALCORD	15	MEDICAL	156.0750	156.7 (T6)	156.0750	156.7 (T6)	MEDICAL
A/G	6	A/G	159.3150	192.8	159.3150	192.8	AIR TO GROUND IS CDF TAC 17
GUARD	16	EMERGENCY	168.6250		168.6250	110.9	EMERGENCY USE ONLY
<b>9. Prepared by: Name:</b> B.J. Corey		<b>Pos/Title:</b> RESL		<b>Signature:</b> 			
ICS 204		<b>Date/Time:</b> 7/29/2018		<b>2216 hrs</b>			

## ASSIGNMENT LIST (ICS 204)

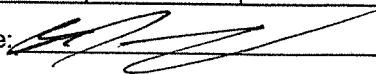
<b>1. Incident Name:</b> Carr		<b>2. Operational Period:</b> Date From: 07/30/18      Date To: 07/31/18 Time From: 0700      Time To: 0700				<b>3.</b> Branch: <b>III</b> Div/Group: <b>M</b> <b>Mike</b>	
<b>4. Operations Personnel:</b> Operations Section Chief: <b>Derrick Davis</b> Night Ops: <b>Tony Brownell</b> Branch Director: <b>Josh Campbell</b> Branch Safety: Ken Margrott, Division/Group Supervisor: <b>Dennis Boic</b> Steve Link (T)							
<b>5. Resources Assigned:</b>		<b>** Resources Below are 24 hour resources unless stated **</b>				Reporting Location, Special Equipment, Remarks, Notes, and Information Time      Location	
Resource Identifier	ALS	Leader	Personnel	Request #			
STC XMR 2140C		Menzel, Dmitri	22	E-277	0700-0700	See Special	
STC XSU 3225C		Cooper, Jason	16	E-112	0700-0700	See Special	
<b>STG TBD</b>					-	<b>See Special</b>	
<b>STG TBD</b>					-	<b>See Special</b>	
DOZ PVT E-51		Cattaneo, Angelo	2	E-51	0700-0700	See Special	
DOZ PVT E-93		Miller, Bruce	2	E-93	0700-0700	See Special	
DOZ PVT E-95		Owen, Mitchell	2	E-95	0700-0700	See Special	
DOZ PVT E-339		Coughlin, Steve	2	E-339	0700-0700	See Special	
DOZ PVT E-340		Oilar, Pat	2	E-340	0700-0700	See Special	
W/T PVT E-124		Presidio, Linn	2	E-124	0700-0700	See Special	
W/T PVT E-127		Mayberry, Steve	2	E-127	0700-0700	See Special	
W/T PVT E-128		Korbly, Eric	2	E-128	0700-0700	See Special	
W/T PVT E-134		Anderson, Sandra	2	E-134	0700-0700	See Special	
<b>FALM SWAMPER O-668</b>		<b>McDaniels, Jim</b>	<b>1</b>	<b>O-668</b>	<b>0700-1900</b>	<b>See Special</b>	
<b>FALM CLABORN O-671</b>		<b>Carter, Zack</b>	<b>1</b>	<b>O-671</b>	<b>0700-1900</b>	<b>See Special</b>	
HEQB DAVI O-15		Davi, Jason	1	O-15	0700-0700	See Special	
HEQB GOLDIE O-519		Goldie, Nathan	1	O-519	0700-0700	See Special	
FEMP SUTTON O-205	ALS	Sutton, Derek	1	O-205	0700-0700	See Special	
FEMT THOMPSON O-339		Thompson, Keith	1	O-339	0700-0700	See Special	
<b>6. Work Assignments:</b> Construct control lines as direct as possible. Construct contingency line. Construct safety zones. Mop up around structures.							
<b>7. Special Instructions:</b> <b>***ALL OUT OF STATE ENGINES ARE TO REPORT TO TEHAMA CAMP FOLLOWING SHIFT.***</b> REMS will be available from DP 55. Resources will report to Witten Ranch x Trinity Mtn Rd.							
<b>8. Communications</b> (radio and/or phone contact numbers needed for this assignment):							
Name	Ch	Function	Rx Freq	Rx Tone	Tx Freq	Tx Tone	Notes
SHA CMD T2	1	COMMAND	154.4300	136.5	159.0150	123.0 (T2)	BASS MTN
CDF T26	7	TACTICAL	159.2925	192.8 (T16)	159.2925	192.8 (T16)	
CALCORD	15	MEDICAL	156.0750	156.7 (T6)	156.0750	156.7 (T6)	MEDICAL
A/G	6	A/G	159.3150	192.8	159.3150	192.8	AIR TO GROUND IS CDF TAC 17
GUARD	16	EMERGENCY	168.6250		168.6250	110.9	EMERGENCY USE ONLY
<b>9. Prepared by: Name:</b> B.J. Corey		Pos/Title: RESL		Date/Time: 7/29/2018 2216 hrs		Signature: 	
<b>ICS 204</b>							

## ASSIGNMENT LIST (ICS 204)

<b>1. Incident Name:</b> Carr		<b>2. Operational Period:</b> Date From: 07/30/18    Date To: 07/31/18 Time From: 0700    Time To: 0700			<b>3.</b> Branch: III Div/Group: O Oscar Page 1 of 2		
<b>4. Operations Personnel:</b> Operations Section Chief: <b>Derrick Davis</b> Night Ops: <b>Tony Brownell</b> Branch Director: <b>Josh Campbell</b> Branch Safety: Ken Margrott, Division/Group Supervisor: <b>Darren Bakken</b> Steve Link (T)							
<b>5. Resources Assigned:</b> <b>** Resources Below are 24 hour resources unless stated **</b>					Reporting Location, Special Equipment, Remarks, Notes, and Information		
Resource Identifier	ALS	Leader	Personnel	Request #	Time	Location	
STC XTR 3275C		Alvord, Scott	18	E-75	0700-0700	Keswick Boat Ramp	
<b>STC CARR # 7</b>		<b>Volrie, Marvin</b>	<b>20</b>	<b>E-9045</b>	<b>0700-1900</b>	<b>Keswick Boat Ramp</b>	
STG SHU 9242G		Lange, Dennis	33	C-28	0700-0700	Keswick Boat Ramp	
<b>STG TBD</b>					-	<b>Keswick Boat Ramp</b>	
STL LMU 9222 L		Domnielsen, Ryan	7	E-21	0700-0700	Keswick Boat Ramp	
DOZ PVT E-52		Cattaneo, Angelo	2	E-52	0700-0700	Keswick Boat Ramp	
DOZ PVT E-54		Edwards, Rob	2	E-54	0700-0700	Keswick Boat Ramp	
DOZ PVT E-87		White, Dusty	2	E-87	0700-0700	Keswick Boat Ramp	
DOZ PVT E-88		Obrien, Mike	2	E-88	0700-0700	Keswick Boat Ramp	
DOZ PVT E-89		Saltens, Mike	3	E-89	0700-0700	Keswick Boat Ramp	
DOZ PVT E-92		Rhoades, Steven	2	E-92	0700-0700	Keswick Boat Ramp	
DOZ PVT E-404		Montz, John	3	E-404	0700-0700	Keswick Boat Ramp	
<b>DOZ TBD</b>					-	<b>Keswick Boat Ramp</b>	
<b>DOZ TBD</b>					-	<b>Keswick Boat Ramp</b>	
W/T SHS 32		Whitmer, John	2	E-28	0700-0700	Keswick Boat Ramp	
W/T PVT E-129		Dunne, Nick	2	E-129	0700-0700	Keswick Boat Ramp	
W/T PVT E-133		Sisson, Mike	2	E-133	0700-0700	Keswick Boat Ramp	
W/T PVT E-150		Pini, Tony	1	E-150	0700-0700	Keswick Boat Ramp	
<b>6. Work Assignments:</b> Construct control lines as direct as possible. Plan secondary control lines, begin if possible. Prepare indirect control lines for possible firing operations. Construct safety zones. Fall hazard trees that will threaten control lines.							
<b>7. Special Instructions:</b> <b>***ALL OUT OF STATE ENGINES ARE TO REPORT TO TEHAMA CAMP FOLLOWING SHIFT.***</b> REMS will be available from DP 55.							
<b>8. Communications</b> (radio and/or phone contact numbers needed for this assignment):							
Name	Ch	Function	Rx Freq	Rx Tone	Tx Freq	Tx Tone	Notes
SHA CMD T2	1	COMMAND	154.4300	136.5	159.0150	123.0 (T2)	BASS MTN
CDF T27	8	TACTICAL	159.3075	192.8 (T16)	159.3075	192.8 (T16)	
CALCORD	15	MEDICAL	156.0750	156.7 (T6)	156.0750	156.7 (T6)	MEDICAL
A/G	6	A/G	159.3150	192.8	159.3150	192.8	AIR TO GROUND IS CDF TAC 17
GUARD	16	EMERGENCY	168.6250		168.6250	110.9	EMERGENCY USE ONLY
<b>9. Prepared by: Name:</b> B.J. Corey		Pos/Title: RESL		Signature:			
ICS 204		Date/Time: 7/29/2018		2216 hrs			

## ASSIGNMENT LIST (ICS 204)

<b>1. Incident Name:</b> Carr		<b>2. Operational Period:</b> Date From: 07/30/18      Date To: 07/31/18 Time From: 0700      Time To: 0700				<b>3.</b>  Branch: III  Div/Group: O  Oscar  <b>Page 2 of 2</b>	
<b>4. Operations Personnel:</b> Operations Section Chief: <b>Derrick Davis</b> Night Ops: <b>Tony Brownell</b> Branch Director: <b>Josh Campbell</b> Branch Safety: Ken Margrott, Division/Group Supervisor: <b>Darren Bakken</b> Steve Link (T)							
<b>5. Resources Assigned:</b>		<b>** Resources Below are 24 hour resources unless stated **</b>					
Resource Identifier	ALS	Leader	Personnel	Request #			
HEQB RYAN O-16		Ryan, Sean	1	O-16	0700-0700	Keswick Boat Ramp	
HEQB (T) THOMAS O-554		Thomas, Ryan	1	O-554	0700-0700	Keswick Boat Ramp	
HEQB TBD					-	Keswick Boat Ramp	
HEQB TBD					-	Keswick Boat Ramp	
FALM O-666		Im Pvt Mendoza Timber F	1	O-666	0700-1900	Keswick Boat Ramp	
FALM O-667		Falm Pvt Mcdaniel	1	O-667	0700-1900	Keswick Boat Ramp	
FELB TBD					0700-1900	Keswick Boat Ramp	
FELB TBD					0700-1900	Keswick Boat Ramp	
FELB TBD					0700-1900	Keswick Boat Ramp	
FELB TBD					0700-1900	Keswick Boat Ramp	
FELB TBD					0700-1900	Keswick Boat Ramp	
FELB TBD					0700-1900	Keswick Boat Ramp	
FEMP ORDILLE O-337	ALS	Ordille, Peter	1	O-337	0700-0700	Keswick Boat Ramp	
FEMT SIEGEL O-214		Siegel, Isaac Emanuel	1	O-214	0700-0700	Keswick Boat Ramp	
<b>6. Work Assignments:</b> Construct control lines as direct as possible. Plan secondary control lines, begin if possible. Prepare indirect control lines for possible firing operations. Construct safety zones. Fall hazard trees that will threaten control lines.							
<b>7. Special Instructions:</b> ***ALL OUT OF STATE ENGINES ARE TO REPORT TO TEHAMA CAMP FOLLOWING SHIFT.*** REMS will be available from DP 55.							
<b>8. Communications</b> (radio and/or phone contact numbers needed for this assignment):							
Name	Ch	Function	Rx Freq	Rx Tone	Tx Freq	Tx Tone	Notes
SHA CMD T2	1	COMMAND	154.4300	136.5	159.0150	123.0 (T2)	BASS MTN
CDF T27	8	TACTICAL	159.3075	192.8 (T16)	159.3075	192.8 (T16)	
CALCORD	15	MEDICAL	156.0750	156.7 (T6)	156.0750	156.7 (T6)	MEDICAL
A/G	6	A/G	159.3150	192.8	159.3150	192.8	AIR TO GROUND IS CDF TAC 17
GUARD	16	EMERGENCY	168.6250		168.6250	110.9	EMERGENCY USE ONLY
<b>9. Prepared by: Name:</b> B.J. Corey		Pos/Title: RESL		Signature:			
ICS 204		Date/Time: 7/29/2018 2216 hrs					

## ASSIGNMENT LIST (ICS 204)

<b>1. Incident Name:</b> Carr		<b>2. Operational Period:</b> Date From: 07/30/18    Date To: 07/31/18 Time From: 0700    Time To: 0700				<b>3.</b>  Branch: <b>III</b>  Div/Group: <b>P</b>  <b>Papa</b>	
<b>4. Operations Personnel:</b> Operations Section Chief: <b>Derrick Davis</b> Night Ops: <b>Tony Brownell</b> Branch Director: <b>Josh Campbell</b> Branch Safety: <b>Ken Margrott, Steve Link (T)</b> Division/Group Supervisor: <b>Darryl Laws</b>							
<b>5. Resources Assigned:</b>		<b>** Resources Below are 24 hour resources unless stated **</b>				Reporting Location, Special Equipment, Remarks, Notes, and Information	
Resource Identifier	ALS	Leader	Personnel	Request #	Time	Location	
STC SKU 9262C		Laws, Darryl	22	E-255	0700-0700	DP 43	
<b>STC SHF 3675C</b>		<b>Smyth, Keith</b>	<b>27</b>	<b>E-164</b>	<b>0700-1900</b>	<b>DP 43</b>	
STG LMU 9224 G		Steele, Mark	33	C-46	0700-0700	DP 43	
STG TBD					-	DP 43	
CRW 1 TBD					-	DP 43	
<b>CRW SHF SHASTA LAKE</b>		<b>Flattley, Isaac</b>	<b>20</b>	<b>C-64</b>	<b>0700-1900</b>	<b>DP 43</b>	
CRW 2 TBD					-	DP 43	
CRW 2 TBD					-	DP 43	
DOZ PVT E-342		Leland, Ward	2	E-342	0700-0700	DP 43	
DOZ PVT E-346		Looper, John	2	E-346	0700-0700	DP 43	
DOZ PVT E-347		Thompson, Torin	2	E-347	0700-0700	DP 43	
DOZ PVT E-752		Perry, Brett	4	E-752	0700-0700	DP 43	
DOZ PVT E-753		Vicini, Merv	2	E-753	0700-0700	DP 43	
W/T PVT E-207		Strother, Thomas	2	E-207	0700-0700	DP 43	
W/T PVT E-352			2	E-352	0700-0700	DP 43	
W/T PVT E-357		Ed	2	E-357	0700-0700	DP 43	
FOBS TBD					-	DP 43	
HEQB TBD					-	DP 43	
HEQB TBD					-	DP 43	
<b>6. Work Assignments:</b> Construct control lines as direct as possible. Plan secondary control lines, begin if possible. Construct safety islands. Hold fire in planned lines. Improve and hold control lines.							
<b>7. Special Instructions:</b> <b>***ALL OUT OF STATE ENGINES ARE TO REPORT TO TEHAMA CAMP FOLLOWING SHIFT.***</b> REMS will be available from DP 55.							
<b>8. Communications</b> (radio and/or phone contact numbers needed for this assignment):							
Name	Ch	Function	Rx Freq	Rx Tone	Tx Freq	Tx Tone	Notes
SHA CMD T2	1	COMMAND	154.4300	136.5	159.0150	123.0 (T2)	BASS MTN
CDF T28	9	TACTICAL	151.1825	192.8 (T16)	151.1825	192.8 (T16)	
CALCORD	15	MEDICAL	156.0750	156.7 (T6)	156.0750	156.7 (T6)	MEDICAL
A/G	6	A/G	159.3150	192.8	159.3150	192.8	AIR TO GROUND IS CDF TAC 17
GUARD	16	EMERGENCY	168.6250		168.6250	110.9	EMERGENCY USE ONLY
<b>9. Prepared by: Name:</b> B.J. Corey		<b>Pos/Title:</b> RESL		<b>Signature:</b>			
<b>ICS 204</b>		<b>Date/Time:</b> 7/29/2018		<b>2216 hrs</b>			

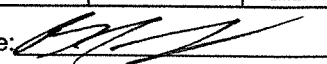

## ASSIGNMENT LIST (ICS 204)

<b>1. Incident Name:</b> Carr		<b>2. Operational Period:</b> Date From: 07/30/18      Date To: 07/31/18 Time From: 0700      Time To: 0700				<b>3.</b>  Branch: <b>IV</b>  Div/Group: <b>S</b>  <b>Sierra</b>  Page 1 of 2	
<b>4. Operations Personnel:</b> Operations Section Chief: <b>Derrick Davis</b> Night Ops: <b>Tony Brownell</b> Branch Director: <b>Merrick Fields</b> Branch Safety: <b>Scott Tavallero</b> Division/Group Supervisor: <b>Donald Davis</b>							
<b>5. Resources Assigned:</b> <b>** Resources Below are 24 hour resources unless stated **</b>							
Resource Identifier	ALS	Leader	Personnel	Request #	Reporting Location, Special Equipment, Remarks, Notes, and Information Time      Location		
STA TBD					-      Shasta Dam x Sac Rd		
STA TBD					-      Shasta Dam x Sac Rd		
STA TBD					-      Shasta Dam x Sac Rd		
STC SCU 9160C		Martin, Mike	18	E-249	0700-0700	Shasta Dam x Sac Rd	
STC LMU 9220 C		Delacour, Sean	17	E-18	0700-0700	Shasta Dam x Sac Rd	
STC TBD					-      Shasta Dam x Sac Rd		
CRW PVT C-31		Moreno, Anselmo	20	C-31	0700-1900	Shasta Dam x Sac Rd	
CRW PVT C-32		Mendoza, Jose	20	C-32	0700-1900	Shasta Dam x Sac Rd	
CRW 2 TBD					-      Shasta Dam x Sac Rd		
CRW 2 TBD					-      Shasta Dam x Sac Rd		
DOZ PVT E-55		Schnetzer, Donald	1	E-55	0700-0700	Shasta Dam x Sac Rd	
DOZ PVT E-90		Ron	3	E-90	0700-0700	Shasta Dam x Sac Rd	
DOZ PVT E-91		Zack	3	E-91	0700-0700	Shasta Dam x Sac Rd	
DOZ PVT E-94		Bruce Miller	2	E-94	0700-0700	Shasta Dam x Sac Rd	
DOZ PVT E-241		Larue, Clint	2	E-241	0700-0700	Shasta Dam x Sac Rd	
DOZ PVT E-242		Drue, Gangbin	2	E-242	0700-0700	Shasta Dam x Sac Rd	
W/T PVT E-356		Tony	2	E-356	0700-0700	Shasta Dam x Sac Rd	
W/T PVT E-361		Debois, Scott	2	E-361	0700-0700	Shasta Dam x Sac Rd	
<b>6. Work Assignments:</b> Complete dozer line from Flanigan Rd. to Dam. Prep structures for structure defense operations. Develop structure defense tactics. Mop up 100 feet or 100%. Complete and improve secondary secondary line.							
<b>7. Special Instructions:</b> ***ALL OUT OF STATE ENGINES ARE TO REPORT TO TEHAMA CAMP FOLLOWING SHIFT.*** REMS will be available from DP 55.							
<b>8. Communications</b> (radio and/or phone contact numbers needed for this assignment):							
Name	Ch	Function	Rx Freq	Rx Tone	Tx Freq	Tx Tone	Notes
SHA CMD T2	1	COMMAND	154.4300	136.5	159.0150	123.0 (T2)	BASS MTN
CDF T29	10	TACTICAL	151.3475	192.8 (T16)	151.3475	192.8 (T16)	
CALCORD	15	MEDICAL	156.0750	156.7 (T6)	156.0750	156.7 (T6)	MEDICAL
A/G	6	A/G	159.3150	192.8	159.3150	192.8	AIR TO GROUND IS CDF TAC 17
GUARD	16	EMERGENCY	168.6250		168.6250	110.9	EMERGENCY USE ONLY
<b>9. Prepared by: Name:</b> B.J. Corey      Pos/Title:      RESL      Signature: 							
<b>ICS 204</b>		Date/Time: 7/29/2018		2216 hrs			

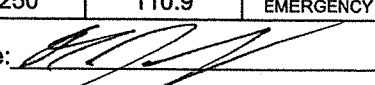

## ASSIGNMENT LIST (ICS 204)

<b>1. Incident Name:</b> Carr		<b>2. Operational Period:</b> Date From: 07/30/18    Date To: 07/31/18 Time From: 0700    Time To: 0700				<b>3.</b>  Branch: <b>IV</b>  Div/Group: <b>T</b>  <b>Tango</b>	
<b>4. Operations Personnel:</b> Operations Section Chief: <b>Derrick Davis</b> Night Ops: <b>Tony Brownell</b> Branch Director: <b>Merrick Fields</b> Branch Safety: <b>Scott Tavallero</b> Division/Group Supervisor: <b>Eric Mattson</b>							
<b>5. Resources Assigned:</b>		<b>** Resources Below are 24 hour resources unless stated **</b>				Reporting Location, Special Equipment, Remarks, Notes, and Information Time                      Location	
Resource Identifier	ALS	Leader	Personnel	Request #			
STA OES 4806A	ALS	Schwalbe, Brian	20	E-260	0700-0700	Hwy 299 x L. Spring	
STA TBD					-	<b>Hwy 299 x L. Spring</b>	
STC HUU 9121C		Bryant, Erik	17	E-681	0700-0700	Hwy 299 x L. Spring	
STC BTU 9210C		Edson, Jeff	17	E-19	0700-0700	Hwy 299 x L. Spring	
T/F OES 3800		Erick Mattson	9	E-76	0700-0700	Hwy 299 x L. Spring	
CRW PVT C-33		Rocha, Federico	20	C-33	0700-1900	Hwy 299 x L. Spring	
CRW PVT C-34		Duran, Ernesto	20	C-34	0700-1900	Hwy 299 x L. Spring	
DOZ PVT E-244		Dills, Evan	2	E-244	0700-0700	Hwy 299 x L. Spring	
DOZ PVT E-349		Darrah, Keith	2	E-349	0700-0700	Hwy 299 x L. Spring	
W/T PVT E-394		Troedel, Bryan	1	E-394	0700-0700	Hwy 299 x L. Spring	
W/T PVT E-396		Dee Holmes	2	E-396	0700-0700	Hwy 299 x L. Spring	
HEQB TBD					-	<b>Hwy 299 x L. Spring</b>	
HEQB TBD					-	<b>Hwy 299 x L. Spring</b>	
<b>6. Work Assignments:</b> Provide for Responder safety, civilian rescue, and evacuation. Effect structure defense tactics. Mop up 100 feet or 100%. Tactical patrol.							
<b>7. Special Instructions:</b> <b>***ALL OUT OF STATE ENGINES ARE TO REPORT TO TEHAMA CAMP FOLLOWING SHIFT.***</b> REMS will be available from DP 55.							
<b>8. Communications</b> (radio and/or phone contact numbers needed for this assignment):							
Name	Ch	Function	Rx Freq	Rx Tone	Tx Freq	Tx Tone	Notes
SHA CMD T2	1	COMMAND	154.4300	136.5	159.0150	123.0 (T2)	BASS MTN
CDF T30	11	TACTICAL	151.3925	192.8 (T16)	151.3925	192.8 (T16)	
CALCORD	15	MEDICAL	156.0750	156.7 (T6)	156.0750	156.7 (T6)	MEDICAL
A/G	6	A/G	159.3150	192.8	159.3150	192.8	AIR TO GROUND IS CDF TAC 17
GUARD	16	EMERGENCY	168.6250		168.6250	110.9	EMERGENCY USE ONLY
<b>9. Prepared by: Name:</b> B.J. Corey		Pos/Title: RESL		Signature: 			
ICS 204		Date/Time: 7/29/2018		2216 hrs			

## ASSIGNMENT LIST (ICS 204)

<b>1. Incident Name:</b> Carr		<b>2. Operational Period:</b> Date From: 07/30/18      Date To: 07/31/18 Time From: 0700      Time To: 0700				<b>3.</b>  Branch: <b>IV</b>  Div/Group: <b>U</b>  <b>Uniform</b>	
<b>4. Operations Personnel:</b> Operations Section Chief: <b>Derrick Davis</b> Night Ops: <b>Tony Brownell</b> Branch Director: <b>Merrick Fields</b> Branch Safety: <b>Scott Tavallero</b> Division/Group Supervisor: <b>Rik Valles</b>							
<b>5. Resources Assigned:</b>		<b>** Resources Below are 24 hour resources unless stated **</b>				Reporting Location, Special Equipment, Remarks, Notes, and Information Time      Location	
Resource Identifier	ALS	Leader	Personnel	Request #			
STA OES5 5805A		Alcorn, Billy	22	E-425	0700-0700	ICP	
<b>STA TBD</b>					-	<b>ICP</b>	
STB OES 5808B		Jelinek, Chris	21	E-426	0700-0700	ICP	
<b>STC TBD</b>					-	<b>ICP</b>	
DOZ PVT E-341		Oilar, Pat	2	E-341	0700-0700	ICP	
DOZ PVT E-846		Ingram, Brad	2	E-846	0700-0700	ICP	
W/T PVT E-353		Douglas, Jason	2	E-353	0700-0700	ICP	
W/T PVT E-354		Matteroli, Clay	2	E-354	0700-0700	ICP	
W/T PVT E-355		Shephard, Mitch	2	E-355	0700-0700	ICP	
W/T PVT E-360		Miller, Jim	2	E-360	0700-0700	ICP	
W/T PVT E-888		Taylor, Dalton	2	E-888	0700-0700	ICP	
<b>FALM O-673</b>		<b>Alderman, Mike</b>	<b>1</b>	<b>O-673</b>	<b>0700-1900</b>	<b>ICP</b>	
<b>HEQB TBD</b>					-	<b>ICP</b>	
HEQB WATNER O-292**		Watner, Mike	1	O-292	0700-0700	ICP	
<b>GRD PVT E-192**</b>		<b>Stenberg, Mike</b>	<b>1</b>	<b>E-192</b>	<b>0700-1900</b>	<b>ICP</b>	
W/T PVT E-132**			2	E-132	0700-0700	ICP	
W/T PVT E-758**		Jones, Ernest	2	E-758	0700-0700	ICP	
W/T PVT E-885**		Gassaway, Norm	2	E-885	0700-0700	ICP	
W/T PVT E-889**		Vieyra, Rich	2	E-889	0700-0700	ICP	
<b>FALM TBD**</b>					<b>0700-1900</b>	<b>ICP</b>	
<b>6. Work Assignments:</b> Provide for Responder safety, civilian rescue, and evacuation. Effect structure defense tactics. Mop up 100 feet or 100%. Tactical patrol.							
<b>7. Special Instructions:</b> <b>***ALL OUT OF STATE ENGINES ARE TO REPORT TO TEHAMA CAMP FOLLOWING SHIFT.***</b> REMS will be available from DP 55. **Dentotes resouces that will work together to grade Southfork Mtn Rd, 7 miles each way.							
<b>8. Communications</b> (radio and/or phone contact numbers needed for this assignment):							
Name	Ch	Function	Rx Freq	Rx Tone	Tx Freq	Tx Tone	Notes
SHA CMD T2	1	COMMAND	154.4300	136.5	159.0150	123.0 (T2)	BASS MTN
CDF T32	12	TACTICAL	151.2425	192.8 (T16)	151.2425	192.8 (T16)	
CALCORD	15	MEDICAL	156.0750	156.7 (T6)	156.0750	156.7 (T6)	MEDICAL
A/G	6	A/G	159.3150	192.8	159.3150	192.8	AIR TO GROUND IS CDF TAC 17
GUARD	16	EMERGENCY	168.6250		168.6250	110.9	EMERGENCY USE ONLY
<b>9. Prepared by: Name:</b>		B.J. Corey		<b>Pos/Title:</b> RESL		Signature: 	
ICS 204		Date/Time: 7/29/2018		2216 hrs			















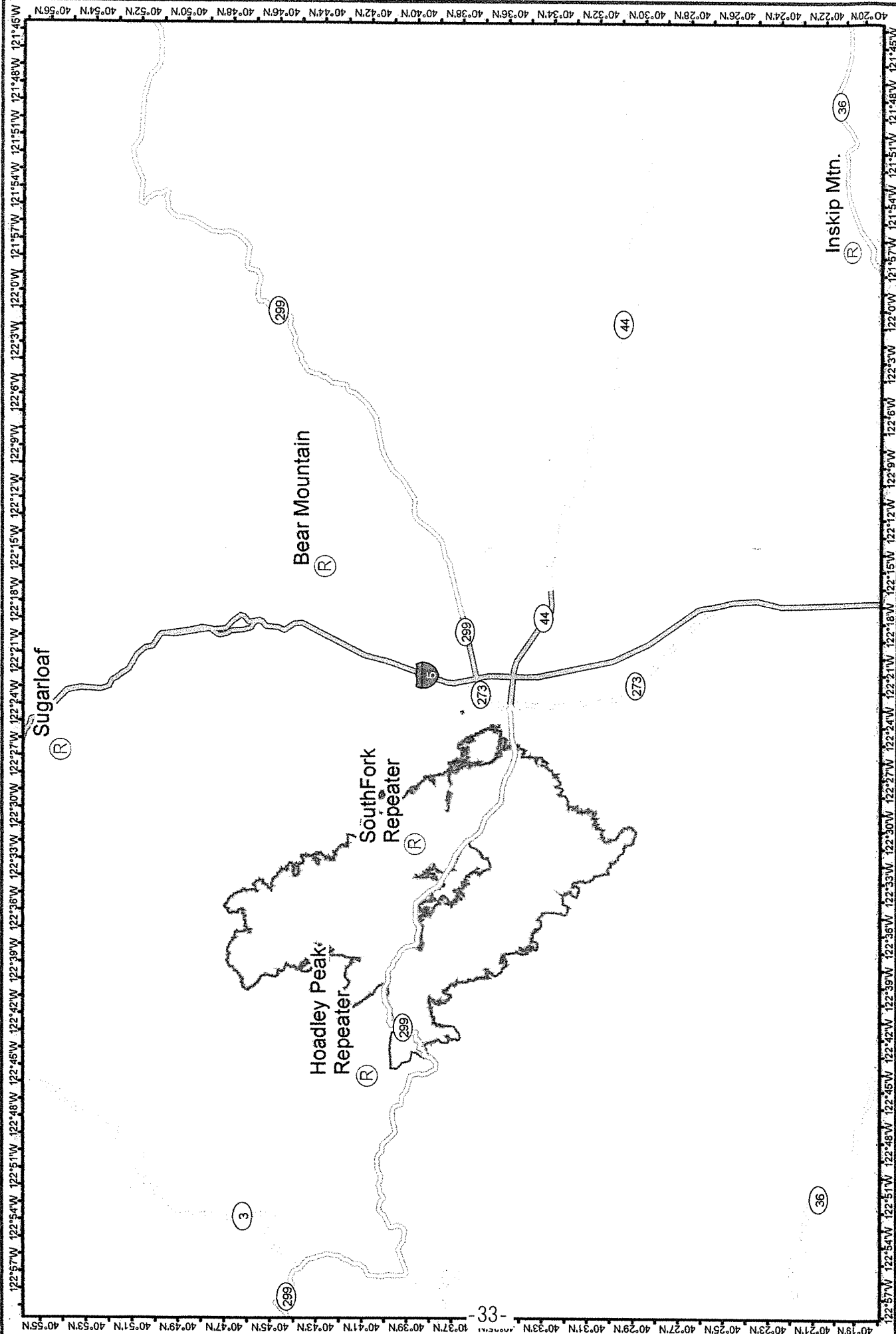

Carr Fire  
 CA-SHU-007808  
**COMMS**  
 Jul 30, 2018



**Communication Map**  
**Carr Fire**  
 CA-SHU-007808



## SAFETY MESSAGE/PLAN (ICS 208)

INCIDENT NAME:  
CARR FIRE CA-SHU-007808

Operational Period: Date From: 7/30/18      Date to: 7/31/18  
Time From: 0700      Time to: 0700

We are **ALL** Accountable and Responsible for **SAFE** behaviors.

### MAJOR HAZARDS AND RISKS

- **EXTREME FIRE BEHAVIOR:** Remember the **BASICS, L.C.E.S.**
- **HYDRATION/NUTRITION/FATIGUE:** Drink water, eat, and rest when necessary and appropriate.
- **REPOPULATION:** Be aware and respectful of the public returning to their homes.
- **RE-ENERGIZED POWER TRANSMISSION LINES:** Be aware that lines may be live.
- **STEEP/RUGGED TERRAIN:** Watch footing, maintain Situational Awareness, Wear PPE.

- **Identify safety zones and escape routes, flag where necessary.**
- **HYDRATION-HYDRATION-HYDRATION- Drink Early Drink Often. Bring plenty of water with you to the line.**
- **Post lookouts when working in areas with underslung line.**
- **Ensure you have been adequately briefed and have established communications with your supervisor and adjacent forces. When in doubt, ask questions. Understand TASK, PURPOSE and END STATE**
- **Complacency- Just because things are going well now, doesn't mean they can't suddenly go horribly wrong.**
- **Understand and follow the communications plan including the ICS 206 Medical Emergency Procedures and incident within incident protocols.**
- **Tailgate Safety Briefings- Discuss Levels of Engagement, consider PACE**
- **Driving- There is a lot of equipment, media, and public driving in the area. Drive slow, with head lights on, and with seatbelts fastened.**

Prepared By: Anthony Stornetta

Position/Title: SOF1(T)

Signature: \_\_\_\_\_



ICS 208

IAP Page

Date/Time: 7/29/18 1800 hrs.

**MEDICAL PLAN (ICS 206)**

<b>1. Incident Name:</b> <b>CARR INCIDENT</b>	<b>2. Operational Period:</b> Date From: 07/30/2018      Date To: 07/31/2018 Time From: 07:00      Time To: 07:00
--	--

<b>3. Medical Aid Stations:</b>		<b>MEDICAL UNIT LEADER: (408) 710-7196</b>	<b>COMMUNICATIONS UNIT: (530) 949-6816</b>
Name	Location	Contact Number(s)/Frequency	Paramedics on Site?
MERT	BASE CAMP (BY CDC SLEEPING AREA)	(530) 310-0716	RN & PA
EXPEDITORS	ANDERSON FAIRGROUNDS (NEAR BRIEFING)	---	NONE
FRONTLINE MEDICAL	RED BLUFF FAIRGROUNDS	(530) 604-8380	PARAMEDICS

**4. Transportation (indicate air or ground):**

Ambulance Service	Location	Contact Number(s)/Frequency	Level of Service
AMR 145	HWY 299 X MAGNOLIA & BASE CAMP	CDF COMMAND 2 T14	ALS
MERCY 115	HWY 299 X MAGNOLIA AVE & BASE CAMP	CDF COMMAND 2 T14	ALS
REACH AIRSHIP 5 (NIGHT)	1524 East St. Redding	(877) 939-6300	RN
PHI AIR MED	5900 Old Oregon Trail Redding	(800) 597-9571	RN
CHP 14 & 16 (HOIST)	2651 Gold Street (Benton Airpark), Redding	(530) 225-2040	ALS/HOIST
NATIONAL GUARD 840	REDDING MUNI HELIBASE	CDF COMMAND 2 T14	24 HOUR HOIST

**5. Hospitals:**

Hospital Name	Address, Latitude & Longitude if Helipad	Contact Number(s)/Frequency	Travel Time		Trauma Center	Burn Center	Helipad
			Air	Ground			
SHASTA REG MED CTR MED 2	1100 BUTTE ST, REDDING 40° 35.106'N, 122° 23.268'W	(530) 244-5400 468.025 Tx, 468.025 Rx PL 5	10 MIN	29 MIN	YES LEVEL: 3	NO	YES
MERCY MED CTR MED 4	2175 ROSALINE AVE, REDDING 40° 34.332'N, 122° 23.796'W	(530) 225-7201 468.075 Tx, 463.000 Rx PL 5	10 MIN	29 MIN	YES LEVEL: 2	NO	YES
UC DAVIS MED 8	2315 STOCKTON BLVD SACRAMENTO 38° 33.360'N, 121° 27.330'W	(916) 734-2011 446.525 Tx, 203.5 Rx	1.25 HOUR	3.5 HOUR	YES Level: 1	YES	YES

**6. Special Medical Emergency Procedures:**  
**LINE EMERGENCY:**  
 Crew Supervisor to contact Division Supervisor with patient complaint/condition, location, and resource needs.

- Division Supervisor contacts and gives report on conditions, complaint/condition, and resource needs to:
  1. Nearest Line FEMT/FEMP
  2. Communications Unit
- Emergency or Priority traffic received: Communication Unit will clear the command channel for emergency traffic only, for the duration of the MAJOR IWI
- Communications Unit will make proper notifications
- OPERATIONS can declare a MAJOR IWI based on the report on conditions from the division supervisor
- Division Supervisor or designee will serve as point of contact (IWI SUPERVISOR) and run the emergency utilizing the COMMAND CHANNEL and CALCORD for the tac net during the IWI

**\*\*ALL EMERGENCIES: Secure the area and identify witnesses for later investigation. Keep an accurate log of events\*\***

**\*\*\*START 20 MINUTE TIMER IF IWI\*\*\***

**BASE CAMP EMERGENCY:**  
**CONTACT COMMUNICATIONS UNIT AT: (530) 949-6816** report patient complaint/condition and location. Medical Staff will respond to stabilize incident

- COMMUNICATIONS Unit contacts:
  1. Operations
  2. Medical
  3. Safety
  4. Logistics

**INJURY REPORTING PROCEDURES**  
 CHIEF COMPLAINT \_\_\_\_\_  
 LOCATION OF PATIENT \_\_\_\_\_  
 TRANSPORT REQUEST BY: AIR \_\_\_\_\_ GROUND \_\_\_\_\_  
 DIVISION \_\_\_\_\_ CREW \_\_\_\_\_  
 POINT OF PICKUP \_\_\_\_\_  
 LAT \_\_\_\_\_ LONG \_\_\_\_\_  
 IS EMT WITH THE PATIENT: YES \_\_\_\_\_ NO \_\_\_\_\_  
 AGE \_\_\_\_\_  
 SEX: MALE \_\_\_\_\_ FEMALE \_\_\_\_\_

**\*\*Pre-determined rendezvous location for transfer from rescue helicopter to ground ambulance or air ambulance: SKY RANCH HELIBASE\*\***  
 N 40°29.49 W 122°22.27  
 7400 MARKET ST  
 REDDING, 96003

7. Prepared by (Medical Unit Leader): Name: JESSE WINNEN	Signature:
8. Approved by (Safety Officer): ANTHONY STORNETTA	Signature:
ICS 206	IAP Page _____ Date/Time: 07/29/2018 1800





# STRUCTURE DEFENSE GUIDE

## STRUCTURE TRIAGE DECISION PROCESS (S-FACTS)

### SURVIVAL

- Initial Assessment: can you survive here? **If not, LEAVE NOW!**
- Is there a Safety Zone nearby? **If not, LEAVE NOW! (IRPG)**
- Do you have a viable Escape Route?
- What is the decision point at which you will leave based on fire behavior and rate of spread?
- Is there a Temporary Refuge Area (TRA) on site? **If not, LEAVE NOW!**
  - Preplanned area for immediate, temporary refuge
    - Use of fire shelter should not be necessary
  - Is there a viable Escape Route to the TRA or Safety Zone?
- Is "Prep and Go" tactic an option?
- Do you have communications with your supervisor and adjoining forces?
- If safety issues cannot be mitigated, **LEAVE NOW!**

### FIRE ENVIRONMENT

- Can you survive based on current and expected fire behavior? **If not, LEAVE NOW!**
- Look up, Look Down, Look Around Indicators:
  - Fuels (characteristics, moisture, temperature)
    - What will the intensity of the fire be when it arrives?
    - How long will it take to consume the fuels?
  - Wind
    - Current speed/direction
    - Expect changing winds
  - Terrain
    - Are you in a chute, chimney, or saddle? **If yes, LEAVE NOW!**
    - Is wind in alignment with topography?
    - What is your position relative to topography?
    - Are you mid slope or on top of a ridge?
  - Atmospheric Stability
  - Fire Behavior (requires constant monitoring)
    - Spotting, crowning, sheeting, rate of spread?
    - Flame length and height?
- Other weather considerations:
  - What is the current relative humidity?
    - Is there an expected change?
  - Are thunderstorms forecasted?

### ACCESS

- Is access compatible with time and distance factors necessary to utilize as an Escape Route to a Safety Zone?
  - Road surface adequate for speed necessary?
  - Adequate width?
  - Turnaround/turnouts?
  - Bridges within limits for fire apparatus?
  - Drainage ditches/culverts?
  - Steep grades?
  - Is there a safe place to spot apparatus?

## CONSTRUCTION/CLEARANCE

- Does the structure have adequate defensible space, based on topography, fuels, and current and expected fire behavior?
- Can defensible space problems be mitigated quickly?
- Will building materials and yard clutter compromise safety?
- Is the construction wood siding or shake shingle roof?
- Are there vent openings, open eaves, large glass windows facing fire front, decks with vegetation below?
  - Will ember intrusion through attic or foundation vents be a problem?
- What are the contents in the garage and outbuildings?
- Are there hazardous materials present?
- Are there propane tanks, fuel tanks, or power lines?
- Is there an adequate water supply nearby?
- Are additional resources needed to mitigate issues?
- Consider "Prep and Go" or "Prep and Defend" tactics

## TIME CONSTRAINTS

- Is there time for an adequate size up of the structure defense problem?
- Is there time to mitigate safety concerns?
- Is there time and adequate resources to properly prepare and defend the structure?
- Is there time to escape, utilizing Escape Routes, to a Safety Zone? **If not, LEAVE NOW!**

## STAY OR GO

- Tactical decision based on the S-FACTS
- Is it safe to stay? If no, utilize "Check and Go" tactic
- Is there time to prepare the structure for defense and what will the fire behavior be when the fire gets here?
- "Prep and Go" or "Fire Front Following" tactics should be used when it is not safe to "Prep and Defend"

## STRUCTURE TRIAGE CATEGORIES

### Not-Threatened

- Safety Zone nearby and TRA present at structure
- Construction features/defensible space make the structure unlikely to ignite
- Residents may/may not have evacuated

### Threatened Defensible

- Safety Zone nearby and TRA present at structure
- Construction features/defensible space require structure defense tactics during fire front impact
- Residents may/may not have evacuated

### Threatened non-Defensible

- Lack of adequate Safety Zone nearby
- Structure cannot be safely defended
- Residents must be evacuated

## ENTRAPMENT AVOIDANCE

- Are you adhering to the **10 Standard Firefighting Orders?** (IRPG)
- Have you considered the **18 Situations that Shout Watch Out?**
- Have you considered the **Common Denominators of Fire Behavior on Tragedy Fires?** (IRPG)
- Are you maintaining **LCES?** (IRPG)
- Look Up, Look Down, Look Around (IRPG)
- Have Decision Points ("Trigger Points") been established?
- Conduct Risk Management (IRPG)
  - Situational Awareness – Hazard Assessment – Hazard Control – Decision Point – Evaluate



# FIRING OPERATION CHECKLIST

Location: \_\_\_\_\_

Date: \_\_\_\_\_ Time: \_\_\_\_\_

Firing Supervisor \_\_\_\_\_

## 1. Personnel Briefing

- Objectives
- Conditions (fire environment)
- Resource assignments identified
  - Firing personnel
  - Holding forces
  - Lookouts
- Ignition plan/sequence
- Communication Plan
- Contingency Plan
- Safety issues

## 2. Go / No-Go

- All personnel briefed
- Weather forecast reviewed
- Resources in place
- Lookouts posted as needed
- Anchor and termination firing points identified
- Communications systems in place
- Fire behavior forecast reviewed
- Escape routes and safety zones established and made known
- Adjoining forces/Air Attack notified

## 3. Approval Prior To Firing

- Division Supervisor
- Branch Director
- Operations

## 4. Other Notifications

- Other: \_\_\_\_\_
- Other: \_\_\_\_\_

Attach Firing Operations Checklist to ICS-214



# PUBLIC INFORMATION



Incident Information Line: (530) 225-2510  
Incident Media Line: (530) 448-2466

STATUS	
Incident Start Date: 7/23/2018	Incident Start Time: 1:15 PM
Cause: Mechanical Failure of Vehicle	Acres:
Containment:	Total Personnel:

**MEDIA** – The California State Penal Code Section 409.5(d) allows the news media to enter scenes of disaster, riot or civil disturbance. Properly identified members of the news media should not be restricted from entering locations specified within the code. However, this does not include crime scenes, private property and does not imply that the news media may interfere with incident operations while they are in the areas of concern. More information can be found [here](#).



**CAL FIRE SOCIAL MEDIA POLICY** – When assigned to a CAL FIRE incident, you will adhere to the CAL FIRE Social Media Policy, Section 0691. You can find further information about the CAL FIRE Social Media Policy [here](#).



**PHOTOGRAPHS AND VIDEOS OF INCIDENT** – We are in a new era of media. Media no longer means news/broadcast industry, but now refers to anyone that has the capability to shoot video, photographs and post them onto social media sites in a matter of minutes. Unfortunately, we have seen some instances of photographs or videos that have depicted unsafe, unprofessional or embarrassing circumstances which are a serious breach of ethics. When this happens, it reflects poorly on all that are attached to this incident. Posting an inappropriate video, photo or blog comment could expose oneself to unwanted ramifications. It may be unsafe to shoot photos or video and a firefighter who is concentrating on a camera loses their situational awareness.

The Public Information Office would like copies of the video and pictures that you safely took while not in an emergency situation, fire suppression activity or in an overhead assignment. Bring your video and pictures to the Public Information trailer; they will be reviewed and possibly uploaded to our many CAL FIRE social media sites. Remember, we don't want photographs or videos that depict unsafe, unprofessional or embarrassing circumstances, which are a serious breach of ethics.

**LOST AND FOUND** – The Information Section will manage lost and found items for the incident. If you have lost an item please leave your contact information and what you have lost at the Information Section. If you have found an item on the incident, bring the item to the Information Section with your contact information as well.

**MAIL SERVICE** – The Information Section can assist you with sending and receiving mail. The address is Shasta District Fairgrounds 1890 Briggs St. Anderson CA. 96007



# CARR FIRE

CA-SHU-007808

## FINANCE MESSAGE

- Finance Section is located in Fusaro Building
  - Please come by the Time Unit and start your and update your FC-33
  - Vendors please drop off your agreements to the Time Unit
  - Shift Tickets need to be completed by line supervisor and turned in at the end of each shift.
  - All injuries need to be reported to the COMP / CLAIMS Unit
  - All property Damage must be reported and documented
  - Please report any Vehicle Damage this includes Rental Vehicles
  - Local Government please check in with OES
  - Federal Time: Timekeeper on site.
  - **OFF-SITE FEEDING IS NOT APPROVED**
  - Water usage report needs to be turned in daily to the COMP / CLAIMS Unit
- 
- **This fire is under Cost Apportionment**
    - **All DIVS, OPBD, STAM need to debrief with the Cost Apportionment Team Daily**
    - Cost Apportionment is located in the trailer directly across from Fusaro Hall

## **INCIDENT BILLING INFORMATION**

### **CAL FIRE – SHASTA / TRINITY UNIT**

875 CYPRESS AVE.  
Redding Ca. 96001

Index Code: 2400

E-fund Billing Code: 013860

Federal P Code: PNL1A6 (1502) [P]





# SHIFT TICKET EXAMPLE

EMERGENCY SHIFT TICKET and EVALUATION FORM					Contractor Name <b>DOZER DUDE</b>	
Incident or Project Name <b>LILAC INC</b>		Incident Number <b>CAMVU024612</b>		Request Number <b>E#</b>		Operator #1 <b>BOB SMITH</b>
Agreement Number <b>XXX - 000000 - 00</b>		Equipment Make <b>CAT</b>		Equipment Model / Type <b>D6XM</b>		Operator #2 <b>TOM SMITH</b>
Serial Number <b>FULL VIN#</b>		Licence Number <b>1234567</b>		Operator Furnished By: <input checked="" type="checkbox"/> Contractor <input type="checkbox"/> Government		Operating Supplies Furnished By: <input checked="" type="checkbox"/> Contractor <input type="checkbox"/> Government
Date Mo / Day		Equipment Use (Circle) <b>Hours</b> Days / Miles		Equipment Status <input checked="" type="checkbox"/> Inspected <input checked="" type="checkbox"/> Under Agreement		
12/8	0700	2400	17	Assignment <b>DIV M</b>		Remarks/Comments **  <b>2 OPERATORS</b>
12/9	0001	0700	7	<b>DIV M</b>		
Vendor Rating					Govt. Rep. Name and Position - PRINT <b>Mike Weber</b>	
Met Performance Expectations					Govt. Rep. Signature <i>Mike Weber</i>	
Equipment in Safe Working Condition					Contractor Signature <i>Bob Smith</i>	
Operator Skill Level					Date <b>08/04/15</b>	
Operates Safely					Time <b>0800</b>	
Operator's Cooperation Level					CALFIRE 297 (Rev 3-2011)	
Overall Performance						
<p>* NOTE: Any rating of POOR requires an explanation in Comment Section.                  **Final evaluation or for more documentation, use an ICS Form 230 or equivalent.</p>						
Pink - Finance		Blue - Home Unit HE Coordinator		Yellow - Vendor		White - Govt Representative

EMERGENCY SHIFT TICKET and EVALUATION FORM					Contractor Name <b>DUDE TRANSPORT</b>	
The responsible Government Officer will complete this form each shift						
Incident or Project Name <b>LILAC INC</b>		Incident Number <b>CAMVU 024612</b>		Request Number <b>E #</b>		Operator #1 <b>BOB SMITH</b>
Agreement Number <b>XXX - 000000 - 00</b>		Equipment Make <b>TRANSPORT/ KENWORTH</b>		Equipment Model / Type <b>COZAD TRAILER /26 WHEELS</b>		Operator #2 <b>TOM SMITH</b>
Serial Number <b>1XP3ESMP14239012</b>		Licence Number <b>9999999</b>		Operator Furnished By: <input checked="" type="checkbox"/> Contractor <input type="checkbox"/> Government		Operating Supplies Furnished By: <input checked="" type="checkbox"/> Contractor <input type="checkbox"/> Government
Date Mo / Day		Equipment Use (Circle) <b>Hours</b> Days / Miles		Equipment Status <input checked="" type="checkbox"/> Inspected <input checked="" type="checkbox"/> Under Agreement		
12/8	0700	2400	17	Assignment <b>DIV M</b>		Remarks/Comments **  <b>2 OPERATORS</b>
12/9	0001	0700	7	<b>DIV M</b>		
Vendor Rating					Govt. Rep. Name and Position - PRINT <b>Mike Weber</b>	
Met Performance Expectations					Govt. Rep. Signature <i>Mike Weber</i>	
Equipment in Safe Working Condition					Contractor Signature <i>Bob Smith</i>	
Operator Skill Level					Date <b>08/04/15</b>	
Operates Safely					Time <b>0800</b>	
Operator's Cooperation Level					CALFIRE 297 (Rev 3-2011)	
Overall Performance						
<p>* NOTE: Any rating of POOR requires an explanation in Comment Section.                  **Final evaluation or for more documentation, use an ICS Form 230 or equivalent.</p>						
Pink - Finance		Blue - Home Unit HE Coordinator		Yellow - Vendor		White - Govt Representative

**Turn shift tickets into Finance.**

# SHIFT TICKET EXAMPLE

EMERGENCY SHIFT TICKET and EVALUATION FORM						Contractor Name				
Incident or Project Name <b>LILAC INC</b>			Incident Number <b>CAMVU 024612</b>		Request Number <b>E or S # Here</b>			Contractor Name <b>H2O DUDE</b>		
Agreement Number <b>XXX - 000000 - 00</b>			Operator #1 <b>BOB SMITH</b>		Operator #2					
Equipment Make <b>FREIGHTLINER</b>			Equipment Model / Type <b>WATER TENDER 2500+ TYPE 1</b>					Operator Furnished By: <input checked="" type="checkbox"/> Contractor <input type="checkbox"/> Government		
Serial Number <b>LAST 8 OF VIN#</b>			Licence Number <b>55555555</b>					Operating Supplies Furnished By: <input checked="" type="checkbox"/> Contractor <input type="checkbox"/> Government		
Equipment Use (Circle) <b>Hours</b> Days / Miles			Equipment Status <input checked="" type="checkbox"/> Inspected <input type="checkbox"/> Under Agreement					Released by Government <input type="checkbox"/> Withdrawn by Contractor		
Date Mo / Day			Start		Stop		Work		Assignment	
12/8			0001		0700		7		OFF SHIFT	
12/8			0700		1900		12		BASE CAMP	
12/8			1900		2400		5		OFFSHIFT	
Vendor Rating						Govt. Rep. Name and Position - PRINT				
Poor* Avg. Good Exc. N/A						<b>Mike Weber</b>				
Met Performance Expectations						Govt. Rep. Signature				
Equipment in Safe Working Condition						<i>Mike Weber</i>				
Operator Skill Level						Contractor Signature				
Operates Safely						<i>Bob Smith</i>				
Operator's Cooperation Level						Date		Time		
Overall Performance						<b>08/04/15</b>		<b>0800</b>		
* NOTE: Any rating of POOR requires an explanation in Comment Section.						CALFIRE 297				
**Final evaluation or for more documentation, use an ICS Form 230 or equivalent.						(Rev 3-2011)				
Pink - Finance		Blue - Home Unit HE Coordinator		Yellow - Vendor		White - Govt Representative				

EMERGENCY SHIFT TICKET and EVALUATION FORM						Contractor Name				
The responsible Government Officer will complete this form each shift						Contractor Name <b>WATER GUY</b>				
Incident or Project Name <b>LILAC INC</b>			Incident Number <b>CAMVU 024612</b>		Request Number <b>E OR S # Here</b>			Operator #1 <b>BOB SMITH</b>		
Agreement Number <b>XXX - 000000 - 00</b>			Operator #2 <b>BILL SMITH</b>		Operator Furnished By: <input checked="" type="checkbox"/> Contractor <input type="checkbox"/> Government					
Equipment Make <b>PETERBUILT</b>			Equipment Model / Type <b>WATER TENDER 2500 + TYPE 1</b>					Operating Supplies Furnished By: <input checked="" type="checkbox"/> Contractor <input type="checkbox"/> Government		
Serial Number <b>LAST 8 OF VIN#</b>			Licence Number <b>9999999</b>					Equipment Status <input checked="" type="checkbox"/> Inspected <input type="checkbox"/> Under Agreement		
Equipment Use (Circle) <b>Hours</b> Days / Miles			Released by Government <input type="checkbox"/> Withdrawn by Contractor							
Date Mo / Day			Start		Stop		Work		Assignment	
12/8			0700		2400		17		DIV M	
12/9			0001		0700		7		DIV M	
Vendor Rating						Govt. Rep. Name and Position - PRINT				
Poor* Avg. Good Exc. N/A						<b>Mike Weber</b>				
Met Performance Expectations						Govt. Rep. Signature				
Equipment in Safe Working Condition						<i>Mike Weber</i>				
Operator Skill Level						Contractor Signature				
Operates Safely						<i>Bob Smith</i>				
Operator's Cooperation Level						Date		Time		
Overall Performance						<b>08/04/15</b>		<b>0800</b>		
* NOTE: Any rating of POOR requires an explanation in Comment Section.						CALFIRE 297				
**Final evaluation or for more documentation, use an ICS Form 230 or equivalent.						(Rev 3-2011)				
Pink - Finance		Blue - Home Unit HE Coordinator		Yellow - Vendor		White - Govt Representative				

**Turn shift tickets into Finance.**

# **TRAINING SPECIALIST MESSAGE**

**TRAINEES: CAPTURE YOUR TRAINING OPPORTUNITIES. COME SEE THE TRAINING SPECIALIST TODAY!**

**LOCATED IN THE FUSARO BUILDING**

**TO OPEN A FILE, YOU MUST BRING THE FOLLOWING ITEMS:**

- YOUR HOME AGENCY ISSUED POSITION TASK BOOK IN FOR REVIEW.
- BRING YOUR IQCS/IQS (RED CARD) OR AGENCY SPECIFIC QUALIFICATION CARD
- YOUR TRAINER/EVALUATOR INFORMATION

**BEFORE DEMOBILIZATION, RETURN TO CLOSE YOUR FILE, YOU **MUST** BRING THE FOLLOWING ITEMS:**

- YOUR INITIATED POSITION TASK BOOK IN FOR REVIEW. THE PTB MUST BE COMPLETED BY THE TRAINER/EVALUATOR
- YOUR TRAINER/EVALUATOR
- COMPLETED EVALUATION RECORD
- COMPLETED INDIVIDUAL PERFORMANCE EVALUATION (ICS 225)

**TRAINING SPECIALIST: DAVE RANDOLPH (805) 857-4820**

**TRAINING SPECIALIST TRAINEE: CHARLIE PICCARO (310) 529-5844**



## Peer Support Team Message:

CARR INCIDENT PEER SUPPORT: (916) 591-9004

The gravity of this event is large. Many of us have been impacted by the events that have occurred as well as past incidents.

A peer support team has been assembled and Peers are available at the ICP. The Peer Support contact number is (916)-591-9004, which is available 24/7.

Some of the signs and symptoms you may be experiencing include, but are not limited to:

Irritability, lack of sleep, quick to anger, withdrawal, above average tobacco use, an increase in negative coping mechanisms such as excessive alcohol and/or substance abuse. You might experience lack of appetite, isolate yourself, and various other unexplained responses to normal every day events.

You may not be experiencing these symptoms now or during this fire incident. However, you may find yourself experiencing them when you return to your home or unit. You may find yourself being triggered by a past event that has impacted you, while assigned to future incidents. A sight, sound, smell, or touch could trigger a memory that previously existed, but you may not have been aware of.

If you find yourself in this situation and need to talk to someone contact your Employee Assistance Program (EAP). EAP programs are here to help. It is important to be able to talk to someone and get stuff off your chest vs carrying this around for your career.

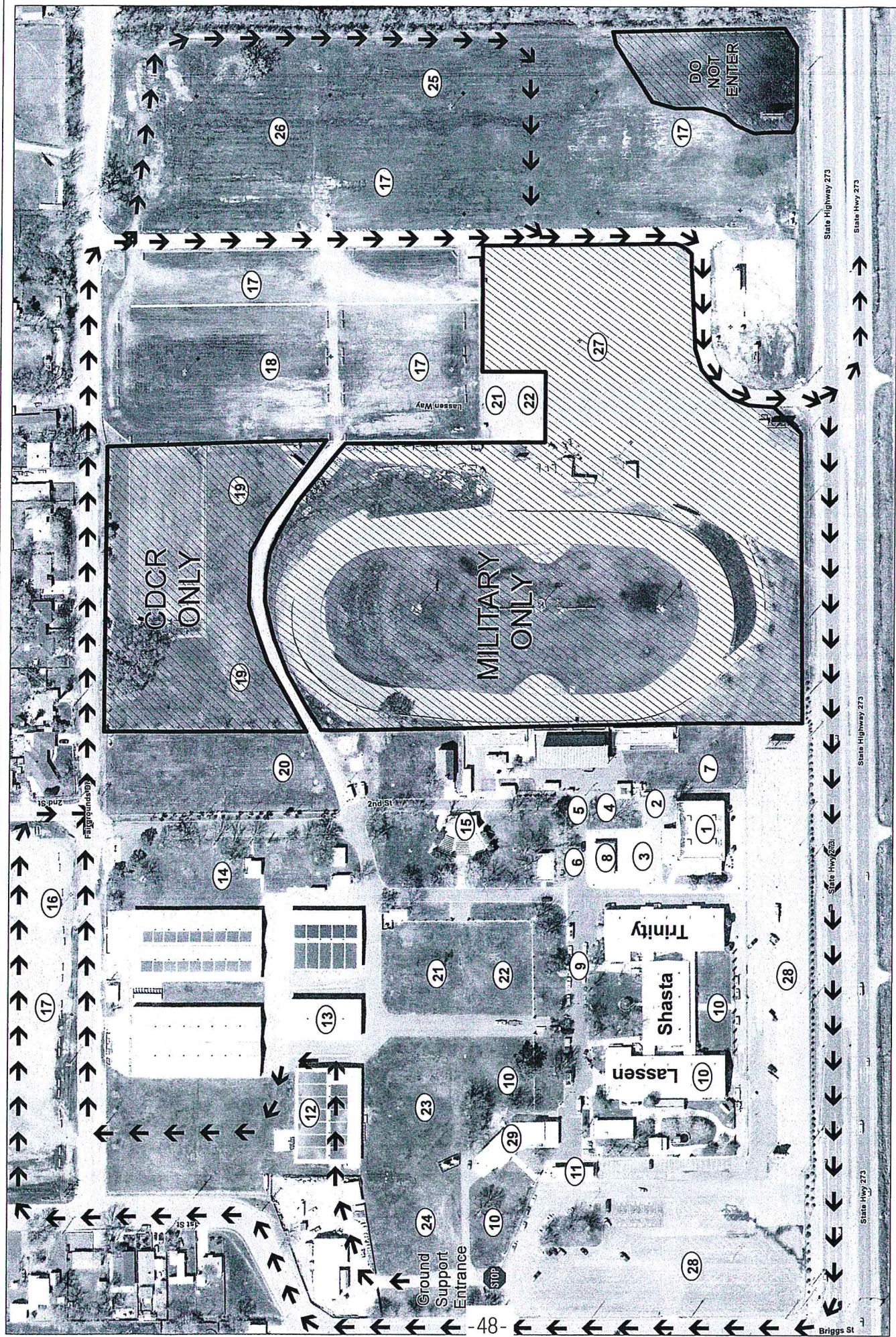

# Facilities Map

## CARR INCIDENT

### CA-SHU-7808

\*Laundry/Showers Available to All.

- 1. Check-In/Finance
- 2. Logistics-Facilities
- 3. Communications
- 4. Safety/OPS
- 5. Liason
- 6. IC
- 7. GIS
- 8. Accomadations
- 9. OES
- 10. Crew Sleeping
- 11. PIO
- 12. Ground Support
- 13. Supply
- 14. Kitchen
- 15. Briefing
- 16. Lunches/Water/Ice
- 17. Engine Parking
- 18. CDCR Parking
- 19. CDCR
- 20. MERT
- 21. Laundry
- 22. Showers
- 23. Mobile Sleepers
- 24. CCC Sleeping
- 25. Fuel
- 26. Transport Parking
- 27. CNG
- 28. Overhead Parking
- 29. Rehab Lounge



TEHEMA FAIR GROUNDS -

LARGE ANIMAL  
EVACUATIONS

NATIONAL GUARD:  
ENTER TRINITY AVE

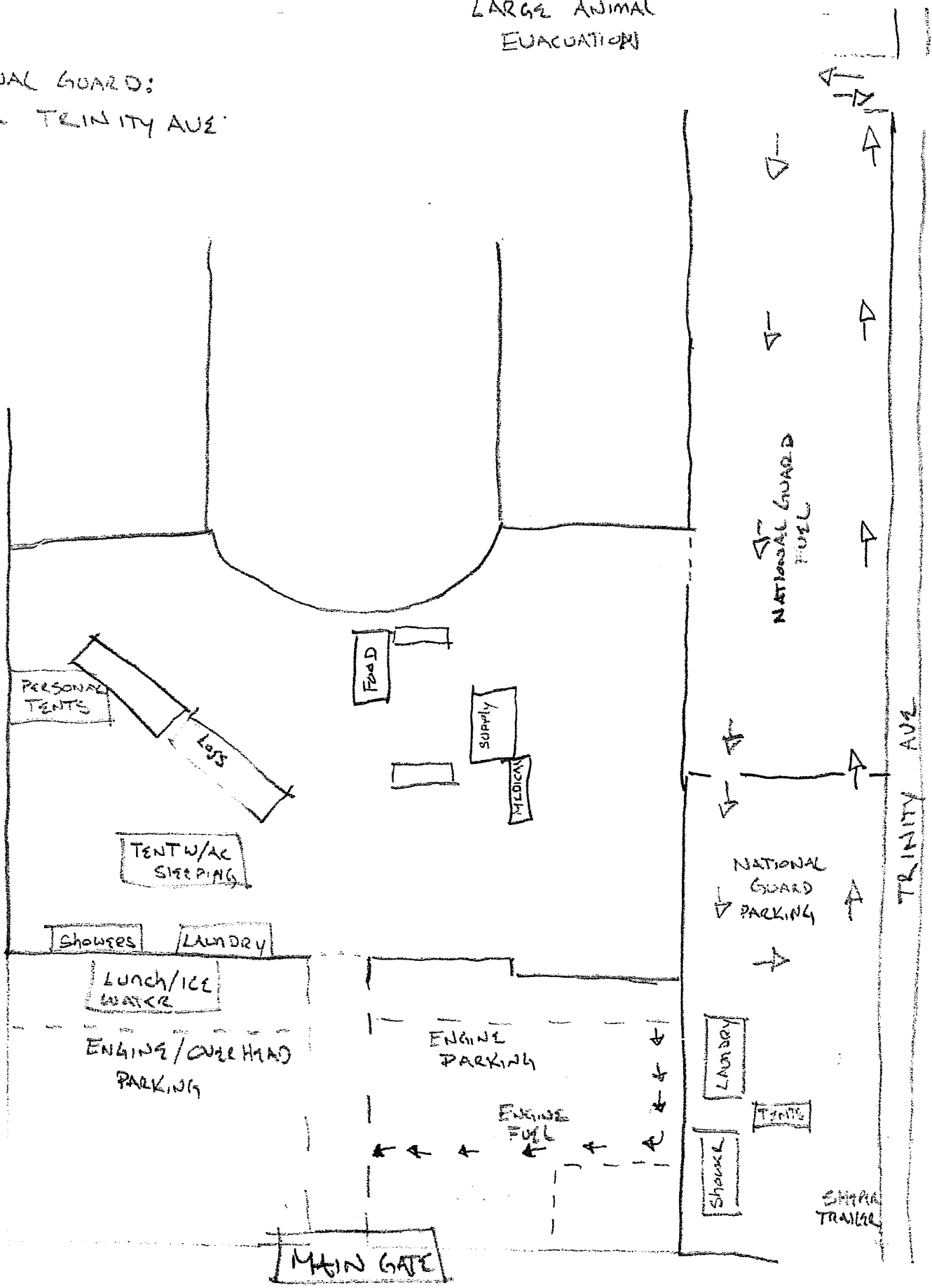

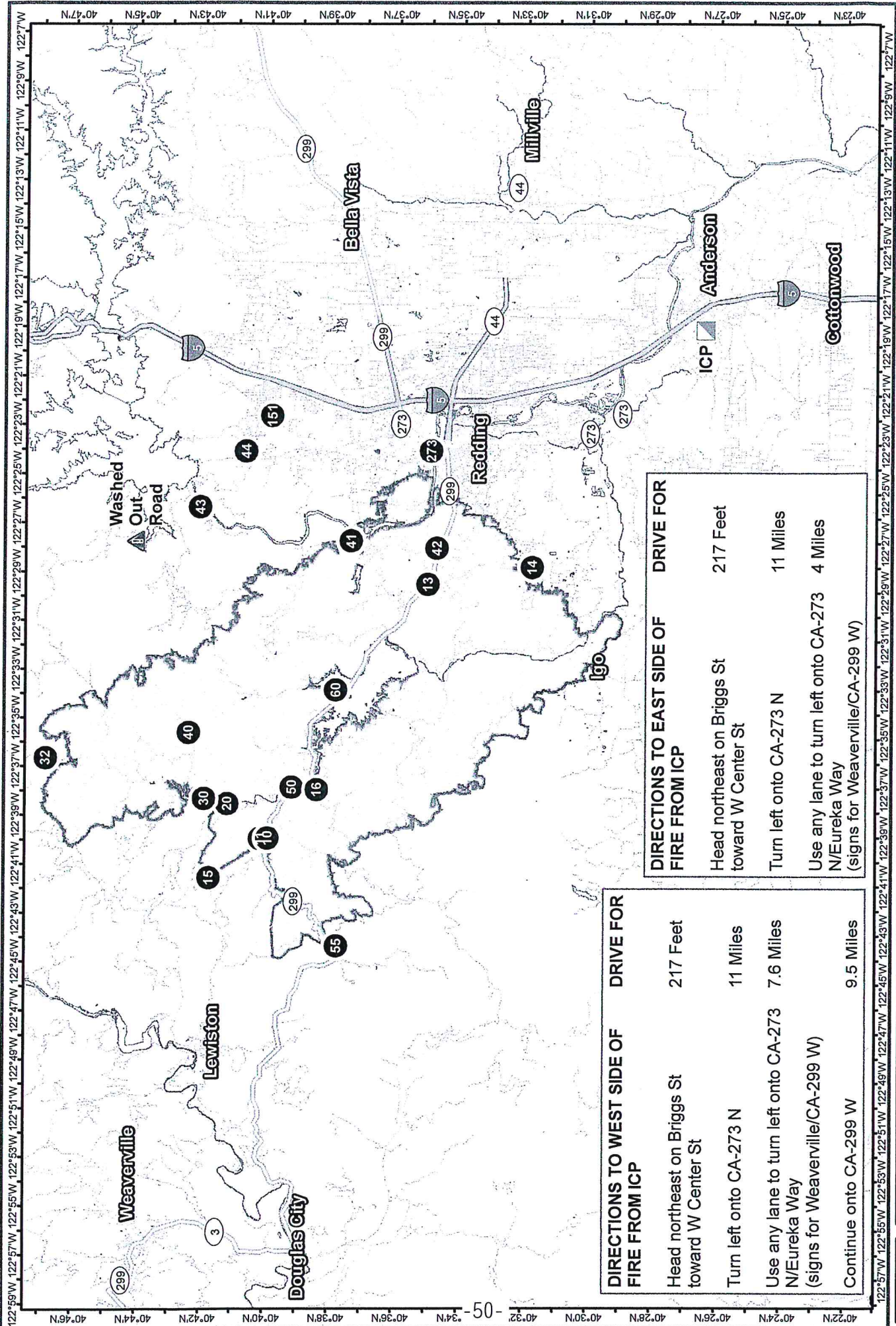

**DIRECTIONS TO WEST SIDE OF FIRE FROM ICP**

Head northeast on Briggs St toward W Center St

Turn left onto CA-273 N

Use any lane to turn left onto CA-273 N/Eureka Way (signs for Weaverville/CA-299 W)

Continue onto CA-299 W

**DRIVE FOR**

217 Feet

11 Miles

7.6 Miles

9.5 Miles

**DIRECTIONS TO EAST SIDE OF FIRE FROM ICP**

Head northeast on Briggs St toward W Center St

Turn left onto CA-273 N

Use any lane to turn left onto CA-273 N/Eureka Way (signs for Weaverville/CA-299 W)

**DRIVE FOR**

217 Feet

11 Miles

4 Miles



- Camp
- ◻ Incident Command Post
- Drop Point

Wildfire Daily Fire Perimeter

**Transportation Map**  
**Carr Fire**  
 CA-SHU-007808





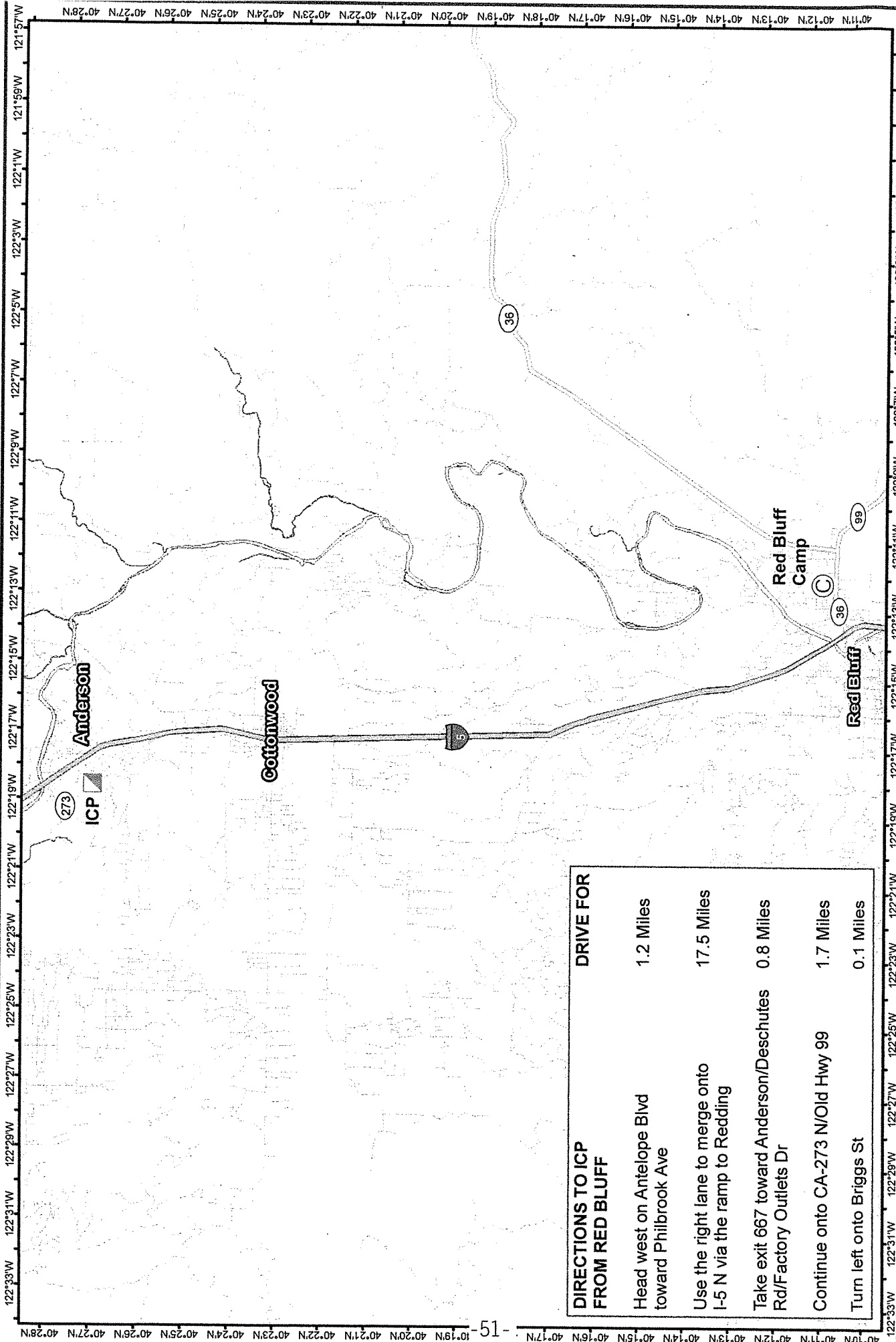

Carr Fire  
 CA-SHU-007808  
 TRANSPORTATION MAP  
 Jul 30, 2018



DIRECTIONS TO ICP FROM RED BLUFF	DRIVE FOR
Head west on Antelope Blvd toward Philbrook Ave	1.2 Miles
Use the right lane to merge onto I-5 N via the ramp to Redding	17.5 Miles
Take exit 667 toward Anderson/Descutes Rd/Factory Outlets Dr	0.8 Miles
Continue onto CA-273 N/Old Hwy 99	1.7 Miles
Turn left onto Briggs St	0.1 Miles

**Transportation Map**  
**Red Bluff Camp to ICP**  
**Carr Fire**  
 CA-SHU-007808



 Camp  
 Incident Command Post  
 Drop Point



NAD83 1:200,000





0 1 2 Miles

**THIS PAGE  
INTENTIONALLY  
LEFT BLANK**



