

*** CORRECTED ***

INCIDENT ACTION PLAN

NORTH COMPLEX WEST ZONE

CA-BTU-010751

Monday



9/14/2020 0700

to

9/15/2020 0700



Briefing Frequency - CDF - Tac 29

INCIDENT OBJECTIVES (ICS 202)

1. Incident Name: NORTH COMPLEX WEST ZONE	2. Operational Period:	Date From: 9/14/2020	Date To: 9/15/2020
		Time From: 0700	Time To: 0700

3. Objective(s):

Management Objectives

- Provide for and maintain public and first responder safety by utilizing the incident safety analysis process.
- Ensure COVID-19 precautions and best practices are met at all times.
- Protect the commercial timberland, historical and cultural assets within the affected area, infrastructure, improvements, and watersheds.
- All management actions and efforts will be focused on serving, safeguarding, and protecting the citizens of Butte and Plumas Counties.
- Ensure coordinated, timely and accurate release of public information.
- Be financially responsible for all management and fire suppression tactics.

Control Objectives

- Keep the fire North of Lamb Hill.
- Keep the fire East of Table Mtn.
- Keep the fire South of Gold Flat.
- Keep the fire West of Big Peak.

General Situational Awareness:

Steep and rugged terrain, critically dry and receptive fuel beds, active area for fire history and drought stressed trees.

In the COVID-19 environment, high density populations or large groups are particularly at risk. To help protect yourself, your family and to ensure all employees return home safely, make sure to practice social distancing.

Enhanced hygiene (especially handwashing), PPE & monitoring practices help limit the infection rate of first responders.

5. Site Safety Plan Required? Yes No

Approved Site Safety Plan(s) Located at:

6. Incident Action Plan

- | | | | |
|---|--|---|---|
| <input checked="" type="checkbox"/> ICS 203 | <input checked="" type="checkbox"/> ICS 215A | <input type="checkbox"/> ICS 205 A | <input type="checkbox"/> |
| <input checked="" type="checkbox"/> ICS 204 | <input checked="" type="checkbox"/> ICS 220 | <input type="checkbox"/> Training Message | <input type="checkbox"/> |
| <input checked="" type="checkbox"/> ICS 205 | <input type="checkbox"/> Facility Maps | <input checked="" type="checkbox"/> Travel Map | <input type="checkbox"/> |
| <input checked="" type="checkbox"/> ICS 206 | <input checked="" type="checkbox"/> Weather Forecast | <input checked="" type="checkbox"/> Demob Plan | <input checked="" type="checkbox"/> County Health Message |
| <input checked="" type="checkbox"/> ICS 208 | <input checked="" type="checkbox"/> Fire Behavior | <input checked="" type="checkbox"/> Finance Message | <input checked="" type="checkbox"/> ICS 214 |

7. Prepared By: David Shy	Position/Title: PSC	Signature:
8. Approved by Incident Commander: ICS 202	Darry Laws	Signature:

ORGANIZATION ASSIGNMENT LIST (ICS 203)

1. Incident Name: NORTH COMPLEX WEST ZONE		2. Operational Period: Date From: 9/14/2020 Date To: 9/15/2020	
		Time From: 0700 Time To: 0700	
3. Incident Commander(s) and Command Staff:		7. Operation Section:	
IC/UC's	Dave Russell, Jay Kurth, Matt Keeling, Aaron Wright	Operations	Shane Lauderdale
Deputy	Darryl Laws (T), Charlie Blankenheim (T)	Deputy Operations	Ron Bravo, Jim Hudson (T)
Safety Officer	Doug Ferro, Brent Stangland, Jack Piccinini	Night Ops	Monty Smith
Information Officer	Steve Kaufmann, Chris Harvey	Staging Area	
Liaison Officer	Dave Pender, Ron Karlen (T)	Branch	XX Barry Biermann <i>(JEREMY SALIZZI ONI (T))</i>
LELO	Josh Allen, Tom Campbell	Division/Group	C Michael Schmidt
4. Agency/Organization Representatives:		Division/Group	D Paul Lohan
Agency/Organization	Name	Division/Group	F Abby Bolt, Ryan Riddle (T)
CAL OES	Corey Zander	Division/Group	I Brian Desmet (9250C)
Butte Co Sheriff	Korey Honea	Division/Group	
Butte Co OES	Cindy Dunsmoor	Branch	XXIII Bill Lopez, Robert Szczepanek (T)
California State Parks	Aaron Wright	Division/Group	M Jake Burgess
BLM	Jeremy Strait	Division/Group	R Jack Thomas, Derek Schepens (12)
CCC	Kelly Plagman	Division/Group	
CDCR	Ben Ingwerson	Division/Group	
DWR	Gina House	Division/Group	
PG&E	David Hawks	Division/Group	
CALtrans	Eric Cummings	Branch	XXV Sean Norman
Butte Co Health Dept	Monica Sodersrom	Division/Group	T Jason Finney
		Division/Group	
		Division/Group	
		Division/Group	
		Division/Group	
		Division/Group	
5. Planning Section:		Branch	NORTH CONTINGENCY Gus Boston (12)
Chief	Chris Burch	Division/Group	NORTH 1 Brandon Brady(12), Patrick Bye(12)
Deputy	David Shy	Division/Group	
Resource Unit	Gwyndolyn Ozard, Nochella Funes (T), Travis Rye (T)	Branch	SOUTH CONTINGENCY John Fredrick(12), Steve Robinson(12)
Situation Unit	Denny O'Neil, John Gaddie (T), Tim Collins (T), Dave Derby (T)	Division/Group	
Documentation Unit	Allison Liang	Division/Group	
Demobilization Unit	Chris Lynch, Tim Fox (T)	Staging Area	CHICO STAGING Kelly Upson
GISS	Daniel Dresselhaus	Division/Group	
FBAN	Jonathan Pangburn	Division/Group	
IMET	Dan Borsum	Division/Group	
Training Tech Spec	Dennis Martin	Air Operations Branch	
Air Resource Adviser		Air Support Group Supervisor	
Hired Equip Tech Spec	Jason Emery	Air Tactical Group Supervisor	
6. Logistics Section		Helibase Manager Ray Gomez	
Chief	Matt Reich		
Deputy	Mathew Brandt		
Supply Unit	Shawn Burris		
Facilities Unit	Travis Heard, Jason Wilson (T)		
Ground Support Unit	Conor Stapleton		
Communications Unit	Mike Heyfron		
Medical Unit	Steve McGary, Leif Jullussen (T)		
Motel Specialist	Dawn Muschetto		
		8. Finance/Administration Section:	
		Chief	Mara Zaver
		Deputy	Rob Jenkins
		Time Unit	Greg Tunzi
		Procurement Unit	Courtney Arebalo
		Comp/Claims Unit	Sean Bowe
		Cost Unit	Angela Davidson
Prepared By: Name:	David Shy	Position/Title:	PSC Signature: <i>[Signature]</i>
ICS 203		Date/Time:	9/13/2020 2300 hours

Fire and COVID-19 Briefing Checklist

Self-Awareness / Screening

- Immediately separate yourself from others.
- Notify supervisor if you or others experience:
 - Cough, more than expected
 - Shortness of breath or difficulty breathing
 - New loss of taste or smell
 - Fever
 - Chills
 - Sore throat
 - Muscle pain
- Review and follow crew and division plans to isolate, triage, and transport symptomatic personnel.

Hygiene on the Fireline

- Properly wash or sanitize your hands often, especially before and after eating or entering a public place, and after coughing or sneezing.
- Avoid handshakes and communal use items.
- Maintain a supply of hand sanitizer and hand wipes. Inform supervisor of needed resupply.
- Disinfect high touch surfaces often:
 - Radios, phones, doors, pumps, fuel cans, etc.

Social Distancing and Protective Equipment

- Initiate, practice, and remind others of social distancing.
- Conduct briefings and conversations outdoors and at least 6 feet apart.
- Utilize face coverings as a tool when practical.
- Clean or replace dirty face coverings, equipment, and PPE.

Communications

- Face coverings and social distancing complicate communications. Ensure effective sender/receiver messaging.

Protect yourself, your crew, and your camp!

Find more information: <https://www.nwccg.gov/coronavirus>.

FIRE BEHAVIOR FORECAST

FORECAST NUMBER: 5	TYPE OF FIRE: Wildland Fire
FIRE NAME: North Complex West Zone	OPERATIONAL PERIOD: 24hr 9/14 (0700-0700)
DATE ISSUED: 9/13/2020	TIME ISSUED: 1900
UNIT: BTU	SIGNED: Jonathan Pangburn, FBAN <i>J.P.</i>

INPUTS

WEATHER SUMMARY

****RED FLAG WARNING****
See Weather Forecast in IAP.

OUTPUTS

GENERAL:

SW winds, low RH, poor recoveries, and warm temps. Clear air likely to produce plume development, and ember cast to both north and south. Fuel moisture levels remain critical for both live and dead fuels. Increased burn conditions into Wednesday. Burning will continue overnight with low RH.

NOPS has issued a fuels and fire behavior advisory for elevated ERCs & dry fuels. 1,000-hr/100-hr dead fuels, BI, & ERC above 97th percentile. Severe Drought conditions.

In the absence of weather conditions outside the forecast or extreme fire behavior conditions expect:

	Max. Flame Length	Max. Rate of Spread	Spotting	Probability of Ignition
Grass	6' (1.8 m)	50 ch/hr (1.0 km/hr)	< 1/2 mile (.7 km)	90%
Grass/Shrub Mix	8' (2.4 m)	30 ch/hr (0.6 km/hr)	< 1/2 mile (.7 km)	90%
Shrub	18' (5.4 m)	75 ch/hr (1.5 km/hr)	< 1/2 mile (.7 km)	90%
Timber Understory	11' (3.3 m)	15 ch/hr (0.3 km/hr)	< 1/2 mile (.7 km)	90%
Timber Litter	5' (1.5 m)	10 ch/hr (0.2 km/hr)	< 1/2 mile (.7 km)	90%

****minimum safety zone size for brush is 3/4-acre (0.3 Ha) for a Strike Team of Engines.**

****minimum safety zone size for timber understory is 1/2-acre (0.2 Ha) for a Strike Team of Engines.**

SPECIFIC:

DIV C / D: Torching likely with any ladder fuels, with potential for crown fire runs. No recent fire history around Clipper Mills and Strawberry Valley. High spotting potential from Sugar Pine Point to Jackass Flat. Lost Creek & Sly Creek Reservoirs may produce crown fire and strong ember cast.

DIV F: Forbestown & Ponderosa Reservoir have heavier fuels, with torching likely. Crown runs in areas of understory. Forbestown Ravine aligned for updrainage run.

DIV I / M: Stringtown area still has spotting potential. Fine fuels in understory will respond to clear air. Limited fire behavior expected unless a slop or spot establishes.

DIV R: Wind favorable to push fire into itself, but fire weakened trees and downed material may lead to ember cast into fine fuels. Bloomer Hill area may try to carry fire to Cherokee, Spring Valley Gulch. Established spots or slops could spread quickly in fine dead fuels.

DIV T: Watch for any fire west of Chino Ridge/Hungary Hunt Peak can find extensive jackpots of fuel around previous logging landings, with a good grass crop to carry fire. Strong wind channeling expected in the Feather River drainage and surrounding areas. Ridgelines will see strong wind gusts. China Gulch will channel any fire spread. Yankee Hill, Jarbo Gap, & Bardees Bar areas have fine fuels conducive to spotting.

AIR OPERATIONS:

Mostly clear.

Mixing height: 10,000 ft. AGL. Transport winds: SW 20 mph. Sunrise 0646, Sunset 1914.

SAFETY

Fires tend to give you warning that they are about to get up and move! Watch for these thresholds:

Temperatures at 90+ degrees, humidity below 20%, and winds more than 20 m.p.h.

HEED these thresholds and COMMUNICATE them to those around you.

Fuels and Fire Behavior Advisory

Northern California Geographic Area

September 7, 2020

Subject: Extended high temperatures continues to rapidly dry out an above normal live fuel load and dead fuels across Northern California. Extreme fire behavior and rapid to dangerous rates of spread has occurred during enhanced breezy periods accompanied with low humidity in areas clear of smoke. Extreme fire behavior will become more common as the fuel drying continues in September.

Discussion: Weeks of record temperatures in August and early September coupled with limited precipitation has been expanding extreme to severe drought conditions across much of the Geographic Area. All indications show these drought conditions persisting through September. The thunderstorm event of August 16-17 produced much lightning with limited rainfall that only lowered fire danger for a very brief period. Fires have recently shown or exhibited rapid or dangerous spread rates or generate extreme fire behavior once the any cap of smoke lifts out. There is a high potential for extreme fire behavior to persist under a wider range of conditions as fuel continues to dry and gusty north to northeast foehn winds events become more frequent.

Difference from normal conditions: Winter precipitation was below to well below normal with 55% of normal mountain snowpack. Late spring moisture during the heart of the low-mid elevation growing season led to **above normal fine fuel loading**. Typical dry summer conditions coupled with above normal temperatures has dramatically effected fuel dryness and fire danger indices. ERC's will generally range between 90th to 97th percentile the next 2 weeks with some PSA's experiencing seasonal record values. This time of year, live brush has typically low moisture levels due to normal seasonal drying but recently sampled live brush are at the at historic lows for many sampling sites.

Fuels – Low Elevation Grass Crop

Sierra Foothills Rangeland Forage Production Data

- 40 years of consistent data
- 2019-20 growing season 4th highest total
- 5 seasons of above normal in a row

Top 5 Growing Seasons	Pounds/Acres
2017-18	5514
1992-93	4696
1982-83	4630
2019-20	4420
2004-05	4410

For more information about the very unseasonable environmental conditions occurring, follow these links:
https://qacc.nifc.gov/oncc/fuelsFireDanger_Bi.php
https://qacc.nifc.gov/oncc/fuelsFireDanger_Erc.php
https://qacc.nifc.gov/oncc/fuelsFireDanger_Hundred.php
<https://veqdri.unl.edu/Home/StateVegDRI.aspx?CA>
https://qacc.nifc.gov/oncc/fuelsFireDanger_Thousand.php
<https://www.esrl.noaa.gov/psd/eddi/>

Concerns to Firefighters and the Public:

- Cured fine fuel loading below 3,000' elevation is above normal, exhibiting very rapid fire spread.
- Firefighters should be prepared for potential extreme fire behavior and dangerous or otherwise rapid rates of spread at any time of day, especially during foehn wind events.
- The potential for extreme fire activity will be likely to continue until enough precipitation occurs to significantly increase fuel moisture.
- Rapid rates of spread could have a significant impact on public safety and make evacuations difficult.

Mitigation Measures:

- All local and visiting firefighters need to remain aware of current and expected weather and burning conditions and consider such information while making strategic and tactical decisions.
- Employ LCES principles (Lookouts, Communications, Escape Routes, Safety Zones).
- Review current fire potential products from Predictive Services at <https://qacc.nifc.gov/oncc/predictive/weather/index.htm> or potential Red Flag conditions from the National Weather Service and weather at <https://www.wrh.noaa.gov/fire2/cafw/>.

Area of Concern: All areas across Northern California could see very active fire behavior. The PSA numbers associated with those areas are NC01, NC02, NC03A, NC03B, NC04, NC05, NC06, NC07 and NC08.

ASSIGNMENT LIST (ICS 204 WF)

CONTROLLED UNCLASSIFIED
INFORMATION/BASIC

1. Incident Name: NORTH COMPLEX WEST ZONE	2. Operational Period: Date From: 09/14/20 Date To: 09/15/20 Time From: 0700 Time To: 0700	3. Branch Division XX C Page 1 of 2 Charlie
--	---	---

4. Operations Personnel: Operations Section Chief: Shane Lauderdale Branch Director: Barry Biermann / JEREMY SALIZZONI (T) Division/Group Supervisor: Michael Schmidt		Night Ops: Monty Smith Branch Safety: Air Attack:
---	--	--

5. Resources Assigned:		** Resources Below in Bold are 12 Hour **					
Resource Identifier	ALS	LWD	Leader	Personnel	Request #	Hours	Reporting Location
STC BDU 9351C			PIDGEON, JOE	16	E-50456	0700-0700	DP22
STC OES 1870C			FAVROS, CHRISTOPHER	18 +/-	E-50008	0700-0700	DP22
STC+						0700-0700	DP22
STG TGU 9257G			ZUCKERMAN, ANDY			0700-0700	DP22
STG AEU 9273G			CHOLICO, ALEJANDRO	33 +/-	C-50046	0700-0700	DP22
STG TUU 9413G			JOHNSON, SAM	33	C-50047	0700-0700	DP22
STG MMU 9424G			COMSTOCK, RICHARD	33	C-50039	0700-0700	DP22
STH LMU 9225H			MADSON, JOE	33	C-50051	0700-0700	DP22
DOZ LNU 1449			BUNDY, BILL	2	E-50172	0700-0700	DP22
DOZ BTU 2142					E-50492	0700-0700	DP22
DOZ NEU 2342					E-30	0700-0700	DP22
DOZ NEU 2346					E-32	0700-0700	DP22
DOZ PVT E-27- STENT			STENT, BOB	2	E-27	0700-0700	DP22
DOZ PVT E-50119 - CLAYTON J			ROPER, GARRETT	2	E-50119	0700-0700	DP22
DOZ PVT E-50121 - RESTAD			RESTAD, BRUCE	1	E-50121	0700-1900	DP22
DOZ PVT E-50122 - JENNIFER			CRONAN, JOHN	3	E-50122	0700-0700	DP22
DOZ PVT E-50123 - TOMS EARTH			FUNES, TOM	2	E-50123	0700-0700	DP22
W/T1 BTC 25			CHURCHILL, B	1		0700-1900	DP22

6. Work Assignments:
 Construct direct line from E Line to Fields Ridge.
 Evaluate the south side of the South Fork of the Feather River for secondary line construction options.
 Perform tactical patrol around structures for the potential of new starts.
 Mop up 200' around structures to prevent structure damage, and alleviate citizen concerns.
 Assess structures for hazardous conditions and provide locations as appropriate.

7. Special Instructions:
*****FOR BUTTE CMD, SEE 205 FOR PROPER TONE-BASED ON LOCATION*****

8. Communications

Name	Ch	Function	Rx Freq	Rx Tone	Tx Freq	Tx Tone	Notes
BUTTE CMD	1	COMMAND	154.4150	123.0 (T2)	159.0000	123.0 (T2)	BUTTE COMMAND
CDF T5	5	TACTICAL	151.2500	192.8 (T16)	151.2500	192.8 (T16)	BRANCH XX
CDF T18	14	AIR TO GROUND	159.3450	192.8 (T16)	159.3450	192.8 (T16)	***AIR TO GROUND TAC***
167.9500	13	A/G COMMAND	167.9500		167.9500		***AIR TO GROUND COMMAND***
CALCORD	15	MEDICAL	156.0750	156.7 (T6)	156.0750	156.7 (T6)	MEDICAL COORDINATION
AIRGUARD	16	AIRGUARD	168.6250		168.6250	110.9 (T1)	EMERGENCY USE ONLY

9. Prepared by: Name: Gwyndolyn Ozard	RESL	Signature:
ICS 204	Date/Time: 9/13/2020 2200	Personnel Count: 179

ASSIGNMENT LIST (ICS 204 WF)

CONTROLLED UNCLASSIFIED
INFORMATION/BASIC

1. Incident Name: NORTH COMPLEX WEST ZONE	2. Operational Period: Date From: 09/14/20 Date To: 09/15/20 Time From: 0700 Time To: 0700	3. Branch Division XX C
--	---	--

4. Operations Personnel: Operations Section Chief: Shane Lauderdale Branch Director: Barry Biermann / JEREMY SALIZZONI Division/Group Supervisor: Michael Schmidt		Night Ops: Monty Smith Branch Safety: Air Attack:
---	--	--

5. Resources Assigned:		** Resources Below in Bold are 12 Hour **					
Resource Identifier	ALS	LWD	Leader	Personnel	Request #	Hours	Reporting Location
W/T PVT E-50048 - FIRELINE			MCMILLIAN, AUSTIN	2	E-50048	0700-0700	DP22
W/T PVT E-50049 - BENDALLS			WALTON, MARK	1	E-50049	0700-1900	DP22
W/T PVT E-50050 - RDL EQUIP			LEVERTON, RYAN	1	E-50050	0700-1900	DP22
W/T PVT E-50053 - RUBINI			RUBINI, NATHAN	2	E-50053	0700-0700	DP22
W/T PVT E-50054 - BLACK CAT			CLAWSON, SCOTT	1	E-50054	0700-1900	DP22
FALM PVT O-35 - MORGAN TREE			MATNEY, THOMAS		O-50233	0700-1900	DP22
HEQB+						0700-0700	DP22
FEMT BABCOCK			BABCOCK, KEN	1	O-50103	0700-0700	DP22
FEMP MARTIN			MARTIN, JASON	1	O-50181	0700-0700	DP22
SOFR RALLS			RALLS, JASON M	1	O-50392	0700-0700	DP22
SOFR GOMES			GOMES, ANTHONY E	1	O-50437	0700-0700	DP22
DOZ PVT E-50128 PAGE					WT PVT DARRAH (12) E40		
DOZ PVT E-50129 WURLITZER					WT PVT E-50041 FIRST		
DOZ PVT E-50132 NORTHWEST					WT PVT E-50292 PATANE		
DOZ PVT E-50133 COCKRELL							
WT PVT E-18 MARYMEE							
WT PVT E-24 COLEMAN							
WT PVT E 37 DARRAH (12)							

6. Work Assignments:
 Construct direct line from E Line to Fields Ridge.
 Evaluate the south side of the South Fork of the Feather River for secondary line construction options.
 Perform tactical patrol around structures for the potential of new starts.
 Mop up 200' around structures to prevent structure damage, and alleviate citizen concerns.
 Assess structures for hazardous conditions and provide locations as appropriate.

7. Special Instructions:
*****FOR BUTTE CMD, SEE 205 FOR PROPER TONE-BASED ON LOCATION*****

8. Communications							
Name	Ch	Function	Rx Freq	Rx Tone	Tx Freq	Tx Tone	Notes
BUTTE CMD	1	COMMAND	154.4150	123.0 (T2)	159.0000	123.0 (T2)	BUTTE COMMAND
CDF T5	5	TACTICAL	151.2500	192.8 (T16)	151.2500	192.8 (T16)	BRANCH XX
CDF T18	14	AIR TO GROUND	159.3450	192.8 (T16)	159.3450	192.8 (T16)	***AIR TO GROUND TAC***
167.9500	13	A/G COMMAND	167.9500		167.9500		***AIR TO GROUND COMMAND***
CALCORD	15	MEDICAL	156.0750	156.7 (T6)	156.0750	156.7 (T6)	MEDICAL COORDINATION
AIRGUARD	16	AIRGUARD	168.6250		168.6250	110.9 (T1)	EMERGENCY USE ONLY

9. Prepared by: Name: Gwyndolyn Ozard RESL
 Signature: *Gwyndolyn Ozard*
 ICS 204 Date/Time: 9/13/2020 2200 Personnel Count: 11

Division/Group Assignment List (ICS 204 WF)
Controlled Unclassified Information//Basic

1. Incident Name:		3.	
NORTH COMPLEX		Branch:	Division/Group:
2. Operational Period:		X	MM
Date/Time From: 09/14/2020 0600 MON	Date/Time To: 09/15/2020 0600 TUE		

4. Operations Personnel			
NORTH OPERATIONS CHIEF	KYLE JACOBSON	BRANCH DIRECTOR	PATRICK LAENG
DIVISION/GROUP SUPERVISOR	MARK MOTT	AIR ATTACK SUPERVISOR	

5. Resources Assigned this Period						
Strike Team / Task Force / Resource Designator	LWD	Leader	Number Persons	Drop Off PT./Time	Pick Up PT./Time	
CRW2 GRAYBACK 17019 C-157	09/16	NYGREN, TIMOTHY	20	QUINCY/0600	QUINCY/1800	
ENG6 MT ADAMS 622 E-565	10/01	RANDOLPH, ERIC	3	QUINCY/0600	QUINCY/1800	
DOZ2 LEPAGE TEHAMA ROCK E-112	09/19	NEWSOME, RANDY	3	QUINCY/0600	QUINCY/1800	
DOZ2 LONESTAR 7 E-329	09/26	SUITES, PAUL	2	QUINCY/0600	QUINCY/1800	
DOZ2 ALPINE FOREST E-506	09/14	BRIGGS, RUSSELL	2	QUINCY/0600	QUINCY/1800	
DOZ2 ALGERINE E-750	09/27	BARAJAS, CONNOR	3	QUINCY/0600	QUINCY/1800	
DOZ2 ROEN #1 E-786	09/27	RYAN, MIKE	2	QUINCY/0600	QUINCY/1800	
DOZ2 ROEN #2 E-787	09/27	ROEN, PAUL	2	QUINCY/0600	QUINCY/1800	
SKG2 PITMAN RESOURCES E-185	09/26	PITMAN, STEVE	2	QUINCY/0600	QUINCY/1800	
SKD2 WYEAST E-670	09/22	WINTER, DEREK	2	QUINCY/0600	QUINCY/1800	
MAST2 STATEWIDE 4 E-428	09/21	BRUINGTON, PAUL	2	QUINCY/0600	QUINCY/1800	
MAST2 LEPAGE E-430	09/19	BROWN, STEVE	2	QUINCY/0600	QUINCY/1800	
FEL2 STATEWIDE E-516	09/25	HAYDEN, CEDRIC	2	QUINCY/0600	QUINCY/1800	
FEL2 STATEWIDE E-517	09/27	STUTESMAN, MIKE	2	QUINCY/0600	QUINCY/1800	
HEQB O-431	09/20	BAKOS, TOBY	1	QUINCY/0600	QUINCY/1800	
HEQB (T) O-666	09/17	TOWNSEND, JACK	1	QUINCY/0600	QUINCY/1800	
HEQB (T) O-919	09/27	MILLER, MICHAEL	1	QUINCY/0600	QUINCY/1800	
FALM HIGH COUNTRY O-693	09/20	SWANTON, KELLY	2	QUINCY/0600	QUINCY/1800	
FALM BROTHERS O-697	09/28	SHIVELY, MICHAEL	2	QUINCY/0600	QUINCY/1800	

6. Division/Group Communication Summary						
Function	Channel	RX Frequency N/W	RX Tone/NAC	TX Frequency N/W	TX Tone/NAC	Mode
COMMAND	4 NIFC C3	170.4250	107.2	168.0750	107.2	A
COMMAND	5 NIFC C44	172.5375	107.2	168.5125	107.2	A
TACTICAL	9 CDF T5	151.2500	192.8	151.2500	192.8	A
AIR TO GROUND	13 A/G CMD	167.9500	NONE	167.9500	NONE	A
AIR TO GROUND	14 A/G TAC	168.4000	NONE	168.4000	NONE	A

9. Prepared By (Resource Unit Leader)	Approved By (Planning Section Chief)	Date	Time
MIKE VETTI	THOMAS MARCHANT	09/13/2020	2200

Division/Group Assignment List (ICS 204 WF)
 Controlled Unclassified Information//Basic

1. Incident Name: NORTH COMPLEX		3.	
2. Operational Period: Date/Time From: 09/14/2020 0600 MON Date/Time To: 09/15/2020 0600 TUE		Branch: X	Division/Group: MM

4. Operations Personnel			
NORTH OPERATIONS CHIEF	KYLE JACOBSON	BRANCH DIRECTOR	PATRICK LAENG
DIVISION/GROUP SUPERVISOR	MARK MOTT	AIR ATTACK SUPERVISOR	

5. Resources Assigned this Period						
Strike Team / Task Force / Resource Designator	LWD	Leader	Number Persons	Drop Off PT./Time	Pick Up PT./Time	
FOBS O-855	09/21	BRUCE, CORY	1	QUINCY/0600	QUINCY/1800	
FOBS (T) O-768	09/22	RATAJ, RICHARD	1	QUINCY/0600	QUINCY/1800	
REMS 2 PVT E-458	09/25	MACK, ADAM	4	QUINCY/0600	QUINCY/1800	

6. Control Operations/Work Assignments:
 Construct indirect fire-line West on Oak Ridge Road systems.
 Coordinate with West Zone DIV T on Tactical 154.2875 (VFIRE25).

7. Special Instructions:
 Back haul all trash, modules need to take all trash back to ICP.
 Drafting restrictions to prevent spread of deadly fungus to endangered frogs.
 Avoidance Flagging: North Complex will be red and black candy striped.
 **SOFR Dotson and SOFR (T) Shields assigned to DIV's AATT and MM & QQ
 REMS 2 assigned to DIV MM and available Branch-wide.
 Ambulance Medic 3 @ DP 86 and available Branch-wide.

8. Division/Group Communication Summary						
Function	Channel	RX Frequency N/W	RX Tone/NAC	TX Frequency N/W	TX Tone/NAC	Mode
COMMAND	4 NIFC C3	170.4250	107.2	168.0750	107.2	A
COMMAND	5 NIFC C44	172.5375	107.2	168.5125	107.2	A
TACTICAL	9 CDF T5	151.2500	192.8	151.2500	192.8	A
AIR TO GROUND	13 A/G CMD	167.9500	NONE	167.9500	NONE	A
AIR TO GROUND	14 A/G TAC	168.4000	NONE	168.4000	NONE	A

9. Prepared By (Resource Unit Leader) MIKE VETTI	Approved By (Planning Section Chief) THOMAS MARCHANT	Date 09/13/2020	Time 2200
---	---	--------------------	--------------

ASSIGNMENT LIST (ICS 204 WF)

CONTROLLED UNCLASSIFIED
INFORMATION//BASIC

1. Incident Name: NORTH COMPLEX WEST ZONE	2. Operational Period: Date From: 09/14/20 Date To: 09/15/20 Time From: 0700 Time To: 0700	3. Branch Division XX D
--	---	--

4. Operations Personnel:		Page 1 of 2 Delta
Operations Section Chief: Shane Lauderdale Branch Director: Barry Biermann <i>JEREMY SALIZZONI (GT)</i> Division/Group Supervisor: Paul Lohan	Night Ops: Monty Smith Branch Safety: Air Attack:	

5. Resources Assigned:		** Resources Below in Bold are 12 Hour **					
Resource Identifier	ALS	LWD	Leader	Personnel	Request #	Hours	Reporting Location
STC+						0700-0700	DP23
T/F SHU 1 (3,3,3,3,CRW)			GRANT, A	30	E-50412	0700-0700	DP23
STG FKU 9435G			CASTILLO, ROBERT	27	C-50034	0700-0700	DP23
STG+						0700-0700	DP23
STG+						0700-0700	DP23
CRW1 SUGAR PINE 2				10	C-2.2	0700-0700	DP23
CRW1 SUGAR PINE 63				14	C-2.3	0700-0700	DP23
CRW2IA TGU CREW 2			NEIL, CHRISTOPHER	13	C-50032	0700-0700	DP23
STL+						0700-0700	DP23
DOZ PVT E-19 - SCHREDER &			HALL, CORY	2	E-19	0700-0700	DP23
DOZ PVT E-25 - TWO BROTHERS					E-25	0700-0700	DP23
DOZ PVT E-34 - MILLER	<i>→ South</i>	<i>Cont</i>	MILLER, HAROLD	2	E-50211	0700-0700	DP23
DOZ PVT E-20076-PALMER	<i>→ RIV</i>	<i>R</i>	PALMER, JAMES	2	E-50385	0700-0700	DP23
DOZ PVT E-30004- LENA HANS	<i>→ DIV</i>	<i>R</i>	DUNLAP, JIM	2	E-50471	0700-0700	DP23
DOZ PVT E-50098 - TRG EQUIP	<i>→ DIV</i>	<i>C</i>	GREGORY, TOM	2	E-50098	0700-0700	DP23
DOZ PVT E-50117 - INGRAM	<i>→ DIV</i>	<i>R</i>	INGRAM, BRAD	2	E-50117	0700-0700	DP23
DOZ PVT E-50130 - PRODUMP			MCLOUGH, TODD	2	E-50130	0700-0700	DP23
DOZ PVT E-50131 - PRODUMP			NORTON, TRACY	2	E-50131	0700-0700	DP23

6. Work Assignments:
 Construct direct line from E Line to Fields Ridge.
 Evaluate the south side of the South Fork of the Feather River for secondary line construction options.
 Perform tactical patrol around structures for the potential of new starts.
 Mop up 200' around structures to prevent structure damage, and alleviate citizen concerns.
 Assess structures for hazardous conditions and provide locations as appropriate.

7. Special Instructions:
 FOR BUTTE CMD, SEE 205 FOR PROPER TONE-BASED ON LOCATION

8. Communications

Name	Ch	Function	Rx Freq	Rx Tone	Tx Freq	Tx Tone	Notes
BUTTE CMD	1	COMMAND	154.4150	123.0 (T2)	159.0000	123.0 (T2)	BUTTE COMMAND
CDF T26	8	TACTICAL	159.2925	192.8 (T16)	159.2925	192.8 (T16)	BRANCH XX
CDF T18	14	AIR TO GROUND	159.3450	192.8 (T16)	159.3450	192.8 (T16)	***AIR TO GROUND TAC***
167.9500	13	A/G COMMAND	167.9500		167.9500		***AIR TO GROUND COMMAND***
CALCORD	15	MEDICAL	156.0750	156.7 (T6)	156.0750	156.7 (T6)	MEDICAL COORDINATION
AIRGUARD	16	AIRGUARD	168.6250		168.6250	110.9 (T1)	EMERGENCY USE ONLY

9. Prepared by: Name:	Gwyndolyn Ozard	RESL	
Signature: <i>Gwyndolyn Ozard</i>			

ASSIGNMENT LIST (ICS 204 WF)

CONTROLLED UNCLASSIFIED
INFORMATION//BASIC

1. Incident Name: NORTH COMPLEX WEST ZONE	2. Operational Period: Date From: 09/14/20 Date To: 09/15/20 Time From: 0700 Time To: 0700	3. Branch Division XX D
--	---	--

4. Operations Personnel:		Page 2 of 2 Delta
Operations Section Chief: Shane Lauderdale	Night Ops: Monty Smith	
Branch Director: Barry Biermann <i>(JEREMY SALIZZONI (T))</i>	Branch Safety:	
Division/Group Supervisor: Paul Lohan	Air Attack:	

5. Resources Assigned:		** Resources Below in Bold are 12 Hour **					
Resource Identifier	ALS	LWD	Leader	Personnel	Request #	Hours	Reporting Location
DOZ+						0700-0700	DP23
DOZ+						0700-0700	DP23
DOZ+						0700-0700	DP23
DOZ+						0700-0700	DP23
DOZ+						0700-0700	DP23
DOZ+						0700-0700	DP23
DOZ+						0700-0700	DP23
DOZ+						0700-0700	DP23
W/T1 BTC 64			JACKSON, RAY	2	E-50218	0700-0700	DP23
W/T PVT E-1028 - DARRAH			CRETEN, BOB	2	E-50310	0700-1900	DP23
W/T1 PVT E-1030 - HANNA			GRANT, HANNA	2	E-50313	0700-1900	DP23
W/T1 PVT E-1097- TOUGH			KENT, SCOTT	1	E-50326	0700-1900	DP23
W/T PVT E-50290 - MATRIX				2	E-50290	0700-0700	DP23
W/T PVT E-50291 - MATRIX				2	E-50291	0700-0700	DP23
HEQB+						0700-0700	DP23
HEQB+						0700-0700	DP23
HEQB+						0700-0700	DP23

6. Work Assignments:
 Construct direct line from E Line to Fields Ridge.
 Evaluate the south side of the South Fork of the Feather River for secondary line construction options.
 Perform tactical patrol around structures for the potential of new starts.
 Mop up 200' around structures to prevent structure damage, and alleviate citizen concerns.
 Assess structures for hazardous conditions and provide locations as appropriate.

7. Special Instructions:
*****FOR BUTTE CMD, SEE 205 FOR PROPER TONE-BASED ON LOCATION*****

8. Communications							
Name	Ch	Function	Rx Freq	Rx Tone	Tx Freq	Tx Tone	Notes
BUTTE CMD	1	COMMAND	154.4150	123.0 (T2)	159.0000	123.0 (T2)	BUTTE COMMAND
CDF T26	8	TACTICAL	159.2925	192.8 (T16)	159.2925	192.8 (T16)	BRANCH XX
CDF T18	14	AIR TO GROUND	159.3450	192.8 (T16)	159.3450	192.8 (T16)	***AIR TO GROUND TAC***
167.9500	13	A/G COMMAND	167.9500		167.9500		***AIR TO GROUND COMMAND***
CALCORD	15	MEDICAL	156.0750	156.7 (T6)	156.0750	156.7 (T6)	MEDICAL COORDINATION
AIRGUARD	16	AIRGUARD	168.6250		168.6250	110.9 (T1)	EMERGENCY USE ONLY

9. Prepared by: Name: Gwyndolyn Ozard **RESL**
 Signature: *Gwyndolyn Ozard*
ICS 204 Date/Time: 9/13/2020 2200 Personnel Count: 7

ASSIGNMENT LIST (ICS 204 WF)

CONTROLLED UNCLASSIFIED
INFORMATION//BASIC

1. Incident Name: NORTH COMPLEX WEST ZONE	2. Operational Period: Date From: 09/14/20 Date To: 09/15/20 Time From: 0700 Time To: 0700	3. Branch Division XX F Page 1 of 2 Foxtrot
--	---	--

4. Operations Personnel: Operations Section Chief: Shane Lauderdale Branch Director: Barry Biermann / JEREMY SALIZZONI (6) Division/Group Supervisor: Abby Bolt, Ryan Riddle (T)		Night Ops: Monty Smith Branch Safety: Air Attack:
--	--	--

5. Resources Assigned:		** Resources Below in Bold are 12 Hour **					
Resource Identifier	ALS	LWD	Leader	Personnel	Request #	Hours	Reporting Location
STC XYO 4282C			KOMULA, ERIK	19	E-50007	0700-0700	STATION 54
STC+						0700-0700	STATION 54
STC+						0700-0700	STATION 54
STF XTU 5185F			RUSSELL, RAYMOND	17	E-50455	0700-0700	STATION 54
ENG3 GCF 305			GIESBRECHT, WES	4	E-50202	0700-0700	STATION 54
STG LMU 9223 G			BONNER, CHRIS	30	C-50008	0700-0700	STATION 54
CRW2 C-50019 - DUST BUSTERS			PACHECO, CINDY	20	C-50019	0700-1900	STATION 54
CRW2 C-50020 - DUST BUSTERS			MORSE, CASY	16 +/-	C-50020	0700-1900	STATION 54
DOZ PVT E-28 - PRECISION					E-28	0700-0700	STATION 54
DOZ PVT E-20062- BENNETT			ZEBALLA, JOHNATHAN	3	E-50378	0700-0700	STATION 54
W/T PVT E-34 - WILLMORE AG					E-34	0700-0700	STATION 54
W/T PVT E-38 - DARRAH			BROWNE, RODNEY	1	E-38	0700-0900	STATION 54
W/T PVT E-41 - T & S DVBE			DONALDSON, JUSTIN	2	E-41	0700-0700	STATION 54
W/T PVT E-42 - T & S DVBE			WALTJEN, TRAYSON	2	E-42	0700-0700	STATION 54
W/T PVT E-43 - TRAFFIC &			JONES, EARNIE	2	E-43	0700-0700	STATION 54
W/T PVT E-45 - WILLMORE AG					E-45	0700-0700	STATION 54
FALM PVT O-50067 - TREE WORX			BILICH, DANIEL	1	O-50067	0700-1900	STATION 54
HEQB+						0700-0700	STATION 54

oos -

6. Work Assignments:
 Fall hazard trees, and trees that threaten control lines, to mitigate the threat of fire escaping, while maintaining personnel safety.
 Hold fire within established control lines.
 Hold and improve control lines to mitigate threat of fire escaping.
 Mop up 100' interior to eliminate threat to the fire line.
 Backhaul excess trash/hose/water.
 Perform tactical patrol around structures for the potential of new starts.
 Mop up 100' around structures to prevent structure damage, and alleviate citizen concerns.
 Be aware of and assist with repopulation activities in the area.
 Identify and document suppression repair needs to facilitate timely completion of repairs.
 Assess structures for hazardous conditions and provide locations as appropriate.

7. Special Instructions:
 FOR BUTTE CMD, SEE 205 FOR PROPER TONE-BASED ON LOCATION

8. Communications							
Name	Ch	Function	Rx Freq	Rx Tone	Tx Freq	Tx Tone	Notes
BUTTE CMD	1	COMMAND	154.4150	123.0 (T2)	159.0000	123.0 (T2)	BUTTE COMMAND
CDF T24	6	TACTICAL	151.3325	192.8 (T16)	151.3325	192.8 (T16)	BRANCH XX
CDF T18	14	AIR TO GROUND	159.3450	192.8 (T16)	159.3450	192.8 (T16)	***AIR TO GROUND TAG***
167.9500	13	A/G COMMAND	167.9500		167.9500		***AIR TO GROUND COMMAND***
CALCORD	15	MEDICAL	156.0750	156.7 (T6)	156.0750	156.7 (T6)	MEDICAL COORDINATION
AIRGUARD	16	AIRGUARD	168.6250		168.6250	110.9 (T1)	EMERGENCY USE ONLY

9. Prepared by: Name: Gwyndolyn Ozard RESL
 Signature: 
 Date/Time: 9/13/2020 2200 Personnel Count: 117

ICS 204
NIMS IAP

ASSIGNMENT LIST (ICS 204 WF)

CONTROLLED UNCLASSIFIED
INFORMATION/BASIC

1. Incident Name: NORTH COMPLEX WEST ZONE	2. Operational Period: Date From: 09/14/20 Date To: 09/15/20 Time From: 0700 Time To: 0700	3. Branch Division XX I Page 1 of 1 India
--	---	--

4. Operations Personnel: Operations Section Chief: Shane Lauderdale Branch Director: Barry Biermann / JEREMY SALIZZONI (G) Division/Group Supervisor: Brian Desmet (9250C)		Night Ops: Monty Smith Branch Safety: Air Attack:
---	--	--

5. Resources Assigned:		** Resources Below in Bold are 12 Hour **					
Resource Identifier	ALS	LWD	Leader	Personnel	Request #	Hours	Reporting Location
STC TGU 9250C			DESMET, BRIAN	19	E-50377	0700-0700	DP28
STC XLS 3075C → DIV R			HITCHCOCK, STEVE	18 +/-	E-8	0700-0700	DP28
STG SHU 9246G → DIV R			CHENOWETH, DAN	25	C-50052	0700-0700	DP28
STH BTU 9270H → DIV R			ABELOE, MARK	30	C-50040	0700-1900	DP28
CRW2 C-50018 - DUST BUSTERS			JENSON, TIM	20	C-50018	0700-1900	DP28
CRW2 C-50021 - DUST BUSTERS			SPENCE, MIKE	20	C-50021	0700-1900	DP28
DOZ BTU 2140			GUTZMAN, ZACH	2	E-50493	0700-0700	DP28
DOZ2 PVT E-12 - INGRAM			ADAMS, NICK	2	E-12-TG3	0700-0700	DP28
W/T1 BTC 42			ANDERSON, TIM	2	E-50496	0700-1900	DP28
W/T1 PVT E-14 - LEPAGE			PONKE, FRANK	1	E-14-TG3	0700-1900	DP28
W/T PVT E-33 - KITE SOLUTIONS			GINTER, DERE	2	E-33	0700-0700	DP28
W/T PVT E-39 - RODGERS WATER			BUNDESAN, GERRY	1	E-39	0700-0900	DP28
W/T PVT E-50044 - ACKLEY			ACKLEY, RAY	1	E-50044	0700-0900	DP28
W/T PVT E-50047 - JOHNSON			LA MARE, DAVE	2	E-50047	0700-0700	DP28
FALM PVT O-50075 - LEPLY			MERRILL, RUSSELL	1	O-50075	0700-1900	DP28
HEQB+						0700-0700	DP28

6. Work Assignments:
 Fall hazard trees, and trees that threaten control lines, to mitigate the threat of fire escaping, while maintaining personnel safety.
 Hold fire within established control lines.
 Hold and improve control lines to mitigate threat of fire escaping.
 Mop up 100' interior to eliminate threat to the fire line.
 Perform tactical patrol around structures for the potential of new starts.
 Mop up 100' around structures to prevent structure damage, and alleviate citizen concerns.
 Assess structures for hazardous conditions and provide locations as appropriate.

7. Special Instructions:
*****FOR BUTTE CMD, SEE 205 FOR PROPER TONE-BASED ON LOCATION*****
 SOFR Fredrick assigned to Div F is available for Div I as well.

8. Communications

Name	Ch	Function	Rx Freq	Rx Tone	Tx Freq	Tx Tone	Notes
BUTTE CMD	1	COMMAND	154.4150	123.0 (T2)	159.0000	123.0 (T2)	BUTTE COMMAND
CDF T27	9	TACTICAL	159.3075	192.8 (T16)	159.3075	192.8 (T16)	BRANCH XX
CDF T18	14	AIR TO GROUND	159.3450	192.8 (T16)	159.3450	192.8 (T16)	***AIR TO GROUND TAC***
167.9500	13	A/G COMMAND	167.9500		167.9500		***AIR TO GROUND COMMAND***
CALCORD	15	MEDICAL	156.0750	156.7 (T6)	156.0750	156.7 (T6)	MEDICAL COORDINATION
AIRGUARD	16	AIRGUARD	168.6250		168.6250	110.9 (T1)	EMERGENCY USE ONLY

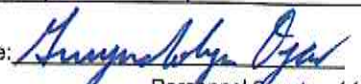
9. Prepared by: Name: Gwyndolyn Ozard RESL
 Signature: 
 ICS 204 Date/Time: 9/13/2020 2200 Personnel Count: 146

ASSIGNMENT LIST (ICS 204 WF)

CONTROLLED UNCLASSIFIED
INFORMATION//BASIC

1. Incident Name:		2. Operational Period:				3. Branch		Division	
NORTH COMPLEX WEST ZONE		Date From: 09/14/20	Date To: 09/15/20			XXIII		M	
		Time From: 0700	Time To: 0700			Page 1 of 1		Mike	
4. Operations Personnel:									
Operations Section Chief: Shane Lauderdale					Night Ops: Monty Smith				
Branch Director: Bill Lopez, Robert Szczepanek (T)					Branch Safety:				
Division/Group Supervisor: Jake Burgess					Air Attack:				
5. Resources Assigned:									
** Resources Below in Bold are 12 Hour **									
Resource Identifier	ALS	LWD	Leader	Personnel	Request #	Hours	Reporting Location		
STC+						0700-0700	DP30		
T/F XAL 2014 (6,3,3,3,3)			CARTER, MARK	21	E-50461	0700-0700	DP30		
ENG5 PVT 75			CONGER, JOHN	3	E-50195	0700-1900	DP30		
DOZ PVT E-50101 - GOLD			CLOWER, CONNOR	2	E-50101	0700-0700	DP30		
DOZ PVT E-50134- MPETERS			JAY, SANDOL	1	E-50134	0700-1900	DP30		
DOZ PVT E-50156- MPETERS			LENMOS, DARREL	1	E-50156	0700-1900	DP30		
W/T PVT E-28 - M & C			KIDWELL, JEREMY	1	E-50207	0700-1900	DP30		
W/T PVT E-30 - WEINRICH			WEINRICH, LUKE	1	E-50209	0700-1900	DP30		
W/T PVT E-35 - DOC'S WATER			VAINE, JOE	2	E-35	0700-0700	DP30		
W/T PVT E-36 - DOC'S WATER			WILSON, TIM	2	E-36	0700-1900	DP30		
W/T1 PVT E-43 - ACT FAST			PETER, RUSSELL	2	E-50215	0700-0700	DP30		
W/T PVT E-82 - HOLMES			NEWLAND, H	1	E-50429	0700-0700	DP30		
W/T2 PVT E-1026 - WELLS			WELLS, JEFF	2	E-50308	0700-1900	DP30		
W/T PVT E-1027 - DARRAH			KAUNDART, DAVE	2	E-50309	0700-1900	DP30		
FALM PVT O-50073 - KNIGHT			MCALLISTER, CAMBEN	1	O-50073	0700-1900	DP30		
FEMP STAHL			STAHL, MICHAEL		O-50095	0700-0700	DP30		
FEMT FLANAGAN			FLANAGAN, BRIAN		O-50105	0700-0700	DP30		
FALM O-50068 All in 1 ← Div R									
6. Work Assignments:									
Fall hazard trees, and trees that threaten control lines, to mitigate the threat of fire escaping, while maintaining personnel safety.									
Hold fire within established control lines.									
Mop up 200' interior to eliminate threat to the fire line.									
Assess structures for hazardous conditions and provide locations as appropriate.									
7. Special Instructions:									
FOR BUTTE CMD, SEE 205 FOR PROPER TONE-BASED ON LOCATION									
8. Communications									
Name	Ch	Function	Rx Freq	Rx Tone	Tx Freq	Tx Tone	Notes		
BUTTE CMD	1	COMMAND	154.4150	123.0 (T2)	159.0000	123.0 (T2)	BUTTE COMMAND		
CDF T32	5	TACTICAL	151.2425	192.8 (T16)	151.2425	192.8 (T16)	BRANCH XXIII		
CDF T18	14	AIR TO GROUND	159.3450	192.8 (T16)	159.3450	192.8 (T16)	***AIR TO GROUND TAC***		
167.9500	13	A/G COMMAND	167.9500		167.9500		***AIR TO GROUND COMMAND***		
CALCORD	15	MEDICAL	156.0750	156.7 (T6)	156.0750	156.7 (T6)	MEDICAL COORDINATION		
AIRGUARD	16	AIRGUARD	168.6250		168.6250	110.9 (T1)	EMERGENCY USE ONLY		
9. Prepared by: Name:									
Gwyndolyn Ozard				RESL					
				Signature:					
ICS 204		Date/Time: 9/13/2020 2200				Personnel Count: 42			

ASSIGNMENT LIST (ICS 204 WF)

CONTROLLED UNCLASSIFIED
INFORMATION//BASIC

1. Incident Name: NORTH COMPLEX WEST ZONE	2. Operational Period: Date From: 09/14/20 Date To: 09/15/20 Time From: 0700 Time To: 0700	3. Branch Division XXIII R
--	---	---

4. Operations Personnel:		Page 1 of 2 Romeo
Operations Section Chief: Shane Lauderdale Branch Director: Bill Lopez, Robert Szczepanek (T) Division/Group Supervisor: Jack Thomas, Derek Schepens (12)	Night Ops: Monty Smith Branch Safety: Air Attack:	

5. Resources Assigned:		** Resources Below in Bold are 12 Hour **					
Resource Identifier	ALS	LWD	Leader	Personnel	Request #	Hours	Reporting Location
STH SHU 9247H				34	C-50022	0700-0700	Cherokee Rd X Rocky Top
DOZ TGU 2540			RUSTE, JOE	1	E-29	0700-0700	Cherokee Rd X Rocky Top
DOZ PVT E-12- ACT FAST			EVANS, DOUG	2	E-50184	0700-1900	Cherokee Rd X Rocky Top
DOZ PVT E-22 - KDK GENERAL					E-22	0700-0700	Cherokee Rd X Rocky Top
DOZ PVT E-26 - ACT FAST			HOGSTUT, STEVE	2	E-26	0700-1900	Cherokee Rd X Rocky Top
DOZ PVT E-1102- PEARSON			PEARSON, ROBERT	2	E-50332	0700-0700	Cherokee Rd X Rocky Top
DOZ PVT E-50118 - MOORE			MOORE, SONNY	2	E-50118	0700-0700	Cherokee Rd X Rocky Top
DOZ+						0700-0700	Cherokee Rd X Rocky Top
W/T1 PVT E-15 - SHUMAS			SHULTS, JUSTIN	2	E-15-TG3	0700-0700	Cherokee Rd X Rocky Top
W/T PVT E-19 - BLACK KNIGHT			LEEMAN, ELLEN	2	E-50361	0700-0700	Cherokee Rd X Rocky Top
W/T PVT E-48 - DIAMOND ENT					E-48	0700-0700	Cherokee Rd X Rocky Top
W/T PVT E-50037 - DADCO				2	E-50037	0700-0700	Cherokee Rd X Rocky Top
W/T PVT E-50038 - FRANK			FUNES, ANTHONY	2	E-50038	0700-0700	Cherokee Rd X Rocky Top
W/T PVT E-50039 - ON SITE			EYERLY, JAMES	1	E-50039	0700-0900	Cherokee Rd X Rocky Top
W/T PVT E-50040 - WILLMORE			UTOOEN, BILLY	1	E-50040	0700-0700	Cherokee Rd X Rocky Top
W/T PVT E-50042 - PJ AND R			WOKOYANA, PAUL	1	E-50042	0700-1900	Cherokee Rd X Rocky Top
FALM PVT O-50068 - ALL IN 1 → DIV M			GILL, TRAVIS	1	O-50068	0700-1900	Cherokee Rd X Rocky Top
FALM PVT O-50072 - BUNDYS			BUNDY, NICK	1	O-50072	0700-1900	Cherokee Rd X Rocky Top

6. Work Assignments:
Construct contingency line from Condor Road to Oregon City Trail.
Assess structures for hazardous conditions and provide locations as appropriate.

4233C ← UNASSIGNED
3075C ← DIV I
9246G ← DIV I
9270H ← DIV I

7. Special Instructions:
*****FOR BUTTE CMD, SEE 205 FOR PROPER TONE-BASED ON LOCATION*****

8. Communications							
Name	Ch	Function	Rx Freq	Rx Tone	Tx Freq	Tx Tone	Notes
BUTTE CMD	1	COMMAND	154.4150	123.0 (T2)	159.0000	123.0 (T2)	BUTTE COMMAND
VFIRE 23	6	TACTICAL	154.2950	156.7 (T6)	154.2950	156.7 (T6)	BRANCH XXIII
CDF T18	14	AIR TO GROUND	159.3450	192.8 (T16)	159.3450	192.8 (T16)	***AIR TO GROUND TAC***
167.9500	13	A/G COMMAND	167.9500		167.9500		***AIR TO GROUND COMMAND***
CALCORD	15	MEDICAL	156.0750	156.7 (T6)	156.0750	156.7 (T6)	MEDICAL COORDINATION
AIRGUARD	16	AIRGUARD	168.6250		168.6250	110.9 (T1)	EMERGENCY USE ONLY

9. Prepared by: Name: Gwyndolyn Ozard RESL
Signature:
Date/Time: 9/13/2020 2200 Personnel Count: 56

ASSIGNMENT LIST (ICS 204 WF)

CONTROLLED UNCLASSIFIED
INFORMATION/BASIC

1. Incident Name:	2. Operational Period:	3. Branch	Division
NORTH COMPLEX WEST ZONE	Date From: 09/14/20 Date To: 09/15/20 Time From: 0700 Time To: 0700	XXV	T
4. Operations Personnel:		Page 1 of 3	Tango

Operations Section Chief: Shane Lauderdale Branch Director: Sean Norman Division/Group Supervisor: Jason Finney	Night Ops: Monty Smith Branch Safety: Air Attack:
--	--

5. Resources Assigned:		** Resources Below in Bold are 12 Hour **					
Resource Identifier	ALS	LWD	Leader	Personnel	Request #	Hours	Reporting Location
STC BTU 9210C			CONATY, MICHAEL	17	E-50445	0700-0700	DP36
STC XSB 1522C	X		GALLAGHER, MICHAEL	20	E-50457	0700-0700	DP36
T/F BTU 1 (3,3,3,3,3)			PEERY, JON			0700-0700	DP36
T/F UTAH 2 (6,6,6,6,6)			⇒ NORTH CONT CATHER, DAN	17	E-50022	0700-0700	DP36
STG SKU 9260G			PINDELL, SETH	33	C-50024	0700-0700	DP36
STG AEU 9275G			DRUMMOND, HOWARD	69	C-50049	0700-0700	DP36
STG TCU 9444G			BISHOP, JAMES	33	C-50037	0700-0700	DP36
STG TCU 9446G			BLAKEWAY, ERIK	29	C-50042	0700-0700	DP36
DOZ LMU 2242			⇒ NORTH CONT STEVENSON, NORM	2	E-31	0700-0700	DP36
DOZ SHU 2442			GERRY, JEREMIAH	2	E-50191	0700-0700	DP36
DOZ PVT E-20 - DUNLAP FARMS				2	E-20	0700-0700	DP36
O DOZ PVT E-21 - DUDLEY'S			⇒ NORTH CONT ERBES, GREG	2	E-50203	0700-0700	DP36
O DOZ PVT E-21 - DEUCES			⇒ NORTH CONT VANPELT, KYLE	2	E-21	0700-0700	DP36
C DOZ PVT E-22 - M & S			LINDAUER, MIKE	2	E-50205	0700-0700	DP36
O DOZ PVT E-24 - RIDGE LOGGING			⇒ NORTH CONT LANDINGHAM	1	E-24	0700-1900	DP36
DOZ PVT E-26 - DIAMOND RING			REEVES, STEVE	2	E-26	0700-0700	DP36
DOZ PVT E-40 - SUNRISE			⇒ NORTH CONT O'BRIAN, MIKE	2	E-50213	0700-0700	DP36
DOZ PVT E-1099- AAA			⇒ NORTH CONT HATLER, TIM	2	E-50327	0700-0700	DP36

6. Work Assignments:

Fall hazard trees, and trees that threaten control lines, to mitigate the threat of fire escaping, while maintaining personnel safety.
 Hold fire within established control lines.
 Hold and improve control lines to mitigate threat of fire escaping.
 Prepare lines for implementation of firing plan.
 Implement firing plan in division.
 Mop up 100' interior to eliminate threat to the fire line.
 Backhaul excess trash/hose/water.
 Scout Fire/Branch/Division to validate control Lines, division breaks, and branch breaks.
 Scout and complete contingency dozer line from Island Bar Peninsula to Shields Gulch Dozerline.
 Assess structures for hazardous conditions and provide locations as appropriate.

7. Special Instructions:

FOR BUTTE CMD, SEE 205 FOR PROPER TONE-BASED ON LOCATION

8. Communications

Name	Ch	Function	Rx Freq	Rx Tone	Tx Freq	Tx Tone	Notes
BUTTE CMD	1	COMMAND	154.4150	123.0 (T2)	159.0000	123.0 (T2)	BUTTE COMMAND
VFIRE 25	8	TACTICAL	154.2875	156.7 (T6)	154.2875	156.7 (T6)	BRANCH XXV
CDF T18	14	AIR TO GROUND	159.3450	192.8 (T16)	159.3450	192.8 (T16)	***AIR TO GROUND TAC***
167.9500	13	A/G COMMAND	167.9500		167.9500		***AIR TO GROUND COMMAND***
CALCORD	15	MEDICAL	156.0750	156.7 (T6)	156.0750	156.7 (T6)	MEDICAL COORDINATION
AIRGUARD	16	AIRGUARD	168.6250		168.6250	110.9 (T1)	EMERGENCY USE ONLY

9. Prepared by: Name: Gwyndolyn Ozard **RESL**

Signature: Personnel Count: 237

ICS 204 Date/Time: 9/13/2020 2200

ASSIGNMENT LIST (ICS 204 WF)

CONTROLLED UNCLASSIFIED
INFORMATION//BASIC

1. Incident Name: NORTH COMPLEX WEST ZONE	2. Operational Period: Date From: 09/14/20 Date To: 09/15/20 Time From: 0700 Time To: 0700	3. Branch Division XXV T
--	---	---

4. Operations Personnel: Operations Section Chief: Shane Lauderdale Branch Director: Sean Norman Division/Group Supervisor: Jason Finney	Night Ops: Monty Smith Branch Safety: Air Attack:
---	--

Page 2 of 3 Tango

5. Resources Assigned:	** Resources Below in Bold are 12 Hour **						
Resource Identifier	ALS	LWD	Leader	Personnel	Request #	Hours	Reporting Location
DOZ PVT E-30003- LENAHAHS			CARLTON, RODNEY	2	E-30003-BL	0700-0700	DP36
DOZ PVT E-50126 - OROVILLE			MEDRANO, RAMERO	2	E-50126	0700-0700	DP36
DOZ PVT E-50127 - OROVILLE			SMART, KYLE	2	E-50127	0700-0700	DP36
W/T PVT E-3 - LENAHAHS			PERRIOT, GERRAD	2	E-50208	0700-0700	DP36
W/T1 PVT E-13 - ACT FAST			ANDREW, TOMMY	1	E-50194	0700-1900	DP36
W/T PVT E-14 - GARR			GARR, TODD	2	E-50186	0700-0700	DP36
W/T PVT E-15 - DAVIS			DAVIS	2	E-50187	0700-0700	DP36
W/T1 PVT E-17- FORD			FORD, GERRY	2	E-50188	0700-0700	DP36
W/T1 PVT E-23 - TWO BROTHER			GOMEZ, ART	2	E-50398	0700-0700	DP36
W/T1 PVT E-25 - CONVERSE			SCHEPPS, STEVEN	2	E-50400	0700-0700	DP36
W/T PVT E-50045 - TAHOE			ARMSTRONG, ADAM	2	E-50045	0700-0700	DP36
W/T PVT E-50051 - TWO DOGS			SANCHEZ, MARTIN	2	E-50051	0700-0700	DP36
W/T PVT E-50055 - BURGESS &			BURGESS, DAVID	2	E-50467	0700-0700	DP36
GRD PVT E-30012- MILLSAPS			MILLSAPS	1	E-30012	0700-1900	DP36
FALM PVT O-50070 - HODGSON			HODGSON, RUSS	1	O-50070	0700-1900	DP36
FALM PVT O-50071 - CTS			TOTH, BRIAN	1	O-50071	0700-0900	DP36
FALM PVT O-50074 - HIGH			BRINEGAR, WESLEY	1	O-50074	0700-1900	DP36
HEQB+						0700-0700	DP36

6. Work Assignments:
 Fall hazard trees, and trees that threaten control lines, to mitigate the threat of fire escaping, while maintaining personnel safety.
 Hold fire within established control lines.
 Hold and improve control lines to mitigate threat of fire escaping.
 Prepare lines for implementation of firing plan.
 Implement firing plan in division.
 Mop up 100' interior to eliminate threat to the fire line.
 Backhaul excess trash/hose/water.
 Scout Fire/Branch/Division to validate control Lines, division breaks, and branch breaks.
 Scout and complete contingency dozer line from Island Bar Peninsula to Shields Gulch Dozerline.
 Assess structures for hazardous conditions and provide locations as appropriate.

7. Special Instructions:
*****FOR BUTTE CMD, SEE 205 FOR PROPER TONE-BASED ON LOCATION*****

8. Communications							
Name	Ch	Function	Rx Freq	Rx Tone	Tx Freq	Tx Tone	Notes
BUTTE CMD	1	COMMAND	154.4150	123.0 (T2)	159.0000	123.0 (T2)	BUTTE COMMAND
VFIRE 25	8	TACTICAL	154.2875	156.7 (T6)	154.2875	156.7 (T6)	BRANCH XXV
CDF T18	14	AIR TO GROUND	159.3450	192.8 (T16)	159.3450	192.8 (T16)	***AIR TO GROUND TAC***
167.9500	13	A/G COMMAND	167.9500		167.9500		***AIR TO GROUND COMMAND***
CALCORD	15	MEDICAL	156.0750	156.7 (T6)	156.0750	156.7 (T6)	MEDICAL COORDINATION
AIRGUARD	16	AIRGUARD	168.6250		168.6250	110.9 (T1)	EMERGENCY USE ONLY

9. Prepared by: Name: Gwyndolyn Ozard RESL
 Signature: *Gwyndolyn Ozard*
 ICS 204 Date/Time: 9/13/2020 2200 Personnel Count: 29

Division/Group Assignment List (ICS 204 WF)
Controlled Unclassified Information//Basic

1. Incident Name:		3.				
NORTH COMPLEX		Branch:	Division/Group:			
2. Operational Period:		VII	JJ			
Date/Time From: 09/14/2020 0600 MON	Date/Time To: 09/15/2020 0600 TUE					
4. Operations Personnel						
SOUTH OPERATIONS CHIEF	DAVID PEREIRA	BRANCH DIRECTOR	GARY MONDAY			
DIVISION/GROUP SUPERVISOR	GRAHM RICE - LWD 9/18 CHARLES HUNTER (T) LWD - 9/18	AIR ATTACK SUPERVISOR				
5. Resources Assigned this Period						
Strike Team / Task Force / Resource Designator	LWD	Leader	Number Persons	Drop Off PT./Time	Pick Up PT./Time	
CRW1 TRUCKEE IHC C-113	09/15	BURGHARDT, SCOTT	20	BROWNSVILLE/0600	BROWNSVILLE/1800	
CRW1 GILA HOTSHOTS IHC C-180	09/23	MICHAEL, HEAD	20	BROWNSVILLE/0600	BROWNSVILLE/1800	
CRW1 BECKWOURTH IHC E-678.3	09/14	WINTCH, MIKE	20	BROWNSVILLE/0600	BROWNSVILLE/1800	
CRW2 PACIFIC OASIS 17056 C-133	09/17	MOIT, JOHN	20	BROWNSVILLE/0600	BROWNSVILLE/1800	
CRW2 GRAYBACK 17021 C-154	09/16	ADAMS, JACOB	20	BROWNSVILLE/0600	BROWNSVILLE/1800	
ENG3 S/T 4660 C E-576	09/15	OKERMAN, KYLE	26	BROWNSVILLE/0600	BROWNSVILLE/1800	
ENG3 S/T 2026 C E-704	09/22	JOHNSON, DARREN	21	BROWNSVILLE/0600	BROWNSVILLE/1800	
FOOTHILL TF 1 SEE CHECK IN		GREEN, CHRIS		BROWNSVILLE/0600	BROWNSVILLE/1800	
ENG3 PNF 15 E-304	09/16	ITHURBURN, PAUL	7	BROWNSVILLE/0600	BROWNSVILLE/1800	
ENG3 COUGAR FIRE E-285	09/19	REILLY, CATHY	3	BROWNSVILLE/0600	BROWNSVILLE/1800	
WTS2 ALLIED WATER E-375	09/23	LIEDTKY, CHARLES	1	BROWNSVILLE/0600	BROWNSVILLE/1800	
WTT2 STF 242 E-678.5	09/30	CARRILLO, MICHAEL	2	BROWNSVILLE/0600	BROWNSVILLE/1800	
DOZ2 TRAPHAGEN 2 E-327	09/24	THOMPSON, TORIN	2	BROWNSVILLE/0600	BROWNSVILLE/1800	
DOZ2 TRAPHAGEN 3 E-328	09/23	TRAPHAGEN, THOMAS	2	BROWNSVILLE/0600	BROWNSVILLE/1800	
DOZ2 PNF 2 E-334	09/14	SANCHEZ, TOM	2	BROWNSVILLE/0600	BROWNSVILLE/1800	
DOZ2 V WORKS E-356	09/20	LINDSROM, DON	2	BROWNSVILLE/0600	BROWNSVILLE/1800	
FEL1 TYRELL RES E-75	09/23	VANMETER, CORY	2	BROWNSVILLE/0600	BROWNSVILLE/1800	
FEL2 WARNER ENT E-74	09/16	CLAIR, ZANE	2	BROWNSVILLE/0600	BROWNSVILLE/1800	
8. Division/Group Communication Summary						
Function	Channel	RX Frequency N/W	RX Tone/NAC	TX Frequency N/W	TX Tone/NAC	Mode
COMMAND	1 NIFC C10	107.4125	107.2	165.9625	107.2	A
COMMAND	3 NIFC C47	172.0750	107.2	162.2000	107.2	A
COMMAND	4 NIFC C3	170.4250	107.2	168.0750	107.2	A
TACTICAL	12 VFIRE25	154.2875	156.7	154.2875	156.7	A
AIR TO GROUND	13 A/G CMD	167.9500	NONE	167.9500	NONE	A
AIR TO GROUND	14 A/G TAC	168.4000	NONE	168.4000	NONE	A
9. Prepared By (Resource Unit Leader)		Approved By (Planning Section Chief)		Date	Time	
MIKE VETTI		THOMAS MARCHANT		09/13/2020	2200	

Division/Group Assignment List (ICS 204 WF)
Controlled Unclassified Information//Basic

1. Incident Name:		3.	
NORTH COMPLEX		Branch:	Division/Group:
2. Operational Period:		VII	JJ
Date/Time From: 09/14/2020 0600	MON		

4. Operations Personnel			
SOUTH OPERATIONS CHIEF	DAVID PEREIRA	BRANCH DIRECTOR	GARY MONDAY
DIVISION/GROUP SUPERVISOR	GRAHM RICE - LWD 9/18 CHARLES HUNTER (T) LWD - 9/18	AIR ATTACK SUPERVISOR	

5. Resources Assigned this Period					
Strike Team / Task Force / Resource Designator	LWD	Leader	Number Persons	Drop Off PT/Time	Pick Up PT/Time
SKG2 DUKES EQUIP E-423		EGGER, KENNY	2	BROWNSVILLE/0600	BROWNSVILLE/1800
SKG2 RIM ROCK E-426	09/19	WILLIAMS, TYLER	1	BROWNSVILLE/0600	BROWNSVILLE/1800
MAST2 NORTHSTATE E-663	09/21	FLOURINOY, BERT	2	BROWNSVILLE/0600	BROWNSVILLE/1800
TFLD O-838	09/21	MILLER, JASON	1	BROWNSVILLE/0600	BROWNSVILLE/1800
TFLD (T) O-678	09/19	OSTER, JEREMY J (T)	1	BROWNSVILLE/0600	BROWNSVILLE/1800
HEQB (T) O-728	09/20	DAWSON, JEANNE E	1	BROWNSVILLE/0600	BROWNSVILLE/1800
HEQB (T) O-731	09/23	HARRIS, JEFFREY	1	BROWNSVILLE/0600	BROWNSVILLE/1800
HEQB (T) O-732	09/23	PETRY, HOLLY	1	BROWNSVILLE/0600	BROWNSVILLE/1800
FALM UNDERDOG O-317	09/21	BROWN, RICHARD	2	BROWNSVILLE/0600	BROWNSVILLE/1800
FALM BROTHERS O-696	09/21	LASTER, BEN	2	BROWNSVILLE/0600	BROWNSVILLE/1800
REMS 3 E-650	09/19	HAUGE, STEN	4	BROWNSVILLE/0600	BROWNSVILLE/1800
SOFR O-867	09/24	TYRRELL, MICHAEL	1	BROWNSVILLE/0600	BROWNSVILLE/1800
SOFR (T) O-502	09/14	MASON, RODNEY	1	BROWNSVILLE/0600	BROWNSVILLE/1800

8. Division/Group Communication Summary						
Function	Channel	RX Frequency N/W	RX Tone/NAC	TX Frequency N/W	TX Tone/NAC	Mode
COMMAND	1 NIFC C10	107.4125	107.2	165.9625	107.2	A
COMMAND	3 NIFC C47	172.0750	107.2	162.2000	107.2	A
COMMAND	4 NIFC C3	170.4250	107.2	168.0750	107.2	A
TACTICAL	12 VFIRE25	154.2875	156.7	154.2875	156.7	A
AIR TO GROUND	13 A/G CMD	167.9500	NONE	167.9500	NONE	A
AIR TO GROUND	14 A/G TAC	168.4000	NONE	168.4000	NONE	A

9. Prepared By (Resource Unit Leader)	Approved By (Planning Section Chief)	Date	Time
MIKE VETTI	THOMAS MARCHANT	09/13/2020	2200

Division/Group Assignment List (ICS 204 WF)
Controlled Unclassified Information//Basic

1. Incident Name: NORTH COMPLEX		3.	
		Branch: VII	Division/Group: JJ
2. Operational Period:			
Date/Time From: 09/14/2020 0600	MON	Date/Time To: 09/15/2020 0600	TUE

4. Operations Personnel			
SOUTH OPERATIONS CHIEF	DAVID PEREIRA	BRANCH DIRECTOR	GARY MONDAY
DIVISION/GROUP SUPERVISOR	GRAHM RICE - LWD 9/18 CHARLES HUNTER (T) LWD - 9/18	AIR ATTACK SUPERVISOR	

5. Resources Assigned this Period					
Strike Team / Task Force / Resource Designator	LWD	Leader	Number Persons	Drop Off PT./Time	Pick Up PT./Time

6. Control Operations/Work Assignments:
 Life safety and point protection are priorities.
 Continue to prep La Porte Road from GG / JJ break to the Zone break at Sly Creek Reservoir.
 Hold and mop up direct dozer / handline from Lost Creek to 21N16 road.

7. Special Instructions:
 Back haul all trash, modules need to take all trash back to ICP.
 Avoidance flagging: North Complex will be red and black candy striped.
DO NOT DRAFT FROM FIRE HYDRANTS IN LA PORTE.
 REMS 3 assigned to DIV GG and available Branch-wide.
 REMS 4 assigned to DIV BB and available Branch-wide.
 Ambulance Medic 2 @ DP 95 and available Branch-wide.
 Ambulance Medic 5 @ DP 120 and available Branch-wide.

8. Division/Group Communication Summary						
Function	Channel	RX Frequency N/W	RX Tone/NAC	TX Frequency N/W	TX Tone/NAC	Mode
COMMAND	1 NIFC C10	107.4125	107.2	165.9625	107.2	A
COMMAND	3 NIFC C47	172.0750	107.2	162.2000	107.2	A
COMMAND	4 NIFC C3	170.4250	107.2	168.0750	107.2	A
TACTICAL	12 VFIRE25	154.2875	156.7	154.2875	156.7	A
AIR TO GROUND	13 A/G CMD	167.9500	NONE	167.9500	NONE	A
AIR TO GROUND	14 A/G TAC	168.4000	NONE	168.4000	NONE	A

9. Prepared By (Resource Unit Leader)		Approved By (Planning Section Chief)		Date	Time
MIKE VETTI		THOMAS MARCHANT		09/13/2020	2200

ASSIGNMENT LIST (ICS 204 WF)

CONTROLLED UNCLASSIFIED
INFORMATION//BASIC

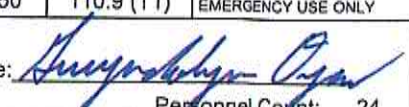
1. Incident Name: NORTH COMPLEX WEST ZONE		2. Operational Period: Date From: 09/14/20 Date To: 09/15/20 Time From: 0700 Time To: 0700			3. Branch Group NORTH CONTINGENCY NORTH 1		
4. Operations Personnel:					Page 1 of 3		
Operations Section Chief: Shane Lauderdale Branch Director: Gus Boston (12) Division/Group Supervisor: Brandon Brady(12), Patrick Byde(12)				Night Ops: Monty Smith Branch Safety: Air Attack:			
5. Resources Assigned:		** Resources Below in Bold are 12 Hour **					
Resource Identifier	ALS	LWD	Leader	Personnel	Request #	Hours	Reporting Location
ENG6+						0700-0700	Rim Rd. X Dixie Rd.
ENG6+						0700-0700	Rim Rd. X Dixie Rd.
CRW2+						0700-0700	Rim Rd. X Dixie Rd.
CRW2+						0700-0700	Rim Rd. X Dixie Rd.
DOZ PVT E-17- MCCULLOUGH			MCCULLOUGH, KLYE	2	E-17	0700-0700	Rim Rd. X Dixie Rd.
DOZ PVT E-18 - JMBS			BARTON, JERRY	2	E-18	0700-1900	Rim Rd. X Dixie Rd.
DOZ PVT E-23 - KDK GENERAL					E-23	0700-0700	Rim Rd. X Dixie Rd.
DOZ2 PVT E-24 - LET R BUCK			LASSEN, STEVE	2	E-50196	0700-0700	Rim Rd. X Dixie Rd.
DOZ PVT E-1104 - MCDONALD			BURFORD, TONY	2	E-50335	0700-1900	Rim Rd. X Dixie Rd.
DOZ PVT E-20063 - NORTHWESTE			STEVENSON, RON	2	E-50380	0700-0700	Rim Rd. X Dixie Rd.
DOZ PVT E-50100 - SLAIGHT			SLAIGHT, JACOB	2	E-50100	0700-0700	Rim Rd. X Dixie Rd.
DOZ PVT E-50102 - KK			KURT, KRAMER	2	E-50102	0700-0700	Rim Rd. X Dixie Rd.
DOZ PVT E-50103 - MCGOWAN			MCGOWAN, HENRY	2	E-50103	0700-0700	Rim Rd. X Dixie Rd.
DOZ PVT E-50104 - OILAR AG			WHITE, JAMES	2	E-50104	0700-0700	Rim Rd. X Dixie Rd.
DOZ PVT E-50105 - OILAR AG			OILER, PAT	2	E-50105	0700-0700	Rim Rd. X Dixie Rd.
DOZ PVT E-50106 - EASTSIDE			SHERER, CHRIS	2	E-50106	0700-0700	Rim Rd. X Dixie Rd.
DOZ PVT E-50124 - C&C			GOLTERMANN, CASEY	2	E-50124	0700-0700	Rim Rd. X Dixie Rd.
DOZ+						0700-0700	Rim Rd. X Dixie Rd.
6. Work Assignments: Construct direct line where appropriate. Construct secondary line where appropriate. Continue contingency line construction to the northwest. Identify and protect sensitive sites. Scout Fire/Branch/Division to validate control lines, division breaks, and branch breaks.							
7. Special Instructions: <p style="text-align: center;">***FOR BUTTE CMD, SEE 205 FOR PROPER TONE-BASED ON LOCATION***</p>							
8. Communications							
Name	Ch	Function	Rx Freq	Rx Tone	Tx Freq	Tx Tone	Notes
BUTTE CMD	1	COMMAND	154.4150	123.0 (T2)	159.0000	136.5 (T4)	BUTTE COMMAND
CDF T31	11	TACTICAL	159.3825	192.8 (T16)	159.3825	192.8 (T16)	NORTH CONTINGENCY
CDF T18	14	AIR TO GROUND	159.3450	192.8 (T16)	159.3450	192.8 (T16)	***AIR TO GROUND TAC***
167.9500	13	A/G COMMAND	167.9500		167.9500		***AIR TO GROUND COMMAND***
CALCORD	15	MEDICAL	156.0750	156.7 (T6)	156.0750	156.7 (T6)	MEDICAL COORDINATION
AIRGUARD	16	AIRGUARD	168.6250		168.6250	110.9 (T1)	EMERGENCY USE ONLY
9. Prepared by: Name:		Gwyndolyn Ozard		RESL		Signature: 	
ICS 204		Date/Time: 9/13/2020 2200		Personnel Count: 24			

ASSIGNMENT LIST (ICS 204 WF)

CONTROLLED UNCLASSIFIED
INFORMATION/BASIC

1. Incident Name: NORTH COMPLEX WEST ZONE	2. Operational Period: Date From: 09/14/20 Date To: 09/15/20 Time From: 0700 Time To: 0700	3. Branch Group NORTH CONTINGENCY NORTH 1
--	---	---

4. Operations Personnel:		Page 2 of 3
Operations Section Chief: Shane Lauderdale Branch Director: Gus Boston (12) Division/Group Supervisor: Brandon Brady(12), Patrick Byde(12)	Night Ops: Monty Smith Branch Safety: Air Attack:	

5. Resources Assigned:		** Resources Below in Bold are 12 Hour **					
Resource Identifier	ALS	LWD	Leader	Personnel	Request #	Hours	Reporting Location
DOZ+						0700-0700	Rim Rd. X Dixie Rd.
DOZ+						0700-0700	Rim Rd. X Dixie Rd.
DOZ+						0700-0700	Rim Rd. X Dixie Rd.
DOZ+						0700-0700	Rim Rd. X Dixie Rd.
DOZ+						0700-0700	Rim Rd. X Dixie Rd.
DOZ+						0700-0700	Rim Rd. X Dixie Rd.
DOZ+						0700-0700	Rim Rd. X Dixie Rd.
DOZ+						0700-0700	Rim Rd. X Dixie Rd.
DOZ+						0700-0700	Rim Rd. X Dixie Rd.
DOZ+						0700-0700	Rim Rd. X Dixie Rd.
W/T PVT E-13-PRODUMP			SEABOURN, FLOYD	2	E-13-PT	0700-1900	Rim Rd. X Dixie Rd.
W/T PVT E-44 - PHOENIX					E-44	0700-1900	Rim Rd. X Dixie Rd.
W/T PVT E-46 - ALAN'S TRANS					E-46	0700-1900	Rim Rd. X Dixie Rd.
W/T PVT E-47 - DIAMOND ENT					E-47	0700-0700	Rim Rd. X Dixie Rd.
W/T+						0700-0700	Rim Rd. X Dixie Rd.
W/T+						0700-0700	Rim Rd. X Dixie Rd.
MAST PVT E-1003 - WURLITZER			NEVERKOVEC, TOM	1	E-50298	0700-1900	Rim Rd. X Dixie Rd.
MAST PVT E-1004 - LESTER			LACKEY, CHES	2	E-50299	0700-1900	Rim Rd. X Dixie Rd.
MAST PVT E-1005 - SUNRISE			WILLIAMS, BRANDON	2	E-50300	0700-1900	Rim Rd. X Dixie Rd.

6. Work Assignments:
 Construct direct line where appropriate.
 Construct secondary line where appropriate.
 Continue contingency line construction to the northwest.
 Identify and protect sensitive sites.
 Scout Fire/Branch/Division to validate control lines, division breaks, and branch breaks.

7. Special Instructions:

*****FOR BUTTE CMD, SEE 205 FOR PROPER TONE-BASED ON LOCATION*****

8. Communications							
Name	Ch	Function	Rx Freq	Rx Tone	Tx Freq	Tx Tone	Notes
BUTTE CMD	1	COMMAND	154.4150	123.0 (T2)	159.0000	136.5 (T4)	BUTTE COMMAND
CDF T31	11	TACTICAL	159.3825	192.8 (T16)	159.3825	192.8 (T16)	NORTH CONTINGENCY
CDF T18	14	AIR TO GROUND	159.3450	192.8 (T16)	159.3450	192.8 (T16)	***AIR TO GROUND TAC***
167.9500	13	A/G COMMAND	167.9500		167.9500		***AIR TO GROUND COMMAND***
CALCORD	15	MEDICAL	156.0750	156.7 (T6)	156.0750	156.7 (T6)	MEDICAL COORDINATION
AIRGUARD	16	AIRGUARD	168.6250		168.6250	110.9 (T1)	EMERGENCY USE ONLY

9. Prepared by: Name: Gwyndolyn Ozard RESL
 Signature: 
ICS 204 Date/Time: 9/13/2020 2200 Personnel Count: 7

ASSIGNMENT LIST (ICS 204 WF)

CONTROLLED UNCLASSIFIED
INFORMATION//BASIC

1. Incident Name: NORTH COMPLEX WEST ZONE	2. Operational Period: Date From: 09/14/20 Date To: 09/15/20 Time From: 0700 Time To: 0700	3. Branch Group NORTH CONTINGENCY NORTH 1
--	---	---

4. Operations Personnel:	Page 3 of 3
---------------------------------	-------------

Operations Section Chief: Shane Lauderdale Branch Director: Gus Boston (12) Division/Group Supervisor: Brandon Brady(12), Patrick Bye(12)	Night Ops: Monty Smith Branch Safety: Air Attack:
--	--

5. Resources Assigned:	** Resources Below in Bold are 12 Hour **							
Resource Identifier	ALS	LWD	Leader	Personnel	Request #	Hours	Reporting Location	
MAST PVT E-1006 - LEPAGE			GREER, MIKE	1	E-50303	0700-1900	Rim Rd. X Dixie Rd.	
MAST PVT E-1078- DIG IT			HOLLAND, CALEB	2	E-50320	0700-1900	Rim Rd. X Dixie Rd.	
MAST PVT E-50246 - KITE			NUNNELEE, CHAD	2	E-50246	0700-1900	Rim Rd. X Dixie Rd.	
GDR PVT E-50484 - DALE ULSH			ULSH, DALE	1	E-50484	0700-1900	Rim Rd. X Dixie Rd.	
FELL PVT E-1060 - LESLIE			LESLIE, PRESTON	1	E-50318	0700-1900	Rim Rd. X Dixie Rd.	
HEQB NOYES			NOYES, COLIN J	1	O-50078	0700-0700	Rim Rd. X Dixie Rd.	
HEQB+						0700-0700	Rim Rd. X Dixie Rd.	
HEQB+						0700-0700	Rim Rd. X Dixie Rd.	
HEQB+						0700-0700	Rim Rd. X Dixie Rd.	
HEQB+						0700-0700	Rim Rd. X Dixie Rd.	
FALM+						0700-1900	Rim Rd. X Dixie Rd.	
T/F UTAH2 (66666) ← DIV T CATHER, DAN						0700-0700		

6. Work Assignments:
 Construct direct line where appropriate.
 Construct secondary line where appropriate.
 Continue contingency line construction to the northwest.
 Identify and protect sensitive sites.
 Scout Fire/Branch/Division to validate control lines, division breaks, and branch breaks.

7. Special Instructions:
 FOR BUTTE CMD, SEE 205 FOR PROPER TONE-BASED ON LOCATION

8. Communications

Name	Ch	Function	Rx Freq	Rx Tone	Tx Freq	Tx Tone	Notes
BUTTE CMD	1	COMMAND	154.4150	123.0 (T2)	159.0000	136.5 (T4)	BUTTE COMMAND
CDF T31	11	TACTICAL	159.3825	192.8 (T16)	159.3825	192.8 (T16)	NORTH CONTINGENCY
CDF T18	14	AIR TO GROUND	159.3450	192.8 (T16)	159.3450	192.8 (T16)	***AIR TO GROUND TAC***
167.9500	13	A/G COMMAND	167.9500		167.9500		***AIR TO GROUND COMMAND***
CALCORD	15	MEDICAL	156.0750	156.7 (T6)	156.0750	156.7 (T6)	MEDICAL COORDINATION
AIRGUARD	16	AIRGUARD	168.6250		168.6250	110.9 (T1)	EMERGENCY USE ONLY

9. Prepared by: Name:	Gwyndolyn Ozard	RESL	Signature:
ICS 204	Date/Time: 9/13/2020	2200	Personnel Count: 8

ASSIGNMENT LIST (ICS 204 WF)

CONTROLLED UNCLASSIFIED
INFORMATION//BASIC

1. Incident Name: NORTH COMPLEX WEST ZONE	2. Operational Period: Date From: 09/14/20 Date To: 09/15/20 Time From: 0700 Time To: 0700	3. Branch SOUTH CONTINGENCY
--	---	--

4. Operations Personnel:		Page 1 of 2
Operations Section Chief: Shane Lauderdale Branch Director: John Fredrick(12), Steve Robinson(12) Division/Group Supervisor:	Night Ops: Monty Smith Branch Safety: Air Attack:	

5. Resources Assigned:		** Resources Below in Bold are 12 Hour **					
Resource Identifier	ALS	LWD	Leader	Personnel	Request #	Hours	Reporting Location
STC+						0700-0700	DP21
STC+						0700-0700	DP21
DOZ PVT E-6- HUMPHERYS			HUMPHERYS, GREG	2	E-6	0700-0700	DP21
DOZ PVT E-27 - LET-ER-BUCK				2		0700-0700	DP21
DOZ PVT E-50107 - LONESTAR			GOODDEN, MIKE	2	E-50107	0700-0700	DP21
DOZ PVT E-50125- LEPAGE			MURPHY, JOE	2	E-50125	0700-0700	DP21
DOZ PVT E-50128 - RJ PAGE			SCOTT, TY	1	E-50128	0700-1900	DP21
DOZ PVT E-50129 - WURLITZER			WULITZER, CALEB	1	E-50129	0700-1900	DP21
DOZ PVT E-50132 - NORTHWESTE			MANZ, JOHN	2	E-50132	0700-0700	DP21
DOZ PVT E-50133 - COCKRELL			COCKRELL, WESTON	2	E-50133	0700-0700	DP21
DOZ+						0700-0700	DP21
DOZ+						0700-0700	DP21
W/T1 PVT E-18 - MARYMEE			MARYME, PATTY	2	E-50189	0700-0700	DP21
W/T PVT E-24 - COLEMAN			HARRIS, JAMES	2	E-50399	0700-0700	DP21
W/T PVT E-37 - DARRAH			DARGER, MARVIN	1	E-37	0700-1900	DP21
W/T PVT E-40 - DARRAH			PRESTON, COREY	1	E-40	0700-1900	DP21
W/T PVT E-50041 - FIRST			QUALLS, MARK	2	E-50041	0700-0700	DP21
W/T PVT E-50292 - PATANE			PATANE, GINO	1	E-50292	0700-1900	DP21

6. Work Assignments:
Establish and implement Contingency Plan.
Identify and construct contingency line where feasible.
Construct indirect line from DP20 to the South Fork of Feather River.

7. Special Instructions:

*****FOR BUTTE CMD, SEE 205 FOR PROPER TONE-BASED ON LOCATION*****

8. Communications							
Name	Ch	Function	Rx Freq	Rx Tone	Tx Freq	Tx Tone	Notes
BUTTE CMD	1	COMMAND	154.4150	123.0 (T2)	159.0000	136.5 (T4)	BUTTE COMMAND
VTAC 11	10	TACTICAL	151.1375	156.7 (T6)	151.1375	156.7 (T6)	SOUTH CONTINGENCY
CDF T18	14	AIR TO GROUND	159.3450	192.8 (T16)	159.3450	192.8 (T16)	***AIR TO GROUND TAC***
167.9500	13	A/G COMMAND	167.9500		167.9500		***AIR TO GROUND COMMAND***
CALCORD	15	MEDICAL	156.0750	156.7 (T6)	156.0750	156.7 (T6)	MEDICAL COORDINATION
AIRGUARD	16	AIRGUARD	168.6250		168.6250	110.9 (T1)	EMERGENCY USE ONLY

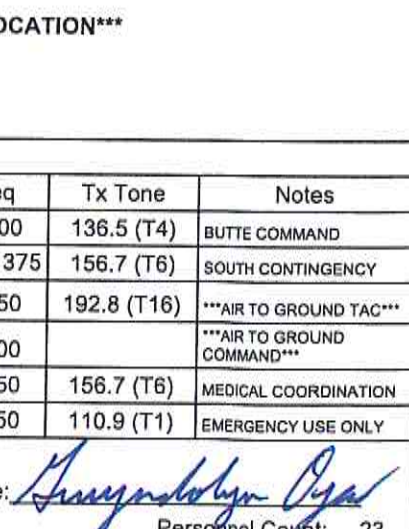
9. Prepared by: Name: Gwyndolyn Ozard **RESL**
Signature: 
ICS 204 Date/Time: 9/13/2020 2200 Personnel Count: 23

ASSIGNMENT LIST (ICS 204 WF)

CONTROLLED UNCLASSIFIED
INFORMATION//BASIC

1. Incident Name: NORTH COMPLEX WEST ZONE	2. Operational Period: Date From: 09/14/20 Date To: 09/15/20 Time From: 0700 Time To: 0700	3. Branch Staging CHICO STAGING
4. Operations Personnel:		Page 1 of 1

Operations Section Chief: Shane Lauderdale Branch Director: Division/Group Supervisor: Kelly Upson	Night Ops: Monty Smith Branch Safety: Air Attack:
--	--

5. Resources Assigned:		** Resources Below in Bold are 12 Hour **					
Resource Identifier	ALS	LWD	Leader	Personnel	Request #	Hours	Reporting Location
DOZ TGU 2544			WILBANKS, CLIFF	1	E-50210	0700-0700	Silver Dollar Fair Grounds
DOZ PVT E-50099 - SAM			THOMPSON, SAM	2	E-50099	0700-0700	Silver Dollar Fair Grounds
W/T PVT E-50043 - FIVE STAR			HUMPHREY, MARC	1	E-50043	0700-1900	Silver Dollar Fair Grounds
W/T PVT E-50046 - HUGHES			NABORS, DUANE	2	E-50046	0700-0700	Silver Dollar Fair Grounds
W/T PVT E-50052 - TULE RIVER			GARCIA, ANTHONY	1	E-50052	0700-1900	Silver Dollar Fair Grounds
W/T PVT E-50056 - PETERS			PATANE, GINO DARREL LEMOS	1	E-50468	0700-1900	Silver Dollar Fair Grounds
W/T PVT E-50288 - NORM PAUL			PAUL NORM	1	E-50288	0700-1900	Silver Dollar Fair Grounds
W/T PVT E-50289 - BURTON'S			BURTON, LARRY	1	E-50289	0700-1900	Silver Dollar Fair Grounds
W/T PVT E-50293 - ROGER			STRALEY, ROGER	1	E-50293	0700-1900	Silver Dollar Fair Grounds
EXC PVT E-20099 - DEPUE			STAMSBERRY, MIKE	2	E-50394	0700-1900	Silver Dollar Fair Grounds
EXC PVT E-20100 - PETER'S			HANAM, BILL	1	E-50396	0700-1900	Silver Dollar Fair Grounds
GDR PVT E-50485 - LAMB			QUIGLEY, CHUCK	2	E-50485	0700-1900	Silver Dollar Fair Grounds
GDR PVT E-50486 - OILAR AG			OILAR, PAT	1	E-50486	0700-1900	Silver Dollar Fair Grounds
DOZ PVT E-50109 - FORD			JOSEPH FORD				
DOZ PVT E-50110 DAD			SEAN COTTON				
DOZ PVT E-50111 STRIKE FIRST			MIKE CHAVEZ				

6. Work Assignments:
Maintain 3 minute response time.

7. Special Instructions:

*****FOR BUTTE CMD, SEE 205 FOR PROPER TONE-BASED ON LOCATION*****

8. Communications

Name	Ch	Function	Rx Freq	Rx Tone	Tx Freq	Tx Tone	Notes
BUTTE CMD	1	COMMAND	154.4150	123.0 (T2)	159.0000	136.5 (T4)	BUTTE COMMAND
CDF T18	14	AIR TO GROUND	159.3450	192.8 (T16)	159.3450	192.8 (T16)	***AIR TO GROUND TAC***
CALCORD	15	MEDICAL	156.0750	156.7 (T6)	156.0750	156.7 (T6)	MEDICAL COORDINATION
AIRGUARD	16	AIRGUARD	168.6250		168.6250	110.9 (T1)	EMERGENCY USE ONLY

9. Prepared by: Name: Gwyndolyn Ozard **RESL**

Signature:

ICS 204 Date/Time: 9/13/2020 2200 Personnel Count: 17



SAFETY MESSAGE

North Complex, West Zone

September 14, 2020 0700-0700 20-CA-BTU-10751



S
A
F
E
T
Y

S
A
F
E
T
Y

S
A
F
E
T
Y

E
V
E
R
Y
O
N
E
S
R
E
S
P
O
N
S
I
B
I
L
I
T
Y

CHANGE IN WEATHER

INCREASED WINDS and WIND SHIFTS IN FIRE AREA

Watch Out – Unstable atmosphere will lift the lid off the fire area

- Increased fire behavior due to WIND changing of direction
- Winds will cause decreased smoke, increased temperatures, and lower humidity's
- High probability for increased fire behavior as the air become less stable

Mitigation Watch your watch and intuition

- Keep informed on predicted fire weather conditions and forecasts
- Base all actions on current and expected fire behavior
- Keep a "Heads Up" and monitor weather in your area

FIRE WEAKENED TREES

SNAGS, and WEAKENED TREES PRESENT A SERIOUS RISK

Watch Out Tree and limb fall has been reported throughout the fire area

- Areas having burned several days ago may have standing snags ready to fall
- Trees may fall without warning, afternoon/evening winds may increase potential
- Drought conditions have created snag patches in areas of the fire

Mitigation Situational awareness is the key to mitigating this risk

- Scout line prior to engagement in areas with drought ridden and bug kill trees, scout areas in daylight when possible
- Disengage in areas with weak and fire weakened trees when appropriate
- Flag hazard trees, prevent access as possible, and notify falling modules to mitigate hazard trees

EMOTIONAL FATIGUE

FATIGUE CAN CAUSE US TO SACRIFICE SAFETY FOR THE SAKE OF THE TASK

Watch Out - Emotional fatigue can disguise itself

- Look for short fuse attitudes, sharp tongue responses and change in overall behavior
- Feeling anxious, difficulty concentrating, increased cynicism or pessimism and sense of dread
- Look for signs and symptoms among your fellow workers, irritability, anger, depression

Mitigation - Promote open discussions

- Get as much quality rest as possible
- Practice mindfulness
- Talk about difficult situations with your peers – seek help through Employee Support Services

Each Safety Message is designed for a daily Tailgate Safety discussion

Douglas M Ferro

IMT 4 SAFETY OFFICER

REMAIN FIRE FOCUSED AND COVID-19 AWARE



INCIDENT ACTION PLAN SAFETY ANALYSIS (ICS 215A)



1. Incident Name: North Complex West Zone **2. Incident Number:** 20-CA-BTU-10751

3. Date/Time Prepared:
Date: 09/013/2020 Time: 1700 hours **4. Operational Period:** Date From: 09/14/2020 To: 09/15/2020
Time From: 0700 hours To: 0700 hours

5. Incident Area	6. Hazards/Risks	7. Mitigations
Branch XX Branch XXIII, Branch XXV	Fatigue – physical and mental Dehydration / Rhabdomyolysis	Continually monitor your crew. Know the signs and symptoms of heat illness. Plan for a 2-1 Work Rest Work Cycle, water and caloric intake regime
Branch XX Branch XXIII, Branch XXV	Poor visibility / Driving Conditions	Drive with lights on, slow down , know your location on the map, size up escape routes and make known to crew, maintain SA
Branch XX Branch XXIII, Branch XXV	Powerlines / Power Poles	IRPG Pg. 24: Treat all lines as if they are energized. Flag damaged powerlines / poles as hazard to others and notify. Deny Entry
Branch XX Branch XXIII, XXV	Weather and Fire Behavior	Stay Mobile and Identify Escape Routes and Safety Zones and make them known to your personnel.
Branch XX Div. C Branch XXV	Poor communications	The radio plan is new and changing, stay alert and in touch with Oroville ECC for any changes.
Branch XX Branch XXIII, Branch XXV	Steep, unstable terrain	Watch footing and maintain downhill tool placement. Be aware of loose material. Look for ash pits and stump holes.
Branch XX Branch XXV	Unburned areas	Watch for Evacuees; LCES - utilize worst case scenario when working in or around pockets of unburned fuels.
Branch XX Branch XXIII, Branch XXV	Hazard Trees / Snags	IRPG Pg 22: Identify and Flag Hazard Trees. Eliminate hazardous trees with qualified sawyers or heavy equipment.
Branch XX Branch XXIII, Branch XXV	Personal Protective Equipment (PPE)	Wear appropriate PPE for all operations until your supervisor indicates it's safe to remove.
Branch XX Branch XXIII, Branch XXV	Airborne Hazards	Be aware of the environment, wear proper PPE, utilize SCBA's and N95 masks, hydrate with water to assist in cleaning your system
Branch XX Branch XXIII, Branch XXV	COVID-19: Reduce exposure potential to yourself, your crew and the public	<u>Wear a mask</u> while in the ICP, while feeding and with the public, and when six feet of social distancing is difficult. Wash hands for at least 20-seconds.
Branch XX Branch XXIII, Branch XXV	Helicopters - Water Drops and Turbulence	Post lookouts and make escape routes and safety zones know. LCES. Watch overhead for hazard trees and wind changes.
Branch XX Branch XXIII, Branch XXV	Burnt Residence and other structures Carcinogens and Hazardous Materials	Utilize Three Stripes Your Out flagging and notify line supervisor
Branch XX Branch XXIII, Branch XXV	Animals maybe stressed and confused	Do not try to feed, pet, capture or rescue any domestic animals.
Branch XXIII, Div. T, R, M Branch XX, Div. I, F	Water Ways, Water Craft	Be vigilant when working around water with your PPE on, State Parks has two patrol boats available for evacs and rescues.

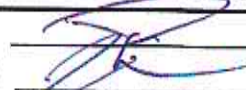
8. Prepared by (Safety Officer) Name: Douglas M Ferro Signature: 

Prepared by (Deputy Operations Section Chief) Name: James Hudson Signature: 

ICS 215A Date/Time: 09.012.2020 1700 Hours

AIR OPERATIONS SUMMARY

Prepared By: Galen Young

Prepared Date/Time: 9/13/2020

1800

1. INCIDENT NAME: North Complex		2. OPERATIONAL PERIOD DATE: 9/14/2020		Start Time 7:00	End Time 21:00	Sunrise: 6:45	Sunset 19:12	
3. REMARKS (Safety Notes, Hazards, Air Operations Special Equipment, etc.): * Wires in the middle fork of Feather River Canyon, Smoke Conditions causing poor visibility. Multiple TFR in proximity of the fire area, be aware of transitioning aircraft. UAS use on incident notify Helibase and announce on Command, fixed or rotor wing entering TFR contact aerial supervision, if no supervision announce on TFR Freq., Command FM, Command Air to Ground FM all zones. Announcement on 5 minute intervals if no aerial supervision.				4. MEDEVAC A/C: Santa Barbara County Fire, Copter 4 N911HN, Medevac NVG Hoist, Type 2 based in Redding, CA Contact - Tony White, 805-895-5007, or 805-896-1135				5. TFR DESCRIPTION: FDC 0/9108 Polygon see TFR map, 12,500 foot ceiling, NOTAM issued for Quincy and Nervino

6. PERSONNEL	Phone	7. FREQUENCIES	AM	FM	8. FIXED-WING (# Avail / Type/ Make-Model / FAA N# / Base(s))
AOBD Galen Young	575-574-8720	A/A BRIEFING	132.275		
ASGS Jim Straitton	760-207-4325	A/A TFR NORTH COMPLEX	135.725		Airtankers
HILCO		A/A ROTARY WING NORTH	120.025		
ATGS Brian Rogers AA06	530-521-1843	AIR/GROUND CMD NORTH		167.9500	
ATGS Brian Baker, H509	530-521-1843	AIR/GROUND TACTICAL		168.4000	
HEBM Jason Horsman, Nerv.	541-216-3793	AIR TACTICS NORTH		166.6125	
HEBM Dave Dale, Quin.	530-515-0799	DECK		163.1000	Leadplanes
ABRO Andrew Whitehall, Nerv.	231-878-4033	CF West A/G Command		167.9500	ATGS
Quincy Helibase	916-296-4876	CF West A/G Tactical		Tx & Rx	Chester Air Attack 06, Relief from RDD pool
AOBD Shem Hawkins, CalFire	530-990-5128	CF West A/A Rotor	121.850		Air Space 760-500-619 PNF 530-283-0193
UASP Matt Gosney	928-273-3523				

9. HELICOPTERS (Use Additional Sheets As Necessary)													
FAA #	TYPE	MAKE/MODEL	BASE	AVAIL	START	REMARKS	FAA #	TYPE	MAKE/MODEL	BASE	AVAIL	START	REMARKS
1048Y	1	S61	Quincy	700	730		45917	1	S-61	Nervino	700	730	
1168U	2	S58T	Quincy	700	730		614HH	3		Nervino	700	730	
659H	2	Bell 205++	Quincy	700	730	RAPPEL							
1043T	1	S61	Nervino	700	730								
947CH	1	CH47	Nervino	700	730								
N20PF	2	Bell 212 HP	Quincy	700	730	512							
109Z	3	Bell 209	Quincy	700	730	H509 - Baker							
407RL	3	Bell 407	Nervino	700	730								
66HJ	2	Bell 205 ++	Quincy	700	730		UAS R31	3	M600	TBD	700	730	

ICS 205 - INCIDENT RADIO COMMUNICATIONS PLAN

1. Incident Name: **NORTH COMPLEX WEST ZONE** 2. Date/Time Prepared: **09/13/2020** 3. Operational Period: **09/14/20**
 Date: **09/13/2020** Date From: **09/14/20** Date To: **09/15/20**
 Time: **1930** Time From: **0700** Time To: **0700**

PAGE 1 OF 2

4. Communications

Ch#	Function	Name	Assigned To	Rx Freq	Rx Tone	Tx Freq	Tx Tone	Notes
1	COMMAND	BUTTE CMD T2	ALL DIVS	154.4150	123.0 (T2)	159.0000	123.0 (T2)	SUNSET
2	COMMAND	BUTTE CMD T4	ALL DIVS	154.4150	123.0 (T2)	159.0000	136.5 (T4)	BALD MTN
3	COMMAND	BUTTE CMD T5	ALL DIVS	154.4150	123.0 (T2)	159.0000	146.2 (T5)	ST. JOHN
4	COMMAND	BUTTE CMD T13	ALL DIVS	154.4150	123.0 (T2)	159.0000	141.3 (T13)	BLOOMER
5	TACTICAL	CDF T5	DRV C	151.2500	192.8 (T16)	151.2500	192.8 (T16)	BRANCH XX
6	TACTICAL	CDF T24	DIV F	151.3325	192.8 (T16)	151.3325	192.8 (T16)	BRANCH XX
7	TACTICAL	CDF T29	ALL DIVS	151.3475	192.8 (T16)	151.3475	192.8 (T16)	***MORNING BRIEFING***
8	TACTICAL	CDF T26	DIV D	159.2925	192.8 (T16)	159.2925	192.8 (T16)	BRANCH XX
9	TACTICAL	CDF T27	DIV I	159.3075	192.8 (T16)	159.3075	192.8 (T16)	BRANCH XX
10	TACTICAL	VTAC11	CONTINGENCY	151.1375	156.7 (T6)	151.1375	156.7 (T6)	SOUTH CONTINGENCY
11	TACTICAL	CDF T31	CONTINGENCY	159.3825	192.8 (T16)	159.3825	192.8 (T16)	NORTH CONTINGENCY
12	AIR TO GROUND	167.9500	AIR TO GROUND	167.9500		167.9500		***AIR TO GROUND COMMAND***
13	AIR TO GROUND	168.4000	ALL DIVS	168.4000		168.4000		***AIR TO GROUND TAC***
14	AIR TO GROUND	CDF T18	ALL DIVS	159.3450	192.8 (T16)	159.3450	192.8 (T16)	***AIR TO GROUND TAC***
15	MEDICAL	CALCORD	ALL DIVS	156.0750	156.7 (T6)	156.0750	156.7 (T6)	MEDICAL COORDINATION
16	AIRGUARD	AIRGUARD	ALL DIVS	168.6250		168.6250	110.9 (T1)	EMERGENCY USE ONLY
17								
18								
19								
20	AIRGUARD	AIRGUARD	ALL DIVS	168.6250		168.6250	110.9 (T1)	EMERGENCY USE ONLY

5. Special Instructions

THE LATEST CLONE FOR SEPTEMBER 14, 2020 IS NCWZ 4 IS THE GROUP NAME IN YOUR HT WEST ZONE COMMUNICATIONS # 559-513-7251***

6. Prepared by (Communications Unit Leader): Name: **Mike Heyfron** Signature: *Mike Heyfron*
 ICS 205 - CONTROLLED UNCLASSIFIED INFORMATION/BASIC Date/Time: **09/13/20** 1930

ICS 205 - INCIDENT RADIO COMMUNICATIONS PLAN

CONTROLLED UNCLASSIFIED INFORMATION/BASIC

1. Incident Name: **NORTH COMPLEX WEST ZONE** 2. Date/Time Prepared: **09/13/2020 1930** 3. Operational Period: **09/14/20 0700**
 Date From: **09/14/20 0700** Date To: **09/15/20 0700**
 Time From: **0700** Time To: **0700**

4. Communications		Assigned To		Rx Freq	Rx Tone	Tx Freq	Tx Tone	Notes
Ch#	Function	Name						
1	COMMAND	BUTTE CMD T2	ALL DIVS	154.4150	123.0 (T2)	159.0000	123.0 (T2)	SUNSET
2	COMMAND	BUTTE CMD T4	ALL DIVS	154.4150	123.0 (T2)	159.0000	136.5 (T4)	BALD MTN
3	COMMAND	BUTTE CMD T5	ALL DIVS	154.4150	123.0 (T2)	159.0000	146.2 (T5)	ST. JOHN
4	COMMAND	BUTTE CMD T13	ALL DIVS	154.4150	123.0 (T2)	159.0000	141.3 (T13)	BLOOMER
5	TACTICAL	CDF T32	DIV M	151.2425	192.8 (T16)	151.2425	192.8 (T16)	BRANCH XXIII
6	TACTICAL	VFIRE 23	DIV R	154.2950	156.7 (T6)	154.2950	156.7 (T6)	BRANCH XXIII
7	TACTICAL	CDF T29	ALL DIVS	151.3475	192.8 (T16)	151.3475	192.8 (T16)	***MORNING BRIEFING***
8	TACTICAL	VFIRE 25	DIV T	154.2875	156.7 (T6)	154.2875	156.7 (T6)	BRANCH XXV
9	TACTICAL	CDF T13	UNASSIGNED	151.3775	192.8 (T16)	151.3775	192.8 (T16)	
10	TACTICAL	VTAC11	CONTINGENCY	151.1375	156.7 (T6)	151.1375	156.7 (T6)	SOUTH CONTINGENCY
11	TACTICAL	CDF T31	CONTINGENCY	159.3825	192.8 (T16)	159.3825	192.8 (T16)	NORTH CONTINGENCY
12	AIR TO GROUND	167.9500	AIR TO GROUND	167.9500		167.9500		*** AIR TO GROUND COMMAND***
13	AIR TO GROUND	168.4000	AIR TO GROUND	168.4000		168.4000		***AIR TO GROUND TAC***
14	AIR TO GROUND	CDF T18	AIR TO GROUND	159.3450	192.8 (T16)	159.3450	192.8 (T16)	***AIR TO GROUND TAC***
15	MEDICAL	CALCORD	ALL DIVS	156.0750	156.7 (T6)	156.0750	156.7 (T6)	MEDICAL COORDINATION
16	AIRGUARD	AIRGUARD	ALL DIVS	168.6250		168.6250	110.9 (T1)	EMERGENCY USE ONLY
17								
18								
19								
20	AIRGUARD	AIRGUARD	ALL DIVS	168.6250		168.6250	110.9 (T1)	EMERGENCY USE ONLY

5. Special Instructions

THE LATEST CLONE FOR SEPTEMBER 14, 2020 IS NCWZ 4 IS THE GROUP NAME IN YOUR HT WEST ZONE COMMUNICATIONS # 559-513-7251***

6. Prepared by (Communications Unit Leader): Name: **Mike Heyfron** Signature: *[Signature]*
 ICS 205 - CONTROLLED UNCLASSIFIED INFORMATION/BASIC NIMS IAP Date/Time: **09/13/20 1930**

Repeater Locations

North Complex West Zone
CA-BTU-010751



Bald Mtn T4
(R)

Magalia
Paradise

Bloomer T13
(R)

Sunset T2
(R)

Oroville

Quincy

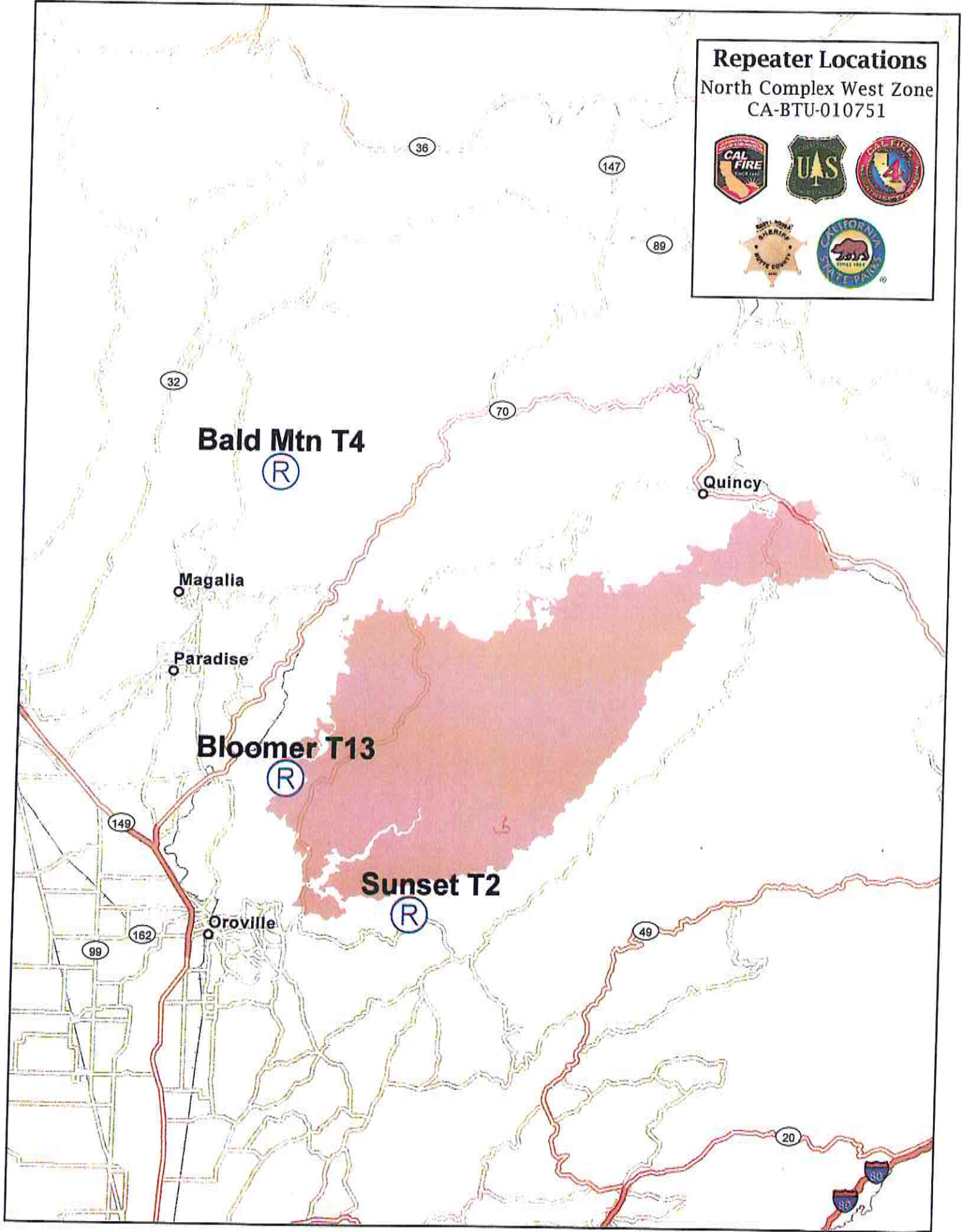

MEDICAL PLAN (ICS 206)

1. Incident Name:	2. Operational Period:	Date From:	9/14/20	Date To:	9/15/20
NORTH COMPLEX WEST ZONE		Time From:	0700	Time To:	0700

3. Medical Aid Stations:			
Name	Location	Contact Number/Freq	Paramedics
CAL-MAT	ICP	(408)341-9589	MD
MERT	ICP	N/A	PA

4. Transportation (indicate air or ground):			
Ambulance Service	Location	Contact Number	Level of Service
Butte Co EMS	DP 30 & DP 24	Command	ALS
Medic 53	DP 36	Command	ALS
Reach / CAL-STAR (Air)	Marysville	(800)338-4045	RN
Enloe (Air)	Chico	(800)344-1863	RN
Santa Barbara Copter 4 (24 Hour Hoist)	Redding (North Ops)	Command	ALS

5. Hospitals:								
Hospital Name	Address		Contact Number(s)/ Frequency	Travel Time		Trauma Center	Burn Center	Helipad
	Lat & Long Helipad			Air	Ground			
Oroville Hospital Oroville, CA	2767 Olive Hwy N39°30.47' W121°32.63'		(530)632-8334	5 MIN	30 MIN	Level 3	N/A	<input checked="" type="checkbox"/>
Enloe Medical Center Chico, CA	1531 Esplanade N39°44.53' W121°50.95'		(530)332-7417	10 MIN	30 MIN	Level 2	N/A	<input checked="" type="checkbox"/>
UC Davis Medical Center Sacramento, CA	2315 Stockton Blvd N38°33.28' W121°27.35'		(916)734-3790	30 MIN	90 MIN	Level 1	<input checked="" type="checkbox"/>	<input checked="" type="checkbox"/>

6. Special Medical Emergency Procedures	
<p>Line Emergency Crew Supervisor will contact Division Supervisor with patient complaint/condition and location. - Division Group Supervisor Contacts: 1. Closest EMS resource 2. Communications Unit - Communications Unit Contacts: 1. Ground or Air ambulance as requested. 2. Operations 3. Safety 4. Medical Unit - Division Supervisor or designee will serve as point of contact and run medical emergency on assigned channel. 1. A pre-assigned tactical frequency (i.e. CALCORD) should be used for IWI and only for duration of the emergency. - Communications Unit will clear the Command channel for emergency traffic as needed for duration of the need.</p> <p>Camp Emergency Contact Medical Unit with patient complain/condition and location. Medical staff will respond to stabilize the patient. - Medical Unit contacts 1. Communications 2. Safety 3. Logistics 4. Operations 5. Crew Supervisor 6. Comp/Claims</p>	<p style="text-align: center;">Injury Reporting Procedures</p> <p>Nature of Injury: _____</p> <p>Location of Patient: _____</p> <p>Point of Contact: _____</p> <p>Transportation Requested by: Air _____ Ground _____</p> <p>Point of Pick-Up: _____</p> <p style="padding-left: 40px;">Lat: _____ Long: _____</p> <p>Patient Unit ID: _____</p> <p>Is an EMT with Patient: Yes _____ No _____</p> <p>Age: _____ Sex: Male _____ Female _____</p> <p style="text-align: center;">All Emergencies - Secure the area and identified witnesses for later investigation. Keep accurate log of events.</p>

Check box if aviation assets are utilized for rescue. If assets are used, coordinate with Air Operations.

7. Prepared by (Medical Unit Leader):	Steve McGary Leif Juliussen (t)
	Signature:

8. Approved by (Safety Officer):	Doug Ferro Brent Stangeland
	Signature:

ICS 206	NIMS IAP		Date/Time:	9/13/20	1900
---------	----------	--	------------	---------	------



NORTH COMPLEX – WEST ZONE **INFORMATION SHEET**



FIRE INFORMATION LINE: (530) 538-7826

Please scan the QR Below for CAL FIRE's Social Media Policy 0691.



INCIDENT MAIL

The PIO Trailer will receive mail/packages shipped to the Incident. Please ensure all mail addressed to the incident follows the format below:

(YOUR NAME, YOUR ORDER NUMBER)
C/O NORTH COMPLEX WEST ZONE BASE CAMP
PUBLIC INFORMATION TRAILER
SILVER DOLLAR FAIRGROUNDS
2357 FAIR STREET, CHICO, CA 95928

LOST AND FOUND

Any items that are found, please bring them to the PIO Trailer located at the entrance to Base Camp and leave them with PIO staff. Please leave your name, your order number, and contact information and description of lost items so we can attempt to reunite you with your items.

GENERAL MESSAGE (ICS 213)

1. Incident Name (Optional):

2. To (Name and Position):

3. From (Name and Position):

4. Subject:

5. Date:

6. Time

7. Message:

8. Approved by: Name: _____ Signature: _____ Position/Title: _____

9. Reply:

10. Replied by: Name: _____ Position/Title: _____ Signature: _____

ICS 213

Date/Time: _____



CAL-FIRE INCIDENT MANAGEMENT TEAM IV



24HR LINE RESOURCE - 2 OPERATOR

EMERGENCY SHIFT TICKET and EVALUATION FORM
The responsible Government Officer will complete this form each shift.

Contractor Name: **THE BEST DOZERS LLC**
Operator #1: **FIRST & LAST**
Operator #2: **FIRST & LAST**

Incident or Project Name: **MISSION**
Request Number: **E-444**
Agreement Number: **CA-MMU-018115**

Equipment Make: **MMU-0000015953**
Equipment Model / Type: **TRANSPORT 18 WHEEL**
Serial Number: **COMPLETE VIN# 12345A1**

Equipment Use: **12345A1**

Date Mo./Day	Start	Stop	Work	Hours	Days / Miles
9/5	0701	2400	17	(Circle)	DIV X
9/6	0001	0700	7	(Circle)	DIV X

Vendor Rating: **NO DAMAGE / NO CLAIM**

Govt. Rep. Name and Position - PRINT: **NO DAMAGE / NO CLAIM**

Print Your Name: **NO DAMAGE / NO CLAIM**

Govt. Rep. Signature: **NO DAMAGE / NO CLAIM**

Operator Skill Level: **VENDOR RATING MUST BE DONE**

Operator's Cooperation Level: **VENDOR RATING MUST BE DONE**

Overall Performance: **VENDOR RATING MUST BE DONE**

Date: **9/6/17** Time: **0700**

* NOTE: any rating of POOR requires an explanation in Comment Section.
** Final evaluation or for more documentation, use a CALFIRE Form 230 or equivalent.

12HR LINE RESOURCE - 1 OPERATOR

EMERGENCY SHIFT TICKET and EVALUATION FORM
The responsible Government Officer will complete this form each shift.

Contractor Name: **THE BEST DOZERS LLC**
Operator #1: **FIRST & LAST**
Operator #2: **Operator #2**

Incident or Project Name: **MISSION**
Request Number: **E-555**
Agreement Number: **CA-MMU-018115**

Equipment Make: **MMU-0000015955**
Equipment Model / Type: **D6N / TYPE II E**
Serial Number: **COMPLETE VIN#**

Equipment Use: **COMPLETE VIN#**

Date Mo./Day	Start	Stop	Work	Hours	Days / Miles
9/7	0001	0700	7	(Circle)	OFF SHIFT
9/7	0701	1900	12	(Circle)	DIV X
9/7	1901	2400	5	(Circle)	OFF SHIFT

Vendor Rating: **NO DAMAGE / NO CLAIM**

Govt. Rep. Name and Position - PRINT: **NO DAMAGE / NO CLAIM**

Print Your Name: **NO DAMAGE / NO CLAIM**

Govt. Rep. Signature: **NO DAMAGE / NO CLAIM**

Operator Skill Level: **VENDOR RATING MUST BE DONE**

Operator's Cooperation Level: **VENDOR RATING MUST BE DONE**

Overall Performance: **VENDOR RATING MUST BE DONE**

Date: **9/5/17** Time: **1900**

* NOTE: any rating of POOR requires an explanation in Comment Section.
** Final evaluation or for more documentation, use a CALFIRE Form 230 or equivalent.

24HR / 12HR TRANSITION SHIFT TICKET

EMERGENCY SHIFT TICKET and EVALUATION FORM
The responsible Government Officer will complete this form each shift.

Contractor Name: **THE BEST DOZERS LLC**
Operator #1: **FIRST & LAST**
Operator #2: **FIRST & LAST**

Incident or Project Name: **MISSION**
Request Number: **E-444**
Agreement Number: **CA-MMU-018115**

Equipment Make: **MMU-0000015953**
Equipment Model / Type: **TRANSPORT 18 WHEEL**
Serial Number: **COMPLETE VIN# 12345A1**

Equipment Use: **12345A1**

Date Mo./Day	Start	Stop	Work	Hours	Days / Miles
9/6	0701	1900	12	(Circle)	DIV X
9/6	1901	2400	5	(Circle)	OFF SHIFT

Vendor Rating: **NO DAMAGE / NO CLAIM**

Govt. Rep. Name and Position - PRINT: **NO DAMAGE / NO CLAIM**

Print Your Name: **NO DAMAGE / NO CLAIM**

Govt. Rep. Signature: **NO DAMAGE / NO CLAIM**

Operator Skill Level: **VENDOR RATING MUST BE DONE**

Operator's Cooperation Level: **VENDOR RATING MUST BE DONE**

Overall Performance: **VENDOR RATING MUST BE DONE**

Date: **9/5/17** Time: **1900**

* NOTE: any rating of POOR requires an explanation in Comment Section.
** Final evaluation or for more documentation, use a CALFIRE Form 230 or equivalent.

24HR IN CAMP RESOURCE

EMERGENCY SHIFT TICKET and EVALUATION FORM
The responsible Government Officer will complete this form each shift.

Contractor Name: **THE BEST CAMP LLC**
Operator #1: **FIRST & LAST**
Operator #2: **Operator #2**

Incident or Project Name: **MISSION**
Request Number: **E-333**
Agreement Number: **CA-MMU-018115**

Equipment Make: **MMU-0000015950**
Equipment Model / Type: **WESTERN SHELTER 19X35**
Serial Number: **COMPLETE VIN#**

Equipment Use: **COMPLETE VIN#**

Date Mo./Day	Start	Stop	Work	Hours	Days / Miles
9/2	0001	2400	24	(Circle)	ICP

Vendor Rating: **NO DAMAGE / NO CLAIM**

Govt. Rep. Name and Position - PRINT: **NO DAMAGE / NO CLAIM**

Print Your Name: **NO DAMAGE / NO CLAIM**

Govt. Rep. Signature: **NO DAMAGE / NO CLAIM**

Operator Skill Level: **VENDOR RATING MUST BE DONE**

Operator's Cooperation Level: **VENDOR RATING MUST BE DONE**

Overall Performance: **VENDOR RATING MUST BE DONE**

Date: **9/5/17** Time: **1900**

* NOTE: any rating of POOR requires an explanation in Comment Section.
** Final evaluation or for more documentation, use a CALFIRE Form 230 or equivalent.



ATTN: Federal Resources (specifically Federal Contracted Resources/ADs)

A process has been developed to submit your invoices/time sheets virtually. If tech-capable, please **scan and email** your documents to 2020.northcomplex.finance.west@firenet.gov email address. In the subject line please start with the word TIME, then add:

TIME - Resource # - Company/Person Name – Attachment description - Fire Name/Number

Otherwise, paper shift tickets and CTR's will continue to be accepted at a designated drop box in Finance Section.

Contract Crew/Equipment:

Please send us the following information (even if you have submitted it to the CAL FIRE finance unit):

- Contact name, phone number, and email for on-site "leader"
- Resource Order
- Contract (Pages 1-2 and any additional pages referencing equipment/resource information)
- Crew Manifest
- Inspection (if one was done)
- Shift Tickets (signed by you and your incident supervisor) / CTRs (signed by your incident supervisor)
- Advance notice of crew swaps

Administratively Determined (AD) Resources:

Please send us the following information:

- Contact phone number and email
- Resource Order and Casual Hire form
- CTRs (signed by your incident supervisor)

Federal Employees:

If you require an OF-288, please email documentation along with a note regarding your last work shift, and we will arrange for you to obtain it (them). If you are claiming no lunch break and/or Hazard Pay, just like always, you must provide a justification for the claim ("H=Hazard") is NOT enough. Use "action verbs" to explain what happened/why you were not able to have a lunch break, and/or claiming the hazard.

Federal S# Requests:

For S# requests related to property loss, please send a completed 213 General Message to the email below.

WHEN YOU ARE CLOSE TO DEMOB:

- Give Finance a "Courtesy Email" 1-2 days prior to make sure all your documents have been received.
- Submit all time documentation (including travel home) ahead of demob.
- Send an email the morning of your demob to the email below so the demob process can be started from the virtual finance group.

EMAIL: 2020.northcomplex.finance.west@firenet.gov

Please **do not wait** until the end of your assignment to get us your information. This is a fluid situation and you may be released to other incidents on short notice. Thank you for your patience as we transition to new way of processing pay documents.



**NORTH COMPLEX WEST ZONE INCIDENT
CA-BTU-010751
REMOTE CHECK-IN**



**Please use this code to Check In to the
NORTH COMPLEX WEST ZONE INCIDENT**

REMEMBER: YOU MUST STILL VISIT TIME UNIT!



DMOB

NORTH COMPLEX WEST ZONE INCIDENT CA-BTU-010751

- Resources must check-in prior to the Demobilization process.
- In order to be deemed excess, supervisors must submit an ICS 213 to the Resources Unit.
- Resources report to Demobilization Unit at the times posted on the tentative DMOB list, which is posted around the Incident Base and posted to the Box Account.
- Prior to reporting to DMOB, please return all supplies and equipment.
- Resources will get signatures from the following units:
 - Ground Support
 - Training (If they have a trainee)
 - Documentation
 - Time
 - DMOB
- The following will be done by radio at DMOB
 - Motels
 - Supply
 - Communications



Local Government Resources on CFAA

If you are demobing from this incident and there is no OES AREP on site

F-42 thru the Incident Finance Section Chief

The Incident keeps the Pink copy and you keep the Golden.
The Original and Green you mail to OES Headquarters as per the
instructions on the front of your F-42

OES JOB AIDS, FORMS, F-42 SAMPLES AND CFAA AGREEMENT



Questions?
Your OES Fire & Rescue Region IV AREP is
Corey Zander
916-712-6771

EMERGENCY FIRE SUPPRESSION REPAIR PLAN – NORTH COMPLEX WEST ZONE

Fire Suppression Repair is the repair of damage caused directly from fire suppression activities. It is not the repair of infrastructure or rehabilitation of burned areas caused by the fire. We cannot upgrade facilities beyond their pre-fire condition. Fire suppression repair shall be applied to mitigate infrastructure damage and natural resource damage.

Infrastructure Damage: Culverts and other watercourse crossings, water sources, trails, road barriers removed for fire access, trash, debris and supplies left by fire suppression activities; miscellaneous.

Natural Resource Damage: Repair of existing problems caused by fire suppression activities (direct effect) to natural resources and to prevent likely future problems such as accelerated erosion caused by rains (indirect effect). The goal is to minimize soil erosion, adverse impacts to water quality, and adverse impacts to protected species of plants and animals

REPAIR GUIDELINES

General: Restore berms and barriers removed for fire control access.

Drop Points/Staging Areas/Safety Zones: New construction - cross drain and abandon (if applicable). Existing - repair to original condition, remove debris resulting from use. Pick up all trash.

Roads: Reshape soil surfaced roads that were used during fire control operations. Roads should be out-sloped with rolling dips where degradation of the road prism has resulted from fire control operations. Clean out culvert inlets and outlets as needed. Report any damaged culverts to the Fire Suppression Repair Specialist for specific repair guidance. Breach berms, where appropriate, to facilitate drainage.

Firelines: Break apart dozer piles of pushed over trees, vegetation and soil, and spread along tractor roads, tractor fire breaks, or any other areas disturbed during fire suppression activities. Lop and scatter displaced vegetation to a height of less than 30 inches or chip within 100' of a public or unlocked private road or structure. Scatter the lopped material along the fire line. Pull back any excess soil material sidecast along roads or tractor disturbed areas that are located within 100 feet of any watercourse or spring. Install waterbreaks on all constructed or used dozer lines using the following criteria:

Fireline and road gradient(%) oak woodland:	0-10	11-25	26-50	>50
Fireline waterbreak spacing:	150'	100'	75'	50'
Road waterbreak spacing:	300'	200'	150'	100'
Fireline and road gradient(%) Timber	0-10	11-25	26-50	>50
Fireline waterbreak spacing:	100'	75'	50'	25'
Road waterbreak spacing:	200'	150'	100'	75'

Waterbreaks and/or rolling dips shall be used to reduce the volume and velocity of water by directing it off fire lines as soon as possible at controlled locations. The outfall end of all waterbreaks shall be opened by hand if necessary. Waterbreaks should be located to discharge into natural vegetation. Waterbreaks should cross the fire line at an angle of approximately 45 degrees.

Handlines: Install waterbreaks as needed based on slope and soil erodibility.

All waterbreaks shall be installed diagonally with a minimum cut of 6" into existing grade, and minimum height of 12". Waterbreaks shall be constructed to allow for drainage at the discharge end into non-erodible material.

Slash Piles: Piles within 150' of permanent structures or public roads will be lopped and/or scattered within 18" of the soil surface.

Piles along roads and fences: Lop to fire protection standards to ensure decreased fire risk is obtained. Scatter smaller debris where applicable.

Watercourse Crossings: All slash, soil, and debris deposited into watercourses resulting from fire suppression activities shall be removed and stabilized above the high-water line.

Major watercourse damage, if present, shall be reported to the Fire Suppression Repair Specialist prior to the end of the shift day.

Where fire lines are constructed within 100' of flowing watercourses, slash or straw mulching will be applied. All loose soil must be pulled away from the watercourse and stabilized.

Archaeological or Historic Sites: All potential sites shall be avoided. Contact Incident Archaeologist or the Suppression Repair Specialist.

All Trainee's

If you are here as a Trainee from the BTU / TGU Incident, you must close out with the Training Specialist and check in under the North Complex West Zone Incident.

You are on a NEW incident !!!!!!!!!!!!!!!

You can use the QR codes to check out and then check back in, or stop by and I will help you.

Training Specialist

Dennis Martin

(707) 479-8421

TRAINING SPECIALIST

CHECK-IN

A Training Specialist is available for trainees on the incident.

All State, Federal and local government agency Trainees working on Position Task Books will need to register with the Incident Training Specialist in order to receive proper credit for your assignment.

Dennis Martin
Training Specialist
(707) 479-8421



Register using the QR Code

Trainee Check-Out

If you would like to CHECK-OUT / CLOSE OUT your packet with the Training Specialist, please scan the QR code, fill in "ALL" information and "click" submit.



Your completed packet will be emailed back to you

If you have any questions or concerns, please feel free to contact me.

Training Specialist

Dennis Martin

(707) 479-8421

Dennis.martin@cityofvallejo.net

CAL FIRE

INCIDENT MANAGEMENT TEAM

WATER USAGE PLAN

California Drought Emergency

The following shall be considered and implemented by all fire resources as a means to provide maximum efficiencies when utilizing water resources, while minimizing the impacts to private and public water supplies. Accountability shall be maintained for all water supplies that are utilized and care should be applied to ensure proper replacement and/or reimbursement to the supplier/ owner.

Fireline personnel- (During mop up operations)

- Use of Pencil Hose and Garden Nozzles with Shut-Offs.
- Use of Back pumps.
- Dry Mop-up and consolidation of heavy fuels to areas where they can burn out safely
- Locate/ Relocate Firelines to lighter fuels or natural barriers when safe.
- Set up and use portable tanks in anticipation of longer transport times for Water Tenders.
- Use of foams, gels and other water enhancers.
- Evaluate need to mop up in excess of 200 feet from fireline

Road Maintenance and Repair-

- Monitor and water roads only when and where needed.
- Water when most effective (evening and nights).
- Use chemical treatments when available (Magchloride, Omni bind ect).
- Consider use of tertiary or treated water (sp)

Aviation Operations-

- Use of Gels, Foams and Retardants. Set up portable plants.
- Consider Blivits and Pencil hose for interior mop up operations as opposed to numerous bucket drops.
- Establish and use pre-use agreements for existing and known water sources.
- Use large watershed dip sites when able. Minimize use of small, static ponds and lakes.
- Maintain accountability of water used and locations of dip sites.
- Evaluate need for interior bucket drops

Private Water Supplies-

- Notify property owner as early as possible.
- Minimize usage and develop alternative water supplies when and where appropriate.
- Track usage (meter, 214 form) and develop a plan to replace water.
- Make arrangements for reimbursement and damage claims if needed.

Public/ Municipal Water Supplies-

- Notify Agency as soon as possible and request a representative to the incident.
- Identify fill areas and request metering devices. Place on incident map.
- Use alternative or reclaimed water sources when available. Place on incident map.
- Make arrangements for reimbursement and damage claims if needed.

Management and Supervision-

- Use leaders intent and establish Water Conservation as an Management Objective.
- Consider complexity of water use on incidents. Establish a Water Supply Group Supervisor to coordinate additional resources to support the incident needs.
- Complete the Water Usage Report daily and turn in to Finance
- Review this check list and brief daily.

FIRING OPERATION CHECKLIST

Location: _____

Date: _____ Time: _____

Firing Supervisor _____

1. Personnel Briefing

- Objectives
- Conditions (fire environment)
- Resource assignments identified
 - Firing personnel
 - Holding forces
 - Lookouts
- Ignition plan/sequence
- Communication Plan
- Contingency Plan
- Safety issues

2. Go / No-Go

- All personnel briefed
- Weather forecast reviewed
- Resources in place
- Lookouts posted as needed
- Anchor and termination firing points identified
- Communications systems in place
- Fire behavior forecast reviewed
- Escape routes and safety zones established and made known
- Adjoining forces/Air Attack notified

3. Approval Prior To Firing

- Division Supervisor
- Branch Director
- Operations

4. Other Notifications

- Other: _____
- Other: _____

Attach Firing Operations Checklist to ICS-214

Rev: Ops Group February 8, 2011

GROUND SUPPORT

2535 NOTRE DAME BLVD
CHICO, CA 95928

ENTER FROM ZANELLA WAY. **DO NOT ENTER ON NOTRE DAME BLVD**

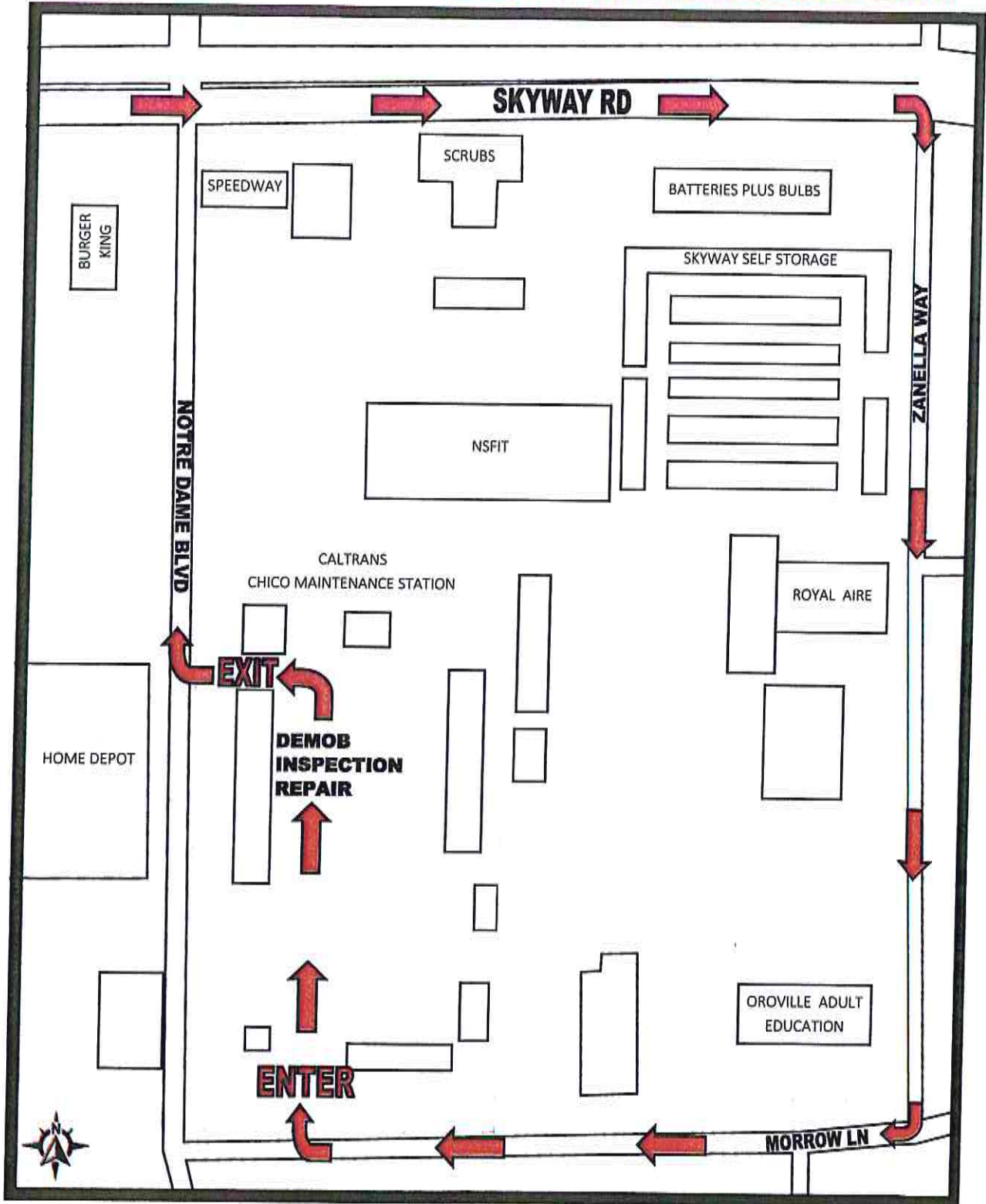

INCIDENT BASE

Silver Dollar Fairgrounds, Chico CA

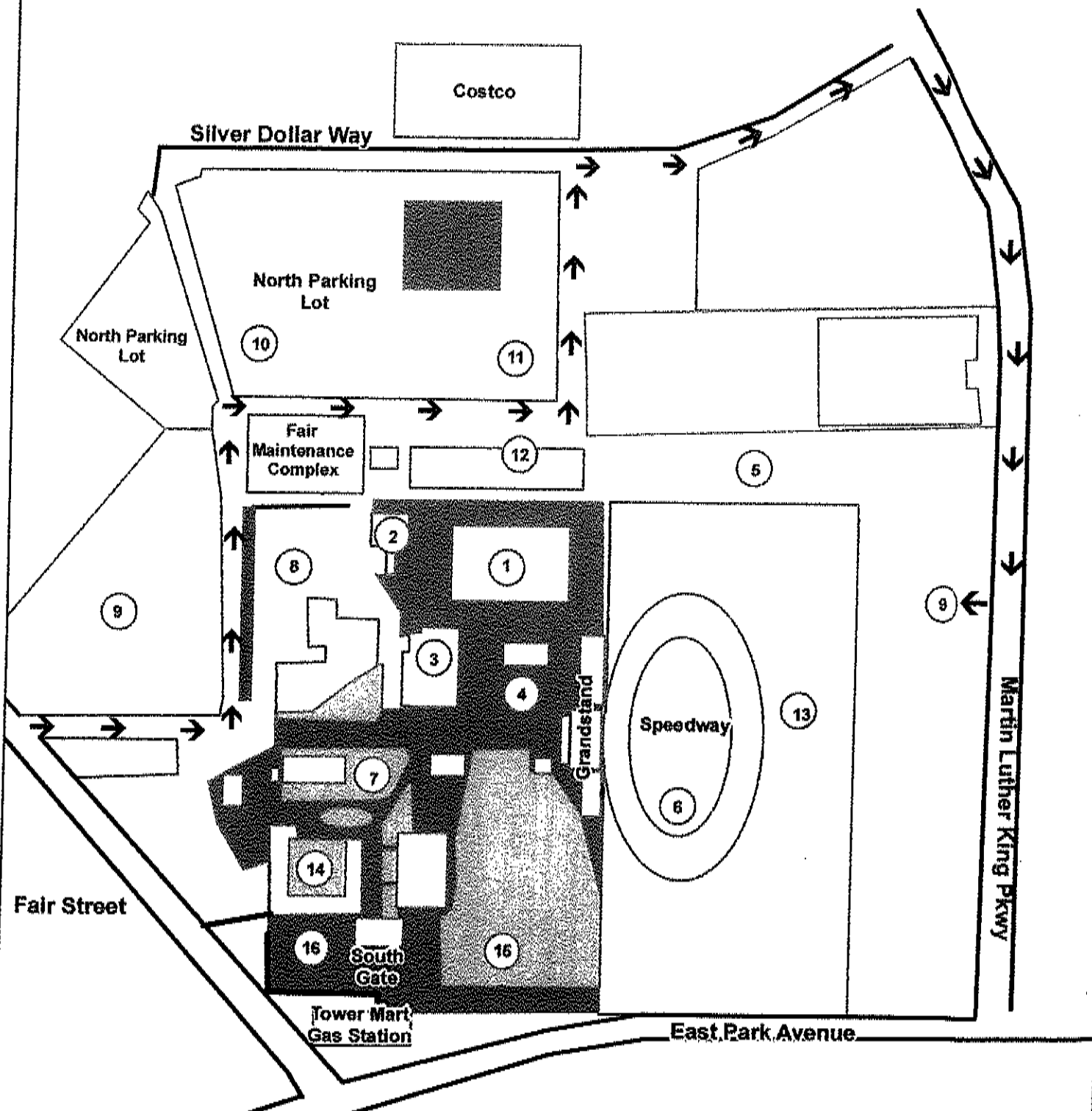

LEGEND

- | | | |
|--|--------------------------------|-------------------------------|
| 1. FEEDING | 5. SHOWERS/LAUNDRY SERVICES | 11. TRANSPORTATION |
| 2. SUPPLY | 6. TYPE 2 CREW SLEEPING | 12. CCC SLEEPING |
| 3. CHECK-IN, TIME, FINANCE,
PLANS, MOTELS, SIT,
PROCUREMENT, IT, DEMOB | 7. FACILITIES, SAFETY, LIASION | 13. MOBILE SLEEPERS |
| 4. MEDICAL UNIT | 8. OVERHEAD PARKING | 14. BRIEFING |
| | 9. EQUIPMENT PARKING | 15. CDCR PARKING/
SLEEPING |
| | 10. FUEL/OVERFLOW PARKING | 16. LE PARKING |

From ICP to DP-38 and DP-38:

1. Travel on E Park Ave. to CA-99 S.
2. Continue on CA-99 S to CA-149 S to CA-70 S
3. Take CA-162 E, arrive DP-34
5. Continue straight on CA-162 E to DP-38

From ICP to DP-30, DP-26 and DP-22:

1. Travel on E Park Ave. to CA-99 S.
2. Continue to CA-149 S to CA-70 S
3. Take CA-162 E to the intersection with Forbestown Rd. (DP-30)
4. Turn right onto Forbestown Rd
5. Turn left onto Lumpkin Road arrive DP-26
6. Continue to DP-22

From DP-30 to DP-24

1. Turn onto Forbestown Rd
2. Continue to DP-24

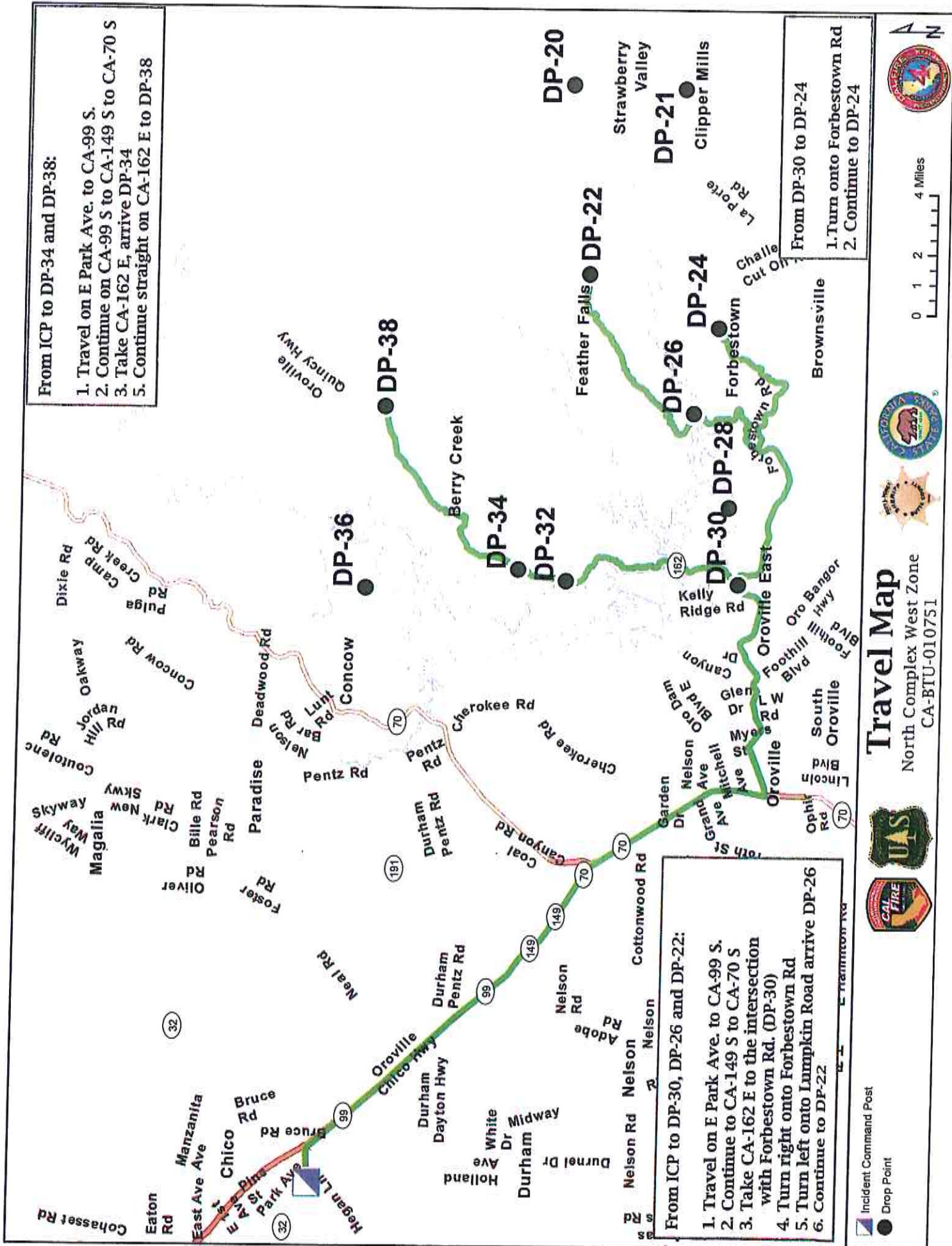

Incident Command Post

Drop Point



Travel Map
North Complex West Zone
CA-BTU-010751



