

**★ Corrected ★**

# INCIDENT ACTION PLAN

## CREWS INCIDENT

CA-SCU-004686

Wednesday



### OPERATIONAL PERIOD

7/8/2020 0700

to

7/9/2020 0700

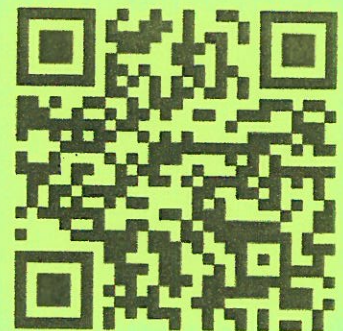



★ Corrected ★

INCIDENT ACTION PLAN

CREWS INCIDENT

CA-SCU-004886

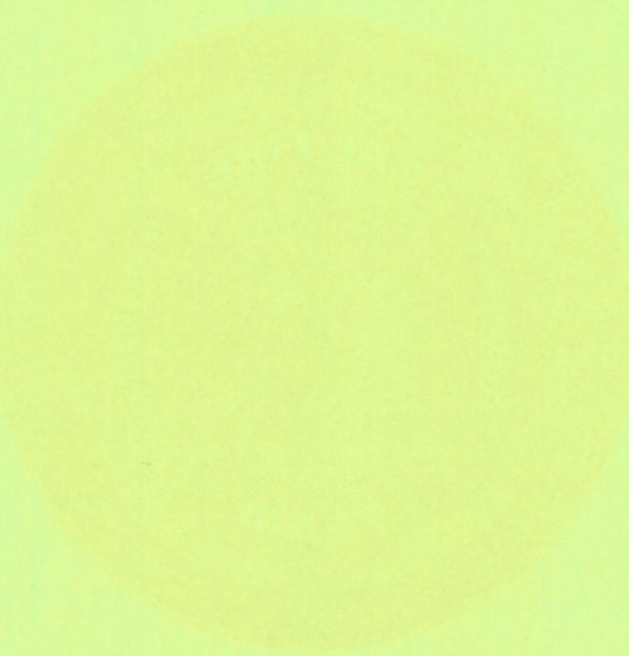

10/20/2017

OPERATIONAL PERIOD

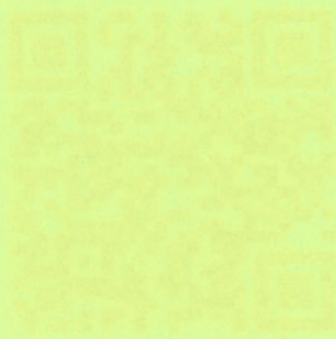

0700 0700

to

0700 0700

# INCIDENT OBJECTIVES (ICS 202)

<b>1. Incident Name:</b> <p style="text-align: center;">CREWS</p>	<b>2. Operational Period:</b>	Date From: 7/8/2020 Time From: 0700	Date To: 7/9/2020 Time To: 0700
----------------------------------------------------------------------	-------------------------------	----------------------------------------	------------------------------------

**3. Objective(s):**

Management Objectives

- Provide for emergency personnel and public safety at all times.
- Ensure COVID-19 precautions and best practices are met at all times.
- Protect property, improvements, and infrastructure.
- Ensure repopulation takes place in a quick, efficient, and effective manner.
- Ensure coordinated, timely and accurate release of public information.
- Foster and maintain relationships with all cooperators and stakeholders.
- Protect economic, natural, cultural and heritage resources.
- Maintain fiscal accountability and keep costs commensurate with values at risk.

Control Objectives

- Keep the fire East of Crews Road
- Keep the fire South of Henry Coe State Park
- Keep the fire West of Highway 152
- Keep the fire North of Highway 152

**General Situational Awareness:**

Steep and rugged terrain, critically dry and receptive fuel beds, active area for fire history and drought stressed trees.

In the COVID-19 environment, high density populations or large groups are particularly at risk. To help protect yourself, your family and to ensure all employees return home safely, make sure to practice social distancing.

Enhanced hygiene (especially handwashing), PPE & monitoring practices help limit the infection rate of first responders.

**5. Site Safety Plan Required?** Yes  No

**Approved Site Safety Plan(s) Located at:**

**6. Incident Action Plan**

<input checked="" type="checkbox"/> ICS 203	<input checked="" type="checkbox"/> ICS 215A	<input checked="" type="checkbox"/> ICS 205 A	<input type="checkbox"/>
<input checked="" type="checkbox"/> ICS 204	<input checked="" type="checkbox"/> ICS 220	<input checked="" type="checkbox"/> Training Message	<input type="checkbox"/>
<input checked="" type="checkbox"/> ICS 205	<input checked="" type="checkbox"/> Facility Maps	<input checked="" type="checkbox"/> Travel Map	<input type="checkbox"/>
<input checked="" type="checkbox"/> ICS 206	<input checked="" type="checkbox"/> Weather Forecast	<input checked="" type="checkbox"/> Demob Plan	<input type="checkbox"/>
<input checked="" type="checkbox"/> ICS 208	<input checked="" type="checkbox"/> Fire Behavior	<input checked="" type="checkbox"/> Finance Message	<input checked="" type="checkbox"/> ICS 214

<b>7. Prepared By:</b> A. Mitchell	Position/Title: PSC	Signature: _____
<b>8. Approved by Incident Commander:</b>	J. Veik / R. Myers	Signature: _____



## ORGANIZATION ASSIGNMENT LIST (ICS 203)

<b>1. Incident Name:</b>		<b>2. Operational Period: Date From:</b> 7/8/2020		<b>Date To:</b> 7/9/2020	
<b>CREWS</b>		<b>Time From:</b> 0700		<b>Time To:</b> 0700	
<b>3. Incident Commander(s) and Command Staff:</b>			<b>7. Operation Section:</b>		
IC/UC's	J. Veik / R. Myers	Operations	T. Ernst / R. Janssen		
Deputy	D. Martin (T) / J. Janssen (T)	Deputy Operations	S. Corn		
Safety Officer	J. Segura / J. Novak (T)	Night Ops	S. Lauderdale		
Information Officer	R. Brocchini / R. Lubben (T)	Staging Area		J. Smith	
Liaison Officer	D. Pender / J. Kiszka (T) / R. Roberts (T)	Branch	I	K. Bohall	
<b>4. Agency/Organization Representatives:</b>			Division/Group	A / Y	M. Maynard <i>B. Muenzer / G. Groneman (T)</i>
Agency/Organization	Name	Division/Group	D	J. Loveless	
Santa Clara County OEM	D. Reed	Division/Group			
Gilroy FD	M. Brisbee	Division/Group			
Cal OES	D. Franklin	Division/Group			
Santa Clara County Pub. Health	Dr. M. Fenstersheib	Branch	III	S. Lane / L. Kalfsbeek (T)	
CHP	C. Armstrong	Division/Group	M	M. Brown <i>L. Thomas</i>	
CDCR	C. Schwartz	Division/Group	P	S. Cullen / D. Attebury (T)	
Line Officer	M. Marcucci	Division/Group	S	<del>B. Muenzer / G. Groneman (T)</del> <i>M. Maynard</i>	
SC Co. Sheriff	T. Lera	Division/Group			
CA State Parks	B. Lutton	Division/Group			
USFS	W. Harris	Branch			
PG&E	J. Walsh	Division/Group	Suppression Repair		
CALTRANS	S. Rem	Division/Group			
		Division/Group			
		Division/Group			
		Division/Group			
		Branch			
		Division/Group			
<b>5. Planning Section:</b>			Division/Group		
Chief	G. Garcia	Division/Group			
Deputy	A. Mitchell / S. Sherwood (T)	Division/Group			
Resource Unit	D. Scheurich / J. Anderson / M. Selzer / J. Heald (T) / J. Worden (T) / A. Summers (T) / M. Thomas (T)	Division/Group			
Situation Unit	C. Ingram / M. Thau (T)	Branch			
Documentation Unit		Division/Group			
Demobilization Unit	T. Shevenell	Division/Group			
GISS	T. Knecht	Division/Group			
FBAN	S. Volmer	Division/Group			
IMET	R. Walbrun	Division/Group			
Training Tech Spec	S. Vargas / I. Crossley (T)	<b>Air Operations Branch:</b>		<b>Director:</b>	B. Kremensky
		Air Support Group Supervisor		N. Matteoli	
		Air Tactical Group Supervisor			
<b>6. Logistics Section:</b>			Helibase Manager K. Hill		
Chief	S. Dohman				
Deputy Chief	J. Warden	<b>8. Finance/Administration Section:</b>			
Supply Unit	P. Lee	Chief	G. Belk		
Facilities Unit	B. Luiz / J. Peckham	Deputy Chief	R. Browne		
Ground Support Unit	J. Luckenbach	Time Unit	J. Navarro		
Communications Unit	J. Brooks / M. Heyfron (T)	Procurement Unit	J. Andrade		
Medical Unit	S. McGary	Comp/Claims Unit	B. Stirton		
		Cost Unit	J. Tapia		
<b>Prepared By: Name:</b> A. Mitchell		<b>Position/Title:</b> PSC		<b>Signature:</b> 	
<b>ICS 203</b>		<b>Date/Time:</b> 7/7/2020 2300 hours			





## Crews Fire Weather Forecast



**FORECAST NO:** 1  
**PREDICTION FOR:** Weds-Thurs am  
**SHIFT DATE:** 0700 7/8-0700 7/9  
**TIME AND DATE**  
**FORECAST ISSUED:** 1900 7/7/2020

**NAME OF FIRE:** Crews CA-SCU-004686  
**UNIT:** CalFire-Santa Clara  
**SIGNED:** Ryan Walbrun-IMET WFO Monterey  
**Incident Meteorologist** *Ryan Walbrun*

**WEATHER DISCUSSION:** No big weather changes forecast for Wednesday's operational period. A 1500 foot deep marine layer will cover the lower portions of the fire but clouds may only be patchy to start the day. Full sunshine will prevail by 0900 hours Wednesday. High temperatures will warm into the mid 80s with afternoon humidity falling to around 25-30%. Afternoon winds will be from the southwest with gusts 15-20 mph. Winds will remain gusty through sunset, strongest higher elevations of Branch III. As the marine layer surges in overnight expect good humidity recovery over most of the fire below 1500 feet. However the highest locations above the marine layer may see little or no humidity recovery overnight into Thursday morning as high pressure begins to build.

### **WEATHER FORECAST WEDNESDAY:**

**WEATHER:** A few morning clouds lower slopes otherwise sunny through the day.

**TEMPERATURES:** Warming into the mid 80s during the afternoon hours.

**HUMIDITY:** Lowering 25-30%, driest above 1500 feet in Branch III

**20 FT WINDS:**

**RIDGETOP -** Southwest 5 mph increasing 6-12 mph afternoon with gusts 15-20 mph

**SLOPE/VALLEY -** Light through midday then West to Southwest 4-8 mph gusts 12 mph.

**STABILITY/INVERSION:** Marine inversion around 1500 feet in the morning, mixing out by late morning.

### **WEATHER FORECAST FOR WEDNESDAY NIGHT:**

**WEATHER:** Clear through 10 pm then a few clouds lower slopes overnight.

**TEMPERATURES:** Overnight lows 50-55 except 55-60 above 1500 feet.

**HUMIDITY:** Good recovery 60-80% lower slopes except 50-60% above 1500 feet.

**20 FT WINDS:**

**RIDGETOP -** Southwest 7-12 mph evening gusts 20 mph easing after 10 pm.

**SLOPE/VALLEY -** Southwest 5-10 mph gusts 15 mph thru sunset then light overnight.

**STABILITY/INVERSION:** Marine inversion 1200 feet overnight lowering to 1000 feet by morning.

**EXTENDED FORECAST:** High pressure will strengthen Thursday through the weekend with a warming and drying trend. Highs in the lower 90s with humidity to around 20%. Light winds except afternoon westerly seabreeze following Hwy 152 corridor.

**SAFETY MESSAGE:** Be mindful of rapidly **lowering** humidity during the overnight hours for elevations above 1500 feet. This occurs as the marine layer hits the lower slopes.

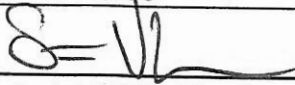

# FIRE BEHAVIOR FORECAST

<b>FORECAST NUMBER:</b> 2	<b>TYPE OF FIRE:</b> WILDLAND
<b>FIRE NAME:</b> CREWS	<b>OPERATIONAL PERIOD:</b> JULY 8 0700-0700
<b>DATE ISSUED:</b> July 7, 2020	<b>TIME ISSUED:</b> 20:00
<b>UNIT:</b> Santa Clara	<b>SIGNED:</b> 
<b>Typed/printed:</b> FBAN Stephen Volmer	

## INPUTS

**WEATHER SUMMARY:** Early morning light down canyon downslope winds transitioning to more breezy conditions beginning in the afternoon and lasting through sundown. Temperatures will begin cooling over the next few days, with good overnight relative humidity recovery in the lower elevations. Expect temperatures to return to normal levels beginning Thursday.

Daytime high temperature mid 80s degrees, decreasing to 50 degrees in the evening. Minimum relative humidity will be 30% during the day, and increase up to 80% overnight. Winds will be Southwest 5-10 with gusts to 15 possible throughout the entire shift

\*\*\*Limited overnight humidity recovery and warmer temperatures above 1500' elv\*\*\*

## OUTPUTS

### FIRE BEHAVIOR

**GENERAL:** Fuels have continued to dry out but are still below critical levels. Expect ignitions to occur easily with dangerous fire spread rates when in alignment with wind, slope, and topography throughout the area. An inversion will set in over night and keep light fuels above 1500' dry and very receptive to any ignition source.

### SPECIFIC:

**GRASS:** Rate of Spread....100 ft/min Flame Length....6 ft Spotting....1/4 mi Probability of Ignition 70%

**SHRUB:** Rate of Spread....20 ft/min Flame Length....7 ft Spotting....1/4 mi Probability of Ignition 70%

**OAK UNDERSTORY:** Rate of Spread....3 ft/min Flame Length....1.5 ft Spotting....1/4 mi Probability of Ignition 70%

Divisions M, P, and S have very steep terrain with heavy canopy cover, which has produced a very dirty burn. Be alert for deep seated heat, stump holes in the duff layer, fire weakened branches, and rolling material.

Sunset 7/8...20:28 Sunrise 7/9...05:55

**AIR OPERATIONS:** Limited visibility in the lower elevations of the fire early in the morning due to inversion setting in. Inversion will break apart by late morning allowing for increased visibility. Expect gusty Southwest winds over the ridgetops 15-20mph.

## SAFETY

Watch out for fire weakened branches and trees while working in and around the oak overstory

Be alert for unburned fuel between you and the fire



## SAFETY MESSAGE/PLAN (ICS 208)

<b>1. Incident Name:</b> CREWS	<b>2. Operational Period:</b>	Date From: 7/8/20 Time From: 0700	Date To: 7/9/20 Time To: 0700
-----------------------------------	-------------------------------	--------------------------------------	----------------------------------

S  
A  
F  
E  
T  
Y  
  
S  
A  
F  
E  
T  
Y  
  
S  
A  
F  
E  
T  
Y  
  
S  
A  
F  
E  
T  
Y

Practice social distancing of 6 ft or greater. Daily self-assessment is key, report negative findings to your supervisor. Wear a mask when in public.

Avoid complacency, potential for extreme fire behavior due to low live and dead fuel moistures is present.

Maintain hydration and nutruiton, monitor each other for signs of fatigue and general illness.

Ensure radios are properly programmed for today's IAP and that crews are trained in communications procedures for the incident.

Ensure that all resources working on the incident receive a briefing.

Steep winding roads are throughout the incident. Slow down when driving on loose gravel and blind curves. Drive defensively with headlights on and use hands free devices.

HEADS UP! Lookout for SNAGS when working around areas with burned trees. Evaluate all wind damaged trees with large limbs before working under and around them.

Wash hands often with soap and water for a minimum of 20 seconds. Keep hand sanitizer nearby. Disinfect vehicle and any PPE often.

I  
T  
S  
U  
P  
T  
O  
Y  
O  
U  
!  
!  
!  
!  
!  
!  
!  
!  
!

5. Prepared By: J. Segura / J. Novak (T)	Position/Title: SOFR	<i>Jorge H. Segura</i>
ICS 208	Date/Time: 7/7/2020 2000	

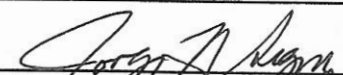

## INCIDENT ACTION PLAN SAFETY ANALYSIS (ICS 215A)

<b>1. Incident Name:</b> CREWS	<b>2. Operational Period:</b>	Date From: 7/8/20 Time From: 0700	Date To: 7/9/20 Time To: 0700
<b>Incident Area</b>	<b>Hazard/Risks</b>	<b>Mitigations</b>	
ALL	FATIGUE	Be alert for signs of fatigue and take breaks as necessary. Drink water before, during and after your shift. Be alert for signs of heat disorder in yourself and others.	
ALL	COVID-19	Practice social distance of 6 ft or greater. Maintain constant hygiene & handwashing. Wear mask when you can't provide for 6ft distance.	
ALL	WEATHER	Be thoroughly familiar with weather predictions and monitor conditions on the ground for changes. Carry proper equipment.	
ALL	DEHYDRATION	Drink water before, during, and after your shift. Logistics will have water available.	
ALL	ANIMAL ATTACK	Keep distance from animals and identify aggressive animals. Be mindful of any injuries that could develop into infection.	
ALL	DRIVING HAZARDS	Drive defensively! Expect the unexpected around every turn. Drive with headlights on, use wheel chocks and always look before backing. Increase following distances on dusty roads.	
<b>5. Prepared By:</b>		Position/Title: SOFR	
ICS 215A	Date/Time: 7/7/2020 / 2030		

# County of Santa Clara

Public Health Department



## COVID-19 SPECIFIC:

### What are the symptoms of the novel coronavirus?

- Symptoms include fever, fatigue, cough, loss of taste or smell, and aches
- The illness can progress to shortness of breath and complications from pneumonia
- Symptoms may also include nausea with vomiting and diarrhea. Some infected patients experience only mild symptoms while others – particularly older individuals and those with underlying health conditions – might develop more severe symptoms
- If you have any of these symptoms, please talk to YOUR LOCATION's Safety Officer

### How can I best protect myself from getting the novel coronavirus?

- Use proper hygiene including washing hands with soap and or using hand sanitizers
- Avoid touching your face, particularly your eyes, nose, and mouth because one-way viruses spread is when you touch your mouth, nose, or eyes
- Cough or sneeze into a tissue, sleeve, or arm--Do not use your hands
- Clean frequently touched surfaces such as countertops and doorknobs
- Keep away from others who are sick
- Stay home when you are sick

### What should I do if I do not feel Well?

- If you have a fever, go home immediately and stay there until at least three days **after** the fever goes away naturally without the use of fever-reducing medicine, assuming that you have not tested positive for COVID-19. (For example: if your fever lasts for three days, you should stay home for at least six days)
- If you have a fever and any of the symptoms listed above, you should self-isolate at home and consult with your doctor.
- Consider not attending or hosting large gatherings. This is where cold, flu, and other respiratory viruses are often spread.















# ASSIGNMENT LIST (ICS 204 WF)

CONTROLLED UNCLASSIFIED  
INFORMATION//BASIC

<b>1. Incident Name:</b> <p style="text-align: center; font-size: 1.2em;"><b>CREWS</b></p>	<b>2. Operational Period:</b> Date From: 07/08/20    Date To: 07/09/20 Time From: 0700    Time To: 0700	<b>3. Branch</b> <b>Division</b> <p style="text-align: center; font-size: 1.5em;">III                      S</p> <p style="text-align: center;">Page 1 of 1              Sierra</p>
-----------------------------------------------------------------------------------------------	---------------------------------------------------------------------------------------------------------------	----------------------------------------------------------------------------------------------------------------------------------------------------------------------------------------

<b>4. Operations Personnel:</b> Operations Section Chief: <b>T. Ernst / R. Janssen</b>		Night Ops: <b>S. Lauderdale</b>
Branch Director: <b>S. Lane / L. Kalfsbeek (T)</b>		Branch Safety:
Division/Group Supervisor: <b>B. Muenzer / G. Groneman (T)</b> <i>M. Maynard</i>		Air Attack:

<b>5. Resources Assigned:</b>		<b>** Resources Below in Bold are 12 Hour **</b>					
Resource Identifier	ALS	LWD	Leader	Personnel	Request #	Hours	Reporting Location
<del>STC LNU 9144C</del>			<del>S. Weese</del>	<del>17</del>	<del>E-65</del>	0700-0700	JAMIESON X CANADA
<b>STC SHF 3675C</b>			<b>L. Hagedon</b>	<b>27</b>	<b>E-32</b>	<b>0700-1900</b>	<b>JAMIESON X CANADA</b>
CRW CZU FELTON 17			R. Quann	15	C-13	0700-0700	JAMIESON X CANADA
STG FKU 9434G			R. Flemming	33		0700-0700	JAMIESON X CANADA
STG TCU 9444G			J. Bishop	33	C-26	0700-0700	JAMIESON X CANADA
<del>STL MEU 9148L</del>			<del>K. Taglio</del>	<del>8</del>	<del>E-44</del>	0700-0700	JAMIESON X CANADA
WT PVT E-78			C. Avila	2	E-78	0700-0700	JAMIESON X CANADA
WT PVT E-83			T. Kelly	2	E-83	0700-0700	JAMIESON X CANADA
<i>STC SCU 916DL</i>			<i>C. Lollins</i>	<i>18</i>	<i>E-64</i>		
<i>STC MEU 9110G</i>			<i>M. Maynard</i>	<i>16</i>	<i>E-66</i>		
<i>CRW BEU Gabilan 3</i>			<i>W Gray</i>	<i>12</i>	<i>C-3</i>		

**6. Work Assignments**  
Construct and hold line utilizing direct tactics.  
Improve direct fire line. Mop up 100' in from control line.

**7. Special Instructions:**  
P-Number PNM8V1/1502 for USFS

<b>8. Communications</b>							
Name	Ch	Function	Rx Freq	Rx Tone	Tx Freq	Tx Tone	Notes
NIFC C9	3	COMMAND	170.0125N	T1 - 110.9	165.2500N	T1 - 110.9	PACHECO PEAK
VFIRE 26	8	TACTICAL	154.3025N	T6 - 156.7	154.3025N	T6 - 156.7	BRANCH III
CDF T15	14	AIR TO GROUND	159.2700N	T16 - 192.8	159.2700N	T16 - 192.8	AIR TO GROUND
CALCORD	15	MEDICAL	156.0750N	T6 - 156.7	156.0750N	T6 - 156.7	MEDICAL COORDINATION
GUARD7	16	AIRGUARD	168.6250N		168.6250N	T1 - 110.9	EMERGENCY USE ONLY

<b>9. Prepared by: Name:</b>	M. Selzer	RESL	Signature: <i>Matt</i>
<b>ICS 204</b>	Date/Time: 7/7/2020	2200	Personnel Count: 137

# ASSIGNMENT LIST (ICS 204 WF)

CONTROLLED UNCLASSIFIED  
INFORMATION//BASIC

<b>1. Incident Name:</b> <p style="text-align: center; font-weight: bold;">CREWS</p>	<b>2. Operational Period:</b> Date From: 07/08/20      Date To: 07/09/20 Time From: 0700              Time To: 0700	<b>3. Branch</b> <b>Division</b> <p style="text-align: center; font-weight: bold;">Suppression Repair</p>
-----------------------------------------------------------------------------------------	---------------------------------------------------------------------------------------------------------------------------	------------------------------------------------------------------------------------------------------------------

<b>4. Operations Personnel:</b>		Page 1 of 1
Operations Section Chief: <b>T. Ernst / R. Janssen</b>	Night Ops: <b>S. Lauderdale</b>	
Branch Director:	Branch Safety:	
Division/Group Supervisor:	Air Attack:	

<b>5. Resources Assigned:</b>		<b>** Resources Below in Bold are 12 Hour **</b>					
Resource Identifier	ALS	LWD	Leader	Personnel	Request #	Hours	Reporting Location
DOZ PVT E-35			<b>T. Scramtim</b>	2	<b>E-35</b>	0700-1900	CHRISTMAS HILL PARK
DOZ PVT E-41			<b>C. Avila</b>	2	<b>E-41</b>	0700-1900	CHRISTMAS HILL PARK
CHIP PVT E-184			<b>J. Hagins</b>	2	<b>E-184</b>	0700-1900	CHRISTMAS HILL PARK
WT PVT E-92			<b>M. Rocca</b>	2	<b>E-92</b>	0700-1900	CHRISTMAS HILL PARK
WT PVT E-111			<b>J. Walter</b>	2	<b>E-111</b>	0700-1900	CHRISTMAS HILL PARK
FOBS FAZIO			<b>J. Fazio</b>	1	<b>O-26</b>	0700-1900	CHRISTMAS HILL PARK
FOBS ORME			<b>M. Orme</b>	1	<b>O-79</b>	0700-1900	CHRISTMAS HILL PARK
FOBS (T) MACKEWICZ			<b>N. Mackewicz</b>	1	<b>O-10</b>	0700-1900	CHRISTMAS HILL PARK

**6. Work Assignments:**  
 Identify suppression repair needs.  
 Knock down Dozer berms.  
 Water bar dozer line per FSR needs.

**7. Special Instructions:**  
 If working in Branch III utilize NIFC C9 for command.

<b>8. Communications</b>							
Name	Ch	Function	Rx Freq	Rx Tone	Tx Freq	Tx Tone	Notes
NIFC C1	2	COMMAND	170.9750N	T1 - 110.9	168.7000N	T1 - 110.9	LOMA MUJERAS HP
CDF T35	9	TACTICAL	159.3225N	T16 - 192.8	159.3225N	T16 - 192.8	
CDF T15	14	AIR TO GROUND	159.2700N	T16 - 192.8	159.2700N	T16 - 192.8	AIR TO GROUND
CALCORD	15	MEDICAL	156.0750N	T6 - 156.7	156.0750N	T6 - 156.7	MEDICAL COORDINATION
GUARD7	16	AIRGUARD	168.6250N		168.6250N	T1 - 110.9	EMERGENCY USE ONLY

<b>9. Prepared by: Name:</b>	M.Selzer	RESL	Signature:
ICS 204	Date/Time: 7/7/2020	2200	Personnel Count: 13



# ASSIGNMENT LIST (ICS 204 WF)

CONTROLLED UNCLASSIFIED INFORMATION//BASIC

<b>1. Incident Name:</b> <b>CREWS</b>	<b>2. Operational Period:</b> Date From: 07/08/20      Date To: 07/09/20 Time From: 0700              Time To: 0700	<b>3. Branch</b> <b>Division</b>  <b>Staging</b>
<b>4. Operations Personnel:</b>		Page 1 of 1

Operations Section Chief: <b>T. Ernst / R. Janssen</b>	Night Ops: <b>S. Lauderdale</b>
Branch Director:	Branch Safety:
Division/Group Supervisor: <b>J. Smith</b>	Air Attack:

Resource Identifier	** Resources Below in Bold are 12 Hour **					Hours	Reporting Location
	ALS	LWD	Leader	Personnel	Request #		
						<b>0700-1900</b>	<b>CHRISTMAS HILL PARK</b>

**6. Work Assignments:**  
Maintain 3 minute response time.  
Monitor command frequencies.

**7. Special Instructions:**

8. Communications							
Name	Ch	Function	Rx Freq	Rx Tone	Tx Freq	Tx Tone	Notes
NIFC C1	2	COMMAND	170.9750N	T1 - 110.9	168.7000N	T1 - 110.9	LOMA MUJERAS HP
CDF T15	14	AIR TO GROUND	159.2700N	T16 - 192.8	159.2700N	T16 - 192.8	AIR TO GROUND
CALCORD	15	MEDICAL	156.0750N	T6 - 156.7	156.0750N	T6 - 156.7	MEDICAL COORDINATION
GUARD7	16	AIRGUARD	168.6250N		168.6250N	T1 - 110.9	EMERGENCY USE ONLY

**9. Prepared by: Name:** M. Selzer                  RESL                  Signature: *Matt Selzer*

ICS 204                  Date/Time: 7/7/2020      2200                  Personnel Count: 0

**AIR OPERATIONS SUMMARY ICS-220**

Incident Name / Number  
CREWS / CA-SCU-004686

Sunrise 5:54  
Startup 6:24  
Cutoff 19:58  
Sunset 20:28

General Remarks, Safety Notes, Hazards, Air Operations Special Equipment, etc.  
 TRACK ALL DIPSITE LOCATIONS / NUMBER OF DIPS / GALLONS TAKEN.  
 TRACK ALL DROP LOCATIONS / NUMBER OF DROPS / GALLONS DROPPED  
 ALL GPS DATA TO BE COLLECTED IN DEGREES, MINUTES, DECIMAL MINUTES FORMAT.  
 AVOID Aerial Application of Retardant / Foam / Agent within 300' of Waterways, Bodies of Water, etc.  
 If Retardant / Foam / Agent is Dropped Within These Areas Immediately Notify the AOB and Provide the Following Information: Lat / Long, Estimated Number of Gallons and a Map Detailing The Area.

Time Prepared  
1500

Shutdown  
20:58

Helibase Information  
Name San Martin  
Latitude 37 04 53.07  
Longitude 121 35 48.5

Name  
Latitude  
Longitude  
(use page 2 if needed)

Date Prepared  
Tuesday, July 7, 2020

Operational Period - Date  
Wednesday July 8, 2020

TFR Information  
Request # A-38  
Radius: 5 NM  
Altitude: 5,500 MSL  
Centerpoint: 37 00.42 Lat  
121 27.20 Long

NOTAMS: 8/6883  
Frequency 125.8250  
<http://tfr.faa.gov/tfr-2/list.html>

Prepared By  
Burke Kremensky

Operational Period - Time  
0700-2100

Rescue Ship Information  
Name 840  
Phone (650)245-1715  
Make/Model UH-60G  
Location San Martin

Night Helist 840  
Request Procedure for These Aircraft:  
Incident Communications  
See Medical Plan For Additional Info

Your Sunrise and Sunset info has not been updated for the current Op period

Update

Frequencies	TX	Tone	RX	Tone	AM / FM	Position	Name	Phone	Trainee	Phone
Command	151.3550	103.5000	151.3550N	T8 - 103.5	FM	AOBD	B. Kremensky			
AIR / GROUND - TACTICAL	159.2700	192.8000	159.2700	192.8000	FM	ASGS	N. Mateoli			
AIR/AIR ROTARY WING	125.8250		125.8250		AM	HEBM	K. Hill			
Helico Briefing										
AIR TACTICS	169.2875		169.2875		FM					
Air Attack Briefing					AM		Lejuan/Remmer			
TOLC	123.0250		123.0250		AM					
DECK	163.1000		163.1000		FM					
CALCORD - MEDICAL	156.0750	156.7 (6)	156.0750	156.7 (6)	FM					
AIRGUARD - Emergency Only	169.6250	110.9 (1)	169.6250		FM					

**HELICOPTERS ( Use page 2 if Needed )**

FAA #	Type	Make/Model	Helibase	Avail	Start	Remarks	FAA #	Type	Make/Model	Helibase	Avail	Start	Remarks
242BH	III	206L3	San Martin	0800	0830	Helico/Recon							
4TV	III	AS350B	San Martin	0800	0830	Helico/Recon							
370FG	II	UH1H	San Martin	0800	0830	Bucket, LL, Restricted							
316LH	II	B212S	San Martin	0800	0830	Bucket, LL, Standard							
811KA	II	BH212HP	San Martin	0800	0830	Bucket, LL, Standard							
62BH	I	UH60A	San Martin	0800	0830	Bucket, LL							
135BH	I	S70A	San Martin	0800	0830	Tank							
N51BH	I	HH-60L	San Martin	0800	0830	Bucket, LL							

**FIXED WING ( Use Page 2 if Needed )**

FAA #	Type	Make/Model	Base	Avail	Start	Remarks	FAA #	Type	Make/Model	Base	Avail	Start	Remarks



# ICS 205 - INCIDENT RADIO COMMUNICATIONS PLAN

CONTROLLED UNCLASSIFIED  
INFORMATION//BASIC

<b>1. Incident Name:</b> <p style="text-align: center;"><b>CREWS</b> <b>Incident Channels</b></p>			<b>2. Date/Time Prepared</b> Date: 07/07/2020 Time: 1930			<b>3. Operational Period:</b> Date From: 07/08/20      Date To: 07/09/20 Time From: 0700              Time To: 0700		
<b>4. Communications</b>								
Ch#	Function	Name	Assigned To	Rx Freq	Rx Tone	Tx Freq	Tx Tone	Notes
1								
2	COMMAND	NIFC C1	BRANCH I	170.9750N	T1 - 110.9	168.7000N	T1 - 110.9	LOMA MUJERAS HP
3	COMMAND	NIFC C9	BRANCH III	170.0125N	T1 - 110.9	165.2500N	T1 - 110.9	PACHECO PEAK
4								
5	TACTICAL	CDF T26	DIV A/Y & DIV D	159.2925N	T16 - 192.8	159.2925N	T16 - 192.8	BRANCH I
6	TACTICAL	CDF T28	DIV M	151.1825N	T16 - 192.8	151.1825N	T16 - 192.8	BRANCH III
7	TACTICAL	VFIRE 25	DIV P	154.2875N	T6 - 156.7	154.2875N	T6 - 156.7	BRANCH III
8	TACTICAL	VFIRE 26	DIV S	154.3025N	T6 - 156.7	154.3025N	T6 - 156.7	BRANCH III
9	TACTICAL	CDF T35	SUPP REPAIR	159.3225N	T16 - 192.8	159.3225N	T16 - 192.8	
10								
11								
12								
13	TACTICAL	VTAC14	RADIO BRIEFING	159.4725N	T6 - 156.7	159.4725N	T6 - 156.7	
14	AIR TO GROUND	CDF T15	ALL BRANCHES	159.2700N	T16 - 192.8	159.2700N	T16 - 192.8	AIR TO GROUND
15	MEDICAL	CALCORD	ALL BRANCHES	156.0750N	T6 - 156.7	156.0750N	T6 - 156.7	MEDICAL COORDINATION
16	AIRGUARD	GUARD7	ALL BRANCHES	168.6250N		168.6250N	T1 - 110.9	EMERGENCY USE ONLY
17								
18								
19								
20	AIRGUARD	GUARD7	ALL BRANCHES	168.6250N		168.6250N	T1 - 110.9	EMERGENCY USE ONLY
<b>5. Special Instructions</b>								
TO CONFIRM YOU HAVE THE MOST CURRENT CLONE, ENSURE YOUR DISPLAY OF CHANNEL 16 OR 20 MATCHES CHANNEL 16 OR 20 OF THE 205 - HEIGHT AND POWER ARE KEY WHEN USING RADIOS; BE AT A HIGH POINT, USE A MOBILE IF POSSIBLE, AND USE RADIO RELAYS WHEN NEEDED								
<b>6. Prepared by (Communications Unit Leader): Name: JOHN BROOKS, IMT 6 COML</b>						Signature: 		
ICS 205 - CONTROLLED UNCLASSIFIED INFORMATION//BASIC					<small>NIMS IAP</small>	Date/Time: 07/07/20 1930		

The Operational  
Briefing will be  
broadcast at **0700** on  
**VTAC14**



## MEDICAL PLAN (ICS 206)

<b>1. Incident Name:</b> <p style="text-align: center; margin: 0;">CREWS</p>		<b>2. Operational Period:</b> Date From: 7/8/20 Date To: 7/9/20 Time From: 0700 Time To: 0700					
<b>3. Medical Aid Stations:</b>							
Name	Location	Contact Number/Freq	Paramedics				
CAL MAT	ICP	916-247-1940/Crews Comms	Yes				
<b>4. Transportation (indicate air or ground):</b>							
Ambulance Service	Location	Contact Number	Level of Service				
AMR Santa Clara Medic 50 (Ground)	Canada and HWY152	Crews Comms	ALS				
AMR Santa Clara Medic 58 (Ground)	Canada and HWY 152	Crews Comms	ALS				
CAL STAR (Air)	Gilroy	Crews Comms	ALS				
<b>5. Hospitals:</b>							
Hospital Name	Address,	Contact Number(s)/ Frequency	Travel Time		Trauma Center	Burn Center	Helipad
	Lat & Long		Air	Ground			
Saint Louise Regional Med	9400 No Name Uno, Gilroy, CA Lat/Long: N37.02.13, W121.34.27	(408)848-8680	5 MIN	10 MIN		<input type="checkbox"/>	<input checked="" type="checkbox"/>
Regional Medical Center	225 North Jackson Ave., San Jose, CA 95116-1691, Lat/Long: N37.18.85, W121.56.05	(408) 259-5000	10 MIN	30 MIN	Level 2	<input type="checkbox"/>	<input checked="" type="checkbox"/>
Santa Clara Valley Medical Center	751 S. Bascom Ave., San Jose, CA 95128, Lat/Long: N37.18.85, W121.56.05	(408) 885-5000	10 MIN	40 MIN	Level 1	<input checked="" type="checkbox"/>	<input checked="" type="checkbox"/>
<b>6. Special Medical Emergency Procedures</b>							
<b>Line Emergency</b> Crew Supervisor will contact Division Supervisor with patient complaint/condition and location. - Division Group Supervisor Contacts: 1. Closest EMS resource 2. Communications Unit - Communications Unit Contacts: 1. Ground or Air ambulance as requested. 2. Operations 3. Safety 4. Medical Unit - Division Supervisor or designee will serve as point of contact and run medical emergency on assigned channel. 1. A pre-assigned tactical frequency (i.e. CALCORD) should be used for IWI and only for duration of the emergency. - Communications Unit will clear the Command channel for emergency traffic as needed for duration of the need.				<b>Injury Reporting Procedures</b>  Nature of Injury: _____ Location of Patient: _____ Point of Contact: _____ Transportation Requested by: Air _____ Ground _____ Point of Pick-Up: _____ Lat: _____ Long: _____ Patient Unit ID: _____ Is an EMT with Patient: Yes _____ No _____ Age: _____ Sex: Male _____ Female _____			
<b>Camp Emergency</b> Contact Medical Unit with patient complaint/condition and location. Medical staff will respond to stabilize the patient. - Medical Unit contacts 1. Communications 2. Safety 3. Logistics 4. Operations 5. Crew Supervisor 6. Comp/Claims				<b>All Emergencies - Secure the area and identified witnesses for later investigation. Keep accurate log of events.</b>			
<input type="checkbox"/> Check box if aviation assets are utilized for rescue. If assets are used, coordinate with Air Operations.							
<b>7. Prepared by (Medical Unit Leader):</b> <p style="text-align: center;">S. McGary</p>				Signature:			
<b>8. Approved by (Safety Officer):</b> <p style="text-align: center;">J. Segura / J. Novak (T)</p>				Signature:			
ICS 206		NIMS IAP		Date/Time:		7-7-20 1800	

# **TRAINEES**

**Welcome to the  
Crews Incident!**

**PLEASE STOP BY THE  
TRAINING SPECIALIST OFFICE TO  
START THE DOCUMENTATION  
PROCESS**

**Any questions please contact the  
Training Specialist:  
Shane Vargas (530) 410-4225**



# DEMobilIZATION INSTRUCTIONS

Crews Incident  
CA-SCU-004686

## DEMOb PROCEDURES

- CHECK THE DEMOB LIST EACH MORNING. YOU CAN FIND THE DEMOB LIST THROUGH THE "QR" CODE ON THE I.A.P. COVER OR ON LISTS POSTED THROUGHOUT CAMP. ONLY REPORT TO DEMOB AT YOUR SCHEDULED TIME. EARLY ADMITTANCE WILL NOT BE ALLOWED.

- FLIGHT ARRANGEMENTS MUST BE MADE 48HRS PRIOR TO RELEASE.

- REPORT TO DEMOB AT APPOINTMENT TIME TO RECEIVE A CHECKOUT FORM (ICS-221), THEN GO TO THE FOLLOWING UNITS TO OBTAIN THE NECESSARY SIGNATURES:
  - ✓ SUPPLY UNIT
  - ✓ COMMUNICATIONS UNIT
  - ✓ GROUND SUPPORT/VEHICLE INSPECTION\*\*\*
  - ✓ DOCUMENTATION UNIT
  - ✓ TIME UNIT
  - ✓ TRAINING UNIT (IF APPLICABLE)
  - ✓ ACCOMMODATIONS (IF APPLICABLE)

### \*\*\*VEHICLE INSPECTION:

- THE DEMOB UNIT WILL INFORM YOU IF THE VEHICLE NEEDS TO BE INSPECTED.
- YOU MUST HAVE THE ICS-221 DEMOB FORM WITH YOU AT VEHICLE INSPECTION.
- A VEHICLE INSPECTION TIME WILL BE PROVIDED WHEN YOU INITIALLY ARRIVE TO THE DEMOBILIZATION UNIT.
- DO NOT REPORT FOR VEHICLE INSPECTION PRIOR TO YOUR APPOINTMENT

HAVE YOUR EQUIPMENT INVENTORY CARD READY WHEN HEADING TO VEHICLE INSPECTION.

RETURN THE COMPLETED ICS-221 FORM TO THE DEMOB UNIT AND TRAVEL HOME SAFE!



# PUBLIC INFORMATION



## Official Sources of Public Information

**Incident Information Line: (530-645-9663)**

**Incident Media Line: (530-645-9798)**

**Incident Website: [www.fire.ca.gov](http://www.fire.ca.gov)**

**Email Signup: <https://tinyurl.com/CALFIREMEDIA>**

## Media Law

The California State Penal Code Section 409.5(d) allows the news media to enter scenes of disaster, riot, or civil disturbance. Properly identified members of the news media should not be restricted from entering locations specified within the code. However, this does not include crime scenes, and does not imply that the news media may interfere with incident operations while they are in the areas of concern. If entering such a location that is hazardous, they should be advised; media access cannot be prevented for safety reasons unless their presence would impede CAL FIRE's mitigation of the incident or the disturbing of evidence. When working around the media, remember:

- Media is not permitted on private property without the property owners permission.
- If approached and questioned by the media and or the public, talk about your assignment or task at hand. Remember to wear all the appropriate PPE.
- If needed call for an incident PIO through the chain of command.
- Never speculate, give opinions or speak for others.
- There is no such thing as an "off the record" comment.

## CAL FIRE Social Media Policy (Social Media 0691)

Social Media is increasingly being used by public agencies, the media as well as the public. This form of communication continues to grow rapidly in order to supply the instant gratification needs of society. Therefore when on a CAL FIRE incident you will adhere to the CAL FIRE Social Media Policy, 0691. You can get further information about the CAL FIRE Social Media Policy from the incident Public Information Officer. While assigned to the incident, there will be no posting of:

- Inappropriate information or materials
- No opinions
- No endorsements
- Inappropriate pictures or videos

## Lost and Found

The Information Section will manage Lost and Found items for the incident. If you have lost an item leave your contact information and what you have lost at the Information Section. If you have found an item on the incident bring the item to the Information Section with your contact information as well.

## Incident Base Camp Mailing Address

**c/o Public Information Office/Trailer**  
**7050 Miller Ave**  
**Gilroy, CA 95020**  
**Christmas Hill Park**



# SHIFT TICKET EXAMPLE

EMERGENCY SHIFT TICKET and EVALUATION FORM				Contractor Name	
Incident or Project Name	Incident Number	Request Number	DOZER DUDE		
CREWS	CASCU 004686	E#	Operator #1	Operator #2	
Agreement Number	XXX - 000000 - 00		BOB SMITH	TOM SMITH	
Equipment Make	Equipment Model / Type		Operator Furnished By: <input type="checkbox"/> Government		
CAT	D6XM		Contractor <input checked="" type="checkbox"/> Contractor		
Serial Number	License Number		Operating Supplies Furnished By: <input type="checkbox"/> Government		
1111111	1111111		Equipment Status <input checked="" type="checkbox"/> Under Agreement		
Equipment Use			Remarks/Comments **		
Date	Start	Stop	Inspected		
Mo / Day	7/6	0700	Released by Government		
	0700	2400	Withdrawn by Contractor		
	7/7	0001	NO DAMAGE/ NO CLAIMS		
			2 OPERATORS		
			NO DAMAGE/ NO CLAIMS		
Vendor Rating			Govt. Rep. Name and Position - PRINT		
Poor*	Avg	Good	Mike Weber		
		Exc.	N/A		
Met Performance Expectations			Govt. Rep. Signature		
Equipment in Safe Working Condition			Mike Weber		
Operator Skill Level			Contractor Signature		
Operates Safely			Bob Smith		
Operator's Cooperation Level			Date		
Overall Performance			07/07/20		
			Time		
			0800		
			CALFIRE 297		
			(Rev 3-2011)		

\* NOTE: Any rating of POOR requires an explanation in Comment Section.  
 \*\*Final evaluation or for more documentation, use an ICS Form 230 or equivalent.

Pink - Finance Blue - Home Unit HE Coordinator Yellow - Vendor White - Govt Representative

EMERGENCY SHIFT TICKET and EVALUATION FORM				Contractor Name	
The responsible Government Officer will complete this form each shift				DUDE TRANSPORT	
Incident or Project Name	Incident Number	Request Number	Operator #1	Operator #2	
CREWS	CASCU 004686	E # Here	BOB SMITH	TOM SMITH	
Agreement Number	XXX - 000000 - 00		Operator Furnished By: <input type="checkbox"/> Government		
Equipment Make	Equipment Model / Type		Contractor <input checked="" type="checkbox"/> Contractor		
TRANSPORT/ KENWORTH	COZAD TRAILER /26 WHEELS		Operating Supplies Furnished By: <input type="checkbox"/> Government		
Serial Number	License Number		Equipment Status <input checked="" type="checkbox"/> Under Agreement		
1XP3ESMP14239012	99999999		Inspected		
Equipment Use			Released by Government		
Date	Start	Stop	Withdrawn by Contractor		
Mo / Day	7/6	0700	Remarks/Comments **		
	0700	2400	2 OPERATORS		
	7/7	0001	NO DAMAGE/ NO CLAIMS		
			Govt. Rep. Name and Position - PRINT		
Vendor Rating			Mike Weber		
Poor*	Avg	Good	Govt. Rep. Signature		
		Exc.	Mike Weber		
Met Performance Expectations			Contractor Signature		
Equipment in Safe Working Condition			Bob Smith		
Operator Skill Level			Date		
Operates Safely			07/07/20		
Operator's Cooperation Level			Time		
Overall Performance			0800		
			CALFIRE 297		
			(Rev 3-2011)		

\* NOTE: Any rating of POOR requires an explanation in Comment Section.  
 \*\*Final evaluation or for more documentation, use an ICS Form 230 or equivalent.

Pink - Finance Blue - Home Unit HE Coordinator Yellow - Vendor White - Govt Representative

Turn shift tickets into Finance.

# CREWS INCIDENT BASE CAMP MAP

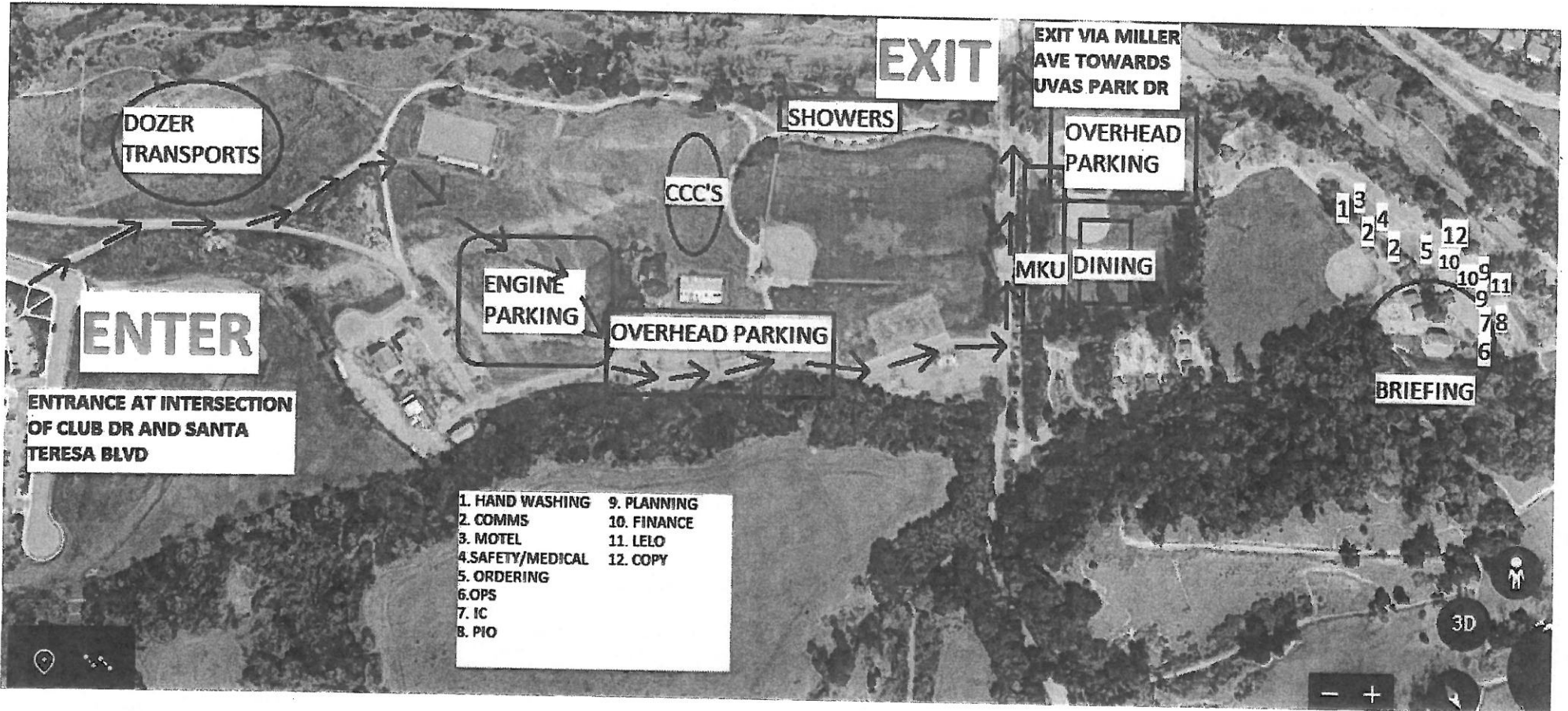



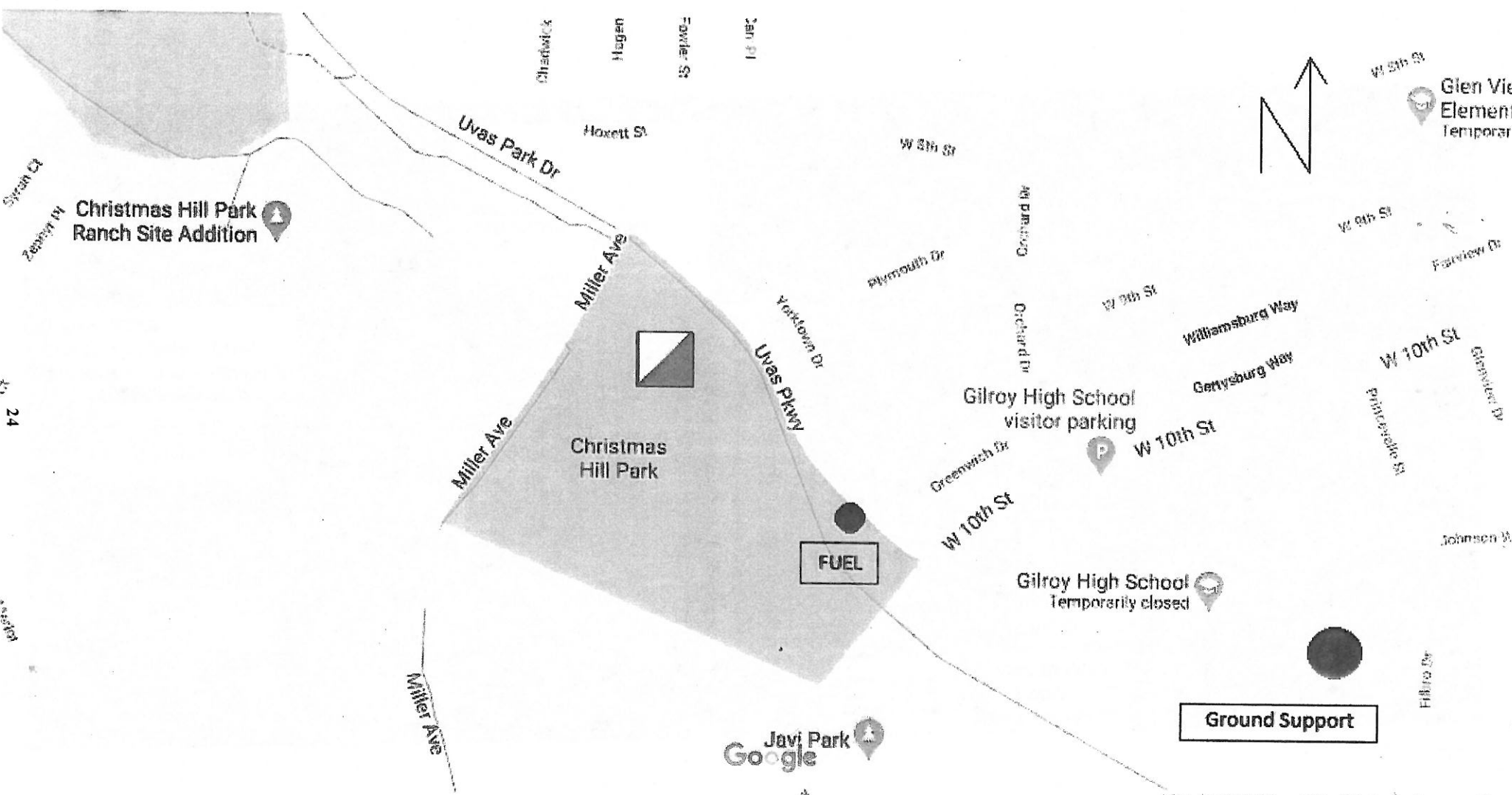

Sycamore Ct  
Zephyr Pl

24

Miller Ave

Shadwick  
Hagen  
Fowler St  
Jan Pl

Haxett St

W 8th St



W 5th St

Glen Vie  
Element  
Temporar

W 9th St

Farview Dr

Uvas Park Dr

Miller Ave

Yorktown Dr

Plymouth Dr

Orchard Dr

W 9th St

Williamsburg Way

Gertysburg Way

W 10th St

Glenview Dr

Christmas  
Hill Park

Gilroy High School  
visitor parking

W 10th St

Pharoside St

FUEL

Greenwich Dr

W 10th St

Johnson W

Gilroy High School  
Temporarily closed

Ground Support

Hilltop Dr

Javi Park

Google

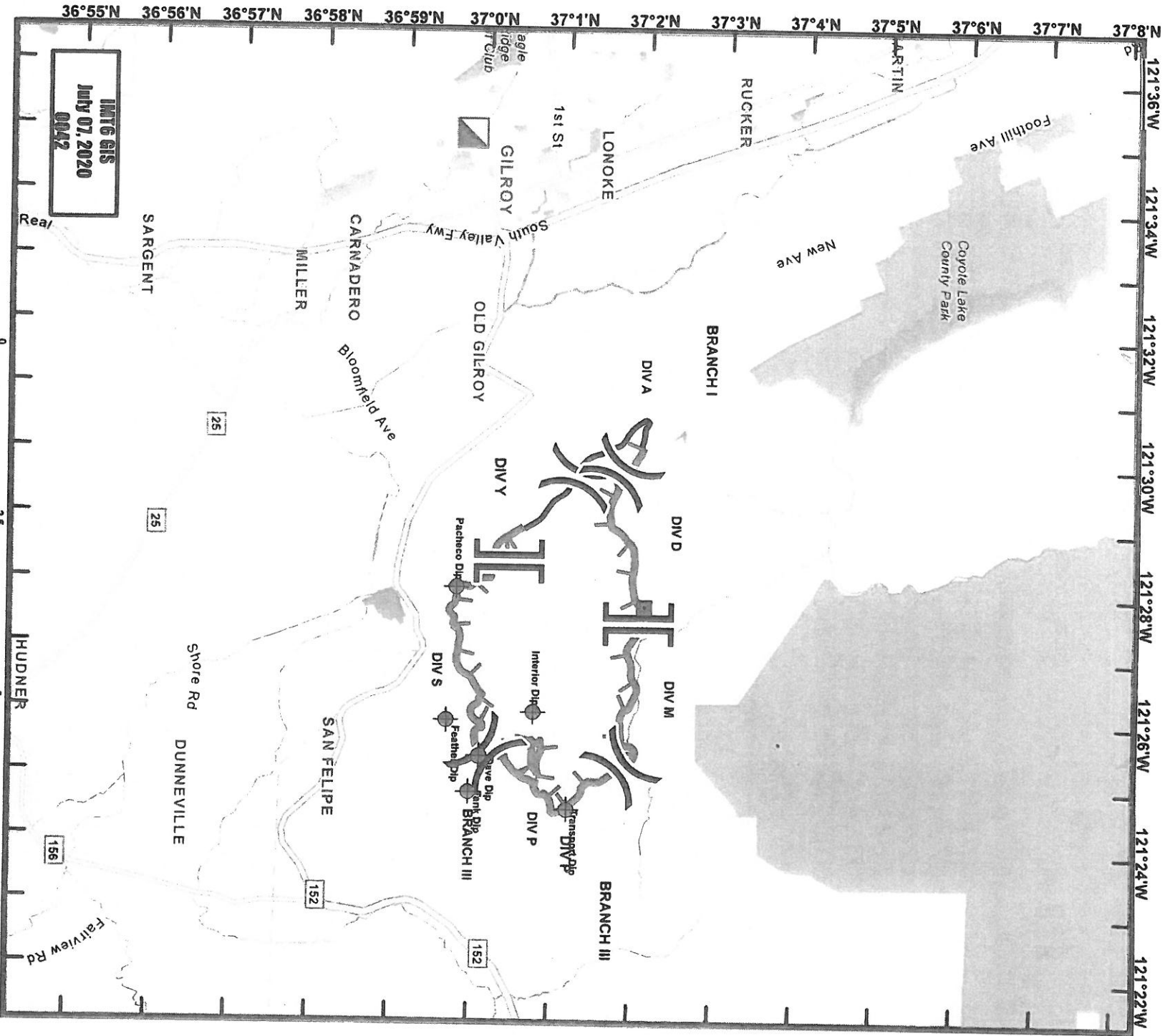

IMT6 GIS  
July 07, 2020  
0042



**Travel Map**  
**Crews Incident**  
**CA-SCU-004648**  
**July 8, 2020**









# ACTIVITY LOG (ICS 214)

**1. Incident Name:** \_\_\_\_\_ **2. Operational Period:** Date From: \_\_\_\_\_ Date To: \_\_\_\_\_  
 Time From: \_\_\_\_\_ Time To: \_\_\_\_\_

**3. Name:** \_\_\_\_\_ **4. ICS Position:** \_\_\_\_\_ **5. Home Agency (and Unit):** \_\_\_\_\_

6. Resources Assigned:		
Name	ICS Position	Home Agency (and Unit)

**7. Activity Log:**

Date/Time	Notable Activities

**8. Prepared by:** Name: \_\_\_\_\_ Position/Title: \_\_\_\_\_ Signature: \_\_\_\_\_  
 ICS 214, Page 1 Date/Time: \_\_\_\_\_