

KING INCIDENT

Incident Action Plan

CA-ENF-023461

P5JEE9 (0503)

Operational Period

DAY SHIFT

9/30/14

0600 - 1800

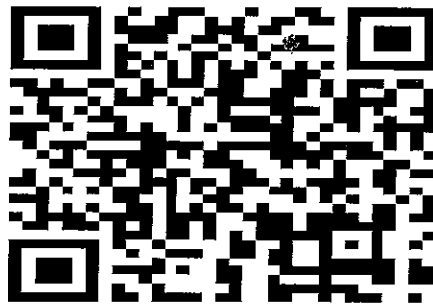

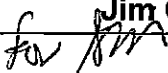
INCIDENT OBJECTIVES	1. INCIDENT NAME	2. DATE PREPARED	3. TIME PREPARED
	KING (Zone 1)	9/29/14	2000
4. OPERATIONAL PERIOD (DATE/TIME) <p style="text-align: center;">DAY SHIFT 9/30/14 0600 - 1800</p>			
5. GENERAL CONTROL OBJECTIVES FOR THE INCIDENT Management Objectives: Provide for safety of responders and the public Establish and maintain positive relationships with cooperating agencies and the public Provide timely and accurate incident information Protect economic and watershed values with safe and aggressive firefighting / suppression repair efforts Keep costs commensurate with values at risk Continue with suppression repair as per the approved Suppression Repair Plan. Control Objectives: Keep the fire: North of Forebay Road and Highway 50 east of Pollock Pines East of Duncan Creek and the Middle Fork of the American River West of Ice House Road South of the Middle Fork of the American River			
6. WEATHER FORCAST FOR OPERATIONAL PERIOD <p style="text-align: center;">See Attached</p>			
7. GENERAL/SAFETY MESSAGE <p style="text-align: center;">See Attached</p>			
8. ATTACHMENTS (X IF ATTACHED)			
<input checked="" type="checkbox"/> 202	<input checked="" type="checkbox"/> SAFETY MESSAGE / LCES	<input checked="" type="checkbox"/> TRANSPORTATION MAP	
<input checked="" type="checkbox"/> 203	<input checked="" type="checkbox"/> WEATHER	<input checked="" type="checkbox"/> INCIDENT MAP	
<input checked="" type="checkbox"/> 204	<input checked="" type="checkbox"/> AIR OPERATIONS SUMMARY	<input checked="" type="checkbox"/> FIRE BEHAVIOR	
<input checked="" type="checkbox"/> 205	<input checked="" type="checkbox"/> HUMAN RESOURCE	<input checked="" type="checkbox"/> TRAINING	
<input checked="" type="checkbox"/> 206	<input checked="" type="checkbox"/> ICP / CAMP MAP	<input checked="" type="checkbox"/> EQUIPMENT LOG	
<input checked="" type="checkbox"/> 214	<input checked="" type="checkbox"/> FIRE WEATHER	<input checked="" type="checkbox"/> SUPPRESSION REPAIR PLAN	
ICS 202	9. PREPARED BY (PLANNING SECTION CHIEF) Dennis Cooper / Rick Leuck (t) / Jason Schillinger (t)	10. APPROVED BY (INCIDNET COMMANDER) (Zone 1)  Jim Giachino	

ORGANIZATION ASSIGNMENT LIST		9. Operations Section	
1. Incident Name: KING (ZONE 1)		Ops Chief	Les Curtis
2. Date: 9/29/14	3. Time: 1800	Planning Ops	Don Smith / Mike Sandwick
4. Operational Period: DAY SHIFT September 30, 2014 0600 - 1800		a. Branch X	
Position	Name	Branch Director	Dana D'Andrea / Jeb Pronto (t)
5. Incident Commander and Command Staff		Division	1B David Buchanan / James White (t)
Incident Commander	Jim Giachino / Steve Millert (t)	Division	1D Bryan Brazzeal / Cory Johnson (t)
Deputy	Carlton Joseph	Division	1F Jason Lambirth / Max Twombly
Safety Officer	Marty Hamel / Steve Ryberg / Charlotte Jordan (t)	b. Branch XII	
Information Officer	Steve Kliest / Mark Savage (t)	Branch Director	Kelly Martin
Liaison Officer	R. Alpert / R. Graham / W. McGrew	Division	1H/1L Lincoln Peters
6. Agency Representative		Division	1K Unstaffed
Eldorado NF	Laurence Crabtree	c. Branch XIV	
Eldorado NF Agency Admin Rep	Duanne Nelson	Branch Director	Unstaffed
Tahoe NF	Tom Quinn	Division	1M Unstaffed
Tahoe NF Agency Admin Rep	Victor Lyon	Division	1P Unstaffed
CAL FIRE Nevada-Yuba-Placer Unit	Randy Smith	d. Branch XVI	
IARR Eastern Area	Jeffery Briggs	Branch Director	Sean Johnson / Corey Rose (t)
IARR Northeastern Region	Robert Heartlove	Division	1R Unstaffed
IARR Southern Region	Tom Barnes / Ed Bratcher / David Berens	Division	1T Unstaffed
IARR Southwestern Region	Carlos Nosie / Louie Sandoval	Division	1U Aaron Riise
PG&E	Scott Holmquist	Division	1W Chris Vero / Johnny Villa (t)
California Highway Patrol	Steve Halbleib	Division	1Y Kim Olson / David Soldavini (t)
Placer County Sheriff	Bill Walton	Division	1Z Justin Hanely / Shannon Myers (t)
California Conservation Corps	Hector Garcia	f. Contingency Group	
7. Planning Section		Branch Director	Don Forsyth / Matt Conklin
Plans Chief	Dennis Cooper / Rick Leuck (t) / Jason Schillinger (t)	Group	American Deano Esades / Jeff Goyings (t)
Resources Unit	R. Ashby / J. Switzer / J. Wilson / E. Matye (t)	Group	Oxbow Thomas Browning
Situation Unit	T. Morelock / M. McHargue / P. Kaiser	Group	Soda Springs Rodney Redniger / Russ Blair (t)
Human Resources	Marilyn Loughrey / Tom Nichols	g. Rehab / Repair Branch X	
READ	Courtney Rowe	Branch	Russell Copp / Dan Bryant / Quincy Chung (t)
Fire Behavior	Shelly Crook	Group	Charles Alluisi / Brooks Baker (t)
Meteorologist	Jason Clapp	h. Rehab / Repair Branch XII	
GISS	Brad Weisshaupt / Eric Shreve (t)	Branch	Russell Copp / Dan Bryant / Quincy Chung (t)
CTSP	Jim Youngblood / Chris Crowder (t)	Group	Mark Darragh
TNSP	Bill Reynolds	i. Rehab / Repair Branch XVI	
DEMOB	Dan Baggao / Jim Cooley	Branch	Russell Copp / Dan Bryant / Quincy Chung (t)
8. Logistics Section		Group	Joel Kerley
Logistics Chief	H. Crane / D. Haston / K. Kumpe (t)	j. Tactical Resource Coordinator	
Supply Unit	Michael Bradford	Group	Unstaffed
Facilities Unit	Jim Eckroth / Wally Grogan	k. Air Operations	
Ground Support Unit	John Badaracco	Air Operations Branch Director	John Keesee
Medical Unit	Robert Russell / Newton Ong (t)	Air Support Supervisor	Craig Dado
Food Unit	Dennis Durham	Helicopter Coordinator	Lane Caldwell / John Chin
Receiving/Distribution	Joe McMahon	Helibase Manager	Brad Bernardy
Communications Unit	Greg Ely / Tim Maguire (t)	10. Finance/Administration Section	
Ordering Manager	Sharon Porter	Finance/Admin. Chief	Teresa Fork / Peter Bymers
		Cost Appro.	Kenny Lucien
		Time Unit	Janice Brown
		Procurement Unit	Wendy Whiteman
		Compensation/Claims Unit	Elaine Downing
		Cost Unit	Roger Siemers
		Personnel Time Recorder	Debra Luna (t)
		Prepared by (Resource Unit Leader)	Eric Matye (t)



ZONE 1 FIRE WEATHER FORECAST



FORECAST NO: 26
PREDICTION FOR: Tuesday Day SHIFT

INCIDENT NAME: King Fire
UNIT: Eldorado National Forest

SHIFT DATE: 30 September 2014

SIGNED: *Jason Clapp*

TIME AND DATE
FORECAST ISSUED: 2000 / 29 September 2014

Jason Clapp
Incident Meteorologist

WEATHER TODAY:

WEATHER: Mostly sunny and warmer with breezier WNW winds. Winds will shift ENE and increase by early evening as the surface high pressure builds into Nevada.

TEMPERATURES: 62-68 *Trend: Up 3 – 5*
RELATIVE HUMIDITY: 40-50% *Trend: Down 7 – 10%*

20 FT WINDS:

RIDGETOP – Morning winds NE 4-8 mph with gusts to 15 mph through 1000, shifting W-WNW throughout day 5-10 mph with afternoon gusts 20 mph.

SLOPE/VALLEY – Downcanyon 3-7 mph and shift WSW 4-7 with gusts to 12 mph around 1200.

LAL: 1. **STABILITY/INVERSION:** Inversions breaking in deep canyons by 1000.

WEATHER DISCUSSION: Expect a mostly sunny sky today with breezier wind. Temperatures will warm this week as surface high pressure builds into NV. This will generate breezy to strong ENE winds tonight into Thursday. Thursday and Friday may have some weak westerly afternoon winds, but the winds will turn northeasterly during overnight hours and through mornings.

WEATHER FOR TUESDAY NIGHT: Mostly clear.

Low temperatures: Higher Elevations 45-50...Lower Elevations 50-55.

Max RH: Ridges 40-50%... Valleys 50-60%. RH will begin higher and drop throughout night.

20FT Winds:

Ridge – ENE 10-15 with gusts to 25 mph, increasing 15-20 with gusts 30-40 mph after 0400.

Slope/valley – Transition to downslope 4-7 mph. Downcanyon 8-15 mph after 2200 with gusts to 25 mph after 0400.

OUTLOOK FOR WEDNESDAY: Sunny. High temps: 65-72. Min RH: 25-30%. Ridge winds: ENE winds from 15-25 with gusts 30-40 mph. Valley/Slope winds: Downcanyon 10-15 with gusts to 25 mph.

Weather Planning Matrix



Weather Observations



ZONE 1: KING FIRE NORTH - FIRE BEHAVIOR FORECAST

FORECAST NUMBER: #27	TYPE OF FIRE: Wildfire
FIRE NAME: King Fire	OPERATIONAL PERIOD: Tuesday 9/30/2013 Day Shift
DATE ISSUED: September 29, 2014	TIME ISSUED: 2100
UNIT: Eldorado & Tahoe NF, CA State	SIGNED:  Shelly Crook - FBAN

INPUTS

WEATHER SUMMARY

(Refer to Weather Forecast for details) **DAY:** Mostly sunny. Wind becoming very gusty around sunset.
 Max Temp: 62-68°. Min RH: 40-50%. Ridgetop winds – W/NW 5-10 mph becoming E/NE10-15, gusts to 25 mph around sunset.. Slope/Valley Winds – Downslope 3-7 mph becoming W/SW 4-6 mph with gusts to 10 mph in the afternoon.

FUELS

Predominantly mature mixed conifer with heavy shrub loading. Fuel loadings are generally heavy. Representative Fuel Models 9, 10, TU5, TL8, TL9. Live fuels moistures are dry; however the dead fuels have moistened up as a result of the rain from yesterday. Large fire history: Star Fire 2001, Ralston Fire 2007, Government and Westville 2008, American Fire 2013.
Minimum fine dead fuel moisture: 6-8%, 1000 hr FMC: 9%, 10 hr FMC: 8-10%, Live fuel moisture: 60-65%.

OUTPUTS - FIRE BEHAVIOR

DAY SHIFT:

Thresholds for Active Fire Behavior in the King Fire area (Eldorado NF PocketCard):
 * 20ft Winds (over 5 mph), *RH (under 22%), *Temperature (over 84°) and *1000hr FMC (under 9%).
Forecasted Indices (Bald Mt RAWS, FM-G) ERC: 36 (up 3) BI: 27 (no change)
Maximum Fire Behavior Potential (head fire upslope): Rate of Spread: 3-5 chains/hour (5 feet/min), Flame Length: 1-3 ft. Probability of Ignition: 40%. Maximum spotting distance of ¼ Mile.

GENERAL for the Entire Zone 1 Fire Area: The rain is gone and the hot, dry and very windy weather is on tap for the next several days. As we transition back into warm and dry conditions, it will become possible for the fine dead to support fire propagation. Any available fine dead fuels in close proximity to smoldering heavy fuels could pose a threat to the containment lines. Expect to see increasing smoke production primarily from the fire's interior. This will be your best opportunity to locate and mop up any remaining heat adjacent to the fire's perimeter. Don't trust your eyes; you may have to depend on your nose to lead the way.

Bald Mountain RAWS Actual ERC as of 9/29

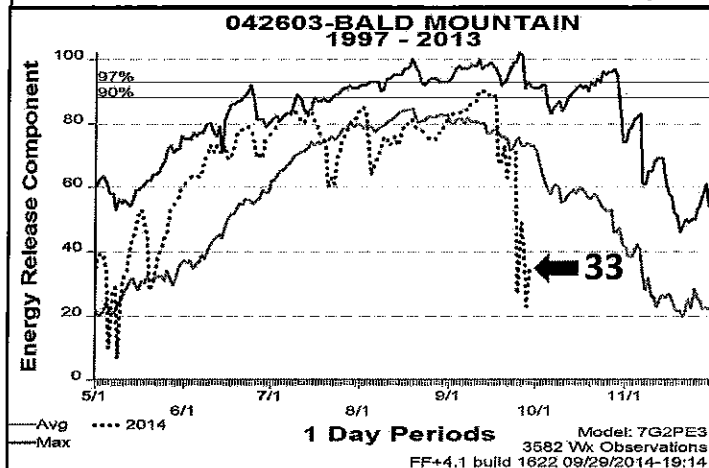

The winds are going to get super gusty this evening, so it will be critical to ensure the entire fire's perimeter is adequately secured. Pay special attention to any interior unburned islands. If they do begin burning actively, there is a potential they could send embers over the line posing a threat for spot fires. As always, heads up for snags and stump holes as the mop up efforts move further into the interior.

FEEDBACK: Collect WX obs hourly and turn in to FBAN or IMET at end of shift. Please include fire behavior observations.

AIR OPERATIONS

Gusty winds in the evening could limit operations. Plan accordingly. Sunrise at 0657. Sunset at 1849.

SAFETY

- The gusty winds this evening could bring down snags and live trees. Be sure to look up before you look down.
- Pay special attention to changing and increasing fire behavior as the day progresses.
- *"It is not the answer that enlightens, but the question." Eugene Ionesco*

Division Assignment List		1. Branch X		2. Division/Group 1 B			
3. Incident Name KING - ZONE 1		4. Operational Period 09/30/14 Tuesday Day Shift 0600 - 1800					
5. Operations Personnel							
Operations Chief	LES CURTIS		Division/Group Supervisor D. BUCHANAN; J. WHITE (t)				
Contingency Ops Chief			Air Attack Supervisor				
Branch Director	DANA D'ANDREA; JEB PRONTO (t)		Safety Officer M HAMEL; S. RYBERG; C. JORDAN (t)				
6. Resources Assigned this Period							
Strike Team/Task Force/ Resource Designator	Leader	Num of Pers.	Trans. Y/N	Drop Off PT./Time	Pick Up PT./Time		
CRW T2 DIAMOND C-40 10/1	LARRY ECKLEMAN	20	N	SUNSET SPIKE 0800	SUNSET SPIKE 1800		
T/F ENF KING #5				SUNSET SPIKE 0800	SUNSET SPIKE 1800		
STEN O-661 10/2	JILL VUGTEVEEN	1	N	SUNSET SPIKE 0800	SUNSET SPIKE 1800		
TFLD O-660 10/3	RYAN SANCHEY	1	N	SUNSET SPIKE 0800	SUNSET SPIKE 1800		
TFLD O-711 10/3	CHET JENSEN (t)	1	N	SUNSET SPIKE 0800	SUNSET SPIKE 1800		
ENG T6 UWF E-486 9/29	RYAN TAYLOR	3	N	SUNSET SPIKE 0800	SUNSET SPIKE 1800		
ENG T6 E-344 10/1	COLTON MCCARTHY	3	N	SUNSET SPIKE 0800	SUNSET SPIKE 1800		
ENG T6 PACIFIC OASIS E-342 9/30	KENT SMITH	3	N	SUNSET SPIKE 0800	SUNSET SPIKE 1800		
ENG T6 E-356 9/30	BILL MACAULEY	3	N	SUNSET SPIKE 0800	SUNSET SPIKE 1800		
ENG T6 FIRESTORM E-339 9/30	RON SARTAIN	3	N	SUNSET SPIKE 0800	SUNSET SPIKE 1800		
DOZ T2 B. INGRAM CON E-554 10/5	BRUCE INGRAM	3	N	SUNSET SPIKE 0800	SUNSET SPIKE 1800		
DOZ T2 DADCO CONST E-568 10/5	DOUGLAS MAGALIA	3	N	SUNSET SPIKE 0800	SUNSET SPIKE 1800		
WT T1 WATER BY C E-259 9/30	JOHN CARMODY	1	N	SUNSET SPIKE 0800	SUNSET SPIKE 1800		
MAST T2 E-861 10/8	CLAYTON GRAHAM	2	N	SUNSET SPIKE 0800	SUNSET SPIKE 1800		
MASTICATOR T1 E-860 10/8		2	N	SUNSET SPIKE 0800	SUNSET SPIKE 1800		
SKID E-910		1	N	SUNSET SPIKE 0800	SUNSET SPIKE 1800		
SKID E-911		1	N	SUNSET SPIKE 0800	SUNSET SPIKE 1800		
SOFR O-699 10/2	PEDRO VILLA	1	N	SUNSET SPIKE 0800	SUNSET SPIKE 1800		
SOFR (t) O-40 9/29	JOHN MARTINEZ	1	N	SUNSET SPIKE 0800	SUNSET SPIKE 1800		
7. Control Operations							
Mop up to the degree necessary to make the likelihood of fire escape very low; based on experience, terrain, fuel types, and fuel conditions from Drop Point 105 south to the Rubicon River and the spot fire as access permits. Complete secondary line on Nevada Point.							
8. Special Instructions							
All dozers report to weed wash and lock all gates at end of shift.							
a. Day resources travel route to line via Foresthill Rd. Return via Mosquito Ridge Rd.							
b. All Division Supervisors need to download information to the Sit Unit for all completed work.							
c. Noxious weeds are marked by orange "noxious weed" flagging. Minimize or avoid activities in these areas.							
d. Sensitive areas are marked with pink/black checkerboard flagging. Minimize ground disturbing activities in these areas.							
e. Backhaul trash and equipment.							
9. Division/Group Communications Summary							
Function	Frequency - RX	Frequency - TX	Tone	System	Channel	System	Channel
Command	166.6125	168.4000	136.5	NIFC C4	1		
Tactical Div/Group	168.2500	168.2500		NIFC T7	9		
Logistics							
Air to Ground	169.1500	169.1500		A/G CMD	13		
Prepared by (Resource Unit Leader) J. Switzler; E. Matye (t); A. Uehara (t)		Approved by (Planning Section Chief) D. Cooper; R. Leuck (t); J. Schillinger (t)		Date Prepared 09/29/14		Time Prepared 1013	

Division Assignment List	1. Branch X	2. Division/Group 1 B
---------------------------------	--------------------	------------------------------

3. Incident Name KING - ZONE 1	4. Operational Period 09/30/14 Tuesday Day Shift 0600 - 1800
--	--

5. Operations Personnel

Operations Chief	LES CURTIS	Division/Group Supervisor	D. BUCHANAN ; J. WHITE (t)
Contingency Ops Chief		Air Attack Supervisor	
Branch Director	DANA D'ANDREA; JEB PRONTO (t)	Safety Officer	M.HAMEL;S.RYBERG;C.JORDAN (t)

6. Resources Assigned this Period

Strike Team/Task Force/ Resource Designator	Leader	Num of Pers.	Trans. Y/N	Drop Off PT./Time	Pick Up PT./Time
FEMP O-756 10/4	JOHN BICONDOVA	1	N	SUNSET SPIKE 0600	SUNSET SPIKE 1800
FEMT O-757 10/4	MATT HECKMANN	1	N	SUNSET SPIKE 0600	SUNSET SPIKE 1800
FOBS O-455 10/1	MICHAEL R CONNOLLY	1	N	SUNSET SPIKE 0600	SUNSET SPIKE 1800
FOBS O-1086 10/2	RYAN A LOBRE	1	N	SUNSET SPIKE 0600	SUNSET SPIKE 1800

7. Control Operations
Mop up to the degree necessary to make the likelihood of fire escape very low; based on experience, terrain, fuel types, and fuel conditions from Drop Point 105 south to the Rubicon River and the spot fire as access permits. Complete secondary line on Nevada Point.

8. Special Instructions
****All dozers report to weed wash and lock all gates at end of shift.****
 a. Day resources travel route to line via Foresthill Rd. Return via Mosquito Ridge Rd.
 b. All Division Supervisors need to download information to the Sit Unit for all completed work.
 c. Noxious weeds are marked by orange "noxious weed" flagging. Minimize or avoid activities in these areas.
 d. Sensitive areas are marked with pink/black checkerboard flagging. Minimize ground disturbing activities in these areas.
 e. Backhaul trash and equipment.

9. Division/Group Communications Summary

Function	Frequency - RX	Frequency - TX	Tone	System	Channel	System	Channel
Command	166.6125	168.4000	136.5	NIFC C4	1		
Tactical Div/Group	168.2500	168.2500		NIFC T7	9		
Logistics							
Air to Ground	169.1500	169.1500		A/G CMD	13		

Prepared by (Resource Unit Leader) J. Switzler; E. Matye (t); A.Uehara (t)	Approved by (Planning Section Chief) D. Cooper; R. Leuck (t); J. Schillinger (t)	Date Prepared 09/29/14	Time Prepared 1013
---	---	---------------------------	-----------------------

Division Assignment List	1. Branch X	2. Division/Group 1 D
---------------------------------	-----------------------	---------------------------------

3. Incident Name KING - ZONE 1	4. Operational Period 09/30/14 Tuesday Day Shift 0600 - 1800
--	---

5. Operations Personnel

Operations Chief	LES CURTIS	Division/Group Supervisor	BRYAN BRAZZEAL; CORY JOHNSON (t)
Contingency Ops Chief		Air Attack Supervisor	
Branch Director	DANA D'ANDREA; JEB PRONTO (t)	Safety Officer	M.HAMEL;S.RYBERG;C JORDAN (t)

6. Resources Assigned this Period

Strike Team/Task Force/ Resource Designator	Leader	Num of Pers.	Trans. Y/N	Drop Off PT./Time	Pick Up PT./Time
CRW T2IA NAVAJO SCTS 1 C-101 9/30	TERRY TSO	20	N	SUNSET SPIKE 0600	SUNSET SPIKE 1800
CRW T2IA NAVAJO SCTS 2 C-4 9/30	ALTON JOHN	20	N	SUNSET SPIKE 0600	SUNSET SPIKE 1800
CRW T2IA R10 #5 C-22 10/1	ROBERT TODD BERNEY	19	N	SUNSET SPIKE 0600	SUNSET SPIKE 1800
CRW T2 PACIFIC OASIS C-46 9/30	WESLEY DODDS	20	N	SUNSET SPIKE 0600	SUNSET SPIKE 1800
CRW T2 MQ FRANCO 136 C-44 10/1	FERNANDO CERVANTES	20	N	SUNSET SPIKE 0600	SUNSET SPIKE 1800
SOF2 O-699 10/2	PEDRO VILLA	1	N	SUNSET SPIKE 0600	SUNSET SPIKE 1800
SOFR (t) O-40 9/29	JOHN MARTINEZ	1	N	SUNSET SPIKE 0600	SUNSET SPIKE 1800
FEMP O-975 9/30	EDUARDO STARY	1	N	SUNSET SPIKE 0600	SUNSET SPIKE 1800
FEMT O-971 10/6	WILLIAM KRON	1	N	SUNSET SPIKE 0600	SUNSET SPIKE 1800

7. Control Operations
Mop up to the degree necessary to make the likelihood of fire escape very low; based on experience, terrain, fuel types, and fuel conditions. Remove all hose and unnecessary equipment from 11 Pines and 2 Road intersection to Drop Point 106.

8. Special Instructions
****All dozers report to weed wash and lock all gates at end of shift.****
a. Day resources travel route to line via Foresthill Rd. Return via Mosquito Ridge Rd.
b. All Division Supervisors need to download information to the Sit Unit for all completed work.
c. Noxious weeds are marked by orange "noxious weed" flagging. Minimize or avoid activities in these areas.
d. Sensitive areas are marked with pink/black checkerboard flagging. Minimize ground disturbing activities in these areas.
e. Backhaul trash and equipment.

9. Division/Group Communications Summary

Function	Frequency - RX	Frequency - TX	Tone	System	Channel	System	Channel
Command	166.6125	168.4000	136.5	NIFC C4	1		
Tactical Div/Group	168.5000	168.5000		NIFC T10	6		
Logistics							
Air to Ground	169.1500	169.1500		A/G CMD	13		

Prepared by (Resource Unit Leader) J. Switzler; E. Matye (t); A.Uehara (t)	Approved by (Planning Section Chief) D. Cooper; R. Leuck (t); J. Schillinger (t)	Date Prepared 09/29/14	Time Prepared 1013
---	---	---------------------------	-----------------------

Division Assignment List	1. Branch X	2. Division/Group 1 F
---------------------------------	-----------------------	---------------------------------

3. Incident Name KING - ZONE 1	4. Operational Period 09/30/14 Tuesday Day Shift 0600 - 1800
--	---

5. Operations Personnel			
Operations Chief	LES CURTIS	Division/Group Supervisor	JASON LAMBIRTH; MAX TWOMBLY
Contingency Ops Chief		Air Attack Supervisor	
Branch Director	DANA D'ANDREA; JEB PRONTO (t)	Safety Officer	M.HAMEL; S. RYBERG; C.JORDAN (t)

6. Resources Assigned this Period					
Strike Team/Task Force/ Resource Designator	Leader	Num of Pers.	Trans. Y/N	Drop Off PT./Time	Pick Up PT./Time
CRW T2IA SAN CARLOS C-5 9/30	THOMAS PATTEN	18	N	SUNSET SPIKE 0800	SUNSET SPIKE 1800
ENG S/T 6632C E-535 10/5	ADOLPHO CASTRO	27	N	SUNSET SPIKE 0800	SUNSET SPIKE 1800
ENG S/T 3675C E-533 10/4	SEAN JOHNNY	27	N	SUNSET SPIKE 0800	SUNSET SPIKE 1800
ENG T/F KING #4				SUNSET SPIKE 0800	SUNSET SPIKE 1800
TFLD O-662	CORY CALNAN	1	N	SUNSET SPIKE 0800	SUNSET SPIKE 1800
STEN O-707 10/3	BEAU MACIAG (t)	1	N	SUNSET SPIKE 0800	SUNSET SPIKE 1800
ENG T6 CPS 62 E-374	RYAN MORGAN	3	N	SUNSET SPIKE 0800	SUNSET SPIKE 1800
ENG T6 TAHOE SAGE FIRE E-358	KEVIN STUDLEY	3	N	SUNSET SPIKE 0800	SUNSET SPIKE 1800
ENG T6 HIGH SIERRA E-338	JERRY VICE	3	N	SUNSET SPIKE 0800	SUNSET SPIKE 1800
ENG T6 HIGH SIERRA E-340	JACOB ROWSEY	3	N	SUNSET SPIKE 0800	SUNSET SPIKE 1800
ENG T6 333 BLY MT FIRE E-355	MARK GROVES	3	N	SUNSET SPIKE 0800	SUNSET SPIKE 1800
WT WATERSUPPORT E-926 10/8	BILL CRAWFORD	2	N	SUNSET SPIKE 0800	SUNSET SPIKE 1800
FALM O-869 10/5	RANDY SHAULIS	2	N	SUNSET SPIKE 0800	SUNSET SPIKE 1800
FALM O-847 10/5	JOHN WALKER	1	N	SUNSET SPIKE 0800	SUNSET SPIKE 1800
SOFR O-700 10/9	DONALD FOCO	1	N	SUNSET SPIKE 0800	SUNSET SPIKE 1800
FEMP O-429 10/1	MITCH CARNEY	1	N	SUNSET SPIKE 0800	SUNSET SPIKE 1800
FEMT O-970 10/6	TODD W ADAMS	1	N	SUNSET SPIKE 0800	SUNSET SPIKE 1800

7. Control Operations
Mop up to the degree necessary to make the likelihood of fire escape very low; based on experience, terrain, fuel types, and fuel conditions. Remove all hose and unnecessary equipment by the end of shift on 9/30 from French Meadows Dam to 2 Road.

8. Special Instructions
****All dozers report to weed wash and lock all gates at end of shift.****
a. Day resources travel route to line via Foresthill Rd. Return via Mosquito Ridge Rd.
b. All Division Supervisors need to download information to the Sit Unit for all completed work.
c. Noxious weeds are marked by orange "noxious weed" flagging. Minimize or avoid activities in these areas.
d. Sensitive areas are marked with pink/black checkerboard flagging. Minimize ground disturbing activities in these areas.
e. Backhaul trash and equipment.

9. Division/Group Communications Summary							
Function	Frequency - RX	Frequency - TX	Tone	System	Channel	System	Channel
Command	166.6125	168.4000	136.5	NIFC C4	1		
Tactical Div/Group	166.7250	166.7250		NIFC T5	7		
Logistics							
Air to Ground	169.1500	169.1500		A/G CMD	13		

Prepared by (Resource Unit Leader) J. Switzler; E. Matye (t); A.Uehara (t)	Approved by (Planning Section Chief) D. Cooper, R. Leuck (t), J. Schilling (t)	Date Prepared 09/29/14	Time Prepared 1013
---	---	---------------------------	-----------------------

Division Assignment List	1. Branch XII	2. Division/Group 1 H / L
---------------------------------	-------------------------	-------------------------------------

3. Incident Name KING - ZONE 1	4. Operational Period 09/30/14 Tuesday Day Shift 0600 - 1800
--	---

5. **Operations Personnel**

Operations Chief LES CURTIS	Division/Group Supervisor LINCOLN PETERS
Contingency Ops Chief	Air Attack Supervisor
Branch Director KELLY MARTIN	Safety Officer M. HAMEL; S. RYBERG; C. JORDAN (t)

6. **Resources Assigned this Period**

Strike Team/Task Force/ Resource Designator	Leader	Num of Pers.	Trans. Y/N	Drop Off PT./Time	Pick Up PT./Time
CRW T2IA ANGORA PEAK C-173 10/3	JASON LANIER	19	N		SUNSET PIKE 1800
CRW T2IA STF 29 C-200 10/5	MICHAEL LANIER	19	N		SUNSET PIKE 1800
ENG S/T 6617C E-534 10/5	JOSHUA BOEHM	27	N		SUNSET PIKE 1800
KING T/F #16					SUNSET PIKE 1800
TFLD O-792 10/4	KIRK HARRIS	1	N		SUNSET PIKE 1800
TFLD (t) O-951 10/5	JAMIE JALVING	1	N		SUNSET PIKE 1800
ENG T6 PAULA HOLTER E-333 9/30	PAULA HOLTH	3	N		SUNSET PIKE 1800
ENG T6 PAULA HOLTER E-334 9/30	CHUCK NEWBERRY	3	N		SUNSET PIKE 1800
ENG T6 PAULA HOLTER E-335 9/30	DON HOLTER	3	N		SUNSET PIKE 1800
ENG T6 PLATTE CANYON E-381 10/2	CODY COX	3	N		SUNSET PIKE 1800
ENG T4 HTF 413 E-484 9/30	JOHN STONELAKE	4	N		SUNSET PIKE 1800
ENG T4 E2411 E-485 9/28	NICKOLAUS MINK	4	N		SUNSET PIKE 1800
WT T2V NO STATE E-526 10/3	ALBERT BUCHTER	1	N		SUNSET PIKE 1800
WT T1 TACTICAL E-3041 10/9		1	N		SUNSET PIKE 1800
STEN O-893 10/5	GILBERT BARRIER	1	N		SUNSET PIKE 1800
SOFR O-141 10/5	RICK CLARK	1	N		SUNSET PIKE 1800
SOFR (t) O-142 10/5	MANI BOUSLAUGH	1	N		SUNSET PIKE 1800
FEMP O-762 10/4	RON CUTTING	1	N		SUNSET PIKE 1800
FEMT O-765 10/5	BRYAN L ESSER	1	N		SUNSET PIKE 1800
FOBS O-118 9/30	TIM BRADLEY	1	N		SUNSET PIKE 1800

7. Control Operations
Remove hose and appliances. Complete suppression repair per the Suppression Repair Guidelines from Star Ridge to Foresthill along Chipmunk Ridge.

8. Special Instructions
****All dozers report to weed wash and lock all gates at end of shift.****
a. Day resources travel route to line via Foresthill Rd. Return via Mosquito Ridge Rd.
b. All Division Supervisors need to download information to the Sit Unit for all completed work.
c. Noxious weeds are marked by orange "noxious weed" flagging. Minimize or avoid activities in these areas.
d. Sensitive areas are marked with pink/black checkerboard flagging. Minimize ground disturbing activities in these areas.
e. Backhaul trash and equipment.

9. **Division/Group Communications Summary**

Function	Frequency - RX	Frequency - TX	Tone	System	Channel	System	Channel
Command	166.6125	168.4000	136.5	NIFC C4	1		
Tactical Div/Group	166.7750	166.7750		NIFC T6	8		
Logistics							
Air to Ground	169.1500	169.1500		A/G CMD	13		

Prepared by (Resource Unit Leader) J. Switzler, E. Matye (t); A. Uehara (t)	Approved by (Planning Section Chief) D. Cooper; R. Leuck (t); J. Scullinger (t)	Date Prepared 09/29/14	Time Prepared 1013
--	--	---------------------------	-----------------------

Division Assignment List	1. Branch XII	2. Division/Group 1 H / L
---------------------------------	-------------------------	-------------------------------------

3. Incident Name KING - ZONE 1	4. Operational Period 09/30/14 Tuesday Day Shift 0600 - 1800
--	--

5. Operations Personnel			
Operations Chief	LES CURTIS	Division/Group Supervisor	LINCOLN PETERS
Contingency Ops Chief		Air Attack Supervisor	
Branch Director	KELLY MARTIN	Safety Officer	M. HAMEL; S. RYBERG; C. JORDAN (t)

6. Resources Assigned this Period					
Strike Team/Task Force/ Resource Designator	Leader	Num of Pers.	Trans. Y/N	Drop Off PT./Time	Pick Up PT./Time
FOBS O-454 9/30	ROBERT OLDS	1	N		SUNSET SPIKE 1800

7. Control Operations
Remove hose and appliances. Complete suppression repair per the Suppression Repair Guidelines from Star Ridge to Foresthill along Chipmunk Ridge.

- 8. Special Instructions**
****All dozers report to weed wash and lock all gates at end of shift.****
- a. Day resources travel route to line via Foresthill Rd. Return via Mosquito Ridge Rd.
 - b. All Division Supervisors need to download information to the Sit Unit for all completed work.
 - c. Noxious weeds are marked by orange "noxious weed" flagging. Minimize or avoid activities in these areas.
 - d. Sensitive areas are marked with pink/black checkerboard flagging. Minimize ground disturbing activities in these areas.
 - e. Backhaul trash and equipment.

9. Division/Group Communications Summary							
Function	Frequency - RX	Frequency - TX	Tone	System	Channel	System	Channel
Command	166.6125	168.4000	136.5	NIFC C4	1		
Tactical Div/Group	166.7750	166.7750		NIFC T6	8		
Logistics							
Air to Ground	169.1500	169.1500		A/G CMD	13		
Prepared by (Resource Unit Leader) J. Switzler; E. Matye (t); A.Uehara (t)			Approved by (Planning Section Chief) D. Cooper ; R. Leuck (t) ; C. Schillinger (t)		Date Prepared 09/29/14		Time Prepared 1910

Division Assignment List	1. Branch	2. Division/Group
	XII	1 K

3. Incident Name KING - ZONE 1	4. Operational Period 09/30/14 Tuesday Day Shift 0600 - 1800
--	--

5. Operations Personnel			
Operations Chief	LES CURTIS	Division/Group Supervisor	UNSTAFFED
Contingency Ops Chief		Air Attack Supervisor	
Branch Director	KELLY MARTIN	Safety Officer	M.HAMEL;S. RYBERG;C. JORDAN (t)

6. Resources Assigned this Period					
Strike Team/Task Force/ Resource Designator	Leader	Num of Pers.	Trans. Y/N	Drop Off PT./Time	Pick Up PT./Time
UNSTAFFED					

7. Control Operations

Unstaffed

8. Special Instructions

****All dozers report to weed wash and lock all gates at end of shift.****

- a. Day resources travel route to line via Foresthill Rd. Return via Mosquito Ridge Rd.
- b. All Division Supervisors need to download information to the Sit Unit for all completed work.
- c. Noxious weeds are marked by orange "noxious weed" flagging. Minimize or avoid activities in these areas.
- d. Sensitive areas are marked with pink/black checkerboard flagging. Minimize ground disturbing activities in these areas.
- e. Backhaul trash and equipment.

9. Division/Group Communications Summary							
Function	Frequency - RX	Frequency - TX	Tone	System	Channel	System	Channel
Command	166.6125	168.4000	136.5	NIFC C4	1		
Tactical Div/Group	167.1125	167.1125		R5 T5	11		
Logistics							
Air to Ground	169.1500	169.1500		A/G CMD	13		

Prepared by (Resource Unit Leader) J. Switzler ; E. Mayte (t); A. Uehara (t)	Approved by (Planning Section Chief) D. Cooper; R. Leuck (t); J. Schillinger (t)	Date Prepared 09/29/14	Time Prepared 1857
---	---	---------------------------	-----------------------

Division Assignment List	1. Branch XIV	2. Division/Group 1 M
---------------------------------	-------------------------	---------------------------------

3. Incident Name KING - ZONE 1	4. Operational Period 09/30/14 Tuesday Day Shift 0600 - 1800
--	---

5. **Operations Personnel**

Operations Chief	LES CURTIS	Division/Group Supervisor	UNSTAFFED
Contingency Ops Chief		Air Attack Supervisor	
Branch Director	UNSTAFFED	Safety Officer	M.HAMEL; S.RYBERG; C.JORDAN (t)

6. **Resources Assigned this Period**

Strike Team/Task Force/ Resource Designator	Leader	Num of Pers.	Trans. Y/N	Drop Off PT./Time	Pick Up PT./Time
UNSTAFFED					

7. **Control Operations**

UNSTAFFED

8. **Special Instructions**

- **All dozers report to weed wash and lock all gates at end of shift.****
- a. Day resources travel route to line via Foresthill Rd. Return via Mosquito Ridge Rd.
 - b. All Division Supervisors need to download information to the Sit Unit for all completed work.
 - c. Noxious weeds are marked by orange "noxious weed" flagging. Minimize or avoid activities in these areas.
 - d. Sensitive areas are marked with pink/black checkerboard flagging. Minimize ground disturbing activities in these areas.
 - e. Backhaul trash and equipment.

9. **Division/Group Communications Summary**

Function	Frequency - RX	Frequency - TX	Tone	System	Channel	System	Channel
Command	166.6125	168.4000	136.5	NIFC C4	1		
Tactical Div/Group	168.5000	168.5000		NIFC T10	6		
Logistics							
Air to Ground	169.1500	169.1500		A/G CMD	13		

Prepared by (Resource Unit Leader) J. Switzler; E. Matye (t); A.Uehara (t)	Approved by (Planning Section Chief) D. Cooper; R. Leuck (t); J. Schillinger (t)	Date Prepared 09/29/14	Time Prepared 1013
---	---	---------------------------	-----------------------

Division Assignment List	1. Branch XVI	2. Division/Group 1 R
---------------------------------	-------------------------	---------------------------------

3. Incident Name KING - ZONE 1	4. Operational Period 09/30/14 Tuesday Day Shift 0600 - 1800
--	--

5. Operations Personnel

Operations Chief	LES CURTIS	Division/Group Supervisor	UNSTAFFED
Contingency Ops Chief		Air Attack Supervisor	
Branch Director	SEAN JOHNSON; COREY ROSE (t)	Safety Officer	M.HAMEL;S.RYBERG;C. JORDAN (t)

6. Resources Assigned this Period

Strike Team/Task Force/ Resource Designator	Leader	Num of Pers.	Trans. Y/N	Drop Off PT./Time	Pick Up PT./Time
UNSTAFFED					

7. Control Operations

UNSTAFFED

8. Special Instructions

- **All dozers report to weed wash and lock all gates at end of shift.****
- a. Day resources travel route to line via Foresthill Rd. Return via Mosquito Ridge Rd.
- b. All Division Supervisors need to download information to the Sit Unit for all completed work.
- c. Noxious weeds are marked by orange "noxious weed" flagging. Minimize or avoid activities in these areas.
- d. Sensitive areas are marked with pink/black checkerboard flagging. Minimize ground disturbing activities in these areas.
- e. Backhaul trash and equipment.

9. Division/Group Communications Summary

Function	Frequency - RX	Frequency - TX	Tone	System	Channel	System	Channel
Command	166.6125	168.4000	136.5	NIFC C4	1		
Tactical Div/Group	168.0500	168.0500		NIFC T1	5		
Logistics							
Air to Ground	169.1500	169.1500		A/G CMD	13		

Prepared by (Resource Unit Leader) J. Switzler; E. Matye (t); A. Uehara (t)	Approved by (Planning Section Chief) D. Cooper; R. Leuck (t); J. Schillinger (t)	Date Prepared 09/29/14	Time Prepared 1013
--	---	---------------------------	-----------------------

Division Assignment List	1. Branch XVI	2. Division/Group 1 T
---------------------------------	-------------------------	---------------------------------

3. Incident Name KING - ZONE 1	4. Operational Period 09/30/14 Tuesday Day Shift 0600 - 1800
--	--

5. **Operations Personnel**

Operations Chief	LES CURTIS	Division/Group Supervisor	UNSTAFFED
Contingency Ops Chief		Air Attack Supervisor	
Branch Director	SEAN JOHNSON; COREY ROSE (t)	Safety Officer	M.HAMEL; S. RYBERG; C. JORDAN (t)

6. **Resources Assigned this Period**

Strike Team/Task Force/ Resource Designator	Leader	Num of Pers.	Trans. Y/N	Drop Off PT./Time	Pick Up PT./Time
UNSTAFFED					

7. Control Operations

UNSTAFFED

8. Special Instructions

****All dozers report to weed wash and lock all gates at end of shift.****

a. Day resources travel route to line via Foresthill Rd. Return via Mosquito Ridge Rd.
b. All Division Supervisors need to download information to the Sit Unit for all completed work.
c. Noxious weeds are marked by orange "noxious weed" flagging. Minimize or avoid activities in these areas.
d. Sensitive areas are marked with pink/black checkerboard flagging. Minimize ground disturbing activities in these areas.
e. Backhaul trash and equipment.

9. **Division/Group Communications Summary**

Function	Frequency - RX	Frequency - TX	Tone	System	Channel	System	Channel
Command	166.6125	168.4000	136.5	NIFC C4	1		
Tactical Div/Group	166.5500	166.5500		R5 T4	10		
Logistics							
Air to Ground	169.1500	169.1500		A/G CMD	13		

Prepared by (Resource Unit Leader) J. Switzler; E. Matye (t); A. Uehara (t)	Approved by (Planning Section Chief) D. Cooper ; R. Leuck (t) ; J. Schillinger (t)	Date Prepared 09/29/14	Time Prepared 1013
--	---	---------------------------	-----------------------

Division Assignment List	1. Branch XVI	2. Division/Group 1 U
---------------------------------	-------------------------	---------------------------------

3. Incident Name KING - ZONE 1	4. Operational Period 09/30/14 Tuesday Day Shift 0600 - 1800
--	--

5. Operations Personnel

Operations Chief	LES CURTIS	Division/Group Supervisor	AARON RIISE
Contingency Ops Chief		Air Attack Supervisor	
Branch Director	SEAN JOHNSON; COREY ROSE (t)	Safety Officer	M.HAMEL; S. RYBERG; C.JORDAN (t)

6. Resources Assigned this Period

Strike Team/Task Force/ Resource Designator	Leader	Num of Pers.	Trans. Y/N	Drop Off PT./Time	Pick Up PT./Time
CRW T1 MAD RIVER IHC C-159 10/5	CHARLES HAIR	19	N	SUNSET SPIKE 0600	SUNSET SPIKE 1800
CRW T1 HELENA IHC C-246 9/30	FRED LUDWIG	21	N	SUNSET SPIKE 0600	SUNSET SPIKE 1800
CRW T2IA ACOMA #1 C-131 9/30	ANDREW HENRY	20	N	SUNSET SPIKE 0600	SUNSET SPIKE 1800
CRW T2IA FOLSOM LAKE C-137 10/1	MATT LYNDE	19	N	SUNSET SPIKE 0600	SUNSET SPIKE 1800
ENG S/T 1663 C E-819 10/7	PETER D STEPHENSON	27	N	SUNSET SPIKE 0600	SUNSET SPIKE 1800
ENG T6 681 E-366 10/1	TODD LIKE	3	N	SUNSET SPIKE 0600	SUNSET SPIKE 1800
FELB O-844 10/4	ROBERT W KRAMER	1	N	SUNSET SPIKE 0600	SUNSET SPIKE 1800
HEQB O-259 10/1	CHRIS COLT	1	N	SUNSET SPIKE 0600	SUNSET SPIKE 1800
SOFR O-3234 10/8	GALE S GIRE	1	N	SUNSET SPIKE 0600	SUNSET SPIKE 1800
FEMP O-760 10/4	KEVIN BERKERY	1	N	SUNSET SPIKE 0600	SUNSET SPIKE 1800
FEMT O-763 10/4	DONALD MCLAUGHLIN	1	N	SUNSET SPIKE 0600	SUNSET SPIKE 1800

7. Control Operations
Mop up to the degree necessary to make the likelihood of fire escape very low; based on experience, terrain, fuel types, and fuel conditions from Bunker Hill Lookout to Hell Hole Reservoir. Leave hose lay in place along the indirect line between Bunker Hill Lookout to Hell Hole Reservoir.

8. Special Instructions
****All dozers report to weed wash and lock all gates at end of shift.****
a. Day resources travel route to line via Foresthill Rd. Return via Mosquito Ridge Rd.
b. All Division Supervisors need to download information to the Sit Unit for all completed work.
c. Noxious weeds are marked by orange "noxious weed" flagging. Minimize or avoid activities in these areas.
d. Sensitive areas are marked with pink/black checkerboard flagging. Minimize ground disturbing activities in these areas.
e. Backhaul trash and equipment.

9. Division/Group Communications Summary

Function	Frequency - RX	Frequency - TX	Tone	System	Channel	System	Channel
Command	166.6125	168.4000	136.5	NIFC C4	1		
Tactical Div/Group	168.0500	168.0500		NIFC T1	5		
Logistics							
Air to Ground	169.1500	169.1500		A/G CMD	13		

Prepared by (Resource Unit Leader) J. Switzler; E. Matye (t); A. Uehara (t)	Approved by (Planning Section Chief) D. Cooper ; R. Leuck (t) ; J. Schillinger (t)	Date Prepared 09/29/14	Time Prepared 1013
--	---	---------------------------	-----------------------

Division Assignment List	1. Branch XVI	2. Division/Group 1 W
---------------------------------	-------------------------	---------------------------------

3. Incident Name KING - ZONE 1	4. Operational Period 09/30/14 Tuesday Day Shift 0600 - 1800
--	--

5. Operations Personnel

Operations Chief	LES CURTIS	Division/Group Supervisor	CHRIS VERO; JOHNNY VILLA (t)
Contingency Ops Chief		Air Attack Supervisor	
Branch Director	SEAN JOHNSON; COREY ROSE (t)	Safety Officer	M.HAMEL; S.RYBERG; C. JORDAN (t)

6. Resources Assigned this Period

Strike Team/Task Force/ Resource Designator	Leader	Num of Pers.	Trans. Y/N	Drop Off PT./Time	Pick Up PT./Time
CRW T2IA MS INTERAGENCY C-231 10/7	WADE IRISH	20	N	SUNSET SPIKE 0600	SUNSET SPIKE 1800
CRW T2 PALOMAR C-252 10/7	RUSTY SEXTON	19	N	SUNSET SPIKE 0600	SUNSET SPIKE 1800
ENG S/T T3 5605 C E-538 10/3	VICTOR LEFOR	27	N	SUNSET SPIKE 0600	SUNSET SPIKE 1800
HEQB O-823 10/6	MICHAEL WORK	1	N	SUNSET SPIKE 0600	SUNSET SPIKE 1800
FALM O-870 10/4	JAMES MORGAN	2	N	SUNSET SPIKE 0600	SUNSET SPIKE 1800
FALM O-878 10/4	JASON WASS	2	N	SUNSET SPIKE 0600	SUNSET SPIKE 1800
FALB O-851 10/5	COURTNEY WALLACE	1	N	SUNSET SPIKE 0600	SUNSET SPIKE 1800
SOFR O-3089 10/4	JECOBIE WATERS	1	N	SUNSET SPIKE 0600	SUNSET SPIKE 1800
SOFR (t) O-938 10/4	MATTHEW BROWN	1	N	SUNSET SPIKE 0600	SUNSET SPIKE 1800
FEMP O-494 10/1	DANIEL NUNEZ	1	N	SUNSET SPIKE 0600	SUNSET SPIKE 1800
FEMT O-495 10/1	TRAVIS MOORE	1	N	SUNSET SPIKE 0600	SUNSET SPIKE 1800

7. Control Operation

Mop up to the degree necessary to make the likelihood of fire escape very low; based on experience, terrain, fuel types, and fuel conditions. Remove all hose and appliances from Bunker Hill Lookout along Wentworth Springs Road south to the 28 Road.

8. Special Instructions

- **All dozers report to weed wash and lock all gates at end of shift.****
- a. Day resources travel route to line via Foresthill Rd. Return via Mosquito Ridge Rd.
 - b. All Division Supervisors need to download information to the Sit Unit for all completed work.
 - c. Noxious weeds are marked by orange "noxious weed" flagging. Minimize or avoid activities in these areas.
 - d. Sensitive areas are marked with pink/black checkerboard flagging. Minimize ground disturbing activities in these areas.
 - e. Backhaul trash and equipment.

9. Division/Group Communications Summary

Function	Frequency - RX	Frequency - TX	Tone	System	Channel	System	Channel
Command	166.6125	168.4000	136.5	NIFC C4	1		
Tactical Div/Group	166.5500	166.5500		R5 T4	10		
Logistics							
Air to Ground	169.1500	169.1500		A/G CMD	13		

Prepared by (Resource Unit Leader) J. Switzler; E. Matye (t); A. Uehara (t)	Approved by (Planning Section Chief) D. Cooper; R. Leuck (t); J. Schillinger (t)	Date Prepared 09/29/14	Time Prepared 1013
--	---	---------------------------	-----------------------

Division Assignment List	1. Branch XVI	2. Division/Group 1 Y
---------------------------------	-------------------------	---------------------------------

3. Incident Name KING - ZONE 1	4. Operational Period 09/30/14 Tuesday Day Shift 0600 - 1800
--	--

5. Operations Personnel			
Operations Chief	LES CURTIS	Division/Group Supervisor	K. OLSON; D. SOLDAVINI (t)
Contingency Ops Chief		Air Attack Supervisor	
Branch Director	SEAN JOHNSON; COREY ROSE(t)	Safety Officer	M HAMEL; S. RYBERG; C. JORDAN (t)

6. Resources Assigned this Period					
Strike Team/Task Force/ Resource Designator	Leader	Num of Pers.	Trans. Y/N	Drop Off PT./Time	Pick Up PT./Time
CRW T2 BEAR JAW C-9 9/30	JD OTTMAN	20	N	SUNSET SPIKE 0600	SUNSET SPIKE 1800
CRW T2IA AOICC INTER C-10 9/30	TIM DEATON	20	N	SUNSET SPIKE 0600	SUNSET SPIKE 1800
CRW T2 OC 19 C-194 9/30	JAMES BOLLINGER	20	N	SUNSET SPIKE 0600	SUNSET SPIKE 1800
ENG T6 4562 E-359 10/1	CHRISTOPHER MOORE	3	N	SUNSET SPIKE 0600	SUNSET SPIKE 1800
ENG T3 44 E-634 10/4	DYLAN PREWITT	5	N	SUNSET SPIKE 0600	SUNSET SPIKE 1800
ENG T3 462 E-639 10/5	MARK GOSHORN	5	N	SUNSET SPIKE 0600	SUNSET SPIKE 1800
WT T3 AWB INC E-13 10/6	RON BELION	1	N	SUNSET SPIKE 0600	SUNSET SPIKE 1800
WT T1 TACTICAL E-128 9/30	ALAN WEST	2	N	SUNSET SPIKE 0600	SUNSET SPIKE 1800
CHIP T3E-438 10/3	GIDEON MACOMBER	2	N	SUNSET SPIKE 0600	SUNSET SPIKE 1800
CHIP E-439 10/2	TIM BURKE	1	N	SUNSET SPIKE 0600	SUNSET SPIKE 1800
CHIP T3 E-471 10/3		2	N	SUNSET SPIKE 0600	SUNSET SPIKE 1800
CHIP T3 E-472 10/2		10	N	SUNSET SPIKE 0600	SUNSET SPIKE 1800
STEN O-895 10/2	JESS REGISTER	1	N	SUNSET SPIKE 0600	SUNSET SPIKE 1800
SOFR O-785 10/5	STEVEN COUNTS	1	N	SUNSET SPIKE 0600	SUNSET SPIKE 1800
FEMP O-960 9/30	STEVEN WALLACE	1	N	SUNSET SPIKE 0600	SUNSET SPIKE 1800
FEMT O-968 10/6	CORY HAAS	1	N	SUNSET SPIKE 0600	SUNSET SPIKE 1800
FOBS O-450 10/2	ALEX RUDNEY	1	N	SUNSET SPIKE 0600	SUNSET SPIKE 1800
FOBS (t) O-613 10/2	JAMES CRAIG	1	N	SUNSET SPIKE 0600	SUNSET SPIKE 1800

7. Control Operations
Mop up to the degree necessary to make the likelihood of fire escape very low; based on experience, terrain, fuel types, and fuel conditions from 28 Road along Wentworth Road south to the Ice House and Wentworth Road intersection.

8. Special Instructions
****All dozers report to weed wash and lock all gates at end of shift.****
a. Day resources travel route to line via Foresthill Rd. Return via Mosquito Ridge Rd.
b. All Division Supervisors need to download information to the Sit Unit for all completed work.
c. Noxious weeds are marked by orange "noxious weed" flagging. Minimize or avoid activities in these areas.
d. Sensitive areas are marked with pink/black checkerboard flagging. Minimize ground disturbing activities in these areas.
e. Backhaul trash and equipment.

9. Division/Group Communications Summary							
Function	Frequency - RX	Frequency - TX	Tone	System	Channel	System	Channel
Command	166.6125	168.4000	136.5	NIFC C4	1		
Tactical Div/Group	167.1125	167.1125		R5 T5	11		
Logistics							
Air to Ground	169.1500	169.1500		A/G CMD	13		

Prepared by (Resource Unit Leader) J. Switzler; E. Mayte (t); A. Uehara (t)	Approved by (Planning Section Chief) D. Cooper; R. Leuck (t); J. Schillinger (t)	Date Prepared 09/29/14	Time Prepared 1012
--	---	---------------------------	-----------------------

Division Assignment List	1. Branch XVI	2. Division/Group 1 Z
---------------------------------	-------------------------	---------------------------------

3. Incident Name KING - ZONE 1	4. Operational Period 09/30/14 Tuesday Day Shift 0600 - 1800
--	--

5. Operations Personnel

Operations Chief	LES CURTIS	Division/Group Supervisor	JUSTIN HANELY; SHANNON MYERS (t)
Contingency Ops Chief		Air Attack Supervisor	
Branch Director	SEAN JOHNSON; COREY ROSE (t)	Safety Officer	M.HAMEL; S.RYBERG; C.JORDAN (t)

6. Resources Assigned this Period

Strike Team/Task Force/ Resource Designator	Leader	Num of Pers.	Trans. Y/N	Drop Off PT./Time	Pick Up PT./Time
ENG T3 72 E-550 10/5	DAVID MOLTER	5	N	SUNSET SPIKE 0600	SUNSET SPIKE 1800
SOF2 O-657 10/2	RICHARD L GEARHART	1	N	SUNSET SPIKE 0600	SUNSET SPIKE 1800
FEMP O-974 9/30	LEO GRANADOS	1	N	SUNSET SPIKE 0600	SUNSET SPIKE 1800
FEMT O-969	ERIC CONNORS	1	N	SUNSET SPIKE 0600	SUNSET SPIKE 1800

7. Control Operations
Mop up to the degree necessary to make the likelihood of fire escape very low; based on experience, terrain, fuel types, and fuel conditions from the Ice House and Wentworth Road intersection west on Wentworth Road to Heartless Mountain.

8. Special Instructions
****All dozers report to weed wash and lock all gates at end of shift.****
a. Day resources travel route to line via Foresthill Rd. Return via Mosquito Ridge Rd.
b. All Division Supervisors need to download information to the Sit Unit for all completed work.
c. Noxious weeds are marked by orange "noxious weed" flagging. Minimize or avoid activities in these areas.
d. Sensitive areas are marked with pink/black checkerboard flagging. Minimize ground disturbing activities in these areas.
e. Backhaul trash and equipment.

9. Division/Group Communications Summary

Function	Frequency - RX	Frequency - TX	Tone	System	Channel	System	Channel
Command	166.6125	168.4000	136.5	NIFC C4	1		
Tactical Div/Group	166.7250	166.7250		NIFC T5	7		
Logistics							
Air to Ground	169.1500	169.1500		A/G CMD	13		

Prepared by (Resource Unit Leader) J. Switzler; E. Matye (t); A. Uehara (t)	Approved by (Planning Section Chief) D. Cooper ; R. Luck (t); J. Schillinger (t)	Date Prepared 09/29/14	Time Prepared 1012
--	---	---------------------------	-----------------------

Division Assignment List			1. Branch CONTINGENCY		2. Division/Group AMERICAN		
3. Incident Name KING - ZONE 1			4. Operational Period 09/30/14 Tuesday Day Shift 0600 - 1800				
5. Operations Personnel							
Operations Chief		LES CURTIS			Division/Group Supervisor		DEANO ESADES / JEFF GOYINGS (t)
Contingency Ops Chief					Air Attack Supervisor		
Branch Director		DON FORSYTH; MATT CONKLIN			Safety Officer		M.HAMEL; S.RYBERG; C.JORDAN (t)
6. Resources Assigned this Period							
Strike Team/Task Force/ Resource Designator		Leader		Num of Pers.	Trans. Y/N	Drop Off PT./Time	Pick Up PT./Time
CRW T2 GRAYBACK C-206 10/8		ANTONIO MENDOZA		20	N		SUNSET SPIKE 1800
CRW T2 BLACK EAGLES 5 C-198 10/5		DANIEL AREGUIN		22	N		SUNSET SPIKE 1800
CRW T2 MQ FRANCO C-43 10/1		ANDREW HENRY		20	N		SUNSET SPIKE 1800
CRW T2 GRAYBACK C-205 10/5		RYAN WATKINS		20	N		SUNSET SPIKE 1800
T/F ENF KING #9							SUNSET SPIKE 1800
TFLD O-888 10/5		NATE HALLAM		1	N		SUNSET SPIKE 1800
ENG T3 35 E-546 10/5		WADE JONES		5	N		SUNSET SPIKE 1800
ENG T3 TMU #42 E-266 9/30		BRIAN ETHERIDG		5	N		SUNSET SPIKE 1800
ENG T3 33 E-549 10/5		BRYAN LANNING		5	N		SUNSET SPIKE 1800
CHIP T2 E-792 10/7		LEWIS YAEGER		2	N		SUNSET SPIKE 1800
CHIP T1 E-794 10/8		CARLOS SANCHEZ		2	N		SUNSET SPIKE 1800
CHIP T1 J E-795 10/6		H. JACKSON		2	N		SUNSET SPIKE 1800
CHIP T1 E-796 10/6				2	N		SUNSET SPIKE 1800
CHIP T3 E-797 10/6				2	N		SUNSET SPIKE 1800
CHIPP T3 C&R E-801 10/8		DILLON NEWMANN		2	N		SUNSET SPIKE 1800
CHIP T2 A CUT ABOVE E-578 10/5				1	N		SUNSET SPIKE 1800
CHIP T1 VALLEY TIMBER E-799 10/6				2	N		SUNSET SPIKE 1800
CHIP T3 C&R E-800 10/8				2	N		SUNSET SPIKE 1800
CHIP T3 TREEMASTER E-585 10/5		CODY MYERS		1	N		SUNSET SPIKE 1800
CHIP T2 CTS VENTURES E-586 10/6		KALVIN CYRUS		1	N		SUNSET SPIKE 1800
7. Control Operations							
Chip cut material and improve road systems along Ralston Ridge from Drop Point 109 to Drop Point 161.							
8. Special Instructions							
All dozers report to weed wash and lock all gates at end of shift.							
a. Day resources travel route to line via Foresthill Rd. Return via Mosquito Ridge Rd.							
b. All Division Supervisors need to download information to the Sit Unit for all completed work.							
c. Noxious weeds are marked by orange "noxious weed" flagging. Minimize or avoid activities in these areas.							
d. Sensitive areas are marked with pink/black checkerboard flagging. Minimize ground disturbing activities in these areas.							
e. Backhaul trash and equipment.							
9. Division/Group Communications Summary							
Function	Frequency - RX	Frequency - TX	Tone	System	Channel	System	Channel
Command	166.6125	168.4000	136.5	NIFC C4	1		
Tactical Div/Group	168.2375	168.2375		R5 T6	12		
Logistics							
Air to Ground	169.1500	169.1500		A/G CMD	13		
Prepared by (Resource Unit Leader) J. Switzler; E. Matye (t); A. Uehara (t)			Approved by (Planning Section Chief) D. Cooper; R. Keuck (t); J. Schillinger (t)		Date Prepared 09/29/14	Time Prepared 1012	

Division Assignment List	1. Branch CONTINGENCY	2. Division/Group AMERICA
---------------------------------	---------------------------------	-------------------------------------

3. Incident Name KING - ZONE 1	4. Operational Period 09/30/14 Tuesday Day Shift 0600 - 1800
--	--

5. Operations Personnel

Operations Chief	LES CURTIS	Division/Group Supervisor	DEANO ESADES; JEFF GOYINGS (t)
Contingency Ops Chief		Air Attack Supervisor	
Branch Director	DON FORSYTH; MATT CONKLIN	Safety Officer	M.HAMEL; S. RYBERG; C.JORDAN (t)

6. Resources Assigned this Period

Strike Team/Task Force/ Resource Designator	Leader	Num of Pers.	Trans. Y/N	Drop Off PT./Time	Pick Up PT./Time
CHIP T2 ABRAHAM E-798 10/7	MIKE JONES	1	N		SUNSET SPIKE 1800
MAST T1 BOOM MOUNTED E-860 10/8	TIM BORDGES	2	N		SUNSET SPIKE 1800
SOFR O-965 10/7	TOM RAW	1	N		SUNSET SPIKE 1800
SOFR O-963 10/7	RICHARD LUDKE	1	N		SUNSET SPIKE 1800
FEMP O-758 10/5	MATTHEW LUCAS	1	N		SUNSET SPIKE 1800
FEMT O-764 10/5	SCOTT HARLAN	1	N		SUNSET SPIKE 1800
FEMP O-973 9/30	SERGIO ZAVALA	1	N		SUNSET SPIKE 1800
FEMT O-972 10/6	CHARLES MCGARY	1	N		SUNSET SPIKE 1800

7. Control Operations

Chip cut material and improve road systems along Ralston Ridge from Drop Point 109 to Drop Point 161.

8. Special Instructions

- **All dozers report to weed wash and lock all gates at end of shift.****
- a. Day resources travel route to line via Foresthill Rd. Return via Mosquito Ridge Rd.
 - b. All Division Supervisors need to download information to the Sit Unit for all completed work.
 - c. Noxious weeds are marked by orange "noxious weed" flagging. Minimize or avoid activities in these areas.
 - d. Sensitive areas are marked with pink/black checkerboard flagging. Minimize ground disturbing activities in these areas.
 - e. Backhaul trash and equipment.

9. Division/Group Communications Summary

Function	Frequency - RX	Frequency - TX	Tone	System	Channel	System	Channel
Command	166.6125	168.4000	136.5	NIFC C4	1		
Tactical Div/Group	168.2375	168.2375		R5 T6	12		
Logistics							
Air to Ground	169.1500	169.1500		A/G CMD	13		
Prepared by (Resource Unit Leader) J. Switzler; E. Matye (t); A. Uehara (t)			Approved by (Planning Section Chief) D. Cooper; R. Leuck (t); J. Schillinger (t)		Date Prepared 09/29/14	Time Prepared 1012	

Division Assignment List	1. Branch CONTINGENCY	2. Division/Group OXBOW
---------------------------------	---------------------------------	-----------------------------------

3. Incident Name KING - ZONE 1	4. Operational Period 09/30/14 Tuesday Day Shift 0600 - 1800
--	--

5. **Operations Personnel**

Operations Chief	LES CURTIS	Division/Group Supervisor	THOMAS BROWNING
Contingency Ops Chief		Air Attack Supervisor	
Branch Director	DON FORSYTH; MATT CONKLIN	Safety Officer	M.HAMEL; S. RYBERG; C.JORDAN (t)

6. **Resources Assigned this Period**

Strike Team/Task Force/ Resource Designator	Leader	Num of Pers.	Trans. Y/N	Drop Off PT./Time	Pick Up PT./Time
CRW T2IA FL ST #1 C-227 10/7	CHARLES KOON	20	N		SUNSET SPIKE 1800
CRW T2IA FL ST #3 C-228 10/7	DAVID THURSTON	20	N		SUNSET SPIKE 1800
CRW T2 OC 52 C-190 10/5	DONALD KEVIN BOWEN	22	N		SUNSET SPIKE 1800
CRW T2 OC 21 C-193 10/7	BRIAN HICKS	21	N		SUNSET SPIKE 1800
CHIP T1 HIGH CLIMBERS E-583 10/5	CURTIS KING	2	N		SUNSET SPIKE 1800
CHIP T2 CECIL LOGGI E-580 10/5	TOM THOMAS	1	N		SUNSET SPIKE 1800
SOFR O-965 10/7	TOM RAW	1	N		SUNSET SPIKE 1800
SOFR O-963 10/7	RICHARD LUDKE	1	N		SUNSET SPIKE 1800
FEMP O-759 10/4	TRAVIS MEDINA	1	N		SUNSET SPIKE 1800
FEMT O-768 10/4	NICHOLAS R MARTINO	1	N		SUNSET SPIKE 1800

7. **Control Operations**

Chip cut material off the road systems along Ralston Ridge from Lynchburg break to the Rubicon River.

8. **Special Instructions**

- **All dozers report to weed wash and lock all gates at end of shift.****
- a. Day resources travel route to line via Foresthill Rd. Return via Mosquito Ridge Rd.
 - b. All Division Supervisors need to download information to the Sit Unit for all completed work.
 - c. Noxious weeds are marked by orange "noxious weed" flagging. Minimize or avoid activities in these areas.
 - d. Sensitive areas are marked with pink/black checkerboard flagging. Minimize ground disturbing activities in these areas.
 - e. Backhaul trash and equipment.

9. **Division/Group Communications Summary**

Function	Frequency - RX	Frequency - TX	Tone	System	Channel	System	Channel
Command	166.6125	168.4000	136.5	NIFC C4	1		
Tactical Div/Group	168.2375	168.2375		R5 T6	12		
Logistics							
Air to Ground	169.1500	169.1500		A/G CMD	13		

Prepared by (Resource Unit Leader) J. Switzler; E. Matye (t); A. Uehara (t)	Approved by (Planning Section Chief) D. Cooper; R. Leuck (t); J. Schillinger (t)	Date Prepared 09/29/14	Time Prepared 1012
--	---	---------------------------	-----------------------

Final PR 2

Division Assignment List	1. Branch CONTINGENCY	2. Division/Group SODA SPRINGS
---------------------------------	---------------------------------	--

3. Incident Name KING - ZONE 1	4. Operational Period 09/30/14 Tuesday Day Shift 0600 - 1800
--	---

5. Operations Personnel

Operations Chief	LES CURTIS	Division/Group Supervisor	RODNEY REDINGER; RUSS BLAIR (t)
Contingency Ops Chief		Air Attack Supervisor	
Branch Director	DON FORSYTH; MATT CONKLIN	Safety Officer	M.HAMEL; S.RYBERG; C.JORDAN (t)

6. Resources Assigned this Period
--

Strike Team/Task Force/ Resource Designator	Leader	Num of Pers.	Trans. Y/N	Drop Off PT./Time	Pick Up PT./Time
CRW T2IA CAC #4 C-16 9/30	RON E BROWN	19	N		SUNSET SPIKE 1800
FELB O-983 10/6	RAY CHAVEZ	1	N		SUNSET SPIKE 1800
SOFR O-965 10/7	TOM RAW	1	N		SUNSET SPIKE 1800
SOFR O-963 10/7	RICHARD LUDKE	1	N		SUNSET SPIKE 1800

7. Control Operations

Chip cut material along Ralston Road.

8. Special Instructions

- **All dozers report to weed wash and lock all gates at end of shift.****
- Day resources travel route to line via Foresthill Rd. Return via Mosquito Ridge Rd.
 - All Division Supervisors need to download information to the Sit Unit for all completed work.
 - Noxious weeds are marked by orange "noxious weed" flagging. Minimize or avoid activities in these areas.
 - Sensitive areas are marked with pink/black checkerboard flagging. Minimize ground disturbing activities in these areas.
 - Backhaul trash and equipment.

9. Division/Group Communications Summary

Function	Frequency - RX	Frequency - TX	Tone	System	Channel	System	Channel
Command	166.6125	168.4000	136.5	NIFC C4	1		
Tactical Div/Group	168.2375	168.2375		R5 T6	12		
Logistics							
Air to Ground	169.1500	169.1500		A/G CMD	13		

Prepared by (Resource Unit Leader) J. Switzler; E. Matye (t); A. Uehara (t)	Approved by (Planning Section Chief) D. Cooper; R. Leuck (t); J. Schillinger (t)	Date Prepared 09/29/14	Time Prepared 1012
--	---	---------------------------	-----------------------

Division Assignment List	1. Branch REHAB REPAIR BRANCH X	2. Division/Group
	3. Incident Name KING - ZONE 1	

4. Operational Period 09/30/14 Tuesday Day Shift 0600 - 1800	
--	--

5. Operations Personnel			
Operations Chief	LES CURTIS	Division/Group Supervisor	CHARLES ALLUISI; BROOKS BAKER (t)
Contingency Ops Chief		Air Attack Supervisor	
Branch Director	R. COPP; D. BRYANT; Q. CHUNG (t)	Safety Officer	M. HAMEL; S. RYBERG; C. JORDAN (t)

6. Resources Assigned this Period						
Strike Team/Task Force/ Resource Designator	Leader	Num of Pers.	Trans. Y/N	Drop Off PT./Time	Pick Up PT./Time	
DOZ T2 BEN'S TRUCK & EQ E-100 9/30	DAVID LAWRENCE	2	N	ICP 0600	PLACERVILE ICP 1800	
DOZ T2 BEN'S TRUCK & EQ E-103 9/30	BUTCH SMITH	4	N	ICP 0600	PLACERVILE ICP 1800	
EXCA T1V BEN'S E-859 10/8	CURT SAVE	2	N	ICP 0600	PLACERVILE ICP 1800	
SKIDDER A & F ENTP E-912 10/8	MICHAEL TEONEY	1	N	ICP 0600	PLACERVILE ICP 1800	
EXCA T2 KOLKOWSKI E-1005	DENNIS MCGOUGH	1	N	ICP 0600	PLACERVILE ICP 1800	
HEQB O-826 10/5	BRENTWOOD REID	1	N	ICP 0600	PLACERVILE ICP 1800	
HEQB O-834 10/6	JAMES WILLIAMS	1	N	ICP 0600	PLACERVILE ICP 1800	
HEQB O-833 10/6	JOSH WILLIAMS	1	N	ICP 0600	PLACERVILE ICP 1800	
HEQB O-838 10/7	TERRON GEE	1	N	ICP 0600	PLACERVILE ICP 1800	
HEQB O-837 10/5	JAMES DICKINSON	1	N	ICP 0600	PLACERVILE ICP 1800	
HEQB O-839 10/6	MIKE KUHNERT	1	N	ICP 0600	PLACERVILE ICP 1800	
HEQB O-830 10/5	FRED MANGLONA	1	N	ICP 0600	PLACERVILE ICP 1800	
HEQB (t) O-1029 10/2	RACHAEL HANSON	1	N	ICP 0600	PLACERVILE ICP 1800	
HEQB O-262 9/30	TERRY WARLICK	1	N	ICP 0600	PLACERVILE ICP 1800	
SOFR O-963 10/7	RICHARD LUDKE	1	N	ICP 0600	PLACERVILE ICP 1800	
FEMP O-973 9/30	SERGIO ZAVALA	1	N	ICP 0600	PLACERVILE ICP 1800	
FEMT O-972 10/6	CHARLES MCGARY	1	N	ICP 0600	PLACERVILE ICP 1800	
FOBS O-1122 10/10	JASON GREEN	1	N	ICP 0600	PLACERVILE ICP 1800	
FOBS (t) O-3327 10/10	BEN MOLITOR	1	N	ICP 0600	PLACERVILE ICP 1800	
READ O-3322 10/9	DYLAN MCCOY	1	N	ICP 0600	PLACERVILE ICP 1800	

7. Control Operations

Complete suppression repair utilizing the Suppression Repair Guidelines from Drop Point 102 to 51 Road along the Tevis Cup Trail and from the 2 and 26 Road intersection east to Wallace Spring along the 2 Road.

8. Special Instructions

****All dozers report to weed wash and lock all gates at end of shift.****

- Day resources travel route to line via Foresthill Rd. Return via Mosquito Ridge Rd.
- All Division Supervisors need to download information to the Sit Unit for all completed work.
- Noxious weeds are marked by orange "noxious weed" flagging. Minimize or avoid activities in these areas.
- Sensitive areas are marked with pink/black checkerboard flagging. Minimize ground disturbing activities in these areas.

9. Division/Group Communications Summary							
Function	Frequency - RX	Frequency - TX	Tone	System	Channel	System	Channel
Command	166.6125	168.4000	136.5	NIFC C4	1		
Tactical Div/Group	167.1125	167.1125		R5 T5	11		
Logistics							
Air to Ground	169.1500	169.1500		A/G CMD	13		
Prepared by (Resource Unit Leader) J. Switzler; E. Matye (t); A. Uehara (t)		Approved by (Planning Section Chief) D. Cooper; R. Leuck (t); J. Schillinger (t)		Date Prepared 09/29/14		Time Prepared 1014	

Division Assignment List	1. Branch REHAB REPAIR BRANCH X	2. Division/Group
---------------------------------	---	-------------------

3. Incident Name KING - ZONE 1	4. Operational Period 09/30/14 Tuesday Day Shift 0600 - 1800
--	---

5. Operations Personnel

Operations Chief	LES CURTIS	Division/Group Supervisor	CHARLES ALLUISI; BROOKS BAKER (t)
Contingency Ops Chief		Air Attack Supervisor	
Branch Director	R. COPP; D. BRYANT; Q. CHUNG (t)	Safety Officer	M. HAMEL; S. RYBERG; C. JORDAN (t)

6. Resources Assigned this Period

Strike Team/Task Force/ Resource Designator	Leader	Num of Pers.	Trans. Y/N	Drop Off PT./Time	Pick Up PT./Time
READ O-929 10/6	TOM JONES	1	N	ICP 0600	PLACERVILLE ICP 1800

7. Control Operations

Complete suppression repair utilizing the Suppression Repair Guidelines from Drop Point 102 to 51 Road along the Tevis Cup Trail and from the 2 and 26 Road intersection east to Wallace Spring along the 2 Road.

8. Special Instructions

- **All dozers report to weed wash and lock all gates at end of shift.****
- a. Day resources travel route to line via Foresthill Rd. Return via Mosquito Ridge Rd.
 - b. All Division Supervisors need to download information to the Sit Unit for all completed work.
 - c. Noxious weeds are marked by orange "noxious weed" flagging. Minimize or avoid activities in these areas.
 - d. Sensitive areas are marked with pink/black checkerboard flagging. Minimize ground disturbing activities in these areas.

9. Division/Group Communications Summary

Function	Frequency - RX	Frequency - TX	Tone	System	Channel	System	Channel
Command	166.6125	168.4000	136.5	NIFC C4	1		
Tactical Div/Group	167.1125	167.1125		R5 T5	11		
Logistics							
Air to Ground	169.1500	169.1500		A/G CMD	13		

Prepared by (Resource Unit Leader) J. Switzler; E. Matye (t); A.Uehara (t)	Approved by (Planning Section Chief) D.Cooper; R. Leuck (t); J. Schillinger (t)	Date Prepared 09/29/14	Time Prepared 1841
---	--	---------------------------	-----------------------

Division Assignment List		1. Branch REHAB REPAIR BRANCH XII		2. Division/Group			
3. Incident Name KING - ZONE 1		4. Operational Period 09/30/14 Tuesday Day Shift 0600 - 1800					
5. Operations Personnel							
Operations Chief		LES CURTIS		Division/Group Supervisor		MARK DARRAGH	
Contingency Ops Chief				Air Attack Supervisor			
Branch Director		R. COPP; D. BRYANT; Q. CHUNG (t)		Safety Officer		M. HAMEL; S. RYBERG; C. JORDAN (t)	
6. Resources Assigned this Period							
Strike Team/Task Force/ Resource Designator		Leader	Num of Pers.	Trans. Y/N	Drop Off PT./Time	Pick Up PT./Time	
CRW T2IA MONTEREY C-254 10/6		KEVIN W POYNER	19	N	ICP 0600	PLACERVILLE ICP 1800	
CRW T21A GILA REGULAR C-171 10/4		FELIX VALDEZ	20	N	ICP 0600	PLACERVILLE ICP 1800	
CRW T2IA COBRAS 4 C-202 10/4		VINCE MONTES	22	N	ICP 0600	PLACERVILLE ICP 1800	
CRW T2IA KICC C-230 10/7		MARK RAGAN	20	N	ICP 0600	PLACERVILLE ICP 1800	
CRW T2IA PIMA #1 C-175 9/29		MARIO RAY DIA	17	N	ICP 0600	PLACERVILLE ICP 1800	
CRW T2 SCORPIONS 6 C-242 10/6		ROBERT NEVAREZ	22	N	ICP 0600	PLACERVILLE ICP 1800	
CRW T2 OC 25 C-191 10/4		MICHAEL SCHEU	17	N	ICP 0600	PLACERVILLE ICP 1800	
DOZ T2 E-567 10/5		CLAY BOSCHI	2	N	ICP 0600	PLACERVILLE ICP 1800	
DOZ T2 E-556 10/5		RANDY STRIEFF	4	N	ICP 0600	PLACERVILLE ICP 1800	
DOZ T2 E-559 10/5		DUANE HAASE	2	N	ICP 0600	PLACERVILLE ICP 1800	
DOZ T2 E-561 10/5		TRAVIS FORTNER	4	N	ICP 0600	PLACERVILLE ICP 1800	
DOZ T2 DUDLEYS E-558 10/4			2	N	ICP 0600	PLACERVILLE ICP 1800	
DOZ T2 GRAHAM E-42 9/28		JEFF GRAHAM	2	N	ICP 0600	PLACERVILLE ICP 1800	
DOZ T2 E-572 10/5		SONNY MOORE	3	N	ICP 0600	PLACERVILLE ICP 1800	
DOZ T2 E-566 9/29		MARK BASHAM	2	N	ICP 0600	PLACERVILLE ICP 1800	
DOZ T2 E-210		RICK RODGER	3	N	ICP 0600	PLACERVILLE ICP 1800	
EXCA T1 E-973 10/11		DALE BRISKI	2	N	ICP 0600	PLACERVILLE ICP 1800	
TFLD O-810 10/5		TOMAS C GONZALEZ	1	N	ICP 0600	PLACERVILLE ICP 1800	
HEQB O-261 10/1		DARIC BURR	1	N	ICP 0600	PLACERVILLE ICP 1800	
HEQB O-825 10/6		EDMOND D WILHITE	1	N	ICP 0600	PLACERVILLE ICP 1800	
7. Control Operations							
Complete suppression repair utilizing the Suppression Repair Guidelines around the spot fire east of French Meadow Reservoir.							
8. Special Instructions							
All dozers report to weed wash and lock all gates at end of shift.							
a. Day resources travel route to line via Foresthill Rd. Return via Mosquito Ridge Rd.							
b. All Division Supervisors need to download information to the Sit Unit for all completed work.							
c. Noxious weeds are marked by orange "noxious weed" flagging. Minimize or avoid activities in these areas.							
d. Sensitive areas are marked with pink/black checkerboard flagging. Minimize ground disturbing activities in these areas.							
9. Division/Group Communications Summary							
Function	Frequency - RX	Frequency - TX	Tone	System	Channel	System	Channel
Command	166.6125	168.4000	136.5	NIFC C4	1		
Tactical Div/Group	167.1125	167.1125		R5 T5	11		
Logistics							
Air-to-Ground	169.1500	169.1500		A/G CMD	13		
Prepared by (Resource Unit Leader) J. Switzler; E. Matye (t); A. Uehara (t)			Approved by (Planning Section Chief) D. Cooper; R. Leuck (t); J. Schillinger(t)		Date Prepared 09/29/14	Time Prepared 1014	

Division Assignment List		1. Branch REHAB REPAIR BRANCH XII		2. Division/Group			
3. Incident Name KING - ZONE 1		4. Operational Period 09/30/14 Tuesday Day Shift 0600 - 1800					
5. Operations Personnel							
Operations Chief LES CURTIS		Division/Group Supervisor MARK DARRAGH					
Contingency Ops Chief		Air Attack Supervisor					
Branch Director R. COPP; D. BRYANT; Q. CHUNG (t)		Safety Officer M.HAMEL; S. RYBERG; C.JORDAN (t)					
6. Resources Assigned this Period							
Strike Team/Task Force/ Resource Designator	Leader	Num of Pers.	Trans. Y/N	Drop Off PT./Time	Pick Up PT./Time		
HEQB O-842	JIMMY MORRIS	1	N	ICP 0600	PLACERVILLE ICP 1800		
HEQB O-835 10/5	RIGOBERTO FLORES	1	N	ICP 0600	PLACERVILLE ICP 1800		
HEQB O-242 10/1	BRANDON WOODWARD	1	N	ICP 0600	PLACERVILLE ICP 1800		
HEQB (t) O-3185 10/5	GABRIEL O'KEEFE	1	N	ICP 0600	PLACERVILLE ICP 1800		
HEQB O-787 10/5	HEATHER FISHER	1	N	ICP 0600	PLACERVILLE ICP 1800		
FEMP O-973 9/30	SERGIO ZAVALA	1	N	ICP 0600	PLACERVILLE ICP 1800		
FEMT O-972 10/6	CHARLES MCGARY	1	N	ICP 0600	PLACERVILLE ICP 1800		
FOBS O-1144 10/11	STEVE ROSS	1	N	ICP 0600	PLACERVILLE ICP 1800		
FOBS O-3327 10/10	BENJAMIN T MOLITOR	1	N	ICP 0600	PLACERVILLE ICP 1800		
FOBS O-1147 10/11	RICHARD RATAJ	1	N	ICP 0600	PLACERVILLE ICP 1800		
FOBS O-1122 10/10	JASON GREEN	1	N	ICP 0600	PLACERVILLE ICP 1800		
READ O-920 10/5	CHELSIE BROKENSHERE	1	N	ICP 0600	PLACERVILLE ICP 1800		
READ O-326 9/30	DAN TEATER	1	N	ICP 0600	PLACERVILLE ICP 1800		
READ O-921 10/6	MARY SULLIVAN	1	N	ICP 0600	PLACERVILLE ICP 1800		
READ O- 1136	JAIME TUI TELE-LEWIS	1	N	ICP 0600	PLACERVILLE ICP 1800		
READ O-931 10/5	DEVIN SNYDER	1	N	ICP 0600	PLACERVILLE ICP 1800		
READ O-684 10/2	KYLE JOHNSON	1	N	ICP 0600	PLACERVILLE ICP 1800		
READ O-1161	ROBERTA LIM	1	N	ICP 0600	PLACERVILLE ICP 1800		
7. Control Operations							
Complete suppression repair utilizing the Suppression Repair Guidelines around the spot fire east of French Meadow Reservoir.							
8. Special Instructions							
All dozers report to weed wash and lock all gates at end of shift.							
a. Day resources travel route to line via Foresthill Rd. Return via Mosquito Ridge Rd.							
b. All Division Supervisors need to download information to the Sit Unit for all completed work.							
c. Noxious weeds are marked by orange "noxious weed" flagging. Minimize or avoid activities in these areas.							
d. Sensitive areas are marked with pink/black checkerboard flagging. Minimize ground disturbing activities in these areas.							
9. Division/Group Communications Summary							
Function	Frequency - RX	Frequency - TX	Tone	System	Channel	System	Channel
Command	166.6125	168.4000	136.5	NIFC C4	1		
Tactical Div/Group	167.1125	167.1125		R5 T5	11		
Logistics							
Air to Ground	169.1500	169.1500		A/G CMD	13		
Prepared by (Resource Unit Leader) J. Switzler; E. Matye (t); A.Uehara (t)		Approved by (Planning Section Chief) D.Cooper; R. Leuck (t); J. Schillinger(t)		Date Prepared 09/29/14		Time Prepared 1013	

Division Assignment List	1. Branch REHAB REPAIR BRANCH XVI	2. Division/Group
---------------------------------	---	-------------------

3. Incident Name KING - ZONE 1	4. Operational Period 09/30/14 Tuesday Day Shift 0600 - 1800
--	--

5. Operations Personnel			
Operations Chief	LES CURTIS	Division/Group Supervisor	JOEL KERLEY
Contingency Ops Chief		Air Attack Supervisor	
Branch Director	R. COPP; D. BRYANT; Q. CHUNG (t)	Safety Officer	M. HAMEL; S. RYBERG; C. JORDAN (t)

6. Resources Assigned this Period						
Strike Team/Task Force/ Resource Designator	Leader	Num of Pers.	Trans. Y/N	Drop Off PT./Time	Pick Up PT./Time	
CRW T2 DIAMOND FIRE C-204 10/5	WES WICKMAN	20	N	ICP 0600	PLACERVILLE ICP 1800	
CRW T2 DIAMOND FIRE C-208 10/5	BILLY SMITH	20	N	ICP 0600	PLACERVILLE ICP 1800	
DOZ T2 AAA EQUIP E-207 9/29	BRENDON SIMUNACI	2	N	ICP 0600	PLACERVILLE ICP 1800	
DOZ T2 NEESE CONST E-575 10/5	DAVID NEESE	2	N	ICP 0600	PLACERVILLE ICP 1800	
EXCA T1 PAUL ROEN E-972 10/11	PAUL ROEN	2	N	ICP 0600	PLACERVILLE ICP 1800	
EXCA G & O BODY SHOP, E-3011 10/4		1	N	ICP 0600	PLACERVILLE ICP 1800	
HEQB O-840 10/6	CLINTON HUFFMAN	1	N	ICP 0600	PLACERVILLE ICP 1800	
FOBS O-1144 10/11	STEVE ROSS	1	N	ICP 0600	PLACERVILLE ICP 1800	
FOBS (t) O-1147 10/11	RICK RATAJ	1	N	ICP 0600	PLACERVILLE ICP 1800	
READ O-932 10/8	RICHARD MONK	1	N	ICP 0600	PLACERVILLE ICP 1800	
READ O-930 10/6	EMILY LONG	1	N	ICP 0600	PLACERVILLE ICP 1800	
READ O-943 10/6	WILLIAM BARFUSS	1	N	ICP 0600	PLACERVILLE ICP 1800	
FEMP O-974 9/30	LEO GRANADOS	1	N	ICP 0600	PLACERVILLE ICP 1800	
FEMT O-969 10/6	ERIC C CONNORS	1	N	ICP 0600	PLACERVILLE ICP 1800	

7. Control Operations

Complete suppression repair utilizing the Suppression Repair Guidelines from Lawyer to Wentworth Springs Road along the Rubicon Trail.

8. Special Instructions

****All dozers report to weed wash and lock all gates at end of shift.****

a. Day resources travel route to line via Foresthill Rd. Return via Mosquito Ridge Rd.
b. All Division Supervisors need to download information to the Sit Unit for all completed work.
c. Noxious weeds are marked by orange "noxious weed" flagging. Minimize or avoid activities in these areas.
d. Sensitive areas are marked with pink/black checkerboard flagging. Minimize ground disturbing activities in these areas.

9. Division/Group Communications Summary							
Function	Frequency - RX	Frequency - TX	Tone	System	Channel	System	Channel
Command	166.6125	168.4000	136.5	NIFC C4	1		
Tactical Div/Group	167.1125	167.1125		R5 T5	11		
Logistics							
Air to Ground	169.1500	169.1500		A/G CMD	13		
Prepared by (Resource Unit Leader) J. Switzler, E. Matye (t); A. Uehara (t)			Approved by (Planning Section Chief) D. Cooper; R. Leuck (t); J. Schillinger (t)			Date Prepared 09/29/14	Time Prepared 1013

AIR OPERATIONS SUMMARY

(Expanded Form for Large Operations)

OPERATIONAL PERIOD DATE: DAY SHIFT DATE: 09/30/2014

START: 0700 END: 2000

1. INCIDENT NAME: King	2. PREPARED BY: John Keesee <i>JK</i>	3. Prepared 09/29/14 1930 hrs
4. REMARKS (Safety Notes, Hazards, Air Operations Special Equipment, etc.): STEEP SMOKEY CONDITIONS, OTHER AIRCRAFT COULD FLY IN OUR AREA **Avoid aerial application of retardant or foam within 300' of waterways, bodies of water. If retardant is dropped within these areas, notify AOB with Lat & Long, est. of gallons, and a map.		
Placerville Helibase is located at Placerville airport. UNICOM: 122.8 Incident aircraft will support initial attack within and adjacent to the TFR.		
5. TFR: 4/1405 Altitude : 9,000' MSL Freq. 118.6250 See TFR map		

6. PERSONNEL		Phone	FREQUENCIES	AM	FM
AOBD: John Keesee (zone 1)		805-551-6422			
AOBD: Jason Nava (zone 2)		949-812-8755	AIR/AIR FW:	118.6250	
ASGS: Craig Dado (zone 1)		530-518-6688			
ASGS: Jerry Disney (zone 2)		209-352-0209	AIR/AIR RW:	120.5750	
ASGS: Shaun Whittington(t)		760-371-3165			
HLCO: Russ Gripp		530-598-4172	A/G Command:		169.1500
			A/G Tactical:		167.9500
ATGS: Todd White		530-263-5621	DECK:	163.100	
Placerville Helibase			COMMAND:	TX	RX
HEBM: Jim Stratton		760-207-4325	AIR GUARD:	168.625	Tone Tx 110.9
Cobra: Gus Johnson		559-708-3570	TOLC:	163.100	

8. FIXED-WING # Avail / Type/ Make-Model / FAA N# / Base(s)

Air Tactical:	
AA 17	
H507	
Lead planes:	
Airtankers:	
Other:	Camino Dispatch 530-647-5220

9. HELICOPTERS (Use Additional Sheets As Necessary)

FAA N#	TY	MAKE/MODEL	BASE	AVAIL	START	REMARKS	FAA N#	TY	MAKE/MODEL	BASE	AVAIL	START	REMARKS
84H	3	Bell 407	PVF	0800	0700	Recon/Helco							
7AC	3	Bell 407	Foresthil	0800	0700	Recon/Helco							
510	2	Bell 210	PVF	0800	0700	Bucket/Shuttle							
534	2	Bell 205	PVF	0800	0700	Bucket/Shuttle							
516	2	Bell 212	PVF	0800	0700	Bucket/Shuttle							
538	2	Bell 205	PVF	0800	0700	Bucket/Shuttle							
507	2	Cobra	PVF	0800	0700	Air Attack/Helco							
408	2	Bell 205	GOO	0800	0700	Medevac/Hoist							
HT 783	1	Skycrane	PVF	0800	0700	Tanked							
HT 746	1	Skycrane	PVF	0800	0700	Tanked							



King Fire

Incident Safety Message

Day 09.30.14

TRANSFER OF COMMAND

Risks to fireline personnel increase significantly during transfer of command periods regardless of the size or complexity of the incident. There is a high potential for fatalities, serious injuries, or incidents with potential during transfer of command periods (some have occurred in the past). Be proactive in mitigating the risks by proper implementation of LCES—Lookout, Communications, Escape Routes, and Safety Zones.

• Factors for increased risks to fireline personnel during transition periods include:

- No, or poor, briefing of incoming personnel
- Lack of fire weather and behavior information, both forecast and observed
- Communications; face-to-face briefings may not be possible and radio frequencies may be overextended and/or changing due to the increased demands on the system.
- Initial attack resources may not have checked-in and the Incident Commander may not be aware of the number, type and location of all resources.
- Location of safety zones and escape routes may not be known and communicated to all resources.

• Mitigation actions to take:

- Lookouts: Post and maintain your own lookouts.
- Communications: Maintain existing communications with your own and adjacent resources, as well as your original supervisor, while you are developing communications with incoming adjacent resources and your new supervisor.
- Escape routes and safety zones: Identify escape routes and assure incoming resources are aware of their locations; be aware that your original escape routes and safety zones may no longer be accessible due to changing fire behavior or your increased distance from them.

King Incident- CA-ENF-023461 INCIDENT SAFETY ANALYSIS 215a

8. Location	9. Hazard	6. Control or Abatement Action (Engineering, Administrative, PPE, Avoidance, Education, etc)
ALL	Snag Hazards	<ul style="list-style-type: none"> • Follow Hazard Tree Safety Guidelines (IRPG). • Limit number of personnel around snags and their exposure time; fallers must be qualified for trees being fallen. • Be especially alert around snags during wind events. • Check overhead for dead branches in sleeping areas. • Maintain Situational Awareness.
ALL	Aircraft Operations	<ul style="list-style-type: none"> • Keep personnel out of drop zones. • Use air-to-ground freq. to communicate with aircraft. • Use clear, concise statements when directing aircraft. Use clock directions from pilot's perspective.
ALL	Direct Attack/Night Operations	<ul style="list-style-type: none"> • Do not engage in direct line tactics in areas where snags have not been mitigated for night operations. • Snag areas in day time before engaging personnel. • Snag roads where nighttime travel is necessary. • Ensure medical protocols are followed. • Have medivac sites pre-identified/established. • Ensure good communications exist and tested.
ALL	Driving Hazards	<ul style="list-style-type: none"> • Practice defensive driving at all times. • Adhere To 30 mph speed limit on forest roads • Drive with headlights on. • Be alert for wildlife and livestock on roads at all times. • Slow down on washboard surfaces. • Avoid gravel berms on the sides of roadways. • Increase following distances on dusty roads. Slow down when you meet opposing traffic. • Maintain Situational Awareness.
ALL	Severe Fire Behavior	<ul style="list-style-type: none"> • Review "Severe Fire Behavior Potential" (IRPG). • Monitor current weather conditions and forecasts. Make sure all personnel receive thorough briefings every shift. • Be observant for formation and passage of pyro-cumulous cells over the fire area and alert all personnel. • Maintain adequate escape routes and safety zones. Advise all personnel if these are compromised or changed. Set trigger points when appropriate. • Adhere to 10 Std Orders, mitigate 18 situations. • Maintain Situational Awareness.
ALL	Working around Dozers	<ul style="list-style-type: none"> • Maintain safe separation distance of personnel from dozers, especially downhill. • Ensure dozers are supervised by qualified DOZB when required or is appropriate for the job.
ALL	Mines	<ul style="list-style-type: none"> • Identify and avoid mining areas • Notify others of mining hazards and flag • Be aware of vertical vent shafts, indicators may be slight indentations in terrain • Watch for and keep out of any horizontal adits or shafts that may be located into the side of a ridge or mountain
ALL	Work/Rest and Fatigue	<ul style="list-style-type: none"> • Be alert for signs of fatigue and take breaks as necessary. • Maintain 2:1 work/rest ratio. • Monitor incoming resources for level of fatigue.
ALL	Hydration	<ul style="list-style-type: none"> • Encourage drinking water before, during and after shifts, up to 1.5 gal. during shifts. • Be alert for signs of heat stress in yourself and others.

King Incident- CA-ENF-023461 INCIDENT SAFETY ANALYSIS 215a

ALL	Line Construction	<ul style="list-style-type: none"> • Conduct thorough briefing for all personnel involved (inside rear cover IRPG). • Ensure LCES in place prior to engagement (IRPG). • Establish adequate safety zones (IRPG). • Use Downhill Line Checklist (IRPG). • Follow "Look Up, Look Down, Look Around" procedures (IRPG). • Utilize Risk Management Process (IRPG).
ALL	Burning Operations	<ul style="list-style-type: none"> • Conduct thorough briefing for all personnel involved (inside rear cover IRPG). • All personnel to be fully qualified for their assignments. Trainees must have qualified trainers. • Utilize Risk Mgmt. Process (IRPG) for implementing plan. • Required PPE to be worn by all personnel involved. • LCES must be established prior to implementing burning operations (IRPG).
ALL	Structure Protection & HazMat Issues	<ul style="list-style-type: none"> • Conduct thorough briefing for all personnel involved (inside rear cover IRPG). • Utilize Structure Assessment Checklist (IRPG p.14). • Follow structure Protection Guidelines (IRPG p. 16).
ALL	Foot Travel	<ul style="list-style-type: none"> • When walking through steep, rocky, and possibly wet terrain, watch footing and maintain proper spacing. • Watch for over-head hazards. • Treat "hot spots" on your feet before they become blisters. • Maintain downhill tool placement. • Refer to F.S. Health and Safety Code sections 18.1, 18.2, 18.3.
ALL	Tree Felling	<ul style="list-style-type: none"> • Conduct thorough briefing for all personnel involved (inside rear cover IRPG). • Establish traffic control as necessary. • Perform tree evaluation, use IRPG page 22. Use Look-Up, Down, All Around Process. IRPG page 3. • Use all required PPE. • Minimize exposure to personnel.
Zone 1	Spike Camps	<ul style="list-style-type: none"> • Ensure camps are clean of trash to avoid attracting wildlife • Keep sleeping areas are clear of snags and other tripping hazards • Have hand sanitizers and body cleaning products to prevent illness • Have a GPS spike locations in the incident 204 and with the Situation Unit • Have night contact/communications plans in place
ALL	Wildlife & Livestock	<ul style="list-style-type: none"> • Watch out for wildlife & livestock inside fire area and along roadways. • Clean up all debris and trash during each operational period and dispose of in receptacles • Do not throw food from lunches out on the fireline
ALL	Vehicle Operations in Inclement Weather	<ul style="list-style-type: none"> • Be alert for potential muddy and slick road surfaces • Avoid parking on soft shoulders along roads • Stay off secondary roads in wet conditions • Increase following distance on slick road surfaces • Send a scout to evaluate roads and work area prior to personnel engagement • Reduce your speed, in camp and on roads, to maintain control of your vehicle
Zone 1	Marijuana Grow Sites	<ul style="list-style-type: none"> • Be alert for signs such as, irrigation drip lines, chemicals, herbicides and fertilizers, trip lines or booby traps • Leave the route you entered • Once clear of the area, notify Law Enforcement, Division and Operations • Do not approach individuals in sites

INCIDENT RADIO COMMUNICATIONS PLAN		Incident Name KING, CA-ENF-023461 - ZONE 1				BK RADIO GROUP GROUP 14		Operational Period Date/Time 9/30/14 0600HRS - 0600HRS	
Ch #	Function	Channel Name/Trunked Radio System/Talkgroup	Assignment	RX Freq N or W	RX Tone/NAC	TX Freq N or W	TX Tone/NAC	Mode A, D or M	Remarks
1	COMMAND	NIFC C4	ZONE 1 CMD	166.6125 N	136.5	168.4000 N	136.5	A	Little Bald Mtn. / Duncon L.O.
2	COMMAND	NIFC C11	ZONE 1 CMD	170.6875 N	136.5	166.5750 N	136.5	A	Bunker Hill L.O.
3	COMMAND	NICF C59	Unassigned	164.8375 N	136.5	170.0500 N	136.5	A	Not In Operation
4	COMMAND	NIFC C61	ZONE 1 CMD	164.8625 N	136.5	170.3875 N	136.5	A	Robbs Peak
5	TACTICAL	NIFC T1	DIV 1U & 1R	168.0500 N		168.0500 N		A	
6	TACTICAL	NIFC T10	DIV 1D & 1M	168.5000 N		168.5000 N		A	
7	TACTICAL	NIFC T5	DIV 1F & 1Z	166.7250 N		166.7250 N		A	
8	TACTICAL	NIFC T6	DIV 1H/1L	166.7750 N		166.7750 N		A	
9	TACTICAL	NIFC T7	DIV 1B & 1P	168.2500 N		168.2500 N		A	
10	TACTICAL	R5 T4	DIV 1W & 1T	166.5500 N		166.5500 N		A	
11	TACTICAL	R5 T5	DIV 1Y & 1K	167.1125 N		167.1125 N		A	Rehab / Repair
12	TACTICAL	R5 T6	Contingency Branch	168.2375 N		168.2375 N		A	Contingency & Roads
13	AIR TO GROUND	A/G CMD	ALL DIVISIONS	169.1500 N		169.1500 N		A	A/G COMMAND
14	AIR TO GROUND	A/G TAC	ALL DIVISIONS	167.9500 N		167.9500 N		A	A/G TACTICAL
15	MEDICAL	CALCORD	ALL DIVISIONS	156.0750 N		156.0750 N	156.7	A	MEDICAL COORDINATION
16	EMERGENCY ONLY	Air Guard	ALL DIVISIONS	168.6250 N		168.6250 N	110.9	A	AIR GUARD - EMERGENCY
17								A	
18								A	
19								A	
20	EMERGENCY ONLY	Air Guard	ALL DIVISIONS	168.6250 N		168.6250 N	110.9	A	AIR GUARD - EMERGENCY

Prepared By (Communications Unit)
TIM MAGUIRE, COML (t)

Incident Location: Foresthill, CA
County: Placer State: CA Latitude 39°1.17' N. Longitude 120°49.77' W

The convention calls for frequency lists to show four digits after the decimal place, followed by either an "N" or a "W", depending on whether the frequency is narrow or wide band. Mode refers to either "A" or "D" indicating analog or digital (e.g. Project 25) or "M" indicating mixed mode. All channels are shown as if programmed in a control station, mobile or portable radio. Repeater and base stations must be programmed with the Rx and Tx reversed.

ICS 205 INCIDENT RADIO COMMUNICATIONS PLAN		Incident Name KING, CA-ENF-023461 - ZONE 2				BK RADIO GROUP GROUP 15				Operational Period Date/Time 9/30/14 0700 hrs. - 10/1/14 0700 hrs.	
Ch #	Function	Channel Name/Trunked Radio System/Talkgroup	Assignment	RX Freq N or W	RX Tone/NAC	TX Freq N or W	TX Tone/NAC	Mode A, D or M	Remarks		
1	COMMAND	NIFC C5	ZONE 2 ALL DIV	167.1000 N	Tone 5 146.2	169.7500 N	Tone 5 146.2	A	BALD MT. - LINKED		
2	COMMAND	NIFC C12	ZONE 2 ALL DIV	173.0375 N	Tone 5 146.2	167.3250 N	Tone 5 146.2	A	BIG MT. - LINKED		
3	COMMAND	NIFC C37	ZONE 2 ALL DIV	172.5500 N	Tone 5 146.2	162.1875 N	Tone 5 146.2	A	UNION HILL- LINKED		
4	COMMAND	NIFC C60	ZONE 2 ALL DIV	167.0625 N	Tone 5 146.2	173.0250 N	Tone 5 146.2	A	ROBBS PK - LINKED		
5	COMMAND	NIFC C58	ZONE 2 ICP	164.1375 N	Tone 5 146.2	169.6500 N	Tone 5 146.2	A	ICP - LINKED		
6	TACTICAL	VFIRE 24	DIV U	154.2725 N	Tone 6 156.7	154.2725 N	Tone 6 156.7	A			
7	TACTICAL	VFIRE 25	DIV E & G	154.2875 N	Tone 6 156.7	154.2875 N	Tone 6 156.7	A			
8	TACTICAL	VFIRE 26	DIV T	154.3025 N	Tone 6 156.7	154.3025 N	Tone 6 156.7	A			
9	TACTICAL	VTAC 11	DIV W/Y	151.1375 N	Tone 6 156.7	151.1375 N	Tone 6 156.7	A			
10	TACTICAL	VTAC 12	REPAIR GROUP	154.4525 N	Tone 6 156.7	154.4525 N	Tone 6 156.7	A			
11	TACTICAL	VTAC 13	DIV A/D	158.7375 N	Tone 6 156.7	158.7375 N	Tone 6 156.7	A			
12	TACTICAL	VTAC 14	ROADS GROUP	159.4725 N	Tone 6 156.7	159.4725 N	Tone 6 156.7	A			
13	AIR TO GROUND	A/G CMD	ALL DIVISIONS	169.1500 N		169.1500 N		A	A/G COMMAND		
14	AIR TO GROUND	A/G TAC	ALL DIVISIONS	167.9500 N		167.9500 N		A	A/G TACTICAL		
15	MEDICAL	CALCORD	ALL DIVISIONS	156.0750 N		156.0750 N	Tone 6 156.7	A	MEDICAL COORDINATION		
16	EMERGENCY ONLY	GUARD	ALL DIVISIONS	168.6250 N		168.6250 N	Tone 1 110.9	A	AIR GUARD - EMERGENCY		
17								A			
18								A			
19								A			
20	EMERGENCY ONLY	GUARD	ALL DIVISIONS	168.6250 N		168.6250 N	Tone 1 110.9	A	AIR GUARD - EMERGENCY		

Prepared By (Communications Unit): *[Signature]*
 Incident Location: Placerville, CA
 County: El Dorado State: CA Latitude Longitude N Longitude W
 Scott La Rue, COML

The convention calls for frequency lists to show four digits after the decimal place, followed by either an "N" or a "W", depending on whether the frequency is narrow or wide band. Mode letters to either "A" or "D" indicating analog or digital (e.g. Project 25) or "M" indicating mixed mode. All channels are shown as if programmed in a control station, mobile or portable radio. Repeater and base stations must be programmed with the Rx and Tx reversed.

1. Incident/Project Name				2. Operational Period					
King Fire - Zone 1 (North)				Date/Time 9/30/2014 0600 - 1800					
3. First Aid Stations									
Name		Complete Address		Phone/EMS Freq.		Advanced Life Support (ALS) Yes No			
King ICP Zone 1 Frontline Medical		Foresthill Old Mill Site 23850 Foresthill Rd., Foresthill, CA 95631				XX			
Sunset Spike Camp Frontline Medical		Union Valley Reservoir - East side 14 mi. north of Hwy 50 on Ice House Road				XX			
4. Ambulance Services									
Name		Complete Address		Phone/EMS Freq.		Advanced Life Support (ALS) Yes No			
Eldorado County Emergency Medical Services Medic 248 (Z2)		Eldorado County Fire Station 17 6426 Pony Express Trail, Pollock Pines, CA		911 or 530-647-5220		XX			
Foresthill Fire Department Medic 89 (French Meadows) (Z1)		Foresthill FPD FS 88 5981 Gold St. Foresthill, CA		911 or 530-886-5375		XX			
El Dorado County Emergency Medical Services Medic 289 (Z2)		Georgetown FPD Station 65 10561 Sand Mountain Rd., Georgetown, CA		911 or 530-647-5220		XX			
AMR Ambulance Medic 290 (Z1)		Div. F DP 109		916 563-0666		XX			
AMR Ambulance Medic 291 (Z1)		Zone 1 ICP		916 563-0666		XX			
Ebbetts Pass Fire District Medic 431 (Z1)		Sunset Spike Camp		209 768-1671		XX			
5. Air Ambulance Services									
Name		Phone		Type of Aircraft & Capability					
Kern County (KRN) H-408 Grass Valley, CA		911 or 530-647-5220		Bell 205++ Hoist, NVG, ALS					
CHP H20 or H24 Auburn, CA		911 or 916-861-1299		Eurocopter B3 Hoist, ALS, No NVG					
CALSTAR 3 Auburn, CA		911 or 530-887-0569		BO 105LS/C-30					
CAL STAR 6 South Lake Tahoe, CA		911 or 530-887-2338		BO 105LS/C-30					
6. Hospitals									
Name Complete Address		GPS Datum - NAD 83 Degrees Decimal Minutes DD° MM.MMM' N - Lat DD° MM.MMM' W - Long		Travel Time Air Gnd		Helipad Yes No		Level of Care Facility	
Marshal Medical Center 1100 Marshall Way, Placerville, CA 95667		Lat: N/A Long: VHF: N/A		1 Hr				X Level III Trauma Center	
Sutter Auburn Faith Hosp. 11815 Education St. Auburn, CA, 95602		Lat: N/A Long: VHF: N/A		30 Min				X Level II Trauma Center	
Sutter Roseville Medical Ctr 1 Medical Plaza Dr, Roseville, CA 95661		Lat: 38 45.58 Long: 121 14.52 VHF:		25 Min 45 Min		(916) 781-1200		X □ Level II Trauma Center	
UC Davis Medical Center 2315 Stockton Ave. Sacramento, CA 95817		Lat: 38 33.17 Long: 121 27.21 VHF:		25 Min 1 Hr		(916) 734-2363		X □ Level I Trauma Center Burn Center	
Barton Memorial Hospital 2170 South Ave. South Lake Tahoe, CA 96158		Lat: 38 54.40 Long: 119 59.48 VHF:		30 Min 2.5 Hr		(530) 541-3420		X □ Level II Trauma Center	
Renown Regional Medical Center 1155 Mill St Reno, NV		Lat: 39 31 32 Long: 119 47 44 VHF:		45 Min 2 Hr		(775) 982-4100		X □ Level II Trauma Center Burn Center	
7. Prepared By (Medical Unit Leader)		8. Date/Time		9. Reviewed By (Safety Officer)		10. Date/Time			
Robert Russell MEDL Newton Ong MEDLt <i>[Signature]</i>		09/29/2014 2000		Marty Hamel SOP 1 <i>[Signature]</i>		09/29/2014 2000			

When an injury occurs, initiate care with available resources at scene and notify DIVS.

The DIVS shall coordinate the incident and direct necessary actions. The following steps shall be taken to mitigate the incident:

1. Determine the nature of the emergency.
2. If the emergency is a medical injury/illness, determine if the injury/illness is life threatening.
3. If the injury is life threatening, then clear designated frequency for emergency traffic.
4. Identify the on-scene point of contact by position.
5. Ensure that the Medical Unit Leader is contacted immediately.
6. Identify number injured, patient assessment(s) and location (geographic and/or GPS coordinates).
7. Identify on-scene medical personnel by position and last name (i.e. EMT Jones).
8. Identify preferred method of patient transport.
9. Determine any additional resources or equipment needed.

The Evacuation Plan should be continually evaluated, and contingencies developed in the event the first plan is not effective.

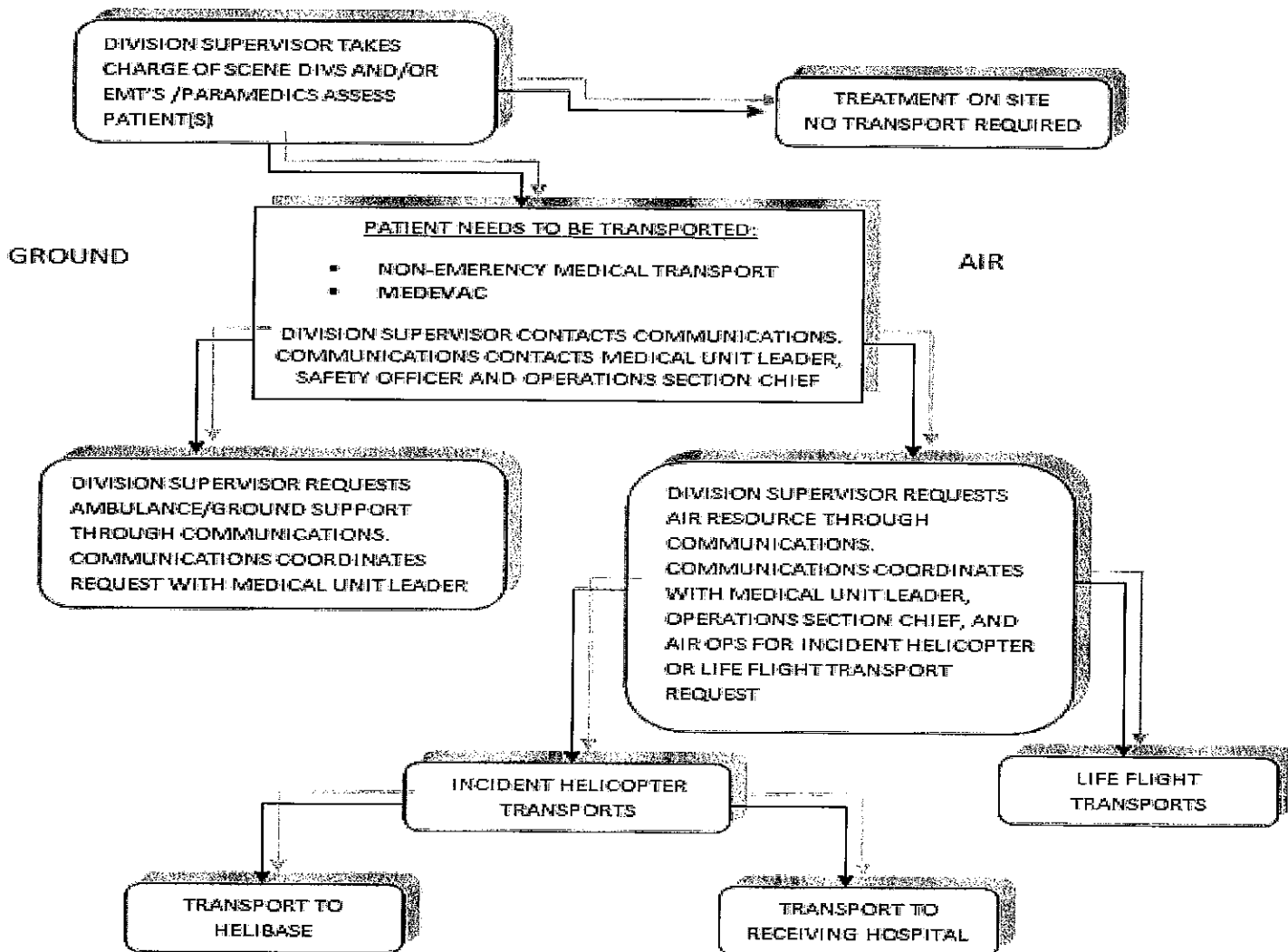

Medical Incident Report

FOR ALL MEDICAL EMERGENCIES: IDENTIFY ON SCENE INCIDENT COMMANDER BY NAME AND POSITION AND ANNOUNCE "MEDICAL EMERGENCY" TO INITIATE RESPONSE FROM IMT COMMUNICATIONS/DISPATCH.

Use items 1 - 9 to communicate situation to communications/dispatch.

1. CONTACT COMMUNICATIONS/DISPATCH

Ex: "Communications, Div. Alpha. Stand-by for Priority Medical Incident Report." (If life threatening request designated frequency be cleared for emergency traffic.)

2. INCIDENT STATUS: Provide incident summary and command structure.

Nature of Injury/Illness		<i>Describe the injury (Ex: Broken leg with bleeding)</i>
Incident Name		<i>Geographic Name + "Medical" (Ex: Trout Meadow Medical)</i>
Incident Commander		<i>Name of IC</i>
Patient Care		<i>Name of Care Provider (Ex: EMT Smith)</i>

3. INITIAL PATIENT ASSESSMENT: Complete this section for each patient. This is only a brief, initial assessment. Provide additional patient info after completing this 9 Line Report.

Number of Patients:	Male / Female	Age:	Weight:
Conscious? <input type="checkbox"/> YES <input type="checkbox"/> NO = MEDEVAC!			
Breathing? <input type="checkbox"/> YES <input type="checkbox"/> NO = MEDEVAC!			
Mechanism of Injury: <i>What caused the injury?</i>			
Lat/Long (Datum WGS84) <i>Ex: N 40° 42.45' x W 123° 03.24'</i>			

4. SEVERITY OF EMERGENCY, TRANSPORT PRIORITY

SEVERITY	TRANSPORT PRIORITY
<input type="checkbox"/> URGENT-RED Life threatening injury or illness. <i>Ex: Unconscious, difficulty breathing, bleeding severely, 2° - 3° burns more than 4 palm sizes, heat stroke, disoriented.</i>	Ambulance or MEDEVAC helicopter. Evacuation need is IMMEDIATE.
<input type="checkbox"/> PRIORITY-YELLOW Serious Injury or illness. <i>Ex: Significant trauma, not able to walk, 2° - 3° burns not more than 1-2 palm sizes.</i>	Ambulance or consider air transport if at remote location. Evacuation may be DELAYED.
<input type="checkbox"/> ROUTINE-GREEN Not a life threatening injury or illness. <i>Ex: Sprains, strains, minor heat-related illness.</i>	Non-Emergency. Evacuation considered Routine of Convenience.

5. TRANSPORT PLAN:

Air Transport: (Agency Aircraft Preferred)

<input type="checkbox"/> Helispot	<input type="checkbox"/> Short-haul/Hoist	<input type="checkbox"/> Life Flight	<input type="checkbox"/> Other
-----------------------------------	---	--------------------------------------	--------------------------------

Ground Transport: Click here to enter text.

<input type="checkbox"/> Self-Extract	<input type="checkbox"/> Carry-Out	<input type="checkbox"/> Ambulance	<input type="checkbox"/> Other
---------------------------------------	------------------------------------	------------------------------------	--------------------------------

6. ADDITIONAL RESOURCE/EQUIPMENT NEEDS:

<input type="checkbox"/> Paramedic/EMT(s)	<input type="checkbox"/> Crew(s)	<input type="checkbox"/> SKED/Backboard/C-Collar
<input type="checkbox"/> Burn Sheet(s)	<input type="checkbox"/> Oxygen	<input type="checkbox"/> Trauma Bag
<input type="checkbox"/> Medication(s)	<input type="checkbox"/> IV/Fluid(s)	<input type="checkbox"/> Cardiac Monitor/AED
<input type="checkbox"/> Other (i.e. splints, rope rescue, wheeled litter)		

7. COMMUNICATIONS:

Function	Channel Name/Number	Receive (Rx)	Tone/NAC *	Transmit (Tx)	Tone/NAC *
<i>Ex: Command</i>	<i>Forest Rpt, Ch. 2</i>	<i>168.3250</i>	<i>110.9</i>	<i>171.4325</i>	<i>110.9</i>
COMMAND					
AIR-TO-GRND					
TACTICAL					

*(NAC for digital radio system)

8. EVACUATION LOCATION:

Lat/Long (Datum WGS84) <i>EX: N 40 42.45' x W 123 03.24'</i>	
Patient's ETA to Evacuation Location:	

Considerations: If primary options fail, what actions can be implemented in conjunction with primary evacuation method? Be thinking ahead...

REMEMBER: Confirm ETA's of resources ordered
Act according to your level of training
Be Alert. Keep Calm. Think Clearly. Act Decisively.

Division - As Assigned	Area Location Capability	
Branch X, DIV 1B 12 Hour (day)	EMS Responders & Capability:	FEMP John Bicondova, FEMT Matt Heckman
	Equipment Available on Scene:	ALS/BLS supplies
	Medical Emergency Channel:	Calcord 156.0750 Tone 6 (156.7) tx/rx
	ETA for Ambulance to Scene:	
	Air:	
	Ground:	45 min
	Approved Helispot:	None identified
	Lat: Long:	
Branch X, DIV 1D 12 Hour (day)	Area Location Capability	
	EMS Responders & Capability:	FEMP Eduardo Stary, FEMT Willie Kron
	Equipment Available on Scene:	ALS/BLS supplies
	Medical Emergency Channel:	Calcord 156.0750 Tone 6 (156.7) tx/rx
	ETA for Ambulance to Scene:	
	Air:	
	Ground:	30 min
	Approved Helispot:	None identified
Lat: Long:		
Branch X, DIV 1F 12 Hour (day)	Area Location Capability	
	EMS Responders & Capability:	FEMT Mitch Carney, FEMT Todd Adams
	Equipment Available on Scene:	ALS/BLS supplies
	Medical Emergency Channel:	Calcord 156.0750 Tone 6 (156.7) tx/rx
	ETA for Ambulance to Scene:	
	Air:	
	Ground:	30 min
	Approved Helispot:	None identified
Lat: Long:		
Branch XII, DIV 1H, 1L 12 Hour (day)	Area Location Capability	
	EMS Responders & Capability:	FEMP Ronald Cutting, FEMT Bryan Esser
	Equipment Available on Scene:	ALS/BLS supplies
	Medical Emergency Channel:	Calcord 156.0750 Tone 6 (156.7) tx/rx
	ETA for Ambulance to Scene:	
	Air:	
	Ground:	30 min
	Approved Helispot:	None identified
Lat: Long:		

Area Location Capability		
Branch XVI, DIV 1U 12 Hour (day)	EMS Responders & Capability:	FEMP Kevin Berkery, FEMT Donald McLaughlin
	Equipment Available on Scene:	ALS/BLS supplies
	Medical Emergency Channel:	Calcord 156.0750 Tone 6 (156.7) tx/rx
	ETA for Ambulance to Scene:	
	Air:	
	Ground:	45 min
	Approved Helispot:	None identified
	Lat:	
	Long:	
Area Location Capability		
Branch XVI, DIV 1W 12 Hour (day)	EMS Responders & Capability:	FEMP Dan Nunez, FEMT Travis Moore
	Equipment Available on Scene:	ALS/BLS supplies
	Medical Emergency Channel:	Calcord 156.0750 Tone 6 (156.7) tx/rx
	ETA for Ambulance to Scene:	
	Air:	
	Ground:	45 min
	Approved Helispot:	None identified
	Lat:	
	Long:	
Area Location Capability		
Branch XVI, DIV 1Y 12 hour (day)	EMS Responders & Capability:	FEMP Steve Wallace, FEMT Cody Haas
	Equipment Available on Scene:	ALS/BLS supplies
	Medical Emergency Channel:	Calcord 156.0750 Tone 6 (156.7) tx/rx
	ETA for Ambulance to Scene:	
	Air:	
	Ground:	45 min
	Approved Helispot:	None identified
	Lat:	
	Long:	
Area Location Capability		
Repair / Rehab Branch Branch XII 12 hour (day)	EMS Responders & Capability:	FEMP Sergio Zavala, FEMT Charles McGary
	Equipment Available on Scene:	ALS/BLS supplies
	Medical Emergency Channel:	Calcord 156.0750 Tone 6 (156.7) tx/rx
	ETA for Ambulance to Scene:	
	Air:	
	Ground:	30 min
	Approved Helispot:	None identified
	Lat:	
	Long:	
Area Location Capability		
Repair / Rehab Branch Branch XVI 12 hour (day)	EMS Responders & Capability:	FEMP Leo Granados, FEMT Eric Connors
	Equipment Available on Scene:	ALS/BLS supplies
	Medical Emergency Channel:	Calcord 156.0750 Tone 6 (156.7) tx/rx
	ETA for Ambulance to Scene:	
	Air:	
	Ground:	30 min
	Approved Helispot:	None identified
	Lat:	
	Long:	

Area Location Capability	
Contingency Branch American 12 Hour (day)	EMS Responders & Capability: FEMP Matt Lucas, FEMT Scott Harlan
	Equipment Available on Scene: ALS/BLS supplies
	Medical Emergency Channel: Calcord 156.0750 Tone 6 (156.7) tx/rx
	ETA for Ambulance to Scene:
	Air:
	Ground: 30 min
	Approved Helispot: None identified
	Lat:
	Long:
Area Location Capability	
Contingency Branch Oxbow 12 Hour (day)	EMS Responders & Capability: FEMP Travis Medina, FEMT Nick Martino
	Equipment Available on Scene: ALS/BLS supplies
	Medical Emergency Channel: Calcord 156.0750 Tone 6 (156.7) tx/rx
	ETA for Ambulance to Scene:
	Air:
	Ground: 30 min
	Approved Helispot: None identified
	Lat:
	Long:
Area Location Capability	
	EMS Responders & Capability:
	Equipment Available on Scene: ALS/BLS supplies
	Medical Emergency Channel: Calcord 156.0750 Tone 6 (156.7) tx/rx
	ETA for Ambulance to Scene:
	Air:
	Ground:
	Approved Helispot: None identified
	Lat:
	Long:
Area Location Capability	
	EMS Responders & Capability:
	Equipment Available on Scene: ALS/BLS supplies
	Medical Emergency Channel: Calcord 156.0750 Tone 6 (156.7) tx/rx
	ETA for Ambulance to Scene:
	Air:
	Ground:
	Approved Helispot: None identified
	Lat:
	Long:

Suppression Damage Repair Guidelines from the Suppression Repair Plan

No covering direct fireline with green vegetation will occur without IC/OPS approval

Take the time to read the full Suppression Damage Plan;
Copies are available from READ's, at the morning briefing, and in the Clerical Trailers.

Objectives - The objective of the fire suppression repair plan is to place areas disturbed by fire suppression activities into a condition that will not negatively affect natural and cultural resources and will not contribute to excessive erosion and sedimentation on the landscape. This is to be done in a manner which does not compromise public and firefighter safety.

- Reduce the potential for soil erosion and sedimentation
- Reduce the visual impacts of fire line as well other suppression activities when feasible
- Repair roads and drainage structures to a functioning condition
- Protect natural and cultural resources from additional potential damage

Critical Guidelines

Sensitive Sites are marked with pink and black checkerboard flagging. Noxious weeds sites are flagged in orange with noxious weed print. Other sensitive site flagging might be present on private lands (orange and white stripe with special treatment area print).

Trash and un-needed flagging will be back-hauled. Please leave safety flagging in place.

On Firelines, waterbars should be installed as described below, fire line covered with slash, and entrances blocked.

Dozer Line

Fire-line Gradient (% slope)	Distance Between Waterbars (A) (feet)
0 to 10	250
10 to 20	100
21 to 40	75
41 to 60 (B)	50 (B)

Hand Line

Fire-line Gradient (% slope)	Distance Between Waterbars (A) (feet)
0 to 5	no waterbars needed
6 to 15	200
16 to 30	100
31 to 50	75
51 to 60	50(B)
>60	None(B)

(A) These are guidelines and are not intended to restrict the implementation of more or less water bars if the need or lack of need is justified.

(B) Firefighter safety should be taken into account; if slopes are too steep for safe implementation then waterbars should not be constructed, if sensitive resources are not present.

- **DEPTH AND WIDTH:** Waterbars need to be cut into surface, do not simply push up soil.
 - Waterbar depths for **dozer lines** should be at least 6 inches; total height from bottom of ditch to the top of the waterbar should average at least 18 inches and not exceed 24 inches.
 - Waterbar depths for **hand lines** should be at least 4 inches; total height from bottom of ditch to top of waterbar should average at least 8 inches and not exceed 12 inches.

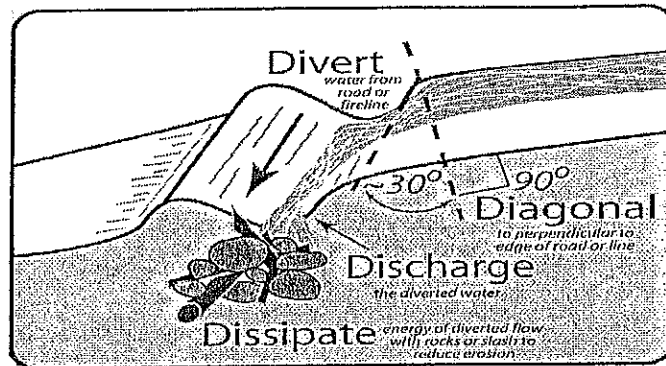

Helispots, Safety Zone, Spike Camp, and Staging Areas: These fire suppression activity areas should be repaired to standards similar to fire line repair. Waterbars placed where appropriate, cleared vegetative material used for soil cover, and concentrations of slash remediated.

Watercourses: Remove deposited soil from streams, watercourses, swales, or draws back to the original contour. Remove only as much as feasible without further damage to the watercourse. Restore bank channels at fire line crossings back to the shape seen adjacent to the crossing. Pull perched soil from drainage edges and spread it evenly across the fire line.

- Do not remove large woody debris which was in the channel prior to the fire, bucked limbs and logs in watercourses from fire suppression activities should be removed from the watercourse.
- Where fire lines are constructed within 100 feet of intermittent and perennial streams, use certified weed free straw, wood strands, or slash to increase soil cover and prevent sediment from entering the stream channel.

Water Drafting Sites: Water sources developed as a water draft site are to be restored to a condition resembling pre fire use. Remove any dams, dikes, or other impoundments that were created for fire suppression activities.

Concentrations of Slash: Concentrations of slash created by fire suppression activities along roadways, developed recreation areas, and among structures should be chipped and spread across the cleared area. Chip piles should not exceed 6 inches in depth. Where appropriate, concentrations of slash can be lopped and scattered, not to exceed 18 inches in height.

OTHER SUPPRESSION DAMAGE REPAIR NEEDS:

- Repair fences, gates, and cattle guards so that they are functional. These repairs must be related to suppression fire activities. Current damage should be rust free.
- Hazard trees should be felled if they pose a safety threat to the general public. Hazard trees to be felled will be identified and marked by a Division Group Supervisor or Felling Boss.

Ask a READ for the list of site specific repair needs for your Division. Please ask questions, we are here to help you get the work done. Ask a READ in the field or come by the READ trailer.

Thank you for all your hard work and professionalism.

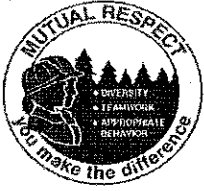

Human Resource Message King Fire

Patience

With a lot of personnel going through demobilization, patience becomes very important. If you start feeling frustrated by the process, take a breath and try to relax. Getting upset won't get you through the process any faster.



"If I made it through demob and got home safe so can you!"

"All it takes is patience,
Just a little patience is all you need."
Patience by Guns and Roses

If you have issues, report them to your supervisor. If you need additional help, contact the Human Resources Specialist Office located on Main Street (next to Documentation).

Office Number (530) 367-8899
Marilyn Loughrey (925) 588-6711
Tom Nichols (916) 878-8165

29 September 2014

09/29/2014

TENTATIVE RELEASE

ENF KING CA-ENF-023461

OVERHEAD

O-251	0600	(HEQB)	HALL, TYLER RAND
O-3186	0600	(DIVS)	VAN KEUREN, TY
O-299	0615	(THSP)	PARR, KATHLEEN
O-734	0800	(THSP)	DAILEY, SCOTT
O-165	1115	(SCKN)	ROLAND, ROBERT
O-857	1200	(FELB)	CASPERSON, HANS
O-270	1215	(OSC1)	TRUETT, JOHN
O-789	1300	(TFLD)	SCOTT, CHRIS R
O-1007	1800	(FFT2)	BRIDGMAN, ROY E
O-451	2000	(FOBS)	RATCLIFF, RICHARD P
O-1027	2000	(GISS)	PETRUZALEK, JERRY R

CREWS

C-96	0600	(HC2)	CRW T2IA UTAH CNTY #2
C-195	1400	(HC2)	CRW T2 PACIFIC OASIS

09/29/2014

TENTATIVE RELEASE

ENF KING CA-ENF-023461

EQUIPMENT

E-130	0700	(WTT1)	WT T1 HEAT SEEKER
E-382	0700	(ENG6)	ENG T6 SOUTH ARKANSAS
E-527	0700	(ENG3)	ENG T3 365
E-574	0700	(DOZ2)	DOZER T2 THOMAS TODD TRAPH
E-608	0700	(ENG3)	ENG T3 MISSOULA
E-638	0700	(ENG3)	ENG T3 426
E-101	0800	(DOZ2)	DOZ T2 TOM'S EARTH MOVIN
E-207	0900	(DOZ2)	DOZ T2 AAA EQUIP
E-499	0900	(ES3)	ENGINE S/T - T3 - 1618 C
E-554	0900	(DOZ2)	DOZ T2V BRAD INGRAM CONST
E-575	0900	(DOZ2)	DOZER T2 NEESE CONST 6GN02
E-619	0900	(ENG3)	ENG T3 14
E-654	0900	(ENG6)	ENG T6 641
E-558	1100	(DOZ2)	DOZER T2 DUDLEYS
E-559	1100	(DOZ2)	DUANE HAASE - C0
E-567	1100	(DOZ2)	DOZ T2V PAUL ROEN #N01
E-857	1100	(FTT2)	FT T2 DAWSON OIL
E-860	1100	(MISC)	MASTICATOR T1 BOOM MOUNTED
E-861	1100	(MISC)	MAST T2 GRAHAM
E-568	1130	(DOZ2)	DOZ T2 DADCO CONSTRUCTION
E-556	1300	(DOZ2)	DOZ T2V TEHAMA M00876
E-572	1530	(DOZ2)	DOZER T2V MOORE EXC. - #AG
E-549	1800	(ENG3)	ENG T3 33
E-722	1800	(BUS)	CRW BUS BIG SKY BUSSING

09/30/2014

TENTATIVE RELEASE

ENF KING CA-ENF-023461

OVERHEAD

O-137	0600	(DIVS)	BROWNING, THOMAS
O-192	0600	(IMET)	CLAPP, JASON
O-231	0600	(DIVS)	BRAZZEAL, BRYAN
O-414	0600	(DIVS)	JOHNSON, CORY
O-677	0600	(FEMP)	GABBARD, NICK
O-976	0600	(FEMP)	PRATT, TIM
O-196	0630	(PIOF)	BOYD, BRIAN
O-40	0730	(SOFR)	MARTINEZ, JOHN
O-1.6	0800	(COML)	IMT ELY, GREG
O-1.19	0800	(FDUL)	DURHAM, DENNIS
O-206	0800	(PSCT)	STUDEBAKER, PERRY
O-216	0800	(FSC1)	BYMERS, PETE
O-226	0800	(DIVS)	LAMBIRTH, JASON L
O-328	0800	(ARCH)	SERIN, JORDAN H
O-1074	0800	(EQPM)	DUNN, MICHAEL T
O-19	1000	(HMGB)	QUINN, JOSHUA
O-187	1000	(BCMG)	DOYLE, CHRIS J
O-188	1000	(BCMG)	LEE, MARTY
O-200	1000	(RADO)	TATEISHI, MIKE
O-217	1000	(DIVS)	REDINGER, RODNEY E
O-220	1000	(DIVS)	HANLEY, JUSTIN L
O-387	1000	(DIVS)	MYERS, SHANNON W
O-541	1000	(SECM)	CAMERON, ROY
O-262	1200	(HEQB)	WARLICK, TERRY
O-410	1200	(DIVS)	BLAIR, RUSSELL

09/30/2014

TENTATIVE RELEASE

ENF KING CA-ENF-023461

O-635	1200	(PIO2)	WILSON, KEVIN
O-636	1200	(PIO2)	KEIBLER, LISA
O-665	1200	(PIO2)	WYNICK, WAYNE C
O-189	1500	(BCMG)	HOWARD, CASEY J
O-236	1500	(OPBD)	JOHNSON, SEAN
O-422	1500	(DMOB)	BAGGAO, DANNY E
O-626	1500	(PIO1)	WILLIAMS, MICHAEL R
O-1020	1500	(SITL)	COATES, BILL J
O-1088	1500	(FEMP)	MENARD, MATTHEW
O-627	1800	(PIO1)	HECKER, LINDA
O-630	1800	(PIO1)	SUMMERFIELD, BOB
O-244	1900	(HEQB)	VALDEZ, ANDREW
O-268	2000	(DPRO)	TAYLOR, STEVEN D
O-455	2200	(FOBS)	CONNOLLY, MICHAEL R

CREWS

C-226	0600	(HC2)	CRW T2IA GRAYBACK 3A
C-238	0630	(HC1)	CRW T1 TAMALPAIS
C-102	0700	(HC1)	CRW T1 RUBY MOUNTAIN IHC
C-112	0830	(CC)	CCC TAHOE 4
C-91	0900	(HC1)	CRW T1 KLAMATH IHC
C-246	0900	(HC1)	CRW T1 HELENA IHC
C-170	1000	(HC2)	CRW T2IA BIG HORN BASIN 2

09/30/2014

TENTATIVE RELEASE

ENF KING CA-ENF-023461

EQUIPMENT

E-82	0600	(BUS)	BUS CRW CARRIER EXPEDITOR
E-83	0600	(BUS)	BUS COACH
E-486	0600	(ENG6)	ENG T6 UWF
E-579	0600	(CHIP)	CHIPPER - TYPE2 - A CUT ABOVE
E-776	0600	(PU)	RENTAL ENTERPRISE DODGE 2500
E-902	0600	(BUS)	HARLOWS BUS SERVICE #47
E-87	0830	(ES3)	ENG S/T PNF 3660C
E-721	1330	(TRLR)	DEER CREEK RESOURCES, LLC VIN#
E-585	1400	(CHIP)	CHIP T3 TREEMASTER
E-151	1500	(MEC)	SERVICE TRUCK T2 MCINTYRE
E-805	1500	(WTS3)	WT T3 INDIHAR
E-724	1800	(AMBU)	AMERICAN MEDICAL RESPONSE, INC

10/01/2014

TENTATIVE RELEASE

ENF KING CA-ENF-023461

OVERHEAD

O-417	0600	(PTRC)	BALLARD, BETTY S
O-454	0600	(FOBS)	OLDS, ROBERT
O-478	0600	(EQTR)	ROST, PATTY
O-620	0600	(EQTR)	MCKELVY, DEBORAH
O-710	0600	(ORDM)	MORRIS, KATE
O-1125	0600	(PTRC)	WEIDNER, EILEEN
O-117	0800	(FOBS)	GAMINO, GABRIEL Z
O-118	0800	(FOBS)	BRADLEY, TIM
O-367	0800	(EQTR)	GILBERT, BERLINDA
O-183	0900	(SEC1)	REGNELL, RYAN
O-184	0900	(SEC1)	MOE, DYLAN
O-185	0900	(SEC1)	GEBICKE, KIRK
O-504	0900	(BCMG)	NAMINGHA, DARREN A
O-138	1130	(DIVS)	ESADES, DEANO
O-506	1300	(BCMG)	JONES, JAMES
O-218	1800	(DIVS)	BUCHANAN, DAVID B
O-413	1800	(DIVS)	WHITE, JAMES A

10/01/2014

TENTATIVE RELEASE

ENF KING CA-ENF-023461

EQUIPMENT

E-259	0600	(WAT4)	WT T1 WATER BY C
E-339	0600	(ENG6)	ENG T6 FIRESTORM
E-342	0600	(ENG6)	ENG T6 PACIFIC OASIS
E-356	0600	(ENG6)	ENG T6 SPKX 21
E-449	0600	(RES)	MEDICAL SUPPORT UNIT - FRONTLI
E-283	0800	(WTS3)	WT T3 SUPPORT
E-399	0800	(FTT1)	FT T1 SIERRA MOUNT
E-518	0800	(FTT1)	FT T1 SIERRA MOUNTAIN CONSTRUCT
E-934	0800	(WTS3)	WT T2 SUSANVILLE TOW
E-397	1800	(GWT1)	GRAY WATER TRUCK T1 NORTHHS
E-530	1800	(GWT1)	WT T1 NORTH STATE EQUIPMENT

Incident Trainee / Trainer Data Worksheet

PLEASE PRINT LEGIBLY!

A: Trainee Data

Trainee Name: _____ Check One: Male Female
Trainee Position: _____ Order Number (E, O, C, A) ____--_____
State Abr. ____ + 3 Letter Designator _____ Agency Type: Federal State Local
 USFS BLM BIA FWS DOD NWS NPS Date Assigned: ____--____--_____
Ordered as a trainee for the incident? Yes No Trainee Cell Number: _____
Ordered as a US Forest Service PRIORITY trainee Yes No FPM IFPM?

**Person's name and title that is responsible for tracking your qualifications:
(Where do you want the packet mailed to?)**

Name: _____ Title: _____ Home Unit: _____
Agency Address: _____ City: _____
State: _____ Zip: _____ Phone Number: () ____--_____

B. Trainee Prerequisites

YES NO

- | | | |
|--|-----------------------|-----------------------|
| 1. Possesses valid Red Card or agency certification card? | <input type="radio"/> | <input type="radio"/> |
| 2. Trainee has a proper agency initiated position task book? | <input type="radio"/> | <input type="radio"/> |
| 3. Trainee has an incident supplied task book? | <input type="radio"/> | <input type="radio"/> |

C. Trainer/Evaluator Data (All fields are required to be filled in)

Trainer/Evaluator Name: _____ Position: _____
Home Unit: _____ Order Number (E, O, C, A) ____--_____
Work Address: _____ City: _____ State: _____
Zip Code: _____ Phone Number: () ____--_____

D. Trainee Goals (items in the position task book to be evaluated on this incident)

1. _____
2. _____
3. _____

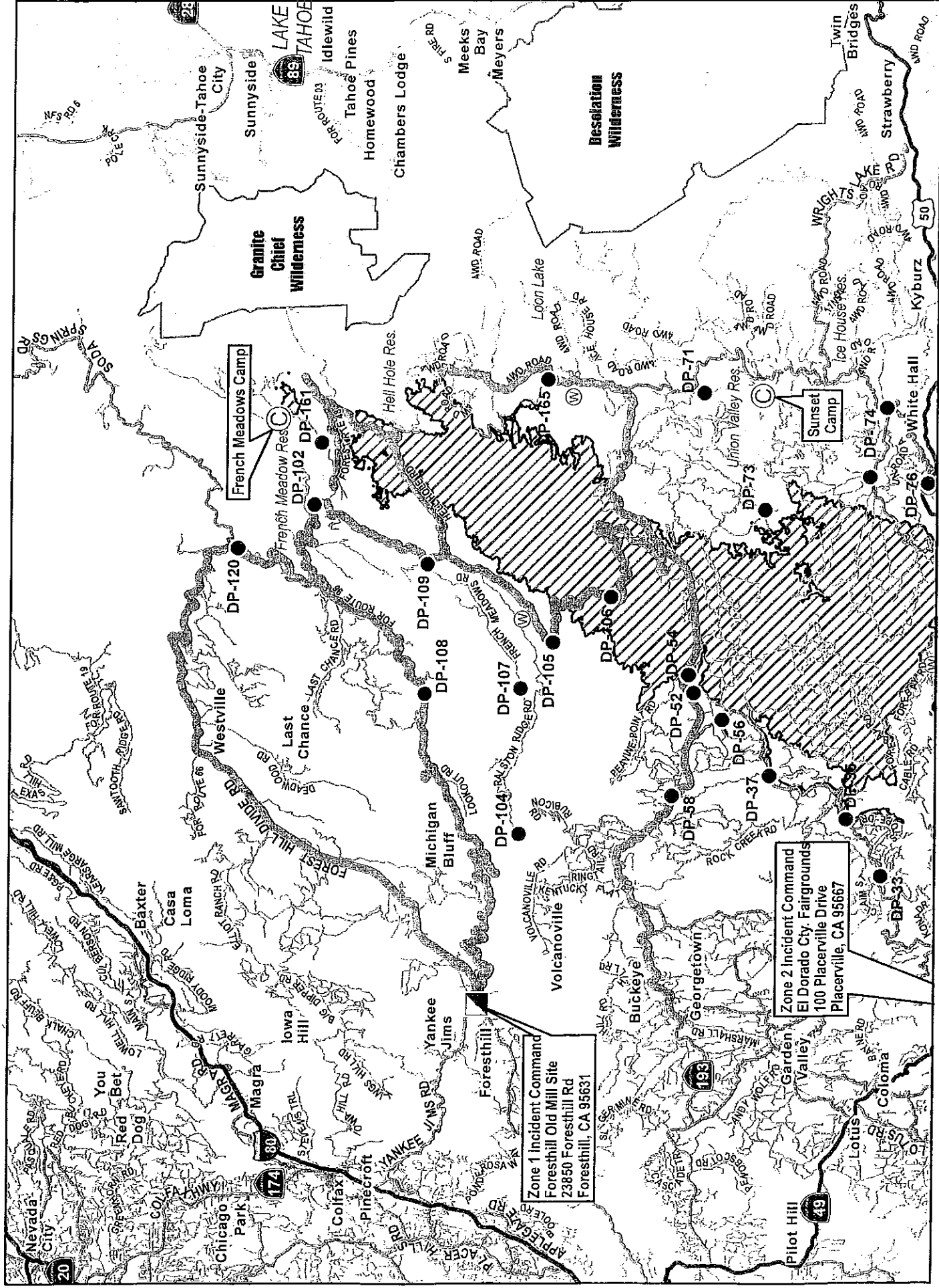
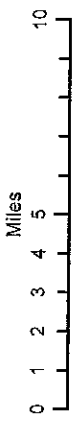

TRANSPORTATION MAP

King Incident CA-ENF-023461

September 24, 2014

- Major Highways
- Highways
- Water
- Major Roads
- Minor Roads
- Zone 1 access routes
- Camp
- Drop Point
- Water Source
- King Fire Polygon

Zone 1 Incident Command
 Foresthill Old Mill Site
 23850 Foresthill Rd
 Foresthill, CA 95631

Zone 2 Incident Command
 El Dorado City Fairgrounds
 100 Placerville Drive
 Placerville, CA 95667

OVERHEAD SLEEPING

SLEEPING
OVERHEAD PARKING
MOBILE SLEEPERS

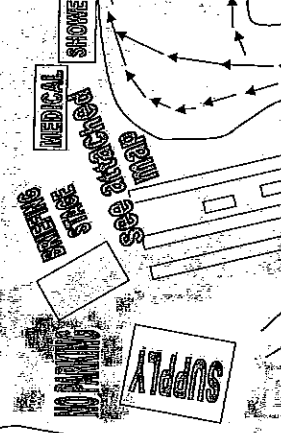
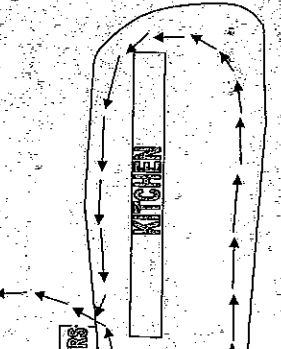

DO NOT ENTER

NO PARKING

EXIT ENTER

SHOWERS
LUNDRY

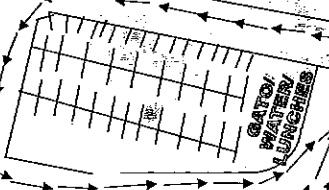

FUEL

PARKING

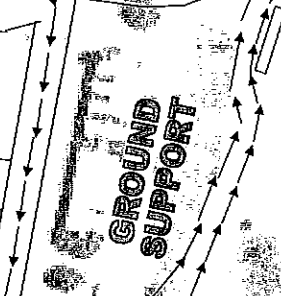

PARKING

DAY SLEEPING
PARKING

GRAY WATER DUMP

GROUND SUPPORT
DO NOT ENTER

DO NOT ENTER
NO PARKING

DO NOT ENTER

BUSHEAVY EQUIP
PARKING

CREWENGINE
PARKING

PARKING

PARKING

