

30,690 Est. Acres
Acres from IR 09/02/2020 2330

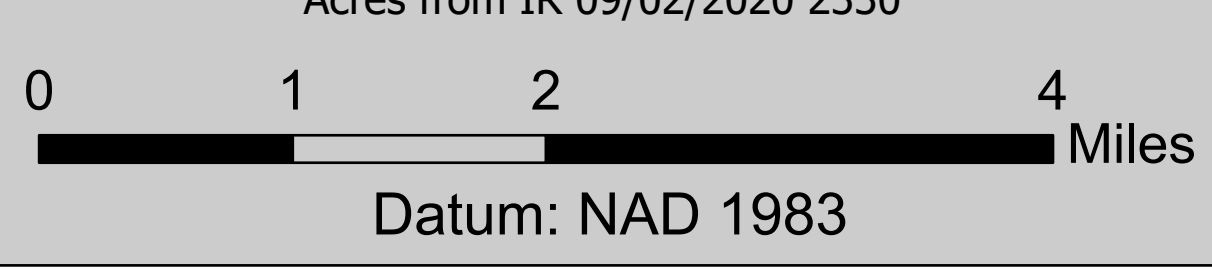

- | | | | | | | | |
|----------------|------------|-----------------------|---------------------|-------------------------|------------------------|-------------------------|-------------|
| Building point | Drop Point | Incident Base | Mobile Weather Unit | Staging Area | Uncontrolled Fire Edge | Access or Improved Road | Trail |
| Bridge | Gate | Incident Command Post | Repeater | Water Source | Contained Line | Line Break Completed | Butler Fire |
| Camp | Hazard | Internet Access | Road Repair | Restricted Water Source | Completed Dozer Line | Proposed Dozer Line | Wilderness |
| Culvert | Helibase | Landmark | Sling Site | Value at Risk | Completed Hand Line | Planned Fire Line | |
| Dip Site | Helispot | Lookout | Spot Fire | Division Break | Road as Completed Line | Roads | |

