

Incident Action Plan

South Complex

CA-SHF-002108

P5J0MZ (0514)

FRIDAY



NIGHT SHIFT

08/14/15 – 08/15/15

1800 - 0600

**FIRE INFORMATION
(530) 628 - 0093**

INCIDENT OBJECTIVES (ICS 202)

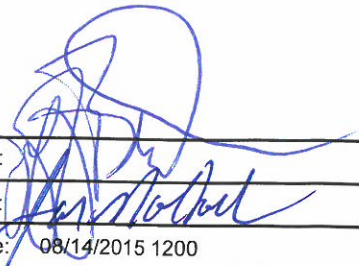
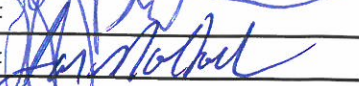
1. Incident Name:		2. Operational Period: NIGHT	
SOUTH COMPLEX		Date/Time From: 08/14/2015 1800 FRI	Date/Time To: 08/15/2015 0600 SAT
3. Objective(s):			
<ul style="list-style-type: none"> • Ensure that strategies and tactics provide for firefighter and public safety through the application of sound risk management principles. • Limit the impacts of unwanted fire on private and tribal lands where it is safe to do so. • Establish and strengthen cooperator, partner, and stakeholder relationships. • Minimize the cost of the incident by employing tactics that have the highest probability of success. • Assist the Route Complex with operational, logistical, and planning support as needed. 			
4. Operational Period Command Emphasis:			
<ul style="list-style-type: none"> • Reduce the threat to the community of Hyampom by keeping the Castle Fire north and east of the community. • Prevent the Castle Fire from spreading further onto the Six Rivers NF by keeping it east of the 311 road. • Minimize the impacts to the Trinity River Byway by keeping the complex south of the Trinity River. • Minimize threat to private property and infrastructure by keeping the Pattison Fire north of Hayfork Creek. 			
General Situational Awareness:			
5. Site Safety Plan Required? Yes <input type="checkbox"/> No <input checked="" type="checkbox"/>			
Approved Site Safety Plan(s) Located at:			
6. Incident Action Plan (the items checked below are included in this Incident Action Plan):			
<input checked="" type="checkbox"/> ICS 202	<input type="checkbox"/> ICS 207	Other Attachments:	
<input checked="" type="checkbox"/> ICS 203	<input type="checkbox"/> ICS 208	<input checked="" type="checkbox"/> FIRE BX	
<input checked="" type="checkbox"/> ICS 204	<input checked="" type="checkbox"/> ICS 220	<input checked="" type="checkbox"/> SAFETY MESSAGE	
<input checked="" type="checkbox"/> ICS 205	<input checked="" type="checkbox"/> Map/Chart	<input checked="" type="checkbox"/> LCES WORKSHEET	
<input checked="" type="checkbox"/> ICS 205A	<input checked="" type="checkbox"/> Weather Forecast/Tides/Currents	<input type="checkbox"/> _____	
<input checked="" type="checkbox"/> ICS 206		<input type="checkbox"/> _____	
7. Prepared by: JEFF BUSCHER		Position/Title: PSC2	Signature: 
8. Approved by Incident Commander:		Name: RICK YOUNG	Signature: 
ICS 202	IAP Page	Date/Time:	08/14/2015 1200

ORGANIZATION ASSIGNMENT LIST (ICS 203)

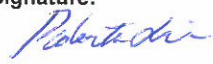
1. Incident Name:		2. Operational Period: NIGHT	
SOUTH COMPLEX		Date/Time From: 08/14/2015 1800 FRI	Date/Time To: 08/15/2015 0600 SAT
3. Incident Commander(s) and Command Staff:			
IC/UC	RICK YOUNG	DEPUTY	AARON LOWE
DEPUTY	JOE MOLHOEK	SUPPLY UNIT	TRACEY VALENTINE
LIAISON OFFICER	TIM FIKE	FACILITIES UNIT	ROBIN DAVIS (T); BILL PATTEN RIC CROWTHER
SAFETY OFFICER	TERRY O'CONNELL STEVE DAVIS	GROUND SUPPORT UNIT	JOHN FELL / MERLE DRUCKER
INFORMATION OFFICER	ADRIENNE FREEMAN COREY WILFORD	COMMUNICATIONS UNIT	DON STONER
		MEDICAL UNIT	PATRICK YOUNG
		FOOD UNIT	KEVIN BROWNING
4. Agency/Organization Representative(s):			
Agency/Organization	Name	7. Operations Section:	
AGENCY ADMIN	DAVE MYERS	DAY OPS CHIEF	ERIC PETTERSON
SHASTA NF DUTY CHIEF	GWEN SANCHEZ	NIGHT OPS CHIEF	DAREN DALRYMPLE
AAR	VINCE KEELER	PLANNING OPS	DAN GEORGE
LEAD RESOURCE ADVISOR	LOIS SHOEMAKER JOE STUBBENDICK	DIVISION/GROUP	L / M / U MARK JOHNSON
TRINITY COUNTY SHERIFF	MIKE RIST	DIVISION/GROUP	O / Q JOE GRIFFIN SAM DONAHUE (T)
TRINITY COUNTY ADVISOR	ROGER JAEGEL LARRY WINTER	DIVISION/GROUP	S / Z STEVE RAYMER
PG&E	JOE CERACERI	DIVISION/GROUP	STRUCTURE UNSTAFFED
AMERICAN RED CROSS	KENDRA POSPYCHALLA	DIVISION/GROUP	CONTINGENCY UNSTAFFED
HYAMPOM VOLUNTEER FD	JOE WATKINS	7b. Air Operations Branch:	
CHP	MIKE ARPAI	AIR OPS BRANCH DIRECTOR	DENNIS KUSTER STACI DICKSON (T)
TRINITY PUD	RORY BARRETT	ASGA	ALEXANDER STONE JOHN MASON (T)
CAL OES	GARY HUMPHREY	ATGS	HARDY BLOEMEKE STEVE REED (T)
5. Planning Section:		HELIBASE MANAGER	TOM KENNEDY
CHIEF	PATRICK FARRELL JEFF BUSCHER (T)	8. Finance/Administration Section:	
RESOURCES UNIT	ROBERTA LIM; D. MILLER	CHIEF	BETH LOPEZ
SITUATION UNIT	K. FLOOD ; M. BROWN; J OWEN (T)	DEPUTY	RICH ANDERSEN
DOCUMENTATION UNIT	REX CRABTREE LATONYA SINGLETON (T)	PERSONNEL TIME UNIT	PENNY PORTLOCK
DEMOBILIZATION UNIT	RUBINA VIGIL	EQUIPMENT TIME UNIT	JUANITA CORTEZ
FIRE BEHAVIOR ANALYST	KEN LARSON	COST UNIT	SAM RAPPHAHN
INCIDENT METEOROLOGIST	ANDY HANER DAVID SHALLENBERGER (T)	COMPENSATION UNIT	TINA KENNEDY
CTSP	SHANE NEAL; Z. SOHL (T)	IBA	ANNA DILLARD
TRAINING SPECIALIST	BRAD SMITH; SEAN WOLF (T)		
GIS SPECIALIST	M. KERR; M. GRUPE; S. MIKULOVSKY		
STATUS CHECK-IN	JONNA HILDENBRAND (T)		
6. Logistics Section:			
CHIEF	JACK COSTELLO		
9. Prepared By: Name: ROBERTA LIM		Position/Title: RESL	Signature:
ICS 203	IAP Page	Date/Time: 08/14/2015 1000	



South Complex Fire Weather Forecast



FORECAST NO: 24

NAME OF FIRE: South Complex

PREDICTION FOR: Friday Night Shift

UNIT: Shasta-Trinity National Forest

SHIFT DATE: Aug 14, 2015

SIGNED: *David J. Shallenberger* 
Incident Meteorologist (T)

TIME AND DATE

FORECAST ISSUED: Aug 14, 2015 @ 1100 PDT

WEATHER DISCUSSION:

Upper level ridging beginning to settle into the region will keep northwest flow across the region in place. Along the lower levels, northwest winds will continue across the northwest oriented drainages. This will, also allow for some marine influence into the Trinity and South Fork through the period keeping the valleys with a good recovery as well as the ridges but then the ridges dropping off in RH after midnight due to the very shallow inversion.

Weather Forecast for Friday Night:

Weather: Clear.

Low Temperature... 49°-54°

Max RH (Ridgetops)..... Fair Recovery: 50-65% on the ridges early

Max RH (Valleys)..... Good Recovery: 65-80% in the valleys.

20-FOOT WINDS:

Ridgetop..... Northwest 6-12 mph late this evening, becoming light and variable overnight

Slope/Valley..... Becoming light and variable, or calm after midnight

CWR (>=0.10").... 0% **LAL....** 1 (No Lightning)

Outlook for Saturday:

Weather: Sunny with smoke and haze.

High Temperature... 83°-93°

Min RH..... 17-27%

20-FOOT WINDS:

Ridgetop..... Northwest winds 4-8 mph in the morning, becoming 9-14 mph with gusts to 17 mph at times in the afternoon

Slope/Valley..... Upslope/upvalley 4-8 mph, with a northwest wind 6-10 mph with gusts to 17 mph developing in the major Trinity and South Trinity drainages around mid-afternoon.

CWR (>=0.10")....0% **LAL....**1 (No Lightning)

EXTENDED OUTLOOK for Sunday through Tuesday:

....Hot and Dry into Next Week....

A hot and dry pattern continue to be in store for the area heading into the new week. A transition in the upper level flow, will allow for a slackening in the winds across northern CA. A weak trough moving through late Monday into Tuesday will allow for a northwest gradient to redevelop over northern CA. Hence, this will result in an increase in northwest winds again late Monday and peaking on Tuesday but continued low relative humidity and warmer temperatures will be the main story.

FIRE BEHAVIOR FORECAST

FORECAST NUMBER: 24	TYPE OF FIRE: Wildland Fire
FIRE NAME: South Complex	OPERATIONAL PERIOD: 1800-0600, August 14-15, 2015
DATE ISSUED: August 14, 2015	TIME ISSUED: 1200
UNIT: Shasta-Trinity NF	SIGNED: /s/ Ken Larson, FBAN

INPUTS

WEATHER SUMMARY: *** See attached Fire Weather Forecast***

Discussion: Northwest flow will bring the marine layer into the lower valleys. Expect good RH recovery in the valleys and ridges but then decreasing RH values on the ridges after midnight.

Weather: Clear.

Min Temp: 49 - 54°

Max RH: 50-65% on ridges early (Fair recovery); 65-80% valleys (Good recovery)

Winds (20 foot): Ridgetop: NW 6 – 12 mph late evening, becoming light and variable overnight.

Slope/Valley: Becoming light and variable to calm after midnight.

FIRE BEHAVIOR

GENERAL

Fire behavior will be active late afternoon through early evening as drainage winds impact lower elevations and northwest winds impact upper elevations of the fire area. Fire spread will be primarily upslope/up canyon with some occasional runs through early evening. Backing fire and roll-out will also contribute to spread. After dark expect the fire behavior to moderate with minimal activity after around 2200-midnight. Hayfork ERC for August 12 was 53.

SPECIFIC FIRE BEHAVIOR

Brush/previous burn areas: potential worst-case surface head fire spread will be 20-30 chains/hour with flame length 5 to 7 feet until early evening then moderate to 2-4 chains/hour or less, flame length 1-2 feet. Backing fire rate of spread up to 2 chains/hour. Maximum spotting distance ¼ mile decreasing to short range after dark. Probability of ignition will drop to 20-30% during the night.

Timber fuel types: potential worst-case surface fire spread will be 6-10 chains/hour with flame length 4 to 6 feet, becoming 2-4 chains/hour maximum, flame length to 4 feet late evening. Backing fire rate of spread to 2 chains/hour. During the evening individual and group tree torching and short-duration crown runs could occur. Spotting distance ¼ mile decreasing to short range late. Probability of ignition will be 20-30%.

Areas of Concern:

Divisions L, M: upcanyon NW winds will spread fire toward the indirect line between the 60 Road and East Garrett Rd.

Division Q: the Mill and York fires, and NE corner of the Castle Fire, may be impacted by the NW upcanyon winds and NW ridgetop winds late afternoon/evening.

Division U: if the fire crosses the drainage south of DP-61 it could run upslope toward the dozer line west of DP-62.

Divisions S, Z: NW winds in the evening may impact any unsecured control lines especially near ridgetops. Unburned interior islands near control lines may result in torching and spotting. Indirect control lines could be compromised.

AIR OPERATIONS

Air operations may be limited due to poor visibility caused by smoke but should be clear early evening.

Sunset: 20:12

Sunrise: 06:23

SAFETY

- Weather is becoming hotter and drier over the next couple days. This will increase fire behavior in terms of rate of spread and intensity. Increases in Probability of Ignition will increase the spotting potential.
- Ensure all personnel are informed of the location of escape routes and safety zones.

Division/Group Assignment List (ICS 204 WF)

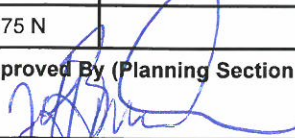
1. Incident Name:			3.			
SOUTH COMPLEX			Branch:		Division/Group: L / M / U 1 OF 2	
2. Operational Period: NIGHT						
Date/Time From: 08/14/2015 1800 FRI		Date/Time To: 08/15/2015 0600 SAT				
4. Operations Personnel						
OPERATIONS CHIEF		DAREN DALRYMPLE		DIVISION/GROUP SUPERVISOR		MARK JOHNSON
BRANCH DIRECTOR				AIR OPERATIONS BRANCH DIRECTOR		DENNIS KUSTER STACI DICKSON (T)
5. Resources Assigned this Period						
Strike Team / Task Force / Resource Designator		LWD	Leader	Number Persons	Drop Off PT./Time	Pick Up PT./Time
CREW - T2IA - SAN CARLOS 1 C-46		08/16	ROBERT JOHNSON	20	DP 60/1900	DP 60/0600
ENG S/T OES T1 2806A E-195		08/14	HUMBERTO ARISTA	22	DP 60/1900	DP 60/0600
ENG S/T OES T1 2807A E-194		08/14	DOUG MCCOUN	22	DP 60/1900	DP 60/0600
ENGINE - T4 - GIST ENT. E-159		08/23	DONALD WOOD	3	DP 60/1900	DP 60/0600
ENGINE - T6 - HEATSEEKER 10 E-11		08/16	DEREK MESTROVICH	3	DP 60/1900	DP 60/0600
ENGINE - T6 - HEATSEEKER 11 E-10		08/16	DANIEL MEYER	3	DP 60/1900	DP 60/0600
ENGINE - T6 - SUNDANCE 4 E-5		08/16	MATTHEW BLESOE	3	DP 60/1900	DP 60/0600
ENGINE - T6 - IRON TRIANGLE 230 E-4		08/16	JAKE MORTON	3	DP 60/1900	DP 60/0600
SKDG - T1 - WLOWB SOFT TRACK ATTACK 24HR E-191		08/24		2	DP 60/1900	DP 60/0600
SKDG - T3 - WLOWB TRM 24HR E-192		08/24	JACOB BULPIN	1	DP 60/1900	DP 60/0600
DOZER - T2 - WLOWB NORTH RIVERS 24HR E-209		08/18	CLINT NEWTON	1	DP 60/1900	DP 60/0600
DOZER - T2 - BAR717 24HR E-177		08/14	KENT CULLARD	1		
6. Control Operations/Work Assignments:						
<ul style="list-style-type: none"> Patrol and hold existing control lines. Provide point protection as needed. Continue to prep and support firing operations from the 3N47 to the 313 road. 						
7. Special Instructions:						
<ul style="list-style-type: none"> Identify resources for IA. Resources need to utilize Water Use log sheet located in the IAP and turn into the Division at the end of the shift. 						
8. Division/Group Communication Summary						
Function	Channel	RX Frequency N/W	RX Tone/NAC	TX Frequency N/W	TX Tone/NAC	Mode
CMD NIFC C3	1	168.0750 N		170.4250 N	131.8	A
CMD NIFC C31	2	163.5750 N		169.7250 N	131.8	A
NIFC TAC 3	6	168.6000 N	131.8	168.6000 N	131.8	A
A/G CMD	10	168.7375 N		168.7375 N		A
9. Prepared By (Resource Unit Leader)			Approved By (Planning Section Chief)		Date	Time
ROBERTA LIM					08/14/2015	1200

Division/Group Assignment List (ICS 204 WF)

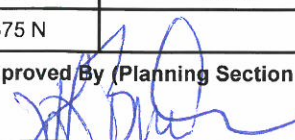
1. Incident Name:			3.			
SOUTH COMPLEX			Branch:		Division/Group: L / M / U 2 OF 2	
2. Operational Period: NIGHT						
Date/Time From: 08/14/2015 1800 FRI		Date/Time To: 08/15/2015 0600 SAT				
4. Operations Personnel						
OPERATIONS CHIEF		DAREN DALRYMPLE		DIVISION/GROUP SUPERVISOR MARK JOHNSON		
BRANCH DIRECTOR				AIR OPERATIONS BRANCH DIRECTOR DENNIS KUSTER STACI DICKSON (T)		
5. Resources Assigned this Period						
Strike Team / Task Force / Resource Designator		LWD	Leader	Number Persons	Drop Off PT./Time	Pick Up PT./Time
MAST - BORDGES TIMBER INC. E-253		08/25	DENNIS TURPIN	4	DP 60/1900	DP 60/0600
WATER TENDER - T2 - PRO-DUMP 24HR E-31		08/16	GARY COATS	1		
WATER TENDER - T2 - DARRAH 24HR E-37		08/16	RUSTY TRACY	1		
WATER TENDER - T2 - DARRAH 24HR E-39		08/16	KEN HOVE	1		
WATER TENDER - T2 - DARRAH 24HR E-35		08/16	ROB MILLER	1	DP 60/1900	DP 60/0600
WATER TENDER - T2 - DUDLEYS 24HR E-34		08/16	GREG ERBES	2	DP 60/1900	DP 60/0600
TFLD O-201		08/16	JASON BERRY	1	DP 60/1900	DP 60/0600
TFLD O-230		08/15	JEFF DION	1	DP 60/1900	DP 60/0600
HEQB O-133		08/19	NEAL YOUNGBLOOD	1	DP 60/1900	DP 60/0600
HEQB (T) O-132		08/19	EAMON ENGBER	1	DP 60/1900	DP 60/0600
HEQB O-222		08/21	ERICK MATTSON	1	DP 60/1900	DP 60/0600
SOFR O-100		08/19	CHRIS O'BRIEN	1	DP 60/1900	DP 60/0600
FEMP O-226; FEMT O-223		08/23	ERIC BENEDEK; M. LANCASTER	2	DP 60/1900	DP 60/0600
6. Control Operations/Work Assignments:						
<ul style="list-style-type: none"> Patrol and hold existing control lines. Provide point protection as needed. Continue to prep and support firing operations from the 3N47 to the 313 road. 						
7. Special Instructions:						
<ul style="list-style-type: none"> Identify resources for IA. Resources need to utilize Water Use log sheet located in the IAP and turn into the Division at the end of the shift. 						
8. Division/Group Communication Summary						
Function	Channel	RX Frequency N/W	RX Tone/NAC	TX Frequency N/W	TX Tone/NAC	Mode
CMD NIFC C3	1	168.0750 N		170.4250 N	131.8	A
CMD NIFC C31	2	163.5750 N		169.7250 N	131.8	A
NIFC TAC 3	6	168.6000 N	131.8	168.6000 N	131.8	A
A/G CMD	10	168.7375 N		168.7375 N		A
9. Prepared By (Resource Unit Leader)			Approved By (Planning Section Chief)		Date	Time
ROBERTA LIM					08/14/2015	1200

Division/Group Assignment List (ICS 204 WF)

1. Incident Name:			3.			
SOUTH COMPLEX			Branch:		Division/Group: O / Q 1 OF 2	
2. Operational Period: NIGHT						
Date/Time From: 08/14/2015 1800 FRI		Date/Time To: 08/15/2015 0600 SAT				
4. Operations Personnel						
OPERATIONS CHIEF		DAREN DALRYMPLE		DIVISION/GROUP SUPERVISOR		JOE GRIFFIN SAM DONAHUE (T)
BRANCH DIRECTOR				AIR OPERATIONS BRANCH DIRECTOR		DENNIS KUSTER STACI DICKSON (T)
5. Resources Assigned this Period						
Strike Team / Task Force / Resource Designator		LWD	Leader	Number Persons	Drop Off PT./Time	Pick Up PT./Time
ENGINE - T4 - FIRESTORMERS 12 E-23		08/16	PAUL HUDDLESTUN	3	DP 66/1900	DP 66/0600
ENGINE - T4 - FIRESTORMERS 11 E-24		08/16	SCOTT EUGENE	3	DP 66/1900	DP 66/0600
ENGINE - T6 - R&R FIRE 17 E-154		08/22	MIKE COX / D. ANDERSON (T)	3	DP 66/1900	DP 66/0600
ENGINE - T4 - BRAKKEN E-163		08/22	JILL BENTON	3	DP 66/1900	DP 66/0600
ENGINE - T4 - STERLING SYSTEMS - E-156		08/23	BRIAN MOORE	3	DP 66/1900	DP 66/0600
DOZER - T2 - WLOWB TRINITY RIVER 24HR E-166		08/15	LANDON THOMAS	1	DP 66/1900	DP 66/0600
WATER TENDER - T2 - BROWN 24HR - E-33		08/16	CHUCK HAPTONSTALL	1	DP 66/1900	DP 66/0600
WATER TENDER - T2 - WILLMORE 24HR - E-32		08/16	JOE MISHOE	1	DP 66/1900	DP 66/0600
WATER TENDER - SUPPORT - T2 - BUNN ENTERPRISES E-205		08/16	WADE BUNN	1	DP 66/1900	DP 66/0600
TFLD 0-231		08/16	MAX TWOMBLY	1	DP 66/1900	DP 66/0600
HEQB O-6		08/18	JOHN GATES	1	DP 66/1900	DP 66/0600
HEQB (T) O-76		08/17	FREDRICK CUTHILL	1	DP 66/1900	DP 66/0600
6. Control Operations/Work Assignments:						
<ul style="list-style-type: none"> Patrol and hold existing control lines. Provide point protection as needed. Monitor York and Mill fires. Prepare the 47 Road for future firing operations. 						
7. Special Instructions:						
<ul style="list-style-type: none"> Identify resources for IA. Resources need to utilize the Water Use Log sheet located in the IAP and turn into the Division at the end of the shift. 						
8. Division/Group Communication Summary						
Function	Channel	RX Frequency N/W	RX Tone/NAC	TX Frequency N/W	TX Tone/NAC	Mode
CMD NIFC C3	1	168.0750 N		170.4250 N	131.8	A
CMD NIFC C31	2	163.5750 N		169.7250 N	131.8	A
NIFC TAC 1	4	168.0500 N	131.8	168.0500 N	131.8	A
A/G CMD	10	168.7375 N		168.7375 N		A
9. Prepared By (Resource Unit Leader)			Approved By (Planning Section Chief)		Date	Time
ROBERTA LIM			<i>Paul Faul PSC2</i>		08/14/2015	1200

Division/Group Assignment List (ICS 204 WF)

1. Incident Name:			3.			
SOUTH COMPLEX			Branch:		Division/Group: O / Q 2 OF 2	
2. Operational Period: NIGHT						
Date/Time From: 08/14/2015 1800 FRI		Date/Time To: 08/15/2015 0600 SAT				
4. Operations Personnel						
OPERATIONS CHIEF		DAREN DALRYMPLE		DIVISION/GROUP SUPERVISOR		JOE GRIFFIN SAM DONAHUE (T)
BRANCH DIRECTOR				AIR OPERATIONS BRANCH DIRECTOR		DENNIS KUSTER STACI DICKSON (T)
5. Resources Assigned this Period						
Strike Team / Task Force / Resource Designator		LWD	Leader	Number Persons	Drop Off PT./Time	Pick Up PT./Time
SOFR O-210		08/23	DAVID RAY	1	DP 66/1900	DP 66/0600
FEMP S-5082		08/20	STAN BANGS	1	DP 66/1900	DP 66/0600
FEMT S-5088		08/20	MIKE PLANETA	1	DP 66/1900	DP 66/0600
6. Control Operations/Work Assignments:						
<ul style="list-style-type: none"> Patrol and hold existing control lines. Provide point protection as needed. Monitor York and Mill fires. Prepare the 47 Road for future firing operations. 						
7. Special Instructions:						
<ul style="list-style-type: none"> Identify resources for IA. Resources need to utilize the Water Use Log sheet located in the IAP and turn into the Division at the end of the shift. 						
8. Division/Group Communication Summary						
Function	Channel	RX Frequency N/W	RX Tone/NAC	TX Frequency N/W	TX Tone/NAC	Mode
CMD NIFC C3	1	168.0750 N		170.4250 N	131.8	A
CMD NIFC C31	2	163.5750 N		169.7250 N	131.8	A
NIFC TAC 1	4	168.0500 N	131.8	168.0500 N	131.8	A
A/G CMD	10	168.7375 N		168.7375 N		A
9. Prepared By (Resource Unit Leader)			Approved By (Planning Section Chief)		Date	Time
ROBERTA LIM			<i>John Paul PSC2</i>		08/14/2015	1200

Division/Group Assignment List (ICS 204 WF)

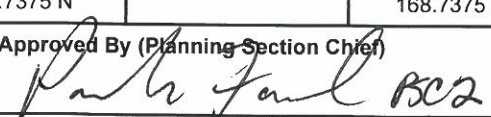
1. Incident Name:			3.			
SOUTH COMPLEX			Branch:		Division/Group: S / Z 1 OF 2	
2. Operational Period: NIGHT						
Date/Time From: 08/14/2015 1800 FRI		Date/Time To: 08/15/2015 0600 SAT				
4. Operations Personnel						
OPERATIONS CHIEF		DAREN DALRYMPLE		DIVISION/GROUP SUPERVISOR		STEVE RAYMER
BRANCH DIRECTOR				AIR OPERATIONS BRANCH DIRECTOR		DENNIS KUSTER STACI DICKSON (T)
5. Resources Assigned this Period						
Strike Team / Task Force / Resource Designator		LWD	Leader	Number Persons	Drop Off PT./Time	Pick Up PT./Time
ENGINE - T6 - EAGLE CAP 1 E-6		08/16	FRED BELL	3	DP 75/1900	DP 75/0600
ENGINE - T6 - EAGLE CAP 2 E-20		08/16	JAMES DITTRICK	3	DP 75/1900	DP 75/0600
ENGINE - T6 - RED TRUCK WILDFIRE E-12		08/17	ETHAN GODREY	3	DP 75/1900	DP 75/0600
ENGINE - T6 - TRICO 50 E-1		08/16	ROY BEAL	3	DP 75/1900	DP 75/0600
ENGINE - T4 - SUNDANCE FIRE E-22		08/16	PHIL RIFENBERY	3	DP 75/1900	DP 75/0600
ENGINE - T4 - J3 CONTRACTING E-19		08/16	REID BARNEY	3	DP 75/1900	DP 75/0600
DOZER - T2 - WLOWB HAT CREEK 24HR - E-105		08/18	CURT EMERALD	1	DP 75/1900	DP 75/0600
DOZER - T2 - WLOWB HAYS EQUIP. E-170		08/24	CHARLIE CIGANOVICH	1	DP 75/1900	DP 75/0600
WATER TENDER - T2 - HARVEY 24HR E-42		08/16	ROY WHEELER	1	DP 75/1900	DP 75/0600
WATER TENDER - T2 - DARRAH 24HR E-36		08/16	DAVE KALDNDART	1	DP 75/1900	DP 75/0600
6. Control Operations/Work Assignments:						
<ul style="list-style-type: none"> • Patrol and hold existing control lines. • Provide point protection to structures along Corral Bottom Road. • Prepare the 47 and 60 road systems for future firing operations. 						
7. Special Instructions:						
<ul style="list-style-type: none"> • Identify resources for IA. • Resources need to utilize Water Use log located in the IAP and turn into the Division at end of shift. 						
8. Division/Group Communication Summary						
Function	Channel	RX Frequency N/W	RX Tone/NAC	TX Frequency N/W	TX Tone/NAC	Mode
CMD NIFC C39	3	173.8750 N		163.6625 N	131.6	A
CMD NIFC C31	2	163.5750 N		169.7250 N	131.8	A
R5 TAC 4	7	166.5500 N	131.8	166.5500 N	131.8	A
A/G CMD	10	168.7375 N		168.7375 N		A
9. Prepared By (Resource Unit Leader)			Approved By (Planning Section Chief)		Date	Time
ROBERTA LIM					08/14/2015	1200

Division/Group Assignment List (ICS 204 WF)

1. Incident Name:			3.			
SOUTH COMPLEX			Branch:		Division/Group: S / Z 2 OF 2	
2. Operational Period: NIGHT						
Date/Time From: 08/14/2015 1800 FRI		Date/Time To: 08/15/2015 0600 SAT				
4. Operations Personnel						
OPERATIONS CHIEF		DAREN DALRYMPLE		DIVISION/GROUP SUPERVISOR		STEVE RAYMER
BRANCH DIRECTOR				AIR OPERATIONS BRANCH DIRECTOR		DENNIS KUSTER STACI DICKSON (T)
5. Resources Assigned this Period						
Strike Team / Task Force / Resource Designator		LWD	Leader	Number Persons	Drop Off PT./Time	Pick Up PT./Time
HEQB O-4		08/18	JEFF SPRITES	1	DP 75/0700	DP 75/0700
HEQB O-108		08/19	VICTOR MEMMOLI	1	DP 75/0700	DP 75/0700
SOFR O-127		08/20	BRUCE MILLER	1	DP 75/0700	DP 75/0700
FEMP		08/20	JILL HEMPELMAN	1	DP 75/0700	DP 75/0700
FEMT		08/20	SCOTT MAYER	1	DP 75/0700	DP 75/0700
6. Control Operations/Work Assignments:						
<ul style="list-style-type: none"> Patrol and hold existing control lines. Provide point protection to structures along Corral Bottom Road. Prepare the 47 and 60 road systems for future firing operations. 						
7. Special Instructions:						
<ul style="list-style-type: none"> Identify resources for IA. Resources need to utilize Water Use log located in the IAP and turn into the Division at end of shift. 						
8. Division/Group Communication Summary						
Function	Channel	RX Frequency N/W	RX Tone/NAC	TX Frequency N/W	TX Tone/NAC	Mode
CMD NIFC C39	3	173.8750 N		163.6625 N	131.6	A
CMD NIFC C31	2	163.5750 N		169.7250 N	131.8	A
R5 TAC 4	7	166.5500 N	131.8	166.5500 N	131.8	A
A/G CMD	10	168.7375 N		168.7375 N		A
9. Prepared By (Resource Unit Leader)			Approved By (Planning Section Chief)		Date	Time
ROBERTA LIM			<i>Paul Furl PSC2</i>		08/14/2015	1200

Division/Group Assignment List (ICS 204 WF)

1. Incident Name:				3.			
SOUTH COMPLEX				Branch:		Division/Group: CONTINGENCY	
2. Operational Period: NIGHT							
Date/Time From: 08/14/2015 1800 FRI		Date/Time To: 08/15/2015 0600 SAT					
4. Operations Personnel							
OPERATIONS CHIEF		DAREN DALRYMPLE		BRANCH DIRECTOR			
DIVISION/GROUP SUPERVISOR		UNSTAFFED		AIR OPERATIONS BRANCH DIRECTOR		DENNIS KUSTER STACI DICKSON (T)	
5. Resources Assigned this Period							
Strike Team / Task Force / Resource Designator			LWD	Leader	Number Persons	Drop Off PT./Time	Pick Up PT./Time
UNSTAFFED							
6. Control Operations/Work Assignments:							
UNSTAFFED							
7. Special Instructions:							
8. Division/Group Communication Summary							
Function	Channel	RX Frequency N/W	RX Tone/NAC	TX Frequency N/W	TX Tone/NAC	Mode	
CMD NIFC C39	3	173.8750 N		163.6625 N	131.6	A	
CMD NIFC C31	2	163.5750 N		169.7250 N	131.8	A	
R5 TAC 6	9	168.2375 N	131.8	168.2375 N	131.8	A	
A/G CMD	10	168.7375 N		168.7375 N		A	
9. Prepared By (Resource Unit Leader)				Approved By (Planning Section Chief)		Date	Time
ROBERTA LIM						08/14/2015	1000

INCIDENT RISK ANALYSIS
SOUTH COMPLEX CA-SHF-002108 (ICS 215A) Night

DIV	HAZARDOUS ACTIONS / CONDITIONS	MITIGATIONS / WARNINGS / REMEDIES
ALL	DANGER TREES	<ul style="list-style-type: none"> Follow "Hazard Tree Safety" guidelines, IRPG pages 22. Post lookouts, or use a spotter in mop-up areas with personnel. Don't park vehicles or take breaks in high concentrations of hazard trees. Establish trigger points for disengagement during high wind events".
ALL	TRAFFIC & DRIVING	<ul style="list-style-type: none"> Practice "Defensive Driving" techniques. Use spotters when backing. Always use headlights. Use warning lights when working on roads or traveling in smoke. Observe posted speed limits. Use chock blocks, turn wheels into hill. Many roads are narrow and mid slope, use caution.
ALL	STRUCTURE PROTECTION	<ul style="list-style-type: none"> Review Structure Protection; IRPG pages 12-16. Do not commit to stay on a structure unless the area around the structure represents an adequate safety zone. Set trigger points to disengage and allow adequate time to relocate to primary and secondary safety zones.
ALL	STEEP TERRAIN & ROLLING DEBRIS	<ul style="list-style-type: none"> Maintain 8'-10' spacing when working & walking. Don't work above any personnel. Evaluate necessity to send personnel in areas with limited access.
ALL	ENVIRONMENTAL HAZARDS	<ul style="list-style-type: none"> Keep alert for wildlife, rattlesnakes, insects, and plants. Watch footing and hand placement around rocks. Personal hygiene is #1 when it comes to Poison Oak Prevention.
ALL	AIR OPERATIONS	<ul style="list-style-type: none"> Follow "Aviation Watch-Out Situations" on page 44, IRPG. Don't plan on air resources for medical transport or resupply. Refer to page 57, IRPG for directing bucket drops. Ensure positive communication with all air resources.
ALL	HEAT RELATED ILLNESS (HRI) & DEHYDRATION	<ul style="list-style-type: none"> Drink 2 to 1 water to sports drinks. Take Frequent breaks, minimum of 10 minutes every hour. Recognize symptoms of HEAT RELATED ILLNESS which include Lack of energy, Headaches, dizziness, lack of rest, no hunger, poor eating habits, hot skin, and lack of sweating
ALL	SPOT FIRES	<ul style="list-style-type: none"> Size up prior to engagement. Watch for multiple spots. Ensure LCES is in place. Maintain Situational Awareness at all times.
DIV L,M,O Q,S Contin. Struct.	HEAVY EQUIPMENT OPERATIONS	<ul style="list-style-type: none"> Ensure communications are established with operators. Use hand signals if other communications are unavailable. Maintain a 50'-100' exclusion area around equipment. Use a spotter when backing. Maintain 200' clearance around masticator operations.
DIV L,M,O Q,S Contin.	INDIRECT LINE CONSTRUCTION	<ul style="list-style-type: none"> Establish and maintain LCES. Locate line in favorable location, lighter fuels and gentler topography when possible. Utilize natural or existing barriers. If possible burn out or backfire as line construction progresses.
ALL	MARIJUANA PLANTATIONS	<ul style="list-style-type: none"> Maintain situational awareness. Watch for open areas and sign of improvements or irrigation systems. Be aware of evidence that cultivation has occurred in the area. If you stumble upon an area with probable cultivation be extremely cautious, exit on the same route you arrived and notify supervisor immediately.
DIV L,M,S, Z	HIGH VOLTAGE POWER LINES	<ul style="list-style-type: none"> Smoke can conduct electricity; stay 150' clear of lines / towers in heavy smoke. Do not operate heavy equipment under power lines. Do not park under power lines. Watch for fallen power lines, stay 200' away, notify your supervisor Follow power line safety guide in the IRPG page 24
INCIDENT NAME: South Complex ICS 215a		DATE PREPARED: <p style="text-align: center;">August 14, 2015</p> TIME PREPARED: 1000 HOURS
		OPERATIONAL PERIOD Night Shift 08/14/15 1800-0600 Prepared by S. Davis TOConnell

Lookouts Communications Escape Routes Safety Zones	South Complex Operation Period: 08/14/2015 Night Shift
	SAFETY MESSAGE

Human Factors Errors

1. Underestimating hazards, and using inadequate safety measures.
2. Failing to notice changing conditions and adjust tactics accordingly.

7 Barriers to Situational Awareness

1. Inexperience.
2. Getting too Comfortable (Complacency, Inattention, Autopilot).
3. Distraction from Primary Duty.
4. Priorities Out of Order.
5. Social Influences (Groupthink, Peer Pressure).
6. Stress Reaction (Tunnel Vision, Mission Fixation).
7. Physical Impairment (Fatigue, Carbon Monoxide, Heat Stress, Medications).

MAJOR HAZARDS AND RISKS

STEEP TERRAIN FATIGUE SPOT FIRES	ROLLING MATERIAL DEHYDRATION BUCKET DROPS	HEAVY EQUIPMENT HAZARD TREES COMPLACENCY
--	---	--

Be sure all elements of your safety plan are in place prior to engagement

Driving Rules

- Keep your seat belt on!
- Keep your eyes on the road!
- Keep your speed down!
- 20 MPH on the pavement
- 15 MPH maximum off pavement
- Uphill traffic yields to downhill traffic
- Reduce speed on the narrow sections of the road, on turns with poor sight lines, and in smokey conditions.
- Park well off of the road

Steps To Protect Yourself From Illnesses

- Wash your hands often
- Avoid touching your eyes, nose, or mouth, germs spread this way
- Try to avoid close contact with sick people
- Practice good health habits. Get plenty of sleep drink plenty of fluids, and eat healthy food
- Cover your nose and mouth with a tissue when you cough or sneeze. Throw the tissue in the trash after you use it
- If you are sick with flu-like illness, separate that person from the rest of your crew and others.



FURADAN IN MARIJUANA GROWS POSES OFFICER SAFETY RISK

On August 25, 2014 a multi-agency team conducted a marijuana enforcement operation at an illegal cultivation site located on National Forest land in Shasta County, California. Officers eradicating the marijuana plants noted that the bottom portions of the stalks were coated with a pink substance. A suspect arrested at the scene disclosed the plants had been treated with **carbofuran**, a pesticide known under the trade name **Furadan** (most common), and others. The suspect stated the pesticide was intended to kill squirrels, rabbits and deer that were eating the marijuana plants. After exposure, at least four officers complained of symptoms including headache, nausea, and a burning sensation in the extremities.

Formerly a U.S. registered pesticide, in March 2009 the U.S. Environmental Protection Agency (EPA) revoked all food tolerances for carbofuran, prohibiting its use on crops intended for human consumption. An eventual ban in the U.S. is anticipated. Carbofuran is highly toxic to vertebrates – a quarter teaspoon (1 ml) is potentially fatal to humans. A cholinesterase inhibitor (neurotoxin), carbofuran exposure can result from inhalation, ingestion, eye, or skin contact. The precautionary statement published by the manufacturer prior to the EPA food tolerance revocation states people handling Furadan should minimally wear long-sleeve shirts, long pants, chemical-resistant gloves, protective eyewear, and use a respirator with a canister approved for pesticides. Symptoms of poisoning include weakness, headache, nausea, vomiting, abdominal cramps, diarrhea, tight chest, blurred vision, constricted pupils, and abnormal saliva flow. Seek immediate medical attention if you are exposed to carbofuran and experience any symptoms.

In addition to using carbofuran to discourage herbivores from feeding on marijuana, illegal growers also add it to bait to kill bears, raccoons, and other animals they fear or consider pests. In July 2013, a rare Pacific fisher killed by a pesticide in the same family as carbofuran was discovered in a marijuana grow site in northern California. In Africa, farmers use carbofuran to illegally kill lions and other predators. Formerly available in the U.S. in pellet form, carbofuran is most commonly encountered as a concentrated pink liquid. Marijuana growers use plastic bottles or other containers to mix the concentrate with water. The solution is applied to marijuana plants by wiping or spraying.



MEDICAL PLAN	1. INCIDENT NAME South Complex	2. DATE PREPARED 08/14/15	3. TIME PREPARED 2000	4. OPERATIONAL PERIOD 08/14/15 1800 to 08/15/15 0600				
MEDICAL AID STATIONS		LOCATION			PARAMEDICS			
Medical Unit		ICP			YES	NO		
Frontline Medical Unit		ICP			XX			
FEMP Benedek and FEMT Lancaster		Division "L/M/U":			XX			
FEMP Bangs and FEMT Planeta		Division "O/Q"			XX			
FEMP Hempleman and FEMT Mayer		Division "S/Z"			XX			
6. TRANSPORTATION								
A. AIR RESOURCES								
NAME		LOCATION		PHONE	PARAMEDICS			
REACH Air Ambulance		Redding, Ca.		530-226-2400	YES	NO		
Mercy Air PHI		Redding, Ca.		530-226-2400	XX			
C.H.P				530-226-2400	XX			
Cal Fire				530-226-2400		XX		
Air National Guard		Redding, Ca.		530-226-2400		XX		
B. INCIDENT AMBULANCES								
NAME		LOCATION			PARAMEDICS			
American Medical Response		AMR 230 and AMR 280 Base Camp			YES	NO		
Trinity County Ambulance		Hayfork, Ca.			XX			
7. HOSPITALS								
NAME	ADDRESS	TRAVEL TIME		PHONE	HELIPAD		BURN CENTER	
		AIR	GRND		YES	NO	YES	NO
Trinity Hospital	60 Easter Ave. Weaverville, Ca.	15 Min	1 Hour 45 Min.	530-623-5541 EXT 1	XX			XX
Shasta Regional Medical Center Level 3 Trauma Center	1100 Butte Redding, Ca.	35 Min	2.5 Hours	530-244-535	XX			XX
Mercy Medical Center Level 2 Trauma Center	2175 Rosaline Ave. Redding, Ca.	35 Min	2.5 Hours	530-225-7201	XX			XX
U.C. Davis Medical Center Level 1 Trauma Center	2315 Stockton Blvd. Sacramento, Ca	1 Hour	6 Hours	916-734-3790 ER 916-734-3636	XX			XX
8. MEDICAL EMERGENCY PROCEDURES								
IN-CAMP CARE				LINE EMERGENCIES				
<ul style="list-style-type: none"> Minor Injuries or illnesses <ul style="list-style-type: none"> Seek Aid directly at the Frontline Medical Unit, report all injuries or illnesses to supervisor Unit Open 0600 hrs to 2200 hrs Moderate to Severe Injuries or Illnesses <ul style="list-style-type: none"> Contact Communications directly Med Unit staffed after hours for Emergencies 				<ul style="list-style-type: none"> Start of shift: notify your Div Sup of EMT's/Paramedic's and Medical gear carried by crew Crew Supervisor contacts Division with Nature of Emergency. Division Supervisor contact's Communications and declare a medical emergency on command Closest DIVS or designee responds to incident <ul style="list-style-type: none"> Closest SOFR/EMT's respond to assist w/care Use attached Injury or Incident Comm. Protocol If ambulance (ground or air) delayed designate rendezvous site and move towards it Secure scene for investigation—keep a log 				
ICS 206 8-78	9. PREPARED BY (MEDICAL UNIT LEADER) Patrick Young MEDL 8/14/2015			10. REVIEWED BY (SAFETY OFFICER) Steve Davis SOF-2 8/14/2015				

INCIDENT RADIO COMMUNICATIONS PLAN (ICS 205)

1. Incident Name:		2. Date/Time Prepared:		3. Operational Period:	
SOUTH COMPLEX		Date: 08/14/2015	Date/Time From: 08/14/2015 1800	FRI	Date/Time To: 08/15/2015 0600
		Time: 1145			SAT

4. Basic Radio Channel Use:											
Zone Group	Ch #	Function	Channel Name/Trunked Radio System Talkgroup	Assignment	RX Freq	RX Tone/NAC	TX Freq	TX Tone/NAC	Mode (A, D, or M)	Remarks	
15	1	CMD NIFC C3	NIFC C3	CMD	168.0750 N		170.4250 N	131.8	A	TONE 3 (131.8) LIMEDYKE MTN LINK TO C31, C39	
15	2	CMD NIFC C31	NIFC C 31	CMD ALT	163.5750 N		169.7250 N	131.8	A	TONE 3 (131.8) IRONSIDE MTN LINK TO C3, C39	
15	3	CMD NIFC C39	NIFC C39	CMD ALT	173.8750 N		163.6625 N	131.6	A	HAYFORK BALLY L.O. LINK TO C3, C31.	
15	4	NIFC TAC 1	NIFC TAC 1	DIV O / Q	168.0500 N	131.8	168.0500 N	131.8	A	TONE 3 (131.8)	
15	5	NIFC TAC 2	NIFC TAC 2	I / A	168.2000 N		168.2000 N		A		
15	6	NIFC TAC 3	NIFC TAC 3	DIV S / L / M / U	168.6000 N	131.8	168.6000 N	131.8	A	TONE 3 (131.8)	
15	7	R5 TAC 4	R5 TAC 4	DIV S / Z	166.5500 N	131.8	166.5500 N	131.8	A	TONE 3 (131.8)	
15	8	R5 TAC 5	R5 TAC 5	STRUCTURE GRP	167.1125 N	131.8	167.1125 N	131.8	A	TONE 3 (131.8)	
15	9	R5 TAC 6	R5 TAC 6	CONT GRP	168.2375 N	131.8	168.2375 N	131.8	A	TONE 3 (131.8)	
15	10	A/G CMD	A / G CMD	ALL DIVS	168.7375 N		168.7375 N		A	A / G CMD FOR ALL DIVS	
15	11	A/G TAC	A / G TAC	ALL DIVS	167.5750 N		167.5750 N		A	A / G TAC FOR ALL DIVS	
15	12	VTAC 11	VTAC 11	ROUTE FIRE	151.1375 N		151.1375 N	156.7	A	TONE 156.7 (TONE 6) SHARED FREQ WITH ROUTE COMPLEX	
15	13	CMD NIFC C37	NIFC C37	ALT CMD	172.5500 N		162.7750 N	156.7		ROUTE CMD C37 LINK TO C6, C9	
15	14	CMD SHF TN12	SHF RPT TN12		171.5750 N		169.1000 N	127.3	A	TONE 12 (127.3) LOCAL FOREST NET	
15	15	CALCORD	CALCORD	ALL DIVS MED	156.0750 N	156.7	156.0750 N	156.7	A	TONE 6(156.7) MEDICAL ALL DIVS	
15	16	AIR GUARD	AIR GUARD	EMERGENCY	168.6250 N		168.6250 N	110.9	A	TONE 1 (110.9) EMERGENCY	

5. Special Instructions:
 Road Group will use the Tactical that is assigned to the division they are working in.

6. Prepared By		Name: DON STONER	
(Communications Unit Leader)		Signature: 	
ICS 205		IAP Page	
		Date/Time: 08/14/2015 1145	

TRAINING SPECIALIST MESSAGE

In order to receive documented credit for your training assignment – you must close out with the Training Specialist prior to Demob!!

Beat the Rush!!

Trainer / Evaluators: If as much work as possible has been completed in the position task book, you are ***strongly*** encouraged to take advantage of your time in camp and conduct the training close-out with the TNSP. It is not necessary to wait until demob!

Bring the following to the “exit interview”

- **A completed and signed ICS 225 Performance Evaluation**
- **A completed Exit Interview Form**

Submitting the attached registration form prior to close out will save you time.

**Brad Smith – TNSP
Sean Wolf – TNSP(t)**

INCIDENT TRAINEE REGISTRATION FORM

Complete **ALL** fields and return to Training Specialist or DROP BOX for entry into database.

Remember to close out training packets with the Training Specialist before DEMOB.

TRAINEE'S DATA

Name (PRINT): _____ ICS Trainee Position: _____

Request # (A,C,E,or O): _____ Agency Designator (Ex. CA-MNF): _____

USFS___ State___ BLM___ BIA___ NPS___ FWS___ Local Govt. ___ DOD___ NWS___

_____ R-5 Priority Trainee R-8 Priority Trainee _____ FS-FPM Trainee _____ IFPM Trainee _____ Ordered as Trainee? Y N

Date Assigned: _____ Cell Phone: _____

TRAINING RECORDS TO BE MAILED TO: (Chief, Training Officer, ect)

Name: _____ Title: _____

Name of Home Unit: _____

Address: _____

City: _____ State: _____ Zip Code: _____ Phone: _____

TRAINEE PREREQUISITES

1. Valid Red Card or agency certification card? _____Yes _____No

2. Trainee has current position task book issued by home unit? _____Yes _____No

Current Task Book Progress: _____0% _____25% _____50% _____75% _____90%

Priority Open Tasks in PTB (You Want to Accomplish On This Incident) _____

TRAINER/EVALUATOR DATA

Trainer/Evaluator Name: _____ ICS position on fire _____

Home Unit: _____ Agency Designator(ex. CA-MNF): _____

Work Address: _____ City: _____

State: _____ Zip Code: _____ Cell Phone: _____

- 1. Check-in, Demob, Documentation
- 2. Training Specialist, Safety
- 3. Equip Time, Comp/Claim
- 4. Persn Time, COST
- 5. Clerical
- 6. GIS
- 7. Frontline Med
- 8. ISI Communications
- 9. READ
- 10. OPS, AIR OPS, PSC, RES, SIT, IMET, FBAN
- 11. Satellite
- 12. COMO/MED
- 13. ROUTE Fire
- 14. Info
- 15. FACL/FOOD
- 16. IC
- 17. Meeting Tent
- 18. LOSS/Ordering

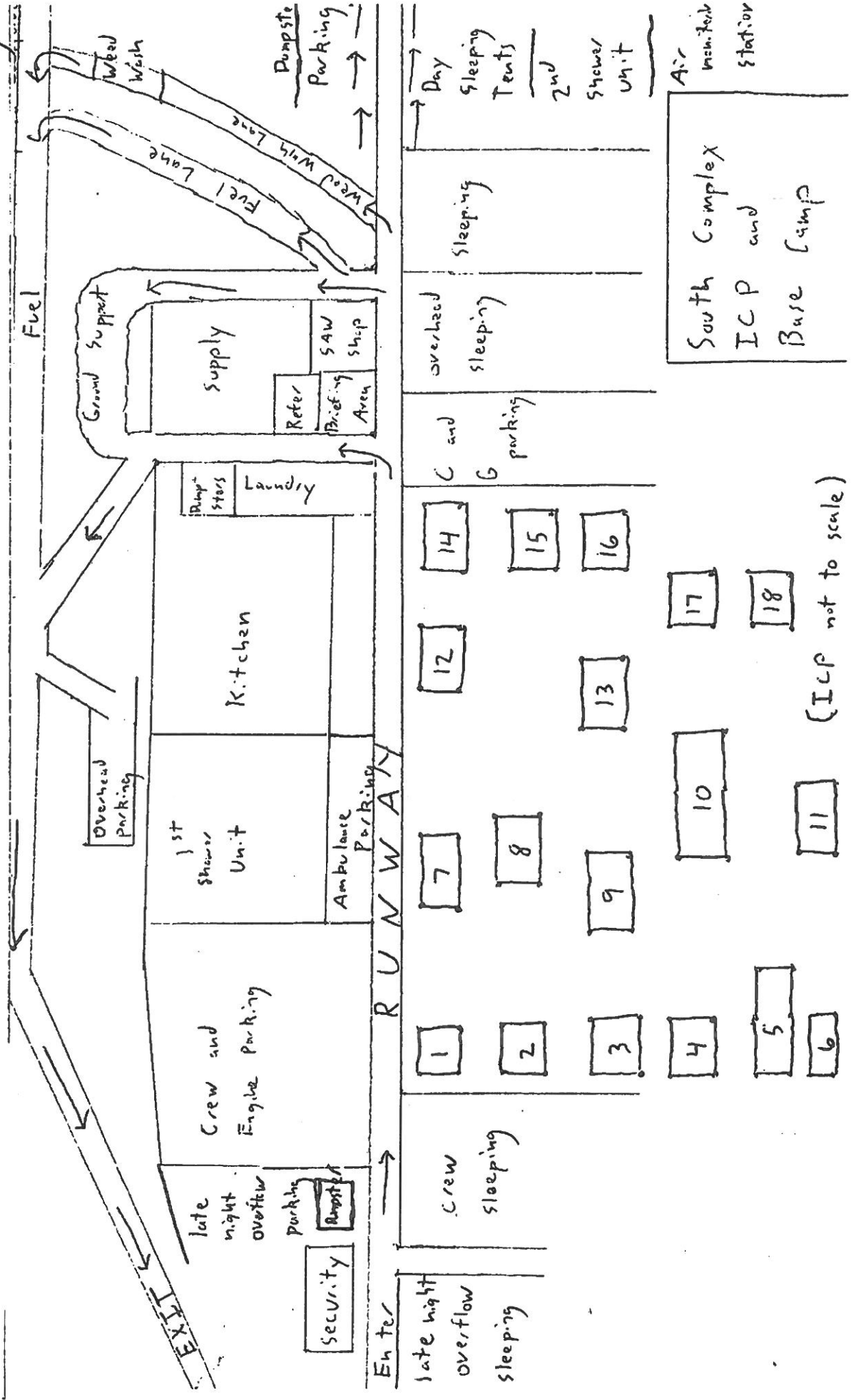

(ICP not to scale)

NORCAL 2 INCIDENT MANAGEMENT TEAM WATER USAGE LOG

DATE: _____

Division / Group: _____

AGENCY ID / VENDOR: _____

i.e.. Strike Team 1110C, Acme Water Tenders

REQUEST # _____

WATER SOURCE LOCATION	Hydrant	Open source i.e. pond	Tank	Gallons Used	Property Owner / Contact Number if known **

****Please note if you made contact with property owner and their contact.
(Use reverse side if needed.)**

Information: _____

The intent of this document is intended to track, record and validated the amount of water used on an incident. It's not intended to review the performance of equipment using the water on an incident.

MEDICAL INCIDENT REPORT

FOR ALL MEDICAL EMERGENCIES: IDENTIFY ON SCENE INCIDENT COMMANDER BY NAME AND POSITION AND ANNOUNCE "MEDICAL EMERGENCY" TO INITIATE RESPONSE FROM IMT COMMUNICATIONS/DISPATCH.

Use items one through nine to communicate situation to communications/dispatch.

1. CONTACT COMMUNICATIONS/DISPATCH

Ex: "Communications, Div. Alpha. Stand-by for Priority Medical Incident Report." (If life threatening request designated frequency be cleared for emergency traffic.)

2. INCIDENT STATUS: Provide incident summary and command structure.

Nature of Injury/Illness		<i>Describe the injury (Ex: Broken leg with bleeding)</i>
Incident Name		<i>Geographic Name + "Medical" (Ex: Trout Meadow Medical)</i>
Incident Commander		<i>Name of IC</i>
Patient Care		<i>Name of Care Provider (Ex: EMT Smith)</i>

3. INITIAL PATIENT ASSESSMENT: Complete this section for each patient. This is only a brief, initial assessment. Provide additional patient info after completing this 9 Line Report.

Number of Patients:	Male / Female	Age:..	Weight:..
Conscious? <input type="checkbox"/> YES <input type="checkbox"/> NO = MEDEVAC!			
Breathing? <input type="checkbox"/> YES <input type="checkbox"/> NO = MEDEVAC!			
Mechanism of Injury: <i>What caused the injury?</i>			
Lat/Long (Datum WGS84) <i>Ex: N 40° 42.45' x W 123° 03.24'</i>			

4. SEVERITY OF EMERGENCY, TRANSPORT PRIORITY

SEVERITY	TRANSPORT PRIORITY
<input type="checkbox"/> URGENT-RED Life threatening injury or illness. <i>Ex: Unconscious, difficulty breathing, bleeding severely, 2° – 3° burns more than 4 palm sizes, heat stroke, disoriented.</i>	Ambulance or MEDEVAC helicopter. Evacuation need is IMMEDIATE.
<input type="checkbox"/> PRIORITY-YELLOW Serious Injury or illness. <i>Ex: Significant trauma, not able to walk, 2° – 3° burns not more than 1-2 palm sizes.</i>	Ambulance or consider air transport if at remote location. Evacuation may be DELAYED.
<input type="checkbox"/> ROUTINE-GREEN Not a life threatening injury or illness. <i>Ex: Sprains, strains, minor heat-related illness.</i>	Non-Emergency. Evacuation considered Routine of Convenience.

5. TRANSPORT PLAN:

Air Transport: (Agency Aircraft Preferred)

- Helispot
 Short-haul/Hoist
 Life Flight
 Other

Ground Transport:

- Self-Extract
 Carry-Out
 Ambulance
 Other

6. ADDITIONAL RESOURCE/EQUIPMENT NEEDS:

- | | | |
|--|--------------------------------------|--|
| <input type="checkbox"/> Paramedic/EMT(s) | <input type="checkbox"/> Crew(s) | <input type="checkbox"/> SKED/Backboard/C-Collar |
| <input type="checkbox"/> Burn Sheet(s) | <input type="checkbox"/> Oxygen | <input type="checkbox"/> Trauma Bag |
| <input type="checkbox"/> Medication(s) | <input type="checkbox"/> IV/Fluid(s) | <input type="checkbox"/> Cardiac Monitor/AED |
| <input type="checkbox"/> Other (i.e. splints, rope rescue, wheeled litter) | | |

8. EVACUATION LOCATION:

Lat/Long (Datum WGS84)
EX: N 40 42.45' x W 123 03.24'

Patient's ETA to Evacuation Location:

Helispot/Extraction Size and Hazards:

9. CONTINGENCY: