

Incident Action Plan

South Complex

CA-SHF-002108

P5J0MZ (0514)



NIGHT SHIFT

08/19/15 – 08/20/15

1800 - 0600

FIRE INFORMATION
(530) 628 – 0093

WEDNESDAY

INCIDENT OBJECTIVES (ICS 202)

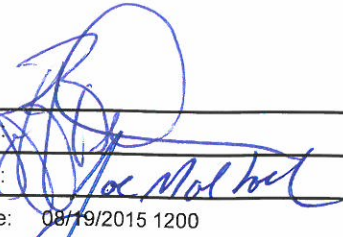
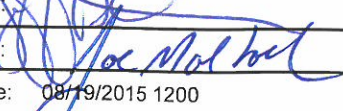
1. Incident Name:		2. Operational Period: NIGHT	
SOUTH COMPLEX		Date/Time From: 08/19/2015 1800 WED	Date/Time To: 08/20/2015 0600 THU
3. Objective(s):			
<ul style="list-style-type: none"> • Ensure that strategies and tactics provide for firefighter and public safety through the application of sound risk management principles. • Limit the impacts of unwanted fire on private and tribal lands where it is safe to do so. • Establish and strengthen cooperator, partner, and stakeholder relationships. • Minimize the cost of the incident by employing tactics that have the highest probability of success. • Assist the Route Complex with operational, logistical, and planning support as needed. 			
4. Operational Period Command Emphasis:			
<ul style="list-style-type: none"> • Reduce the threat to the community of Hyampom by keeping the Castle Fire north and east of the community. • Prevent the Castle Fire from spreading further onto the Six Rivers NF by keeping it east of the 311 road. • Minimize the impacts to the Trinity River Byway by keeping the complex south of the Trinity River. • Minimize threat to private property and infrastructure by keeping the Pattison Fire north of Hayfork Creek. 			
General Situational Awareness:			
5. Site Safety Plan Required? Yes <input type="checkbox"/> No <input checked="" type="checkbox"/>			
Approved Site Safety Plan(s) Located at:			
6. Incident Action Plan (the items checked below are included in this Incident Action Plan):			
<input checked="" type="checkbox"/> ICS 202	<input type="checkbox"/> ICS 207	Other Attachments:	
<input checked="" type="checkbox"/> ICS 203	<input type="checkbox"/> ICS 208	<input checked="" type="checkbox"/> FIRE BX	
<input checked="" type="checkbox"/> ICS 204	<input type="checkbox"/> ICS 220	<input checked="" type="checkbox"/> SAFETY MESSAGE	
<input checked="" type="checkbox"/> ICS 205	<input checked="" type="checkbox"/> Map/Chart	<input checked="" type="checkbox"/> LCES WORKSHEET	
<input checked="" type="checkbox"/> ICS 205A	<input checked="" type="checkbox"/> Weather Forecast/Tides/Currents	<input type="checkbox"/> _____	
<input checked="" type="checkbox"/> ICS 206		<input type="checkbox"/> _____	
7. Prepared by: PATRICK FARRELL		Position/Title: PSC2	
8. Approved by Incident Commander:		Signature: 	
Name: RICK YOUNG		Signature: 	
ICS 202	IAP Page	Date/Time: 08/19/2015 1200	

ORGANIZATION ASSIGNMENT LIST (ICS 203)

1. Incident Name:		2. Operational Period: NIGHT	
SOUTH COMPLEX		Date/Time From: 08/19/2015 1800	Date/Time To: 08/20/2015 0600
		WED	THU
3. Incident Commander(s) and Command Staff:		6. Logistics Section:	
IC/UC	RICK YOUNG	CHIEF	JACK COSTELLO
DEPUTY	JOE MOLHOEK	DEPUTY	AARON LOWE
LIAISON OFFICER	TIM FIKE	SUPPLY UNIT	TRACEY VALENTINE
SAFETY OFFICER	TERRY O'CONNELL STEVE DAVIS	FACILITIES UNIT	RIC CROWTHER / BILL PATTEN ROBIN DAVIS (T)
INFORMATION OFFICER	ADRIENNE FREEMAN COREY WILFORD	GROUND SUPPORT UNIT	JOHN FELL / MERLE DRUCKER
4. Agency/Organization Representative(s):		COMMUNICATIONS UNIT	DON STONER
Agency/Organization	Name	MEDICAL UNIT	PATRICK YOUNG
AGENCY ADMIN	DAVE MYERS	FOOD UNIT	KEVIN BROWNING
SHASTA NF DUTY CHIEF	GWEN SANCHEZ	7. Operations Section:	
AAR	CAROLYN NAPPER	DAY OPS CHIEF	ERIC PETTERSON
CAL FIRE	SCOTT PACKWOOD	NIGHT OPS CHIEF	DAREN DALRYMPLE
CAL OES	DAVE STONE	PLANNING OPS	DAN GEORGE
LEAD RESOURCE ADVISOR	MATT STAUDACHER		
TRINITY COUNTY SHERIFF	MIKE RIST	DIVISION/GROUP	H / L / M
TRINITY COUNTY ADVISOR	ROGER JAEGEL LARRY WINTER	DIVISION/GROUP	O / Q / S / T / Z
PG&E	JOE CERACERI	DIVISION/GROUP	W / X / Y
AMERICAN RED CROSS	KENDRA POSPYCHALLA	DIVISION/GROUP	STRUCTURE
HYAMPOM VOLUNTEER FD	JOE WATKINS	7b. Air Operations Branch:	
CHP	MIKE ARPAI	AIR OPS BRANCH DIRECTOR	DENNIS KUSTER STACI DICKSON (T)
TRINITY PUD	RORY BARRETT	ASGA	JOHN MASON (T)
5. Planning Section:		ATGS	JASON WITHROW
CHIEF	PATRICK FARRELL JEFF BUSCHER (T)	HELIBASE MANAGER	TOM KENNEDY
RESOURCES UNIT	ROBERTA LIM, DUANE MILLER MATT BROWN (T)	8. Finance/Administration Section:	
SITUATION UNIT	KEITH FLOOD JOHN OWEN (T)	CHIEF	BETH LOPEZ
DOCUMENTATION UNIT	LATONYA SINGLETON (T)	DEPUTY	RICH ANDERSEN
DEMOBILIZATION UNIT	MARIA WILSON; KAREN MCWILLIAMS	PERSONNEL TIME UNIT	PENNY PORTLOCK
FIRE BEHAVIOR ANALYST	KEN LARSON	EQUIPMENT TIME UNIT	JUANITA CORTEZ
INCIDENT METEOROLOGIST	BOB NESTER DAVID SHALLENBERGER (T)	COST UNIT	SAM RAPPHAHN
CTSP	SHANE NEAL; Z. SOHL (T)	COMPENSATION UNIT	TINA KENNEDY
TRAINING SPECIALIST	BRAD SMITH; SEAN WOLF (T)	IBA	ANNA DILLARD
GIS SPECIALIST	M. GRUPE; S. MIKULOVSKY		
STATUS CHECK-IN	HEATHER CAREY (T)		
9. Prepared By:	Name: ROBERTA LIM	Position/Title: RESL	Signature:
ICS 203	IAP Page	Date/Time: 08/19/2015 1000	



South Complex Fire Weather Forecast



FORECAST NO: 34

NAME OF FIRE: South Complex

PREDICTION FOR: Wednesday Night Shift

UNIT: Shasta-Trinity National Forest

SHIFT DATE: Aug 19, 2015

SIGNED: *David J. Shallenberger* 
Incident Meteorologist

TIME AND DATE

FORECAST ISSUED: Aug 19, 2015 @ 1100 PDT

WEATHER DISCUSSION:

...Inversion to Keep Smoke in Again...

Light upslope and up-valley winds will turn to drainage winds tonight a bit later than previous nights. Wind speeds will be generally between 2 and 5 mph. The inversion will set up a bit later as well with smoke being trapped under the inversion with slightly better RH recoveries. Where some of the ridges peak above the inversion, winds will be westerly.

Weather Forecast for Wednesday Night:

Weather: Clear. Smoke in the valleys.

Low Temperature (Ridgetops).....51°-56°

Low Temperature (Valleys).....59°-66°

Max RH (Midslopes/Ridgetops)..... 25-35%

Max RH (Valleys)..... 84-92%

20-FOOT WINDS:

Ridgetop..... Northwest at 4-8 mph.

Slope/Valley..... Downslope/downvalley 2-4 mph after 2000.

Outlook for Thursday:

Weather: Smoke and haze in the morning, dense at times, becoming less dense in the afternoon.

High Temperature ... 87°-95°

Min RH (Ridgetops).....15-23%

Min RH (Valleys)..... 25-30%

20-FOOT WINDS:

Ridgetop..... Northwest at 4 to 8 mph early, becoming 6 to 10 mph after noon.

Slope/Valley..... Light and variable, becoming upslope and up-valley at 6 to 10 mph with some winds over northwest oriented drainages northwest at 8 to 12 mph.

EXTENDED OUTLOOK for Friday through Sunday:

...A "Partial" Break in the Inversion Possible Friday...

A weak and dry trough will pass through Friday with some cooler air expected and an increase in northwest winds over the ridges. This will bring a slight increase of instability RHs. This will be enough to bring a brief break in the inversion partially lifting smoke for a few hours in the afternoon. Another ridge builds in for Saturday and Sunday as dry conditions, warmer temperatures, and the re-development of a strong inversion.

FIRE BEHAVIOR FORECAST

FORECAST NUMBER: 34	TYPE OF FIRE: Wildland Fire
FIRE NAME: South Complex	OPERATIONAL PERIOD: 1800-0600, August 19-20, 2015
DATE ISSUED: August 19, 2015	TIME ISSUED: 1100
UNIT: Shasta-Trinity NF	SIGNED: /s/ Ken Larson, FBAN

INPUTS

WEATHER SUMMARY: ***See attached Fire Weather Forecast***

Discussion: An inversion will persist over the fire area tonight with very smoky conditions. Expect good RH recovery in the valleys, poor above the inversion.

Weather: Clear, smoke in the valleys.

Min Temp: 59 - 66° valleys, 51 - 56° ridges

Max RH: 25-35% ridgetop (Poor recovery); 84-92% valleys (Good recovery)

Winds (20 foot): Ridgetop: upslope 3-6 mph early, becoming NW 4-8 mph

Slope/Valley: upslope/upvalley 3-7 early becoming downslope/downvalley 2-4 mph late

FIRE BEHAVIOR

GENERAL

Fire behavior will be active through early evening as hot dry weather coupled with very dry fuels impact the fire area. If the inversion weakens or lifts fire behavior could increase substantially. Expect upslope spread with occasional runs through early evening. ERC for August 18 was 58.

SPECIFIC FIRE BEHAVIOR

Brush/previous burn areas: potential worst-case surface head fire spread will be 10-20 chains/hour with flame length 4 to 6 feet until early evening then moderate to 2-4 chains/hour, flame length 1-2 feet below the inversion. Backing fire rate of spread up to 2 chains/hour. Potential for short-duration crown runs in brush and live oak early. Maximum spotting distance ¼ mile decreasing to short range late. Probability of ignition will drop to 20-30% during the night. Above the inversion expect spread rates 4-8 chains/hour, flame length to 4 feet, probability of ignition 40-50%, and occasional torching through the night.

Timber fuel types: potential worst-case surface fire spread will be 4-6 chains/hour with flame length 3 to 5 feet, becoming 2-4 chains/hour maximum, flame length to 4 feet early evening. Backing fire rate of spread to 2 chains/hour. During the evening individual and group tree torching and short-duration crown runs could occur. Spotting distance ¼ mile decreasing to short range late. Probability of ignition will be 20-30% below inversion, 40-50% above.

Areas of Concern:

Division M: high temperatures and low RH will keep fire actively burning on the east side of South Fork Trinity River well into the night. Spotting over the river is the primary concern for these Divisions.

Divisions Y, Z: Fire has already become established at the top of Olsen Creek drainage and could move North toward Division Z or South toward the 3N05 Road. Most fire activity late evening will become backing/flanking fire with occasional torching.

AIR OPERATIONS

Air operations may be limited due to poor visibility caused by smoke.

Sunset: 20:05

Sunrise: 06:28

SAFETY

Pay attention to changes in weather during the early evening. Ensure someone is assigned to take weather observations on a regular basis and relay that information, as a minimum, to others on your assigned Division. Be especially aware of wind direction and speed and watch for possible lifting of the inversion.

Division/Group Assignment List (ICS 204 WF)

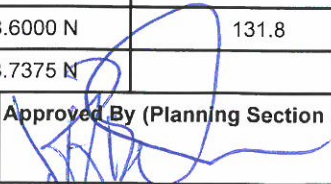
1. Incident Name:			3.			
SOUTH COMPLEX			Branch:		Division/Group: H / L / M 1 OF 2	
2. Operational Period: NIGHT						
Date/Time From: 08/19/2015 1800 WED		Date/Time To: 08/20/2015 0600 THU				
4. Operations Personnel						
OPERATIONS CHIEF		DAREN DALRYMPLE		DIVISION/GROUP SUPERVISOR		MARK JOHNSON
BRANCH DIRECTOR				AIR OPERATIONS BRANCH DIRECTOR		DENNIS KUSTER STACI DICKSON (T)
5. Resources Assigned this Period						
Strike Team / Task Force / Resource Designator		LWD	Leader	Number Persons	Drop Off PT./Time	Pick Up PT./Time
CREW S/T - T1 - 9474G C-78		08/28	ALICIA WHOPPY / ROBERT CASTILLO	31	DP 60/1900	DP 60/0600
CREW S/T - T1 - 9253G C-80		08/28	JESSE MCGUIRE	32	DP 60/1900	DP 60/0600
ENGINE S/T OES T1 2126A E-280		08/30	JEFF VELIQUETTE	22	DP 60/1900	DP 60/0600
ENGINE - T4 - GIST ENT. E-159		08/23	DONALD WOOD	3	DP 60/1900	DP 60/0600
ENGINE - T6 - HEATSEEKER 10 E-11		08/23	DEREK MESTROVICH	3	DP 60/1900	DP 60/0600
ENGINE - T6 -HEATSEEKER 11 E-10		08/23	DANIEL MEYER	3	DP 60/1900	DP 60/0600
ENGINE - T6 - IRON TRIANGLE 230 E-4		08/23	GUTHER VOLKER	3	DP 60/1900	DP 60/0600
ENGINE - T6 - SUNDANCE 4 E-5		08/23	MATTHEW BLESOE	3	DP 60/1900	DP 60/0600
DOZER - T2 - WLOWB BAR 717 24HR E-177		08/21		1	DP 60/1900	DP 60/0600
DOZER - T2 - WLOWB N. RIVERS 24HR E-209		08/26	MIKE NICHOLS	1	DP 60/1900	DP 60/0600
6. Control Operations/Work Assignments:						
<ul style="list-style-type: none"> Hold and mop-up existing control lines. Monitor fire as it backs down to river and prepare to take action. Be prepared to support other Divisions. 						
7. Special Instructions:						
<ul style="list-style-type: none"> Identify resources for IA. Resources need to utilize Water Use log sheet located in the IAP and turn into the Division at the end of the shift. 						
8. Division/Group Communication Summary						
Function	Channel	RX Frequency N/W	RX Tone/NAC	TX Frequency N/W	TX Tone/NAC	Mode
CMD NIFC C3	1	168.0750 N		170.4250 N	131.8	A
CMD NIFC C31	2	163.5750 N		169.7250 N	131.8	A
NIFC TAC 3	6	168.6000 N	131.8	168.6000 N	131.8	A
A/G CMD	10	168.7375 N		168.7375 N		A
9. Prepared By (Resource Unit Leader)			Approved By (Planning Section Chief)		Date	Time
ROBERTA LIM					08/19/2015	1200

Division/Group Assignment List (ICS 204 WF)

1. Incident Name:		3.	
SOUTH COMPLEX		Branch:	Division/Group:
2. Operational Period: NIGHT			
Date/Time From: 08/19/2015 1800	WED	Date/Time To: 08/20/2015 0600	THU

H / L / M 2 OF 2

4. Operations Personnel			
OPERATIONS CHIEF	DAREN DALRYMPLE	DIVISION/GROUP SUPERVISOR	MARK JOHNSON
BRANCH DIRECTOR		AIR OPERATIONS BRANCH DIRECTOR	DENNIS KUSTER STACI DICKSON (T)

5. Resources Assigned this Period					
Strike Team / Task Force / Resource Designator	LWD	Leader	Number Persons	Drop Off PT./Time	Pick Up PT./Time
WATER TENDER - T2 - PRO-DUMP 24HR E-31	08/23	GARY COATS	1	DP 60/1900	DP 60/0600
WATER TENDER - T2 - DARRAH 24HR E-37	08/23	RUSTY TRACY	1	DP 60/1900	DP 60/0600
WATER TENDER - T2 - DARRAH 24HR E-39	08/23	KEN HOVE	1	DP 60/1900	DP 60/0600
WATER TENDER - T2 - DARRAH 24HR E-35	08/23	ROB MILLER	1	DP 60/1900	DP 60/0600
WATER TENDER - T2 - DUDLEYS 24HR E-34	08/23	JEREMY HATHAWAY	1	DP 60/1900	DP 60/0600
TFLD 0-290	08/28	GREG ROSS	1	DP 60/1900	DP 60/0600
HEQB O-133	08/19	NEAL YOUNGBLOOD	1	DP 60/1900	DP 60/0600
HEQB (T) O-132	08/19	EAMON ENGBER	1	DP 60/1900	DP 60/0600
SOFR O-127	08/20	BRUCE MILLER	1	DP 60/1900	DP 60/0600
FEMP O-226	08/23	ERIC BENEDEK	1	DP 60/1900	DP 60/0600
FEMT O-223	08/23	MATTHEW LANCASTER	1	DP 60/1900	DP 60/0600

- 6. Control Operations/Work Assignments:**
- Hold and mop-up existing control lines.
 - Monitor fire as it backs down to river and prepare to take action.
 - Be prepared to support other Divisions.

- 7. Special Instructions:**
- Identify resources for IA.
 - Resources need to utilize Water Use log sheet located in the IAP and turn into the Division at the end of the shift.

8. Division/Group Communication Summary						
Function	Channel	RX Frequency N/W	RX Tone/NAC	TX Frequency N/W	TX Tone/NAC	Mode
CMD NIFC C3	1	168.0750 N		170.4250 N	131.8	A
CMD NIFC C31	2	163.5750 N		169.7250 N	131.8	A
NIFC TAC 3	6	168.6000 N	131.8	168.6000 N	131.8	A
A/G CMD	10	168.7375 N		168.7375 N		A

9. Prepared By (Resource Unit Leader)	Approved By (Planning Section Chief)	Date	Time
ROBERTA LIM		08/19/2015	1200

FINAL

Division/Group Assignment List (ICS 204 WF)

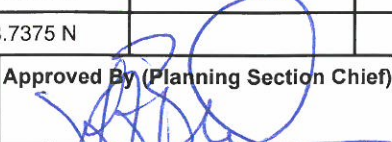
1. Incident Name:			3.			
SOUTH COMPLEX			Branch:		Division/Group: O / Q / S / T / Z 1 OF 2	
2. Operational Period: NIGHT						
Date/Time From: 08/19/2015 1800 WED		Date/Time To: 08/20/2015 0600 THU				
4. Operations Personnel						
OPERATIONS CHIEF		DAREN DALRYMPLE		DIVISION/GROUP SUPERVISOR		
				STEVE RAYMER; MICHAEL HOLMES TIM CORDERO (T)		
BRANCH DIRECTOR				AIR OPERATIONS BRANCH DIRECTOR		
				DENNIS KUSTER STACI DICKSON (T)		
5. Resources Assigned this Period						
Strike Team / Task Force / Resource Designator		LWD	Leader	Number Persons	Drop Off PT./Time	Pick Up PT./Time
ENGINE S/T - T3 - SHF 3675C E-271		08/28	MIKE ANDERSON	18	DP 66/1900	DP 66/0600
ENGINE - T4 - FIRESTORMERS - E-23		08/23	KEVIN CURFMAN	3	DP 66/1900	DP 66/0600
ENGINE - T4 - FIRESTORMERS - E-24		08/23	JAMES HARTER	3	DP 66/1900	DP 66/0600
ENGINE - T4 - J3 CONTRACTING E-19		08/23	REID BARNEY	3	DP 66/1900	DP 66/0600
ENGINE - T4 - BAKKEN - E-163		08/29	JILL BENTON	3	DP 66/1900	DP 66/0600
ENGINE - T6 - TRICO 50 E-1		08/24	ROY BEAL	3	DP 66/1900	DP 66/0600
ENGINE - T6 - RED TRUCK WILDFIRE E-12		08/24	ETHAN GODFREY	3	DP 66/1900	DP 66/0600
ENGINE - T6 - EAGLE CAP 2 E-20		08/23	JAKE MORTON	3	DP 66/1900	DP 66/0600
DOZER - T2 - TRINITY RIVER 24 HR E-166		08/22	LANDON THOMAS	1	DP 66/1900	DP 66/0600
6. Control Operations/Work Assignments:						
<ul style="list-style-type: none"> Hold and mop up existing control lines. Be prepared to support other divisions 						
7. Special Instructions:						
<ul style="list-style-type: none"> Identify resources for IA. Resources need to utilize Water Use log located in the IAP and turn into the Division at end of shift. 						
8. Division/Group Communication Summary						
Function	Channel	RX Frequency N/W	RX Tone/NAC	TX Frequency N/W	TX Tone/NAC	Mode
CMD NIFC C31	2	163.5750 N		169.7250 N	131.8	A
CMD NIFC C39	3	173.8750 N		163.6625 N	131.6	A
NIFC T1	4	168.0500 N	131.8	168.0500 N	131.8	A
A/G CMD	10	168.7375 N		168.7375 N		A
9. Prepared By (Resource Unit Leader)			Approved By (Planning Section Chief)		Date	Time
ROBERTA LIM					08/19/2015	1300

Division/Group Assignment List (ICS 204 WF)

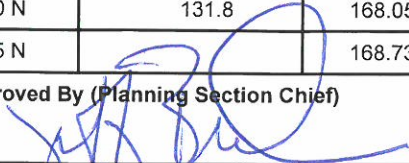
1. Incident Name:				3.			
SOUTH COMPLEX				Branch:		Division/Group: O / Q / S / T / Z 2 OF 2	
2. Operational Period: NIGHT							
Date/Time From: 08/19/2015 1800 WED		Date/Time To: 08/20/2015 0600 THU					
4. Operations Personnel							
OPERATIONS CHIEF		DAREN DALRYMPLE		DIVISION/GROUP SUPERVISOR		STEVE RAYMER; MICHAEL HOLMES TIM CORDERO (T)	
BRANCH DIRECTOR				AIR OPERATIONS BRANCH DIRECTOR		DENNIS KUSTER STACI DICKSON (T)	
5. Resources Assigned this Period							
Strike Team / Task Force / Resource Designator		LWD	Leader	Number Persons	Drop Off PT./Time	Pick Up PT./Time	
WATER TENDER - T2- WILLMORE 24 HR E-32		08/23	JOE MISHOE	2	DP 66/1900	DP 66/0600	
WATER TENDER - T2 - BUNN 24 HR E-205		08/24	KAYLA JOHNSON	1	DP 66/1900	DP 66/0600	
HEQB O-6		08/25	JOHN JASON GATES	1	DP 66/1900	DP 66/0600	
HEQB (T) O- 76		08/25	FREDRICK CUTHILL	1	DP 66/1900	DP 66/0600	
SOFR O-210		08/23	DAVID RAY	1	DP 66/1900	DP 66/0600	
FEMP S-5082		08/20	STAN BANGS	1	DP 66/1900	DP 66/0600	
FEMP S-5088		08/20	MIKE PALENTA	1	DP 66/1900	DP 66/0600	
6. Control Operations/Work Assignments:							
<ul style="list-style-type: none"> Hold and mop up existing control lines. Be prepared to support other divisions 							
7. Special Instructions:							
<ul style="list-style-type: none"> Identify resources for IA. Resources need to utilize Water Use log located in the IAP and turn into the Division at end of shift. 							
8. Division/Group Communication Summary							
Function	Channel	RX Frequency N/W	RX Tone/NAC	TX Frequency N/W	TX Tone/NAC	Mode	
CMD NIFC C31	2	163.5750 N		169.7250 N	131.8	A	
CMD NIFC C39	3	173.8750 N		163.6625 N	131.6	A	
NIFC TAC 1	4	168.0500 N	131.8	168.0500 N	131.8	A	
A/G CMD	10	168.7375 N		168.7375 N		A	
9. Prepared By (Resource Unit Leader)			Approved By (Planning Section Chief)			Date	
ROBERTA LIM						08/19/2015	
						Time	
						1300	

Division/Group Assignment List (ICS 204 WF)

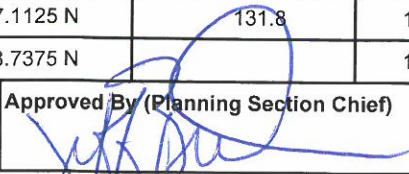
1. Incident Name:			3.			
SOUTH COMPLEX			Branch:		Division/Group: W / X / Y 1 OF 2	
2. Operational Period: NIGHT						
Date/Time From: 08/19/2015 1800 WED		Date/Time To: 08/20/2015 0600 THU				
4. Operations Personnel						
OPERATIONS CHIEF		DAREN DALRYMPLE		DIVISION/GROUP SUPERVISOR		
				DEBBIE MAYER		
BRANCH DIRECTOR				AIR OPERATIONS BRANCH DIRECTOR		
				DENNIS KUSTER STACI DICKSON (T)		
5. Resources Assigned this Period						
Strike Team / Task Force / Resource Designator		LWD	Leader	Number Persons	Drop Off PT./Time	Pick Up PT./Time
ENGINE S/T - T3 - 2350C E-281		08/26	DAN SCHINDLER	21	DP 19/1900	DP 19/0600
ENGINE - T4 - STERLING 2 E-156		08/23	BRIAN MOORE	3	DP 19/1900	DP 19/0600
ENGINE - T4 - R&R 17 E-154		08/29	MIKE COX; DEREK ANDERSON (T)	3	DP 19/1900	DP 19/0600
ENGINE - T4 - SUNDANCE FIRE E-22		08/23	PHIL RIFENBERY	3	DP 19/1900	DP 19/0600
SKDGM - T1 - WLOWB SOFT TRACK 24HR E-265		08/28	RON STREET	1	DP 19/1900	DP 19/0600
SKDGM - T1 - WLOWB SOFT TRACK 24HR E-266		08/28	BEN MILLER	1	DP 19/1900	DP 19/0600
SOFTTRACK - T1 - SOFT TRACK ATTACK E-191		08/24	CODY HUTCHINGS	2	DP 19/1900	DP 19/0600
DOZER - T2 - WLOWB HAYS EQUIP E-170		08/24	CHARLIE CIGANOVICH	1	DP 19/1900	DP 19/0600
WATER TENDER - T2 - DARRAH LOGGING E-36		08/23	DAVE KALDNDART	2	DP 19/1900	DP 19/0600
WATER TENDER - T2 - BROWN PLUMBING E-33		08/23	CHUCK HAPTONSTALL	2	DP 19/1900	DP 19/0600
6. Control Operations/Work Assignments:						
<ul style="list-style-type: none"> • Continue line prep out of Bar 717 to Division break. • Be prepared to support other Divisions. 						
7. Special Instructions:						
<ul style="list-style-type: none"> • Identify resources for IA. • Resources need to utilize the Water Use log and turn into the Division at the end of shift. 						
8. Division/Group Communication Summary						
Function	Channel	RX Frequency N/W	RX Tone/NAC	TX Frequency N/W	TX Tone/NAC	Mode
CMD NIFC C3	1	168.0750 N		170.4250 N	131.8	A
CMD NIFC C31	2	163.5750 N		169.7250 N	131.8	A
R5 TAC 5	8	167.1125 N	131.8	167.1125 N	131.8	A
A/G CMD	10	168.7375 N		168.7375 N		A
9. Prepared By (Resource Unit Leader)			Approved By (Planning Section Chief)		Date	Time
ROBERTA LIM					08/19/2015	1000

Division/Group Assignment List (ICS 204 WF)

1. Incident Name:		3.	
SOUTH COMPLEX		Branch:	Division/Group: W / X / Y 2 OF 2
2. Operational Period: NIGHT			
Date/Time From: 08/19/2015 1800 WED	Date/Time To: 08/20/2015 0600 THU		

4. Operations Personnel			
OPERATIONS CHIEF	DAREN DALRYMPLE	DIVISION/GROUP SUPERVISOR	DEBBIE MAYER
BRANCH DIRECTOR		AIR OPERATIONS BRANCH DIRECTOR	DENNIS KUSTER STACI DICKSON (T)

5. Resources Assigned this Period					
Strike Team / Task Force / Resource Designator	LWD	Leader	Number Persons	Drop Off PT./Time	Pick Up PT./Time
WATER TENDER - HARVEY E-42	08/23	KIMBER BAKER	1	DP 19/1900	DP 19/0600
MAST - T1 - WLOWB BORDGE'S 24HR E-253	08/26	DENNIS TURPIN	1	DP 19/1900	DP 19/0600
HEQB O-222	08/21	ERICK MATTSON	1	DP 19/1900	DP 19/0600
FEMP S-5081	08/20	JILL HEMPELMAN	1	DP 19/1900	DP 19/0600
FEMT S-5494	08/31	CODY CELINSKY	1	DP 19/1900	DP 19/0600

6. Control Operations/Work Assignments:

- Continue line prep out of Bar 717 to Division break.
- Be prepared to support other Divisions.

7. Special Instructions:

- Identify resources for IA.
- Resources need to utilize the Water Use log and turn into the Division at the end of shift.

8. Division/Group Communication Summary						
Function	Channel	RX Frequency N/W	RX Tone/NAC	TX Frequency N/W	TX Tone/NAC	Mode
CMD NIFC C3	1	168.0750 N		170.4250 N	131.8	A
CMD NIFC C31	2	163.5750 N		169.7250 N	131.8	A
R5 TAC 5	8	167.1125 N	131.8	167.1125 N	131.8	A
A/G CMD	10	168.7375 N		168.7375 N		A

9. Prepared By (Resource Unit Leader) ROBERTA LIM	Approved By (Planning Section Chief) 	Date 08/19/2015	Time 1000
---	---	---------------------------	---------------------

Division/Group Assignment List (ICS 204 WF)

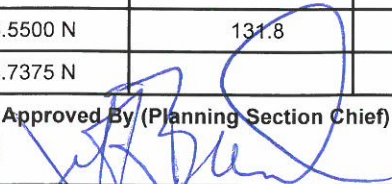
1. Incident Name:				3.			
SOUTH COMPLEX				Branch:		Division/Group: STRUCTURE	
2. Operational Period: NIGHT							
Date/Time From: 08/19/2015 1800 WED		Date/Time To: 08/20/2015 0600 THU					
4. Operations Personnel							
OPERATIONS CHIEF				DIVISION/GROUP SUPERVISOR		UNSTAFFED	
BRANCH DIRECTOR				AIR ATTACK SUPERVISOR			
5. Resources Assigned this Period							
Strike Team / Task Force / Resource Designator			LWD	Leader	Number Persons	Drop Off PT./Time	Pick Up PT./Time
UNSTAFFED							
6. Control Operations/Work Assignments:							
7. Special Instructions:							
8. Division/Group Communication Summary							
Function	Channel	RX Frequency N/W	RX Tone/NAC	TX Frequency N/W	TX Tone/NAC	Mode	
CMD NIFC C3	1	168.0750 N		170.4250 N	131.8	A	
CMD NIFC C31	2	163.5750 N		169.7250 N	131.8	A	
R5 TAC 4	7	166.5500 N	131.8	166.5500 N	131.8	A	
A/G CMD	10	168.7375 N		168.7375 N		A	
9. Prepared By (Resource Unit Leader)				Approved By (Planning Section Chief)		Date	Time
ROBERTA LIM						08/19/2015	1000

INCIDENT RISK ANALYSIS

SOUTH COMPLEX CA-SHF-002108

(ICS 215A) Night

DIV	HAZARDOUS ACTIONS / CONDITIONS	MITIGATIONS / WARNINGS / REMEDIES
ALL	DANGER TREES	<ul style="list-style-type: none"> Follow "Hazard Tree Safety" guidelines, IRPG pages 22. Post lookouts, or use a spotter in mop-up areas with personnel. Don't park vehicles or take breaks in high concentrations of hazard trees. Establish trigger points for disengagement during high wind events".
ALL	TRAFFIC & DRIVING	<ul style="list-style-type: none"> Practice "Defensive Driving" techniques. Use spotters when backing. Always use headlights. Use warning lights when working on roads or traveling in smoke. Observe posted speed limits. Use chock blocks, turn wheels into hill. Many roads are narrow and mid slope, use caution.
ALL	STRUCTURE PROTECTION	<ul style="list-style-type: none"> Review Structure Protection; IRPG pages 12-16. Do not commit to stay on a structure unless the area around the structure represents an adequate safety zone. Set trigger points to disengage and allow adequate time to relocate to primary and secondary safety zones.
ALL	STEEP TERRAIN & ROLLING DEBRIS	<ul style="list-style-type: none"> Maintain 8'-10' spacing when working & walking. Don't work above any personnel. Evaluate necessity to send personnel in areas with limited access.
ALL	ENVIRONMENTAL HAZARDS	<ul style="list-style-type: none"> Keep alert for wildlife, rattlesnakes, insects, and plants. Watch footing and hand placement around rocks. Personal hygiene is #1 when it comes to Poison Oak Prevention.
ALL	AIR OPERATIONS	<ul style="list-style-type: none"> Follow " Aviation Watch-Out Situations" on page 44, IRPG Refer to page 57, IRPG for directing bucket drops. Ensure positive communication with all air resources.
ALL	HEAT RELATED ILLNESS (HRI) & DEHYDRATION	<ul style="list-style-type: none"> Drink 2 to 1 water to sports drinks. Take Frequent breaks, minimum of 10 minutes every hour. Recognize symptoms of HEAT RELATED ILLNESS which include Lack of energy, Headaches, dizziness, lack of rest, no hunger, poor eating habits, hot skin, and lack of sweating
ALL	SPOT FIRES	<ul style="list-style-type: none"> Size up prior to engagement. Watch for multiple spots. Ensure LCES is in place. Maintain Situational Awareness at all times.
ALL	MOP UP	<ul style="list-style-type: none"> Conduct thorough briefing for all personnel (inside rear cover IRPG). Use all required PPE, including eye protection. Maintain proper spacing and overhead clearance. Be alert for stump holes and root cavities. Minimize exposure to smoke, and rotate personnel into clean air when practical. Evaluate unburned islands/Increase situational awareness.
DIV O,Q,S, T,S,Y, Z	HEAVY EQUIPMENT OPERATIONS	<ul style="list-style-type: none"> Ensure communications are established with operators. Use hand signals if other communications are unavailable. Maintain a 50'-100' exclusion area around equipment. Use a spotter when backing. Maintain 200' clearance around masticator operations.
DIV T, Y	INDIRECT LINE CONSTRUCTION	<ul style="list-style-type: none"> Establish and maintain LCES. Locate line in favorable location, lighter fuels and gentler topography if possible. Utilize natural or existing barriers. If possible burn out or backfire as line construction progresses.
ALL	MARIJUANA PLANTATIONS	<ul style="list-style-type: none"> Be aware of evidence that cultivation has occurred in the area. If you stumble upon an area with probable cultivation be extremely cautious, exit on the same route you arrived and notify supervisor immediately.
DIV L,M,S, Z	HIGH VOLTAGE POWER LINES	<ul style="list-style-type: none"> Smoke can conduct electricity; stay 150' clear of lines / towers in heavy smoke. Do not operate heavy equipment under power lines Watch for fallen power lines, stay 200' away, notify your supervisor Follow power line safety guide in the IRPG page 24
INCIDENT NAME: South Complex ICS 215a		DATE PREPARED: <p style="text-align: center;">August 19, 2015</p> TIME PREPARED: 1000 HOURS
		OPERATIONAL PERIOD Night Shift 08/19-20/15 1800-0600 Prepared by S. Davis T. OConnell

Lookouts
Communications
Escape Routes
Safety Zones

South Complex

Operation Period: 08/19-20/2015 Night Shift

SAFETY MESSAGE

Safety Zones in the Timber

- Identifying effective safety zones in the timber fuel models can be difficult.
- Natural Safety Zones (large areas void of fuel) are generally the only option under worst-case scenario conditions.
- Previously burned areas often have re-burn potential, and can also be impacted by convective heat, and seldom have space for vehicles.
- Setting conservative decision points, withdrawing from the area placing time and space between you and the fire is often the best option.

MAJOR HAZARDS AND RISKS

STEEP TERRAIN FATIGUE SPOT FIRES	ROLLING MATERIAL DEHYDRATION BUCKET DROPS	HEAVY EQUIPMENT HAZARD TREES POISON OAK
--	---	---

Be sure all elements of your safety plan are in place prior to engagement

Cumulative Fatigue

Maintaining peak performance requires that you take good care of your body.

Get the appropriate amount of rest. Manage your off time to get as much sleep as possible.

Proper Nutrition and hydration is critical to managing fatigue.

Planning for Medical Emergencies

Ask and be able to answer these 3 questions

1. What are we going to do if someone gets hurt?
2. How will we get them out of here?
3. How long will it take to get them to a hospital?

All operational activities should be based on answers to these questions. See page 2 of the IRPG for more information.

MEDICAL PLAN	1. INCIDENT NAME South Complex	2. DATE PREPARED 08/19/15	3. TIME PREPARED 2000	4. OPERATIONAL PERIOD 08/19/15 1800 to 08/20/15 0600				
MEDICAL AID STATIONS		LOCATION			PARAMEDICS			
					YES	NO		
Medical Unit		ICP			XX			
Frontline Medical Unit		ICP			XX			
FEMP Benedek and FEMT Lancaster		Division "H/L/M":			XX			
FEMP Bangs and FEMT Planeta		Division "O/Q/S/T/Z"			XX			
FEMP Hempleman and FEMT Colenske		Division "W/X/Y"			XX			
6. TRANSPORTATION								
A. AIR RESOURCES								
NAME		LOCATION		PHONE	PARAMEDICS			
					YES	NO		
REACH Air Ambulance		Redding, Ca.		530-226-2400	XX			
Mercy Air PHI		Redding, Ca.		530-226-2400	XX			
C.H.P				530-226-2400	XX			
Cal Fire				530-226-2400			XX	
Air National Guard		Redding, Ca.		530-226-2400			XX	
B. INCIDENT AMBULANCES								
NAME		LOCATION			PARAMEDICS			
					YES	NO		
American Medical Response		AMR 230 and AMR 280 Base Camp			XX			
Trinity County Ambulance		Hayfork, Ca.			XX			
7. HOSPITALS								
NAME	ADDRESS	TRAVEL TIME		PHONE	HELIPAD		BURN CENTER	
		AIR	GRND		YES	NO	YES	NO
Trinity Hospital	60 Easter Ave. Weaverville, Ca.	15 Min	1 Hour 45 Min.	530-623-5541 EXT 1	XX			XX
Shasta Regional Medical Center Level 3 Trauma Center	1100 Butte Redding, Ca.	35 Min	2.5 Hours	530-244-5353 530-244-5350	XX			XX
Mercy Medical Center Level 2 Trauma Center	2175 Rosaline Ave. Redding, Ca.	35 Min	2.5 Hours	530-225-7201	XX			XX
U.C. Davis Medical Center Level 1 Trauma Center	2315 Stockton Blvd. Sacramento, Ca	1 Hour	6 Hours	916-734-3790 ER 916-734-3636	XX			XX
8. MEDICAL EMERGENCY PROCEDURES								
IN-CAMP CARE				LINE EMERGENCIES				
<ul style="list-style-type: none"> Minor Injuries or illnesses <ul style="list-style-type: none"> Seek Aid directly at the Frontline Medical Unit, report all injuries or illnesses to supervisor Unit Open 0600 hrs to 2200 hrs Moderate to Severe Injuries or Illnesses <ul style="list-style-type: none"> Contact Communications directly Med Unit staffed after hours for Emergencies 				<ul style="list-style-type: none"> Start of shift: notify your Div Sup of EMT's/Paramedic's and Medical gear carried by crew Crew Supervisor contacts Division with Nature of Emergency. <ul style="list-style-type: none"> Division Supervisor contact's Communications and declare a medical emergency on command Closest DIVS or designee responds to incident <ul style="list-style-type: none"> Closest SOFR/EMT's respond to assist w/care Use attached Injury or Incident Comm. Protocol If ambulance (ground or air) delayed designate rendezvous site and move towards it Secure scene for investigation—keep a log 				
ICS 206 8-78	9. PREPARED BY (MEDICAL UNIT LEADER) Patrick Young MEDL 8/19/2015			10. REVIEWED BY (SAFETY OFFICER) Steve Davis SOF-2 8/19/2015				

INCIDENT RADIO COMMUNICATIONS PLAN (ICS 205)

1. Incident Name:		2. Date/Time Prepared:		3. Operational Period:						
SOUTH COMPLEX		Date: 08/19/2015 Time: 1019	Date/Time From: 08/19/2015 1800	Date/Time To: 08/20/2015 0600	NIGHT WED THU					
4. Basic Radio Channel Use:										
Zone Group	Ch #	Function	Channel Name/Trunked Radio System Talkgroup	Assignment	RX Freq	RX Tone/NAC	TX Freq	TX Tone/NAC	Mode (A, D, or M)	Remarks
15	1	CMD NIFC C3	NIFC C3	CMD	168.0750 N		170.4250 N	131.8	A	TONE 3 (131.8) LIMEDYKE MTN LINK TO C31, C39
15	2	CMD NIFC C31	NIFC C 31	CMD ALT	163.5750 N		169.7250 N	131.8	A	TONE 3 (131.8) IRONSIDE MTN LINK TO C3, C39
15	3	CMD NIFC C39	NIFC C39	CMD ALT	173.8750 N		163.6625 N	131.6	A	HAYFORK BALLY L.O. LINK TO C3, C31.
15	4	NIFC TAC 1	NIFC TAC 1	DIV O / Q / S / T / Z	168.0500 N	131.8	168.0500 N	131.8	A	TONE 3 (131.8)
15	5	NIFC TAC 2	NIFC TAC 2	I / A	168.2000 N		168.2000 N		A	
15	6	NIFC TAC 3	NIFC TAC 3	DIV'S H / L / M	168.6000 N	131.8	168.6000 N	131.8	A	TONE 3 (131.8)
15	7	R5 TAC 4	R5 TAC 4	DIV STR GRP	166.5500 N	131.8	166.5500 N	131.8	A	TONE 3 (131.8)
15	8	R5 TAC 5	R5 TAC 5	DIV W / X / Y	167.1125 N	131.8	167.1125 N	131.8	A	TONE 3 (131.8)
15	9	R5 TAC 6	R5 TAC 6	CONT GRP	168.2375 N	131.8	168.2375 N	131.8	A	TONE 3 (131.8)
15	10	A/G CMD	A / G CMD	ALL DIVS	168.7375 N		168.7375 N		A	A / G CMD FOR ALL DIVS
15	11	A/G TAC	A / G TAC	ALL DIVS	167.5750 N		167.5750 N		A	A / G TAC FOR ALL DIVS
15	12	VTAC 11	VTAC 11	ROUTE FIRE	151.1375 N		151.1375 N	156.7	A	TONE 156.7 (TONE 6) SHARED FREQ WITH ROUTE COMPLEX
15	13	CMD NIFC C37	NIFC C37	ALT CMD	172.5500 N		162.7750 N	156.7	A	ROUTE CMD C37 LINK TO C6, C9
15	14	CMD SHF TN12	SHF RPT TN12		171.5750 N		169.1000 N	127.3	A	TONE 12 (127.3) LOCAL FOREST NET
15	15	CALCORD	CALCORD	ALL DIVS MED	156.0750 N	156.7	156.0750 N	156.7	A	TONE 6(156.7) MEDICAL ALL DIVS
15	16	AIR GUARD	AIR GUARD	EMERGENCY	168.6250 N		168.6250 N	110.9	A	TONE 1 (110.9) EMERGENCY
5. Special Instructions:										
Road Group will use the Tactical that is assigned to the division they are working in.										
6. Prepared By		Name:		Signature:						
(Communications Unit Leader)		DON STONER								
ICS 205		IAP Page		Date/Time: 08/19/2015 1019						

FINAL

TRAINING SPECIALIST MESSAGE

If Dmobing on or before Thursday August 20th, you must close out with the South Complex Training Specialists no later 20:00 hrs. on Thursday evening.

-After That-

All South Complex training records will be moved to ICP in Hayfork and all "open" training assignments will be closed out there.

Plan Ahead!

Brad Smith - TNSP
Sean Wolf - TNSP(t)

INCIDENT TRAINEE REGISTRATION FORM

Complete **ALL** fields and return to Training Specialist or DROP BOX for entry into database.

Remember to close out training packets with the Training Specialist before DEMOB.

TRAINEE's DATA

Name (PRINT): _____ ICS Trainee Position: _____

Request # (A,C,E,or O): _____ Agency Designator (Ex. CA-MNF): _____

USFS___ State___ BLM___ BIA___ NPS___ FWS___ Local Govt. ___ DOD___ NWS___

____ R-5 Priority Trainee R-8 Priority Trainee _____ FS-FPM Trainee _____ IFPM Trainee _____ Ordered as Trainee? Y N

Date Assigned: _____ Cell Phone: _____

TRAINING RECORDS TO BE MAILED TO: (Chief, Training Officer, ect)

Name: _____ Title: _____

Name of Home Unit: _____

Address: _____

City: _____ State: _____ Zip Code: _____ Phone: _____

TRAINEE PREREQUISITES

1. Valid Red Card or agency certification card? _____ Yes _____ No

2. Trainee has current position task book issued by home unit? _____ Yes _____ No

Current Task Book Progress: _____ 0% _____ 25% _____ 50% _____ 75% _____ 90%

Priority Open Tasks in PTB (You Want to Accomplish On This Incident) _____

TRAINER/EVALUATOR DATA

Trainer/Evaluator Name: _____ ICS position on fire _____

Home Unit: _____ Agency Designator(ex. CA-MNF): _____

Work Address: _____ City: _____

State: _____ Zip Code: _____ Cell Phone: _____

1. Check-in, Demob, Documentation
2. Training Specialist, Safety
3. Equip Time, Comp/Claim
4. Persn Time, COST
5. Clerical
6. GIS
7. Faultline Mod
8. ISI Communications
9. READ
10. OPS, Air OPS, PSC, RES, SIT, IMET, FBAN
11. Satellite
12. COMO/MED
13. ROUTE Fire
14. Info
15. FACIL/FOOD
16. IC
17. Meeting Tent
18. Logs/Ordering

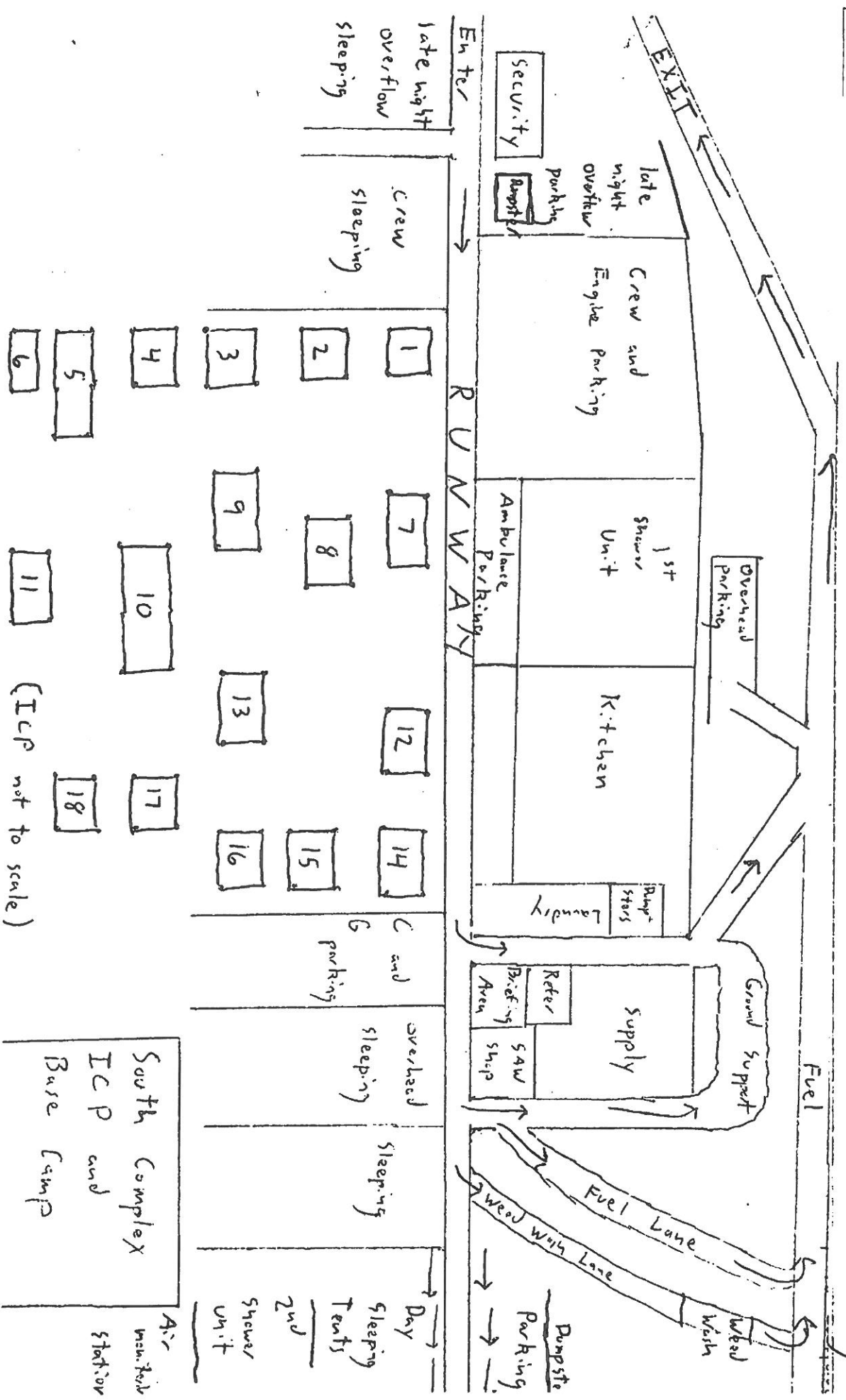

(ICP not to scale)

MEDICAL INCIDENT REPORT

FOR ALL MEDICAL EMERGENCIES: IDENTIFY ON SCENE INCIDENT COMMANDER BY NAME AND POSITION AND ANNOUNCE "MEDICAL EMERGENCY" TO INITIATE RESPONSE FROM IMT COMMUNICATIONS/DISPATCH.

Use items one through nine to communicate situation to communications/dispatch.

1. CONTACT COMMUNICATIONS/DISPATCH

Ex: "Communications, Div. Alpha. Stand-by for Priority Medical Incident Report." (If life threatening request designated frequency be cleared for emergency traffic.)

2. INCIDENT STATUS: Provide incident summary and command structure.

Nature of Injury/Illness		<i>Describe the injury (Ex: Broken leg with bleeding)</i>
Incident Name		<i>Geographic Name + "Medical" (Ex: Trout Meadow Medical)</i>
Incident Commander		<i>Name of IC</i>
Patient Care		<i>Name of Care Provider (Ex: EMT Smith)</i>

3. INITIAL PATIENT ASSESSMENT: Complete this section for each patient. This is only a brief, initial assessment. Provide additional patient info after completing this 9 Line Report.

Number of Patients:	Male / Female	Age:.	Weight:.
Conscious? <input type="checkbox"/> YES <input type="checkbox"/> NO = MEDEVAC!			
Breathing? <input type="checkbox"/> YES <input type="checkbox"/> NO = MEDEVAC!			
Mechanism of Injury: <i>What caused the injury?</i>			
Lat/Long (Datum WGS84) <i>Ex: N 40° 42.45' x W 123° 03.24'</i>			

4. SEVERITY OF EMERGENCY, TRANSPORT PRIORITY

SEVERITY	TRANSPORT PRIORITY
<input type="checkbox"/> URGENT-RED Life threatening injury or illness. <i>Ex: Unconscious, difficulty breathing, bleeding severely, 2° – 3° burns more than 4 palm sizes, heat stroke, disoriented.</i>	Ambulance or MEDEVAC helicopter. Evacuation need is IMMEDIATE.
<input type="checkbox"/> PRIORITY-YELLOW Serious Injury or illness. <i>Ex: Significant trauma, not able to walk, 2° – 3° burns not more than 1-2 palm sizes.</i>	Ambulance or consider air transport if at remote location. Evacuation may be DELAYED.
<input type="checkbox"/> ROUTINE-GREEN Not a life threatening injury or illness. <i>Ex: Sprains, strains, minor heat-related illness.</i>	Non-Emergency. Evacuation considered Routine of Convenience.

5. TRANSPORT PLAN:

Air Transport: (Agency Aircraft Preferred)

Helispot Short-haul/Hoist Life Flight Other

Ground Transport:

Self-Extract Carry-Out Ambulance Other

6. ADDITIONAL RESOURCE/EQUIPMENT NEEDS:

<input type="checkbox"/> Paramedic/EMT(s)	<input type="checkbox"/> Crew(s)	<input type="checkbox"/> SKED/Backboard/C-Collar
<input type="checkbox"/> Burn Sheet(s)	<input type="checkbox"/> Oxygen	<input type="checkbox"/> Trauma Bag
<input type="checkbox"/> Medication(s)	<input type="checkbox"/> IV/Fluid(s)	<input type="checkbox"/> Cardiac Monitor/AED
<input type="checkbox"/> Other (i.e. splints, rope rescue, wheeled litter)		

8. EVACUATION LOCATION:

Lat/Long (Datum WGS84)
EX: N 40 42.45' x W 123 03.24'

Patient's ETA to Evacuation Location:

Helispot/Extraction Size and Hazards:

9. CONTINGENCY: