

CORRECTED

GASQUET

COMPLEX

INCIDENT ACTION PLAN

OPERATIONAL PERIOD

AUG 12 - AUG 13, 2015

0600-0600



"Adapt...Improvise...and Overcome"



CA-SRF-001488

P5J0PQ (0510)

NAD 83
dd^o m.mm'

INCIDENT OBJECTIVES (ICS 202)

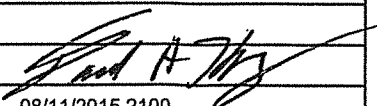
1. Incident Name:		2. Operational Period: 0600 - 0600	
GASQUET COMPLEX		Date/Time From: 08/12/2015 0600 WED	Date/Time To: 08/13/2015 0600 THU
3. Objective(s):			
<p>STRATEGIC FRAMEWORK: THE FRAMEWORK FOR THE GASQUET COMPLEX STRATEGIC PLAN CONSISTS OF USING A COMBINATION OF DIRECT ATTACK WHERE FEASIBLE, OTHERWISE INDIRECT USING NATURAL BARRIERS. A KEY ELEMENT IS FLEXIBILITY AND THE ABILITY TO APPLY THE RIGHT RESOURCE TO THE RIGHT TASK AT THE RIGHT TIME. FIRELINE WILL BE CONSTRUCTED ONLY WHERE FEASIBLE AND SAFE TO DO SO.</p> <p>LEADERS INTENT: PROVIDE THE HIGHEST LEVEL OF CUSTOMER SERVICES TO ALL INVOLVED WITH OR IMPACTED BY THE GASQUET COMPLEX. ALL INCIDENT PERSONNEL SHOULD BE PREPARED TO TAKE THE APPROPRIATE ACTIONS REGARDING:</p> <ul style="list-style-type: none"> • PERSONAL INTERACTIONS BOTH INSIDE AND OUTSIDE THE INCIDENT MANAGEMENT ORGANIZATION. • PERSONAL SAFETY AND THE SAFETY OF OTHERS. • AN INCIDENT-WITHIN-AN-INCIDENT. <p>OBJECTIVES:</p> <ul style="list-style-type: none"> • PROVIDE FOR FIREFIGHTER AND PUBLIC SAFETY BY ENSURING L C E S IS EVALUATED USING SOUND RISK MANAGMENT PRINCIPLES. • MAINTAIN AND BUILD COOPERATOR AND STAKEHOLDER RELATIONSHIPS. • SUPPRESS FIRES WHILE NOT EXPOSING FIREFIGHTERS OR AIRCRAFT TO UNNECESSARY RISKS. • IDENTIFY AND PROTECT NATIVE AMERICAN TRADITIONAL AREAS AND OTHER SENSITIVE CULTURAL AND HISTORIC SITES. 			
4. Operational Period Command Emphasis:			
UTILIZE SUPPRESSION STRATEGIES COMMENSURATE WITH VALUES AT RISK. IMPLEMENT TACTICS WHICH INCREASE THE PROBABILITIES OF SUCCESS WHILE HOLDING EXISTING CONTAINMENT.			
General Situational Awareness:			
USE EMERGENCY LIGHTING AS NEEDED, ESPECIALLY WHEN WORKING ALONG PUBLIC ROADWAYS. DRIVE CAREFULLY THROUGH DOWNTOWN GASQUET.			
5. Site Safety Plan Required? Yes <input type="checkbox"/> No <input checked="" type="checkbox"/>			
Approved Site Safety Plan(s) Located at:			
6. Incident Action Plan (the items checked below are included in this Incident Action Plan):			
<input checked="" type="checkbox"/> ICS 202	<input type="checkbox"/> ICS 207	Other Attachments:	
<input checked="" type="checkbox"/> ICS 203	<input type="checkbox"/> ICS 208	<input checked="" type="checkbox"/> SAFETY / 215A	
<input checked="" type="checkbox"/> ICS 204	<input checked="" type="checkbox"/> ICS 220	<input checked="" type="checkbox"/> INCIDENT WITHIN AN INCIDENT	
<input checked="" type="checkbox"/> ICS 205	<input checked="" type="checkbox"/> Map/Chart	<input checked="" type="checkbox"/> TRAINING MESSAGE	
<input type="checkbox"/> ICS 205A	<input checked="" type="checkbox"/> Weather Forecast/Tides/Currents	<input checked="" type="checkbox"/> HR MESSAGE	
<input checked="" type="checkbox"/> ICS 206			
7. Prepared by: DAVE LATTIMORE Position/Title: PSC2		Signature: _____	
8. Approved by Incident Commander:		Signature: 	
ICS 202 IAP Page		Date/Time: 08/11/2015 2100	

FIRE BEHAVIOR FORECAST

FORECAST NUMBER: #9	TYPE OF FIRE: Wildland Fire
FIRE NAME: Gasquet Complex	OPERATIONAL PERIOD: August 12, 2015
DATE ISSUED: August 11, 2015	TIME ISSUED: 2000
UNIT: Smith River NRA, Six Rivers NF	SIGNED: <i>Byron R Kimball</i>
	Typed/printed:/s/ Byron R. Kimball FBAN

INPUTS

WEATHER SUMMARY: Off shore low pressure ridge will be south of the area, only result being partly cloudy skies. Temperature and Relative Humidity will remain near normal, with light winds across the area.

MAX TEMPERATURE.....High 60's to Low 70's.

MIN HUMIDITY.....35 - 45%

EYE LEVEL WINDS.....Light and Variable early, Becoming west to southwest 3 to 5 along the ridges in the afternoon.

For more specific information, please see the Spot Weather forecast

OUTPUTS

FIRE BEHAVIOR

GENERAL:

Lower humidities and less cloud cover may lead to more activity. RH below 40% has proven to be a trigger for more energetic burning. Light winds will help dry out the lighter fuels, but fires will be terrain driven if runs get going. Increased air movement may be enough to bring supposedly dead areas back to life. Be sure to keep eyes on all unlined sections of the line.

With line construction in incomplete burns, be positive that you are exposing the black edge and getting all the hot ash and embers inside your line.

SPECIFIC:

Timber Understory: Fire behavior in the Understory models may increase. Drier RH and increased solar heating may increase overall general activity.

ROS: 5 to 10 ch/hr.

FL: 6 to 8 ft.

Timber Litter: Timber Litter fire behavior should be more active. More sunlight coupled with lower RH may lead to more complete consumption with an associated increase in intensity. Stay aware of rollout and upslope runs through incomplete burns.

ROS: 3 to 6 ch/hr.

FL: 2 to 3 ft.

Rollout of heavier fuels continues to present a concern as the fires work into the drainages. Be prepared for a slope reversal run if fire establishes with sufficient heat.

AIR OPERATIONS:

Inversion above 6000 ft all day. May be able to work underneath the inversion but visibility will remain limited.

SAFETY

Be aware of fire in the standing timber and instability of trees and snags. Ash pits and stump holes become more of an issue the longer the fire burns in the fuel bed.

Division/Group Assignment List (ICS 204 WF)

1. Incident Name:			3.			
GASQUET COMPLEX			Branch:		Division/Group:	
2. Operational Period: 0600 - 0600			A - COON FIRE			
Date/Time From: 08/12/2015 0600 WED		Date/Time To: 08/13/2015 0600 THU				
4. Operations Personnel						
OPERATIONS CHIEF		NICKIE WASHINGTON DARRELL MILLER		DIVISION/GROUP SUPERVISOR		MITCH FOWLKES DAN O'CONNOR (T)
PLANNING OPS		MATT CONKLIN AARON THOMPSON (T)		AIR ATTACK SUPERVISOR		CLIFF CLARIDGE KEN MCLAUGHLIN
5. Resources Assigned this Period						
Strike Team / Task Force / Resource Designator		LWD	Leader	Number Persons	Drop Off PT./Time	Pick Up PT./Time
HC2 STEELHEAD C-30		08/15	ALEJANDRO RODRIGUEZ	20	ICP/0630	ICP/1900
HCM HOOPA O-275		08/24	ROCKY COLEGROVE	12	ICP/0630	ICP/1900
TFLD VIKTORA / WHEELER (T)		08/18		2	ICP/0630	ICP/1900
TFLD PHILLIPS O-75 / KEYSE (T) O-78		08/18		2	ICP/0630	ICP/1900
ENG3 LKP 5031 E-75		08/14	RICK BERGEN	3	ICP/0630	ICP/1900
ENG3 SRM 331 E-76		08/14	MIKE AVERY	4	ICP/0630	ICP/1900
ENG3 CRK 379 E-77		08/14	JOHN ANGELL	4	ICP/0630	ICP/1900
ENG6 ALBANY 2180 E-79		08/21	TIM SMYSER	3	ICP/0630	ICP/1900
HEQB HEISEY O-84 / DOZZ ROEN 9481 E-90		08/20		2	ICP/0630	ICP/1900
HEQB LANTERMAN O-83 / DOZZ FISK'S E-91		08/21		2	ICP/0630	ICP/1900
HEQB TERRY CARRICO O-217		08/24		1	ICP/0630	ICP/1900
SKG4 L & L EXCAVATING W/ TRSPT E-111		08/23	SHANE NODINE	2	ICP/0630	ICP/1900
SKG3 UNDERHILL 1 W/ TRSPT E-112		08/22	JOE BRADBURY	2	ICP/0630	ICP/1900
FAL1 NORTH ZONE FALLERS #1 O-94		08/18	ALAN STEWART	2	ICP/0630	ICP/1900
WTS2 DUDLEY'S E-136		08/25	DON GUICE	1	ICP/0630	ICP/1900
FEMT RANDOLPH O-133 / VANZINNI O-134		08/21		2	ICP/0630	ICP/1900
6. Control Operations/Work Assignments:						
<ul style="list-style-type: none"> • SCOUT FOR OPPORTUNITIES TO REACH CONTAINMENT OBJECTIVES. • CONTINUE INDIRECT DOZER LINE FROM 17N07J ROAD WEST TO SOUTH FORK OF THE SMITH RIVER AND IDENTIFY SAFETY ZONES. 						
7. Special Instructions:						
• COORDINATE AND ORDER AIRCRAFT FOR WATER AND RETARDANT NEEDS WITH AIR ATTACK.						
8. Division/Group Communication Summary						
Function	Channel	RX Frequency N/W	RX Tone/NAC	TX Frequency N/W	TX Tone/NAC	Mode
COMMAND	1	167.1000	162.2	169.7500	162.2	A
TACTICAL	13	167.1125	162.2	167.1125	162.2	A
BACKUP NET	4	168.1250		170.4750	127.3	A
AIR TO GROUND	10	165.3875		165.3875		A
9. Prepared By (Resource Unit Leader)			Approved By (Planning Section Chief)		Date	Time
NANCY MASTERS			DAVE LATTIMORE		08/11/2015	2100

Division/Group Assignment List (ICS 204 WF)

1. Incident Name:			3.			
GASQUET COMPLEX			Branch:		Division/Group:	
2. Operational Period: 0600 - 0600					G - BEAR FIRE	
Date/Time From: 08/12/2015 0600 WED	Date/Time To: 08/13/2015 0600 THU					
4. Operations Personnel						
OPERATIONS CHIEF		NICKIE WASHINGTON DARRELL MILLER		DIVISION/GROUP SUPERVISOR		
PLANNING OPS		MATT CONKLIN AARON THOMPSON (T)		AIR ATTACK SUPERVISOR		
				ERIC PLATZ CHRIS ST PIERRE (T)		
				CLIFF CLARIDGE KEN MCLAUGHLIN		
5. Resources Assigned this Period						
Strike Team / Task Force / Resource Designator		LWD	Leader	Number Persons	Drop Off PT./Time	Pick Up PT./Time
HC2 FORT APACHE 4 C-11		08/20	DANNY EDWARDS	19	ICP/0630	ICP/1900
TFLD JOEL PETERS O-226		08/23		1	ICP/0630	ICP/1900
FELB CHRIS HENRIE O-181		08/24		1	ICP/0630	ICP/1900
FAL1 NORTH ZONE FALLERS #2 O-95		08/18	BILLY BELMONT	2	ICP/0630	ICP/1900
FAL1 NORTH ZONE FALLERS #4 O-97		08/18	BILL MEADOWS	2	ICP/0630	ICP/1900
FAL1 MCKELLER TREE O-202		08/22	DOUG MCKELLAR	2	ICP/0630	ICP/1900
WTS2 TRAYNHAM TRUCKING E 137 <i>NO SHOW</i>		08/25	DAVE DAMON	1	ICP/0630	ICP/1900
SOFR BRAD LIDELL O-252		08/25		1	ICP/0630	ICP/1900
6. Control Operations/Work Assignments:						
<ul style="list-style-type: none"> SCOUT FOR OPPORTUNITIES FOR DIRECT LINE CONSTRUCTION. PREP BEAR BASIN LOOKOUT TOWER. CONTINUE LINE PREP FROM BEAR BASIN LOOKOUT DOWN THE SHIP MT RD TO THE WILDERNESS BOUNDARY. 						
7. Special Instructions:						
<ul style="list-style-type: none"> COORDINATE AND ORDER AIRCRAFT FOR WATER ONLY DROPS WITH AIR ATTACK. FOBS SCHEID / BAERTSCHI (T) WORKING IN DIV E AND DIV G. 						
8. Division/Group Communication Summary						
Function	Channel	RX Frequency N/W	RX Tone/NAC	TX Frequency N/W	TX Tone/NAC	Mode
COMMAND	1	167.1000	162.2	169.7500	162.2	A
TACTICAL	7	168.2500	162.2	168.2500	162.2	A
BACKUP NET	4	168.1250		170.4750	127.3	A
AIR TO GROUND	10	165.3875		165.3875		A
9. Prepared By (Resource Unit Leader)			Approved By (Planning Section Chief)		Date	Time
KYLE HAUDUCOEUR			DAVE LATTIMORE		08/11/2015	2100

Division/Group Assignment List (ICS 204 WF)

1. Incident Name:			3.			
GASQUET COMPLEX			Branch:		Division/Group: W - FEEDER FIRE	
2. Operational Period: 0600 - 0600						
Date/Time From: 08/12/2015 0600 WED		Date/Time To: 08/13/2015 0600 THU				
4. Operations Personnel						
OPERATIONS CHIEF		NICKIE WASHINGTON DARRELL MILLER		DIVISION/GROUP SUPERVISOR		GLENN WEBB AL WARD (T)
PLANNING OPS		MATT CONKLIN AARON THOMPSON (T)		AIR ATTACK SUPERVISOR		CLIFF CLARIDGE KEN MCLAUGHLIN
5. Resources Assigned this Period						
Strike Team / Task Force / Resource Designator		LWD	Leader	Number Persons	Drop Off PT./Time	Pick Up PT./Time
HC2I WHITE MOUNTAIN #1 C-3		08/19	KEITH M SARGENT	19	ICP/0630	ICP/1900
TFLD HYATT O-144 / OLEARY O-234		08/16		2	ICP/0630	ICP/1900
ENG2 GASQUET 214 E-78		08/14	TOM ZURFLUEH	4	ICP/0630	ICP/1900
ENG4 WEBER FIRE DISTRICT 464 E-80		08/14	BARRY LOCKE	4	ICP/0630	ICP/1900
ENG6 TONTO 1247 E-82		08/16	SHAWN O'CONNELL	7	ICP/0630	ICP/1900
ENG6 AMERICAN FIRE CO 61 E-86		08/14	MATT MORRELL	3	ICP/0630	ICP/1900
ENG6 AMERICAN FIRE CO 62 E-85		08/14	MANI MORRELL	3	ICP/0630	ICP/1900
HEQB HARRIS O-218 / EXCA WALBERG, INC E-57		08/25		3	ICP/0630	ICP/1900
HEQB MCCLELLAN O-216 / DOZ2 A TEAM E-127		08/24		5	ICP/0630	ICP/1900
WTT2 SRF 15 E-45		08/16	JACOB MC ADAMS	2	ICP/0630	ICP/1900
WTT2 GASQUET VFD E-88		08/15	SALENA COX	2	ICP/0630	ICP/1900
FAL1 NORTH ZONE FALLERS #3 O-96		08/18	RICK MEE	2	ICP/0630	ICP/1900
6. Control Operations/Work Assignments:						
<ul style="list-style-type: none"> • CONTINUE PREPPING THE 14N39 ROAD FROM DP30 NORTH TO 14N39G ROAD. • SECURE AND HOLD FIRE ALONG 14N39 ROAD TO 14N39G ROAD. • SCOUT FOR OPPORTUNITY TO REACH CONTAINMENT OBJECTIVES. 						
7. Special Instructions:						
<ul style="list-style-type: none"> • COORDINATE AND ORDER AIRCRAFT FOR RETARDANT NEEDS WITH AIR ATTACK. • RAPID EXTRACTION MODULE (R.E.M.) AVAILABLE TO ALL DIVISIONS AND CONTINGENCY GROUP 						
8. Division/Group Communication Summary						
Function	Channel	RX Frequency N/W	RX Tone/NAC	TX Frequency N/W	TX Tone/NAC	Mode
COMMAND	1	167.1000	162.2	169.7500	162.2	A
TACTICAL	12	166.5500	162.2	166.5500	162.2	A
BACKUP NET	4	168.1250		170.4750	127.3	A
AIR TO GROUND	10	165.3875		165.3875		A
9. Prepared By (Resource Unit Leader)			Approved By (Planning Section Chief)		Date	Time
JOE SCURI (T)			DAVE LATTIMORE		08/11/2015	2100

Division/Group Assignment List (ICS 204 WF)

1. Incident Name:			3.			
GASQUET COMPLEX			Branch:		Division/Group:	
2. Operational Period: 0600 - 0600					CONTINGENCY GROUP	
Date/Time From: 08/12/2015 0600	WED	Date/Time To: 08/13/2015 0600				
4. Operations Personnel						
OPERATIONS CHIEF		NICKIE WASHINGTON DARRELL MILLER		DIVISION/GROUP SUPERVISOR		JEREMY COWIE BRIAN FABBRI (T)
PLANNING OPS		MATT CONKLIN AARON THOMPSON (T)		AIR ATTACK SUPERVISOR		CLIFF CLARIDGE KEN MCLAUGHLIN
5. Resources Assigned this Period						
Strike Team / Task Force / Resource Designator		LWD	Leader	Number Persons	Drop Off PT./Time	Pick Up PT./Time
TFLD JON OLSEN O-233		08/24		1	ICP/0630	ICP/1900
CHIP CECIL 1 E-130		08/25	JUSTIN CECIL	2	ICP/0630	ICP/1900
CHIP COASTAL TREE SERVICE E-131		08/24	JOHN DILLON	2	ICP/0630	ICP/1900
6. Control Operations/Work Assignments:						
<ul style="list-style-type: none"> • COORDINATE WITH SOPL TO VALIDATE LONG TERM PLANS. • COORDINATE CHIPPING ACTIVITIES WITH ALL DIVISIONS. 						
7. Special Instructions:						
<ul style="list-style-type: none"> • RAPID EXTRACTION MODULE (R.E.M.) AVAILABLE TO ALL DIVISIONS AND CONTINGENCY GROUP • REVIEW CHIPPER JHA. • FOBS - PENNY / MASTERS. 						
8. Division/Group Communication Summary						
Function	Channel	RX Frequency N/W	RX Tone/NAC	TX Frequency N/W	TX Tone/NAC	Mode
COMMAND		SEE COMM PLAN				
TACTICAL						
BACKUP NET						
AIR TO GROUND						
9. Prepared By (Resource Unit Leader)			Approved By (Planning Section Chief)		Date	Time
JOE SCURI (T)			DAVE LATTIMORE		08/11/2015	2100

AIR OPERATIONS SUMMARY

PREPARED BY: Ted Visser



PREPARED DATE/TIME: 08/11/15 1900

<p>1. INCIDENT NAME: Gasquet Complex</p> <p>2. OPERATIONAL PERIOD DATE: 08/12/15 START TIME: 0700 END TIME: 2000 SUNRISE: 0621 SUNSET: 2022</p>	<p>4. MEDEVAC A/C: 512</p>	<p>5. TFR: 5/0539 Radius: 10 NM Altitude: 9000 MSL Centerpoint: N 41 40.00 W 123 50.00 Freq: 128.0750 Illinois Valley Tower Freq: 133.275</p>																																			
<p>3. REMARKS (Safety Notes, Hazards, Air Operations Special Equipment, etc.) Thunderstorms, erratic winds. Low wires, cables, power lines. Divisions, contact Helibase for all aviation needs, include coordinates of possible helispot/unimproved landing locations. Possible smoke concerns. Bear Fire Div E, 41 48.928 123 44.678 Coon Fire Div C, 41 45.786 123 57.709 Feeder Fire Div W, 41 35.065 123 50.726 Peak Fire Div L, 41 33.065 123 46.134 Summit Fire Div V, 41 35.000 123 47.800 Williams Fire Div H, 41 35.290 123 45.621</p>																																					
<p>6. PERSONNEL</p> <table border="1" style="width:100%; border-collapse: collapse;"> <thead> <tr> <th>PERSONNEL</th> <th>Phone</th> <th>7. FREQUENCIES</th> <th>AIM</th> <th>FM</th> </tr> </thead> <tbody> <tr> <td>AODB: Ted Visser</td> <td>619-981-2409</td> <td>AIR/AIR FW:</td> <td></td> <td>166.4500</td> </tr> <tr> <td>ASGS: Galen Young</td> <td>575-574-8720</td> <td>AIR/AIR RW:</td> <td>128.0750</td> <td></td> </tr> <tr> <td>ATGS: Ken McLaughlan</td> <td>813-997-0317</td> <td>AIR/GROUND CMD: AIR/GROUND TAC:</td> <td></td> <td>165.3875</td> </tr> <tr> <td>ATGS: Cliff Claridge</td> <td>480-688-5330</td> <td>COMMAND: RX: TX:</td> <td></td> <td>167.1000 169.7500 Tone 15 162.2</td> </tr> <tr> <td>HEB1: Melvin Tate</td> <td>850-849-0405</td> <td>DECK:</td> <td></td> <td>163.100</td> </tr> <tr> <td>HEB1(T): Rita Clipperton</td> <td>530-559-0905</td> <td>AIR GUARD:</td> <td></td> <td>168.6250</td> </tr> </tbody> </table>			PERSONNEL	Phone	7. FREQUENCIES	AIM	FM	AODB: Ted Visser	619-981-2409	AIR/AIR FW:		166.4500	ASGS: Galen Young	575-574-8720	AIR/AIR RW:	128.0750		ATGS: Ken McLaughlan	813-997-0317	AIR/GROUND CMD: AIR/GROUND TAC:		165.3875	ATGS: Cliff Claridge	480-688-5330	COMMAND: RX: TX:		167.1000 169.7500 Tone 15 162.2	HEB1: Melvin Tate	850-849-0405	DECK:		163.100	HEB1(T): Rita Clipperton	530-559-0905	AIR GUARD:		168.6250
PERSONNEL	Phone	7. FREQUENCIES	AIM	FM																																	
AODB: Ted Visser	619-981-2409	AIR/AIR FW:		166.4500																																	
ASGS: Galen Young	575-574-8720	AIR/AIR RW:	128.0750																																		
ATGS: Ken McLaughlan	813-997-0317	AIR/GROUND CMD: AIR/GROUND TAC:		165.3875																																	
ATGS: Cliff Claridge	480-688-5330	COMMAND: RX: TX:		167.1000 169.7500 Tone 15 162.2																																	
HEB1: Melvin Tate	850-849-0405	DECK:		163.100																																	
HEB1(T): Rita Clipperton	530-559-0905	AIR GUARD:		168.6250																																	
<p>8. FIXED-WING</p> <table border="1" style="width:100%; border-collapse: collapse;"> <thead> <tr> <th>8. FIXED-WING</th> <th># Avail / Type/ Make-Model / FAA # / Base(s)</th> </tr> </thead> <tbody> <tr> <td>Airtankers:</td> <td>Available through Dispatch SEAT 818, SEAT 886, SEAT 898</td> </tr> <tr> <td>Leadplanes:</td> <td>Available through Dispatch</td> </tr> <tr> <td>ATBase:</td> <td></td> </tr> <tr> <td>ATGS Aircraft:</td> <td>N 4579N, A-6 Claridge N 285 , A-65 McLaughlan</td> </tr> <tr> <td>AAB:</td> <td>MRB: ICL, Joe Hart, 208-699-1166</td> </tr> <tr> <td>Gary Smith S-31,32,33 Uni Engine 530-598-1434</td> <td>Cave- HOS Trir, E-2, Chris Long, 208-539-7108 Cave- 49er WT, E-41 Bobby Alvarez, 619-300-0801 Cave Helibase 541-592-2852, FAX 541-592-3798</td> </tr> </tbody> </table>			8. FIXED-WING	# Avail / Type/ Make-Model / FAA # / Base(s)	Airtankers:	Available through Dispatch SEAT 818, SEAT 886, SEAT 898	Leadplanes:	Available through Dispatch	ATBase:		ATGS Aircraft:	N 4579N, A-6 Claridge N 285 , A-65 McLaughlan	AAB:	MRB: ICL, Joe Hart, 208-699-1166	Gary Smith S-31,32,33 Uni Engine 530-598-1434	Cave- HOS Trir, E-2, Chris Long, 208-539-7108 Cave- 49er WT, E-41 Bobby Alvarez, 619-300-0801 Cave Helibase 541-592-2852, FAX 541-592-3798																					
8. FIXED-WING	# Avail / Type/ Make-Model / FAA # / Base(s)																																				
Airtankers:	Available through Dispatch SEAT 818, SEAT 886, SEAT 898																																				
Leadplanes:	Available through Dispatch																																				
ATBase:																																					
ATGS Aircraft:	N 4579N, A-6 Claridge N 285 , A-65 McLaughlan																																				
AAB:	MRB: ICL, Joe Hart, 208-699-1166																																				
Gary Smith S-31,32,33 Uni Engine 530-598-1434	Cave- HOS Trir, E-2, Chris Long, 208-539-7108 Cave- 49er WT, E-41 Bobby Alvarez, 619-300-0801 Cave Helibase 541-592-2852, FAX 541-592-3798																																				

9. HELICOPTERS (Use Additional Sheets As Necessary)

FAA #	TY	MAKE/MODEL	BASE	AVAILABLE	START	REMARKS	FAA #	TY	MAKE/MODEL	BASE	AVAILABLE	START	REMARKS
HT-702	1	S-61	Cave	0730	0830	A-20							
HT-782	1	S-64	Cave	0730	0830	A-62							
512	2	Bell 212	Cave	0730	0830	A-42							
517	2	Bell 205	Cave	0730	0830	A-57 Restricted							
988B	3	Bell L4	Cave	0730	0830	A-28							

MEDICAL PLAN	1. INCIDENT NAME Gasquet Complex	2. DATE PREPARED 8/11/15	3. TIME PREPARED 1730	4 OPERATIONAL PERIOD 8/12-13/2015 0600-0600				
5. INCIDENT MEDICAL AID STATIONS								
MEDICAL AID STATIONS		LOCATION		PARAMEDIC				
Medical Supply		Base Camp		YES NO X				
TRANSPORTATION								
A. Air Ambulances								
NAME	ADDRESS	PHONE	PARAMEDIC YES NO					
National Guard H-825 (Day/Night, Hoist)	Redding Airport, CA	Communications	X					
CHP H-14 (Day/Night, Hoist)	Redding Airport, CA	(530) 842-3515	X					
Coast Guard (Day/Night, Hoist)	Air Station Humboldt Bay, CA	(707) 839-6100		X				
CalFire Kneeland Helitack H-102 (Hoist capable)	Kneeland Station, CA	(707) 441-2863		X				
Reach 5 Air Medical	Redding, CA	1-800-338-4045	X					
Mercy Air Ambulance 105	Medford, Oregon	1-800-903-9000	X					
PHI Air Medical	Redding, CA	1-800-597-9571	X					
B. Ground Ambulances								
Del Norte Ambulance, Station 2	2600 Morehead Rd Crescent City CA	Communications	X					
C. Rapid Extraction Modules								
R.E.M. – South	Gasquet South Operations	Communications		X				
7. HOSPITALS								
NAME	ADDRESS	TRAVEL TIME		PHONE	HELIPAD		BURN CENTER	
		AIR	GRND		YES	NO	YES	NO
Sutter Coast Hospital	800 E Washington Crescent City CA.		25min	ER: 707-464-8888 Gen: 707-464-8511		X		X
Mercy Med. Center Level 3 Trauma	914 Pine St. Mt. Shasta, CA. N. 40 34.14 x W. 122 23.97	45m	4.5hr	(530)926-9360	X			X
Rogue Valley Med Center Level 2 Trauma	2825 Barnett Rd. Medford, OR. N. 42 19.092 W. 122 49.833	30m	2 hr	(541)789-7100	X			X
UC Davis Med Center Level 1 Trauma Burn Center	2315 Stockton Blvd. Sacramento, CA N. 38 33.3 x W. 121 27.3	2hr	7.0hr	(916) 734-3636 Burn Center (916) 734-3790 ER	X		X	
8. MEDICAL EMERGENCY PROCEDURES								
<p>In the event of a medical emergency provide the following information to your Divs or Gasquet Communications on Command.</p> <ol style="list-style-type: none"> 1. Declare the nature of the emergency. <ol style="list-style-type: none"> a. Medical injury/illness? b. Is injury/illness life threatening? 2. If life threatening, then request that the designated frequency be cleared for emergency traffic. 3. Identify the on-scene Point of Contact (POC) by resource and last name (i.e POC is TFLD Smith). 4. Identify nature of incident, number injured, patient assessment(s) and location (geographic and GPS coordinates). 5. Identify on-scene medical personnel by position and name (i.e EMT Jones). 6. Identify preferred method of patient transport. 7. Request any additional resources and/or equipment needed 8. Document all information received and transmitted on the radio or phone. 9. Identify any changes in the on-scene Point of Contact or medical personnel as they occur. 				<p>INJURY REPORTING PROCEDURES</p> <p>NATURE OF INJURY _____ # of Patients _____</p> <p>TRANSPORTATION NEEDED Air _____ Ground _____</p> <p>REM Needed Y ___ N ___ Estimated Air Temp _____</p> <p>LAT _____ LONG _____ Elevation _____</p> <p>Specific Hazards In Area _____</p> <p>PATIENT UNIT ID _____</p> <p>REMINDER: DO NOT GIVE PT NAME OVER RADIO</p> <p>IS MEDICAL PERSONNEL WITH PATIENT: YES ___ NO ___</p> <p>AGE ___ SEX: MALE ___ FEMALE ___</p> <p>ALL EMERGENCIES—Secure the area and identify witnesses for later investigation. Keep an accurate log of events.</p>				
9. PREPARED BY (MEDICAL UNIT LEADER) Gena Fowlkes MEDL (909) 762-9032		10. REVIEWED BY (SAFETY OFFICER) James Aragon SOF2						



Health & Safety Message

Incident: Gasquet Complex CA-SRF-001488	Date/Op Period: 8/12-13/15 0600-0600
---	---

Hazards & Risks

Weather/Visibility: Restricted visibility due to haze and smoke limits the ability of FOBS, Lookouts & Aircraft to see you or fire activity on the ground. Monitor weather trends and post lookouts with these limitations in mind. Adjust tactics accordingly with the expectation that aviation support may be severely limited.

Emergency Medical: Review and brief the medical treatment and evacuation plan on the ICS 206 Medical Plan. The Gasquet area has extended response and transport times for EMS so get medical responders going early in your incident.

REALIZE THAT AIRCRAFT EVACUATIONS MAY BE SEVERELY LIMITED
DUE TO RESTRICTED VISIBILITY. HAVE A GROUND TRANSPORT
CONTINGENCY PLAN FOR YOUR DIVISIONS

Steep Terrain and Rolling Stuff! : With very steep terrain in all Divisions comes rolling rocks, logs, and humans. Watch your footing and avoid working below other personnel and equipment working above you. Stagger yourselves as you hike up and down the fireline and watch your spacing.

Vehicle Operation: Respect the local traffic laws and use extra caution when driving along forest roads in your areas of operation. Establish a traffic flow plan in areas that require it. Use emergency lighting as needed, especially when working along public roadways. Drive carefully through downtown Gasquet.

Prepared By: Paul Tompkins SOFR2	Approved: Dave Kelly, Deputy IC
---	--

L. Lookouts **C.** Communications **E.** Escape Routes **S.** Safety Zones

BE MINDFUL



Incident within an Incident Action Plan

Position Assignment Supportive Actions

Division Supervisor

- See items 1-6 on page one
- If unable to access accident/incident location, delegate command to a closer qualified resource

Medical Unit Leader

- Respond to Comm Unit as soon as possible
- Coordinate with Division Supervisor to ensure proper resources are rapidly ordered
- Assign a MEDL to the scene and other positions to support the response as needed
- Monitor condition updates of patient(s) and coordinate response with Operations

Communications Unit Leader

- Maintain clear radio traffic and monitor communications to support response
- Recommend appropriate security and investigative process
- Assess the need for critical Incident Stress Response

Safety Officer

- Provide for Safety personnel on scene as needed
- Recommend appropriate security and investigative process
- Assess the need for critical Incident Stress Response

Air Attack Supervisor

- Obtain coordinates of the emergency location
- Coordinate air-medical response
- Assist and support the designated Point of Contact with communications and coordination of the emergency response as necessary

IC, Command & General Staff

- Manage the emergency and direct specific responsibilities to individual positions to provide an appropriate response
- Notify the host unit and host dispatch center of the size-up information
- Constantly monitor and assess the appropriate response and adapt direction as needed
- Submit all documentation pertaining to the emergency to the Plans Chief

Reference the full Incident Medical Emergency Plan for additional

LCP

Mountain School
 55 Azalea Lane
 Gasket, CA 95543
 (707) 457-3211

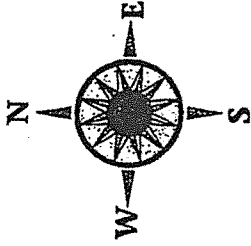

P	Portable	Fire Alarm Panel
C	Classroom	Water Shut Off
	Exit/Door	Electrical Shut Off
	Fire Extinguisher	

071410/Site Maps/Del Norte

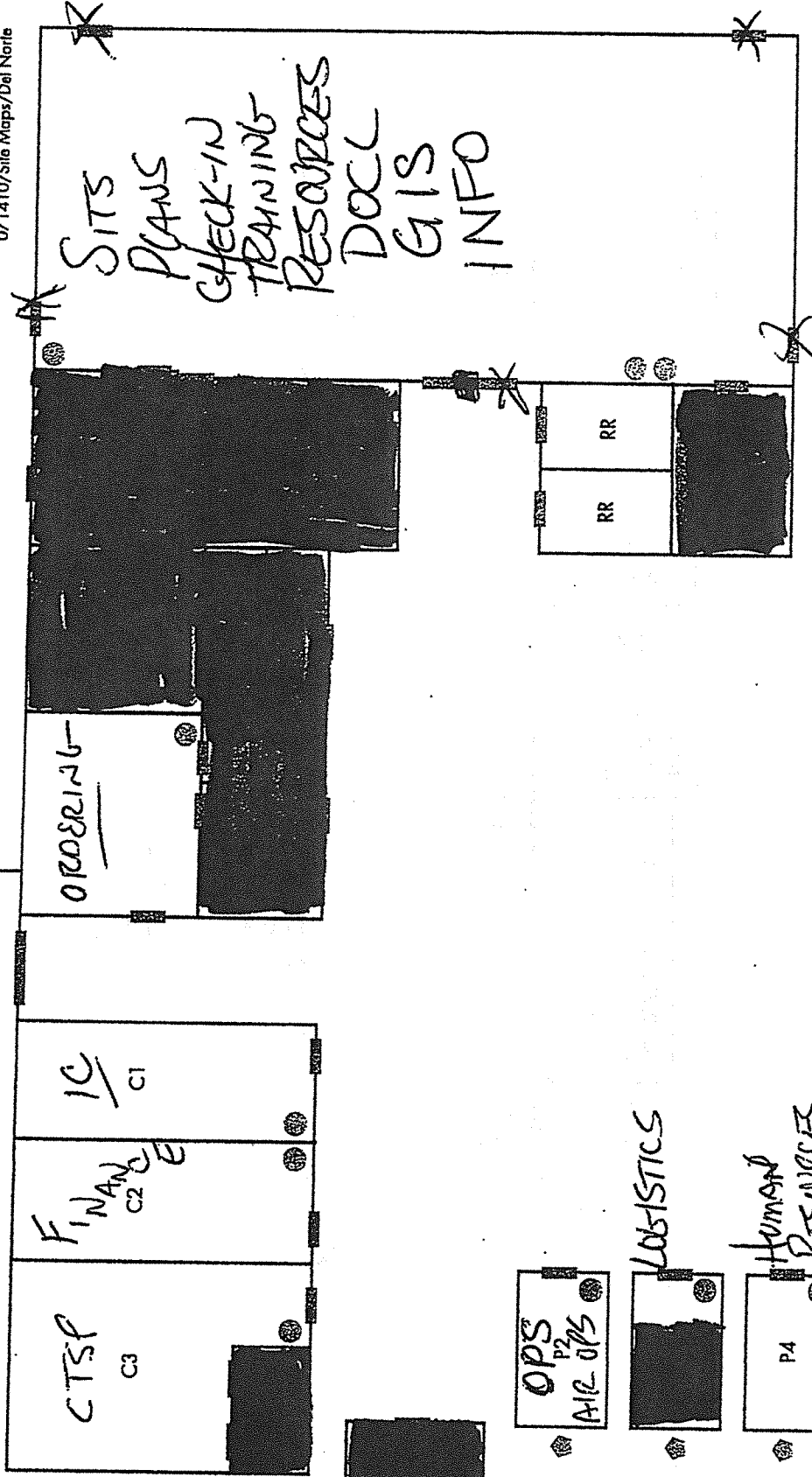

OPS
 P2
 AIR OPS

LOGISTICS

HUMAN
 RESOURCES

As of 8/7/2015

1 Gasquet
N Complex
CA-SRF-001488

Transportation MAP

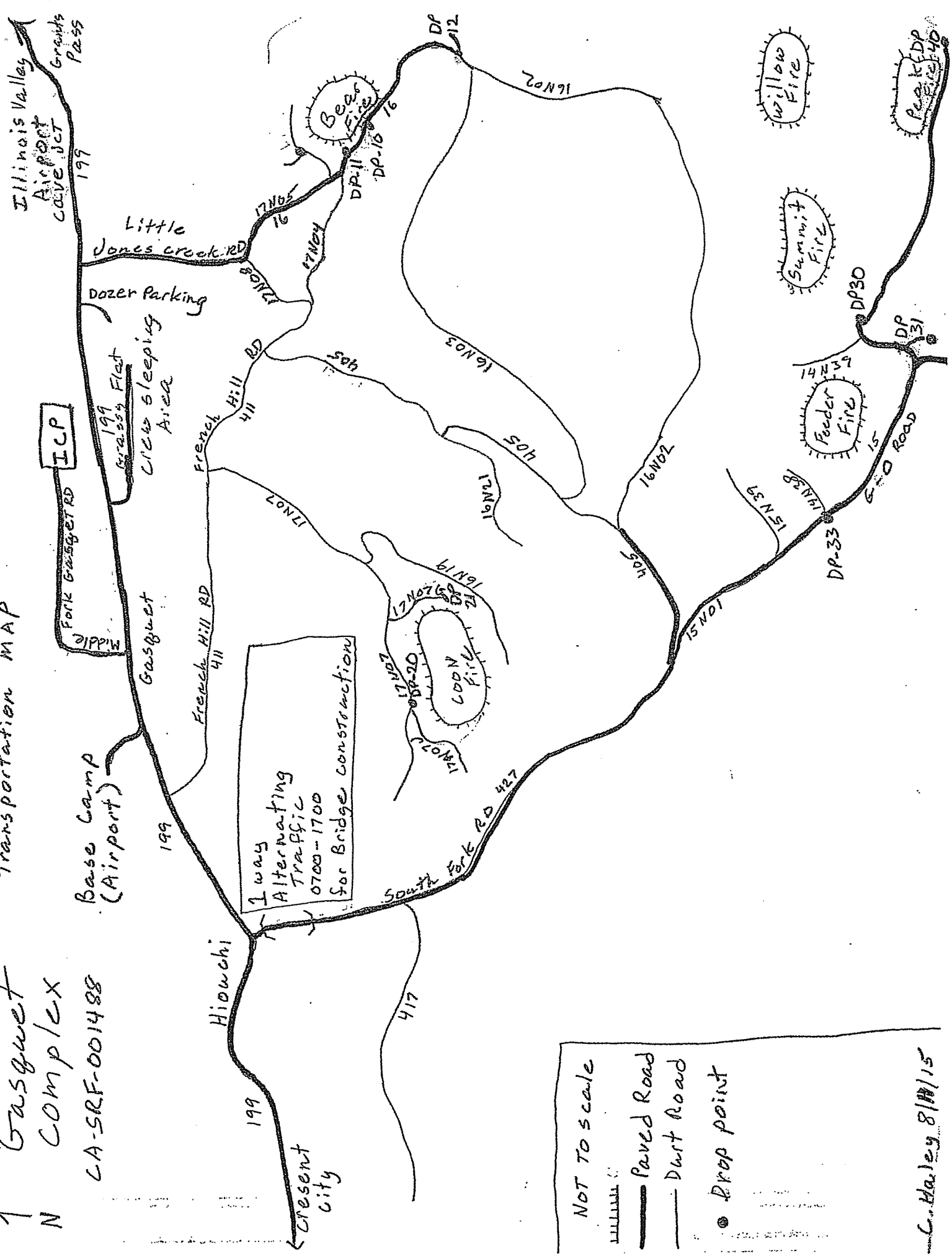

1 way
Alternating
Traffic
for Bridge construction
0700-1700

NOT TO SCALE

- Paved Road
- Dirt Road
- Drop point

C. Haley 8/11/15