

\*CORRECTED\*

# GASQUET COMPLEX

## INCIDENT ACTION PLAN

OPERATIONAL PERIOD

AUG 13 - AUG 14, 2015

0600-0600



*"Adapt...Improvise...and Overcome"*



CA-SRF-001488  
P5JOPQ (0510)

NAD 83  
dd<sup>o</sup> m.mm'

## INCIDENT OBJECTIVES (ICS 202)

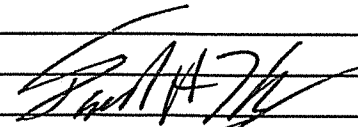
<b>1. Incident Name:</b>		<b>2. Operational Period:</b> 0600 - 0600	
GASQUET COMPLEX		Date/Time From: 08/13/2015 0600 THU	Date/Time To: 08/14/2015 0600 FRI
<b>3. Objective(s):</b>			
<p><b>STRATEGIC FRAMEWORK:</b> THE FRAMEWORK FOR THE GASQUET COMPLEX STRATEGIC PLAN CONSISTS OF USING A COMBINATION OF DIRECT ATTACK WHERE FEASIBLE, OTHERWISE INDIRECT USING NATURAL BARRIERS. A KEY ELEMENT IS FLEXIBILITY AND THE ABILITY TO APPLY THE RIGHT RESOURCE TO THE RIGHT TASK AT THE RIGHT TIME. FIRELINE WILL BE CONSTRUCTED ONLY WHERE FEASIBLE AND SAFE TO DO SO.</p> <p><b>LEADERS INTENT:</b> PROVIDE THE HIGHEST LEVEL OF CUSTOMER SERVICES TO ALL INVOLVED WITH OR IMPACTED BY THE GASQUET COMPLEX. ALL INCIDENT PERSONNEL SHOULD BE PREPARED TO TAKE THE APPROPRIATE ACTIONS REGARDING:</p> <ul style="list-style-type: none"> <li>• PERSONAL INTERACTIONS BOTH INSIDE AND OUTSIDE THE INCIDENT MANAGEMENT ORGANIZATION.</li> <li>• PERSONAL SAFETY AND THE SAFETY OF OTHERS.</li> <li>• AN INCIDENT-WITHIN-AN-INCIDENT.</li> </ul> <p><b>OBJECTIVES:</b></p> <ul style="list-style-type: none"> <li>• PROVIDE FOR FIREFIGHTER AND PUBLIC SAFETY BY ENSURING L C E S IS EVALUATED USING SOUND RISK MANAGEMENT PRINCIPLES.</li> <li>• MAINTAIN AND BUILD COOPERATOR AND STAKEHOLDER RELATIONSHIPS.</li> <li>• SUPPRESS FIRES WHILE NOT EXPOSING FIREFIGHTERS OR AIRCRAFT TO UNNECESSARY RISKS.</li> <li>• IDENTIFY AND PROTECT NATIVE AMERICAN TRADITIONAL AREAS AND OTHER SENSITIVE CULTURAL AND HISTORIC SITES.</li> </ul>			
<b>4. Operational Period Command Emphasis:</b>			
UTILIZE SUPPRESSION STRATEGIES COMMENSURATE WITH VALUES AT RISK. IMPLEMENT TACTICS WHICH INCREASE THE PROBABILITIES OF SUCCESS WHILE HOLDING EXISTING CONTAINMENT.			
<b>General Situational Awareness:</b>			
ROOT SYSTEMS OF GREEN TREES HAVE BEEN WEAKENED BY DROUGHT. THIS CAN RESULT IN TREES COMING DOWN WITH LITTLE EFFORT FROM HEAVY EQUIPMENT.			
<b>5. Site Safety Plan Required?</b> Yes <input type="checkbox"/> No <input checked="" type="checkbox"/>			
<b>Approved Site Safety Plan(s) Located at:</b>			
<b>6. Incident Action Plan</b> (the items checked below are included in this Incident Action Plan):			
<input checked="" type="checkbox"/> ICS 202	<input type="checkbox"/> ICS 207	<b>Other Attachments:</b>	
<input checked="" type="checkbox"/> ICS 203	<input type="checkbox"/> ICS 208	<input checked="" type="checkbox"/> SAFETY / 215A	
<input checked="" type="checkbox"/> ICS 204	<input checked="" type="checkbox"/> ICS 220	<input checked="" type="checkbox"/> INCIDENT WITHIN AN INCIDENT	
<input checked="" type="checkbox"/> ICS 205	<input checked="" type="checkbox"/> Map/Chart	<input checked="" type="checkbox"/> HR / TRAINING MESSAGE	
<input type="checkbox"/> ICS 205A	<input checked="" type="checkbox"/> Weather Forecast/Tides/Currents	<input checked="" type="checkbox"/> DEMOB LIST	
<input checked="" type="checkbox"/> ICS 206			
<b>7. Prepared by:</b> DAVE LATTIMORE		<b>Position/Title:</b> PSC2	
<b>8. Approved by Incident Commander:</b>		<b>Signature:</b> 	
Name: DON GARWOOD		<b>Signature:</b>	
ICS 202		<b>Date/Time:</b> 08/12/2015 2100	
IAP Page			

## ORGANIZATION ASSIGNMENT LIST (ICS 203)

<b>1. Incident Name:</b>		<b>2. Operational Period:</b> 0600 - 0600	
GASQUET COMPLEX		Date/Time From: 08/13/2015 0600	Date/Time To: 08/14/2015 0600
		THU	FRI
<b>3. Incident Commander(s) and Command Staff:</b>		<b>7. Operations Section:</b>	
IC/UC	DON GARWOOD	OPS SECTION CHIEF	DERRICK DAVIS DARRELL MILLER
DEPUTY	DAVE KELLY		
SAFETY OFFICER	JAMES ARAGON; P TOMPKINS; J BATES; F HERNANDEZ (T)	PLANNING OPS	MATTHEW CONKLIN AARON THOMPSON (T)
INFORMATION OFFICER	JIM WILKINS; ROBERT POOLE ASCENSION BRIBIESCAS		
LIAISON OFFICER	LARRY LA VOGUE 909-855-5756	DIVISION/GROUP	A - COON FIRE MITCH FOWLKES DAN O'CONNOR (T)
HUMAN RESOURCES	KATHY KREYNS 909-731-1771 ANDREA CABIDA (T)	DIVISION/GROUP	C - COON FIRE TODD MCDIVITT BRIAN BERRY (T)
<b>4. Agency/Organization Representative(s):</b>		DIVISION/GROUP	D - COON FIRE TRENT INGRAM KEN VAN WIG (T)
Agency/Organization	Name	DIVISION/GROUP	E - BEAR FIRE DAVID MARTINEZ JOHN OWINGS (T)
USFS	DAVE PALMER	DIVISION/GROUP	G - BEAR FIRE ERIC PLATZ CHRIS ST. PIERRE (T)
GASQUET VFD	NICK KARANPOULOS	DIVISION/GROUP	H/L/N/V WILLIAMS / PEAK / SUMMIT CANDICE KUTROSKY PAUL MANDOLINI (T)
<del>CAL OES</del> <del>CAL EMA</del>	JOHN SALVATE	DIVISION/GROUP	W - FEEDER FIRE GLENN WEBB AL WARD (T)
CAL TRANS		DIVISION/GROUP	Z - FEEDER FIRE ADAM KOHLEY ROBERT ALLAN (T)
SRF-NFFE	ROBERTA CORAGLIOTTI 530-784-7542 JOHN MC RAE 707-845-8017	DIVISION/GROUP	CONTINGENCY JEREMY COWIE BRIAN FABRI (T)
<b>5. Planning Section:</b>		<b>7b. Air Operations Branch:</b>	
CHIEF	DAVE LATTIMORE	AIR OPS BRANCH DIRECTOR	TED VISSER
DEPUTY	RICH STERRY (T)	AIR SUPPORT SUPERVISOR	GALEN YOUNG
RESOURCES UNIT	K HAUDUCOEUR, N MASTERS B KERSHAW, J SCURI (T)	AIR ATTACK SUPERVISOR	CLIFF CLARIDGE KEN MCLAUGHLIN
SITUATION UNIT	GORDON TAMPLIN(T), TIM KNORR(T)	AIR TANKER COORDINATOR	
DOCUMENTATION	VANESSA HANSON	HELICOPTER COORDINATOR	
DEMOB UNIT	JIM STITELER (T)		
IMET	RACHEL COBB		
FIRE BEHAVIOR	BYRON KIMBALL		
SOPL	BOB LINEBACK		
TRAINING SPECIALIST	ANN HUTCHINSON		
GISS	R MURILLO; A. KIRSCH; A SALDIVAR(T)		
CTSP	CHARLES VERTREES		
<b>6. Logistics Section:</b>		<b>8. Finance/Administration Section:</b>	
CHIEF	ERIC SWEETMAN	CHIEF	DEBBIE YORK
DEPUTY	STEVE KING (T) / <i>Dave Whitney (T)</i>	TIME UNIT	SHARON R MAKOSKY DEANNA THOMPSON (T)
SUPPLY UNIT	EVAN TISS; DAVID WHITNEY	COMPENSATION UNIT	BETH SJOBLUM
FACILITIES UNIT	ART CURLEY; DOUG WINN(T)	COST UNIT	THOMAS STEELE KRIS STERBENS (T)
GROUND SUPT UNIT	CHRIS HALEY; RON NOORDMAN		
COMM UNIT	DAVE LARKIN; CHRIS PERRY(T)		
MEDICAL UNIT	GENA FOWLKES MATTHEW MENARD (T)		
SECURITY UNIT	HEATHER NAIGUS		
FOOD UNIT	RICHARD WAITE		
<b>9. Prepared By:</b>	Name: KYLE HAUDUCOEUR	Position/Title: RESL	Signature:
ICS 203	IAP Page	Date/Time: 08/12/2015 2100	

# FIRE BEHAVIOR FORECAST

<b>FORECAST NUMBER: #10</b>	<b>TYPE OF FIRE: Wildland Fire</b>
<b>FIRE NAME: Gasquet Complex</b>	<b>OPERATIONAL PERIOD: August 13, 2015</b>
<b>DATE ISSUED: August 12, 2015</b>	<b>TIME ISSUED: 2000</b>
<b>UNIT: Smith River NRA, Six Rivers NF</b>	<b>SIGNED: <i>Byron R. Kimball</i></b>
	<b>Typed/printed:/s/ Byron R. Kimball FBAN</b>

## INPUTS

**WEATHER SUMMARY:** Off shore low pressure will move northeast, bringing cloudy skies and a chance of evening showers. Temperature cooler and Relative Humidity higher, with more marine air present.

MAX TEMPERATURE.....60's to 70.

MIN HUMIDITY.....40 – 50%

EYE LEVEL WINDS.....Upslope/upvalley light, Ridges NE 3 to 6 becoming SW 6-12, G 20 late morning into afternoon

**For more specific information, please see the Spot Weather forecast**

## OUTPUTS

### FIRE BEHAVIOR

#### GENERAL:

A return to cloudy skies, more marine air, and higher RH should lead to less activity. RH above 40% should slow down spread and lower intensity. Gusty winds along the ridges could push the fire, but without significantly increasing the intensity. Winds increase and change direction in the afternoon, be aware of the shift.

With line construction in incomplete burns, be positive that you are exposing the black edge and getting all the hot ash and embers inside your line.

#### SPECIFIC:

Timber Understory: Fire behavior in the Understory models should decrease. Increased RH and some cloud cover will reduce the burn window.

ROS: 5 to 10 ch/hr.

FL: 6 to 8 ft.

Timber Litter: Timber Litter fire behavior should be less active. RH above 40% should calm the fire activity. Stay aware of rollout and upslope runs through incomplete burns.

ROS: 3 to 6 ch/hr.

FL: 2 to 3 ft.

Rollout of heavier fuels continues to present a concern as the fires work into the drainages. Be prepared for a slope reversal run if fire establishes with sufficient heat.

### AIR OPERATIONS:

Return to cloudy skies and marine layer may limit air craft in the morning. May improve in the afternoon when whatever solar heating that the fire gets sets in fully.

## SAFETY

Be aware of fire in the standing timber and instability of trees and snags. Ash pits and stump holes become more of an issue the longer the fire burns in the fuel bed.



## INCIDENT Weather Forecast

FORECAST NO: 2

NAME OF FIRE: Gasquet Complex

PREDICTION FOR: Day Shift

SHIFT DATE: 8/13/2015

SIGNED: *Rachel Cobb*

TIME AND DATE

FORECAST ISSUED: 1900 8/12/2015

Rachel Cobb

Incident Meteorologist

---

**WEATHER DISCUSSION:** An offshore area of low pressure will move northeast on Thursday, bringing mostly cloudy skies, and a chance of showers during the evening. Temperatures will cooler and relative humidity higher, with onshore flow pushing marine air inland. Gusty southwest winds will also be possible. The low will then move away from the area on Friday, and warmer and drier conditions can be expected. Winds will become lighter and be more northerly on Friday.

---

### **WEATHER FORECAST for Thursday:**

**WEATHER:** Mostly cloudy and smoky. A chance of showers in the afternoon and evening, with less than a tenth of an inch of rain.

**MAXIMUM TEMPERATURES:** 65 – 70 degrees valleys...60 – 65 degrees ridges.

**MINIMUM HUMIDITY:** 40 – 50 percent.

**20 FT WINDS:**

**RIDGETOP** – Northeast 3 to 6 mph becoming southwest 6 to 12 mph with gusts around 20 mph in the late morning and afternoon.

**SLOPE/VALLEY** – Upslope/upvalley 3 to 8 mph.

**HAINES INDEX:** 2 (low).

**STABILITY/INVERSION:** Inversion between 5000 and 6000 feet msl.

---

**OUTLOOK for Thursday Night:** Mostly cloudy and smoky. A slight chance of showers before midnight. Low temperatures 45 – 55 degrees and maximum relative humidity 80 – 95%. Ridgetop winds variable 3 to 6 mph. Haines Index: 2.

---

**OUTLOOK for Friday:** Partly cloudy and smoky. Highs 66 – 77 degrees and relative humidity 30 – 40%. Ridgetop winds north-northwest 6 to 11 mph. Mixing height: 7500 feet msl. Haines Index: 4.

---

**EXTENDED FORECAST:** High pressure will be influencing the area Saturday and Sunday with warmer and drier conditions and light northerly winds. It may be slightly cooler with higher humidity Monday and Tuesday, but a weather system to the north could bring gusty winds.

## Division/Group Assignment List (ICS 204 WF)

<b>1. Incident Name:</b>			<b>3.</b>			
GASQUET COMPLEX			<b>Branch:</b>		<b>Division/Group:</b>	
<b>2. Operational Period:</b> 0600 - 0600			<b>A - COON FIRE</b>			
Date/Time From: 08/13/2015 0600 THU		Date/Time To: 08/14/2015 0600 FRI				
<b>4. Operations Personnel</b>						
<b>OPERATIONS CHIEF</b>		DERRICK DAVIS DARRELL MILLER		<b>DIVISION/GROUP SUPERVISOR</b>		MITCH FOWLKES DAN O'CONNOR (T)
<b>PLANNING OPS</b>		MATT CONKLIN AARON THOMPSON (T)		<b>AIR ATTACK SUPERVISOR</b>		CLIFF CLARIDGE KEN MCLAUGHLIN
<b>5. Resources Assigned this Period</b>						
Strike Team / Task Force / Resource Designator		LWD	Leader	Number Persons	Drop Off PT./Time	Pick Up PT./Time
HC2 STEELHEAD C-30		08/15	ALEJANDRO RODRIGUEZ	20	ICP/0630	ICP/1900
HCM HOOPA O-275		08/24	ROCKY COLEGROVE	12	ICP/0630	ICP/1900
TFLD VIKTORA / WHEELER (T)		08/18		2	ICP/0630	ICP/1900
TFLD PHILLIPS O-75 / KEYSE (T) O-78		08/18		2	ICP/0630	ICP/1900
ENG3 LKP 5031 E-75		08/14	RICK BERGEN	3	ICP/0630	ICP/1900
ENG6 ALBANY 2180 E-79		08/21	TIM SMYSER	3	ICP/0630	ICP/1900
HEQB HEISEY / ALLEN (T) / DOZ2 ROEN E-90		08/20		3	ICP/0630	ICP/1900
DWE HEQB LANTERMAN O-83 / DOZ2 FISK'S E-91		08/21		2	ICP/0630	ICP/1900
HEQB TERRY CARRICO O-217		08/24		1	ICP/0630	ICP/1900
SKG4 L & L EXCAVATING W/ TRSPT E-111		08/23	SHANE NODINE	2	ICP/0630	ICP/1900
SKG3 UNDERHILL 1 W/ TRSPT E-112		08/22	JOE BRADBURY	2	ICP/0630	ICP/1900
FAL1 NORTH ZONE FALLERS #1 O-94		08/18	ALAN STEWART	2	ICP/0630	ICP/1900
WTS2 DUDLEY'S E-136		08/25	DON GUICE	1	ICP/0630	ICP/1900
FEMT RANDOLPH O-133 / VANZINNI O-134		08/21		2	ICP/0630	ICP/1900
<b>6. Control Operations/Work Assignments:</b>						
<p>ENG6 Kai bab 611 E-165</p> <ul style="list-style-type: none"> <li>• SCOUT FOR OPPORTUNITIES TO REACH CONTAINMENT OBJECTIVES.</li> <li>• CONTINUE INDIRECT DOZER LINE FROM 17N07J ROAD WEST TO SOUTH FORK OF THE SMITH RIVER AND IDENTIFY SAFETY ZONES.</li> </ul>						
<b>7. Special Instructions:</b>						
<ul style="list-style-type: none"> <li>• COORDINATE AND ORDER AIRCRAFT FOR WATER AND RETARDANT NEEDS WITH AIR ATTACK.</li> </ul>						
<b>8. Division/Group Communication Summary</b>						
Function	Channel	RX Frequency N/W	RX Tone/NAC	TX Frequency N/W	TX Tone/NAC	Mode
COMMAND	1	167.1000	162.2	169.7500	162.2	A
TACTICAL	13	167.1125	162.2	167.1125	162.2	A
BACKUP NET	4	168.1250		170.4750	127.3	A
AIR TO GROUND	10	165.3875		165.3875		A
<b>9. Prepared By (Resource Unit Leader)</b>			<b>Approved By (Planning Section Chief)</b>		<b>Date</b>	<b>Time</b>
JOE SCURI (T)			DAVE LATTIMORE		08/12/2015	2100

## Division/Group Assignment List (ICS 204 WF)

<b>1. Incident Name:</b>			<b>3.</b>			
GASQUET COMPLEX			<b>Branch:</b>		<b>Division/Group:</b>	
<b>2. Operational Period:</b> 0600 - 0600					<b>C - COON FIRE</b>	
Date/Time From: 08/13/2015 0600	THU	Date/Time To: 08/14/2015 0600	FRI			
<b>4. Operations Personnel</b>						
<b>OPERATIONS CHIEF</b>		DERRICK DAVIS DARRELL MILLER		<b>DIVISION/GROUP SUPERVISOR</b>		TODD MCDIVITT BRIAN BERRY (T)
<b>PLANNING OPS</b>		MATT CONKLIN AARON THOMPSON (T)		<b>AIR ATTACK SUPERVISOR</b>		CLIFF CLARIDGE KEN MCLAUGHLIN
<b>5. Resources Assigned this Period</b>						
Strike Team / Task Force / Resource Designator		LWD	Leader	Number Persons	Drop Off PT./Time	Pick Up PT./Time
HCM BEAR PEAK O-59		08/23	FRED FLEISCHMAN	9	ICP/0630	ICP/1900
ES3 2141C E-122		08/20	PETE DAVIS	21	ICP/0630	ICP/1900
ENG3 SANTA CLARA VFD 33 E-29		08/19	TYREL HANSEN	4	ICP/0630	ICP/1900
ENG3 SRF 11 E-189		08/24	JOE ENIEM	5	ICP/0630	ICP/1900
HEQB RICH WATERS O-85		08/18		1	ICP/0630	ICP/1900
DOZ2 BROWNING E-44		08/20	PAT BROWNING	1	ICP/0630	ICP/1900
DOZ2 WARNER E-43		08/18	DAN WARNER	3	ICP/0630	ICP/1900
WTT2 WOOD'S 99 E-87		08/15	STEVE WENDT	2	ICP/0630	ICP/1900
WTS2 ALL AGENCY E-38		08/18	JOHN HILL	1	ICP/0630	ICP/1900
WTS2 SIERRA TIMBER E-42		08/19	DOUG LINGEN	1	ICP/0630	ICP/1900
WTS2 WILLS E-138		08/25	PHIL WILLS	1	ICP/0630	ICP/1900
SOFR SCHNEIDER (T) O-90 / BERG (T) O-146		08/20		2	ICP/0630	ICP/1900
FEMP CRADDOCK O-240 / FEMT PESHKIN O-241		08/25		2	ICP/0630	ICP/1900
<b>6. Control Operations/Work Assignments:</b>						
<ul style="list-style-type: none"> <li>• SECURE ALL FIRE WEST OF THE 17N07G ROAD FROM DP 20 TO COON CREEK.</li> <li>• IMPROVE HANDLINE FROM DOZER LINE TO COON CREEK.. • SCOUT FOR SECONDARY CONTINGENCY LINE.</li> </ul>						
<b>7. Special Instructions:</b>						
<ul style="list-style-type: none"> <li>• COORDINATE AND ORDER AIRCRAFT FOR RETARDANT NEEDS WITH AIR ATTACK.</li> <li>• FOBS PIPPIN / HAMER (T) WORKING IN DIV A AND DIV C.</li> </ul>						
<b>8. Division/Group Communication Summary</b>						
Function	Channel	RX Frequency N/W	RX Tone/NAC	TX Frequency N/W	TX Tone/NAC	Mode
COMMAND	1	167.1000	162.2	169.7500	162.2	A
TACTICAL	5	166.7250	162.2	166.7250	162.2	A
BACKUP NET	4	168.1250		170.4750	127.3	A
AIR TO GROUND	10	165.3875		165.3875		A
<b>9. Prepared By (Resource Unit Leader)</b>			<b>Approved By (Planning Section Chief)</b>		<b>Date</b>	<b>Time</b>
JOE SCURI (T)			DAVE LATTIMORE		08/12/2015	2100





## Division/Group Assignment List (ICS 204 WF)

<b>1. Incident Name:</b>			<b>3.</b>			
GASQUET COMPLEX			<b>Branch:</b>		<b>Division/Group:</b>	
<b>2. Operational Period:</b> 0600 - 0600			<b>E - BEAR FIRE</b>			
Date/Time From: 08/13/2015 0600 THU		Date/Time To: 08/14/2015 0600 FRI				
<b>4. Operations Personnel</b>						
<b>OPERATIONS CHIEF</b>		DERRICK DAVIS DARRELL MILLER		<b>DIVISION/GROUP SUPERVISOR</b>		DAVID MARTINEZ JOHN OWINGS (T)
<b>PLANNING OPS</b>		MATT CONKLIN AARON THOMPSON (T)		<b>AIR ATTACK SUPERVISOR</b>		CLIFF CLARIDGE KEN MCLAUGHLIN
<b>5. Resources Assigned this Period</b>						
Strike Team / Task Force / Resource Designator		LWD	Leader	Number Persons	Drop Off PT./Time	Pick Up PT./Time
HC2I GRAYBACK 8B C-5		08/13	TIM NYGREN	20	ICP/0630	ICP/1900
HC2 FORT APACHE 3 C-10		08/20	BURNETTE BENNETT	20	ICP/0630	ICP/1900
TFLD TONY ERICKSON O-232		08/23		1	ICP/0630	ICP/1900
ENG3 UTAH COUNTY 12 E-31		08/19	ANDREW WATSON	4	ICP/0630	ICP/1900
ENG6 NV-WID 2616 E-35		08/19	CHAD NIBLETT	3	ICP/0630	ICP/1900
ENG6 WEBER FIRE 661 E-33		08/19	SCOTT HANEY	3	ICP/0630	ICP/1900
ENG6 GREAT BASIN 311 E-34		08/19	TYLER ERSKINE	3	ICP/0630	ICP/1900
DOZ2 PLUMAS 1 E-126		08/24	JAMES SMITH	4	ICP/0630	ICP/1900
WTS2 YREKA OUTLANDS E-19		08/18	ALLEN WILLIAMS	2	ICP/0630	ICP/1900
WTS1 V&P E-139		08/25		1	ICP/0630	ICP/1900
<del>FAL1 BROWN O-201 / MILLER TIMBER O-204</del>		<del>08/21</del>	<del>D. BROWN / C. GOODSON</del>	<del>4</del>	<del>ICP/0630</del>	<del>ICP/1900</del>
FEMP FELDMAN O-135 / FEMT WICKLAS O-132		08/20		2	ICP/0630	ICP/1900
HEQB Lanterman / Doz2 FSKS						
<b>6. Control Operations/Work Assignments:</b>						
<p>TFLD Balant (T) O-209</p> <ul style="list-style-type: none"> <li>CONTINUE TO HOLD AND IMPROVE LINE ALONG THE 17N03 ROAD. ... CONTINUE DOZER LINE FROM 17N05 DOWN 17N35 RIDGE.</li> <li>CONTINUE PREP FROM DP10 TO 17N04 RD. . IMPROVE ANCHOR POINT AND SECURE HANDLINE CONSTRUCTION ON WEST FLANK.</li> </ul>						
<b>7. Special Instructions:</b>						
<ul style="list-style-type: none"> <li>COORDINATE AND ORDER AIRCRAFT FOR RETARDANT NEEDS WITH AIR ATTACK.</li> </ul>						
<b>8. Division/Group Communication Summary</b>						
Function	Channel	RX Frequency N/W	RX Tone/NAC	TX Frequency N/W	TX Tone/NAC	Mode
COMMAND	1	167.1000	162.2	169.7500	162.2	A
TACTICAL	6	166.7750	162.2	166.7750	162.2	A
BACKUP NET	4	168.1250		170.4750	127.3	A
AIR TO GROUND	10	165.3875		165.3875		A
<b>9. Prepared By (Resource Unit Leader)</b>			<b>Approved By (Planning Section Chief)</b>		<b>Date</b>	<b>Time</b>
KYLE HAUDUCOEUR			DAVE LATTIMORE		08/12/2015	2100

## Division/Group Assignment List (ICS 204 WF)

<b>1. Incident Name:</b>			<b>3.</b>			
GASQUET COMPLEX			<b>Branch:</b>		<b>Division/Group:</b>	
<b>2. Operational Period:</b> 0600 - 0600					<b>G - BEAR FIRE</b>	
Date/Time From: 08/13/2015 0600 THU	Date/Time To: 08/14/2015 0600 FRI					
<b>4. Operations Personnel</b>						
<b>OPERATIONS CHIEF</b>		DERRICK DAVIS DARRELL MILLER		<b>DIVISION/GROUP SUPERVISOR</b>		ERIC PLATZ CHRIS ST PIERRE (T)
<b>PLANNING OPS</b>		MATT CONKLIN AARON THOMPSON (T)		<b>AIR ATTACK SUPERVISOR</b>		CLIFF CLARIDGE KEN MCLAUGHLIN
<b>5. Resources Assigned this Period</b>						
Strike Team / Task Force / Resource Designator		LWD	Leader	Number Persons	Drop Off PT./Time	Pick Up PT./Time
HC2 FORT APACHE 4 C-11		08/20	DANNY EDWARDS	19	ICP/0630	ICP/1900
TFLD JOEL PETERS O-226		08/23		1	ICP/0630	ICP/1900
SKG3 CLEARWATER FIRE E-155		08/26	ED URICK	1	ICP/0630	ICP/1900
FELB CHRIS HENRIE O-181		08/24		1	ICP/0630	ICP/1900
FAL1 NORTH ZONE FALLERS #2 O-95		08/18	BILLY BELMONT	2	ICP/0630	ICP/1900
FAL1 NORTH ZONE FALLERS #4 O-97		08/18	BILL MEADOWS	2	ICP/0630	ICP/1900
FAL1 MCKELLER TREE O-202		08/22	DOUG MCKELLAR	2	ICP/0630	ICP/1900
SOFR BRAD LIDELL O-252		08/25		1	ICP/0630	ICP/1900
ENG 6 Boulder 4333 E-152						
ENG 6 A Bar 613 E-166						
<b>6. Control Operations/Work Assignments:</b>						
<ul style="list-style-type: none"> <li>SCOUT FOR OPPORTUNITIES FOR DIRECT LINE CONSTRUCTION.</li> <li>PREP BEAR BASIN LOOKOUT TOWER AND PRESCOTT CABIN RUINS.</li> <li>CONTINUE LINE PREP FROM BEAR BASIN LOOKOUT DOWN THE SHIP MT RD TO THE WILDERNESS BOUNDARY.</li> </ul>						
<b>7. Special Instructions:</b>						
<ul style="list-style-type: none"> <li>COORDINATE AND ORDER AIRCRAFT FOR <b>WATER ONLY</b> DROPS WITH AIR ATTACK.</li> <li>FOBS SCHEID / BAERTSCHI (T) WORKING IN DIV E AND DIV G.</li> </ul>						
<b>8. Division/Group Communication Summary</b>						
Function	Channel	RX Frequency N/W	RX Tone/NAC	TX Frequency N/W	TX Tone/NAC	Mode
COMMAND	1	167.1000	162.2	169.7500	162.2	A
TACTICAL	7	168.2500	162.2	168.2500	162.2	A
BACKUP NET	4	168.1250		170.4750	127.3	A
AIR TO GROUND	10	165.3875		165.3875		A
<b>9. Prepared By (Resource Unit Leader)</b>			<b>Approved By (Planning Section Chief)</b>		<b>Date</b>	<b>Time</b>
KYLE HAUDUCOEUR			DAVE LATTIMORE		08/12/2015	2100

## Division/Group Assignment List (ICS 204 WF)

<b>1. Incident Name:</b>			<b>3.</b>			
GASQUET COMPLEX			<b>Branch:</b>		<b>Division/Group:</b>	
<b>2. Operational Period:</b> 0600 - 0600					<b>H/L/N/V - PEAK FIRE</b>	
Date/Time From: 08/13/2015 0600	THU	Date/Time To: 08/14/2015 0600	FRI			
<b>4. Operations Personnel</b>						
<b>OPERATIONS CHIEF</b>		DERRICK DAVIS DARRELL MILLER		<b>DIVISION/GROUP SUPERVISOR</b>		CANDICE KUTROSKY PAUL MANDOLINI (T)
<b>PLANNING OPS</b>		MATT CONKLIN AARON THOMPSON (T)		<b>AIR ATTACK SUPERVISOR</b>		CLIFF CLARIDGE KEN MCLAUGHLIN
<b>5. Resources Assigned this Period</b>						
Strike Team / Task Force / Resource Designator	LWD	Leader	Number Persons	Drop Off PT./Time	Pick Up PT./Time	
TFLD GREGORY COX O-74	08/18		1	ICP/0630	ICP/1900	
TFLD DALE NEWBY (T) O-73	08/18		1	ICP/0630	ICP/1900	
ENG3 TRI CITY 106 E-25	08/19	ANTHONY GRAINGER	4	ICP/0630	ICP/1900	
ENG3 MONTANA FIRE 341 E-30	08/20	MIKE WARREN	3	ICP/0630	ICP/1900	
ENG4 FIRESTORM 03 E-114	08/14	BRAD CLEMENS	3	ICP/0630	ICP/1900	
ENG4 CENTRAL WILDFIRE 741 E-116	08/14	DAVID PARSON	3	ICP/0630	ICP/1900	
ENG6 SANTA CLARA 32 E-37	08/19	GABE RUNOLFSON	2	ICP/0630	ICP/1900	
WTS2 ROGER CHERRY E-140	08/25	ROGER CHERRY	1	ICP/0630	ICP/1900	
FAL1 Brown						
FAL1 Miller						
---CONTINUED ON PG 2---						
<b>8. Division/Group Communication Summary</b>						
Function	Channel	RX Frequency N/W	RX Tone/NAC	TX Frequency N/W	TX Tone/NAC	Mode
COMMAND	1	167.1000	162.2	169.7500	162.2	A
TACTICAL	8	168.0500	162.2	168.0500	162.2	A
BACKUP NET	4	168.1250		170.4750	127.3	A
AIR TO GROUND	10	165.3875		165.3875		A
<b>9. Prepared By (Resource Unit Leader)</b>			<b>Approved By (Planning Section Chief)</b>		<b>Date</b>	<b>Time</b>
KYLE HAUDUCOEUR			DAVE LATTIMORE		08/12/2015	2100

## Division/Group Assignment List (ICS 204 WF)

<b>1. Incident Name:</b>			<b>3.</b>			
GASQUET COMPLEX			<b>Branch:</b>		<b>Division/Group:</b>	
<b>2. Operational Period:</b> 0600 - 0600					<b>H/L/N/V - PEAK FIRE</b>	
Date/Time From: 08/13/2015 0600 THU			Date/Time To: 08/14/2015 0600 FRI			
<b>4. Operations Personnel</b>						
<b>OPERATIONS CHIEF</b>		DERRICK DAVIS DARRELL MILLER		<b>DIVISION/GROUP SUPERVISOR</b>	CANDICE KUTROSKY PAUL MANDOLINI (T)	
<b>PLANNING OPS</b>		MATT CONKLIN AARON THOMPSON (T)		<b>AIR ATTACK SUPERVISOR</b>	CLIFF CLARIDGE KEN MCLAUGHLIN	
<b>5. Resources Assigned this Period</b>						
<b>Strike Team / Task Force / Resource Designator</b>	<b>LWD</b>	<b>Leader</b>	<b>Number Persons</b>	<b>Drop Off PT./Time</b>	<b>Pick Up PT./Time</b>	
TFLD STEVE SISCOE O-79	08/20		1	ICP/0630	ICP/1900	
<del>TFLD NICHOLAS BALENT (T) O-209</del>	<del>08/21</del>		<del>1</del>	<del>ICP/0630</del>	<del>ICP/1900</del>	
ENG3 SRM 331 E-76	08/14	MIKE AVERY	4	ICP/0630	ICP/1900	
ENG3 CRK 379 E-77	08/14	JOHN ANGELL	4	ICP/0630	ICP/1900	
ENG3 PICTURE ROCK 121 E-26	08/20	ROCKY ORTIZ	4	ICP/0630	ICP/1900	
ENG6 GRAND JUNCTION BR 3 E-151			3	ICP/0630	ICP/1900	
ENG6 MONTROSE HELL FIGHTERS E-148	08/26	JASON HOBBY	3	ICP/0630	ICP/1900	
WTS2 TRAYNHAM TRUCKING E-137	08/25	DAVE DAMON	1	ICP/0630	ICP/1900	
FEMP MATT LUCAS O-137	08/20		1	ICP/0630	ICP/1900	
FEMT TONY CASTANEDA O-131	08/20		1	ICP/0630	ICP/1900	
<b>6. Control Operations/Work Assignments:</b>						
<ul style="list-style-type: none"> <li>KEEP FIRE NORTH AND EAST OF G-O ROAD IF POSSIBLE.</li> <li>FOLLOW THE MINIMUM REQUIREMENT DIRECTION OF 8-11-15.</li> </ul>						
<b>7. Special Instructions:</b>						
<ul style="list-style-type: none"> <li>ALL RESOURCES USE CALL SIGN "LIMA"</li> <li>COORDINATE AND ORDER AIRCRAFT FOR <u>WATER ONLY</u> DROPS WITH AIR ATTACK.</li> <li>MONITOR SUMMIT &amp; WILLIAMS FIRES BY AIR</li> <li>RAPID EXTRACTION MODULE (R.E.M.) AVAILABLE TO ALL DIV'S &amp; GRP'S.</li> </ul>						
<b>8. Division/Group Communication Summary</b>						
<b>Function</b>	<b>Channel</b>	<b>RX Frequency N/W</b>	<b>RX Tone/NAC</b>	<b>TX Frequency N/W</b>	<b>TX Tone/NAC</b>	<b>Mode</b>
COMMAND	1	167.1000	162.2	169.7500	162.2	A
TACTICAL	8	168.0500	162.2	168.0500	162.2	A
BACKUP NET	4	168.1250		170.4750	127.3	A
AIR TO GROUND	10	165.3875		165.3875		A
<b>9. Prepared By (Resource Unit Leader)</b>			<b>Approved By (Planning Section Chief)</b>		<b>Date</b>	<b>Time</b>
KYLE HAUDUCOEUR			DAVE LATTIMORE		08/12/2015	2100

## Division/Group Assignment List (ICS 204 WF)

<b>1. Incident Name:</b>			<b>3.</b>			
GASQUET COMPLEX			<b>Branch:</b>		<b>Division/Group:</b>	
<b>2. Operational Period:</b> 0600 - 0600					<b>W - FEEDER FIRE</b>	
Date/Time From: 08/13/2015 0600 THU			Date/Time To: 08/14/2015 0600 FRI			
<b>4. Operations Personnel</b>						
<b>OPERATIONS CHIEF</b>		DERRICK DAVIS DARRELL MILLER		<b>DIVISION/GROUP SUPERVISOR</b>		GLENN WEBB AL WARD (T)
<b>PLANNING OPS</b>		MATT CONKLIN AARON THOMPSON (T)		<b>AIR ATTACK SUPERVISOR</b>		CLIFF CLARIDGE KEN MCLAUGHLIN
<b>5. Resources Assigned this Period</b>						
Strike Team / Task Force / Resource Designator		LWD	Leader	Number Persons	Drop Off PT./Time	Pick Up PT./Time
HC2I WHITE MOUNTAIN #1 C-3		08/19	KEITH M SARGENT	19	ICP/0630	ICP/1900
TFLD HYATT O-144 / OLEARY O-234		08/16		2	ICP/0630	ICP/1900
ENG2 GASQUET 214 E-78		08/14	TOM ZURFLUEH	4	ICP/0630	ICP/1900
ENG4 WEBER FIRE DISTRICT 464 E-80		08/14	BARRY LOCKE	4	ICP/0630	ICP/1900
ENG6 TONTO 1247 E-82		08/16	SHAWN O'CONNELL	7	ICP/0630	ICP/1900
ENG6 AMERICAN FIRE CO 61 E-86		08/14	MATT MORRELL	3	ICP/0630	ICP/1900
ENG6 AMERICAN FIRE CO 62 E-85		08/14	MANI MORRELL	3	ICP/0630	ICP/1900
HEQB HARRIS O-218 / EXCA WALBERG, INC E-57		08/25		3	ICP/0630	ICP/1900
HEQB MCCLELLAN O-216 / DOZZ A TEAM E-127		08/24		5	ICP/0630	ICP/1900
WTT2 SRF 15 E-45		08/16	JACOB MC ADAMS	2	ICP/0630	ICP/1900
WTT2 GASQUET VFD E-88		08/15	SALENA COX	2	ICP/0630	ICP/1900
FAL1 NORTH ZONE FALLERS #3 O-96		08/18	RICK MEE	2	ICP/0630	ICP/1900
<b>6. Control Operations/Work Assignments:</b>						
<ul style="list-style-type: none"> <li>• CONTINUE TO PREP, SECURE &amp; HOLD FIRE ALONG 14N39 RD FROM DP 30 NORTH TO THE 14N39G RD.</li> </ul>						
<b>7. Special Instructions:</b>						
<ul style="list-style-type: none"> <li>• COORDINATE AND ORDER AIRCRAFT FOR RETARDANT NEEDS WITH AIR ATTACK.</li> <li>• RAPID EXTRACTION MODULE (R.E.M.) AVAILABLE TO ALL DIVISIONS AND CONTINGENCY GROUP</li> </ul>						
<b>8. Division/Group Communication Summary</b>						
Function	Channel	RX Frequency N/W	RX Tone/NAC	TX Frequency N/W	TX Tone/NAC	Mode
COMMAND	1	167.1000	162.2	169.7500	162.2	A
TACTICAL	12	166.5500	162.2	166.5500	162.2	A
BACKUP NET	4	168.1250		170.4750	127.3	A
AIR TO GROUND	10	165.3875		165.3875		A
<b>9. Prepared By (Resource Unit Leader)</b>			<b>Approved By (Planning Section Chief)</b>		<b>Date</b>	<b>Time</b>
KYLE HAUDUCOEUR			DAVE LATTIMORE		08/12/2015	2100

## Division/Group Assignment List (ICS 204 WF)

<b>1. Incident Name:</b>			<b>3.</b>			
GASQUET COMPLEX			<b>Branch:</b>		<b>Division/Group:</b>	
<b>2. Operational Period:</b> 0600 - 0600			<b>Z - FEEDER FIRE</b>			
Date/Time From: 08/13/2015 0600 THU		Date/Time To: 08/14/2015 0600 FRI				
<b>4. Operations Personnel</b>						
<b>OPERATIONS CHIEF</b>		DERRICK DAVIS DARRELL MILLER		<b>DIVISION/GROUP SUPERVISOR</b>		ADAM KOHLEY ROBERT ALLAN (T)
<b>PLANNING OPS</b>		MATT CONKLIN AARON THOMPSON (T)		<b>AIR ATTACK SUPERVISOR</b>		CLIFF CLARIDGE KEN MCLAUGHLIN
<b>5. Resources Assigned this Period</b>						
Strike Team / Task Force / Resource Designator		LWD	Leader	Number Persons	Drop Off PT./Time	Pick Up PT./Time
HC1 SMITH RIVER C-29		08/23	TIM MEMMER	19	ICP/0630	ICP/1900
HC2I NHS#1 C-4		08/19	JOHN ROSS	20	ICP/0630	ICP/1900
HCM SLATE MOUNTAIN O-245		08/26	STEVE REYES	10	ICP/0630	ICP/1900
TFLD CATHLEEN LOWE O-76		08/19		1	ICP/0630	ICP/1900
ENG3 LONE PEAK 1667 E-27		08/19	TOM WILSON	7	ICP/0630	ICP/1900
ENG3 BLACK HILLS 381 E-146		08/26	BRANDON SELK	5	ICP/0630	ICP/1900
ENG6 GRAND COUNTY 6802 E-36		08/19	MARK MARCUM	2	ICP/0630	ICP/1900
ENG6 SUNDANCE BR3 E-169		08/25	DANA LAW	3	ICP/0630	ICP/1900
HEQB ANDERSON O-215 / DOZZ JA COOK E-170		08/24		3	ICP/0630	ICP/1900
WTS2 BOWNE WATER SERVICE E-40		08/17	MICHAEL BOONE	1	ICP/0630	ICP/1900
FAL1 CECIL LOGGING O-203		08/22	MICHEAL BERRY	2	ICP/0630	ICP/1900
SOFR PETE VILLA O-68		08/19		1	ICP/0630	ICP/1900
<b>6. Control Operations/Work Assignments:</b>						
<ul style="list-style-type: none"> <li>CONTINUE PREP WORK ON G-O ROAD, FROM W / Z BREAK NORTH TO 15N01U ROAD.</li> <li>CONTINUE DOZER / HANDLINE FROM G-O ROAD TO W / Z BREAK.</li> </ul>						
<b>7. Special Instructions:</b>						
<ul style="list-style-type: none"> <li>COORDINATE AND ORDER AIRCRAFT FOR RETARDANT NEEDS WITH AIR ATTACK.</li> <li>RAPID EXTRACTION MODULE (R.E.M.) AVAILABLE TO ALL DIVISIONS AND CONTINGENCY GROUP.</li> <li>FOBS RICK / TWEED (T) WORKING IN DIV W AND DIV Z.</li> </ul>						
<b>8. Division/Group Communication Summary</b>						
Function	Channel	RX Frequency N/W	RX Tone/NAC	TX Frequency N/W	TX Tone/NAC	Mode
COMMAND	1	167.1000	162.2	169.7500	162.2	A
TACTICAL	9	168.6000	162.2	168.6000	162.2	A
BACKUP NET	4	168.1250		170.4750	127.3	A
AIR TO GROUND	10	165.3875		165.3875		A
<b>9. Prepared By (Resource Unit Leader)</b>			<b>Approved By (Planning Section Chief)</b>		<b>Date</b>	<b>Time</b>
JOE SCURI (T)			DAVE LATTIMORE		08/12/2015	2100



## INCIDENT RADIO COMMUNICATIONS PLAN (ICS 205)

<b>1. Incident Name:</b> GASQUET COMPLEX	<b>2. Date/Time Prepared:</b> Date: 08/12/2015 Time: 2100	<b>3. Operational Period:</b> 0600 - 0600
		Date/Time From: 08/13/2015 0600
		THU
		Date/Time To: 08/14/2015 0600
		FRI

4. Basic Radio Channel Use:										
Zone Group	Ch #	Function	Channel Name/Trunked Radio System Talkgroup	Assignment	RX Freq	RX Tone/NAC	TX Freq	TX Tone/NAC	Mode (A, D, or M)	Remarks
	1	COMMAND	CMD 1	ALL DIVISIONS	167.1000	162.2	169.7500	162.2	A	SHIP MTN
	2	COMMAND	CMD 2	UNASSIGNED	000.0000		000.0000		A	
	3	COMMAND	CMD 3	UNASSIGNED	000.0000		000.0000		A	
	4	BACKUP NET	SRE ADM	ALL DIVISIONS	168.1250		170.4750	127.3	A	GORDON MTN
	5	TACTICAL	NIFC T5	DIV C	166.7250	162.2	166.7250	162.2	A	
	6	TACTICAL	NIFC T6	DIV E	166.7750	162.2	166.7750	162.2	A	
	7	TACTICAL	NIFC T7	DIV G	168.2500	162.2	168.2500	162.2	A	
	8	TACTICAL	NIFC T1	DIV H/I/L/N/V	168.0500	162.2	168.0500	162.2	A	CALL SIGN DIV L
	9	TACTICAL	NIFC T3	DIV Z	168.6000	162.2	168.6000	162.2	A	
	10	AIR TO GROUND	AG TAC	ALL DIVISIONS	165.3875		165.3875		A	
	11	AIR TO GROUND	AG CMD	UNASSIGNED	000.0000		000.0000		A	
	12	TACTICAL	R5 TAC 4	DIV W	166.5500	162.2	166.5500	162.2	A	
	13	TACTICAL	R5 TAC 5	DIV A	167.1125	162.2	167.1125	162.2	A	
	14	TACTICAL	R5 TAC 6	DIV D	168.2375	162.2	168.2375	162.2	A	
	15	EMS TAC	CALCORD	ALL DIVISIONS	156.0750		156.0750	156.7	A	MEDICAL A/G
	16	AIR GUARD	GUARD	ALL DIVISIONS	168.6250		168.6250	110.9	A	EMERGENCY ONLY
	20	AIR GUARD	GUARD	ALL DIVISIONS	168.6250		168.6250	110.9	A	EMERGENCY ONLY

<b>6. Prepared By</b> (Communications Unit Leader)	Name: CHRIS PERRY (T)
ICS 205	Signature: 
IAP Page	Date/Time: 08/12/2015 2100



# AIR OPERATIONS SUMMARY

PREPARED BY: Ted Visser



PREPARED DATE/TIME: 08/12/15 1900

1. INCIDENT NAME: Gasquet Complex		2. OPERATIONAL PERIOD DATE: 08/13/15		START TIME: 0700	END TIME: 2000	SUNRISE: 0622	SUNSET: 2021
3. REMARKS (Safety Notes, Hazards, Air Operations Special Equipment, etc.) Thunderstorms, erratic winds. Low wires, cables, power lines. Divisions, contact Helibase for all aviation needs, include coordinates of possible helispot/unimproved landing locations. Possible smoke concerns. Track all retardant usage and location if used. Do not dip from lakes near 41 35.000 x 123 43.00 IP for Air Tankers 41 47.21 X 123 04.40 5000' Cave HB Gate 10155# Six Rivers Disp. Air Desk 707-726-1266						4. MEDEVAC A/C: 512	
Bear Fire Div E, 41 48.928 123 44.678 Coon Fire Div C, 41 45.786 123 57.709 Feeder Fire Div W, 41 35.065 123 50.726 Peak Fire Div L, 41 33.065 123 46.134 Summit Fire Div V, 41 35.000 123 47.800 Williams Fire Div H, 41 35.290 123 45.621						5. TFR: 5/0539 Radius: 10 NM Altitude: 9000 MSL Centerpoint: N 41 41.57 W 123 49.05 Freq: 128.0750 Illinois Valley Tower Freq: 133.275	

6. PERSONNEL	Phone	7. FREQUENCIES	AM	FM	8. FIXED-WING	# Avail / Type / Make-Model / FAA # / Base(s)
AOBD: Ted Visser	619-981-2409	AIR/AIR FW:		166.4500	Airtankers:	Available through Dispatch SEAT 818, SEAT 886
ASGS: Galen Young	575-574-8720	AIR/AIR RW:	128.0750		Leadplanes:	Available through Dispatch
ATGS: Ken McLaughlan	813-997-0317	AIR/GROUND CMD: AIR/GROUND TAC:		165.3875	ATBase:	
ATGS: Cliff Claridge	480-688-5330	COMMAND: RX: TX:		167.1000 169.7500 Tone 15 162.2	ATGS Aircraft:	N 4579N, A-6 Claridge N 285 , A-65 McLaughlan
HEB1: Melvin Tate	850-849-0405				AAB:	MRB: ICL, Joe Hart, 208-699-1166
HEB1(T): Rita Clipperton	530-559-0905	DECK:		163.100		Cave- HOS Trlr, E-2, Chris Long, 208-539-7108 Cave- 49er WT, E-41 Bobby Alvarez, 619-300-0801 Cave Helibase 541-592-2852, FAX 541-592-3798
SEAT:		AIR GUARD:		168.6250		

## 9. HELICOPTERS (Use Additional Sheets As Necessary)

FAA #	TY	MAKE/MODEL	BASE	AVAILABLE	START	REMARKS	FAA #	TY	MAKE/MODEL	BASE	AVAILABLE	START	REMARKS
HT-702	1	S-61	Cave	0730	0830	A-20							
HT-782	1	S-64	Cave	0730	0830	A-62							
512	2	Bell 212	Cave	0730	0830	A-42							
517	2	Bell 205	Cave	UNK	UNK	A-57 Restricted							
988B	3	Bell L4	Cave	0730	0830	A-28							

<b>MEDICAL PLAN</b>	1. INCIDENT NAME <b>Gasquet Complex</b>	2. DATE PREPARED 8/12/15	3. TIME PREPARED 1730	4 OPERATIONAL PERIOD 8/13-14/2015 0600-0600
---------------------	--	-----------------------------	--------------------------	---

**5. INCIDENT MEDICAL AID STATIONS**

MEDICAL AID STATIONS	LOCATION	PARAMEDIC	
		YES	NO
Medical Supply	Base Camp		X

**TRANSPORTATION**

**A. Air Ambulances**

NAME	ADDRESS	PHONE	PARAMEDIC	
			YES	NO
National Guard H-825 (Day/Night, Hoist)	Redding Airport, CA	Communications	X	
CHP H-14 (Day/Night, Hoist)	Redding Airport, CA	(530) 842-3515	X	
Coast Guard (Day/Night, Hoist)	Air Station Humboldt Bay, CA	(707) 839-6100		X
CalFire Kneeland Helitack H-102 (Hoist capable)	Kneeland Station, CA	(707) 441-2863		X
Reach 5 Air Medical	Redding, CA	1-800-338-4045	X	
Mercy Air Ambulance 105	Medford, Oregon	1-800-903-9000	X	
PHI Air Medical	Redding, CA	1-800-597-9571	X	

**B. Ground Ambulances**

Del Norte Ambulance, Station 2	2600 Morehead Rd Crescent City CA	Communications	X	
--------------------------------	-----------------------------------	----------------	---	--

**C. Rapid Extraction Modules**

R.E.M. – South	Gasquet South Operations	Communications		X
----------------	--------------------------	----------------	--	---

**7. HOSPITALS**

NAME	ADDRESS	TRAVEL TIME		PHONE	HELIPAD		BURN CENTER	
		AIR	GRND		YES	NO	YES	NO
Sutter Coast Hospital	800 E Washington Crescent City CA.		25min	ER: 707-464-8888 Gen: 707-464-8511		X		X
Mercy Med. Center Level 3 Trauma	914 Pine St. Mt. Shasta, CA. N. 40 34.14 x W. 122 23.97	45m	4.5hr	(530)926-9360	X			X
Rogue Valley Med Center Level 2 Trauma	2825 Barnett Rd. Medford, OR. N. 42 19.092 W. 122 49.833	30m	2 hr	(541)789-7100	X			X
UC Davis Med Center Level 1 Trauma Burn Center	2315 Stockton Blvd. Sacramento, CA N. 38 33.3 x W. 121 27.3	2hr	7.0hr	(916) 734-3636 Burn Center (916) 734-3790 ER	X		X	

**8. MEDICAL EMERGENCY PROCEDURES**

**In the event of a medical emergency provide the following information to your Divs or Gasquet Communications on Command.**

1. Declare the nature of the emergency.
  - a. Medical injury/illness?
  - b. Is injury/illness life threatening?
2. If life threatening, then request that the designated frequency be cleared for emergency traffic.
3. Identify the on-scene Point of Contact (POC) by resource and last name (i.e POC is TFLD Smith).
4. Identify nature of incident, number injured, patient assessment(s) and location (geographic and GPS coordinates).
5. Identify on-scene medical personnel by position and name (i.e EMT Jones).
6. Identify preferred method of patient transport.
7. Request any additional resources and/or equipment needed
8. Document all information received and transmitted on the radio or phone.
9. Identify any changes in the on-scene Point of Contact or medical personnel as they occur.

**INJURY REPORTING PROCEDURES**

NATURE OF INJURY \_\_\_\_\_ # of Patients \_\_\_\_\_

TRANSPORTATION NEEDED Air \_\_\_\_\_ Ground \_\_\_\_\_

REM Needed Y \_\_\_ N \_\_\_ Estimated Air Temp \_\_\_\_\_

LAT \_\_\_\_\_ LONG \_\_\_\_\_ Elevation \_\_\_\_\_

Specific Hazards In Area \_\_\_\_\_

PATIENT UNIT ID \_\_\_\_\_

**REMINDER: DO NOT GIVE PT NAME OVER RADIO**

IS MEDICAL PERSONNEL WITH PATIENT: YES \_\_\_ NO \_\_\_

AGE \_\_\_ SEX: MALE \_\_\_ FEMALE \_\_\_

**ALL EMERGENCIES—Secure the area and identify witnesses for later investigation. Keep an accurate log of events.**

ICS 206 8-78	9. PREPARED BY (MEDICAL UNIT LEADER) Gena Fowlkes MEDL (909) 762-9032	10. REVIEWED BY (SAFETY OFFICER) James Aragon SOF2
--------------	--	---

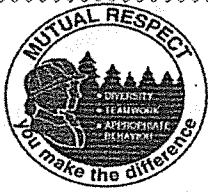

## Human Resource and Training Message

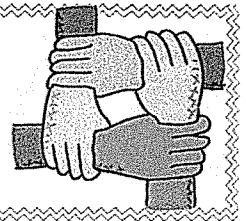

Please come and Join us  
on Thursday Night, August 13, 2015  
from 1800-2000

Training and HRSP will have a table between the  
Caterer's tent and Supply:

- We are going to be there to answer any questions you may have in reference to your training or any other questions.
- We will also have a "where are you from" activity.
- Also Remember, it is close to Demob and we want to make sure you get your training experience credited and documented.
  - Taskbooks with information recorded for incident
  - Trainee's Personnel Performance Rating for ICS 225 completed
  - Incident Trainee Interview (provided by TNSP)

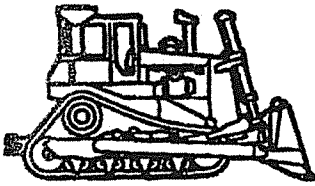

# SAFETY MESSAGE



"Adapt...Improvise...and Overcome"



**Incident:** Gasquet Complex

**Date / Operational Period:** 8/13-14/15

## MAJOR HAZARDS AND RISKS

- |   |   |
|---|---|
| <ul style="list-style-type: none"> <li>• Ongoing air operations. Refer to aviation blue pages in your IRPG for retardant and bucket drop safety tips.</li> <li>• Communications... conduct communications checks up and down your operational structure</li> <li>• Dehydration—Drink lots of water</li> </ul> | <ul style="list-style-type: none"> <li>• Rocky, rough terrain--falls/slips</li> <li>• Snags!!! Rolling Rocks!!!</li> <li>• Driving, backing and turning around on narrow, washboard mountain roads- watch for soft shoulders</li> <li>• Fast moving traffic on HWY 199 – take extra time to check for oncoming traffic prior to driving onto highway</li> </ul> |
|---|---|

## *Working with Heavy Equipment*

- When working around heavy equipment in timber, keep a distance of 2 ½ times the canopy height away from the equipment.
- Never approach equipment until you have eye contact with the operator, all implements have been lowered to the ground and equipment is idled down.
- Avoid working below equipment where rolling material could jeopardize your safety.
- Establish visual communication methods prior to engaging.
- Communicate all hazards to the operator (spot fires, firing operations, and obstacles).
- Equipment operators have difficulty seeing ground personnel; take responsibility for your safety and all those around you.
- Watch for heavy equipment being transported on or working on narrow forest roads. Traffic guards or road closures may need to be implemented in areas with active heavy equipment operations.
- The root systems of green trees are in a weak state due to the drought. This can result in trees coming down with little effort or push by machinery. Brief crews on this condition so that they can plan accordingly.

**Prepared By:**

*Fred Hernandez, Safety Officer (r)*

**Approved By:**

*James Aragon, Safety Officer*

## INCIDENT SAFETY ANALYSIS 215a

Gasquet Complex - Thursday, August 13, 2015

8. Location	9. Hazard	6. Control or Abatement Action (Engineering, Administrative, PPE, Avoidance, Education, etc.)
All	Hazard Trees	<ul style="list-style-type: none"> <li>~ Follow "Hazard Tree Safety" guidelines, IRPG pages 22 &amp; 23</li> <li>~ Post lookouts, or use a spotter in mop-up areas with personnel</li> <li>~ Don't park vehicles or take breaks in high concentrations of hazard trees</li> <li>~ Establish trigger points for disengagement during high wind events</li> </ul>
All	Air Operations	<ul style="list-style-type: none"> <li>~ Follow "Aviation Watch-Out Situations" on page 44, IRPG</li> <li>~ Don't plan on air resources for medical transport or resupply.</li> <li>~ Refer to page 57, IRPG for directing bucket drops.</li> <li>~ Ensure positive communication with all air resources.</li> </ul>
All	Chain Saw Operations	<ul style="list-style-type: none"> <li>~ Follow "Hazard Tree Safety" guidelines, IRPG pages 22 &amp; 23</li> <li>~ Look up, down around for hazard tree indicators</li> <li>~ Only fell and buck trees within your expertise, and training</li> <li>~ Follow "Procedural Felling Operations" on page 79 in IRPG</li> <li>~ Do not fall trees during high wind events</li> </ul>
All	Steep Terrain & Rolling Debris	<ul style="list-style-type: none"> <li>~ Maintain 8'-10' spacing when working &amp; walking</li> <li>~ Don't work above any personnel</li> <li>~ Evaluate necessity to send personnel in areas with limited access</li> </ul>
All	Driving & Traffic	<ul style="list-style-type: none"> <li>~ Practice "Defensive Driving" techniques traveling on all roads and city streets, mitigation strategy includes:               <ul style="list-style-type: none"> <li>~ Use spotters when backing</li> <li>~ Honk horn to alert personnel when backing</li> <li>~ Always use headlights</li> <li>~ Yield to pedestrians and bicycles</li> <li>~ Observe posted speed limits</li> <li>~ Follow 3 second rule of following distance when driving</li> <li>~ Use chock blocks, turn wheels into hill</li> </ul> </li> </ul>
All	Firing Operations & Devices	<ul style="list-style-type: none"> <li>~ Only personnel trained in the use of each device will be authorized to use firing equipment.</li> <li>~ Ensure all personnel are aware of firing operation that may affect them.</li> <li>~ Wear appropriate PPE.</li> <li>~ Ensure aerial/ground ignition plans have been adequately developed and personnel are briefed.</li> </ul>
All	Injury & Medical Emergency	<ul style="list-style-type: none"> <li>~ Assist injured employee appropriate medical care</li> <li>~ Use EMT's on Division for initial care</li> <li>~ Follow medical protocol as outlined in ICS-206</li> </ul>
All	Bees, Ticks, Mosquitoes	<ul style="list-style-type: none"> <li>~ Be aware of crew members with sting allergies.</li> <li>~ Ensure crew members have medication pens if needed.</li> <li>~ Perform daily self inspection</li> <li>~ Use repellent as necessary</li> </ul>
All	Poisonous Plants	<ul style="list-style-type: none"> <li>~ Identify and Avoid hazard areas</li> <li>~ Launder clothing</li> <li>~ Shower frequently</li> </ul>
A,C,E,W	Heavy Equipment Operations	<ul style="list-style-type: none"> <li>~ Ensure communications are established with operators</li> <li>~ Use hand signals if other communications are unavailable</li> <li>~ Maintain a 50'-100' exclusion area around equipment</li> <li>~ Use a spotter when backing</li> </ul>



## **Incident within an Incident Action Plan**

### **Position Assignment Supportive Actions**

#### **Division Supervisor**

- See items 1-6 on page one
- If unable to access accident/incident location, delegate command to a closer qualified resource

#### **Medical Unit Leader**

- Respond to Comm Unit as soon as possible
- Coordinate with Division Supervisor to ensure proper resources are rapidly ordered
- Assign a MEDL to the scene and other positions to support the response as needed
- Monitor condition updates of patient(s) and coordinate response with Operations

#### **Communications Unit Leader**

- Maintain clear radio traffic and monitor communications to support response
- Recommend appropriate security and investigative process
- Assess the need for critical Incident Stress Response

#### **Safety Officer**

- Provide for Safety personnel on scene as needed
- Recommend appropriate security and investigative process
- Assess the need for critical Incident Stress Response

#### **Air Attack Supervisor**

- Obtain coordinates of the emergency location
- Coordinate air-medical response
- Assist and support the designated Point of Contact with communications and coordination of the emergency response as necessary

#### **IC, Command & General Staff**

- Manage the emergency and direct specific responsibilities to individual positions to provide an appropriate response
- Notify the host unit and host dispatch center of the size-up information
- Constantly monitor and assess the appropriate response and adapt direction as needed
- Submit all documentation pertaining to the emergency to the Plans Chief

Reference the full Incident Medical Emergency Plan for additional



## Incident within an Incident Action Plan

### When the scope or complexity of the emergency exceeds division resource needs

This plan is designed to identify the initial actions that should be taken by the first arriving personnel on a serious accident. This person may be a single resource, engine boss, or a crew boss. Accidents or incidents within an incident happen rapidly and require sound, calm initial decisions to handle the problem, while still focusing on the main incident. The following checklist provides some key thoughts and actions.

The first arriving person to any accident should notify their Division Supervisor, or the Div Sup assigned to that location.

#### Advise of the critical information needed:

- Accident scene safety assessment and advise incoming personnel
- Number of injuries and their severity
- Special equipment needs (extrication, low/high angle rescue, fire protection or suppression)
- Assist the injured as necessary without endangering yourself or other personnel
- Do not move trauma victims unless their safety is in jeopardy
- Utilize PINK pages of the Incident Response Pocket Guide (IRPG) for patient assessment/medical procedures

#### Remain aware of surroundings and delegate personnel to monitor the main fire

The Division Supervisor will assume command of the accident/incident scene upon arrival. The following list outlines the general duties and tasks that should be completed on most accidents/incidents.

1. Delegate division oversight to another Division Supervisor or other qualified person.
2. Request a clear frequency from Comm and consider switching to designated Emergency Tactical (Incident Comm will notify the MEDL who will initiate the medical plan for injuries)
3. Order/delegate resources appropriate for the accident/incident (crew EMT's, Line EMT's or Line Medics, rescue equipment, patient transport needs, manpower)
4. Notify Operations Section Chief and Safety Officer on all accidents/incidents.
5. Begin to document the event accurately and completely. Use ICS form 201 if the event is large or complex.
6. Protect the scene for Investigators

Reference the full Incident Medical Emergency Plan for additional

**Mountain School**  
 55 Azalea Lane  
 Gasket, CA 95543  
 (707) 457-3211

# ICP

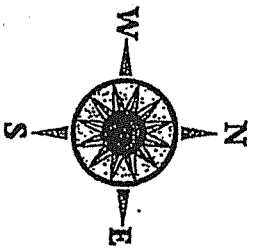

P	Portable	Fire Alarm Panel
C	Classroom	Water Shut Off
Exit/Door	Exit/Door	Electrical Shut Off
Fire Extinguisher	Fire Extinguisher	

071410/Silo Maps/Del Norte

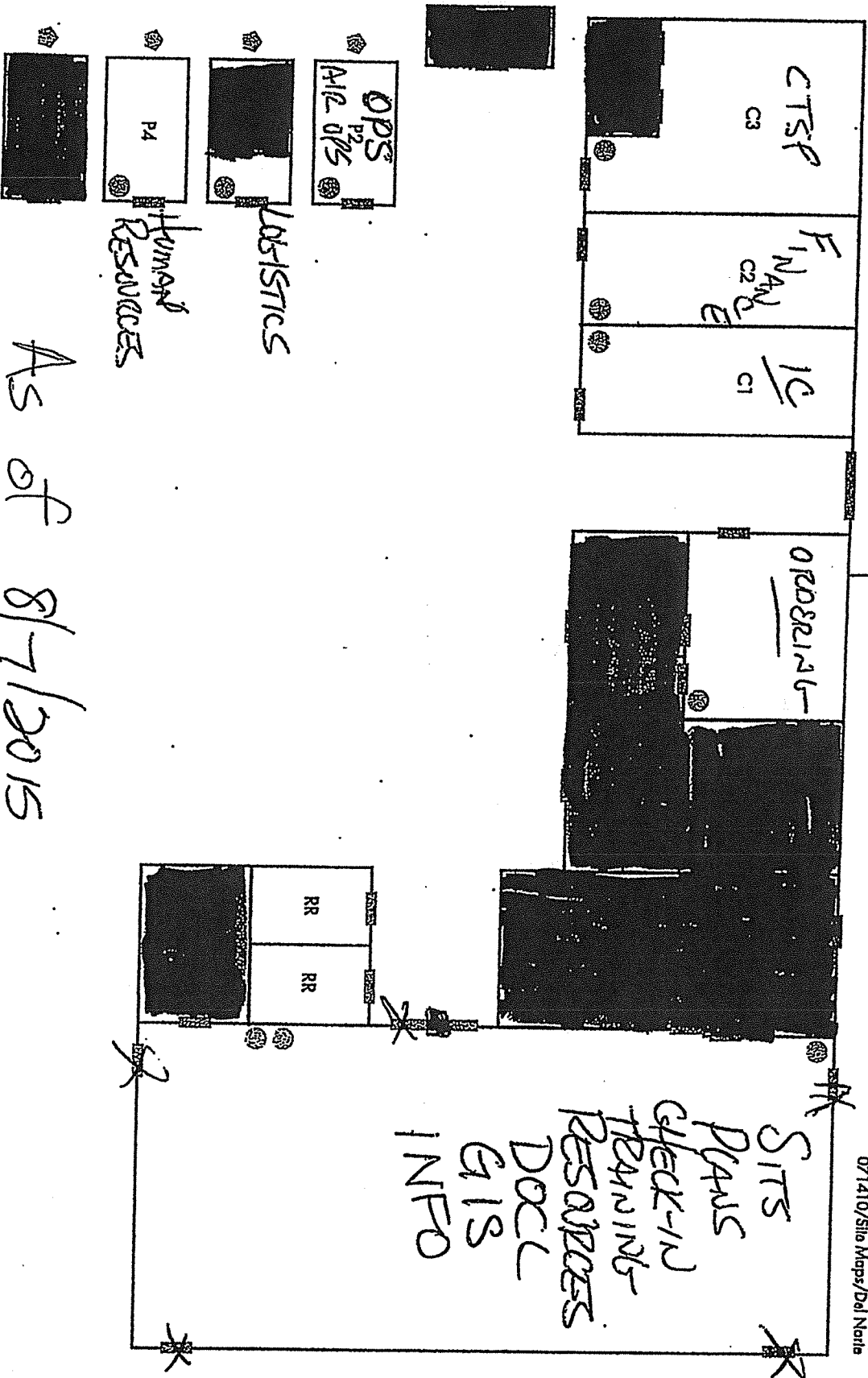

As of 8/7/2015



# GASQUET COMPLEX BASE CAMP

Updated 08/10/2015

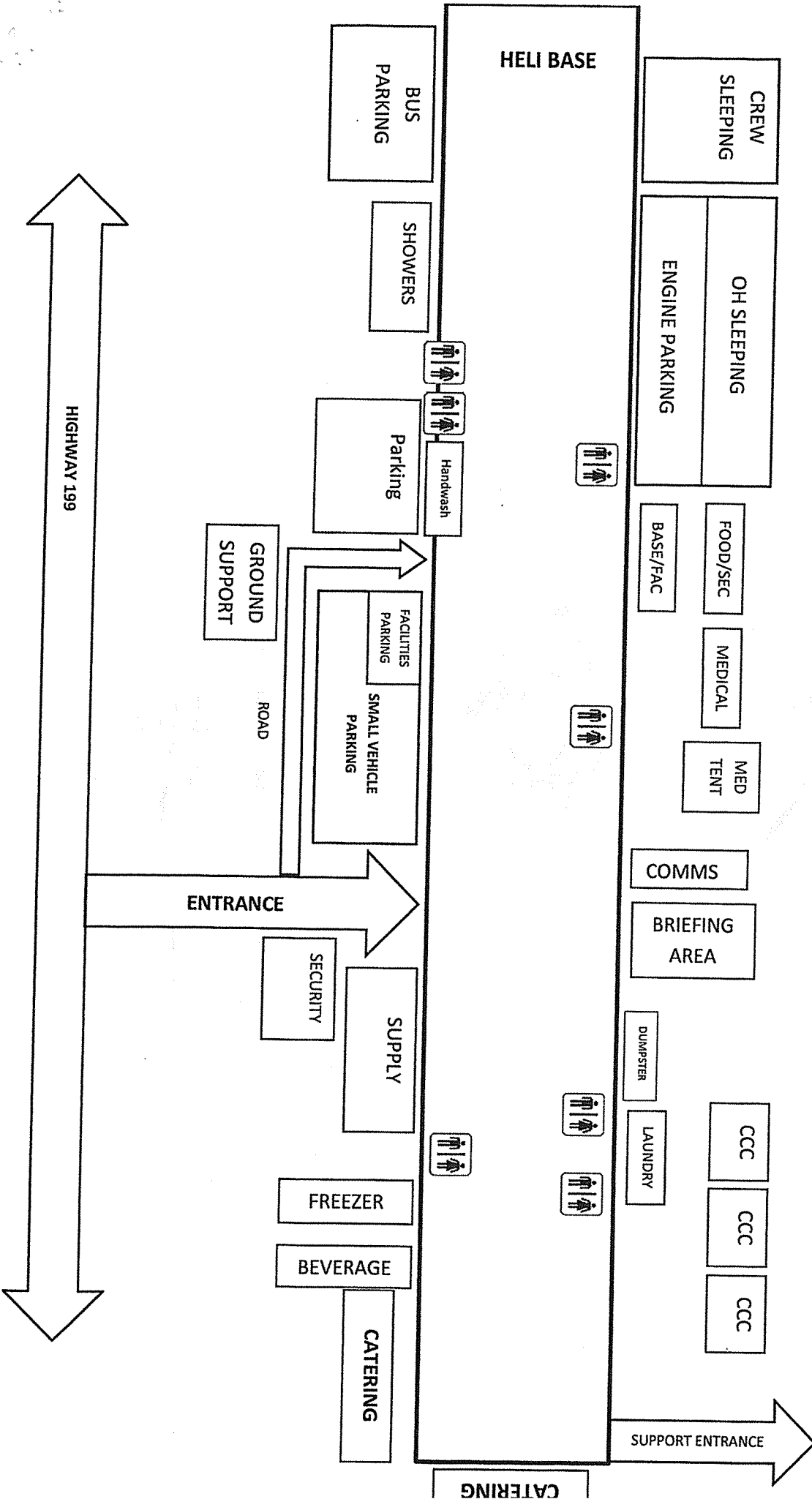
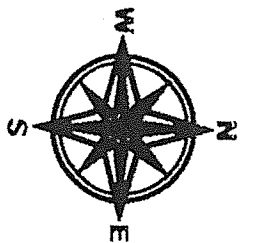

HELI BASE

CREW SLEEPING

OH SLEEPING

ENGINE PARKING

BUS PARKING

SHOWERS

Handwash

Parking

FACILITIES PARKING

SMALL VEHICLE PARKING

GROUND SUPPORT

ROAD

ENTRANCE

SUPPLY

SECURITY

FREEZER

BEVERAGE

CATERING



SUPPORT ENTRANCE

CATERING

HIGHWAY 199

1 Gasquet Complex

LA-SRF-001488

Transportation MAP

Base Camp (Airport)

Middle

ICP

199 Access Flat

Circus sleeping Area

Dozer Parking  
Jones creek rd  
Little

Illinois Valley  
Airport  
Cave St  
199  
Grants Pass

199  
Hiwachi  
Crescent City

1 way  
Alternating  
Traffic  
0700-1700  
for Bridge construction

French Hill rd  
411

French Hill rd  
411

17N05  
17N06  
17N07  
17N08  
17N09  
17N10  
17N11  
17N12  
17N13  
17N14  
17N15  
17N16  
17N17  
17N18  
17N19  
17N20  
17N21  
17N22  
17N23  
17N24  
17N25  
17N26  
17N27  
17N28  
17N29  
17N30

417

South Fork rd  
422

COON FIRE

12N01

12N02

12N03

12N04

12N05

12N06

12N07

NOT TO SCALE

Legend

Paved Road

Dirt Road

Prop point

C. Halsey 8/10/15

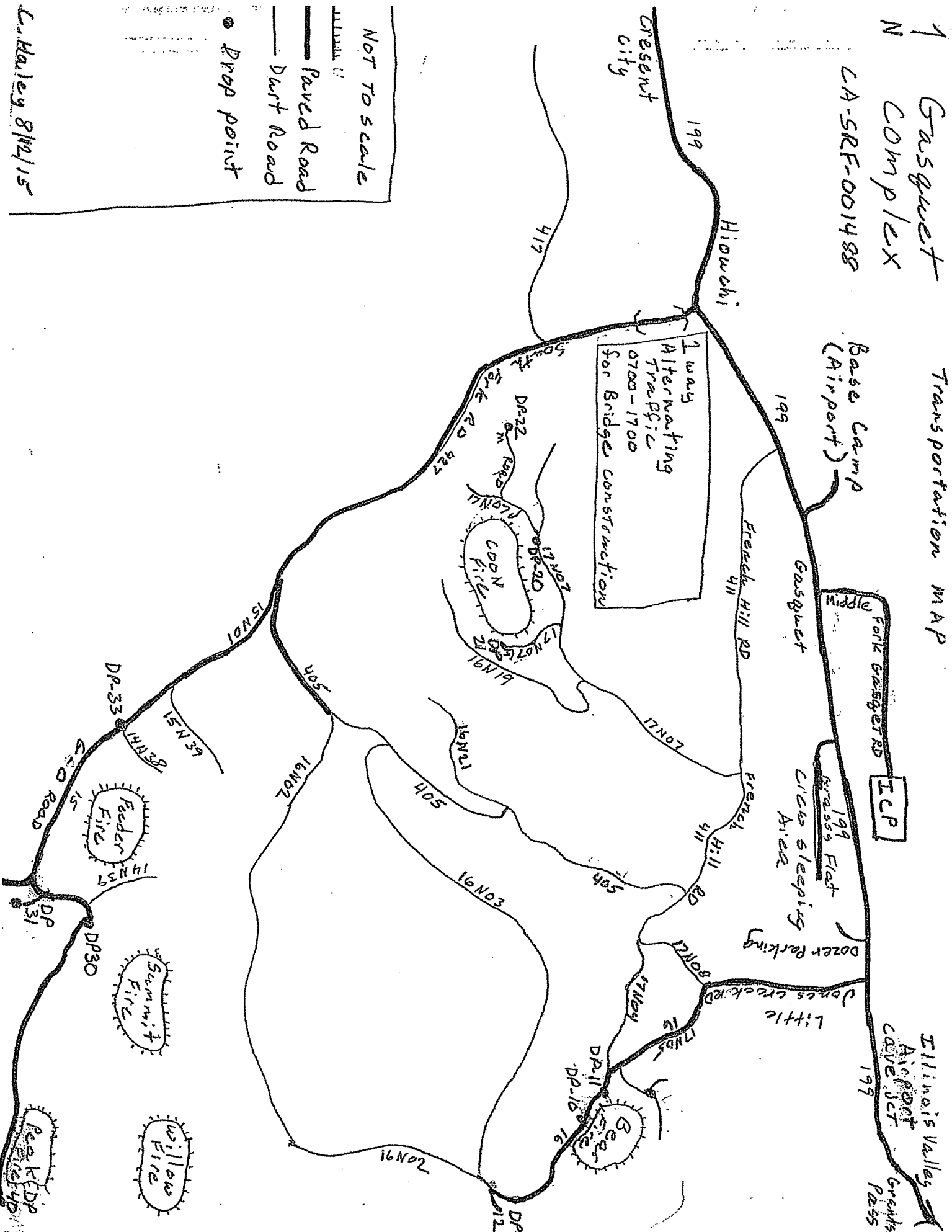

## Gasquet Complex Demob Date as of 8-12-2015

REQUEST NUMBER	RESOURCE NAME	ITEM CODE	DEMOB DATE
O-103	TWEED, CHRIS	FOBS	08/14/2015
O-139	SCURI, JOSEPH	RESL	08/14/2015
O-141	PAYNE, DALE	DRIV	08/14/2015
A-57	BALD MOUNTAIN HELITAK H517	HEL2	08/15/2015
E-75	LKP 5031	ENG3	08/15/2015
E-76	SRM 331	ENG3	08/15/2015
E-77	CRK 379	ENG3	08/15/2015
E-78	GASQUET 214	ENG2	08/15/2015
E-80	WEBER FIRE DISTRICT 464	ENG4	08/15/2015
E-114	FIRESTORM 03	ENG4	08/15/2015
E-116	CENTERAL WILDFIRE 741	ENG4	08/15/2015
E-117	PATRICK 14	ENG6	08/15/2015
O-149	SCOTT, JAISY	PTRC	08/15/2015
O-150	BALENT, SHEILA	EQTR	08/15/2015
C-30	STEELHEAD	HC2	08/16/2015
E-82	TONTO 1247	ENG6	08/16/2015
E-86	AMERICAN FIRE CO 61	ENG6	08/16/2015
E-87	WOOD'S WT 99	WTT2	08/16/2015
E-88	GASQUET VFD	WTT2	08/16/2015
E-115	ASI 3	ENG6	08/16/2015
E-118	DARE ENTERPRISES 32	ENG6	08/16/2015
O-88	WINN, DOUGLAS	FACL	08/16/2015
O-148	WYATT, JANICE	CAMP	08/16/2015
O-207	DEVLIN, BRENDA	THSP	08/16/2015
O-208	MCCAINE, MIKE	THSP	08/16/2015
O-262	MOSEY, KERI	CAMP	08/16/2015
O-276	FREDERICK, MICHAEL	AREP	08/16/2015





