

* Corrected *

GASQUET COMPLEX

INCIDENT ACTION PLAN

OPERATIONAL PERIOD

AUG 16 – AUG 17, 2015

0600-0600



"Adapt...Improvise...and Overcome"



CA-SRF-001488

P5JOPQ (0510)

NAD 83
dd° m.mm'

INCIDENT OBJECTIVES (ICS 202)

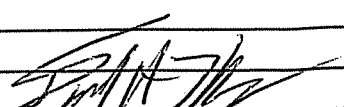
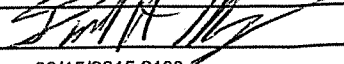
1. Incident Name:		2. Operational Period: 0600 - 0600	
GASQUET COMPLEX		Date/Time From: 08/16/2015 0600 SUN	Date/Time To: 08/17/2015 0600 MON
3. Objective(s):			
<p>STRATEGIC FRAMEWORK: THE FRAMEWORK FOR THE GASQUET COMPLEX STRATEGIC PLAN CONSISTS OF USING A COMBINATION OF DIRECT ATTACK WHERE FEASIBLE, OTHERWISE INDIRECT USING NATURAL BARRIERS. A KEY ELEMENT IS FLEXIBILITY AND THE ABILITY TO APPLY THE RIGHT RESOURCE TO THE RIGHT TASK AT THE RIGHT TIME. FIRELINE WILL BE CONSTRUCTED ONLY WHERE FEASIBLE AND SAFE TO DO SO.</p> <p>LEADERS INTENT: PROVIDE THE HIGHEST LEVEL OF CUSTOMER SERVICES TO ALL INVOLVED WITH OR IMPACTED BY THE GASQUET COMPLEX. ALL INCIDENT PERSONNEL SHOULD BE PREPARED TO TAKE THE APPROPRIATE ACTIONS REGARDING:</p> <ul style="list-style-type: none"> • PERSONAL INTERACTIONS BOTH INSIDE AND OUTSIDE THE INCIDENT MANAGEMENT ORGANIZATION. • PERSONAL SAFETY AND THE SAFETY OF OTHERS. • AN INCIDENT-WITHIN-AN-INCIDENT. <p>OBJECTIVES:</p> <ul style="list-style-type: none"> • PROVIDE FOR FIREFIGHTER AND PUBLIC SAFETY BY ENSURING L C E S IS EVALUATED USING SOUND RISK MANAGEMENT PRINCIPLES. • MAINTAIN AND BUILD COOPERATOR AND STAKEHOLDER RELATIONSHIPS. • SUPPRESS FIRES WHILE NOT EXPOSING FIREFIGHTERS OR AIRCRAFT TO UNNECESSARY RISKS. • IDENTIFY AND PROTECT NATIVE AMERICAN TRADITIONAL AREAS AND OTHER SENSITIVE CULTURAL AND HISTORIC SITES. 			
4. Operational Period Command Emphasis:			
UTILIZE SUPPRESSION STRATEGIES COMMENSURATE WITH VALUES AT RISK. IMPLEMENT TACTICS WHICH INCREASE THE PROBABILITIES OF SUCCESS WHILE HOLDING EXISTING CONTAINMENT.			
General Situational Awareness:			
CUMULATIVE FATIGUE IS DANGEROUS. IT PREVENTS SOUND DECISION-MAKING, CONFOUNDS SITUATIONAL AWARENESS, AND DULLS REACTION TIMES.			
5. Site Safety Plan Required? Yes <input type="checkbox"/> No <input checked="" type="checkbox"/>			
Approved Site Safety Plan(s) Located at:			
6. Incident Action Plan (the items checked below are included in this Incident Action Plan):			
<input checked="" type="checkbox"/> ICS 202	<input type="checkbox"/> ICS 207	Other Attachments:	
<input checked="" type="checkbox"/> ICS 203	<input type="checkbox"/> ICS 208	<input checked="" type="checkbox"/> SAFETY / 215A	
<input checked="" type="checkbox"/> ICS 204	<input checked="" type="checkbox"/> ICS 220	<input checked="" type="checkbox"/> INCIDENT WITHIN AN INCIDENT	
<input checked="" type="checkbox"/> ICS 205	<input checked="" type="checkbox"/> Map/Chart	<input checked="" type="checkbox"/> HR / TRAINING MESSAGE	
<input type="checkbox"/> ICS 205A	<input checked="" type="checkbox"/> Weather Forecast/Tides/Currents	<input checked="" type="checkbox"/> DEMOB LIST	
<input checked="" type="checkbox"/> ICS 206			
7. Prepared by: DAVE LATTIMORE		Position/Title: PSC2	Signature: 
8. Approved by Incident Commander:		Name: DON GARWOOD	Signature: 
ICS 202	IAP Page		Date/Time: 08/15/2015 2100

ORGANIZATION ASSIGNMENT LIST (ICS 203)

1. Incident Name:		2. Operational Period: 0600 - 0600	
GASQUET COMPLEX		Date/Time From: 08/16/2015 0600	SUN
		Date/Time To: 08/17/2015 0600	MON
3. Incident Commander(s) and Command Staff:		7. Operations Section:	
IC/UC	DON GARWOOD	OPS SECTION CHIEF	DERRICK DAVIS DARRELL MILLER
DEPUTY	DAVE KELLY		
SAFETY OFFICER	JAMES ARAGON; P TOMPKINS; J BATES; F HERNANDEZ (T)	PLANNING OPS	MATTHEW CONKLIN AARON THOMPSON (T)
INFORMATION OFFICER	JIM WILKINS; ROBERT POOLE ASCENSION BRIBIESCAS		
LIAISON OFFICER	LARRY LA VOGUE 909-855-5756	DIVISION/GROUP	A - COON FIRE MITCH FOWLKES DAN O'CONNOR (T)
HUMAN RESOURCES	KATHY KREYNS 909-731-1771 ANDREA CABIDA (T)	DIVISION/GROUP	C - COON FIRE IRA PESHKIN BRIAN BERRY (T)
4. Agency/Organization Representative(s):		DIVISION/GROUP	D - COON FIRE TRENT INGRAM KEN VAN WIG (T)
Agency/Organization	Name	DIVISION/GROUP	E - BEAR FIRE DAVID MARTINEZ JOHN OWINGS (T)
USFS	DAVE PALMER	DIVISION/GROUP	G - BEAR FIRE ERIC PLATZ CHRIS ST. PIERRE (T)
GASQUET VFD	NICK KARANPOULOS	DIVISION/GROUP	H/L/NV WILLIAMS / PEAK / SUMMIT CANDICE KUTROSKY PAUL MANDOLINI (T)
CAL OES	JOHN SALVATE	DIVISION/GROUP	W - FEEDER FIRE GLENN WEBB AL WARD (T)
CAL TRANS		DIVISION/GROUP	Z - FEEDER FIRE ADAM KOHLEY ROBERT ALLAN (T)
SRF-NFFE	ROBERTA CORAGLIOTTI 530-784-7542 JOHN MC RAE 707-845-8017	DIVISION/GROUP	CONTINGENCY JEREMY COWIE BRIAN FABBRI (T)
5. Planning Section:		7b. Air Operations Branch:	
CHIEF	DAVE LATTIMORE	AIR OPS BRANCH DIRECTOR	TED VISSER
DEPUTY	RICH STERRY (T)	AIR SUPPORT SUPERVISOR	GALEN YOUNG
RESOURCES UNIT	KYLE HAUDUCOER J SCURI (T), JAKE HUGHES (T)	AIR ATTACK SUPERVISOR	CLIFF CLARIDGE KEN MCLAUGHLIN
SITUATION UNIT	GORDON TAMPLIN(T)	AIR TANKER COORDINATOR	
DOCUMENTATION	VANESSA HANSON	HELICOPTER COORDINATOR	
DEMOB UNIT	JIM STITELER (T)		
IMET	RACHEL COBB		
FIRE BEHAVIOR	BYRON KIMBALL		
SOPL	BOB LINEBACK		
TRAINING SPECIALIST	ANN HUTCHINSON		
GISS	R MURILLO; A. KIRSCH; A SALDIVAR(T)		
CTSP	CHARLES VERTREES		
6. Logistics Section:		8. Finance/Administration Section:	
CHIEF	ERIC SWEETMAN	CHIEF	DEBBIE YORK
DEPUTY	STEVE KING (T); DAVID WHITNEY (T)	TIME UNIT	SHARON R MAKOSKY DEANNA THOMPSON (T)
SUPPLY UNIT	EVAN TISS	COMPENSATION UNIT	BETH SJOBLUM
FACILITIES UNIT	ART CURLEY; DOUG WINN(T)	COST UNIT	THOMAS STEELE KRIS STERBENS (T)
GROUND SUPT UNIT	CHRIS HALEY; RON NOORDMAN		
COMM UNIT	DAVE LARKIN; CHRIS PERRY(T)		
MEDICAL UNIT	GENA FOWLKES MATTHEW MENARD (T)		
SECURITY UNIT	HEATHER NAIGUS		
FOOD UNIT	RICHARD WAITE		
9. Prepared By:	Name: JOE SCURI (T)	Position/Title: RESL	Signature:
ICS 203	IAP Page	Date/Time: 08/15/2015 2100	



INCIDENT Weather Forecast



FORECAST NO: 5

NAME OF FIRE: Gasquet Complex

PREDICTION FOR: Day Shift

SHIFT DATE: 8/16/2015

SIGNED: *Rachel Cobb*

TIME AND DATE

FORECAST ISSUED: 1900 8/15/2015

Rachel Cobb

Incident Meteorologist

WEATHER DISCUSSION: High pressure over California and the eastern Pacific on Sunday and Monday will cause a thermal trough to position itself over the area. This will bring hotter and drier conditions, and an offshore flow will keep skies clear. This will also lead to gusty northeast winds during the overnight hours and poor relative humidity recoveries in the mountains.

WEATHER FORECAST for Sunday:

WEATHER: Clear, but smoky.

MAXIMUM TEMPERATURES: 88 – 93 degrees valleys...81 – 87 degrees ridges.

MINIMUM HUMIDITY: 17 – 22 percent.

20 FT WINDS:

RIDGETOP – Northeast 4 to 11 mph.

SLOPE/VALLEY – Upslope/upvalley 3 to 8 mph.

HAINES INDEX: 5 (moderate).

STABILITY/INVERSION: Mixing height 8500 feet msl.

OUTLOOK for Sunday Night: Clear, but smoky. Low temperatures 60 – 65 degrees and maximum relative humidity 25 – 55%. Ridgetop winds northeast 10 to 18 mph with gusts to 25 mph. Haines Index: 5. Thermal belt 4000 – 5000 feet msl.

OUTLOOK for Monday: Clear, but smoky. Highs temperatures 80 – 91 degrees and minimum relative humidity 20 – 25%. Ridgetop winds northerly 4 to 8 mph. Mixing height: 9500 feet msl. Haines Index: 4.

EXTENDED FORECAST: Hot and dry conditions will persist through Thursday, but overnight relative humidity recoveries will start to show some improvement.

FIRE BEHAVIOR FORECAST

FORECAST NUMBER: #13	TYPE OF FIRE: Wildland Fire
FIRE NAME: Gasquet Complex	OPERATIONAL PERIOD: August 16, 2015
DATE ISSUED: August 15, 2015	TIME ISSUED: 2000
UNIT: Smith River NRA, Six Rivers NF	SIGNED: <i>Byron R. Kimball</i>
	Typed/printed:/s/ Byron R. Kimball FBAN

INPUTS

WEATHER SUMMARY: Clear skies. Warmer and drier, Haines Index of 5
MAX TEMPERATURE.....Valleys 88-93, Ridges 81-87.
MIN HUMIDITY.....17 - 21%
EYE LEVEL WINDS.....Upslope/upvalley 3-8, Ridges NE 4 to 9,
For more specific information, please see the Incident Weather forecast

OUTPUTS

FIRE BEHAVIOR

GENERAL:

Increased warming and drying bring excellent potential burning conditions. Stubborn inversion may delay the start to the burn period. Inversion may not lift till late afternoon. Expect low to moderate activity under the inversion. Beware of indicators that the inversion is lifting, air becoming clear, fire activity increasing. Once the inversion lifts, conditions are present to allow for a significant increase in activity. Spotting becomes a concern as brush understory becomes involved.

With line construction in incomplete burns, be positive that you are exposing the black edge and getting all the hot ash and embers inside your line.

SPECIFIC:

Timber Understory: Fire behavior in the Understory models could begin early. Warmer and drier conditions will expand the burn window, once the inversion lifts. Expect more involvement of the understory brush and shrubs with increased intensity.

ROS: 5 to 10 ch/hr.

FL: 6 to 8 ft.

Timber Litter: Timber Litter fire behavior may be active early. Increased consumption of heavier fuels and understory may provide additional material for spots and roll out. Stay aware of rollout and upslope runs through incomplete burns.

ROS: 3 to 6 ch/hr.

FL: 2 to 3 ft.

Spotting becomes a concern with improved burn conditions. Know where your smoke is going and check for fallout.

AIR OPERATIONS:

Inversion will hold smoke in early. Air may improve in the afternoon as heating lifts the inversion.

SAFETY

Inversion breaks can lead to sudden increases in fire behavior. Pay attention to weather readings and other indicators that the inversion may be lifting or breaking.

Division/Group Assignment List (ICS 204 WF)

1. Incident Name:			3.			
GASQUET COMPLEX			Branch:		Division/Group:	
2. Operational Period: 0600 - 0600					A - COON FIRE	
Date/Time From: 08/16/2015 0600 SUN	Date/Time To: 08/17/2015 0600 MON					
4. Operations Personnel						
OPERATIONS CHIEF		DERRICK DAVIS DARRELL MILLER		DIVISION/GROUP SUPERVISOR		MITCH FOWLKES DAN O'CONNOR (T)
PLANNING OPS		MATT CONKLIN AARON THOMPSON (T)		AIR ATTACK SUPERVISOR		CLIFF CLARIDGE KEN MCLAUGHLIN
5. Resources Assigned this Period						
Strike Team / Task Force / Resource Designator	LWD	Leader	Number Persons	Drop Off PT./Time	Pick Up PT./Time	
HCM HOOPA O-275	08/24	ROCKY COLEGROVE	12	ICP/0630	ICP/1900	
TFLD VIKTORA O-80 / WHEELER (T) O-106	08/18		2	ICP/0630	ICP/1900	
TFLD PHILLIPS O-75 / KEYSE (T) O-78	08/20		2	ICP/0630	ICP/1900	
ENG3 ALBUQUERQUE 317 E-161	08/26	BRIAN FOX	4	ICP/0630	ICP/1900	
ENG3 BERTHOUD 13 E-144	08/27	NICO ROMERO	3	ICP/0630	ICP/1900	
ENG3 TRICITY 411 E-142	08/27	FRANK ZUPANCIC	4	ICP/0630	ICP/1900	
ENG6 KAIBAB 611 E-165	08/26	NICK BEHRENDIS	6	ICP/0630	ICP/1900	
HEQB HEISEY / DOZ2 ROEN E-90	08/20		3	ICP/0630	ICP/1900	
HEQB TERRY CARRICO O-217	08/24		1	ICP/0630	ICP/1900	
SKG4 L & L EXCAVATING W/ TRSPT E-111	08/23	SHANE NODINE	2	ICP/0630	ICP/1900	
SKG3 UNDERHILL 1 W/ TRSPT E-112	08/22	JOE BRADBURY	2	ICP/0630	ICP/1900	
FAL1 NORTH ZONE FALLERS #1 O-94	08/18	ALAN STEWART	2	ICP/0630	ICP/1900	
WTS2 ALL AGENCY E-38 / DUDLEY'S E-136	09/02	JOHN HILL	1	ICP/0630	ICP/1900	
FEMT RANDOLPH O-133 / VANZINNI O-134	08/21		2	ICP/0630	ICP/1900	
6. Control Operations/Work Assignments:						
<ul style="list-style-type: none"> • CONTINUE INDIRECT DOZER LINE FROM 17N07J ROAD WEST TO SOUTH FORK OF THE SMITH RIVER AND IDENTIFY SAFETY ZONES. 						
7. Special Instructions:						
<ul style="list-style-type: none"> • COORDINATE AND ORDER AIRCRAFT FOR WATER AND RETARDANT NEEDS WITH AIR ATTACK. • DO NOT FILL WATER FROM COMMUNITY OF HIOUCHI FIRE HYDRANTS. 						
8. Division/Group Communication Summary						
Function	Channel	RX Frequency N/W	RX Tone/NAC	TX Frequency N/W	TX Tone/NAC	Mode
COMMAND	1	167.1000	162.2	169.7500	162.2	A
TACTICAL	13	167.1125	162.2	167.1125	162.2	A
BACKUP NET	4	168.1250		170.4750	127.3	A
AIR TO GROUND	10	165.3875		165.3875		A
9. Prepared By (Resource Unit Leader)			Approved By (Planning Section Chief)		Date	Time
JAKE HUGHES (T)			DAVE LATTIMORE		08/15/2015	2100

Division/Group Assignment List (ICS 204 WF)

1. Incident Name:			3.			
GASQUET COMPLEX			Branch:		Division/Group: C - COON FIRE	
2. Operational Period: 0600 - 0600						
Date/Time From: 08/16/2015 0600 SUN		Date/Time To: 08/17/2015 0600 MON				
4. Operations Personnel						
OPERATIONS CHIEF		DERRICK DAVIS DARRELL MILLER		DIVISION/GROUP SUPERVISOR		IRA PESHKIN BRIAN BERRY (T)
PLANNING OPS		MATT CONKLIN AARON THOMPSON (T)		AIR ATTACK SUPERVISOR		CLIFF CLARIDGE KEN MCLAUGHLIN
5. Resources Assigned this Period						
Strike Team / Task Force / Resource Designator		LWD	Leader	Number Persons	Drop Off PT./Time	Pick Up PT./Time
HCM BEAR PEAK O-59		08/23	FRED FLEISCHMAN	9	ICP/0630	ICP/1900
ES3 2141C E-122		08/20	PETE DAVIS	21	ICP/0630	ICP/1900
ENG3 SANTA CLARA VFD 33 E-29		08/19	TYREL HANSEN	4	ICP/0630	ICP/1900
ENG3 SRF 11 E-189		08/24	JOE ENIEM	5	ICP/0630	ICP/1900
HEQB RICH WATERS O-85		08/18		1	ICP/0630	ICP/1900
DOZ2 BROWNING E-44		08/20	PAT BROWNING	1	ICP/0630	ICP/1900
DOZ2 WARNER E-43		08/18	DAN WARNER	3	ICP/0630	ICP/1900
WTS2 SIERRA TIMBER E-42		09/02	JIM ESRY	1	ICP/0630	ICP/1900
WTS2 WILLS E-138		09/08	PHIL WILLS	1	ICP/0630	ICP/1900
SOFR SCHNEIDER (T) O-90 / BERG (T) O-146		08/20		2	ICP/0630	ICP/1900
FEMP CRADDOCK O-240 / <i>Menard</i>		08/25		2	ICP/0630	ICP/1900
6. Control Operations/Work Assignments:						
<ul style="list-style-type: none"> SECURE HANDLINE FROM DOZER LINE TO COON CREEK. SECURE ALL FIRE WEST OF THE 17NO7G ROAD FROM DP 20 TO COON CREEK. 						
7. Special Instructions:						
<ul style="list-style-type: none"> COORDINATE AND ORDER AIRCRAFT FOR RETARDANT NEEDS WITH AIR ATTACK. FOBS PIPPIN / HAMER (T) WORKING IN DIV A AND DIV C. DO NOT FILL WATER FROM COMMUNITY OF HIOUCHI FIRE HYDRANTS TWO ENGINES FROM 2141C TO PROVIDE LADDERS TO DIV G FOR STRUCTURE WRAP. 						
8. Division/Group Communication Summary						
Function	Channel	RX Frequency N/W	RX Tone/NAC	TX Frequency N/W	TX Tone/NAC	Mode
COMMAND	1	167.1000	162.2	169.7500	162.2	A
TACTICAL	5	166.7250	162.2	166.7250	162.2	A
BACKUP NET	4	168.1250		170.4750	127.3	A
AIR TO GROUND	10	165.3875		165.3875		A
9. Prepared By (Resource Unit Leader)			Approved By (Planning Section Chief)		Date	Time
JAKE HUGHES (T)			DAVE LATTIMORE		08/15/2015	2100

Division/Group Assignment List (ICS 204 WF)

1. Incident Name:				3.			
GASQUET COMPLEX				Branch:		Division/Group:	
2. Operational Period: 0600 - 0600				D - COON FIRE			
Date/Time From: 08/16/2015 0600 SUN		Date/Time To: 08/17/2015 0600 MON					
4. Operations Personnel							
OPERATIONS CHIEF		DERRICK DAVIS DARRELL MILLER		DIVISION/GROUP SUPERVISOR		TRENT INGRAM KEN VAN WIG (T)	
PLANNING OPS		MATT CONKLIN AARON THOMPSON (T)		AIR ATTACK SUPERVISOR		CLIFF CLARIDGE KEN MCLAUGHLIN	
5. Resources Assigned this Period							
Strike Team / Task Force / Resource Designator		LWD	Leader	Number Persons	Drop Off PT./Time	Pick Up PT./Time	
ENG6 BOHICA 61 E-168		08/26	DAVE CAMPBELL	3	ICP /0630	ICP/1900	
ENG6 ENG 705 E-162		08/27	MANUEL WESAW	4	ICP /0630	ICP/1900	
HEQB JON MCCLELLAN O-216		08/24		1	ICP /0630	ICP/1900	
MAST JR-3 E-55		08/27	RICK ESTEY	2	ICP /0630	ICP/1900	
MAST JR-4 E-54		08/27	HARVEY MOON	2	ICP /0630	ICP/1900	
MAST SMITH GRINDING E-133			***SEE CHECK-IN***		ICP /0630	ICP/1900	
DO22 FISK'S TREE E-91		08/21	RICK ANDERSON	1	ICP /0630	ICP/1900	
DO22 KENS DOZER E-171		08/27	EIAN OWENS	1	ICP /0630	ICP/1900	
FEL1 STATEWIDE 49				1	ICP /0630	ICP/1900	
FEL1 STATEWIDE 50				1	ICP /0630	ICP/1900	
6. Control Operations/Work Assignments:							
<ul style="list-style-type: none"> • CONTINUE SHADED FUEL BREAK ALONG 16N19 RD, PER DISTRICT FUEL SPECIALIST SPECS. 							
7. Special Instructions:							
<ul style="list-style-type: none"> • COORDINATE AND ORDER AIRCRAFT FOR RETARDANT NEEDS WITH AIR ATTACK. • DO FILL WATER FROM COMMUNITY OF HIOUCHI FIRE HYDRANTS 							
8. Division/Group Communication Summary							
Function	Channel	RX Frequency N/W	RX Tone/NAC	TX Frequency N/W	TX Tone/NAC	Mode	
COMMAND	1	167.1000	162.2	169.7500	162.2	A	
TACTICAL	14	168.2375	162.2	168.2375	162.2	A	
BACKUP NET	4	168.1250		170.4750	127.3	A	
AIR TO GROUND	10	165.3875		165.3875		A	
9. Prepared By (Resource Unit Leader)			Approved By (Planning Section Chief)			Date	Time
JOE SCURI (T)			DAVE LATTIMORE			08/15/2015	2100

Division/Group Assignment List (ICS 204 WF)

1. Incident Name:				3.			
GASQUET COMPLEX				Branch:		Division/Group:	
2. Operational Period: 0600 - 0600				E - BEAR FIRE			
Date/Time From: 08/16/2015 0600 SUN		Date/Time To: 08/17/2015 0600 MON					
4. Operations Personnel							
OPERATIONS CHIEF		DERRICK DAVIS DARRELL MILLER		DIVISION/GROUP SUPERVISOR		DAVID MARTINEZ JOHN OWINGS (T)	
PLANNING OPS		MATT CONKLIN AARON THOMPSON (T)		AIR ATTACK SUPERVISOR		CLIFF CLARIDGE KEN MCLAUGHLIN	
5. Resources Assigned this Period							
Strike Team / Task Force / Resource Designator		LWD	Leader	Number Persons	Drop Off PT./Time	Pick Up PT./Time	
HC2I GRAYBACK 8B C-5		08/20	TIM NYGREN	20	ICP/0630	ICP/1900	
HC2 FORT APACHE 3 C-10		08/20	BURNETTE BENNETT	20	ICP/0630	ICP/1900	
TFLD T ERICKSON O-232 / N BALENT (T) O-209		08/23		2	ICP/0630	ICP/1900	
ENG3 UTAH COUNTY 12 E-31		08/19	ANDREW WATSON	4	ICP/0630	ICP/1900	
ENG3 ARCHER MOUNTAIN 13 E-28		08/19	JUSTUS BARTON	3	ICP/0630	ICP/1900	
ENG3 HOOPA 9531 E-175		08/26	NELS NELSON	5	ICP/0630	ICP/1900	
ENG6 WEBER FIRE 661 E-33		08/19	SCOTT HANEY	3	ICP/0630	ICP/1900	
ENG6 GREAT BASIN 311 E-34		08/19	TYLER ERSKINE	3	ICP/0630	ICP/1900	
HEQB TIMOTHY LANTERMAN O-83		08/21		1	ICP/0630	ICP/1900	
DOZ2 PLUMAS 1		08/24	JAMES SMITH	4	ICP/0630	ICP/1900	
WTS1 V&P E-139		08/26	VICTOR KNIGHT	2	ICP/0630	ICP/1900	
WTS2 YREKA OUTLANDS E-19		08/18	ALLEN WILLIAMS	2	ICP/0630	ICP/1900	
FEMP FELDMAN O-135 / FEMT WICKLAS O-132		08/20		2	ICP/0630	ICP/1900	
6. Control Operations/Work Assignments:							
<p><i>Fisks Dozer E-91</i></p> <ul style="list-style-type: none"> • CONTINUE TO HOLD AND IMPROVE LINE ALONG THE 17N03 ROAD. ... CONTINUE DOZER LINE FROM 17N05 DOWN 17N35 RIDGE. • CONTINUE PREP FROM DP10 TO 17N04 RD. 							
7. Special Instructions:							
<ul style="list-style-type: none"> • COORDINATE AND ORDER AIRCRAFT FOR RETARDANT NEEDS WITH AIR ATTACK. • DO NOT FILL WATER FROM COMMUNITY OF HIOUCHI FIRE HYDRANTS 							
8. Division/Group Communication Summary							
Function	Channel	RX Frequency N/W	RX Tone/NAC	TX Frequency N/W	TX Tone/NAC	Mode	
COMMAND	1	167.1000	162.2	169.7500	162.2	A	
TACTICAL	6	166.7750	162.2	166.7750	162.2	A	
BACKUP NET	4	168.1250		170.4750	127.3	A	
AIR TO GROUND	10	165.3875		165.3875		A	
9. Prepared By (Resource Unit Leader)			Approved By (Planning Section Chief)			Date	Time
JOE SCURI (T)			DAVE LATTIMORE			08/15/2015	2100

Division/Group Assignment List (ICS 204 WF)

1. Incident Name:			3.			
GASQUET COMPLEX			Branch:		Division/Group: G - BEAR FIRE	
2. Operational Period: 0600 - 0600						
Date/Time From: 08/16/2015 0600 SUN		Date/Time To: 08/17/2015 0600 MON				
4. Operations Personnel						
OPERATIONS CHIEF		DERRICK DAVIS DARRELL MILLER		DIVISION/GROUP SUPERVISOR		ERIC PLATZ CHRIS ST PIERRE (T)
PLANNING OPS		MATT CONKLIN AARON THOMPSON (T)		AIR ATTACK SUPERVISOR		CLIFF CLARIDGE KEN MCLAUGHLIN
5. Resources Assigned this Period						
Strike Team / Task Force / Resource Designator		LWD	Leader	Number Persons	Drop Off PT./Time	Pick Up PT./Time
HC2 FORT APACHE 4 C-11		08/20	DANNY EDWARDS	19	ICP/0630	ICP/1900
TFLD JOEL PETERS O-226		08/23		1	ICP/0630	ICP/1900
ENG6 BOULDER MTN 4333 E-152		08/26	MIKE PALAMARA	3	ICP/0630	ICP/1900
ENG6 A BAR S 613 E-166		08/26	MATT BUSTAMANTE	4	ICP/0630	ICP/1900
ENG6 NV-WID 2616 E-35		08/19	CHAD NIBLETT	3	ICP/0630	ICP/1900
ENG6 BL12 E-163		08/27	MICHAEL MORIN	3	ICP/0630	ICP/1900
SKG3 CLEARWATER FIRE E-155		08/26	ED URICK	1	ICP/0630	ICP/1900
FELB CHRIS HENRIE O-181		08/24		1	ICP/0630	ICP/1900
FAL1 NORTH ZONE FALLERS #2 O-95		08/18	BILLY BELMONT	2	ICP/0630	ICP/1900
FAL1 NORTH ZONE FALLERS #4 O-97		08/18	BILL MEADOWS	2	ICP/0630	ICP/1900
FAL1 MCKELLER TREE O-202		08/22	DOUG MCKELLAR	2	ICP/0630	ICP/1900
SOFR BRAD LIDELL O-252		08/25		1	ICP/0630	ICP/1900
6. Control Operations/Work Assignments:						
<ul style="list-style-type: none"> • CONTINUE LINE PREP FROM BEAR BASIN LOOKOUT DOWN THE SHIP MT RD TO THE WILDERNESS BOUNDARY. • STRUCTURE WRAP THE BEAR BASIN LOOKOUT, CABIN, OUTHOUSE, AND WOODPILES. 						
7. Special Instructions:						
<ul style="list-style-type: none"> • COORDINATE AND ORDER AIRCRAFT FOR WATER ONLY DROPS WITH AIR ATTACK. • DO NOT FILL WATER FROM COMMUNITY OF HIOUCHI FIRE HYDRANTS. 						
8. Division/Group Communication Summary						
Function	Channel	RX Frequency N/W	RX Tone/NAC	TX Frequency N/W	TX Tone/NAC	Mode
COMMAND	1	167.1000	162.2	169.7500	162.2	A
TACTICAL	7	168.2500	162.2	168.2500	162.2	A
BACKUP NET	4	168.1250		170.4750	127.3	A
AIR TO GROUND	10	165.3875		165.3875		A
9. Prepared By (Resource Unit Leader)			Approved By (Planning Section Chief)		Date	Time
KYLE HAUDUCOEUR			DAVE LATTIMORE		08/15/2015	2100

Division/Group Assignment List (ICS 204 WF)

1. Incident Name:			3.			
GASQUET COMPLEX			Branch:		Division/Group: H/L/N/V - PEAK FIRE	
2. Operational Period: 0600 - 0600						
Date/Time From: 08/16/2015 0600 SUN		Date/Time To: 08/17/2015 0600 MON				
4. Operations Personnel						
OPERATIONS CHIEF		DERRICK DAVIS DARRELL MILLER		DIVISION/GROUP SUPERVISOR		CANDICE KUTROSKY PAUL MANDOLINI (T)
PLANNING OPS		MATT CONKLIN AARON THOMPSON (T)		AIR ATTACK SUPERVISOR		CLIFF CLARIDGE KEN MCLAUGHLIN
5. Resources Assigned this Period						
Strike Team / Task Force / Resource Designator		LWD	Leader	Number Persons	Drop Off PT./Time	Pick Up PT./Time
TFLD STEVE SISCOE O-79		08/20		1	ICP/0630	ICP/1900
ENG6 GRAND JUNCTION BR3 E-151		08/26	JOSH EVANS	3	ICP/0630	ICP/1900
ENG6 MONTROSE HELL FIGHTERS E-148		08/26	JASON HOBBY	3	ICP/0630	ICP/1900
ENG6 LAKE DILLON 8 E-150		08/26	DENNIS JACKSON	2	ICP/0630	ICP/1900
WTT2 AFD-WT1 E-158		08/27	STEVEN BERG	1	ICP/0630	ICP/1900
WTS2 TRAYNHAM TRUCKING E-137		08/25	DAVE DAMON	1	ICP/0630	ICP/1900
FAL1 MILLER TIMBER O-204		08/22	CHRIS GOODSON	2	ICP/0630	ICP/1900
FEMP MATT LUCAS O-137		08/20		1	ICP/0630	ICP/1900
FEMT TONY CASTANEDA O-131		08/20		1	ICP/0630	ICP/1900
6. Control Operations/Work Assignments:						
<ul style="list-style-type: none"> • KEEP FIRE NORTH AND EAST OF G-O ROAD IF POSSIBLE. FOLLOW THE MINIMUM REQUIREMENT DIRECTION OF 8-14-15. 						
7. Special Instructions:						
<ul style="list-style-type: none"> • ALL RESOURCES USE CALL SIGN "LIMA" • COORDINATE AND ORDER AIRCRAFT FOR <u>WATER ONLY</u> DROPS WITH AIR ATTACK. • MONITOR SUMMIT & WILLIAMS FIRES BY AIR • RAPID EXTRACTION MODULE (R.E.M.) AVAILABLE TO ALL DIV'S & GRP'S. • DO NOT FILL WATER FROM COMMUNITY OF HIOUCHI FIRE HYDRANTS. • FOBS SCHEID / MASTERS / BAERTSCHI (T) WORKING IN DIV H / L / N / V. 						
8. Division/Group Communication Summary						
Function	Channel	RX Frequency N/W	RX Tone/NAC	TX Frequency N/W	TX Tone/NAC	Mode
COMMAND	1	167.1000	162.2	169.7500	162.2	A
TACTICAL	8	168.0500	162.2	168.0500	162.2	A
BACKUP NET	4	168.1250		170.4750	127.3	A
AIR TO GROUND	10	165.3875		165.3875		A
9. Prepared By (Resource Unit Leader)			Approved By (Planning Section Chief)		Date	Time
JAKE HUGHES (T)			DAVE LATTIMORE		08/15/2015	2100

Division/Group Assignment List (ICS 204 WF)

1. Incident Name:			3.			
GASQUET COMPLEX			Branch:		Division/Group: W - FEEDER FIRE	
2. Operational Period: 0600 - 0600						
Date/Time From: 08/16/2015 0600 SUN		Date/Time To: 08/17/2015 0600 MON				
4. Operations Personnel						
OPERATIONS CHIEF		DERRICK DAVIS DARRELL MILLER		DIVISION/GROUP SUPERVISOR		GLENN WEBB AL WARD (T)
PLANNING OPS		MATT CONKLIN AARON THOMPSON (T)		AIR ATTACK SUPERVISOR		CLIFF CLARIDGE KEN MCLAUGHLIN
5. Resources Assigned this Period						
Strike Team / Task Force / Resource Designator		LWD	Leader	Number Persons	Drop Off PT./Time	Pick Up PT./Time
HC2I WHITE MOUNTAIN #1 C-3		08/19	KEITH M SARGENT	19	ICP/0630	ICP/1900
TFLD HYATT O-144 / OLEARY O-234		08/16	***HYATT SEE DMOB***	2	ICP/0630	ICP/1900
ENG3 TIMBER MESA 7213 E-143		08/27	JERROD AMATOR	3	ICP/0630	ICP/1900
ENG3 UTAH FIRE 16A E-32		08/20	KRISTA SPRAYCAR	3	ICP/0630	ICP/1900
ENG3 PICTURE ROCK 121 E-26		08/20	ROCKY ORTIZ	4	ICP/0630	ICP/1900
ENG6 LYONS 4031 E-159		08/27	NICOLE PALESTRO	3	ICP/0630	ICP/1900
HEQB HARRIS O-218 / ALLEN III (T) O-260		08/25		2	ICP/0630	ICP/1900
DOZ2 A TEAM 1 E-127		08/24	PETE GIRARONO	4	ICP/0630	ICP/1900
EXCA WALBERG, INC E-57		08/24	DAVE MCDONALD	2	ICP/0630	ICP/1900
SKG2 YOUNG LOGGING E-154		08/27	PAUL ARBOGAST	2	ICP/0630	ICP/1900
WTT2 SRF 15 E-45		08/16	JACOB MC ADAMS	2	ICP/0630	ICP/1900
FAL1 NORTH ZONE FALLERS #3 O-96		08/18	RICK MEE	2	ICP/0630	ICP/1900
6. Control Operations/Work Assignments:						
<ul style="list-style-type: none"> • HOLD AND SECURE CONTAINMENT LINE, TO MINIMIZE THE THREAT FOR ESCAPE. 						
7. Special Instructions:						
<ul style="list-style-type: none"> • ORDER AIRCRAFT FOR RETARDANT NEEDS WITH AIR ATTACK. * DO NOT FILL WATER FROM COMMUNITY OF HIOUCHI FIRE HYDRANTS. • RAPID EXTRACTION MODULE (R.E.M.) AVAILABLE TO ALL DIVISIONS AND CONTINGENCY GROUP. 						
8. Division/Group Communication Summary						
Function	Channel	RX Frequency N/W	RX Tone/NAC	TX Frequency N/W	TX Tone/NAC	Mode
COMMAND	1	167.1000	162.2	169.7500	162.2	A
TACTICAL	12	166.5500	162.2	166.5500	162.2	A
BACKUP NET	4	168.1250		170.4750	127.3	A
AIR TO GROUND	10	165.3875		165.3875		A
9. Prepared By (Resource Unit Leader)			Approved By (Planning Section Chief)		Date	Time
JOE SCURI (T)			DAVE LATTIMORE		08/15/2015	2100

Division/Group Assignment List (ICS 204 WF)

1. Incident Name:			3.			
GASQUET COMPLEX			Branch:		Division/Group:	
2. Operational Period: 0600 - 0600			Z - FEEDER FIRE			
Date/Time From: 08/16/2015 0600	SUN	Date/Time To: 08/17/2015 0600				
4. Operations Personnel						
OPERATIONS CHIEF		DERRICK DAVIS DARRELL MILLER		DIVISION/GROUP SUPERVISOR		ADAM KOHLEY ROBERT ALLAN (T)
PLANNING OPS		MATT CONKLIN AARON THOMPSON (T)		AIR ATTACK SUPERVISOR		CLIFF CLARIDGE KEN MCLAUGHLIN
5. Resources Assigned this Period						
Strike Team / Task Force / Resource Designator	LWD	Leader	Number Persons	Drop Off PT./Time	Pick Up PT./Time	
HEQB ANDERSON O-215 / DOZ2 JA COOK E-170	08/24		3	ICP/0630	ICP/1900	
WTT1 DB JET E-156	08/28	RUSS BERGETTE	2	ICP/0630	ICP/1900	
WTT1 TENDR 1121 E-157	08/28	DAN CANO	2	ICP/0630	ICP/1900	
WTS2 BOWNE WATER SERVICE E-40	08/17	MICHAEL BOONE	1	ICP/0630	ICP/1900	
FAL1 CECIL LOGGING O-203	08/22	MICHEAL BERRY	2	ICP/0630	ICP/1900	
SOFR PETE VILLA O-68	08/19		1	ICP/0630	ICP/1900	
6. Control Operations/Work Assignments:						
<ul style="list-style-type: none"> SECURE DOZER / HANDLINE FROM G-O ROAD TO W / Z BREAK. SECURE LINE CONSTRUCTION FROM MOST SOUTHERN POINT OF FEEDER FIRE SOUTH TO THE G-O RD. 						
7. Special Instructions:						
<ul style="list-style-type: none"> COORDINATE AND ORDER AIRCRAFT FOR RETARDANT NEEDS WITH AIR ATTACK. RAPID EXTRACTION MODULE (R.E.M.) AVAILABLE TO ALL DIVISIONS AND CONTINGENCY GROUP. DO NOT FILL WATER FROM COMMUNITY OF HIOUCHI HYDRANTS. FOBS PENNY / RICK 						
8. Division/Group Communication Summary						
Function	Channel	RX Frequency N/W	RX Tone/NAC	TX Frequency N/W	TX Tone/NAC	Mode
COMMAND	1	167.1000	162.2	169.7500	162.2	A
TACTICAL	9	168.6000	162.2	168.6000	162.2	A
BACKUP NET	4	168.1250		170.4750	127.3	A
AIR TO GROUND	10	165.3875		165.3875		A
9. Prepared By (Resource Unit Leader)			Approved By (Planning Section Chief)		Date	Time
JOE SCURI (T)			DAVE LATTIMORE		08/15/2015	2100

INCIDENT RADIO COMMUNICATIONS PLAN (ICS 205)

1. Incident Name: GASQUET COMPLEX	2. Date/Time Prepared: Date: 08/15/2015 Time: 2100	3. Operational Period: 0600 - 0600 Date/Time From: 08/16/2015 0600 Date/Time To: 08/17/2015 0600 SUN MON
---	---	--

4. Basic Radio Channel Use:

Zone Group	Ch #	Function	Channel Name/Trunked Radio System Talkgroup	Assignment	RX Freq	RX Tone/NAC	TX Freq	TX Tone/NAC	Mode (A,D, or M)	Remarks
	1	COMMAND	CMD 1	ALL DIVISIONS	167.1000	162.2	169.7500	162.2	A	SHIP MTN
	2	COMMAND	CMD 2	UNASSIGNED	000.0000		000.0000		A	
	3	COMMAND	CMD 3	UNASSIGNED	000.0000		000.0000		A	
	4	BACKUP NET	SRF ADM	ALL DIVISIONS	168.1250		170.4750	127.3	A	GORDON MTN
	5	TACTICAL	NIFC T5	DIV C	166.7250	162.2	166.7250	162.2	A	
	6	TACTICAL	NIFC T6	DIV E	166.7750	162.2	166.7750	162.2	A	
	7	TACTICAL	NIFC T7	DIV G	168.2500	162.2	168.2500	162.2	A	
	8	TACTICAL	NIFC T1	DIV H/L/NV	168.0500	162.2	168.0500	162.2	A	CALL SIGN DIV L
	9	TACTICAL	NIFC T3	DIV Z	168.8000	162.2	168.8000	162.2	A	
	10	AIR TO GROUND	A/G TAC	ALL DIVISIONS	165.3875		165.3875		A	
	11	AIR TO GROUND	A/G CMD	UNASSIGNED	000.0000		000.0000		A	
	12	TACTICAL	R5 TAC 4	DIV W	166.5500	162.2	166.5500	162.2	A	
	13	TACTICAL	R5 TAC 5	DIV A	167.1125	162.2	167.1125	162.2	A	
	14	TACTICAL	R5 TAC 6	DIV D	168.2375	162.2	168.2375	162.2	A	
	15	EMS TAC	CALCORD	ALL DIVISIONS	156.0750		156.0750	156.7	A	MEDICAL A/G
	16	AIR GUARD	GUARD	ALL DIVISIONS	168.6250		168.6250	110.9	A	EMERGENCY ONLY
	20	AIR GUARD	GUARD	ALL DIVISIONS	168.6250		168.6250	110.9	A	EMERGENCY ONLY

6. Prepared By (Communications Unit Leader)	Name: CHRIS PERRY (T)
Signature:	Date/Time: 08/15/2015 2100

ICS 205	IAP Page
---------	----------

MEDICAL PLAN	1. INCIDENT NAME Gasquet Complex	2. DATE PREPARED 8/15/15	3. TIME PREPARED 1730	4. OPERATIONAL PERIOD 8/16-17/2015 0600-0600				
5. INCIDENT MEDICAL AID STATIONS								
MEDICAL AID STATIONS	LOCATION			PARAMEDIC				
				YES NO				
Medical Supply	Base Camp			X				
TRANSPORTATION								
A. Air Ambulances								
NAME	ADDRESS	PHONE	PARAMEDIC					
			YES	NO				
National Guard H-825 (Day/Night, Hoist)	Redding Airport, CA	Communications	X					
CHP H-14 (Day/Night, Hoist)	Redding Airport, CA	(530) 842-3515	X					
Coast Guard (Day/Night, Hoist)	Air Station Humboldt Bay, CA	(707) 839-6100		X				
Cal Fire Kneeland Helitack H-102 (Hoist)	Kneeland Station, CA	(707) 441-2863		X				
Reach 5 Air Medical	Redding, CA	1-800-338-4045	X					
Mercy Air Ambulance 105	Medford, Oregon	1-800-903-9000	X					
PHI Air Medical	Redding, CA	1-800-597-9571	X					
B. Ground Ambulances								
Hoopa Ambulance	Base Camp/Fireline	Communications	X					
Del Norte Ambulance, Station 2	2600 Morehead Rd Crescent City CA	Communications	X					
7. HOSPITALS								
NAME	ADDRESS	TRAVEL TIME		PHONE	HELIPAD		BURN CENTER	
		AIR	GRND		YES	NO	YES	NO
Sutter Coast Hospital	800 E Washington Crescent City CA. N. 41 46.454 x W 124 11.537		25min	ER: 707-464-8888 Gen: 707-464-8511		X		X
Mercy Med. Center Level 3 Trauma	914 Pine St. Mt. Shasta, CA. N. 40 34.14 x W. 122 23.97	45m	4.5hr	(530)926-9360	X			X
Rogue Valley Med Center L- 2 Trauma/STEMI/Stroke	2825 Barnett Rd. Medford, OR. N. 42 19.092 W. 122 49.833	30m	2 hr	(541)789-7100	X			X
UC Davis Med Center Level 1 Trauma Burn Center	2315 Stockton Blvd. Sacramento, CA N. 38 33.3 x W. 121 27.3	2hr	7.0hr	(916) 734-3636 Burn Center (916) 734-3790 ER	X		X	
8. MEDICAL EMERGENCY PROCEDURES								
<p>In the event of a medical emergency provide the following information to your Division or Gasquet Communications on Command.</p> <ol style="list-style-type: none"> 1. Declare the nature of the emergency. <ol style="list-style-type: none"> a. Medical injury/illness? b. Is injury/illness life threatening? 2. If life threatening, then request that the designated frequency be cleared for emergency traffic. 3. Identify the on-scene Point of Contact (POC) by resource and last name (i.e POC is TFLD Smith). 4. Identify nature of incident, number injured, patient assessment(s) and location (geographic and GPS coordinates). 5. Identify on-scene medical personnel by position and name (i.e EMT Jones). 6. Identify preferred method of patient transport. 7. Request any additional resources and/or equipment needed 8. Document all information received and transmitted on the radio or phone. 9. Identify any changes in the on-scene Point of Contact or medical personnel as they occur. 					<p><u>INJURY REPORTING PROCEDURES</u></p> <p>NATURE OF INJURY _____ # of Patients _____</p> <p>TRANSPORTION NEEDED Air _____ Ground _____</p> <p>REM Needed Y ___ N ___ Estimated Air Temp _____</p> <p>LAT _____ LONG _____ Elevation _____</p> <p>Specific Hazards In Area _____</p> <p>PATIENT UNIT ID _____</p> <p>REMINDER: DO NOT GIVE PT NAME OVER RADIO</p> <p>IS MEDICAL PERSONNEL WITH PATIENT: YES ___ NO ___</p> <p>AGE ___ SEX: MALE ___ FEMALE ___</p> <p>ALL EMERGENCIES---Secure the area and identify witnesses for later investigation. Keep an accurate log of events.</p>			
ICS 206 8-78	9. PREPARED BY (MEDICAL UNIT LEADER) Gena Fowlkes MEDL (909) 762-9032				10. REVIEWED BY (SAFETY OFFICER) James Aragon SOF2			



Incident within an Incident Action Plan

When the scope or complexity of the emergency exceeds division resource needs

This plan is designed to identify the initial actions that should be taken by the first arriving personnel on a serious accident. This person may be a single resource, engine boss, or a crew boss. Accidents or incidents within an incident happen rapidly and require sound, calm initial decisions to handle the problem, while still focusing on the main incident. The following checklist provides some key thoughts and actions.

The first arriving person to any accident should notify their Division Supervisor, or the Div Sup assigned to that location.

Advise of the critical information needed:

- Accident scene safety assessment and advise incoming personnel
- Number of injuries and their severity
- Special equipment needs (extrication, low/high angle rescue, fire protection or suppression)
- Assist the injured as necessary without endangering yourself or other personnel
- Do not move trauma victims unless their safety is in jeopardy
- Utilize PINK pages of the Incident Response Pocket Guide (IRPG) for patient assessment/medical procedures

Remain aware of surroundings and delegate personnel to monitor the main fire

The Division Supervisor will assume command of the accident/incident scene upon arrival. The following list outlines the general duties and tasks that should be completed on most accidents/incidents.

1. Delegate division oversight to another Division Supervisor or other qualified person.
2. Request a clear frequency from Comm and consider switching to designated Emergency Tactical (Incident Comm will notify the MEDL who will initiate the medical plan for injuries)
3. Order/delegate resources appropriate for the accident/incident (crew EMT's, Line EMT's or Line Medics, rescue equipment, patient transport needs, manpower)
4. Notify Operations Section Chief and Safety Officer on all accidents/incidents.
5. Begin to document the event accurately and completely. Use ICS form 201 if the event is large or complex.
6. Protect the scene for Investigators

Reference the full Incident Medical Emergency Plan for additional



Incident within an Incident Action Plan

Position Assignment Supportive Actions

Division Supervisor

- See items 1-6 on page one
- If unable to access accident/incident location, delegate command to a closer qualified resource

Medical Unit Leader

- Respond to Comm Unit as soon as possible
- Coordinate with Division Supervisor to ensure proper resources are rapidly ordered
- Assign a MEDL to the scene and other positions to support the response as needed
- Monitor condition updates of patient(s) and coordinate response with Operations

Communications Unit Leader

- Maintain clear radio traffic and monitor communications to support response
- Recommend appropriate security and investigative process
- Assess the need for critical Incident Stress Response

Safety Officer

- Provide for Safety personnel on scene as needed
- Recommend appropriate security and investigative process
- Assess the need for critical Incident Stress Response

Air Attack Supervisor

- Obtain coordinates of the emergency location
- Coordinate air-medical response
- Assist and support the designated Point of Contact with communications and coordination of the emergency response as necessary

IC, Command & General Staff

- Manage the emergency and direct specific responsibilities to individual positions to provide an appropriate response
- Notify the host unit and host dispatch center of the size-up information
- Constantly monitor and assess the appropriate response and adapt direction as needed
- Submit all documentation pertaining to the emergency to the Plans Chief

Reference the full Incident Medical Emergency Plan for additional

AIR OPERATIONS SUMMARY PREPARED BY: Ted Visser *Ted Visser* PREPARED DATE/TIME: 08/15/15 1900

1. INCIDENT NAME: Gasquet Complex	2. OPERATIONAL PERIOD DATE: 08/16/15	START TIME: 0700	END TIME: 2000	SUNRISE: 0625	SUNSET: 2018
3. REMARKS (Safety Notes, Hazards, Air Operations Special Equipment, etc.) Thunderstorms, erratic winds. Low wires, cables, power lines. Divisions, contact Helibase for all aviation needs, include coordinates of possible helispot/unimproved landing locations. Possible smoke concerns. Track all retardant usage and location if used. Do not dip from lakes near 41 35,000 x 123 43,00 IP for Air Tankers 41 47.21 X 123 04,40 5000' Cave HB Gate 10155# Six Rivers Disp. Air Desk 707-726-1266			4. MEDEVAC A/C: 512		
Bear Fire Div E, 41 48,928 123 44,678 Coon Fire Div C, 41 45,786 123 57,709 Feeder Fire Div W, 41 35,065 123 50,726 Peak Fire Div L, 41 33,065 123 46,134 Summit Fire Div V, 41 35,000 123 47,800 Williams Fire Div H, 41 35,290 123 45,621			5. TFR: 5/0539 Radius: <u>10</u> NM Altitude: <u>9000</u> MSL Centerpoint: N 41 41.57 W 123 49.05 Freq: 128.0750 Illinois Valley Tower Freq: 133.275		

6. PERSONNEL	Phone	7. FREQUENCIES	AM	FM	8. FIXED-WING	# Avail / Type/ Make-Model / FAA N# / Base(s)
AOBD: Ted Visser	619-981-2409	AIR/AIR FW:		166.4500	Airtankers:	Available through Dispatch SEAT 818, SEAT 886
ASGS: Galen Young	575-574-8720	AIR/AIR RW:	128.0750		Leadplanes:	Available through Dispatch
ASGS(T): Ken Ostrom	307-272-3266	COMMAND: RX: TX:		167.1000 169.7500 Tone 15 162.2	ATBase:	
ATGS: Ken McLaughlan	813-997-0317	AIR/GROUND CMD: AIR/GROUND TAC:		165.3875	ATGS Aircraft:	N 4579N, A-6 Claridge N 285 , A-65 McLaughlan Medford
ATGS: Cliff Claridge	480-688-5330	DECK:		163.100	AAB: MRB:	Cave- HOS Trlr, E-2, Raechel, 208-569-7476 Cave- 49er WT, E-41 Bobby Alvarez, 619-300-0801 Cave Helibase 541-592-2852, FAX 541-592-3798
HEB1: Melvin Tate	850-849-0405	AIR GUARD:		168.6250		
HEB1(T): Rika Clipperton	530-559-0905					
SEAT MGR: Jose Rosales SEAT MGR: Crystal Henson	541-417-2361 707-599-5345					

9. HELICOPTERS (Use Additional Sheets As Necessary)

FAA N#	TY	MAKE/MODEL	BASE	AVAILABLE	START	REMARKS	FAA N#	TY	MAKE/MODEL	BASE	AVAILABLE	START	REMARKS
HT-702	1	S-61	Cave	0730	0830	A-20							
HT-782	1	S-64	Cave	0730	0830	A-58							
512	2	Bell 212	Cave	0730	0830	A-42							
988B	3	Bell L4	Cave	0730	0830	A-28							

10. TASK/MISSION/ASSIGNMENT (Type/Function Includes: Air Tactical, Retardant, Recon, Personnel Transport, Water Dropping, S&R, etc.)

TYPE/FUNCTION	NAME OF PERSONNEL OR CARGO (if applicable) OR INSTRUCTIONS FOR TACTICAL AIRCRAFT	MISSION START	FLY FROM	FLY TO
Bucket drops per request	Division Sup. To request and coordinate with Air Attack or helibase.			
Recon Flights	To be approved by OPS or AOB			
Cargo / Sling	Per Request from Div Sups, all sling loads / crew shuttles			
Ops Recon				
Div Sup Recon				
DIPSITES	River Dip 41 44,150 X 123 59,02 Whiskey Dip 41 39,240 X 123 39,690 Buck Dip 41 48,894 X 123 41,335 Bear Dip 41 50,487 X 123 46,359 Feeder Dip 41 36,831 X 123 51,810			
Nickowitz Fire Fred's	Air to Air FW 164,7500 Air to Air RW 126,075			
Nickowitz Ar Ops: Brian Drinville 530-627-3208	Air to Ground 164,8625 Command 2 173,0375 Rx 167,3250 Tx Tone 127.3			
Nickowitz Fir FAX 530-627-3401				
Sawtooth Fire	41 36,572 X 123 42,451			

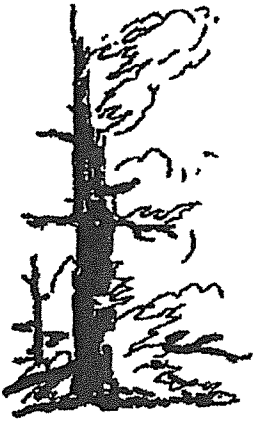

SAFETY MESSAGE



"Adapt...Improvise...and Overcome"



Incident: Gasquet Complex **Date / Operational Period:** 8/16-17/15

MAJOR HAZARDS AND RISKS

- | | |
|--|---|
| <ul style="list-style-type: none"> • Ongoing air operations. Refer to aviation blue pages in your IRPG for retardant and bucket drop safety tips. • Increased fire behavior, maintain LCES • Communications... conduct communications checks up and down your operational structure • Dehydration—Drink lots of water • Firefighter fatigue | <ul style="list-style-type: none"> • Rocky, rough terrain--falls/slips • Snags!!! Rolling Rocks!!! • Driving, backing and turning around on narrow, washboard mountain roads- watch for soft shoulders • Fast moving traffic on HWY 199 – take extra time to check for oncoming traffic prior to driving onto highway |
|--|---|

FIRE FIGHTER FATIGUE

- Fatigue management goes beyond counting hours on timesheets, it is individualized and overt.
- Cumulative fatigue is dangerous. It prevents sound decision-making, confounds situational awareness, and dulls reaction times. It is as problematic in the office as it is on the fireline.
- Cumulative fatigue is manifest in the explanations used when folks are asked to take a break, or take a day off..."I don't have time." "There is too much going on." "As soon as things calm down a bit."
- Fire fighters **MUST** assure their situational awareness and that risks are assessed and mitigated before committing to an action.
- Our values are simple...firefighter and public safety are the number one concern to be addressed within the priorities of suppression. Please take the time to watch out for each other

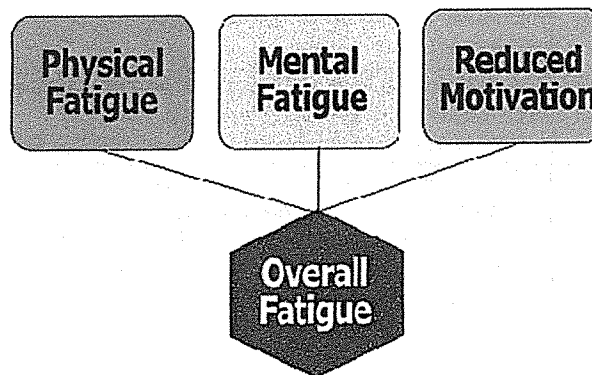

Prepared By:
Fred Hernandez, Safety Officer (t)

Approved By:
James Aragon, Safety Officer

INCIDENT SAFETY ANALYSIS 215a

Gasquet - Sunday, August 16, 2015

8. Location	9. Hazard	6. Control or Abatement Action (Engineering, Administrative, PPE, Avoidance, Education, etc)
All	Hazard Trees	<ul style="list-style-type: none"> ~ Follow "Hazard Tree Safety" guidelines, IRPG pages 22 & 23 ~ Post lookouts, or use a spotter in mop-up areas with personnel ~ Don't park vehicles or take breaks in high concentrations of hazard trees ~ Establish trigger points for disengagement during high wind events
All	Air Operations	<ul style="list-style-type: none"> ~ Follow "Aviation Watch-Out Situations" on page 44, IRPG ~ Don't plan on air resources for medical transport or resupply. ~ Refer to page 57, IRPG for directing bucket drops. ~ Ensure positive communication with all air resources.
All	Chain Saw Operations	<ul style="list-style-type: none"> ~ Follow "Hazard Tree Safety" guidelines, IRPG pages 22 & 23 ~ Look up, down around for hazard tree indicators ~ Only fell and buck trees within your expertise, and training ~ Follow "Procedural Felling Operations" on page 79 in IRPG ~ Do not fall trees during high wind events
All	Steep Terrain & Rolling Debris	<ul style="list-style-type: none"> ~ Maintain 8'-10' spacing when working & walking ~ Don't work above any personnel ~ Evaluate necessity to send personnel in areas with limited access
All	Bees, Ticks	<ul style="list-style-type: none"> ~ Be aware of crew members with sting allergies. ~ Ensure crew members have medication pens if needed. ~ Perform daily self inspection ~ Use repellent as necessary
A,C,E,W,D,G	Heavy Equipment Operations	<ul style="list-style-type: none"> ~ Ensure communications are established with operators ~ Use hand signals if other communications are unavailable ~ Maintain a 50'-100' exclusion area around equipment ~ Use a spotter when backing
All	Driving & Traffic	<ul style="list-style-type: none"> ~ Practice "Defensive Driving" techniques traveling on all roads and city streets, mitigation strategy includes: <ul style="list-style-type: none"> ~ Use spotters when backing ~ Honk horn to alert personnel when backing ~ Always use headlights ~ Yield to pedestrians and bicycles ~ Observe posted speed limits ~ Follow 3 second rule of following distance when driving ~ Use chock blocks, turn wheels into hill
All	Firing Operations & Devices	<ul style="list-style-type: none"> ~ Only personnel trained in the use of each device will be authorized to use firing equipment. ~ Ensure all personnel are aware of firing operation that may affect them. ~ Wear appropriate PPE. ~ Ensure aerial/ground ignition plans have been adequately developed and personnel are briefed.
All	Injury & Medical Emergency	<ul style="list-style-type: none"> ~ Assist injured employee appropriate medical care ~ Use EMT's on Division for initial care ~ Follow medical protocol as outlined in ICS-206
All	Fatigue & Overexertion	<ul style="list-style-type: none"> ~ Drink 1 quart of water each hour during and after work ~ Rotate crews out of smoky areas ~ Set a reasonable work pace and allow adequate rest breaks while on the project ~ Stagger work crews start time to limit fatigue ~ Use buddy system to monitor personnel of heat related and fatigue issues ~ Follow work / rest guidelines
All	Poisonous Plants	<ul style="list-style-type: none"> ~ Identify and Avoid hazard areas ~ Launder clothing ~ Shower frequently



Human Resource Message

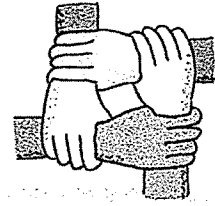

FATIGUE

Fatigue affects your physical and emotional state! It can have a negative impact on your concentration, your conduct, and speech. This can have all sorts of consequences so please make an effort to rest up and get back to your normal productive self!

"In matters of style, swim with the current; in matters of principle, stand like a rock." - Thomas Jefferson

- HRSP-Kathy and HRSP(t) Andrea

Training Message

THANKS TO ALL TRAINER/EVALUATORS AND TRAINEES

Receiving quality training and documenting your training are very important. Everyone on the assignment depend on it.

If you are demobing on or before Monday, August 17

DON'T WAIT UNTIL THE LAST MINUTE

See the Training Specialist with:

1. **Trainee Exit Interview Form:** Filled out by the Trainee
2. **Position Task Book:** With Evaluator input done
3. **ICS-225 Incident Personnel Performance Rating**

Ann Hutchinson (Training Specialist)

Next check-in/demob

or call 623-293-8628

DEMOB LIST

8 / 1 6 / 2 0 1 5

EQUIPMENT

- E-82 (ENG6) TONTO 1247
- E-85 (ENG6) AMERICAN FIRE CO 62
- E-86 (ENG6) AMERICAN FIRE CO
- E-88 (WTT2) GASQUET VFD
- E-114 (ENG4) FIRESTORM 03
- E-115 (ENG6) ASI 3
- E-116 (ENG4) CENTRAL WILDFIRE 741
- E-118 (ENG6) DARE ENTERPRISES 32

OVERHEAD

- O-207 (THSP) DEVLIN, BRENDA
- O-276 (AREP) FREDERICK, MICHAEL
- O-208 (THSP) MCCAIN, MIKE
- O-262 (CAMP) MOSEY, KERI
- O-285 (LSC2) WHITNEY, DAVID
- O-148 (CAMP) WYATT, JANICE

1 Gasquet
N Complex
CA-SRF-001488

Transportation MAP

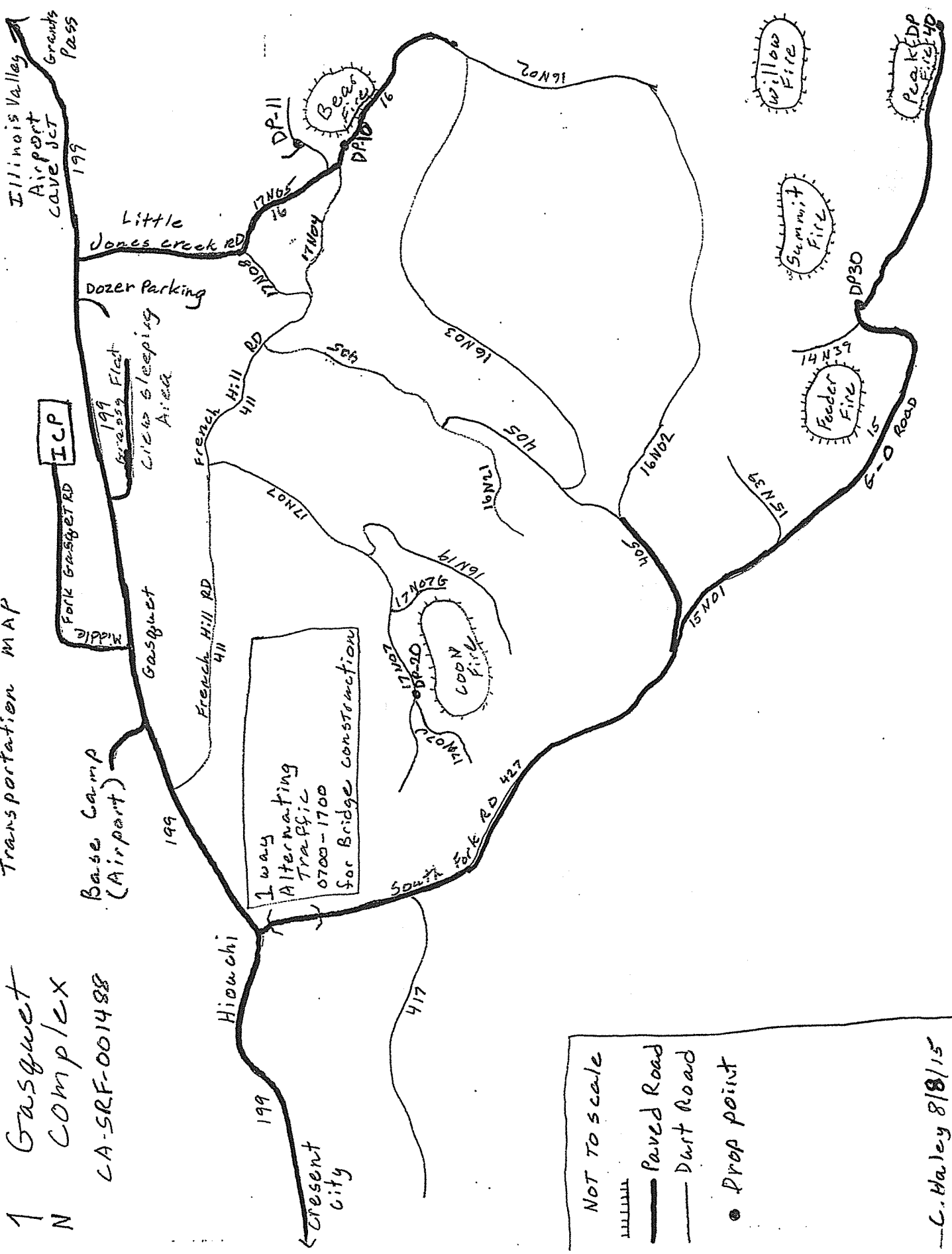

NOT TO SCALE

- ▬ Paved Road
- ▬ Dirt Road
- Prop point

— C. Maley 8/8/15

GASQUET COMPLEX BASE CAMP

Updated 08/10/2015

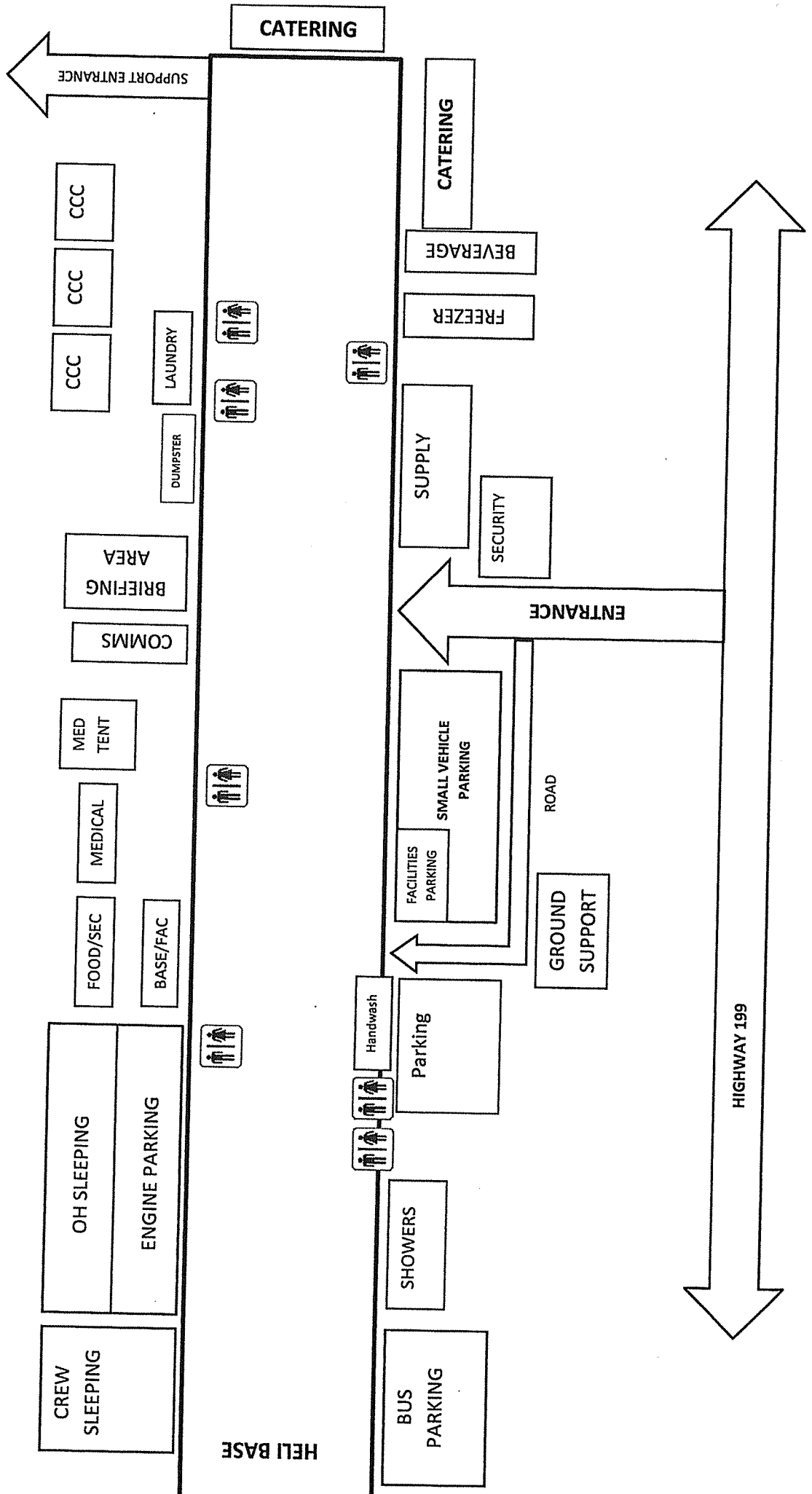
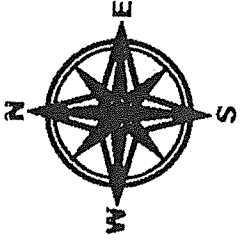

HELL BASE

SUPPORT ENTRANCE

CATERING

CATERING

BEVERAGE

FREEZER

SUPPLY

SECURITY

ENTRANCE

SMALL VEHICLE PARKING

FACILITIES PARKING

GROUND SUPPORT

ROAD

HIGHWAY 199

SHOWERS

Parking

Handwash

CREW SLEEPING

OH SLEEPING

ENGINE PARKING

FOOD/SEC

MEDICAL

MED TENT

COMMS

BRIEFING AREA

DUMPSTER

LAUNDRY

CCC

CCC

CCC

BUS PARKING

ICP

Mountain School
 55 Azalea Lane
 Gasket, CA 95543
 (707) 457-3211

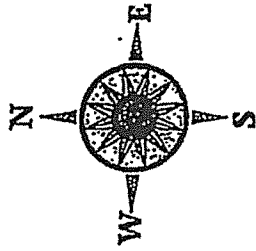

P	Portable	Fire Alarm Panel
C	Classroom	Water Shut Off
	Exit/Door	Electrical Shut Off
	Fire Extinguisher	

071410/Site Maps/Del Norte

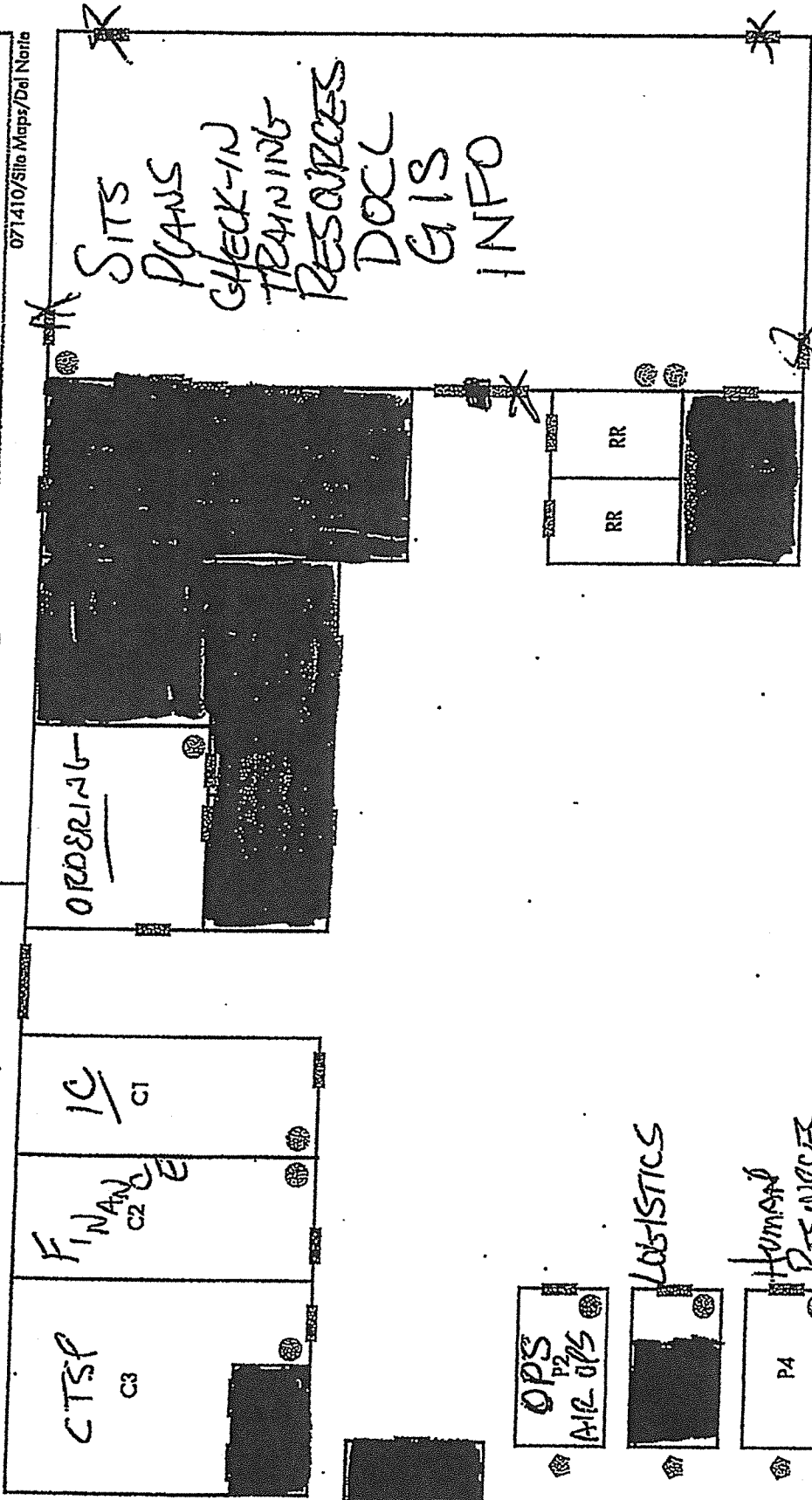

As of 8/7/2015

