

GASQUET COMPLEX

INCIDENT ACTION PLAN

OPERATIONAL PERIOD

AUG 12 - AUG 13, 2015

0600-0600



"Adapt...Improvise...and Overcome"



CA-SRF-001488
P5J0PQ (0510)

NAD 83
dd^o m.mm'

INCIDENT OBJECTIVES (ICS 202)

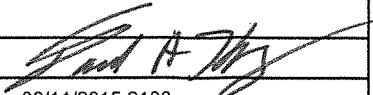
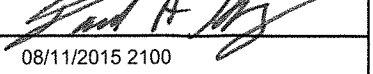
1. Incident Name:		2. Operational Period: 0600 - 0600	
GASQUET COMPLEX		Date/Time From: 08/12/2015 0600 WED	Date/Time To: 08/13/2015 0600 THU
3. Objective(s):			
<p>STRATEGIC FRAMEWORK: THE FRAMEWORK FOR THE GASQUET COMPLEX STRATEGIC PLAN CONSISTS OF USING A COMBINATION OF DIRECT ATTACK WHERE FEASIBLE, OTHERWISE INDIRECT USING NATURAL BARRIERS. A KEY ELEMENT IS FLEXIBILITY AND THE ABILITY TO APPLY THE RIGHT RESOURCE TO THE RIGHT TASK AT THE RIGHT TIME. FIRELINE WILL BE CONSTRUCTED ONLY WHERE FEASIBLE AND SAFE TO DO SO.</p> <p>LEADERS INTENT: PROVIDE THE HIGHEST LEVEL OF CUSTOMER SERVICES TO ALL INVOLVED WITH OR IMPACTED BY THE GASQUET COMPLEX. ALL INCIDENT PERSONNEL SHOULD BE PREPARED TO TAKE THE APPROPRIATE ACTIONS REGARDING:</p> <ul style="list-style-type: none"> • PERSONAL INTERACTIONS BOTH INSIDE AND OUTSIDE THE INCIDENT MANAGEMENT ORGANIZATION. • PERSONAL SAFETY AND THE SAFETY OF OTHERS. • AN INCIDENT-WITHIN-AN-INCIDENT. <p>OBJECTIVES:</p> <ul style="list-style-type: none"> • PROVIDE FOR FIREFIGHTER AND PUBLIC SAFETY BY ENSURING L C E S IS EVALUATED USING SOUND RISK MANAGEMENT PRINCIPLES. • MAINTAIN AND BUILD COOPERATOR AND STAKEHOLDER RELATIONSHIPS. • SUPPRESS FIRES WHILE NOT EXPOSING FIREFIGHTERS OR AIRCRAFT TO UNNECESSARY RISKS. • IDENTIFY AND PROTECT NATIVE AMERICAN TRADITIONAL AREAS AND OTHER SENSITIVE CULTURAL AND HISTORIC SITES. 			
4. Operational Period Command Emphasis:			
UTILIZE SUPPRESSION STRATEGIES COMMENSURATE WITH VALUES AT RISK. IMPLEMENT TACTICS WHICH INCREASE THE PROBABILITIES OF SUCCESS WHILE HOLDING EXISTING CONTAINMENT.			
General Situational Awareness:			
USE EMERGENCY LIGHTING AS NEEDED, ESPECIALLY WHEN WORKING ALONG PUBLIC ROADWAYS. DRIVE CAREFULLY THROUGH DOWNTOWN GASQUET.			
5. Site Safety Plan Required? Yes <input type="checkbox"/> No <input checked="" type="checkbox"/>			
Approved Site Safety Plan(s) Located at:			
6. Incident Action Plan (the items checked below are included in this Incident Action Plan):			
<input checked="" type="checkbox"/> ICS 202	<input type="checkbox"/> ICS 207	Other Attachments:	
<input checked="" type="checkbox"/> ICS 203	<input type="checkbox"/> ICS 208	<input checked="" type="checkbox"/> SAFETY / 215A	
<input checked="" type="checkbox"/> ICS 204	<input checked="" type="checkbox"/> ICS 220	<input checked="" type="checkbox"/> INCIDENT WITHIN AN INCIDENT	
<input checked="" type="checkbox"/> ICS 205	<input checked="" type="checkbox"/> Map/Chart	<input checked="" type="checkbox"/> TRAINING MESSAGE	
<input type="checkbox"/> ICS 205A	<input checked="" type="checkbox"/> Weather Forecast/Tides/Currents	<input checked="" type="checkbox"/> HR MESSAGE	
<input checked="" type="checkbox"/> ICS 206			
7. Prepared by: DAVE LATTIMORE		Position/Title: PSC2	
Signature:			
8. Approved by Incident Commander:		Name: DON GARWOOD	
Signature:			
ICS 202		IAP Page	
Date/Time: 08/11/2015 2100			

ORGANIZATION ASSIGNMENT LIST (ICS 203)

1. Incident Name:		2. Operational Period: 0600 - 0600	
GASQUET COMPLEX		Date/Time From: 08/12/2015 0600	Date/Time To: 08/13/2015 0600
		WED	THU
3. Incident Commander(s) and Command Staff:		7. Operations Section:	
IC/UC	DON GARWOOD	OPS SECTION CHIEF	NICKIE WASHINGTON DARRELL MILLER
DEPUTY	DAVE KELLY		
SAFETY OFFICER	JAMES ARAGON; P TOMPKINS; J BATES; F HERNANDEZ (T)	PLANNING OPS	MATTHEW CONKLIN AARON THOMPSON (T)
INFORMATION OFFICER	JIM WILKINS; ROBERT POOLE ASCENSION BRIBIESCAS		
LIAISON OFFICER	LARRY LA VOGUE 909-855-5756	DIVISION/GROUP	A - COON FIRE MITCH FOWLKES DAN O'CONNOR (T)
HUMAN RESOURCES	KATHY KREYNS 909-731-1771 ANDREA CABIDA (T)	DIVISION/GROUP	C - COON FIRE TADD MCDIVITT BRIAN BERRY (T)
4. Agency/Organization Representative(s):		DIVISION/GROUP	D - COON FIRE TRENT INGRAM KEN VAN WIG (T)
Agency/Organization	Name	DIVISION/GROUP	E - BEAR FIRE DAVID MARTINEZ JOHN OWINGS (T)
USFS	DAVE PALMER	DIVISION/GROUP	G - BEAR FIRE ERIC PLATZ CHRIS ST. PIERRE (T)
GASQUET VFD	NICK KARANPOULOS	DIVISION/GROUP	H/L/N/V WILLIAMS / PEAK / SUMMIT CANDICE KUTROSKY PAUL MANDOLINI (T)
CAL EMA	JOHN SALVATE	DIVISION/GROUP	W - FEEDER FIRE GLENN WEBB AL WARD (T)
CAL TRANS		DIVISION/GROUP	Z - FEEDER FIRE ADAM KOHLEY ROBERT ALLAN (T)
SRF-NFFE	ROBERTA CORAGLIOTTI 530-784-7542 JOHN MC RAE 707-845-8017	DIVISION/GROUP	CONTINGENCY JEREMY COWIE BRIAN FABBRI (T)
5. Planning Section:		7b. Air Operations Branch:	
CHIEF	DAVE LATTIMORE	AIR OPS BRANCH DIRECTOR	TED VISSER
DEPUTY	RICH STERRY (T)	AIR SUPPORT SUPERVISOR	GALEN YOUNG
RESOURCES UNIT	K HAUDUCOEUR, N MASTERS JOSEPH SCURI (T)	AIR ATTACK SUPERVISOR	CLIFF CLARIDGE KEN MCLAUGHLIN
SITUATION UNIT	GORDON TAMPLIN(T), TIM KNORR(T)	AIR TANKER COORDINATOR	
DOCUMENTATION	VANESSA HANSON	HELICOPTER COORDINATOR	
DEMOB UNIT	JIM STITELER (T)		
IMET	RACHEL COBB		
FIRE BEHAVIOR	BYRON KIMBALL		
SOPL	BOB LINEBACK		
TRAINING SPECIALIST	ANN HUTCHINSON		
GISS	R MURILLO; A. KIRSCH; A SALDIVAR(T)		
CTSP	CHARLES VERTREES		
6. Logistics Section:		8. Finance/Administration Section:	
CHIEF	ERIC SWEETMAN	CHIEF	DEBBIE YORK
DEPUTY	STEVE KING (T)	TIME UNIT	SHARON R MAKOSKY DEANNA THOMPSON (T)
SUPPLY UNIT	EVAN TISS; DAVID WHITNEY	COMPENSATION UNIT	BETH SJOBLUM
FACILITIES UNIT	ART CURLEY; DOUG WINN(T)	COST UNIT	THOMAS STEELE KRIS STERBENS (T)
GROUND SUPT UNIT	CHRIS HALEY; RON NOORDMAN		
COMM UNIT	DAVE LARKIN; CHRIS PERRY(T)		
MEDICAL UNIT	GENA FOWLKES MATTHEW MENARD (T)		
SECURITY UNIT	HEATHER NAIGUS		
FOOD UNIT	RICHARD WAITE		
9. Prepared By:	Name: KYLE HAUDUCOEUR	Position/Title: RESL	Signature:
ICS 203	IAP Page	Date/Time: 08/10/2015 2100	

FIRE BEHAVIOR FORECAST

FORECAST NUMBER: #9	TYPE OF FIRE: Wildland Fire
FIRE NAME: Gasquet Complex	OPERATIONAL PERIOD: August 12, 2015
DATE ISSUED: August 11, 2015	TIME ISSUED: 2000
UNIT: Smith River NRA, Six Rivers NF	SIGNED: <i>Byron R Kimball</i>
	Typed/printed:/s/ Byron R. Kimball FBAN

INPUTS

WEATHER SUMMARY: Off shore low pressure ridge will be south of the area, only result being partly cloudy skies. Temperature and Relative Humidity will remain near normal, with light winds across the area.

MAX TEMPERATURE.....High 60's to Low 70's.

MIN HUMIDITY.....35 - 45%

EYE LEVEL WINDS.....Light and Variable early, Becoming west to southwest 3 to 5 along the ridges in the afternoon.

For more specific information, please see the Spot Weather forecast

OUTPUTS

FIRE BEHAVIOR

GENERAL:

Lower humidities and less cloud cover may lead to more activity. RH below 40% has proven to be a trigger for more energetic burning. Light winds will help dry out the lighter fuels, but fires will be terrain driven if runs get going. Increased air movement may be enough to bring supposedly dead areas back to life. Be sure to keep eyes on all unlined sections of the line.

With line construction in incomplete burns, be positive that you are exposing the black edge and getting all the hot ash and embers inside your line.

SPECIFIC:

Timber Understory: Fire behavior in the Understory models may increase. Drier RH and increased solar heating may increase overall general activity.

ROS: 5 to 10 ch/hr.

FL: 6 to 8 ft.

Timber Litter: Timber Litter fire behavior should be more active. More sunlight coupled with lower RH may lead to more complete consumption with an associated increase in intensity. Stay aware of rollout and upslope runs through incomplete burns.

ROS: 3 to 6 ch/hr.

FL: 2 to 3 ft.

Rollout of heavier fuels continues to present a concern as the fires work into the drainages. Be prepared for a slope reversal run if fire establishes with sufficient heat.

AIR OPERATIONS:

Inversion above 6000 ft all day. May be able to work underneath the inversion but visibility will remain limited.

SAFETY

Be aware of fire in the standing timber and instability of trees and snags. Ash pits and stump holes become more of an issue the longer the fire burns in the fuel bed.

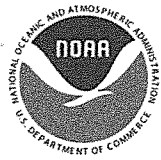

INCIDENT Weather Forecast



FORECAST NO: 1

NAME OF FIRE: Gasquet Complex

PREDICTION FOR: Day Shift

SHIFT DATE: 8/12/2015

SIGNED: *Rachel Cobb*

TIME AND DATE

FORECAST ISSUED: 1900 8/11/2015

Rachel Cobb

Incident Meteorologist

WEATHER DISCUSSION: An area of low pressure will be southwest of the area on Wednesday, but far enough offshore that the only influence will be partly cloudy skies. Temperatures will be near normal for this time of year, but relative humidity will be slightly below normal. The low will then start to move back to the north on Thursday, and slightly cooler and moister conditions can be expected, with a possible light rain shower. Winds will generally be light and terrain driven both Wednesday and Thursday.

WEATHER FORECAST for Wednesday:

WEATHER: Partly cloudy and smoky.

MAXIMUM TEMPERATURES: 70 – 75 degrees valleys...65 – 70 degrees ridges.

MINIMUM HUMIDITY: 35 – 45 percent.

20 FT WINDS:

RIDGETOP – Southeast 5 to 10 mph becoming westerly in the afternoon.

SLOPE/VALLEY – Upslope/upvalley 2 to 6 mph.

HAINES INDEX: 4 (low).

STABILITY/INVERSION: Inversion not lifting above 6000 feet msl.

OUTLOOK for Wednesday Night: Partly cloudy and smoky. Low temperatures 50 – 55 degrees and maximum relative humidity 75 – 90%. Ridgetop winds north-northeast 3 to 6 mph. Haines Index: 2.

OUTLOOK for Thursday: Partly cloudy and smoky. A slight chance of showers. Highs 60 – 70 degrees and relative humidity 40 – 50%. Ridgetop winds westerly 5 to 10 mph. Mixing height: 6000 feet msl. Haines Index: 2.

EXTENDED FORECAST: The low will move away from the area on Friday, and high pressure will return Saturday. Therefore, a warming and drying trend can be expected Friday through at least Sunday.

Division/Group Assignment List (ICS 204 WF)

1. Incident Name:			3.			
GASQUET COMPLEX			Branch:		Division/Group:	
2. Operational Period: 0600 - 0600			A - COON FIRE			
Date/Time From: 08/12/2015 0600 WED		Date/Time To: 08/13/2015 0600 THU				
4. Operations Personnel						
OPERATIONS CHIEF		NICKIE WASHINGTON DARRELL MILLER		DIVISION/GROUP SUPERVISOR		MITCH FOWLKES DAN O'CONNOR (T)
PLANNING OPS		MATT CONKLIN AARON THOMPSON (T)		AIR ATTACK SUPERVISOR		CLIFF CLARIDGE KEN MCLAUGHLIN
5. Resources Assigned this Period						
Strike Team / Task Force / Resource Designator		LWD	Leader	Number Persons	Drop Off PT./Time	Pick Up PT./Time
HC2 STEELHEAD C-30		08/15	ALEJANDRO RODRIGUEZ	20	ICP/0630	ICP/1900
HCM HOOPA O-275		08/24	ROCKY COLEGROVE	12	ICP/0630	ICP/1900
TFLD VIKTORA / WHEELER (T)		08/18		2	ICP/0630	ICP/1900
TFLD PHILLIPS O-75 / KEYSE (T) O-78		08/18		2	ICP/0630	ICP/1900
ENG3 LKP 5031 E-75		08/14	RICK BERGEN	3	ICP/0630	ICP/1900
ENG3 SRM 331 E-76		08/14	MIKE AVERY	4	ICP/0630	ICP/1900
ENG3 CRK 379 E-77		08/14	JOHN ANGELL	4	ICP/0630	ICP/1900
ENG6 ALBANY 2180 E-79		08/21	TIM SMYSER	3	ICP/0630	ICP/1900
HEQB HEISEY O-84 / DOZ2 ROEN 9481 E-90		08/20		2	ICP/0630	ICP/1900
HEQB LANTERMAN O-83 / DOZ2 FISK'S E-91		08/21		2	ICP/0630	ICP/1900
HEQB TERRY CARRICO O-217		08/24		1	ICP/0630	ICP/1900
SKG4 L & L EXCAVATING W/ TRSPT E-111		08/23	SHANE NODINE	2	ICP/0630	ICP/1900
SKG3 UNDERHILL 1 W/ TRSPT E-112		08/22	JOE BRADBURY	2	ICP/0630	ICP/1900
FAL1 NORTH ZONE FALLERS #1 O-94		08/18	ALAN STEWART	2	ICP/0630	ICP/1900
WTS2 DUDLEY'S E-136		08/25	DON GUICE	1	ICP/0630	ICP/1900
FEMT RANDOLPH O-133 / VANZINNI O-134		08/21		2	ICP/0630	ICP/1900
6. Control Operations/Work Assignments:						
<ul style="list-style-type: none"> • SCOUT FOR OPPORTUNITIES TO REACH CONTAINMENT OBJECTIVES. • CONTINUE INDIRECT DOZER LINE FROM 17N07J ROAD WEST TO SOUTH FORK OF THE SMITH RIVER AND IDENTIFY SAFETY ZONES. 						
7. Special Instructions:						
• COORDINATE AND ORDER AIRCRAFT FOR WATER AND RETARDANT NEEDS WITH AIR ATTACK.						
8. Division/Group Communication Summary						
Function	Channel	RX Frequency N/W	RX Tone/NAC	TX Frequency N/W	TX Tone/NAC	Mode
COMMAND	1	167.1000	162.2	169.7500	162.2	A
TACTICAL	13	167.1125	162.2	167.1125	162.2	A
BACKUP NET	4	168.1250		170.4750	127.3	A
AIR TO GROUND	10	165.3875		165.3875		A
9. Prepared By (Resource Unit Leader)			Approved By (Planning Section Chief)		Date	Time
NANCY MASTERS			DAVE LATTIMORE		08/11/2015	2100

Division/Group Assignment List (ICS 204 WF)

1. Incident Name:			3.			
GASQUET COMPLEX			Branch:		Division/Group:	
2. Operational Period: 0600 - 0600					C - COON FIRE	
Date/Time From: 08/12/2015 0600 WED	Date/Time To: 08/13/2015 0600 THU					
4. Operations Personnel						
OPERATIONS CHIEF		NICKIE WASHINGTON DARRELL MILLER		DIVISION/GROUP SUPERVISOR		TODD MCDIVITT BRIAN BERRY (T)
PLANNING OPS		MATT CONKLIN AARON THOMPSON (T)		AIR ATTACK SUPERVISOR		CLIFF CLARIDGE KEN MCLAUGHLIN
5. Resources Assigned this Period						
Strike Team / Task Force / Resource Designator		LWD	Leader	Number Persons	Drop Off PT./Time	Pick Up PT./Time
HCM BEAR PEAK O-59		08/23	FRED FLEISCHMAN	9	ICP/0630	ICP/1900
ES3 2141C E-122		08/20	PETE DAVIS	21	ICP/0630	ICP/1900
ENG3 SANTA CLARA VFD 33 E-29		08/19	TYREL HANSEN	4	ICP/0630	ICP/1900
ENG3 SRF 11 E-189		08/24	JOE ENIEM	5	ICP/0630	ICP/1900
HEQB RICH WATERS O-85		08/18		1	ICP/0630	ICP/1900
DOZ2 BROWNING E-44		08/20	PAT BROWNING	1	ICP/0630	ICP/1900
DOZ2 WARNER E-43		08/18	DAN WARNER	3	ICP/0630	ICP/1900
WTT2 WOOD'S 99 E-87		08/15	STEVE WENDT	2	ICP/0630	ICP/1900
WTS2 ALL AGENCY E-38		08/18	HILL JOHN	1	ICP/0630	ICP/1900
WTS2 SIERRA TIMBER E-42		08/19	DOUG LINGEN	1	ICP/0630	ICP/1900
WTS2 WILLS E-138		08/25	PHIL WILLS	1	ICP/0630	ICP/1900
SOFR BOB SCHNEIDER (T) O-90		08/20		1	ICP/0630	ICP/1900
6. Control Operations/Work Assignments:						
<ul style="list-style-type: none"> IMPROVE HANDLINE FROM DOZER LINE TO COON CREEK. SCOUT FOR SECONDARY CONTINGENCY LINE SECURE ALL FIRE WEST OF THE 17NO7G ROAD FROM DP 20 TO COON CREEK. 						
7. Special Instructions:						
<ul style="list-style-type: none"> COORDINATE AND ORDER AIRCRAFT FOR RETARDANT NEEDS WITH AIR ATTACK. FOBS PIPPIN / HAMMER (T) WORKING IN DIV. A AND DIV. C. 						
8. Division/Group Communication Summary						
Function	Channel	RX Frequency N/W	RX Tone/NAC	TX Frequency N/W	TX Tone/NAC	Mode
COMMAND	1	167.1000	162.2	169.7500	162.2	A
TACTICAL	5	166.7250	162.2	166.7250	162.2	A
BACKUP NET	4	168.1250		170.4750	127.3	A
AIR TO GROUND	10	165.3875		165.3875		A
9. Prepared By (Resource Unit Leader)			Approved By (Planning Section Chief)		Date	Time
JOE SCURI (T)			DAVE LATTIMORE		08/11/2015	2100

Division/Group Assignment List (ICS 204 WF)

1. Incident Name:			3.			
GASQUET COMPLEX			Branch:		Division/Group:	
2. Operational Period: 0600 - 0600			D - COON FIRE			
Date/Time From: 08/12/2015 0600 WED						Date/Time To: 08/13/2015 0600 THU
4. Operations Personnel						
OPERATIONS CHIEF		NICKIE WASHINGTON; DARREL MILLER		DIVISION/GROUP SUPERVISOR		
				TRENT INGRAM; KEN VAN WIG (T)		
PLANNING OPS		MATT CONKLIN; AARON THOMPSON (T)		AIR ATTACK SUPERVISOR		
				CLIFF CLARIDGE KEN MCLAUGHLIN		
5. Resources Assigned this Period						
Strike Team / Task Force / Resource Designator		LWD	Leader	Number Persons	Drop Off PT./Time	Pick Up PT./Time
ENG6 PATRICK 14 E-117		08/14	JOEL DICE	3	ICP /0630	ICP/1900
ENG6 DARE ENTERPRISES 32 E-118		08/14	RICO SCHRAFF	3	ICP /0630	ICP/1900
ENG6 ASI 3 E-115		08/15	MICHAEL HOLLOWAY	3	ICP /0630	ICP/1900
6. Control Operations/Work Assignments:						
<ul style="list-style-type: none"> • COMPLETE STRUCTURE PREP OF TOLLEFSON PROPERTY. • SCOUT FOR OPPORTUNITIES TO DEVELOP CONTROL LINE FROM DIV A TO DIV C. 						
7. Special Instructions:						
<ul style="list-style-type: none"> • COORDINATE AND ORDER AIRCRAFT FOR RETARDANT NEEDS WITH AIR ATTACK. 						
8. Division/Group Communication Summary						
Function	Channel	RX Frequency N/W	RX Tone/NAC	TX Frequency N/W	TX Tone/NAC	Mode
COMMAND	1	167.1000	162.2	169.7500	162.2	A
TACTICAL	14	168.2375	162.2	168.2375	162.2	A
BACKUP NET	4	168.1250		170.4750	127.3	A
AIR TO GROUND	10	165.3875		165.3875		A
9. Prepared By (Resource Unit Leader)		Approved By (Planning Section Chief)			Date	Time
JOE SCURI (T)		DAVE LATTIMORE			08/11/2015	2100

Division/Group Assignment List (ICS 204 WF)

1. Incident Name:			3.			
GASQUET COMPLEX			Branch:		Division/Group:	
2. Operational Period: 0600 - 0600					E - BEAR FIRE	
Date/Time From: 08/12/2015 0600	WED	Date/Time To: 08/13/2015 0600	THU			
4. Operations Personnel						
OPERATIONS CHIEF		NICKIE WASHINGTON DARRELL MILLER		DIVISION/GROUP SUPERVISOR		DAVID MARTINEZ JOHN OWINGS (T)
PLANNING OPS		MATT CONKLIN AARON THOMPSON (T)		AIR ATTACK SUPERVISOR		CLIFF CLARIDGE KEN MCLAUGHLIN
5. Resources Assigned this Period						
Strike Team / Task Force / Resource Designator		LWD	Leader	Number Persons	Drop Off PT./Time	Pick Up PT./Time
HC2I GRAYBACK 8B C-5		08/12	TIM NYGREN	20	ICP/0630	ICP/1900
HC2 FORT APACHE 3 C-10		08/20	BURNETTE BENNETT	20	ICP/0630	ICP/1900
TFLD S. SISCOE O-79 / N. BALENT (T) 0-209		08/20		2	ICP/0630	ICP/1900
ENG3 UTAH COUNTY 12 E-31		08/19	ANDREW WATSON	4	ICP/0630	ICP/1900
ENG3 PICTURE ROCK 121 E-26		08/20	ROCKY ORTIZ	4	ICP/0630	ICP/1900
TFLD TONY ERICKSON O-232		08/23		1	ICP/0630	ICP/1900
ENG6 NV-WID 2616 E-35		08/19	CHAD NIBLETT	3	ICP/0630	ICP/1900
ENG6 WEBER FIRE 661 E-33		08/19	SCOTT HANEY	3	ICP/0630	ICP/1900
ENG6 GREAT BASIN 311 E-34		08/19	TYLER ERSKINE	3	ICP/0630	ICP/1900
DOZ2 PLUMAS 1 E-126		08/24	JAMES SMITH	4	ICP/0630	ICP/1900
WTS2 YREKA OUTLANDS E-19		08/18	ALLEN WILLIAMS	2	ICP/0630	ICP/1900
FAL1 BROWN O-201 / MILLER TIMBER O-204		08/21	D. BROWN / C. GOODSON	4	ICP/0630	ICP/1900
FEMP FELDMAN O-135 / FEMT WICKLAS O-132		08/20		2	ICP/0630	ICP/1900
6. Control Operations/Work Assignments:						
<ul style="list-style-type: none"> • CONTINUE TO HOLD AND IMPROVE LINE ALONG THE 17N03 ROAD. • CONTINUE DOZER LINE FROM 17N05 DOWN 17N35 RIDGE. • CONTINUE PREP FROM DP10 TO 17N04 RD. • IMPROVE ANCHOR POINT AND SECURE HANDLINE CONSTRUCTION ON WEST FLANK. 						
7. Special Instructions:						
<ul style="list-style-type: none"> • COORDINATE AND ORDER AIRCRAFT FOR RETARDANT NEEDS WITH AIR ATTACK. 						
8. Division/Group Communication Summary						
Function	Channel	RX Frequency N/W	RX Tone/NAC	TX Frequency N/W	TX Tone/NAC	Mode
COMMAND	1	167.1000	162.2	169.7500	162.2	A
TACTICAL	6	166.7750	162.2	166.7750	162.2	A
BACKUP NET	4	168.1250		170.4750	127.3	A
AIR TO GROUND	10	165.3875		165.3875		A
9. Prepared By (Resource Unit Leader)			Approved By (Planning Section Chief)		Date	Time
JOE SCURI (T)			DAVE LATTIMORE		08/10/2015	2100

Division/Group Assignment List (ICS 204 WF)

1. Incident Name:				3.			
GASQUET COMPLEX				Branch:		Division/Group: G - BEAR FIRE	
2. Operational Period: 0600 - 0600							
Date/Time From: 08/12/2015 0600 WED		Date/Time To: 08/13/2015 0600 THU					
4. Operations Personnel							
OPERATIONS CHIEF		NICKIE WASHINGTON DARRELL MILLER		DIVISION/GROUP SUPERVISOR		ERIC PLATZ CHRIS ST PIERRE (T)	
PLANNING OPS		MATT CONKLIN AARON THOMPSON (T)		AIR ATTACK SUPERVISOR		CLIFF CLARIDGE KEN MCLAUGHLIN	
5. Resources Assigned this Period							
Strike Team / Task Force / Resource Designator		LWD	Leader	Number Persons	Drop Off PT./Time	Pick Up PT./Time	
HC2 FORT APACHE 4 C-11		08/20	DANNY EDWARDS	19	ICP/0630	ICP/1900	
TFLD JOEL PETERS O-226		08/23		1	ICP/0630	ICP/1900	
FELB CHRIS HENRIE O-181		08/24		1	ICP/0630	ICP/1900	
FAL1 NORTH ZONE FALLERS #2 O-95		08/18	BILLY BELMONT	2	ICP/0630	ICP/1900	
FAL1 NORTH ZONE FALLERS #4 O-97		08/18	BILL MEADOWS	2	ICP/0630	ICP/1900	
FAL1 MCKELLER TREE O-202		08/22	DOUG MCKELLAR	2	ICP/0630	ICP/1900	
WTS2 TRAYNHAM TRUCKING E-137		08/25	DAVE DAMON	1	ICP/0630	ICP/1900	
SOFR BRAD LIDELL O-252		08/25		1	ICP/0630	ICP/1900	
6. Control Operations/Work Assignments:							
<ul style="list-style-type: none"> SCOUT FOR OPPORTUNITIES FOR DIRECT LINE CONSTRUCTION. PREP BEAR BASIN LOOKOUT TOWER. CONTINUE LINE PREP FROM BEAR BASIN LOOKOUT DOWN THE SHIP MT RD TO THE WILDERNESS BOUNDARY. 							
7. Special Instructions:							
<ul style="list-style-type: none"> COORDINATE AND ORDER AIRCRAFT FOR WATER ONLY DROPS WITH AIR ATTACK. FOBS SCHEID / BAERTSCHI (T) WORKING IN DIV E AND DIV G. 							
8. Division/Group Communication Summary							
Function	Channel	RX Frequency N/W	RX Tone/NAC	TX Frequency N/W	TX Tone/NAC	Mode	
COMMAND	1	167.1000	162.2	169.7500	162.2	A	
TACTICAL	7	168.2500	162.2	168.2500	162.2	A	
BACKUP NET	4	168.1250		170.4750	127.3	A	
AIR TO GROUND	10	165.3875		165.3875		A	
9. Prepared By (Resource Unit Leader)			Approved By (Planning Section Chief)			Date	Time
KYLE HAUDUCOEUR			DAVE LATTIMORE			08/11/2015	2100

Division/Group Assignment List (ICS 204 WF)

1. Incident Name:			3.			
GASQUET COMPLEX			Branch:		Division/Group: H/L/N/V - PEAK FIRE	
2. Operational Period: 0600 - 0600						
Date/Time From: 08/12/2015 0600 WED		Date/Time To: 08/13/2015 0600 THU				
4. Operations Personnel						
OPERATIONS CHIEF		NICKIE WASHINGTON DARRELL MILLER		DIVISION/GROUP SUPERVISOR		CANDICE KUTROSKY PAUL MANDOLINI (T)
PLANNING OPS		MATT CONKLIN AARON THOMPSON (T)		AIR ATTACK SUPERVISOR		CLIFF CLARIDGE KEN MCLAUGHLIN
5. Resources Assigned this Period						
Strike Team / Task Force / Resource Designator		LWD	Leader	Number Persons	Drop Off PT./Time	Pick Up PT./Time
TFLD GREGORY COX O-74		08/18		1	ICP/0630	ICP/1900
TFLD DALE NEWBY (T) O-73		08/18		1	ICP/0630	ICP/1900
ENG3 TRI CITY 106 E-25		08/19	ANTHONY GRAINGER	4	ICP/0630	ICP/1900
ENG3 MONTANA FIRE 341 E-30		08/20	MIKE WARREN	3	ICP/0630	ICP/1900
ENG4 FIRESTORM 03 E-114		08/14	BRAD CLEMENS	3	ICP/0630	ICP/1900
ENG4 CENTRAL WILDFIRE 741 E-116		08/14	DAVID PARSON	3	ICP/0630	ICP/1900
ENG6 SANTA CLARA 32 E-37		08/19	GABE RUNOLFSON	2	ICP/0630	ICP/1900
WTS2 ROGER CHERRY E-140		08/25	ROGER CHERRY	1	ICP/0630	ICP/1900
FEMP MATT LUCAS O-137		08/20		1	ICP/0630	ICP/1900
FEMT TONY CASTANEDA O-131		08/20		1	ICP/0630	ICP/1900
6. Control Operations/Work Assignments:						
<ul style="list-style-type: none"> KEEP FIRE NORTH AND EAST OF G-O ROAD IF POSSIBLE. FOLLOW THE MINIMUM REQUIREMENT DIRECTION OF 8-11-15. 						
7. Special Instructions:						
<ul style="list-style-type: none"> ALL RESOURCES USE CALL SIGN "LIMA" COORDINATE AND ORDER AIRCRAFT FOR WATER ONLY DROPS WITH AIR ATTACK. MONITOR SUMMIT & WILLIAMS FIRES BY AIR RAPID EXTRACTION MODULE (R.E.M.) AVAILABLE TO ALL DIVISIONS AND CONTINGENCY GROUP. FOBS - JUSTIN RICK & CHRIS TWEED(T) 						
8. Division/Group Communication Summary						
Function	Channel	RX Frequency N/W	RX Tone/NAC	TX Frequency N/W	TX Tone/NAC	Mode
COMMAND	1	167.1000	162.2	169.7500	162.2	A
TACTICAL	8	168.0500	162.2	168.0500	162.2	A
BACKUP NET	4	168.1250		170.4750	127.3	A
AIR TO GROUND	10	165.3875		165.3875		A
9. Prepared By (Resource Unit Leader)			Approved By (Planning Section Chief)		Date	Time
KYLE HAUDUCOEUR			DAVE LATTIMORE		08/11/2015	2100

Division/Group Assignment List (ICS 204 WF)

1. Incident Name:			3.			
GASQUET COMPLEX			Branch:		Division/Group: W - FEEDER FIRE	
2. Operational Period: 0600 - 0600						
Date/Time From: 08/12/2015 0600 WED		Date/Time To: 08/13/2015 0600 THU				
4. Operations Personnel						
OPERATIONS CHIEF		NICKIE WASHINGTON DARRELL MILLER		DIVISION/GROUP SUPERVISOR		GLENN WEBB AL WARD (T)
PLANNING OPS		MATT CONKLIN AARON THOMPSON (T)		AIR ATTACK SUPERVISOR		CLIFF CLARIDGE KEN MCLAUGHLIN
5. Resources Assigned this Period						
Strike Team / Task Force / Resource Designator		LWD	Leader	Number Persons	Drop Off PT./Time	Pick Up PT./Time
HC2I WHITE MOUNTAIN #1 C-3		08/19	KEITH M SARGENT	19	ICP/0630	ICP/1900
TFLD HYATT O-144 / OLEARY O-234		08/16		2	ICP/0630	ICP/1900
ENG2 GASQUET 214 E-78		08/14	TOM ZURFLUEH	4	ICP/0630	ICP/1900
ENG4 WEBER FIRE DISTRICT 464 E-80		08/14	BARRY LOCKE	4	ICP/0630	ICP/1900
ENG6 TONTO 1247 E-82		08/16	SHAWN O'CONNELL	7	ICP/0630	ICP/1900
ENG6 AMERICAN FIRE CO 61 E-86		08/14	MATT MORRELL	3	ICP/0630	ICP/1900
ENG6 AMERICAN FIRE CO 62 E-85		08/14	MANI MORRELL	3	ICP/0630	ICP/1900
HEQB HARRIS O-218 / EXCA WALBERG, INC E-57		08/25		3	ICP/0630	ICP/1900
HEQB MCCLELLAN O-216 / DOZ2 A TEAM E-127		08/24		5	ICP/0630	ICP/1900
WTT2 SRF 15 E-45		08/16	JACOB MC ADAMS	2	ICP/0630	ICP/1900
WTT2 GASQUET VFD E-88		08/15	SALENA COX	2	ICP/0630	ICP/1900
FAL1 NORTH ZONE FALLERS #3 O-96		08/18	RICK MEE	2	ICP/0630	ICP/1900
6. Control Operations/Work Assignments:						
<ul style="list-style-type: none"> CONTINUE PREPPING THE 14N39 ROAD FROM DP30 NORTH TO 14N39G ROAD. SECURE AND HOLD FIRE ALONG 14N39 ROAD TO 14N39G ROAD. SCOUT FOR OPPORTUNITY TO REACH CONTAINMENT OBJECTIVES. 						
7. Special Instructions:						
<ul style="list-style-type: none"> COORDINATE AND ORDER AIRCRAFT FOR RETARDANT NEEDS WITH AIR ATTACK. RAPID EXTRACTION MODULE (R.E.M.) AVAILABLE TO ALL DIVISIONS AND CONTINGENCY GROUP 						
8. Division/Group Communication Summary						
Function	Channel	RX Frequency N/W	RX Tone/NAC	TX Frequency N/W	TX Tone/NAC	Mode
COMMAND	1	167.1000	162.2	169.7500	162.2	A
TACTICAL	12	166.5500	162.2	166.5500	162.2	A
BACKUP NET	4	168.1250		170.4750	127.3	A
AIR TO GROUND	10	165.3875		165.3875		A
9. Prepared By (Resource Unit Leader)			Approved By (Planning Section Chief)		Date	Time
JOE SCURI (T)			DAVE LATTIMORE		08/11/2015	2100

Division/Group Assignment List (ICS 204 WF)

1. Incident Name:			3.			
GASQUET COMPLEX			Branch:		Division/Group:	
2. Operational Period: 0600 - 0600					Z - FEEDER FIRE	
Date/Time From: 08/12/2015 0600	WED	Date/Time To: 08/13/2015 0600	THU			
4. Operations Personnel						
OPERATIONS CHIEF		NICKIE WASHINGTON DARRELL MILLER		DIVISION/GROUP SUPERVISOR		ADAM KOHLEY ROBERT ALLAN (T)
PLANNING OPS		MATT CONKLIN AARON THOMPSON (T)		AIR ATTACK SUPERVISOR		CLIFF CLARIDGE KEN MCLAUGHLIN
5. Resources Assigned this Period						
Strike Team / Task Force / Resource Designator		LWD	Leader	Number Persons	Drop Off PT./Time	Pick Up PT./Time
HC1 SMITH RIVER C-29		08/23	TIM MEMMER	19	ICP/0630	ICP/1900
HC2I NHS#1 C-4		08/19	JOHN ROSS	20	ICP/0630	ICP/1900
TFLD CATHLEEN LOWE O-76		08/19		1	ICP/0630	ICP/1900
ENG3 LONE PEAK 1667 E-27		08/19	TOM WILSON	7	ICP/0630	ICP/1900
ENG6 GRAND COUNTY 6802 E-36		08/19	MARK MARCUM	2	ICP/0630	ICP/1900
HEQB DWAYNE ANDERSON O-215		08/24		1	ICP/0630	ICP/1900
DOZ2 J A COOK E-170		08/25	JON COOK	2	ICP/0630	ICP/1900
WTS2 BOWNE WATER SERVICE E-40		08/17	MICHAEL BOONE	1	ICP/0630	ICP/1900
FAL1 CECIL LOGGING O-203		08/22	MICHEAL BERRY	2	ICP/0630	ICP/1900
SOFR PETE VILLA O-68		08/19		1	ICP/0630	ICP/1900
SOFR BILL KERSHAW (T) O-3.19		08/15		1	ICP/0630	ICP/1900
6. Control Operations/Work Assignments:						
<ul style="list-style-type: none"> CONTINUE PREP WORK ON G-O ROAD, FROM W / Z BREAK NORTH TO 15N01U ROAD. SCOUT FOR OPPORTUNITIES TO REACH CONTAINMENT OBJECTIVE. 						
7. Special Instructions:						
<ul style="list-style-type: none"> COORDINATE AND ORDER AIRCRAFT FOR RETARDANT NEEDS WITH AIR ATTACK. RAPID EXTRACTION MODULE (R.E.M.) AVAILABLE TO ALL DIVISIONS AND CONTINGENCY GROUP. FOBS MASTERS / RICK / TWEED (T) WORKING IN DIV W AND DIV Z. 						
8. Division/Group Communication Summary						
Function	Channel	RX Frequency N/W	RX Tone/NAC	TX Frequency N/W	TX Tone/NAC	Mode
COMMAND	1	167.1000	162.2	169.7500	162.2	A
TACTICAL	9	168.6000	162.2	168.6000	162.2	A
BACKUP NET	4	168.1250		170.4750	127.3	A
AIR TO GROUND	10	165.3875		165.3875		A
9. Prepared By (Resource Unit Leader)			Approved By (Planning Section Chief)		Date	Time
JOE SCURI (T)			DAVE LATTIMORE		08/11/2015	2100

Division/Group Assignment List (ICS 204 WF)

1. Incident Name:			3.			
GASQUET COMPLEX			Branch:		Division/Group:	
2. Operational Period: 0600 - 0600					CONTINGENCY GROUP	
Date/Time From: 08/12/2015 0600 WED			Date/Time To: 08/13/2015 0600 THU			
4. Operations Personnel						
OPERATIONS CHIEF		NICKIE WASHINGTON DARRELL MILLER		DIVISION/GROUP SUPERVISOR		JEREMY COWIE BRIAN FABBRI (T)
PLANNING OPS		MATT CONKLIN AARON THOMPSON (T)		AIR ATTACK SUPERVISOR		CLIFF CLARIDGE KEN MCLAUGHLIN
5. Resources Assigned this Period						
Strike Team / Task Force / Resource Designator		LWD	Leader	Number Persons	Drop Off PT./Time	Pick Up PT./Time
TFLD JON OLSEN O-233		08/24		1	ICP/0630	ICP/1900
CHIP CECIL 1 E-130		08/25	JUSTIN CECIL	2	ICP/0630	ICP/1900
CHIP COASTAL TREE SERVICE E-131		08/24	JOHN DILLON	2	ICP/0630	ICP/1900
6. Control Operations/Work Assignments:						
<ul style="list-style-type: none"> • COORDINATE WITH SOPL TO VALIDATE LONG TERM PLANS. • COORDINATE CHIPPING ACTIVITIES WITH ALL DIVISIONS. 						
7. Special Instructions:						
<ul style="list-style-type: none"> • RAPID EXTRACTION MODULE (R.E.M.) AVAILABLE TO ALL DIVISIONS AND CONTINGENCY GROUP • REVIEW CHIPPER JHA. • FOBS - PENNY / MASTERS. 						
8. Division/Group Communication Summary						
Function	Channel	RX Frequency N/W	RX Tone/NAC	TX Frequency N/W	TX Tone/NAC	Mode
COMMAND		SEE COMM PLAN				
TACTICAL						
BACKUP NET						
AIR TO GROUND						
9. Prepared By (Resource Unit Leader)			Approved By (Planning Section Chief)		Date	Time
JOE SCURI (T)			DAVE LATTIMORE		08/11/2015	2100

INCIDENT RADIO COMMUNICATIONS PLAN (ICS 205)

1. Incident Name:		2. Date/Time Prepared:		3. Operational Period: 0600 - 0600						
GASQUET COMPLEX		Date: 08/11/2015	Time: 2100	Date/Time From: 08/12/2015 0600	WED	Date/Time To: 08/12/2015 0600	WED			
4. Basic Radio Channel Use:										
Zone Group	Ch #	Function	Channel Name/Trunked Radio System Talkgroup	Assignment	RX Freq	RX Tone/NAC	TX Freq	TX Tone/NAC	Mode (A, D, or M)	Remarks
	1	COMMAND	CMD 1	ALL DIVISIONS	167.1000	162.2	169.7500	162.2	A	SHIP MTN
	2	COMMAND	CMD 2	UNASSIGNED	000.0000		000.0000		A	
	3	COMMAND	CMD 3	UNASSIGNED	000.0000		000.0000		A	
	4	BACKUP NET	SRF ADM	ALL DIVISIONS	168.1250		170.4750	127.3	A	GORDON MTN
	5	TACTICAL	NIFC T5	DIV C	166.7250	162.2	166.7250	162.2	A	
	6	TACTICAL	NIFC T6	DIV E	166.7750	162.2	166.7750	162.2	A	
	7	TACTICAL	NIFC T7	DIV G	168.2500	162.2	168.2500	162.2	A	
	8	TACTICAL	NIFC T1	DIV H/L/N/V	168.0500	162.2	168.0500	162.2	A	CALL SIGN DIV L
	9	TACTICAL	NIFC T3	DIV Z	168.6000	162.2	168.6000	162.2	A	
	10	AIR TO GROUND	A/G TAC	ALL DIVISIONS	165.3875		165.3875		A	
	11	AIR TO GROUND	A/G CMD	UNASSIGNED	000.0000		000.0000		A	
	12	TACTICAL	R5 TAC 4	DIV W	166.5500	162.2	166.5500	162.2	A	
	13	TACTICAL	R5 TAC 5	DIV A	167.1125	162.2	167.1125	162.2	A	
	14	TACTICAL	R5 TAC 6	DIV D	168.2375	162.2	168.2375	162.2	A	
	15	EMS TAC	CALCORD	ALL DIVISIONS	156.0750		156.0750	156.7	A	MEDICAL A/G
	16	AIR GUARD	GUARD	ALL DIVISIONS	168.6250		168.6250	110.9	A	EMERGENCY ONLY
	20	AIR GUARD	GUARD	ALL DIVISIONS	168.6250		168.6250	110.9	A	EMERGENCY ONLY
6. Prepared By:				Name: CHRIS PERRY (T)				Signature: 		
(Communications Unit Leader)				IAP Page				Date/Time: 08/11/2015 2100		

AIR OPERATIONS SUMMARY

PREPARED BY: Ted Visser



PREPARED DATE/TIME: 08/11/15 1900

1. INCIDENT NAME: Gasquet Complex	2. OPERATIONAL PERIOD DATE: 08/12/15 START TIME: 0700 END TIME: 2000 SUNRISE: 0621 SUNSET: 2022		
3. REMARKS (Safety Notes, Hazards, Air Operations Special Equipment, etc.) Thunderstorms, erratic winds. Low wires, cables, power lines. Divisions, contact Helibase for all aviation needs, include coordinates of possible helispot/unimproved landing locations. Possible smoke concerns. Bear Fire Div E, 41 48.928 123 44.678 Track all retardant usage and location if used. Coon Fire Div C, 41 45.786 123 57.709 Do not dip from lakes near 41 35.000 x 123 43.00 Feeder Fire Div W, 41 35.065 123 50.726 IP for Air Tankers 41 47.21 X 123 04.40 5000' Peak Fire Div L, 41 33.065 123 46.134 Cave HB Gate 10155# Summit Fire Div V, 41 35.000 123 47.800 Six Rivers Disp. Air Desk 707-726-1266 Williams Fire Div H, 41 35.290 123 45.621			
4. MEDEVAC A/C: 512 5. TFR: 5/0539 Radius: 10 NM Altitude: 9000 MSL Centerpoint: N 41 40.00 W 123 50.00 Freq: 128.0750 Illinois Valley Tower Freq: 133.275			
8. FIXED-WING # Avail / Type/ Make-Model / FAA N# / Base(s) Available through Dispatch SEAT 818, SEAT 886, SEAT 898 Available through Dispatch Available through Dispatch ATGs Aircraft: N 4579N, A-6 Claridge N 285 , A-65 McLaughlin AAB: MRB: ICL, Joe Hart, 208-699-1166 Gary Smith S-31,32,33 Uni Engine 530-598-1434			

9. HELICOPTERS (Use Additional Sheets As Necessary)													
FAA N#	TY	MAKE/MODEL	BASE	AVAILABLE	START	REMARKS	FAA N#	TY	MAKE/MODEL	BASE	AVAILABLE	START	REMARKS
HT-702	1	S-61	Cave	0730	0830	A-20							
HT-782	1	S-64	Cave	0730	0830	A-62							
512	2	Bell 212	Cave	0730	0830	A-42							
517	2	Bell 205	Cave	0730	0830	A-57 Restricted							
988B	3	Bell I4	Cave	0730	0830	A-28							

10. TASK/MISSION/ASSIGNMENT (Type/Function Includes: Air Tactical, Retardant, Recon, Personnel Transport, Water Dropping, S&R, etc.)

TYPE/FUNCTION	NAME OF PERSONNEL OR CARGO (if applic) OR INSTRUCTIONS FOR TACTICAL AIRCRAFT	MISSION START	FLY FROM	FLY TO
Bucket drops per request	Division Sup. To request and coordinate with Air Attack or helibase.			
Recon Flights	To be approved by OPS or AOB			
Cargo / Sling	Per Request from Div Sups, all sling loads / crew shuttles			
Ops Recon				
Div Sup Recon				
DIPSITES	River Dip 41 44.15 X 123 59.02			
Nickowitz Fire Freq's	Air to Air FW 165.7500 Air to Air RW 118.950			
	Air to Ground 167.600 Command 2 170.4125 Rx 165.9625Tx Tone 127.3			

MEDICAL PLAN	1. INCIDENT NAME Gasquet Complex	2. DATE PREPARED 8/11/15	3. TIME PREPARED 1730	4 OPERATIONAL PERIOD 8/12-13/2015 0600-0600				
5. INCIDENT MEDICAL AID STATIONS								
MEDICAL AID STATIONS		LOCATION		PARAMEDIC				
Medical Supply		Base Camp		YES NO X				
TRANSPORTATION								
A. Air Ambulances								
NAME	ADDRESS	PHONE	PARAMEDIC					
National Guard H-825 (Day/Night, Hoist)	Redding Airport, CA	Communications	YES	NO				
CHP H-14 (Day/Night, Hoist)	Redding Airport, CA	(530) 842-3515	X					
Coast Guard (Day/Night, Hoist)	Air Station Humboldt Bay, CA	(707) 839-6100		X				
CalFire Kneeland Helitack H-102 (Hoist capable)	Kneeland Station, CA	(707) 441-2863		X				
Reach 5 Air Medical	Redding, CA	1-800-338-4045	X					
Mercy Air Ambulance 105	Medford, Oregon	1-800-903-9000	X					
PHI Air Medical	Redding, CA	1-800-597-9571	X					
B. Ground Ambulances								
Del Norte Ambulance, Station 2	2600 Morehead Rd Crescent City CA	Communications	X					
C. Rapid Extraction Modules								
R.E.M. – South	Gasquet South Operations	Communications		X				
7. HOSPITALS								
NAME	ADDRESS	TRAVEL TIME		HELIPAD		BURN CENTER		
		AIR	GRND	PHONE	YES	NO	YES	NO
Sutter Coast Hospital	800 E Washington Crescent City CA.		25min	ER: 707-464-8888 Gen: 707-464-8511		X		X
Mercy Med. Center Level 3 Trauma	914 Pine St. Mt. Shasta, CA. N. 40 34.14 x W. 122 23.97	45m	4.5hr	(530)926-9360	X			X
Rogue Valley Med Center Level 2 Trauma	2825 Barnett Rd. Medford, OR. N. 42 19.092 W. 122 49.833	30m	2 hr	(541)789-7100	X			X
UC Davis Med Center Level 1 Trauma Burn Center	2315 Stockton Blvd. Sacramento, CA N. 38 33.3 x W. 121 27.3	2hr	7.0hr	(916) 734-3636 Burn Center (916) 734-3790 ER	X		X	
8. MEDICAL EMERGENCY PROCEDURES								
<p>In the event of a medical emergency provide the following information to your Divs or Gasquet Communications on Command.</p> <ol style="list-style-type: none"> 1. Declare the nature of the emergency. <ol style="list-style-type: none"> a. Medical injury/illness? b. Is injury/illness life threatening? 2. If life threatening, then request that the designated frequency be cleared for emergency traffic. 3. Identify the on-scene Point of Contact (POC) by resource and last name (i.e POC is TFLD Smith). 4. Identify nature of incident, number injured, patient assessment(s) and location (geographic and GPS coordinates). 5. Identify on-scene medical personnel by position and name (i.e EMT Jones). 6. Identify preferred method of patient transport. 7. Request any additional resources and/or equipment needed 8. Document all information received and transmitted on the radio or phone. 9. Identify any changes in the on-scene Point of Contact or medical personnel as they occur. 				<p><u>INJURY REPORTING PROCEDURES</u></p> <p>NATURE OF INJURY _____ # of Patients _____</p> <p>TRANSPORTION NEEDED Air _____ Ground _____</p> <p>REM Needed Y ___ N ___ Estimated Air Temp _____</p> <p>LAT _____ LONG _____ Elevation _____</p> <p>Specific Hazards In Area _____</p> <p>PATIENT UNIT ID _____</p> <p>REMINDER: DO NOT GIVE PT NAME OVER RADIO</p> <p>IS MEDICAL PERSONNEL WITH PATIENT: YES ___ NO ___</p> <p>AGE _____ SEX: MALE _____ FEMALE _____</p> <p>ALL EMERGENCIES--Secure the area and identify witnesses for later investigation. Keep an accurate log of events.</p>				
<p>ICS 206 8-78</p>		<p>9. PREPARED BY (MEDICAL UNIT LEADER) Gena Fowlkes MEDL (909) 762-9032</p>			<p>10. REVIEWED BY (SAFETY OFFICER) James Aragon SOF2</p>			



Human Resource Message

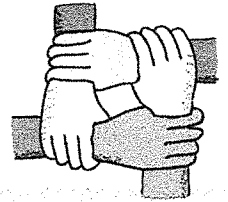

- Human Resource Specialist Trainee has arrived to the Gasquet Complex –

Please welcome HRSP(t) Andrea Cabida. Andrea is an HR Specialist for USFS Fire and Aviation Management in the Pacific Southwest Regional Office in Vallejo, CA.

**There have been no Civil Rights issues on the Incident.
Thx for your mutual respect.**



Time's flying by!! Be sure the Training Specialist, Ann Hutchinson has your information. She's near the Check in/Demob or call 623-293-8628.

WHY?

- ⇒ To be sure you get credit for your training experience.
- ⇒ To be sure the incident has an accurate training report.

What to bring to Training Specialist (TNSP):

1. Taskbook with information recorded for incident.
2. Trainee's Personnel Performance Rating form ICS 225 completed
3. Incident Trainee Interview (provided by TNSP)

Have a safe.....and learning assignment!!!



Health & Safety Message

Incident: Gasquet Complex CA-SRF-001488	Date/Op Period: 8/12-13/15 0600-0600
---	---

Hazards & Risks

Weather/Visibility: Restricted visibility due to haze and smoke limits the ability of FOBS, Lookouts & Aircraft to see you or fire activity on the ground. Monitor weather trends and post lookouts with these limitations in mind. Adjust tactics accordingly with the expectation that aviation support may be severely limited.

Emergency Medical: Review and brief the medical treatment and evacuation plan on the ICS 206 Medical Plan. The Gasquet area has extended response and transport times for EMS so get medical responders going early in your incident.

REALIZE THAT AIRCRAFT EVACUATIONS MAY BE SEVERELY LIMITED
DUE TO RESTRICTED VISIBILITY. HAVE A GROUND TRANSPORT
CONTINGENCY PLAN FOR YOUR DIVISIONS

Steep Terrain and Rolling Stuff! : With very steep terrain in all Divisions comes rolling rocks, logs, and humans. Watch your footing and avoid working below other personnel and equipment working above you. Stagger yourselves as you hike up and down the fireline and watch your spacing.

Vehicle Operation: Respect the local traffic laws and use extra caution when driving along forest roads in your areas of operation. Establish a traffic flow plan in areas that require it. Use emergency lighting as needed, especially when working along public roadways. Drive carefully through downtown Gasquet.

Prepared By: Paul Tompkins SOFR2	Approved: Dave Kelly, Deputy IC
---	--

L. Lookouts **C.** Communications **E.** Escape Routes **S.** Safety Zones

BE MINDFUL

INCIDENT SAFETY ANALYSIS 215a

Gasquet Complex - Wednesday, August 12, 2015

8. Location	9. Hazard	6. Control or Abatement Action (Engineering, Administrative, PPE, Avoidance, Education, etc)
All	Hazard Trees	<ul style="list-style-type: none"> ~ Follow "Hazard Tree Safety" guidelines, IRPG pages 22 & 23 ~ Post lookouts, or use a spotter in mop-up areas with personnel ~ Don't park vehicles or take breaks in high concentrations of hazard trees ~ Establish trigger points for disengagement during high wind events
All	Air Operations	<ul style="list-style-type: none"> ~ Follow "Aviation Watch-Out Situations" on page 44, IRPG ~ Don't plan on air resources for medical transport or resupply. ~ Refer to page 57, IRPG for directing bucket drops. ~ Ensure positive communication with all air resources.
All	Chain Saw Operations	<ul style="list-style-type: none"> ~ Follow "Hazard Tree Safety" guidelines, IRPG pages 22 & 23 ~ Look up, down around for hazard tree indicators ~ Only fell and buck trees within your expertise, and training ~ Follow "Procedural Felling Operations" on page 79 in IRPG ~ Do not fall trees during high wind events
All	Steep Terrain & Rolling Debris	<ul style="list-style-type: none"> ~ Maintain 8'-10' spacing when working & walking ~ Don't work above any personnel ~ Evaluate necessity to send personnel in areas with limited access
All	Driving & Traffic	<ul style="list-style-type: none"> ~ Practice "Defensive Driving" techniques traveling on all roads and city streets, mitigation strategy includes: <ul style="list-style-type: none"> ~ Use spotters when backing ~ Honk horn to alert personnel when backing ~ Always use headlights ~ Yield to pedestrians and bicycles ~ Observe posted speed limits ~ Follow 3 second rule of following distance when driving ~ Use chock blocks, turn wheels into hill
All	Firing Operations & Devices	<ul style="list-style-type: none"> ~ Only personnel trained in the use of each device will be authorized to use firing equipment. ~ Ensure all personnel are aware of firing operation that may affect them. ~ Wear appropriate PPE. ~ Ensure aerial/ground ignition plans have been adequately developed and personnel are briefed.
All	Injury & Medical Emergency	<ul style="list-style-type: none"> ~ Assist injured employee appropriate medical care ~ Use EMT's on Division for initial care ~ Follow medical protocol as outlined in ICS-206
All	Bees, Ticks, Mosquitoes	<ul style="list-style-type: none"> ~ Be aware of crew members with sting allergies. ~ Ensure crew members have medication pens if needed. ~ Perform daily self inspection ~ Use repellent as necessary
All	Poisonous Plants	<ul style="list-style-type: none"> ~ Identify and Avoid hazard areas ~ Launder clothing ~ Shower frequently



Incident within an Incident Action Plan

Position Assignment Supportive Actions

Division Supervisor

- See items 1-6 on page one
- If unable to access accident/incident location, delegate command to a closer qualified resource

Medical Unit Leader

- Respond to Comm Unit as soon as possible
- Coordinate with Division Supervisor to ensure proper resources are rapidly ordered
- Assign a MEDL to the scene and other positions to support the response as needed
- Monitor condition updates of patient(s) and coordinate response with Operations

Communications Unit Leader

- Maintain clear radio traffic and monitor communications to support response
- Recommend appropriate security and investigative process
- Assess the need for critical Incident Stress Response

Safety Officer

- Provide for Safety personnel on scene as needed
- Recommend appropriate security and investigative process
- Assess the need for critical Incident Stress Response

Air Attack Supervisor

- Obtain coordinates of the emergency location
- Coordinate air-medical response
- Assist and support the designated Point of Contact with communications and coordination of the emergency response as necessary

IC, Command & General Staff

- Manage the emergency and direct specific responsibilities to individual positions to provide an appropriate response
- Notify the host unit and host dispatch center of the size-up information
- Constantly monitor and assess the appropriate response and adapt direction as needed
- Submit all documentation pertaining to the emergency to the Plans Chief

Reference the full Incident Medical Emergency Plan for additional



Incident within an Incident Action Plan

When the scope or complexity of the emergency exceeds division resource needs

This plan is designed to identify the initial actions that should be taken by the first arriving personnel on a serious accident. This person may be a single resource, engine boss, or a crew boss. Accidents or incidents within an incident happen rapidly and require sound, calm initial decisions to handle the problem, while still focusing on the main incident. The following checklist provides some key thoughts and actions.

The first arriving person to any accident should notify their Division Supervisor, or the Div Sup assigned to that location.

Advise of the critical information needed:

- Accident scene safety assessment and advise incoming personnel
- Number of injuries and their severity
- Special equipment needs (extrication, low/high angle rescue, fire protection or suppression)
- Assist the injured as necessary without endangering yourself or other personnel
- Do not move trauma victims unless their safety is in jeopardy
- Utilize PINK pages of the Incident Response Pocket Guide (IRPG) for patient assessment/medical procedures

Remain aware of surroundings and delegate personnel to monitor the main fire

The Division Supervisor will assume command of the accident/incident scene upon arrival. The following list outlines the general duties and tasks that should be completed on most accidents/incidents.

1. Delegate division oversight to another Division Supervisor or other qualified person.
2. Request a clear frequency from Comm and consider switching to designated Emergency Tactical (Incident Comm will notify the MEDL who will initiate the medical plan for injuries)
3. Order/delegate resources appropriate for the accident/incident (crew EMT's, Line EMT's or Line Medics, rescue equipment, patient transport needs, manpower)
4. Notify Operations Section Chief and Safety Officer on all accidents/incidents.
5. Begin to document the event accurately and completely. Use ICS form 201 if the event is large or complex.
6. Protect the scene for Investigators

Reference the full Incident Medical Emergency Plan for additional

ICP

Mountain School
55 Azalea Lane
Gasket, CA 95543
(707) 457-3211

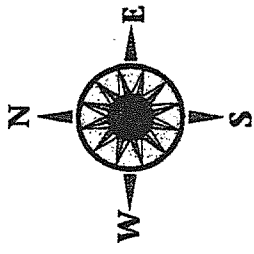

- P Portable
- C Classroom
- Exit/Door
- Fire Extinguisher
- Fire Alarm Panel
- Water Shut Off
- Electrical Shut Off

071410/Site Maps/Del Norte

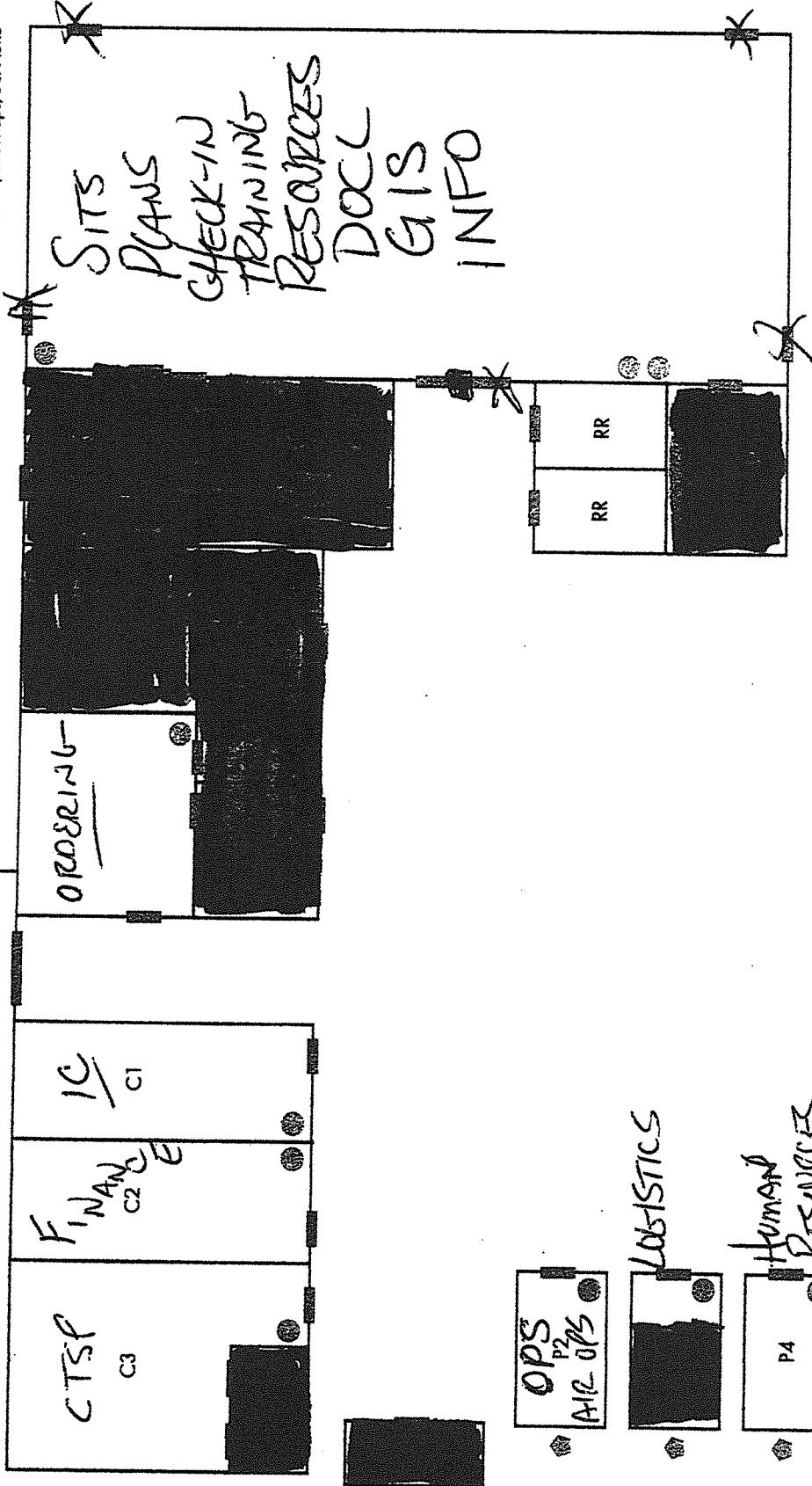

OPS
P2 OPS
A/R OPS

LOGISTICS

HUMAN RESOURCES
P4

[Redacted]

As of 8/7/2015

GASQUET COMPLEX BASE CAMP

Updated 08/10/2015

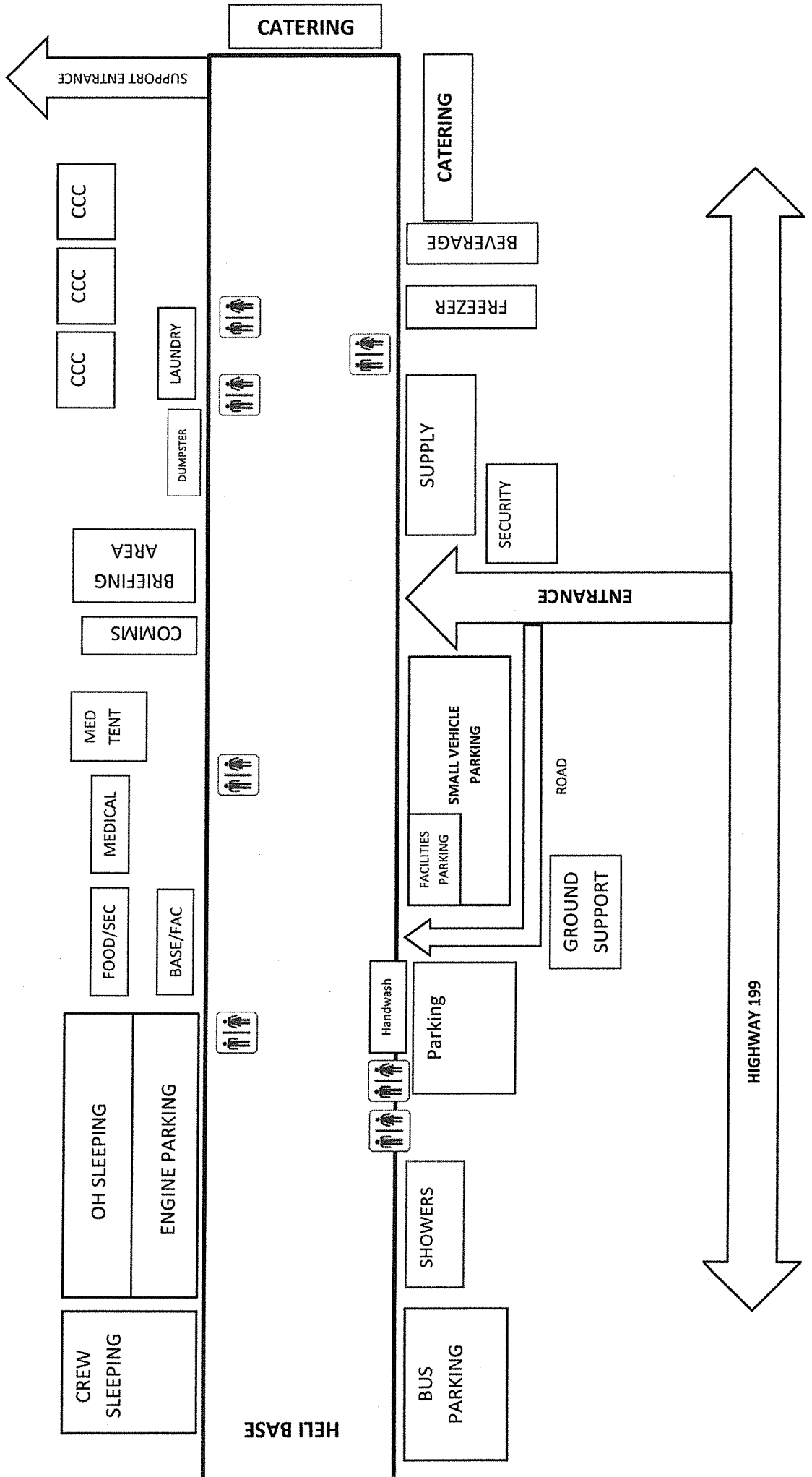
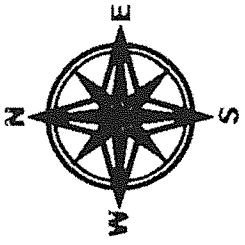

CATERING

SUPPORT ENTRANCE

CCC

CCC

CCC

LAUNDRY

DUMPSTER

BRIEFING AREA

COMMS

MED TENT

MEDICAL

FOOD/SEC

BASE/FAC

OH SLEEPING
ENGINE PARKING

CREW SLEEPING



Handwash



SHOWERS

BUS PARKING

Parking

FACILITIES PARKING

SMALL VEHICLE PARKING

ROAD

GROUND SUPPORT

SECURITY

SUPPLY

FREEZER

BEVERAGE

CATERING

ENTRANCE

HIGHWAY 199

HELLI BASE

