

GASQUET COMPLEX

INCIDENT ACTION PLAN

OPERATIONAL PERIOD

AUG 13 - AUG 14, 2015

0600-0600



"Adapt...Improvise...and Overcome"



**CA-SRF-001488
P5JOPQ (0510)**

**NAD 83
dd^o m.mm'**

INCIDENT OBJECTIVES (ICS 202)

| | | | | | | |
|---|---|---|---|--|---|---|
| 1. Incident Name: | | 2. Operational Period: 0600 - 0600 | | | | |
| GASQUET COMPLEX | | Date/Time From: 08/13/2015 0600 THU | Date/Time To: 08/14/2015 0600 FRI | | | |
| 3. Objective(s): STRATEGIC FRAMEWORK: THE FRAMEWORK FOR THE GASQUET COMPLEX STRATEGIC PLAN CONSISTS OF USING A COMBINATION OF DIRECT ATTACK WHERE FEASIBLE, OTHERWISE INDIRECT USING NATURAL BARRIERS. A KEY ELEMENT IS FLEXIBILITY AND THE ABILITY TO APPLY THE RIGHT RESOURCE TO THE RIGHT TASK AT THE RIGHT TIME. FIRELINE WILL BE CONSTRUCTED ONLY WHERE FEASIBLE AND SAFE TO DO SO. LEADERS INTENT: PROVIDE THE HIGHEST LEVEL OF CUSTOMER SERVICES TO ALL INVOLVED WITH OR IMPACTED BY THE GASQUET COMPLEX. ALL INCIDENT PERSONNEL SHOULD BE PREPARED TO TAKE THE APPROPRIATE ACTIONS REGARDING: <ul style="list-style-type: none"> • PERSONAL INTERACTIONS BOTH INSIDE AND OUTSIDE THE INCIDENT MANAGEMENT ORGANIZATION. • PERSONAL SAFETY AND THE SAFETY OF OTHERS. • AN INCIDENT-WITHIN-AN-INCIDENT. OBJECTIVES: <ul style="list-style-type: none"> • PROVIDE FOR FIREFIGHTER AND PUBLIC SAFETY BY ENSURING L C E S IS EVALUATED USING SOUND RISK MANAGEMENT PRINCIPLES. • MAINTAIN AND BUILD COOPERATOR AND STAKEHOLDER RELATIONSHIPS. • SUPPRESS FIRES WHILE NOT EXPOSING FIREFIGHTERS OR AIRCRAFT TO UNNECESSARY RISKS. • IDENTIFY AND PROTECT NATIVE AMERICAN TRADITIONAL AREAS AND OTHER SENSITIVE CULTURAL AND HISTORIC SITES. | | | | | | |
| 4. Operational Period Command Emphasis: UTILIZE SUPPRESSION STRATEGIES COMMENSURATE WITH VALUES AT RISK. IMPLEMENT TACTICS WHICH INCREASE THE PROBABILITIES OF SUCCESS WHILE HOLDING EXISTING CONTAINMENT. | | | | | | |
| General Situational Awareness: ROOT SYSTEMS OF GREEN TREES HAVE BEEN WEAKENED BY DROUGHT. THIS CAN RESULT IN TREES COMING DOWN WITH LITTLE EFFORT FROM HEAVY EQUIPMENT. | | | | | | |
| 5. Site Safety Plan Required? Yes <input type="checkbox"/> No <input checked="" type="checkbox"/> | | | | | | |
| Approved Site Safety Plan(s) Located at: | | | | | | |
| 6. Incident Action Plan (the items checked below are included in this Incident Action Plan): <table style="width: 100%; border: none;"> <tr> <td style="width: 33%; vertical-align: top;"> <input checked="" type="checkbox"/> ICS 202 <input checked="" type="checkbox"/> ICS 203 <input checked="" type="checkbox"/> ICS 204 <input checked="" type="checkbox"/> ICS 205 <input type="checkbox"/> ICS 205A <input checked="" type="checkbox"/> ICS 206 </td> <td style="width: 33%; vertical-align: top;"> <input type="checkbox"/> ICS 207 <input type="checkbox"/> ICS 208 <input checked="" type="checkbox"/> ICS 220 <input checked="" type="checkbox"/> Map/Chart <input checked="" type="checkbox"/> Weather Forecast/Tides/Currents </td> <td style="width: 33%; vertical-align: top;"> Other Attachments: <input checked="" type="checkbox"/> SAFETY / 215A <input checked="" type="checkbox"/> INCIDENT WITHIN AN INCIDENT <input checked="" type="checkbox"/> HR / TRAINING MESSAGE <input checked="" type="checkbox"/> DEMOB LIST </td> </tr> </table> | | | | <input checked="" type="checkbox"/> ICS 202 <input checked="" type="checkbox"/> ICS 203 <input checked="" type="checkbox"/> ICS 204 <input checked="" type="checkbox"/> ICS 205 <input type="checkbox"/> ICS 205A <input checked="" type="checkbox"/> ICS 206 | <input type="checkbox"/> ICS 207 <input type="checkbox"/> ICS 208 <input checked="" type="checkbox"/> ICS 220 <input checked="" type="checkbox"/> Map/Chart <input checked="" type="checkbox"/> Weather Forecast/Tides/Currents | Other Attachments: <input checked="" type="checkbox"/> SAFETY / 215A <input checked="" type="checkbox"/> INCIDENT WITHIN AN INCIDENT <input checked="" type="checkbox"/> HR / TRAINING MESSAGE <input checked="" type="checkbox"/> DEMOB LIST |
| <input checked="" type="checkbox"/> ICS 202 <input checked="" type="checkbox"/> ICS 203 <input checked="" type="checkbox"/> ICS 204 <input checked="" type="checkbox"/> ICS 205 <input type="checkbox"/> ICS 205A <input checked="" type="checkbox"/> ICS 206 | <input type="checkbox"/> ICS 207 <input type="checkbox"/> ICS 208 <input checked="" type="checkbox"/> ICS 220 <input checked="" type="checkbox"/> Map/Chart <input checked="" type="checkbox"/> Weather Forecast/Tides/Currents | Other Attachments: <input checked="" type="checkbox"/> SAFETY / 215A <input checked="" type="checkbox"/> INCIDENT WITHIN AN INCIDENT <input checked="" type="checkbox"/> HR / TRAINING MESSAGE <input checked="" type="checkbox"/> DEMOB LIST | | | | |
| 7. Prepared by: DAVE LATTIMORE Position/Title: PSC2 | | Signature: | | | | |
| 8. Approved by Incident Commander: | | Name: DON GARWOOD Signature: | | | | |
| ICS 202 | | IAP Page | | | | |
| | | Date/Time: 08/12/2015 2100 | | | | |

ORGANIZATION ASSIGNMENT LIST (ICS 203)

| | | | |
|--|--|---|--|
| 1. Incident Name: | | 2. Operational Period: 0600 - 0600 | |
| GASQUET COMPLEX | | Date/Time From: 08/13/2015 0600 THU | Date/Time To: 08/14/2015 0600 FRI |
| 3. Incident Commander(s) and Command Staff: | | 7. Operations Section: | |
| IC/UC | DON GARWOOD | OPS SECTION CHIEF | DERRICK DAVIS DARRELL MILLER |
| DEPUTY | DAVE KELLY | | |
| SAFETY OFFICER | JAMES ARAGON; P TOMPKINS; J BATES; F HERNANDEZ (T) | PLANNING OPS | MATTHEW CONKLIN AARON THOMPSON (T) |
| INFORMATION OFFICER | JIM WILKINS; ROBERT POOLE ASCENSION BRIBIESCAS | | |
| LIAISON OFFICER | LARRY LA VOGUE 909-855-5756 | DIVISION/GROUP | A - COON FIRE MITCH FOWLKES DAN O'CONNOR (T) |
| HUMAN RESOURCES | KATHY KREYNS 909-731-1771 ANDREA CABIDA (T) | DIVISION/GROUP | C - COON FIRE TODD MCDIVITT BRIAN BERRY (T) |
| 4. Agency/Organization Representative(s): | | DIVISION/GROUP | D - COON FIRE TRENT INGRAM KEN VAN WIG (T) |
| Agency/Organization | Name | DIVISION/GROUP | E - BEAR FIRE DAVID MARTINEZ JOHN OWINGS (T) |
| USFS | DAVE PALMER | DIVISION/GROUP | G - BEAR FIRE ERIC PLATZ CHRIS ST. PIERRE (T) |
| GASQUET VFD | NICK KARANPOULOS | DIVISION/GROUP | H/L/N/V WILLIAMS / PEAK / SUMMIT CANDICE KUTROSKY PAUL MANDOLINI (T) |
| CAL EMA | JOHN SALVATE | DIVISION/GROUP | W - FEEDER FIRE GLENN WEBB AL WARD (T) |
| CAL TRANS | | DIVISION/GROUP | Z - FEEDER FIRE ADAM KOHLEY ROBERT ALLAN (T) |
| SRF-NFFE | ROBERTA CORAGLIOTTI 530-784-7542 JOHN MC RAE 707-845-8017 | DIVISION/GROUP | CONTINGENCY JEREMY COWIE BRIAN FABBRI (T) |
| 5. Planning Section: | | 7b. Air Operations Branch: | |
| CHIEF | DAVE LATTIMORE | AIR OPS BRANCH DIRECTOR | TED VISSER |
| DEPUTY | RICH STERRY (T) | AIR SUPPORT SUPERVISOR | GALEN YOUNG |
| RESOURCES UNIT | K HAUDUCOEUR, N MASTERS B KERSHAW, J SCURI (T) | AIR ATTACK SUPERVISOR | CLIFF CLARIDGE KEN MCLAUGHLIN |
| SITUATION UNIT | GORDON TAMPLIN(T), TIM KNORR(T) | AIR TANKER COORDINATOR | |
| DOCUMENTATION | VANESSA HANSON | HELICOPTER COORDINATOR | |
| DEMOB UNIT | JIM STITELER (T) | | |
| IMET | RACHEL COBB | | |
| FIRE BEHAVIOR | BYRON KIMBALL | | |
| SOPL | BOB LINEBACK | | |
| TRAINING SPECIALIST | ANN HUTCHINSON | | |
| GISS | R MURILLO; A. KIRSCH; A SALDIVAR(T) | | |
| CTSP | CHARLES VERTREES | | |
| 6. Logistics Section: | | 8. Finance/Administration Section: | |
| CHIEF | ERIC SWEETMAN | CHIEF | DEBBIE YORK |
| DEPUTY | STEVE KING (T) | TIME UNIT | SHARON R MAKOSKY DEANNA THOMPSON (T) |
| SUPPLY UNIT | EVAN TISS; DAVID WHITNEY | COMPENSATION UNIT | BETH SJOBLUM |
| FACILITIES UNIT | ART CURLEY; DOUG WINN(T) | COST UNIT | THOMAS STEELE KRIS STERBENS (T) |
| GROUND SUPT UNIT | CHRIS HALEY; RON NOORDMAN | | |
| COMM UNIT | DAVE LARKIN; CHRIS PERRY(T) | | |
| MEDICAL UNIT | GENA FOWLKES MATTHEW MENARD (T) | | |
| SECURITY UNIT | HEATHER NAIGUS | | |
| FOOD UNIT | RICHARD WAITE | | |
| 9. Prepared By: | Name: KYLE HAUDUCOEUR | Position/Title: RESL | Signature: |
| ICS 203 | IAP Page | Date/Time: 08/12/2015 2100 | |

FIRE BEHAVIOR FORECAST

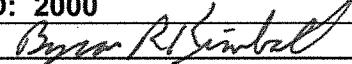
| | |
|--------------------------------------|--|
| FORECAST NUMBER: #10 | TYPE OF FIRE: Wildland Fire |
| FIRE NAME: Gasquet Complex | OPERATIONAL PERIOD: August 13, 2015 |
| DATE ISSUED: August 12, 2015 | TIME ISSUED: 2000 |
| UNIT: Smith River NRA, Six Rivers NF | SIGNED:  |
| | Typed/printed:/s/ Byron R. Kimball FBAN |

INPUTS

WEATHER SUMMARY: Off shore low pressure will move northeast, bringing cloudy skies and a chance of evening showers. Temperature cooler and Relative Humidity higher, with more marine air present.

MAX TEMPERATURE.....60's to 70.

MIN HUMIDITY.....40 – 50%

EYE LEVEL WINDS.....Upslope/upvalley light, Ridges NE 3 to 6 becoming SW 6-12, G 20 late morning into afternoon

For more specific information, please see the Spot Weather forecast

OUTPUTS

FIRE BEHAVIOR

GENERAL:

A return to cloudy skies, more marine air, and higher RH should lead to less activity. RH above 40% should slow down spread and lower intensity. Gusty winds along the ridges could push the fire, but without significantly increasing the intensity. Winds increase and change direction in the afternoon, be aware of the shift.

With line construction in incomplete burns, be positive that you are exposing the black edge and getting all the hot ash and embers inside your line.

SPECIFIC:

Timber Understory: Fire behavior in the Understory models should decrease. Increased RH and some cloud cover will reduce the burn window.

ROS: 5 to 10 ch/hr.

FL: 6 to 8 ft.

Timber Litter: Timber Litter fire behavior should be less active. RH above 40% should calm the fire activity. Stay aware of rollout and upslope runs through incomplete burns.

ROS: 3 to 6 ch/hr.

FL: 2 to 3 ft.

Rollout of heavier fuels continues to present a concern as the fires work into the drainages. Be prepared for a slope reversal run if fire establishes with sufficient heat.

AIR OPERATIONS:

Return to cloudy skies and marine layer may limit air craft in the morning. May improve in the afternoon when whatever solar heating that the fire gets sets in fully.

SAFETY

Be aware of fire in the standing timber and instability of trees and snags. Ash pits and stump holes become more of an issue the longer the fire burns in the fuel bed.



INCIDENT Weather Forecast



FORECAST NO: 2

NAME OF FIRE: Gasquet Complex

PREDICTION FOR: Day Shift

SHIFT DATE: 8/13/2015

SIGNED: *Rachel Cobb*

TIME AND DATE

FORECAST ISSUED: 1900 8/12/2015

Rachel Cobb

Incident Meteorologist

WEATHER DISCUSSION: An offshore area of low pressure will move northeast on Thursday, bringing mostly cloudy skies, and a chance of showers during the evening. Temperatures will cooler and relative humidity higher, with onshore flow pushing marine air inland. Gusty southwest winds will also be possible. The low will then move away from the area on Friday, and warmer and drier conditions can be expected. Winds will become lighter and be more northerly on Friday.

WEATHER FORECAST for Thursday:

WEATHER: Mostly cloudy and smoky. A chance of showers in the afternoon and evening, with less than a tenth of an inch of rain.

MAXIMUM TEMPERATURES: 65 – 70 degrees valleys...60 – 65 degrees ridges.

MINIMUM HUMIDITY: 40 – 50 percent.

20 FT WINDS:

RIDGETOP – Northeast 3 to 6 mph becoming southwest 6 to 12 mph with gusts around 20 mph in the late morning and afternoon.

SLOPE/VALLEY – Upslope/upvalley 3 to 8 mph.

HAINES INDEX: 2 (low).

STABILITY/INVERSION: Inversion between 5000 and 6000 feet msl.

OUTLOOK for Thursday Night: Mostly cloudy and smoky. A slight chance of showers before midnight. Low temperatures 45 – 55 degrees and maximum relative humidity 80 – 95%. Ridgetop winds variable 3 to 6 mph. Haines Index: 2.

OUTLOOK for Friday: Partly cloudy and smoky. Highs 66 – 77 degrees and relative humidity 30 – 40%. Ridgetop winds north-northwest 6 to 11 mph. Mixing height: 7500 feet msl. Haines Index: 4.

EXTENDED FORECAST: High pressure will be influencing the area Saturday and Sunday with warmer and drier conditions and light northerly winds. It may be slightly cooler with higher humidity Monday and Tuesday, but a weather system to the north could bring gusty winds.

Division/Group Assignment List (ICS 204 WF)

| | | | | | | |
|--|--------------------------------------|------------------------------------|---|----------------------------------|------------------------|-----------------------------------|
| 1. Incident Name: | | | 3. | | | |
| GASQUET COMPLEX | | | Branch: | | Division/Group: | |
| 2. Operational Period: 0600 - 0600 | | | | | A - COON FIRE | |
| Date/Time From: 08/13/2015 0600 THU | Date/Time To: 08/14/2015 0600 FRI | | | | | |
| 4. Operations Personnel | | | | | | |
| OPERATIONS CHIEF | | DERRICK DAVIS DARRELL MILLER | | DIVISION/GROUP SUPERVISOR | | MITCH FOWLKES DAN O'CONNOR (T) |
| PLANNING OPS | | MATT CONKLIN AARON THOMPSON (T) | | AIR ATTACK SUPERVISOR | | CLIFF CLARIDGE KEN MCLAUGHLIN |
| 5. Resources Assigned this Period | | | | | | |
| Strike Team / Task Force / Resource Designator | | LWD | Leader | Number Persons | Drop Off PT./Time | Pick Up PT./Time |
| HC2 STEELHEAD C-30 | | 08/15 | ALEJANDRO RODRIGUEZ | 20 | ICP/0630 | ICP/1900 |
| HCM HOOPA O-275 | | 08/24 | ROCKY COLEGROVE | 12 | ICP/0630 | ICP/1900 |
| TFLD VIKTORA / WHEELER (T) | | 08/18 | | 2 | ICP/0630 | ICP/1900 |
| TFLD PHILLIPS O-75 / KEYSE (T) O-78 | | 08/18 | | 2 | ICP/0630 | ICP/1900 |
| ENG3 LKP 5031 E-75 | | 08/14 | RICK BERGEN | 3 | ICP/0630 | ICP/1900 |
| ENG6 ALBANY 2180 E-79 | | 08/21 | TIM SMYSER | 3 | ICP/0630 | ICP/1900 |
| HEQB HEISEY / ALLEN (T) / DOZ2 ROEN E-90 | | 08/20 | | 3 | ICP/0630 | ICP/1900 |
| HEQB LANTERMAN O-83 / DOZ2 FISK'S E-91 | | 08/21 | | 2 | ICP/0630 | ICP/1900 |
| HEQB TERRY CARRICO O-217 | | 08/24 | | 1 | ICP/0630 | ICP/1900 |
| SKG4 L & L EXCAVATING W/ TRSPT E-111 | | 08/23 | SHANE NODINE | 2 | ICP/0630 | ICP/1900 |
| SKG3 UNDERHILL 1 W/ TRSPT E-112 | | 08/22 | JOE BRADBURY | 2 | ICP/0630 | ICP/1900 |
| FAL1 NORTH ZONE FALLERS #1 O-94 | | 08/18 | ALAN STEWART | 2 | ICP/0630 | ICP/1900 |
| WTS2 DUDLEY'S E-136 | | 08/25 | DON GUICE | 1 | ICP/0630 | ICP/1900 |
| FEMT RANDOLPH O-133 / VANZINNI O-134 | | 08/21 | | 2 | ICP/0630 | ICP/1900 |
| 6. Control Operations/Work Assignments: | | | | | | |
| <ul style="list-style-type: none"> SCOUT FOR OPPORTUNITIES TO REACH CONTAINMENT OBJECTIVES. CONTINUE INDIRECT DOZER LINE FROM 17N07J ROAD WEST TO SOUTH FORK OF THE SMITH RIVER AND IDENTIFY SAFETY ZONES. | | | | | | |
| 7. Special Instructions: | | | | | | |
| <ul style="list-style-type: none"> COORDINATE AND ORDER AIRCRAFT FOR WATER AND RETARDANT NEEDS WITH AIR ATTACK. | | | | | | |
| 8. Division/Group Communication Summary | | | | | | |
| Function | Channel | RX Frequency N/W | RX Tone/NAC | TX Frequency N/W | TX Tone/NAC | Mode |
| COMMAND | 1 | 167.1000 | 162.2 | 169.7500 | 162.2 | A |
| TACTICAL | 13 | 167.1125 | 162.2 | 167.1125 | 162.2 | A |
| BACKUP NET | 4 | 168.1250 | | 170.4750 | 127.3 | A |
| AIR TO GROUND | 10 | 165.3875 | | 165.3875 | | A |
| 9. Prepared By (Resource Unit Leader) | | | Approved By (Planning Section Chief) | | Date | Time |
| JOE SCURI (T) | | | DAVE LATTIMORE | | 08/12/2015 | 2100 |

Division/Group Assignment List (ICS 204 WF)

| | | | | | | |
|--|--------------------------------------|------------------------------------|---|----------------------------------|------------------------|----------------------------------|
| 1. Incident Name: | | | 3. | | | |
| GASQUET COMPLEX | | | Branch: | | Division/Group: | |
| 2. Operational Period: 0600 - 0600 | | | | | C - COON FIRE | |
| Date/Time From: 08/13/2015 0600 THU | Date/Time To: 08/14/2015 0600 FRI | | | | | |
| 4. Operations Personnel | | | | | | |
| OPERATIONS CHIEF | | DERRICK DAVIS DARRELL MILLER | | DIVISION/GROUP SUPERVISOR | | TODD MCDIVITT BRIAN BERRY (T) |
| PLANNING OPS | | MATT CONKLIN AARON THOMPSON (T) | | AIR ATTACK SUPERVISOR | | CLIFF CLARIDGE KEN MCLAUGHLIN |
| 5. Resources Assigned this Period | | | | | | |
| Strike Team / Task Force / Resource Designator | | LWD | Leader | Number Persons | Drop Off PT./Time | Pick Up PT./Time |
| HCM BEAR PEAK O-59 | | 08/23 | FRED FLEISCHMAN | 9 | ICP/0630 | ICP/1900 |
| ES3 2141C E-122 | | 08/20 | PETE DAVIS | 21 | ICP/0630 | ICP/1900 |
| ENG3 SANTA CLARA VFD 33 E-29 | | 08/19 | TYREL HANSEN | 4 | ICP/0630 | ICP/1900 |
| ENG3 SRF 11 E-189 | | 08/24 | JOE ENIEM | 5 | ICP/0630 | ICP/1900 |
| HEQB RICH WATERS O-85 | | 08/18 | | 1 | ICP/0630 | ICP/1900 |
| DOZ2 BROWNING E-44 | | 08/20 | PAT BROWNING | 1 | ICP/0630 | ICP/1900 |
| DOZ2 WARNER E-43 | | 08/18 | DAN WARNER | 3 | ICP/0630 | ICP/1900 |
| WTT2 WOOD'S 99 E-87 | | 08/15 | STEVE WENDT | 2 | ICP/0630 | ICP/1900 |
| WTS2 ALL AGENCY E-38 | | 08/18 | JOHN HILL | 1 | ICP/0630 | ICP/1900 |
| WTS2 SIERRA TIMBER E-42 | | 08/19 | DOUG LINGEN | 1 | ICP/0630 | ICP/1900 |
| WTS2 WILLS E-138 | | 08/25 | PHIL WILLS | 1 | ICP/0630 | ICP/1900 |
| SOFR SCHNEIDER (T) O-90 / BERG (T) O-146 | | 08/20 | | 2 | ICP/0630 | ICP/1900 |
| FEMP CRADDOCK O-240 / FEMT PESHKIN O-241 | | 08/25 | | 2 | ICP/0630 | ICP/1900 |
| 6. Control Operations/Work Assignments: | | | | | | |
| <ul style="list-style-type: none"> SECURE ALL FIRE WEST OF THE 17N07G ROAD FROM DP 20 TO COON CREEK. IMPROVE HANDLINE FROM DOZER LINE TO COON CREEK. ● SCOUT FOR SECONDARY CONTINGENCY LINE. | | | | | | |
| 7. Special Instructions: | | | | | | |
| <ul style="list-style-type: none"> COORDINATE AND ORDER AIRCRAFT FOR RETARDANT NEEDS WITH AIR ATTACK. FOBS PIPPIN / HAMER (T) WORKING IN DIV A AND DIV C. | | | | | | |
| 8. Division/Group Communication Summary | | | | | | |
| Function | Channel | RX Frequency N/W | RX Tone/NAC | TX Frequency N/W | TX Tone/NAC | Mode |
| COMMAND | 1 | 167.1000 | 162.2 | 169.7500 | 162.2 | A |
| TACTICAL | 5 | 166.7250 | 162.2 | 166.7250 | 162.2 | A |
| BACKUP NET | 4 | 168.1250 | | 170.4750 | 127.3 | A |
| AIR TO GROUND | 10 | 165.3875 | | 165.3875 | | A |
| 9. Prepared By (Resource Unit Leader) | | | Approved By (Planning Section Chief) | | Date | Time |
| JOE SCURI (T) | | | DAVE LATTIMORE | | 08/12/2015 | 2100 |

Division/Group Assignment List (ICS 204 WF)

| | | | | | | |
|--|---------|--------------------------------------|------------------|---------------------------|----------------------|----------------------------------|
| 1. Incident Name: | | | 3. | | | |
| GASQUET COMPLEX | | | Branch: | | Division/Group: | |
| 2. Operational Period: 0600 - 0600 | | | | | D - COON FIRE | |
| Date/Time From: 08/13/2015 0600 THU | | Date/Time To: 08/14/2015 0600 FRI | | | | |
| 4. Operations Personnel | | | | | | |
| OPERATIONS CHIEF | | DERRICK DAVIS DARRELL MILLER | | DIVISION/GROUP SUPERVISOR | | TRENT INGRAM KEN VAN WIG (T) |
| PLANNING OPS | | MATT CONKLIN AARON THOMPSON (T) | | AIR ATTACK SUPERVISOR | | CLIFF CLARIDGE KEN MCLAUGHLIN |
| 5. Resources Assigned this Period | | | | | | |
| Strike Team / Task Force / Resource Designator | | LWD | Leader | Number Persons | Drop Off PT./Time | Pick Up PT./Time |
| ENG6 PATRICK 14 E-117 | | 08/14 | JOEL DICE | 3 | ICP /0630 | ICP/1900 |
| ENG6 DARE ENTERPRISES 32 E-118 | | 08/14 | RICO SCHRAFF | 3 | ICP /0630 | ICP/1900 |
| ENG6 ASI 3 E-115 | | 08/15 | MICHAEL HOLLOWAY | 3 | ICP /0630 | ICP/1900 |
| ENG6 BOHICA 61 E-168 | | 08/26 | DAVE CAMPBELL | 3 | ICP /0630 | ICP/1900 |
| | | | | | | |
| | | | | | | |
| | | | | | | |
| | | | | | | |
| | | | | | | |
| | | | | | | |
| | | | | | | |
| | | | | | | |
| | | | | | | |
| | | | | | | |
| 6. Control Operations/Work Assignments: | | | | | | |
| <ul style="list-style-type: none"> • COMPLETE STRUCTURE PREP OF TOLLEFSON PROPERTY. • SCOUT FOR OPPORTUNITIES TO DEVELOP CONTROL LINE FROM DIV A TO DIV C. | | | | | | |
| 7. Special Instructions: | | | | | | |
| <ul style="list-style-type: none"> • COORDINATE AND ORDER AIRCRAFT FOR RETARDANT NEEDS WITH AIR ATTACK. | | | | | | |
| 8. Division/Group Communication Summary | | | | | | |
| Function | Channel | RX Frequency N/W | RX Tone/NAC | TX Frequency N/W | TX Tone/NAC | Mode |
| COMMAND | 1 | 167.1000 | 162.2 | 169.7500 | 162.2 | A |
| TACTICAL | 14 | 168.2375 | 162.2 | 168.2375 | 162.2 | A |
| BACKUP NET | 4 | 168.1250 | | 170.4750 | 127.3 | A |
| AIR TO GROUND | 10 | 165.3875 | | 165.3875 | | A |
| 9. Prepared By (Resource Unit Leader) | | Approved By (Planning Section Chief) | | | Date | Time |
| JOE SCURI (T) | | DAVE LATTIMORE | | | 08/12/2015 | 2100 |

Division/Group Assignment List (ICS 204 WF)

| | | | | | | |
|---|--------------------------------------|------------------------------------|---|----------------------------------|------------------------|-----------------------------------|
| 1. Incident Name: | | | 3. | | | |
| GASQUET COMPLEX | | | Branch: | | Division/Group: | |
| 2. Operational Period: 0600 - 0600 | | | | | E - BEAR FIRE | |
| Date/Time From: 08/13/2015 0600 THU | Date/Time To: 08/14/2015 0600 FRI | | | | | |
| 4. Operations Personnel | | | | | | |
| OPERATIONS CHIEF | | DERRICK DAVIS DARRELL MILLER | | DIVISION/GROUP SUPERVISOR | | DAVID MARTINEZ JOHN OWINGS (T) |
| PLANNING OPS | | MATT CONKLIN AARON THOMPSON (T) | | AIR ATTACK SUPERVISOR | | CLIFF CLARIDGE KEN MCLAUGHLIN |
| 5. Resources Assigned this Period | | | | | | |
| Strike Team / Task Force / Resource Designator | | LWD | Leader | Number Persons | Drop Off PT./Time | Pick Up PT./Time |
| HC2I GRAYBACK 8B C-5 | | 08/13 | TIM NYGREN | 20 | ICP/0630 | ICP/1900 |
| HC2 FORT APACHE 3 C-10 | | 08/20 | BURNETTE BENNETT | 20 | ICP/0630 | ICP/1900 |
| TFLD TONY ERICKSON O-232 | | 08/23 | | 1 | ICP/0630 | ICP/1900 |
| ENG3 UTAH COUNTY 12 E-31 | | 08/19 | ANDREW WATSON | 4 | ICP/0630 | ICP/1900 |
| ENG6 NV-WID 2616 E-35 | | 08/19 | CHAD NIBLETT | 3 | ICP/0630 | ICP/1900 |
| ENG6 WEBER FIRE 661 E-33 | | 08/19 | SCOTT HANEY | 3 | ICP/0630 | ICP/1900 |
| ENG6 GREAT BASIN 311 E-34 | | 08/19 | TYLER ERSKINE | 3 | ICP/0630 | ICP/1900 |
| DO22 PLUMAS 1 E-126 | | 08/24 | JAMES SMITH | 4 | ICP/0630 | ICP/1900 |
| WTS2 YREKA OUTLANDS E-19 | | 08/18 | ALLEN WILLIAMS | 2 | ICP/0630 | ICP/1900 |
| WTS1 V&P E-139 | | 08/25 | | 1 | ICP/0630 | ICP/1900 |
| FAL1 BROWN O-201 / MILLER TIMBER O-204 | | 08/21 | D. BROWN / C. GOODSON | 4 | ICP/0630 | ICP/1900 |
| FEMP FELDMAN O-135 / FEMT WICKLAS O-132 | | 08/20 | | 2 | ICP/0630 | ICP/1900 |
| | | | | | | |
| 6. Control Operations/Work Assignments: | | | | | | |
| <ul style="list-style-type: none"> • CONTINUE TO HOLD AND IMPROVE LINE ALONG THE 17N03 ROAD. ... CONTINUE DOZER LINE FROM 17N05 DOWN 17N35 RIDGE. • CONTINUE PREP FROM DP10 TO 17N04 RD. . IMPROVE ANCHOR POINT AND SECURE HANDLINE CONSTRUCTION ON WEST FLANK. | | | | | | |
| 7. Special Instructions: | | | | | | |
| <ul style="list-style-type: none"> • COORDINATE AND ORDER AIRCRAFT FOR RETARDANT NEEDS WITH AIR ATTACK. | | | | | | |
| 8. Division/Group Communication Summary | | | | | | |
| Function | Channel | RX Frequency N/W | RX Tone/NAC | TX Frequency N/W | TX Tone/NAC | Mode |
| COMMAND | 1 | 167.1000 | 162.2 | 169.7500 | 162.2 | A |
| TACTICAL | 6 | 166.7750 | 162.2 | 166.7750 | 162.2 | A |
| BACKUP NET | 4 | 168.1250 | | 170.4750 | 127.3 | A |
| AIR TO GROUND | 10 | 165.3875 | | 165.3875 | | A |
| 9. Prepared By (Resource Unit Leader) | | | Approved By (Planning Section Chief) | | Date | Time |
| KYLE HAUDUCOEUR | | | DAVE LATTIMORE | | 08/12/2015 | 2100 |

Division/Group Assignment List (ICS 204 WF)

| | | | | | | |
|---|---------|------------------------------------|---|-----------------------------------|------------------------|------------------|
| 1. Incident Name: | | | 3. | | | |
| GASQUET COMPLEX | | | Branch: | | Division/Group: | |
| 2. Operational Period: 0600 - 0600 | | | | | G - BEAR FIRE | |
| Date/Time From: 08/13/2015 0600 | THU | Date/Time To: 08/14/2015 0600 | FRI | | | |
| 4. Operations Personnel | | | | | | |
| OPERATIONS CHIEF | | DERRICK DAVIS DARRELL MILLER | | DIVISION/GROUP SUPERVISOR | | |
| | | | | ERIC PLATZ CHRIS ST PIERRE (T) | | |
| PLANNING OPS | | MATT CONKLIN AARON THOMPSON (T) | | AIR ATTACK SUPERVISOR | | |
| | | | | CLIFF CLARIDGE KEN MCLAUGHLIN | | |
| 5. Resources Assigned this Period | | | | | | |
| Strike Team / Task Force / Resource Designator | | LWD | Leader | Number Persons | Drop Off PT./Time | Pick Up PT./Time |
| HC2 FORT APACHE 4 C-11 | | 08/20 | DANNY EDWARDS | 19 | ICP/0630 | ICP/1900 |
| TFLD JOEL PETERS O-226 | | 08/23 | | 1 | ICP/0630 | ICP/1900 |
| SKG3 CLEARWATER FIRE E-155 | | 08/26 | ED URICK | 1 | ICP/0630 | ICP/1900 |
| FELB CHRIS HENRIE O-181 | | 08/24 | | 1 | ICP/0630 | ICP/1900 |
| FAL1 NORTH ZONE FALLERS #2 O-95 | | 08/18 | BILLY BELMONT | 2 | ICP/0630 | ICP/1900 |
| FAL1 NORTH ZONE FALLERS #4 O-97 | | 08/18 | BILL MEADOWS | 2 | ICP/0630 | ICP/1900 |
| FAL1 MCKELLER TREE O-202 | | 08/22 | DOUG MCKELLAR | 2 | ICP/0630 | ICP/1900 |
| SOFR BRAD LIDELL O-252 | | 08/25 | | 1 | ICP/0630 | ICP/1900 |
| | | | | | | |
| | | | | | | |
| | | | | | | |
| 6. Control Operations/Work Assignments: | | | | | | |
| <ul style="list-style-type: none"> SCOUT FOR OPPORTUNITIES FOR DIRECT LINE CONSTRUCTION. PREP BEAR BASIN LOOKOUT TOWER AND PRESCOTT CABIN RUINS. CONTINUE LINE PREP FROM BEAR BASIN LOOKOUT DOWN THE SHIP MT RD TO THE WILDERNESS BOUNDARY. | | | | | | |
| 7. Special Instructions: | | | | | | |
| <ul style="list-style-type: none"> COORDINATE AND ORDER AIRCRAFT FOR WATER ONLY DROPS WITH AIR ATTACK. FOBS SCHEID / BAERTSCHI (T) WORKING IN DIV E AND DIV G. | | | | | | |
| 8. Division/Group Communication Summary | | | | | | |
| Function | Channel | RX Frequency N/W | RX Tone/NAC | TX Frequency N/W | TX Tone/NAC | Mode |
| COMMAND | 1 | 167.1000 | 162.2 | 169.7500 | 162.2 | A |
| TACTICAL | 7 | 168.2500 | 162.2 | 168.2500 | 162.2 | A |
| BACKUP NET | 4 | 168.1250 | | 170.4750 | 127.3 | A |
| AIR TO GROUND | 10 | 165.3875 | | 165.3875 | | A |
| 9. Prepared By (Resource Unit Leader) | | | Approved By (Planning Section Chief) | | Date | Time |
| KYLE HAUDUCOEUR | | | DAVE LATTIMORE | | 08/12/2015 | 2100 |

Division/Group Assignment List (ICS 204 WF)

| | | | | | | |
|---|--------------------------------------|------------------------------------|---|----------------------------------|--------------------------------|--|
| 1. Incident Name: | | | 3. | | | |
| GASQUET COMPLEX | | | Branch: | | Division/Group: | |
| 2. Operational Period: 0600 - 0600 | | | | | H/L/N/V - PEAK FIRE | |
| Date/Time From: 08/13/2015 0600 THU | Date/Time To: 08/14/2015 0600 FRI | | | | | |
| 4. Operations Personnel | | | | | | |
| OPERATIONS CHIEF | | DERRICK DAVIS DARRELL MILLER | | DIVISION/GROUP SUPERVISOR | | CANDICE KUTROSKY PAUL MANDOLINI (T) |
| PLANNING OPS | | MATT CONKLIN AARON THOMPSON (T) | | AIR ATTACK SUPERVISOR | | CLIFF CLARIDGE KEN MCLAUGHLIN |
| 5. Resources Assigned this Period | | | | | | |
| Strike Team / Task Force / Resource Designator | | LWD | Leader | Number Persons | Drop Off PT./Time | Pick Up PT./Time |
| TFLD GREGORY COX O-74 | | 08/18 | | 1 | ICP/0630 | ICP/1900 |
| TFLD DALE NEWBY (T) O-73 | | 08/18 | | 1 | ICP/0630 | ICP/1900 |
| ENG3 TRI CITY 106 E-25 | | 08/19 | ANTHONY GRAINGER | 4 | ICP/0630 | ICP/1900 |
| ENG3 MONTANA FIRE 341 E-30 | | 08/20 | MIKE WARREN | 3 | ICP/0630 | ICP/1900 |
| ENG4 FIRESTORM 03 E-114 | | 08/14 | BRAD CLEMENS | 3 | ICP/0630 | ICP/1900 |
| ENG4 CENTERAL WILDFIRE 741 E-116 | | 08/14 | DAVID PARSON | 3 | ICP/0630 | ICP/1900 |
| ENG6 SANTA CLARA 32 E-37 | | 08/19 | GABE RUNOLFSON | 2 | ICP/0630 | ICP/1900 |
| WTS2 ROGER CHERRY E-140 | | 08/25 | ROGER CHERRY | 1 | ICP/0630 | ICP/1900 |
| | | | | | | |
| | | | | | | |
| | | | | | | |
| ----CONTINUED ON PG 2---- | | | | | | |
| | | | | | | |
| | | | | | | |
| | | | | | | |
| | | | | | | |
| | | | | | | |
| | | | | | | |
| | | | | | | |
| | | | | | | |
| | | | | | | |
| 8. Division/Group Communication Summary | | | | | | |
| Function | Channel | RX Frequency N/W | RX Tone/NAC | TX Frequency N/W | TX Tone/NAC | Mode |
| COMMAND | 1 | 167.1000 | 162.2 | 169.7500 | 162.2 | A |
| TACTICAL | 8 | 168.0500 | 162.2 | 168.0500 | 162.2 | A |
| BACKUP NET | 4 | 168.1250 | | 170.4750 | 127.3 | A |
| AIR TO GROUND | 10 | 165.3875 | | 165.3875 | | A |
| 9. Prepared By (Resource Unit Leader) | | | Approved By (Planning Section Chief) | | Date | Time |
| KYLE HAUDUCOEUR | | | DAVE LATTIMORE | | 08/12/2015 | 2100 |

Division/Group Assignment List (ICS 204 WF)

| | | | | | | |
|--|---------|--------------------------------------|---|----------------------------------|---|--|
| 1. Incident Name: | | | 3. | | | |
| GASQUET COMPLEX | | | Branch: | | Division/Group: H/L/N/V - PEAK FIRE | |
| 2. Operational Period: 0600 - 0600 | | | | | | |
| Date/Time From: 08/13/2015 0600 THU | | Date/Time To: 08/14/2015 0600 FRI | | | | |
| 4. Operations Personnel | | | | | | |
| OPERATIONS CHIEF | | DERRICK DAVIS DARRELL MILLER | | DIVISION/GROUP SUPERVISOR | | CANDICE KUTROSKY PAUL MANDOLINI (T) |
| PLANNING OPS | | MATT CONKLIN AARON THOMPSON (T) | | AIR ATTACK SUPERVISOR | | CLIFF CLARIDGE KEN MCLAUGHLIN |
| 5. Resources Assigned this Period | | | | | | |
| Strike Team / Task Force / Resource Designator | | LWD | Leader | Number Persons | Drop Off PT./Time | Pick Up PT./Time |
| TFLD STEVE SISCOE O-79 | | 08/20 | | 1 | ICP/0630 | ICP/1900 |
| TFLD NICHOLAS BALENT (T) O-209 | | 08/21 | | 1 | ICP/0630 | ICP/1900 |
| ENG3 SRM 331 E-76 | | 08/14 | MIKE AVERY | 4 | ICP/0630 | ICP/1900 |
| ENG3 CRK 379 E-77 | | 08/14 | JOHN ANGELL | 4 | ICP/0630 | ICP/1900 |
| ENG3 PICTURE ROCK 121 E-26 | | 08/20 | ROCKY ORTIZ | 4 | ICP/0630 | ICP/1900 |
| ENG6 GRAND JUNCTION BR 3 E-151 | | | | 3 | ICP/0630 | ICP/1900 |
| ENG6 MONTROSE HELL FIGHTERS E-148 | | 08/26 | JASON HOBBY | 3 | ICP/0630 | ICP/1900 |
| WTS2 TRAYNHAM TRUCKING E-137 | | 08/25 | DAVE DAMON | 1 | ICP/0630 | ICP/1900 |
| FEMP MATT LUCAS O-137 | | 08/20 | | 1 | ICP/0630 | ICP/1900 |
| FEMT TONY CASTANEDA O-131 | | 08/20 | | 1 | ICP/0630 | ICP/1900 |
| | | | | | | |
| 6. Control Operations/Work Assignments: | | | | | | |
| <ul style="list-style-type: none"> KEEP FIRE NORTH AND EAST OF G-O ROAD IF POSSIBLE. FOLLOW THE MINIMUM REQUIREMENT DIRECTION OF 8-11-15. | | | | | | |
| 7. Special Instructions: | | | | | | |
| <ul style="list-style-type: none"> ALL RESOURCES USE CALL SIGN "LIMA" COORDINATE AND ORDER AIRCRAFT FOR WATER ONLY DROPS WITH AIR ATTACK. MONITOR SUMMIT & WILLIAMS FIRES BY AIR RAPID EXTRACTION MODULE (R.E.M.) AVAILABLE TO ALL DIV'S & GRP'S. | | | | | | |
| 8. Division/Group Communication Summary | | | | | | |
| Function | Channel | RX Frequency N/W | RX Tone/NAC | TX Frequency N/W | TX Tone/NAC | Mode |
| COMMAND | 1 | 167.1000 | 162.2 | 169.7500 | 162.2 | A |
| TACTICAL | 8 | 168.0500 | 162.2 | 168.0500 | 162.2 | A |
| BACKUP NET | 4 | 168.1250 | | 170.4750 | 127.3 | A |
| AIR TO GROUND | 10 | 165.3875 | | 165.3875 | | A |
| 9. Prepared By (Resource Unit Leader) | | | Approved By (Planning Section Chief) | | Date | Time |
| KYLE HAUDUCOEUR | | | DAVE LATTIMORE | | 08/12/2015 | 2100 |

Division/Group Assignment List (ICS 204 WF)

| | | | | | | |
|---|---------|--------------------------------------|---|----------------------------------|-------------------|----------------------------------|
| 1. Incident Name: | | | | 3. | | |
| GASQUET COMPLEX | | | | Branch: | | Division/Group: |
| 2. Operational Period: 0600 - 0600 | | | | W - FEEDER FIRE | | |
| Date/Time From: 08/13/2015 0600 THU | | Date/Time To: 08/14/2015 0600 FRI | | | | |
| 4. Operations Personnel | | | | | | |
| OPERATIONS CHIEF | | DERRICK DAVIS DARRELL MILLER | | DIVISION/GROUP SUPERVISOR | | GLENN WEBB AL WARD (T) |
| PLANNING OPS | | MATT CONKLIN AARON THOMPSON (T) | | AIR ATTACK SUPERVISOR | | CLIFF CLARIDGE KEN MCLAUGHLIN |
| 5. Resources Assigned this Period | | | | | | |
| Strike Team / Task Force / Resource Designator | | LWD | Leader | Number Persons | Drop Off PT./Time | Pick Up PT./Time |
| HC2I WHITE MOUNTAIN #1 C-3 | | 08/19 | KEITH M SARGENT | 19 | ICP/0630 | ICP/1900 |
| TFLD HYATT O-144 / OLEARY O-234 | | 08/16 | | 2 | ICP/0630 | ICP/1900 |
| ENG2 GASQUET 214 E-78 | | 08/14 | TOM ZURFLUEH | 4 | ICP/0630 | ICP/1900 |
| ENG4 WEBER FIRE DISTRICT 464 E-80 | | 08/14 | BARRY LOCKE | 4 | ICP/0630 | ICP/1900 |
| ENG6 TONTO 1247 E-82 | | 08/16 | SHAWN O'CONNELL | 7 | ICP/0630 | ICP/1900 |
| ENG6 AMERICAN FIRE CO 61 E-86 | | 08/14 | MATT MORRELL | 3 | ICP/0630 | ICP/1900 |
| ENG6 AMERICAN FIRE CO 62 E-85 | | 08/14 | MANI MORRELL | 3 | ICP/0630 | ICP/1900 |
| HEQB HARRIS O-218 / EXCA WALBERG, INC E-57 | | 08/25 | | 3 | ICP/0630 | ICP/1900 |
| HEQB MCCLELLAN O-216 / DOZ2 A TEAM E-127 | | 08/24 | | 5 | ICP/0630 | ICP/1900 |
| WTT2 SRF 15 E-45 | | 08/16 | JACOB MC ADAMS | 2 | ICP/0630 | ICP/1900 |
| WTT2 GASQUET VFD E-88 | | 08/15 | SALENA COX | 2 | ICP/0630 | ICP/1900 |
| FAL1 NORTH ZONE FALLERS #3 O-96 | | 08/18 | RICK MEE | 2 | ICP/0630 | ICP/1900 |
| 6. Control Operations/Work Assignments: | | | | | | |
| <ul style="list-style-type: none"> • CONTINUE TO PREP, SECURE & HOLD FIRE ALONG 14N39 RD FROM DP 30 NORTH TO THE 14N39G RD. | | | | | | |
| 7. Special Instructions: | | | | | | |
| <ul style="list-style-type: none"> • COORDINATE AND ORDER AIRCRAFT FOR RETARDANT NEEDS WITH AIR ATTACK. • RAPID EXTRACTION MODULE (R.E.M.) AVAILABLE TO ALL DIVISIONS AND CONTINGENCY GROUP | | | | | | |
| 8. Division/Group Communication Summary | | | | | | |
| Function | Channel | RX Frequency N/W | RX Tone/NAC | TX Frequency N/W | TX Tone/NAC | Mode |
| COMMAND | 1 | 167.1000 | 162.2 | 169.7500 | 162.2 | A |
| TACTICAL | 12 | 166.5500 | 162.2 | 166.5500 | 162.2 | A |
| BACKUP NET | 4 | 168.1250 | | 170.4750 | 127.3 | A |
| AIR TO GROUND | 10 | 165.3875 | | 165.3875 | | A |
| 9. Prepared By (Resource Unit Leader) | | | Approved By (Planning Section Chief) | | Date | Time |
| KYLE HAUDUCOEUR | | | DAVE LATTIMORE | | 08/12/2015 | 2100 |

Division/Group Assignment List (ICS 204 WF)

| | | | | | | |
|---|---------|--------------------------------------|---|----------------------------------|---|----------------------------------|
| 1. Incident Name: | | | 3. | | | |
| GASQUET COMPLEX | | | Branch: | | Division/Group: Z - FEEDER FIRE | |
| 2. Operational Period: 0600 - 0600 | | | | | | |
| Date/Time From: 08/13/2015 0600 THU | | Date/Time To: 08/14/2015 0600 FRI | | | | |
| 4. Operations Personnel | | | | | | |
| OPERATIONS CHIEF | | DERRICK DAVIS DARRELL MILLER | | DIVISION/GROUP SUPERVISOR | | ADAM KOHLEY ROBERT ALLAN (T) |
| PLANNING OPS | | MATT CONKLIN AARON THOMPSON (T) | | AIR ATTACK SUPERVISOR | | CLIFF CLARIDGE KEN MCLAUGHLIN |
| 5. Resources Assigned this Period | | | | | | |
| Strike Team / Task Force / Resource Designator | | LWD | Leader | Number Persons | Drop Off PT./Time | Pick Up PT./Time |
| HC1 SMITH RIVER C-29 | | 08/23 | TIM MEMMER | 19 | ICP/0630 | ICP/1900 |
| HC2I NHS#1 C-4 | | 08/19 | JOHN ROSS | 20 | ICP/0630 | ICP/1900 |
| HCM SLATE MOUNTAIN O-245 | | 08/26 | STEVE REYES | 10 | ICP/0630 | ICP/1900 |
| TFLD CATHLEEN LOWE O-76 | | 08/19 | | 1 | ICP/0630 | ICP/1900 |
| ENG3 LONE PEAK 1667 E-27 | | 08/19 | TOM WILSON | 7 | ICP/0630 | ICP/1900 |
| ENG3 BLACK HILLS 381 E-146 | | 08/26 | BRANDON SELK | 5 | ICP/0630 | ICP/1900 |
| ENG6 GRAND COUNTY 6802 E-36 | | 08/19 | MARK MARCUM | 2 | ICP/0630 | ICP/1900 |
| ENG6 SUNDANCE BR3 E-169 | | 08/25 | DANA LAW | 3 | ICP/0630 | ICP/1900 |
| HEQB ANDERSON O-215 / DOZZ JA COOK E-170 | | 08/24 | | 3 | ICP/0630 | ICP/1900 |
| WTS2 BOWNE WATER SERVICE E-40 | | 08/17 | MICHAEL BOONE | 1 | ICP/0630 | ICP/1900 |
| FAL1 CECIL LOGGING O-203 | | 08/22 | MICHEAL BERRY | 2 | ICP/0630 | ICP/1900 |
| SOFR PETE VILLA O-68 | | 08/19 | | 1 | ICP/0630 | ICP/1900 |
| 6. Control Operations/Work Assignments: | | | | | | |
| <ul style="list-style-type: none"> • CONTINUE PREP WORK ON G-O ROAD, FROM W / Z BREAK NORTH TO 15N01U ROAD. • CONTINUE DOZER / HANDLINE FROM G-O ROAD TO W / Z BREAK. | | | | | | |
| 7. Special Instructions: | | | | | | |
| <ul style="list-style-type: none"> • COORDINATE AND ORDER AIRCRAFT FOR RETARDANT NEEDS WITH AIR ATTACK. • RAPID EXTRACTION MODULE (R.E.M.) AVAILABLE TO ALL DIVISIONS AND CONTINGENCY GROUP. • FOBS RICK / TWEED (T) WORKING IN DIV W AND DIV Z. | | | | | | |
| 8. Division/Group Communication Summary | | | | | | |
| Function | Channel | RX Frequency N/W | RX Tone/NAC | TX Frequency N/W | TX Tone/NAC | Mode |
| COMMAND | 1 | 167.1000 | 162.2 | 169.7500 | 162.2 | A |
| TACTICAL | 9 | 168.6000 | 162.2 | 168.6000 | 162.2 | A |
| BACKUP NET | 4 | 168.1250 | | 170.4750 | 127.3 | A |
| AIR TO GROUND | 10 | 165.3875 | | 165.3875 | | A |
| 9. Prepared By (Resource Unit Leader) | | | Approved By (Planning Section Chief) | | Date | Time |
| JOE SCURI (T) | | | DAVE LATTIMORE | | 08/12/2015 | 2100 |

Division/Group Assignment List (ICS 204 WF)

| | | | | | | |
|---|---------|---|-----------------|--|-------------------|------------------|
| 1. Incident Name: | | 3. | | | | |
| GASQUET COMPLEX | | Branch: | | Division/Group: CONTENGENCY GROUP | | |
| 2. Operational Period: 0600 - 0600 | | | | | | |
| Date/Time From: 08/13/2015 0600 THU | | Date/Time To: 08/14/2015 0600 FRI | | | | |
| 4. Operations Personnel | | | | | | |
| OPERATIONS CHIEF | | DERRICK DAVIS DARRELL MILLER | | DIVISION/GROUP SUPERVISOR JEREMY COWIE BRIAN FABBRI (T) | | |
| PLANNING OPS | | MATT CONKLIN AARON THOMPSON (T) | | AIR ATTACK SUPERVISOR CLIFF CLARIDGE KEN MCLAUGHLIN | | |
| 5. Resources Assigned this Period | | | | | | |
| Strike Team / Task Force / Resource Designator | | LWD | Leader | Number Persons | Drop Off PT./Time | Pick Up PT./Time |
| TFLD JON OLSEN O-233 | | 08/24 | | 1 | ICP/0630 | ICP/1900 |
| CHIP CECIL 1 E-130 | | 08/25 | JUSTIN CECIL | 2 | ICP/0630 | ICP/1900 |
| CHIP COASTAL TREE SERVICE E-131 | | 08/24 | JOHN DILLON | 2 | ICP/0630 | ICP/1900 |
| ENG3 PASO 3110 E-160 | | 08/26 | DAVID JR YOWELL | 3 | ICP/0630 | ICP/1900 |
| ENG6 NATIONAL 204 E-149 | | 08/26 | LEENKUN BACA | 3 | ICP/0630 | ICP/1900 |
| | | | | | | |
| | | | | | | |
| | | | | | | |
| | | | | | | |
| | | | | | | |
| | | | | | | |
| | | | | | | |
| | | | | | | |
| | | | | | | |
| | | | | | | |
| 6. Control Operations/Work Assignments: | | | | | | |
| <ul style="list-style-type: none"> • COORDINATE WITH SOPL TO VALIDATE LONG TERM PLANS. • COORDINATE CHIPPING ACTIVITIES WITH ALL DIVISIONS. | | | | | | |
| 7. Special Instructions: | | | | | | |
| <ul style="list-style-type: none"> • RAPID EXTRACTION MODULE (R.E.M.) AVAILABLE TO ALL DIVISIONS AND CONTINGENCY GROUP • REVIEW CHIPPER JHA. • FOBS - PENNY / MASTERS. | | | | | | |
| 8. Division/Group Communication Summary | | | | | | |
| Function | Channel | RX Frequency N/W | RX Tone/NAC | TX Frequency N/W | TX Tone/NAC | Mode |
| COMMAND | | SEE COMM PLAN | | | | |
| TACTICAL | | | | | | |
| BACKUP NET | | | | | | |
| AIR TO GROUND | | | | | | |
| 9. Prepared By (Resource Unit Leader) | | Approved By (Planning Section Chief) | | Date | Time | |
| KYLE HAUDUCOEUR | | DAVE LATTIMORE | | 08/12/2015 | 2100 | |

INCIDENT RADIO COMMUNICATIONS PLAN (ICS 205)

| | | |
|---|---|--|
| 1. Incident Name: GASQUET COMPLEX | 2. Date/Time Prepared: Date: 08/12/2015 Time: 2100 | 3. Operational Period: 0600 - 0600 Date/Time From: 08/13/2015 0600 Date/Time To: 08/14/2015 0600 THU FRI |
|---|---|--|

| 4. Basic Radio Channel Use: | | | | | | | | | | |
|-----------------------------|------|---------------|---|---------------|----------|-------------|----------|-------------|------------------|-----------------|
| Zone Group | Ch # | Function | Channel Name/Trunked Radio System Talkgroup | Assignment | RX Freq | RX Tone/NAC | TX Freq | TX Tone/NAC | Mode (A,D, or M) | Remarks |
| | 1 | COMMAND | CMD 1 | ALL DIVISIONS | 167.1000 | 162.2 | 169.7500 | 162.2 | A | SHIP MTN |
| | 2 | COMMAND | CMD 2 | UNASSIGNED | 000.0000 | | 000.0000 | | A | |
| | 3 | COMMAND | CMD 3 | UNASSIGNED | 000.0000 | | 000.0000 | | A | |
| | 4 | BACKUP NET | SRF ADM | ALL DIVISIONS | 168.1250 | | 170.4750 | 127.3 | A | GORDON MTN |
| | 5 | TACTICAL | NIFC T5 | DIV C | 166.7250 | 162.2 | 166.7250 | 162.2 | A | |
| | 6 | TACTICAL | NIFC T6 | DIV E | 166.7750 | 162.2 | 166.7750 | 162.2 | A | |
| | 7 | TACTICAL | NIFC T7 | DIV G | 168.2500 | 162.2 | 168.2500 | 162.2 | A | |
| | 8 | TACTICAL | NIFC T1 | DIV H/L/NV | 168.0500 | 162.2 | 168.0500 | 162.2 | A | CALL SIGN DIV L |
| | 9 | TACTICAL | NIFC T3 | DIV Z | 168.6000 | 162.2 | 168.6000 | 162.2 | A | |
| | 10 | AIR TO GROUND | A/G TAC | ALL DIVISIONS | 165.3875 | | 165.3875 | | A | |
| | 11 | AIR TO GROUND | A/G CMD | UNASSIGNED | 000.0000 | | 000.0000 | | A | |
| | 12 | TACTICAL | R5 TAC 4 | DIV W | 166.5500 | 162.2 | 166.5500 | 162.2 | A | |
| | 13 | TACTICAL | R5 TAC 5 | DIV A | 167.1125 | 162.2 | 167.1125 | 162.2 | A | |
| | 14 | TACTICAL | R5 TAC 6 | DIV D | 168.2375 | 162.2 | 168.2375 | 162.2 | A | |
| | 15 | EMS TAC | CALCORD | ALL DIVISIONS | 156.0750 | | 156.0750 | 156.7 | A | MEDICAL A/G |
| | 16 | AIR GUARD | GUARD | ALL DIVISIONS | 168.6250 | | 168.6250 | 110.9 | A | EMERGENCY ONLY |
| | 20 | AIR GUARD | GUARD | ALL DIVISIONS | 168.6250 | | 168.6250 | 110.9 | A | EMERGENCY ONLY |

6. Prepared By (Communications Unit Leader) Name: CHRIS PERRY (T) Signature: 

ICS 205 IAP Page Date/Time: 08/12/2015 2100

AIR OPERATIONS SUMMARY

PREPARED BY: Ted Visser



PREPARED DATE/TIME: 08/12/15 1900

1. INCIDENT NAME: Gasquet Complex

2. OPERATIONAL PERIOD DATE: 08/13/15

START TIME: 0700

END TIME: 2000

SUNRISE: 0622

SUNSET: 2021

3. REMARKS (Safety Notes, Hazards, Air Operations Special Equipment, etc.)

Thunderstorms, erratic winds. Low wires, cables, power lines.

Divisions, contact Hellbase for all aviation needs, include coordinates of possible helispot/unimproved landing locations.

Possible smoke concerns.

Track all retardant usage and location if used.

Do not dip from lakes near 41 35.000 x 123 43.00

IP for Air Tankers 41 47.21 X 123 04.40 5000'

Cave HB Gate 10155#

Six Rivers Disp. Air Desk 707-726-1266

4. MEDEVAC
A/C: 512

5. TFR: 5/0539
Radius: 10 NMI
Altitude: 9000 MSL
Centerpoint: N 41 41.57
W 123 49.05

Freq: 128.0750

Illinois Valley Tower Freq: 133.275

6. PERSONNEL

AOBD: Ted Visser

ASGS: Galen Young

ATGS: Ken McLaughlan

ATGS: Cliff Claridge

HEB1: Melvin Tate

HEB1(T): Rita Clipperton

SEAT:

Phone

619-981-2409

575-574-8720

813-997-0317

480-688-5330

850-849-0405

530-559-0905

7. FREQUENCIES

AIR/AIR FW:

AIR/AIR RW:

AIR/GROUND CMD:
AIR/GROUND TAC:

COMMAND: RX:
TX:

AM

166.4500

128.0750

165.3875

167.1000
169.7500
Tone 15 162.2

8. FIXED-WING

Airtankers:

Leadplanes:

ATBase:

ATGS Aircraft:

AAB:

Avail / Type / Make-Model / FAA # / Base(s)

Available through Dispatch
SEAT 818, SEAT 886

Available through Dispatch

N 4579N, A-6 Claridge
N 285 , A-65 McLaughlan

MRB: ICL, Joe Hart, 208-699-1166

Gary Smith
S-31,32,33
Uni Engine
530-598-1434

Cave- HOS Trlr., E-2, Chris Long, 208-539-7108
Cave- 49er WTr, E-41 Bobby Alvarez, 619-300-0801
Cave Hellbase 541-592-2852, FAX 541-592-3798

9. HELICOPTERS (Use Additional Sheets As Necessary)

| FAA # | TY | MAKE/MODEL | BASE | AVAILABLE | START | REMARKS | FAA # | TY | MAKE/MODEL | BASE | AVAILABLE | START | REMARKS |
|--------|----|------------|------|-----------|-------|--------------------|-------|----|------------|------|-----------|-------|---------|
| HT-702 | 1 | S-61 | Cave | 0730 | 0830 | A-20 | | | | | | | |
| HT-782 | 1 | S-64 | Cave | 0730 | 0830 | A-62 | | | | | | | |
| 512 | 2 | Bell 212 | Cave | 0730 | 0830 | A-42 | | | | | | | |
| 517 | 2 | Bell 205 | Cave | UNK | UNK | A-57 Restricted | | | | | | | |
| 9888 | 3 | Bell 14 | Cave | 0730 | 0830 | A-28 | | | | | | | |

10. TASK/MISSION/ASSIGNMENT (Type/Function Includes: Air Tactical, Retardant, Recon, Personnel Transport, Water Dropping, S&R, etc.)

| TYPE/FUNCTION | NAME OF PERSONNEL OR CARGO (if applicable) OR INSTRUCTIONS FOR TACTICAL AIRCRAFT | MISSION START | FLY FROM | FLY TO |
|--------------------------|--|---------------|----------|--------|
| Bucket drops per request | Division Sup. To request and coordinate with Air Attack or helibase. | | | |
| Recon Flights | To be approved by OPS or AOBD | | | |
| Cargo / Sling | Per Request from Div Sups, all sling loads / crew shuttles | | | |
| Ops Recon | | | | |
| Div Sup Recon | | | | |
| DIPSITES | River Dip 41 44 .150 X 123 59.02 Bear Dip 41 50.487 X 123 46.359 | | | |
| Nickowitz Fire Freq's | Air to Air FW 165.7500 Air to Air RW 118.950 | | | |
| | Air to Ground 167.600 Command 2 170.4125 Rx 165.9625Tx Tone 127.3 | | | |
| | | | | |
| | | | | |
| | | | | |
| | | | | |
| | | | | |
| | | | | |
| | | | | |

| | | | | | | | | |
|--|--|-----------------------------------|---|---|---------|----|-------------|----|
| MEDICAL PLAN | 1. INCIDENT NAME Gasquet Complex | 2. DATE PREPARED 8/12/15 | 3. TIME PREPARED 1730 | 4 OPERATIONAL PERIOD 8/13-14/2015 0600-0600 | | | | |
| 5. INCIDENT MEDICAL AID STATIONS | | | | | | | | |
| MEDICAL AID STATIONS | | LOCATION | | PARAMEDIC YES NO | | | | |
| Medical Supply | | Base Camp | | | | | | |
| TRANSPORTATION | | | | | | | | |
| A. Air Ambulances | | | | | | | | |
| NAME | | ADDRESS | | PHONE PARAMEDIC YES NO | | | | |
| National Guard H-825 (Day/Night, Hoist) | | Redding Airport, CA | | Communications X | | | | |
| CHP H-14 (Day/Night, Hoist) | | Redding Airport, CA | | (530) 842-3515 X | | | | |
| Coast Guard (Day/Night, Hoist) | | Air Station Humboldt Bay, CA | | (707) 839-6100 X | | | | |
| CalFire Kneeland Helitack H-102 (Hoist capable) | | Kneeland Station, CA | | (707) 441-2863 X | | | | |
| Reach 5 Air Medical | | Redding, CA | | 1-800-338-4045 X | | | | |
| Mercy Air Ambulance 105 | | Medford, Oregon | | 1-800-903-9000 X | | | | |
| PHI Air Medical | | Redding, CA | | 1-800-597-9571 X | | | | |
| B. Ground Ambulances | | | | | | | | |
| Del Norte Ambulance, Station 2 | | 2600 Morehead Rd Crescent City CA | | Communications X | | | | |
| C. Rapid Extraction Modules | | | | | | | | |
| R.E.M. – South | | Gasquet South Operations | | Communications X | | | | |
| 7. HOSPITALS | | | | | | | | |
| NAME | ADDRESS | TRAVEL TIME | | PHONE | HELIPAD | | BURN CENTER | |
| | | AIR | GRND | | YES | NO | YES | NO |
| Sutter Coast Hospital | 800 E Washington Crescent City CA. | | 25min | ER: 707-464-8888 Gen: 707-464-8511 | | X | | X |
| Mercy Med. Center Level 3 Trauma | 914 Pine St. Mt. Shasta, CA. N. 40 34.14 x W. 122 23.97 | 45m | 4.5hr | (530)926-9360 | X | | | X |
| Rogue Valley Med Center Level 2 Trauma | 2825 Barnett Rd. Medford, OR. N. 42 19.092 W. 122 49.833 | 30m | 2 hr | (541)789-7100 | X | | | X |
| UC Davis Med Center Level 1 Trauma Burn Center | 2315 Stockton Blvd. Sacramento, CA N. 38 33.3 x W. 121 27.3 | 2hr | 7.0hr | (916) 734-3636 Burn Center (916) 734-3790 ER | X | | X | |
| 8. MEDICAL EMERGENCY PROCEDURES | | | | | | | | |
| <p>In the event of a medical emergency provide the following information to your Divs or Gasquet Communications on Command.</p> <ol style="list-style-type: none"> 1. Declare the nature of the emergency. <ol style="list-style-type: none"> a. Medical injury/illness? b. Is injury/illness life threatening? 2. If life threatening, then request that the designated frequency be cleared for emergency traffic. 3. Identify the on-scene Point of Contact (POC) by resource and last name (i.e POC is TFLD Smith). 4. Identify nature of incident, number injured, patient assessment(s) and location (geographic and GPS coordinates). 5. Identify on-scene medical personnel by position and name (i.e EMT Jones). 6. Identify preferred method of patient transport. 7. Request any additional resources and/or equipment needed 8. Document all information received and transmitted on the radio or phone. 9. Identify any changes in the on-scene Point of Contact or medical personnel as they occur. | | | | | | | | |
| <p><u>INJURY REPORTING PROCEDURES</u></p> <p>NATURE OF INJURY _____ # of Patients _____</p> <p>TRANSPORTION NEEDED Air _____ Ground _____</p> <p>REM Needed Y _____ N _____ Estimated Air Temp _____</p> <p>LAT _____ LONG _____ Elevation _____</p> <p>Specific Hazards In Area _____</p> <p>PATIENT UNIT ID _____</p> <p>REMINDER: DO NOT GIVE PT NAME OVER RADIO</p> <p>IS MEDICAL PERSONNEL WITH PATIENT: YES _____ NO _____</p> <p>AGE _____ SEX: MALE _____ FEMALE _____</p> <p>ALL EMERGENCIES—Secure the area and identify witnesses for later investigation. Keep an accurate log of events.</p> | | | | | | | | |
| ICS 206 8-78 | 9. PREPARED BY (MEDICAL UNIT LEADER) Gena Fowlkes MEDL (909) 762-9032 | | 10. REVIEWED BY (SAFETY OFFICER) James Aragon SOF2 | | | | | |



Human Resource and Training Message

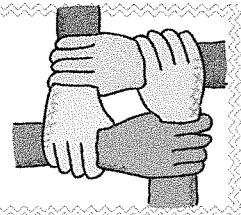

Please come and Join us
on Thursday Night, August 13, 2015
from 1800-2000

Training and HRSP will have a table between the
Caterer's tent and Supply:

- We are going to be there to answer any questions you may have in reference to your training or any other questions.
- We will also have a "where are you from" activity.
- Also Remember, it is close to Demob and we want to make sure you get your training experience credited and documented.
 - Taskbooks with information recorded for incident
 - Trainee's Personnel Performance Rating for ICS 225 completed
 - Incident Trainee Interview (provided by TNSP)

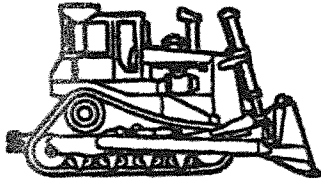

SAFETY MESSAGE



"Adapt...Improvise...and Overcome"

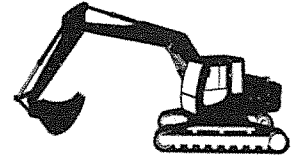

Incident: Gasquet Complex

Date / Operational Period: 8/13-14/15

MAJOR HAZARDS AND RISKS

- | | |
|---|---|
| <ul style="list-style-type: none"> • Ongoing air operations. Refer to aviation blue pages in your IRPG for retardant and bucket drop safety tips. • Communications... conduct communications checks up and down your operational structure • Dehydration—Drink lots of water | <ul style="list-style-type: none"> • Rocky, rough terrain--falls/slips • Snags!!! Rolling Rocks!!! • Driving, backing and turning around on narrow, washboard mountain roads- watch for soft shoulders • Fast moving traffic on HWY 199 – take extra time to check for oncoming traffic prior to driving onto highway |
|---|---|

Working with Heavy Equipment

- When working around heavy equipment in timber, keep a distance of 2 ½ times the canopy height away from the equipment.
- Never approach equipment until you have eye contact with the operator, all implements have been lowered to the ground and equipment is idled down.
- Avoid working below equipment where rolling material could jeopardize your safety.
- Establish visual communication methods prior to engaging.
- Communicate all hazards to the operator (spot fires, firing operations, and obstacles).
- Equipment operators have difficulty seeing ground personnel; take responsibility for your safety and all those around you.
- Watch for heavy equipment being transported on or working on narrow forest roads. Traffic guards or road closures may need to be implemented in areas with active heavy equipment operations.
- The root systems of green trees are in a weak state due to the drought. This can result in trees coming down with little effort or push by machinery. Brief crews on this condition so that they can plan accordingly.

Prepared By:

Fred Hernandez, Safety Officer (r)

Approved By:

James Aragon, Safety Officer

INCIDENT SAFETY ANALYSIS 215a

Gasquet Complex - Thursday, August 13, 2015

| 8. Location | 9. Hazard | 6. Control or Abatement Action (Engineering, Administrative, PPE, Avoidance, Education, etc.) |
|-------------|--------------------------------|---|
| All | Hazard Trees | <ul style="list-style-type: none"> ~ Follow "Hazard Tree Safety" guidelines, IRPG pages 22 & 23 ~ Post lookouts, or use a spotter in mop-up areas with personnel ~ Don't park vehicles or take breaks in high concentrations of hazard trees ~ Establish trigger points for disengagement during high wind events |
| All | Air Operations | <ul style="list-style-type: none"> ~ Follow "Aviation Watch-Out Situations" on page 44, IRPG ~ Don't plan on air resources for medical transport or resupply. ~ Refer to page 57, IRPG for directing bucket drops. ~ Ensure positive communication with all air resources. |
| All | Chain Saw Operations | <ul style="list-style-type: none"> ~ Follow "Hazard Tree Safety" guidelines, IRPG pages 22 & 23 ~ Look up, down around for hazard tree indicators ~ Only fell and buck trees within your expertise, and training ~ Follow "Procedural Felling Operations" on page 79 in IRPG ~ Do not fall trees during high wind events |
| All | Steep Terrain & Rolling Debris | <ul style="list-style-type: none"> ~ Maintain 8'-10' spacing when working & walking ~ Don't work above any personnel ~ Evaluate necessity to send personnel in areas with limited access |
| All | Driving & Traffic | <ul style="list-style-type: none"> ~ Practice "Defensive Driving" techniques traveling on all roads and city streets, mitigation strategy includes: <ul style="list-style-type: none"> ~ Use spotters when backing ~ Honk horn to alert personnel when backing ~ Always use headlights ~ Yield to pedestrians and bicycles ~ Observe posted speed limits ~ Follow 3 second rule of following distance when driving ~ Use chock blocks, turn wheels into hill |
| All | Firing Operations & Devices | <ul style="list-style-type: none"> ~ Only personnel trained in the use of each device will be authorized to use firing equipment. ~ Ensure all personnel are aware of firing operation that may affect them. ~ Wear appropriate PPE. ~ Ensure aerial/ground ignition plans have been adequately developed and personnel are briefed. |
| All | Injury & Medical Emergency | <ul style="list-style-type: none"> ~ Assist injured employee appropriate medical care ~ Use EMT's on Division for initial care ~ Follow medical protocol as outlined in ICS-206 |
| All | Bees, Ticks, Mosquitoes | <ul style="list-style-type: none"> ~ Be aware of crew members with sting allergies. ~ Ensure crew members have medication pens if needed. ~ Perform daily self inspection ~ Use repellent as necessary |
| All | Poisonous Plants | <ul style="list-style-type: none"> ~ Identify and Avoid hazard areas ~ Launder clothing ~ Shower frequently |
| A,C,E,W | Heavy Equipment Operations | <ul style="list-style-type: none"> ~ Ensure communications are established with operators ~ Use hand signals if other communications are unavailable ~ Maintain a 50'-100' exclusion area around equipment ~ Use a spotter when backing |



Incident within an Incident Action Plan

Position Assignment Supportive Actions

Division Supervisor

- See items 1-6 on page one
- If unable to access accident/incident location, delegate command to a closer qualified resource

Medical Unit Leader

- Respond to Comm Unit as soon as possible
- Coordinate with Division Supervisor to ensure proper resources are rapidly ordered
- Assign a MEDL to the scene and other positions to support the response as needed
- Monitor condition updates of patient(s) and coordinate response with Operations

Communications Unit Leader

- Maintain clear radio traffic and monitor communications to support response
- Recommend appropriate security and investigative process
- Assess the need for critical Incident Stress Response

Safety Officer

- Provide for Safety personnel on scene as needed
- Recommend appropriate security and investigative process
- Assess the need for critical Incident Stress Response

Air Attack Supervisor

- Obtain coordinates of the emergency location
- Coordinate air-medical response
- Assist and support the designated Point of Contact with communications and coordination of the emergency response as necessary

IC, Command & General Staff

- Manage the emergency and direct specific responsibilities to individual positions to provide an appropriate response
- Notify the host unit and host dispatch center of the size-up information
- Constantly monitor and assess the appropriate response and adapt direction as needed
- Submit all documentation pertaining to the emergency to the Plans Chief

Reference the full Incident Medical Emergency Plan for additional



Incident within an Incident Action Plan

When the scope or complexity of the emergency exceeds division resource needs

This plan is designed to identify the initial actions that should be taken by the first arriving personnel on a serious accident. This person may be a single resource, engine boss, or a crew boss. Accidents or incidents within an incident happen rapidly and require sound, calm initial decisions to handle the problem, while still focusing on the main incident. The following checklist provides some key thoughts and actions.

The first arriving person to any accident should notify their Division Supervisor, or the Div Sup assigned to that location.

Advise of the critical information needed:

- Accident scene safety assessment and advise incoming personnel
- Number of injuries and their severity
- Special equipment needs (extrication, low/high angle rescue, fire protection or suppression)
- Assist the injured as necessary without endangering yourself or other personnel
- Do not move trauma victims unless their safety is in jeopardy
- Utilize PINK pages of the Incident Response Pocket Guide (IRPG) for patient assessment/medical procedures

Remain aware of surroundings and delegate personnel to monitor the main fire

The **Division Supervisor** will assume command of the accident/incident scene upon arrival. The following list outlines the general duties and tasks that should be completed on most accidents/incidents.

1. Delegate division oversight to another Division Supervisor or other qualified person.
2. Request a clear frequency from Comm and consider switching to designated Emergency Tactical (Incident Comm will notify the MEDL who will initiate the medical plan for injuries)
3. Order/delegate resources appropriate for the accident/incident (crew EMT's, Line EMT's or Line Medics, rescue equipment, patient transport needs, manpower)
4. Notify Operations Section Chief and Safety Officer on all accidents/incidents.
5. Begin to document the event accurately and completely. Use ICS form 201 if the event is large or complex.
6. Protect the scene for Investigators

Reference the full Incident Medical Emergency Plan for additional

Mountain School
 55 Azalea Lane
 Gasket, CA 95543
 (707) 457-3211

ICP

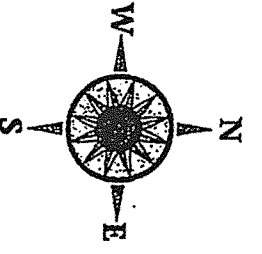

| | | |
|-------------------|-------------------|---------------------|
| P | Portable | Fire Alarm Panel |
| C | Classroom | Water Shut Off |
| Exit/Door | Exit/Door | Electrical Shut Off |
| Fire Extinguisher | Fire Extinguisher | |

071410/Site Maps/Del Norte

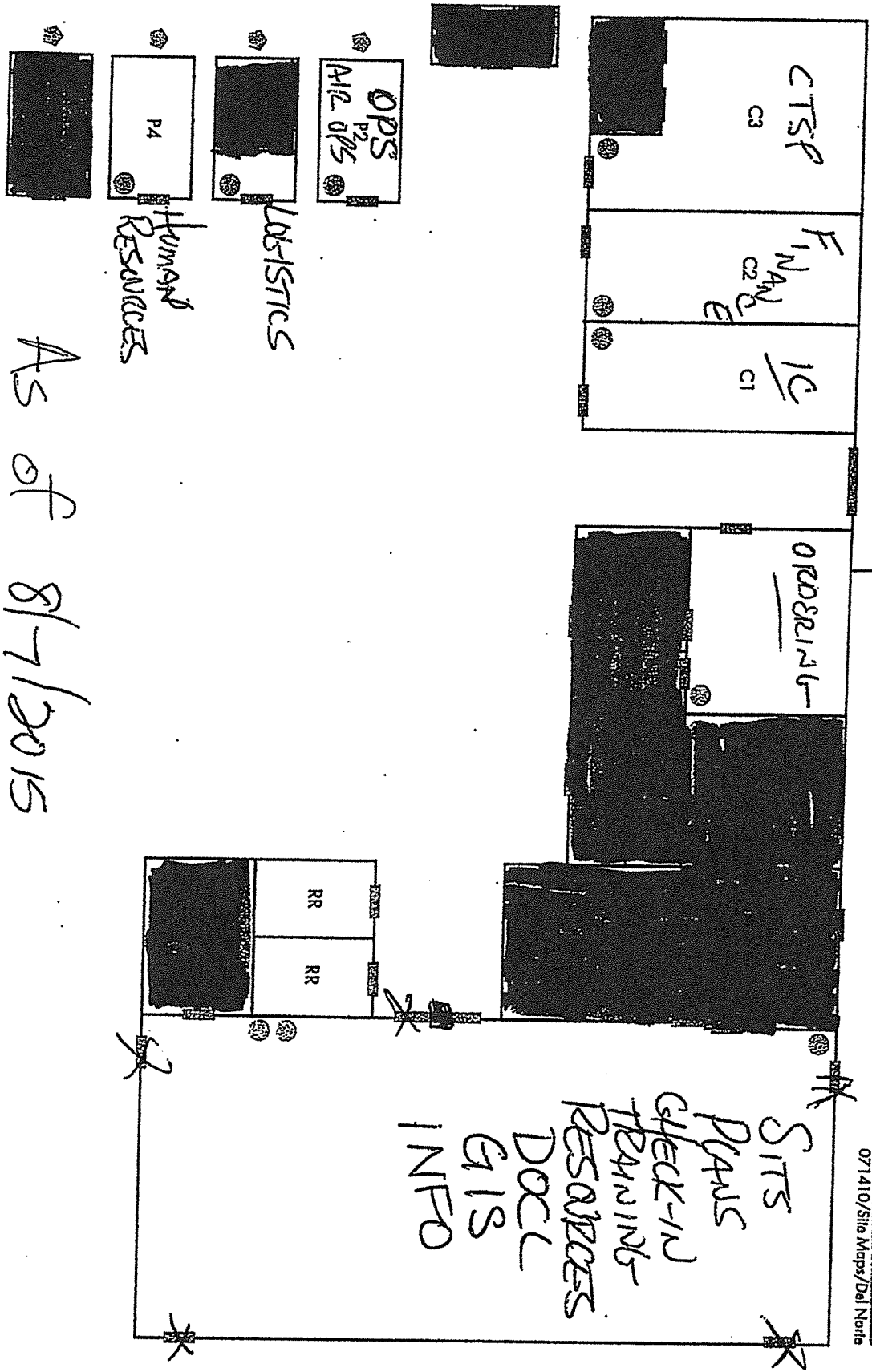

As of 8/7/2015

GASQUET COMPLEX BASE CAMP

Updated 08/10/2015

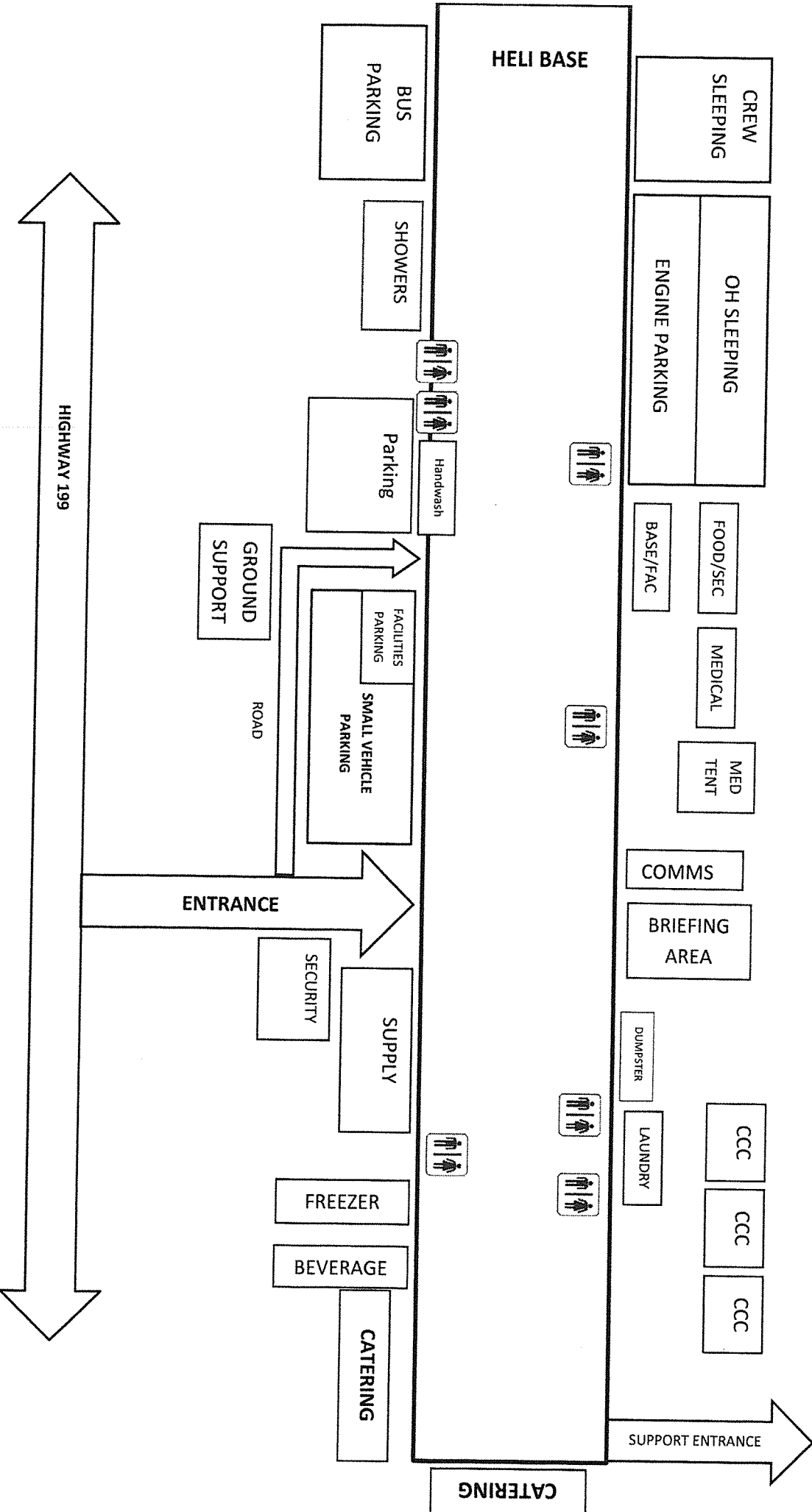
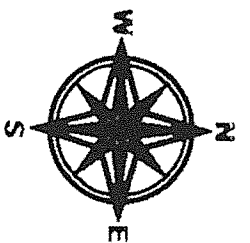

1 Gasquet Complex

LA-SRF-001488

Transportation MAP

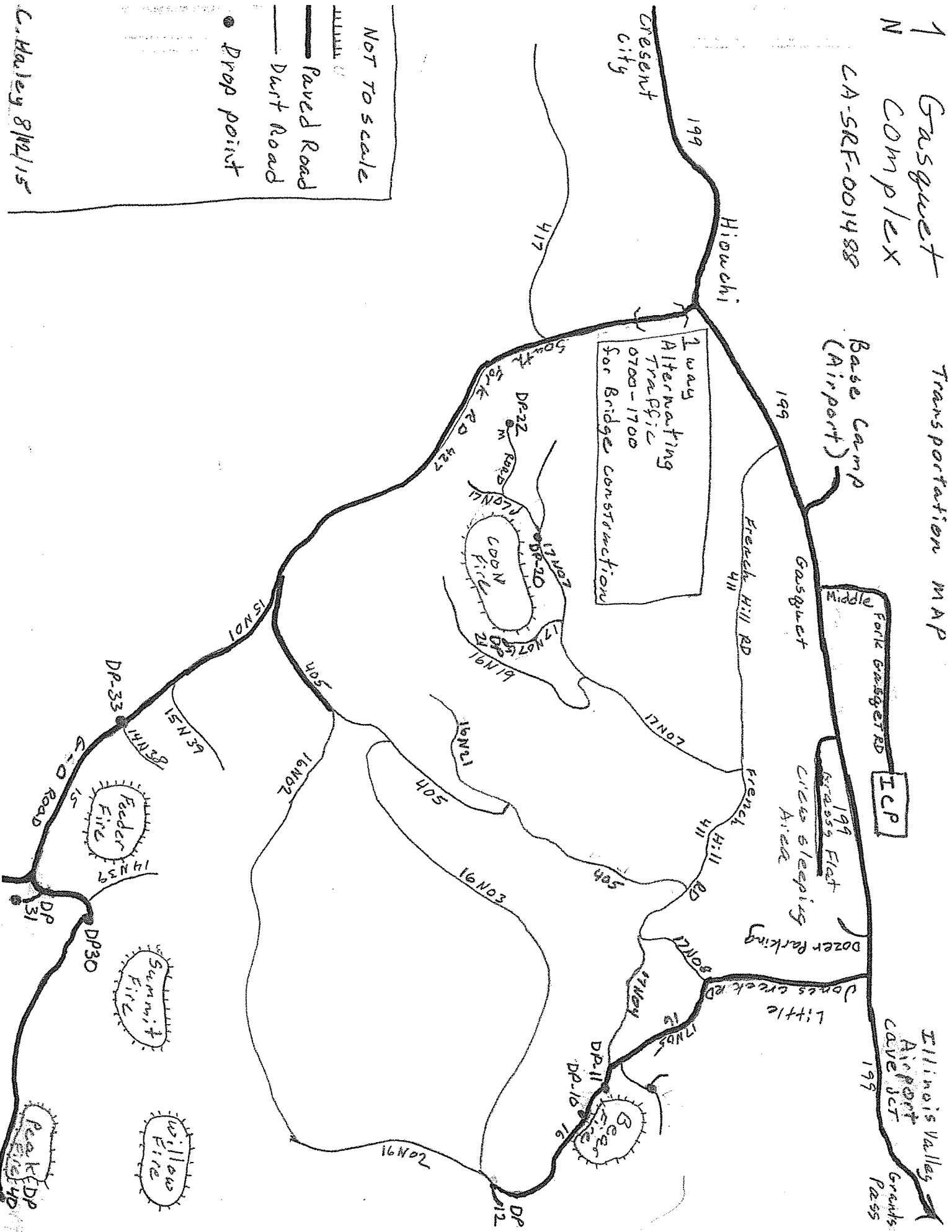

NOT TO scale

Paved Road

Dirt Road

Prop point

C. Halsey 8/10/15

Gasquet Complex Demob Date as of 8-12-2015

| REQUEST NUMBER | RESOURCE NAME | ITEM CODE | DEMOB DATE |
|----------------|----------------------------|-----------|------------|
| O-103 | TWEED, CHRIS | FOBS | 08/14/2015 |
| O-139 | SCURI, JOSEPH | RESL | 08/14/2015 |
| O-141 | PAYNE, DALE | DRIV | 08/14/2015 |
| A-57 | BALD MOUNTAIN HELITAK H517 | HEL2 | 08/15/2015 |
| E-75 | LKP 5031 | ENG3 | 08/15/2015 |
| E-76 | SRM 331 | ENG3 | 08/15/2015 |
| E-77 | CRK 379 | ENG3 | 08/15/2015 |
| E-78 | GASQUET 214 | ENG2 | 08/15/2015 |
| E-80 | WEBER FIRE DISTRICT 464 | ENG4 | 08/15/2015 |
| E-114 | FIRESTORM 03 | ENG4 | 08/15/2015 |
| E-116 | CENTERAL WILDFIRE 741 | ENG4 | 08/15/2015 |
| E-117 | PATRICK 14 | ENG6 | 08/15/2015 |
| O-149 | SCOTT, JAISY | PTRC | 08/15/2015 |
| O-150 | BALENT, SHEILA | EQTR | 08/15/2015 |
| C-30 | STEELHEAD | HC2 | 08/16/2015 |
| E-82 | TONTO 1247 | ENG6 | 08/16/2015 |
| E-86 | AMERICAN FIRE CO 61 | ENG6 | 08/16/2015 |
| E-87 | WOOD'S WT 99 | WTT2 | 08/16/2015 |
| E-88 | GASQUET VFD | WTT2 | 08/16/2015 |
| E-115 | ASI 3 | ENG6 | 08/16/2015 |
| E-118 | DARE ENTERPRISES 32 | ENG6 | 08/16/2015 |
| O-88 | WINN, DOUGLAS | FACL | 08/16/2015 |
| O-148 | WYATT, JANICE | CAMP | 08/16/2015 |
| O-207 | DEVLIN, BRENDA | THSP | 08/16/2015 |
| O-208 | MCCAINE, MIKE | THSP | 08/16/2015 |
| O-262 | MOSEY, KERI | CAMP | 08/16/2015 |
| O-276 | FREDERICK, MICHAEL | AREP | 08/16/2015 |

