

# **GASQUET COMPLEX**

## **INCIDENT ACTION PLAN**

**OPERATIONAL PERIOD**

**AUG 14 – AUG 15, 2015**

**0600-0600**



*"Adapt...Improvise...and Overcome"*



**CA-SRF-001488  
P5JOPQ (0510)**

**NAD 83  
dd° m.mm'**

## INCIDENT OBJECTIVES (ICS 202)

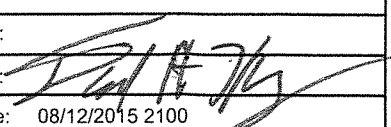
<b>1. Incident Name:</b>		<b>2. Operational Period:</b> 0600 - 0600	
GASQUET COMPLEX		Date/Time From: 08/14/2015 0600      FRI	Date/Time To: 08/15/2015 0600      SAT
<b>3. Objective(s):</b>			
<p><b>STRATEGIC FRAMEWORK:</b> THE FRAMEWORK FOR THE GASQUET COMPLEX STRATEGIC PLAN CONSISTS OF USING A COMBINATION OF DIRECT ATTACK WHERE FEASIBLE, OTHERWISE INDIRECT USING NATURAL BARRIERS. A KEY ELEMENT IS FLEXIBILITY AND THE ABILITY TO APPLY THE RIGHT RESOURCE TO THE RIGHT TASK AT THE RIGHT TIME. FIRELINE WILL BE CONSTRUCTED ONLY WHERE FEASIBLE AND SAFE TO DO SO.</p> <p><b>LEADERS INTENT:</b> PROVIDE THE HIGHEST LEVEL OF CUSTOMER SERVICES TO ALL INVOLVED WITH OR IMPACTED BY THE GASQUET COMPLEX. ALL INCIDENT PERSONNEL SHOULD BE PREPARED TO TAKE THE APPROPRIATE ACTIONS REGARDING:</p> <ul style="list-style-type: none"> <li>• PERSONAL INTERACTIONS BOTH INSIDE AND OUTSIDE THE INCIDENT MANAGEMENT ORGANIZATION.</li> <li>• PERSONAL SAFETY AND THE SAFETY OF OTHERS.</li> <li>• AN INCIDENT-WITHIN-AN-INCIDENT.</li> </ul> <p><b>OBJECTIVES:</b></p> <ul style="list-style-type: none"> <li>• PROVIDE FOR FIREFIGHTER AND PUBLIC SAFETY BY ENSURING L C E S IS EVALUATED USING SOUND RISK MANAGMENT PRINCIPLES.</li> <li>• MAINTAIN AND BUILD COOPERATOR AND STAKEHOLDER RELATIONSHIPS.</li> <li>• SUPPRESS FIRES WHILE NOT EXPOSING FIREFIGHTERS OR AIRCRAFT TO UNNECESSARY RISKS.</li> <li>• IDENTIFY AND PROTECT NATIVE AMERICAN TRADITIONAL AREAS AND OTHER SENSITIVE CULTURAL AND HISTORIC SITES.</li> </ul>			
<b>4. Operational Period Command Emphasis:</b>			
UTILIZE SUPPRESSION STRATEGIES COMMENSURATE WITH VALUES AT RISK. IMPLEMENT TACTICS WHICH INCREASE THE PROBABILITIES OF SUCCESS WHILE HOLDING EXISTING CONTAINMENT.			
<b>General Situational Awareness:</b>			
WHEN WORKING ON HILLSIDES, BE AWARE OF FALLING TREES. THESE TREES CAN SLIDE ALONG WAY DOWN THE HILL BEFORE STOPPING, AND CAN START FIRES BELOW YOU IN THE GREEN.			
<b>5. Site Safety Plan Required?</b> Yes <input type="checkbox"/> No <input checked="" type="checkbox"/>			
Approved Site Safety Plan(s) Located at:			
<b>6. Incident Action Plan</b> (the items checked below are included in this Incident Action Plan):			
<input checked="" type="checkbox"/> ICS 202	<input type="checkbox"/> ICS 207	Other Attachments:	
<input checked="" type="checkbox"/> ICS 203	<input type="checkbox"/> ICS 208	<input checked="" type="checkbox"/> SAFETY / 215A	
<input checked="" type="checkbox"/> ICS 204	<input checked="" type="checkbox"/> ICS 220	<input checked="" type="checkbox"/> INCIDENT WITHIN AN INCIDENT	
<input checked="" type="checkbox"/> ICS 205	<input checked="" type="checkbox"/> Map/Chart	<input checked="" type="checkbox"/> HR / TRAINING MESSAGE	
<input type="checkbox"/> ICS 205A	<input checked="" type="checkbox"/> Weather Forecast/Tides/Currents	<input checked="" type="checkbox"/> DEMOB LIST	
<input checked="" type="checkbox"/> ICS 206			
<b>7. Prepared by:</b> DAVE LATTIMORE		<b>Position/Title:</b> PSC2	<b>Signature:</b>
<b>8. Approved by Incident Commander:</b>		<b>Name:</b> DON GARWOOD	<b>Signature:</b> 
ICS 202		IAP Page	<b>Date/Time:</b> 08/12/2015 2100

## ORGANIZATION ASSIGNMENT LIST (ICS 203)

<b>1. Incident Name:</b>		<b>2. Operational Period:</b> 0600 - 0600	
GASQUET COMPLEX		Date/Time From: 08/14/2015 0600 FRI	Date/Time To: 08/15/2015 0600 SAT
<b>3. Incident Commander(s) and Command Staff:</b>		<b>7. Operations Section:</b>	
IC/UC	DON GARWOOD	OPS SECTION CHIEF	DERRICK DAVIS DARRELL MILLER
DEPUTY	DAVE KELLY	PLANNING OPS	MATTHEW CONKLIN AARON THOMPSON (T)
SAFETY OFFICER	JAMES ARAGON; P TOMPKINS; J BATES; F HERNANDEZ (T)	DIVISION/GROUP	A - COON FIRE MITCH FOWLKES DAN O'CONNOR (T)
INFORMATION OFFICER	JIM WILKINS; ROBERT POOLE ASCENSION BRIBIESCAS	DIVISION/GROUP	C - COON FIRE TODD MCDIVITT BRIAN BERRY (T)
LIAISON OFFICER	LARRY LA VOGUE 909-855-5756	DIVISION/GROUP	D - COON FIRE TRENT INGRAM KEN VAN WIG (T)
HUMAN RESOURCES	KATHY KREYNS 909-731-1771 ANDREA CABIDA (T)	DIVISION/GROUP	E - BEAR FIRE DAVID MARTINEZ JOHN OWINGS (T)
<b>4. Agency/Organization Representative(s):</b>		DIVISION/GROUP	G - BEAR FIRE ERIC PLATZ CHRIS ST. PIERRE (T)
Agency/Organization	Name	DIVISION/GROUP	H/L/N/V WILLIAMS / PEAK / SUMMIT CANDICE KUTROSKY PAUL MANDOLINI (T)
USFS	DAVE PALMER	DIVISION/GROUP	W - FEEDER FIRE GLENN WEBB AL WARD (T)
GASQUET VFD	NICK KARANPOULOS	DIVISION/GROUP	Z - FEEDER FIRE ADAM KOHLEY ROBERT ALLAN (T)
CAL OES	JOHN SALVATE	DIVISION/GROUP	CONTINGENCY JEREMY COWIE BRIAN FABBRI (T)
CAL TRANS		<b>7b. Air Operations Branch:</b>	
SRF-NFFE	ROBERTA CORAGLIOTTI 530-784-7542 JOHN MC RAE 707-845-8017	AIR OPS BRANCH DIRECTOR	TED VISSER
<b>5. Planning Section:</b>		AIR SUPPORT SUPERVISOR	GALEN YOUNG
CHIEF	DAVE LATTIMORE	AIR ATTACK SUPERVISOR	CLIFF CLARIDGE KEN MCLAUGHLIN
DEPUTY	RICH STERRY (T)	AIR TANKER COORDINATOR	
RESOURCES UNIT	KYLE HAUDUCOER, BILL KERSHAW J SCURI (T)	HELICOPTER COORDINATOR	
SITUATION UNIT	GORDON TAMPLIN(T), TIM KNORR(T)	<b>8. Finance/Administration Section:</b>	
DOCUMENTATION	VANESSA HANSON	CHIEF	DEBBIE YORK
DEMOB UNIT	JIM STITELER (T)	TIME UNIT	SHARON R MAKOSKY DEANNA THOMPSON (T)
IMET	RACHEL COBB	COMPENSATION UNIT	BETH SJOBLUM
FIRE BEHAVIOR	BYRON KIMBALL	COST UNIT	THOMAS STEELE KRIS STERBENS (T)
SOPL	BOB LINEBACK		
TRAINING SPECIALIST	ANN HUTCHINSON		
GISS	R MURILLO; A. KIRSCH; A SALDIVAR(T)		
CTSP	CHARLES VERTREES		
<b>6. Logistics Section:</b>			
CHIEF	ERIC SWEETMAN		
DEPUTY	STEVE KING (T); DAVID WHITNEY (T)		
SUPPLY UNIT	EVAN TISS		
FACILITIES UNIT	ART CURLEY; DOUG WINN(T)		
GROUND SUPT UNIT	CHRIS HALEY; RON NOORDMAN		
COMM UNIT	DAVE LARKIN; CHRIS PERRY(T)		
MEDICAL UNIT	GENA FOWLKES MATTHEW MENARD (T)		
SECURITY UNIT	HEATHER NAIGUS		
FOOD UNIT	RICHARD WAITE		
<b>9. Prepared By:</b>	Name: KYLE HAUDUCOEUR	Position/Title: RESL	Signature:
ICS 203	IAP Page	Date/Time: 08/13/2015 2100	



## INCIDENT Weather Forecast



FORECAST NO: 3

NAME OF FIRE: Gasquet Complex

PREDICTION FOR: Day Shift

SHIFT DATE: 8/14/2015

SIGNED: *Rachel Cobb*

TIME AND DATE

FORECAST ISSUED: 1900 8/13/2015

Rachel Cobb

Incident Meteorologist

---

**WEATHER DISCUSSION:** The low will continue to move north and away from the area today. Skies will remain partly cloudy, and winds will shift northwesterly and could again be gusty. Otherwise, it will likely be slightly warmer and drier. High pressure will then build over California on Saturday, bringing even warmer and drier conditions, and an offshore flow will keep skies clear. This will also lead to diminishing overnight humidity recoveries in the mountains.

---

**WEATHER FORECAST for Friday:**

**WEATHER:** Partly cloudy and smoky.

**MAXIMUM TEMPERATURES:** 70 – 75 degrees valleys...65 – 70 degrees ridges.

**MINIMUM HUMIDITY:** 34 – 43 percent.

**20 FT WINDS:**

**RIDGETOP** – Northwest 5 to 10 mph with gusts around 20 mph in the afternoon.

**SLOPE/VALLEY** – Upslope/upvalley 3 to 8 mph.

**HAINES INDEX:** 4 (low).

**STABILITY/INVERSION:** Mixing height 7000 feet msl.

---

**OUTLOOK for Friday Night:** Clearing, but smoky. Low temperatures 55 – 60 degrees and maximum relative humidity 57 – 83%. Ridgetop winds northeast 5 to 11 mph. Haines Index: 4. Thermal belt 4000 – 5000 feet msl.

---

**OUTLOOK for Saturday:** Clear, but smoky. Highs 74 – 87 degrees and relative humidity 22 – 27%. Ridgetop winds northeast 7 to 13 mph. Mixing height: 8000 feet msl. Haines Index: 4.

---

**EXTENDED FORECAST:** High pressure will be influencing the area through next week with warm and dry conditions and northerly winds.

## FIRE BEHAVIOR FORECAST

FORECAST NUMBER: #11	TYPE OF FIRE: Wildland Fire
FIRE NAME: Gasquet Complex	OPERATIONAL PERIOD: August 14, 2015
DATE ISSUED: August 13, 2015	TIME ISSUED: 2000
UNIT: Smith River NRA, Six Rivers NF	SIGNED: <i>Byron R. Kimball</i>
	Typed/printed:/s/ Byron R. Kimball FBAN

### INPUTS

**WEATHER SUMMARY:** Slightly warmer and drier. Skies remain partly cloudy. Gusty Northwest winds possible

MAX TEMPERATURE.....Valleys 70-75, Ridges 65-70.

MIN HUMIDITY.....34 - 43%

EYE LEVEL WINDS.....Upslope/upvalley 3-8, Ridges NW 5 to 10, G 20 in the afternoon

**For more specific information, please see the Spot Weather forecast**

### OUTPUTS

#### FIRE BEHAVIOR

##### GENERAL:

Warming and drying bring back proven burning conditions. Slightly increased winds may add additional energy to the mix. Expanded burn window should allow for more consumption as fuels have a longer timeframe to heat up and dry out. Spotting becomes a concern as brush understory becomes involved.

With line construction in incomplete burns, be positive that you are exposing the black edge and getting all the hot ash and embers inside your line.

##### SPECIFIC:

Timber Understory: Fire behavior in the Understory models should increase. Warmer and drier conditions will expand the burn window.

ROS: 5 to 10 ch/hr.

FL: 6 to 8 ft.

Timber Litter: Timber Litter fire behavior pick up. Lower RH and increased slope winds may increase the fire activity. Stay aware of rollout and upslope runs through incomplete burns.

ROS: 3 to 6 ch/hr.

FL: 2 to 3 ft.

Spotting becomes a concern with improved burn conditions. Know where your smoke is going and check for fallout.

#### AIR OPERATIONS:

High pressure should hold down the marine layer and improve flying conditions.

### SAFETY

Be aware of fire in the standing timber and instability of trees and snags. Ash pits and stump holes become more of an issue the longer the fire burns in the fuel bed.

## Division/Group Assignment List (ICS 204 WF)

<b>1. Incident Name:</b>		<b>3.</b>				
GASQUET COMPLEX		<b>Branch:</b>		<b>Division/Group:</b>		
<b>2. Operational Period:</b> 0600 - 0600				<b>A - COON FIRE</b>		
Date/Time From: 08/14/2015 0600      FRI	Date/Time To: 08/15/2015 0600      SAT					
<b>4. Operations Personnel</b>						
<b>OPERATIONS CHIEF</b>	DERRICK DAVIS DARRELL MILLER		<b>DIVISION/GROUP SUPERVISOR</b>	MITCH FOWLKES DAN O'CONNOR (T)		
<b>PLANNING OPS</b>	MATT CONKLIN AARON THOMPSON (T)		<b>AIR ATTACK SUPERVISOR</b>	CLIFF CLARIDGE KEN MCLAUGHLIN		
<b>5. Resources Assigned this Period</b>						
Strike Team / Task Force / Resource Designator	LWD	Leader	Number Persons	Drop Off PT./Time	Pick Up PT./Time	
HC2 STEELHEAD C-30	08/15	ALEJANDRO RODRIGUEZ	20	ICP/0630	ICP/1900	
HCM HOOPA O-275	08/24	ROCKY COLEGROVE	12	ICP/0630	ICP/1900	
TFLD VIKTORA O-80 / WHEELER O-106	08/18		1	ICP/0630	ICP/1900	
ENG6 KAIBAB 611 E-165	08/26	NICK BEHRENDIS	6	ICP/0630	ICP/1900	
ENG6 ALBANY 2180 E-79	08/21	TIM SMYSER	3	ICP/0630	ICP/1900	
TFLD PHILLIPS O-75 / KEYSE (T) O-78	08/18		2	ICP/0630	ICP/1900	
ENG3 ALBUQUERQUE E-161	08/26	BRIAN FOX	4	ICP/0630	ICP/1900	
ENG3 BERTHOUD 13 E-144	08/27	NICO ROMERO	3	ICP/0630	ICP/1900	
ENG3 LKP 5031 E-75	08/14	RICK BERGEN	3	ICP/0630	ICP/1900	
HEQB HEISEY / DOZ2 ROEN E-90	08/20		3	ICP/0630	ICP/1900	
HEQB TERRY CARRICO O-217	08/24		1	ICP/0630	ICP/1900	
SKG4 L & L EXCAVATING W/ TRSPT E-111	08/23	SHANE NODINE	2	ICP/0630	ICP/1900	
SKG3 UNDERHILL 1 W/ TRSPT E-112	08/22	JOE BRADBURY	2	ICP/0630	ICP/1900	
FAL1 NORTH ZONE FALLERS #1 O-94	08/18	ALAN STEWART	2	ICP/0630	ICP/1900	
WTS2 DUDLEY'S E-136	08/25	DON GUICE	1	ICP/0630	ICP/1900	
FEMT RANDOLPH O-133 / VANZINNI O-134	08/21		2	ICP/0630	ICP/1900	
<b>6. Control Operations/Work Assignments:</b>						
<ul style="list-style-type: none"> <li>• CONTINUE INDIRECT DOZER LINE FROM 17N07J ROAD WEST TO SOUTH FORK OF THE SMITH RIVER AND IDENTIFY SAFETY ZONES.</li> </ul>						
<b>7. Special Instructions:</b>						
<ul style="list-style-type: none"> <li>• COORDINATE AND ORDER AIRCRAFT FOR WATER AND RETARDANT NEEDS WITH AIR ATTACK.</li> </ul>						
<b>8. Division/Group Communication Summary</b>						
Function	Channel	RX Frequency N/W	RX Tone/NAC	TX Frequency N/W	TX Tone/NAC	Mode
COMMAND	1	167.1000	162.2	169.7500	162.2	A
TACTICAL	13	167.1125	162.2	167.1125	162.2	A
BACKUP NET	4	168.1250		170.4750	127.3	A
AIR TO GROUND	10	165.3875		165.3875		A
<b>9. Prepared By (Resource Unit Leader)</b>		<b>Approved By (Planning Section Chief)</b>		<b>Date</b>	<b>Time</b>	
JAKE HUGHES (T)		DAVE LATTIMORE		08/13/2015	2100	

## Division/Group Assignment List (ICS 204 WF)

<b>1. Incident Name:</b>			<b>3.</b>			
GASQUET COMPLEX			<b>Branch:</b>		<b>Division/Group:</b>	
<b>2. Operational Period:</b> 0600 - 0600					<b>C - COON FIRE</b>	
Date/Time From: 08/14/2015 0600 FRI	Date/Time To: 08/15/2015 0600 SAT					
<b>4. Operations Personnel</b>						
<b>OPERATIONS CHIEF</b>		DERRICK DAVIS DARRELL MILLER		<b>DIVISION/GROUP SUPERVISOR</b>		TODD MCDIVITT BRIAN BERRY (T)
<b>PLANNING OPS</b>		MATT CONKLIN AARON THOMPSON (T)		<b>AIR ATTACK SUPERVISOR</b>		CLIFF CLARIDGE KEN MCLAUGHLIN
<b>5. Resources Assigned this Period</b>						
Strike Team / Task Force / Resource Designator		LWD	Leader	Number Persons	Drop Off PT./Time	Pick Up PT./Time
HCM BEAR PEAK O-59		08/23	FRED FLEISCHMAN	9	ICP/0630	ICP/1900
ES3 2141C E-122		08/20	PETE DAVIS	21	ICP/0630	ICP/1900
ENG3 SANTA CLARA VFD 33 E-29		08/19	TYREL HANSEN	4	ICP/0630	ICP/1900
ENG3 SRF 11 E-189		08/24	JOE ENIEM	5	ICP/0630	ICP/1900
HEQB RICH WATERS O-85		08/18		1	ICP/0630	ICP/1900
DOZ2 BROWNING E-44		08/20	PAT BROWNING	1	ICP/0630	ICP/1900
DOZ2 WARNER E-43		08/18	DAN WARNER	3	ICP/0630	ICP/1900
WTT2 WOOD'S 99 E-87		08/15	STEVE WENDT	2	ICP/0630	ICP/1900
WTS2 ALL AGENCY E-38		08/18	JOHN HILL	1	ICP/0630	ICP/1900
WTS2 SIERRA TIMBER E-42		08/19	DOUG LINGEN	1	ICP/0630	ICP/1900
WTS2 WILLS E-138		08/25	PHIL WILLS	1	ICP/0630	ICP/1900
SOFR SCHNEIDER (T) O-90 / BERG (T) O-146		08/20		2	ICP/0630	ICP/1900
FEMP CRADDOCK O-240 / FEMT PESHKIN O-241		08/25		2	ICP/0630	ICP/1900
<b>6. Control Operations/Work Assignments:</b>						
<ul style="list-style-type: none"> <li>IMPROVE HANDLINE FROM DOZER LINE TO COON CREEK SCOUT FOR SECONDARY CONTINGENCY LINE.</li> <li>SECURE ALL FIRE WEST OF THE 17N07G ROAD FROM DP 20 TO COON CREEK.</li> </ul>						
<b>7. Special Instructions:</b>						
<ul style="list-style-type: none"> <li>COORDINATE AND ORDER AIRCRAFT FOR RETARDANT NEEDS WITH AIR ATTACK.</li> <li>FOBS PIPPIN / HAMER (T) WORKING IN DIV A AND DIV C.</li> </ul>						
<b>8. Division/Group Communication Summary</b>						
Function	Channel	RX Frequency N/W	RX Tone/NAC	TX Frequency N/W	TX Tone/NAC	Mode
COMMAND	1	167.1000	162.2	169.7500	162.2	A
TACTICAL	5	166.7250	162.2	166.7250	162.2	A
BACKUP NET	4	168.1250		170.4750	127.3	A
AIR TO GROUND	10	165.3875		165.3875		A
<b>9. Prepared By (Resource Unit Leader)</b>			<b>Approved By (Planning Section Chief)</b>		<b>Date</b>	<b>Time</b>
JACOB HUGHES (T)			DAVE LATTIMORE		08/13/2015	2100

## Division/Group Assignment List (ICS 204 WF)

<b>1. Incident Name:</b>			<b>3.</b>			
GASQUET COMPLEX			<b>Branch:</b>		<b>Division/Group:</b>	
<b>2. Operational Period:</b> 0600 - 0600					<b>D - COON FIRE</b>	
Date/Time From: 08/14/2015 0600 FRI			Date/Time To: 08/15/2015 0600 SAT			
<b>4. Operations Personnel</b>						
<b>OPERATIONS CHIEF</b>		DERRICK DAVIS DARRELL MILLER		<b>DIVISION/GROUP SUPERVISOR</b>		TRENT INGRAM KEN VAN WIG (T)
<b>PLANNING OPS</b>		MATT CONKLIN AARON THOMPSON (T)		<b>AIR ATTACK SUPERVISOR</b>		CLIFF CLARIDGE KEN MCLAUGHLIN
<b>5. Resources Assigned this Period</b>						
Strike Team / Task Force / Resource Designator		LWD	Leader	Number Persons	Drop Off PT./Time	Pick Up PT./Time
ENG6 PATRICK 14 E-117		08/14	JOEL DICE	3	ICP /0630	ICP/1900
ENG6 DARE ENTERPRISES 32 E-118		08/14	RICO SCHRAFF	3	ICP /0630	ICP/1900
ENG6 ASI 3 E-115		08/15	MICHAEL HOLLOWAY	3	ICP /0630	ICP/1900
ENG6 BOHICA 61 E-168		08/26	DAVE CAMPBELL	3	ICP /0630	ICP/1900
ENG6 ENG 705 E-162		08/27	MANUEL WESAW	4	ICP /0630	ICP/1900
HEQB JON MCCLELLAN O-216		08/24		1	ICP /0630	ICP/1900
MAST JR-3 E-55		08/27	RICK ESTEY	2	ICP /0630	ICP/1900
MAST JR-4 E-54		08/27	HARVEY MOON	2	ICP /0630	ICP/1900
<b>6. Control Operations/Work Assignments:</b>						
<ul style="list-style-type: none"> <li>• COMPLETE STRUCTURE PREP OF TOLLEFSON PROPERTY.</li> <li>• INITIATE SHADED FUEL BREAK ALONG 16N19 RD, PER DISTRICT FUEL SPECIALIST SPECS.</li> </ul>						
<b>7. Special Instructions:</b>						
<ul style="list-style-type: none"> <li>• COORDINATE AND ORDER AIRCRAFT FOR RETARDANT NEEDS WITH AIR ATTACK.</li> </ul>						
<b>8. Division/Group Communication Summary</b>						
Function	Channel	RX Frequency N/W	RX Tone/NAC	TX Frequency N/W	TX Tone/NAC	Mode
COMMAND	1	167.1000	162.2	169.7500	162.2	A
TACTICAL	14	168.2375	162.2	168.2375	162.2	A
BACKUP NET	4	168.1250		170.4750	127.3	A
AIR TO GROUND	10	165.3875		165.3875		A
<b>9. Prepared By (Resource Unit Leader)</b>			<b>Approved By (Planning Section Chief)</b>		<b>Date</b>	<b>Time</b>
JOE SCURI (T)			DAVE LATTIMORE		08/13/2015	2100



## Division/Group Assignment List (ICS 204 WF)

<b>1. Incident Name:</b>			<b>3.</b>			
GASQUET COMPLEX			<b>Branch:</b>		<b>Division/Group:</b>	
<b>2. Operational Period:</b> 0600 - 0600					<b>E - BEAR FIRE</b>	
Date/Time From: 08/14/2015 0600 FRI		Date/Time To: 08/15/2015 0600 SAT				
<b>4. Operations Personnel</b>						
<b>OPERATIONS CHIEF</b>		DERRICK DAVIS DARRELL MILLER		<b>DIVISION/GROUP SUPERVISOR</b>		DAVID MARTINEZ JOHN OWINGS (T)
<b>PLANNING OPS</b>		MATT CONKLIN AARON THOMPSON (T)		<b>AIR ATTACK SUPERVISOR</b>		CLIFF CLARIDGE KEN MCLAUGHLIN
<b>5. Resources Assigned this Period</b>						
Strike Team / Task Force / Resource Designator		LWD	Leader	Number Persons	Drop Off PT./Time	Pick Up PT./Time
HC2I GRAYBACK 8B C-5		08/13	TIM NYGREN	20	ICP/0630	ICP/1900
HC2 FORT APACHE 3 C-10		08/20	BURNETTE BENNETT	20	ICP/0630	ICP/1900
TFLD T ERICKSON O-232 / N BALENT (T) O-209		08/23		1	ICP/0630	ICP/1900
ENG3 UTAH COUNTY 12 E-31		08/19	ANDREW WATSON	4	ICP/0630	ICP/1900
ENG6 NV-WID 2616 E-35		08/19	CHAD NIBLETT	3	ICP/0630	ICP/1900
ENG6 WEBER FIRE 661 E-33		08/19	SCOTT HANEY	3	ICP/0630	ICP/1900
ENG6 GREAT BASIN 311 E-34		08/19	TYLER ERSKINE	3	ICP/0630	ICP/1900
ENG3 HOOPA 9531 E-175		08/26		5	ICP/0630	ICP/1900
HEQB TIMOTHY LANTERMAN O-83		08/21		1	ICP/0630	ICP/1900
DOZ2 PLUMAS 1 / DOZ2 FISKS TREE		08/24	JAMES SMITH	4	ICP/0630	ICP/1900
SKG2 YOUNG LOGGING E-154		08/27	PAUL ARBOGAST	2	ICP/0630	ICP/1900
WTS2 YREKA OUTLANDS E-19		08/18	ALLEN WILLIAMS	2	ICP/0630	ICP/1900
WTS1 V&P E-139		08/25		1	ICP/0630	ICP/1900
FEMP FELDMAN O-135 / FEMT WICKLAS O-132		08/20		2	ICP/0630	ICP/1900
<b>6. Control Operations/Work Assignments:</b>						
<ul style="list-style-type: none"> <li>• CONTINUE TO HOLD AND IMPROVE LINE ALONG THE 17N03 ROAD. • CONTINUE DOZER LINE FROM 17N05 DOWN 17N35 RIDGE.</li> <li>• CONTINUE PREP FROM DP10 TO 17N04 RD. • IMPROVE ANCHOR POINT AND SECURE HANDLINE CONSTRUCTION ON WEST FLANK.</li> </ul>						
<b>7. Special Instructions:</b>						
<ul style="list-style-type: none"> <li>• COORDINATE AND ORDER AIRCRAFT FOR RETARDANT NEEDS WITH AIR ATTACK.</li> </ul>						
<b>8. Division/Group Communication Summary</b>						
Function	Channel	RX Frequency N/W	RX Tone/NAC	TX Frequency N/W	TX Tone/NAC	Mode
COMMAND	1	167.1000	162.2	169.7500	162.2	A
TACTICAL	6	166.7750	162.2	166.7750	162.2	A
BACKUP NET	4	168.1250		170.4750	127.3	A
AIR TO GROUND	10	165.3875		165.3875		A
<b>9. Prepared By (Resource Unit Leader)</b>			<b>Approved By (Planning Section Chief)</b>		<b>Date</b>	<b>Time</b>
JOE SCURI (T)			DAVE LATTIMORE		08/13/2015	2100

## Division/Group Assignment List (ICS 204 WF)

<b>1. Incident Name:</b>				<b>3.</b>			
GASQUET COMPLEX				Branch:		Division/Group:	
<b>2. Operational Period:</b> 0600 - 0600						<b>G - BEAR FIRE</b>	
Date/Time From: 08/14/2015 0600 FRI		Date/Time To: 08/15/2015 0600 SAT					
<b>4. Operations Personnel</b>							
<b>OPERATIONS CHIEF</b>		DERRICK DAVIS DARRELL MILLER		<b>DIVISION/GROUP SUPERVISOR</b>		ERIC PLATZ CHRIS ST PIERRE (T)	
<b>PLANNING OPS</b>		MATT CONKLIN AARON THOMPSON (T)		<b>AIR ATTACK SUPERVISOR</b>		CLIFF CLARIDGE KEN MCLAUGHLIN	
<b>5. Resources Assigned this Period</b>							
Strike Team / Task Force / Resource Designator		LWD	Leader	Number Persons	Drop Off PT./Time	Pick Up PT./Time	
HC2 FORT APACHE 4 C-11		08/20	DANNY EDWARDS	19	ICP/0630	ICP/1900	
TFLD JOEL PETERS O-226		08/23		1	ICP/0630	ICP/1900	
SKG3 CLEARWATER FIRE E-155		08/26	ED URICK	1	ICP/0630	ICP/1900	
ENG6 BOULDER MOUNTAIN 4333 E-152		08/26	MIKE SEBASTIAN PALAMARA	3	ICP/0630	ICP/1900	
ENG6 A BAR S 613 E-166		08/26	MATT BUSTAMANTE	4	ICP/0630	ICP/1900	
FELB CHRIS HENRIE O-181		08/24		1	ICP/0630	ICP/1900	
FAL1 NORTH ZONE FALLERS #2 O-95		08/18	BILLY BELMONT	2	ICP/0630	ICP/1900	
FAL1 NORTH ZONE FALLERS #4 O-97		08/18	BILL MEADOWS	2	ICP/0630	ICP/1900	
FAL1 MCKELLER TREE O-202		08/22	DOUG MCKELLAR	2	ICP/0630	ICP/1900	
SOFR BRAD LIDELL O-252		08/25		1	ICP/0630	ICP/1900	
<b>6. Control Operations/Work Assignments:</b>							
<ul style="list-style-type: none"> <li>SCOUT FOR OPPORTUNITIES FOR DIRECT LINE CONSTRUCTION.</li> <li>CONTINUE LINE PREP FROM BEAR BASIN LOOKOUT DOWN THE SHIP MT RD TO THE WILDERNESS BOUNDARY.</li> </ul>							
<b>7. Special Instructions:</b>							
<ul style="list-style-type: none"> <li>COORDINATE AND ORDER AIRCRAFT FOR <b>WATER ONLY</b> DROPS WITH AIR ATTACK.</li> <li>FOBS SCHEID / BAERTSCHI (T) WORKING IN DIV E AND DIV G.</li> </ul>							
<b>8. Division/Group Communication Summary</b>							
Function	Channel	RX Frequency N/W	RX Tone/NAC	TX Frequency N/W	TX Tone/NAC	Mode	
COMMAND	1	167.1000	162.2	169.7500	162.2	A	
TACTICAL	7	168.2500	162.2	168.2500	162.2	A	
BACKUP NET	4	168.1250		170.4750	127.3	A	
AIR TO GROUND	10	165.3875		165.3875		A	
<b>9. Prepared By (Resource Unit Leader)</b>			<b>Approved By (Planning Section Chief)</b>			<b>Date</b>	<b>Time</b>
KYLE HAUDUCOEUR			DAVE LATTIMORE			08/13/2015	2100

### Division/Group Assignment List (ICS 204 WF)

<b>1. Incident Name:</b>			<b>3.</b>			
GASQUET COMPLEX			Branch:	Division/Group:  <b>H/L/N/V - PEAK FIRE</b>		
<b>2. Operational Period: 0600 - 0600</b>						
Date/Time From: 08/14/2015 0600      FRI	Date/Time To: 08/15/2015 0600      SAT					
<b>4. Operations Personnel</b>						
<b>OPERATIONS CHIEF</b>	DERRICK DAVIS DARRELL MILLER		<b>DIVISION/GROUP SUPERVISOR</b>	CANDICE KUTROSKY PAUL MANDOLINI (T)		
<b>PLANNING OPS</b>	MATT CONKLIN AARON THOMPSON (T)		<b>AIR ATTACK SUPERVISOR</b>	CLIFF CLARIDGE KEN MCLAUGHLIN		
<b>5. Resources Assigned this Period</b>						
Strike Team / Task Force / Resource Designator	LWD	Leader	Number Persons	Drop Off PT./Time	Pick Up PT./Time	
TFLD GREGORY COX O-74	08/18		1	ICP/0630	ICP/1900	
TFLD DALE NEWBY (T) O-73	08/18		1	ICP/0630	ICP/1900	
ENG3 TRI CITY 106 E-25	08/19	ANTHONY GRAINGER	4	ICP/0630	ICP/1900	
ENG3 MONTANA FIRE 341 E-30	08/20	MIKE WARREN	3	ICP/0630	ICP/1900	
ENG4 FIRESTORM 03 E-114	08/14	BRAD CLEMENS	3	ICP/0630	ICP/1900	
ENG4 CENTRAL WILDFIRE 741 E-116	08/14	DAVID PARSON	3	ICP/0630	ICP/1900	
ENG6 SANTA CLARA 32 E-37	08/19	GABE RUNOLFSON	2	ICP/0630	ICP/1900	
ENG6 TIMBERLINE E-147	08/27	DAVID BREGLIA	3	ICP/0630	ICP/1900	
ENG6 FLAGSTAFF 16 E-167	08/16	KATIE BROWN	3	ICP/0630	ICP/1900	
WTS2 ROGER CHERRY E-140	08/25	ROGER CHERRY	1	ICP/0630	ICP/1900	
FAL1 BROWN O-201	08/21	DUSTIN BROWN	2	ICP/0630	ICP/1900	
----CONTINUED ON PG 2----						
<b>8. Division/Group Communication Summary</b>						
Function	Channel	RX Frequency N/W	RX Tone/NAC	TX Frequency N/W	TX Tone/NAC	Mode
COMMAND	1	167.1000	162.2	169.7500	162.2	A
TACTICAL	8	168.0500	162.2	168.0500	162.2	A
BACKUP NET	4	168.1250		170.4750	127.3	A
AIR TO GROUND	10	165.3875		165.3875		A
<b>9. Prepared By (Resource Unit Leader)</b>		<b>Approved By (Planning Section Chief)</b>		<b>Date</b>		<b>Time</b>
JACOB HUGHES		DAVE LATTIMORE		08/13/2015		2100

## Division/Group Assignment List (ICS 204 WF)

<b>1. Incident Name:</b>			<b>3.</b>			
GASQUET COMPLEX			<b>Branch:</b>		<b>Division/Group:</b>	
<b>2. Operational Period:</b> 0600 - 0600					<b>H/L/N/V - PEAK FIRE</b>	
Date/Time From: 08/14/2015 0600 FRI			Date/Time To: 08/15/2015 0600 SAT			
<b>4. Operations Personnel</b>						
<b>OPERATIONS CHIEF</b>		DERRICK DAVIS DARRELL MILLER		<b>DIVISION/GROUP SUPERVISOR</b>		CANDICE KUTROSKY PAUL MANDOLINI (T)
<b>PLANNING OPS</b>		MATT CONKLIN AARON THOMPSON (T)		<b>AIR ATTACK SUPERVISOR</b>		CLIFF CLARIDGE KEN MCLAUGHLIN
<b>5. Resources Assigned this Period</b>						
Strike Team / Task Force / Resource Designator		LWD	Leader	Number Persons	Drop Off PT./Time	Pick Up PT./Time
TFLD STEVE SISCOE O-79		08/20		1	ICP/0630	ICP/1900
ENG3 SRM 331 E-76		08/14	MIKE AVERY	4	ICP/0630	ICP/1900
ENG3 CRK 379 E-77		08/14	JOHN ANGELL	4	ICP/0630	ICP/1900
ENG3 PICTURE ROCK 121 E-26		08/20	ROCKY ORTIZ	4	ICP/0630	ICP/1900
ENG6 GRAND JUNCTION BR 3 E-151				3	ICP/0630	ICP/1900
ENG6 MONTROSE HELL FIGHTERS E-148		08/26	JASON HOBBY	3	ICP/0630	ICP/1900
ENG3 HOOPA 9533 E-174		08/27	AARON WILLIAMS	1	ICP/0630	ICP/1900
ENG6 LAKE DILLON 8 E-150		08/26	DENNIS JACKSON		ICP/0630	ICP/1900
FAL1 MILLER TIMBER O-204		08/22	CHRIS GOODSON	2	ICP/0630	ICP/1900
WTS2 TRAYNHAM TRUCKING E-137		08/25	DAVE DAMON	1	ICP/0630	ICP/1900
FEMP MATT LUCAS O-137		08/20		1	ICP/0630	ICP/1900
FEMT TONY CASTANEDA O-131		08/20		1	ICP/0630	ICP/1900
<b>6. Control Operations/Work Assignments:</b>						
<ul style="list-style-type: none"> <li>• KEEP FIRE NORTH AND EAST OF G-O ROAD IF POSSIBLE. . • FOLLOW THE MINIMUM REQUIREMENT DIRECTION OF 8-11-15.</li> </ul>						
<b>7. Special Instructions:</b>						
<ul style="list-style-type: none"> <li>• ALL RESOURCES USE CALL SIGN "LIMA"</li> <li>• COORDINATE AND ORDER AIRCRAFT FOR <b>WATER ONLY</b> DROPS WITH AIR ATTACK.</li> <li>• MONITOR SUMMIT &amp; WILLIAMS FIRES BY AIR</li> <li>• RAPID EXTRACTION MODULE (R.E.M.) AVAILABLE TO ALL DIV'S &amp; GRP'S.</li> </ul>						
<b>8. Division/Group Communication Summary</b>						
Function	Channel	RX Frequency N/W	RX Tone/NAC	TX Frequency N/W	TX Tone/NAC	Mode
COMMAND	1	167.1000	162.2	169.7500	162.2	A
TACTICAL	8	168.0500	162.2	168.0500	162.2	A
BACKUP NET	4	168.1250		170.4750	127.3	A
AIR TO GROUND	10	165.3875		165.3875		A
<b>9. Prepared By (Resource Unit Leader)</b>			<b>Approved By (Planning Section Chief)</b>		<b>Date</b>	<b>Time</b>
JACOB HUGHES			DAVE LATTIMORE		08/13/2015	2100

## Division/Group Assignment List (ICS 204 WF)

<b>1. Incident Name:</b>			<b>3.</b>			
GASQUET COMPLEX			<b>Branch:</b>		<b>Division/Group:</b>	
<b>2. Operational Period:</b> 0600 - 0600					<b>W - FEEDER FIRE</b>	
Date/Time From: 08/14/2015 0600      FRI	Date/Time To: 08/15/2015 0600      SAT					
<b>4. Operations Personnel</b>						
<b>OPERATIONS CHIEF</b>		DERRICK DAVIS DARRELL MILLER		<b>DIVISION/GROUP SUPERVISOR</b>		GLENN WEBB AL WARD (T)
<b>PLANNING OPS</b>		MATT CONKLIN AARON THOMPSON (T)		<b>AIR ATTACK SUPERVISOR</b>		CLIFF CLARIDGE KEN MCLAUGHLIN
<b>5. Resources Assigned this Period</b>						
Strike Team / Task Force / Resource Designator		LWD	Leader	Number Persons	Drop Off PT./Time	Pick Up PT./Time
HC2I WHITE MOUNTAIN #1 C-3		08/19	KEITH M SARGENT	19	ICP/0630	ICP/1900
TFLD HYATT O-144 / OLEARY O-234		08/16		2	ICP/0630	ICP/1900
ENG2 GASQUET 214 E-78		08/14	TOM ZURFLUEH	4	ICP/0630	ICP/1900
ENG4 WEBER FIRE DISTRICT 464 E-80		08/14	BARRY LOCKE	4	ICP/0630	ICP/1900
ENG6 TONTO 1247 E-82		08/16	SHAWN O'CONNELL	7	ICP/0630	ICP/1900
ENG6 AMERICAN FIRE CO 61 E-86		08/14	MATT MORRELL	3	ICP/0630	ICP/1900
ENG6 AMERICAN FIRE CO 62 E-85		08/14	MANI MORRELL	3	ICP/0630	ICP/1900
ENG6 LYONS 4031 E-159		08/27	NICOLE PALESTRO	3	ICP/0630	ICP/1900
HEQB HARRIS O-218 / ALLEN III (T) O-260		08/25		3	ICP/0630	ICP/1900
DOZ2 A TEAM 1 E-127		08/24	PETE GIRARONO	4	ICP/0630	ICP/1900
EXCA WALBERG, INC E-57		08/24	DAVE MCDONALD	2	ICP/0630	ICP/1900
WTT2 SRF 15 E-45		08/16	JACOB MC ADAMS	2	ICP/0630	ICP/1900
WTT2 GASQUET VFD E-88		08/15	SALENA COX	2	ICP/0630	ICP/1900
FAL1 NORTH ZONE FALLERS #3 O-96		08/18	RICK MEE	2	ICP/0630	ICP/1900
<b>6. Control Operations/Work Assignments:</b>						
<ul style="list-style-type: none"> <li>• CONTINUE TO PREP, SECURE &amp; HOLD FIRE ALONG 14N39 RD FROM DP 30 NORTH TO THE 14N39G RD.</li> </ul>						
<b>7. Special Instructions:</b>						
<ul style="list-style-type: none"> <li>• COORDINATE AND ORDER AIRCRAFT FOR RETARDANT NEEDS WITH AIR ATTACK.</li> <li>• RAPID EXTRACTION MODULE (R.E.M.) AVAILABLE TO ALL DIVISIONS AND CONTINGENCY GROUP</li> </ul>						
<b>8. Division/Group Communication Summary</b>						
Function	Channel	RX Frequency N/W	RX Tone/NAC	TX Frequency N/W	TX Tone/NAC	Mode
COMMAND	1	167.1000	162.2	169.7500	162.2	A
TACTICAL	12	166.5500	162.2	166.5500	162.2	A
BACKUP NET	4	168.1250		170.4750	127.3	A
AIR TO GROUND	10	165.3875		165.3875		A
<b>9. Prepared By (Resource Unit Leader)</b>			<b>Approved By (Planning Section Chief)</b>		<b>Date</b>	<b>Time</b>
JOE SCURI (T)			DAVE LATTIMORE		08/13/2015	2100

## Division/Group Assignment List (ICS 204 WF)

<b>1. Incident Name:</b>			<b>3.</b>			
GASQUET COMPLEX			<b>Branch:</b>		<b>Division/Group:</b>	
<b>2. Operational Period:</b> 0600 - 0600					<b>Z - FEEDER FIRE</b>	
Date/Time From: 08/14/2015 0600 FRI	Date/Time To: 08/15/2015 0600 SAT					
<b>4. Operations Personnel</b>						
<b>OPERATIONS CHIEF</b>		DERRICK DAVIS DARRELL MILLER		<b>DIVISION/GROUP SUPERVISOR</b>		ADAM KOHLEY ROBERT ALLAN (T)
<b>PLANNING OPS</b>		MATT CONKLIN AARON THOMPSON (T)		<b>AIR ATTACK SUPERVISOR</b>		CLIFF CLARIDGE KEN MCLAUGHLIN
<b>5. Resources Assigned this Period</b>						
Strike Team / Task Force / Resource Designator		LWD	Leader	Number Persons	Drop Off PT./Time	Pick Up PT./Time
HC1 SMITH RIVER C-29		08/23	TIM MEMMER	19	ICP/0630	ICP/1900
HC2I NHS#1 C-4		08/19	JOHN ROSS	20	ICP/0630	ICP/1900
HCM SLATE MOUNTAIN O-245		08/26	STEVE REYES	10	ICP/0630	ICP/1900
TFLD CATHLEEN LOWE O-76		08/19		1	ICP/0630	ICP/1900
ENG3 LONE PEAK 1667 E-27		08/19	TOM WILSON	7	ICP/0630	ICP/1900
ENG3 BLACK HILLS 381 E-146		08/26	BRANDON SELK	5	ICP/0630	ICP/1900
ENG6 GRAND COUNTY 6802 E-36		08/19	MARK MARCUM	2	ICP/0630	ICP/1900
ENG6 SUNDANCE BR3 E-169		08/25	DANA LAW	3	ICP/0630	ICP/1900
HEQB ANDERSON O-215 / DOZ2 JA COOK E-170		08/24		3	ICP/0630	ICP/1900
WTS2 BOWNE WATER SERVICE E-40		08/17	MICHAEL BOONE	1	ICP/0630	ICP/1900
FAL1 CECIL LOGGING O-203		08/22	MICHEAL BERRY	2	ICP/0630	ICP/1900
SOFR PETE VILLA O-68		08/19		1	ICP/0630	ICP/1900
<b>6. Control Operations/Work Assignments:</b>						
<ul style="list-style-type: none"> <li>CONTINUE DOZER / HANDLINE FROM G-O ROAD TO W / Z BREAK.</li> <li>CONTINUE LINE CONSTRUCTION FROM MOST SOUTHERN POINT OF FEEDER FIRE SOUTH TO THE G-O RD.</li> </ul>						
<b>7. Special Instructions:</b>						
<ul style="list-style-type: none"> <li>COORDINATE AND ORDER AIRCRAFT FOR RETARDANT NEEDS WITH AIR ATTACK.</li> <li>RAPID EXTRACTION MODULE (R.E.M.) AVAILABLE TO ALL DIVISIONS AND CONTINGENCY GROUP.</li> </ul>						
<b>8. Division/Group Communication Summary</b>						
Function	Channel	RX Frequency N/W	RX Tone/NAC	TX Frequency N/W	TX Tone/NAC	Mode
COMMAND	1	167.1000	162.2	169.7500	162.2	A
TACTICAL	9	168.6000	162.2	168.6000	162.2	A
BACKUP NET	4	168.1250		170.4750	127.3	A
AIR TO GROUND	10	165.3875		165.3875		A
<b>9. Prepared By (Resource Unit Leader)</b>			<b>Approved By (Planning Section Chief)</b>		<b>Date</b>	<b>Time</b>
JOE SCURI (T)			DAVE LATTIMORE		08/13/2015	2100

## Division/Group Assignment List (ICS 204 WF)

<b>1. Incident Name:</b>			<b>3.</b>			
GASQUET COMPLEX			<b>Branch:</b>		<b>Division/Group:</b>  <b>CONTENGENCY GROUP</b>	
<b>2. Operational Period:</b> <b>0600 - 0600</b>						
Date/Time From: 08/14/2015 0600          FRI	Date/Time To: 08/15/2015 0600          SAT					
<b>4. Operations Personnel</b>						
<b>OPERATIONS CHIEF</b>	DERRICK DAVIS DARRELL MILLER	<b>DIVISION/GROUP SUPERVISOR</b>	JEREMY COWIE BRIAN FABBRI (T)			
<b>PLANNING OPS</b>	MATT CONKLIN AARON THOMPSON (T)	<b>AIR ATTACK SUPERVISOR</b>	CLIFF CLARIDGE KEN MCLAUGHLIN			
<b>5. Resources Assigned this Period</b>						
Strike Team / Task Force / Resource Designator	LWD	Leader	Number Persons	Drop Off PT./Time	Pick Up PT./Time	
TFLD JON OLSEN O-233	08/24		1	ICP/0630	ICP/1900	
CHIP CECIL 1 E-130	08/25	JUSTIN CECIL	2	ICP/0630	ICP/1900	
CHIP COASTAL TREE SERVICE E-131	08/24	JOHN DILLON	2	ICP/0630	ICP/1900	
ENG3 PASO 3110 E-160	08/26	DAVID JR YOWELL	3	ICP/0630	ICP/1900	
ENG6 NATIONAL 204 E-149	08/26	LEENKUN BACA	3	ICP/0630	ICP/1900	
<b>6. Control Operations/Work Assignments:</b>						
<ul style="list-style-type: none"> <li>COORDINATE WITH SOPL TO VALIDATE LONG TERM PLANS.</li> <li>COORDINATE CHIPPING ACTIVITIES WITH ALL DIVISIONS.</li> </ul>						
<b>7. Special Instructions:</b>						
<ul style="list-style-type: none"> <li>RAPID EXTRACTION MODULE (R.E.M.) AVAILABLE TO ALL DIVISIONS AND CONTINGENCY GROUP</li> <li>REVIEW CHIPPER JHA.</li> <li>FOBS - PENNY / MASTERS / RICK.</li> </ul>						
<b>8. Division/Group Communication Summary</b>						
Function	Channel	RX Frequency N/W	RX Tone/NAC	TX Frequency N/W	TX Tone/NAC	Mode
COMMAND		SEE COMM PLAN				
TACTICAL						
BACKUP NET						
AIR TO GROUND						
<b>9. Prepared By (Resource Unit Leader)</b>			<b>Approved By (Planning Section Chief)</b>		<b>Date</b>	<b>Time</b>
JOE SCURI (T)			DAVE LATTIMORE		08/13/2015	2100

## INCIDENT RADIO COMMUNICATIONS PLAN (ICS 205)

<b>1. Incident Name:</b> GASQUET COMPLEX	<b>2. Date/Time Prepared:</b> Date: 08/13/2015 Time: 2100	<b>3. Operational Period:</b> 0600 - 0600 Date/Time From: 08/14/2015 0600 Date/Time To: 08/15/2015 0600 FRI SAT
---	---	--

**4. Basic Radio Channel Use:**

Zone Group	Ch #	Function	Channel Name/Trunked Radio System Talkgroup	Assignment	RX Freq	RX Tone/NAC	TX Freq	TX Tone/NAC	Mode (A,D, or M)	Remarks
	1	COMMAND	CMD 1	ALL DIVISIONS	167.1000	162.2	169.7500	162.2	A	SHIP MTN
	2	COMMAND	CMD 2	UNASSIGNED	000.0000		000.0000		A	
	3	COMMAND	CMD 3	UNASSIGNED	000.0000		000.0000		A	
	4	BACKUP NET	SRF ADM	ALL DIVISIONS	168.1250		170.4750	127.3	A	GORDON MTN
	5	TACTICAL	NIFC T5	DIV C	166.7250	162.2	166.7250	162.2	A	
	6	TACTICAL	NIFC T6	DIV E	166.7750	162.2	166.7750	162.2	A	
	7	TACTICAL	NIFC T7	DIV G	168.2500	162.2	168.2500	162.2	A	
	8	TACTICAL	NIFC T1	DIV H/I/L/NV	168.0500	162.2	168.0500	162.2	A	CALL SIGN DIV L
	9	TACTICAL	NIFC T3	DIV Z	168.6000	162.2	168.6000	162.2	A	
	10	AIR TO GROUND	A/G TAC	ALL DIVISIONS	165.3875		165.3875		A	
	11	AIR TO GROUND	A/G CMD	UNASSIGNED	000.0000		000.0000		A	
	12	TACTICAL	R5 TAC 4	DIV W	166.5500	162.2	166.5500	162.2	A	
	13	TACTICAL	R5 TAC 5	DIV A	167.1125	162.2	167.1125	162.2	A	
	14	TACTICAL	R5 TAC 6	DIV D	168.2375	162.2	168.2375	162.2	A	
	15	EMS TAC	CALCORD	ALL DIVISIONS	156.0750		156.0750	156.7	A	MEDICAL A/G
	16	AIR GUARD	GUARD	ALL DIVISIONS	168.6250		168.6250	110.9	A	EMERGENCY ONLY
	20	AIR GUARD	GUARD	ALL DIVISIONS	168.6250		168.6250	110.9	A	EMERGENCY ONLY

<b>6. Prepared By</b> (Communications Unit Leader)	Name: CHRIS PERRY (T)
Signature:	

ICS 205	IAP Page	Date/Time: 08/13/2015 2100
---------	----------	----------------------------

DRAFT



1. INCIDENT NAME: Gasquet Complex      2. OPERATIONAL PERIOD DATE: 08/14/15      START TIME: 0700      END TIME: 2000      SUNRISE: 0622      SUNSET: 2019

3. REMARKS (Safety Notes, Hazards, Air Operations Special Equipment, etc.)  
 Thunderstorms, erratic winds. Low wires, cables, power lines.  
 Divisions, contact Helibase for all aviation needs, include coordinates of possible helispot/unimproved landing locations.  
 Possible smoke concerns.  
 Track all retardant usage and location if used.  
 Do not dip from lakes near 41 35.000 x 123 43.00  
 IP for Air Tankers 41 47.21 X 123 04.40 5000'  
 Cave HB Gate 10155#  
 Six Rivers Disp. Air Desk 707-726-1266

4. MEDEVAC  
 A/C: 512

5. TFR: 5/0539  
 Radius: 10 NM  
 Altitude: 9000 MSL  
 Centerpoint: N 41 41.57  
 W 123 49.05  
 Freq: 128.0750  
 Illinois Valley Tower Freq: 133.275

6. PERSONNEL	Phone	7. FREQUENCIES	AMI	FMI	8. FIXED-WING	# Avail / Type/ Make-Model / FAA # / Base(s)
AOBD: Ted Visser	619-981-2409	AIR/AIR FW:		166.4500	Airtankers:	Available through Dispatch SEAT 818, SEAT 886
ASGS: Galen Young	575-574-8720	AIR/AIR RW:	128.0750		Leadplanes:	Available through Dispatch
ATGS: Ken McLaughlan	813-997-0317	AIR/GROUND CMD: AIR/GROUND TAC:		165.3875	ATBase:	
ATGS: Cliff Claridge	480-688-5330	COMMAND: RX: TX:		167.1000 169.7500 Tone 15 162.2	ATGS Aircraft:	N 4579N, A-6 Claridge N 285 , A-65 McLaughlan
HEB1: Melvin Tate	850-849-0405				AAB:	MRB: ICL, Joe Hart, 208-699-1166 A-26
HEB1(T): Rita Clipperton	530-559-0905	DECK:		163.100	Gary Smith S-31,32,33 Uni Engine 530-598-1434	Cave- HOS Trlr., E-2, Chris Long, 208-539-7108 Cave- 49er WT, E-41 Bobby Alvarez, 619-300-0801 Cave Helibase 541-592-2852, FAX 541-592-3798
SEAT:		AIR GUARD:		168.6250		

9. HELICOPTERS (Use Additional Sheets As Necessary)

FAA #	TY	MAKE/MODEL	BASE	AVAILABLE	START	REMARKS	FAA #	TY	MAKE/MODEL	BASE	AVAILABLE	START	REMARKS
HT-702	1	S-61	Cave	0730	0830	A-20							
HT-782	1	S-64	Cave	0730	0830	A-62							
512	2	Bell 212	Cave	0730	0830	A-42							
517	2	Bell 205	Cave	UAV	UAV	A-57 Restricted							
988B	3	Bell L4	Cave	0730	0830	A-28							

10. TASK/MISSION/ASSIGNMENT (Type/Function includes: Air Tactical, Retardant, Recon, Personnel Transport, Water Dropping, S&R, etc.)

TYPE/FUNCTION	NAME OF PERSONNEL OR CARGO (if applic) OR INSTRUCTIONS FOR TACTICAL AIRCRAFT	MISSION START	FLY FROM	FLY TO
Bucket drops per request	Division Sup. To request and coordinate with Air Attack or helibase.			
Recon Flights	To be approved by OPS or AOBD			
Cargo / Sling	Per Request from Div Sups, all sling loads / crew shuttles			
Ops Recon				
Div Sup Recon				
DIPSITES	River Dip 41 44.150 X 123 59.02    Whiskey Dip 41 39.240 X 123 39.690    Buck Dip 41 48.894 X 123 41.335 Bear Dip 41 50.487 X 123 46.359    Feeder Dip 41 36.831 X 123 51.810			
Nickowitz Fire Freq's	Air to Air FW 164.7500 Air to Air RW 126.075			
Nickowitz Ar Ops: Brian Driville 530-575-8169	Air to Ground 164.8625 Command 2 173.0375 Rx 67.3250 Tx Tone 127.3			

<b>MEDICAL PLAN</b>	<b>1. INCIDENT NAME</b> <b>Gasquet Complex</b>	<b>2. DATE PREPARED</b> 8/13/15	<b>3. TIME PREPARED</b> 1730	<b>4 OPERATIONAL PERIOD</b> 8/14-15/2015 0600-0600
---------------------	---	------------------------------------	---------------------------------	--

**5. INCIDENT MEDICAL AID STATIONS**

MEDICAL AID STATIONS	LOCATION	PARAMEDIC	
		YES	NO
Medical Supply	Base Camp		X

**TRANSPORTATION**

**A. Air Ambulances**

NAME	ADDRESS	PHONE	PARAMEDIC	
			YES	NO
National Guard H-825 (Day/Night, Hoist)	Redding Airport, CA	Communications	X	
CHP H-14 (Day/Night, Hoist)	Redding Airport, CA	(530) 842-3515	X	
Coast Guard (Day/Night, Hoist)	Air Station Humboldt Bay, CA	(707) 839-6100		X
Cal Fire Kneeland Helitack H-102 (Hoist)	Kneeland Station, CA	(707) 441-2863		X
Reach 5 Air Medical	Redding, CA	1-800-338-4045	X	
Mercy Air Ambulance 105	Medford, Oregon	1-800-903-9000	X	
PHI Air Medical	Redding, CA	1-800-597-9571	X	

**B. Ground Ambulances**

Hoopa Ambulance	Base Camp/Fireline	Communications	X	
Del Norte Ambulance, Station 2	2600 Morehead Rd Crescent City CA	Communications	X	

**7. HOSPITALS**

NAME	ADDRESS	TRAVEL TIME		PHONE	HELIPAD		BURN CENTER	
		AIR	GRND		YES	NO	YES	NO
Sutter Coast Hospital	800 E Washington Crescent City CA. N. 41 46.454 x W 124 11.537		25min	ER: 707-464-8888 Gen: 707-464-8511		X		X
Mercy Med. Center Level 3 Trauma	914 Pine St. Mt. Shasta, CA. N. 40 34.14 x W. 122 23.97	45m	4.5hr	(530)926-9360	X			X
Rogue Valley Med Center L- 2 Trauma/STEMI/Stroke	2825 Barnett Rd. Medford, OR. N. 42 19.092 W. 122 49.833	30m	2 hr	(541)789-7100	X			X
UC Davis Med Center Level 1 Trauma Burn Center	2315 Stockton Blvd. Sacramento, CA N. 38 33.3 x W. 121 27.3	2hr	7.0hr	(916) 734-3636 Burn Center (916) 734-3790 ER	X		X	

**8. MEDICAL EMERGENCY PROCEDURES**

**In the event of a medical emergency provide the following information to your Division or Gasquet Communications on Command.**

1. Declare the nature of the emergency.
  - a. Medical injury/illness?
  - b. Is injury/illness life threatening?
2. If life threatening, then request that the designated frequency be cleared for emergency traffic.
3. Identify the on-scene Point of Contact (POC) by resource and last name (i.e POC is TFLD Smith).
4. Identify nature of incident, number injured, patient assessment(s) and location (geographic and GPS coordinates).
5. Identify on-scene medical personnel by position and name (i.e EMT Jones).
6. Identify preferred method of patient transport.
7. Request any additional resources and/or equipment needed
8. Document all information received and transmitted on the radio or phone.
9. Identify any changes in the on-scene Point of Contact or medical personnel as they occur.

**INJURY REPORTING PROCEDURES**

NATURE OF INJURY \_\_\_\_\_ # of Patients \_\_\_\_\_

TRANSPORTATION NEEDED Air \_\_\_\_\_ Ground \_\_\_\_\_

REM Needed Y \_\_\_\_\_ N \_\_\_\_\_ Estimated Air Temp \_\_\_\_\_

LAT \_\_\_\_\_ LONG \_\_\_\_\_ Elevation \_\_\_\_\_

Specific Hazards In Area \_\_\_\_\_

PATIENT UNIT ID \_\_\_\_\_

REMINDER: DO NOT GIVE PT NAME OVER RADIO

IS MEDICAL PERSONNEL WITH PATIENT: YES \_\_\_\_\_ NO \_\_\_\_\_

AGE \_\_\_\_\_ SEX: MALE \_\_\_\_\_ FEMALE \_\_\_\_\_

**ALL EMERGENCIES—Secure the area and identify witnesses for later investigation. Keep an accurate log of events.**

<b>ICS 206 8-78</b>	<b>9. PREPARED BY (MEDICAL UNIT LEADER)</b> Gena Fowlkes MEDL (909) 762-9032	<b>10. REVIEWED BY (SAFETY OFFICER)</b> James Aragon SOF2
---------------------	---	--



## Incident within an Incident Action Plan

### When the scope or complexity of the emergency exceeds division resource needs

This plan is designed to identify the initial actions that should be taken by the first arriving personnel on a serious accident. This person may be a single resource, engine boss, or a crew boss. Accidents or incidents within an incident happen rapidly and require sound, calm initial decisions to handle the problem, while still focusing on the main incident. The following checklist provides some key thoughts and actions.

The first arriving person to any accident should notify their Division Supervisor, or the Div Sup assigned to that location.

#### **Advise of the critical information needed:**

- Accident scene safety assessment and advise incoming personnel
- Number of injuries and their severity
- Special equipment needs (extrication, low/high angle rescue, fire protection or suppression)
- Assist the injured as necessary without endangering yourself or other personnel
- Do not move trauma victims unless their safety is in jeopardy
- Utilize PINK pages of the Incident Response Pocket Guide (IRPG) for patient assessment/medical procedures

#### **Remain aware of surroundings and delegate personnel to monitor the main fire**

The **Division Supervisor** will assume command of the accident/incident scene upon arrival. The following list outlines the general duties and tasks that should be completed on most accidents/incidents.

1. Delegate division oversight to another Division Supervisor or other qualified person.
2. Request a clear frequency from Comm and consider switching to designated Emergency Tactical (Incident Comm will notify the MEDL who will initiate the medical plan for injuries)
3. Order/delegate resources appropriate for the accident/incident (crew EMT's, Line EMT's or Line Medics, rescue equipment, patient transport needs, manpower)
4. Notify Operations Section Chief and Safety Officer on all accidents/incidents.
5. Begin to document the event accurately and completely. Use ICS form 201 if the event is large or complex.
6. Protect the scene for Investigators

Reference the full Incident Medical Emergency Plan for additional



## Incident within an Incident Action Plan

### Position Assignment Supportive Actions

#### Division Supervisor

- See items 1-6 on page one
- If unable to access accident/incident location, delegate command to a closer qualified resource

#### Medical Unit Leader

- Respond to Comm Unit as soon as possible
- Coordinate with Division Supervisor to ensure proper resources are rapidly ordered
- Assign a MEDL to the scene and other positions to support the response as needed
- Monitor condition updates of patient(s) and coordinate response with Operations

#### Communications Unit Leader

- Maintain clear radio traffic and monitor communications to support response
- Recommend appropriate security and investigative process
- Assess the need for critical Incident Stress Response

#### Safety Officer

- Provide for Safety personnel on scene as needed
- Recommend appropriate security and investigative process
- Assess the need for critical Incident Stress Response

#### Air Attack Supervisor

- Obtain coordinates of the emergency location
- Coordinate air-medical response
- Assist and support the designated Point of Contact with communications and coordination of the emergency response as necessary

#### IC, Command & General Staff

- Manage the emergency and direct specific responsibilities to individual positions to provide an appropriate response
- Notify the host unit and host dispatch center of the size-up information
- Constantly monitor and assess the appropriate response and adapt direction as needed
- Submit all documentation pertaining to the emergency to the Plans Chief

Reference the full Incident Medical Emergency Plan for additional



## ***Health & Safety Message***

<b>Incident: Gasquet Complex CA-SRF-001488</b>	<b>Date/Op Period: 8/14-15/2015 0600-0600</b>
--	---

### **Hazard Tree Safety**

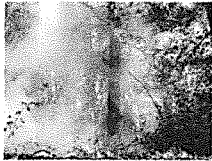

Environmental conditions that increase snag hazard:

- Strong winds
- Drought
- Steep slopes
- Diseased or bug-kill areas

Hazard tree indicators

- Trees have been burning for an extended period
- High risk tree species(rot and shallow root system)
- Numerous down trees
- Dead or broken tops and limbs overhead
- Accumulation of down limbs
- Absence of needles, bark or limbs
- Leaning or trees that have fallen and are hung-up in another tree.



Yellow Jackets AKA Wasps

Jellow Jackets are well know for their very painful stings. Jellow Jackets are in the wasp family and are very aggressive and can often be found nested in clump grass, or in the ground at the base of roadway safety rails.

Be heads up where you are utilizing hand tools so you don't disrupt their nests.

What do you do if stung?

If you have allergies to bees let your Div/Gp/Sup know while in your briefing.

If stung, notify your supervisor so you can be monitored for any alergic reactions and or notify medical.

If you have medication for bee stings, let you supervisors know.

***Prepared By: John Bates SOF2***

***Approved: James Aragon SOF2***

*Effective leadership is not about making speeches or being liked; leadership is defined by results not attributes.*

By: Peter Drucker

## INCIDENT SAFETY ANALYSIS 215a

Gasquet Complex - Thursday, August 14-15, 2015

8. Location	9. Hazard	6. Control or Abatement Action (Engineering, Administrative, PPE, Avoidance, Education, etc.)
All	Hazard Trees	<ul style="list-style-type: none"> <li>~ Follow "Hazard Tree Safety" guidelines, IRPG pages 22 &amp; 23</li> <li>~ Post lookouts, or use a spotter in mop-up areas with personnel</li> <li>~ Don't park vehicles or take breaks in high concentrations of hazard trees</li> <li>~ Establish trigger points for disengagement during high wind events</li> </ul>
All	Air Operations	<ul style="list-style-type: none"> <li>~ Follow " Aviation Watch-Out Situations" on page 44, IRPG</li> <li>~ Don't plan on air resources for medical transport or resupply.</li> <li>~ Refer to page 57, IRPG for directing bucket drops.</li> <li>~ Ensure positive communication with all air resources.</li> </ul>
All	Chain Saw Operations	<ul style="list-style-type: none"> <li>~ Follow "Hazard Tree Safety" guidelines, IRPG pages 22 &amp; 23</li> <li>~ Look up, down around for hazard tree indicators</li> <li>~ Only fell and buck trees within your expertise, and training</li> <li>~ Follow "Procedural Felling Operations" on page 79 in IRPG</li> <li>~ Do not fall trees during high wind events</li> </ul>
All	Steep Terrain & Rolling Debris	<ul style="list-style-type: none"> <li>~ Maintain 8'-10' spacing when working &amp; walking</li> <li>~ Don't work above any personnel</li> <li>~ Evaluate necessity to send personnel in areas with limited access</li> </ul>
All	Driving & Traffic	<ul style="list-style-type: none"> <li>~ Practice "Defensive Driving" techniques traveling on all roads and city streets, mitigation strategy includes:               <ul style="list-style-type: none"> <li>~ Use spotters when backing</li> <li>~ Honk horn to alert personnel when backing</li> <li>~ Always use headlights</li> <li>~ Yield to pedestrians and bicycles</li> <li>~ Observe posted speed limits</li> <li>~ Follow 3 second rule of following distance when driving</li> <li>~ Use chock blocks, turn wheels into hill</li> </ul> </li> </ul>
All	Firing Operations & Devices	<ul style="list-style-type: none"> <li>~ Only personnel trained in the use of each device will be authorized to use firing equipment.</li> <li>~ Ensure all personnel are aware of firing operation that may affect them.</li> <li>~ Wear appropriate PPE.</li> <li>~ Ensure aerial/ground ignition plans have been adequately developed and personnel are briefed.</li> </ul>
All	Injury & Medical Emergency	<ul style="list-style-type: none"> <li>~ Assist injured employee appropriate medical care</li> <li>~ Use EMT's on Division for initial care</li> <li>~ Follow medical protocol as outlined in ICS-206</li> </ul>
All	Bees, Ticks, Mosquitoes	<ul style="list-style-type: none"> <li>~ Be aware of crew members with sting allergies.</li> <li>~ Ensure crew members have medication pens if needed.</li> <li>~ Perform daily self inspection</li> <li>~ Use repellent as necessary</li> </ul>
All	Poisonous Plants	<ul style="list-style-type: none"> <li>~ Identify and Avoid hazard areas</li> <li>~ Launder clothing</li> <li>~ Shower frequently</li> </ul>
A,C,E,W	Heavy Equipment Operations	<ul style="list-style-type: none"> <li>~ Ensure communications are established with operators</li> <li>~ Use hand signals if other communications are unavailable</li> <li>~ Maintain a 50'-100' exclusion area around equipment</li> <li>~ Use a spotter when backing</li> </ul>

---

**Task Book Assigned To:**

Trainee's Name: \_\_\_\_\_

Home Unit/Agency: \_\_\_\_\_

Home Unit Phone Number: \_\_\_\_\_

---

**Task Book Initiated By:**

Official's Name: \_\_\_\_\_

Home Unit Title: \_\_\_\_\_

Home Unit/Agency: \_\_\_\_\_

Home Unit Phone Number: \_\_\_\_\_

Home Unit Address: \_\_\_\_\_

Date Initiated: \_\_\_\_\_

The material contained in this book accurately defines the performance expected of the position for which it was developed. This task book is approved for use as a position qualification document in accordance with the instructions contained herein.

## Training Message

Everyday is a training day!  
 Everyday is an opportunity to learn  
 About yourself, your co-workers,  
 and  
 The environment we work in

**Contact: Training Specialist (Ann Hutchinson)**  
**Located near Check-In / DMOB .....OR**  
**At the morning briefing.....OR**  
**Call 623-293-8628**



## Human Resource Message

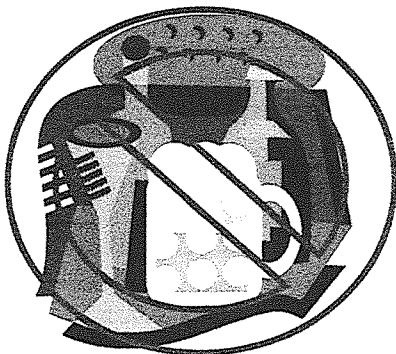

Take Care of your health.  
 Remember this is an Alcohol  
 and Non-Prescription Drug free  
 Incident.  
 Thank you, Kathy and Andrea





**Mountain School**  
 55 Azalea Lane  
 Gasket, CA 95543  
 (707) 457-3211

**ICP**

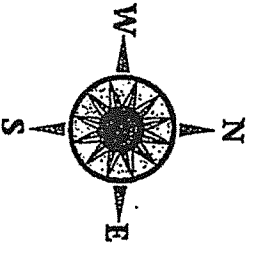

P	Portable	Fire Alarm Panel
C	Classroom	Water Shut Off
Exit/Door	Exit/Door	Electrical Shut Off
Fire Extinguisher	Fire Extinguisher	

071410/ Site Maps/ Del Norte

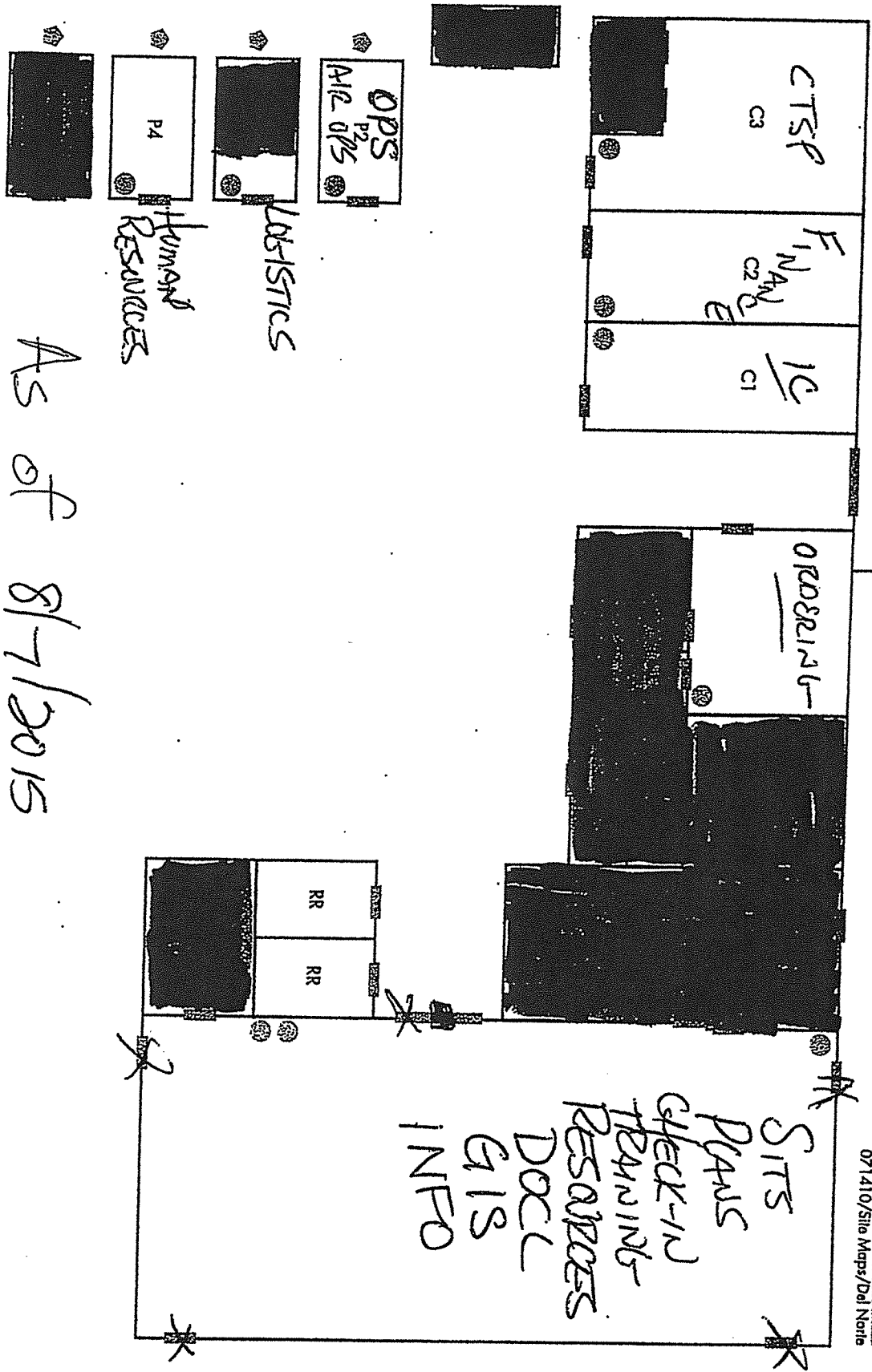

As of 8/7/2015

# GASQUET COMPLEX BASE CAMP

Updated 08/10/2015

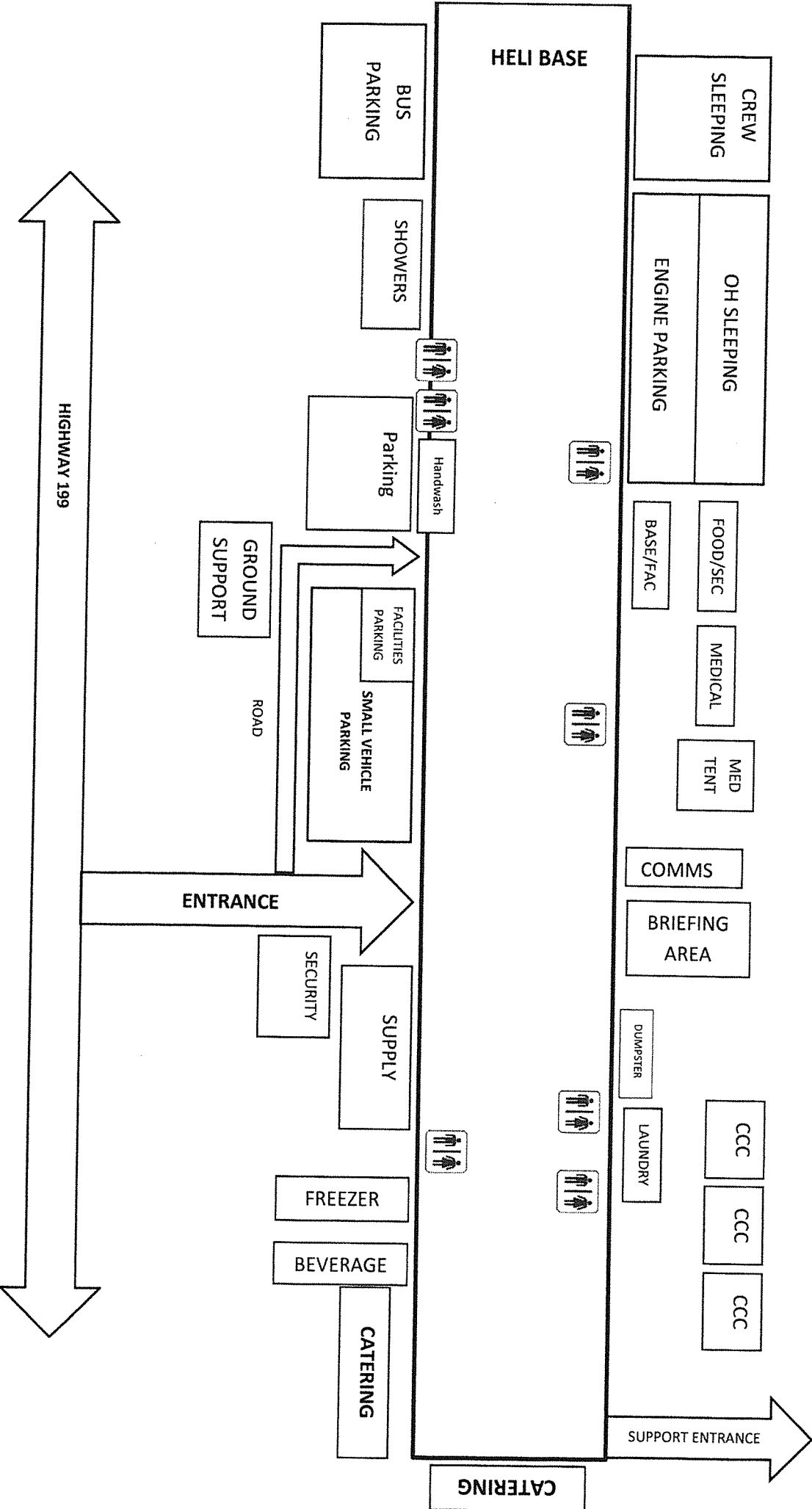
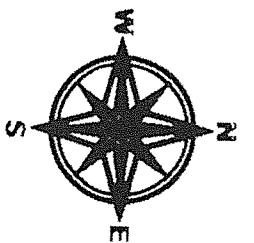

1 Gasquet Complex  
 N  
 CA-SRF-001488

Transportation Map

Base Camp (Airport)

Illinois Valley Airport  
 Grants Pass  
 199  
 Little Jones Creek Rd  
 Dozer Parking  
 199 Flat Area & Sleeping Area  
 ICP  
 Middle Fork Gasquet Rd  
 Gasquet  
 French Hill Rd  
 French Hill Rd  
 199

199  
 Crescent City  
 Hiwahi

1 way Alternating Traffic for Bridge Construction  
 0700-1700

NOT TO SCALE  
 Paved Road  
 Dirt Road  
 Prep point

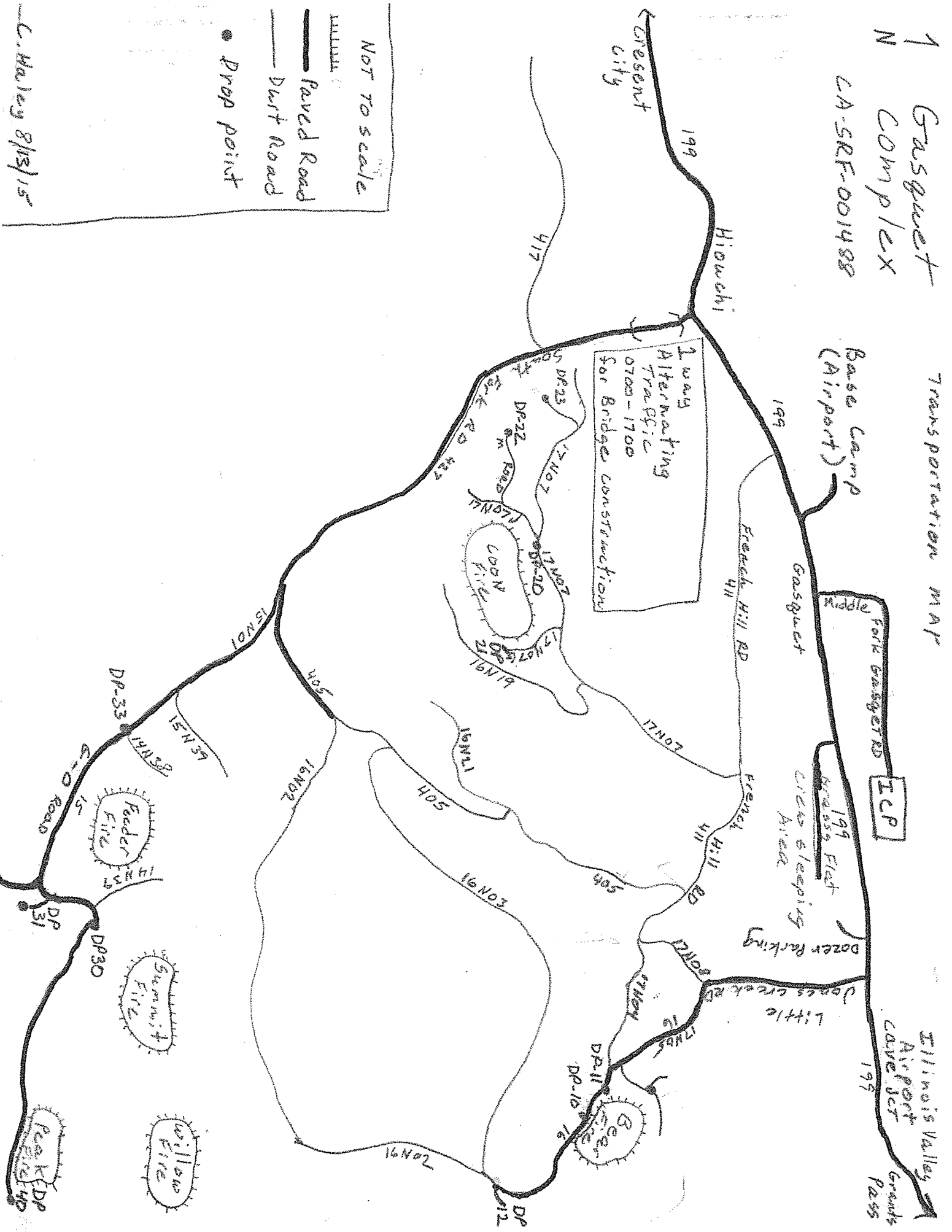

C. Haley 8/13/15

## Resources Up For Demob as of 8/13/15

REQUEST NUMBER	RESOURCE NAME	ITEM CODE	DEMOB DATE
O-141	PAYNE, DALE	DRIV	08/14/2015
A-57	BALD MOUNTAIN HELITAK H517	HEL2	08/15/2015
E-75	LKP 5031	ENG3	08/15/2015
E-76	SRM 331	ENG3	08/15/2015
E-77	CRK 379	ENG3	08/15/2015
E-78	GASQUET 214	ENG2	08/15/2015
E-80	WEBER FIRE DISTRICT 464	ENG4	08/15/2015
E-114	FIRESTORM 03	ENG4	08/15/2015
O-149	SCOTT, JAISY	PTRC	08/15/2015
O-150	BALENT, SHEILA	EQTR	08/15/2015
O-238	PALMER, DAVID	AADM	08/15/2015
C-30	STEELHEAD	HC2	08/16/2015
E-82	TONTO 1247	ENG6	08/16/2015
E-86	AMERICAN FIRE CO 61	ENG6	08/16/2015
E-87	WOOD'S WT 99	WTT2	08/16/2015
E-88	GASQUET VFD	WTT2	08/16/2015
E-115	ASI 3	ENG6	08/16/2015
E-116	CENTERAL WILDFIRE 741	ENG4	08/16/2015
E-118	DARE ENTERPRISES 32	ENG6	08/16/2015
O-88	WINN, DOUGLAS	FACL	08/16/2015
O-148	WYATT, JANICE	CAMP	08/16/2015
O-207	DEVLIN, BRENDA	THSP	08/16/2015
O-208	MCCAINE, MIKE	THSP	08/16/2015
O-262	MOSEY, KERI	CAMP	08/16/2015
O-276	FREDERICK, MICHAEL	AREP	08/16/2015
O-285	WHITNEY, DAVID	LSC2	08/16/2015
E-45	SRF WT15	WTT2	08/17/2015
E-167	FLAGSTAFF 16	ENG6	08/17/2015
O-42	MCDANIEL, KOREY	SEC1	08/17/2015
O-144	HYATT, CHAD	TFLD	08/17/2015
O-145	WEBB, GLENN	DIVS	08/17/2015
O-281	HENSON, CRYSTAL	SEMG	08/17/2015



