

# GASQUET COMPLEX

## INCIDENT ACTION PLAN

OPERATIONAL PERIOD

AUG 15 - AUG 16, 2015

0600-0600



*"Adapt...Improvise...and Overcome"*



CA-SRF-001488

P5JOPQ (0510)

NAD 83

dd° m.mm'

## INCIDENT OBJECTIVES (ICS 202)

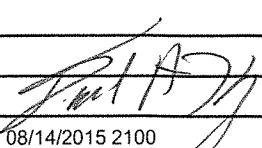
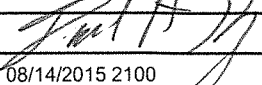
<b>1. Incident Name:</b>		<b>2. Operational Period:</b> 0600 - 0600	
GASQUET COMPLEX		Date/Time From: 08/15/2015 0600 SAT	Date/Time To: 08/16/2015 0600 SUN
<b>3. Objective(s):</b>			
<p><b>STRATEGIC FRAMEWORK:</b> THE FRAMEWORK FOR THE GASQUET COMPLEX STRATEGIC PLAN CONSISTS OF USING A COMBINATION OF DIRECT ATTACK WHERE FEASIBLE, OTHERWISE INDIRECT USING NATURAL BARRIERS. A KEY ELEMENT IS FLEXIBILITY AND THE ABILITY TO APPLY THE RIGHT RESOURCE TO THE RIGHT TASK AT THE RIGHT TIME. FIRELINE WILL BE CONSTRUCTED ONLY WHERE FEASIBLE AND SAFE TO DO SO.</p> <p><b>LEADERS INTENT:</b> PROVIDE THE HIGHEST LEVEL OF CUSTOMER SERVICES TO ALL INVOLVED WITH OR IMPACTED BY THE GASQUET COMPLEX. ALL INCIDENT PERSONNEL SHOULD BE PREPARED TO TAKE THE APPROPRIATE ACTIONS REGARDING:</p> <ul style="list-style-type: none"> <li>• PERSONAL INTERACTIONS BOTH INSIDE AND OUTSIDE THE INCIDENT MANAGEMENT ORGANIZATION.</li> <li>• PERSONAL SAFETY AND THE SAFETY OF OTHERS.</li> <li>• AN INCIDENT-WITHIN-AN-INCIDENT.</li> </ul> <p><b>OBJECTIVES:</b></p> <ul style="list-style-type: none"> <li>• PROVIDE FOR FIREFIGHTER AND PUBLIC SAFETY BY ENSURING L C E S IS EVALUATED USING SOUND RISK MANAGMENT PRINCIPLES.</li> <li>• MAINTAIN AND BUILD COOPERATOR AND STAKEHOLDER RELATIONSHIPS.</li> <li>• SUPPRESS FIRES WHILE NOT EXPOSING FIREFIGHTERS OR AIRCRAFT TO UNNECESSARY RISKS.</li> <li>• IDENTIFY AND PROTECT NATIVE AMERICAN TRADITIONAL AREAS AND OTHER SENSITIVE CULTURAL AND HISTORIC SITES.</li> </ul>			
<b>4. Operational Period Command Emphasis:</b>			
UTILIZE SUPPRESSION STRATEGIES COMMENSURATE WITH VALUES AT RISK. IMPLEMENT TACTICS WHICH INCREASE THE PROBABILITIES OF SUCCESS WHILE HOLDING EXISTING CONTAINMENT.			
<b>General Situational Awareness:</b>			
WHEN WORKING ON HILLSIDES, BE AWARE OF FALLING TREES. THESE TREES CAN SLIDE ALONG WAY DOWN THE HILL BEFORE STOPPING, AND CAN START FIRES BELOW YOU IN THE GREEN.			
<b>5. Site Safety Plan Required?</b> Yes <input type="checkbox"/> No <input checked="" type="checkbox"/>			
<b>Approved Site Safety Plan(s) Located at:</b>			
<b>6. Incident Action Plan</b> (the items checked below are included in this Incident Action Plan):			
<input checked="" type="checkbox"/> ICS 202	<input type="checkbox"/> ICS 207	Other Attachments:	
<input checked="" type="checkbox"/> ICS 203	<input type="checkbox"/> ICS 208	<input checked="" type="checkbox"/> SAFETY / 215A	
<input checked="" type="checkbox"/> ICS 204	<input checked="" type="checkbox"/> ICS 220	<input checked="" type="checkbox"/> INCIDENT WITHIN AN INCIDENT	
<input checked="" type="checkbox"/> ICS 205	<input checked="" type="checkbox"/> Map/Chart	<input checked="" type="checkbox"/> HR / TRAINING MESSAGE	
<input type="checkbox"/> ICS 205A	<input checked="" type="checkbox"/> Weather Forecast/Tides/Currents	<input checked="" type="checkbox"/> DEMOB LIST	
<input checked="" type="checkbox"/> ICS 206			
<b>7. Prepared by:</b> DAVE LATTIMORE		<b>Position/Title:</b> PSC2	<b>Signature:</b> 
<b>8. Approved by Incident Commander:</b>		<b>Name:</b> DON GARWOOD	<b>Signature:</b> 
ICS 202		<b>IAP Page</b>	<b>Date/Time:</b> 08/14/2015 2100

## ORGANIZATION ASSIGNMENT LIST (ICS 203)

<b>1. Incident Name:</b>		<b>2. Operational Period:</b> 0600 - 0600	
GASQUET COMPLEX		Date/Time From: 08/15/2015 0600 SAT	Date/Time To: 08/16/2015 0600 SUN
<b>3. Incident Commander(s) and Command Staff:</b>		<b>7. Operations Section:</b>	
IC/UC	DON GARWOOD	OPS SECTION CHIEF	DERRICK DAVIS DARRELL MILLER
DEPUTY	DAVE KELLY	PLANNING OPS	MATTHEW CONKLIN AARON THOMPSON (T)
SAFETY OFFICER	JAMES ARAGON; P TOMPKINS; J BATES; F HERNANDEZ (T)		
INFORMATION OFFICER	JIM WILKINS; ROBERT POOLE ASCENSION BRIBIESCAS	DIVISION/GROUP	A - COON FIRE MITCH FOWLKES DAN O'CONNOR (T)
LIAISON OFFICER	LARRY LA VOGUE 909-855-5756	DIVISION/GROUP	C - COON FIRE TODD MCDIVITT BRIAN BERRY (T)
HUMAN RESOURCES	KATHY KREYNS 909-731-1771 ANDREA CABIDA (T)	DIVISION/GROUP	D - COON FIRE TRENT INGRAM KEN VAN WIG (T)
<b>4. Agency/Organization Representative(s):</b>		DIVISION/GROUP	E - BEAR FIRE DAVID MARTINEZ JOHN OWINGS (T)
<b>Agency/Organization</b>	<b>Name</b>	DIVISION/GROUP	G - BEAR FIRE ERIC PLATZ CHRIS ST. PIERRE (T)
USFS	DAVE PALMER	DIVISION/GROUP	H/L/N/V WILLIAMS / PEAK / SUMMIT CANDICE KUTROSKY PAUL MANDOLINI (T)
GASQUET VFD	NICK KARANPOULOS	DIVISION/GROUP	W - FEEDER FIRE GLENN WEBB AL WARD (T)
CAL OES	JOHN SALVATE	DIVISION/GROUP	Z - FEEDER FIRE ADAM KOHLEY ROBERT ALLAN (T)
CAL TRANS		DIVISION/GROUP	CONTINGENCY JEREMY COWIE BRIAN FABBRI (T)
SRF-NFFE	ROBERTA CORAGLIOTTI 530-784-7542 JOHN MC RAE 707-845-8017	<b>7b. Air Operations Branch:</b>	
<b>5. Planning Section:</b>		AIR OPS BRANCH DIRECTOR	TED VISSER
CHIEF	DAVE LATTIMORE	AIR SUPPORT SUPERVISOR	GALEN YOUNG
DEPUTY	RICH STERRY (T)	AIR ATTACK SUPERVISOR	CLIFF CLARIDGE KEN MCLAUGHLIN
RESOURCES UNIT	KYLE HAUDUCOER, BILL KERSHAW J SCURI (T)	AIR TANKER COORDINATOR	
SITUATION UNIT	GORDON TAMPLIN(T), TIM KNORR(T)	HELICOPTER COORDINATOR	
DOCUMENTATION	VANESSA HANSON	<b>8. Finance/Administration Section:</b>	
DEMOB UNIT	JIM STITELER (T)	CHIEF	DEBBIE YORK
IMET	RACHEL COBB	TIME UNIT	SHARON R MAKOSKY DEANNA THOMPSON (T)
FIRE BEHAVIOR	BYRON KIMBALL	COMPENSATION UNIT	BETH SJOBLUM
SOPL	BOB LINEBACK	COST UNIT	THOMAS STEELE KRIS STERBENS (T)
TRAINING SPECIALIST	ANN HUTCHINSON		
GISS	R MURILLO; A. KIRSCH; A SALDIVAR(T)		
CTSP	CHARLES VERTREES		
<b>6. Logistics Section:</b>			
CHIEF	ERIC SWEETMAN		
DEPUTY	STEVE KING (T); DAVID WHITNEY (T)		
SUPPLY UNIT	EVAN TISS		
FACILITIES UNIT	ART CURLEY; DOUG WINN(T)		
GROUND SUPT UNIT	CHRIS HALEY; RON NOORDMAN		
COMM UNIT	DAVE LARKIN; CHRIS PERRY(T)		
MEDICAL UNIT	GENA FOWLKES MATTHEW MENARD (T)		
SECURITY UNIT	HEATHER NAIGUS		
FOOD UNIT	RICHARD WAITE		
<b>9. Prepared By:</b>	<b>Name:</b> KYLE HAUDUCOEUR	<b>Position/Title:</b> RESL	<b>Signature:</b>
ICS 203	IAP Page	<b>Date/Time:</b> 08/14/2015 2100	



## INCIDENT Weather Forecast



FORECAST NO: 4

NAME OF FIRE: Gasquet Complex

PREDICTION FOR: Day Shift

SHIFT DATE: 8/15/2015

SIGNED: *Rachel Cobb*

TIME AND DATE

FORECAST ISSUED: 1900 8/14/2015

Rachel Cobb

Incident Meteorologist

---

**WEATHER DISCUSSION:** High pressure will build over California on Saturday and Sunday, and a thermal trough will position itself over the area. This will bring much warmer and drier conditions, and an offshore flow will keep skies clear. This will also lead to gusty northeast winds during the overnight hours and poor humidity recoveries in the mountains.

---

**WEATHER FORECAST for Saturday:**

**WEATHER:** Clearing, but smoky.

**MAXIMUM TEMPERATURES:** 80 – 87 degrees valleys...74 – 80 degrees ridges.

**MINIMUM HUMIDITY:** 23 – 29 percent.

**20 FT WINDS:**

RIDGETOP – Northerly 5 to 10 mph.

SLOPE/VALLEY – Upslope/upvalley 3 to 8 mph.

**HAINES INDEX:** 4 (moderate).

**STABILITY/INVERSION:** Mixing height 8000 feet msl.

---

**OUTLOOK for Saturday Night:** Clear, but smoky. Low temperatures 55 – 60 degrees and maximum relative humidity 40 – 60%. Ridgetop winds northeast 10 to 15 mph with gusts to 25 mph. Haines Index: 4. Thermal belt 4000 – 5000 feet msl.

---

**OUTLOOK for Sunday:** Clear, but smoky. Highs temperatures 77 – 89 degrees and minimum relative humidity 21 – 27%. Ridgetop winds northerly 5 to 10 mph. Mixing height: 7500 feet msl. Haines Index: 4.

---

**EXTENDED FORECAST:** Hot and dry conditions will persist through Thursday.

# FIRE BEHAVIOR FORECAST

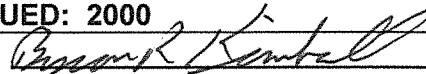
FORECAST NUMBER: #12	TYPE OF FIRE: Wildland Fire
FIRE NAME: Gasquet Complex	OPERATIONAL PERIOD: August 15, 2015
DATE ISSUED: August 14, 2015	TIME ISSUED: 2000
UNIT: Smith River NRA, Six Rivers NF	SIGNED:  Typed/printed:/s/ Byron R. Kimball FBAN

## INPUTS

**WEATHER SUMMARY:** Clear skies. Warmer and drier, Haines Index of 5  
MAX TEMPERATURE.....Valleys 80-87, Ridges 74-80.  
MIN HUMIDITY.....23 - 29%  
EYE LEVEL WINDS.....Upslope/upvalley 3-8, Ridges NW 5 to 10,  
**For more specific information, please see the Incident Weather forecast**

## OUTPUTS

### FIRE BEHAVIOR

#### GENERAL:

Increased warming and drying bring excellent burning conditions. Additional solar heating, reduced RHs and lack of a marine layer should allow for an early start to the burn period. Expanded burn window should allow for more consumption as fuels have a longer timeframe to heat up and dry out. Spotting becomes a concern as brush understory becomes involved.

With line construction in incomplete burns, be positive that you are exposing the black edge and getting all the hot ash and embers inside your line.

#### SPECIFIC:

Timber Understory: Fire behavior in the Understory models should begin early. Warmer and drier conditions will expand the burn window. Expect more involvement of the understory brush and shrubs with increased intensity.

ROS: 5 to 10 ch/hr.

FL: 6 to 8 ft.

Timber Litter: Timber Litter fire behavior should be active early. Increased consumption of heavier fuels and understory may provide additional material for spots and roll out. Stay aware of rollout and upslope runs through incomplete burns.

ROS: 3 to 6 ch/hr.

FL: 2 to 3 ft.

Spotting becomes a concern with improved burn conditions. Know where your smoke is going and check for fallout.

### AIR OPERATIONS:

High pressure should hold down the marine layer and improve flying conditions.

## SAFETY

Be aware of fire in the standing timber and instability of trees and snags. Ash pits and stump holes become more of an issue the longer the fire burns in the fuel bed.

## Division/Group Assignment List (ICS 204 WF)

<b>1. Incident Name:</b>			<b>3.</b>			
GASQUET COMPLEX			<b>Branch:</b>		<b>Division/Group:</b>	
<b>2. Operational Period:</b> 0600 - 0600					<b>A - COON FIRE</b>	
Date/Time From: 08/15/2015 0600 SAT			Date/Time To: 08/16/2015 0600 SUN			
<b>4. Operations Personnel</b>						
<b>OPERATIONS CHIEF</b>		DERRICK DAVIS DARRELL MILLER		<b>DIVISION/GROUP SUPERVISOR</b>		MITCH FOWLKES DAN O'CONNOR (T)
<b>PLANNING OPS</b>		MATT CONKLIN AARON THOMPSON (T)		<b>AIR ATTACK SUPERVISOR</b>		CLIFF CLARIDGE KEN MCLAUGHLIN
<b>5. Resources Assigned this Period</b>						
Strike Team / Task Force / Resource Designator		LWD	Leader	Number Persons	Drop Off PT./Time	Pick Up PT./Time
HC2 STEELHEAD C-30		08/15	ALEJANDRO RODRIGUEZ	20	ICP/0630	ICP/1900
HCM HOOPA O-275		08/24	ROCKY COLEGROVE	12	ICP/0630	ICP/1900
TFLD VIKTORA O-80 / WHEELER (T) O-106		08/18		2	ICP/0630	ICP/1900
ENG3 ALBUQUERQUE E-161		08/26	BRIAN FOX	4	ICP/0630	ICP/1900
ENG3 BERTHOUD 13 E-144		08/27	NICO ROMERO	3	ICP/0630	ICP/1900
ENG3 TRICITY 411 E-142		08/27	FRANK ZUPANCIC	4	ICP/0630	ICP/1900
ENG6 KAIBAB 611 E-165		08/26	NICK BEHRENDIS	6	ICP/0630	ICP/1900
HEQB HEISEY / DOZ2 ROEN E-90		08/20		3	ICP/0630	ICP/1900
HEQB TERRY CARRICO O-217		08/24		1	ICP/0630	ICP/1900
SKG4 L & L EXCAVATING W/ TRSPT E-111		08/23	SHANE NODINE	2	ICP/0630	ICP/1900
SKG3 UNDERHILL 1 W/ TRSPT E-112		08/22	JOE BRADBURY	2	ICP/0630	ICP/1900
FAL1 NORTH ZONE FALLERS #1 O-94		08/18	ALAN STEWART	2	ICP/0630	ICP/1900
WTS2 DUDLEY'S E-136		08/25	DON GUICE	1	ICP/0630	ICP/1900
FEMT RANDOLPH O-133 / VANZINNI O-134		08/21		2	ICP/0630	ICP/1900
<b>6. Control Operations/Work Assignments:</b>						
<ul style="list-style-type: none"> <li>• CONTINUE INDIRECT DOZER LINE FROM 17N07J ROAD WEST TO SOUTH FORK OF THE SMITH RIVER AND IDENTIFY SAFETY ZONES.</li> </ul>						
<b>7. Special Instructions:</b>						
<ul style="list-style-type: none"> <li>• COORDINATE AND ORDER AIRCRAFT FOR WATER AND RETARDANT NEEDS WITH AIR ATTACK.</li> <li>• DO NOT FILL WATER FROM COMMUNITY OF HIOUCHI FIRE HYDRANTS.</li> </ul>						
<b>8. Division/Group Communication Summary</b>						
Function	Channel	RX Frequency N/W	RX Tone/NAC	TX Frequency N/W	TX Tone/NAC	Mode
COMMAND	1	167.1000	162.2	169.7500	162.2	A
TACTICAL	13	167.1125	162.2	167.1125	162.2	A
BACKUP NET	4	168.1250		170.4750	127.3	A
AIR TO GROUND	10	165.3875		165.3875		A
<b>9. Prepared By (Resource Unit Leader)</b>			<b>Approved By (Planning Section Chief)</b>		<b>Date</b>	<b>Time</b>
JAKE HUGHES (T)			DAVE LATTIMORE		08/14/2015	2100

## Division/Group Assignment List (ICS 204 WF)

<b>1. Incident Name:</b>				<b>3.</b>		
GASQUET COMPLEX				Branch:		Division/Group:
<b>2. Operational Period:</b> 0600 - 0600				<b>C - COON FIRE</b>		
Date/Time From: 08/15/2015 0600 SAT		Date/Time To: 08/16/2015 0600 SUN				
<b>4. Operations Personnel</b>						
<b>OPERATIONS CHIEF</b>		DERRICK DAVIS DARRELL MILLER		<b>DIVISION/GROUP SUPERVISOR</b>		TODD MCDIVITT BRIAN BERRY (T)
<b>PLANNING OPS</b>		MATT CONKLIN AARON THOMPSON (T)		<b>AIR ATTACK SUPERVISOR</b>		CLIFF CLARIDGE KEN MCLAUGHLIN
<b>5. Resources Assigned this Period</b>						
Strike Team / Task Force / Resource Designator		LWD	Leader	Number Persons	Drop Off PT./Time	Pick Up PT./Time
HCM BEAR PEAK O-59		08/23	FRED FLEISCHMAN	9	ICP/0630	ICP/1900
ES3 2141C E-122		08/20	PETE DAVIS	21	ICP/0630	ICP/1900
ENG3 SANTA CLARA VFD 33 E-29		08/19	TYREL HANSEN	4	ICP/0630	ICP/1900
ENG3 SRF 11 E-189		08/24	JOE ENIEM	5	ICP/0630	ICP/1900
HEQB RICH WATERS O-85		08/18		1	ICP/0630	ICP/1900
DO22 BROWNING E-44		08/20	PAT BROWNING	1	ICP/0630	ICP/1900
DO22 WARNER E-43		08/18	DAN WARNER	3	ICP/0630	ICP/1900
WTS2 ALL AGENCY E-38		08/18	JOHN HILL	1	ICP/0630	ICP/1900
WTS2 SIERRA TIMBER E-42		08/19	DOUG LINGEN	1	ICP/0630	ICP/1900
WTS2 WILLS E-138		08/25	PHIL WILLS	1	ICP/0630	ICP/1900
SOFR SCHNEIDER (T) O-90 / BERG (T) O-146		08/20		2	ICP/0630	ICP/1900
FEMP CRADDOCK O-240 / FEMT PESHKIN O-241		08/25		2	ICP/0630	ICP/1900
<b>6. Control Operations/Work Assignments:</b>						
<ul style="list-style-type: none"> <li>• SECURE HANDLINE FROM DOZER LINE TO COON CREEK . # SCOUT FOR SECONDARY CONTINGENCY LINE.</li> <li>• SECURE ALL FIRE WEST OF THE 17NO7G ROAD FROM DP 20 TO COON CREEK.</li> </ul>						
<b>7. Special Instructions:</b>						
<ul style="list-style-type: none"> <li>• COORDINATE AND ORDER AIRCRAFT FOR RETARDANT NEEDS WITH AIR ATTACK.</li> <li>• FOBS PIPPIN / HAMER (T) WORKING IN DIV A AND DIV C.</li> <li>• DO NOT FILL WATER FROM COMMUNITY OF HIOUCHI FIRE HYDRANTS</li> </ul>						
<b>8. Division/Group Communication Summary</b>						
Function	Channel	RX Frequency N/W	RX Tone/NAC	TX Frequency N/W	TX Tone/NAC	Mode
COMMAND	1	167.1000	162.2	169.7500	162.2	A
TACTICAL	5	166.7250	162.2	166.7250	162.2	A
BACKUP NET	4	168.1250		170.4750	127.3	A
AIR TO GROUND	10	165.3875		165.3875		A
<b>9. Prepared By (Resource Unit Leader)</b>			<b>Approved By (Planning Section Chief)</b>		<b>Date</b>	<b>Time</b>
JAKE HUGHES (T)			DAVE LATTIMORE		08/14/2015	2100

## Division/Group Assignment List (ICS 204 WF)

<b>1. Incident Name:</b>			<b>3.</b>			
GASQUET COMPLEX			Branch:		Division/Group:  <b>D - COON FIRE</b>	
<b>2. Operational Period:</b> 0600 - 0600						
Date/Time From: 08/15/2015 0600 SAT		Date/Time To: 08/16/2015 0600 SUN				
<b>4. Operations Personnel</b>						
<b>OPERATIONS CHIEF</b>		DERRICK DAVIS DARRELL MILLER		<b>DIVISION/GROUP SUPERVISOR</b>		TRENT INGRAM KEN VAN WIG (T)
<b>PLANNING OPS</b>		MATT CONKLIN AARON THOMPSON (T)		<b>AIR ATTACK SUPERVISOR</b>		CLIFF CLARIDGE KEN MCLAUGHLIN
<b>5. Resources Assigned this Period</b>						
Strike Team / Task Force / Resource Designator		LWD	Leader	Number Persons	Drop Off PT./Time	Pick Up PT./Time
TFLD JEREMIAH PHILLIPS O-75		08/20		1	ICP /0630	ICP/1900
TFLD DARIN KEYSE (T) O-78		08/20		1	ICP /0630	ICP/1900
ENG6 ASI 3 E-115		08/15	MICHAEL HOLLOWAY	3	ICP /0630	ICP/1900
ENG6 BOHICA 61 E-168		08/26	DAVE CAMPBELL	3	ICP /0630	ICP/1900
ENG6 ENG 705 E-162		08/27	MANUEL WESAW	4	ICP /0630	ICP/1900
HEQB JON MCCLELLAN O-216		08/24		1	ICP /0630	ICP/1900
MAST JR-3 E-55		08/27	RICK ESTEY	2	ICP /0630	ICP/1900
MAST JR-4 E-54		08/27	HARVEY MOON	2	ICP /0630	ICP/1900
MAST SMITH GRINDING E-133			***SEE OPERATIONS***		ICP /0630	ICP/1900
DO22 FISK'S TREE E-91		08/21	RICK ANDERSON	1	ICP /0630	ICP/1900
DO22 KENS DOZER E-171		08/27	EIAN OWENS	1	ICP /0630	ICP/1900
<b>6. Control Operations/Work Assignments:</b>						
<ul style="list-style-type: none"> <li>COMPLETE STRUCTURE PREP OF TOLLEFSON PROPERTY.</li> <li>INITIATE SHADED FUEL BREAK ALONG 16N19 RD, PER DISTRICT FUEL SPECIALIST SPECS.</li> </ul>						
<b>7. Special Instructions:</b>						
<ul style="list-style-type: none"> <li>COORDINATE AND ORDER AIRCRAFT FOR RETARDANT NEEDS WITH AIR ATTACK.</li> <li>DO FILL WATER FROM COMMUNITY OF HIOUCHI FIRE HYDRANTS</li> </ul>						
<b>8. Division/Group Communication Summary</b>						
Function	Channel	RX Frequency N/W	RX Tone/NAC	TX Frequency N/W	TX Tone/NAC	Mode
COMMAND	1	167.1000	162.2	169.7500	162.2	A
TACTICAL	14	168.2375	162.2	168.2375	162.2	A
BACKUP NET	4	168.1250		170.4750	127.3	A
AIR TO GROUND	10	165.3875		165.3875		A
<b>9. Prepared By (Resource Unit Leader)</b>			<b>Approved By (Planning Section Chief)</b>		<b>Date</b>	<b>Time</b>
JOE SCURI (T)			DAVE LATTIMORE		08/14/2015	2100



## Division/Group Assignment List (ICS 204 WF)

<b>1. Incident Name:</b>			<b>3.</b>			
GASQUET COMPLEX			<b>Branch:</b>		<b>Division/Group:</b>	
<b>2. Operational Period:</b> 0600 - 0600					<b>E - BEAR FIRE</b>	
Date/Time From: 08/15/2015 0600 SAT			Date/Time To: 08/16/2015 0600 SUN			
<b>4. Operations Personnel</b>						
<b>OPERATIONS CHIEF</b>		DERRICK DAVIS DARRELL MILLER		<b>DIVISION/GROUP SUPERVISOR</b>		DAVID MARTINEZ JOHN OWINGS (T)
<b>PLANNING OPS</b>		MATT CONKLIN AARON THOMPSON (T)		<b>AIR ATTACK SUPERVISOR</b>		CLIFF CLARIDGE KEN MCLAUGHLIN
<b>5. Resources Assigned this Period</b>						
Strike Team / Task Force / Resource Designator		LWD	Leader	Number Persons	Drop Off PT./Time	Pick Up PT./Time
HC2I GRAYBACK 8B C-5		08/20	TIM NYGREN	20	ICP/0630	ICP/1900
HC2 FORT APACHE 3 C-10		08/20	BURNETTE BENNETT	20	ICP/0630	ICP/1900
TFLD T ERICKSON O-232 / N BALENT (T) O-209		08/23		2	ICP/0630	ICP/1900
ENG3 UTAH COUNTY 12 E-31		08/19	ANDREW WATSON	4	ICP/0630	ICP/1900
ENG3 ARCHER MOUNTAIN 13 E-28		08/19	JUSTUS BARTON	3	ICP/0630	ICP/1900
ENG3 HOOPA 9531 E-175		08/26	NELS NELSON	5	ICP/0630	ICP/1900
ENG6 WEBER FIRE 661 E-33		08/19	SCOTT HANEY	3	ICP/0630	ICP/1900
ENG6 GREAT BASIN 311 E-34		08/19	TYLER ERSKINE	3	ICP/0630	ICP/1900
HEQB TIMOTHY LANTERMAN O-83		08/21		1	ICP/0630	ICP/1900
DO22 PLUMAS 1		08/24	JAMES SMITH	4	ICP/0630	ICP/1900
WTS1 V&P E-139		08/25	SEE CHECK IN	1	ICP/0630	ICP/1900
WTS2 YREKA OUTLANDS E-19		08/18	ALLEN WILLIAMS	2	ICP/0630	ICP/1900
FEMP FELDMAN O-135 / FEMT WICKLAS O-132		08/20		2	ICP/0630	ICP/1900
<b>6. Control Operations/Work Assignments:</b>						
<ul style="list-style-type: none"> <li>• CONTINUE TO HOLD AND IMPROVE LINE ALONG THE 17N03 ROAD. • CONTINUE DOZER LINE FROM 17N05 DOWN 17N35 RIDGE.</li> <li>• CONTINUE PREP FROM DP10 TO 17N04 RD • IMPROVE ANCHOR POINT AND SECURE HANDLINE CONSTRUCTION ON WEST FLANK.</li> </ul>						
<b>7. Special Instructions:</b>						
<ul style="list-style-type: none"> <li>• COORDINATE AND ORDER AIRCRAFT FOR RETARDANT NEEDS WITH AIR ATTACK.</li> <li>• DO NOT FILL WATER FROM COMMUNITY OF HIOUCHI FIRE HYDRANTS</li> </ul>						
<b>8. Division/Group Communication Summary</b>						
Function	Channel	RX Frequency N/W	RX Tone/NAC	TX Frequency N/W	TX Tone/NAC	Mode
COMMAND	1	167.1000	162.2	169.7500	162.2	A
TACTICAL	6	166.7750	162.2	166.7750	162.2	A
BACKUP NET	4	168.1250		170.4750	127.3	A
AIR TO GROUND	10	165.3875		165.3875		A
<b>9. Prepared By (Resource Unit Leader)</b>			<b>Approved By (Planning Section Chief)</b>		<b>Date</b>	<b>Time</b>
JOE SCURI (T)			DAVE LATTIMORE		08/14/2015	2100

## Division/Group Assignment List (ICS 204 WF)

<b>1. Incident Name:</b>				<b>3.</b>			
GASQUET COMPLEX				<b>Branch:</b>		<b>Division/Group:</b>	
<b>2. Operational Period:</b> 0600 - 0600						<b>G - BEAR FIRE</b>	
Date/Time From: 08/15/2015 0600 SAT		Date/Time To: 08/16/2015 0600 SUN					
<b>4. Operations Personnel</b>							
<b>OPERATIONS CHIEF</b>		DERRICK DAVIS DARRELL MILLER		<b>DIVISION/GROUP SUPERVISOR</b>		ERIC PLATZ CHRIS ST PIERRE (T)	
<b>PLANNING OPS</b>		MATT CONKLIN AARON THOMPSON (T)		<b>AIR ATTACK SUPERVISOR</b>		CLIFF CLARIDGE KEN MCLAUGHLIN	
<b>5. Resources Assigned this Period</b>							
Strike Team / Task Force / Resource Designator		LWD	Leader	Number Persons	Drop Off PT./Time	Pick Up PT./Time	
HC2 FORT APACHE 4 C-11		08/20	DANNY EDWARDS	19	ICP/0630	ICP/1900	
TFLD JOEL PETERS O-226		08/23		1	ICP/0630	ICP/1900	
SKG3 CLEARWATER FIRE E-155		08/26	ED URICK	1	ICP/0630	ICP/1900	
ENG6 BOULDER MTN 4333 E-152		08/26	MIKE PALAMARA	3	ICP/0630	ICP/1900	
ENG6 A BAR S 613 E-166		08/26	MATT BUSTAMANTE	4	ICP/0630	ICP/1900	
ENG6 NV-WID 2616 E-35		08/19	CHAD NIBLETT	3	ICP/0630	ICP/1900	
ENG6 BL12 E-163		08/27	MICHAEL MORIN	3	ICP/0630	ICP/1900	
FELB CHRIS HENRIE O-181		08/24		1	ICP/0630	ICP/1900	
FAL1 NORTH ZONE FALLERS #2 O-95		08/18	BILLY BELMONT	2	ICP/0630	ICP/1900	
FAL1 NORTH ZONE FALLERS #4 O-97		08/18	BILL MEADOWS	2	ICP/0630	ICP/1900	
FAL1 MCKELLER TREE O-202		08/22	DOUG MCKELLAR	2	ICP/0630	ICP/1900	
SOFR BRAD LIDELL O-252		08/25		1	ICP/0630	ICP/1900	
<b>6. Control Operations/Work Assignments:</b>							
<ul style="list-style-type: none"> <li>SCOUT FOR OPPORTUNITIES FOR DIRECT LINE CONSTRUCTION.</li> <li>CONTINUE LINE PREP FROM BEAR BASIN LOOKOUT DOWN THE SHIP MT RD TO THE WILDERNESS BOUNDARY.</li> </ul>							
<b>7. Special Instructions:</b>							
<ul style="list-style-type: none"> <li>COORDINATE AND ORDER AIRCRAFT FOR <b>WATER ONLY</b> DROPS WITH AIR ATTACK.</li> <li>DO NOT FILL WATER FROM COMMUNITY OF HIOUCHI FIRE HYDRANTS.</li> </ul>							
<b>8. Division/Group Communication Summary</b>							
Function	Channel	RX Frequency N/W	RX Tone/NAC	TX Frequency N/W	TX Tone/NAC	Mode	
COMMAND	1	167.1000	162.2	169.7500	162.2	A	
TACTICAL	7	168.2500	162.2	168.2500	162.2	A	
BACKUP NET	4	168.1250		170.4750	127.3	A	
AIR TO GROUND	10	165.3875		165.3875		A	
<b>9. Prepared By (Resource Unit Leader)</b>			<b>Approved By (Planning Section Chief)</b>			<b>Date</b>	<b>Time</b>
KYLE HAUDUCOEUR			DAVE LATTIMORE			08/14/2015	2100



## Division/Group Assignment List (ICS 204 WF)

<b>1. Incident Name:</b>		<b>3.</b>				
GASQUET COMPLEX		<b>Branch:</b>		<b>Division/Group:</b>		
<b>2. Operational Period:</b> 0600 - 0600				<b>H/L/N/V - PEAK FIRE</b>		
Date/Time From: 08/15/2015 0600 SAT	Date/Time To: 08/16/2015 0600 SUN					
<b>4. Operations Personnel</b>						
<b>OPERATIONS CHIEF</b>	DERRICK DAVIS DARRELL MILLER	<b>DIVISION/GROUP SUPERVISOR</b>	CANDICE KUTROSKY PAUL MANDOLINI (T)			
<b>PLANNING OPS</b>	MATT CONKLIN AARON THOMPSON (T)	<b>AIR ATTACK SUPERVISOR</b>	CLIFF CLARIDGE KEN MCLAUGHLIN			
<b>5. Resources Assigned this Period</b>						
Strike Team / Task Force / Resource Designator	LWD	Leader	Number Persons	Drop Off PT./Time	Pick Up PT./Time	
TFLD STEVE SISCOE O-79	08/20		1	ICP/0630	ICP/1900	
ENG6 GRAND JUNCTION BR 3 E-151			3	ICP/0630	ICP/1900	
ENG6 MONTROSE HELL FIGHTERS E-148	08/26	JASON HOBBY	3	ICP/0630	ICP/1900	
ENG6 LAKE DILLON 8 E-150	08/26	DENNIS JACKSON	2	ICP/0630	ICP/1900	
WTT2 AFD-WT1 E-158	08/27	STEVEN BERG	1	ICP/0630	ICP/1900	
WTS2 TRAYNHAM TRUCKING E-137	08/25	DAVE DAMON	1	ICP/0630	ICP/1900	
FAL1 MILLER TIMBER O-204	08/22	CHRIS GOODSON	2	ICP/0630	ICP/1900	
FEMP MATT LUCAS O-137	08/20		1	ICP/0630	ICP/1900	
FEMT TONY CASTANEDA O-131	08/20		1	ICP/0630	ICP/1900	
<b>6. Control Operations/Work Assignments:</b>						
<ul style="list-style-type: none"> <li>• KEEP FIRE NORTH AND EAST OF G-O ROAD IF POSSIBLE. • FOLLOW THE MINIMUM REQUIREMENT DIRECTION OF 8-14-15.</li> </ul>						
<b>7. Special Instructions:</b>						
<ul style="list-style-type: none"> <li>• ALL RESOURCES USE CALL SIGN "LIMA"</li> <li>• COORDINATE AND ORDER AIRCRAFT FOR <b>WATER ONLY</b> DROPS WITH AIR ATTACK.</li> <li>• MONITOR SUMMIT &amp; WILLIAMS FIRES BY AIR</li> <li>• RAPID EXTRACTION MODULE (R.E.M.) AVAILABLE TO ALL DIV'S &amp; GRP'S.</li> <li>• DO NOT FILL WATER FROM COMMUNITY OF HIOUCHI FIRE HYDRANTS.</li> <li>• FOBS SCHEID / RICK / BAERTSCHI (T) WORKING IN DIV H / L / N / V.</li> </ul>						
<b>8. Division/Group Communication Summary</b>						
Function	Channel	RX Frequency N/W	RX Tone/NAC	TX Frequency N/W	TX Tone/NAC	Mode
COMMAND	1	167.1000	162.2	169.7500	162.2	A
TACTICAL	8	168.0500	162.2	168.0500	162.2	A
BACKUP NET	4	168.1250		170.4750	127.3	A
AIR TO GROUND	10	165.3875		165.3875		A
<b>9. Prepared By (Resource Unit Leader)</b>		<b>Approved By (Planning Section Chief)</b>		<b>Date</b>	<b>Time</b>	
JACOB HUGHES		DAVE LATTIMORE		08/14/2015	2100	

## Division/Group Assignment List (ICS 204 WF)

<b>1. Incident Name:</b>			<b>3.</b>			
GASQUET COMPLEX			<b>Branch:</b>		<b>Division/Group:</b>	
<b>2. Operational Period:</b> 0600 - 0600					<b>W - FEEDER FIRE</b>	
Date/Time From: 08/15/2015 0600 SAT	Date/Time To: 08/16/2015 0600 SUN					
<b>4. Operations Personnel</b>						
<b>OPERATIONS CHIEF</b>		DERRICK DAVIS DARRELL MILLER		<b>DIVISION/GROUP SUPERVISOR</b>		GLENN WEBB AL WARD (T)
<b>PLANNING OPS</b>		MATT CONKLIN AARON THOMPSON (T)		<b>AIR ATTACK SUPERVISOR</b>		CLIFF CLARIDGE KEN MCLAUGHLIN
<b>5. Resources Assigned this Period</b>						
Strike Team / Task Force / Resource Designator		LWD	Leader	Number Persons	Drop Off PT./Time	Pick Up PT./Time
HC2I WHITE MOUNTAIN #1 C-3		08/19	KEITH M SARGENT	19	ICP/0630	ICP/1900
TFLD HYATT O-144 / OLEARY O-234		08/16		2	ICP/0630	ICP/1900
ENG3 TIMBER MESA 7213 E-143		08/27	JERROD AMATOR	3	ICP/0630	ICP/1900
ENG3 UTAH FIRE 16A E-32		08/20	KRISTA SPRAYCAR	3	ICP/0630	ICP/1900
ENG3 PICTURE ROCK 121 E-26		08/20	ROCKY ORTIZ	4	ICP/0630	ICP/1900
ENG6 TONTO 1247 E-82		08/16	SHAWN O'CONNELL	7	ICP/0630	ICP/1900
ENG6 LYONS 4031 E-159		08/27	NICOLE PALESTRO	3	ICP/0630	ICP/1900
HEQB HARRIS O-218 / ALLEN III (T) O-260		08/25		2	ICP/0630	ICP/1900
DOZ2 A TEAM 1 E-127		08/24	PETE GIRARONO	4	ICP/0630	ICP/1900
EXCA WALBERG, INC E-57		08/24	DAVE MCDONALD	2	ICP/0630	ICP/1900
SKG2 YOUNG LOGGING E-154		08/27	PAUL ARBOGAST	2	ICP/0630	ICP/1900
WTT2 SRF 15 E-45		08/16	JACOB MC ADAMS	2	ICP/0630	ICP/1900
WTT2 GASQUET VFD E-88		08/15	SALENA COX	2	ICP/0630	ICP/1900
FAL1 NORTH ZONE FALLERS #3 O-96		08/18	RICK MEE	2	ICP/0630	ICP/1900
<b>6. Control Operations/Work Assignments:</b>						
<ul style="list-style-type: none"> <li>• CONTINUE TO PREP, SECURE &amp; HOLD FIRE ALONG 14N39 RD FROM DP 30 NORTH TO THE 14N39G RD.</li> </ul>						
<b>7. Special Instructions:</b>						
<ul style="list-style-type: none"> <li>• ORDER AIRCRAFT FOR RETARDANT NEEDS WITH AIR ATTACK. * DO NOT FILL WATER FROM COMMUNITY OF HIOUCHI FIRE HYDRANTS.</li> <li>• RAPID EXTRACTION MODULE (R.E.M.) AVAILABLE TO ALL DIVISIONS AND CONTINGENCY GROUP.</li> </ul>						
<b>8. Division/Group Communication Summary</b>						
Function	Channel	RX Frequency N/W	RX Tone/NAC	TX Frequency N/W	TX Tone/NAC	Mode
COMMAND	1	167.1000	162.2	169.7500	162.2	A
TACTICAL	12	166.5500	162.2	166.5500	162.2	A
BACKUP NET	4	168.1250		170.4750	127.3	A
AIR TO GROUND	10	165.3875		165.3875		A
<b>9. Prepared By (Resource Unit Leader)</b>			<b>Approved By (Planning Section Chief)</b>		<b>Date</b>	<b>Time</b>
JOE SCURI (T)			DAVE LATTIMORE		08/14/2015	2100

## Division/Group Assignment List (ICS 204 WF)

<b>1. Incident Name:</b>			<b>3.</b>			
GASQUET COMPLEX			<b>Branch:</b>		<b>Division/Group:</b>	
<b>2. Operational Period:</b> 0600 - 0600			<b>Z - FEEDER FIRE</b>			
Date/Time From: 08/15/2015 0600 SAT		Date/Time To: 08/16/2015 0600 SUN				
<b>4. Operations Personnel</b>						
<b>OPERATIONS CHIEF</b>		DERRICK DAVIS DARRELL MILLER		<b>DIVISION/GROUP SUPERVISOR</b>		ADAM KOHLEY ROBERT ALLAN (T)
<b>PLANNING OPS</b>		MATT CONKLIN AARON THOMPSON (T)		<b>AIR ATTACK SUPERVISOR</b>		CLIFF CLARIDGE KEN MCLAUGHLIN
<b>5. Resources Assigned this Period</b>						
Strike Team / Task Force / Resource Designator		LWD	Leader	Number Persons	Drop Off PT./Time	Pick Up PT./Time
HC1 SMITH RIVER C-29		08/23	TIM MEMMER	19	ICP/0630	ICP/1900
HC2I NHS#1 C-4		08/19	JOHN ROSS	20	ICP/0630	ICP/1900
HCM SLATE MOUNTAIN O-245		08/26	STEVE REYES	10	ICP/0630	ICP/1900
TFLD LOWE O-76 / ARCHULETA O-264		08/19		2	ICP/0630	ICP/1900
ENG3 LONE PEAK 1667 E-27		08/19	TOM WILSON	7	ICP/0630	ICP/1900
ENG3 BLACK HILLS 381 E-146		08/26	BRANDON SELK	5	ICP/0630	ICP/1900
ENG3 HOOPA 9533 E-174		08/27	AARON WILLIAMS	5	ICP/0630	ICP/1900
ENG4 BITTER LAK E2044 E-164		08/28	JOSHUA GONZALES	4	ICP/0630	ICP/1900
ENG6 GRAND COUNTY 6802 E-36		08/19	MARK MARCUM	2	ICP/0630	ICP/1900
ENG6 SUNDANCE BR3 E-169		08/25	DANA LAW	3	ICP/0630	ICP/1900
--- <td></td> <td></td> <td></td> <td></td> <td></td>						
<b>8. Division/Group Communication Summary</b>						
Function	Channel	RX Frequency N/W	RX Tone/NAC	TX Frequency N/W	TX Tone/NAC	Mode
COMMAND	1	167.1000	162.2	169.7500	162.2	A
TACTICAL	9	168.6000	162.2	168.6000	162.2	A
BACKUP NET	4	168.1250		170.4750	127.3	A
AIR TO GROUND	10	165.3875		165.3875		A
<b>9. Prepared By (Resource Unit Leader)</b>			<b>Approved By (Planning Section Chief)</b>		<b>Date</b>	<b>Time</b>
JOE SCURI (T)			DAVE LATTIMORE		08/14/2015	2100

## Division/Group Assignment List (ICS 204 WF)

<b>1. Incident Name:</b>			<b>3.</b>			
GASQUET COMPLEX			Branch:		Division/Group:  <b>Z - FEEDER FIRE</b>	
<b>2. Operational Period:</b> 0600 - 0600						
Date/Time From: 08/15/2015 0600 SAT		Date/Time To: 08/16/2015 0600 SUN				
<b>4. Operations Personnel</b>						
<b>OPERATIONS CHIEF</b>		DERRICK DAVIS DARRELL MILLER		<b>DIVISION/GROUP SUPERVISOR</b>		ADAM KOHLEY ROBERT ALLAN (T)
<b>PLANNING OPS</b>		MATT CONKLIN AARON THOMPSON (T)		<b>AIR ATTACK SUPERVISOR</b>		CLIFF CLARIDGE KEN MCLAUGHLIN
<b>5. Resources Assigned this Period</b>						
Strike Team / Task Force / Resource Designator		LWD	Leader	Number Persons	Drop Off PT./Time	Pick Up PT./Time
HEQB ANDERSON O-215 / DOZ2 JA COOK E-170		08/24		3	ICP/0630	ICP/1900
WTT1 DB JET E-156		08/28	RUSS BERGETTE	2	ICP/0630	ICP/1900
WTT1 TENDR 1121 E-157		08/16	DAN CANO	2	ICP/0630	ICP/1900
WTS2 BOWNE WATER SERVICE E-40		08/17	MICHAEL BOONE	1	ICP/0630	ICP/1900
FAL1 CECIL LOGGING O-203		08/22	MICHEAL BERRY	2	ICP/0630	ICP/1900
SOFR PETE VILLA O-68		08/19		1	ICP/0630	ICP/1900
<b>6. Control Operations/Work Assignments:</b>						
<ul style="list-style-type: none"> <li>• SECURE DOZER / HANDLINE FROM G-O ROAD TO W / Z BREAK.</li> <li>• SECURE LINE CONSTRUCTION FROM MOST SOUTHERN POINT OF FEEDER FIRE SOUTH TO THE G-O RD.</li> </ul>						
<b>7. Special Instructions:</b>						
<ul style="list-style-type: none"> <li>• COORDINATE AND ORDER AIRCRAFT FOR RETARDANT NEEDS WITH AIR ATTACK.</li> <li>• RAPID EXTRACTION MODULE (R.E.M.) AVAILABLE TO ALL DIVISIONS AND CONTINGENCY GROUP.</li> <li>• DO NOT FILL WATER FROM COMMUNITY OF HIOUCHI HYDRANTS.</li> </ul>						
<b>8. Division/Group Communication Summary</b>						
Function	Channel	RX Frequency N/W	RX Tone/NAC	TX Frequency N/W	TX Tone/NAC	Mode
COMMAND	1	167.1000	162.2	169.7500	162.2	A
TACTICAL	9	168.6000	162.2	168.6000	162.2	A
BACKUP NET	4	168.1250		170.4750	127.3	A
AIR TO GROUND	10	165.3875		165.3875		A
<b>9. Prepared By (Resource Unit Leader)</b>			<b>Approved By (Planning Section Chief)</b>		<b>Date</b>	<b>Time</b>
JOE SCURI (T)			DAVE LATTIMORE		08/14/2015	2100

## Division/Group Assignment List (ICS 204 WF)

<b>1. Incident Name:</b>				<b>3.</b>			
GASQUET COMPLEX				Branch:		Division/Group:	
<b>2. Operational Period: 0600 - 0600</b>				<b>CONTENGENCY GROUP</b>			
Date/Time From: 08/15/2015 0600 SAT		Date/Time To: 08/16/2015 0600 SUN					
<b>4. Operations Personnel</b>							
<b>OPERATIONS CHIEF</b>		DERRICK DAVIS DARRELL MILLER		<b>DIVISION/GROUP SUPERVISOR</b>		JEREMY COWIE BRIAN FABBRI (T)	
<b>PLANNING OPS</b>		MATT CONKLIN AARON THOMPSON (T)		<b>AIR ATTACK SUPERVISOR</b>		CLIFF CLARIDGE KEN MCLAUGHLIN	
<b>5. Resources Assigned this Period</b>							
Strike Team / Task Force / Resource Designator		LWD	Leader	Number Persons	Drop Off PT./Time	Pick Up PT./Time	
TFLD JON OLSEN O-233		08/24		1	ICP/0630	ICP/1900	
ENG3 PASO 3110 E-160		08/26	DAVID JR YOWELL	3	ICP/0630	ICP/1900	
ENG6 NATIONAL 204 E-149		08/26	LEENKUN BACA	3	ICP/0630	ICP/1900	
CHIP CECIL 1 E-130		08/25	JUSTIN CECIL	2	ICP/0630	ICP/1900	
CHIP COASTAL TREE SERVICE E-131		08/24	JOHN DILLON	2	ICP/0630	ICP/1900	
<b>6. Control Operations/Work Assignments:</b>							
<ul style="list-style-type: none"> <li>• COORDINATE WITH SOPL TO VALIDATE LONG TERM PLANS.</li> <li>• COORDINATE CHIPPING ACTIVITIES WITH ALL DIVISIONS.</li> </ul>							
<b>7. Special Instructions:</b>							
<ul style="list-style-type: none"> <li>• RAPID EXTRACTION MODULE (R.E.M.) AVAILABLE TO ALL DIVISIONS AND CONTINGENCY GROUP</li> <li>• REVIEW CHIPPER JHA.</li> <li>• DO NOT FILL WATER FROM COMMUNITY OF HIOUCHI FIRE HYDRANTS</li> <li>• FOBS - PENNY / MASTERS.</li> </ul>							
<b>8. Division/Group Communication Summary</b>							
Function	Channel	RX Frequency N/W	RX Tone/NAC	TX Frequency N/W	TX Tone/NAC	Mode	
COMMAND		SEE COMM PLAN					
TACTICAL							
BACKUP NET							
AIR TO GROUND							
<b>9. Prepared By (Resource Unit Leader)</b>			<b>Approved By (Planning Section Chief)</b>			<b>Date</b>	<b>Time</b>
JOE SCURI (T)			DAVE LATTIMORE			08/14/2015	2100



<b>MEDICAL PLAN</b>	1. INCIDENT NAME <b>Gasquet Complex</b>	2. DATE PREPARED 8/14/15	3. TIME PREPARED 1730	4 OPERATIONAL PERIOD 8/15-16/2015 0600-0600
---------------------	--	-----------------------------	--------------------------	---

5. INCIDENT MEDICAL AID STATIONS				
MEDICAL AID STATIONS		LOCATION		PARAMEDIC
Medical Supply		Base Camp		YES NO
				X

**TRANSPORTATION**

A. Air Ambulances				
NAME	ADDRESS	PHONE	PARAMEDIC	
National Guard H-825 (Day/Night, Hoist)	Redding Airport, CA	Communications	X	
CHP H-14 (Day/Night, Hoist)	Redding Airport, CA	(530) 842-3515	X	
Coast Guard (Day/Night, Hoist)	Air Station Humboldt Bay, CA	(707) 839-6100		X
Cal Fire Kneeland Helitack H-102 (Hoist)	Kneeland Station, CA	(707) 441-2863		X
Reach 5 Air Medical	Redding, CA	1-800-338-4045	X	
Mercy Air Ambulance 105	Medford, Oregon	1-800-903-9000	X	
PHI Air Medical	Redding, CA	1-800-597-9571	X	

B. Ground Ambulances				
Hoopla Ambulance	Base Camp/Fireline	Communications	X	
Del Norte Ambulance, Station 2	2600 Morehead Rd Crescent City CA	Communications	X	

**7. HOSPITALS**

NAME	ADDRESS	TRAVEL TIME		PHONE	HELIPAD		BURN CENTER	
		AIR	GRND		YES	NO	YES	NO
Sutter Coast Hospital	800 E Washington Crescent City CA. N. 41 46.454 x W 124 11.537		25min	ER: 707-464-8888 Gen: 707-464-8511		X		X
Mercy Med. Center Level 3 Trauma	914 Pine St. Mt. Shasta, CA. N. 40 34.14 x W. 122 23.97	45m	4.5hr	(530)926-9360	X			X
Rogue Valley Med Center L- 2 Trauma/STEMI/Stroke	2825 Barnett Rd. Medford, OR. N. 42 19.092 W. 122 49.833	30m	2 hr	(541)789-7100	X			X
UC Davis Med Center Level 1 Trauma Burn Center	2315 Stockton Blvd. Sacramento, CA N. 38 33.3 x W. 121 27.3	2hr	7.0hr	(916) 734-3636 Burn Center (916) 734-3790 ER	X		X	

**8. MEDICAL EMERGENCY PROCEDURES**

**In the event of a medical emergency provide the following information to your Division or Gasquet Communications on Command.**

1. Declare the nature of the emergency.
  - a. Medical injury/illness?
  - b. Is injury/illness life threatening?
2. If life threatening, then request that the designated frequency be cleared for emergency traffic.
3. Identify the on-scene Point of Contact (POC) by resource and last name (i.e POC is TFLD Smith).
4. Identify nature of incident, number injured, patient assessment(s) and location (geographic and GPS coordinates).
5. Identify on-scene medical personnel by position and name (i.e EMT Jones).
6. Identify preferred method of patient transport.
7. Request any additional resources and/or equipment needed
8. Document all information received and transmitted on the radio or phone.
9. Identify any changes in the on-scene Point of Contact or medical personnel as they occur.

**INJURY REPORTING PROCEDURES**

NATURE OF INJURY \_\_\_\_\_ # of Patients \_\_\_\_\_

TRANSPORTATION NEEDED Air \_\_\_\_ Ground \_\_\_\_\_

REM Needed Y \_\_\_\_ N \_\_\_\_ Estimated Air Temp \_\_\_\_\_

LAT \_\_\_\_\_ LONG \_\_\_\_\_ Elevation \_\_\_\_\_

Specific Hazards In Area \_\_\_\_\_

PATIENT UNIT ID \_\_\_\_\_

REMINDER: DO NOT GIVE PT NAME OVER RADIO

IS MEDICAL PERSONNEL WITH PATIENT: YES \_\_\_\_ NO \_\_\_\_

AGE \_\_\_\_ SEX: MALE \_\_\_\_ FEMALE \_\_\_\_

**ALL EMERGENCIES—Secure the area and identify witnesses for later investigation. Keep an accurate log of events.**

ICS 206 8-78	9. PREPARED BY (MEDICAL UNIT LEADER) Gena Fowlkes MEDL (909) 762-9032	10. REVIEWED BY (SAFETY OFFICER) James Aragon SOF
--------------	--	--

## INCIDENT RADIO COMMUNICATIONS PLAN (ICS 205)

1. Incident Name: <b>GASQUET COMPLEX</b>		2. Date/Time Prepared: Date: 08/14/2015 Time: 2100		3. Operational Period: 0600 - 0600		Date/Time From: 08/15/2015 0600	SAT	Date/Time To: 08/16/2015 0600	SUN	
4. Basic Radio Channel Use:										
Zone Group	Ch #	Function	Channel Name/Trunked Radio System Talkgroup	Assignment	RX Freq	RX Tone/NAC	TX Freq	TX Tone/NAC	Mode (A,D, or M)	Remarks
	1	COMMAND	CMD 1	ALL DIVISIONS	167.1000	162.2	169.7500	162.2	A	SHIP MTN
	2	COMMAND	CMD 2	UNASSIGNED	000.0000		000.0000		A	
	3	COMMAND	CMD 3	UNASSIGNED	000.0000		000.0000		A	
	4	BACKUP NET	SRF ADM	ALL DIVISIONS	168.1250		170.4750	127.3	A	GORDON MTN
	5	TACTICAL	NIFC T5	DIV C	166.7250	162.2	166.7250	162.2	A	
	6	TACTICAL	NIFC T6	DIV E	166.7750	162.2	166.7750	162.2	A	
	7	TACTICAL	NIFC T7	DIV G	168.2500	162.2	168.2500	162.2	A	
	8	TACTICAL	NIFC T1	DIV H/L/N/V	168.0500	162.2	168.0500	162.2	A	CALL SIGN DIV L
	9	TACTICAL	NIFC T3	DIV Z	168.6000	162.2	168.6000	162.2	A	
	10	AIR TO GROUND	A/G TAC	ALL DIVISIONS	165.3875		165.3875		A	
	11	AIR TO GROUND	A/G CMD	UNASSIGNED	000.0000		000.0000		A	
	12	TACTICAL	R5 TAC 4	DIV W	166.5500	162.2	166.5500	162.2	A	
	13	TACTICAL	R5 TAC 5	DIV A	167.1125	162.2	167.1125	162.2	A	
	14	TACTICAL	R5 TAC 6	DIV D	168.2375	162.2	168.2375	162.2	A	
	15	EMS TAC	CALCORD	ALL DIVISIONS	156.0750		156.0750	156.7	A	MEDICAL A/G
	16	AIR GUARD	GUARD	ALL DIVISIONS	168.6250		168.6250	110.9	A	EMERGENCY ONLY
	20	AIR GUARD	GUARD	ALL DIVISIONS	168.6250		168.6250	110.9	A	EMERGENCY ONLY
6. Prepared By		(Communications Unit Leader)			Name: CHRIS PERRY (T)		Signature: 		Date/Time: 08/14/2015 2100	
ICS 205				IAP Page						

DRAFT

**AIR OPERATIONS SUMMARY**

PREPARED BY: Ted Visser



PREPARED DATE/TIME: 08/14/15 1900

1. INCIDENT NAME: Gasquet Complex      2. OPERATIONAL PERIOD DATE: 08/15/15      START TIME: 0700      END TIME: 2000      SUNRISE: 0625      SUNSET: 2018

3. REMARKS (Safety Notes, Hazards, Air Operations Special Equipment, etc.)  
 Thunderstorms, erratic winds. Low wires, cables, power lines.  
 Divisions, contact Helibase for all aviation needs, include coordinates of possible helispot/unimproved landing locations.  
 Possible smoke concerns.      Bear Fire Div E,      41 48.928      123 44.678  
 Track all retardant usage and location if used.      Coon Fire Div C,      41 45.786      123 57.709  
 Do not dip from lakes near 41 35.000 x 123 43.00      Feeder Fire Div W,      41 35.065      123 50.726  
 IP for Air Tankers 41 47.21 X 123 04.40      5000'      Peak Fire Div L,      41 33.065      123 46.134  
 Cave HB Gate 10155#      Summit Fire Div V,      41 35.000      123 47.800  
 Six Rivers Disp. Air Desk 707-726-1266      Williams Fire Div H,      41 35.290      123 45.621

4. MEDEVAC  
 A/C: 512

5. TER: 5/0539  
 Radius: 10 NM  
 Altitude: 9000 MSL  
 Centerpoint: N 41 41.57  
 W 123 49.05  
 Illinois Valley Tower Freq: 133.275

6. PERSONNEL      Phone      7. FREQUENCIES      AM      FM

AOBD: Ted Visser      619-981-2409      AIR/AIR FW:           166.4500  
 ASGS: Galen Young      575-574-8720      AIR/AIR RW:      128.0750  
 ASGS(T): Ken Ostrom      307-272-3266

ATGS: Ken McLaughlan      813-997-0317      AIR/GROUND CMD:      165.3875  
 AIR/GROUND TAC:

ATGS: Cliff Claridge      480-688-5330      COMMAND: RX:      167.1000  
 TX:      169.7500  
 Tone 15 162.2

HEB1: Melvin Tate      850-849-0405

HEB1(T): Rita Clipperton      530-559-0905      DECK:      163.100

SEAT MGR: Jose Rosales      541-417-2361  
 SEAT MGR: Crystal Henson      707-599-5345      AIR GUARD:      168.6250

9. HELICOPTERS (Use Additional Sheets As Necessary)

FAA N#	TY	MAKE/MODEL	BASE	AVAILABLE	START	REMARKS	FAA N#	TY	MAKE/MODEL	BASE	AVAILABLE	START	REMARKS
HT-702	1	S-61	Cave	0730	0830	A-20							
HT-782	1	S-64	Cave	0730	0830	A-58							
512	2	Bell 212	Cave	0730	0830	A-42							
988B	3	Bell L4	Cave	0730	0830	A-28							

10. TASK/MISSION/ASSIGNMENT (Type/Function Includes: Air Tactical, Retardant, Recon, Personnel Transport, Water Dropping, S&R, etc.)

TYPE/FUNCTION	NAME OF PERSONNEL OR CARGO (if applicable) OR INSTRUCTIONS FOR TACTICAL AIRCRAFT	MISSION START	FLY FROM	FLY TO
Bucket drops per request	Division Sup. To request and coordinate with Air Attack or helibase.			
Recon Flights	To be approved by OPS or AOB			
Cargo / Sling	Per Request from Div Sups, all sling loads / crew shuttles			
Ops Recon				
Div Sup Recon				
DIPSITES	River Dip 41 44.150 X 123 59.02    Whiskey Dip 41 39.240 X 123 39.690    Buck Dip 41 48.894 X 123 41.335 Bear Dip 41 50.487 X 123 46.359    Feeder Dip 41 36.831 X 123 51.810			
Nickowitz Fire Fred's	Air to Air FW 164.7500 Air to Air RW 126.075			
Nickowitz Ar Ops: Brian Drinville 530-627-3208	Air to Ground 164.8625 Command 2 173.0375 Rx 67.3250 Tx Tone 127.3			



## Incident within an Incident Action Plan

### When the scope or complexity of the emergency exceeds division resource needs

This plan is designed to identify the initial actions that should be taken by the first arriving personnel on a serious accident. This person may be a single resource, engine boss, or a crew boss. Accidents or incidents within an incident happen rapidly and require sound, calm initial decisions to handle the problem, while still focusing on the main incident. The following checklist provides some key thoughts and actions.

The first arriving person to any accident should notify their Division Supervisor, or the Div Sup assigned to that location.

#### **Advise of the critical information needed:**

- Accident scene safety assessment and advise incoming personnel
- Number of injuries and their severity
- Special equipment needs (extrication, low/high angle rescue, fire protection or suppression)
- Assist the injured as necessary without endangering yourself or other personnel
- Do not move trauma victims unless their safety is in jeopardy
- Utilize PINK pages of the Incident Response Pocket Guide (IRPG) for patient assessment/medical procedures

#### **Remain aware of surroundings and delegate personnel to monitor the main fire**

The **Division Supervisor** will assume command of the accident/incident scene upon arrival. The following list outlines the general duties and tasks that should be completed on most accidents/incidents.

1. Delegate division oversight to another Division Supervisor or other qualified person.
2. Request a clear frequency from Comm and consider switching to designated Emergency Tactical (Incident Comm will notify the MEDL who will initiate the medical plan for injuries)
3. Order/delegate resources appropriate for the accident/incident (crew EMT's, Line EMT's or Line Medics, rescue equipment, patient transport needs, manpower)
4. Notify Operations Section Chief and Safety Officer on all accidents/incidents.
5. Begin to document the event accurately and completely. Use ICS form 201 if the event is large or complex.
6. Protect the scene for Investigators

Reference the full Incident Medical Emergency Plan for additional



## Incident within an Incident Action Plan

### Position Assignment Supportive Actions

#### Division Supervisor

- See items 1-6 on page one
- If unable to access accident/incident location, delegate command to a closer qualified resource

#### Medical Unit Leader

- Respond to Comm Unit as soon as possible
- Coordinate with Division Supervisor to ensure proper resources are rapidly ordered
- Assign a MEDL to the scene and other positions to support the response as needed
- Monitor condition updates of patient(s) and coordinate response with Operations

#### Communications Unit Leader

- Maintain clear radio traffic and monitor communications to support response
- Recommend appropriate security and investigative process
- Assess the need for critical Incident Stress Response

#### Safety Officer

- Provide for Safety personnel on scene as needed
- Recommend appropriate security and investigative process
- Assess the need for critical Incident Stress Response

#### Air Attack Supervisor

- Obtain coordinates of the emergency location
- Coordinate air-medical response
- Assist and support the designated Point of Contact with communications and coordination of the emergency response as necessary

#### IC, Command & General Staff

- Manage the emergency and direct specific responsibilities to individual positions to provide an appropriate response
- Notify the host unit and host dispatch center of the size-up information
- Constantly monitor and assess the appropriate response and adapt direction as needed
- Submit all documentation pertaining to the emergency to the Plans Chief

Reference the full Incident Medical Emergency Plan for additional



## Health & Safety Message

<b>Incident:</b> Gasquet Complex CA-SRF-001488	<b>Date/Op Period:</b> 8/15/15 0600-0600 DAY SHIFT
---	---

### Hazards & Risks

**Firefighter Health:** With multiple days of working on the fireline; cuts, abrasions, rashes and blisters are accumulating on your body. Prevent infections by washing your hands often, take daily showers, wash or change your clothes frequently and care for minor wounds each shift. Treatment early-on will help prevent larger medical problems later!

### **Fire Order # 6: Be Alert, Keep Calm, Think Clearly, Act Decisively**

As fatigue and complacency set in with multiple days on the fire, this fire order can be challenging to meet. Taking frequent rest breaks, eating plenty of fruits & vegetables, and staying hydrated can help alleviate the signs & symptoms of cumulative fatigue. Watch out for each other.

### **Watchout # 11: Unburned fuel between you and the main fire**

A lot of indirect fireline is being constructed on the fire. Use strategically placed lookouts to keep you informed on fire behavior and weather factors. Use hourly weather readings to monitor changing conditions. Give serious and realistic considerations to the location of escape routes and safety zones.

### **Final Reminders:**

Review medical plan and brief it to crews.  
 Look up, down & around for stuff that can hurt you.  
 Drive carefully & SLOW DOWN.  
 Work within the limits of your qualifications & abilities.  
 Evaluate risk & minimize guess work.

<b>Prepared By:</b> Paul Tompkins SOFR2	<b>Approved:</b> Dave Kelly, Deputy IC
---	--

**L.** Lookouts    **C.** Communications    **E.** Escape Routes    **S.** Safety Zones

BE MINDFUL

## INCIDENT SAFETY ANALYSIS 215a

Gasquet Complex - Saturday 8/15/2015

8. Location	9. Hazard	6. Control or Abatement Action (Engineering, Administrative, PPE, Avoidance, Education, etc)
All	Hazard Trees	<ul style="list-style-type: none"> <li>~ Follow "Hazard Tree Safety" guidelines, IRPG pages 22 &amp; 23</li> <li>~ Post lookouts, or use a spotter in mop-up areas with personnel</li> <li>~ Don't park vehicles or take breaks in high concentrations of hazard trees</li> <li>~ Establish trigger points for disengagement during high wind events</li> </ul>
All	Air Operations	<ul style="list-style-type: none"> <li>~ Follow "Aviation Watch-Out Situations" on page 44, IRPG</li> <li>~ Don't plan on air resources for medical transport or resupply.</li> <li>~ Refer to page 57, IRPG for directing bucket drops.</li> <li>~ Ensure positive communication with all air resources.</li> </ul>
All	Chain Saw Operations	<ul style="list-style-type: none"> <li>~ Follow "Hazard Tree Safety" guidelines, IRPG pages 22 &amp; 23</li> <li>~ Look up, down around for hazard tree indicators</li> <li>~ Only fell and buck trees within your expertise, and training</li> <li>~ Follow "Procedural Felling Operations" on page 79 in IRPG</li> <li>~ Do not fall trees during high wind events</li> </ul>
All	Steep Terrain & Rolling Debris	<ul style="list-style-type: none"> <li>~ Maintain 8'-10' spacing when working &amp; walking</li> <li>~ Don't work above any personnel</li> <li>~ Evaluate necessity to send personnel in areas with limited access</li> </ul>
All	Driving & Traffic	<ul style="list-style-type: none"> <li>~ Practice "Defensive Driving" techniques traveling on all roads and city streets, mitigation strategy includes:               <ul style="list-style-type: none"> <li>~ Use spotters when backing</li> <li>~ Honk horn to alert personnel when backing</li> <li>~ Always use headlights</li> <li>~ Yield to pedestrians and bicycles</li> <li>~ Observe posted speed limits</li> <li>~ Follow 3 second rule of following distance when driving</li> <li>~ Use chock blocks, turn wheels into hill</li> </ul> </li> </ul>
All	Firing Operations & Devices	<ul style="list-style-type: none"> <li>~ Only personnel trained in the use of each device will be authorized to use firing equipment.</li> <li>~ Ensure all personnel are aware of firing operation that may affect them.</li> <li>~ Wear appropriate PPE.</li> <li>~ Ensure aerial/ground ignition plans have been adequately developed and personnel are briefed.</li> </ul>
All	Injury & Medical Emergency	<ul style="list-style-type: none"> <li>~ Assist injured employee appropriate medical care</li> <li>~ Use EMT's on Division for initial care</li> <li>~ Follow medical protocol as outlined in ICS-206</li> </ul>
All	Bees, Ticks, Mosquitoes	<ul style="list-style-type: none"> <li>~ Be aware of crew members with sting allergies.</li> <li>~ Ensure crew members have medication pens if needed.</li> <li>~ Perform daily self inspection</li> <li>~ Use repellent as necessary</li> </ul>
All	Poisonous Plants	<ul style="list-style-type: none"> <li>~ Identify and Avoid hazard areas</li> <li>~ Launder clothing</li> <li>~ Shower frequently</li> </ul>
A,C,E,W,D,G	Heavy Equipment Operations	<ul style="list-style-type: none"> <li>~ Ensure communications are established with operators</li> <li>~ Use hand signals if other communications are unavailable</li> <li>~ Maintain a 50'-100' exclusion area around equipment</li> <li>~ Use a spotter when backing</li> </ul>



## Resources Up For Demob as 08/14/2015

REQUEST NUMBER	RESOURCE NAME	ITEM CODE	DEMOMB DATE
E-75	LKP 5031	ENG3	08/15/2015
E-76	SRM 331	ENG3	08/15/2015
E-77	CRK 379	ENG3	08/15/2015
E-78	GASQUET 214	ENG2	08/15/2015
O-149	SCOTT, JAISY	PTRC	08/15/2015
O-150	BALENT, SHEILA	EQTR	08/15/2015
O-238	PALMER, DAVID	AADM	08/15/2015
C-30	STEELHEAD	HC2	08/16/2015
E-82	TONTO 1247	ENG6	08/16/2015
E-86	AMERICAN FIRE CO 61	ENG6	08/16/2015
E-87	WOOD'S WT 99	WTT2	08/16/2015
E-88	GASQUET VFD	WTT2	08/16/2015
E-114	FIRESTORM 03	ENG4	08/16/2015
E-115	ASI 3	ENG6	08/16/2015
E-116	CENTERAL WILDFIRE 741	ENG4	08/16/2015
E-118	DARE ENTERPRISES 32	ENG6	08/16/2015
O-88	WINN, DOUGLAS	FACL	08/16/2015
O-148	WYATT, JANICE	CAMP	08/16/2015
O-207	DEVLIN, BRENDA	THSP	08/16/2015
O-208	MCCAINE, MIKE	THSP	08/16/2015
O-262	MOSEY, KERI	CAMP	08/16/2015
O-276	FREDERICK, MICHAEL	AREP	08/16/2015
O-285	WHITNEY, DAVID	LSC2	08/16/2015
E-45	SRF WT15	WTT2	08/17/2015
E-157	TENDR 1121	WTT1	08/17/2015
O-42	MCDANIEL, KOREY	SEC1	08/17/2015
O-144	HYATT, CHAD	TFLD	08/17/2015
O-145	WEBB, GLENN	DIVS	08/17/2015
O-281	HENSON, CRYSTAL	SEMG	08/17/2015
C-1	DELTA 2	CC	08/18/2015
E-6	ED STAUB & SONS	FT	08/18/2015
E-8	LAWRENCE T PETERSON	MEC	08/18/2015
E-9	TONYS EQUIPMENT REPAIR	MEC	08/18/2015
E-10	GROOMS, JACK	PU	08/18/2015
E-11	MCCULLOUGH CONSTRUCTION	PU	08/18/2015
E-12	NEWMAN, CRAIG R FORESTRY	DRIV	08/18/2015
E-14	SUSAN E PARTIDA	PU	08/18/2015
E-40	BOWNE WATER SERVICE	WTS2	08/18/2015
E-41	49ER	WTS2	08/18/2015
O-1	THOMPSON, AARON	OSC2	08/18/2015
O-2	HERNANDEZ, FRED	SOF2	08/18/2015
O-113	SMITH, SHAWN	EQPM	08/18/2015
O-146	BERG, DOUG	SOFR	08/18/2015
O-185	MASTERS, JOHN	FOBS	08/18/2015
O-229	INGRAM, TRENT	DIVS	08/18/2015
O-280	ROSALES, JOSE	SEMG	08/18/2015



## Human Resource and Training Message

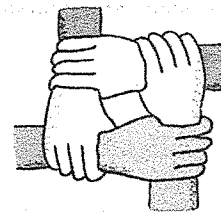

### Diversity

The concept of diversity encompasses acceptance and respect. The "Where are you From" map was a great opportunity to visualize our diversity. In two hours we received 247 names and places on our map. Thank you to everyone that was able to participate. The map represents the success we have while coming together with a common purpose. This is true in all aspects of life and you are all great examples of how it is done well!

The raffle prize winners are:

1. Andrew Ripple, Fortuna, CA
2. David Kelly, Twin Peaks, CA
3. Spencer Johnson, Lake Port, CA
4. Even Tiss, CA

Please call Andrea at 707-330-9939 OR come to the HR trailer at ICP to collect your prize. (Prizes were personally donated by SoCal2).

### Training Message

**THANKS TO ALL TRAINER/EVALUATORS AND TRAINEES**

Receiving quality training and documenting your training are very important. Everyone on the assignment depend on it.

**If you are demobing on or before Monday, August 17**

**DON'T WAIT UNTIL THE LAST MINUTE**

**See the Training Specialist with:**

1. **Trainee Exit Interview Form:** Filled out by the Trainee
2. **Position Task Book:** With Evaluator input done
3. **ICS-225 Incident Personnel Performance Rating**

**Ann Hutchinson (Training Specialist)**  
**Next check-in/demob**  
**or call 623-293-8628**

1 Gasquet  
N Complex

CA-SRF-001488

Transportation MAP

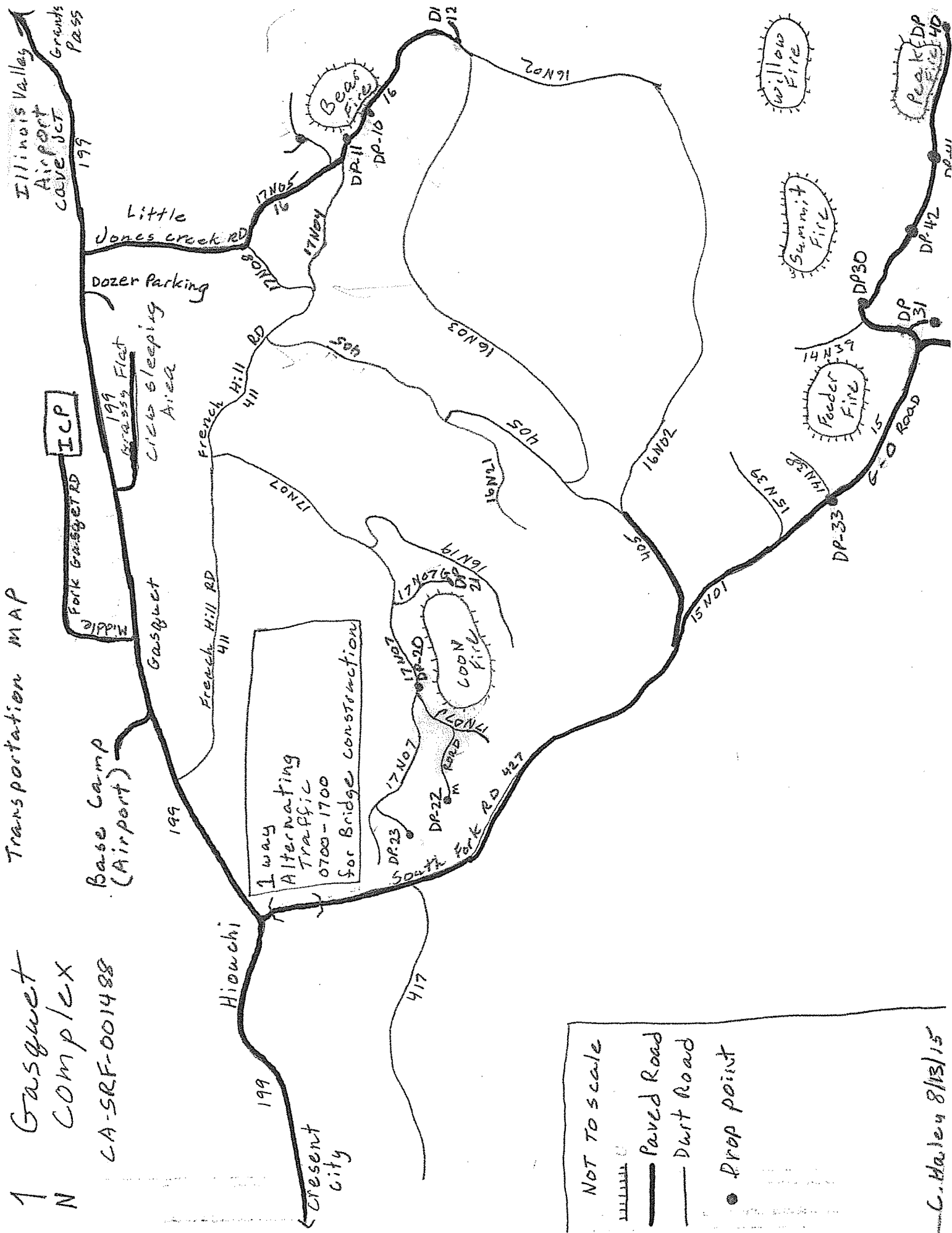

NOT TO SCALE

- Paved Road
- Dirt Road
- Drop point

C. Halesy 8/13/15

# GASQUET COMPLEX BASE CAMP

Updated 08/10/2015

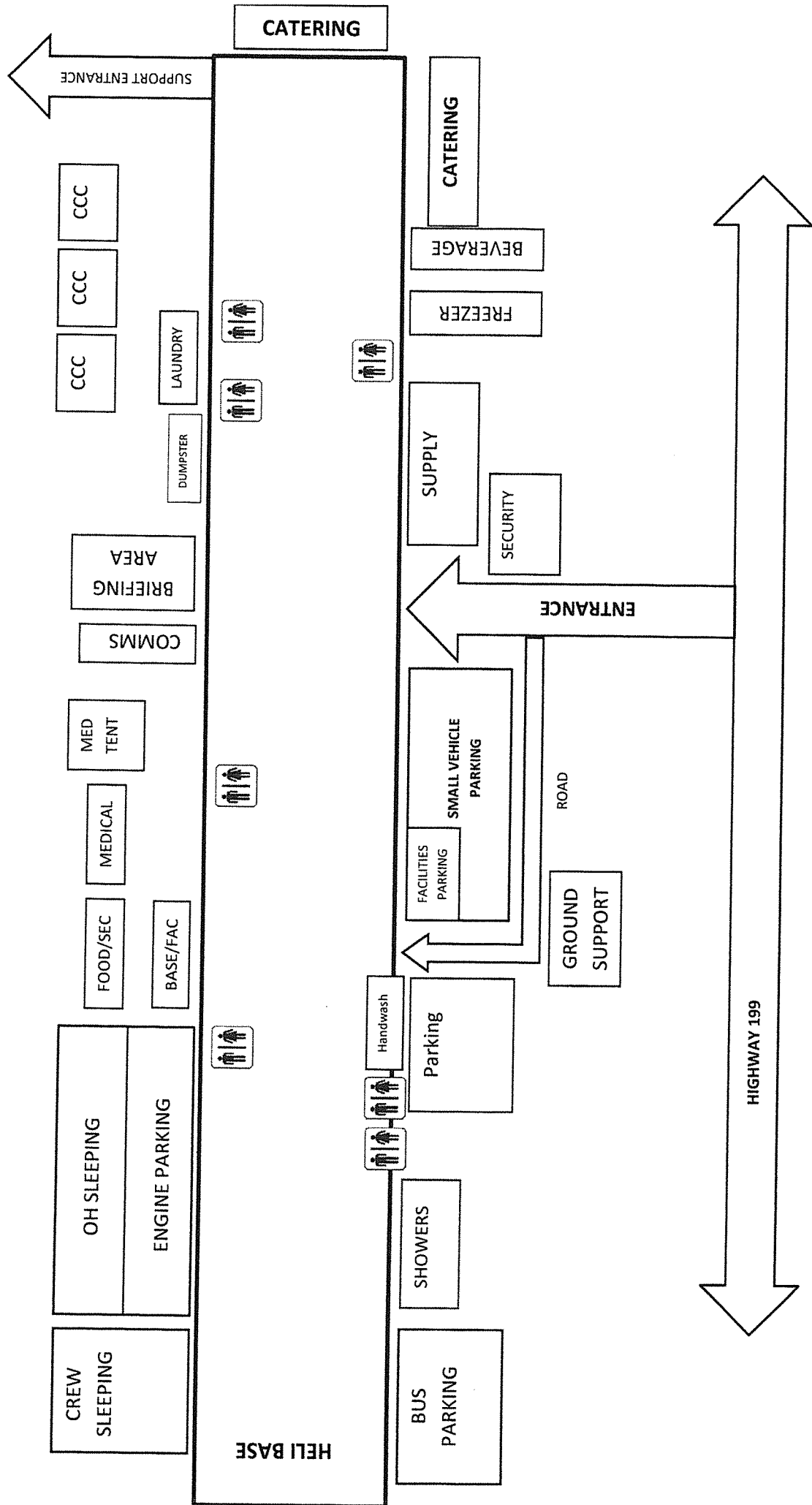
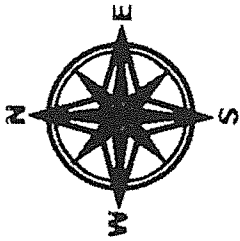

# ICP

**Mountain School**  
 55 Azalea Lane  
 Gasket, CA 95543  
 (707) 457-3211

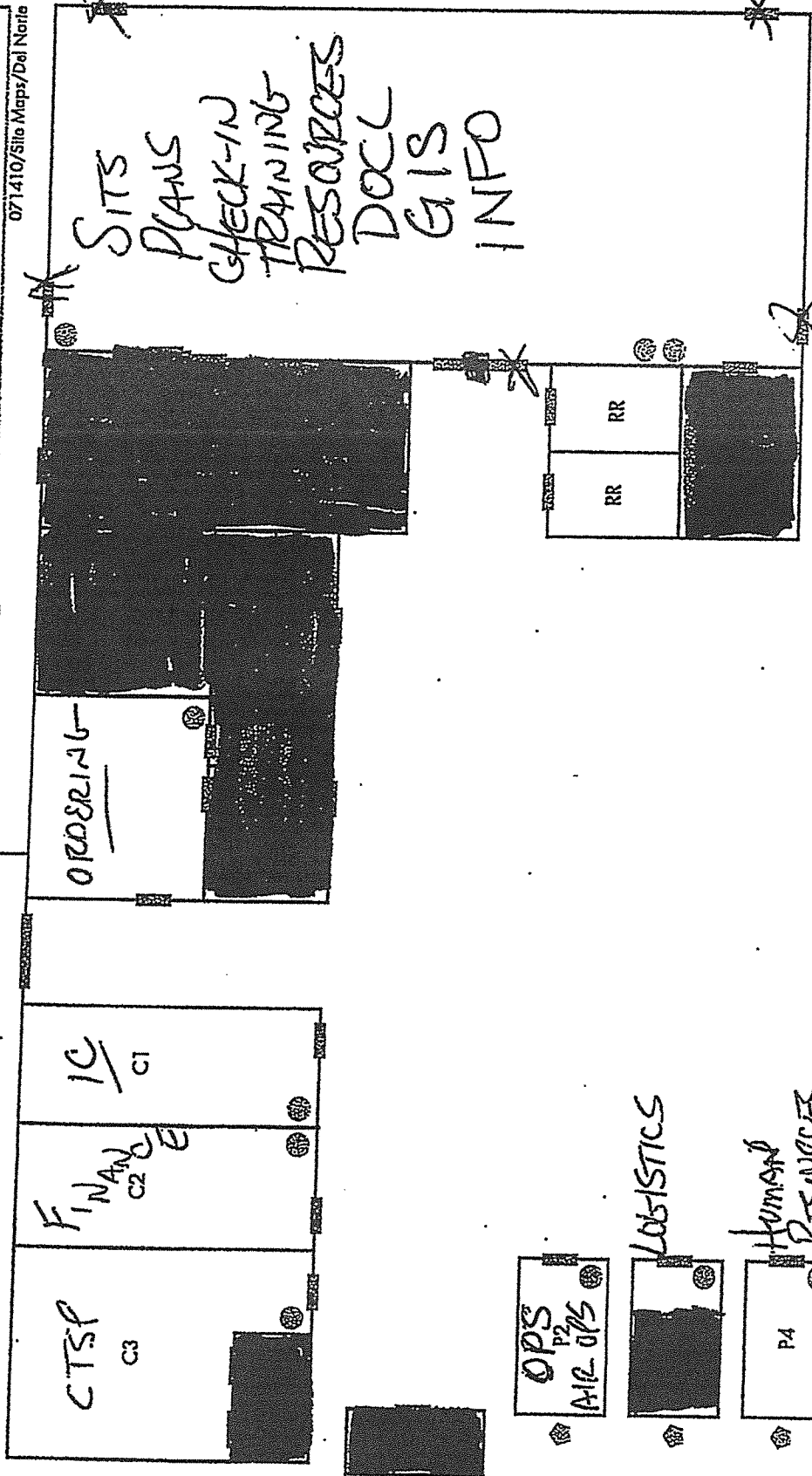
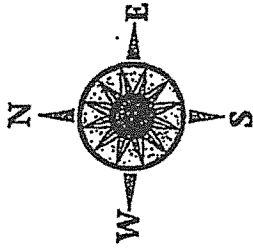

P	Portable	Fire Alarm Panel
C	Classroom	Water Shut Off
	Exit/Door	Electrical Shut Off
	Fire Extinguisher	

- OPS P2 AIR OPS
- LOGISTICS
- HUMAN RESOURCES P4

As of 8/7/2015

