

Incident Action Plan

Pony Fire
CA KNF - 004500
P5J90 -0505



DAY SHIFT
June 10, 2016
0600 - 1800

INCIDENT OBJECTIVES	1. Incident Name Pony	2. Date 6/09/2016	3. Time 2000
4. Operational Period 6/10/2016 0600-1800			
5. General Control Objectives for the Incident (include alternatives) Management Objectives: <ul style="list-style-type: none"> • Ensure that strategies and tactics provide for firefighter and public safety through the application of sound risk management principles. • Minimize the cost of the incident by employing tactics that have the highest probability of success. • Avoid negative fire effects on the landscape especially within the Crawford project area by minimizing fire intensity where feasible. • Establish and strengthen cooperator, partner, and stakeholder relationships. Control Objectives: <p>Pony Fire</p> <ul style="list-style-type: none"> • Keep the fire out of the North Fork of Dillon Creek by keeping the fire east of the dozer line that runs from Pony Peak and Elbow Spring. • Minimize spread to the north by keeping the fire south of the 15N19 Road from Elbow Springs to Dry Lake Staging. • Keep the fire out of the Coon Creek drainage by keeping it west of the dozer line that runs from Dry Creek Staging south to Highway 96. • Minimize impacts to Highway 96 by keeping the fire west of the highway. <p>Dillon Fire</p> <ul style="list-style-type: none"> • Continue to implement a direct attack strategy where it is safe to do so. 			
6. Weather Forecast for Period See attached forecast			
7. General Safety Message See attached safety message			
8. Attachments (mark if attached)			
<input checked="" type="checkbox"/> Organization List - ICS 203	<input checked="" type="checkbox"/> Medical Plan - ICS 206	<input checked="" type="checkbox"/> Weather	
<input checked="" type="checkbox"/> Div. Assignment Lists - ICS 204	<input checked="" type="checkbox"/> Incident Map	<input checked="" type="checkbox"/> Safety Message	
<input checked="" type="checkbox"/> Communications Plan - ICS 205	<input type="checkbox"/> Traffic Plan	<input checked="" type="checkbox"/> LCES Worksheet	
9. Prepared by (Planning Section Chief) Jeff Buscher	10. Approved by (Incident Commander) Rick Young		

Spot Forecast for Pony Fire

National Weather Service Medford

305 PM PDT Thu Jun 9 2016

.DISCUSSION...

AN UPPER LEVEL TROUGH WILL BRING CONTINUED COOLING OF THE AIR MASS TO THE BURN SITE THURSDAY INTO FRIDAY. HUMIDITY RECOVERY WILL ALSO BE GOOD. THE TROUGH WILL MOVE THROUGH FRIDAY INTO SATURDAY. WHILE THERE IS A SLIGHT CHANCE OF SHOWERS, MOST WILL REMAIN TO THE NORTH. EXPECT SUNDAY AND MONDAY TO MODERATE BACK TO NORMAL TEMPERATURE-WISE, BUT ANOTHER TROUGH COULD BRING COOLING AGAIN BY THE MIDDLE OF NEXT WEEK.

.FRIDAY...June 10, 2016

SKY/WEATHER.....PARTLY CLOUDY WITH A SLIGHT CHANCE OF SHOWERS.
MAX TEMPERATURE.....55-57.
MIN HUMIDITY.....37-42 PERCENT.
EYE LEVEL WINDS.....LIGHT NORTHWEST 0-2 MPH EARLY INCREASING TO 3-5
MPH WITH GUSTS TO 8 MPH IN THE AFTERNOON.
MIXING HEIGHT.....1000 FT AGL INCREASING TO 2500 FT AGL BY LATE
MORNING, THEN 4500 FT AGL EARLY IN THE AFTERNOON.
MIXING WINDS.....NORTHWEST 10-15 MPH.
CWR.....8 PERCENT.
LAL.....1.
WIND (20 FT).....LIGHT NORTHWEST 1-3 MPH INCREASING TO 4-7 MPH
WITH GUSTS TO 10 MPH.

.FRIDAY NIGHT...

SKY/WEATHER.....PARTLY CLOUDY.
MIN TEMPERATURE.....32-36.
MAX HUMIDITY.....90 PERCENT.
EYE LEVEL WINDS.....NORTH 3-5 MPH WITH GUSTS TO 8 MPH IN THE EVENING
BECOMING NORTHEAST 1-3 MPH OVERNIGHT.
MIXING HEIGHT.....3500 FT AGL LOWERING TO 1000 FEET AGL.
MIXING WINDS.....NORTH 10-15 MPH BECOMING NORTHEAST.
CWR.....0 PERCENT.
LAL.....1.
WIND (20 FT).....NORTH 4-7 MPH WITH GUSTS TO 10 MPH IN THE EVENING
BECOMING NORTHEAST 2-5 MPH OVERNIGHT.

.SATURDAY...June 11, 2016

SKY/WEATHER.....PARTLY CLOUDY.
MAX TEMPERATURE.....66-70.
MIN HUMIDITY.....25-30 PERCENT.
EYE LEVEL WINDS.....NORTHEAST 1-3 MPH EARLY BECOMING NORTH 3-5 MPH
WITH GUSTS TO 8 MPH IN THE AFTERNOON.
MIXING HEIGHT.....1000 FT AGL EARLY INCREASING TO 3000 FT AGL LATE
MORNING THEN NEAR 5000 FT AGL EARLY IN THE
AFTERNOON.
MIXING WINDS.....NORTH NORTHEAST 10-15 MPH.
CWR.....8 PERCENT.
LAL.....1.
WIND (20 FT).....LIGHT NORTHEAST 1-3 MPH BECOMING NORTH AND
INCREASING TO 4-7 MPH WITH GUSTS TO 10 MPH.

Spot Forecast for Dillon Fire

National Weather Service Medford

246 PM PDT Thu Jun 9 2016

.DISCUSSION...

AN UPPER LEVEL TROUGH WILL BRING CONTINUED COOLING OF THE AIR MASS TO THE BURN SITE THURSDAY INTO FRIDAY. HUMIDITY RECOVERY WILL ALSO BE GOOD. THE TROUGH WILL MOVE THROUGH FRIDAY INTO SATURDAY. WHILE THERE IS A SLIGHT CHANCE OF SHOWERS FRIDAY, MOST WILL REMAIN TO THE NORTH. EXPECT SUNDAY AND MONDAY TO MODERATE BACK TO NORMAL TEMPERATURE-WISE, BUT ANOTHER TROUGH COULD BRING COOLING AGAIN BY THE MIDDLE OF NEXT WEEK.

.FRIDAY...June 10, 2016

SKY/WEATHER.....PARTLY CLOUDY. SLIGHT CHANCE OF SHOWERS.
MAX TEMPERATURE.....65.
MIN HUMIDITY.....29-34 PERCENT.
EYE LEVEL WINDS.....LIGHT NORTH 0-1 MPH BECOMING NORTHWEST 2-4 MPH
(GUSTS TO 6 MPH IN THE AFTERNOON).
MIXING HEIGHT.....1000 FT AGL INCREASING TO 3500 FT AGL LATE
MORNING THEN 5500 FT AGL EARLY IN THE AFTERNOON.
MIXING WINDS.....NORTHWEST 10-15 MPH.
CWR.....3 PERCENT.
LAL.....1.
WIND (20 FT).....LIGHT NORTH 1-3 MPH BECOMING NORTHWEST 4-6 MPH IN
THE AFTERNOON.

.FRIDAY NIGHT...

SKY/WEATHER.....PARTLY CLOUDY.
MIN TEMPERATURE.....AROUND 40.
MAX HUMIDITY.....90 PERCENT.
EYE LEVEL WINDS.....NORTH 2-4 MPH (GUSTS TO 6 MPH) IN THE EVENING
BECOMING NORTHEAST 0-2 MPH OVERNIGHT.
MIXING HEIGHT.....4500 FT AGL LOWERING TO 1000 FEET AGL.
MIXING WINDS.....NORTH 10-15 MPH BECOMING NORTHEAST.
CWR.....0 PERCENT.
LAL.....1.
WIND (20 FT).....NORTH 4-6 MPH IN THE EVENING BECOMING NORTHEAST
2-4 MPH OVERNIGHT.

.SATURDAY...June 11, 2016

SKY/WEATHER.....PARTLY CLOUDY.
MAX TEMPERATURE.....74.
MIN HUMIDITY.....19-24 PERCENT.
EYE LEVEL WINDS.....NORTHEAST 0-2 MPH EARLY BECOMING NORTH 2-4 MPH
(GUSTS TO 6 MPH IN THE AFTERNOON).
MIXING HEIGHT.....1000 FT AGL EARLY INCREASING TO 4000 FT AGL LATE
MORNING THEN NEAR 6000 FT AGL EARLY IN THE
AFTERNOON.
MIXING WINDS.....NORTH NORTHEAST 10-15 MPH.
CWR.....0 PERCENT.
LAL.....1.
WIND (20 FT).....LIGHT NORTHEAST 1-2 MPH BECOMING NORTH AND
INCREASING TO 4-6 MPH.

FIRE BEHAVIOR FORECAST

FORECAST NUMBER: 2	TYPE OF FIRE: Wildland Fire
FIRE NAME: Pony & Dillon Fires	OPERATIONAL PERIOD: 0600 – 1800, June 10, 2016
DATE ISSUED: June 9, 2016	TIME ISSUED: 2000
UNIT: Happy Camp R.D. Klamath N.F.	SIGNED: <i>Isi Teresa Riesenhuber</i> , FBAN-t

INPUTS

WEATHER SUMMARY: *** See attached Spot Weather Forecasts ***

Discussion: The upper level trough continues to bring a cooler air mass into Friday with good overnight humidity recovery (70-90%). Pony Fire daytime humidity up about 5-10% and temperatures down about 10° from Thursday. Dillon Fire little change in humidity but temps drop about 5°.

Weather: Partly cloudy, slight chance of showers

Max Temp: 55 – 57°

Min RH: 37 – 42%

Winds (20 foot): NW 1-3 mph increasing to 4-7 with gusts to 10 mph

Live Fuel Moisture (manzanita): 150% **1000 hr fuels:** 9%

FIRE BEHAVIOR

GENERAL

Higher humidity and lower daytime temperatures will continue to moderate fire behavior thru Friday compared to earlier this week. Expect the fire to lay low until late morning/early afternoon when the winds pick up and inversion lifts. Primary fire spread for the Pony Fire is backing with occasional roll-out and short upslope runs on the west side of Swillup Creek. Heavies will continue to burn down and preheat the live fuels.

Dutch Indy RAWS ERC for June 8 = 60.

POI 50%, **Flame lengths** 2 – 7 feet, **Rate of Spread** 4 – 10 ch/hr, **Spotting Potential** 1/10 mile

SPECIFIC FIRE BEHAVIOR

Division A: The fire will continue to flank and roll-out into Elliot Creek. Predicted NW winds in the afternoon should keep smoke and embers from crossing the fireline.

Division C: Once the fire crosses Swillup Creek there could be alignment with winds and slope, combined with dense brush and regeneration conifers intermixed with heavy slash.

Division B, D, H: Fire not expected to reach your division today.

Dillion: High RH and low temps should enhance containment and mop-up efforts.

AIR OPERATIONS



Air operations may be limited until mid-morning due to smoke settling in valleys and canyons. Expect the inversions to burn off mid-morning.

Sunrise: 05:38



Sunset: 20:48



SAFETY

Post or relocate lookouts in multiple locations as the fire grows and moves into new terrain. The Pony Fire has been backing downslope for several days, some parts of the main fire are moving more quickly than others. Changes in slope could change fire behavior and spread direction. Know where you are in relation to the fire and have a plan for escape should the need arise.

DIVISION ASSIGNMENT LIST		1. Branch		2. Division/Group A 1 of 2		
3. Incident Name Pony		4. Operational Period Date: June 10, 2016 Time: 0600 - 1800				
5. Operations Personnel						
Operations Chief	Scott Lucas		Division/Group Supervisor		Heather Grove / Matt Watson (t)	
Planning Ops.	Eric Petterson		Air Operations Branch Dir.		Dennis Kuster	
6. Resources Assigned this Period						
Strike Team/Task Force/ Resource Designator	Leader	LWD	Number Persons	Trans. Needed	Drop Off PT./Time	Pick Up PT./Time
HC1 Klamath IHC	SMYTH		18	N	Dry Lake Staging 0700	1800
HC1 Ukonom IHC	Keith Smith		20	N	Dry Lake Staging 0700	1800
HC1 Modoc IHC C1	Willy Almand	6/21	19	N	Dry Lake Staging 0700	1800
HC1 Baker River IHC C-13	Kurt Ranta	6/21	20	N	Dry Lake Staging 0700	1800
HC2IA Salyer			20	N	Dry Lake Staging 0700	1800
HC2IA Grayback C-1'0	Timothy Brewer	6/21	20	N	Dry Lake Staging 0700	1800
ENG3 ST6604C	Jim Snow / Richard Wicgand (t)	6/21	27	N	Dry Lake Staging 0700	1800
ENG3 LNF 82	BUTTERBATCH		5	N	Dry Lake Staging 0700	1800
DOZ2 KNF DZ1	MURIEEN/TUPMAN		2	N	Dry Lake Staging 0700	1800
DOZ3 Kev's w/LOWB E-13	Carlson		2	N	Dry Lake Staging 0700	1800
EXCA2 North Rivers E-71	Billy Parry	6/23	1	N	Dry Lake Staging 0700	1800
WT2 Let Er Buck E-26	Steve Lassen	6/22	1	N	Dry Lake Staging 0700	1800
WT2T KNF 21			5	N	Dry Lake Staging 0700	1800
7. Control Operation						
<ul style="list-style-type: none"> Reopen road and dozer line between Elbow Springs and Pony Peak. Prep for firing. 						
8. Special Instructions:						
<ul style="list-style-type: none"> Scout direct suppression tactics where feasible 						
9. Division Group Communication Summary						
Function	Channel	Channel Name	RX Frequency N/W	RX Tone	TX Frequency N/W	TX Tone
Command	1	NIFC C1	168.7000		170.9750	110.9 Tone 1
Tactical	4	NIFC T1	168.0500		168.0500	
Air - Ground CMD	13	A/G CMD	167.9500		167.9500	
Air - Ground TAC	14	A/G TAC	166.6750		166.6750	
Prepared by (Resource Unit Leader) Duane Miller 		Approved by (Planning Section Chief) Jeff Buscher 			Date June 9, 2016	

DIVISION ASSIGNMENT LIST		1. Branch	2. Division/Group A 2 of 2			
3. Incident Name Pony		4. Operational Period Date: June 10, 2016 Time: 0600 - 1800				
5. Operations Personnel						
Operations Chief	Scott Lucas	Division/Group Supervisor	Heather Grove / Matt Watson (t)			
Planning Ops.	Eric Petterson	Air Operations Branch Dir.	Dennis Kuster			
6. Resources Assigned this Period						
Strike Team/Task Force/ Resource Designator	Leader	LWD	Number Persons	Trans. Needed	Drop Off PT./Time	Pick Up PT./Time
FALM ATF	Moen / Moen		2	N	Dry Lake Staging 0700	1800
FALM Miller Wood	Lefit / Osago		2	N	Dry Lake Staging 0700	1800
TFLD	Robert Hilfer	6/22	1	N	Dry Lake Staging 0700	1800
TFLD (t)	Eric Husmann	6/22	1	N	Dry Lake Staging 0700	1800
HEQB O-33	Ty Isbell	6/22	1	N	Dry Lake Staging 0700	1800
SOFR	Martinez		1	N	Dry Lake Staging 0700	1800
FEMP O-95	Scott Scardina	6/22	1	N	Dry Lake Staging 0700	1800
FEMT O-96	Dave Moncada	6/22	1	N	Dry Lake Staging 0700	1800
7. Control Operation						
<ul style="list-style-type: none"> • Reopen road and dozer line between Elbow Springs and Pony Peak. • Prep for firing. 						
8. Special Instructions:						
<ul style="list-style-type: none"> • Scout direct suppression tactics where feasible 						
9. Division Group Communication Summary						
Function	Channel	Channel Name	RX Frequency N/W	RX Tone	TX Frequency N/W	TX Tone
Command	1	NIFC C1	168.7000		170.9750	110.9 Tone 1
Tactical	4	NIFC T1	168.0500		168.0500	
Air - Ground CMD	13	A/G CMD	167.9500		167.9500	
Air - Ground TAC	14	A/G TAC	166.6750		166.6750	
Prepared by (Resource Unit Leader) Duane Miller		Approved by (Planning Section Chief) Jeff Buscher			Date June 9, 2016	

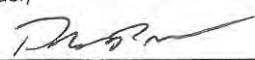
DIVISION ASSIGNMENT LIST		1. Branch		2. Division/Group B 1 of 2		
3. Incident Name Pony		4. Operational Period Date: June 10, 2016 Time: 0600 - 1800				
5. Operations Personnel						
Operations Chief	Scott Lucas		Division/Group Supervisor	Tom Browning / Issac Flatley (t)		
Planning Ops.	Eric Petterson		Air Operations Branch Dir.	Dennis Kuster		
6. Resources Assigned this Period						
Strike Team/Task Force/ Resource Designator	Leader	LWD	Number Persons	Trans. Needed	Drop Off PT./Time	Pick Up PT./Time
HC1 Tallac IHC C-7	Kyle Betty	6/20	19	N	Dry Lake Staging 0700	1800
HC1 Horseshoe C-16			20	N	Dry Lake Staging 0700	1800
HC2IA Karuk 1 C-3	Kenji Okazaki	6/20	20	N	Dry Lake Staging 0700	1800
HC2IA Zephyr C-11	Matt Fogarty	6/21	19	N	Dry Lake Staging 0700	1800
HC2 Pat NCC C-18	Weston Smith	6/21	20	N	Dry Lake Staging 0700	1800
ENG3 KNF 326	Cortes		5	N	Dry Lake Staging 0700	1800
ENG3 LKR 82			5	N	Dry Lake Staging 0700	1800
WT1 Cattle Lack E-68	Robert Buck	6/22	1	N	Dry Lake Staging 0700	1800
WT2 Tobiasson Water Trucking E-23	Raynold Tobiasson	6/22	1	N	Dry Lake Staging 0700	1800
WT2 E-25			1	N	Dry Lake Staging 0700	1800
WT2 KNF 17 E-51			2	N	Dry Lake Staging 0700	1800
WT3 Let Er Buck E-10	Dickson Pierce	6/22	2	N	Dry Lake Staging 0700	1800
7. Control Operation						
<ul style="list-style-type: none"> • Prep road from A/B break towards Div C. • Construct indirect line to improve control line location. 						
8. Special Instructions:						
9. Division Group Communication Summary						
Function	Channel	Channel Name	RX Frequency N/W	RX Tone	TX Frequency N/W	TX Tone
Command	1	NIFC C1	168.7000		170.9750	110.9 Tone 1
Tactical	6	NIFC T3	168.6000		168.6000	
Air - Ground CMD	13	A/G CMD	167.9500		167.9500	
Air Ground TAC	14	A/G TAC	166.6750		166.6750	
Prepared by (Resource Unit Leader) Duane Miller 		Approved by (Planning Section Chief) Jeff Buscher 			Date June 9, 2016	

DIVISION ASSIGNMENT LIST		1. Branch		2. Division/Group B 2 of 2		
3. Incident Name Pony		4. Operational Period Date: June 10, 2016 Time: 0600 - 1800				
5. Operations Personnel						
Operations Chief	Scott Lucas		Division/Group Supervisor	Tom Browning / Issac Flatley (t)		
Planning Ops.	Eric Petterson		Air Operations Branch Dir.	Dennis Kuster		
6. Resources Assigned this Period						
Strike Team/Task Force/ Resource Designator	Leader	LWD	Number Persons	Trans. Needed	Drop Off PT./Time	Pick Up PT./Time
FALM North Zone Faller O-109	Allen Stewart / Gary Burg	6/22	2	N	Dry Lake Staging 0700	1800
FALM	Woodman / Holloway		2	N	Dry Lake Staging 0700	1800
TFLD O-28	Gordon Meyer	6/21	1	N	Dry Lake Staging 0700	1800
SOF2 O-7	Chris Church	6/23	1	N	Dry Lake Staging 0700	1800
FEMP O-94	Scott Moder	6/22	1	N	Dry Lake Staging 0700	1800
FEMT O-98	Daniel Hart	6/22	1	N	Dry Lake Staging 0700	1800
ARCH O-54	Zach Rodriguez	6/20	1	N	Dry Lake Staging 0700	1800
FOBS O-60	John Donahue	6/20	1	N	Dry Lake Staging 0700	1800
FOBS O-61	Troy Maquire	6/23	1	N	Dry Lake Staging 0700	1800
7. Control Operation						
<ul style="list-style-type: none"> • Prep road from A/B break towards Div C. • Construct indirect line to improve control line location. 						
8. Special Instructions:						
9. Division Group Communication Summary						
Function	Channel	Channel Name	RX Frequency N/W	RX Tone	TX Frequency N/W	TX Tone
Command	1	NIFC C1	168.7000		170.9750	110.9 Tone 1
Tactical	6	NIFC T3	168.6000		168.6000	
Air - Ground CMD	13	A/G CMD	167.9500		167.9500	
Air Ground TAC	14	A/G TAC	166.6750		166.6750	
Prepared by (Resource Unit Leader) Duane Miller 		Approved by (Planning Section Chief) Jeff Buscher 			Date June 9, 2016	

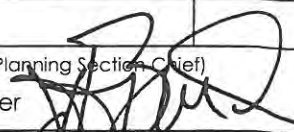
DIVISION ASSIGNMENT LIST		1. Branch		2. Division/Group C 1 of 2			
3. Incident Name Pony		4. Operational Period Date: June 10, 2016 Time: 0600 - 1800					
5. Operations Personnel							
Operations Chief	Scott Lucas		Division/Group Supervisor		Heather McRae / Brian Bates (t)		
Planning Ops.	Eric Petterson		Air Operations Branch Dir.		Dennis Kuster		
6. Resources Assigned this Period							
Strike Team/Task Force/ Resource Designator	Leader	LWD	Number Persons	Trans. Needed	Drop Off PT./Time	Pick Up PT./Time	
HC1 Mendocino IHC C-4	Chris Markey	6/22	19	N	Dry Lake Staging 0700	1800	
HC1 Smith River IHC C-14	Doug Denlinger	6/16	21	N	Dry Lake Staging 0700	1800	
HC2IA Firestorm	Field		20	N	Dry Lake Staging 0700	1800	
HC2IA GFP 15B	Cambell		20	N	Dry Lake Staging 0700	1800	
HC2 Slide Mtn. C-12	Eric Derrash	6/22	20	N	Dry Lake Staging 0700	1800	
HC Crew 506 A-7	Glenn Dietz	6/20	10	N	Dry Lake Staging 0700	1800	
ENG3 ST3646C E-6	Roy Jones	6/21	27	N	Dry Lake Staging 0700	1800	
ENG3 SRF 31	Nicholson		5	N	Dry Lake Staging 0700	1800	
DOZ2 Bob Johnson w/LOWB E-14	Jonathan Ferreira	6/22	2	N	Dry Lake Staging 0700	1800	
DOZ2 Carlson Const. w/LOWB E-70	Doug Bishop	6/22	2	N	Dry Lake Staging 0700	1800	
WT2 Cattle Lack E-28	Virgil Hardy	6/22	1	N	Dry Lake Staging 0700	1800	
WT3 Allie Water Service E-7	Michael St. Germain	6/22	1	N	Dry Lake Staging 0700	1800	
7. Control Operation							
<ul style="list-style-type: none"> Prepare road and dozer line from Dry Lake to Hwy 96 for firing. 							
8. Special Instructions:							
<ul style="list-style-type: none"> Scout the Progeny site and look for point protection opportunities. Work to keep fire out of Crawford project area. 							
9. Division Group Communication Summary							
Function	Channel	Channel Name	RX Frequency N/W	RX Tone	TX Frequency N/W	TX Tone	
Command	1	NIFC C1	168.7000		170.9750	110.9 Tone 1	
Tactical	7	NIFC T5	166.7250		166.7250		
Air - Ground CMD	13	A/G CMD	167.9500		167.9500		
Air Ground TAC	14	A/G TAC	166.6750		166.6750		
Prepared by (Resource Unit Leader) Duane Miller 		Approved by (Planning Section Chief) Jeff Buscher 			Date June 9, 2016		

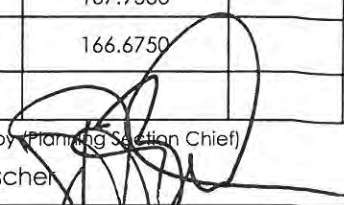
DIVISION ASSIGNMENT LIST		1. Branch		2. Division/Group H		
3. Incident Name Pony		4. Operational Period Date: June 10, 2016 Time: 0600 - 1800				
5. Operations Personnel						
Operations Chief	Scott Lucas		Division/Group Supervisor		James Lico / Bryan Johnson (t)	
Planning Ops.	Eric Petterson		Air Operations Branch Dir.		Dennis Kuster	
6. Resources Assigned this Period						
Strike Team/Task Force/ Resource Designator	Leader	LWD	Number Persons	Trans. Needed	Drop Off PT./Time	Pick Up PT./Time
HC2IA Crew 3 C-19	David McCarville	6/21	21	N	DP 30 0700	1800
HC2 ASP C-17	Clarence Gahagan	6/21	20	N	DP 30 0700	1800
HC2 GFP Ent. C-5	Jason Campbell	6/20	20	N	DP 30 0700	1800
DOZ2 Johnson w/LOWB E-15	Jim Johnson	6/23	2	N	DP 30 0700	1800
DOZ2 North Rivers w/LOWB E-69	Cody Carlson	6/23	2	N	DP 30 0700	1800
TFLD O-40	Bruce Jackson	6/22	1	N	DP 30 0700	1800
TFLD (t) O-105	Chris Voelker	6/22	1	N	DP 30 0700	1800
FEMP O-93	Dave Durham	6/22	1	N	DP 30 0700	1800
FEMT O-97	Matthew Maumdynier	6/22	1	N	DP 30 0700	1800
7. Control Operation						
<ul style="list-style-type: none"> Open 14N39 and dozer line from Hwy 96 to Pony Peak. Prepare for firing. 						
8. Special Instructions:						
<ul style="list-style-type: none"> Be cautious when working in and around Hwy 96. Establish a traffic plan once 14N39 is opened. 						
9. Division Group Communication Summary						
Function	Channel	Channel Name	RX Frequency N/W	RX Tone	TX Frequency N/W	TX Tone
Command	1	NIFC C1	168.7000		170.9750	110.9 Tone 1
Tactical	9	NIFC T7	168.2500		168.2500	
Air - Ground CMD	13	A/G CMD	167.9500		167.9500	
Air Ground TAC	14	A/G TAC	166.6750		166.6750	
Prepared by (Resource Unit Leader) Duane Miller 		Approved by (Planning Section Chief) Jeff Buscher 			Date June 9, 2016	

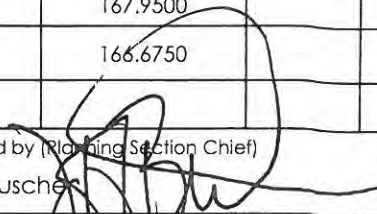
DIVISION ASSIGNMENT LIST		1. Branch		2. Division/Group Dillon		
3. Incident Name Pony		4. Operational Period Date: June 10, 2016 Time: 0600-1800				
5. Operations Personnel						
Operations Chief	Scott Lucas		Division/Group Supervisor		Mark Johnson	
Planning Ops.	Eric Petterson		Air Operations Branch Dir.		Dennis Kuster	
6. Resources Assigned this Period						
Strike Team/Task Force/ Resource Designator	Leader	LWD	Number Persons	Trans. Needed	Drop Off PT./Time	Pick Up PT./Time
HC1 Mill Creek IHC C-15	John Ellison	6/15	21	N	Dillon Spike	
HC1 Tahoe IHC			20	N	Dillon Spike	
HC Smokejumper Module			8	N	Dillon Spike	
FEMP	Sandler		1	N	Dillon Spike	
7. Control Operation <ul style="list-style-type: none"> Continue line construction. 						
8. Special Instructions:						
9. Division Group Communication Summary						
Function	Channel	Channel Name	RX Frequency N/W	RX Tone	TX Frequency N/W	TX Tone
Command	1	NIFC C1	168.7000		170.9750	110.9 Tone 1
Tactical	5	NIFC T2	168.2000		168.2000	
Air - Ground CMD	13	A/G CMD	167.9500		167.9500	
Air Ground TAC	14	A/G TAC	166.6750		166.6750	
Prepared by (Resource Unit Leader) Duane Miller 		Approved by (Planning Section Chief) Jeff Buscher 			Date June 9, 2016	

AIR OPERATIONS SUMMARY

Prepared By: Dennis Kuster

Prepared Date 6/9/2016

Prepared Time: 21:00

1. INCIDENT NAME: Pony Fire	2. OPS PERIOD DATE: 6/10/2016	START TIME: 0700	END TIME: 2100	SUNRISE: 0538	SUNSET: 2048
3. REMARKS (Safety Notes, Hazards, Air Operations, Special Equipment, etc.): Possible low wires & cables in river canyon. Independence Check Point 41° 39.57' x 123° 26.96' Dillon Check Point 41° 34.35' x 123° 32.30' Slippery Check Point 41° 41.847' x 123° 33.426'			4. READY ALERT AIRCRAFT MEDEVAC- H 506 I.A. - H 506		5. TFR #: 6/7/128 A-27 Radius 5NM Altitude 10,000 AGL Freq: 118.0250 Center Point 41° 37.11' 123° 33.185

6. PERSONNEL	NAME	PHONE #	7. FREQUENCIES	AM	FM	8. FIXED-WING- Type/ Make-Model/ N#/ Base
AOBD	Dennis Kuster	209-352-0855	AIR/ AIR FW	118.0250	169.2000	AIRTANKERS - Ordered by ATGS
ASGS	Staci Dickson	530-277-5153	AIR/ AIR RW	118.5750		LEAD PLANES- Ordered by ATGS
ASGS	Jim Gould	530-598-4132				AA-05
ATGS	Stew Richter	530-941-0499	AIR/ AIR RW- FF			AA-509
ATGS						AA-507
HEB2	Ray Wilson	707-472-8088	A/G Command		167.9500	KNF ECC Aircraft Dispatcher 530-841-4600
			A/G Tactical		166.6750	Siskiyou Tanker Base 530-459-5116/5453
Helibase	Happy Camp	530-493-1779	COMMAND Rx	See comm plan		OTHER FW AIRCRAFT-
Helibase	Scott Valley	530-468-1293/1294	DECK Tx		163.100	
Air Ops Desk			TOLC			

9. HELICOPTERS (Use Additional Sheets as Necessary)

FAA N#	TY	MAKE/ MODEL	BASE	AVAIL	START	REMARKS	FAA N#	TY	MAKE/ MODEL	BASE	AVAIL	START	REMARKS
		South							Forks				
502	2	Bell 205 A+	Scott Valley	0800									
506	2	Bell 205A+	Happy Camp	0800									
503	3	Bell 407	Happy Camp	0800									
HT 701	1	Sikorsky S61	Happy Camp	0800									
HT 702	1	Sikorsky S61	Happy Camp	0800									
HT 703	1	Sikorsky S61	Happy Camp	0800									

10. TASK/ MISSION/ ASSIGNMENT (Type/ function includes: Air Tactical, Retardant, Recon, Personnel Transport, Bucket Operations, SAR, etc.)

TYPE/FUNCTION	NAME OF PERSONNEL OR CARGO (If applicable) or instructions for tactical aircraft	MISSION START	FLY FROM	FLY TO
Water Dropping		As Needed		
Recon		As Needed		

INCIDENT RISK ANALYSIS (ICS 215a)

DIV	HAZARDOUS ACTIONS / CONDITIONS	MITIGATIONS / WARNINGS / REMEDIES
ALL	HAZARD TREES	<ul style="list-style-type: none"> Follow Hazard Tree Safety Guidelines (IRPG p. 22). Limit number of personnel around snags and their exposure time; fallers must be qualified for trees being fallen. Be especially alert around snags during wind events or changing wind direction. Check for hazard trees & "widow-makers" in sleeping areas prior to using. Maintain Situational Awareness.
ALL	FIRE BEHAVIOR	<ul style="list-style-type: none"> Review "Severe Fire Behavior Potential" (IRPG p.68). Monitor current weather conditions and forecasts. Make sure all personnel receive thorough briefings every shift. Be observant for formation and passage of thunder cells through or close to fire area and alert all personnel. Maintain adequate escape routes and safety zones. Advise all personnel if these are compromised or changed. Set trigger points when appropriate. Adhere to 10 Std Orders, mitigate 18 situations. Maintain Situational Awareness.
ALL	HYDRATION	<ul style="list-style-type: none"> Drinking water before, during and after shifts, up to 1.5 gal. per shift. Be alert for signs of heat disorder in yourself and others.
ALL	AIRCRAFT OPERATIONS	<ul style="list-style-type: none"> Wear all required PPE when being transported by helicopter. Follow all helitack instructions when approaching, loading, and unloading from the aircraft. Use qualified personnel for long-line operations. Keep others clear of the operation. Keep personnel out of drop zones when bucket work in progress. Use air-to-ground frequency to communicate with aircraft. Use clear, concise statements when directing aircraft. Use clock directions from pilot's perspective.
ALL	INDIRECT LINE CONSTRUCTION	<ul style="list-style-type: none"> Establish and maintain LCES. Locate line in favorable location, lighter fuels and gentler topography when possible. Utilize natural or existing barriers. If possible burn out or backfire as line construction progresses.
ALL	POISONOUS INSECTS, SNAKES	<ul style="list-style-type: none"> Identify, avoid, and get treatment for any bites or stings. Use caution (for bees, wasps, etc.) when drinking from opened cans. Watch your footing.

ALL	SAFETY ZONES	<ul style="list-style-type: none"> Follow safety zone guidelines (IRPG p. 8) Carefully evaluate burned areas before designation as safety zones due to spotty burning in numerous areas. When safety zones are distant from work site, set trigger points to allowing personnel to reach them in a timely manner.
ALL	MARIJUANA PLANTATIONS	<ul style="list-style-type: none"> Maintain situational awareness. Watch for open areas and sign of improvements or irrigation systems. Be aware of evidence that cultivation has occurred in the area. If you stumble upon an area with probable cultivation be extremely cautious, exit on the same route you arrived and notify supervisor immediately.
ALL	HEAVY EQUIPMENT/DOZERS	<ul style="list-style-type: none"> Utilize appropriate PPE and other equipment safety mechanisms. Maintain safe working distances. Utilize observer or spotter. Ensure the use of effective communication (radio, hand signals). Identify hazards.
ALL	COMMUNICATIONS	<ul style="list-style-type: none"> Share your Situational Awareness (hazards, changes, etc.) to those who also have a need. Answer questions when asked by others. Ask for intel if and when you don't know the plan. Ensure all personnel are familiar with the incident and IA communications plans.
ALL	ENVIRONMENTAL HAZARDS	<ul style="list-style-type: none"> Keep alert for wildlife, insects, and plants. Watch footing and hand placement around rocks. Keep food out of tents and from around sleeping areas to prevent wildlife night visits. Personal hygiene is #1 when it comes to Poison Oak Prevention.

INCIDENT NAME: PONY	DATE PREPARED: 06-09	OPERATIONAL PERIOD 06-10 Day
ICS 215a	TIME PREPARED 1600	Prepared by T OConnell

Lookouts
Communications
Escape Routes
Safety Zones

Incident Pony, Dillon

Operation Period: 06/10/2013 Day Shift

Emphasis on Situational Awareness

Mission Analysis and Engagement

- What is the mission, what is the assignment?
- Are all hazards identified and made known?
- Is additional information needed?
- Lookouts - Communications - Escape Routes - Safety Zones
- Maintain Situational Awareness

MAJOR HAZARDS AND RISKS

STEEP TERRAIN AIR OPERATIONS FATIGUE DRIVING	ROLLING MATERIAL RATTLESNAKES DEHYDRATION BUCKET DROPS	HEAVY EQUIPMENT SNAGS MARIJUANA GROWS COMPLACENCY
---	---	--

Be sure all elements of your safety plan are in place prior to engagement

Snag Safety

Inspect area for snags before starting work. Are there trees that have been falling, leaning, hung up, or have broken tops? Are there high risk species? How long has the fire been burning in the area?

Identify hazards and fell or avoid the hazard and flag.

Take down snags only with qualified sawyers and then only if necessary.

Briefing Protocol

Brief your personnel using the IRPG checklist prior to engagement

Re-brief anytime your plan changes, unexpected changes compromise the plan or your safety, or anytime essential information becomes known and needs to be communicated

Ask questions to be sure essential content is understood

MEDICAL PLAN	1. INCIDENT NAME PONY	2. DATE PREPARED 06/09/2016	3. TIME PREPARED 1900	4. OPERATIONAL PERIOD 06/10/2016 0600-1800				
5. INCIDENT MEDICAL AID STATIONS								
MEDICAL AID STATIONS	LOCATION	PARAMEDICS						
		YES	NO					
Medical Unit	Base Camp	XX						
Mountain Medical	Base Camp	XX						
FEMP Scardina and FEMT Moncada	Division "A"	XX						
FEMP Moder and FEMT Hart	Division "B"	XX						
FEMP Durham and FEMT Maumoynier	Division "H"	XX						
FEMP Sandler	Dillion	XX						
6. TRANSPORTATION								
A. AIR RESOURCES								
NAME	LOCATION	PHONE	PARAMEDICS					
			YES	NO				
Mercy Flights Air Ambulance	Medford, Oregon	911	XX					
B. INCIDENT AMBULANCES								
NAME	LOCATION	PARAMEDICS						
		YES	NO					
Happy Camp Vol. Ambulance	Happy Camp, Ca.	XX	XX					
Mt. Shasta Ambulance	Yreka, Ca.	XX						
7. HOSPITALS								
NAME	ADDRESS	TRAVEL TIME		PHONE	HELIPAD		BURN CENTER	
		AIR	GRND		YES	NO	YES	NO
Fairchild Medical Center	4444 Bruce St. Yreka, Ca. N. 41 43.13 x W 122 38.69	10 Min	45 Min	530-841-4121	XX			XX
Karuk Community Health Clinic	64236 2 nd Ave Happy Camp Ca.		10 Min	530-493-5257	XX			XX
Ashland Community Hospital	280 Maple St Ashland Or.		1 hr 15 min	541-201-4000		XX		XX
Providence Medical Center	1111 Crater Lake Rd. Medford, Or	15 Min	1.5 Hours	541-732-5000	XX			XX
Rogue Valley Medical Center Level 2 Trauma	2825 Barnett Rd. Medford, Or N 42 19.08 x W 122 49.91	15 Min	1.5 Hours	541-608-4900	XX			XX
U.C. Davis Medical Center Level 1 Trauma	2015 Stockton Ave Sacramento, Ca. N 38 33.3 x W 121 27.3	1 Hour	5 Hours	916-734-2011	XX		XX	
8. MEDICAL EMERGENCY PROCEDURES								
IN-CAMP CARE				LINE EMERGENCIES				
<ul style="list-style-type: none"> • Minor Injuries or illnesses <ul style="list-style-type: none"> • Seek Aid directly at Medical Unit, report all injuries or illnesses to supervisor • Unit Open 0600 hrs to 2200 hrs • Moderate to Severe Injuries or Illnesses <ul style="list-style-type: none"> • Contact Communications directly • Med Unit staffed after hours for Emergencies 				<ul style="list-style-type: none"> • <u>Start of shift:</u> notify your Div Sup of EMT's/Paramedic's and Medical gear carried by crew 				
				<ul style="list-style-type: none"> • Crew Supervisor contacts Division with Nature of Emergency. 				
				<ul style="list-style-type: none"> • Division Supervisor contact's Communications and declare a medical emergency on command 				
				<ul style="list-style-type: none"> • Closest DIVS or designee responds to incident 				
				<ul style="list-style-type: none"> • Closest SOFR/EMT's respond to assist w/care 				
				<ul style="list-style-type: none"> • Use attached Injury or Incident Comm. Protocol 				
<ul style="list-style-type: none"> • If ambulance (ground or air) delayed designate rendezvous site and move towards it 								
<ul style="list-style-type: none"> • Secure scene for investigation—keep a log 								
9. PREPARED BY (MEDICAL UNIT LEADER) Patrick Young MEDL				10. REVIEWED BY (SAFETY OFFICER) Terry O'Connell SOF-2				
ICS 206 8-78								

INCIDENT RADIO COMMUNICATIONS PLAN Incident Name: **PONY CA-KNF-004500** Date/Time Prepared: **06/08/16, 2000** Operational Period Date/Time: **6/10/16, 0600-1800**

Zn / Ch	Function	Channel Name/Trunked Talkgroup	Assignment	RX Freq	RX Tone/NA/C	TX Freq	TX Tone/NA/C	Mode A, D, M	Remarks
1	Command	NIFC C1	All Divisions	168.7000	0.0	170.9750	110.9	A	Tone 1 UKONOM Mt
2	Command			169.5375	0.0	164.7125	110.9	A	
3	Command			0.0000	0.0	0.0000	0.0	A	
4	Tactical	NIFC T1	DIV A	168.0500	0.0	168.0500	0.0	A	
5	Tactical	NIFC T2	Dillion - I/A	168.2000	0.0	168.2000	0.0	A	
6	Tactical	NIFC T3	DIV B	168.6000	0.0	168.6000	0.0	A	
7	Tactical	NIFC T5	DIV C	166.7250	0.0	166.7250	0.0	A	
8	Tactical	NIFC T6	DIV D	166.7750	0.0	166.7750	0.0	A	
9	Tactical	NIFC T7	DIV H	168.2500	0.0	168.2500	0.0	A	
10	CH 10			0.0000	0	0.0000	0	A	
11	CH 11			0.0000	0.0	0.0000	0.0	A	
12	Command	ALT CMD	All Divisions	172.2750	0.0	164.7000	136.5	A	Tone 4 UKONOM Mt
13	Air - Ground CMD	A/G CMD	All Divisions	167.9500	0.0	167.9500	0.0	A	
14	Air - Ground TAC	A/G TAC	All Divisions	166.6750	0.0	166.6750	0.0	A	
15	Tactical	CALCORD	Medical	156.0750	156.7	156.0750	156.7	A	Medical Evac - Tone 6
16	Emergency only	GUARD	All Divisions	168.6250	0.0	168.6250	110.9	A	AIR GUARD - emerg. use only-Tone 1
17									
18									
19									
20	Emergency only	GUARD	All Divisions	168.6250	0.0	168.6250	110.9	A	AIR GUARD - emerg. use only-Tone 1

Prepared By: (Communications Unit Leader)
Don Stoner, COML Norcal II

Incident Location: **Happy Camp**
 County: **Happy Camp**
 Latitude, Longitude

Deviation is assumed to be narrow band unless otherwise noted in the remarks. Mode refers to either "A" (analog), "D" (digital) or "M" (mixed mode). 1/14/14 v.5

INCIDENT TRAINING MESSAGE

**All trainees on the incident need to check in with the
Training Specialist (TNSP)**

- Training Specialist is located on “Main Street” at the ICP
- Blank forms and a “drop box” for registering your assignment are located in the Training Trailer

Trainees: To register your assignment and receive documented credit you need the following items:

- Current Red Card
- Initiated Position Task Book

****Trainers if you leave the incident before your trainee you will need to complete a Performance Evaluation for the time your trainee was assigned to you.****

INCIDENT TRAINEE REGISTRATION FORM

Complete **ALL** fields and return to Training Specialist or DROP BOX for entry into database.

Remember to close out training packets with the Training Specialist before DEMOB.

TRAINEE's DATA

Name (PRINT): _____ ICS Trainee Position: _____

Request # (A,C,E,or O): _____ Agency Designator (Ex. CA-MNF): _____

USFS___ State___ BLM___ BIA___ NPS___ FWS___ Local Govt. ___ DOD___ NWS___

___ Regional Trainee ___ FS-FPM Trainee ___ IFPM Trainee ___ Ordered as Trainee? Y N

Date Assigned: _____ Cell Phone: _____

TRAINING RECORDS TO BE MAILED TO: (Chief, Training Officer, ect)

Name: _____ Title: _____

Name of Home Unit: _____

Address: _____

City: _____ State: _____ Zip Code: _____ Phone: _____

TRAINEE PREREQUISITES

1. Valid Red Card or agency certification card? _____ Yes _____ No

2. Trainee has current position task book issued by home unit? _____ Yes _____ No

Current Task Book Progress: _____ 0% _____ 25% _____ 50% _____ 75% _____ 90%

Priority Tasks needed for Taskbook: _____

TRAINER/EVALUATOR DATA

Trainer/Evaluator Name: _____ ICS position on fire _____

Home Unit: _____ Agency Designator(ex. CA-MNF): _____

Work Address: _____ City: _____

State: _____ Zip Code: _____ Phone: _____

Fire ← ····· Hwy 96

Incident Base Camp Map

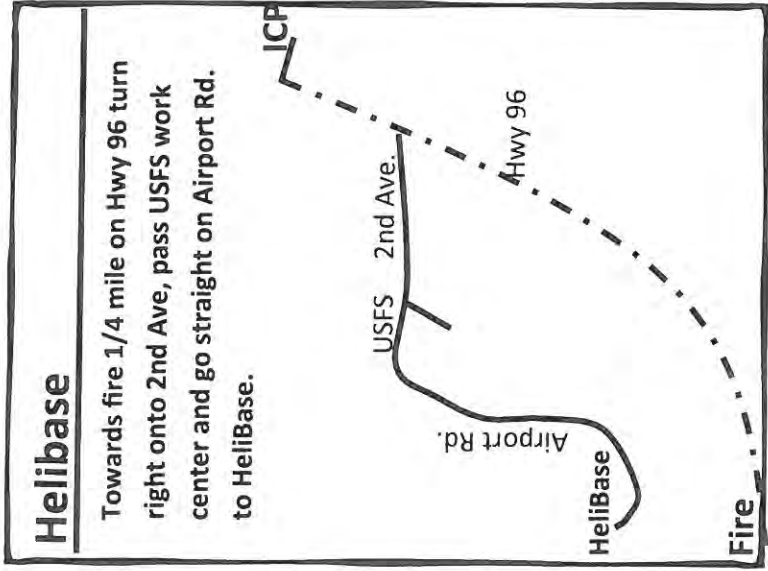

Park Way Rd

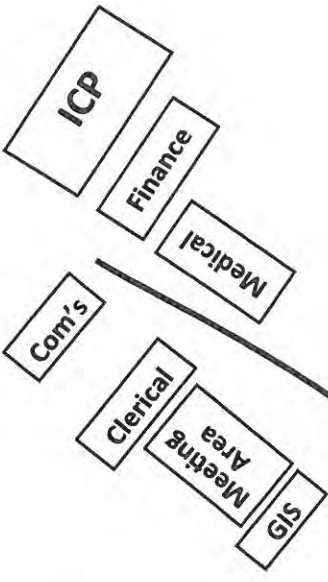

Briefing Area

Lunches

Kitchen

Supply Unit

Ground Support

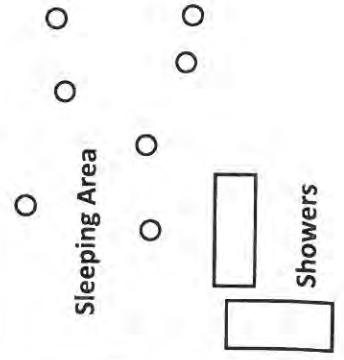
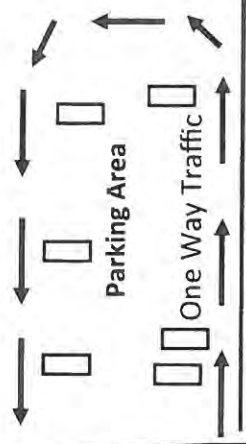

No Parking

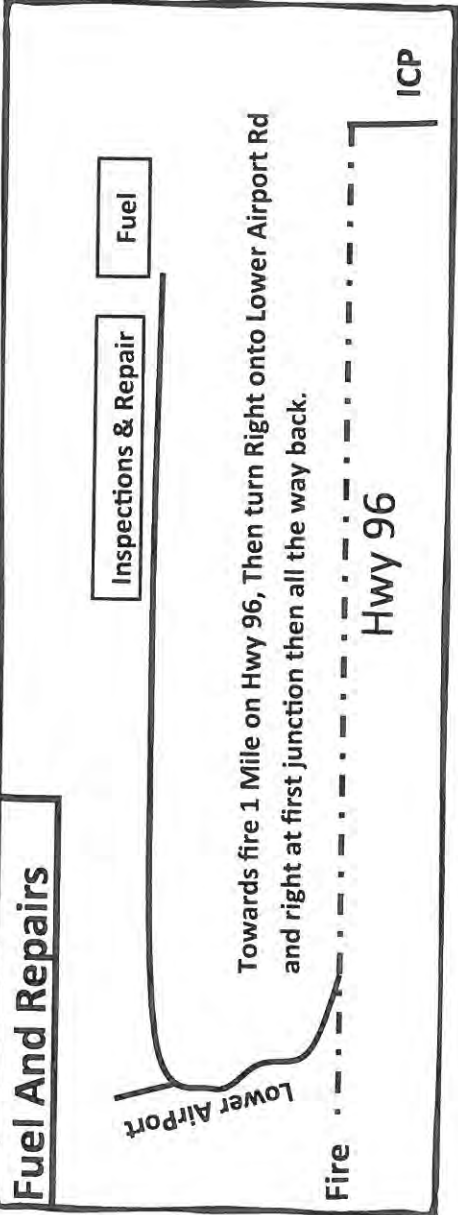

FOR ALL MEDICAL EMERGENCIES: IDENTIFY ON SCENE INCIDENT COMMANDER BY NAME AND POSITION AND ANNOUNCE "MEDICAL EMERGENCY" TO INITIATE RESPONSE FROM IMT COMMUNICATIONS/DISPATCH.

Use items one through nine to communicate situation to communications/dispatch.

1. CONTACT COMMUNICATIONS/DISPATCH

Ex: "Communications, Div. Alpha. Stand-by for Priority Medical Incident Report." (If life threatening request designated frequency be cleared for emergency traffic.)

2. INCIDENT STATUS: Provide incident summary and command structure.

Nature of Injury/Illness		<i>Describe the injury (Ex: Broken leg with bleeding)</i>
Incident Name		<i>Geographic Name + "Medical" (Ex: Trout Meadow Medical)</i>
Incident Commander		<i>Name of IC</i>
Patient Care		<i>Name of Care Provider (Ex: EMT Smith)</i>

3. INITIAL PATIENT ASSESSMENT: Complete this section for each patient. This is only a brief, initial assessment. Provide additional patient info after completing this 9 Line Report.

Number of Patients:	Male / Female	Age..	Weight..
Conscious? <input type="checkbox"/> YES <input type="checkbox"/> NO = MEDEVAC!			
Breathing? <input type="checkbox"/> YES <input type="checkbox"/> NO = MEDEVAC!			
Mechanism of Injury: <i>What caused the injury?</i>			
Lat/Long (Datum WGS84) <i>Ex: N 40° 42.45' x W 123° 03.24'</i>			

4. SEVERITY OF EMERGENCY, TRANSPORT PRIORITY

SEVERITY	TRANSPORT PRIORITY
<input type="checkbox"/> URGENT-RED Life threatening injury or illness. <i>Ex: Unconscious, difficulty breathing, bleeding severely, 2° – 3° burns more than 4 palm sizes, heat stroke, disoriented.</i>	Ambulance or MEDEVAC helicopter. Evacuation need is IMMEDIATE.
<input type="checkbox"/> PRIORITY-YELLOW Serious Injury or illness. <i>Ex: Significant trauma, not able to walk, 2° – 3° burns not more than 1-2 palm sizes.</i>	Ambulance or consider air transport if at remote location. Evacuation may be DELAYED.
<input type="checkbox"/> ROUTINE-GREEN Not a life threatening injury or illness. <i>Ex: Sprains, strains, minor heat-related illness.</i>	Non-Emergency. Evacuation considered Routine of Convenience.

5. TRANSPORT PLAN:

Air Transport: (Agency Aircraft Preferred)

<input type="checkbox"/> Helispot	<input type="checkbox"/> Short-haul/Hoist	<input type="checkbox"/> Life Flight	<input type="checkbox"/> Other
-----------------------------------	---	--------------------------------------	--------------------------------

Ground Transport:

<input type="checkbox"/> Self-Extract	<input type="checkbox"/> Carry-Out	<input type="checkbox"/> Ambulance	<input type="checkbox"/> Other
---------------------------------------	------------------------------------	------------------------------------	--------------------------------

6. ADDITIONAL RESOURCE/EQUIPMENT NEEDS:

<input type="checkbox"/> Paramedic/EMT(s)	<input type="checkbox"/> Crew(s)	<input type="checkbox"/> SKED/Backboard/C-Collar
<input type="checkbox"/> Burn Sheet(s)	<input type="checkbox"/> Oxygen	<input type="checkbox"/> Trauma Bag
<input type="checkbox"/> Medication(s)	<input type="checkbox"/> IV/Fluid(s)	<input type="checkbox"/> Cardiac Monitor/AED
<input type="checkbox"/> Other (i.e. splints, rope rescue, wheeled litter)		

8. EVACUATION LOCATION:

Lat/Long (Datum WGS84) <i>EX: N 40 42.45' x W 123 03.24'</i>	
Patient's ETA to Evacuation Location:	
Helispot/Extraction Size and Hazards:	

9. CONTINGENCY: