

Corrected

Hough Complex

CA-PNF- 001324

(0511) P5HV99

AUGUST 23, 2013

Day Operational Period

0600 - 1800

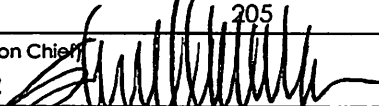
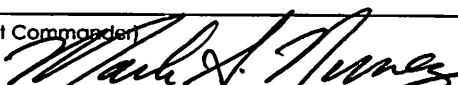
INCIDENT OBJECTIVES	1. Incident Name Hough Complex	2. Date Prepared 8/22/2013	3. Time Prepared 2310															
4. Operational Period August 23, 2013																		
Day Operations: 0600-1800																		
5. General Control Objectives for the Incident (include alternatives) Management Objectives <ol style="list-style-type: none"> 1. Provide for firefighter and public safety as the highest priority. 2. Provide and coordinate protection of structures, timber lands, and infrastructure on public and private lands within the complex. 3. Provide timely information, notification and communications regarding fire activity and effects on air quality. 4. Minimize effects of fire and fire suppression activities on sensitive resources through effective use of resource advisors and close collaboration with cooperators and administering agencies. 5. Maintain a high level of collaboration with local communities, neighboring and cooperating agencies. 6. Minimize disruption to local economies with local communities, neighboring and cooperating agencies. 7. Provide IA response and resources for new starts through the Central Coast Incident Commander. Control Objectives Suppress fires within the complex in the smallest area that can be safely accomplished with available resources.																		
6. Weather Forecast for Period See Attached Weather Forecast																		
7. General Safety Message See Attached Safety Message																		
8. Attachments (mark if attached) <table border="0" style="width: 100%;"> <tr> <td><input checked="" type="checkbox"/> Incident Objectives - ICS 202</td> <td><input checked="" type="checkbox"/> Division Assignment List - ICS 204</td> <td><input checked="" type="checkbox"/> Medical Plan - ICS 206</td> </tr> <tr> <td><input checked="" type="checkbox"/> Organization List - ICS 203</td> <td><input checked="" type="checkbox"/> Safety Message</td> <td><input type="checkbox"/> Human Resource Message</td> </tr> <tr> <td><input checked="" type="checkbox"/> Fire Weather Forecast</td> <td><input checked="" type="checkbox"/> Incident Safety Analysis - ICS 215A</td> <td><input checked="" type="checkbox"/> Traffic Plan</td> </tr> <tr> <td><input checked="" type="checkbox"/> Fire Behavior Forecast</td> <td><input checked="" type="checkbox"/> Air Ops Summary - ICS 220</td> <td><input type="checkbox"/> Incident Map</td> </tr> <tr> <td><input type="checkbox"/> Pocket Card</td> <td><input checked="" type="checkbox"/> Communications Plan - ICS 205</td> <td><input checked="" type="checkbox"/> Unit Log - ICS 214</td> </tr> </table>				<input checked="" type="checkbox"/> Incident Objectives - ICS 202	<input checked="" type="checkbox"/> Division Assignment List - ICS 204	<input checked="" type="checkbox"/> Medical Plan - ICS 206	<input checked="" type="checkbox"/> Organization List - ICS 203	<input checked="" type="checkbox"/> Safety Message	<input type="checkbox"/> Human Resource Message	<input checked="" type="checkbox"/> Fire Weather Forecast	<input checked="" type="checkbox"/> Incident Safety Analysis - ICS 215A	<input checked="" type="checkbox"/> Traffic Plan	<input checked="" type="checkbox"/> Fire Behavior Forecast	<input checked="" type="checkbox"/> Air Ops Summary - ICS 220	<input type="checkbox"/> Incident Map	<input type="checkbox"/> Pocket Card	<input checked="" type="checkbox"/> Communications Plan - ICS 205	<input checked="" type="checkbox"/> Unit Log - ICS 214
<input checked="" type="checkbox"/> Incident Objectives - ICS 202	<input checked="" type="checkbox"/> Division Assignment List - ICS 204	<input checked="" type="checkbox"/> Medical Plan - ICS 206																
<input checked="" type="checkbox"/> Organization List - ICS 203	<input checked="" type="checkbox"/> Safety Message	<input type="checkbox"/> Human Resource Message																
<input checked="" type="checkbox"/> Fire Weather Forecast	<input checked="" type="checkbox"/> Incident Safety Analysis - ICS 215A	<input checked="" type="checkbox"/> Traffic Plan																
<input checked="" type="checkbox"/> Fire Behavior Forecast	<input checked="" type="checkbox"/> Air Ops Summary - ICS 220	<input type="checkbox"/> Incident Map																
<input type="checkbox"/> Pocket Card	<input checked="" type="checkbox"/> Communications Plan - ICS 205	<input checked="" type="checkbox"/> Unit Log - ICS 214																
9. Prepared by (Planning Section Chief) Steve Anderson, PSC2 		10. Approved by (Incident Commander) Mark Nunez, ICT2 																

ORGANIZATION ASSIGNMENT LIST		9. Operations Section	
1. Incident Name HOUGH COMPLEX		Day	STEVE STOLL / MARK SMITH (T)
2. Date Prepared 08/22/13		Night	JOHN ABELL JOE SEAN KENNEDY ICT3 (T)
3. Time Prepared 1709		a. Branch I - Division/Groups	
4. Operational Period 08/23/13 Friday Day Shift 0600 - 1800		Division/Group B	JAMES WETTSTAED; JOE TIESO (T)
Position	Name	Division/Group H	DAVID NEELS; MAEVE JUAREZ (T)
5. Incident Commander and Staff		Division/Group W	MATT FERRIS
Incident Commander	MARK NUNEZ; MARK von TILLOW(T)	Division/Group Y	KEITH AGGSON; DAN FREEH (T)
Deputy	DANA D'ANDREA	Division/Group STRUCTURE	LEON JEFFERY
Safety Officer	TOM ZEULNER; RICK BERTRAM (T)	Division/Group IA	LEON JEFFERY
Formation Officer	HELEN TARBET; MADRIGAL, MANUEL	Division/Group	
Assignment Officer	MCGREW; GRAHAM ; JONES; WALDRON(T)	b. Branch II - Division/Groups	
6. Agency Representative		Branch Director	
Agency	Name	Deputy	
Agency Administrator	KAREN HAYDEN; MICHAEL DONALD (T)	Division/Group	
ALFire	JIM BARRY	Division/Group	
REST SAFETY OFFICER	LEE MERCER	Division/Group	
UMAS NF FIRE CHIEF	STEVE MILLERT	Division/Group	
ES	JOHN CLARY	Division/Group	
7. Planning Section		c. Branch III - Division/Groups	
Chief	ANN MARX	Branch Director	
Deputy	STEVE ANDERSON	Deputy	
Resources Unit	BILL BRICKEY ; PAT CAPRIOLI	Division/Group	
Situation Unit	JOHN GERMANETTI; MIKE HELD	Division/Group	
Documentation Unit	DEBRA RIOS	Division/Group	
Demobilization Unit	DENA FOOSE	Division/Group	
Public Behavior Analyst	STEWART TURNER	Division/Group	
Human Resource Specialist		d. Air Operations Branch	
Training Specialist	DOUG DICKSON ; TONY AYALA (T)	Air Operations Branch Director	BRAD JOOS
IS Specialist	M.FLEISCHER/W.RANNALS/S.POWELL	Helibase Manager	CURT WARNER
Computer Specialist	SCOTT DANIELS	Air Attack Supervisor	WALTER BUNT
NET	MIKE SMITH	Air Support Supervisor	AL DRIESBACH
MAN	STEWART TURNER	Helicopter Coordinator	
		Air Tanker Coordinator	
8. Logistics Section		10. Finance Section	
Chief	TOM CRAKES	Chief	JUDY REYNOLDS
Deputy	JERRY BEAN	Deputy	ROBIN NIMURA
Supply Unit	JOHN HARKLEROAD	Time Unit	CASEY BRYSON
Facilities Unit	SCOTT GARDNER / MIKE FARMER (T)	Procurement Unit	
Ground Support Unit	VIC MUZYKA / JOHN SAUNDERS	Compensation/Claims Unit	
Communications Unit	DAVID PASCHKE	Cost Unit	
Medical Unit	ROBERT ETHRIDGE/TYE JOHNSON (T)	Prepared by (Resource Unit Leader)	
Security Unit		BILL BRICKEY (RESL)	
Food Unit	KERRY KELLOGG		



INCIDENT Weather Forecast



FORECAST NO: 4

NAME OF FIRE: Hough Complex

PREDICTION FOR: Friday Day SHIFT

UNIT: Hough RD, Plumas NF

SHIFT DATE: Aug 23, 2013

SIGNED: Mike Smith

TIME AND DATE

Incident Meteorologist

FORECAST ISSUED: 2100 Aug 22, 2013

WEATHER DISCUSSION: Stable southwest flow aloft returns to the region Friday between high pressure over the central U.S and a trough developing in the eastern Pacific. More stable conditions will translate to fair skies, more developed morning inversions and an end to any shower or thunderstorm threat. Steady onshore flow should keep temperature and humidity conditions relatively mild for this time of year. These mild conditions are expected to last into the weekend. Relatively light winds on Friday will increase a bit over the ridges on Saturday as the eastern Pacific trough digs a weak frontal band towards the coast. Stronger ridge winds are possible on Sunday along with a bit of cloudiness as this weak front clips the far north portion of the state.

WEATHER FORECAST:

WEATHER: Mostly sunny except some morning smoke in the valleys.

TEMPERATURES: Maximum temperatures 86 to 93.

HUMIDITY: Minimum humidity 18 to 25%.

20 FT WINDS:

RIDGETOP – Southwest winds to 5 mph with occasional gusts to 10 mph in the afternoon.

SLOPE/VALLEY – Variable to 5 mph becoming upslope to upcanyon 3 to 8 mph after about 1000.

STABILITY/INVERSION: Valley inversions clearing by late morning. Moderately stable aloft.

OUTLOOK FOR (Friday night): Fair skies except smoke developing in the valleys after about 2000. Minimum temperatures 54-58. Max RH recovery 70-75%. Ridge winds southwest to 5 mph with occasional gusts to 10 mph. Winds becoming light downslope on the slopes after about 2000.

OUTLOOK FOR Saturday: Mostly Sunny. High temperatures 84 to 91. Min RH 18 to 25%. Ridge winds increasing in the afternoon to southwest 8 to 15 mph with occasional gust to 20 mph. Slope winds upslope to upcanyon 3-8 mph except upper south slopes southwest 4-8 gusts to 12 mph.

EXTRA INFORMATION: Sunrise 6:22 Sunset 7:50

FIRE BEHAVIOR FORECAST

FORECAST NUMBER: 7

TYPE OF FIRE: Wildfire

FIRE NAME: Hough Complex

OPERATIONAL PERIOD: Day Shift 8/23/2013

DATE ISSUED: August 22, 2013

TIME ISSUED: 2200

UNIT: Plumas National Forest

SIGNED: Stewart Turner FBAN

INPUTS

WEATHER SUMMARY:

Mostly sunny except some morning smoke in the valleys.

Maximum Temp 86°-93°, Minimum RH 18-25%, winds slope/valley upslope 3-8 mph after about 1000, ridgetop southwest 5 mph gusts 10 mph in the afternoon.

OUTPUTS

FIRE BEHAVIOR

GENERAL:

The effect of the recent rain on the fine fuels is gone and they are available to burn. With the moderate overnight recovery expect to see activity to pick up about 1400-1500 hours. Fire behavior will be low, moderate, active, and very active. Occasional single and group tree torching with short crown runs where fuels, topography and winds line up. Rollouts and spotting will be a problem contributing to the rapid spread of the fire. Local threshold for fire weather: Winds greater than 6 mph, humidity less than 20%, temperature greater than 80°, and 10 hour fuel moisture less than 5%. **The Probability of Ignition will be 76%. The fine dead fuel moisture will be 4%. Currently the dead fuel moistures are low with the 1000 hour fuels around 8%. Expect spotting up to 1/3 mile.**

SPECIFIC:

Ridge: Fire will continue to actively back with upslope growth on the west side.

Johnson: Interior fuels will continue to burn with backing creeping and some torching. Unnamed spot south of Johnson will continue to burn interior fuels.

Evans: Watch for rollouts.

Initial attack: Most fires have been single trees with surface fire experiencing low to moderate fire behavior.

Expect new starts this afternoon from sleepers.

Mop in the heavy fuels is very important. Turn the logs over, dig the stumps out paying attention to the larger fuels. Rekindle is very common when fuels are this dry.

AIR OPERATIONS: Smoke may limit air operations in some divisions for a period of time.

SAFETY

Risk Analysis

Initiate all actions based on current and expected fire behavior

- *Can the resources you are replacing give you a thorough briefing?*
- *Can you observe the area, use scouts?*
- *Have escape routes and safety zones been thoroughly scouted?*
- *Are they marked for night use?*
- *Have potential dangers been located, can they be dealt with?*
- *Access to weather and fire behavior forecast?*

Division Assignment List	1. Branch	2. Division/Group Y
---------------------------------	-----------	-------------------------------

3. Incident Name HOUGH COMPLEX	4. Operational Period 08/23/13 Friday Day Shift 0600 - 1800
--	---

5. Operations Personnel			
Operations Chief (Day)	STEVE STOLL / MARK SMITH (T)	Division/Group	DAVID NEELS <i>Aggson/Freese</i>
Operations Chief (Night)	JOHN ABELL	Air Attack Supervisor	WALTER BUNT
	JOE SEAN KENNEDY ICT3 (T)	Safety Officer	TOM ZEULNER / RICK BERTRAM (T)

6. Resources Assigned this Period

Strike Team/Task Force/ Resource Designator	Leader	Num of Pers.	Trans. Y/N	Drop Off PT./Time	Pick Up PT./Time
CREW SHASTA LAKE IHC	LEE	20	N	ICP/0600	BASE CAMP/1800
CREW T2 NORTH PACIFIC	HINER	20	N	ICP/0600	BASE CAMP/1800
WT CA LMU 9222 G (24 HR)	<i>Antelope 1</i>	38	N	ICP/0600	BASE CAMP/0600
WT CA SKU 9261C (24 HR)	<i>Antelope 4</i>	16	N	ICP/0600	BASE CAMP/0600
WT CA LMU 9225C (24 HR)	DELACOUR	17	N	ICP/0600	BASE CAMP/0600
WT CA XYO 4276C	BINNS	22	N	ICP/0600	BASE CAMP/1800
WT CA XME 2150C		17	N	ICP/0600	BASE CAMP/1800
WT CA XAM 4025C	TAYLOR	17 22	N	ICP/0600	BASE CAMP/1800
ENGINE T6 INBOUND (E-36)	BRADLEY	3	N	ICP/0600	BASE CAMP/1800
MOZER T2 CA PNF 3	SHEPHARD	2	N	ICP/0600	BASE CAMP/1800
MOZER T2 CA SRF 4	PILLOW	3	N	ICP/0600	BASE CAMP/1800
MOZER T2 CA TGU 2540 (24 HR)	GLENN	2	N	ICP/0600	BASE CAMP/0600
VT T2 BENS	HALE	1	N	ICP/0600	BASE CAMP/1800
VT T2 CARNHAM	<i>Carnaham</i>	1	N	ICP/0600	BASE CAMP/1800
VT T3 DEETS (E-74)		1	N	ICP/0600	BASE CAMP/1800
WOFR	HEINBOCKEL	1	N		
<i>WT Grubs T2</i>	<i>Pearce</i>	<i>1</i>	<i>N</i>		
<i>WT T3 Letterbuch E-109</i>	<i>Andrews/Lassen</i>	<i>2</i>	<i>N</i>		
<i>FEMT</i>	<i>Peterson</i>	<i>1</i>	<i>N</i>		
<i>FEMT</i>	<i>Culhao</i>	<i>1</i>	<i>N</i>		

CONTROL OPERATIONS
CONTROL, SECURE AND HOLD LINE.
MONITOR FOR NEW STARTS, TAKE SUPPRESSION ACTION AS NEEDED.

7. Special Instructions

WINDSPEED / HEIGHT: 228 ac.,

8. Division/Group Communications Summary

Function	Frequency - RX	Frequency - TX	Tone	System	Channel	System	Channel
Command	170.5500	169.9000	5, 6	FOREST NET	1		
actical	166.7750	166.7750		NIFC T6	5		
ogistics							
ir to Ground	169.1500	169.1500		AIR/GROUND	9		

Prepared by (Resource Unit Leader) WILL BRICKEY, RESL <i>[Signature]</i>	Approved by (Planning Section Chief) STEVE ANDERSON, PSC2 <i>[Signature]</i>	Date Prepared 08/22/13	Time Prepared 2137
---	---	---------------------------	-----------------------

AIR OPERATIONS SUMMARY

Prepared By: Joos/ Driesbach

Prepared Date: 8/22/13 Prepared Time: 2200

1. INCIDENT NAME: **Hough CPLX** 2. OPERATIONAL PERIOD DATE: **8/23/13** START TIME: 0800 END TIME: 2024 SUNRISE: 0622 SUNSET: 1952

3. REMARKS (Safety Notes, Hazards, Air Operations Special Equipment, etc.):						4. MEDIVAC AIRCRAFT	5. TFR: In Place A-35
Visibility - Smoke. (Check with ATGS) Flight Hazards- Snags and tight dip sites and drop sites Cables and Powerlines across rivers Down Drafts from Thunderstorms Fly all missions with landing lights on. Keep foam and retardant out of waterways, including dry river beds.						Incident medevac: Follow Hough Medical Plan	TFR for 119.075AM NOTAM 3/5045 40* 07' 12" 120* 52'06" 10,000' MSL @ 9NM centerpoint
On order: Mobile Retardant Plant							
6. PERSONNEL	NAME	Phone #	7. FREQUENCY	AM	FM	8. FIXED-WING Avail/Type/Make-Model/ FAA N# / Base(s)	
AOBD	Brad Joos	805-886-6970	Command Rptr		170.550 RX 169.900 TX Tone 6	AA: 06 Chester CWN platform N1385L (Cessna 337)	
ASGS	Al Driesbach	805-703-0649				Air Tankers ; None assigned, needs coordinated thru Forest via Region	
ATGS	Jason Winthrow	530-206-6955	RW A/A Tactics	119.075		Lead Planes:	
ATGS	Zackery Hawkins	530-514-5280	FW A/A Tactics Air to Ground		170.000 169.150		
HEB1: HEB1 t:	Curt Warner	805-478-1231	DECK		163.100	Helibase located at Quincy Airport	
Flight Following & TOLC						National Guard AAML – Dan Hickey 916-798-3280	
Ground to Air Emergency Only			Air Guard		168.6250		
Plumas ECC Dispatch	Barb	530-283-7833					

Special Equipment:

Crash Rescue- On order

Water Tenders- N/A

HELICOPTERS (Use Additional Sheets As Necessary)

FAA N#	TY	MAKE/MODEL	BASE	AVAIL	START	REMARKS	FAA N#	TY	MAKE/MODEL	BASE	AVAL	START	REMARKS
H-506	II	Bell 205	Quincy Airport	0730	0800	A-29	H-801	I	Chinook	RON @ Redding	0900	0930	National Guard
							H-821	I	Blackhawk	Ron @ Redding	0900	0930	National Guard
H-553	III	Bell 206	Quincy Airport	0730	0800		H-822	I	Blackhawk	RON @ Redding	0900	0930	National Guard

9. TASK/MSSION/ASSIGNMENT (Type/Function includes: Air Tactical, Retardant, Recon, Personnel Transport, Water Dropping, S&R, etc.)

TYPE/FUNCTION	NAME OF PERSONNEL OR CARGO OR INTSTRUCTIONS FOR TACTICAL AIRCRAFT	MISSION START	FLY FROM	FLY TO
Air Tactical	Provide coverage as needed over incident by ATGS. ATGS to coordinate rotor and fixed wing A/C use and flight following over the fire. Monitor all divisions and new starts.	0800	Chester	Fire
Dropping Retardant: Air Tankers	FW air tankers as ordered by DIVS/OPS to ATGS. Support operations as necessary. May support firing operations as yesterday. Need one Guard Ship to service Chance Fire for one fuel cycle after morning briefing. Confirm start with Chance IC thru Dispatch. Any additional usage, contact Ops or Air Ops prior for approval.	When requested		Fire
Recon	Morning recons for Ops and Divs, once inversion lifts and clear air. Fly out of <u>Johnson Ranch</u> . Need helitack to staff helispot H-1 at the ranch	TBA	Johnson Ranch	Fire
Mapping/Infrared	Daily mapping flights. Use H-1 (N40 05.115 W120 52.102 Elev 3523ft) at Johnson Ranch	TBA	Johnson Ranch	Fire
Transport of Personnel				
Cargo Transport	.Blivits may be ordered to support line			
Dip Site Names and Locations	<u>Establish Dip Site Manager @ Assigned sites.</u> <u>Record times and gallons!!!</u> <u>Get Lat and Longs of all dip sites</u>		Quincy Helibase	Fire
I.A.	H-512	As requested through Ops	Quincy Helibase	IA

Hough Complex – Safety Message

INCIDENT: # CA-PNF-001324

DATE: 08-23-13

TIME: 0600 – 1800 DAY

Major Hazards and Risks:

Environment

- Temperatures warming with increasing winds
- Increasing fire behavior
- Possible long range spotting
- Rugged steep terrain / Rolling rocks and other materials
- Watch for snags on the line and roads, mark them and make them known to your crews

Human Factors

- When driving keep speeds at posted limits, seatbelts on and your headlights on
- Fatigue
- Dehydration due to increasing temperatures is a factor – drink plenty of fluids and pace yourselves
- Lookouts, Communication, Escape Routes and Safety Zones – make sure they are in place...
- Don't forget to get an anchor point on any initial attack fire

Animals, Insects and Other Pests

- Ticks (Lyme Disease), Bees (aggressive), Mice (Hanta Virus), Rattle Snakes, Mountain Lions and Bears
- Numerous Deer on public roads during early morning and early evenings trying to hit your vehicle

Narrative: We have seen all types of weather and fire behavior on this incident. The watch out situations are everywhere and most of the time obvious. What can cloud your judgment is complacency. This can be caused by a number of factors. Fatigue is a major contributor. If this is your first, second or fifth assignment you are fatigued to some degree, don't fool yourself. Look at each other and if your fellow crewmember is at this state help him/her out, lets try and get that person some extra rest or food. Don't be afraid to ask for help if you need it. It's going to be a long fire season and for many of you it already has been. Take the time to call home and ensure your family is ok. If they're not doing well you won't be in the right state either. You and your families well being is important to this team.

****Gold mining was a big part of this area's history as well as other types of mining. Please be alert for vertical shafts, even horizontal shafts contain life threatening hazards. Do Not go in any mine to explore or for any other reason. If you find it FLAG it and get GPS coordinates.**



13. ON A HILLSIDE WHERE ROLLING MATERIAL CAN IGNITE FUEL BELOW

DO YOU HAVE DEHYDRATION?

Confusion

Sluggishness (lethargy)

Headache

Fainting

Seizures

Difficulty breathing

Chest or abdominal pains

No urine in the last 12 hours

Incident Safety Officers: Tom Zeulner SOF2 / Rick Bertram SOF2 (T) Lee Mercer- Forest Safety Officer

(Signature)

(Signature)

HOUGH COMPLEX INCIDENT ANALYSIS (ICS 215a)

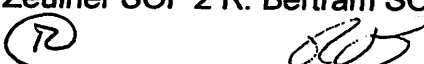
DIV	HAZARDOUS ACTIONS / CONDITIONS	MITIGATIONS / WARNINGS / REMEDIES
ALL	COMMUNICATIONS	<ul style="list-style-type: none"> • After cloning at ICP make sure to check your radio's operation
ALL	MINES	<ul style="list-style-type: none"> • Stay on assignment , do not wander off • Focus on the terrain while walking • Scan the area with your headlamp prior to walking in a direction • Stop often and look for irregularities in the terrain, - ex. Collapses GPS spot, contact division, flag it off and ensure others notified
ALL	HAZARD TREES	<ul style="list-style-type: none"> • Follow Hazard Tree Safety Guidelines IRPG p.20 • Limit number of personnel around snags and their exposure time; fallers must be qualified for trees being fallen. • Be especially alert around snags during wind events. • Check for hazard trees & "widow-makers. Look up and live. • Night time complicates hazard tree identification
ALL	HAZARDOUS WEATHER	<ul style="list-style-type: none"> • Watch for changes in wind direction, intensity • Observe build-up of clouds and be ready for downdrafts • Follow lightning protocol - IRPG P.19 • Slow down on wet roads and dirt roads, possibility of rain • Monitor command channel for thunderstorm warnings
ALL	FIRE BEHAVIOR	<ul style="list-style-type: none"> • Long Range Spotting has greatly increased Fire behavior, plan for increased ROS • Review "Severe Fire Behavior Potential" IRPG p.78. • Monitor current weather conditions and forecasts. Make sure all personnel receive thorough briefings every shift. • Maintain adequate escape routes and safety zones. Advise all personnel if these are compromised or changed. Set trigger points when appropriate. • Adhere to 10 Std Fire Orders, mitigate 18 situations that shout... • Maintain Situational Awareness. LCES in place always.
ALL	FATIGUE	<ul style="list-style-type: none"> • Be alert for signs of fatigue and take breaks as necessary. • Maintain 2:1 work/rest ratio. • Monitor incoming resources for level of fatigue. • Drink plenty of fluids before, during and after your shift • Stay alert for signs of heat exhaustion
ALL	AIRCRAFT OPERATIONS	<ul style="list-style-type: none"> • Keep personnel out of drop zones. • Use air-to-ground frequency to communicate with aircraft. • Use clear, concise statements when directing aircraft. Use clock directions from pilot's perspective. • Don't engage in "heli-mopping" if possible. Eliminate unnecessary pilot exposure.
ALL	LINE CONSTRUCTION	<ul style="list-style-type: none"> • Ensure LCES in place prior to engagement IRPG p. 6. • Establish adequate safety zones IRPG p.7. • Use Downhill Line Checklist, IRPG p. 8. • Follow "Look Up, Look Down, Look Around" procedures IRPG p. 2-3 • Utilize Risk Management Process IRPG p.1.
ALL	INITIAL ATTACK	<ul style="list-style-type: none"> • Do the Risk Management process prior to any engagement • LCES will be in place during any operation. • This country requires you to LOOK UP, LOOK DOWN AND AROUND. • The weather can change instantly, always be observant. • Base all actions on current and expected fire behavior • Possible long drive times to Initial Attack assignments
	DATE PREPARED: August 22, 2013	OPERATIONAL PERIOD 0600 - 1800 DAY Shift 08/23/13 Prepared by
	TIME PREPARED: 1700 hrs	T. Zeulner SOF 2 R. Bertram SOF 2 (T) Lee Mercer 

INCIDENT RADIO COMMUNICATIONS PLAN			Incident Name Hough Complex			Date/Time Prepared 8/23/13 2100 HRS.			Operational Period Date/Time 8/23/13 -0600-1800		
Ch #	Function	Channel Name/Trunked Radio System Talkgroup	Assignment	RX Freq N or W	RX Tone/NAC	TX Freq N or W	Tx Tone/NAC	Mode	Remarks		
1	COMMAND	FOREST NET	ALL DIVISIONS	170.5500 N		169.9000 N		A	T5-Kettlerock/T6-Mt.Hough		
2	TACTICAL	NIFC T3	DIVISION B	168.6000 N		168.6000 N		A			
3	TACTICAL	NIFC T5	DIVISION H	166.7250 N		166.7250 N		A			
4	TACTICAL	VTAC 11	DIVISION W	151.1375 N		151.1375 N	156.7	A	MUST USE T6 TO TX		
5	TACTICAL	NIFC T6	DIVISION Y	166.7750 N		166.7750 N		A			
6	TACTICAL	NIFC T7	STR GRP	168.2500 N		168.2500 N		A			
7	TACTICAL	VTAC 13	CONTINGENCY	158.7375 N		158.7375 N	156.7	A			
8	TACTICAL	NIFC T2	INITIAL ATTACK	168.2000 N		168.2000 N		A			
9	AIR TO GROUND	AIR/GRND	ALL DIVISIONS	169.1500 N		169.1500 N		A			
10											
11											
12											
13											
14											
15	CALCORD	Medical	CALCORD	156.0750 N		156.0750 N	156.7	A	A/G MEDICAL EMERGENCIES TONE 6		
16	Air Guard	Guard	ALL DIVISIONS	168.6250 N		168.6250 N	110.9	A	Ground to Air EMERGENCY ONLY TONE 1		
5. Prepared by (Communications Unit) David Paschke, COML					Incident Location County Plumas State CA Latitude N Longitude W						

The convention calls for frequency lists to show four digits after the decimal place, followed by either an "N" or a "W", depending on whether the frequency is narrow or wide band. Mode refers to either "A" or "D" indicating analog or digital (Project 25) **Last Clone 08-22**

MEDICAL PLAN ICS 206	1. INCIDENT NAME Hough Complex	2. DATE PREPARED 08/22/13	3. TIME PREPARED 1930	4. OPERATIONAL PERIOD DATE / TIME	
				08/23/13	0600 - 1800

5. INCIDENT MEDICAL AID STATIONS

MEDICAL AID STATIONS	LOCATION	PARAMEDICS	
		YES	NO
Medical Unit	Base Camp	<input checked="" type="checkbox"/>	<input type="checkbox"/>
		<input type="checkbox"/>	<input type="checkbox"/>

6. TRANSPORTATION

A. MEDEVAC SERVICES

NAME	LOCATION	PHONE	PARAMEDICS	
			YES	NO
Mountain Life Lite 5	650 Ash St. Susanville	530-257-2444	<input checked="" type="checkbox"/>	<input type="checkbox"/>
Enloe Flight Care (NVG)	Enloe Medical Center, Chico	800-344-1863	<input checked="" type="checkbox"/>	<input type="checkbox"/>
CHP Helicopter (Hoist)	2651 Gold St. Redding	530-225-2040	<input checked="" type="checkbox"/>	<input type="checkbox"/>
Raven - Washoe County Sheriff's (Hoist, NVG)	Reno-Stead, Nv	775-785-4228	<input type="checkbox"/>	<input checked="" type="checkbox"/>

B. AMBULANCES

NAME	LOCATION	PARAMEDICS	
		YES	NO
Plumas 1	Staging Throughout Incident	<input checked="" type="checkbox"/>	<input type="checkbox"/>
		<input type="checkbox"/>	<input type="checkbox"/>
		<input type="checkbox"/>	<input type="checkbox"/>

7. HOSPITALS

NAME	ADDRESS	TRAVEL TIME From ICP		PHONE	HELIPAD		BURN CENTER	
		AIR	GROUND		YES	NO	YES	NO
Plumas District Hospital Minor Trauma	1065 Bucks Lane, Quincy, Ca. N39° 56.41' x W120° 57.72'	15 Min	40 Min	530-283-2121 (ER)	<input checked="" type="checkbox"/>	<input type="checkbox"/>	<input type="checkbox"/>	<input checked="" type="checkbox"/>
Enloe Medical Center Level 2	1531 Esplanade, Chico, Ca. N39° 44.78' x W121° 51.03'	45 Min	2 Hr	916-786-3033 (ER)	<input checked="" type="checkbox"/>	<input type="checkbox"/>	<input type="checkbox"/>	<input checked="" type="checkbox"/>
UC Davis Medical Center Level 1	2315 Stockton Blvd. Sacramento N38° 33.2907', W121° 27.3771'	Min	3 Hr	916-734-3892 (ER)	<input checked="" type="checkbox"/>	<input type="checkbox"/>	<input checked="" type="checkbox"/>	<input type="checkbox"/>
Renown Health Medical Level 2	1155 Mill St. Reno N39° 13.6853' x W121° 2.8323'	45 Min	2 Hr	775-982-4144 (ER)	<input checked="" type="checkbox"/>	<input type="checkbox"/>	<input type="checkbox"/>	<input checked="" type="checkbox"/>

8. MEDICAL EMERGENCY PROCEDURES

LINE EMERGENCY

Crew Supervisor to contact Division Supervisor with complaint and Location.

- Division Supervisor Contacts:
 1. Line EMT
 2. Communications Unit
- Communications Unit contacts:
 1. Medical Unit
 2. Operations
 3. Air Operations / Helibase
 4. Safety
 5. Liaison
- Division Supervisor will designate Point of Contact who will run emergency on command channel
- Communication Unit will clear command channel for emergency traffic
- Medical Unit
 1. Arrange proper transportation
 2. Notify receiving hospital of injury status.

BASE CAMP / ICP EMERGENCY

Contact Medical Unit with patient complaint/ condition and location. Medical Unit will respond to stabilize incident:

- Medical Unit contacts:

1. Communications	4. Operation
2. Safety	5. Crew Supervisor
3. Logistic	

INJURY REPORTING PROCEDURES

NATURE OF INJURY _____
 LOCATION OF PATIENT _____
 TRANSPORTATION REQUEST BY: AIR _____ GROUND _____
 AIR FREQUENCY: Medical (Ch 15 on Incident Radio)
 POINT OF PICK UP _____
 LAT _____ LONG _____
 PATIENT UNIT ID _____
 IS EMT WITH PATIENT: YES _____ NO _____
 AGE: _____
 SEX: MALE _____ FEMALE _____
 History: _____
 Medication: _____
 Allergies: _____
 Vitals and other information: _____

9. PREPARED BY (MEDICAL UNIT LEADER)

Tye Johnson MEDL-T

Medical: (530) 284-1047

10. REVIEWED BY (SAFETY OFFICER)

Tom Zeulner SOF2



Fire Information

Just a friendly reminder, when you are out in the community and are approached by the public, please answer only questions that you are certain of. If uncertain of a question asked, please refer the community to the Public Information Officers in the ICP.

Also, please advise the community of the following information resources:

InciWeb – www.inciweb.org

Twitter – Central Coast IMT7

Thanks for your help,

CCIIMT7 PIOs

HARD LINE CELL PHONES FOR HOUGH FIRE

IC / Safety	530-284-7596
Operations	530-284-6685
PIO	530-284-7120
PIO	530-284-1815
Resource / Demob	530-284-1582
Finance	530-284-7068
Med Unit	530-284-1047
Comm Unit	530-284-1824
Plans	530-284-0823
Supply / Ordering	530-284-6238
Situation	530-284-1856
Weather	530-284-0915

Incident Trainee / Trainer Data Worksheet

PLEASE PRINT LEGIBLY!

A: Trainee Data

Trainee Name: _____

Trainee Position: _____

Order Number (E, O, C, A) ____--_____

State Abr. ____ + 3 Letter Designator _____

Agency Type: Federal State Local

USFS BLM BIA FWS DOD NWS NPS

Date Assigned: ____--____--_____

Ordered as a Trainee for the incident? Yes No

Ordered as a PRIORITY trainee? Yes No

Person's name and title that is responsible for tracking your qualifications:
(Where do you want the packet mailed to?)

Name: _____ Title: _____ Home Unit: _____

Agency Address: _____ City: _____

State: _____ Zip: _____ Phone Number: () ____--_____

B. Trainee Prerequisites

- | | YES | NO |
|--|-----------------------|-----------------------|
| 1. Possesses valid Red Card or agency certification card? | <input type="radio"/> | <input type="radio"/> |
| 2. Trainee has a proper agency initiated position task book? | <input type="radio"/> | <input type="radio"/> |
| 3. Trainee has an incident issued task book? | <input type="radio"/> | <input type="radio"/> |

C. Trainer/Evaluator Data (All fields are required to be filled in)

Trainer/Evaluator Name: _____ Position: _____

Home Unit: _____ Order Number (E, O, C, A) ____--_____

Work Address: _____ City: _____ State: _____

Zip Code: _____ Phone Number: () ____--_____

D. Trainee Goals (items in the position task book to be evaluated on this incident)

1. _____
2. _____
3. _____

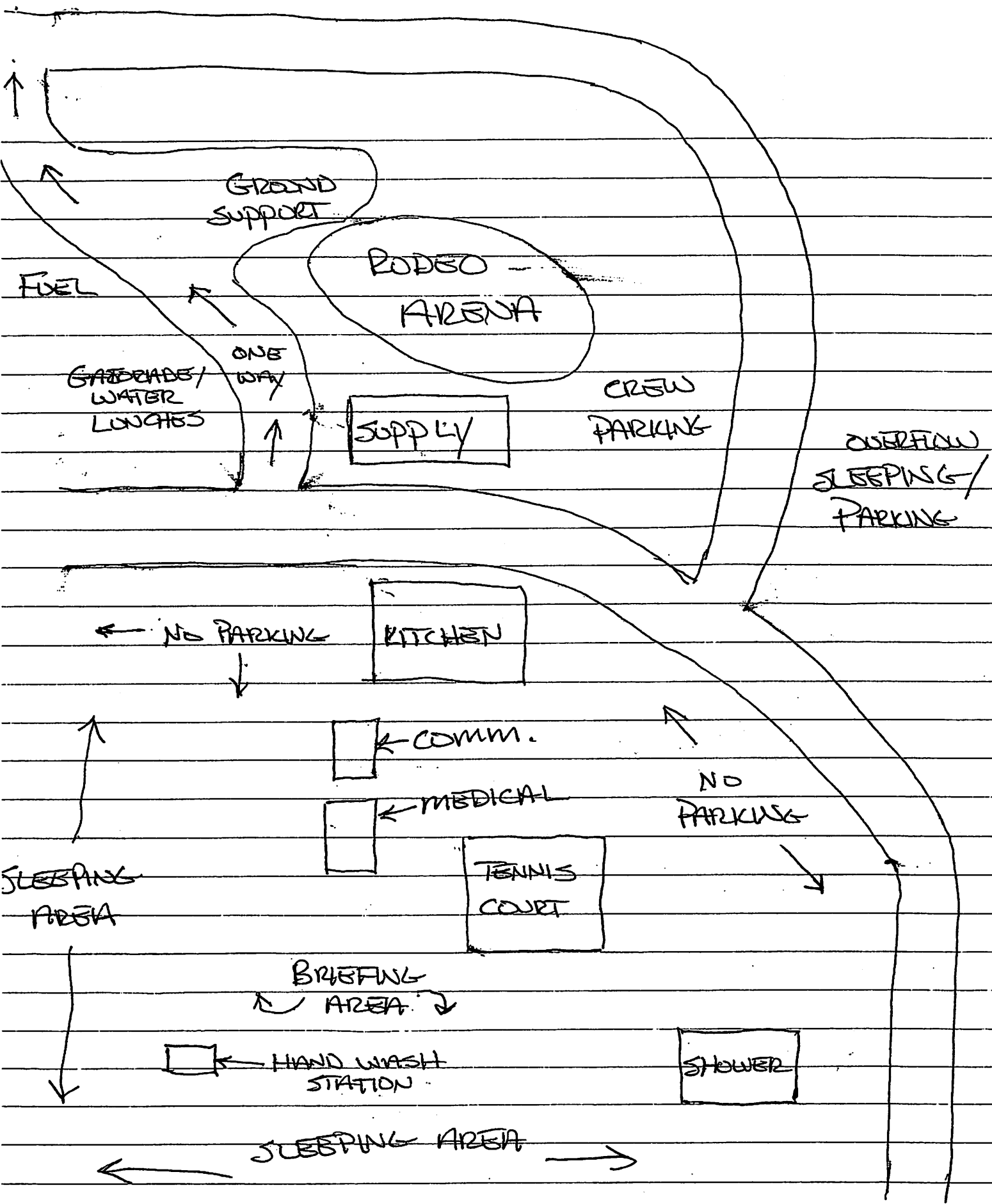

← N BASE CAMP →

8/20/13

GRANGES BLDG.

ICP

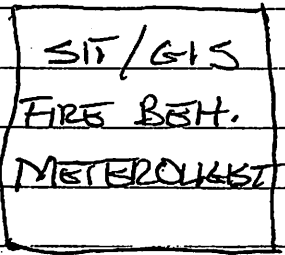
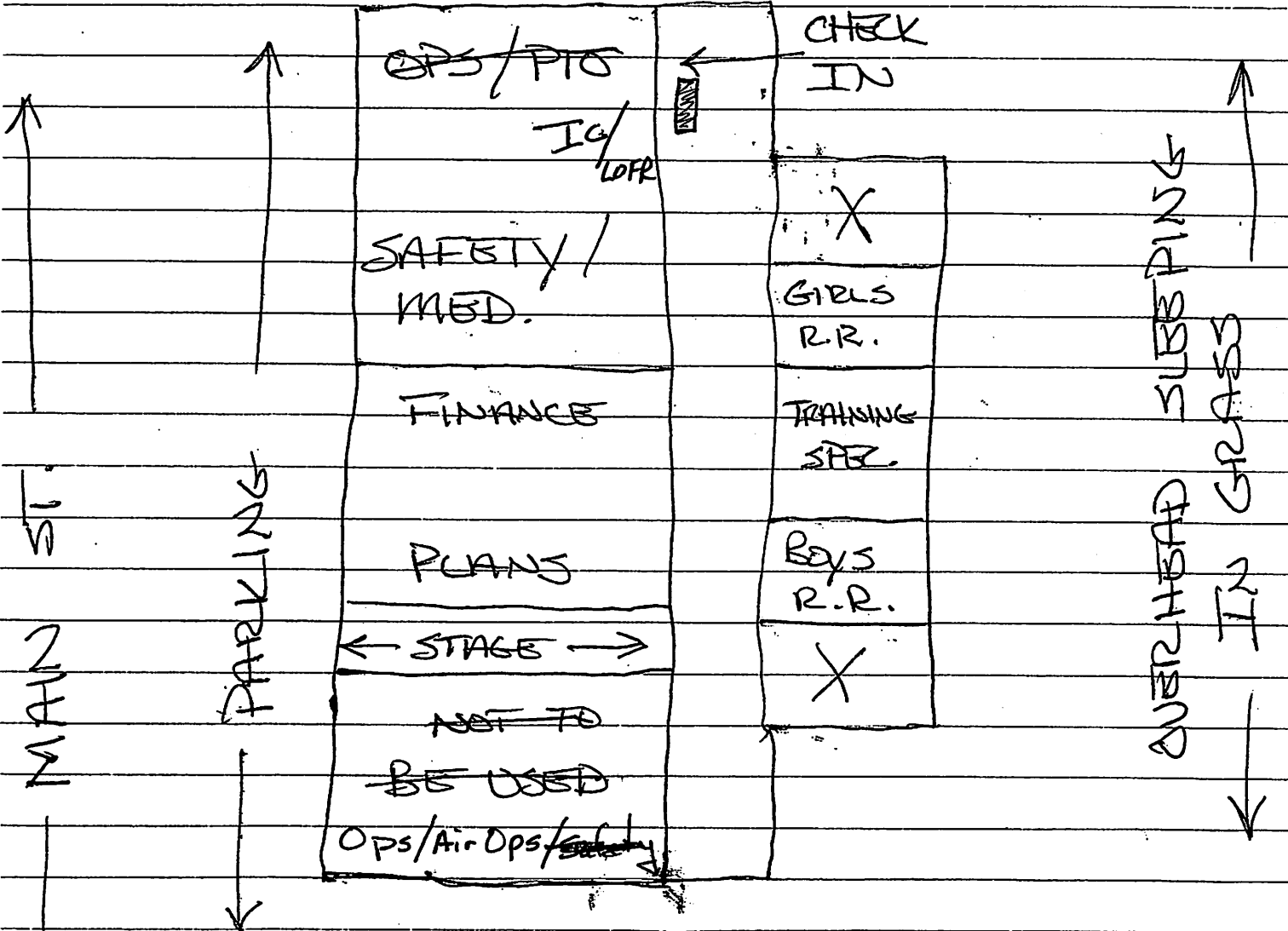
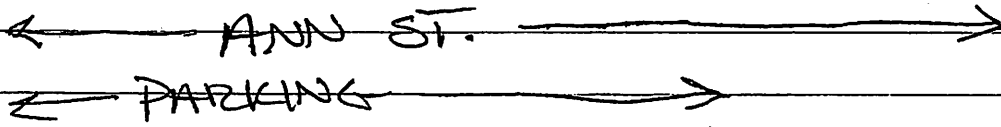
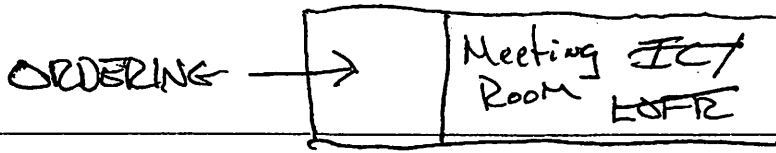

- N

8/20/13

