

# ***Corral Complex***

***CA-SRF-001494***

***PJHU49***

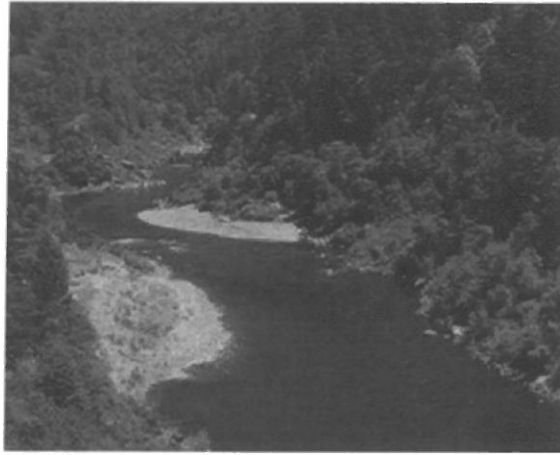

## ***Incident Action Plan***

***8-15-2013 06:00 to 8-16-2013 06:00***



***Lookouts    Communications    Escape-Routes    Safety Zones***



<b>INCIDENT OBJECTIVES</b>  <b>ICS 202</b>	1. INCIDENT NAME  <b>Corral Complex</b>	2. DATE PREPARED  <b>8/14/2013</b>	3. TIME PREPARED  <b>22:06</b>
--	---	--	--------------------------------------

4. OPERATIONAL PERIOD (DATE/TIME)  
**8-15-2013 0600 to 8-16-2013 0600**

5. GENERAL CONTROL OBJECTIVES FOR THE INCIDENT (INCLUDE ALTERNATIVES)

- Incident Objectives:**
- Provide for firefighter and public safety in all incident operations.
  - Protect property and infrastructure. Control fire closest to communities.
  - Keep stakeholders, the public, and cooperators informed of fire status.
  - Keep costs commensurate with identified values at risk.
  - Protect cultural and natural resources.
  - Protect wilderness values and utilize MIST in the Trinity Alps Wilderness.

- Operational Objectives:**
- Keep the fire:
    - o East and South of the Hoopa Valley Indian Reservation.
    - o North of Lone Pine Ridge.
    - o West of the defensible ridgeline running through Grizzly Camp and Trinity Summit along the county line, which had contingency line built in 2009 during the Backbone Fire.
    - o South of the 2009 Backbone Fire.

6. WEATHER FORECAST FOR OPERATIONAL PERIOD  
**See attached**

7. GENERAL / SAFETY MESSAGE  
**See attached**

8. ATTACHMENTS (CHECK IF ATTACHED)
- |   |  |  |
|---|--|--|
| <input checked="" type="checkbox"/> ORGANIZATION LIST (ICS 203)         | <input checked="" type="checkbox"/> MEDICAL PLAN (ICS 206) | <input checked="" type="checkbox"/> AIR OPERATIONS SUMMARY (ICS 220) |
| <input checked="" type="checkbox"/> DIVISION ASSIGNMENT LISTS (ICS 204) | <input checked="" type="checkbox"/> INCIDENT MAP           | <input checked="" type="checkbox"/> TRAINING                         |
| <input checked="" type="checkbox"/> COMMUNICATIONS PLAN (ICS 205)       | <input checked="" type="checkbox"/> TRAFFIC PLAN           | <input type="checkbox"/>   |

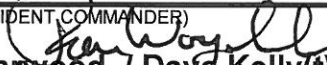
<b>ICS 202</b>	9. PREPARED BY (PLANNING SECTION CHIEF)  <b>Gerry Gardner/S. Abbott(t)</b>	10. APPROVED BY (INCIDENT COMMANDER)   <b>Don Garwood / Dave Kelly(t)</b>
----------------	--	---

ORGANIZATION ASSIGNMENT LIST ICS-203		1 INCIDENT NAME	2. DATE PREPARED	3. TIME PREPARED
		<b>Corral Complex</b>	<b>8/14/2013</b>	<b>8/14/2013 22:10</b>
5. INCIDENT COMMANDER AND STAFF		4 OPERATIONAL PERIOD (DATE/TIME) <b>8-15-2013 0600 to 8-16-2013 0600</b>		
INCIDENT COMMANDER	Don Garwood / Dave Kelly(t)	9 OPERATIONS SECTION		
DEPUTY	Ron Woychak	CHIEF	Mary Bogens	
SAFETY OFFICER	James Arragon	DEPUTY OSC		
INFORMATION OFFICER	Jim Wilkins	PLANNING OSC	Kelly Martin	
LIAISON OFFICER	Larry LaVogue	a. BRANCH I - DIVISIONS/GROUPS		
HUMAN RESOURCES	Kathleen Kreyns	BRANCH DIRECTOR	Matt Conklin	
6 AGENCY REPRESENTATIVES		DEPUTY		
AGENCY	NAME	DIVISION / GROUP	A Sal Reyes	
SRF	Mike Minton	DIVISION / GROUP	F Mitch Fowlkes	
SRF	Rick Young	DIVISION / GROUP	L Jason Escandel / Kyle Jackson(t)	
Hoopla	Rod Mendes	DIVISION / GROUP		
Cal Fire	Hugh Scanlon	DIVISION / GROUP		
Res. Cultural Adv.	Darin Jarnaghan	DIVISION / GROUP		
7. PLANNING SECTION		b. BRANCH V - DIVISIONS/GROUPS		
CHIEF	Gerry Gardner/S. Abbott(t)	BRANCH DIRECTOR	Mike Koontz	
DEPUTY		DEPUTY		
RESOURCES UNIT	Tim Knorr / Kyle Hauducoeur(t)	DIVISION / GROUP	M Bob Evans / Gordon Tamplin	
SITUATION UNIT	Jerry McClelland / Ken Van Wig(t)	DIVISION / GROUP	P Unstaffed	
DOCUMENTATION UNIT	Lorne Ellickson	DIVISION / GROUP	R Rick Marinelli	
DEMOBILIZATION UNIT	TJ McGovern	DIVISION / GROUP	W Shawn Duggar	
TECHNICAL SPECIALISTS		DIVISION / GROUP	Z Todd McDivitt	
FBAN	Rich Gonzales / Bob Eisele	DIVISION / GROUP		
LTAN	Amy Ziegler / Mike Beasley	DIVISION / GROUP		
TNSP	Betty Tattersfield	DIVISION / GROUP		
GISS	Suzanne Leininger / Rich Murillo	DIVISION / GROUP		
READ	Ramona Butz / Jesse Irwin	DIVISION / GROUP		
8. LOGISTICS SECTION		c. BRANCH III - DIVISIONS/GROUPS		
CHIEF	Eric Sweetman	BRANCH DIRECTOR		
DEPUTY LSC	Dave Haston	DEPUTY		
a. SUPPORT BRANCH		d. AIR OPERATIONS BRANCH		
DIRECTOR		AIR OPERATIONS BR. DIR.	Ted Visser	
SUPPLY UNIT	Evan Tiss	AIR ATTACK SUPERVISOR	Jim Gonzalez	
FACILITIES UNIT	Steve King / Art Curley	AIR SUPPOPRT SUPERVISOR	Galen Young	
GROUND SUPPORT UNIT	Chris Haley / Ron Noordman	HELICOPTER COORDINATOR		
b. SERVICE BRANCH		AIR TANKER COORDINATOR		
DIRECTOR		10 FINANCE SECTION		
COMMUNICATIONS UNIT	Dave Larkin	CHIEF	Debbie Rutherford / Larry Lee	
MEDICAL UNIT	Jimmie Ahl / Brian Puckett(t)	DEPUTY FSC		
FOOD UNIT	Rick Waite	TIME UNIT	Karen Bauman	
PREPARED BY (RESOURCES UNIT)		PROCUREMENT UNIT		
ICS 203		COMPENSATION/CLAIMS UNIT		
		COST UNIT		
		Tim Knorr / Kyle Hauducoeur(t)		

## SPOT WEATHER FORECAST:

IF CONDITIONS BECOME UNREPRESENTATIVE, CONTACT THE NATIONAL WEATHER SERVICE.  
SPOT FORECAST FOR CORRAL COMPLEX...SOCAL IMT #2  
NATIONAL WEATHER SERVICE EUREKA CA  
127 PM PDT WED AUG 14 2013

FORECAST IS BASED ON REQUEST TIME OF 1001 PDT ON AUGUST 14. IF CONDITIONS  
BECOME UNREPRESENTATIVE...CONTACT THE NATIONAL WEATHER SERVICE IN EUREKA AT  
(707) 443-6484.

### .DISCUSSION...

AN UPPER LEVEL RIDGE OVER THE INTER-MOUNTAIN WEST WILL BRING SEASONAL  
TEMPERATURES AND LOW AFTERNOON RH VALUES TO THE FIRE THURSDAY. OVERNIGHT RH  
RECOVERIES SHOULD BE DECENT IN THE VALLEYS BUT POORER AT THE HIGHER  
ELEVATIONS. A TROUGH APPROACHING THE REGION TOWARD THE END OF THE WEEK SHOULD  
ALLOW TEMPERATURES TO COOL SLIGHTLY AND FOR RH VALUES TO IMPROVE THURSDAY  
NIGHT INTO SATURDAY.

### .THURSDAY...

SKY/WEATHER.....MOSTLY SUNNY. AREAS OF SMOKE.  
MAX TEMPERATURE.....AROUND 81.  
MIN HUMIDITY.....28 PERCENT.  
EYE LEVEL WINDS.....LIGHT TERRAIN DRIVEN WINDS BECOMING WEST-SOUTHWEST  
3 TO 5 MPH IN THE AFTERNOON.  
MIXING HEIGHT.....900 FT AGL INCREASING TO 9000 FT AGL  
LATE IN THE MORNING...THEN DECREASING TO 6000  
FT AGL LATE IN THE AFTERNOON.  
MIXING WINDS.....SOUTH AROUND 9 MPH.  
WIND (20 FT).....LIGHT TERRAIN DRIVEN WINDS BECOMING SOUTHWEST 5 TO  
6 MPH GUSTING TO 13 MPH IN THE AFTERNOON.  
VALLEY INVERSION....3500 FEET...PERSISTING THROUGH THE DAY.

### .THURSDAY NIGHT...

SKY/WEATHER.....PARTLY CLOUDY. AREAS OF SMOKE.  
MIN TEMPERATURE.....AROUND 57.  
MAX HUMIDITY.....65 PERCENT.  
EYE LEVEL WINDS.....SOUTHWEST WINDS AROUND 5 MPH IN THE EVENING BECOMING  
LIGHT AND TERRAIN DRIVEN.  
MIXING HEIGHT.....6000 FT AGL DECREASING TO 500 FT AGL EARLY  
IN THE EVENING.  
MIXING WINDS.....NORTH AROUND 4 MPH.  
WIND (20 FT).....WEST WINDS AROUND 5 MPH IN THE EVENING BECOMING  
LIGHT AND TERRAIN DRIVEN.  
VALLEY INVERSION....3000 FEET.

### .FRIDAY...

SKY/WEATHER.....MOSTLY SUNNY. AREAS OF SMOKE.  
MAX TEMPERATURE.....AROUND 81.  
MIN HUMIDITY.....33 PERCENT.  
EYE LEVEL WINDS.....LIGHT AND TERRAIN DRIVEN BECOMING WEST NORTHWEST  
AROUND 5 MPH IN THE AFTERNOON.  
MIXING HEIGHT.....500 FT AGL INCREASING TO 5000 FT AGL LATE  
IN THE MORNING...THEN DECREASING TO 3500 FT  
AGL LATE IN THE AFTERNOON.  
MIXING WINDS.....SOUTHWEST AROUND 7 MPH.  
WIND (20 FT).....LIGHT TERRAIN DRIVEN WINDS BECOMING WEST NORTHWEST  
AROUND 5 MPH IN THE AFTERNOON.  
VALLEY INVERSION....3000 FEET...DISSIPATING AROUND 2 PM.

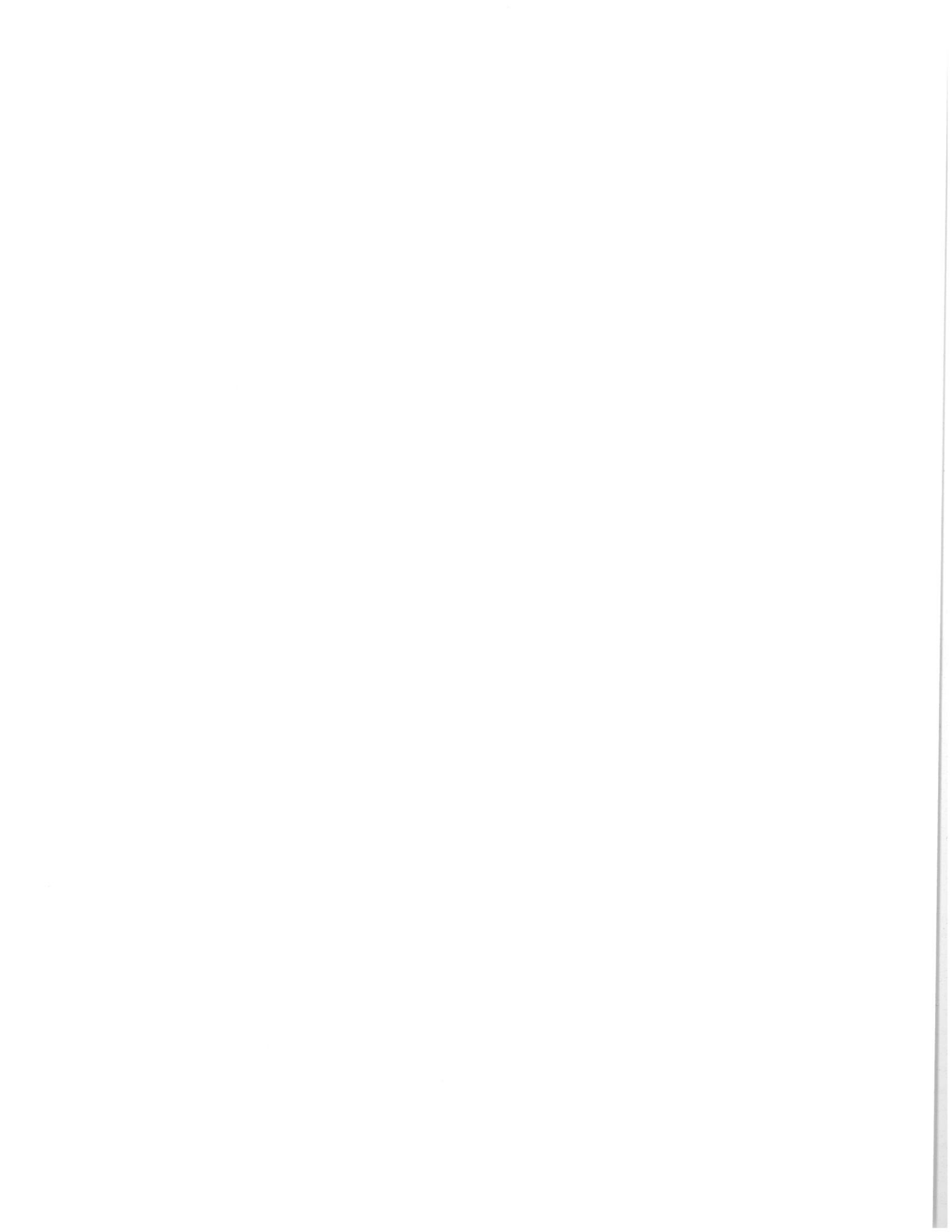

## FIRE BEHAVIOR FORECAST

<b>FORECAST NUMBER: #2</b>	<b>TYPE OF FIRE: Wildfire</b>
<b>FIRE NAME: CORRAL</b>	<b>OPERATIONAL PERIOD: August 15-16, 2013 0600-0600</b>
<b>DATE ISSUED: August 14, 2013</b>	<b>TIME ISSUED: 1800 hrs</b>
<b>UNIT: Six Rivers NF</b>	<b>SIGNED: Richard Gonzales, FBAN</b> 

### INPUTS

#### WEATHER SUMMARY

**Refer to Weather Forecast for details:** Mostly sunny. Max Temp: 80-82°. Min RH: 26-30%.  
Eye Level Winds: Light terrain driven winds becoming West-Southwest 3-5 mph in the afternoon

#### FUELS

Fires are burning within the Megram Fire (1999) and Back Bone Fire (2009). Fuels consist of abundant Heavy Dead and Down, Snags and Shrubs (Ceanothus/Snow Brush).  
Minimum fine fuel moisture: 6%, 1000 hour FMC: 9%, Live fuel moisture: 120%. Persistent drought conditions.

### OUTPUTS - FIRE BEHAVIOR

#### GENERAL:

The primary carrier of the Fires are horizontal stacked logs and branches that have fallen due to previous Fires (Megram 1999 and Back Bone 2009). Fires are slowly creeping through these fuels and consuming shrubs and snags. Snags are producing embers that are contributing to forward progress by spotting ahead.

Expect today's fire behavior to be similar to yesterday. Expect uncontrolled areas of heat along the perimeter. Heat will hold longer in the heavier fuels and in the drainage bottoms.

Corral Fire: continue to creep and back with available fuels. Growth is occurring northerly into the Back Bone Fire scar. Along the eastern flank, the Fire will continue backing towards Horse Linto Creek and establish in the drainage. Watch out for uphill runs on west facing slope as heat builds.

Patterson and Swamp Fires will continue to creep and back with available fuels.

The fire behavior potential will increase in the afternoon as the wind speeds increase. This will be most pronounced on exposed ridges and slopes where the wind alignment occurs.

Maximum Fire Behavior Potential (Head Fire): Rate of Spread: 5 ch/hr. Flame Length: 3-4 ft. Probability of Ignition: 80%. Max spotting distance up to 1/8 mile (observed).

Local Thresholds for active fire behavior: 20' Windspeed > 7 mph; RH < 31%; Temps > 82°; 1000 hr FM < 13; BI > 50; ERC > 47.

Predicted Indices: BI- 59 (down 2) and ERC- 59 (down 1)

**FEEDBACK:** Collect WX obs hourly and turn in to FBAN or IMET at end of shift..include observed fire behavior.

### AIR OPERATIONS

Air support may be limited due to Inversion.

### SAFETY.

When developing strategies and tactics, safety zones and escape routes, you should be evaluating potential fire behavior (worst case scenario), not just observed fire behavior.

## Fire Danger Rating Areas 112/113/115 Energy Release Component

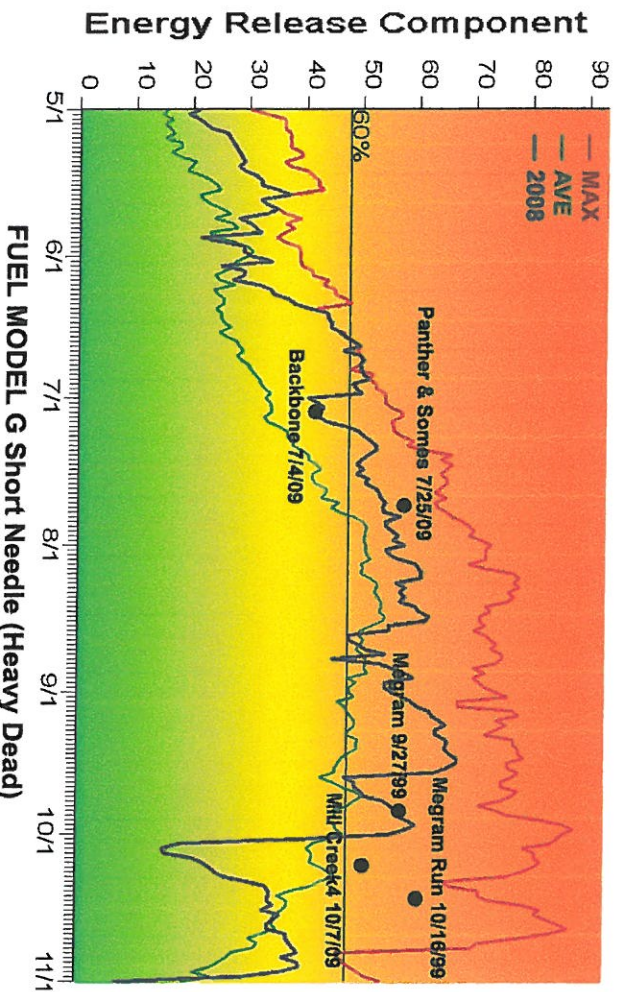

## Fire Danger Rating Areas 112/113/115 Burning Index

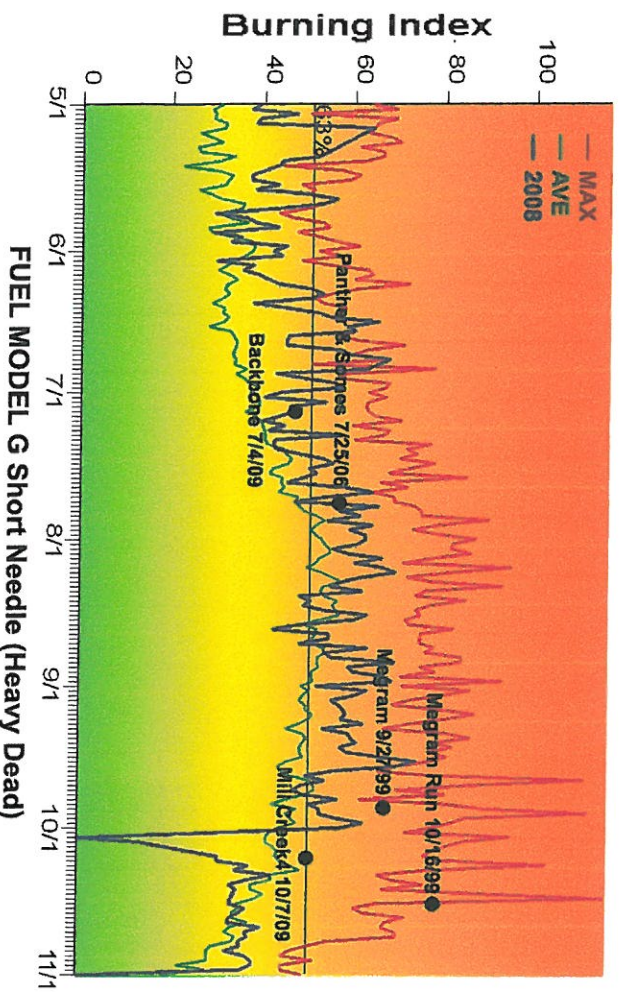

- Fire Danger Areas 112/113/115:
- \* 112 - Orleans Ranger District
  - \* 113 - Hoopa Indian Reservation
  - \* 115 - Lower Trinity Ranger District
  - \* NW CA - Region 5
- Weather Stations Used:
- \* 040404 Brush Mountain
  - \* 040408 Hoopa (NFDRS)
  - \* 040519 Underwood (NFDRS)



### Local Thresholds - WATCHOUT:

Combinations of any of these factors can greatly increase fire behavior: 20+ Windspeed over 7 mph; RH less than 31%; Temperature over 82; 1000-hour Fuel Moisture less than 13. Large fires become more frequent when BI exceeds 50 and when ERC exceeds 47.

**Graph Interpretation, Energy Release Component:**  
 Maximum = Highest ERC by day for 1979-2009  
 Average = Shows Peak Fire Season  
 60% = 60th Percentile means 60% of days observed had an ERC below 47.

### PAST EXPERIENCE / LOCAL KNOWLEDGE:

- Wildfires become a problem @ 50 acres on the Six Rivers NF due to topography, fuels, and accessibility. (Large fires=50 acres)
- Large fires become more frequent when 1000 hour fuel moistures drop below 13
- Large fires become more frequent when BI exceeds 50
- Large fires become more frequent when ERC exceeds 47
- High severity, past burn areas with heavy snag / dead and down lead to control problems. (Backbone was a result of this, as it started in the Megram fire area of 99)
- \* Afternoon winds in the Trinity River Drainage greatly influence fire behavior.
- \* Coastal fog observed from the Trinity Valley is a good indicator of strong down canyon winds in side drainages west of the river.
- \* Klamath River Canyon has very strong up-river winds daily, from the border near Weitchpec to the confluence with the Salmon River. Expect strong winds in the afternoon until sundown. Potential thermal belt up to approx. 2000'.

**Graph Interpretation, Burning Index:**  
 Maximum = Highest BI by day for 1979-2009  
 Average = Shows Peak Fire Season  
 63% = 63rd Percentile means 63% of all days observed had a BI below 50.



1. BRANCH <b>I</b>		2. DIVISION/GROUP <b>A</b>		<b>DIVISION ASSIGNMENT LIST ICS 204</b>				
3. INCIDENT NAME <b>Corral Complex</b>				4. OPERATIONAL PERIOD <b>8-15-2013 0600 to 8-16-2013 0600</b>				
5. OPERATIONS PERSONNEL								
OPERATIONS CHIEF <b>Mary Bogens</b>			DIVISION/GROUP SUPERVISOR <b>Sal Reyes</b>					
BRANCH DIRECTOR <b>Matt Conklin</b>			AIR ATTACK SUPERVISOR <b>Jim Gonzalez</b>					
6. RESOURCES ASSIGNED THIS PERIOD								
STRIKE TEAM/TASK FORCE/ RESOURCE DESIGNATOR		LEADER	NUMBER PERSONS	TRANS. NEEDED	DROP OFF POINT / TIME	PICK UP POINT / TIME		
<b>San Juan IHC (C-13)</b>		<b>John Godson</b>	<b>19</b>		<b>0600</b>	<b>2000</b>		
<b>Northern Colorado #1 (C-11)</b>		<b>Reid Marquart</b>	<b>20</b>		<b>0600</b>	<b>2000</b>		
<b>2 DOZ1</b>					<b>0600</b>	<b>2000</b>		
<b>2 HEQB</b>					<b>0600</b>	<b>2000</b>		
<b>DOZB</b>		<b>James Rust</b>			<b>0600</b>	<b>2000</b>		
7. CONTROL OPERATIONS Continue scouting for potential contingency lines in the division.								
8. SPECIAL INSTRUCTIONS Map retardant drops and submit to READ. All Branch I resources report to the wash station prior to and exiting Hoopa reservation.								
9. DIVISION/GROUP COMMUNICATIONS SUMMARY								
FUNCTION		FREQ.	SYSTEM	CHAN.	FUNCTION	FREQ.	SYSTEM	CHAN.
COMMAND	LOCAL	See ICS205			SUPPORT			
	REPEAT	on back						
DIV./GROUP TACTICAL		See ICS205			GROUND TO AIR	See ICS205		
		on back				on back		
PREPARED BY (RESOURCE UNIT LDR.) <b>Tim Knorr / Kyle Hauducoeur(t)</b>				APPROVED BY (PLANNING SECT. CH.) <b>Gerry Gardner/S. Abbott(t)</b>		DATE 8/14/2013	TIME <b>8/14/2013 22:47</b>	

<b>INCIDENT RADIO COMMUNICATION PLAN</b>	Incident Name	Date/Time Prepared	Operational Period Date/Time
	<b>Corral Complex Fire</b>	8-14-13 2000 hrs	8-15-13 thru 8-16-13 0600-0600 (24 hrs)

**Radio Channel Utilization**

Ch#	Function	Channel Name	Assignment	Frequency	Remarks
1	COMMAND	NIFC C-1	ALL DIVISIONS	Rx: 168.7000 Tx: 170.9750	Trinity Summit <b>Tone 11 (114.8)</b>
2	COMMAND <b>(Pending)</b>	NIFC C-8	ALL DIVISIONS	Rx: 169.5375 Tx: 164.7125	Ironside Mtn <b>Tone 11 (114.8)</b>
3			Unassigned		
4	BACKUP COMMAND NET	SRF ADM	ALL DIVISIONS	Rx: 168.1250 Tx: 170.4750	<b>Tone 13 (141.3)</b> <b>Tone 3 (131.8)</b>
5	TACTICAL	NIFC T-5	DIVISION A	166.7250	
6	TACTICAL	NIFC T-6	DIVISION F	166.7750	
7	TACTICAL	NIFC T-7	DIVISION L	168.2500	
8	TACTICAL	R5 TAC 4	DIVISION M	166.5500	
9	TACTICAL	R5 TAC 5	DIVISION R	167.1125	
10	TACTICAL	R5 TAC 6	DIVISION Z	168.2375	
11	AIR-TO-GROUND	A/G	ALL DIVISIONS	167.0625	
12	TACTICAL	VFIRE 24	DIVISION W	154.2725	<b>Tone 6 (156.7)</b>
13	TACTICAL	VFIRE 25	DIVISION P	154.2875	<b>Tone 6 (156.7)</b>
14	TACTICAL	VFIRE 26	Unassigned	154.3025	<b>Tone 6 (156.7)</b>
15	MED A/G TAC	CALCORD	ALL DIVISIONS	156.0750	MEDICAL EMERG <b>Tone 6 (156.7)</b>
16/20	AIR GUARD	GUARD	ALL DIVISIONS	168.6250	EMERGENCY ONLY <b>Tone 1 (110.9)</b>

**Notes:**

Prepared by:  
David Larkin COML

1. BRANCH <b>I</b>	2. DIVISION/GROUP <b>F</b>	<b>DIVISION ASSIGNMENT LIST ICS 204</b>
-----------------------	-------------------------------	---

3. INCIDENT NAME <b>Corral Complex</b>	4. OPERATIONAL PERIOD <b>8-15-2013 0600 to 8-16-2013 0600</b>
---	--

5. OPERATIONS PERSONNEL			
OPERATIONS CHIEF <b>Mary Bogens</b>		DIVISION/GROUP SUPERVISOR <b>Mitch Fowlkes</b>	
BRANCH DIRECTOR <b>Matt Conklin</b>		AIR ATTACK SUPERVISOR <b>Jim Gonzalez</b>	

6. RESOURCES ASSIGNED THIS PERIOD					
STRIKE TEAM/TASK FORCE/ RESOURCE DESIGNATOR	LEADER	NUMBER PERSONS	TRANS. NEEDED	DROP OFF POINT / TIME	PICK UP POINT / TIME
<b>Kern Valley IHC</b>	<b>(need to checkin)</b>			<b>0600</b>	<b>2000</b>
<b>Smith River IHC (c-9)</b>	<b>Tim Memmer</b>	<b>21</b>		<b>0600</b>	<b>2000</b>
<b>2 HEQB</b>				<b>0600</b>	<b>2000</b>
<b>2 DOZ1</b>				<b>0600</b>	<b>2000</b>

7. CONTROL OPERATIONS  
Continue scouting for potential contingency lines in the division.

8. SPECIAL INSTRUCTIONS  
Map retardant drops and submit to READ. All Branch I resources report to the wash station prior to and exiting Hoopa reservation.

9. DIVISION/GROUP COMMUNICATIONS SUMMARY									
FUNCTION	LOCAL REPEAT	FREQ.	SYSTEM	CHAN.	FUNCTION	LOCAL REPEAT	FREQ.	SYSTEM	CHAN.
COMMAND		See ICS205 on back			SUPPORT				
DIV./GROUP TACTICAL		See ICS205 on back			GROUND TO AIR		See ICS205 on back		

PREPARED BY (RESOURCE UNIT LDR.) <b>Tim Knorr / Kyle Hauducoeur(t)</b>	APPROVED BY (PLANNING SECT. CH.) <b>Gerry Gardner/S. Abbott(t)</b>	DATE 8/14/2013	TIME <b>8/14/2013 22:47</b>
---	---	-------------------	--------------------------------

<b>INCIDENT RADIO COMMUNICATION PLAN</b>	Incident Name	Date/Time Prepared	Operational Period Date/Time
	<b>Corral Complex Fire</b>	8-14-13 2000 hrs	8-15-13 thru 8-16-13 0600-0600 (24 hrs)

**Radio Channel Utilization**

Ch#	Function	Channel Name	Assignment	Frequency	Remarks
1	COMMAND	NIFC C-1	ALL DIVISIONS	Rx: 168.7000 Tx: 170.9750	Trinity Summit <b>Tone 11 (114.8)</b>
2	COMMAND (Pending)	NIFC C-8	ALL DIVISIONS	Rx: 169.5375 Tx: 164.7125	Ironside Mtn <b>Tone 11 (114.8)</b>
3			Unassigned		
4	BACKUP COMMAND NET	SRF ADM	ALL DIVISIONS	Rx: 168.1250 Tx: 170.4750	<b>Tone 13 (141.3)</b> <b>Tone 3 (131.8)</b>
5	TACTICAL	NIFC T-5	DIVISION A	166.7250	
6	TACTICAL	NIFC T-6	DIVISION F	166.7750	
7	TACTICAL	NIFC T-7	DIVISION L	168.2500	
8	TACTICAL	R5 TAC 4	DIVISION M	166.5500	
9	TACTICAL	R5 TAC 5	DIVISION R	167.1125	
10	TACTICAL	R5 TAC 6	DIVISION Z	168.2375	
11	AIR-TO-GROUND	A/G	ALL DIVISIONS	167.0625	
12	TACTICAL	VFIRE 24	DIVISION W	154.2725	<b>Tone 6 (156.7)</b>
13	TACTICAL	VFIRE 25	DIVISION P	154.2875	<b>Tone 6 (156.7)</b>
14	TACTICAL	VFIRE 26	Unassigned	154.3025	<b>Tone 6 (156.7)</b>
15	MED A/G TAC	CALCORD	ALL DIVISIONS	156.0750	MEDICAL EMERG <b>Tone 6 (156.7)</b>
16/20	AIR GUARD	GUARD	ALL DIVISIONS	168.6250	EMERGENCY ONLY <b>Tone 1 (110.9)</b>

**Notes:**

Prepared by:  
David Larkin COML

1. BRANCH <b>I</b>	2. DIVISION/GROUP <b>L</b>	<b>DIVISION ASSIGNMENT LIST ICS 204</b>
-----------------------	-------------------------------	---

3. INCIDENT NAME <b>Corral Complex</b>	4. OPERATIONAL PERIOD <b>8-15-2013 0600 to 8-16-2013 0600</b>
---	--

5. OPERATIONS PERSONNEL			
OPERATIONS CHIEF	<b>Mary Bogens</b>	DIVISION/GROUP SUPERVISOR	<b>Jason Escandel/ Kyle Jackson</b>
BRANCH DIRECTOR	<b>Matt Conklin</b>	AIR ATTACK SUPERVISOR	<b>Jim Gonzalez</b>

6. RESOURCES ASSIGNED THIS PERIOD					
STRIKE TEAM/TASK FORCE/ RESOURCE DESIGNATOR	LEADER	NUMBER PERSONS	TRANS. NEEDED	DROP OFF POINT / TIME	PICK UP POINT / TIME
<b>4 excavators with masticator</b>				<b>0600</b>	<b>2000</b>
<b>2 excavators with thumb</b>				<b>0600</b>	<b>2000</b>
<b>4 feller bunchers</b>				<b>0600</b>	<b>2000</b>

7. CONTROL OPERATIONS Validate location of contingency line in Trinity Wilderness.
---

8. SPECIAL INSTRUCTIONS Map retardant drops and submit to READ. All Branch I resources report to the wash station prior to and exiting Hoopa reservation.
--

9. DIVISION/GROUP COMMUNICATIONS SUMMARY							
FUNCTION	FREQ.	SYSTEM	CHAN.	FUNCTION	FREQ.	SYSTEM	CHAN.
COMMAND	LOCAL REPEAT	See ICS205 on back		SUPPORT	LOCAL REPEAT		
DIV./GROUP TACTICAL		See ICS 205 on back		GROUND TO AIR	See ICS205 on back		

PREPARED BY (RESOURCE UNIT LDR.) <b>Tim Knorr / Kyle Hauducoeur(t)</b>	APPROVED BY (PLANNING SECT. CH.) <b>Gerry Gardner/S. Abbott(t)</b>	DATE 8/14/2013	TIME <b>8/14/2013 22:47</b>
---	---	-------------------	--------------------------------

<b>INCIDENT RADIO COMMUNICATION PLAN</b>	Incident Name	Date/Time Prepared	Operational Period Date/Time
	<b>Corral Complex Fire</b>	8-14-13 2000 hrs	8-15-13 thru 8-16-13 0600-0600 (24 hrs)

**Radio Channel Utilization**

Ch#	Function	Channel Name	Assignment	Frequency	Remarks
1	COMMAND	NIFC C-1	ALL DIVISIONS	Rx: 168.7000 Tx: 170.9750	Trinity Summit <b>Tone 11 (114.8)</b>
2	COMMAND (Pending)	NIFC C-8	ALL DIVISIONS	Rx: 169.5375 Tx: 164.7125	Ironside Mtn <b>Tone 11 (114.8)</b>
3			Unassigned		
4	BACKUP COMMAND NET	SRF ADM	ALL DIVISIONS	Rx: 168.1250 Tx: 170.4750	<b>Tone 13 (141.3)</b> <b>Tone 3 (131.8)</b>
5	TACTICAL	NIFC T-5	DIVISION A	166.7250	
6	TACTICAL	NIFC T-6	DIVISION F	166.7750	
7	TACTICAL	NIFC T-7	DIVISION L	168.2500	
8	TACTICAL	R5 TAC 4	DIVISION M	166.5500	
9	TACTICAL	R5 TAC 5	DIVISION R	167.1125	
10	TACTICAL	R5 TAC 6	DIVISION Z	168.2375	
11	AIR-TO-GROUND	A/G	ALL DIVISIONS	167.0625	
12	TACTICAL	VFIRE 24	DIVISION W	154.2725	<b>Tone 6 (156.7)</b>
13	TACTICAL	VFIRE 25	DIVISION P	154.2875	<b>Tone 6 (156.7)</b>
14	TACTICAL	VFIRE 26	Unassigned	154.3025	<b>Tone 6 (156.7)</b>
15	MED A/G TAC	CALCORD	ALL DIVISIONS	156.0750	MEDICAL EMERG <b>Tone 6 (156.7)</b>
16/20	AIR GUARD	GUARD	ALL DIVISIONS	168.6250	EMERGENCY ONLY <b>Tone 1 (110.9)</b>

**Notes:**

Prepared by:  
David Larkin COML

1. BRANCH <b>V</b>	2. DIVISION/GROUP <b>M</b>	<b>DIVISION ASSIGNMENT LIST ICS 204</b>
-----------------------	-------------------------------	---

3. INCIDENT NAME <b>Corral Complex</b>	4. OPERATIONAL PERIOD <b>8-15-2013 0600 to 8-16-2013 0600</b>
---	--

5. OPERATIONS PERSONNEL			
OPERATIONS CHIEF <u><b>Mary Bogens</b></u>	DIVISION/GROUP SUPERVISOR <u><b>Bob Evans / Gordon Tamplin</b></u>		
BRANCH DIRECTOR <u><b>Mike Koontz</b></u>	AIR ATTACK SUPERVISOR <u><b>Jim Gonzalez</b></u>		

6. RESOURCES ASSIGNED THIS PERIOD					
STRIKE TEAM/TASK FORCE/ RESOURCE DESIGNATOR	LEADER	NUMBER PERSONS	TRANS. NEEDED	DROP OFF POINT / TIME	PICK UP POINT / TIME

7. CONTROL OPERATIONS Evaluate potential heilspots for crew shuttle. Prep structures at Trinity Summit Guard Station and prepare to wrap.
--

8. SPECIAL INSTRUCTIONS Map retardant drops and submit to READ. <b>SOFR Jerry Wheeless will be assigned to all divisions on Branch V.</b> No DIP in Mill Creek Lake and Water Dog Lakes. Ensure dip and delivery remains west of the Six Rivers / Shasta NF boundary.
--

9. DIVISION/GROUP COMMUNICATIONS SUMMARY								
FUNCTION	FREQ.	SYSTEM	CHAN.	FUNCTION	FREQ.	SYSTEM	CHAN.	
COMMAND	LOCAL REPEAT	See ICS205 on back		SUPPORT	LOCAL REPEAT			
DIV./GROUP TACTICAL		See ICS205 on back		GROUND TO AIR	See ICS205 on back			

PREPARED BY (RESOURCE UNIT LDR.) <b>Tim Knorr / Kyle Hauducoeur(t)</b>	APPROVED BY (PLANNING SECT. CH.) <b>Gerry Gardner/S. Abbott(t)</b>	DATE 8/14/2013	TIME <b>M</b>
---	---	-------------------	------------------

<b>INCIDENT RADIO COMMUNICATION PLAN</b>	Incident Name	Date/Time Prepared	Operational Period Date/Time
	<b>Corral Complex Fire</b>	8-14-13 2000 hrs	8-15-13 thru 8-16-13 0600-0600 (24 hrs)

**Radio Channel Utilization**

Ch#	Function	Channel Name	Assignment	Frequency	Remarks
1	COMMAND	NIFC C-1	ALL DIVISIONS	Rx: 168.7000 Tx: 170.9750	Trinity Summit <b>Tone 11 (114.8)</b>
2	COMMAND (Pending)	NIFC C-8	ALL DIVISIONS	Rx: 169.5375 Tx: 164.7125	Ironside Mtn <b>Tone 11 (114.8)</b>
3			Unassigned		
4	BACKUP COMMAND NET	SRF ADM	ALL DIVISIONS	Rx: 168.1250 Tx: 170.4750	<b>Tone 13 (141.3)</b> <b>Tone 3 (131.8)</b>
5	TACTICAL	NIFC T-5	DIVISION A	166.7250	
6	TACTICAL	NIFC T-6	DIVISION F	166.7750	
7	TACTICAL	NIFC T-7	DIVISION L	168.2500	
8	TACTICAL	R5 TAC 4	DIVISION M	166.5500	
9	TACTICAL	R5 TAC 5	DIVISION R	167.1125	
10	TACTICAL	R5 TAC 6	DIVISION Z	168.2375	
11	AIR-TO-GROUND	A/G	ALL DIVISIONS	167.0625	
12	TACTICAL	VFIRE 24	DIVISION W	154.2725	<b>Tone 6 (156.7)</b>
13	TACTICAL	VFIRE 25	DIVISION P	154.2875	<b>Tone 6 (156.7)</b>
14	TACTICAL	VFIRE 26	Unassigned	154.3025	<b>Tone 6 (156.7)</b>
15	MED A/G TAC	CALCORD	ALL DIVISIONS	156.0750	MEDICAL EMERG <b>Tone 6 (156.7)</b>
16/20	AIR GUARD	GUARD	ALL DIVISIONS	168.6250	EMERGENCY ONLY <b>Tone 1 (110.9)</b>

**Notes:**

Prepared by:  
David Larkin COML





<b>INCIDENT RADIO COMMUNICATION PLAN</b>	Incident Name	Date/Time Prepared	Operational Period Date/Time
	<b>Corral Complex Fire</b>	8-14-13 2000 hrs	8-15-13 thru 8-16-13 0600-0600 (24 hrs)

**Radio Channel Utilization**

Ch#	Function	Channel Name	Assignment	Frequency	Remarks
1	COMMAND	NIFC C-1	ALL DIVISIONS	Rx: 168.7000 Tx: 170.9750	Trinity Summit <b>Tone 11 (114.8)</b>
2	COMMAND (Pending)	NIFC C-8	ALL DIVISIONS	Rx: 169.5375 Tx: 164.7125	Ironside Mtn <b>Tone 11 (114.8)</b>
3			Unassigned		
4	BACKUP COMMAND NET	SRF ADM	ALL DIVISIONS	Rx: 168.1250 Tx: 170.4750	<b>Tone 13 (141.3)</b> <b>Tone 3 (131.8)</b>
5	TACTICAL	NIFC T-5	DIVISION A	166.7250	
6	TACTICAL	NIFC T-6	DIVISION F	166.7750	
7	TACTICAL	NIFC T-7	DIVISION L	168.2500	
8	TACTICAL	R5 TAC 4	DIVISION M	166.5500	
9	TACTICAL	R5 TAC 5	DIVISION R	167.1125	
10	TACTICAL	R5 TAC 6	DIVISION Z	168.2375	
11	AIR-TO-GROUND	A/G	ALL DIVISIONS	167.0625	
12	TACTICAL	VFIRE 24	DIVISION W	154.2725	<b>Tone 6 (156.7)</b>
13	TACTICAL	VFIRE 25	DIVISION P	154.2875	<b>Tone 6 (156.7)</b>
14	TACTICAL	VFIRE 26	Unassigned	154.3025	<b>Tone 6 (156.7)</b>
15	MED A/G TAC	CALCORD	ALL DIVISIONS	156.0750	MEDICAL EMERG <b>Tone 6 (156.7)</b>
16/20	AIR GUARD	GUARD	ALL DIVISIONS	168.6250	EMERGENCY ONLY <b>Tone 1 (110.9)</b>

**Notes:**

Prepared by:  
David Larkin COML

1. BRANCH <b>V</b>	2. DIVISION/GROUP <b>R</b>	<b>DIVISION ASSIGNMENT LIST ICS 204</b>
-----------------------	-------------------------------	---

3. INCIDENT NAME <b>Corral Complex</b>	4. OPERATIONAL PERIOD <b>8-15-2013 0600 to 8-16-2013 0600</b>
---	--

5. OPERATIONS PERSONNEL			
OPERATIONS CHIEF	<b>Mary Bogens</b>	DIVISION/GROUP SUPERVISOR	<b>Rick Marinelli</b>
BRANCH DIRECTOR	<b>Mike Koontz</b>	AIR ATTACK SUPERVISOR	<b>Jim Gonzalez</b>

6. RESOURCES ASSIGNED THIS PERIOD					
STRIKE TEAM/TASK FORCE/ RESOURCE DESIGNATOR	LEADER	NUMBER PERSONS	TRANS. NEEDED	DROP OFF POINT / TIME	PICK UP POINT / TIME
<b>Dalton IHC (C-1)</b>	<b>Steve Robles</b>	<b>20</b>		<b>0600</b>	<b>2000</b>
<b>Corral Task Force 1</b>	Benjie Stewart/Mike Anderson(t)			<b>0600</b>	<b>2000</b>
<b>Faller module (E-20)</b>		<b>2</b>		<b>0600</b>	<b>2000</b>
<b>Faller (SRF Lightning O-32)</b>	<b>Theodore Scwhartz</b>	<b>1</b>		<b>0600</b>	<b>2000</b>

7. CONTROL OPERATIONS  
Construct line on the contingency, working towards the guard station.

8. SPECIAL INSTRUCTIONS  
Map retardant drops and submit to READ. Corral Task force 1 consists of TFLD Benjie Stewart and TFLD(t) Mike Anderson, Trinity IHC (shasta C #unknown), CRW2IA Rio Grande (shasta C #unknown) , CRW2IA South Carolina (shasta C #unknown) , CRW2 Shasta CCC (shasta C #unknown). **SOFR Jerry Wheeless will be assigned to all divisions on Branch V.** No DIP in Mill Creek Lake and Water Dog Lakes. Ensure dip and delivery remains west of the Six Rivers / Shasta NF boundary.

9. DIVISION/GROUP COMMUNICATIONS SUMMARY							
FUNCTION	LOCAL REPEAT	FREQ.	SYSTEM	CHAN.	FUNCTION	LOCAL REPEAT	FREQ.
COMMAND		See ICS205 on back			SUPPORT		
DIV./GROUP TACTICAL		See ICS205 on back			GROUND TO AIR		See ICS205 on back

PREPARED BY (RESOURCE UNIT LDR.) <b>Tim Knorr / Kyle Hauducoeur(t)</b>	APPROVED BY (PLANNING SECT. CH.) <b>Gerry Gardner/S. Abbott(t)</b>	DATE 8/14/2013	TIME <b>8/14/2013 22:47</b>
---	---	-------------------	--------------------------------

<b>INCIDENT RADIO COMMUNICATION PLAN</b>	Incident Name	Date/Time Prepared	Operational Period Date/Time
	<b>Corral Complex Fire</b>	8-14-13 2000 hrs	8-15-13 thru 8-16-13 0600-0600 (24 hrs)

**Radio Channel Utilization**

Ch#	Function	Channel Name	Assignment	Frequency	Remarks
1	COMMAND	NIFC C-1	ALL DIVISIONS	Rx: 168.7000 Tx: 170.9750	Trinity Summit <b>Tone 11 (114.8)</b>
2	COMMAND (Pending)	NIFC C-8	ALL DIVISIONS	Rx: 169.5375 Tx: 164.7125	Ironside Mtn <b>Tone 11 (114.8)</b>
3			Unassigned		
4	BACKUP COMMAND NET	SRF ADM	ALL DIVISIONS	Rx: 168.1250 Tx: 170.4750	<b>Tone 13 (141.3)</b> <b>Tone 3 (131.8)</b>
5	TACTICAL	NIFC T-5	DIVISION A	166.7250	
6	TACTICAL	NIFC T-6	DIVISION F	166.7750	
7	TACTICAL	NIFC T-7	DIVISION L	168.2500	
8	TACTICAL	R5 TAC 4	DIVISION M	166.5500	
9	TACTICAL	R5 TAC 5	DIVISION R	167.1125	
10	TACTICAL	R5 TAC 6	DIVISION Z	168.2375	
11	AIR-TO-GROUND	A/G	ALL DIVISIONS	167.0625	
12	TACTICAL	VFIRE 24	DIVISION W	154.2725	<b>Tone 6 (156.7)</b>
13	TACTICAL	VFIRE 25	DIVISION P	154.2875	<b>Tone 6 (156.7)</b>
14	TACTICAL	VFIRE 26	Unassigned	154.3025	<b>Tone 6 (156.7)</b>
15	MED A/G TAC	CALCORD	ALL DIVISIONS	156.0750	MEDICAL EMERG <b>Tone 6 (156.7)</b>
16/20	AIR GUARD	GUARD	ALL DIVISIONS	168.6250	EMERGENCY ONLY <b>Tone 1 (110.9)</b>

**Notes:**

Prepared by:  
David Larkin COML

1. BRANCH <b>V</b>	2. DIVISION/GROUP <b>W</b>	<b>DIVISION ASSIGNMENT LIST</b>	<b>ICS 204</b>
-----------------------	-------------------------------	---------------------------------	----------------

3. INCIDENT NAME <b>Corral Complex</b>	4. OPERATIONAL PERIOD <b>8-15-2013 0600 to 8-16-2013 0600</b>
---	--

5. OPERATIONS PERSONNEL			
OPERATIONS CHIEF	<b>Mary Bogens</b>	DIVISION/GROUP SUPERVISOR	<b>Shawn Duggar</b>
BRANCH DIRECTOR	<b>Mike Koontz</b>	AIR ATTACK SUPERVISOR	<b>Jim Gonzalez</b>

6. RESOURCES ASSIGNED THIS PERIOD					
STRIKE TEAM/TASK FORCE/ RESOURCE DESIGNATOR	LEADER	NUMBER PERSONS	TRANS. NEEDED	DROP-OFF POINT / TIME	PICK UP POINT / TIME
<b>1 CRW1</b>				<b>0600</b>	<b>2000</b>
<b>2 DOZ2</b>				<b>0600</b>	<b>2000</b>
<b>2 FALB</b>				<b>0600</b>	<b>2000</b>

7. CONTROL OPERATIONS	Remove snags that are a threat to road and dozer line.
-----------------------	--

8. SPECIAL INSTRUCTIONS	Map retardant drops and submit to READ. <b>SOFR Jerry Wheeless will be assigned to all divisions on Branch V.</b> No DIP in Mill Creek Lake and Water Dog Lakes. Ensure dip and delivery remains west of the Six Rivers / Shasta NF boundary.
-------------------------	---

9. DIVISION/GROUP COMMUNICATIONS SUMMARY								
FUNCTION	LOCAL REPEAT	FREQ.	SYSTEM	CHAN.	FUNCTION	FREQ.	SYSTEM	CHAN.
COMMAND		See ICS205 on back			SUPPORT			
		See ICS205 on back			GROUND TO AIR	See ICS205 on back		

PREPARED BY (RESOURCE UNIT LDR.) <b>Tim Knorr / Kyle Hauducoeur(t)</b>	APPROVED BY (PLANNING SECT. CH.) <b>Gerry Gardner/S. Abbott(t)</b>	DATE 8/14/2013	TIME <b>8/14/13 22:47</b>
---	---	-------------------	------------------------------

<b>INCIDENT RADIO COMMUNICATION PLAN</b>	Incident Name	Date/Time Prepared	Operational Period Date/Time
	<b>Corral Complex Fire</b>	8-14-13 2000 hrs	8-15-13 thru 8-16-13 0600-0600 (24 hrs)

**Radio Channel Utilization**

Ch#	Function	Channel Name	Assignment	Frequency	Remarks
1	COMMAND	NIFC C-1	ALL DIVISIONS	Rx: 168.7000 Tx: 170.9750	Trinity Summit <b>Tone 11 (114.8)</b>
2	COMMAND (Pending)	NIFC C-8	ALL DIVISIONS	Rx: 169.5375 Tx: 164.7125	Ironside Mtn <b>Tone 11 (114.8)</b>
3			Unassigned		
4	BACKUP COMMAND NET	SRF ADM	ALL DIVISIONS	Rx: 168.1250 Tx: 170.4750	<b>Tone 13 (141.3)</b> <b>Tone 3 (131.8)</b>
5	TACTICAL	NIFC T-5	DIVISION A	166.7250	
6	TACTICAL	NIFC T-6	DIVISION F	166.7750	
7	TACTICAL	NIFC T-7	DIVISION L	168.2500	
8	TACTICAL	R5 TAC 4	DIVISION M	166.5500	
9	TACTICAL	R5 TAC 5	DIVISION R	167.1125	
10	TACTICAL	R5 TAC 6	DIVISION Z	168.2375	
11	AIR-TO-GROUND	A/G	ALL DIVISIONS	167.0625	
12	TACTICAL	VFIRE 24	DIVISION W	154.2725	<b>Tone 6 (156.7)</b>
13	TACTICAL	VFIRE 25	DIVISION P	154.2875	<b>Tone 6 (156.7)</b>
14	TACTICAL	VFIRE 26	Unassigned	154.3025	<b>Tone 6 (156.7)</b>
15	MED A/G TAC	CALCORD	ALL DIVISIONS	156.0750	MEDICAL EMERG <b>Tone 6 (156.7)</b>
16/20	AIR GUARD	GUARD	ALL DIVISIONS	168.6250	EMERGENCY ONLY <b>Tone 1 (110.9)</b>

**Notes:**

Prepared by:  
David Larkin COML

1. BRANCH <b>V</b>	2. DIVISION/GROUP <b>Z</b>	<b>DIVISION ASSIGNMENT LIST ICS 204</b>
-----------------------	-------------------------------	---

3. INCIDENT NAME <b>Corral Complex</b>	4. OPERATIONAL PERIOD <b>8-15-2013 0600 to 8-16-2013 0600</b>
---	--

5. OPERATIONS PERSONNEL			
OPERATIONS CHIEF	<b>Mary Bogens</b>	DIVISION/GROUP SUPERVISOR	<b>Todd McDivitt</b>
BRANCH DIRECTOR	<b>Mike Koontz</b>	AIR ATTACK SUPERVISOR	<b>Jim Gonzalez</b>

6. RESOURCES ASSIGNED THIS PERIOD					
STRIKE TEAM/TASK FORCE/ RESOURCE DESIGNATOR	LEADER	NUMBER PERSONS	TRANS. NEEDED	DROP OFF POINT / TIME	PICK UP POINT / TIME
<b>CRW 2IA Arden Solutions (C-10)</b>	<b>Remington Katon</b>	<b>20</b>		<b>0600</b>	<b>2000</b>
<b>2 DOZ2</b>				<b>0600</b>	<b>2000</b>
<b>4 FALB</b>		<b>4</b>		<b>0600</b>	<b>2000</b>
<b>2 HEQB</b>		<b>2</b>		<b>0600</b>	<b>2000</b>
<b>4 FELB</b>		<b>4</b>		<b>0600</b>	<b>2000</b>
<b>4 Fellerbunchers</b>		<b>4</b>		<b>0600</b>	<b>2000</b>

7. CONTROL OPERATIONS Continue to prep road and remove snags that are a threat to the road and dozer lines.
--

8. SPECIAL INSTRUCTIONS Map retardant drops and submit to READ. <b>SOFR Jerry Wheeless will be assigned to all divisions on Branch V.</b> No DIP in Mill Creek Lake and Water Dog Lakes. Ensure dip and delivery remains west of the Six Rivers / Shasta NF boundary.
--

9. DIVISION/GROUP COMMUNICATIONS SUMMARY								
FUNCTION	LOCAL REPEAT	FREQ.	SYSTEM	CHAN.	FUNCTION	FREQ.	SYSTEM	CHAN.
COMMAND					SUPPORT			

PREPARED BY (RESOURCE UNIT LDR.) <b>Tim Knorr / Kyle Hauducoeur(t)</b>	APPROVED BY (PLANNING SECT. CH.) <b>Gerry Gardner/S. Abbott(t)</b>	DATE 8/14/2013	TIME <b>8/14/2013 22:47</b>
---	---	-------------------	--------------------------------

<b>INCIDENT RADIO COMMUNICATION PLAN</b>	Incident Name	Date/Time Prepared	Operational Period Date/Time
	<b>Corral Complex Fire</b>	8-14-13 2000 hrs	8-15-13 thru 8-16-13 0600-0600 (24 hrs)

**Radio Channel Utilization**

Ch#	Function	Channel Name	Assignment	Frequency	Remarks
1	COMMAND	NIFC C-1	ALL DIVISIONS	Rx: 168.7000 Tx: 170.9750	Trinity Summit <b>Tone 11 (114.8)</b>
2	COMMAND (Pending)	NIFC C-8	ALL DIVISIONS	Rx: 169.5375 Tx: 164.7125	Ironside Mtn <b>Tone 11 (114.8)</b>
3			Unassigned		
4	BACKUP COMMAND NET	SRF ADM	ALL DIVISIONS	Rx: 168.1250 Tx: 170.4750	<b>Tone 13 (141.3)</b> <b>Tone 3 (131.8)</b>
5	TACTICAL	NIFC T-5	DIVISION A	166.7250	
6	TACTICAL	NIFC T-6	DIVISION F	166.7750	
7	TACTICAL	NIFC T-7	DIVISION L	168.2500	
8	TACTICAL	R5 TAC 4	DIVISION M	166.5500	
9	TACTICAL	R5 TAC 5	DIVISION R	167.1125	
10	TACTICAL	R5 TAC 6	DIVISION Z	168.2375	
11	AIR-TO-GROUND	A/G	ALL DIVISIONS	167.0625	
12	TACTICAL	VFIRE 24	DIVISION W	154.2725	<b>Tone 6 (156.7)</b>
13	TACTICAL	VFIRE 25	DIVISION P	154.2875	<b>Tone 6 (156.7)</b>
14	TACTICAL	VFIRE 26	Unassigned	154.3025	<b>Tone 6 (156.7)</b>
15	MED A/G TAC	CALCORD	ALL DIVISIONS	156.0750	MEDICAL EMERG <b>Tone 6 (156.7)</b>
16/20	AIR GUARD	GUARD	ALL DIVISIONS	168.6250	EMERGENCY ONLY <b>Tone 1 (110.9)</b>

**Notes:**

Prepared by:  
David Larkin COML



# AIR OPERATIONS SUMMARY

PREPARED BY: Ted Visser



PREPARED DATE/TIME: 8/14/2013 2100hr

1. INCIDENT NAME: Corral Complex	2. OPERATIONAL PERIOD DATE: 8/15/13	START TIME: 0600	END TIME: 2030	SUNRISE: 0623	SUNSET: 2015
3. REMARKS (Safety Notes, Hazards, Air Operations Special Equipment, etc.): Wire rich environment. Get Thorough Briefing. Study Flight Hazard Map ** All Lat and Long locations are to be in Degrees, Minutes, Decimal Minutes when possible**					
Willow Creek Base N 40 57.036 W 123 38.164 EVS N 41 02.260 W 123 33.782 (Light Only)					
4. MEDEVAC A/C: 102 Kneeland CDF 707-444-2863			5. TFR: Radius: 5 NIM Altitude: 9,000 MSL Centerpoint: N 41 2 56 W 123 28 32 TFR# 3/9067 Contact Freq. 132.3500		

6. PERSONNEL	Phone	7. FREQUENCIES	AM	FM	8. FIXED-WING	# Avail / Type/ Make-Model / FAA # / Base(s)
AOBD: Ted Visser	619-981-2409	AIR/AIR FW:		166.6000	Air tankers	
ATGS: Jim Gonzalez	619-607-8642	AIR/AIR RW:	132.3500		Lead planes	Rohnerville ATB 707-725-4572
ASGS: Galen Young	575-574-8720	AIR/GROUND:		167.0625	Base FAX #:	
HLCO:		COMMAND:			ATGS Aircraft	N848CE
HEBM: Matt Lingenfelter O-70	805-705-8621	COMMAND RPT Tone 11 (114.8)	Rx: 168.7000 TX: 170.9750			
HEBM: Brian Rogers O-27	530-310-5421	DECK FREQ:		168.3500		
DECK: Jameson Collins O-117		TOLC FREQ:				

## 9. HELICOPTERS (Use Additional Sheets As Necessary)

FAA #	TY	MAKE/MODEL	BASE	AVAIL	START	REMARKS	FAA #	TY	MAKE/MODEL	BASE	AVAIL	START	REMARKS
22EA	3	Bell 206B3 A-13	Willow	0700	0730	Mgr. Kevin Halleran 435-640-5424 O-71							
62HP	3	Bell 206L4 A-7	Willow	0700	0730	Mgr. Brian Rogers 530-310-5421 O-27							
912CK	1	SH3H A-6	Willow	0700	0730	Mgr. Patrick Edwards 208-863-2831 O-24							
CFIRX	1	S-61N A-8	Willow	0700	0730	Mgr. Chris Corrigan T 305-781-8706 O-25							

INCIDENT RADIO COMMUNICATION PLAN		Incident Name	Date/Time Prepared	Operational Period Date/Time	
		<b>Corral Complex Fire</b>	8-14-13 2000 hrs	8-15-13 thru 8-16-13 0600-0600 (24 hrs)	
Radio Channel Utilization					
Ch#	Function	Channel Name	Assignment	Frequency	Remarks
1	COMMAND	NIFC C-1	ALL DIVISIONS	Rx: 168.7000 Tx: 170.9750	Trinity Summit Tone 11 (114.8)
2	COMMAND (Pending)	NIFC C-8	ALL DIVISIONS	Rx: 169.5375 Tx: 164.7125	Ironside Mtn Tone 11 (114.8)
3			Unassigned		
4	BACKUP COMMAND NET	SRF ADM	ALL DIVISIONS	Rx: 168.1250 Tx: 170.4750	Tone 13 (141.3) Tone 3 (131.8)
5	TACTICAL	NIFC T-5	DIVISION A	166.7250	
6	TACTICAL	NIFC T-6	DIVISION F	166.7750	
7	TACTICAL	NIFC T-7	DIVISION L	168.2500	
8	TACTICAL	R5 TAC 4	DIVISION M	166.5500	
9	TACTICAL	R5 TAC 5	DIVISION R	167.1125	
10	TACTICAL	R5 TAC 6	DIVISION Z	168.2375	
11	AIR-TO-GROUND	A/G	ALL DIVISIONS	167.0625	
12	TACTICAL	VFIRE 24	DIVISION W	154.2725	Tone 6 (156.7)
13	TACTICAL	VFIRE 25	DIVISION P	154.2875	Tone 6 (156.7)
14	TACTICAL	VFIRE 26	Unassigned	154.3025	Tone 6 (156.7)
15	MED A/G TAC	CALCORD	ALL DIVISIONS	156.0750	MEDICAL EMERG Tone 6 (156.7)
16/20	AIR GUARD	GUARD	ALL DIVISIONS	168.6250	EMERGENCY ONLY Tone 1 (110.9)
<b>Notes:</b>					
Prepared by: David Larkin COML					

<b>MEDICAL PLAN</b>	1. INCIDENT NAME <b>CORRAL COMPLEX</b>	2. DATE PREPARED <b>8/14/2013</b>	3. TIME PREPARED <b>16:45</b>	4. OPERATIONAL PERIOD <b>8/15/2013</b>
---------------------	---	--------------------------------------	----------------------------------	---

5. INCIDENT MEDICAL AID STATIONS				
MEDICAL AID STATIONS	LOCATION			PARAMEDICS
Medical Unit	ICP: Veterans Park, Willow Creek, CA			YES NO <b>X</b>

6. TRANSPORTATION				
A. GROUND AMBULANCES				
NAME	ADDRESS	Contact	PARAMEDICS	
Hoopla Ambulance	Hoopla and Willow Creek	Communications	YES NO <b>X</b>	

B. AIR AMBULANCES and RESCUE AIRCRAFT				
NAME	LOCATION	Est. Flighttime to Incident	PARAMEDICS	
CalFire 107 (DAY ONLY HOIST)	Kneeland, CA	25 Minutes	YES NO	<b>X</b>
CHP H-13 (HOIST)	Redding, CA	40 Minutes	<b>X</b>	
AFRCC / Coast Guard (HOIST)	Eureka, CA	30 Minutes		<b>X</b>
Reach 5	Redding, CA	40 Minutes	<b>X</b>	
PHI Air Medical	Redding, CA	40 Minutes	<b>X</b>	

7. HOSPITALS								
NAME	ADDRESS	TRAVEL TIME		Trauma Level	HELIPAD		BURN CENTER	
		AIR	GRND		YES	NO	YES	NO
Willow Creek Community Health Center	Willow Creek, CA	X	5min	NO		X		X
Mad River Community Hospital	Willow Creek, CA	X	5min	NO		X		X
St Joseph Hospital	Eureka, CA	25min	1hr	Level 4	X			X
Mercy Medical Center	Redding, CA	40min	2hr	Level 2	X			X
UC Davis	Sacramento, CA	1.5hr	X	Level 1	X		X	

8. MEDICAL EMERGENCY PROCEDURES		
<b>Line/Spike Camp Emergency</b> Crew Supervisor to contact DIVS with patient complaint/condition and location. DIVS Contacts: Line EMT Corral Communications Operations / Branch On Scene EMS, DIVS, or MEDL decides mode of transportation. Communications will contact: Fortuna Interagency Comm Center Medical Unit Safety Air Ops DIVS will manage the emergency with input from Med Unit. If a MedEvac is needed, be sure to identify the Lat/Long of the closest helispot.	<b>Base Camp Emergency</b> Contact Medical Unit with patient complaint/condition and location. Medical staff will respond to stabilize incident. Medical Unit contacts: Communications Safety Logistics Operations Crew Supervisor	<b>Injury Reporting Procedures</b> Nature of Injury Location of Patient: Transportation Required: Air:           Ground: Point of Pickup: Lat: Lon: Crew ID (NO NAMES ON RADIO): Is EMT with Patient? Age: Sex:

**For incident medical evacuation plan, see  
Medical Evacuation of Personnel from Corral Complex attachment.**

<b>ICS 206</b>	9. PREPARED BY (MEDICAL UNIT LEADER) <b>B. Puckett</b>	10. REVIEWED BY (SAFETY OFFICER) <b>J. Aragon</b>
----------------	---	--

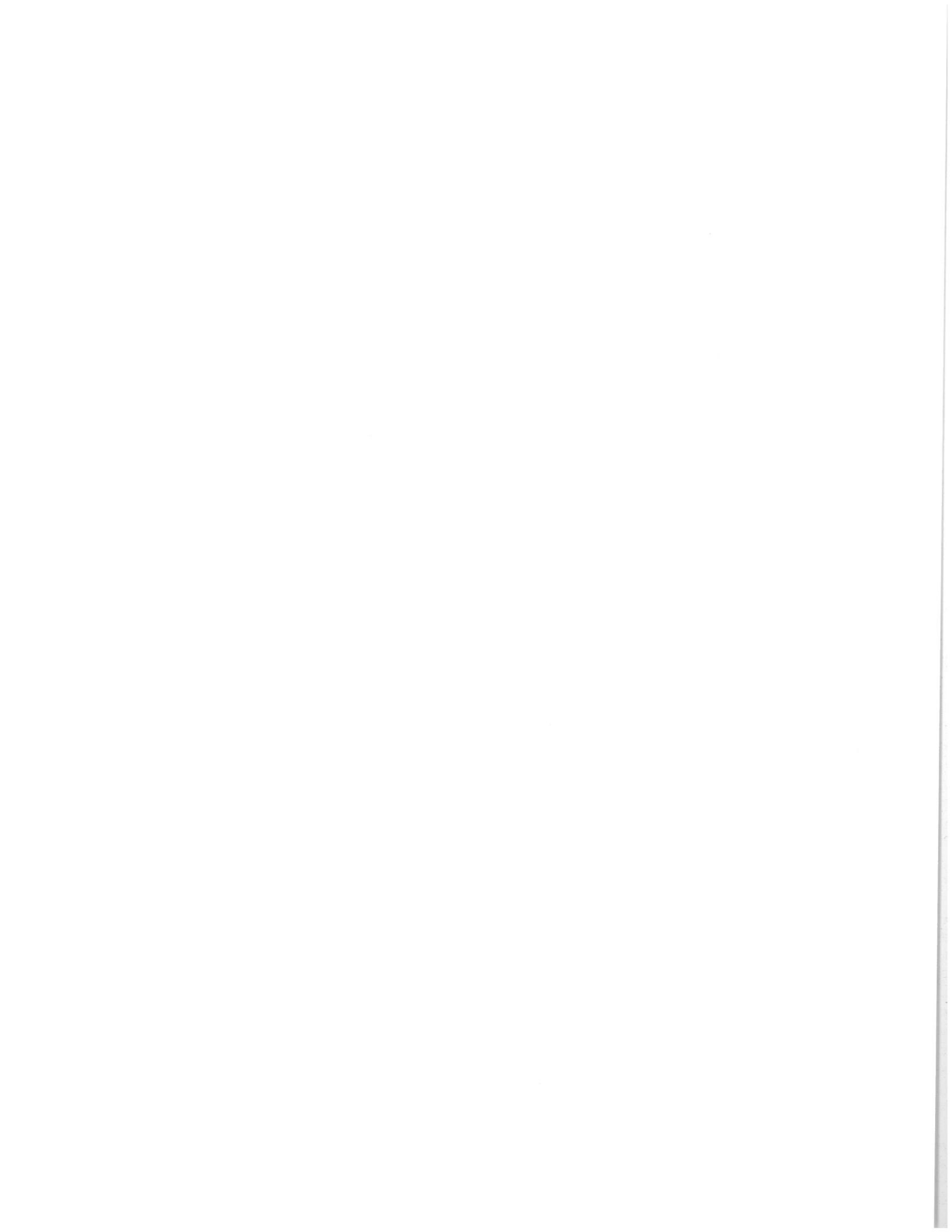



## Medical Evacuation of Personnel from Corral Complex

This fire is burning in very remote, steep and rugged terrain where access is difficult. Southern California Incident Management Team 2 is committed to providing the necessary response should any medical incident occur and to ensure that a rapid and appropriate evacuation is completed. This plan is designed to identify and outline the steps necessary to safely and effectively evacuate an injured firefighter from the Corral Complex and deliver that firefighter to an appropriate medical facility in both daytime and nighttime settings.

Once notification of a medical emergency, and the Division Supervisor and/or EMT's make the decision that a medical evacuation is required, Incident Management Team components will work together to accomplish the evacuation. Medical Unit Leader, Safety Officer, and Air Operations will join the Communications Unit in the communications trailer for a coordinated response. The highest qualified medical personnel on scene shall assume control of patient care. The Division Supervisor shall coordinate the response, and handle communications with incident communication unit and medical unit, and air to ground communications. The Division Supervisor may delegate communications to appropriate resources as needed to facilitate the operation.

### Ground Medical Evacuation

- If the injured firefighter is *WITHIN* reasonable hiking distance from a road which can be driven and determined to have a condition which *WILL NOT* be aggravated by driving him/her out, then an incident vehicle shall be utilized to evacuate the injured firefighter from the scene to either the ICP Medical Unit or to a rendezvous point with a ground ambulance. The destination decision shall lie with the DIVS with consultation from the highest level care provider on scene.
  
- The following ground ambulance providers and locations for ground ambulance coverage for this incident location:

Agency	Base Location	Provider Level	Drive Time to ICP
Hoopa Ambulance	Willow Creek, CA	Paramedic	5 minutes
Hoopa Ambulance	Hoopa, CA	Paramedic	30 minutes

**Air Medical Evacuation**

- If the injured firefighter is *NOT WITHIN* reasonable hiking distance to a road and/or determined to have a condition which *WILL* be aggravated and worsened by driving him/her out, the following aircraft shall be launched based on the closest available resource needed to meet the injured firefighter at the helispot or hoist site. The Division Supervisor will coordinate a hand carry out of the injured firefighter to the helispot/hoist site. The rescue helicopter will evacuate the firefighter to an appropriate location based on medical necessity to rendezvous with ground ambulance, air ambulance, or hospital. Rescue aircraft and locations for this incident are:

Agency	Hoist Capabilities	Medical Capabilities	Base Location	Estimated Flight Time to Incident
CalFire107	Day Hoist	BLS	Kneeland, CA	25 minutes
CHP H-13	Day/Night Hoist	ALS	Redding, CA	40 minutes
Military Resources	Day/Night Hoist	BLS / Sometimes ALS	Multiple	45+ minutes (+ military call out time)
Assigned incident aviation resources as available	None	Varies	Varies	Varies

- If the injured firefighter requires air ambulance transportation to a hospital, the following helicopters shall be utilized:

Agency	Base Location	Flight time to Incident
Reach 5	Redding, CA	40 Minutes
PHI Air Medical	Redding, CA	40 Minutes

Once lifted, the helicopters will experience an estimated flight time to each of the following facilities:

Hospital	Specialty Center	Location	Helipad	Flight time from Incident
Mercy Medical Center	Level 2 Trauma	Redding, CA	Depends on AC	40 minutes
UC Davis Hospital	Level 1 Trauma and Burn Center	Sacramento, CA	Yes	1.5 hours

  
 Prepared By:  
 Brian Puckett, MEDL

  
 Approved By:  
 James Aragon, SOF2

# **Snag & Contour**

## **Felling Safety Message**

**Size-up hazards in the work area.  
Never become complacent.  
Always look up.  
Get wind/weather report.**

### **Corral Complex – August 15th**

**Snag and contour felling considerations include:**

- 1) Use saw teams and Falling Bosses.**
- 2) Post lookouts concentrating on snags.**
- 3) All sawyers assure themselves a quick and safe escape route from the tree they are falling.**
- 4) Do not turn your back on a falling snag.**
- 5) Snag fire access routes as necessary – roads, trails, and drop points.**
- 6) Keep crews spread out – Don't bunch up.**
- 7) Two sets of eyes are better than one.**
- 8) Heads up for erratic winds from storm cells.**
- 9) Stay well clear of all air operations including cargo drops, water drops, slurry drops, low level flights, arrivals and departures at helispots, etc.**
- 10) Consider the domino effect when determining safe distances from hazard snags.**
- 11) If a crew doesn't have a qualified saw with them to mitigate hazard snags, they should just stay entirely clear from identified hazard snags.**
- 12) Consider green trees as hazards also – burned out stems or root systems pose a serious safety hazard.**
- 13) Watch for burned out root systems on snags and green trees as well, especially several days into the incident – a sound snag or tree today may not be tomorrow.**

**LOOK UP - LOOK DOWN -LOOK ALL AROUND**

**THE VERY WORST FIRE PLAN IS NO FIRE PLAN**

**James Arragon, Safety Officer**

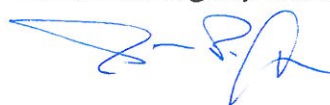

# Incident Trainee / Trainer Data Worksheet

PLEASE PRINT LEGIBLY!

## A: Trainee Data

Trainee Name: \_\_\_\_\_ Check One:  Male  Female  
Trainee Position: \_\_\_\_\_ Order Number (E, O, C, A) \_\_\_\_--\_\_\_\_\_  
State Abr. \_\_\_\_ + 3 Letter Designator \_\_\_\_\_ Agency Type:  Federal  State  Local  
 USFS  BLM  BIA  FWS  DOD  NWS  NPS Date Assigned: \_\_\_\_--\_\_\_\_--\_\_\_\_\_  
Ordered as a Trainee for the incident?  Yes  No Ordered as a PRIORITY trainee?  Yes  No

## Person's name and title that is responsible for tracking your qualifications:

(Where do you want the packet mailed to?)

Name: \_\_\_\_\_ Title: \_\_\_\_\_ Home Unit: \_\_\_\_\_  
Agency Address: \_\_\_\_\_ City: \_\_\_\_\_  
State: \_\_\_\_\_ Zip: \_\_\_\_\_ Phone Number: (     ) \_\_\_\_\_--\_\_\_\_\_

## B. Trainee Prerequisites

	YES	NO
1. Possesses valid Red Card or agency certification card?	<input type="radio"/>	<input type="radio"/>
2. Trainee has a proper agency initiated position task book?	<input type="radio"/>	<input type="radio"/>
3. Trainee has an <b>incident issued</b> task book?	<input type="radio"/>	<input type="radio"/>

## C. Trainer/Evaluator Data (All fields are required to be filled in)

Trainer/Evaluator Name: \_\_\_\_\_ Position: \_\_\_\_\_  
Home Unit: \_\_\_\_\_ Order Number (E, O, C, A) \_\_\_\_--\_\_\_\_\_  
Work Address: \_\_\_\_\_ City: \_\_\_\_\_ State: \_\_\_\_\_  
Zip Code: \_\_\_\_\_ Phone Number: (     ) \_\_\_\_\_--\_\_\_\_\_

## D. Trainee Goals (items in the position task book to be evaluated on this incident)

1. \_\_\_\_\_
2. \_\_\_\_\_
3. \_\_\_\_\_



# Base Camp Map

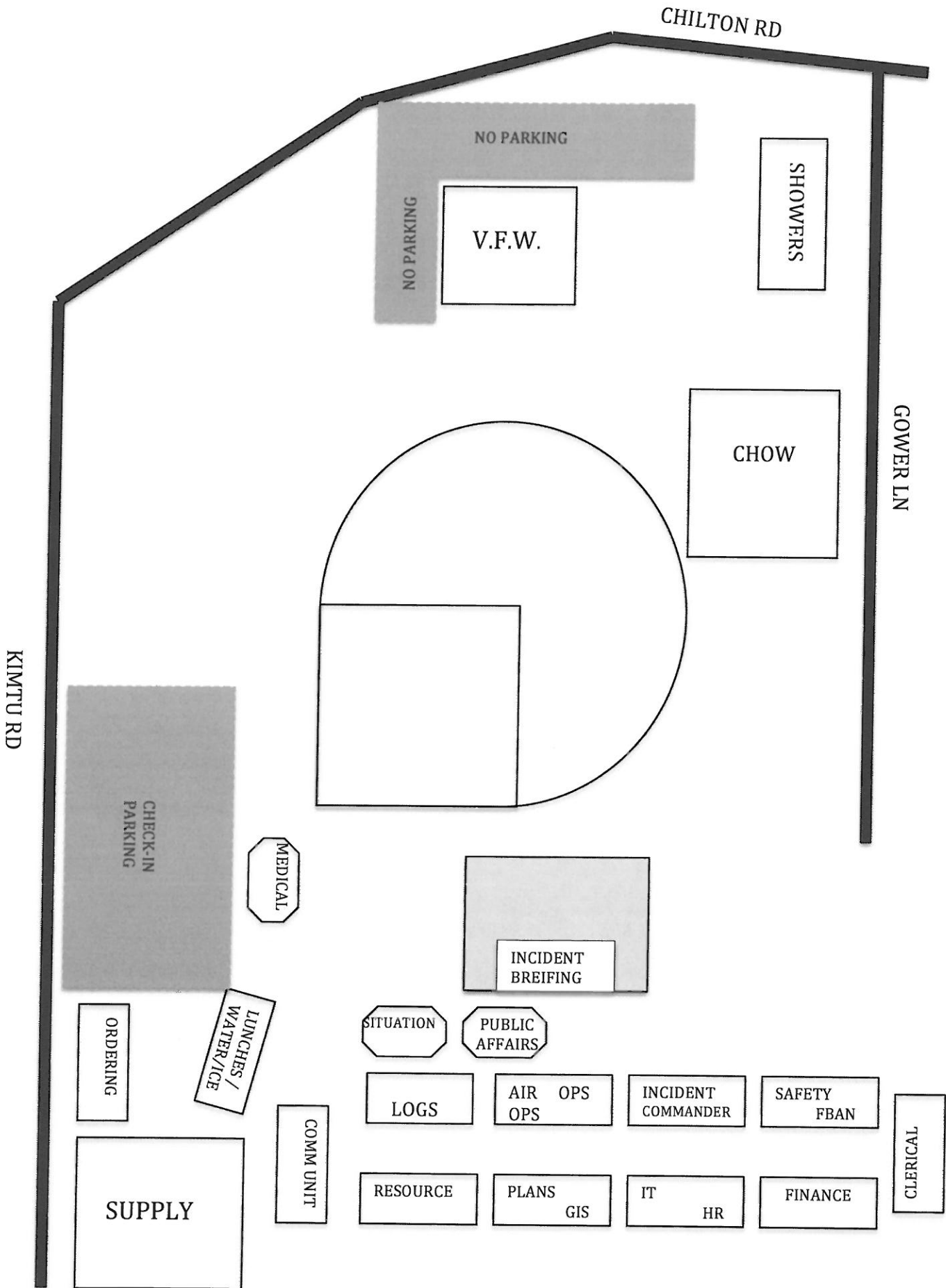

GENERAL COMPLEX  
TRANSPORTATION MAP

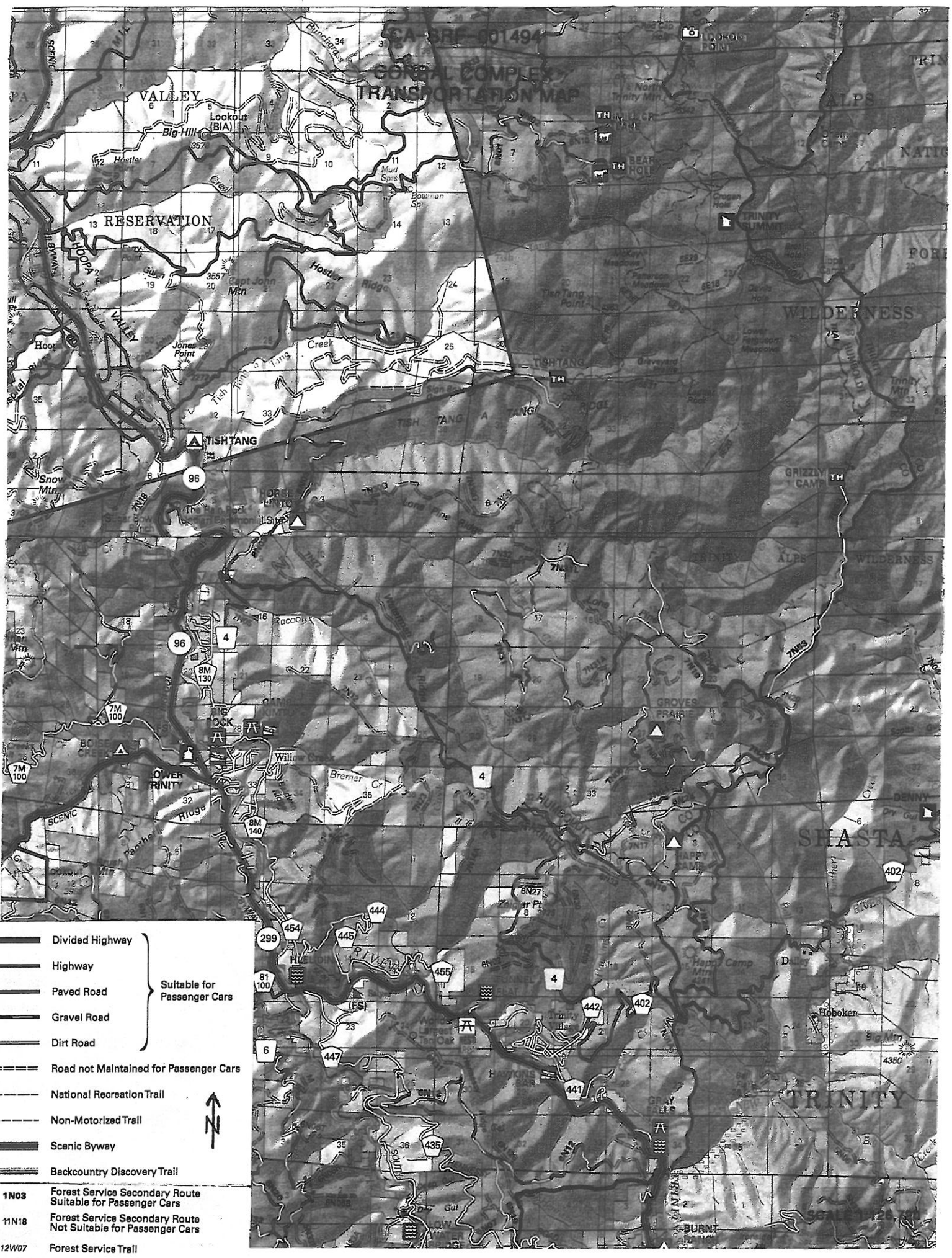

- |              |  |                               |
|--------------|--|-------------------------------|
|              | Divided Highway  | } Suitable for Passenger Cars |
|              | Highway  |                               |
|              | Paved Road   |                               |
|              | Gravel Road  |                               |
|              | Dirt Road  |                               |
|              | Road not Maintained for Passenger Cars                         |                               |
|              | National Recreation Trail                                      |                               |
|              | Non-Motorized Trail  |                               |
|              | Scenic Byway   |                               |
|              | Backcountry Discovery Trail                                    |                               |
| <b>1N03</b>  | Forest Service Secondary Route Suitable for Passenger Cars     |                               |
| <b>1N18</b>  | Forest Service Secondary Route Not Suitable for Passenger Cars |                               |
| <b>12W07</b> | Forest Service Trail   |                               |

