

HAPPY CAMP COMPLEX

CA-KNF-005956

P5JB1F-0505

DAY/NIGHT SHIFT

AUGUST 31, 2014 0600-1800

AUGUST 31-SEPTEMBER 1, 2014

1800-0600

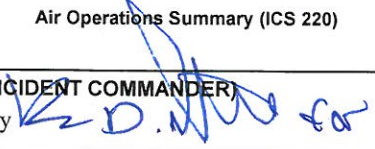

INCIDENT OBJECTIVES	1. INCIDENT NAME Happy Camp Complex	2. DATE 8/31/2014	3. TIME 2000									
4. OPERATIONAL PERIOD (DATE/TIME) August 31, 2014 – September 1, 2014 DAY/NIGHT 0600-1800/1800-0600												
<p>5. GENERAL CONTROL OBJECTIVES FOR THE INCIDENT (INCLUDE ALTERNATIVES)</p> <p>Firefighter and public safety is our core value. All identified hazards will be mitigated or avoided.</p> <p>MANAGEMENT OBJECTIVES:</p> <p>Manage costs commensurate with values at risk.</p> <p>Minimize damage to natural and cultural resources caused by fire suppression activities.</p> <p>Maintain the current communication strategy to inform the public, cooperators, and key stakeholders on current fire status and planned actions.</p> <p>CONTROL OBJECTIVES:</p> <p>Use MIST to minimize impacts to wilderness characteristics.</p> <p>Provide structure defense resources for the communities of Elk Creek, Curly Jack, Happy Camp, Fort Goff, China Grade, Thompson Creek, Seiad, Hamburg, and Scott Bar. Provide support for protecting private property and infrastructure.</p> <p>Manage and coordinate all new fires within Zone 1 and Zone 2 as defined by the TFR.</p> <p>Manage all fires under a full suppression strategy.</p>												
<p>6. WEATHER FORECAST FOR OPERATIONAL PERIOD</p> <p>Today will mark the beginning of another warming and drying trend as high pressure begins to rebuild over the region. Temperatures should trend as much as 5-10 degrees warmer than yesterday with much drier RH readings as well. Winds will be shifting to a North/Northeast direction along the ridges but should remain fairly light</p>												
<p>7. GENERAL SAFETY MESSAGE</p> <p>Don't get lured into a sense of complacency with the change in the weather.</p>												
<p>8. Attachments <input checked="" type="checkbox"/> if attached</p> <table border="0"> <tr> <td><input checked="" type="checkbox"/> Organization List (ICS 203)</td> <td><input checked="" type="checkbox"/> Medical Plan (ICS 206)</td> <td><input checked="" type="checkbox"/> Weather Forecast</td> </tr> <tr> <td><input checked="" type="checkbox"/> Assignment List (ICS 204)</td> <td><input checked="" type="checkbox"/> Incident Map</td> <td><input checked="" type="checkbox"/> Base Camp Map</td> </tr> <tr> <td><input checked="" type="checkbox"/> Communications Plan (ICS 205)</td> <td><input checked="" type="checkbox"/> Fire Behavior Forecast</td> <td><input checked="" type="checkbox"/> Air Operations Summary (ICS 220)</td> </tr> </table>				<input checked="" type="checkbox"/> Organization List (ICS 203)	<input checked="" type="checkbox"/> Medical Plan (ICS 206)	<input checked="" type="checkbox"/> Weather Forecast	<input checked="" type="checkbox"/> Assignment List (ICS 204)	<input checked="" type="checkbox"/> Incident Map	<input checked="" type="checkbox"/> Base Camp Map	<input checked="" type="checkbox"/> Communications Plan (ICS 205)	<input checked="" type="checkbox"/> Fire Behavior Forecast	<input checked="" type="checkbox"/> Air Operations Summary (ICS 220)
<input checked="" type="checkbox"/> Organization List (ICS 203)	<input checked="" type="checkbox"/> Medical Plan (ICS 206)	<input checked="" type="checkbox"/> Weather Forecast										
<input checked="" type="checkbox"/> Assignment List (ICS 204)	<input checked="" type="checkbox"/> Incident Map	<input checked="" type="checkbox"/> Base Camp Map										
<input checked="" type="checkbox"/> Communications Plan (ICS 205)	<input checked="" type="checkbox"/> Fire Behavior Forecast	<input checked="" type="checkbox"/> Air Operations Summary (ICS 220)										
<p>9. PREPARED BY (PLANNING SECTION CHIEF) Gordon P Martin </p>	<p>10. APPROVED BY (INCIDENT COMMANDER) Jeanne Pincha-Tulley </p>											

ORGANIZATION ASSIGNMENT LIST		9 Operations Section	
1. Incident Name HAPPY CAMP COMPLEX ZONE 1 DAY		Day	RICKARD; ADELL; HAYES(t)
2. Date Prepared 08/30/14		3. Time Prepared 0843	Planning Ops J. GIPSON; J. TOPOLESK(t)
a. Zone I			
4. Operational Period 08/31/14 Sunday Day Shift 0600 - 1800		Branch I Director	
Position	Name	Deputy	
5. Incident Commander and Staff		Division A/C	ROBERT SCOTT
Incident Commander	MICHAEL WAKOSKI, DAN FELIX (t)	Division D/F	MARK GERWE
Deputy	KENNETH KEMPTER	Division H	TODD JENKINS
Safety Officer	DOUG ELLIOT; J. CHAMBERLIN (t)	Division I	BRAD SAWYER
Information Officer	MARC PEEBLES; RALPH H GONZALES		
Liaison Officer	BRIAN RAMSEY	b. Zone I	
6. Agency Representative		Branch I Director	
Agency	Name		
HAPPY CAMP DISTRICT	TOM MUTZ	Division O	KEITH WOLFERMAN
KARUK	BILL TRIPP	Division Q/T/Z	J.FOLEY; S. COUNTS(t)
HAPPY CAMP FD	JEFF MOPAS	Division IA	CLINT GOULD
KNF DIV3	WALTERS, TERRY	Staging	DENNIS SPEAR
EACC-IARR	MITCH BOUCHONVILLE		
7. Planning Section		c. Division/Groups	
Chief	DENA SICKELS	Branch Director	
Resources Unit	S. BRIGGS; L. BABNEW; J. PETERSON (t)	Deputy	
Situation Unit	MICHAEL BILHEIMER; C. FRY(t)	Division	
Documentation Unit	KIMBERLY KNOBLE; REX CRABTREE	Division	
Demobilization Unit	MICHAEL LEWIS	Division	
Fire Behavior Analyst	JIM HARRIS	Group	
Human Resource Specialist	JAN M CAWTHON		
Training Specialist	WILLIAM R REYNOLDS	d. Air Operations Branch	
GIS Specialist	ED LAMAS, EVAN CONKLIN, RICH MURRILLO	Air Operations Branch Director	BILL MONAHAN
Computer Specialist	CHARLES VERTREES; DAVID VUONG(T)	Helibase Manager(Cave)	KIRBY COOK
IMET	JEFF TONKIN	Air Attack Supervisor	
READ		Air Support Supervisor(Cave)	KENT WEDIN
LTAN	ERIN NONAN-WRIGHT	Helicopter Coordinator	
8. Logistics Section		Air Tanker Coordinator	
Chief	JACK VAN LEAR; DAN FROELICH (t);	10. Finance Section	
Supply Unit	BILL CREWS	Chief	RICHARD TOBIN
Facilities Unit	NEIL GRAF	Deputy	
Ground Support Unit	KEVIN PALM	Time Unit	STEVE GREEN; JESSICA ESTRADA; ERIC SCHLUMPF
Communications Unit	MICHAEL HORST	Procurement Unit	
Medical Unit	ROBERT HERMAN; DAVID SWEEN; GENA FOWL KES	Compensation/Claims Unit	JANNA MASI, CHRISTY CAMACHO
Security Unit	BRIAN WILLBOND	Cost Unit	VERA WESTMOLAND
Food Unit	KORRY BELMONTEZ	Prepared by (Resource Unit Leader)	
Base Support (THOMAS)	CHICO 23; FORTUNA 3, SAC 2; UKIPA 3	S. BRIGGS	

ORGANIZATION ASSIGNMENT LIST		9 Operations Section	
1. Incident Name HAPPY CAMP COMPLEX ZONE 1 NIGHT		Night	FREELAND; MOORE; HINSON(t)
2. Date Prepared 08/30/14	3. Time Prepared 0852		
4. Operational Period 08/31/14 Sunday Night Shift 1800 - 0600		a Branch - Division/Groups	
Position	Name	Branch Director	
		Deputy	
5. Incident Commander and Staff		Division/Group A/C	UNSTAFFED
Incident Commander		Division/Group D/F	E.WITTE; R. PICAZO(t)
Deputy		Division/Group H	T. GARNER
Safety Officer		Division/Group I	UNSTAFFED
Information Officer		Division/Group O/Q/T/Z	S. UNDERWOOD
Liaison Officer		b Branch - Division/Groups	
6. Agency Representative		Branch Director	
Agency	Name	Deputy	
HAPPY CAMP DISTRICT		Division/Group	
KARUK		Division/Group	
HAPPY CAMP FD		Division/Group	
KNF DIV3		Division/Group	
EACC-IARR		Division/Group	
7. Planning Section		c. Branch - Division/Groups	
Chief		Branch Director	
Resources Unit		Deputy	
Situation Unit		Division/Group	
Documentation Unit		Division/Group	
Demobilization Unit		Division/Group	
Fire Behavior Analyst		Division/Group	
Human Resource Specialist		Division/Group HAPPY CAMP STAGING	
Training Specialist		d Air Operations Branch	
GIS Specialist		Air Operations Branch Director	
Computer Specialist		Helibase Manager	
IMET		Air Attack Supervisor	
READ		Air Support Supervisor	
LTAN		Helicopter Coordinator	
8. Logistics Section		Air Tanker Coordinator	
Chief		10. Finance Section	
Supply Unit		Chief	
Facilities Unit		Deputy	
Ground Support Unit		Time Unit	
Communications Unit		Procurement Unit	
Medical Unit		Compensation/Claims Unit	
Security Unit		Cost Unit	
Food Unit		Prepared by (Resource Unit Leader)	
CCC AREP (Thomas)		STEVE BRIGGS	

ICS Form 203 ORGANIZATION ASSIGNMENT LIST		1. INCIDENT NAME HAPPY CAMP COMPLEX ZONE 2	2. DATE PREPARED 08/30/2014	3. TIME PREPARED 2000
5. INCIDENT COMMAND STAFF		4. OPERATIONAL PERIOD (DATE/TIME) 08/31-9/1/2014 0600-1800, 1800-0600		
Position	Name	9. OPERATIONS SECTION		
INCIDENT COMMANDER	JEANNE PINCHA-TULLEY	DAY OPS	CARLISLE/TOMASELLI(t)	
DEPUTY	MARK VONTILLOW	NIGHT OPS	JOHN TRUETT	
SAFETY OFFICER	BOB MOORE	PLANNING OPS	RICH HERRERA/PAT RUSSELL(t)	
INFORMATION OFFICER	MIKE LINDBERY/JAY NICHOLS(t)	DAY OPERATIONS		
LIAISON OFFICER	TOM EFIRD			
HRSP	JANINE SUMMY			
6. AGENCY REPRESENTATIVES		BRANCH DIRECTOR	II	LARRY WRIGHT
		DIVISION/GROUP	J	ISAAC POWNING
		DIVISION/GROUP	L	JOHN WAGNER
AGENCY	NAME	DIVISION/GROUP	M	JOHNNY CLEM
SALMON/SCOTT RIVER RD	GARY ASBRIDGE	DIVISION/GROUP	N	DAVIS/RICE(t)
CAL FIRE AGENCY REP	MIKE BRADLEY	DIVISION/GROUP	SCOTT RIVER GRP	KEVIN WEGENER
		DIVISION/GROUP	DOZER GRP	BOB MEYERS
		DIVISION/GROUP	96 HWY/IA GRP	T. STUKEY/ J. COTTINGHAM
			STAGING	JOHN NICKEY
7. PLANNING SECTION		NIGHT OPERATIONS		
CHIEF	GORDON MARTIN	DIVISION/GROUP	SCOTT RIVER GRP	M. WALBURN/M. JOHNSON
DEPUTY		DIVISION/GROUP	96 HWY GRP	REED/PESATA
RESOURCES UNIT	FERGUSON/WEBSTER/DENNETT (t)/MEYERS (t)			
SITUATION UNIT	STEVE FORMAN/CHRIS WIKEEN			
DOCUMENTATION UNIT				
DEMOBILIZATION UNIT	IRMA CONTRERAS			
READ	RAMONA BUTZ			
TNSP	GREG KURTZ/J. VILLA(t)			
FBAN	DENNIS BURNS			
GISS	TAYLOR/STUMP(t)/MISHLER(t)			
CTSP	KOHLER/SINGLETON(t)/SHELTON(t)			
IMET	RYAN WALBRUN			
8. LOGISTICS SECTION				
CHIEF	BRETT SHURR			
DEPUTY	BRIAN GADDIS	10. AIR OPERATIONS BRANCH		
		AIR OPERATIONS BR. DIR.	BILLY MONAHAN	
A. SUPPORT BRANCH		AIR TACTICAL GROUP SUP.	KELVIN MCELFISH	
SECURITY	ROY CAMERON	AIR SUPPORT GROUP SUP.		
SUPPLY UNIT	MARTIN HERNANDEZ	HELICOPTER COORDINATOR		
FACILITIES UNIT	MATT HASKINS	AIR TANKER/FIXED WING CRD.		
GROUND SUPPORT	JOHN SILVA/BARRY CLARK	11. FINANCE		
		CHIEF	DENNIS STEVENS	
B. SERVICE BRANCH		DEPUTY		
COMMUNICATIONS UNIT	KEVIN HARPER/JEFF TONG	TIME UNIT	JENNIFER WHITE/JESSICA PRINCE(t)	
MEDICAL UNIT	SCOTT MCKENNEY/MIKE HAZLETT	PROCUREMENT UNIT	PJ VILHAUER	
FOOD UNIT	ADAM TAT	COMPENSATION/CLAIMS UNIT	HEIDI BARAJAS	
BASE CAMP MANAGER		PERSONNEL TIME		
		COST UNIT	JILL LIPSEY	
Prepared By (Resources Unit) JEFF FERGUSON				



Happy Camp Complex Weather Forecast



FORECAST NO: 18 D/N
 PREDICTION FOR: Saturday Day/Night Shift
 SHIFT DATE: August 31, 2014
 FORECAST ISSUED: 1900 August 30, 2014

NAME OF FIRE: Happy Camp Complex
 UNIT: KNF
 Incident Meteorologist: Ryan Walbrun

WEATHER DISCUSSION: Today will mark the beginning of another **warming and drying trend** as high pressure begins to rebuild over the region. Temperatures should trend as much as 5-10 degrees warmer than yesterday with much drier RH readings as well. **Winds will be shifting** to a North/Northeast direction along the ridges but should remain fairly light. The inversion will strengthen as well keeping smoke and heat trapped for much of the day with fairly stable air aloft. **For night operations expect very poor RH recovery** with continued light northeast wind flow. Looking ahead more warm and dry weather is forecast through early next week.

WEATHER FORECAST FOR TODAY (SUNDAY DAY SHIFT):

WEATHER: Mostly sunny except abundant smoke Zone 2. Warmer and drier.
MAX TEMPERATURES: With Smoke: Valleys (1,200 ft) 83 – 88 F, Ridges (4,000 ft) 70 – 76 F
No Smoke: Valleys (1,200 ft) 79 – 84 F, Ridges (4,000 ft) 74 – 81 F
MIN HUMIDITY: With Smoke: Valleys (1,200 ft) 19 – 26%, Ridges (4,000 ft) 28 – 38%
No Smoke: Valleys (1,200 ft) 14 – 19%, Ridges (4,000 ft) 20 – 30%
WINDS (EYE LEVEL):
 Lower Slopes / Drainages – Afternoon up slope /up canyon 2 – 5 mph.
 Ridges – North to Northeast 3-6 mph with a few gusts 8-10 mph late day.
LAL: 1 CWR: 0% HAINES: 3 (mid level calculation)
STABILITY / INVERSION: Strong inversion will be slow to mix out between 1500-1700
SMOKE TRANSPORT: North to Northeast 4-8 mph.

WEATHER FORECAST FOR TONIGHT (SUNDAY NIGHT SHIFT):

WEATHER: Areas of smoke Zone 2 otherwise mostly clear Zone 1.
MIN TEMPERATURES: 55 to 65 F...locally 50 in the lower drainages and river canyons.
MAX HUMIDITY: Valleys (1,200 ft) 60 – 70%F, Ridges (4,000 ft) 40 – 50% but some of the higher Ridges above 5000 feet may only recover 30-40%
WINDS (EYE LEVEL): Valleys – North or Downslope / down valley 2 – 4 mph
 Ridges – Northeast to East 2-5 mph.
LAL: 1 CWR: 0% HAINES: 3
STABILITY / INVERSION: Strong inversion developing after 10 pm.
SMOKE TRANSPORT: North/Northeast 4-8 mph.

OUTLOOK FOR MONDAY (4500 FT): Mostly sunny. Areas of smoke. Warmer and drier. Max Temps: 80 to 90. Min RH: 15 - 25%. Ridge Wind: North/Northeast 3 – 6 mph gusts 10 mph. LAL 1. CWR 0%. Haines 3.

THREE DAY EXTENDED DAYTIME (TUESDAY – THURSDAY 4500 FT)

	Max T	Min RH	Max RH	Ridge Winds	LAL	WX
TUE	85 – 95	15%	40%	N/NE 3 - 6 G 8 mph	1	SMK
WED	80 – 90	20%	45%	N/NW 4 - 6 G 10 mph	1	SMK
THU	78– 85	22%	50%	N/NW 4 - 8 G 12mph	1	SMK

FIRE BEHAVIOR FORECAST

FORECAST NO. 27

PREDICTION FOR: 8/31/14 24hr.

NAME OF FIRE: Happy Camp

UNIT: CA-KNF 5956

SIGNED: /s/ Dennis Burns

DATE & TIME ISSUED: 08/30 2200 hr

FIRE BEHAVIOR ANALYST

WEATHER SUMMARY: Slightly warmer and dryer

Winds: Day, Ridges NW 8-12mph, Night: Downslope/down valley 3-5mph.

Min. RH: 20-30% Max. RH 25-35%

Temperatures: Day 78-85. Night: 60-70

LAL 1 Haines 3 ERC @90th percentile 1000hr fuels 8%

FIRE BEHAVIOR FORECAST

GENERAL FIRE BEHAVIOR:

With more stable air the potential for large fire growth will be diminished. The fire will remain fuels and topography driven. At present primary fire spread is from spot fires caused by rolling material and torching. Drainages with continuous fuels have a high potential for sustained runs once the inversion breaks. Falling snags and rolling material will challenge containment lines and will increase the potential for fire spread over barriers that would normally hold the fire.

Expect rapid acceleration of fire behavior when the inversion lifts. The fire will go from smoldering and creeping to torching as soon as the sun hits the fuels.

Fire will remain active into the night until the RH recovers to 40%.

SPECIFIC:

Frying Pan

- Div. H&J fire progression will continue to the east, fire is established across Grider Creek. Fire should stay in a backing alignment. Watch for spotting across lines to the north.
- Div. O&I fire progression will continue as flanking fire to the east.
- West end of the fire no forward progression expected. Interior fuels will continue to burn out
- Expect active backing fire in the areas where the fire has breached Walker Ridge Div J.
- East west drainages north of Rancheria Crk. have high potential for sustained runs.
- South end of the fire will continue to hold on the PCT ridge. Spots from torching will challenge containment.
- Div. M&L Mainly backing and flanking fire, rollout will continue to challenge containment

Air Operations: Poor visibility has a high potential to limit air operations.

SAFETY:

As the inversion lifts, expect a rapid increase of fire behavior.

Steep country means rolling material, watch for spot fires below you!



Safety Message

August 31, 2014

Hazards we face:

- Steep terrain
- Working around heavy equipment
- Hazard trees
- Communications
- Firefighter care
- Weather observations
- Traffic Controls

Some possible mitigations could include:

- Think - "how will I get someone out if they get injured?"
- Close coordination between heavy equipment operators and crews.
- Hazard trees will continue to be a problem - Look UP, Look Around. Employ good falling practices.
- Is your "Message" necessary over command net or can you switch to your "tac net"
- Take time to care for yourself- personal hygiene is a must...use the medical unit to nip things quickly
- Take you weather observations and bring them to the IMET the more Intel the better!
- Be aware of road traffic along Route 96, even though traffic controls are in or could be in place, don't forget you are working along a state highway.
- Keep focused on your job, don't let outside distractions bother you.



Happy Camp Complex Safety Officer: Bob Moore

Division Assignment List		1. Branch ZONE 1		2. Division/Group A/C			
3. Incident Name HAPPY CAMP COMPLEX		4. Operational Period 08/31/14 Sunday Day Shift 0600 - 1800					
5 Operations Personnel							
Operations Chief	RICKARD; ADELL; HAYES(t)			Division/Group Supervisor	ROBERT SCOTT		
Operations Chief	J. TOPOLESK(t) I; J. GIPSON			Air Attack Supervisor			
Branch Director				Safety Officer	DOUG ELLIOT; J. CHAMBERLIN (t)		
6 Resources Assigned this Period							
Strike Team/Task Force/ Resource Designator	Leader	Num of Pers.	Trans. Y/N	Drop Off PT./Time	Pick Up PT./Time		
CREW - T2 - UKIAH 1 C-149 9/12	SHELBY MAJORS	20	N	0700	1800		
ENGINE - T6 - E651 E-362 9/13	JEREMY BRYANT	5	N	0700	1800		
TFLD O-329 9/3	DAN TILZEY	1	N	0700	1800		
READ O-321 9/1	GREGG BOUSFIELD	1	N	0700	1800		
READ O-253 9/3	JASON FARMER	1	N	0700	1800		
READ(t) O-346 9/4	LAURA CLARE SHAFFER	1	N	0700	1800		
7. Control Operations: *All personnel must review Hazard Tree Safety IRPG pg. 22 during division breakouts and tail gate briefings. Hold and secure all fire north of Klamath River. Remove and back haul trash and equipment as needed. When firing, head fire should be considered only when life or property are threatened. All divisions refer to M.A.P.s. (Management Action Points) Mop up to the degree necessary to make the likelihood of escape very low; based on experience, terrain, fuel types and fuel conditions, and current and predicted weather conditions.							
8. Special Instructions Do not use non metered hydrants Ensure all crews have been briefed prior to traveling to their work assignment about the naturally occurring asbestos job hazard analysis. SOFR will notify DIVS when entering Division and exiting. FOBS and READ will notify DIVS when entering Division and exiting. KNF-E27, KNF-E25, KNF-WT21 and KNF-E326 - To be deployed in a manner that they can be made available for IA if needed.							
9 Division/Group Communications Summary							
Function	Frequency - RX	Frequency - TX	Tone	System	Channel	System	Channel
Command	173.0625	167.9625	RX 107.2/TX 107.2	NIFC	1	CMD 1	
Tactical Div/Group	166.7750	166.7750	RX 107.2/TX 107.2	NIFC	8	NIFC T-6	
Logistics							
Air to Ground	166.6750	166.6750	CSQ / NONE	NIFC	13	A/G-TAC	
Prepared by (Resource Unit Leader) S BRIGGS / L BABNEW / J PETERSON(t)		Approved by (Planning Section Chief) DENA SICKELS			Date Prepared 08/30/14	Time Prepared 0843	

Division Assignment List		1. Branch ZONE 1		2. Division/Group D / F			
3. Incident Name HAPPY CAMP COMPLEX		4. Operational Period 08/31/14 Sunday Day Shift 0600 - 1800					
5 Operations Personnel							
Operations Chief	RICKARD, ADELL; HAYES(t)		Division/Group Supervisor	MARK GERWE			
Operations Chief	JACOB GIPSON; JIM TOPOLESKI(t)		Air Attack Supervisor				
Branch Director			Safety Officer	DOUG ELLIOT; J. CHAMBERLIN(t)			
6 Resources Assigned this Period							
Strike Team/Task Force/ Resource Designator	Leader	Num of Pers.	Trans. Y/N	Drop Off PT./Time	Pick Up PT./Time		
CREW - T1 - SIERRA IHC C-120 9/5	AL ROBY	19	N	0700	1800		
CREW - T2 - OC 24 C-124 9/2	SHAUN HERMOSILLO	16	N	0700	1800		
CREW - T2 - CMNI-36 C-127 9/5	TYLER VANORMER	20	N	0700	1800		
CREW -T2IA- LOLO #1 C-132 9/5	JOHN MATATARE	20	N	0700	1800		
HAPPY CAMP T/F #7	R GROSS; J HUTCHINSON(t)	16	N	0700	1800		
*ENG - T3 - ASF ENGINE 374 E-292 9/6	SHANE BACA		N	0700	1800		
*ENG - T3 - CNF ENGINE 551 E-294 9/6	ERIC EGE		N	0700	1800		
*ENG - T3 - MISSOULA ENG 132 E-295 9/6	DICK WEAR		N	0700	1800		
*WTS- T2 - WHITE LOGGING E-264 9/6	TOM WHITE		N	0700	1800		
ENG- T6- CB FIRE TECH E-194 9/1	BRETT BOWER	4	N	0700	1800		
ENGINE S/T - T3 - 3660C CA-PN E-351 9/11	STEVE GONZALEZ	27	N	0700	1800		
WT T2 PRO DUMP E-191 8/31	MICHAEL WILLIAMS	1	N	0700	1800		
HEQB O-439 9/7	GORDON MEYER	1	N	0700	1800		
TFLD O-453 9/8	SHAUN CRAIG	1	N	0700	1800		
TFLD O-454 9/8	GREG VER	1	N	0700	1800		
FEMP O-264 9/1	STEVEN WALLACE	1	N	0700	1800		
FEMP O-460 9/8	PAUL SALVESTRIN	1	N	0700	1800		
ARCH O-347 9/3	WILLIAM BARFUSS	1	N	0700	1800		
SOF2 O-312 9/15	KEVIN LA BELLA	1	N	0700	1800		
7. Control Operations. *All personnel must review Hazard Tree Safety IRPG pg. 22 during division breakouts and tail gate briefings. Mop-up according to special instructions. Tactical ignition as directed and approved by OBD and OSC. When firing, head fire should be considered only when life or property are threatened. All divisions refer to M.A.P.s. (Management Action Points) Mop up to the degree necessary to make the likelihood of escape very low; based on experience, terrain, fuel types and fuel conditions, and current and predicted weather conditions. Back haul trash and equipment as needed.							
8. Special Instructions Do not use non metered hydrants. Ensure all crews have been briefed prior to traveling to their work assignment about the naturally occurring asbestos job hazard analysis. SOFR will notify DIVS when entering Division and exiting. FOBS and READ will notify DIVS when entering Division and exiting. KNF-E27, KNF-E25, KNF-WT21 and KNF-E326 - To be deployed in a manner that they can be made available for IA if needed.							
9 Division/Group Communications Summary							
Function	Frequency - RX	Frequency - TX	Tone	System	Channel	System	Channel
Command	173.0625	167.9625	RX 107.2/TX 107.2	NIFC	1	CMD 1	
Tactical Div/Group	168.6000	168.6000	RX 107.2/TX 107.2	NIFC	6	NIFC T-3	
Logistics							
Air to Ground	166.6750	166.6750	CSQ / NONE	NIFC	13	A/G-TAC	
Prepared by (Resource Unit Leader) S BRIGGS / L BABNEW / J PETERSON(t)		Approved by (Planning Section Chief) DENA SICKELS		Date Prepared 08/30/14		Time Prepared 0843	

Division Assignment List		1. Branch ZONE 1		2. Division/Group H (1 of 2)			
3. Incident Name HAPPY CAMP COMPLEX		4. Operational Period 08/31/14 Sunday Day Shift 0600 - 1800					
5 Operations Personnel							
Operations Chief	RICKARD; ADELL; HAYES(t)		Division/Group Supervisor	TODD JINKINS			
Operations Chief	JACOB GIPSON; JIM TOPOLESKI(t)		Air Attack Supervisor				
Branch Director			Safety Officer	DOUG ELLIOT; J. CHAMBERLIN(t)			
6 Resources Assigned this Period							
Strike Team/Task Force/ Resource Designator	Leader	Num of Pers.	Trans. Y/N	Drop Off PT./Time	Pick Up PT./Time		
CREW - T1 - BOISE IHC C-89 8/31	DEON BERNER	20	N	0700	1800		
CREW - T1 - SAWTOOTH IHC C-109 9/4	MICHAEL KRUPSKI	22	N	0700	1800		
CREW - T1 - MODOC IHC C-70 8/31	WILLIE ALMAND	20	N	0700	1800		
CREW - T1 - FEATHER RIVER IHC C-97 9/2	ROBERT DANIELS	20	N	0700	1800		
CREW - T1 - AUGUSTA HOTSHOTS I C-142 9/7	TED DOCEV	20	N	0700	1800		
CREW - T2 - MILLER TIMBER #15 C-100 9/3	LUIS AYALA	20	N	0700	1800		
CREW - T2 - MILLER TIMBER C-101 9/2	MIKE CAPANNA	20	N	0700	1800		
CREW - T2 - PACIFIC OASIS C-113 9/6	BENJAMIN DODDS	20	N	0700	1800		
HAPPY CAMP S/T #2	J. GOYINGS; J. THORNOCK(t)	25	N	0700	1800		
*ENG - T3 KNF- E326 E-163 8/30	BRANDON CORTES		N	0700	1800		
*ENG - T3 - KNF 27 E-72 9/12	HARRIS STONER		N	0700	1800		
DZ - T2 - CARSON'S CONST. E-144 9/14	MIKE REUZE	2	N	0700	1800		
DZ - T2 - INGRAM D6 E-175 9/15	RYAN GRABLE	2	N	0700	1800		
DZ-T1- DARRAH LOGGING E-226 9/16	GARY QUINONES	1	N	0700	1800		
DZ-T2 - BROWN CONST. E-254 9/16	GARY CARTWRIGHT	1	N	0700	1800		
ZEBBS TREE SERVICE E-245 9/4	RENEE STAFF	2	N	0700	1800		
DZ-T2 - PETERS - D7 E-253 9/2	JERRY SLATES	2	N	0700	1800		
SKIDGINE - T1 - TIGER TRUCKING E-312 9/12	MICKEY MUNAU	2	N	0700	1800		
WHITE LOGGING CO. E-223 8/31	WALT WHITMAN	1	N	0700	1800		
WTS - T2 - YREKA OUTLANDS E-263 9/2	ALLAN WILLIAMS	1	N	0700	1800		
7. Control Operations: *All personnel must review Hazard Tree Safety IRPG pg. 22 during division breakouts and tail gate briefings. Prepare line for holding along the D/F to F/H break. Tactical ignitions as directed and approved by OBD and OSC. When firing, head fire should be considered only when life or property are threatened. All divisions refer to M.A.P.s. (Management Action Points) Mop up to the degree necessary to make the likelihood of escape very low; based on experience, terrain, fuel types and fuel conditions, and current and predicted weather conditions.							
8. Special Instructions: Do not use non metered hydrants Ensure all crews have been briefed prior to traveling to their work assignment about the naturally occurring asbestos job hazard analysis. KNF-E27, KNF-E25, KNF-WT21 and KNF-E326 - To be deployed in a manner that they can be made available for IA if needed. SOFR will notify DIVS when entering Division and exiting. FOBS and READ will notify DIVS when entering Division and exiting.							
9 Division/Group Communications Summary							
Function	Frequency - RX	Frequency - TX	Tone	System	Channel	System	Channel
Command	173.0625	167.9625	RX 107.2/TX 107.2	NIFC	1	CMD 1	
Tactical Div/Group	166.5500	166.5500	RX 107.2/TX 107.2	NIFC	10	R5 TAC4	
Logistics							
Air to Ground	166.6750	166.6750	CSQ / NONE	NIFC	13	A/G-TAC	
Prepared by (Resource Unit Leader) S BRIGGS / L BABNEW / J PETERSON(t)		Approved by (Planning Section Chief) DENA SICKELS		Date Prepared 08/30/14		Time Prepared 0843	

Division Assignment List		1. Branch ZONE 1		2. Division/Group H (2 of 2)			
3. Incident Name HAPPY CAMP COMPLEX		4. Operational Period 08/31/14 Sunday Day Shift 0600 - 1800					
5 Operations Personnel							
Operations Chief	RICKARD; ADELL; HAYES(t)		Division/Group Supervisor	TODD JENKINS			
Operations Chief	JACOB GIPSON; JIM TOPOLESKI(t)		Air Attack Supervisor				
Branch Director			Safety Officer	DOUG ELLIOT; J. CHAMBERLIN(t)			
6 Resources Assigned this Period							
Strike Team/Task Force/ Resource Designator	Leader	Num of Pers.	Trans. Y/N	Drop Off PT./Time	Pick Up PT./Time		
WTT - T2 - DARRAH E-104 9/1	WAYNE WILLIAMS	1	N	0700	1800		
HEQB O-333 9/4	TIM WILSON	1	N	0700	1800		
HEQB O-440 9/8	JON STONELAKE	1	N	0700	1800		
STCR O-366 9/5	DAVID SOLDAVINI	1	N	0700	1800		
FELB O-313 9/2	BRIAN SEE	1	N	0700	1800		
FALM AMERICAN TIMBR O-113 9/3	MIKE MOEN	2	N	0700	1800		
FALM NORTH ZONE O-387 9/3	BRANTON/PARKER	2	N	0700	1800		
FOBS O-249 9/3	ISAAC KARVAS	1	N	0700	1800		
FOBS O-362 8/30	KEVIN OSBORNE	1	N	0700	1800		
FEMP O-459 9/8	KEVIN WHITE	1	N	0700	1800		
FEMP O-489 9/11	DAN COYLE	1	N	0700	1800		
FEMP O-490 9/10	DALE WILLIAMS	1	N	0700	1800		
READ O-471 9/9	EAMON ENGBER	1	N	0700	1800		
ARCH O-285 9/2	ROBERT DELOS GRATE JR	1	N	0700	1800		
SOFR O-310 9/3	JEFFERY A HENDERSON	1	N	0700	1800		
7. Control Operations: *All personnel must review Hazard Tree Safety IRPG pg. 22 during division breakouts and tail gate briefings. Prepare line for holding along the D/F to F/H break. Tactical ignitions as directed and approved by OBD and OSC. When firing, head fire should be considered only when life or property are threatened. All divisions refer to M.A.P.s. (Management Action Points) Mop up to the degree necessary to make the likelihood of escape very low; based on experience, terrain, fuel types and fuel conditions, and current and predicted weather conditions.							
8. Special Instructions: KNF-E27, KNF-E25, KNF-WT21 and KNF-E326 - To be deployed in a manner that they can be made available for IA if needed. Do not use non metered hydrants Ensure all crews have been briefed prior to traveling to their work assignment about the naturally occurring asbestos job hazard analysis. SOFR will notify DIVS when entering Division and exiting. FOBS and READ will notify DIVS when entering Division and exiting.							
9 Division/Group Communications Summary							
Function	Frequency - RX	Frequency - TX	Tone	System	Channel	System	Channel
Command	173.0625	167.9625	RX 107.2/TX 107.2	NIFC	1	CMD 1	
Tactical Div/Group	166.5500	166.5500	RX 107.2/TX 107.2	NIFC	10	R5 TAC4	
Logistics							
Air to Ground	166.6750	166.6750	CSQ / NONE	NIFC	13	A/G-TAC	
Prepared by (Resource Unit Leader) S BRIGGS / L BABNEW / J PETERSON(t)		Approved by (Planning Section Chief) DENA SICKELS		Date Prepared 08/30/14		Time Prepared 0843	

Division Assignment List		1. Branch ZONE 1		2. Division/Group I			
3. Incident Name HAPPY CAMP COMPLEX		4. Operational Period 08/31/14 Sunday Day Shift 0600 - 1800					
5 Operations Personnel							
Operations Chief	RICKARD; ADELL; HAYES(t);		Division/Group Supervisor		BRAD S SAWYER		
Operations Chief	JACOB GIPSON; JIM TOPOLESKI(t)		Air Attack Supervisor				
Branch Director			Safety Officer		DOUG ELLIOT; J. CHAMBERLIN(t)		
6 Resources Assigned this Period							
Strike Team/Task Force/ Resource Designator		Leader		Num of Pers.	Trans. Y/N	Drop Off PT./Time	Pick Up PT./Time
CREW - T1 - IDAHO CITY IHC C-88 9/2		BRIAN CARDOZA		21	N	0700	1800
7. Control Operations: *All personnel must review Hazard Tree Safety IRPG pg. 22 during division breakouts and tail gate briefings. Scout for line placement and construct line from O/I break to I/N break. When firing, head fire should be considered only when life or property are threatened. All divisions refer to M.A.P.s. (Management Action Points) Mop up to the degree necessary to make the likelihood of escape very low; based on experience, terrain, fuel types and fuel conditions, and current and predicted weather conditions.							
8. Special Instructions: Do not use non metered hydrants Ensure all crews have been briefed prior to traveling to their work assignment about the naturally occurring asbestos job hazard analysis. KNF-E27, KNF-E25, KNF-WT21 and KNF-E326 - To be deployed in a manner that they can be made available for IA if needed. SOFR will notify DIVS when entering Division and exiting. FOBS and READ will notify DIVS when entering Division and exiting.							
9. Division/Group Communications Summary							
Function	Frequency - RX	Frequency - TX	Tone	System	Channel	System	Channel
Command	173.0625	167.9625	RX 107.2/TX 107.2	NIFC	1	CMD 1	
Tactical Div/Group	168.2500	168.2500	RX 107.2/TX 107.2	NIFC	9	NIFC T-7	
Logistics							
Air to Ground	166.6750	166.6750	CSQ / NONE	NIFC	13	A/G-TAC	
Prepared by (Resource Unit Leader) S BRIGGS / L BABNEW / J PETERSON(t)		Approved by (Planning Section Chief) DENA SICKELS		Date Prepared 08/30/14		Time Prepared 0843	

Division Assignment List		1. Branch ZONE 1	2. Division/Group 0
3. Incident Name HAPPY CAMP COMPLEX		4. Operational Period 08/31/14 Sunday Day Shift 0600 - 1800	

5. Operations Personnel			
Operations Chief	RICKARD; ADELL; HAYES(t)	Division/Group Supervisor	KEITH WOLFERMAN
Operations Chief	JACOB GIPSON; JIM TOPOLESKI(t)	Air Attack Supervisor	
Branch Director		Safety Officer	DOUG ELLIOT; J. CHAMBERLIN(t)

6. Resources Assigned this Period						
Strike Team/Task Force/ Resource Designator	Leader	Num of Pers.	Trans. Y/N	Drop Off PT./Time	Pick Up PT./Time	
CREW - T2IA - HAPPY CAMP CREW C-103 9/2	DAMON MCCARTNEY	22	N	0700	1800	
CREW - T2IA - ASI ARDEN SOLUTI C-146 9/11	COUER D'ALENE	20	N	0700	1800	
ENG - T3 - RANCHERIA 2 E-249 9/2	DANNY Y MANNING	5	N	0700	1800	
ENG - T3 - 3639 E-248 9/3	MICHAEL MEDINA	4	N	0700	1800	
WTS - T2 - HARRIS EMS E-268 9/2	ELDON CALDWELL	2	N	0700	1800	
FALLER MOD O-502 9/11	DOUG MCKELLAR	2	N	0700	1800	
FEMP O-280 9/1	JORDAN RUSSELL	1	N	0700	1800	
FEMT O-302 8/31	JOHN DALEY	1	N	0700	1800	
SOFR O-401 9/9	WILLIAM SCHUCKERT	1	N	0700	1800	

7. Control Operations: *All personnel must review Hazard Tree Safety IRPG pg. 22 during division breakouts and tail gate briefings.
 Monitor and patrol.
 Monitor fire progression into Elk Creek.
 Construct line along Titus Ridge.
 When firing, head fire should be considered only when life or property are threatened.
 All divisions refer to M.A.P.s. (Management Action Points)
 Mop up to the degree necessary to make the likelihood of escape very low; based on experience, terrain, fuel types and fuel conditions, and current and predicted weather conditions.

8. Special Instructions
 Do not use non metered hydrants
 Ensure all crews have been briefed prior to traveling to their work assignment about the naturally occurring asbestos job hazard analysis.
 SOFR will notify DIVS when entering Division and exiting.
 FOBS and READ will notify DIVS when entering Division and exiting.
 KNF-E27, KNF-E25, KNF-WT21 and KNF-E326 - To be deployed in a manner that they can be made available for IA if needed.

9. Division/Group Communications Summary							
Function	Frequency - RX	Frequency - TX	Tone	System	Channel	System	Channel
Command	173.0625	167.9625	RX 107.2/TX 107.2	NIFC	1	CMD 1	
Tactical Div/Group	168.2375	168.2375	RX 107.2/TX 107.2	NIFC	12	R5 TAC6	
Logistics							
Air to Ground	166.6750	166.6750	CSQ / NONE	NIFC	13	A/G-TAC	

Prepared by (Resource Unit Leader) S BRIGGS / L BABNEW / J PETERSON(t)	Approved by (Planning Section Chief) DENA SICKELS	Date Prepared 08/30/14	Time Prepared 0843
---	--	---------------------------	-----------------------

Division Assignment List	1. Branch ZONE 1	2. Division/Group Q/I/T/Z
3. Incident Name HAPPY CAMP COMPLEX	4. Operational Period 08/31/14 Sunday Day Shift 0600 - 1800	

5. Operations Personnel			
Operations Chief	RICKARD; ADELL; HAYES (t)	Division/Group Supervisor	JOHN FOLEY; STEVEN COUNTS(t)
Planning Operations Chief	JACOB GIPSON; JIM TOPOLESKI (t)	Air Attack Supervisor	
Branch Director		Safety Officer	DOUG ELLIOT, J. CHAMBERLIN(t)

6. Resources Assigned this Period					
Strike Team/Task Force/ Resource Designator	Leader	Num of Pers.	Trans. Y/N	Drop Off PT./Time	Pick Up PT./Time
CREW - T2 - BIG HORN C-79 9/1	DAN LAMM	23	N	0700	1800
ENG S/T - T3 - 1659 C E-60 9/3	THIBAUT, ROB	27	N	0700	1800
ENG - T6 - LAP ENGINE 7362 E-300 9/5	DAKOTA O'BRIEN	4	N	0700	1800
ENG - T6 - 1160 GOLDEN GATE E-365 9/13	NICHOLAS CHAVIRA	4	N	0700	1800
WTS2 ANGELO CATTANEO E-189	MATT MEIER	1	N	0700	1800
WTS2 ANGELO CATTANEO E-190	RICARDO RUBY	1	N	0700	1800
FALM O-500 9/12	BRIAN CROCKER	2	N	0700	1800
FALM O-2097 9/12	DUSTIN BROWN	2	N	0700	1800
FALM O-2098 9/12	MARTY MILLER	2	N	0700	1800
SOFR O-189 9/1	DOUGLAS WELBOURN	1	N	0700	1800

7. Control Operations: *All personnel must review Hazard Tree Safety IRPG pg. 22 during division breakouts and tail gate briefings.
 Monitor fire progression into Elk Creek. Mop up and patrol.
 When firing, head fire should be considered only when life or property are threatened.
 All divisions refer to M.A.P.s. (Management Action Points)
 Mop up to the degree necessary to make the likelihood of escape very low; based on experience, terrain, fuel types and fuel conditions, and current and predicted weather conditions.
 Back haul equipment and trash as needed.

8. Special Instructions: Do not use non metered hydrants.
 Ensure all crews have been briefed prior to traveling to their work assignment about the naturally occurring asbestos job hazard analysis KNF-E27, KNF-E25, KNF-WT21 and KNF-E326 - To be deployed in a manner that they can be made available for IA if needed.
 SOFR will notify DIVS when entering DIVISION and exiting
 FOBS and READ will notify DIVS when entering DIVISION and exiting

9. Division/Group Communications Summary							
Function	Frequency - RX	Frequency - TX	Tone	System	Channel	System	Channel
Command	173.0625	167.9625	RX 107.2/TX 107.2	NIFC	1	CMD 1	
Tactical Div/Group	168.2500	168.2500	RX 107.2/TX 107.2	NIFC	9	NIFC T-7	
Logistics							
Air to Ground	166.6750	166.6750	CSQ / NONE	NIFC	13	A/G-TAC	

Prepared by (Resource Unit Leader) S BRIGGS/ L BABNEW/ J PETERSON (t)	Approved by (Planning Section Chief) DENA SICKELS	Date Prepared 08/30/14	Time Prepared 0843
--	--	---------------------------	-----------------------

Division Assignment List		1. Branch ZONE 1	2. Division/Group IA
3. Incident Name HAPPY CAMP COMPLEX		4. Operational Period 08/31/14 Sunday Day Shift 0600 - 1800	

5 Operations Personnel

Operations Chief	RICKARD; ADELL; HAYES(t)	Division/Group Supervisor	CLINT GOULD
Operations Chief	JACOB GIPSON; JIM TOPOLESKI(t)	Air Attack Supervisor	
Branch Director		Safety Officer	DOUG ELLIOT; J. CHAMBERLIN(t)

6 Resources Assigned this Period

Strike Team/Task Force/ Resource Designator	Leader	Num of Pers.	Trans. Y/N	Drop Off PT./Time	Pick Up PT./Time
CREW - T2 - OC 19 (CA-PNF) C-147 9/12	PATRICK CALLAHAN	19	N	0700	1800
ENG -T6 - MOUNT ADAMS #323 E-193 9/1	PAULA HOLTER	3	N	0700	1800
WTT - T2 - KNF E-108 9/10	AMY WYCKOFF	2	N	0700	1800
HIGH VOLUME PUMP E-273 9/3	DAVE BRANSON	1	N	0700	1800

7. Control Operations: *All personnel must review Hazard Tree Safety IRPG pg. 22 during division breakouts and tail gate briefings. Coordinate and suppress initial attack requests in the Happy Camp Ranger District. When firing, head fire should be considered only when life or property are threatened. All divisions refer to M.A.P.s. (Management Action Points) Mop up to the degree necessary to make the likelihood of escape very low; based on experience, terrain, fuel types and fuel conditions, and current and predicted weather conditions.

8. Special Instructions: Do not use non metered hydrants Ensure all crews have been briefed prior to traveling to their work assignment about the naturally occurring asbestos job hazard analysis. KNF-E27, KNF-E25, KNF-WT21 and KNF-E326 - To be deployed in a manner that they can be made available for IA if needed. SOFR will notify DIVS when entering Division and exiting. FOBS and READ will notify DIVS when entering Division and exiting.

9 Division/Group Communications Summary

Function	Frequency - RX	Frequency - TX	Tone	System	Channel	System	Channel
Command	173.0625	167.9625	RX 107.2/TX 107.2	NIFC	1	CMD 1	
Tactical Div/Group	168.0500	168.0500	RX 107.2/TX 107.2	NIFC	5	NIFC T-1	
Logistics							
Air to Ground	166.6750	166.6750	CSQ / NONE	NIFC	13	A/G-TAC	

Prepared by (Resource Unit Leader) S BRIGGS / L BABNEW / J PETERSON(t)	Approved by (Planning Section Chief) DENA SICKELS	Date Prepared 08/30/14	Time Prepared 0843
---	--	---------------------------	-----------------------

Division Assignment List	1. Branch ZONE 1	2. Division/Group H
3. Incident Name HAPPY CAMP COMPLEX NIGHT SHIFT	4. Operational Period 08/31/14 Sunday Night Shift 1800 - 0600	

5. Operations Personnel			
Operations Chief	FREELAND; MOORE; HINSON(t)	Division/Group Supervisor	TERRY GARNER
Operations Chief		Air Attack Supervisor	
Branch Director		Safety Officer	

6. Resources Assigned this Period						
Strike Team/Task Force/ Resource Designator	Leader	Num of Pers.	Trans. Y/N	Drop Off PT./Time	Pick Up PT./Time	
HAPPY CAMP TF #5	PETER GLOVER	15	N	1900	0600	
*ENG - T3 - CARSON CITY #3335 E-291 9/5	NATHAN WENDEL		N	1900	0600	
*ENG - T3 - STOX ENGINE 173 E-293 9/5	JASON SPELTZ		N	1900	0600	
*ENG- T6- STOREY CO. PATROL 72 E-296 9/5	NICK REVELLE		N	1900	0600	
*ENG - T6 - CNF ENGINE 533 E-297 9/3	MICHAEL W GUSTAFSON		N	1900	0600	
HAPPY CAMP TF #6	JOHN FOLEY	15	N	1900	0600	
*ENG - T3 - CAMINOS FIRE E-164 8/30	JOHN ROADS		N	1900	0600	
ENG - T6 - WID - ENG 2616 E-298 9/6	TERAH MALSAM		N	1900	0600	
*ENG - T6 - CCD 3636 E-299 9/6	MARK LAMONT		N	1900	0600	
*ENG - T6 - KNF 51 (MONTANA) E-301 9/6	TODD E MURRAY		N	1900	0600	
*WTS - T2- DOLCINI DAIRY E-267 9/2	ROBERT DOLCINI		N	1900	0600	
FEMT O-394 9/1	JEFF ROE	1	N	1900	0600	
WILSON, TIM O-396 9/2	TIM WILSON	1	N	1900	0600	
FEMP O-491 9/11	CHRIS MARSON	1	N	1900	0600	

7. Control Operations: ***All personnel must review Hazard Tree Safety IRPG pg. 22 during division breakouts and tail gate briefings.**
 When firing, head fire should be considered only when life or property are threatened.
 All divisions refer to M.A.P s. (Management Action Points)
 Mop up to the degree necessary to make the likelihood of escape very low, based on experience, terrain, fuel types and fuel conditions, and current and predicted weather conditions.

8. Special Instructions
 Do not use non metered hydrants
 Ensure all crews have been briefed prior to traveling to their work assignment about the naturally occurring asbestos job hazard analysis.
 SOFR will notify DIVS when entering Division and exiting.
 FOBS and READ will notify DIVS when entering Division and exiting.

9. Division/Group Communications Summary							
Function	Frequency - RX	Frequency - TX	Tone	System	Channel	System	Channel
Command	173.0625	167.9625	RX 107.2/TX 107.2	NIFC	1	CMD 1	
Tactical Div/Group	166.7750	166.7750	RX 107.2/TX 107.2	NIFC	8	NIFC T-6	
Logistics							
Air to Ground	166.6750	166.6750	CSQ / NONE	NIFC	13	A/G-TAC	
Prepared by (Resource Unit Leader) S BRIGGS / L BABNEW / J PETERSON(t)			Approved by (Planning Section Chief) DENA SICKELS		Date Prepared 08/30/14	Time Prepared 0852	

Division Assignment List		1. Branch ZONE 1		2. Division/Group O/Q/T/Z			
3. Incident Name HAPPY CAMP COMPLEX NIGHT SHIFT		4. Operational Period 08/31/14 Sunday Night Shift 1800 - 0600					
5. Operations Personnel							
Operations Chief	FREELAND; MOORE; HINSON(t)			Division/Group Supervisor	S. UNDERWOOD		
Operations Chief				Air Attack Supervisor			
Branch Director				Safety Officer			
6. Resources Assigned this Period							
Strike Team/Task Force/ Resource Designator	Leader	Num of Pers.	Trans. Y/N	Drop Off PT./Time	Pick Up PT./Time		
CREW - T1 - SMITH RIVER IHC C-129 9/2	TIM MEMMER	20	N	1900	0600		
CREW - T2 - DIAMOND FIRE C-99 9/2	JOHN WACHOSKI	20	N	1900	0600		
CREW- T2IA- FIRESTORM 15D C-145 9/11	ANDAVERDE; GRAY(t)	20	N	1900	0600		
* HAPPY CAMP T/F #3*	DONNELLEY; OSTMAN(t)	9	N	1900	0600		
*ENG - T6 - CHEMULT 642 E-207 9/2	NICHOLAS A BJORNSTAD		N	1900	0600		
*ENG- T6- MT ADAMS E-363 9/12	PAULA HOLDER		N	1900	0600		
*WTS - T2 - ALLIED WATER E-265 10/18	HANK BODREAU		N	1900	0600		
ENG - T6 - MOUNT ADAMS E-364 9/12	CHARLES NEWBERY	3	N	1900	0600		
ENG- T6- ALASKA WILDLAND E-370 9/13	DEAN SIBOLD	3	N	1900	0600		
FEMT O-395 9/1	DUSTIN RICHARDS	1	N	1900	0600		
FEMP O-492 9/11	DAMIEN CRINER	1	N	1900	0600		
SOFR O-308 9/2	LAWRENCE GRUBBS	1	N	1900	0600		
7. Control Operations: *All personnel must review Hazard Tree Safety IRPG pg. 22 during division breakouts and tail gate briefings. Keep fire within current control lines. Document ignition origin and termination points. When firing, head fire should be considered only when life or property are threatened. All divisions refer to M.A.P.s. Mop up to the degree necessary to make the likelihood of escape very low, based on experience, terrain, fuel types and fuel conditions, and current and predicted weather conditions.							
8. Special Instructions Do not use non metered hydrants Ensure all crews have been briefed prior to traveling to their work assignment about the naturally occurring asbestos job hazard analysis. Safety Officer to be shared in all divisions. SOFR will notify DIVS when entering Division and exiting. FOBS and READ will notify DIVS when entering Division and exiting.							
9. Division/Group Communications Summary							
Function	Frequency - RX	Frequency - TX	Tone	System	Channel	System	Channel
Command	173.0625	167.9625	RX 107.2/TX 107.2	NIFC	1	CMD 1	
Tactical Div/Group	168.2375	168.2375	RX 107.2/TX 107.2	NIFC	12	R5 TAC6	
Logistics							
Air to Ground	166.6750	166.6750	CSQ / NONE	NIFC	13	A/G-TAC	
Prepared by (Resource Unit Leader) S BRIGGS / L BABNEW / J PETERSON(t)		Approved by (Planning Section Chief) DENA SICKELS		Date Prepared 08/30/14		Time Prepared 0852	

DIVISION ASSIGNMENT LIST			1. Branch Zone 2 Branch II		2. Division/Group J		
3. Incident Name Happy Camp Complex			4. Operational Period Date: 08/31/14 Time: 0600-1800				
5. Operations Personnel							
Operations Chief	Carlisle/Tomaselli (t)		Division/Group Supervisor		Isaac Powning		
Branch Director	Larry Wright		Safety		Dave Molter		
6. Resources Assigned This Period							
Strike Team/Task Force/ Resource Designator	Leader	Number Persons	Trans Needed	Drop Off PT/Time	Pick Up PT/Time		
Crew – T1 – Salmon River C-2006 9/9	Bill Robinson	20	N	Horse Camp/0700	Horse Camp/1900		
Crew – T1 – Redding Jumpers C-139 9/8	Felipe Marquez	19	N	Horse Camp/0700	Horse Camp/1900		
Crew – T1 – Roosevelt IHC C-110 9/5	Larry Money	20	N	Horse Camp/0700	Horse Camp/1900		
Crew – T1 – Ukonom IHC C-137 9/7	Keith Smith	19	N	Horse Camp/0700	Horse Camp/1900		
Eng – T3 – Bohica 31 E-2105 9/11	David Breglia	3	N	Horse Camp/0700	Horse Camp/1900		
Eng – T3 – Rocky Mtn 6358 E-2116 9/5	Fred Fleischman	4	N	Horse Camp/0700	Horse Camp/1900		
Eng – T3 – SRF 351 E-2106 9/11	John Maxwell	5	N	Horse Camp/0700	Horse Camp/1900		
Eng – T3 – BLM 5444 E-2124 9/12	Alan Dabash	4	N	Horse Camp/0700	Horse Camp/1900		
WT – T2 – KNF21 E-108 9/11	Dennis Franklin	1	N	Horse Camp/0700	Horse Camp/1900		
Chipper – Behrens E-290 10/21	Jacob Behrens	1	N	Horse Camp/0700	Horse Camp/1900		
Grader – Darrah E-2156 9/13	Van Bond	2	N	Horse Camp/0700	Horse Camp/1900		
TFLD O-2108 9/3	Richard Morris	1	N	Horse Camp/0700	Horse Camp/1900		
FOBS O-2023 9/8	Steve Ross	1	N	Horse Camp/0700	Horse Camp/1900		
FOBS O-2029 9/8	Steven Dean	1	N	Horse Camp/0700	Horse Camp/1900		
READ O-470 9/9	Terra Perkins	1	N	Horse Camp/0700	Horse Camp/1900		
ARCH O-2048 9/10	Patty Hubley	1	N	Horse Camp/0700	Horse Camp/1900		
FEMP O-359 9/3	Eric Schroth	1	N	Horse Camp/0700	Horse Camp/1900		
7. Control Operations							
Continue to prep Scott River Road from Highway 96 south toward Swanson Gulch. Scout for opportunities for engagement. Construct line as opportunity presents while maintaining LCES and mitigating hazards.							
8. Special Instructions							
9. Division/Group Communication Summary							
Function	Frequency	System	Channel	Function	Frequency	System	Channel
Command	RX 169.5375 TX 164.7125	CMD 3 Tone 10	3				
Tactical	167.1125	R5 TAC 5 Tone 10	11	Air to Ground	166.6750	A/G	13
Prepared By (Resource Unit Leader) A. Webster RESL		Approved By (Planning Sect. Ch.) Gordon Martin		Date 08/30/14		Time 2000	

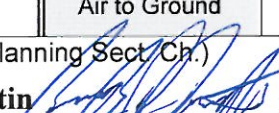
DIVISION ASSIGNMENT LIST		1. Branch Zone 2 Branch II		2. Division/Group M			
3. Incident Name Happy Camp Complex		4. Operational Period Date: 08/31/2014 Time: 0600-1800					
5. Operations Personnel							
Operations Chief	Carlisle/Tomaselli (t)	Division/Group Supervisor		Johnny Clem			
Branch Director	Larry Wright	Safety		Gearhardt/Pingiezer(t)			
6. Resources Assigned This Period							
Strike Team/Task Force/ Resource Designator	Leader	Number Persons	Trans Needed	Drop Off PT/Time	Pick Up PT/Time		
Crew – T1 – Plumas IHC C-123 9/1	Jack Sevelson	19	N	Zone 2 ICP/0600	Zone 2 ICP/1800		
Crew – T1 – Klamath IHC C-2013 9/10	Kevin Smyth	19	N	Zone 2 ICP/0600	Zone 2 ICP/1800		
Crew – T1 – Groveland IHC C-136 8/31	Patrick Laeng	18	N	Zone 2 ICP/0600	Zone 2 ICP/1800		
Crew – T1 – American River IHC C-144 9/10	Adam Leyba	19	N	Zone 2 ICP/0600	Zone 2 ICP/1800		
Eng S/T– T3 – 3676C E-2087 9/11	Mike Carter	27	N	Zone 2 ICP/0600	Zone 2 ICP/1800		
Eng – T3 – MDF 65 E-2102 9/12	Bernie Guthrie	5	N	Zone 2 ICP/0600	Zone 2 ICP/1800		
WT– T2 – SRF 245 E-346 9/9	Jeremy Leuis	2	N	Zone 2 ICP/0600	Zone 2 ICP/1800		
WT– T2 – ENF 5 E-347 9/10	Jacobie Waters	2	N	Zone 2 ICP/0600	Zone 2 ICP/1800		
FALM – Pro Plus O-337 9/3	Campbell/Porter	2	N	Zone 2 ICP/0600	Zone 2 ICP/1800		
FOBS O-414 9/2	Timothy Epp	1	N	Zone 2 ICP/0600	Zone 2 ICP/1800		
FOBS O-413 9/2	Kay Kudo	1	N	Zone 2 ICP/0600	Zone 2 ICP/1800		
READ O-344 9/5	John Reese	1	N	Zone 2 ICP/0600	Zone 2 ICP/1800		
READ O-345 9/5	Jason Wright	1	N	Zone 2 ICP/0600	Zone 2 ICP/1800		
ARCH O-2049	Ryan Brown	1	N	Zone 2 ICP/0600	Zone 2 ICP/1800		
FEMP O-458 9/7	Mark Fitzgerald	1	N	Zone 2 ICP/0600	Zone 2 ICP/1800		
7. Control Operations							
Scout for opportunities for engagement. Construct line as opportunity presents while maintaining LCES and mitigating hazards.							
8. Special Instructions							
9. Division/Group Communication Summary							
Function	Frequency	System	Channel	Function	Frequency	System	Channel
Command	RX 172.5500 TX 163.8250	CMD 4 Tone 10	4				
Tactical	166.7250	NIFC T-5 Tone 10	7	Air to Ground	166.6750	A/G	13
Prepared By (Resource Unit Leader) C. Dennett RESL		Approved By (Planning Sect. Ch.) Gordon Martin 		Date 08/30/2014	Time 2000		

DIVISION ASSIGNMENT LIST			1. Branch Zone 2 Branch II		2. Division/Group N		
3. Incident Name Happy Camp Complex			4. Operational Period Date: 08/31/14 Time: 0600-1800				
5. Operations Personnel							
Operations Chief	Carlisle/Tomaselli (t)		Division/Group Supervisor		Don Davis/Grahm Rice		
Branch Director	Larry Wright		Safety		Pedro Martinez		
6. Resources Assigned This Period							
Strike Team/Task Force/ Resource Designator	Leader	Number Persons	Trans Needed	Drop Off PT/Time	Pick Up PT/Time		
Crew – T1 – Redding IHC C-2009 9/1	Dan Malia	20	N	Coyote	Coyote		
Crew – T1 – Truckee IHC C-2007 9/4	Bobby Hubby	20	N	Coyote	Coyote		
Crew – T2IA – Alaska R10 C-91 9/4	Daniel Osborne	20	N	Coyote	Coyote		
Crew – T2IA – Flathead C-133 9/5	Brett Pargman	20	N	Coyote	Coyote		
Pack String – E-2081 9/10	Ken Smith	1	N	Coyote	Coyote		
Pack String – E-2082 9/11	Dan Menne	1	N	Coyote	Coyote		
FEMP O-265 9/1	Todd LaSieur	1	N	Coyote	Coyote		
FEMT O-270 9/1	David Mazaika	1	N	Coyote	Coyote		
7. Control Operations							
Construct line from Paradise Lake northeast toward Stud Horse Spring.							
8. Special Instructions							
Use care when working around equines.							
9. Division/Group Communication Summary							
Function	Frequency	System	Channel	Function	Frequency	System	Channel
Command	RX172.5500 TX163.8250	CMD 4 Tone 10	4				
Tactical	168.0500	NIFC T1 Tone 10	5	Air to Ground	166.6750	A/G	13
Prepared By (Resource Unit Leader)		Approved By (Planning Sect. Ch)		Date		Time	
A. Webster RESL		Gordon Martin 		08/30/14		2000	

DIVISION ASSIGNMENT LIST		1. Branch Zone 2 Branch II		2. Division/Group SCOTT RIVER			
3. Incident Name Happy Camp Complex		4. Operational Period Date: 08/31/2014 Time: 0600-1800					
5. Operations Personnel							
Operations Chief	Carlisle/Tomaselli (t)	Division/Group Supervisor	Kevin Wegener Page 1 of 2				
Branch Director	Larry Wright	Safety	Mike Long				
6. Resources Assigned This Period							
Strike Team/Task Force/ Resource Designator	Leader	Number Persons	Trans Needed	Drop Off PT/Time	Pick Up PT/Time		
Crew – T2IA – Mescalero C-92 9/6	John Cenante	19	N	Zone 2 ICP/0600	Zone 2 ICP/1800		
Crew – T2IA – Patrick 13A C-2003 9/4	Randy Teel	20	N	Zone 2 ICP/0600	Zone 2 ICP/1800		
Crew – T2IA – Navajo Scouts #2 C-2002 9/5	Delbert Damon	21	N	Zone 2 ICP/0600	Zone 2 ICP/1800		
Crew – T2 – Cobras #3 C-77 9/1	Alan Wippert	23	N	Zone 2 ICP/0600	Zone 2 ICP/1800		
Crew – T2 – Aztecs C-111 9/4	Angel Acosta	20	N	Zone 2 ICP/0600	Zone 2 ICP/1800		
S/T – 9261C C-2147 9/3	Ivan Kaufner	18	N	Zone 2 ICP/0600	Zone 2 ICP/1800		
Eng – T3 – KNF E76 E-283 9/4	Chris Hansen	5	N	Zone 2 ICP/0600	Zone 2 ICP/1800		
Eng – T3 – KNF E77 E-284 9/3	Matt Strom	5	N	Zone 2 ICP/0600	Zone 2 ICP/1800		
Eng – T3 – INF E32 E-251 9/3	Troy Maguire	5	N	Zone 2 ICP/0600	Zone 2 ICP/1800		
Eng – T6 – GE Forestry E1 E-216 8/31	Hugo Chaparro	3	N	Zone 2 ICP/0600	Zone 2 ICP/1800		
Eng – T6 – Pacific Coast E76 E-215 8/31	Tommy Starts	3	N	Zone 2 ICP/0600	Zone 2 ICP/1800		
DZ – T2 – Mike Peters E-252 9/2	Jerry Slades	2	N	Zone 2 ICP/0600	Zone 2 ICP/1800		
WT – T2 – SHF - WT66 E-344 9/9	Andy Klein	2	N	Zone 2 ICP/0600	Zone 2 ICP/1800		
SKGN – Let 'Er Buck E-311 9/6	Steve Lassn	2	N	Zone 2 ICP/0600	Zone 2 ICP/1800		
Chipper – Firestorm E-289 9/4	James Barbaria	2	N	Zone 2 ICP/0600	Zone 2 ICP/1800		
Chipper – Zeb's E-245 9/4	Doug Staff	2	N	Zone 2 ICP/0600	Zone 2 ICP/1800		
Chipper – 3 B's E-2118 9/2	Rafael Vela	2	N	Zone 2 ICP/0600	Zone 2 ICP/1800		
FALM – North Zone O-385 9/3	Nealy/Burt	2	N	Zone 2 ICP/0600	Zone 2 ICP/1800		
FALM – North Zone O-386 9/3	Meadows/Lee	2	N	Zone 2 ICP/0600	Zone 2 ICP/1800		
7. Control Operations							
Continue to prep structures and provide structure defense in the communities of Seiad, Hamburg, and Scott Bar from DP14 to DP10. Work with READs for all proposed line construction.							
8. Special Instructions							
9. Division/Group Communication Summary							
Function	Frequency	System	Channel	Function	Frequency	System	Channel
Command	RX 172.5500 TX 163.8250	CMD 4 Tone 10	4				
Tactical	168.2500	NIFC T-7 Tone 10	9	Air to Ground	166.6750	A/G	13
Prepared By (Resource Unit Leader) C. Dennett RESL		Approved By (Planning Sect. Ch.) Gordon Martin		Date 08/30/2014		Time 2000	

DIVISION ASSIGNMENT LIST		1. Branch Zone 2 Branch II		2. Division/Group SCOTT RIVER			
3. Incident Name Happy Camp Complex		4. Operational Period Date: 08/31/2014 Time: 0600-1800					
5. Operations Personnel							
Operations Chief	Carlisle/Tomaselli (t)	Division/Group Supervisor		Kevin Wegener	Page 2 of 2		
Branch Director	Larry Wright	Safety		Mike Long			
6. Resources Assigned This Period							
Strike Team/Task Force/ Resource Designator	Leader	Number Persons	Trans Needed	Drop Off PT/Time	Pick Up PT/Time		
TFLD O-239 9/3	Jason Danen	1	N	Zone 2 ICP/0600	Zone 2 ICP/1800		
TFLD O-327 9/3	Steve Markason	1	N	Zone 2 ICP/0600	Zone 2 ICP/1800		
TFLD (t) O-121 9/2	Jesse Parry	1	N	Zone 2 ICP/0600	Zone 2 ICP/1800		
FELB O-314 9/2	John Ward	1	N	Zone 2 ICP/0600	Zone 2 ICP/1800		
FEMT O-268 9/1	Jeremy Slocum	1	N	Zone 2 ICP/0600	Zone 2 ICP/1800		
FEMP O-267 9/1	Jason Barker	1	N	Zone 2 ICP/0600	Zone 2 ICP/1800		
FEMP O-2138 9/5	Paul Cubak	1	N	Zone 2 ICP/0600	Zone 2 ICP/1800		
7. Control Operations							
Continue to prep structures and provide structure defense in the communities of Seiad, Hamburg, and Scott Bar from DP14 to DP10. Work with READs for all proposed line construction.							
8. Special Instructions							
9. Division/Group Communication Summary							
Function	Frequency	System	Channel	Function	Frequency	System	Channel
Command	RX 172.5500 TX 163.8250	CMD 4 Tone 10	4				
Tactical	168.2500	NIFC T-7 Tone 10	9	Air to Ground	166.6750	A/G	13
Prepared By (Resource Unit Leader) C. Dennett RESL		Approved By (Planning Sect. Ch.) Gordon Martin		Date 08/30/2014	Time 2000		

DIVISION ASSIGNMENT LIST		1. Branch Zone 2 Branch II		2. Division/Group DOZER			
3. Incident Name Happy Camp Complex		4. Operational Period Date: 08/31/2014 Time: 0600-1800					
5. Operations Personnel							
Operations Chief	Carlisle/Tomaselli (t)	Division/Group Supervisor		Bob Meyers			
Branch Director	Larry Wright	Safety		Harvey Carr			
6. Resources Assigned This Period							
Strike Team/Task Force/ Resource Designator	Leader	Number Persons	Trans Needed	Drop Off PT/Time	Pick Up PT/Time		
DZ- T2 – Johnson E-145 8/29	Tim Johnson	1	N	Zone 2 ICP/0600	Zone 2 ICP/1800		
DZ- T2 – North State E-177 9/8	Gifford Tollmadge	1	N	Zone 2 ICP/0600	Zone 2 ICP/1800		
DZ – T2 – MNF 3 E-2083 9/11	Rodney Carlton	2	N	Zone 2 ICP/0600	Zone 2 ICP/1800		
DZ – T2 – MDF 4 E-2084 9/10	Perry St John	2	N	Zone 2 ICP/0600	Zone 2 ICP/1800		
DZ – T2 – Peters E-253 9/02	Jerry Slate	2	N	Zone 2 ICP/0600	Zone 2 ICP/1800		
DZ – T2 – Northstate E-176 9/15	Michael Brash	2	N	Zone 2 ICP/0600	Zone 2 ICP/1800		
HEQB O-2122 09/13	Chris Voelker	1	N	Zone 2 ICP/0600	Zone 2 ICP/1800		
HEQB O-2124 9/9	Ron Booker	1	1	Zone 2 ICP/0600	Zone 2 ICP/1800		
HEQB O-2123 9/8	Brad Mikhelic	1	1	Zone 2 ICP/0600	Zone 2 ICP/1800		
7. Control Operations							
Scout for opportunities for engagement. Construct line as opportunity presents while maintaining LCES and mitigating hazards.							
8. Special Instructions							
9. Division/Group Communication Summary							
Function	Frequency	System	Channel	Function	Frequency	System	Channel
Command	RX 172.5500 TX 163.8250	CMD 4 Tone 10	4				
Tactical	166.7750	NIFC T-6 Tone 10	8	Air to Ground	166.6750	A/G	13
Prepared By (Resource Unit Leader) A. Webster RESL		Approved By (Planning Sect. Ch.) Gordon Martin		Date 08/30/14	Time 2000		

DIVISION ASSIGNMENT LIST				1. Branch Zone 2 Branch II		2. Division/Group 96 HWY/IA	
3. Incident Name Happy Camp Complex				4. Operational Period Date: 08/31/14 Time: 0600-1800			
5. Operations Personnel							
Operations Chief		Carlisle/Tomaselli (t)		Division/Group Supervisor		Stukey/Cottingham Page 1 of 2	
Branch Director		Larry Wright		Safety		David North/Bobby Hubby (t)	
6. Resources Assigned This Period							
Strike Team/Task Force/ Resource Designator		Leader	Number Persons	Trans Needed	Drop Off PT/Time	Pick Up PT/Time	
Crew – T2IA – Salyer C-143 9/9		Dale Mendes	20	N	Zone 2 ICP/0600	Zone 2 ICP/1800	
Crew – T2IA – Zephyr C-2004 9/2		Mat Fogarty	19	N	Zone 2 ICP/0600	Zone 2 ICP/1800	
Crew – T2IA – Hoopa #1 C-80 8/31		Nels Nelson	20	N	Zone 2 ICP/0600	Zone 2 ICP/1800	
Crew – T2IA – Firestorm #4 C-140 9/8		James Ramirez	20	N	Zone 2 ICP/0600	Zone 2 ICP/1800	
Crew – T2IA – Firestorm #5 C-141 9/9		Stan Hankins	20	N	Zone 2 ICP/0600	Zone 2 ICP/1800	
Crew – T2IA – Black Eagles 1 C-125 8/30		Casperson/Aguilar(t)	20	N	Zone 2 ICP/0600	Zone 2 ICP/1800	
Crew – T2 – Inyo 4 C-112 9/4		Andrew Auld	20	N	Zone 2 ICP/0600	Zone 2 ICP/1800	
Crew – T2 – 3B's C-114 9/6		Krishan Kochar	20	N	Zone 2 ICP/0600	Zone 2 ICP/1800	
Eng S/T – T3 – 4660C E-250 9/10		Matt Mullins	27	N	Zone 2 ICP/0600	Zone 2 ICP/1800	
Happy Camp S/T #1		James Jones	18	N	Zone 2 ICP/0600	Zone 2 ICP/1800	
*Eng – T6 – 863 Umatilla E-213 8/31		Paul Basye		N	Zone 2 ICP/0600	Zone 2 ICP/1800	
*Eng – T6 – 002 – Rogue Valley E-212 8/31		Stuart Johnson		N	Zone 2 ICP/0600	Zone 2 ICP/1800	
*Eng – T6 – Grand Ronde Tribe E-211 8/31		Jeremy Ojua		N	Zone 2 ICP/0600	Zone 2 ICP/1800	
*Eng – T6 – Grand Rond Tribe E-210 8/31		Cliff Gabe		N	Zone 2 ICP/0600	Zone 2 ICP/1800	
*Eng – T6 – Deschutes 652 E-209 8/31		Jared Nelson		N	Zone 2 ICP/0600	Zone 2 ICP/1800	
Happy Camp TF #4		Ezra Butterfield	19	N	Zone 2 ICP/0600	Zone 2 ICP/1800	
*Eng – T6 – Interior Brush 1 E-132 8/30		Chase Strand		N	Zone 2 ICP/0600	Zone 2 ICP/1800	
*Eng – T6 – Deschutes 640 E-208 8/31		Zebron Watts		N	Zone 2 ICP/0600	Zone 2 ICP/1800	
*Eng – T3 – Castle Mt. E-202 9/02		Jill Benton		N	Zone 2 ICP/0600	Zone 2 ICP/1800	
*Eng – T6 – Pacific Forest 74 E-214 8/31		Kevin Roberts		N	Zone 2 ICP/0600	Zone 2 ICP/1800	
*Eng – T6 – Firestorm 9905 E-75 9/10		Ken Maples		N	Zone 2 ICP/0600	Zone 2 ICP/1800	
*WT – T2 – WT4 E-349 9/11		Ted King		N	Zone 2 ICP/0600	Zone 2 ICP/1800	
*WT – T2 – WT3 E-348 9/11		Mike Kendrick		N	Zone 2 ICP/0600	Zone 2 ICP/1800	
7. Control Operations Continue to prep structures and provide structure defense in the communities of Seiad, Hamburg, and Scott Bar. Coordinate initial attack. Respond to newly reported fires. Ensure all crews are briefed prior to travelling and engaging.							
8. Special Instructions							
9. Division/Group Communication Summary							
Function	Frequency	System	Channel	Function	Frequency	System	Channel
Command	RX172.5500 TX163.8250	CMD 4 Tone 10	4				
Tactical	168.0500	NIFC Tac 1 Tone 10	5	Air to Ground	166.6750	A/G	13
Prepared By (Resource Unit Leader) A. Webster RESL			Approved By (Planning Sect. Ch) Gordon Martin		Date 08/30/14		Time 2000

DIVISION ASSIGNMENT LIST		1. Branch Zone 2 Branch II		2. Division/Group 96 HWY/IA			
3. Incident Name Happy Camp Complex		4. Operational Period Date: 08/31/14 Time: 0600-1800					
5. Operations Personnel							
Operations Chief	Carlisle/Tomaselli (t)	Division/Group Supervisor		Tom Stukey	Page 2 of 2		
Branch Director	Larry Wright	Safety		David North/Bobby Hubby (t)			
6. Resources Assigned This Period							
Strike Team/Task Force/ Resource Designator	Leader	Number Persons	Trans Needed	Drop Off PT/Time	Pick Up PT/Time		
Eng – T3 – Rocky Mountain #4 E-2103 9/6	Kimbrell Nutt	3	N	Zone 2 ICP/0600	Zone 2 ICP/1800		
Eng – T3 – LNF E13 E-2133 9/12	Jonathan Thiede	5	N	Zone 2 ICP/0600	Zone 2 ICP/1800		
Eng – T3 – Rim Fire E-2115 9/11	Dan Terrell	3	N	Zone 2 ICP/0600	Zone 2 ICP/1800		
TFLD O-315 9/2	Tim Bradley	1	N	Zone 2 ICP/0600	Zone 2 ICP/1800		
TFLD O-2107 9/11	Mark Winkleman	1	N	Zone 2 ICP/0600	Zone 2 ICP/1800		
TFLD O-483 9/8	John Martinez	1	N	Zone 2 ICP/0600	Zone 2 ICP/1800		
FOBS O-248 9/2	John Luepke	1	N	Zone 2 ICP/0600	Zone 2 ICP/1800		
FOBS O-2024 9/9	Bob Hoard	1	N	Zone 2 ICP/0600	Zone 2 ICP/1800		
FEMP	Nick Lawler	1	N	Zone 2 ICP/0600	Zone 2 ICP/1800		
7. Control Operations							
Continue to prep structures and provide structure defense in the communities of Seiad, Hamburg, and Scott Bar. Coordinate initial attack. Respond to newly reported fires. Ensure all crews are briefed prior to travelling and engaging.							
8. Special Instructions							
9. Division/Group Communication Summary							
Function	Frequency	System	Channel	Function	Frequency	System	Channel
Command	RX172.5500 TX163.8250	CMD 4 Tone 10	4				
Tactical	168.0500	NIFC Tac 1 Tone 10	5	Air to Ground	166.6750	A/G	13
Prepared By (Resource Unit Leader) A. Webster RESL		Approved By (Planning Sect. Ch.) Gordon Martin		Date 08/30/14	Time 2000		

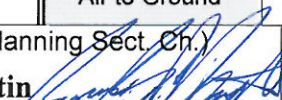
DIVISION ASSIGNMENT LIST				1. Branch Zone 2 Branch II		2. Division/Group SCOTT RIVER	
3. Incident Name Happy Camp Complex Night Shift				4. Operational Period Date: 08/31/14-09/01/14 Time: 1800-0600			
5. Operations Personnel							
Operations Chief		John Truett		Division/Group Supervisor		Walburn/Johnson/Webb(t)	
Branch Director				Safety		Tom Plymale	
6. Resources Assigned This Period							
Strike Team/Task Force/ Resource Designator		Leader	Number Persons	Trans Needed	Drop Off PT/Time	Pick Up PT/Time	
CREW – T1 – Eldorado IHC C-2015 9/8		Will Harris	20	N	Zone 2 ICP/1800	Zone 2 ICP/0600	
ENG - S/T – T3 – 4640C E-2089 9/8		Neal Robison	27	N	Zone 2 ICP/1800	Zone 2 ICP/0600	
ENG – T3 – PSC 321 E-2134 9/13		Steven Schrock	5	N	Zone 2 ICP/1800	Zone 2 ICP/0600	
ENG – T3 – Firestorm 9901 E-2104 9/12		Jess Wills	3	N	Zone 2 ICP/1800	Zone 2 ICP/0600	
ENG – T3 – Firestorm 9907 E-2113 9/12		Dan Kelleher	3	N	Zone 2 ICP/1800	Zone 2 ICP/0600	
ENG – T4 – HTF 415 E-2126 9/12		Taylor Farrington	4	N	Zone 2 ICP/1800	Zone 2 ICP/0600	
ENG – T6 – High Sierra E-2108 9/12		Jerry Vice	3	N	Zone 2 ICP/1800	Zone 2 ICP/0600	
ENG – T6 – E9 E-2112 9/12		Jacob Rowsey	3	N	Zone 2 ICP/1800	Zone 2 ICP/0600	
ENG – T6 – Wood E27 E-2127 9/12		Steve Felix	4	N	Zone 2 ICP/1800	Zone 2 ICP/0600	
ENG – T6 – Eng 9902 E-2128 9/12		N. Newitt	3	N	Zone 2 ICP/1800	Zone 2 ICP/0600	
FEMP O-462 9/9		Marciano Duran	1	N	Zone 2 ICP/1800	Zone 2 ICP/0600	
FEMP		Harris	1	N	Zone 2 ICP/1800	Zone 2 ICP/0600	
7. Control Operations							
Patrol and monitor fire conditions. Engage in perimeter fire suppression or structure defense as necessary.							
8. Special Instructions							
9. Division/Group Communication Summary							
Function	Frequency	System	Channel	Function	Frequency	System	Channel
Command	RX169.5375 TX164.7125	CMD 3 Tone 10	3				
Tactical	168.2500	NIFC TAC7 Tone 10	9	Air to Ground	166.6750	A/G	13
Prepared By (Resource Unit Leader)			Approved By (Planning Sect. Ch.)		Date		Time
A. Webster RESL			Gordon Martin 		08/30/14		2000

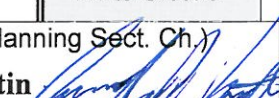
DIVISION ASSIGNMENT LIST				1. Branch Zone 2 Branch II		2. Division/Group 96 HWY	
3. Incident Name Happy Camp Complex Night Shift				4. Operational Period Date: 08/31/14-09/01/14 Time: 1800-0600			
5. Operations Personnel							
Operations Chief		John Truett		Division/Group Supervisor		Stephen Reed/Una Pesata	
Branch Director				Safety		Tom Plymale	
6. Resources Assigned This Period							
Strike Team/Task Force/ Resource Designator		Leader	Number Persons	Trans Needed	Drop Off PT/Time	Pick Up PT/Time	
CREW – T1 – Chief Mtn IHC C-2010 9/6		Lyle St Goddard	21	N	Zone 2 ICP/1800	Zone 2 ICP/0600	
ENG - S/T – 6631C E2085 9/11		Green/Canning (t)	27	N	Zone 2 ICP/1800	Zone 2 ICP/0600	
ENG - S/T – T3 – 4600C E-2086 9/10		Phil Weston	27	N	Zone 2 ICP/1800	Zone 2 ICP/0600	
ENG – T3 – IAR-09 E-2111 9/11		William Leflet	4	N	Zone 2 ICP/1800	Zone 2 ICP/0600	
ENG – T3 – Hoopa 9533 E-2117 9/11		Aaron Williams	5	N	Zone 2 ICP/1800	Zone 2 ICP/0600	
ENG – T6 – Firestorm 9904 E-2109 9/12		Joshua Bradley	4	N	Zone 2 ICP/1800	Zone 2 ICP/0600	
ENG – T6 – Firestorm 9906 E-2110 9/11		Aaron Wines	3	N	Zone 2 ICP/1800	Zone 2 ICP/0600	
ENG – T6 – Firestorm 9909 E-2114 9/12		Ronald Sartain	3	N	Zone 2 ICP/1800	Zone 2 ICP/0600	
7. Control Operations							
Patrol structures along Highway 96. Monitor fire progress on Grider Ridge between DP 17 and DP 4.							
8. Special Instructions							
Use frequencies for Div H.							
9. Division/Group Communication Summary							
Function	Frequency	System	Channel	Function	Frequency	System	Channel
Command	RX 169.5375 TX 164.7125	CMD 3 Tone 10	1				
Tactical	166.5500	R5 TAC 4 Tone 10	5	Air to Ground	166.6750	A/G	13
Prepared By (Resource Unit Leader)			Approved By (Planning Sect. Ch.)		Date		Time
A. Webster RESL			Gordon Martin 		08/30/14		2000

AIR OPERATIONS SUMMARY

PREPARED BY: Billy Monahan

PREPARED DATE/TIME: 08/30/14

1. INCIDENT NAME: Happy Camp Complex	2. OPERATIONAL PERIOD DATE: 08/31/14	START TIME: 0700	END TIME: 1930	SUNRISE: 0634	SUNSET: 1956
--------------------------------------	--------------------------------------	------------------	----------------	---------------	--------------

<p>3. REMARKS (Safety Notes, Hazards, Air Operations Special Equipment, etc.) Thunderstorms, erratic winds. Low wires and cables Numerous aircraft in confined areas. MTR's & MOA's near fire area. Flight following procedures at Cave Heilbase will be done with Cave Tower, 125.725</p> <p>Track all retardant usage, location & gallons. Helispots: H-1 41 38.84 123 13.423 H-41 37.756 123 12.460 Expect some Type2&3 Missions Supporting Happy Camp Fire from Scott HB (Recons,IR) Note: Cave Heilbase at Illinois Valley airport now has a Temporary Tower, "Cave Tower" 125.725</p>	<p>4. MEDEVAC A/C: 408 (NVG, ALS, Hoist) @ Scott Valley, 503 Litter Capable at Happy HB 510 litter capable at Cave HB</p>	<p>5. TFR: 4/6671 Radius: See dimensions below Altitude: 10,000' MSL 42 00.00 X 123 35.00 42 00.00 X 123 00.00 41 36.09 X 123 35.00 41 36.09 X 123 00.00 Frequency: 119.625</p>
---	--	--

6. PERSONNEL	Phone	7. FREQUENCIES	AM	FM	8. FIXED-WING	# Avail / Type/ Make-Model / FAA # / Base(s)
AOBD: Billy Monahan	661-221-1322	AIR/AIR FW:		162.2250	Airtankers	As needed
ATGS: Val Linch	661 487-2636	AIR/AIR RW: TFR-Victor	133.7250 119.6250		Leadplanes	As needed
ASGS: Kelvin McElfish	916-204-1012	AIR/GRD: Tac AIR/GRD: Cmd		166.6750 169.1500		
ASGS: (Cave) Kent Wedin	575 538-1075	COMMAND 1	Rx: 167.9625 Tx: 173.0625	Tone 107.2		
HEB1: (Cave) Kirby Cook HEB1 (t) Curtis Ritzman	541 592-2034				ATGS Aircraft	AA- 17V Val Linch AA- 06 Walter Bunt 507 - Cobra/Weed
HEB2: (Happy) Jim Gould HEB2(t) Brad Idol	530 493-1779 Happy Hard line	July Complex TFR	118.1250			
Cave Heilbase Scott Heilbase	541 592-2034 530-468-129	Medical AIR/GRD CALCORD	Rx:156.7 Tx:156.7	156.0750 Tone 6		

9. HELICOPTERS (Use Additional Sheets As Necessary)

FAA #	TY	MAKE/MODEL	BASE	AVAIL	START	REMARKS	FAA #	TY	MAKE/MODEL	BASE	AVAIL	START	REMARKS
H-503	3	Bell 407	Happy Camp	0730	0700	I/A with crew	184CH	1	Columbia 107	Cave	0800	0730	Bucket
911CV	3	Astar	Cave	0800	0730		HT-783	1	S-64	Cave	0800	0730	Tanked
7HE	3	Astar B3	Scott HB	0800	0730	Recon/Litter/PSD	HT-746	1	S-64	Cave	0800	0730	Tanked
H-510	2	Bell 205	Cave	0800	0730		HT-743	1	S-64	Cave	0800	0730	Tanked
H-516	2	Bell 212	Cave	0800	0730	I/A with crew	699RH	1	K-Max	Happy	0730	0700	Bucket
H-522	2	Bell 205	Cave	0800	0730	Moving to Scott HB							

10. TASK/MISSION/ASSIGNMENT (Type/Function includes: Air Tactical, Retardant, Recon, Personnel Transport, Water Dropping, S&R, etc.)

TYPE/FUNCTION	NAME OF PERSONNEL OR CARGO (if applic) OR INSTRUCTIONS FOR TACTICAL AIRCRAFT	MISSION START	FLY FROM	FLY TO
Bucket drops per request	Division Sup. To request and coordinate. Also Air Assets to record where their drops were and amount of Water/Retardant used.			
Recon Flights	To be approved by OPS or AOBD			
Cargo / Sling	Per Request from Div Sups, all sling loads / crew shuttles			
Heliwell	Norcross Heliwell 7000 gallons Water Tender E266 DIPSITES Blue Granite 41 33.960 x 123 18.600 Indian 41 53.743N x 123 24.373W Thompson 41 52.589N x 123 19.192W Nine Six 41 51.651N x 123 18.447W Ranch 41 52.435N x 123 25.053W Russel 41 52.24N x 123 24.52W Elk 41 46.88N x 123 23.657W Wire 41 48.43N x 123 21.75W Ukonom Lake 41 34.818N x 123 .402 Selad MRB 41 50.035 x 123 11.708	41 38.817 123 18.622		

INCIDENT RADIO COMMUNICATIONS PLAN		Incident Name		Happy Camp Complex		Date/Time Prepared		Operational Period Date/Time		
						8/30/2014 @ 2000		8/31/14 to 9/01/14		
Zn Ch	Function	Channel Name/Talkgroup	Assignment	RX Freq	RX Tone/NAC	TX Freq	TX Tone/NAC	Dev	Mode A, D, M	Remarks
Zn15 Ch1	COMMAND	CMD 1	ALL DIVISIONS	173.0625	Tone 10 107.2	167.9625	Tone 10 107.2	N L	A	ALL CMD'S LINKED TOGETHER
Zn15 Ch2	COMMAND	CMD 2	ALL DIVISIONS	168.7000	Tone 10 107.2	170.9750	Tone 10 107.2	N L	A	ALL CMD'S LINKED TOGETHER
Zn15 Ch3	COMMAND	CMD 3	ALL DIVISIONS	169.5375	Tone 10 107.2	164.7125	Tone 10 107.2	N L	A	ALL CMD'S LINKED TOGETHER
Zn15 Ch4	COMMAND	CMD 4	ALL DIVISIONS	172.5500	Tone 10 107.2	163.8250	Tone 10 107.2	N L	A	ALL CMD'S LINKED TOGETHER
Zn15 Ch5	TACTICAL	NIFC T-1	DIV N & 96 HWY/IA	168.0500	Tone 10 107.2	SIMPLEX	Tone 10 107.2	N L	A	
Zn15 Ch6	TACTICAL	NIFC T-3	DIV L & DIV D/F	168.6000	Tone 10 107.2	SIMPLEX	Tone 10 107.2	N L	A	NIGHT DIV D/F
Zn15 Ch7	TACTICAL	NIFC T-5	DIV M & STAGING GRP	166.7250	Tone 10 107.2	SIMPLEX	Tone 10 107.2	N L	A	
Zn15 Ch8	TACTICAL	NIFC T-6	DIV A/C & DOZER GRP	166.7750	Tone 10 107.2	SIMPLEX	Tone 10 107.2	N L	A	NIGHT DIV H **RIVER TRAFFIC**
Zn15 Ch9	TACTICAL	NIFC T-7	DIV Q/T/Z, DIV I & SCOTT RIVER GRP	168.2500	Tone 10 107.2	SIMPLEX	Tone 10 107.2	N L	A	
Zn15 Ch10	TACTICAL	R5 TAC4	DIV H & STRUCTURE GROUP	166.5500	Tone 10 107.2	SIMPLEX	Tone 10 107.2	N L	A	NIGHT STRUCTURE GRP
Zn15 Ch11	TACTICAL	R5 TAC5	DIV J	167.1125	Tone 10 107.2	SIMPLEX	Tone 10 107.2	N L	A	NIGHT DIV J
Zn15 Ch12	TACTICAL	R5 TAC6	DIV O	168.2375	Tone 10 107.2	SIMPLEX	Tone 10 107.2	N L	A	NIGHT DIV O/Q/T/Z
Zn15 Ch13	AIR TO GROUND	A/G-TAC	ALL DIVISIONS	166.6750	CSQ	SIMPLEX	NONE	N L	A	
Zn15 Ch14	AIR TO GROUND	A/G-CMD	OVERHEAD	169.1500	CSQ	SIMPLEX	NONE	N L	A	
Zn15 Ch15	MEDICAL TAC	CALCORD	ALL DIVISIONS	156.0750	CSQ	SIMPLEX	Tone 6 156.7	N H	A	AS NEEDED FOR MEDIVAC
Zn15 Ch16	AIR GUARD	AIR GUARD	ALL DIVISIONS	168.6250	CSQ	SIMPLEX	Tone 1 110.9	N L	A	

Prepared By (Communications Unit Leader)

MIKE HORST - COM1 (661) 645-4254 / KEVIN HARPER COM1(661) 330-0209

KOH

Incident Location: KLAMATH NATIONAL FOREST - HAPPY CAMP, CA
Cntry: SISKIYOU

Latitude Longitude

MEDICAL PLAN	1. INCIDENT NAME Happy Camp Complex	2. DATE PREPARED 8/30/14	3. TIME PREPARED 1800	4. OPERATIONAL PERIOD 8/31 to 9-1/2014 0600-0600
	5. INCIDENT MEDICAL AID STATIONS			

MEDICAL AID STATIONS	LOCATION	PARAMEDIC	
		YES	NO
Frontline Medical	Zone 1 Happy Camp, Camp	X	
Frontline Medical	Zone 2 Horse Creek Camps	X	
Frontline Medical	Zone 2 Horse Creek Camp	X	

6. TRANSPORTATION

A. Air Ambulances				
NAME	ADDRESS	PHONE	PARAMEDIC	
			YES	NO
Mercy Flights (Until 2400, No Hoist)	Medford, Oregon	(530) 842-3515	X	
Kern County 408 (NVG, Hoist)	Medford, Oregon	(530) 842-3515	X	
CHP H-14 (NVG, Hoist)	Redding Airport	(530) 842-3515		X

B. Ground Ambulances				
NAME	ADDRESS	PHONE	PARAMEDIC	
			YES	NO
Arcata Ambulance	Happy Camp Zone 1	Communications	X	
Hoopa Ambulance	Ft Jones, Zone 2	Communications	X	
Happy Camp Ambulance	Horse Creek, Camp, Zone 2	Communications	X	

7. HOSPITALS

NAME	ADDRESS	TRAVEL TIME		PHONE	HELIPAD		BURN CENTER	
		AIR	GRND		YES	NO	YES	NO
Fairchild MC	444 Bruce St. Yreka, CA. N. 41 43.13 W 122 38.69	20m	1 hr	(530) 841-6292	X			X
Mercy MC (Level 3 Trauma)	914 Pine St. Mt. Shasta, CA. N. 40 34.14 W. 122 23.97	45m	2.0 hr	(530) 926-9360	X			X
Rogue Valley MC (Level 2 Trauma)	2825 Barnett Rd. Medford, OR. N. 42 19.092 W. 122 49.833	30m	1.5 hr	(541) 789-7100	X			X
Providence Medford MC Level 2 Trauma	1111 Crater Lake Ave. Medford OR N 42 20.330 W 122 51.766	30m	1.5 hr	(541) 732-6440	X			X
UC Davis Med Center Level 1 Trauma	2315 Stockton Blvd. Sacramento, CA N. 38 33.3 W. 121 27.3	2hr	6.0 hr	(916) 734-3636 Burn Center (916) 734-3790 ER	X		X	

8. MEDICAL EMERGENCY PROCEDURES

In the event of a medical emergency, provide the following information to your DIVS or Happy Camp Communications on Command Net.

1. Declare the nature of the emergency.
 - a. Medical injury/illness?
 - b. Is injury/illness life threatening?
2. If life threatening, then request that the designated frequency be cleared for emergency traffic.
3. Identify the on-scene Point of Contact (POC) by resource and last name (i.e POC is TFLD Smith).
4. Identify nature of incident, number injured, patient assessment(s) and location (geographic and GPS coordinates).
5. Identify on-scene medical personnel by position and name (i.e EMT Jones).
6. Identify preferred method of patient transport.
7. Request any additional resources and/or equipment needed
8. Document all information received and transmitted on the radio or phone.
9. Identify any changes in the on-scene POC or medical personnel as they occur.

INJURY REPORTING PROCEDURES

Nature Of Injury _____ # of Patients _____

Transportation Needed: Air _____ REM _____ Ground _____

Lat _____ Long _____

Elevation _____ Estimated Air Temp _____

Specific Hazards In Area to Aircraft _____

Patient Unit ID _____

(REMINDER: DO NOT GIVE PT NAME OVER RADIO)

Are Medical Personnel With Patient: Yes _____ No _____

Age _____ Sex: Male _____ Female _____

ALL EMERGENCIES---Secure the area and identify witnesses for later investigation. Keep an accurate log of events.

Zone 1 Medical Unit Leader (916) 591-8802, Office (530) 493-1506
Zone 2 Medical Unit Leader (916) 215-2732

ICS 206 8-78	9. PREPARED BY (MEDICAL UNIT LEADER) Scott McKenney, MEDL	10. REVIEWED BY (SAFETY OFFICER) Bob Moore, SOF1
--------------	---	--

Medical Information	TOPIC:	CALIFORNIA	
	GETTING HELP DURING A MEDICAL EMERGENCY	INCIDENT RESPONSE TEAM	
Incident Aid Stations & Medical Teams Assignments for August 31, 2014			
Name	Location	Paramedic	
		Yes	No
Happy Camp (Front Line Medical)	Zone 1 Happy Camp (Camp)	X	
Horse Creek Camp (Front Line Medical)	Zone 2 Horse Creek Camp	X	
Fort Jones Camp (Front Line Medical)	Zone 2 Fort Jones Camp	X	
Arcata Ambulance	Staged at Happy Camp	X	
Happy Camp Ambulance	Staged at Horse Creek Camp	X	
Hoopaa Ambulance	Staged at Fort Jones Camp	X	
Zone 1 REM1	Assigned by OPS in Happy Camp area		X
Zone 2 REM2	Assigned by OPS in Scott Valley area		X
Zone 2 REM3 (Expected to arrive 08-31-14 AM)	Assigned by OPS in Seiad area Highway 96		X
Div. D / F FEMP Wallace & Salvestrin	In Division Moved as Directed by Div or Safety	X	
Div. H FEMP White, Coyle, Williams, Ford	In Division Moved as Directed by Div or Safety	X	
Div. O FEMP Russell, FEMT Daley	In Division Moved as Directed by Div or Safety	X	
Div. Q/T/Z FEMP Palmer, Colman	In Division Moved as Directed by Div or Safety	X	
Div. J FEMP Schroth,	In Division Moved as Directed by Div or Safety	X	
Div. L FEMP Balbiani, FEMT Turner	In Division Moved as Directed by Div or Safety	X	
Div. M FEMP Fitzgerald	In Division Moved as Directed by Div or Safety	X	
Div. N FEMP LaSieur, FEMT Mazaika	In Division Moved as Directed by Div or Safety	X	
Scott River Rd Group FEMT Slocum, FEMP Cubak, Barker	As Directed by Group Sup or Safety	X	
Hwy 96 Structure Group FEMP Lawler	As Directed by Group Sup or Safety	X	
NIGHT SHIFT			
Div H FEMT Roe, FEMP Wilson, Larson	In Division Moved as Directed by Div or Safety		X
Div O/Q/T/Z FEMP Criner, FEMT Richards	In Division Moved as Directed by Div or Safety		X
Scott River Group FEMP Duran, FEMP Harris	As Directed by Operations	X	

Medical Pre-Incident Planning:

- Identify EMTs and Equipment imbedded in suppression recourses.
- Review the Incident or Forest Emergency reporting procedures
- Review the Incident's assigned Medical resources and their location. (note radio call sign)
- Assure that all assigned supervisors have reviewed and understand the Medical Plan. (if none is available develop a quick plan before engaging)

Arriving at work site:

- Assess access and egress for medical ground units.
- Assure that all resources can clearly articulate their location. (update as they move)
- GPS potential Drop Points or Landing Zones.
- Note weather changes and check on availability of air resources.
- Pre-Position medical supplies

During Response to a Medical Emergency:

- Contact Communications and declare a **MEDICAL EMERGENCY!!**
- Identify the Unit needing help and their location
- Insure that LCES are maintained.
- Obtain patient info and severity.
- Develop a resource list
 - o Initial care
 - o Sustained care
 - o Extrication/evacuation
- Report the Emergency and request anticipated resources needs
- Put two plans in place and start both plans clearly identifying the primary and backup plan to resources assigned.
- During the Evacuation (every 15 min.)**
- Reassess the treatment and the patient response (Are they getting better?) Do you have the right level of care?
- Assess the evacuation plans progress and adjust as needed.
- Assure that additional personnel are available for relief.
- Up-date Comm/Disp of the progress of the rescue.

Human Resource Message August 31, 2014

SOME BOTTOM LINES

No matter what your position or assignment on this incident, you must take immediate and appropriate action when you become aware of acts of -

Discrimination

Sexual Harassment

Other forms of inappropriate behavior

Employees take action by -

Reporting the facts to your immediate supervisor, strike team leader, Division Supervisor, the IC or other appropriate individual.,

Supervisors or others who receive reports take action by -

Insuring the behavior stops, notifying the Human Resource Specialist and gathering facts.

The Human Resource Specialist takes action by -

Facilitating resolution of the issue, notifying appropriate agency individuals and advising individuals of rights and obligations. The Human Resource Specialist also assists in understanding rights, duties, and obligations on both the employee's and supervisor's part.



"Courage is what it takes to stand up and speak; courage is also what it takes to sit down and listen"

-Winston Churchill-

Janine Summy, Zone 2 HRSP, 509-429-1206

ZONE 2 TRAINING SPECIALIST MESSAGE

- ❖ **A TNSP WILL BE AVAILABLE FOR TRAINEE REGISTRATION DAILY AT ZONE 2 BASE CAMP FROM 0530-0730 AND FROM 1800-2000.**
- ❖ **A TNSP WILL BE AVAILABLE AT THE ZONE 2 ICP FROM 0800-2130 DAILY.**
- ❖ **ALL ZONE 2 TRAINEES MUST CLOSE OUT THEIR TRAINING PACKAGE AT THE ZONE 2 ICP.**

Resource Guidelines for Fire Suppression

1. Heavy Equipment and Machine Fire Lines

- Avoid using heavy equipment on slopes > 35%. If machine line is absolutely necessary on slopes > 35%, use an excavator and/or feller buncher – not a dozer.
- Do not build machine line within 300 feet of live streams – use hand line within 300 feet of streams.
- An excavator and/or feller buncher are the preferred pieces of heavy equipment if machine line is necessary – dozers are not preferred.
- Limit the depth and width of machine lines to that necessary to stop fire spread. Smaller is better than bigger.
- After use, recontour all machine lines, seed and fertilize with appropriate seed mixes, cover the recontoured lines with abundant slash; and mulch with weed free straw where prescribed.

2. Hand Lines

- Size and location consistent with Minimum Impact Suppression Tactics.
- Avoid using stream bottoms as improved or constructed control points. If needed, consult with the resource advisor to minimize impacts to streams.
- Tactical ignition of riparian areas is preferred over digging hand line in riparian areas or across streams.
- After use, recontour all hand line within 300 feet of streams and throw slash on the recontoured line. If possible, recontour all hand line regardless of location. At a minimum, waterbar all hand line outside of 300 feet using Forest specifications.

3. Retardants, Foams, and Surfactants

- Do not apply retardant within 300 feet of water bodies.
- Notify Forest dispatch immediately in the event of an accidental retardant application to water bodies
- Do not pump directly from streams if chemical products are to be injected into the system. If chemicals are used, pump from a fold-a-tank located at least 300 feet from water.
- Do not back flush pumps and charged hoses into streams and lakes.

4. Fuel Spills

- Store fuels at least 300 feet from water bodies.
- Apply spill prevention and containment measures on all pumps.
- Develop a HAZMAT Plan for all refueling/fuel storage areas. Have HAZMAT materials and trained personnel at these locations at all times.

5. Camp, Helibase, Helispot & Medivac Locations

- Helispot & pre-positioned medivac locations must be pre-authorized by Resource Advisor.
- Avoid locating camps and helibases within 300 feet of water bodies. If no other options exist, camps and helibases can be located within 300 feet of water bodies on a case-by-case basis if approved by the resource advisor.
- Use portable toilets at camps whenever possible. Latrines can be used temporarily or for small camps and will be located at least 300 feet from water sources.
- Spike camp locations, along with numbers of people staged & duration of use, must be pre-authorized by Resource Advisor.

6. Water Drafting and Helicopter Dipping

- Intakes on all pumps must be screened with mesh less than or equal to a 3/36th inch pore size.
- Install spill containment devices on all pumps.

- In non-emergency situations, do not dip from streams unless authorized by the resource advisor. Pump water into heli-wells or other portable tanks instead of dipping from streams. Dipping from lakes and ponds may be OK if authorized by the Resource Advisor.
- Helicopter dipping should be done only after chemical injection systems have been removed, disconnected, or rinsed clean.
- Make sure that all intake structures are clean and dry of mud and vegetation before placing them into water bodies.

7. Noxious Weeds and Aquatic Nuisance Species

- All vehicles mobilizing onto the fire and demobilizing from the fire must go through the weed wash station.
- Locate helibases in weed-free areas. If flowering weeds are present at helibases, they should be mowed and removed to an area where they cannot attach to gear.
- Inspect helicopter cargo nets to ensure that they are free of seeds and plant debris.
- Brush all seeds and plant debris off of your line gear before exiting the fire.
- Before placing it in water, ensure that all firefighting equipment (i.e. helicopter buckets, screens on pump intakes, hoses, etc) is clean of all dirt and plant debris, and dry.

8. Snags

- When snagging roadsides, retain the larger snags that are leaning away from the road.
- Do not cut down cambium-peeled trees.
- When possible, roll logs out of road/fireline instead of bucking.

9. Brushing and Fuel Breaks

- Maintain as many green trees and variety of size classes as possible – try to leave the brushed area as visually appealing as possible.
- Flush cut all stumps. Dispose of the cookies where they are not visible from the road or trail.
- When possible, roll logs out of roads whole instead of bucking.
- If chipping occurs, spray the chips across as wide an area as possible. Do not create beds of chips deeper than a couple of inches.

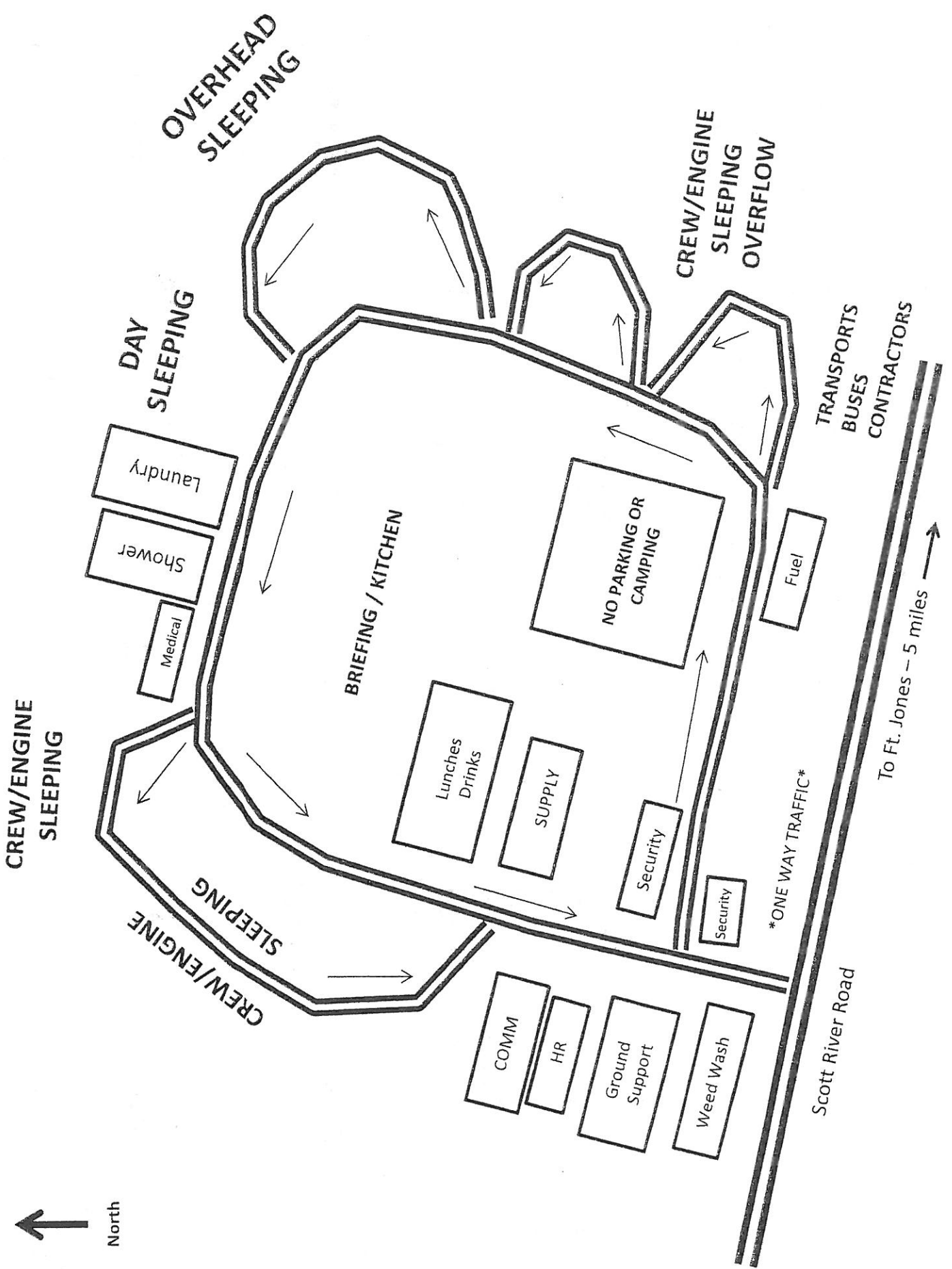

FORT JONES ICP

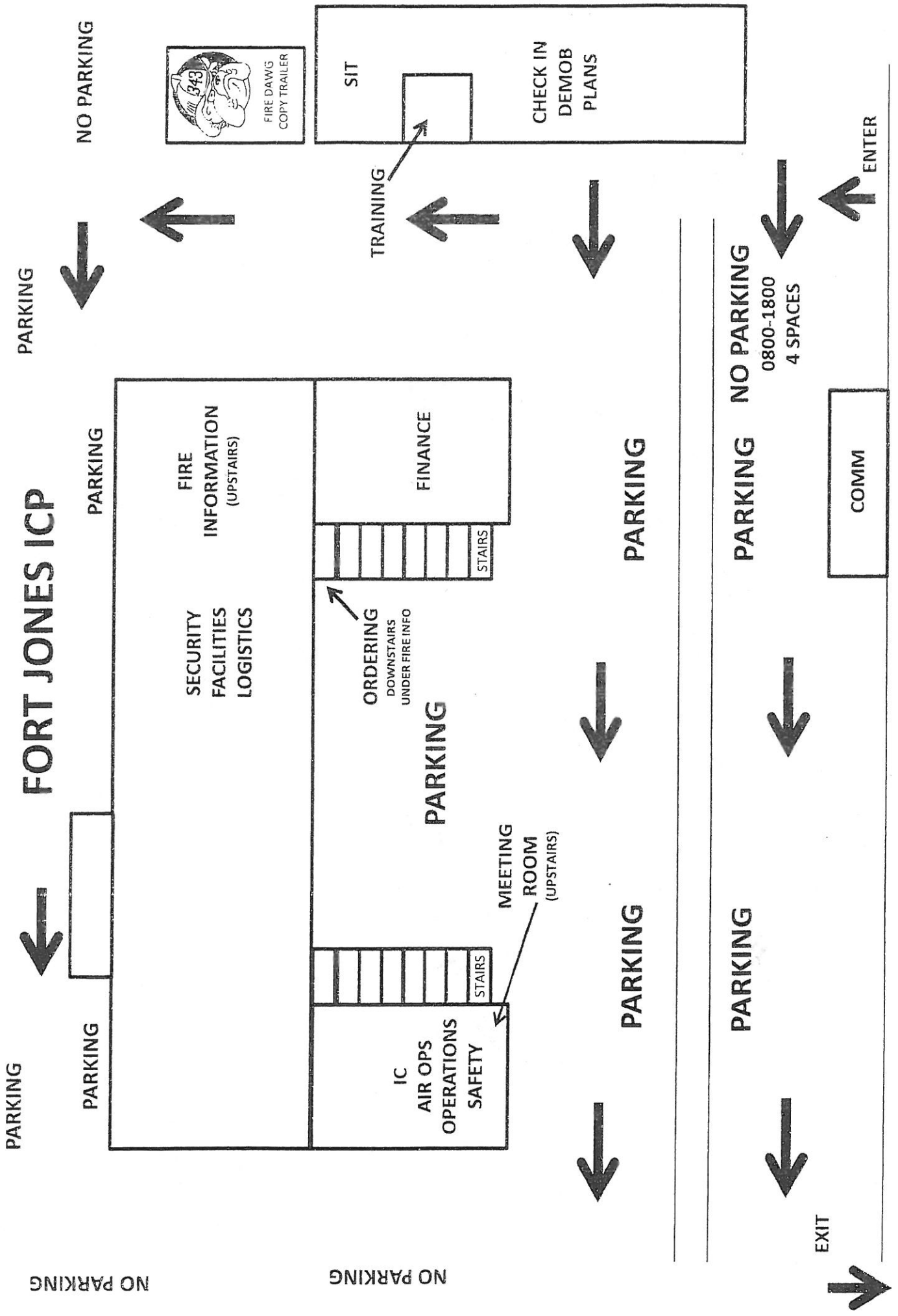

NO PARKING

NO PARKING

NO PARKING

NO PARKING

NO PARKING

