

HAPPY CAMP COMPLEX

CA-KNF-005956



P5JB1F-0505

DAY/NIGHT SHIFT

September 1, 2014 0600-1800

September 1-2, 2014 1800-0600

CALIFORNIA
INCIDENT MANAGEMENT TEAM

INCIDENT OBJECTIVES	1. INCIDENT NAME Happy Camp Complex	2. DATE 8/31/2014	3. TIME 2000									
4. OPERATIONAL PERIOD (DATE/TIME) September 1-2, 2014 DAY/NIGHT 0600-1800/1800-0600												
<p>5. GENERAL CONTROL OBJECTIVES FOR THE INCIDENT (INCLUDE ALTERNATIVES)</p> <p>Firefighter and public safety is our core value. All identified hazards will be mitigated or avoided.</p> <p>MANAGEMENT OBJECTIVES:</p> <p>Manage costs commensurate with values at risk.</p> <p>Minimize damage to natural and cultural resources caused by fire suppression activities.</p> <p>Maintain the current communication strategy to inform the public, cooperators, and key stakeholders on current fire status and planned actions.</p> <p>CONTROL OBJECTIVES:</p> <p>Use MIST to minimize impacts to wilderness characteristics.</p> <p>Provide structure defense resources for the communities of Elk Creek, Curly Jack, Happy Camp, Fort Goff, China Grade, Thompson Creek, Seiad, Hamburg, and Scott Bar. Provide support for protecting private property and infrastructure.</p> <p>Manage and coordinate all new fires within Zone 1 and Zone 2 as defined by the TFR.</p> <p>Manage all fires under a full suppression strategy.</p>												
<p>6. WEATHER FORECAST FOR OPERATIONAL PERIOD</p> <p>The very dry air aloft will produce potentially unstable conditions should the fire break through the inversion after 1500 with a Haines of 5 forecast over the region suggesting plume dominated fire potential. Warm and dry conditions will continue as the night shift transitions with day shift.</p>												
<p>7. GENERAL SAFETY MESSAGE</p> <p>Use good driving habits on the road system. Pay attention to your speed and be alert for wildlife on the roads.</p>												
<p>8. Attachments (☑ if attached)</p> <table border="0"> <tr> <td><input checked="" type="checkbox"/> Organization List (ICS 203)</td> <td><input checked="" type="checkbox"/> Medical Plan (ICS 206)</td> <td><input checked="" type="checkbox"/> Weather Forecast</td> </tr> <tr> <td><input checked="" type="checkbox"/> Assignment List (ICS 204)</td> <td><input checked="" type="checkbox"/> Incident Map</td> <td><input checked="" type="checkbox"/> Base Camp Map</td> </tr> <tr> <td><input checked="" type="checkbox"/> Communications Plan (ICS 205)</td> <td><input checked="" type="checkbox"/> Fire Behavior Forecast</td> <td><input checked="" type="checkbox"/> Air Operations Summary (ICS 220)</td> </tr> </table>				<input checked="" type="checkbox"/> Organization List (ICS 203)	<input checked="" type="checkbox"/> Medical Plan (ICS 206)	<input checked="" type="checkbox"/> Weather Forecast	<input checked="" type="checkbox"/> Assignment List (ICS 204)	<input checked="" type="checkbox"/> Incident Map	<input checked="" type="checkbox"/> Base Camp Map	<input checked="" type="checkbox"/> Communications Plan (ICS 205)	<input checked="" type="checkbox"/> Fire Behavior Forecast	<input checked="" type="checkbox"/> Air Operations Summary (ICS 220)
<input checked="" type="checkbox"/> Organization List (ICS 203)	<input checked="" type="checkbox"/> Medical Plan (ICS 206)	<input checked="" type="checkbox"/> Weather Forecast										
<input checked="" type="checkbox"/> Assignment List (ICS 204)	<input checked="" type="checkbox"/> Incident Map	<input checked="" type="checkbox"/> Base Camp Map										
<input checked="" type="checkbox"/> Communications Plan (ICS 205)	<input checked="" type="checkbox"/> Fire Behavior Forecast	<input checked="" type="checkbox"/> Air Operations Summary (ICS 220)										
<p>9. PREPARED BY (PLANNING SECTION CHIEF) Gordon P Martin </p>		<p>10. APPROVED BY (INCIDENT COMMANDER) Jeanne Pincha-Tulley </p>										



Happy Camp Complex Weather Forecast

FORECAST NO: 19 D/N
PREDICTION FOR: Monday Day/Night Shift
SHIFT DATE: Sept 1, 2014
FORECAST ISSUED: 1900 August 31, 2014

NAME OF FIRE: Happy Camp Complex
UNIT: KNF
Incident Meteorologist: Ryan Walbrun

WEATHER DISCUSSION: Continued warming and drying trend today as high pressure builds and a thermal trough develops over the region. Smoke over the fire will limit some of the heating but air just outside the fire environment will continue to warm and dry. Winds aloft and over the ridges will continue from the North/Northeast but will likely turn up-valley during the afternoon along Hwy 96 and Scott River Rd. **The very dry air aloft will produce potentially unstable conditions should the fire break through the inversion after 1500 with a Haines of 5 forecast over the region suggesting plume dominated fire potential.** Warm and dry conditions will continue as the night shift transitions with day shift. Night operations should expect very poor RH recovery especially over the ridges above 4000 feet.

WEATHER FORECAST FOR TODAY (MONDAY DAY SHIFT):

WEATHER: Sunny except abundant smoke Zone 1. Warmer and drier.

MAX TEMPERATURES: **With Smoke:** Valleys (1,200 ft) 78 – 85 F, Ridges (4,000 ft) 75 – 81 F

No Smoke: Valleys (1,200 ft) 85 – 92 F, Ridges (4,000 ft) 78 – 84 F

MIN HUMIDITY: **With Smoke:** Valleys (1,200 ft) 18 – 24%, Ridges (4,000 ft) 24 – 29%

No Smoke: Valleys (1,200 ft) 12 – 18%, Ridges (4,000 ft) 18 – 25%

WINDS (EYE LEVEL):

Lower Slopes / Drainages – North then afternoon up slope /up canyon 2 – 5 mph.

Ridges – North to Northeast 3-6 mph with a few gusts 8-10 mph late day.

LAL: 1 CWR: 0% HAINES: 5 (unstable and favorable for plume dominated fire when inversion breaks)

STABILITY / INVERSION: Strong inversion will be slow to mix out between 1500-1700

SMOKE TRANSPORT: Northerly 4-8 mph.

WEATHER FORECAST FOR TONIGHT (MONDAY NIGHT SHIFT):

WEATHER: Abundant smoke...otherwise mostly clear.

MIN TEMPERATURES: 55 to 65 F...locally 50 in the lower drainages and river canyons.

MAX HUMIDITY: Valleys (1,200 ft) 50 – 60%F, Ridges (4,000 ft) 35 – 45% but some of the higher

Ridges above 4000 feet may only recover 28-38%

WINDS (EYE LEVEL): Valleys – North or Downslope / down valley 2 – 4 mph

Ridges – Northeast to East 3-6 mph.

LAL: 1 CWR: 0% HAINES: 4

STABILITY / INVERSION: Strong inversion developing after 10 pm.

SMOKE TRANSPORT: North/Northeast 4-8 mph.

OUTLOOK FOR TUESDAY (4500 FT): Mostly sunny. Areas of smoke. Continued warm and dry.

Max Temps: 82 to 92. Min RH: 12 - 24%. Ridge Wind: North/Northeast 3 – 6 mph gusts 10 mph but turning westerly/upslope in the afternoon. LAL 1. CWR 0%. Haines 4-5.

THREE DAY EXTENDED DAYTIME (WEDNESDAY – FRIDAY 4500 FT)

	<u>Max T</u>	<u>Min RH</u>	<u>Max RH</u>	<u>Ridge Winds</u>	<u>LAL</u>	<u>WX</u>
WED	78 – 85	20%	50%	N/NE 3 - 6 G 8 mph	1	SMK
THU	79 – 87	18%	40%	N/NW 4 - 6 G 12 mph	1	SMK
FRI	80 – 86	20%	45%	N/NW 4 - 8 G 12mph	1	SMK

FIRE BEHAVIOR FORECAST

FORECAST NO. 28

NAME OF FIRE: Happy Camp

UNIT: CA-KNF 5956

DATE & TIME ISSUED: 08/31 2200 hr

PREDICTION FOR: 9/1/14 24hr.

SIGNED: /s/ Dennis Burns

FIRE BEHAVIOR ANALYST

WEATHER SUMMARY: Warmer and dry with a moderate potential for large growth.

Winds: Day, Ridges N-NE 4-8mph, Night: Downslope/down valley 3-5mph.

Min. RH: 18-28% Max. RH 25-35%

Temperatures: Day 78-88. Night: 55-65

LAL 1 Haines 5 ERC @90th percentile 1000hr fuels 8%

FIRE BEHAVIOR FORECAST

GENERAL FIRE BEHAVIOR:

The fire will remain fuels and topography driven. At present primary fire spread is from spot fires caused by rolling material and torching, most of the fire is in a backing alignment. Drainages with continuous fuels have a high potential for sustained runs once the inversion breaks. Falling snags and rolling material will challenge containment lines and will increase the potential for fire spread over barriers that would normally hold the fire. If a large column develops expect spot fires out to 1+miles.

Expect rapid acceleration of fire behavior when the inversion lifts. The fire will go from smoldering and creeping to torching as soon as the sun hits the fuels.

Fire will remain active into the night until the RH recovers to 40%.

SPECIFIC:

Frying Pan

- Div. H&J fire progression will continue to the east, fire is established across Grider Creek. Fire should stay in a backing alignment. Watch for spotting across lines to the north.
- Div. O&I fire progression will continue as flanking fire to the east.
- West end of the fire no forward progression expected. Interior fuels will continue to burn out
- Expect active backing fire in the areas where the fire has breached Walker Ridge Div M&L.
- East west drainages north of Rancheria Crk. have high potential for sustained runs.
- South end of the fire will continue to hold on the PCT ridge. Spots from torching will challenge containment.
- Div. M&L Mainly backing and flanking fire, rollout will continue to challenge containment

Air Operations: Poor visibility has a high potential to limit air operations.

SAFETY:

As the inversion lifts, expect a rapid increase of fire behavior.

Steep country means rolling material, watch for spot fires below you!

Safety Message

September 1st, 2014

Hazards we face:

- Traffic hazards
- Night Contact
- Snags / Rolling material / steep terrain / uneven footing
- Safety Zones
- Smoke/hydration
- Sleeping Areas

Some possible mitigation could include:

- Narrow roads accessing fire area, non-fire traffic will start picking up this week. All fire personnel use slow speeds, exercise cautious driving and make sure the pull out you are using is big enough to fit your vehicle, it is important to be fully off the travel way.
- Wildlife leaving the fire area, especially bears require a heads up. If any errant cattle are found, notify commo.
- Crews in a Coyote or Spike situation make sure that Ops can contact (by radio, cell phone or sat phone) you at night if an emergency arises, do a test before going off shift.
- Snags in the fire area are burning through and falling on their own, this tends to bring rocks and material with it. Stage your people, equipment and vehicles safely and out of the "fall zone". Watch out for each other.
- Safety zones and Escape paths are key to your survival- build them into your tactics, have them well flagged and known to all.
- Hydrating will help stem off some of the effects of smoke.
- Use appropriate sleeping areas, they are well marked.

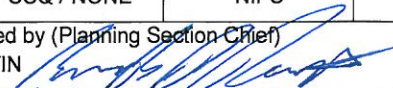

3. SAFETY ZONES AND ESCAPE ROUTES
NOT IDENTIFIED

Division Assignment List			1. Branch BRANCH II		2. Division/Group G		
3. Incident Name HAPPY CAMP COMPLEX			4. Operational Period 09/01/14 Monday Day Shift 0600 - 1800				
5. Operations Personnel							
Operations Chief		JOHN TRUETT; JIM TOMASELLI (t)		Division/Group Supervisor		ANDY VERDUGO; STEVE CHUMLEY(t)	
Operations Chief				Air Attack Supervisor		VALENTINE C LINCH	
Branch Director		LARRY WRIGHT		Safety Officer		HENDERSON	
6. Resources Assigned this Period							
Strike Team/Task Force/ Resource Designator		Leader		Num of Pers.	Trans. Y/N	Drop Off PT./Time	Pick Up PT./Time
CREW - T1 - SAWTOOTH IHC C-109 9/4		MICHAEL KRUPSKI		22	N	HAPPY CAMP ICP 0600	HAPPY CAMP ICP 1800
CREW - T1 - FEATHER RIVER IHC C-97 9/2		ROBERT DANIELS		20	N	HAPPY CAMP ICP 0600	HAPPY CAMP ICP 1800
CREW - T2 - PACIFIC OASIS C-113 9/6		BENJAMIN DODDS		20	N	HAPPY CAMP ICP 0600	HAPPY CAMP ICP 1800
CREW-T2- TBA						HAPPY CAMP ICP 0600	HAPPY CAMP ICP 1800
DZ-T2-CARSON'S CONST. E-144 8/29		MIKE REUZE		2	N	HAPPY CAMP ICP 0600	HAPPY CAMP ICP 1800
WT-T2-YREKA OUTLANDS E-263 9/2		ALLAN WILLIAMS		1	N	HAPPY CAMP ICP 0600	HAPPY CAMP ICP 1800
ZEBS TREE SERVICE E-245 9/4		RENEE STAFF		2	N	HAPPY CAMP ICP 0600	HAPPY CAMP ICP 1800
SKIDGINE-T1-TIGER E-312 9/12		MICKEY MUNAU		2	N	HAPPY CAMP ICP 0600	HAPPY CAMP ICP 1800
FALM AMERICAN TIMBER O-113 9/3		MIKE MOEN		2	N	HAPPY CAMP ICP 0600	HAPPY CAMP ICP 1800
FALM NORTH ZONE O-387 9/3		BRANTON/PARKER		2	N	HAPPY CAMP ICP 0600	HAPPY CAMP ICP 1800
HEQB O-333 9/4		TIM WILSON		1	N	HAPPY CAMP ICP 0600	HAPPY CAMP ICP 1800
HEQB O-440 9/8		JON STONELAKE		1	N	HAPPY CAMP ICP 0600	HAPPY CAMP ICP 1800
STCR O-366 9/5		DAVID SOLDAVINI		1	N	HAPPY CAMP ICP 0600	HAPPY CAMP ICP 1800
FELB O-313 9/2		BRIAN SEE		1	N	HAPPY CAMP ICP 0600	HAPPY CAMP ICP 1800
FOBS O-249 9/3		ISAAC KARVAS		1	N	HAPPY CAMP ICP 0600	HAPPY CAMP ICP 1800
FEMP O-489 9/11		DAN COYLE		1	N	HAPPY CAMP ICP 0600	HAPPY CAMP ICP 1800
FEMP		FORD		1	N	HAPPY CAMP ICP 0600	HAPPY CAMP ICP 1800
7. Control Operations: *All personnel must review Hazard Tree Safety IRPG pg. 22 during division breakouts and tail gate briefings. Prepare line for holding along the F/G to G/H break. Tactical ignitions as directed and approved by OBD and OSC. When firing, head fire should be considered only when life or property are threatened. All divisions refer to M.A.P.s (Management Action Points) Mop up to the degree necessary to make the likelihood of escape very low; based on experience, terrain, fuel types and fuel conditions, and current and predicted weather conditions.							
8. Special Instructions Do not use non metered hydrants Ensure all crews have been briefed prior to traveling to their work assignment about the naturally occurring asbestos job hazard analysis. SOFR will notify DIVS when entering Division and exiting. FOBS and READ will notify DIVS when entering Division and exiting.							
9. Division/Group Communications Summary							
Function	Frequency - RX	Frequency - TX	Tone	System	Channel	System	Channel
Command	173.0625	167.9625	RX 107.2/TX 107.2	NIFC	1	CMD 1	
Tactical Div/Group	168.2375	168.2375	RX 107.2/TX 107.2	NIFC	12	R5 TAC4	
Logistics							
Air to Ground	166.6750	166.6750	CSQ / NONE	NIFC	13	A/G-TAC	
Prepared by (Resource Unit Leader) H. MEYERS			Approved by (Planning Section Chief) G. MARTIN 			Date Prepared 08/31/14	Time Prepared 2000

Division Assignment List	1. Branch BRANCH II	2. Division/Group J
---------------------------------	-------------------------------	-------------------------------

3. Incident Name HAPPY CAMP COMPLEX	4. Operational Period 09/01/14 Monday Day Shift 0600 - 1800
---	---

5. Operations Personnel

Operations Chief	JOHN TRUETT; JIM TOMASELLI (t)	Division/Group Supervisor	ISAAC POWNING
Operations Chief		Air Attack Supervisor	VALENTINE C LINCH
Branch Director	LARRY WRIGHT	Safety Officer	MIKE LONG

6. Resources Assigned this Period

Strike Team/Task Force/ Resource Designator	Leader	Num of Pers.	Trans. Y/N	Drop Off PT./Time	Pick Up PT./Time
CREW-T1-SALMON RIVER IHC C-2006 9/2	BILL ROBINSON	20	N	HORSE CAMP/0600	HORSE CAMP /1800
CREW-T1-ROOSEVELT IHC C-110 9/5	LARRY MONEY	20	N	HORSE CAMP/0600	HORSE CAMP /1800
CREW-T2-REDDING SMKJ C-139 9/9	LUIS GOMEZ	20	N	HORSE CAMP/0600	HORSE CAMP /1800
CREW-T1-UKONOM IHC C-137 9/7	KEITH SMITH	20	N	HORSE CAMP/0600	HORSE CAMP /1800
CREW-T2-AZTECS C-111 9/4	ANGEL ACOSTA	20	N	HORSE CAMP/0600	HORSE CAMP /1800
CREW-T2IA-PATRICK 13A C-2003 9/4	RANDY TEEL	20	N	HORSE CAMP/0600	HORSE CAMP /1800
ENGINE - SRF 351 E-2106 9/11	JON MAXWELL	5	N	HORSE CAMP/0600	HORSE CAMP /1800
ENGINE - T4 - NV-SND - 5444 E-2124 9/12	ALAN DABASH	4	N	HORSE CAMP/0600	HORSE CAMP /1800
ENGINE - T3 - ROCKY MOUNTAIN F E-2116 9/5	FRED FLEISCHMAN	4	N	HORSE CAMP/0600	HORSE CAMP /1800
ENGINE - T3 - BOHICA E-31 E-2105 9/11	DAVID BREGLIA	3	N	HORSE CAMP/0600	HORSE CAMP /1800
WT-T2-KNF 21 E-108 9/10	AMY WYCKOFF	2	N	HORSE CAMP/0600	HORSE CAMP /1800
WT-T2-LNF 1 E-374 9/13	KEVIN JOHNSON	2	N	HORSE CAMP/0600	HORSE CAMP /1800
CHIPPER BEHRENS E-290 9/5	JACOB BEHRENS	1	N	HORSE CAMP/0600	HORSE CAMP /1800
CHIPPER ZEB'S E-245 9/4	DOUG STAFF	2	N	HORSE CAMP/0600	HORSE CAMP /1800
CHIPPER FIRESTORM E-289 9/5	JAMES BARBARIA	1	N	HORSE CAMP/0600	HORSE CAMP /1800
GRADER DARRAH E-2156 9/13	VAN BOND	2	N	HORSE CAMP/0600	HORSE CAMP /1800
TFLD O-2108 9/3	RICHARD MORRIS	1	N	HORSE CAMP/0600	HORSE CAMP /1800
READ O-470 9/9	TERRA PERKINS	1	N	HORSE CAMP/0600	HORSE CAMP /1800
FEMP O-359 9/4	ERIC SCHROTH	1	N	HORSE CAMP/0600	HORSE CAMP /1800

7. Control Operations
Continue to prep Highway 96 southward to Scott River Road and the K/L break. Scout for opportunities for engagement. Construct line as opportunity presents while maintaining LCES and mitigating hazards.

8. Special Instructions

9. Division/Group Communications Summary

Function	Frequency - RX	Frequency - TX	Tone	System	Channel	System	Channel
Command	169.5375	164.7125	RX 107.2/TX 107.2	NIFC	3		
Tactical Div/Group	167.1125	167.1125	RX 107.2/TX 107.2	NIFC	11		
Logistics							
Air to Ground	166.6750	166.6750	CSQ / NONE	NIFC	13		

Prepared by (Resource Unit Leader) A. Webster RESL	Approved by (Planning Section Chief) G. Martin PSC1	Date Prepared 08/31/14	Time Prepared 2000
--	---	----------------------------------	------------------------------

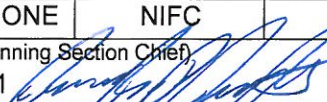
Division Assignment List			1. Branch BRANCH II		2. Division/Group 96 HWY STRUCTURE 1 OF 2		
3. Incident Name HAPPY CAMP COMPLEX			4. Operational Period 09/01/14 Monday Day Shift 0600 - 1800				
5. Operations Personnel							
Operations Chief		JOHN TRUETT; JIM TOMASELLI (t)		Division/Group Supervisor		LOOMIS/COTTINGHAM (t)	
Operations Chief				Air Attack Supervisor			
Branch Director		LARRY WRIGHT		Safety Officer		DON STUKEY	
6. Resources Assigned this Period							
Strike Team/Task Force/ Resource Designator		Leader		Num of Pers.	Trans. Y/N	Drop Off PT./Time	Pick Up PT./Time
CREW-T2IA-SALYER C-143 9/9		MENDES, DALE		20	N	FORT JONES ICP/0600	FORT JONES ICP/0600
CREW-T2IA-ZEPHYR C-2004 9/2		FOGERTY, MATT		19	N	FORT JONES ICP/0600	FORT JONES ICP/0600
CREW-T2IA-FIRESTORM 4 C-140 9/9		RAMIREZ, JAMES		20	N	FORT JONES ICP/0600	FORT JONES ICP/0600
CREW-T2IA-FIRESTORM 5 C-141 9/9		HANKINS, STAN		20	N	FORT JONES ICP/0600	FORT JONES ICP/0600
CREW-T2-BLACK EAGLES 1 C-125 8/31		CASPERSON, HANS		22	N	FORT JONES ICP/0600	FORT JONES ICP/0600
CREW-T2-3B'S FORESTRY C-114 9/6		JONES, MIKE		20	N	FORT JONES ICP/0600	FORT JONES ICP/0600
CREW-T2-INYO 4 C-112 9/4		AULD, ANDREW		20	N	FORT JONES ICP/0600	FORT JONES ICP/0600
HAPPY CAMP T/F #1		JAMES JONES				FORT JONES ICP/0600	FORT JONES ICP/0600
*ENG-T6-GRANDE RONDE #112 E-210 9/7		CLIFT GABE				FORT JONES ICP/0600	FORT JONES ICP/0600
*ENG-T6-GRANDE RONDE #113 E-211 9/7		JEREMY OJUA				FORT JONES ICP/0600	FORT JONES ICP/0600
HAPPY CAMP T/F #4		EZRA BUTTERFILED		18	N	FORT JONES ICP/0600	FORT JONES ICP/0600
*ENG-T6-ENG 640 E-208 9/7		ZEBRON WATTS				FORT JONES ICP/0600	FORT JONES ICP/0600
*ENG-T6-PACIFIC ENG 74 E-214 9/7		KEN ROBERTS				FORT JONES ICP/0600	FORT JONES ICP/0600
*ENG-T6-GDC003 E		BAKKEN/BENTON				FORT JONES ICP/0600	FORT JONES ICP/0600
*ENG-T6-FIRESTORM 9905 E-75 9/10		KEN NAPLES				FORT JONES ICP/0600	FORT JONES ICP/0600
*WT-T2-WT3 E-348		MIKE KENDRICK		2		FORT JONES ICP/0600	FORT JONES ICP/0600
*WT-T2-WT4 E-349 9/11		TED KING		1		FORT JONES ICP/0600	FORT JONES ICP/0600
ENG-T3-ENG 13 E-2133 9/12		JONATHAN THIEDE		5	N	FORT JONES ICP/0600	FORT JONES ICP/0600
ENG-T3-ROCKY MTN #4 E-2103 9/6		KIMBERLY NUTT		3	N	FORT JONES ICP/0600	FORT JONES ICP/0600
ENG-T3-RIM FIRE E-2115 9/11		DAN TERRELL		3	N	FORT JONES ICP/0600	FORT JONES ICP/0600
7. Control Operations							
Continue to prep structures and provide structure defense in the communities of Seiad, Hamburg, and Scott Bar. Ensure all crews are briefed prior to travelling and engaging. Engage in perimeter fire suppression or structure defense as necessary.							
8. Special Instructions							
9. Division/Group Communications Summary							
Function	Frequency - RX	Frequency - TX	Tone	System	Channel	System	Channel
Command	172.5500	163.8250	RX 107.2/TX 107.2	NIFC	4		
Tactical Div/Group	168.0500	168.0500	RX 107.2/TX 107.2	NIFC	5		
Logistics							
Air to Ground	166.6750	166.6750	CSQ / NONE	NIFC	13		
Prepared by (Resource Unit Leader) A. Webster RESL			Approved by (Planning Section Chief) G. Martin PSC1 		Date Prepared 08/31/14		Time Prepared 2000

Division Assignment List	1. Branch BRANCH IV	2. Division/Group K/L
---------------------------------	-------------------------------	---------------------------------

3. Incident Name HAPPY CAMP COMPLEX	4. Operational Period 09/01/14 Monday Day Shift 0600 - 1800
---	---

5. Operations Personnel

Operations Chief	JOHN TRUETT/JIM TOMASELLI(t)	Division/Group Supervisor	KEVIN WENGENER/R. INGRAM(t)
Operations Chief		Air Attack Supervisor	VALENTINE C LINCH
Branch Director	PAT REBELLO	Safety Officer	JAMES WOLF

6. Resources Assigned this Period

Strike Team/Task Force/ Resource Designator	Leader	Num of Pers.	Trans. Y/N	Drop Off PT./Time	Pick Up PT./Time
CREW-T2IA-JACKSON BLM C-41 9/6	FREDERICK ASHFORD	21	N	FORT JONES ICP 0600	FORT JONES ICP 1800
CREW-T2IA-KARUK C-2018 9/13	KENJI OKAZAKI	21	N	FORT JONES ICP 0600	FORT JONES ICP 1800
CREW-T2IA-MESCALERO C-92 9/6	JOHN CERVANTES	19	N	FORT JONES ICP 0600	FORT JONES ICP 1800
CREW-T2IA-NAVAJO SCOUTS 2 C-2002 9/5	DELBERT DAMON	21	N	FORT JONES ICP 0600	FORT JONES ICP 1800
ENG-T3-MDF 65 E-2102 9/11	BERNIE GUTHRIE	5	N	FORT JONES ICP 0600	FORT JONES ICP 1800
ENG-T3-KNF 46 E-2182	BRIAN FABBRI	6	N	FORT JONES ICP 0600	FORT JONES ICP 1800
ENG-T3-KNF 332 E-2138 9/13	BRANDON ALLEN	5	N	FORT JONES ICP 0600	FORT JONES ICP 1800
ENG3-MTR 5131 E-2132 9/11	STEVE GONZALES	4	N	FORT JONES ICP 0600	FORT JONES ICP 1800
ENG-T6-AZ-E363 E-2208 9/5	STEVE ESTELLE	4	N	FORT JONES ICP 0600	FORT JONES ICP 1800
ENG-T6-CNF E41 E-02200	D.OSTLER/J.FITZGERALD (t)	4	N	FORT JONES ICP 0600	FORT JONES ICP 1800
CHIP-T1-3 B'S FORESTRY E-2118 9/12	RAFAEL VELA	2	N	FORT JONES ICP 0600	FORT JONES ICP 1800
FOBS O-2023 9/8	STEVE ROSS	1	N	FORT JONES ICP 0600	FORT JONES ICP 1800
FOBS O-2029 9/8	STEVEN DEA	1	N	FORT JONES ICP 0600	FORT JONES ICP 1800
ARCH O-2048	PATTY HUBLEY	1	N	FORT JONES ICP 0600	FORT JONES ICP 1800
ARCH O-2049 9/11	RYAN BROWN	1	N	FORT JONES ICP 0600	FORT JONES ICP 1800
FEMT O-2151 9/11	CHRIS GILBERT	1	N	FORT JONES ICP 0600	FORT JONES ICP 1800
FEMT O-2150 9/11	DENNIS GILARDI	1	N	FORT JONES ICP 0600	FORT JONES ICP 1800

7. Control Operations

Continue to prep Scott River Road from Highway 96 south toward Swanson Gulch. Scout for opportunities for engagement. Construct line as opportunity presents while maintaining LCES and mitigating hazards.

8. Special Instructions

9. Division/Group Communications Summary

Function	Frequency - RX	Frequency - TX	Tone	System	Channel	System	Channel
Command	169.5375	164.7125	RX 107.2/TX 107.2	NIFC	3		
Tactical Div/Group	168.6000	168.6000	RX 107.2/TX 107.2	NIFC	6		
Logistics							
Air to Ground	166.6750	166.6750	CSQ / NONE	NIFC	13		

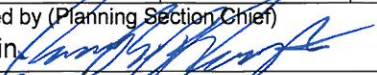
Prepared by (Resource Unit Leader) JEFF FERGUSON	Approved by (Planning Section Chief) G. Martin 	Date Prepared 08/31/14	Time Prepared 2200
--	---	----------------------------------	------------------------------

Division Assignment List	1. Branch BRANCH IV	2. Division/Group S
---------------------------------	-------------------------------	-------------------------------

3. Incident Name HAPPY CAMP COMPLEX	4. Operational Period 09/01/14 Monday Day Shift 0600 - 1800
---	---

5. Operations Personnel

Operations Chief	JOHN TRUETT/JIM TOMASELLI(t)	Division/Group Supervisor	JOE GONZALES
Operations Chief		Air Attack Supervisor	VALENTINE C LINCH
Branch Director	LARRY WRIGHT/PAT REBELLO	Safety Officer	DAVID NORTH/BOBBY HUBBY(t)

6. Resources Assigned this Period

Strike Team/Task Force/ Resource Designator	Leader	Num of Pers.	Trans. Y/N	Drop Off PT./Time	Pick Up PT./Time
CREW-T1-AMERICAN RIVER C-144 9/10	ADAM LEYBA	19	N	Fort Jones ICP0600	Fort Jones ICP 1800
CREW-T1-DALTON IHC C-2011 9/12	STEVE ROBLES	18	N	Fort Jones ICP0600	Fort Jones ICP 1800
CREW-T1-KLAMATH IHC C-2013 9/10	JOHNNY CLEM	20	N	Fort Jones ICP0600	Fort Jones ICP 1800
CREW-T1-HORSESHOE IHC C-2012	JOSE GONZALES	19	N	Fort Jones ICP0600	Fort Jones ICP 1800
CREW-T1-LEWIS & CLARK IHC C-131	MATT HOLMSTROM	20	N	Fort Jones ICP0600	Fort Jones ICP 1800
CREW-T1-PLUMAS IHC C-123 9/1	JACK SEVELSON	19	N	Fort Jones ICP0600	Fort Jones ICP 1800
S/T-T3-3676C E-2087 9/11	MIKE CARTER	26	N	Fort Jones ICP0600	Fort Jones ICP 1800
WT-T2-SRF-245 E-346 9/9	JEREMY LEWIS	2	N	Fort Jones ICP0600	Fort Jones ICP 1800
WT-T2-ENF-5 E-347 9/10	JECOBIE WATERS	2	N	Fort Jones ICP0600	Fort Jones ICP 1800
WT-T2-TNF-12 E-345 9/9	ANDREW ZWOLINSKI	2	N	Fort Jones ICP0600	Fort Jones ICP 1800
FOBS O-414 9/2	TIMOTHY EPP	1	N	Fort Jones ICP0600	Fort Jones ICP 1800
FOBS O-413 9/2	KAY KUDO	1	N	Fort Jones ICP0600	Fort Jones ICP 1800
FEMP O-267 9/1	JASON BARKER	1	N	Fort Jones ICP0600	Fort Jones ICP 1800
FEMP	SLOCUM	1	N	Fort Jones ICP0600	Fort Jones ICP 1800

7. Control Operations

Continue to prep Scott River Road from R/S break west to S/M break. Scout for opportunities for engagement. Construct line as oppourtunity presents while maintaining LCES and mitigating hazards.

8. Special Instructions

9. Division/Group Communications Summary

Function	Frequency - RX	Frequency - TX	Tone	System	Channel	System	Channel
Command	173.0625	167.9625	RX 107.2/TX 107.2	NIFC	1		
Tactical Div/Group	166.7750	166.7750	RX 107.2/TX 107.2	NIFC	8		
Logistics							
Air to Ground	166.6750	166.6750	CSQ / NONE	NIFC	13		

Prepared by (Resource Unit Leader) JEFF FERGUSON	Approved by (Planning Section Chief) G. Martin	Date Prepared 08/31/14	Time Prepared 2312
--	--	----------------------------------	------------------------------

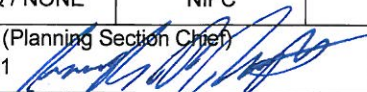
Division Assignment List			1. Branch BRANCH IV		2. Division/Group SCOTT RIVER STR GRP		
3. Incident Name HAPPY CAMP COMPLEX			4. Operational Period 09/01/14 Monday Day Shift 0600 - 1800				
5. Operations Personnel							
Operations Chief		JOHN TRUETT/JIM TOMASELLI (t)		Division/Group Supervisor		TOM STUKEY	
Operations Chief				Air Attack Supervisor		VALENTINE C LINCH	
Branch Director		PAT REBELLO		Safety Officer		DON STUKEY	
6. Resources Assigned this Period							
Strike Team/Task Force/ Resource Designator		Leader		Num of Pers.	Trans. Y/N	Drop Off PT./Time	Pick Up PT./Time
CREW S/T - T1 - 9260G C-2014		CYRUS MCCORMICK		40	N	FORT JONES ICP 0600	FORT JONES ICP 1800
ENGINE S/T - T3 - 9261C E-2147 9/12		IVAN KAUFNEK		18	N	FORT JONES ICP 0600	FORT JONES ICP 1800
ENG - T3 - INF 32 E-251 9/3		TROY AL MAGUIRE		5	N	FORT JONES ICP 0600	FORT JONES ICP 1800
ENG-T3 -KNF E76 E-283 9/4		CHRIS HANSON		5	N	FORT JONES ICP 0600	FORT JONES ICP 1800
ENG-T3- KNF-E77 E-284 9/3		MATT STROM		5	N	FORT JONES ICP 0600	FORT JONES ICP 1800
ENGINE - T3 - GTP E3 E-2139 9/13		RYLAN LYNAM		5	N	FORT JONES ICP 0600	FORT JONES ICP 1800
ENG3 AZ-SAD - E4337 E-2185 9/14				4	N	FORT JONES ICP 0600	FORT JONES ICP 1800
ENG-T4-UWF 461 9/12		JOSH LAMBERT		5	N	FORT JONES ICP 0600	FORT JONES ICP 1800
DZ-T2-MIKE PETERS E-252 9/2		JERRY SLADES		2	N	FORT JONES ICP 0600	FORT JONES ICP 1800
WT-T2-SHF WT66 E-344 9/9		ANDREW KLEIN		2	N	FORT JONES ICP 0600	FORT JONES ICP 1800
FALLER MODULE O-385 9/3		NEALY/BURT		2	N	FORT JONES ICP 0600	FORT JONES ICP 1800
FALLER MODULE O-386 9/3		MEADOWS/LEE		2	N	FORT JONES ICP 0600	FORT JONES ICP 1800
FELB O-314 9/2		JOHN WARD		1	N	FORT JONES ICP 0600	FORT JONES ICP 1800
TFLD O-327 9/3		STEVE MARKASON		1	N	FORT JONES ICP 0600	FORT JONES ICP 1800
TFLD O-239 9/3		JASON DANEN		1	N	FORT JONES ICP 0600	FORT JONES ICP 1800
TFLD O-121		JESSE PARRY		1	N	FORT JONES ICP 0600	FORT JONES ICP 1800
7. Control Operations:							
Continue to prep structures and provide structure defense in the communities of Seiad, Hamburg, and Scott Bar from DP14 to DP10. Work with READS for all proposed line construction.							
8. Special Instructions Do not use non metered hydrants Ensure all crews have been briefed prior to traveling to their work assignment about the naturally occurring asbestos job hazard analysis. SOFR will notify DIVS when entering Division and exiting. FOBS and READ will notify DIVS when entering Division and exiting.							
9. Division/Group Communications Summary							
Function	Frequency - RX	Frequency - TX	Tone	System	Channel	System	Channel
Command	172.5500	163.8250	RX 107.2/TX 107.2	NIFC	4	CMD 1	
Tactical Div/Group	168.2500	168.2500	RX 107.2/TX 107.2	NIFC	9	R5 TAC4	
Logistics							
Air to Ground	166.6750	166.6750	CSQ / NONE	NIFC	13	A/G-TAC	
Prepared by (Resource Unit Leader) A. Webster RESL			Approved by (Planning Section Chief) G. Martin PSC1 			Date Prepared 08/31/14	Time Prepared 2000

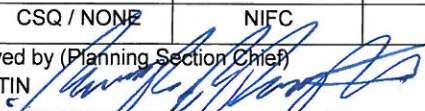
Division Assignment List			1. Branch			2. Division/Group STAGING		
3. Incident Name HAPPY CAMP COMPLEX			4. Operational Period 09/01/14 Monday Day Shift 0600 - 1800					
5. Operations Personnel								
Operations Chief		JOHN TRUETT/JIM TOMASELLI(t)			Division/Group Supervisor		JOHN NICKEY	
Planning Operations Chief		HERRERA/RUSSELL (t)			Air Attack Supervisor			
Branch Director					Safety Officer			
6. Resources Assigned this Period								
Strike Team/Task Force/ Resource Designator		Leader		Num of Pers.	Trans. Y/N	Drop Off PT./Time		Pick Up PT./Time
ENG-T3-TONTO E-37 E-2184 9/14		JOHN MCLAUGHLIN		5	N	0600		1800
ENG-T3-BRUSH 10 E-2168 9/14		ALAN ANDERSON		3	N	0600		1800
ENG-T3-CCFX-151 E-2169 9/14		KEVIN NYBERG		3	N	0600		1800
ENG-T3-TDOX-21 E-2161 9/14		TODD MOSS		4	N	0600		1800
ENG-T6-ASF-E663 E-2201 9/14		JUSTIN A GABLER		4	N	0600		1800
ENG-T4-BOF-431		JARED PEAK		7	N	0600		1800
ENG-T5-SITPA #22 E-2180 9/14		KIKE BLAKEWAY		3	N	0600		1800
ENG-T5-001-PACIFIC OA E-2176 9/14		STEVEN MILLER		3	N	0600		1800
DOZ-T2-MNF-3 E-2083		RODNEY CARLTON		2	N	0600		1800
DOZ-T2-MDF-4 E-2084		PERRY ST. JOHN		2	N	0600		1800
DOZ-T2-BROWN E-254		GARY CARTWRIGHT		2	N	0600		1800
DOZ-T2-MOODY 9747 E-2070		WALT MOODY		2	N	0600		1800
DOZ-T2-NORTH STATE E-176		MICHAEL BRASH		2	N	0600		1800
DOZ-T2-PERTERS E-253		JERRY SLATES		2	N	0600		1800
DOZ-T2-NORTHSTATE E-177		GIFFORD TOLLMADGE		2	N	0600		1800
DOZ-T2-JOHNSON E-145		TIM JOHNSON		2	N	0600		1800
DOZ-T2-INGRAM E-175		RYANGRABLE		2	N	0600		1800
DOZ-T1-DARRAH E-226		GARY QUINONES		1	N	0600		1800
DOZ-T2-BROWN E-245		GARY CARTWRIGHT		1	N	0600		1800
SKIDGEON-LET-ER-BUCK E-311		STEVE LASSN		2	N	0600		1800
7. Control Operations:								
Stage at basecamp. Maintain readiness and communications with overhead resources.								
8. Special Instructions								
9. Division/Group Communications Summary								
Function	Frequency - RX	Frequency - TX	Tone	System	Channel	System	Channel	
Command	172.5500	163.8250	RX 107.2/TX 107.2	NIFC	4	CMD 1		
Tactical Div/Group	166.7250	166.7250	RX 107.2/TX 107.2	NIFC	7	NIFC T-5		
Logistics								
Air to Ground	166.6750	166.6750	CSQ / NONE	NIFC	13	A/G-TAC		
Prepared by (Resource Unit Leader) JEFF FERGUSON			Approved by (Planning Section Chief) G. MARTIN 			Date Prepared 08/31/14		Time Prepared 2200

AIR OPERATIONS SUMMARY

PREPARED BY: Billy Monahan

PREPARED DATE/TIME: 08/31/14

1. INCIDENT NAME: Happy Camp Complex		2. OPERATIONAL PERIOD DATE: 09/01/14		START TIME: 0700		END TIME: 1930		SUNRISE:0634		SUNSET:1956		
3. REMARKS (Safety Notes, Hazards, Air Operations Special Equipment, etc.) Thunderstorms, erratic winds. Low wires and cables Numerous aircraft in confined areas. MTR's & MOA's near fire area. Flight following procedures at Cave Helibase will be done with Cave Tower, 125.725 Track all retardant usage, location & gallons. Helispots; H-1 41 38.84 123 13.423 H-41 37.756 123 12.460 Expect some Type2&3 Missions Supporting Happy Camp Fire from Scott HB (Recons,IR) <u>Note:</u> Cave Helibase at Illinois Valley airport now has a Temporary Tower, "Cave Tower" 125.725												
4. MEDEVAC A/C: 408 (NVG, ALS, Hoist) @ Cave HB, 503 Litter Capable at Happy HB 510 litter capable at Cave HB				5. TFR: 4/6671 Radius: See dimensions below Altitude: _10,000'_ MSL 42 00.00 X 123 35.00 42 00.00 X 123 00.00 41 36.09 X 123 35.00 41 36.09 X 123 00.00 Frequency: 119.625								
6. PERSONNEL		7. FREQUENCIES		8. FIXED-WING		8. AIRCRAFT		9. HELICOPTERS (Use Additional Sheets As Necessary)		10. REMARKS		
AOBD: Billy Monahan	Phone: 661-221-1322	AIR/AIR FW:	AM: 162.2250	Airtankers	As needed	ATGS Aircraft	AA-17V Val Linch AA-06 Walter Bunt 507 - Cobra/Weed	FAA N#	BASE	MAKE/MODEL	TY	REMARKS
ATGS: Val Linch	661 487-2636	AIR/AIR RW: TFR-Victor	133.7250 119.6250	Leadplanes	As needed			184CH	Cave	Columbia 107	1	I/A with crew
ASGS: Kelvin McElfish	916-204-1012	AIR/GRD: Tac AIR/GRD: Cmd	166.6750 169.1500					HT-783	Cave	S-64	1	
ASGS: (Cave) Kent Wedin	575 538-1075	COMMAND 1	Tx: 167.9625 Tone 107.2 Rx: 173.0625 Tone 107.2					HT-746	Cave	S-64	1	Recon/Litter/PSD
HEB1: (Cave) Kirby Cook HEB1 (t) Curtis Ritzman	541 592-2034							HT-743	Cave	S-64	1	
HEB2: (Happy) Jim Gould HEB2(t) Brad Idol	530 493-1779 Happy Hard line	July Complex TFR	118.1250					699RH	Happy	K-Max	1	I/A with crew
Cave Helibase Scott Helibase	541 592-2034 530-468-129	Medical AIR/GRD CALCORD	Rx:156.7 Tx:156.7									Moving to Scott HB

9. HELICOPTERS (Use Additional Sheets As Necessary)

FAA N#	TY	MAKE/MODEL	BASE	AVAIL	START	REMARKS	FAA N#	TY	MAKE/MODEL	BASE	AVAIL	START	REMARKS
H-503	3	Bell 407	Happy Camp	0730	0700	I/A with crew	184CH	1	Columbia 107	Cave	0800	0730	Bucket
911CV	3	Astar	Cave	0800	0730		HT-783	1	S-64	Cave	0800	0730	Tanked
7HE	3	Astar B3	Scott HB	0800	0730	Recon/Litter/PSD	HT-746	1	S-64	Cave	0800	0730	Tanked
H-510	2	Bell 205	Cave	0800	0730		HT-743	1	S-64	Cave	0800	0730	Tanked
H-516	2	Bell 212	Cave	0800	0730	I/A with crew	699RH	1	K-Max	Happy	0730	0700	Bucket
H-522	2	Bell 205	Cave	0800	0730	Moving to Scott HB							

10. TASK/MISSION/ASSIGNMENT (Type/Function includes: Air Tactical, Retardant, Recon, Personnel Transport, Water Dropping, S&R, etc.)

TYPE/FUNCTION	NAME OF PERSONNEL OR CARGO (if applic) OR INSTRUCTIONS FOR TACTICAL AIRCRAFT	MISSION START	FLY FROM	FLY TO
Bucket drops per request	Division Sup. To request and coordinate. Also Air Assets to record where their drops were and amount of Water/Retardant used.			
Recon Flights	To be approved by OPS or AOBD			
Cargo / Sling	Per Request from Div Sups, all sling loads / crew shuttles			
Heliwell	Norcross Heliwell 7000 gallons 41 38.817 123 18.622 Water Tender E266			
	DIPSITES			
	Blue Granite 41 33.960 x 123 18.600			
	Indian 41 53.743N x 123 24.373W			
	Thompson 41 52.589N x 123 19.192W			
	Nine Six 41 51.651N x 123 18.447W			
	Ranch 41 52.435N x 123 25.053W			
	Russel 41 52.24N x 123 24.52W			
	Elk 41 46.88N x 123 23.657W			
	Wire 41 48.43N x 123 21.75W			
	Ukonom Lake 41 34.818N x 123 .402			
	Seiad MRB 41 50.035 x 123 11.708			

INCIDENT RADIO COMMUNICATIONS PLAN		Incident Name		Happy Camp Complex		Date/Time Prepared		8/31/2014 @ 2030		Operational Period Date/Time		09/01/14 to 9/02/14		
Zn Ch	Function	Channel Name/Trunked Talkgroup	Assignment	RX Freq	RX Tone/NAC	IX Freq	Tx Tone/NAC	Dev	Pwr	Mode A, D, M	Remarks			
Zn15 Ch1	COMMAND	CMD 1	ALL DIVISIONS	173.0625	Tone 10 407.2	167.9625	Tone 10 407.2	N	L	A	ALL CMD'S LINKED TOGETHER			
Zn15 Ch2	COMMAND	CMD 2	ALL DIVISIONS	168.7000	Tone 10 407.2	170.9750	Tone 10 407.2	N	L	A	ALL CMD'S LINKED TOGETHER			
Zn15 Ch3	COMMAND	CMD 3	ALL DIVISIONS	169.5375	Tone 10 407.2	164.7125	Tone 10 407.2	N	L	A	ALL CMD'S LINKED TOGETHER			
Zn15 Ch4	COMMAND	CMD 4	ALL DIVISIONS	172.5500	Tone 10 407.2	163.8250	Tone 10 407.2	N	L	A	ALL CMD'S LINKED TOGETHER			
Zn15 Ch5	TACTICAL	NIFC T-1	96 STRUCTURE	168.0500	Tone 10 107.2	SIMPLEX	Tone 10 107.2	N	L	A				
Zn15 Ch6	TACTICAL	NIFC T-3	DIV K/L & D/F	168.6000	Tone 10 107.2	SIMPLEX	Tone 10 107.2	N	L	A				
Zn15 Ch7	TACTICAL	NIFC T-5	DIV M/N & STAGING GRP	166.7250	Tone 10 107.2	SIMPLEX	Tone 10 107.2	N	L	A	NIGHT K/L M/N R/S			
Zn15 Ch8	TACTICAL	NIFC T-6	DIV A/C & S	166.7750	Tone 10 107.2	SIMPLEX	Tone 10 107.2	N	L	A	**RIVER TRAFFIC**			
Zn15 Ch9	TACTICAL	NIFC T-7	DIV Q/T/Z, & SCOTT RVR STRUCT	168.2500	Tone 10 107.2	SIMPLEX	Tone 10 107.2	N	L	A				
Zn15 Ch10	TACTICAL	R5 TAC4	DIV H & R	166.5500	Tone 10 107.2	SIMPLEX	Tone 10 107.2	N	L	A				
Zn15 Ch11	TACTICAL	R5 TAC5	DIV J	167.1125	Tone 10 407.2	SIMPLEX	Tone 10 407.2	N	L	A				
Zn15 Ch12	TACTICAL	R5 TAC6	DIV O,G & CONTINGENCY	168.2375	Tone 10 107.2	SIMPLEX	Tone 10 107.2	N	L	A	NIGHT DIV O/Q/T/Z			
Zn15 Ch13	AIR TO GROUND	A/G-TAC	ALL DIVISIONS	166.6750	CSQ	SIMPLEX	NONE	N	L	A				
Zn15 Ch14	AIR TO GROUND	A/G-CMD	OVERHEAD	169.1500	CSQ	SIMPLEX	NONE	N	L	A				
Zn15 Ch15	MEDICAL TAC	CALCORD	ALL DIVISIONS	156.0750	CSQ	SIMPLEX	Tone 6 156.7	N	H	A	AS NEEDED FOR MEDIVAC			
Zn15 Ch16	AIR GUARD	AIR GUARD	ALL DIVISIONS	168.6250	CSQ	SIMPLEX	Tone 1 140.9	N	L	A				
Prepared By (Communications Unit Leader)												Incident Location: KLAMATH NATIONAL FOREST - HAPPY CAMP, CA	Latitude	Longitude
KEVIN HARPER COML(661) 330-0209 JEFF TONG COML (406)580-0408				Cnty: SISKIYOU										

CPX

MEDICAL PLAN	1. INCIDENT NAME Happy Camp Complex	2. DATE PREPARED 8/31/14	3. TIME PREPARED 2000	4. OPERATIONAL PERIOD 9-1 to 9-2/2014 0600-0600
5. INCIDENT MEDICAL AID STATIONS				
MEDICAL AID STATIONS		LOCATION		PARAMEDIC YES NO
Frontline Medical		Zone 1 Happy Camp, Camp		X
Frontline Medical		Zone 2 Horse Creek Camps		X
Frontline Medical		Zone 2 Horse Creek Camp		X
TRANSPORTATION				
A. Air Ambulances				
NAME		ADDRESS		PHONE PARAMEDIC YES NO
Mercy Flights (Until 2400, No Hoist)		Medford, Oregon		(530) 842-3515 X
Kern County 408 (NVG, Hoist)		Medford, Oregon		(530) 842-3515 X
CHP H-14 (NVG, Hoist)		Redding Airport		(530) 842-3515 X
B. Ground Ambulances				
Arcata Ambulance		Happy Camp Zone 1		Communications X
Hoopa Ambulance		Ft Jones, Zone 2		Communications X
Happy Camp Ambulance		Horse Creek, Camp, Zone 2		Communications X
7. HOSPITALS				
NAME		ADDRESS		TRAVEL TIME AIR GRND
Fairchild MC		444 Bruce St. Yreka, CA. N. 41 43.13 W 122 38.69		20m 1 hr (530) 841-6292 X
Mercy MC (Level 3 Trauma)		914 Pine St. Mt. Shasta, CA. N. 40 34.14 W. 122 23.97		45m 2.0 hr (530) 926-9360 X
Rogue Valley MC (Level 2 Trauma)		2825 Barnett Rd. Medford, OR. N. 42 19.092 W. 122 49.833		30m 1.5 hr (541) 789-7100 X
Providence Medford MC Level 2 Trauma		1111 Crater Lake Ave. Medford OR N 42 20.330 W 122 51.766		30m 1.5 hr (541) 732-6440 X
UC Davis Med Center Level 1 Trauma		2315 Stockton Blvd. Sacramento, CA N. 38 33.3 W. 121 27.3		2hr 6.0 hr (916) 734-3636 Burn Center (916) 734-3790 ER X X
8. MEDICAL EMERGENCY PROCEDURES				
<p>In the event of a medical emergency, provide the following information to your DIVS or Happy Camp Communications on Command Net.</p> <ol style="list-style-type: none"> 1. Declare the nature of the emergency. <ol style="list-style-type: none"> a. Medical injury/illness? b. Is injury/illness life threatening? 2. If life threatening, then request that the designated frequency be cleared for emergency traffic. 3. Identify the on-scene Point of Contact (POC) by resource and last name (i.e POC is TFLD Smith). 4. Identify nature of incident, number injured, patient assessment(s) and location (geographic and GPS coordinates). 5. Identify on-scene medical personnel by position and name (i.e EMT Jones). 6. Identify preferred method of patient transport. 7. Request any additional resources and/or equipment needed 8. Document all information received and transmitted on the radio or phone. 9. Identify any changes in the on-scene POC or medical personnel as they occur. 			<p><u>INJURY REPORTING PROCEDURES</u></p> <p>Nature Of Injury _____ # of Patients _____</p> <p>Transportation Needed: Air _____ REM _____ Ground _____</p> <p>Lat _____ Long _____</p> <p>Elevation _____ Estimated Air Temp _____</p> <p>Specific Hazards In Area to Aircraft _____</p> <p>Patient Unit ID _____</p> <p style="text-align:center;">(REMINDER: DO NOT GIVE PT NAME OVER RADIO)</p> <p>Are Medical Personnel With Patient: Yes _____ No _____</p> <p>Age _____ Sex: Male _____ Female _____</p> <p>ALL EMERGENCIES---Secure the area and identify witnesses for later investigation. Keep an accurate log of events.</p> <p><u>Zone 1 Medical Unit Leader (916) 591-8802, Office (530) 493-1506</u> <u>Zone 2 Medical Unit Leader (916) 215-2732</u></p>	
ICS 206 8-78	9. PREPARED BY (MEDICAL UNIT LEADER) Scott McKenney, MEDL	10. REVIEWED BY (SAFETY OFFICER) Bob Moore, SOF1		

Medical Information	TOPIC:	CALIFORNIA INCIDENT RESPONSE TEAM	
	GETTING HELP DURING A MEDICAL EMERGENCY		
Incident Aid Stations & Medical Teams Assignments for September 1, 2014			
Name	Location	Paramedic Yes	No
Happy Camp (Front Line Medical)	Zone 1 Happy Camp (Camp)	X	
Horse Creek Camp (Front Line Medical)	Zone 2 Horse Creek Camp	X	
Fort Jones Camp (Front Line Medical)	Zone 2 Fort Jones Camp	X	
Arcata Ambulance	Staged at Happy Camp	X	
Happy Camp Ambulance	Staged at Horse Creek Camp	X	
Hoopa Ambulance	Staged at Fort Jones Camp	X	
Zone 1 REM1	Assigned by OPS in Happy Camp area		X
Zone 2 REM2	Assigned by OPS in Scott Valley area		X
Zone 2 REM3	Assigned by OPS in Seiad area Highway 96		X
Div. A /C FEMT Coleman,			
Div. D / F FEMP Wallace, FEMP Salvestrin	In Division Moved as Directed by Div or Safety	X	
Div. G FEMP Coyle, Ford	In Division Moved as Directed by Div or Safety	X	
Div. H FEMP White, Williams	In Division Moved as Directed by Div or Safety	X	
Div. O FEMT Roe, Richards	In Division Moved as Directed by Div or Safety	X	
Div. Q/T/Z FEMP Palmer	In Division Moved as Directed by Div or Safety	X	
Div. J FEMP Schroth,	In Division Moved as Directed by Div or Safety	X	
Div. K/L FEMP Gilbert, FEMP Gilardi	In Division Moved as Directed by Div or Safety	X	
Div. M/N FEMP Lasieur, FEMT Mazaika	In Division Moved as Directed by Div or Safety	X	
Div. R FEMP Cubak, FEMP Fitzgerald	In Division Moved as Directed by Div or Safety	X	
Div. S FEMP Barker, FEMT Slocum	As Directed by Group Sup or Safety	X	
Hwy 96 Structure Group FEMP Lawler	As Directed by Group Sup or Safety	X	
NIGHT SHIFT			
Div D/F FEMP Wilson, Marson	In Division Moved as Directed by Div or Safety	X	
Div O/Q/T/Z FEMP Criner	In Division Moved as Directed by Div or Safety		X
Scott River Grp FEMP Duran, FEMP, Fisher, FEMP Hughes	As Directed by Operations	X	

Medical Pre-Incident Planning:

- Identify EMTs and Equipment imbedded in suppression recourses.
- Review the Incident or Forest Emergency reporting procedures
- Review the Incident's assigned Medical resources and their location. (note radio call sign)
- Assure that all assigned supervisors have reviewed and understand the Medical Plan. (if none is available develop a quick plan before engaging)

Arriving at work site:

- Assess access and egress for medical ground units.
- Assure that all resources can clearly articulate their location. (update as they move)
- GPS potential Drop Points or Landing Zones.
- Note weather changes and check on availability of air resources.
- Pre-Position medical supplies

During Response to a Medical Emergency:

- Contact Communications and declare a **MEDICAL EMERGENCY!!**
- Identify the Unit needing help and their location
- Insure that LCES are maintained.
- Obtain patient info and severity.
- Develop a resource list
 - Initial care
 - Sustained care
 - Extrication/evacuation
- Report the Emergency and request anticipated resources needs
- Put two plans in place and start both plans clearly identifying the primary and backup plan to resources assigned.
- During the Evacuation (every 15 min.)**
- Reassess the treatment and the patient response (Are they getting better?) Do you have the right level of care?
- Assess the evacuation plans progress and adjust as needed.
- Assure that additional personnel are available for relief.
- Up-date Comm/Disp of the progress of the rescue.

Human Resource Message
Happy Camp Complex

Personality Factors in Emergency Personnel...

Research indicates that emergency personnel have different personalities from the average person who has a less risky or demanding job.

Emergency personnel are more interested in details than people from other professions.

They take pride in doing a perfect job, set personal standards that are extremely high, and become frustrated when they fail. This attention to detail helps them do a better job, but it also sets them up for the stress associated with a failure to achieve high expectations.

They are action oriented. They are quick decision makers under pressure and task oriented. They seek immediate results and are easily bored.

Risk taking behaviors accompany action orientation in their personalities. They often seek sports activities that are highly stimulating and exciting because they are easily bored and need something to keep them alert.

They have an extreme sense of dedication.

They have a strong need to be liked by the people around them.

They have a difficult time expressing their emotions and are more prone to experiencing delayed stress responses and the effects of cumulative stress.

Consider your own personality, some of these traits may or may not fit...

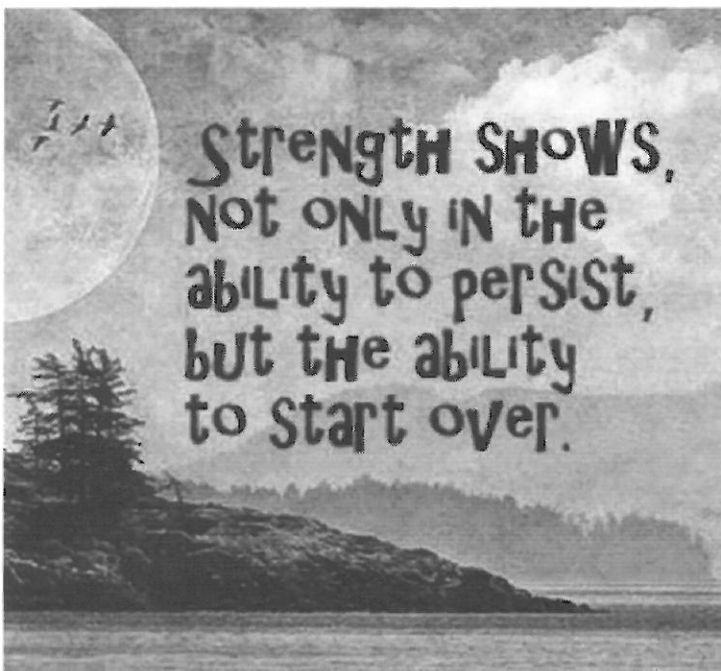

Janine Summy, California
Incident Management Team #3,
509-429-1206



TRAINING SPECIALIST MESSAGE

- ❖ **A TNSP WILL BE AVAILABLE FOR TRAINEE REGISTRATION DAILY AT BASE CAMP FROM 0530-0730 AND FROM 1700-1900.**

- ❖ **A TNSP WILL BE AVAILABLE AT THE FORT JONES ICP FROM 0800-2130 DAILY.**

- ❖ **ALL TRAINEES MUST CLOSE OUT THEIR TRAINING PACKAGE AT THE FORT JONES ICP.**

Resource Guidelines for Fire Suppression

1. Heavy Equipment and Machine Fire Lines

- Avoid using heavy equipment on slopes > 35%. If machine line is absolutely necessary on slopes > 35%, use an excavator and/or feller buncher – not a dozer.
- Do not build machine line within 300 feet of live streams – use hand line within 300 feet of streams.
- An excavator and/or feller buncher are the preferred pieces of heavy equipment if machine line is necessary – dozers are not preferred.
- Limit the depth and width of machine lines to that necessary to stop fire spread. Smaller is better than bigger.
- After use, recontour all machine lines, seed and fertilize with appropriate seed mixes, cover the recontoured lines with abundant slash; and mulch with weed free straw where prescribed.

2. Hand Lines

- Size and location consistent with Minimum Impact Suppression Tactics.
- Avoid using stream bottoms as improved or constructed control points. If needed, consult with the resource advisor to minimize impacts to streams.
- Tactical ignition of riparian areas is preferred over digging hand line in riparian areas or across streams.
- After use, recontour all hand line within 300 feet of streams and throw slash on the recontoured line. If possible, recontour all hand line regardless of location. At a minimum, waterbar all hand line outside of 300 feet using Forest specifications.

3. Retardants, Foams, and Surfactants

- Do not apply retardant within 300 feet of water bodies.
- Notify Forest dispatch immediately in the event of an accidental retardant application to water bodies
- Do not pump directly from streams if chemical products are to be injected into the system. If chemicals are used, pump from a fold-a-tank located at least 300 feet from water.
- Do not back flush pumps and charged hoses into streams and lakes.

4. Fuel Spills

- Store fuels at least 300 feet from water bodies.
- Apply spill prevention and containment measures on all pumps.
- Develop a HAZMAT Plan for all refueling/fuel storage areas. Have HAZMAT materials and trained personnel at these locations at all times.

5. Camp, Helibase, Helispot & Medivac Locations

- Helispot & pre-positioned medivac locations must be pre-authorized by Resource Advisor.
- Avoid locating camps and helibases within 300 feet of water bodies. If no other options exist, camps and helibases can be located within 300 feet of water bodies on a case-by-case basis if approved by the resource advisor.
- Use portable toilets at camps whenever possible. Latrines can be used temporarily or for small camps and will be located at least 300 feet from water sources.
- Spike camp locations, along with numbers of people staged & duration of use, must be pre-authorized by Resource Advisor.

6. Water Drafting and Helicopter Dipping

- Intakes on all pumps must be screened with mesh less than or equal to a 3/36th inch pore size.
- Install spill containment devices on all pumps.

- In non-emergency situations, do not dip from streams unless authorized by the resource advisor. Pump water into heli-wells or other portable tanks instead of dipping from streams. Dipping from lakes and ponds may be OK if authorized by the Resource Advisor.
- Helicopter dipping should be done only after chemical injection systems have been removed, disconnected, or rinsed clean.
- Make sure that all intake structures are clean and dry of mud and vegetation before placing them into water bodies.

7. Noxious Weeds and Aquatic Nuisance Species

- All vehicles mobilizing onto the fire and demobilizing from the fire must go through the weed wash station.
- Locate helibases in weed-free areas. If flowering weeds are present at helibases, they should be mowed and removed to an area where they cannot attach to gear.
- Inspect helicopter cargo nets to ensure that they are free of seeds and plant debris.
- Brush all seeds and plant debris off of your line gear before exiting the fire.
- Before placing it in water, ensure that all firefighting equipment (i.e. helicopter buckets, screens on pump intakes, hoses, etc) is clean of all dirt and plant debris, and dry.

8. Snags

- When snagging roadsides, retain the larger snags that are leaning away from the road.
- Do not cut down cambium-peeled trees.
- When possible, roll logs out of road/fireline instead of bucking.

9. Brushing and Fuel Breaks

- Maintain as many green trees and variety of size classes as possible – try to leave the brushed area as visually appealing as possible.
- Flush cut all stumps. Dispose of the cookies where they are not visible from the road or trail.
- When possible, roll logs out of roads whole instead of bucking.
- If chipping occurs, spray the chips across as wide an area as possible. Do not create beds of chips deeper than a couple of inches.

Last Work Day Report

Incident: HAPPY CAMP COMPLEX CA-KNF-005956

09/01/2014 - 09/03/2014

9/1/2014

CREWS

HC2	C-79	CREW-T2-BIG HORN
HC1	C-106	CREW-T1-INYO IHC
HC1	C-123	CREW-T1-PLUMAS IHC
HC1	C-2009	CREW-T1-REDDING IHC

EQUIPMENT

WTT2	E-104	WT-T2-DARRAH
DOZ1	E-227	DZ-T1-MOODY
ENG6	E-193	ENG-T6-MOUNT ADAMS
ENG6	E-194	ENG-T6-CB FIRE TECH

OVERHEAD

RCDM	O-29	HARTMAN, RALPH E
HECM	O-129	WHITE, DANIEL GARY
SOFR	O-189	WELBOURN, DOUGLAS RANKIN
COMT	O-218	CORBIN, DAVID
IMET	O-219	TONKIN, JEFF
SEC2	O-223	BRAZZEL, ALBERT
SEC1	O-246	SMITH, TORRY
FOBS	O-247	LATTIMORE, DAVID
FOBS	O-250	PERRINE, NATHAN PHILLIP
HLCO	O-136	ALVAREZ, ROBERT
SEC1	O-221	LEGLER, TRAVIS A
FOBS	O-251	HECKER JR, JOHN P
FEMP	O-264	WALLACE, STEVEN
FEMP	O-265	LESIEUR, TODD
FEMP	O-267	BARKER JASON,
FEMT	O-268	SLOCUM, JEREMY
FEMT	O-270	MAZAICA, DAVID
STEN	O-238	JONES, JAMES
SEC2	O-273	MAKOWSKI, PAIGE
SEC2	O-274	BELANGER, DANIEL
READ	O-321	BOUSFIELD, GREGG
CTSP	O-318	SHELTON, WILLIAM
GSUL	O-363	COCKMAN, JONEEN
SEC2	O-391	SAVERY, THERESA A S
FEMT	O-394	ROE, JEFFREY
FEMT	O-395	RICHARDS, DUSTIN
CULS	O-513	TRIPP, WILLIAM A

9/2/2014

CREWS

HC1	C-97	CREW-T1-FEATHER RIVER IHC
HC1	C-88	CREW-T1-IDAHO CITY IHC
HC2	C-103	CREW-T2IA-HAPPY CAMP CREW
HC2	C-99	CREW-T2-DIAMOND FIRE
HC1	C-107	CREW-T1-LAGUNA IHC
HC2	C-124	CREW-T2-OC 24
HC1	C-129	CREW-T1-SMITH RIVER IHC
HC2	C-2004	CREW-T2IA-ZEPHYR
HC1	C-2006	CREW-T1-SALMON RIVER IHC

EQUIPMENT

Last Work Day Report

Incident: HAPPY CAMP COMPLEX CA-KNF-005956
09/01/2014 - 09/03/2014

WTS2	E-34	WT-T2-ZABEL
ENG6	E-207	ENG-T6-FWF-CHEMULT 642
DOZ2	E-253	DZ-T2-PETERS-D7
DOZ2	E-252	DZ-T2-PETERS-D6
ENG3	E-249	ENG - T3 - RANCHERIA 2
STK	E-239	STAKESIDE - T2 - J & D FIRE
STK	E-240	STAKESIDE T1 - PHILLIP INDIHAR
WTS2	E-263	WT-T2-YREKA OUTLANDS
WTS2	E-266	WT-T2- CATTLE RANCH
WTS2	E-267	WT-T2-DOLCINI DAIRY
WTS2	E-268	WTS-T2-HARRIS EMS
BUS	E-2075	TRANSPORTATION BUS CREW CARRIE

OVERHEAD

STCR	O-121	PARRY, JESSE
FOBS	O-248	LUEPKE, JONATHAN DAVID
TFLD	O-315	BRADLEY, TIM
TFLD	O-316	BUTTERFIELD, EZRA NATHANIEL
EQTR	O-295	CAMACHO, CHRISTIE
SEC1	O-275	MCDONALD, MATTHEW
LOFR	O-306	RAMSEY, BRIAN
PIOF	O-319	RODRIGUEZ, JACOB
FELB	O-313	SEE, BRIAN
FELB	O-314	WARD, JOHN L
ARCH	O-285	GRATE JR, ROBERT DELOS
FOBS	O-341	SAVAGE, JAMES
HEQB	O-331	RESER, GREGORY
FALC	O-384	MODULE-FALLER-PRO PLUS FALLERS
FEMT	O-396	WILSON, TIM
SEC1	O-383	RIGGIN, CHAD
SEC2	O-399	MADARA-YAGLA, AMYANN L
FOBS	O-413	KUDO, KAY K
FOBS	O-414	EPP, TIMOTHY LEE

9/3/2014

CREWS

HC2	C-100	CREW-T2-MILLER TIMBER 15
HC2	C-101	CREW-T2-MILLER TIMBER

EQUIPMENT

WTS2	E-35	WT-T2-CJ FIRE
ENG3	E-251	ENG - T3 - INF 32
ENG3	E-248	ENG - T3 - 3639
WTS2	E-265	WT-T2-ALLIED WATER
ENG3	E-284	ENG-T3- KNF-E77
ENG6	E-297	ENG-T6-CNF E533

OVERHEAD

DIVS	O-72	GARNER, TERRY J
SOFR	O-115	PINGICZER, FRANK
STPS	O-173.24	IMT - LAWRENCE, PETE
READ	O-253	FARMER, JASON
PTRC	O-289	ATTLA, PHYLLIS M
EQPM	O-298	BOND, ROY
STEN	O-239	DONNELLY, MATTHEW T

Last Work Day Report

Incident: **HAPPY CAMP COMPLEX CA-KNF-005956**
09/01/2014 - 09/03/2014

SOFR	O-309	GEARHART, RICHARD L
SOFR	O-308	GRUBBS, LAWRENCE WILLIAM
SOFR	O-310	HENDERSON, JEFFERY A
EQPM	O-299	METTS, LEON
TIME	O-293	OBRIEN, KEVIN M
READ	O-272	MCFADIN, MICHAEL C
PTRC	O-290	IVEY, DEBRA ALENE
TFLD	O-328	DONNELLY, MATTHEW T
TFLD	O-329	TILZEY, DAN
ARCH	O-347	BARFUSS, WILLIAM
DMOB	O-351	OLSON, MARGARET M
FEMP	O-359	SCHROTH, ERIC
TFLD	O-327	MARKASON, STEVE
FALC	O-385	MODULE-FALLER-NORTH ZONE FALLE
FALC	O-386	MODULE-FALLER-NORTH ZONE FALLE
FALC	O-387	MODULE-FALLER-NORTH ZONE FALLE
FDUL	O-411	LOWE, JAMES
RADO	O-436	MCCULLOCH, SUSAN
BCMG	O-2085	RYON, SHAUN
PIO1	O-2094	SCHMITT, DAVE
TFLD	O-2108	MORRIS, RICHARD J

FORT JONES ICP

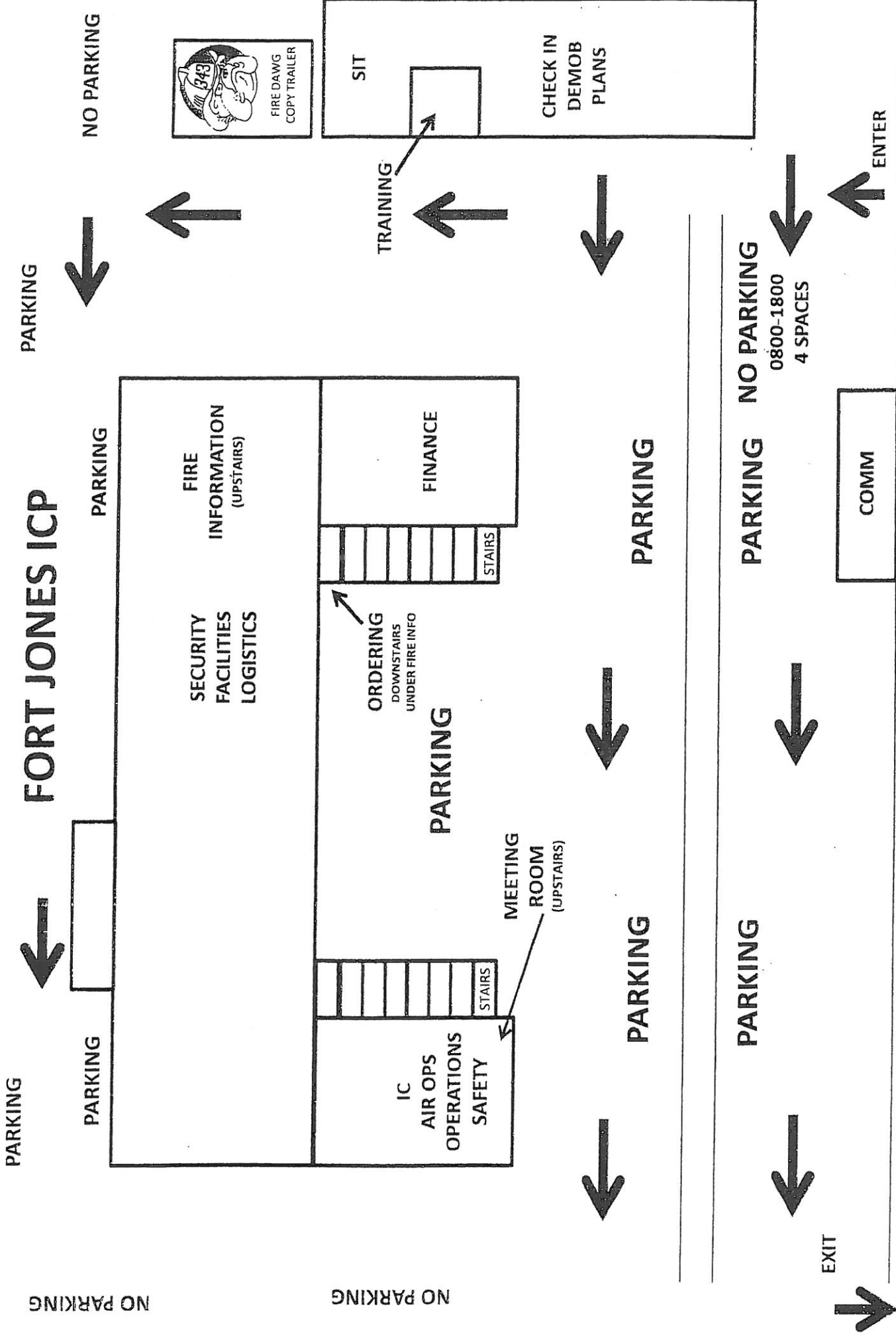

NO PARKING

NO PARKING

NO PARKING

NO PARKING

NO PARKING

HIGHWAY 3

EXIT

COMM

ENTER

PARKING NO PARKING

0800-1800
4 SPACES

PARKING

PARKING

PARKING

NO PARKING

PARKING



CREW/ENGINE SLEEPING

CREW/ENGINE SLEEPING

DAY SLEEPING

OVERHEAD SLEEPING

CREW/ENGINE SLEEPING OVERFLOW

Medical
Shower
Laundry

BRIEFING / KITCHEN

Lunches
Drinks

SUPPLY

Security

Security

NO PARKING OR CAMPING

Fuel

COMM

HR

Ground Support

Weed Wash

TRANSPORTS BUSES CONTRACTORS

ONE WAY TRAFFIC

Scott River Road

To Ft. Jones - 5 miles

