



INCIDENT ACTION PLAN



PNF BECKWOURTH COMPLEX

CA-PNF-1064
P5N4MK (0511)

SATURDAY / SUNDAY

July 17 – 18, 2021

DAY OPERATIONAL PERIOD

0600 HOURS – 1800 HOURS

NIGHT OPERATIONAL PERIOD

1800 HOURS – 0600 HOURS



IAPS/MAPS

This page left intentionally blank

INCIDENT OBJECTIVES (ICS 202)

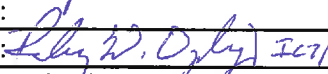
1. Incident Name:		2. Operational Period	
PNF - BECKWOURTH COMPLEX		Date/Time From: 7/17/2021 0600 SAT	Date/Time To: 7/18/2021 0600 SUN
3. Objective(s):			
<u>Management Objectives:</u>			
<ul style="list-style-type: none"> · Provide for the safety of all responders and the public by utilizing national Risk Management Standards. · Reduce firefighter exposure by engaging fire operations with the highest probability of success. · Engage cooperators and stakeholders to jointly provide priorities for the defense of communities, infrastructure and economic interests. · Utilize resource specialists to identify and protect sensitive sites and cultural resource values by minimizing impacts from suppression operations. · Maintain and enhance relationships between local residents, stakeholders, County, State and Federal agencies through accurate and timely dissemination of information. · Follow identified standard procedures to minimize the spread of COVID-19 to all personnel of the incident. · Keep cost commensurate with the values at risk. 			
<u>Control Objectives:</u>			
<ul style="list-style-type: none"> · Keep fire north of highway 70. · Keep fire south of Ferris Flat Road, and Plumas Sierra KV powerline. · Keep fire west of Lassen and Washoe county boundary. · Keep fire east of Beckwourth Genesee Road, Dixie Valley Road, and Beckwourth Milford Road. 			
4. Operational Period Command Emphasis:			
Stay the course.			
General Situational Awareness:			
The ability of a group of people to do remarkable things hinges on how well those people can pull together as a team.			
5. Site Safety Plan Required?		Yes <input type="checkbox"/>	No <input checked="" type="checkbox"/>
Approved Site Safety Plan(s) Located at:			
6. Incident Action Plan		(the items checked below are included in thi Incident Action Plan):	
<input checked="" type="checkbox"/> ICS 202	<input checked="" type="checkbox"/> Map/Chart	<input type="checkbox"/>	
<input checked="" type="checkbox"/> ICS 203	<input checked="" type="checkbox"/> Weather Forecast/Tide/Currents	<input type="checkbox"/>	
<input checked="" type="checkbox"/> ICS 204	<input checked="" type="checkbox"/> COVID-19 Protocols	<input type="checkbox"/>	
<input checked="" type="checkbox"/> ICS 205	<input checked="" type="checkbox"/> TENTATIVE DMOB LIST	<input type="checkbox"/>	
<input checked="" type="checkbox"/> ICS 206	<input checked="" type="checkbox"/> OTHER ATTACHMENTS	<input type="checkbox"/>	
<input checked="" type="checkbox"/> ICS 220			
7. Prepared by: Joe Scuri		Position/Title: PSC2 (T)	Signature: 
		Position/Title:	Signature:
8. Approved by Incident Commander:		Name: Rocky W. Opliger	Signature: 
ICS 202		IAP Page 1 of 1	Date/Time: 7/16/2021 2200 hrs

ORGANIZATION ASSIGNMENT LIST	
1. Incident Name PNF – Beckwouth Complex	
2. Date Prepared 07/16/2021	3. Time 2200
4. Operational Period: July 17, 2021 0600 to July 18, 2021 0600	
Position	Name
5. Incident Commander and Staff	
Incident Commanders	Rocky W. Opliger
Deputy IC	Jaime Gamboa
Safety Officer	Dan Snow / Michael Alforque / Liz Younger Curt Schwarm (Doyle Camp)
Information Officer	Michael Ferris / Phyllis Ashmead Lisa Cox (Doyle Camp) / Melanie Banton (Doyle Camp)
Liaison	Allen Johnson / Barbara Drake (T) Scott Lucas (T) / Heather Noel (T)
6. Agency Representatives	
Agency	Name
USFS PNF AA	Chris Carlton
USFS Covid 19 Advisor	Francisco Rico / Allison Sanger
BLM AA	Ken Collum, CCD / Emily Ryan, NOD
BLM NOD	Grant Gifford
CALFIRE	Eric Ewing
Plumas County Sheriff	Chad Hermann
CHP	Erik Egide
CAL OES	Kit Bailey
CCC	Araceli Loayza
7. Planning Section	
Chief	Joe Scuri (T) / Tom Reaves (Doyle Camp)
Resources Unit	Mike Vetti / Shawn Steiner (T) Kelly Mosinski Logan Brown / Gina Bald
Situation Unit	Damian Guilliani (Doyle Camp) / John Hamer Tad Morelock / Ray Rook (T) / James Milligan (T)
FBAN	Diendray Wiley
IMET	Dan Harty
ITSS	James Whiteside / Tony Yang Gabriel Marquez
GISS	Matthew Eister / Chris Barrett Travis Coughlin / Samantha Dinar (T) Naomi Chow (T)
LTAN	Rob Scott (T)
Training Specialist	Emil Picchi
THSP - Air	Ariane Sarzotti
HRSP	Andrea Cabida / Ben Wexler (T)
Documentation	Johanna Ostling
READ	Jake Marfin
DMOB	Mike Melton / Brian Talbott (T)
DPRO	Ryan Toby
8. Logistics Section	
Chief	Cheryl Raines / Jennifer Wells (T)
Communications Unit	Sal Bonilla Jr. / Tim Maguire
Medical Unit	Eric Williams / Doug Stewart
Food Unit	Jan Palecek / Mitch Stiles (Doyle Camp)
Facilities Unit	Aron Levin
Supply Unit	Jennifer Armstrong
Ground Support	Ron Brewer / Jeff Burch

9. Operations Section	
Day Operations	Kyle Jacobson
Night Operations	Dave Pereira / Steve Burns
Planning Operations	Jake Cagle / Dave Soldavini (T)
a. Branch I (Day)	
Branch Director	Gary Monday / Derek Hoban
Division A	Pat Callahan / Jason Hansen (T)
Division C / E / G	Brad Allen
Division I	Cheveyo Munk
b. Branch IV	
Branch Director	Robert Bertolina / James Lico (T)
Division N	Joseph Reyes
Division R / T	Kevin Marino
c. Branch VII	
Branch Director	Joe Gonzales
Division V	Chris Voelker / Lewis Prevatke (T)
Division X / Z	Kenny Griffith
d. Contingency Branch	
Branch Director	Jay Waiter
Division	Heather Grove / Alan Whisler
e. Branch I (Night)	
Branch Director	Nick Bunch
Division A/C	Antonio Jimenez
Division E / G	Jimmy Hidalgo / Shepley Schroth-Cary
Division I	William Edwards / Robert Kilpatrick (T)
f. Branch IV (Night)	
Branch Director	Drew Graham
Division N	Nathan Suida / Rex Tucker
Division R / T	John Sorensen
g. Branch VII (Night)	
Branch Director	Pat Laeng
Division V/X/Z	Cameron Todd
h. Air Operations Branch	
Branch Director	Joanne Overracker
10. Finance Section	
Finance Section Chief	Judy Reynolds
Time Unit	Sheila Miner / Loni Holt / Mike Turos
Equipment Time	Evelyn Trujillo
Personnel Time	Anna Reiber
Procurement Unit	Craig Ericson
Cost	Vicki Wilson
Comp /Claims	Scott Parsons
Prepared by: Logan Brown - RESL	



INCIDENT Weather Forecast



FORECAST NO: 11
PREDICTION FOR: Sat 0600 – Sun 0600
SHIFT DATE: July 17-18, 2021
FORECAST ISSUED: 1900, July 16, 2021

NAME OF FIRE: Beckwourth Complex
UNIT: Plumas National Forest
Incident Meteorologist: Dan Harty

Dan Harty

WEATHER DISCUSSION: Slightly warmer today but otherwise little change in relative humidity and wind. The typical afternoon breezy to gusty pattern continues with generally light winds through the morning then picking up after the inversion lifts by late morning. While the prevailing flow will remain west southwest, the influences of complex terrain channeling and fire induced in-drafts can create more variable wind directions and speed. The fire is capable of creating its own weather at times and that threat continues with additional fire whirls with strong erratic winds possible. Downsloping flow along the escarpment could bring a period of increased westerly gusts in Branch IV from the late afternoon into the evening. Low temperatures will nudge up from last night but still becoming cool by morning in most areas while thermal belts remain warm and dry.

WEATHER FORECAST for SATURDAY:

Weather obs around fire area



WEATHER: Sunny and dry. Areas of smoke.

TEMPERATURES: Valleys/Lower Slopes: 87-97° Mid-Slopes/Ridges: 83-89°

HUMIDITY: 7-17% **HAINES INDEX: 5 (Moderate potential for large fire growth)**

20 FT WINDS:

RIDGETOP - Southwest 6-12 mph increasing to 10-18 mph by afternoon. Gusts to around 28 mph.

SLOPE/VALLEY - Upslope/upvalley 4-8 mph in the morning, becoming west southwest 8-16 mph with gusts to around 28 mph in the afternoon. Local effects can alter wind flow.

STABILITY/INVERSION: Moderate stability in the morning, inversion around 5800', lifting late morning.

WEATHER FORECAST for SATURDAY NIGHT:

WEATHER: Areas of smoke, otherwise clear and cool.

TEMPERATURES: Valleys/Lower Slopes: 40-60° Mid-Slopes/Ridges: 57-67°
(Warmest along mid-slopes in thermal belt)

HUMIDITY: Valleys/Lower Slopes: 40-55% Mid-Slopes/Ridges: 25-40%
(Lowest along mid-slopes in thermal belt)

20 FT WINDS:

RIDGETOP - Southwest 10-18 mph with gusts to around 28 mph in the early evening, gradually decreasing after sunset to southwest 6-12 mph.

SLOPE/VALLEY - West southwest 8-16 mph with gusts around 28 mph in the early evening diminishing after sunset and transitioning to downslope/downvalley 1-6 mph.

STABILITY/INVERSION: Becoming more stable overnight with inversion developing after midnight.

OUTLOOK for Sunday through Tuesday: Slightly warmer Sunday but clouds will begin moving in during the day as monsoon moisture moves up from the south. There is slight chance of thunderstorms late in the day or evening then the chances increase overnight into Monday. Storms may be dry initially then transition to wet. A lower chance of thunderstorms will remain on Tuesday. Winds will continue to be west southwest with gusty conditions in the afternoon and evening, but complex terrain and fire behavior can result in highly variable wind speeds and direction. Also, any thunderstorm can produce strong and erratic outflow winds.

FIRE BEHAVIOR FORECAST

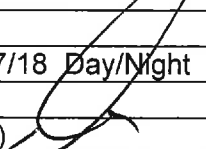
FORECAST NUMBER: 12	TYPE OF FIRE Wildfire
FIRE NAME: Beckwourth Complex	OPERATIONAL PERIOD 07/17-07/18 Day/Night
DATE ISSUED Friday July 16, 2021	TIME ISSUED 1830
UNIT Plumas National Forest	SIGNED Diondray Wiley, FBAN (T) 

INPUTS

WEATHER SUMMARY

WEATHER: Sunny and hot. Areas of smoke.

MAX TEMP: Mid Slope: 83-89° Valleys: 87-97°

Humidity 7-17%

20 FOOT WINDS: Valleys/Slope: upslope 4-8 mph becoming **WSW 8-16 mph G28 mph** in the afternoon.
Ridge Top: **SW 6-12 mph** increasing **10-18 mph by afternoon Gusts to near 28 mph.**

LAL: 1 HAINES INDEX 5 CHANCE OF WETTING RAIN: 0%

FUELS: The major fuel types, found in and around the fire area are timber understory and brush.

Ignition Receptiveness: ERC levels are just below the 97th percentile. **Probability of Ignition** 100%

Dryness: Dead and down fuel moistures: 1 hour – 2% **10 hour–4%**, 100 hour– 6%, and 1000 hour–9%.

FIRE BEHAVIOR

The fire environment remains primed for large fire growth. Even with cooler temps, fuels will not recover. Smoldering interior islands are a potential source of ember cast. Be mindful of rollout in steep terrain (Branch I). Areas with minimal fire activity can increase suddenly with the introduction of strong winds. Watch for re-burn potential.

SPECIFIC FIRE BEHAVIOR:

Branch I

Division A: Minimal fire behavior, interior smoldering.

Division C/E/G: Active fire behavior, flanking fire with potential for uphill movement, in the Ramelli Creek area.

Division I: Minimal activity interior smoldering. SW winds can become compressed and change direction through Frenchman Blvd. Spotting potential.

Branch IV

Division N: Interior smoldering. Meadow view is a wind prone area. Be mindful of increased wind speed. Spotting potential.

Division R/T: Smoldering heavy fuels and islands under windy conditions can spread embers into receptive fuel beds.

Branch VII

Division V: Minimal activity, interior smoldering.

Division X/Z: Minimal activity, interior smoldering.

Night Divisions

Cooler temperatures and low RH in the beginning of the shift. Moderate RH recovery on ridge tops and up to 55% in the valleys. Be mindful of wind shifts and speeds due to topographical features. The shift will start with a Pig of 70-80% diminishing after sunset. Expect fire activity to diminish after 0300. Potential for large fire growth and intensity continues to exist at night.

AIR OPERATIONS

Are you deviating from the assigned operation or flight?

Safety Message

WATCH OUT SITUATIONS: Unfamiliar with weather and local factors influencing fire behavior.

DAY

Division/Group Assignment List (ICS 204 WF)
Controlled Unclassified Information//Basic

1. Incident Name:		3.				
BECKWOURTH COMPLEX		Branch:	Division/Group			
2. Operational Period:		DAY BR I	DIV A			
Date/Time From: 07/17/2021 0600 SAT	Date/Time To: 07/18/2021 0600 SUN					
4. Operations Personnel						
OPERATIONS CHIEF	KYLE JACOBSON	BRANCH DIRECTOR	GARY MONDAY DEREK HOBAN			
DIVISION/GROUP SUPERVISOR	PATRICK CALLAHAN LWD 7/18 JASON HANSEN LWD 7/26 (T)	BRANCH SAFETY				
5. Resources Assigned this Period						
Strike Team / Task Force / Resource Designator	LWD	Leader	Number Persons	Drop Off PT./Time	Pick Up PT./Time	
ENG6 THREE RIVERS 139 E-98	07/19	TOMMY DIAZ	4	ICP/0600	ICP/1800	
EXCA DIAMOND RING RANCH E-222	07/24	JOE BRITTON	2	ICP/0600	ICP/1800	
HEQB O-261	07/25	DAN MARSHALL	1	ICP/0600	ICP/1800	
EMPF O-355	07/20	RONALD SPELLMAN	1	ICP/0600	ICP/1800	
EMPF O-279	07/25	DAN DEYOUNG	1	ICP/0600	ICP/1800	
SOFR O-133	07/25	JEFFREY P BIRG	1	ICP/0600	ICP/1800	
READ O-85	07/20	SETH CHARLES BROWN	1	ICP/0600	ICP/1800	
6. Control Operations/Work Assignments:						
Utilize appropriate suppression techniques to keep the fire within its current containment lines.						
7. Special Instructions:						
SOFR Jeff Birg assigned to Divisions A and C/E/G. The following Field Observers (FOBS) will be in Branch I and Branch IV mapping and collecting intel on all Divisions: FOBS Marco Garcia O-463 FOBS (T) Tim Chow O-433 FOBS (T) Darrick Rossotti O-1.56 FOBS (T) Eric Hooper O-236 FOBS (T) Robert Barron O-235 FOBS Jesse Allread O-464 FOBS (T) Mike Moses O-456						
8. Division/Group Communication Summary						
Function	Channel	RX Frequency N/W	RX Tone/NAC	TX Frequency N/W	TX Tone/NAC	Mode
COMMAND	1	169.7500	CSQ	167.1000	146.2	
COMMAND	2	173.0375	CSQ	167.3250	146.2	
COMMAND	4	171.1125	CSQ	162.1875	146.2	
TACTICAL	6	165.3625	146.2	165.3625	146.2	
AIR TO GROUND	14	169.2875	CSQ	169.2875		
AIR TO GROUND	15	167.0625	CSQ	167.0625		
9. Prepared By (Resource Unit Leader)		Approved By (Planning Section Chief)		Date	Time	
MIKE VETTI		JOE SCURI		07/16/2021	2200	

Division/Group Assignment List (ICS 204 WF)
Controlled Unclassified Information//Basic

1. Incident Name:			3.			
BECKWOURTH COMPLEX			Branch:		Division/Group	
2. Operational Period:			DAY BR I		DIV C / E / G	
Date/Time From: 07/17/2021 0600 SAT	Date/Time To: 07/18/2021 0600 SUN					
4. Operations Personnel						
OPERATIONS CHIEF		KYLE JACOBSON		BRANCH DIRECTOR		GARY MONDAY DEREK HOBAN
DIVISION/GROUP SUPERVISOR		BRAD ALLEN LWD 7/21		BRANCH SAFETY		
5. Resources Assigned this Period						
Strike Team / Task Force / Resource Designator		LWD	Leader	Number Persons	Drop Off PT./Time	Pick Up PT./Time
CRW2 FRANCO REFORESTATION C-35		07/23	LEONARD TOWNSEND	20	ICP/0600	ICP/1800
CRW2 DIAMOND FIRE CREW 12 C-71		07/24	JOSIAH KELDY	20	ICP/0600	ICP/1800
CRW2 R&R CONTRACTING C-89		07/27	ISMAEL RANGEL	20	ICP/0600	ICP/1800
WTS1 NORTH STATE E-79		07/21	WILLIAM GILLETT	1	ICP/0600	ICP/1800
DOZ2 NORTHSTATE E-155		07/23	CARSON METZ	1	ICP/0600	ICP/1800
DOZ3 RIDGE LOGGING E-260		07/24	JAMIE SLACK	1	ICP/0600	ICP/1800
HEQB (T) O-394		07/21	WILLIAM DALE	1	ICP/0600	ICP/1800
HEQB O-260		07/25	FELIX URRUTIA	1	ICP/0600	ICP/1800
FALM O-193		07/23	NORTH ZONE FALLERS	2	ICP/0600	ICP/1800
FALM O-194		07/23	KEENEN SMITH	2	ICP/0600	ICP/1800
6. Control Operations/Work Assignments:						
Construct handline as appropriate. Prepare for tactical firing operations. Prep contingency line along 01 Road to Dixie Valley. Provide structure defense for Dixie Valley.						
7. Special Instructions:						
SOFR Jeff Birg is assigned to Division A and Division C/E/G. The following Field Observers (FOBS) will be in Branch I and Branch IV mapping and collecting intel on all Divisions: FOBS Marco Garcia O-463 FOBS (T) Tim Chow O-433 FOBS (T) Darrick Rossotti O-1.56 FOBS (T) Eric Hooper O-236 FOBS (T) Robert Barron O-235 FOBS Jesse Allread O-464 FOBS (T) Mike Moses O-456						
8. Division/Group Communication Summary						
Function	Channel	RX Frequency N/W	RX Tone/NAC	TX Frequency N/W	TX Tone/NAC	Mode
COMMAND	1	169.7500	CSQ	167.1000	146.2	
COMMAND	2	173.0375	CSQ	167.3250	146.2	
COMMAND	3	169.5375	CSQ	164.7125	146.2	
TACTICAL	7	168.0500	146.2	168.0500	146.2	
AIR TO GROUND	14	169.2875	CSQ	169.2875		
AIR TO GROUND	15	167.0625	CSQ	167.0625		
9. Prepared By (Resource Unit Leader)		Approved By (Planning Section Chief)			Date	Time
MIKE VETTI		JOE SCURI			07/16/2021	2200

Division/Group Assignment List (ICS 204 WF)
Controlled Unclassified Information//Basic

1. Incident Name:			3.			
BECKWOURTH COMPLEX			Branch:		Division/Group	
2. Operational Period:			DAY BR I		DIV I	
Date/Time From: 07/17/2021 0600 SAT	Date/Time To: 07/18/2021 0600 SUN					
4. Operations Personnel						
OPERATIONS CHIEF KYLE JACOBSON		BRANCH DIRECTOR GARY MONDAY DEREK HOBAN				
DIVISION/GROUP SUPERVISOR CHEVEYO MUNK LWD 7/25		BRANCH SAFETY				
5. Resources Assigned this Period						
Strike Team / Task Force / Resource Designator	LWD	Leader	Number Persons	Drop Off PT./Time	Pick Up PT./Time	
CRW1 FULTON IHC C-16	07/18	JOSH S ACOSTA	19	ICP/0600	ICP/1800	
CRW1 SALMON RIVER IHC 4 C-64	07/26	KELSEY LOFDAHL	20	ICP/0600	ICP/1800	
CRW1 BECKWOURTH IHC C-92	07/28	MIKE WINTCH	20	ICP/0600	ICP/1800	
CRW2IA UKONOM C-60	07/23	JOEL BERG	20	ICP/0600	ICP/1800	
CRW2IA GROVELAND 4 C-65	07/20	TIMOTHY MARKIN	18	ICP/0600	ICP/1800	
CRW2IA FOLSOM LAKE C-83	07/25	JASON SCHROEDER	16	ICP/0600	ICP/1800	
CRW2IA ZEPHYR C-10	07/20	MATTHEW FOGARTY	18	ICP/0600	ICP/1800	
CRW2 BIRRUJETA 1 C-31	07/18	ANTONIO BIRRUJETA	20	ICP/0600	ICP/1800	
CRW2 BLUE MOUNTAIN 5 C-48	07/23	ANTONIO LEON	20	ICP/0600	ICP/1800	
ENG3 S/T 4226C E-316	07/25	JOHN MCNAMARA	22	ICP/0600	ICP/1800	
T/F BECKWOURTH 2		DAVID REYNOLDS	43	ICP/0600	ICP/1800	
ENG3 BLM 8337 E-357	07/25	GEORGE JOLICOEUR	5	ICP/0600	ICP/1800	
ENG3 ENGINE 8430 E-425	07/29	ZACH MCGARR	4	ICP/0600	ICP/1800	
ENG3 WFST 316 E-311	07/18	JOEY DEMARTINO	3	ICP/0600	ICP/1800	
ENG3 OMAR GONZALEZ E-358	07/17	OMAR GONZALEZ	3	ICP/0600	ICP/1800	
ENG3 TREASURE VALLEY FIRE E-388	07/27	JOSHUA VLAHOS	3	ICP/0600	ICP/1800	
WTT1 GARDEN VALLEY E-269	07/24	CHARLES FROST	1	ICP/0600	ICP/1800	
WTT1 G&N LLC E-144	07/24	NEAL GALLIGAN	2	ICP/0600	ICP/1800	
8. Division/Group Communication Summary						
Function	Channel	RX Frequency N/W	RX Tone/NAC	TX Frequency N/W	TX Tone/NAC	Mode
COMMAND	1	169.7500	CSQ	167.1000	146.2	
COMMAND	2	173.0375	CSQ	167.3250	146.2	
COMMAND	4	171.1125	CSQ	162.1875	146.2	
TACTICAL	8	168.6000	146.2	168.6000	146.2	
AIR TO GROUND	14	169.2875	CSQ	169.2875		
AIR TO GROUND	15	167.0625	CSQ	167.0625		
9. Prepared By (Resource Unit Leader)		Approved By (Planning Section Chief)		Date		Time
GINA BALD		JOE SCURI		07/16/2021		2200

Division/Group Assignment List (ICS 204 WF)
 Controlled Unclassified Information//Basic

1. Incident Name:			3.			
BECKWOURTH COMPLEX			Branch:		Division/Group	
2. Operational Period:			DAY BR I		DIV I	
Date/Time From: 07/17/2021 0600 SAT	Date/Time To: 07/18/2021 0600 SUN					
4. Operations Personnel						
OPERATIONS CHIEF		KYLE JACOBSON		BRANCH DIRECTOR		
				GARY MONDAY DEREK HOBAN		
DIVISION/GROUP SUPERVISOR		CHEVEYO MUNK LWD 7/25		BRANCH SAFETY		
5. Resources Assigned this Period						
Strike Team / Task Force / Resource Designator	LWD	Leader	Number Persons	Drop Off PT./Time	Pick Up PT./Time	
WTT2 DIETZ E-185	07/24	DAVID RICHARDSON	1	ICP/0600	ICP/1800	
WTS2 FOOTPRINTS FIRE E-92	07/17	TAMMY NOXON	1	ICP/0600	ICP/1800	
DOZ2 PNF1 E-34 **24 HR**	07/29	JAMES SMITH	3	ICP/0600	ICP/1800	
DOZ2 PNF 3 E-51 **24 HR**	07/20	ANDREW SHEPHERD	3	ICP/0600	ICP/1800	
DOZ2 DUNLAP E-28 **24 HR**	07/20	KYLE TROSKY	2	ICP/0600	ICP/1800	
DOZ2 NORTHSTATE E-88	07/21	BRETT RICHARDS	2	ICP/0600	ICP/1800	
DOZ2 2C LAND & TIMBER E-91 **24 HR**	07/21	JUSTIN ROBERTSON	2	ICP/0600	ICP/1800	
DOZ2 NORTHSTATE E-198	07/23	GEORGE POE	1	ICP/0600	ICP/1800	
DOZ2 BRIAN FORKNER E-200	07/23	DARRELL LANDINGHAM	1	ICP/0600	ICP/1800	
DOZ3 BLACK KNIGHT E-156 **24 HR**	07/22	ALEX WUNSCH	2	ICP/0600	ICP/1800	
DOZ3 JUNGWIRTH E-158	07/22	JERRY JUNGWIRTH	2	ICP/0600	ICP/1800	
DOZ3 KITE SOLUTIONS E-159 **24 HR**	07/22	RYAN OLSEN	2	ICP/0600	ICP/1800	
DOZ3 NORTHWESTERN FIRE SUPPORT E-196	07/23	MIKE SALTERS	4	ICP/0600	ICP/1800	
DOZ3 PAUL ROEN E-199 **24 HR**	07/22	PAUL ROEN	2	ICP/0600	ICP/1800	
DOZ3 PAUL ROEN E-218 **24 HR**	07/23	DWIGHT CERESOLA	2	ICP/0600	ICP/1800	
DOZ3 MILE HIGH MILL E-219	07/24	TORIN THOMPSON	3	ICP/0600	ICP/1800	
DOZ3 NORTHWESTERN FIRE SUPPORT E-221	07/23	ALEX REHWALD	4	ICP/0600	ICP/1800	
DOZ3 RIDGE LOGGING E-261	07/24	JASON WALKER	3	ICP/0600	ICP/1800	
6. Division/Group Communication Summary						
Function	Channel	RX Frequency N/W	RX Tone/NAC	TX Frequency N/W	TX Tone/NAC	Mode
COMMAND	1	169.7500	CSQ	167.1000	146.2	
COMMAND	2	173.0375	CSQ	167.3250	146.2	
COMMAND	4	171.1125	CSQ	162.1875	146.2	
TACTICAL	8	168.6000	146.2	168.6000	146.2	
AIR TO GROUND	14	169.2875	CSQ	169.2875		
AIR TO GROUND	15	167.0625	CSQ	167.0625		
9. Prepared By (Resource Unit Leader)		Approved By (Planning Section Chief)		Date	Time	
GINA BALD		JOE SCURI		07/16/2021	2200	

Division/Group Assignment List (ICS 204 WF)
Controlled Unclassified Information//Basic

1. Incident Name:			3.			
BECKWOURTH COMPLEX			Branch:		Division/Group	
2. Operational Period:			DAY BR I		DIV I	
Date/Time From: 07/17/2021 0600 SAT	Date/Time To: 07/18/2021 0600 SUN					
4. Operations Personnel						
OPERATIONS CHIEF		KYLE JACOBSON		BRANCH DIRECTOR		
				GARY MONDAY DEREK HOBAN		
DIVISION/GROUP SUPERVISOR		CHEVEYO MUNK LWD 7/25		BRANCH SAFETY		
5. Resources Assigned this Period						
Strike Team / Task Force / Resource Designator	LWD	Leader	Number Persons	Drop Off PT./Time	Pick Up PT./Time	
DOZ3 DOMINICUS E-263	07/25	ROBERT DOMINICUS	2	ICP/0600	ICP/1800	
DOZ3 MOORE EXCAVATING E-264 **24 HR**	07/24	DILLAN MOORE	2	ICP/0600	ICP/1800	
DOZ3 LONESTAR E-265 **24 HR**	07/24	SEAN COTTEN	2	ICP/0600	ICP/1800	
DIVS O-255	07/22	DANNY WRISTEN	1	ICP/0600	ICP/1800	
TFLD O-49	07/19	KEVIN VALENTIN	1	ICP/0600	ICP/1800	
TFLD (T) O-98	07/21	RICHARD ZINCHUK	1	ICP/0600	ICP/1800	
TFLD (T) O-186	07/25	JAMIE WILLBURN	1	ICP/0600	ICP/1800	
HEQB O-162	07/22	SHAWN L DEASON	1	ICP/0600	ICP/1800	
HEQB O-192	07/23	MIKE C KNIPFEL	1	ICP/0600	ICP/1800	
HEQB O-262	07/24	BRIAN TOROSIAN	1	ICP/0600	ICP/1800	
HEQB (T) O-224	07/23	KYLE J SCHMIDT	1	ICP/0600	ICP/1800	
HEQB (T) O-467	07/20	TENAYA WOOD	1	ICP/0600	ICP/1800	
REMS 2 O-357	07/21	DANNY GIVVIN	4	ICP/0600	ICP/1800	
EMPF O-354	07/20	MIKE STIEHR	1	ICP/0600	ICP/1800	
EMPF O-286	07/25	ADRIAN BAVERY	1	ICP/0600	ICP/1800	
EMPF O-300	07/25	SCOTT VASQUEZ	1	ICP/0600	ICP/1800	
EMPF O-282	07/25	BRANDON BENNEWATE	1	ICP/0600	ICP/1800	
EMPF O-379	07/26	LARRY POLLOCK	1	ICP/0600	ICP/1800	
8. Division/Group Communication Summary						
Function	Channel	RX Frequency N/W	RX Tone/NAC	TX Frequency N/W	TX Tone/NAC	Mode
COMMAND	1	169.7500	CSQ	167.1000	146.2	
COMMAND	2	173.0375	CSQ	167.3250	146.2	
COMMAND	4	171.1125	CSQ	162.1875	146.2	
TACTICAL	8	168.6000	146.2	168.6000	146.2	
AIR TO GROUND	14	169.2875	CSQ	169.2875		
AIR TO GROUND	15	167.0625	CSQ	167.0625		
9. Prepared By (Resource Unit Leader)		Approved By (Planning Section Chief)		Date	Time	
GINA BALD		JOE SCURI		07/16/2021	2200	

Division/Group Assignment List (ICS 204 WF)
Controlled Unclassified Information//Basic

1. Incident Name:			3.			
BECKWOURTH COMPLEX			Branch:		Division/Group	
2. Operational Period:			DAY BR IV		DIV N	
Date/Time From: 07/17/2021 0600 SAT		Date/Time To: 07/18/2021 0600 SUN				
4. Operations Personnel						
OPERATIONS CHIEF KYLE JACOBSON		BRANCH DIRECTOR ROBERT BERTOLINA JAMES LICO (T)				
DIVISION/GROUP SUPERVISOR JOSEPH REYES 7/28		BRANCH SAFETY				
5. Resources Assigned this Period						
Strike Team / Task Force / Resource Designator		LWD	Leader	Number Persons	Drop Off PT./Time	Pick Up PT./Time
CRW2IA MS MSS #1 C-69		07/17	BRYAN WHEELER	19	DOYLE CAMP/0600	DOYLE CAMP/1800
CRW2 LAVA 5 C-32		07/19	TORRES RIGOBERTO	20	DOYLE CAMP/0600	DOYLE CAMP/1800
CRW2 FSE HC C-46		07/19	JEREMY SLIFER	20	DOYLE CAMP/0600	DOYLE CAMP/1800
ENG3 S/T 2140C E-315		07/25	KYLE DAGUE	22	DOYLE CAMP/0600	DOYLE CAMP/1800
ENG6 S/T 2860F E-312		07/27	PABLO SIGUENZA	17	DOYLE CAMP/0600	DOYLE CAMP/1800
ENG3 PNF 334 E-211		07/23	DAVID L MOLTER	5	DOYLE CAMP/0600	DOYLE CAMP/1800
ENG3 TNF 373 E-309		07/25	NADINE A FRETWELL	5	DOYLE CAMP/0600	DOYLE CAMP/1800
ENG3 PNF 13 E-318		07/25	CHRIS ENRIQUEZ	5	DOYLE CAMP/0600	DOYLE CAMP/1800
ENG3 ICEBURNS 29 E-54		07/18	BEN TITUS	3	DOYLE CAMP/0600	DOYLE CAMP/1800
ENG3 MT. ADAMS E-135		07/22	MIKE WILSON	3	DOYLE CAMP/0600	DOYLE CAMP/1800
ENG3 FIRESTORM E-209		07/24	STAN HANKINS	3	DOYLE CAMP/0600	DOYLE CAMP/1800
ENG4 NAT WILDLAND FIRE 432 E-72		07/18	CHUCK MURPHY	3	DOYLE CAMP/0600	DOYLE CAMP/1800
ENG6 ARF 653 E-100		07/18	LINDA AUSTIN	5	DOYLE CAMP/0600	DOYLE CAMP/1800
WTT1 WEST SHORE FD E-238		07/24	MARK MURRAY	2	DOYLE CAMP/0600	DOYLE CAMP/1800
WTT1 LOOKOUT VOL FIRE E-270 **24 HR**		07/23	TOM STANSBERRY	2	DOYLE CAMP/0600	DOYLE CAMP/1800
WTT1 OES 42 E-271		07/24	RODNEY JOHNSON	2	DOYLE CAMP/0600	DOYLE CAMP/1800
WTT1 SIERRA MADRE E-289		07/25	BLAKE SILCOTT	2	DOYLE CAMP/0600	DOYLE CAMP/1800
WTT1 DUST CONTROL E-274		07/26	JACK HAFER	2	DOYLE CAMP/0600	DOYLE CAMP/1800
8. Division/Group Communication Summary						
Function	Channel	RX Frequency N/W	RX Tone/NAC	TX Frequency N/W	TX Tone/NAC	Mode
COMMAND	1	169.7500	CSQ	167.1000	146.2	
COMMAND	2	173.0375	CSQ	167.3250	146.2	
COMMAND	4	171.1125	CSQ	162.1875	146.2	
TACTICAL	6	165.3625	146.2	165.3625	146.2	
AIR TO GROUND	14	169.2875	CSQ	169.2875		
AIR TO GROUND	15	167.0625	CSQ	167.0625		
9. Prepared By (Resource Unit Leader)		Approved By (Planning Section Chief)		Date	Time	
SHAWN STEINER		JOE SCURI		07/16/2021	2200	

Division/Group Assignment List (ICS 204 WF)
Controlled Unclassified Information//Basic

1. Incident Name:		3.	
BECKWOURTH COMPLEX		Branch:	Division/Group
2. Operational Period:		DAY BR IV	DIV N
Date/Time From: 07/17/2021 0600 SAT	Date/Time To: 07/18/2021 0600 SUN		

4. Operations Personnel			
OPERATIONS CHIEF	KYLE JACOBSON	BRANCH DIRECTOR	ROBERT BERTOLINA JAMES LICO (T)
DIVISION/GROUP SUPERVISOR	JOSEPH REYES 7/28	BRANCH SAFETY	

5. Resources Assigned this Period					
Strike Team / Task Force / Resource Designator	LWD	Leader	Number Persons	Drop Off PT./Time	Pick Up PT./Time
WTT2 SQF24 E-29	07/22	ALEXANDRIA BENDER	2	DOYLE CAMP/0600	DOYLE CAMP/1800
WTT2 AURORA 13 E-276	07/26	ROBERT D HENSEL	2	DOYLE CAMP/0600	DOYLE CAMP/1800
WTT2 CARBONDALE E-284	07/26	KARL OLIVER	2	DOYLE CAMP/0600	DOYLE CAMP/1800
WTT2 UTAH FIRE CO E-277	07/26	SHELLEY MONSON	2	DOYLE CAMP/0600	DOYLE CAMP/1800
WTS2 PRECISION WT49 E-81	07/25	DAINAUSKUS MIKE	1	DOYLE CAMP/0600	DOYLE CAMP/1800
WTS2 FRANK TRUCKING E-93	07/25	FRANK ZABEL	1	DOYLE CAMP/0600	DOYLE CAMP/1800
WTS2 K&B WATER TRUCK SVC E-95	07/25	KYLE LAWLESS	1	DOYLE CAMP/0600	DOYLE CAMP/1800
WTS3 ALANS WATER E-225	07/24	STEVE WHARFF	1	DOYLE CAMP/0600	DOYLE CAMP/1800
DOZ2 STF 51 E-27	07/20	KYLE R CROW	3	DOYLE CAMP/0600	DOYLE CAMP/1800
STEN (T) O-408	07/27	JAMES SEETS	1	DOYLE CAMP/0600	DOYLE CAMP/1800
HEQB O-190	07/22	REESE SEWELL	1	DOYLE CAMP/0600	DOYLE CAMP/1800
FMOD VOLCANO CREEK O-268	07/25	JEFF TURPIN	2	DOYLE CAMP/0600	DOYLE CAMP/1800
FALM KEENAN SMITH O-267	07/23	SCOTT BLUE	2	DOYLE CAMP/0600	DOYLE CAMP/1800
SMOD GREAT LAKES O-362	07/21	TIMOTHY J DONOHOE	6	DOYLE CAMP/0600	DOYLE CAMP/1800
REMS 1 O-248	07/20	VICTOR CARNEWAL	4	DOYLE CAMP/0600	DOYLE CAMP/1800
EMPF O-380	07/26	ROBERT ANDERSON	1	DOYLE CAMP/0600	DOYLE CAMP/1800
EMPF O-280	07/26	NEVIN KAY	1	DOYLE CAMP/0600	DOYLE CAMP/1800
EMPF O-371	07/26	SILAS FISCHER	1	DOYLE CAMP/0600	DOYLE CAMP/1800

8. Division/Group Communication Summary						
Function	Channel	RX Frequency N/W	RX Tone/NAC	TX Frequency N/W	TX Tone/NAC	Mode
COMMAND	1	169.7500	CSQ	167.1000	146.2	
COMMAND	2	173.0375	CSQ	167.3250	146.2	
COMMAND	4	171.1125	CSQ	162.1875	146.2	
TACTICAL	6	165.3625	146.2	165.3625	146.2	
AIR TO GROUND	14	169.2875	CSQ	169.2875		
AIR TO GROUND	15	167.0625	CSQ	167.0625		

9. Prepared By (Resource Unit Leader)	Approved By (Planning Section Chief)	Date	Time
SHAWN STEINER	JOE SCURI	07/16/2021	2200

Division/Group Assignment List (ICS 204 WF)
Controlled Unclassified Information//Basic

1. Incident Name:			3.			
BECKWOURTH COMPLEX			Branch:		Division/Group	
2. Operational Period:			DAY BR IV		DIV N	
Date/Time From: 07/17/2021 0600 SAT	Date/Time To: 07/18/2021 0600 SUN					
4. Operations Personnel						
OPERATIONS CHIEF	KYLE JACOBSON		BRANCH DIRECTOR	ROBERT BERTOLINA JAMES LICO (T)		
DIVISION/GROUP SUPERVISOR	JOSEPH REYES 7/28		BRANCH SAFETY			
5. Resources Assigned this Period						
Strike Team / Task Force / Resource Designator	LWD	Leader	Number Persons	Drop Off PT./Time	Pick Up PT./Time	
EMTF O-101	07/19	JUSTIN JOHNSON	1	DOYLE CAMP/0600	DOYLE CAMP/1800	
SOFR O-132	07/21	MICHAEL TYRRELL	1	DOYLE CAMP/0600	DOYLE CAMP/1800	
6. Control Operations/Work Assignments:						
<p>Construct fireline as appropriate; mop up and secure structures. Prep structures ahead of fire. Provide structure defense as appropriate.</p>						
7. Special Instructions:						
<p>The following Field Observers (FOBS) will be in Branch I and Branch IV mapping and collecting intel on all Divisions: FOBS Marco Garcia O-463 FOBS (T) Tim Chow O-433 FOBS (T) Darrick Rossotti O-1.56 FOBS (T) Eric Hooper O-236 FOBS (T) Robert Barron O-235 FOBS Jesse Allread O-464 FOBS (T) Mike Moses O-456</p>						
8. Division/Group Communication Summary						
Function	Channel	RX Frequency N/W	RX Tone/NAC	TX Frequency N/W	TX Tone/NAC	Mode
COMMAND	1	169.7500	CSQ	167.1000	146.2	
COMMAND	2	173.0375	CSQ	167.3250	146.2	
COMMAND	4	171.1125	CSQ	162.1875	146.2	
TACTICAL	6	165.3625	146.2	165.3625	146.2	
AIR TO GROUND	14	169.2875	CSQ	169.2875		
AIR TO GROUND	15	167.0625	CSQ	167.0625		
9. Prepared By (Resource Unit Leader)		Approved By (Planning Section Chief)		Date	Time	
SHAWN STEINER		JOE SCURI		07/16/2021	2200	

Division/Group Assignment List (ICS 204 WF)
Controlled Unclassified Information//Basic

1. Incident Name:			3.			
BECKWOURTH COMPLEX			Branch:		Division/Group	
2. Operational Period:			DAY BR IV		DIV R / T	
Date/Time From: 07/17/2021 0600 SAT		Date/Time To: 07/18/2021 0600 SUN				
4. Operations Personnel						
OPERATIONS CHIEF		KYLE JACOBSON		BRANCH DIRECTOR		
				ROBERT BERTOLINA JAMES LICO (T)		
DIVISION/GROUP SUPERVISOR		KEVIN MARINO 7/27				
5. Resources Assigned this Period						
Strike Team / Task Force / Resource Designator		LWD	Leader	Number Persons	Drop Off PT./Time	Pick Up PT./Time
CRW2 LAVA RIVER 7 C-5		07/20	DANIEL JIMENEZ	20	DOYLE CAMP/0600	DOYLE CAMP/1800
CRW2 LAVA RIVER 6 C-9		07/19	JESUS RUIZ	20	DOYLE CAMP/0600	DOYLE CAMP/1800
ENG3 S/T 1521C E-314		07/25	MICHAEL DE PONCE	22	DOYLE CAMP/0600	DOYLE CAMP/1800
ENG3 TNF 73 E-310		07/25	ZACHARIAH STOCKDALE	5	DOYLE CAMP/0600	DOYLE CAMP/1800
ENG3 LOCAL RESOURCE MILFORD 1727			SEE CHECK-IN		DOYLE CAMP/0600	DOYLE CAMP/1800
WTS2 ESRYS E-268		07/17	JIM ESRY	1	DOYLE CAMP/0600	DOYLE CAMP/1800
DOZ2 PNF 2 E-35 **24 HR**		07/27	TOM SANCHEZ	2	DOYLE CAMP/0600	DOYLE CAMP/1800
EMPF O-424		07/20	JUSTIN RIVERA	1	DOYLE CAMP/0600	DOYLE CAMP/1800
EMPF O-373		07/19	BRIAN J PILON	1	DOYLE CAMP/0600	DOYLE CAMP/1800
EMPF O-374		07/20	BRANDON GRAY	1	DOYLE CAMP/0600	DOYLE CAMP/1800
EMTF O-102		07/19	JEFFERY L OLIVER	1	DOYLE CAMP/0600	DOYLE CAMP/1800
SOFR O-62		07/23	ROBERT MILLEA	1	DOYLE CAMP/0600	DOYLE CAMP/1800
REAF O-337		07/25	MIKE S EYCHISON	1	DOYLE CAMP/0600	DOYLE CAMP/1800
6. Control Operations/Work Assignments:						
Construct fireline as appropriate; mop up and secure structures. Prep structures ahead of fire. Provide structure defense as appropriate.						
7. Special Instructions:						
Field Observers (FOBS) will be in Branch I and Branch IV mapping and collecting intel on all Divisions: FOBS Marco Garcia O-463 FOBS (T), Tim Chow O-433 FOBS (T), Darrick Rossotti O-1.56, FOBS (T) Eric Hooper O-236, FOBS (T) Robert Barron O-235, FOBS Jesse Allread O-464, FOBS (T) Mike Moses O-456						
8. Division/Group Communication Summary						
Function	Channel	RX Frequency N/W	RX Tone/NAC	TX Frequency N/W	TX Tone/NAC	Mode
COMMAND	1	169.7500	CSQ	167.1000	146.2	
COMMAND	3	169.5375	CSQ	164.7125	146.2	
COMMAND	4	171.1125	CSQ	162.1875	146.2	
TACTICAL	10	166.7250	146.2	166.7250	146.2	
AIR TO GROUND	14	169.2875	CSQ	169.2875		
AIR TO GROUND	15	167.0625	CSQ	167.0625		
9. Prepared By (Resource Unit Leader)		Approved By (Planning Section Chief)		Date	Time	
KELLY MOSINSKI		JOE SCURI		07/16/2021	2200	

Division/Group Assignment List (ICS 204 WF)
Controlled Unclassified Information//Basic

1. Incident Name:			3.			
BECKWOURTH COMPLEX			Branch:		Division/Group	
2. Operational Period:			DAY BR VII		DIV V	
Date/Time From: 07/17/2021 0600 SAT	Date/Time To: 07/18/2021 0600 SUN					
4. Operations Personnel						
OPERATIONS CHIEF KYLE JACOBSON		BRANCH DIRECTOR JOE GONZALES				
DIVISION/GROUP SUPERVISOR CHRIS VOELKER LWD 7/20 LEWIS PREVATKE (T) LWD 7/24		BRANCH SAFETY				
5. Resources Assigned this Period						
Strike Team / Task Force / Resource Designator		LWD	Leader	Number Persons	Drop Off PT./Time	Pick Up PT./Time
CRW2 LAVA RIVER 8 C-6		07/20	BENJAMIN CASAS	20	ICP/0600	ICP/1800
CRW2 NORTH PACIFIC FORESTRY 10 C-8		07/20	JUAN PADILLA	20	ICP/0600	ICP/1800
CRW2 PACIFIC OASIS 11 C-29		07/22	WILLIAM DODD	20	ICP/0600	ICP/1800
CRW2 R & R CONTRACTING C-30		07/17	ROGELIO IBARRA	20	ICP/0600	ICP/1800
CRW2 NORTH PACIFIC NP6 C-47		07/20	JOSE JUAN CISNEROS MACIEL	20	ICP/0600	ICP/1800
ENG3 PEF 9178 E-342		07/24	RYAN NOWLING	3	ICP/0600	ICP/1800
ENG3 BRUSH 361 E-376		07/26	JOHN CRISCIONI	4	ICP/0600	ICP/1800
ENG3 BRUSH 53 E-387		07/26	KEVIN NYBERG	4	ICP/0600	ICP/1800
ENG3 SUNDANCE FIRE 303 E-74		07/21	ANTHONY BEELY	3	ICP/0600	ICP/1800
ENG4 IDAHO TRAILBLAZERS 14 E-52		07/19	CHRIS STEWART	3	ICP/0600	ICP/1800
ENG4 FIRE SUPPRESION 401 E-73		07/18	MARCOS MONTOYA SR.	3	ICP/0600	ICP/1800
ENG6 A-1 FIRE E-36		07/17	BRIAN JONES	3	ICP/0600	ICP/1800
ENG6 THREE RIVERS 137 E-97		07/18	AARON MARRUJO	3	ICP/0600	ICP/1800
ENG6 BIG STATE 13 E-106		07/22	JOE NOLIND	3	ICP/0600	ICP/1800
WTT1 GRAEAGLE 9231 E-230		07/23	CODY WARD	2	ICP/0600	ICP/1800
WTT1 SONOMA CTY FIRE OES E-272		07/24	PABLO MENDEZ	2	ICP/0600	ICP/1800
WTT1 REEDLEY FIRE OES 52 E-282		07/24	FABIAN MORALES	2	ICP/0600	ICP/1800
WTT1 WT310 E-288		07/25	RICHARD SHELTON	2	ICP/0600	ICP/1800
8. Division/Group Communication Summary						
Function	Channel	RX Frequency N/W	RX Tone/NAC	TX Frequency N/W	TX Tone/NAC	Mode
COMMAND	1	169.7500	CSQ	167.1000	146.2	
COMMAND	2	173.0375	CSQ	167.3250	146.2	
COMMAND	5	173.0250	CSQ	163.8250	146.2	
TACTICAL	9	166.7750	146.2	166.7750	146.2	
AIR TO GROUND	14	169.2875	CSQ	169.2875		
AIR TO GROUND	15	167.0625	CSQ	167.0625		
9. Prepared By (Resource Unit Leader)		Approved By (Planning Section Chief)		Date	Time	
KELLY MOSINSKI		JOE SCURI		07/16/2021	2200	

Division/Group Assignment List (ICS 204 WF)
Controlled Unclassified Information//Basic

1. Incident Name:			3.			
BECKWOURTH COMPLEX			Branch:		Division/Group	
2. Operational Period:			DAY BR VII		DIV V	
Date/Time From: 07/17/2021 0600 SAT	Date/Time To: 07/18/2021 0600 SUN					
4. Operations Personnel						
OPERATIONS CHIEF		KYLE JACOBSON		BRANCH DIRECTOR		JOE GONZALES
DIVISION/GROUP SUPERVISOR		CHRIS VOELKER LWD 7/20 LEWIS PREVATKE (T) LWD 7/24		BRANCH SAFETY		
5. Resources Assigned this Period						
Strike Team / Task Force / Resource Designator		LWD	Leader	Number Persons	Drop Off PT./Time	Pick Up PT./Time
WTT1 ID HEATSEEKER E-279		07/25	MARK HILDERBRAND	1	ICP/0600	ICP/1800
WTT2 LOOMIS E-145		07/25	JEAN LOOMIS	1	ICP/0600	ICP/1800
WTT2 PIERCE FIRE TENDER 4 E-147		07/22	ART MEECHAM	1	ICP/0600	ICP/1800
WTT2 PIERCE FIRE 5 E-148		07/23	RYAN LOCKHART	1	ICP/0600	ICP/1800
DIVS (T) O-457		07/20	SUSAN GREENLEAF	1	ICP/0600	ICP/1800
EMPF O-99		07/21	ERIC GRIFFITHS	1	ICP/0600	ICP/1800
EMTF O-104		07/19	NATHAN BENNER	1	ICP/0600	ICP/1800
EMPF O-281		07/25	MATTHEW GAMACHE	1	ICP/0600	ICP/1800
EMPF O-284		07/25	SEAN WISE	1	ICP/0600	ICP/1800
SOFR O-135		07/22	ERIC ULWELLING	1	ICP/0600	ICP/1800
READ (T) O-332		07/24	MONICA LOMAHUKLUH	1	ICP/0600	ICP/1800
ARCH O-307		07/26	JUSTICE FIFE	1	ICP/0600	ICP/1800
6. Control Operations/Work Assignments:						
Hold and secure line from Scott Road to X/Z break.						
7. Special Instructions:						
GPS all pumps and tanks, report location to SITL.						
8. Division/Group Communication Summary						
Function	Channel	RX Frequency N/W	RX Tone/NAC	TX Frequency N/W	TX Tone/NAC	Mode
COMMAND	1	169.7500	CSQ	167.1000	146.2	
COMMAND	2	173.0375	CSQ	167.3250	146.2	
COMMAND	5	173.0250	CSQ	163.8250	146.2	
TACTICAL	9	166.7750	146.2	166.7750	146.2	
AIR TO GROUND	14	169.2875	CSQ	169.2875		
AIR TO GROUND	15	167.0625	CSQ	167.0625		
9. Prepared By (Resource Unit Leader)		Approved By (Planning Section Chief)			Date	Time
KELLY MOSINSKI		JOE SCURI			07/16/2021	2200

Division/Group Assignment List (ICS 204 WF)
Controlled Unclassified Information//Basic

1. Incident Name:			3.			
BECKWOURTH COMPLEX			Branch:		Division/Group	
2. Operational Period:			DAY BR VII		DIV X / Z	
Date/Time From: 07/17/2021 0600 SAT	Date/Time To: 07/18/2021 0600 SUN					
4. Operations Personnel						
OPERATIONS CHIEF		KYLE JACOBSON		BRANCH DIRECTOR		
				JOE GONZALES		
DIVISION/GROUP SUPERVISOR		KENNY GRIFFIN LWD 7/24		BRANCH SAFETY		
5. Resources Assigned this Period						
Strike Team / Task Force / Resource Designator	LWD	Leader	Number Persons	Drop Off PT./Time	Pick Up PT./Time	
CRW2 LAVA RIVER 9 C-7	07/20	JOSE LOPEZ	20	ICP/0600	ICP/1800	
CRW2 BIRRUETA 2 C-27	07/22	CHRISTIAN JUAREZ	20	ICP/0600	ICP/1800	
CRW2 PACIFIC OASIS 2 C-28	07/22	JAMAL KWIATKOWSKI	20	ICP/0600	ICP/1800	
ENG4 AUSTIN 47 E-35	07/18	DAVID AUSTIN	3	ICP/0600	ICP/1800	
ENG6 A-1 FIRE 46 E-40	07/17	WYATT LAWRENCE	3	ICP/0600	ICP/1800	
WTT1 SOUTH ARKANSAS E-150	07/24	DAVID J DEPETRO	2	ICP/0600	ICP/1800	
WTT2 INKOM163 E-56	07/20	WADE TYDEMAN	2	ICP/0600	ICP/1800	
EMPF O-283	07/25	TREVOR BURCH	1	ICP/0600	ICP/1800	
EMPF O-285	07/25	OLIVER PEDROZA	1	ICP/0600	ICP/1800	
READ O-167	07/23	SCOTT DAILEY	1	ICP/0600	ICP/1800	
READ O-278	07/25	ADAM RUSSELL	1	ICP/0600	ICP/1800	
6. Control Operations/Work Assignments:						
Patrol control lines from H1 to DIV V break. Mop up where appropriate.						
7. Special Instructions:						
GPS all pumps and tanks, report location to SITL. Backhaul excess equipment.						
8. Division/Group Communication Summary						
Function	Channel	RX Frequency N/W	RX Tone/NAC	TX Frequency N/W	TX Tone/NAC	Mode
COMMAND	1	169.7500	CSQ	167.1000	146.2	
COMMAND	2	173.0375	CSQ	167.3250	146.2	
COMMAND	5	173.0250	CSQ	163.8250	146.2	
TACTICAL	9	166.7750	146.2	166.7750	146.2	
AIR TO GROUND	14	169.2875	CSQ	169.2875		
AIR TO GROUND	15	167.0625	CSQ	167.0625		
9. Prepared By (Resource Unit Leader)		Approved By (Planning Section Chief)		Date	Time	
KELLY MOSINSKI		JOE SCURI		07/16/2021	2200	

Division/Group Assignment List (ICS 204 WF)
Controlled Unclassified Information//Basic

1. Incident Name:			3.			
BECKWOURTH COMPLEX			Branch:		Division/Group	
2. Operational Period:			CONTING		BRANCH	
Date/Time From: 07/17/2021 0600 SAT	Date/Time To: 07/18/2021 0600 SUN					
4. Operations Personnel						
OPERATIONS CHIEF		KYLE JACOBSON		BRANCH DIRECTOR		JAY WALTER
DIVISION/GROUP SUPERVISOR		HEATHER GROVE LWD 7/17 ALAN WHISLER 7/25		AIR ATTACK SUPERVISOR		
5. Resources Assigned this Period						
Strike Team / Task Force / Resource Designator	LWD	Leader	Number Persons	Drop Off PT./Time	Pick Up PT./Time	
CRW2 FRANCO REFORESTATION C-44	07/23	FLORENCIO FRANCO	20	ICP/0600	ICP/1800	
CRW2 R&R CONTRACTING C-61	07/23	CHRISTIAN CASTRO	20	ICP/0600	ICP/1800	
ENG3 VULCAN FIRE 22 E-381	07/26	ADAM TIEMAN	3	ICP/0600	ICP/1800	
ENG3 OUTBACK FIREFIGHTING E-385	07/26	JARED ANDRA	3	ICP/0600	ICP/1800	
ENG4 ROC-N-R 6 E-359	07/18	RANDY NORRID	3	ICP/0600	ICP/1800	
WTT1 SIERRA COUNTY FIRE WT84 E-237	07/23	MCCOLLUM JEFF	1	ICP/0600	ICP/1800	
WTS1 2541 E-286	07/25	ANTUS AARON	1	ICP/0600	ICP/1800	
DO22 LEPAGE E-151	07/22	ROBERT BALCOM	1	ICP/0600	ICP/1800	
DO22 CLAYTON GRAHAM E-152	07/22	SKYLERE EVANS	3	ICP/0600	ICP/1800	
DO23 LEPAGE E-160	07/22	JOHN MANZ	1	ICP/0600	ICP/1800	
DO23 T&S 40 TRAFFIC E-267	07/25	SEBASTIAN MAYNARD	1	ICP/0600	ICP/1800	
MAST2 KITE SOLUTIONS E-290	07/24	CHAD NUNNELEE	2	ICP/0600	ICP/1800	
MAST2 DAVIS CORPORATION E-291	07/28	LEVI MERRILL	2	ICP/0600	ICP/1800	
MAST2 TOUGH COUNTRY E-390	07/28	JEREMY TODD	2	ICP/0600	ICP/1800	
MAST2 PAUL ROEN E-391	07/28	TROY FOSTER	2	ICP/0600	ICP/1800	
MAST2 GRAHAM MASTICATOR E-392	07/27	REN BURNS	2	ICP/0600	ICP/1800	
MAST NORTH STATE EQUIP E-393	07/28	JOSH VIBERG	2	ICP/0600	ICP/1800	
TFLD O-112	07/17	JACOB BLEHM	1	ICP/0600	ICP/1800	
8. Division/Group Communication Summary						
Function	Channel	RX Frequency N/W	RX Tone/NAC	TX Frequency N/W	TX Tone/NAC	Mode
COMMAND	1	169.7500	CSQ	167.1000	146.2	
COMMAND	2	173.0375	CSQ	167.3250	146.2	
COMMAND	3	169.5375	CSQ	164.7125	146.2	
TACTICAL	7	168.0500	146.2	168.0500	146.2	
AIR TO GROUND	15	167.0625	CSQ	167.0625		
AIR TO GROUND	14	169.2875	CSQ	169.2875		
9. Prepared By (Resource Unit Leader)		Approved By (Planning Section Chief)		Date	Time	
KELLY MOSINSKI		JOE SCURI		07/16/2021	2200	

Division/Group Assignment List (ICS 204 WF)
 Controlled Unclassified Information//Basic

1. Incident Name:			3.			
BECKWOURTH COMPLEX			Branch:		Division/Group	
2. Operational Period:			CONTING		BRANCH	
Date/Time From: 07/17/2021 0600 SAT	Date/Time To: 07/18/2021 0600 SUN					
4. Operations Personnel						
OPERATIONS CHIEF		KYLE JACOBSON		BRANCH DIRECTOR		JAY WALTER
DIVISION/GROUP SUPERVISOR		HEATHER GROVE LWD 7/17 ALAN WHISLER 7/25		AIR ATTACK SUPERVISOR		
5. Resources Assigned this Period						
Strike Team / Task Force / Resource Designator		LWD	Leader	Number Persons	Drop Off PT./Time	Pick Up PT./Time
TFLD O-121		07/24	ERICK MATTSON	1	ICP/0600	ICP/1800
TFLD (T) O-340		07/26	DANIEL PATTERSON	1	ICP/0600	ICP/1800
6. Control Operations/Work Assignments:						
Scout and develop contingency plans. Implement contingency plans as appropriate.						
7. Special Instructions:						
8. Division/Group Communication Summary						
Function	Channel	RX Frequency N/W	RX Tone/NAC	TX Frequency N/W	TX Tone/NAC	Mode
COMMAND	1	169.7500	CSQ	167.1000	146.2	
COMMAND	2	173.0375	CSQ	167.3250	146.2	
COMMAND	3	169.5375	CSQ	164.7125	146.2	
TACTICAL	7	168.0500	146.2	168.0500	146.2	
AIR TO GROUND	15	167.0625	CSQ	167.0625		
AIR TO GROUND	14	169.2875	CSQ	169.2875		
9. Prepared By (Resource Unit Leader)		Approved By (Planning Section Chief)			Date	Time
KELLY MOSINSKI		JOE SCURI			07/16/2021	2200

NIGHT

Division/Group Assignment List (ICS 204 WF)
Controlled Unclassified Information//Basic

1. Incident Name:			3.			
BECKWOURTH COMPLEX			Branch:		Division/Group	
2. Operational Period:			NIGHT BR I		DIV A / C	
Date/Time From: 07/17/2021 0600	SAT	Date/Time To: 07/18/2021 0600				
4. Operations Personnel						
OPERATIONS CHIEF		DAVE PEREIRA STEVE BURNS		BRANCH DIRECTOR		NICK BUNCH
DIVISION/GROUP SUPERVISOR		ANTONIO M JIMENEZ LWD 7/21		BRANCH SAFETY		
5. Resources Assigned this Period						
Strike Team / Task Force / Resource Designator		LWD	Leader	Number Persons	Drop Off PT./Time	Pick Up PT./Time
CRW1 ELDORADO IHC C-13		07/29	BENJAMIN STRAHAN	20	ICP/1800	ICP/0600
CRW2 CABRERA CONTRACTING C-73		07/24	MANNY MORENO	20	ICP/1800	ICP/0600
ENG3 S/T 2150C E-242		07/25	MITCH FRANKLIN	17	ICP/1800	ICP/0600
ENG3 KANAB FD E-375		07/27	BRETT PEIRSON	4	ICP/1800	ICP/0600
ENG3 WILDFIRE SUPPORT TEAM E-371		07/27	MIKE JARAMILLO	3	ICP/1800	ICP/0600
ENG3 BLACK RANGE E-372		07/27	TIMOTHY PEARSON	3	ICP/1800	ICP/0600
ENG3 AAA FORESTRY E-379		07/27	SCOT STEINBRING	3	ICP/1800	ICP/0600
ENG3 J3 E29 E-380		07/27	WES WALLACE	3	ICP/1800	ICP/0600
ENG4 ROC-N-R E-99		07/18	JIM LASALLE	3	ICP/1800	ICP/0600
ENG6 YIA 9462 E-214		07/24	BLAINE MCKINNON	4	ICP/1800	ICP/0600
WTT1 OES 32 E-195		07/23	JAMES IRVINE	2	ICP/1800	ICP/0600
WTT1 SPEARFISH WT E-146		07/25	THOMAS WRIGHT HAGEMAN	2	ICP/1800	ICP/0600
WTS1 OILAR E-281		07/24	DANIEL OILAR	1	ICP/1800	ICP/0600
WTT2 E. PLUMAS RFPD 9834 E-7		07/21	TODD TURNER	2	ICP/1800	ICP/0600
WTS2 BAY AREA WATER 34 E-30		07/23	MARCUS LEMA	1	ICP/1800	ICP/0600
TFLD O-26		07/17	DAVID RICHARD	1	ICP/1800	ICP/0600
TFLD O-253		07/25	MANUAL DAFONTE	1	ICP/1800	ICP/0600
EMPF O-377		07/25	THERESA CHAMBERS	1	ICP/1800	ICP/0600
8. Division/Group Communication Summary						
Function	Channel	RX Frequency N/W	RX Tone/NAC	TX Frequency N/W	TX Tone/NAC	Mode
COMMAND	1	169.7500	CSQ	167.1000	146.2	
COMMAND	2	173.0375	CSQ	167.3250	146.2	
COMMAND	4	171.1125	CSQ	162.1875	146.2	
TACTICAL	6	165.3625	146.2	165.3625	146.2	
AIR TO GROUND	14	169.2875	CSQ	169.2875		
AIR TO GROUND	15	167.0625	CSQ	167.0625		
9. Prepared By (Resource Unit Leader)		Approved By (Planning Section Chief)			Date	Time
MIKE VETTI		JOE SCURI			07/16/2021	2200

Division/Group Assignment List (ICS 204 WF)
Controlled Unclassified Information//Basic

1. Incident Name:		3.				
BECKWOURTH COMPLEX		Branch:		Division/Group		
2. Operational Period:		NIGHT BR I		DIV A / C		
Date/Time From: 07/17/2021 0600 SAT	Date/Time To: 07/18/2021 0600 SUN					
4. Operations Personnel						
OPERATIONS CHIEF	DAVE PEREIRA STEVE BURNS	BRANCH DIRECTOR		NICK BUNCH		
DIVISION/GROUP SUPERVISOR	ANTONIO M JIMENEZ LWD 7/21	BRANCH SAFETY				
5. Resources Assigned this Period						
Strike Team / Task Force / Resource Designator	LWD	Leader	Number Persons	Drop Off PT./Time	Pick Up PT./Time	
EMPF O-376	07/26	MICHAEL S SCARDINA	1	ICP/1800	ICP/0600	
SOF2 O-65	07/24	TOM NASH	1	ICP/1800	ICP/0600	
6. Control Operations/Work Assignments:						
Utilize appropriate suppression techniques to keep the fire within current containment lines.						
7. Special Instructions:						
SOFR Tom Nash is assigned to Divisions A/C and E/G.						
8. Division/Group Communication Summary						
Function	Channel	RX Frequency N/W	RX Tone/NAC	TX Frequency N/W	TX Tone/NAC	Mode
COMMAND	1	169.7500	CSQ	167.1000	146.2	
COMMAND	2	173.0375	CSQ	167.3250	146.2	
COMMAND	4	171.1125	CSQ	162.1875	146.2	
TACTICAL	6	165.3625	146.2	165.3625	146.2	
AIR TO GROUND	14	169.2875	CSQ	169.2875		
AIR TO GROUND	15	167.0625	CSQ	167.0625		
9. Prepared By (Resource Unit Leader)		Approved By (Planning Section Chief)		Date	Time	
MIKE VETTI		JOE SCURI		07/16/2021	2200	

Division/Group Assignment List (ICS 204 WF)
Controlled Unclassified Information//Basic

1. Incident Name:				3.		
BECKWOURTH COMPLEX				Branch:		Division/Group
2. Operational Period:				NIGHT BR I		DIV E / G
Date/Time From: 07/17/2021 0600 SAT		Date/Time To: 07/18/2021 0600 SUN				
4. Operations Personnel						
OPERATIONS CHIEF		DAVE PEREIRA STEVE BURNS		BRANCH DIRECTOR		NICK BUNCH
DIVISION/GROUP SUPERVISOR		SHEPLEY SCHROTH-CARY LWD 7/26 JIMMY HIDALGO		BRANCH SAFETY		
5. Resources Assigned this Period						
Strike Team / Task Force / Resource Designator		LWD	Leader	Number Persons	Drop Off PT./Time	Pick Up PT./Time
CRW2IA DIAMOND MOUNTAIN IHC C-85		07/29	DANIEL DOBYNS	20	ICP/1800	ICP/0600
CRW2 J FRANCO C-34		07/23	JOAN ALCANTAR	19	ICP/1800	ICP/0600
CRW2 DIAMOND FIRE 14 C-62		07/24	BRAD EMERY	20	ICP/1800	ICP/0600
CRW2 CABRERA 16 E-93		07/19	BENNY CABRERA	20	ICP/1800	ICP/0600
ENG3 S/T 5780C E-458		07/20	ROBERT HUDLAND	27	ICP/1800	ICP/0600
ENG3 332 E-428		07/29	NORMAN GOODWIN	5	ICP/1800	ICP/0600
ENG6 SCHOLL FIRE E-429		07/30	BYRON LONG	3	ICP/1800	ICP/0600
ENG6 FIRE TRAX E-430		07/30	RETO NIKLAUS	3	ICP/1800	ICP/0600
DO22 LET-ER BUCK TRUCKING E-217		07/25	TERRY CUMMINGS	1	ICP/1800	ICP/0600
DO23 49 CREEK RANCH E-266		07/24	LANCE LINKER	2	ICP/1800	ICP/0600
TFLD O-158		07/25	KENN PERREAULT	1	ICP/1800	ICP/0600
REMS SMA 6 O-420		07/20	WALTER PATTON	4	ICP/1800	ICP/0600
EMPF O-169		07/25	KENNETH DAY	1	ICP/1800	ICP/0600
EMPF O-244		07/20	KYLE A BUSBY	1	ICP/1800	ICP/0600
EMPF O-245		07/20	AIDAN SMITH	1	ICP/1800	ICP/0600
8. Division/Group Communication Summary						
Function	Channel	RX Frequency N/W	RX Tone/NAC	TX Frequency N/W	TX Tone/NAC	Mode
COMMAND	1	169.7500	CSQ	167.1000	146.2	
COMMAND	2	173.0375	CSQ	167.3250	146.2	
COMMAND	4	171.1125	CSQ	162.1875	146.2	
TACTICAL	7	168.0500	146.2	168.0500	146.2	
AIR TO GROUND	14	169.2875	CSQ	169.2875		
AIR TO GROUND	15	167.0625	CSQ	167.0625		
9. Prepared By (Resource Unit Leader)		Approved By (Planning Section Chief)			Date	Time
KELLY MOSINSKI		JOE SCURI			07/16/2021	2200

Division/Group Assignment List (ICS 204 WF)
Controlled Unclassified Information//Basic

1. Incident Name:			3.			
BECKWOURTH COMPLEX			Branch:		Division/Group	
2. Operational Period:			NIGHT BR I		DIV I	
Date/Time From: 07/17/2021 0600 SAT	Date/Time To: 07/18/2021 0600 SUN					
4. Operations Personnel						
OPERATIONS CHIEF	DAVE PEREIRA STEVE BURNS		BRANCH DIRECTOR		NICK BUNCH	
DIVISION/GROUP SUPERVISOR	WILLIAM EDWARDS LWD 7/24 ROBERT L KILPATRICK (T) LWD 7/27		BRANCH SAFETY			
5. Resources Assigned this Period						
Strike Team / Task Force / Resource Designator	LWD	Leader	Number Persons	Drop Off PT./Time	Pick Up PT./Time	
CRW1 KLAMATH IHC C-55	07/24	ANDREW S ZINK	20	ICP/1800	ICP/0600	
CRW1 TRINITY C-63	07/27	TRISTAN DIAS	20	ICP/1800	ICP/0600	
CRW2IA DALTON C-19	07/20	IGNACIO PIZANO	20	ICP/1800	ICP/0600	
CRW2IA SHASTA LAKE C-25	07/17	JOE T BOGDAN	20	ICP/1800	ICP/0600	
CRW2IA FIRESTORM 3 C-42	07/28	ALEXANDRA RHEA	18	ICP/1800	ICP/0600	
CRW2 FIRESTORM 1 C-45	07/23	GRAHAM LOWE	20	ICP/1800	ICP/0600	
ENG3 S/T 2600C E-243	07/24	HAROLD REED	27	ICP/1800	ICP/0600	
T/F BECKWOURTH 1		AARON EDWARDS	42	ICP/1800	ICP/0600	
ENG3 TAHOE 331 E-308	07/25	DANNY RASMUSSEN	5	ICP/1800	ICP/0600	
ENG6 EAGLE 6 E-102	07/19	DENIS BARCUS	3	ICP/1800	ICP/0600	
ENG6 L&A WILDFIRE 27 E-422	07/28	KEN ARINGDALE	3	ICP/1800	ICP/0600	
ENG6 GLOBAL FRONT E-423	07/28	STEVEN BROUILLETTE	3	ICP/1800	ICP/0600	
WTT2 STF WT 212 E-142	07/23	JAMES C BAKER	1	ICP/1800	ICP/0600	
WTS1 PIONEER FPD E-287	07/25	JEREMIAH WALSH	2	ICP/1800	ICP/0600	
WTS2 DIETZ EQUIPMENT E-165	07/24	THOMAS CULP	1	ICP/1800	ICP/0600	
DOZ2 PNF1 E-34 **24 HR**	07/29	JAMES SMITH	3	ICP/1800	ICP/0600	
DOZ2 DUNLAP E-28 **24 HR**	07/20	KYLE TROSKY	2	ICP/1800	ICP/0600	
DOZ2 2C LAND & TIMBER E-91 **24 HR**	07/21	JUSTIN ROBERTSON	2	ICP/1800	ICP/0600	
8. Division/Group Communication Summary						
Function	Channel	RX Frequency N/W	RX Tone/NAC	TX Frequency N/W	TX Tone/NAC	Mode
COMMAND	1	169.7500	CSQ	167.1000	146.2	
COMMAND	2	173.0375	CSQ	167.3250	146.2	
COMMAND	4	171.1125	CSQ	162.1875	146.2	
TACTICAL	8	168.6000	146.2	168.6000	146.2	
AIR TO GROUND	14	169.2875	CSQ	169.2875		
AIR TO GROUND	15	167.0625	CSQ	167.0625		
9. Prepared By (Resource Unit Leader)		Approved By (Planning Section Chief)		Date	Time	
GINA BALD		JOE SCURI		07/16/2021	2200	

Division/Group Assignment List (ICS 204 WF)
Controlled Unclassified Information//Basic

1. Incident Name:			3.			
BECKWOURTH COMPLEX			Branch:		Division/Group	
2. Operational Period:			NIGHT BR I		DIV I	
Date/Time From: 07/17/2021 0600 SAT	Date/Time To: 07/18/2021 0600 SUN					
4. Operations Personnel						
OPERATIONS CHIEF		DAVE PEREIRA STEVE BURNS		BRANCH DIRECTOR		NICK BUNCH
DIVISION/GROUP SUPERVISOR		WILLIAM EDWARDS LWD 7/24 ROBERT L KILPATRICK (T) LWD 7/27		BRANCH SAFETY		
5. Resources Assigned this Period						
Strike Team / Task Force / Resource Designator		LWD	Leader	Number Persons	Drop Off PT./Time	Pick Up PT./Time
DOZ3 BLACK KNIGHT E-156 **24 HR**		07/22	ALEX WUNSCH	2	ICP/1800	ICP/0600
DOZ3 KITE SOLUTIONS E-159 **24 HR**		07/22	DONOVAN HILLAN	2	ICP/1800	ICP/0600
DOZ3 PAUL ROEN E-199 **24 HR**		07/22	PAUL ROEN	2	ICP/1800	ICP/0600
DOZ3 PAUL ROEN E-218 **24 HR**		07/23	MIKE RYAN	2	ICP/1800	ICP/0600
DOZ3 MOORE EXCAVATING E-264 **24 HR**		07/24	DILLAN MOORE	2	ICP/1800	ICP/0600
DOZ3 LONESTAR E-265 **24 HR**		07/24	SEAN COTTEN	2	ICP/1800	ICP/0600
TFLD O-111		07/19	ANTHONY J SIGONA	1	ICP/1800	ICP/0600
TFLD O-156		07/25	FRANK ALVES	1	ICP/1800	ICP/0600
TFLD O-252		07/25	DAN SCHINDLER	1	ICP/1800	ICP/0600
TFLD (T) O-116		07/27	BEN OSTERLAND	1	ICP/1800	ICP/0600
TFLD (T) O-187		07/22	JAMES W HILL	1	ICP/1800	ICP/0600
HEQB O-259		07/24	DOUG LINGEN	1	ICP/1800	ICP/0600
EMTF O-356		07/20	ERNESTO DIAZ	1	ICP/1800	ICP/0600
EMTF O-353		07/20	THOMAS STILLMAN	1	ICP/1800	ICP/0600
SOF2 O-149		07/19	KEN GORDON	1	ICP/1800	ICP/0600
8. Division/Group Communication Summary:						
Function	Channel	RX Frequency N/W	RX Tone/NAC	TX Frequency N/W	TX Tone/NAC	Mode
COMMAND	1	169.7500	CSQ	167.1000	146.2	
COMMAND	2	173.0375	CSQ	167.3250	146.2	
COMMAND	4	171.1125	CSQ	162.1875	146.2	
TACTICAL	8	168.6000	146.2	168.6000	146.2	
AIR TO GROUND	14	169.2875	CSQ	169.2875		
AIR TO GROUND	15	167.0625	CSQ	167.0625		
9. Prepared By (Resource Unit Leader)		Approved By (Planning Section Chief)			Date	Time
GINA BALD		JOE SCURI			07/16/2021	2200

Division/Group Assignment List (ICS 204 WF)
 Controlled Unclassified Information//Basic

1. Incident Name:			3.			
BECKWOURTH COMPLEX			Branch:		Division/Group	
2. Operational Period:			NIGHT BR I		DIV I	
Date/Time From: 07/17/2021 0600 SAT	Date/Time To: 07/18/2021 0600 SUN					
4. Operations Personnel						
OPERATIONS CHIEF	DAVE PEREIRA STEVE BURNS		BRANCH DIRECTOR		NICK BUNCH	
DIVISION/GROUP SUPERVISOR	WILLIAM EDWARDS LWD 7/24 ROBERT L KILPATRICK (T) LWD 7/27		BRANCH SAFETY			
5. Resources Assigned this Period						
Strike Team / Task Force / Resource Designator	LWD	Leader	Number Persons	Drop Off PT./Time	Pick Up PT./Time	
6. Control Operations/Work Assignments:						
Construct fireline as appropriate. Prepare for tactical firing operations. Provide structure defense as needed. Scout for proposed fireline.						
7. Special Instructions:						
8. Division/Group Communication Summary						
Function	Channel	RX Frequency N/W	RX Tone/NAC	TX Frequency N/W	TX Tone/NAC	Mode
COMMAND	1	169.7500	CSQ	167.1000	146.2	
COMMAND	2	173.0375	CSQ	167.3250	146.2	
COMMAND	4	171.1125	CSQ	162.1875	146.2	
TACTICAL	8	168.6000	146.2	168.6000	146.2	
AIR TO GROUND	14	169.2875	CSQ	169.2875		
AIR TO GROUND	15	167.0625	CSQ	167.0625		
9. Prepared By (Resource Unit Leader)		Approved By (Planning Section Chief)		Date	Time	
GINA BALD		JOE SCURI		07/16/2021	2200	

Division/Group Assignment List (ICS 204 WF)
Controlled Unclassified Information//Basic

1. Incident Name:			3.			
BECKWOURTH COMPLEX			Branch:		Division/Group	
2. Operational Period:			NIGHT BR IV		DIV N	
Date/Time From: 07/17/2021 0600 SAT	Date/Time To: 07/18/2021 0600 SUN					
4. Operations Personnel						
OPERATIONS CHIEF	DAVE PEREIRA STEVE BURNS		BRANCH DIRECTOR		DREW GRAHAM	
DIVISION/GROUP SUPERVISOR	NATHAN SUIDA LWD 7/23 REX TUCKER LWD 7/23		BRANCH SAFETY			
5. Resources Assigned this Period						
Strike Team / Task Force / Resource Designator	LWD	Leader	Number Persons	Drop Off PT./Time	Pick Up PT./Time	
ENG6 EARTH INDUSTRIES 1 E-459	07/28	RUDY VOSS	3	DOYLE CAMP/1800	DOYLECAMP/0600	
ENG6 FIREANT 327 E-460	07/28	ZACH ANTHIS	3	DOYLE CAMP/1800	DOYLECAMP/0600	
ENG6 B&B FIRE SUPPRESSION E-76 E-462	07/27	DAVID BRYANT	3	DOYLE CAMP/1800	DOYLECAMP/0600	
ENG6 J3 CONTRACTING 12 E-463	07/27	BRYAN CRAWLEY	3	DOYLE CAMP/1800	DOYLECAMP/0600	
WTT1 ORANGE COVE FD E-283	07/24	TYLER TORRES	2	DOYLE CAMP/1800	DOYLECAMP/0600	
WTT2 LPF 5 E-143	07/23	JUAN A LAVADORES	2	DOYLE CAMP/1800	DOYLECAMP/0600	
SOFR O-63	07/22	SCOTT WILSON	1	DOYLE CAMP/1800	DOYLECAMP/0600	
6. Control Operations/Work Assignments:						
<p>Construct fire line as appropriate, mop up and secure structures. Prep structures ahead of fire. Provide structure defense as needed.</p>						
7. Special Instructions:						
8. Division/Group Communication Summary						
Function	Channel	RX Frequency N/W	RX Tone/NAC	TX Frequency N/W	TX Tone/NAC	Mode
COMMAND	1	169.7500	CSQ	167.1000	146.2	
COMMAND	2	173.0375	CSQ	167.3250	146.2	
COMMAND	4	171.1125	CSQ	162.1875	146.2	
TACTICAL	6	165.3625	146.2	165.3625	146.2	
AIR TO GROUND	14	169.2875	CSQ	169.2875		
AIR TO GROUND	15	167.0625	CSQ	167.0625		
9. Prepared By (Resource Unit Leader)			Approved By (Planning Section Chief)		Date	Time
SHAWN STEINER			JOE SCURI		07/16/2021	2200

Division/Group Assignment List (ICS 204 WF)
Controlled Unclassified Information//Basic

1. Incident Name:			3.			
BECKWOURTH COMPLEX			Branch:		Division/Group	
2. Operational Period:			NIGHT BR IV		DIV R / T	
Date/Time From: 07/17/2021 0600 SAT	Date/Time To: 07/18/2021 0600 SUN					
4. Operations Personnel						
OPERATIONS CHIEF		DAVE PEREIRA STEVE BURNS		BRANCH DIRECTOR		DREW GRAHAM
DIVISION/GROUP SUPERVISOR		JOHN SORENSEN LWD 7/26		BRANCH SAFETY		
5. Resources Assigned this Period						
Strike Team / Task Force / Resource Designator	LWD	Leader	Number Persons	Drop Off PT./Time	Pick Up PT./Time	
CREW2 ROCHA C3 C-88	07/27	JORGE DURAN	20	DOYLE CAMP/1800	DOYLE CAMP/0600	
ENG3 S/T 6604C E-136	07/23	DANIEL DIEZ	27	DOYLE CAMP/1800	DOYLE CAMP/0600	
ENG3 S/T CNF 6633C E-137	07/23	JOEL MORTIER	27	DOYLE CAMP/1800	DOYLE CAMP/0600	
WTT1 LOOKOUT VF E-270 **24 HR**	07/23	TOM STANSBERRY	2	DOYLE CAMP/1800	DOYLE CAMP/0600	
WTS2 NORTH STATE E-31	07/23	BOB GETZ	1	DOYLE CAMP/1800	DOYLE CAMP/0600	
DO22 PNF2 E-35 **24 HR**	07/27	DAVID COLLINS	2	DOYLE CAMP/1800	DOYLE CAMP/0600	
6. Control Operations/Work Assignments:						
Construct fireline as appropriate, mop up and secure structures. Prep structures ahead of fire. Provide structure defense as needed.						
7. Special Instructions:						
8. Division/Group Communication Summary						
Function	Channel	RX Frequency N/W	RX Tone/NAC	TX Frequency N/W	TX Tone/NAC	Mode
COMMAND	1	169.7500	CSQ	167.1000	146.2	
COMMAND	2	173.0375	CSQ	167.3250	146.2	
COMMAND	4	171.1125	CSQ	162.1875	146.2	
TACTICAL	10	166.7250	146.2	166.7250	146.2	
AIR TO GROUND	14	169.2875	CSQ	169.2875		
AIR TO GROUND	15	167.0625	CSQ	167.0625		
9. Prepared By (Resource Unit Leader)		Approved By (Planning Section Chief)			Date	Time
LOGAN BROWN		JOE SCURI			07/16/2021	2200

Division/Group Assignment List (ICS 204 WF)
 Controlled Unclassified Information//Basic

1. Incident Name:			3.			
BECKWOURTH COMPLEX			Branch:		Division/Group	
2. Operational Period:			NIGHT BR VII		DIV V / X / Z	
Date/Time From: 07/17/2021 0600 SAT	Date/Time To: 07/18/2021 0600 SUN					
4. Operations Personnel						
OPERATIONS CHIEF		DAVE PEREIRA STEVE BURNS		BRANCH DIRECTOR		PATRICK LAENG
DIVISION/GROUP SUPERVISOR		CAMERON TODD LWD 7/23		BRANCH SAFETY		
5. Resources Assigned this Period						
Strike Team / Task Force / Resource Designator		LWD	Leader	Number Persons	Drop Off PT./Time	Pick Up PT./Time
CRW2 MNF OC 51 C-72		07/23	STEVE OCAMPO	19	ICP/1800	ICP/0600
ENG3 CAMINOS FIRE CAFS1 E-53		07/25	JOHN ROADS	3	ICP/1800	ICP/0600
ENG5 HI COUNTRY 72 E-32		07/22	CODY SUTTON	3	ICP/1800	ICP/0600
ENG6 HEATSEEKER 9 E-37		07/20	ROGGIO IAN	3	ICP/1800	ICP/0600
EMPF O-370		07/26	PHILLIP BROWN	1	ICP/1800	ICP/0600
EMPF O-375		07/20	LUKE R GRANGER	1	ICP/1800	ICP/0600
6. Control Operations/Work Assignments:						
Hold and secure line from Scott Road to Frenchman Road (284). Patrol dozer lines from DP1 to H1, mop up where appropriate.						
7. Special Instructions:						
8. Division/Group Communication Summary						
Function	Channel	RX Frequency N/W	RX Tone/NAC	TX Frequency N/W	TX Tone/NAC	Mode
COMMAND	1	169.7500	CSQ	167.1000	146.2	
COMMAND	2	173.0375	CSQ	167.3250	146.2	
COMMAND	5	173.0250	CSQ	163.8250	146.2	
TACTICAL	9	166.7750	146.2	166.7750	146.2	
AIR TO GROUND	14	169.2875	CSQ	169.2875		
AIR TO GROUND	15	167.0625	CSQ	167.0625		
9. Prepared By (Resource Unit Leader)		Approved By (Planning Section Chief)			Date	Time
SHAWN STEINER		JOE SCURI			07/16/2021	2200

AIR OPERATIONS SUMMARY

PREPARED BY: *JoAnn Overacker*

PREPARED DATE/TIME: 07/16/21 1900

1. INCIDENT NAME: Beckwourth

2. OPERATIONAL PERIOD DATE: 7/17/21

START TIME: 0830

END TIME: 0900

SUNRISE: 0544

SUNSET: 2030

3. REMARKS (Safety Notes, Hazards, Air Operations Special Equipment, etc.)
 NIGHT SHIFT ONLY - Night Flying Hoist Medivac Helicopter located in Reno.
 Herlong MRB is operational

4. MEDEVAC A/C:
 See medical plan.
 Use local air med ships.

5. TFR: 1/6966
 Radius: NM
 Altitude: 12,500 MSL
 See Notam for Lat/Long
 Frequency 120.1250

AIRCRAFT FLYING OUT OF NERVINO CONTACT THE TOWER ON 121.225
 AIRCRAFT FLYING OUT OF STEAD CONTACT THE TOWER ON 126.875

6. PERSONNEL	Phone	7. FREQUENCIES	AM	FM	8. FIXED-WING	# Avail/ Type/ Make-Model / FAA N# / Base(s)
AOBD: JoAnn Overacker	209-559-1617	AIR/AIR FW:	120.1250	171.0375	Airtankers	As ordered
ASGS:		AIR/AIR RW:	124.0750	171.0375	Leadplanes	As ordered
ATGS: Brian Rogers	530-310-3506	AIR/AIR BRIEFING	133.0250			
ATGS: Todd White	530-283-5621	AIR/GRD CMD		169.2875		
ASGS9t) Bryan Rosenow	530-412-3632	AIR/GRD TAC		167.0825		
HLCO: Brad Corbin	661-985-8680	IA A/G CMD		167.500	ATGS Aircraft	AA 06 and 17
HLCO Matt Lynde	530-941-4600	IA A/G TAC		169.1125		
HEBM: Jael Constantino Nervino	307-351-3296	Stead Deck	168.350 T-5			
HEBM: Roger Caballero Stead	909-815-0714	Nervino Deck	163.100 T-5		UAS	UR-32 - Edmond Yue - 304-908-9085
HEBM(T) Kenny Smith	530-575-1302					

9. HELICOPTERS (Use Additional Sheets As Necessary)

FAA N#	TY	MAKE/MODEL	BASE	AVAIL	START	REMARKS	FAA N#	TY	MAKE/MODEL	BASE	AVAIL	START	REMARKS
2PJ	1	Black Hawk	Stead	0900	0830	CWN	3AC	1	S-64	Nervino	0900	0830	Exclusive Use
3FH	1	Black Hawk	Stead	0900	0830	Exclusive Use	H-538	2	S-54	Nervino	0800	0730	Exclusive Use
3BH	1	Fire Hawk	Stead	0900	0830	Exclusive Use	H-512	2	Kmax	Nervino	0900	0830	Exclusive Use
H-516	2	Bell 212 HP	Stead	0900	0830	Exclusive Use	H-553	3	Bell 205B++	Nervino	0800	0730	Exclusive Use
H-514	2	Bell 212 HP	Stead	0900	0830	Unavailable Mechanical	3JR	3	Bell 212 HP	Nervino	0900	0830	Unavailable Mechanical
7XL	3	Astar	Nervino	0900	0830	HLCO	H-553	3	Bell 407 HP	Nervino	0900	0830	Exclusive Use
H-509	3	Bell 209	Nervino	0900	0830	HLCO/ATGS	3JR	3	Bell 407?	Nervino	0900	0830	Exclusive Use
37S	1	S-64E	Nervino	0900	0830	Exclusive Use							
73U	1	S-61	Nervino	0900	0830	CWN							

10. TASK/MISSION/ASSIGNMENT (Type/Function includes: Air Tactical, Retardant, Recon, Personnel Transport, Water Dropping, S&R, etc.)

TYPE/FUNCTION	NAME OF PERSONNEL OR CARGO (if applic) OR INSTRUCTIONS FOR TACTICAL AIRCRAFT	MISSION START	FLY FROM	FLY TO
Water drops per request				
Recon Flights per request				
Cargo / Slings				
Ops Recon				
Herlong Resources For Doyle Camp	A-169 Mobile Retardant Base - 14 people, Watertenders E-285, E-278, E-266, E-225 for 4 people			

Beckwourth Complex – Safety Message

INCIDENT #CA-PNF-001064

DATE: 07-17/18-2021 TIME: 0600-0600 Day/Night Shift

Foot Travel in Steep Terrain

- When walking through steep and rocky terrain, watch footing and maintain proper spacing.
- Identify safe routes and local conditions.
- Test and use secure footing.
- Watch for over-head hazards, carry tools on downhill side, and wear gloves.

Treat "hot spots" on feet before they become blisters.

General Safety Concerns

- **Driving-** Predictable is preventable. Speeding=Accident. Slow down and keep an eye out for wildlife and civilians.
- **Wildlife-** Bees are becoming an issue. Avoid when possible and know the Medical Plan (ICS 206) in the event of an incident. Know your people, are any of them allergic?
- **Stump Holes-** Lots of stump holes are out there. Use your tools to probe in front as you walk.
- **Dehydration** - It can take it's toll. So drink lots of **WATER**. Strive to drink 2 quarts per hour during heavy exertion.

HUMAN FACTOR BARRIERS TO SITUATIONAL AWARENESS

- **Fatigue**
 - Carbon Monoxide
 - Dehydration
 - Heat Stress
 - Fitness Level
 - 24-hrs awake affects your decision making like 0.1 blood alcohol content
- **Hazardous Attitude**
 - Invulnerability
 - Anti-Authority
 - Impulsive
 - Over confident
 - Complacent
 - Resigned
- Afraid to speak up, or disagree

Communication Responsibilities

All firefighters have five communication responsibilities:

1. Brief others as needed
2. Debrief your actions
3. Communicate hazards to others
4. Acknowledge messages
5. Ask if you don't know

Prepared by;

CIIMT #4 Safety Group



INCIDENT RISK ANALYSIS

ICS (215A) DAY SHIFT

BR/DV	HAZARDOUS ACTIONS – CONDITIONS	MITIGATIONS – WARNINGS – REMEDIES
ALL	TRAFFIC HAZARDS AND DRIVING	<ul style="list-style-type: none"> Travelers on Highway 395 often exceed the posted speed limit. Take extra precaution when entering or exiting the Highway. During high fire activity, expect drivers to pull over or drive through the area slower. Practice "Defensive Driving" techniques. Maintain high visibility when in the operational area, use warning lights when working on roads or traveling in smoke. Best practice is to follow California DOT standard with high vis vest where appropriate Many roads are narrow and mid-slope, with soft shoulders. Allow heavy vehicles to pass on uphill side. Use spotters when backing or turning around. 5mph speed limit in and around ICP, keep your speed down in all areas. Drive at or below posted speed limits Use warning lights when working on roads or traveling in smoke. Use chock blocks, turn wheels into hill. Be alert for wildlife. Dusk to Dawn pose the greatest potential for accidents.
ALL	STEEP TERRAIN & ROLLING DEBRIS	<ul style="list-style-type: none"> Maintain 8'-10' spacing when working & walking. Do not work above any personnel. Evaluate necessity to send personnel in areas with limited access.
ALL	INDIRECT LINE CONSTRUCTION	<ul style="list-style-type: none"> Establish and maintain LCES. Utilize favorable locations when constructing control features; IE lighter fuels, natural or existing barriers and ridgelines
ALL	AIR OPERATIONS	<ul style="list-style-type: none"> Follow "Aviation Watch-Out Situations" on page 46, IRPG. Do not plan on air resources for tactical support or medical transportation. Refer to page 58, IRPG for directing bucket drops. Ensure positive communication with all air resources.
ALL	FIRE BEHAVIOR	<ul style="list-style-type: none"> Are you seeing what we have predicted? Conduct thorough assessments before starting work. Ensure LCES is in place. Plan & communicate your exit strategy with your crew and adjacent resources. Provide additional briefing for new resources and maintain communications.
ALL	NIGHT OPERATIONS	<ul style="list-style-type: none"> Have a purpose for where you drive and what you do. Don't rush into assignments. Use caution where you park or stage, especially in steep timbered areas. Use available time for briefings on roads, terrain, and potential rolling material, especially if the resources are new to the area. Increase SA by trying to see the work area during daylight hours. Use glow sticks to mark hazards, and ensure personnel have headlamps.
ALL	COMMUNICATIONS	<ul style="list-style-type: none"> Share your Situational Awareness (hazards, changes, etc.) to those who also have a need. Answer questions when asked by others. Ask for intel when you do not know the plan. Ensure all personnel are familiar with the incident and IA communications plans.
ALL	HEAT RELATED ILLNESS	<ul style="list-style-type: none"> Drink 2 to 1 water to sports drinks. Take frequent breaks, minimum of 10 minutes every hour. Recognize symptoms of HEAT RELATED ILLNESS which include low energy, cramping, headaches, dizziness, poor rest, poor eating habits, hot skin, and lack of sweating.
ALL	HAZARD / DANGER TREES	<ul style="list-style-type: none"> Follow Hazard Tree Safety Guidelines (IRPG p.22.) Limit number of personnel around snags and their exposure time. Fallers must be qualified for the trees being felled. Be alert around hazard trees during wind events, even green trees. The hazard zone extends a minimum of 2½ tree lengths. Avoid parking vehicles or taking breaks under or near hazard trees.
ALL	WILDLAND URBAN INTERFACE OPERATIONS	<ul style="list-style-type: none"> Maintain continuous Situational Awareness based upon the fire environment, observed fire behavior, hazards and incident objectives. Key to success in the WUI is preparation and preplanning. Be active and engage in defense preparations & do not wait for the fire to arrive. Be decisive in tactical engagement. Know when to engage or not. Establish management decision points, Safety Zones, TRA's, and Escape Routes.

INCIDENT NAME:

BECKWORTH COMPLEX

OPERATIONAL PERIOD: 0600 – 0600

JULY 17/18, 2021

Date/Time Prepared: 07/16/2021 – 1130



1. Incident Name				2. Operational Period							
Beckwourth Complex Medical Plan				Date/Time: 7/17-18/2021 (0600-0600)							
3. Medical Aid Stations / Ambulance Services / REMS											
Name		Location		Frequency		Advanced Life Support (ALS) Yes No					
Plumas 12 Ambulance		DP-55/ ICP Night (Available)		Beckwourth Command		X					
Chester 4x4 Ambulance		DP-35 (10:00-22:00)		Beckwourth Command		X					
Mountain Medics 4x4 Ambulance 1		DP-15 Day		Beckwourth Command		X					
Mountain Medics 4x4 Ambulance 4		Branch IV / Doyle 24 Hours		Beckwourth Command		X					
Frontline Medical Trailer		ICP / Doyle Camp				X					
4. Air Rescue / Air Ambulance Services											
Name		Location		Type of Aircraft & Capability							
Care Flight 4		Beckwourth		ALS, 24 Hours							
Care Flight 3		Truckee		ALS, 24 Hours							
CHP H14 / H16		Redding		ALS, Hoist, Day Only							
Washoe County Sheriff		Reno		Hoist, 24 Hours							
Air National Guard 822		Stead / Reno		ALS, Hoist 1800-0600 (Ground Contact USE CALCORD)							
5. Hospitals (all times estimated from incident location)											
Name & Level		GPS Datum – WGS 84 Degrees Decimal Minutes		Travel Time (From ICP)		Phone		Helipad		Address	
				Air	Gnd			Yes	No		
Eastern Plumas Health Care		Lat:	N 39° 48.33'	5	10	530-832-6500		X	500 1 st Ave, Portola CA		
		Long:	W 120° 27.77'	MINS	MINS						
Plumas District Hospital (Level 4)		Lat:	N 39° 56.4115'	5	40	530-283-7110	X	1065 Bucks Lake Rd Quincy, CA			
		Long:	W 124° 08.800'	MINS	MINS						
Banner Lassen Medical Center		Lat:	N 40° 24.45'	10	90	530-252-2000	X	1800 Spring Ridge Dr. Susanville, CA			
		Long:	W 120° 39.73'	MINS	MINS						
Renown Medical Center (Level 2)		Lat:	N 39° 31.52'	20	50	775-982-2005	X	1156 Mill St Reno, NV			
		Long:	W 124°05.45'	MINS	MINS						
St. Mary's Regional Medical Center		Lat:	N 33°46.82'	20	50	775-770-3000	X	235 W 6 th St. Reno, NV			
		Long:	W 118°11.17'	MINS	MINS						
U.C. Davis Medical Center (Level 1 Trauma/Burn)		Lat:	N 38°33.32'	45	3	916-703-6576	X	2315 Stockton Blvd. Sacramento, CA.			
		Long:	W 121°27.35'	MINS	HRS						
6. Division / Crew Emergency Pre-Plan								<i>Update and discuss with assigned resources daily.</i>			
Fireline EMT / Medic's Division / Branch Location											
Air Hoist site location site: Lat: / Long: / Elevation:											
Helispot: Lat: / Long: / Elevation:											
MED LZ:											
7. Prepared By (Medical Unit Leader)				8. Date/Time		9. Reviewed By (Safety Officer)		10. Date/Time			
MEDL Eric Williams / Doug Stuart <i>[Signature]</i>				7/16/2021 1600		SOF1 Dan Snow <i>[Signature]</i> <i>Write Memoirs for Snow</i>		07/16/2021 1600			



Medical Incident Report

FOR A **NON-EMERGENCY INCIDENT**: WORK THROUGH CHAIN OF COMMAND TO REPORT AND TRANSPORT INJURED PERSONNEL AS NECESSARY.

FOR A **MEDICAL EMERGENCY**: IDENTIFY ON SCENE INCIDENT COMMANDER BY NAME AND POSITION AND ANNOUNCE **"MEDICAL EMERGENCY"** TO INITIATE RESPONSE FROM COMMUNICATIONS

Use the following items to communicate situation to communications/dispatch.

1. CONTACT COMMUNICATIONS / DISPATCH (Verify correct frequency prior to starting report)

Ex: "Communications, Div. Alpha. Stand-by for Emergency Traffic."

2. INCIDENT STATUS: Provide incident summary (including number of patients) and command structure.

Ex: "Communications, I have a Red priority patient, unconscious, struck by a falling tree.

Requesting air ambulance to Forest Road 1 at (Lat./Long.)

"This will be the Trout Meadow Medical Incident, IC is TFLD Jones. EMT Smith is providing medical care."

Severity of Emergency AND Transport Priority (priority 1, 2, 3)	<input type="checkbox"/> RED / PRIORITY 1 Life or limb threatening injury or illness. Evacuation need is IMMEDIATE <i>Ex: Unconscious, difficulty breathing, bleeding severely, 2° – 3° burns more than 4 palm sizes, heat stroke, disoriented.</i> <input type="checkbox"/> YELLOW / PRIORITY 2 Serious Injury or illness. Evacuation may be DELAYED if necessary. <i>Ex: Significant trauma, unable to walk, 2° – 3° burns not more than 1-3 palm sizes.</i> <input type="checkbox"/> GREEN / PRIORITY 3 Minor Injury or illness. Non-Emergency transport <i>Ex: Sprains, strains, minor heat-related illness.</i>
Nature of Injury or Illness & Mechanism of Injury	Brief Summary of Injury or Illness (Ex: Unconscious, Struck by Falling Tree)
Transport Request	Air Ambulance / Short Haul/Hoist Ground Ambulance / Other
Patient Location	Descriptive Location & Lat. / Long. (WGS84)
Incident Name	Geographic Name + "Medical" (Ex: Trout Meadow Medical)
On-Scene Incident Commander	Name of on-scene IC of Incident within an Incident (Ex: TFLD Jones)
Crew Patient Care	Name of Care Provider (Ex: EMT Smith)

3. INITIAL PATIENT ASSESSMENT: Complete this section for each patient as applicable (start with the most severe patient)

Patient Assessment: (IRPG PAGE 106)	Age:	Weight:	Chief Complaint:
Skin Signs: (color/moisture/temp)	Level of Consciousness:	BP:	HR: Respirations:
Treatment:			

4. TRANSPORT PLAN:

Evacuation Location (drop point, intersection, helispot, Lat. / Long, hazards)	Patient's ETA to Location:
--	----------------------------

5. ADDITIONAL RESOURCES / EQUIPMENT NEEDS:

Paramedic / EMT - Crews - Immobilization Devices - AED - Oxygen - Trauma Bag - IV/Fluid(s) - Splints - Rope rescue - Wheeled litter - HAZMAT - Extrication

6. COMMUNICATIONS: Identify State Air/Ground EMS Frequencies and Hospital Contacts as applicable

Function	Channel Name/Number	Receive (RX)	Tone/NAC *	Transmit (TX)	Tone/NAC *
COMMAND					
AIR-TO-GRND					
TACTICAL					

7. CONTINGENCY: Considerations: If primary options fail, what actions can be implemented in conjunction with primary evacuation method?
Be thinking ahead.

8. ADDITIONAL INFORMATION: Updates/Changes, etc.

REMEMBER: Confirm ETA's of resources ordered. Act according to your level of training
Be Alert - Keep Calm - Think Clearly - Act Decisively

*** Follow up with MEDL upon return to ICP ***



INCIDENT RADIO COMMUNICATIONS PLAN		Incident Name BECKWOURTH COMPLEX, CA-PNF-001064				Date/Time 7/17/2021		Operational Period Date/Time 0600-0600 HRS	
Ch #	Function	Channel Name/Trunked Radio System Talkgroup	Assignment	RX Freq	RX Tone/NAC	TX Freq	Tx Tone/NAC	Remarks	
1	COMMAND	NIFC C5	ALL DIVISIONS	169.7500	CSQ	167.1000	146.2	Dixie L.O. all repeaters linked to ICP	
2	COMMAND	NIFC C12	ALL DIVISIONS	173.0375	CSQ	167.3250	146.2	Smith Mt. all repeaters linked to ICP	
3	COMMAND	NIFC C8	ALL DIVISIONS	169.5375	CSQ	164.7125	146.2	Black Mt. all repeaters linked to ICP	
4	COMMAND	NIFC C30	ALL DIVISIONS	171.1125	CSQ	162.1875	146.2	Stateline all repeaters linked to ICP	
5	COMMAND	NIFC C31	ALL DIVISIONS	173.0250	CSQ	163.8250	146.2	Chilcoot Summit all repeaters to ICP	
6	TACTICAL	TAC 6	DIV A, N	165.3625	146.2	165.3625	146.2		
7	TACTICAL	TAC 7	DIV C/E/G	168.0500	146.2	168.0500	146.2	CONTINGENCY BRANCH	
8	TACTICAL	TAC 8	DIV I	168.6000	146.2	168.6000	146.2		
9	TACTICAL	TAC 9	DIV V, X/Z	166.7750	146.2	166.7750	146.2		
10	TACTICAL	TAC 10	DIV R/T	166.7250	146.2	166.7250	146.2		
11	COMMAND	PNF NET	INITIAL ATTACK	170.5500	CSQ	164.8750	167.9	TONE 7 - DIXIE MT. L.O.	
12	TACTICAL	NIFC T2	INITIAL ATTACK	168.2000	CSQ	168.2000			
13	TACTICAL	CALCORD	MEDICAL COORDINATION	156.0750	156.7	156.0750	156.7	ALL DIVISIONS	
14	AIR TO GROUND	A/G CMD	A/G CMD	169.2875	CSQ	169.2875		ALL DIVISIONS	
15	AIR TO GROUND	A/G TAC	A/G TAC	167.0625	CSQ	167.0625		ALL DIVISIONS	
16	TACTICAL	GUARD 9	EMERGENCY ONLY	168.6250	CSQ	168.6250	110.9	ALL DIVISIONS	
Prepared By (Communications Unit)		BONILLA, MAGUIRE, COML 530-832-0211 ext 4140		LAST CLONE 7/9		Incident Location: Portola, CA		County: Plumas Latitude, Longitude: N 49.1134, W120 28.6977	

7/16/2021 16:17

INCIDENT RADIO COMMUNICATIONS PLAN		Incident Name BECKWOURTH COMPLEX, CA-PNF-001064				Date/Time 7/17/2021	Operational Period Date/Time 0600-0600 HRS	
Ch #	Function	Channel Name/Trunked Radio System Talkgroup	Assignment	RX Freq	RX Tone/NAC	TX Freq	Tx Tone/NAC	Remarks
1	COMMAND	NIFC C5	ALL DIVISIONS	169.7500	CSQ	167.1000	146.2	Dixie L.O. all repeaters linked to ICP
2	COMMAND	NIFC C12	ALL DIVISIONS	173.0375	CSQ	167.3250	146.2	Smith Mt. all repeaters linked to ICP
3	COMMAND	NIFC C8	ALL DIVISIONS	169.5375	CSQ	164.7125	146.2	Black Mt. all repeaters linked to ICP
4	COMMAND	NIFC C30	ALL DIVISIONS	171.1125	CSQ	162.1875	146.2	Stateline all repeaters linked to ICP
5	COMMAND	NIFC C31	ALL DIVISIONS	173.0250	CSQ	163.8250	146.2	Chilcoot all repeater linked to ICP
6	TACTICAL	TAC 6	NIGHT DIV A/C, N	165.3625	146.2	165.3625	146.2	
7	TACTICAL	TAC 7	NIGHT DIV E/G	168.0500	146.2	168.0500	146.2	
8	TACTICAL	TAC 8	NIGHT DIV I	168.6000	146.2	168.6000	146.2	
9	TACTICAL	TAC 9	NIGHT DIV V/X/Z	166.7750	146.2	166.7750	146.2	
10	TACTICAL	TAC 10	NIGHT DIV R/T	166.7250	146.2	166.7250	146.2	
11	COMMAND	PNF NET	INITIAL ATTACK	170.5500	CSQ	164.8750	167.9	TONE 7 - DIXIE MT. L.O.
12	TACTICAL	NIFC T2	INITIAL ATTACK	168.2000	CSQ	168.2000		
13	TACTICAL	CALCORD	MEDICAL COORDINATION	156.0750	156.7	156.0750	156.7	ALL DIVISIONS
14	AIR TO GROUND	A/G CMD	A/G CMD	169.2875	CSQ	169.2875		ALL DIVISIONS
15	AIR TO GROUND	A/G TAC	A/G TAC	167.0625	CSQ	167.0625		ALL DIVISIONS
16	TACTICAL	GUARD 9	EMERGENCY ONLY	168.6250	CSQ	168.6250	110.9	ALL DIVISIONS
Prepared By (Communications Unit)				Incident Location: Portola, CA				
BONILLA, MAGUIRE, COML 530-832-0211 ext 4140 LAST CLONE 7/9				County: Plumas				Latitude, Longitude: N 49.1134, W120 28.6977

7/16/2021 22:23

FINANCE MESSAGE

Finance is now accepting electronic submission of
CTR's and Shift Tickets via email

Scan & Email your signed documents to:

2021.Beckwourth.finance@firenet.gov

****NOTE: YOUR DOCUMENTATION MUST BE
AN ATTACHMENT, AND NOT EMBEDDED IN
BODY OF THE EMAIL****

Install PDF Scanner app below by scanning QR with phone camera

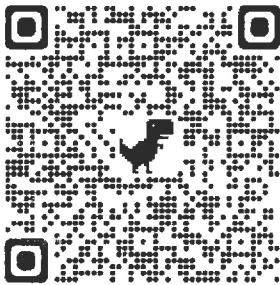

Android

Set subject line
to TIME when
sending email

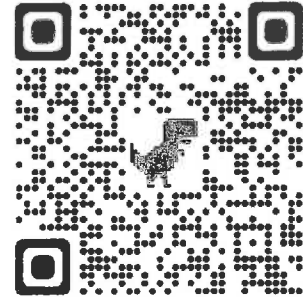

iPhone/iOS

Be sure to check in with Finance as close to
when you arrive as possible!

Stay safe out there

Public Information

General info line: 530-330-5650

Email: 2021.beckwourthcomplex@firenet.gov

www.facebook.com/USFSPlumas

www.facebook.com/LassenNF

Doyle/Susanville Area Media and Public Interest

Refer to Doyle ICP Information Office

Melanie Banton - 352-231-9276

Lisa Cox – 909-659-5835

Lost and Found: Portola and Doyle Information

Fire videos and photos wanted!

Firefighters must have proper PPE.

Hold camera sideways for best video.



Human Resource Message

Andrea Cabida and Ben Wexler HRSP(t), We are the Human Resource Specialists assigned to the incident. As the Human Resource Specialists, we are available to incident personnel to provide work environment information and assist with conflict resolution, if needed. If we can be of assistance to you, please let us know. You can contact Andrea by cell phone at 707-330-9939 or via e-mail at andrea.cabida@usda.gov. You can contact Ben at 707-980-2780 or via email at Benjamin.wexler@usda.gov. You can call, text, or email anytime.

As a reminder, we have a zero tolerance for illegal drugs, alcohol, sexual harassment, and any other type of inappropriate behavior. We expect all incident personnel to treat each other with dignity and respect, and to work as a team to support a positive work environment.

Be Safe! Keep your positive attitude and have a great day!

Hours are 0600 to 2200

Andrea Cabida- HRSP- 707-330-9939; andrea.cabida@usda.gov

Ben Wexler- HRSP(t)- 707-980-2780; benjamin.wexler@usda.gov



TRAINING SPECIALIST MESSAGE



Trainer / Mentors:

As of 7/18/21 there is no longer a Training Specialist assigned to this incident. If this changes you will be notified.

TRAINEES:

If you **ARE NOT** currently registered with the Training Specialist please make sure you get completed before you leave the incident the following from your trainer:

- **Signatures in your task book**
- **An evaluator record completed**
- **A completed 225 Personnel Evaluation**

• If you **ARE** currently registered with the Training Specialist, please contact me and I will process your training packet over the phone. You will need to text or email me the following information:

- **Completed ICS-225WF or ICS-226 Personnel Evaluation**
- **Evaluator record for incident**
- **Dates of your assignment, position held, and Trainer information**
- **Trainer information includes name, phone, home unit, email address**
- **Percentage of your task book that has been completed**

**Additional forms are available on-line @
<https://www.nwccg.gov/publications/ics-forms>.**

Emil Picchi
Training Specialist
(650)520-5102
TNSPEP@gmail.com



EXIT
INTERVIEW

Fire and COVID-19 Briefing Checklist

- Current Forest Service policy is that fully vaccinated individuals do not need to wear a mask or physically distance in federal buildings or on Federal lands, except where called for by Federal, State, local, tribal, or territorial laws, rules, and regulations.
- Masks are required on all federally managed incidents for individuals that are not fully vaccinated. Mask wearing requirements on incidents or in federal facilities should be consistent with CDC guidance.
- Any person that has COVID like symptoms listed below are required to contact their supervisor, supervisor should immediately separate the individual from others and contact the Medical Unit and/or COVID advisors.

Self-Awareness / Screening

- Notify supervisor if you or others experience:
 - Shortness of breath or difficulty breathing
 - New loss of taste or smell
 - Fever
 - Chills
 - Sore throat
 - Muscle pain
- Review and follow crew and division plans to isolate, triage, and transport symptomatic personnel.

SUPERVISOR:

Notify Medical Unit as soon as possible of any individual that show symptom and to arrange for a testing.

Send the employee needs to the Frontline Medical Unit for evaluation and testing.

If you are interested in getting a rapid COVID testing during your Demob process, please see Frontline medical

COVID Advisor Info

Francisco Rico (530) 913 6931

Allison Sanger (530) 218-7794

Chris Low (530) 927-8029

7/17/21

Demob List

CREW

C-43	0600	(HC1)	TEXAS CANYON IHC
C-24	0630	(HC1)	AMERICAN RIVER IHC
C-38	0700	(HC1)	VENTANA IHC
C-50	1600	(HC2)	MOUNTAINEER CONT 2

EQUIPMENT

E-41	0730	(ENG6)	ENG6 BRUSH 106
E-193	0800	(ENG3)	OES S/T 3800 A
E-241	0830	(ENG3)	OES S/T 4802 A
E-194	0900	(ENG3)	OES WTT1 OES 31
E-43	0930	(ENG6)	ENG6 CLEARWATER 62
E-319	1000	(ENG3)	NEVADA TF E-319
E-10	1030	(WTS2)	BENS
E-38	1100	(ENG3)	ENG3 J313
E-39	1130	(ENG3)	ENG3 J3 CONTRACTING
E-320	1230	(ENG3)	NEVADA TF E-320
E-321	1300	(ENG3)	E 4331
E-323	1330	(ENG3)	E 2432

OVERHEAD

O-291	1345	(SEC2)	DANIEL BELANGER
O-82	1415	(RADO)	BRYSON MARQUEZ
O-235	1430	(FOBS)	ROBERT BARRON
O-1.7	1200	(SOFR)	PAT DOTSON
O-1.4	1215	(SOFR)	DAN SNOW
O-1.8	1230	(PIO1)	MICHAEL FERRIS
O-312	1300	(TFLD)	JASON CAIN
O-313	1315	(TFLD)	BRANDON HANSEN
O-1.14	1330	(OSC1)	DAVID PEREIRA
O-1.15	1345	(OSC1)	JOE GONZALES
O-1.17	1400	(OSC2)	NICK BUNCH

7/18/21

Demob List

CREWS

C-69	0600	(HC1)	CRW2IA MS MSS #1
C-25	0630	(HC2I)	CRW2IA SHASTA LAKE
C-30	0700	(HC21)	R & R CONTRACTING

EQUIPMENT

E-40	0730	(ENG6)	ENG6 A-1 FIRE
E-9	0930	(STK)	SIERRA EARTHWORKS
E-14	1000	(PU)	MOULTRIE TRUCKING
E-36	1030	(ENG6)	ENG6 A-1 FIRE
E-72	1100	(ENG4)	ENG4 NAT WILDLAND FIRE
E-22	1130	(WTS1)	WTS1 OILAR
E-13	1200	(AMB)	PLUMAS AMBULANCE
E-6	1230	(ENG1)	BECKWOURTH FD
E-358	1300	(ENG3)	OMAR GONZALES

OVERHEAD

O-35	0615	(AOBD)	JOANN OVERACKER
O-26	1245	(TFLD)	DAVID RICHARD
O-49	1130	(TFLD)	KEVIN VALENTIN
O-112	1145	(TFLD)	JACOB BLEHM

7/19/21

Demob List

CREWS

C-2	0600	(CC)	DELTA 6 CAMP CREW
C-16	0630	(HC1)	CRW1 FULTON IHC
C-31	0700	(HC2)	BIRRUETA 1
C-32	0730	(HC2)	LAVA 5

EQUIPMENT

E-11	0800	(PU)	TRANSPORTATION PICKUP
E-35	0830	(ENG4)	ENG4 AUSTIN 47
E-53	0900	(ENG3)	ENG3 CAMINOS FIRE CAFS1 E
E-54	1000	(ENG3)	ENG3 ICEBURNS 29
E-73	1030	(ENG4)	ENG4 FIRE SUPPRESION
E-97	1100	(ENG6)	ENG6 THREE RIVERS 137
E-99	1130	(ENG4)	ENG4 ROC-N-R
E-100	1200	(ENG6)	ENG6 ARF 653
O-318	1230	(PIOF)	MICHAEL OBER
E-311	1300	(ENG3)	WFST 316
E-359	1330	(ENG4)	ROC-N-R E-6

OVERHEAD

O-1.59	0745	(DIVS)	PATRICK CALLAHAN
O-334	0815	(EQPM)	JAMES RICKARD
O-293	0845	(SEC2)	KELSEY ZAENGLE
O-67	1015	(HMGB)	JEFFREY DAVIDS
O-319	1115	(PIOF)	KIMBERLY KASCHALK
O-322	1215	(PIOF)	STEPHANIE BISHOP
O-1.59	1245	(DIVS)	PATRICK CALLAHAN

WEST ST.

SERVICE ROAD / ENTRANCE

OVERHEAD PARKING LOT

LOFR	FBAN	AV	LIASON	PIO
IC	IMET	PROD		

RESORS	SITL	
TRNG	GISS	
DEMOB	IT	
CHK-IN		
PLANS		

MEDICAL
CAL OES
COML
ORDM/SPUL

LOGS

HUMAN RESOURCES
AGENCY ADMIN
COVID SPC
READ

RM 2	RM 3
RM 1	RM 4

CLERICAL	REFER TRAILER	REFER TRAILER	HAND WASH
FINANCE	SAFETY	GYM	BRIEFING MEETINGS AREA
OPS			
SUPPLIES			LAUNDRY

OVERHEAD PARKING

CREW SLEEPING

FOOD

HAND WASH

SHOWERS

ENGINE PARKING

DOYLE CAMP

436-965 Susan Dr.
Doyle, CA

SLEEPING
AREA

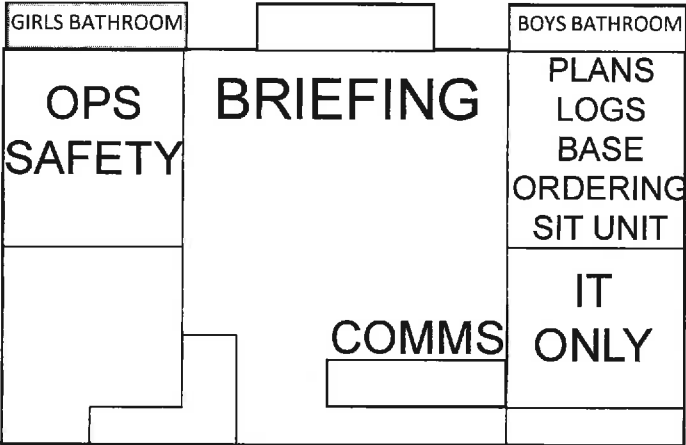
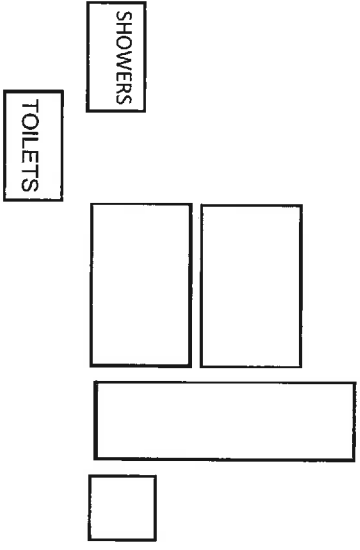

SUPPLY



REFER

TOILETS

TOILETS

OVERHEAD
PARKING

TOILETS

SUSAN DR.

TOILETS

FUEL ↑

RIG
PARKING

SLEEPING

SLEEPING

FRONTLINE
MEDICAL

TOILETS

This page left intentionally blank

