

# YUBA FIRE

## Incident Action Plan

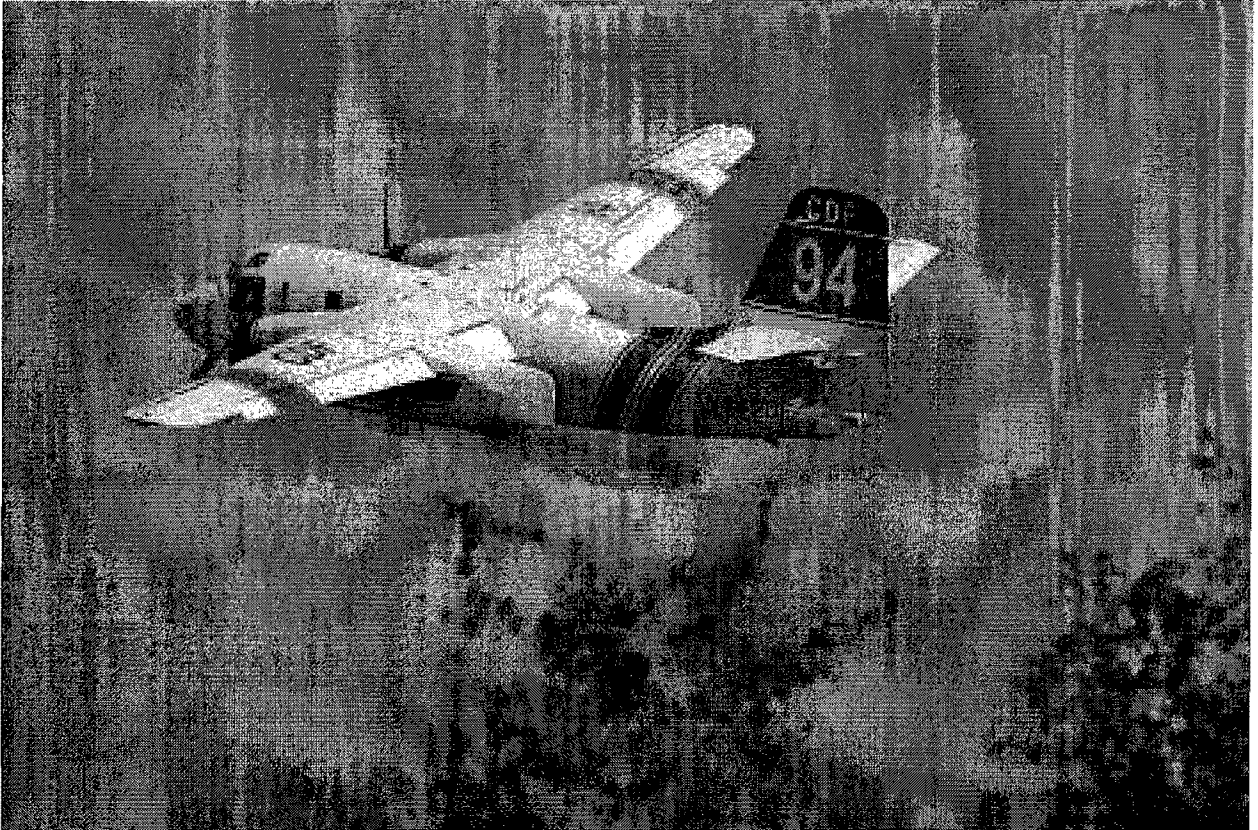

CA-NEU-16856

MONDAY  
August 17, 2009  
0600 - 0600

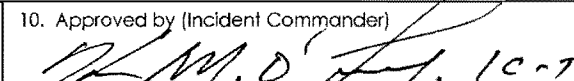
<b>INCIDENT OBJECTIVES</b>	1. Incident Name Yuba Fire	2. Date 8/16/09	3. Time 2000 hrs
4. Operational Period 8/17/09 – 0600 to 0600			
5. General Control Objectives for the Incident (include alternatives) <p>Management Objectives:</p> <ol style="list-style-type: none"> <li>1. Provide for the health and safety of the firefighters and the public.</li> <li>2. Minimize damage to improvements and the environment.</li> <li>3. Keep costs commensurate with values at risk.</li> <li>4. Work cooperatively with allied agencies.</li> </ol> <p>Control Objectives:</p> <ul style="list-style-type: none"> <li>• Keep the Fire North of San Juan Ridge</li> <li>• Keep the Fire South of Lake Francis and Marysville Road</li> <li>• Keep the Fire East of Rice's Crossing</li> <li>• Keep the Fire West of Pleasant Valley Road/Sebastopol Diggings/Chute Ridge.</li> </ul>			
6. Weather Forecast for Period See attached Spot Weather Forecast			
7. General Safety Message See attached Safety Message			
8. Attachments (mark if attached)			
<input checked="" type="checkbox"/> Organization List - ICS 203 <input checked="" type="checkbox"/> Medical Plan - ICS 206 <input checked="" type="checkbox"/> Weather Forecast <input checked="" type="checkbox"/> Div. Assignment Lists - ICS 204 <input checked="" type="checkbox"/> Incident Map <input checked="" type="checkbox"/> Fire Behavior Forecast <input checked="" type="checkbox"/> Communications Plan - ICS 205 <input type="checkbox"/> Traffic Plan <input checked="" type="checkbox"/> Air Ops Summary			
9. Prepared by (Planning Section Chief)		10. Approved by (Incident Commander) 	

## ORGANIZATION ASSIGNMENT LIST

<b>1. Incident Name</b>	
Yuba Fire	
<b>2. Date</b>	<b>3. Time</b>
8/16/09	2000 hrs
<b>4. Operational Period</b>	
8/17/09 0600-0600	
Position	Name
<b>5. Incident Commander and Staff</b>	
Incident Commander	Robert Lewin / Kevin O'Leary (T)
Deputy	Kelly Keenan
Safety Officer	Chris Cox / Walt Holloway (T)
Information Officer	Nick Schuler / Fernando Herrera / Greg McKeown (T)
Liaison Officer	Steve Negro / Greg Turner (T)
<b>6. Agency Representative</b>	
Agency	Name
CHP	Sgt. Scott Klocker
Yuba/Nevada S.O.	Lt. Jim Downs/Lt. Shannon Moon
USFS, TNF/PNF	Mike Cherry/John Estes
USFS, PNF	John Estes
PG&E	Ken McClure
Yuba County OES	Aaron Ward
Nevada County OES	Vic Ferrera
<b>7. Planning Section</b>	
Chief	Bruce Schofield / Mike Despain (T)
Deputy	Jeff Johnson
Resources Unit	Matt Conoscente (T) / Andy Murphy (T) / Dave Anderson (T)
Situation Unit	Buddy Bloxham / Ron Roberts (T) / Jeff Dapper (T)
Documentation Unit	
Demobilization Unit	Bill Smith / Jeff Adams (T)
Technical Specialists	
Training	Paul Melendrez
Fire Behavior Analyst	Chris Waters
IMET	Ryan Walbrun
<b>8. Logistics Section</b>	
Chief	Robert Michael / Geoff Pemberton (T)
Deputy	Frank Reilly
Supply Unit	Tim Stewart
Facilities Unit	Wendy Stuller
Ground Support Unit	Gary Phillips
Communications Unit	Scotty Preston / Chet Ashbaugh (T)
Medical Unit	
Hotel Tech	Milford Ferguson
Hired Equip Tech. Spec	Walt Williams/Henry Baker

<b>9. Operations Section</b>		
Chief	Brian Estes / Mark Brunton	
Deputy	Justin McGough	
Staging	Lake Francis Staging	
Staging	Bridgeport Staging	
<b>a. Branch I - Division/Groups</b>		
Branch Director	Fred Lopez	
Deputy		
Division/Group	Div A/B	Ken French
Division/Group	Div Z	Robert Sanders
Division/Group		
Division/Group		
Division/Group		
<b>b. Branch II - Division/Groups</b>		
Branch Director	Dave Russell	
Deputy		
Division/Group	Div C	Jason Morris
Division/Group	Div D	Mark Barr
Division/Group		
Division/Group		
Division/Group		
<b>c. Branch III - Division/Groups</b>		
Branch Director	Billy See	
Deputy		
Division/Group	Div L	Don Watt
Division/Group	Div M	Jeremy Hill
Division/Group		
Division/Group		
Division/Group		
<b>d. Air Operations Branch</b>		
Air Operations Branch Director	John Richardson	
Air Support Group	Travis Alexander	
Air Support Supervisor		
Helicopter Coordinator	Scott Upton / Randy Rapp	
Helibase Manager	Matt Stanford	
<b>10. Finance Section</b>		
Chief	Roger Raines	
Deputy		
Time Unit	Andrew Lorpuz / Richard Bruning (T)	
Procurement Unit	Rich Brocune	
Compensation/Claims Unit	Laura Germany	
Cost Unit	Terry Eastwood / Mara Zaver (T)	
Prepared by (Resource Unit Leader)		

# Yuba Fire Safety Message

August 17, 2009

## Major Hazards and Risks:

**WEATHER!!!!** Be aware of changing conditions and erratic winds. Review the weather forecast.

**ALWAYS** watch for **SNAGS**. Avoid them, flag them and report them so we can get them mitigated.

**Driving Safety:** Watch speeds on roads, there are tight turns, narrow roads and civilian traffic.

**FATIGUE, DEHYDRATION AND HEAT EXHAUSTION!!!** Get plenty of rest, watch for fatigue and mitigate, and follow proper hydration procedures.

## Key Points:

Poison Oak is abundant in the drainages. Watch for snakes, bees, and ticks.

Stump holes with hot ash can be found in all areas of the fire.

Mine Shafts may be found in all areas of the fire.

**ELECTRICAL SAFETY:** Watch out for power lines, treat them all as live. **BE CAREFUL** – Generators **MAY** back feed the system.

The Ten Standard Orders are **FIRM**. There is no compromise.

Every Crew: conduct **AND** document your tailgate safety message.

Establish and Maintain your LCES.

Each element needs to be established **AND** maintained throughout the shift, if LCES is compromised, mitigate it.

**LCES Topic of the Day:**

**E**

What is an escape route?

Do you have YOUR two escape routes planned?

Does your whole CREW know the escape route?

**Watchout topic of the day: #11**

Unburned fuel between you and the fire

Do you have lookouts?

Are you in communication with adjoining forces?

Have you scouted your section of line?

# SAFETY ALERT

## HEAT RELATED ILLNESS

### ***HEAT RELATED ILLNESS IS PREVENTABLE!!!!***

All personnel shall follow established guidelines.

Heat-induced illness is a result of the body's inability to cope with heat. This can be a minor symptom or a serious life-threatening injury. While recognition and treatment are important, prevention is the key.

Becoming acclimated to working in a hot environment takes time.

- It normally takes 4-8 days to acclimate
- Fatigue and alcohol consumption delays this process
- Persons not acclimated are at increased risk and can suffer heat-related illness at lower levels of heat and work activity

Personnel need to pre-hydrate before work and continuously hydrate during work.

- Water is the primary form of fluid replacement
- Before work, it is recommended to drink 20 ounces of sports drink
- During work drink 8 ounces of water every 15 minutes (1 Quart/hour)
- For every three water drinks, consume at least one electrolyte drink.
- Remember – After 6-8 hours of even good hydration, you must have **nutrition (carbohydrates) as well or the liquid will do you no good!**

### **Avoid Hyponatremia**

- Hyponatremia develops when the concentration of sodium is diluted in the bloodstream
- Exercise-induced hyponatremia occurs when this phenomenon is caused by excess water intake during exercise or work
- Proper nutrition and consumption of carbohydrate/electrolyte sports drinks as part of hydration will assist in avoiding hyponatremia
- Symptoms can include disorientation, headache, muscle cramps and nausea

### **Take Frequent Rest Breaks**

- Hydrate during the rest break
- Create improvised shade, get out of the sun
- Document your rest breaks

### **Avoid Certain Drinks**

- To help prevent dehydration, **AVOID** carbonated beverages and performance beverages such as Red Bull, Rock Star, Monster Drinks, etc.
- Caffeine hastens fluid loss in the urine.

INCIDENT ACTION PLAN SAFETY ANALYSIS											Incident Name Yuba Fire		Date: August 17, 2009		Time: 0600-0600					
LCES Analysis of Tactical Applications																				
Division	Indirect Fireline	Downhill Fireline	Underslung Fireline	Mid-Slope Fireline	Frontal Assault	Anchor Points	Extreme Conditions	Reburn Potential	Snags	Steep Terrain	Road Stability	LCES Mitigations	Predicted Wind Event	Transportation +1 hour	Communications	Structure Protection	Traffic on Roads	Power Lines	Other Risk Mitigations	
A/B		X		X				X	X	X	X	Use downhill line construction guidelines		X	X				X	Take adequate rest breaks/nutrition and hydrate
Z	X	X		X				X	X	X		Post Lookouts		X	X				X	Watch for traffic issues while driving
C	X	X		X			X	X	X	X		Ensure you have an escape route to a good safety zone w/lookouts		X	X	X			X	Make sure your communications is well established
D	X	X		X			X	X	X	X		Watch for weather changes		X	X	X			X	Avoid all powerlines
L	X	X		X			X	X	X	X		Flag, avoid, and report snags		X	X	X			X	
M	X	X		X			X	X	X	X		Structure Protection		X	X				X	

Prepared by: Chris Cox, SOF1, ICT #10

ICS 215A

## Fire Weather Forecast

FORECAST NO: 1

NAME OF FIRE: Yuba

PREDICTION FOR: 0600 Mon-0600 Tue

UNIT: CALFIRE-NEU-016586

SHIFT DATE: Aug 17-18th 2009

SIGNED:



TIME AND DATE

FORECAST ISSUED: 2100 8/16/09

Incident Meteorologist  
Ryan Walbrun

---

**WEATHER DISCUSSION:** Strong high pressure will build over the state today with continued warming and drying trend over the Yuba Fire. Winds will be primarily terrain driven down the canyons and along the Yuba River. However, the general wind flow will be Northeast in the morning and late night hours with West to Southwest in the afternoon and evening. The inversion will likely strengthen under the building High, keeping smoke and heat contained but should the fire build enough heat during a sustained slope run the inversion will break during the afternoon hours. Any firing operations should be cognizant of the tendency for up-canyon winds during the afternoon and possible strong down-canyons at night in Branch III along the Yuba River. Remember bends in the river are dangerous locations for wind eddies. Finally, during night Operations... expect strong thermal belts between 1000-2000 feet with little or no RH recovery and warm overnight temperatures.

---

**WEATHER FORECAST For Monday:**

...Continued Hot and Dry ...

**WEATHER:** Widespread smoke until midday... otherwise hazy sunshine.

**HIGH TEMPERATURES:** 90-100...locally cooler under dense smoke in Branch II and III

**MINIMUM HUMIDITY:** 12-19%

**20 FT WINDS:**

**RIDGETOP** – Northeast 4-8 mph with gusts 12 mph early...then West 3-6 mph gusts 10 mph in the afternoon.

**SLOPE/VALLEY** – Down-canyon 3-6 mph gust 10 mph til 11 am then turning up-canyon this afternoon.

**HAINES INDEX:** 3-4...stable airmass aloft. Low potential for plume dominated fire behavior.

**STABILITY/INVERSION:** Stable airmass. Inversion will be strong and likely only partially break by 1300. However should the inversion suddenly break expect extreme behavior.

---

**Monday Night:** Clear except areas of smoke settling into the canyons. Low 60-70. Min RH 30-40%...locally drier on the ridges above the Yuba River. Evening up-canyon winds to 8 mph becoming downcanyon 2-5 mph overnight. On the ridges West-Southwest to 10 mph in the evening turning Northeast 5-10 mph after midnight.

---

**EXTENDED FORECAST:** High pressure continues Tuesday and Wednesday with little overall change in the weather. Perhaps a hint of cooling by the end of the week with slightly stronger West-Southwest winds.

---

**Safety Thought:** Stay Hydrated. Heat related illnesses are cumulative.

---

**Observed Weather on Sunday:**

Reader Ranch RAWS at ~1893 feet: High 93 degrees Min RH 14% ...max gust 12 mph .

Bangor RAWS at 803 feet: High 95 degrees Min RH 15%...max gust 14 mph.

## FIRE BEHAVIOR FORECAST NO. 02

NAME OF FIRE: Yuba Incident CA-NEU-16856

PREDICTION FOR: Day/Night Shift

SHIFT DATE: 08/17/09 (Monday) TIME AND DATE FORECAST ISSUED: 08/16/09 2000 Hours

Signed: N. Chris Waters FBAN 

**Weather Summary:** High pressure will continue to build over the area bringing warmer temperatures and lower relative humidity. Nighttime inversions and resulting thermal belts will develop over the fire area and persist throughout the day. Expect northeast down canyon winds to support active burning over night.

**Fire Behavior General:** Fire spread is primarily surface spread supported by roll outs and uphill runs with occasional group and single tree torching accompanied by spotting. Fuels on the southerly aspects above the Yuba River are primarily heavy oak brush and scattered pockets of Grey and Ponderosa Pine. Northerly aspects are generally dominated by Sierra Mixed Conifer and Ponderosa Pine stands.

Terrain within the Yuba River Canyon is extreme with slopes close to the Yuba River well over 100%. These slopes will continue to support roll outs and hard slope runs – the dominate driver of fire behavior of this fire. Areas away from the river canyon present terrain and fuels conditions more suitable to suppression operations.

Nighttime easterly winds will continue to support active burning within thermal belts. Expect fire activity to show sudden increases over higher elevations as these winds surface. Well developed inversions will develop over night and persist throughout the day. Smokey conditions will continue to dampen fire behavior by blocking solar radiation to fuel beds. If the smoke clears, fire activity will increase significantly.

### Predicted PI (1600 Hrs.)

Clear Sky 90%

Under the Smoke 50%

### SPECIFIC:

Branch I: South Aspects. Grass and oak woodlands with scattered stands of timber and heavy brush. Fire activity has dropped off significantly with only the river canyon supporting active fire spread. River canyon slopes will continue to support roll out driven slope runs.

Branch II: South and West Aspect. Ponderosa Pine and mixed conifer timber stands and brush fields over steeper terrain. Fire continues to move up canyon during the day. Expect continued strong slope runs over the steeper portions of the Branch.

Branch III: North Aspect. Heavy mixed conifer timber stands. Fire will continue to make slope runs over the steeper slopes. Fire will generally moderate substantially upon reaching the top of the ridges.

**AVIATION OPERATIONS:** Heavy inversions in the morning with smoky conditions persisting most of the day.

**SAFETY:** Watch for strong slope runs originating from roll outs. This fire activity will continue for the entire shift. If the smoke clears expect sudden and extreme increases in fire behavior.



<b>DIVISION ASSIGNMENT LIST</b>		1. Branch I		2. Division/Group Division A/B			
3. Incident Name Yuba Fire		4. Operational Period Date: 8/17/09 Time: 0600 to 0600					
5. Operations Personnel							
Operations Chief		Brian Estes / Mark Brunton		Division/Group Supervisor		Ken French	
Branch Director		Fred Lopez		Air Attack Supervisor No.		John Richardson	
6. Resources Assigned this Period							
Strike Team/Task Force/ Resource Designator		Leader		Number Persons	Trans. Needed	Drop Off PT./Time	Pick Up PT./Time
S/T LNU 9145C (E-119)		BOB BARRON		20		LAKE FRANCIS STAGING/0800	
S/T XNA 2200C (E-121)		JEREMY LAWSON		18		" "	
CRW TMU OC 36 (C-10)		KRISTOPHER JAMES		22		" "	
CRW SHF 19B (C-8)		JOE LABERGE		20		" "	
CRW FCF 8A (C-44)		NICK LEE		20		" "	
CRW FCF 7C (C-48)		RAMIRO MENDOZA		20		" "	
W/T PVT ROMERO (E-112)		TOM ROMERO		2		" "	
W/T MAY WATER TENDER #238 (E-24)		JEFF FUENTES				" "	
7. Control Operations Mop-up and patrol 200' in from perimeter.							
8. Special Instructions Notify DIVS of any damage assessment needs.							
9. Division/Group Communication Summary							
Function	Frequency	System	Channel	Function	Frequency	System	Channel
Command	Tx: 167.1000 N Rx: 169.7500 N		CDF CMD-5	Logistics			
Tactical Div/Group	Tx: 164.1375 N Rx: 164.1375 N		NIFC TAC-4	Air to Ground	Tx: 168.5375 N Rx: 168.5375 N		Yuba A/G
Prepared by (Resource Unit Ldr.)		Approved by (Planning Sect. Ch.)			Date		Time

<b>DIVISION ASSIGNMENT LIST</b>			1. Branch I		2. Division/Group Division Z		
3. Incident Name Yuba Fire			4. Operational Period Date: 8/17/09 Time: 0600 to 0600				
<b>5. Operations Personnel</b>							
Operations Chief		Brian Estes / Mark Brunton		Division/Group Supervisor		Robert Sanders*	
Branch Director		Fred Lopez		Air Attack Supervisor No.		John Richardson	
<b>6. Resources Assigned this Period</b>							
Strike Team/Task Force/ Resource Designator		Leader		Number Persons	Trans. Needed	Drop Off PT./Time	Pick Up PT./Time
S/T ENG XLK 2100C (E-38)		MCCABE		17		A/B/Z BREAK / 0800 HRS	
S/T CRW NEU 9232G (C-32)		ART RODRIGUEZ		32		" "	
S/T CRW SKU 9261G (C-19)		MONTE WHIPPLE		36		" "	
CRW PVT DIAMOND (C-55)		JONATHAN ALVAREZ		20		" "	
CRW PVT FERGUSON NCC (C-45)		VICTOR HALEY		20		" "	
W/T PVT GOMES (E-111)		DARRYL GOMES		2		" "	
DZR PNF DOZER #3 (E-53)		DAVE WALL				" "	
7. Control Operations Mop-up and patrol 200' in from perimeter. Improve line and complete contingency line.							
8. Special Instructions Notify DIVS of any damage assessment needs.  Asterisk (*) denotes that 12 hours shift for DIVS.							
<b>9. Division/Group Communication Summary</b>							
Function	Frequency	System	Channel	Function	Frequency	System	Channel
Command	Tx: 167.1000 N Rx: 169.7500 N		CDF CMD-5	Logistics			
Tactical Div/Group	Tx: 151.1375 N Rx: 151.1375 N	Tone 156.7	V-TAC	Air to Ground	Tx: 168.5375 N Rx: 168.5375 N		Yuba A/G
Prepared by (Resource Unit Ldr.)		Approved by (Planning Sect. Ch.)			Date		Time

<b>DIVISION ASSIGNMENT LIST</b>		1. Branch II		2. Division/Group Division C			
3. Incident Name Yuba Fire		4. Operational Period Date: 8/17/09 Time: 0600 to 0600					
5. Operations Personnel							
Operations Chief	Brian Estes / Mark Brunton	Division/Group Supervisor	Jason Morris				
Branch Director	Dave Russell	Air Attack Supervisor No.	John Richardson				
6. Resources Assigned this Period							
Strike Team/Task Force/ Resource Designator	Leader	Number Persons	Trans. Needed	Drop Off PT./Time	Pick Up PT./Time		
S/T ENG XLK 2100C (E-38)		16		LAKE FRANCIS STAGING / 0800			
S/T ENG OES 2870C (E-123)	R. DICKINSON	22					
S/T CRW FKU 9475G (C-30)	BEN HUTCHISON	37					
CRW PNF PLUMAS IHC (C-15)	J. SEVELSON	20					
CRW TEF REDMOND IHC (C-7)	CHRIS BUHRIG	20					
W/T NSJ WATER TENDER 6191 (E-25)		2					
W/T FTL WATER TENDER 6591 (E-2)							
DZR TGU DOZER 2540 (E-91)	JOHN WILSON	2					
DZR BTU DOZER 2140 (E-134)	GARY HURLEY	2					
DZR SHF DOZER 29 (E-43)							
DZR SRF DOZER 4 (E-44)	L. TUPMAN	2					
DOZB JOHN WHITE (O-227)							
7. Control Operations Continue to hold and improve line. Mop-up 300' in from perimeter.							
8. Special Instructions Notify DIVS of any damage assessment needs.  FOBS GREEN/JULIN assigned to Branch II. SOFT OROSCO assigned to Branch II.							
9. Division/Group Communication Summary							
Function	Frequency	System	Channel	Function	Frequency	System	Channel
Command	Tx: 167.1000 N Rx: 169.7500 N		CDF CMD-5	Logistics			
Tactical Div/Group	Tx: 166.7250 N Rx: 166.7250 N		NIFC TAC-5	Air to Ground	Tx: 168.5375 N Rx: 168.5375 N		Yuba A/G
Prepared by (Resource Unit Ldr.)		Approved by (Planning Sect. Ch.)		Date		Time	

<b>DIVISION ASSIGNMENT LIST</b>		1. Branch II		2. Division/Group Division D			
3. Incident Name Yuba Fire		4. Operational Period Date: 8/17/09 Time: 0600 to 0600					
<b>5. Operations Personnel</b>							
Operations Chief		Brian Estes / Mark Brunton		Division/Group Supervisor Mark Barr			
Branch Director		Dave Russell		Air Attack Supervisor No. John Richardson			
<b>6. Resources Assigned this Period</b>							
Strike Team/Task Force/ Resource Designator	Leader	Number Persons	Trans. Needed	Drop Off PT./Time	Pick Up PT./Time		
S/T ENG XSA 4154C (E-124)	DEAN CROSS	22		DP #3 / 0800			
S/T ENG XYO 4276C (E-122)		20		" "			
S/T ENG XNE 4101C (E-29)	JERRY GOOD	19		" "			
S/T ENG XSJ 4175C (E-20)	NEELY			" "			
ENG PNF ENGINE #31 (E-10)	MIKE TYRELL	3		" "			
ENG TNF ENGINE #267 (E-35)				" "			
ENG TNF ENGINE #31 (E-10)	JEN WELLS			" "			
S/T CRW CZU 9174G (C-17)		29		" "			
S/T CRW LNU 9141G (C-33)	ROB THYARKS	33		" "			
CRW TNF TAHOE IHC (C-6)	WHITE	20		" "			
CRW TMU SLIDE MOUNTAIN (C-11)	CODY	18		" "			
DZR PVT ELLIOTT LOGGING (E-125)	DENNIS ELLIOTT	2					
DZR PVT A&F (E-41)	A. HOPKINS	2					
DZR PVT TAYLOR DOZER (E-129)							
DZR LNU DOZER 1448 (E-133)	JERRY WEISE	1					
W/T CTN WATER 6390 (E-26)							
W/T PVT PAUL WATER TENDER (E-113)							
7. Control Operations Continue to reinforce dozer and hand line. Prepare for firing operation.							
8. Special Instructions Notify DIVS of any damage assessment needs.  FOBS GREEN/JULIN assigned to Branch II. SOFT OROSCO assigned to Branch II.							
<b>9. Division/Group Communication Summary</b>							
Function	Frequency	System	Channel	Function	Frequency	System	Channel
Command	Tx: 167.1000 N Rx: 169.7500 N		CDF CMD-5	Logistics			
Tactical Div/Group	Tx: 166.7750 N Rx: 166.7750 N		NIFC TAC-6	Air to Ground	Tx: 168.5375 N Rx: 168.5375 N		Yuba A/G
Prepared by (Resource Unit Ldr.)		Approved by (Planning Sect. Ch.)		Date		Time	

<b>DIVISION ASSIGNMENT LIST</b>				1. Branch III		2. Division/Group Division L	
3. Incident Name <p style="text-align: center;">Yuba Fire</p>				4. Operational Period <p style="text-align: center;">Date: 8/17/09                      Time: 0600 to 0600</p>			
5. Operations Personnel							
Operations Chief		Brian Estes / Mark Brunton		Division/Group Supervisor		Don Watt	
Branch Director		Billy See		Air Attack Supervisor No.		John Richardson	
6. Resources Assigned this Period							
Strike Team/Task Force/ Resource Designator		Leader		Number Persons	Trans. Needed	Drop Off PT./Time	Pick Up PT./Time
S/T ENG RRU 9311C (E-172)		ANDREW BENNE		21		BRIDGEPORT STAGING / 0800	
S/T ENG SKU 9260C (E-50)		RON BRAVO		16		" "	
S/T CRW MMU 9470G (C-31)		GERALD JAY		35		" "	
S/T CRW SLU 9395G (C-29)		JEFF ELMORE		22		" "	
CRW ENF EL DORADO IHC (C-12)		WILLIAM HARRIS		21		" "	
CRW SRF SMITH RIVER (C-20)		GLEN TINGLEY		19		" "	
S/T DZR SCU 9161L (E-37)		JOEY FELIX		11		" "	
S/T DZR LNU 9142L (E-159)		PAUL FRANKLIN		5		" "	
W/T PVT NORTH TREE (E-3)		LAYNE		1		" "	
W/T PVT SOPPER WHEELER (E-22)		RON HAGUE		2		" "	
FOBS ROSS MILLER (O-118)						" "	
FOBS KEVIN DIXEN (O-212)						" "	
7. Control Operations Direct line construction and indirect line where necessary. Continue with contingency line.							
8. Special Instructions Notify DIVS of any damage assessment needs.  SOFT Tray Bair assigned to Branch III.							
9. Division/Group Communication Summary							
Function	Frequency	System	Channel	Function	Frequency	System	Channel
Command	Tx: 167.1000 N Rx: 169.7500 N		CDF CMD-5	Logistics			
Tactical Div/Group	Tx: 168.2500 N Rx: 168.2500 N		NIFC TAC-7	Air to Ground	Tx: 168.5375 N Rx: 168.5375 N		Yuba A/G
Prepared by (Resource Unit Ldr.)		Approved by (Planning Sect. Ch.)			Date		Time

<b>DIVISION ASSIGNMENT LIST</b>			1. Branch III		2. Division/Group Division M		
3. Incident Name Yuba Fire			4. Operational Period Date: 8/17/09 Time: 0600 to 0600				
5. Operations Personnel							
Operations Chief		Brian Estes / Mark Brunton		Division/Group Supervisor		Jerry Hill	
Branch Director		Billy See		Air Attack Supervisor No.		John Richardson	
6. Resources Assigned this Period							
Strike Team/Task Force/ Resource Designator		Leader		Number Persons	Trans. Needed	Drop Off PT./Time	Pick Up PT./Time
S/T ENG XME 2150C (E-39)		SHANE BURKE		19			
S/T ENG XSK 3200C (E-120)		CHRIS BAKER		17			
S/T ENG XPL 4127C (E-40)							
S/T ENG TNF 4660C (E-17)		BUELL		26			
S/T CRW CZU 9175G (C-18)							
S/T CRW TUU 9473G (C-16)							
CRW WWF LA GRANDE IHC (C-25)		B BUSH		16			
CRW SHF SHASTA LAKE (C-39)		JEFF MICHEL		18			
CRW ENF IRON MOUNTAIN (C-9)		BRAD STEWART		21			
CRW PVT FERGUSON 19B (C-8)		JOE LABERGE		20			
S/T DZR LNU 9147L (E-83)		RYAN ALLBAUGH		7			
S/T DZR TGU 9250L (E-36)				5			
DZR PVT MAJOR (E-126)		AL MAJOR		2			
DZR PVT WALLA (E-109)		J GAUNTT		2			
W/T PVT WAGONER (E-110)		D WAGONER		2			
W/T PVT NORTH TREE (E-4)		LAYNE		1			
FOBS SAM JOHNSON (O-274)							
FOBS(T) NATHAN OPIA (O-275)							
DOZB JOHN WARD (O-225)							
7. Control Operations Firing operations from Troost Road to Yuba River along dozer and handline.							
8. Special Instructions Notify DIVS of any damage assessment needs.  SOFT Tray Bair assigned to Branch III.							
9. Division/Group Communication Summary							
Function	Frequency	System	Channel	Function	Frequency	System	Channel
Command	Tx: 167.1000 N Rx: 169.7500 N		CDF CMD-5	Logistics			
Tactical Div/Group	Tx: 158.7375 N Rx: 158.7375 N	Tone 156.7	V-TAC 13	Air to Ground	Tx: 168.5375 N Rx: 168.5375 N		Yuba A/G
Prepared by (Resource Unit Ldr.)		Approved by (Planning Sect. Ch.)			Date		Time

<b>DIVISION ASSIGNMENT LIST</b>		1. Branch OPS		2. Division/Group Bridgeport Staging			
3. Incident Name <p style="text-align:center;">Yuba Fire</p>		4. Operational Period <p style="text-align:center;">Date: 8/17/09                      Time: 0600 to 0600</p>					
<b>5. Operations Personnel</b>							
Operations Chief	Brian Estes / Mark Brunton		Division/Group Supervisor				
Branch Director			Air Attack Supervisor No.	John Richardson			
<b>6. Resources Assigned this Period</b>							
Strike Team/Task Force/ Resource Designator	Leader	Number Persons	Trans. Needed	Drop Off PT./Time	Pick Up PT./Time		
S/T ENG OES 3800A (E-117)*	ADRIAN ROGERS	20					
S/T ENG XNE 4102A (E-27)*	MARK BUTTRON	21					
S/T ENG OES 4804A (E-144)*	JAY GLASS	22					
S/T ENG XSO 2350A (E-143)	JOHN JANSEN	21					
S/T ENG XBO 6820A (E-32)	RICK MC LINTOCK	21					
S/T ENG OES 4805A (E-118)**	THOMAS KEATING	20					
S/T ENG OES 0801A (E-115)							
DZR NEU DOZER 2340 (E-12)	BESOTES	2					
DZR NEU DOZER 2342 (E-13)	CLAY NORMAN	1					
DZR PVT NEVERKOVEC (E-127)	NEVERKOVEC	2					
7. Control Operations							
8. Special Instructions							
Asterisk (*) resources denote Initial Attack resources for local area response.							
Double Asterisk (**) denotes a resource dedicated to working with California State Park to protect the historic covered bridge only.							
<b>9. Division/Group Communication Summary</b>							
Function	Frequency	System	Channel	Function	Frequency	System	Channel
Command	Tx: 167.1000 N Rx: 169.7500 N		CDF CMD-5	Logistics			
Tactical Div/Group				Air to Ground			
Prepared by (Resource Unit Ldr.)		Approved by (Planning Sect. Ch.)			Date		Time

<b>DIVISION ASSIGNMENT LIST</b>			1. Branch OPS		2. Division/Group Francis Staging		
3. Incident Name Yuba Fire			4. Operational Period Date: 8/17/09 Time: 0600 to 0600				
5. Operations Personnel							
Operations Chief		Brian Estes / Mark Brunton		Division/Group Supervisor			
Branch Director				Air Attack Supervisor No.		John Richardson	
6. Resources Assigned this Period							
Strike Team/Task Force/ Resource Designator		Leader		Number Persons	Trans. Needed	Drop Off PT./Time	Pick Up PT./Time
S/T ENG XSU 3225C (E-160)*		PETE DAILEY		17			
S/T ENG OES 2801A (E-81)*		HANK SEGUIN		22			
ENG LRB ENGINE #61 (E-11)*		MIKE TOCHE		4			
S/T ENG OES 3801A (E-78)		JOHN BENNETT					
S/T ENG XSH 3150B (E-116)		JOHN BAUER		16			
S/T ENG OES 6800A (E-33)		JOHN MARTINEZ		24			
S/T ENG XNA 2201A (E-146)		DOUG GARSIDE		21			
S/T ENG XPL 4128A (E-145)		KEITH BURSON		21			
FALC STEVE PAGNI (O-71)							
FALLER PVT SOPPER WHEELER (O-78)							
FALLER PVT SOPPER WHEELER (O-79)							
FALLER PVT SPAR TREE (E-70)							
AMB PVT BI-COUNTY ALS AMB (E-107)		SUZANNE CRISS		2			
7. Control Operations							
8. Special Instructions  Asterisk (*) resources denote Initial Attack resources for local area response.							
9. Division/Group Communication Summary							
Function	Frequency	System	Channel	Function	Frequency	System	Channel
Command	Tx: 167.1000 N Rx: 169.7500 N		CDF CMD-5	Logistics			
Tactical Div./Group				Air to Ground			
Prepared by (Resource Unit Ldr.)			Approved by (Planning Sect. Ch.)			Date	Time

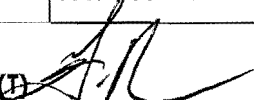

INCIDENT RADIO COMMUNICATIONS PLAN			Incident Name Yuba Fire			Date/Time Prepared 8-16-09			Operational Period Date/Time 0600-0600		
Ch #	Function	Channel Name/Trunked Radio System Talkgroup	Assignment	RX Freq	N or W	RX Tone/NAC	TX Freq	N or W	Tx Tone/NAC	Mode A, D or M	Remarks
1											
2	Command	CMD 5	All Command	167.1000	N		169.7500	N	TONE 5		
3											
4	Tactical	NIFC TAC 4	Branch I, Div A,B	164.1375	N		164.1375	N			
5	Tactical	V-TAC	Branch I, Div Z	151.1375	N		151.1375	N	156.7		
6	Tactical	NIFC TAC 5	Branch II, Div C	166.7250	N		166.7250	N			
7	Tactical	NIFC TAC 6	Branch II, Div D	166.7750	N		166.7750	N			
8	Tactical	NIFC TAC 7	Branch III, Div L	168.2500	N		168.2500	N			
9	Tactical	V-TAC 13	Branch III, Div M	158.7375	N		158.7375	N	156.7		
10											
11	NEU West	NEU West	Unassigned	151.3250	W		159.3600	W			Assigned pending dispatch
12	EMS	CALCORD	All Div's	156.075	W		156.075	W			
13	Air- Ground	YUBA A/G	All Div's	168.5375	N		168.5375	N			
14	Emergency	AIR GUARD	All Div's	168.6250	N		168.6250	N	110.9		Emg. contact with aircraft
15											
16	Emergency	AIR GUARD	All Div's	168.6250	N		168.6250	N	110.9		Emg. contact with aircraft
Prepared by (Communications Unit) Scott Preston COML (T) Chet Ashbaugh COML (T) 						Incident Location County _____ State _____ Latitude _____ N Longitude _____ W					

The convention calls for frequency lists to show four digits after the decimal place, followed by either an "N" or a "W", depending on whether the frequency is narrow or wide band. Mode refers to either "A" or "D" indicating analog or digital (e.g. Project 25) or "M" indicating mixed mode. All channels are shown as if programmed in a control station, mobile or portable radio. Repeater and base stations must be programmed with the Rx and Tx reversed.

<b>MEDICAL PLAN</b>	1. INCIDENT NAME <b>Yuba</b>	2. DATE PREPARED 8/16/09	3. TIME PREPARED 1900	4. OPERATIONAL PERIOD 8/17/09 0600 - 0600				
<b>5. INCIDENT MEDICAL AID STATION</b>								
MEDICAL AID STATIONS	LOCATION			PARAMEDICS				
				YES NO				
ICP	Medical Unit			<input type="checkbox"/> <input checked="" type="checkbox"/>				
				<input type="checkbox"/> <input type="checkbox"/>				
				<input type="checkbox"/> <input type="checkbox"/>				
				<input type="checkbox"/> <input type="checkbox"/>				
				<input type="checkbox"/> <input type="checkbox"/>				
<b>6. TRANSPORTATION</b>								
<b>A. AMBULANCE SERVICES</b>								
NAME	ADDRESS	PHONE	PARAMEDICS					
			YES	NO				
Bi-County Ambulance	Marysville Rd x Hwy 20	530-743-1893	<input checked="" type="checkbox"/>	<input type="checkbox"/>				
			<input type="checkbox"/>	<input type="checkbox"/>				
Cal-Star Air Amb.	Grass Valley Emergency Command Center	GV ECC	<input checked="" type="checkbox"/>	<input type="checkbox"/>				
Reach Air Amb.	Grass Valley Emergency Command Center	GV ECC	<input checked="" type="checkbox"/>	<input type="checkbox"/>				
			<input type="checkbox"/>	<input type="checkbox"/>				
<b>B. INCIDENT AMBULANCES</b>								
NAME	LOCATION			PARAMEDICS				
			YES	NO				
Bi-County Ambulance	Lake Francis Staging			<input checked="" type="checkbox"/> <input type="checkbox"/>				
			<input type="checkbox"/>	<input type="checkbox"/>				
			<input type="checkbox"/>	<input type="checkbox"/>				
			<input type="checkbox"/>	<input type="checkbox"/>				
<b>7. HOSPITALS</b>								
NAME	ADDRESS	TRAVEL TIME		PHONE	HELIPAD		BURN CENTER	
		AIR	GRND		YES	NO	YES	NO
Rideout Hosp.	726 4th Street, Marysville	15	40	530-749-4300	<input checked="" type="checkbox"/>	<input type="checkbox"/>	<input type="checkbox"/>	<input checked="" type="checkbox"/>
Sierra Nevada	155 Glassen Way, Grass Valley	10	30	530-274-6001	<input checked="" type="checkbox"/>	<input type="checkbox"/>	<input type="checkbox"/>	<input checked="" type="checkbox"/>
Enloe Med. Cntr	1531 Esplanade Circle, Chico CA	25	90	530-332-7330	<input checked="" type="checkbox"/>	<input type="checkbox"/>	<input type="checkbox"/>	<input checked="" type="checkbox"/>
UC Davis Burn	2315 Stockton Ave., Sacramento	20	60	916-734-3636	<input checked="" type="checkbox"/>	<input type="checkbox"/>	<input checked="" type="checkbox"/>	<input type="checkbox"/>
		<input type="checkbox"/>	<input type="checkbox"/>		<input type="checkbox"/>	<input type="checkbox"/>	<input type="checkbox"/>	<input type="checkbox"/>
<b>8. MEDICAL EMERGENCY PROCEDURES</b>								
<b>LINE EMERGENCY</b> Facilitated under the direction of Operations Section Chief								
<ul style="list-style-type: none"> <li>Crewmembers will immediately to notify their Supervisor of an injury. Supervisor will provide Branch/Division with patient complaint/condition and location, request line-EMT if assigned on their Branch/Division.</li> <li>If major Injury, Branch/Division will declare a medical emergency with the communication unit and will advise of nature of emergency, location of emergency, type of recommended transportation required (ground or air), and location for transportation to make patient contact.</li> <li>Communication Unit will clear command channel for emergency traffic only</li> <li>Branch/Division will notify Operations</li> <li>Communications and Operations will coordinate/direct the appropriate mode of evacuation/transportation.</li> <li>If minor injury, Branch/Division will arrange treatment/transport with Line EMT as available, or coordinate through communications with incident.</li> <li>Safety and Medical Unit will assist as needed to help mitigate the emergency. Ensure all notifications are made.</li> </ul>								
<b>IN-CAMP EMERGENCY</b>								
Contact the Communications Unit with patient complaint/condition and location. Medical Unit will respond as requested. Operations/Crew Supervisor, Safety, and Medical Unit Leader will be notified.								
9. PREPARED BY (MEDICAL UNIT LEADER)					10. REVIEWED BY (SAFETY OFFICER)			
					Walt Holloway, SOF1(T)			

**AIR OPERATIONS SUMMARY 220**

PREPARED BY: John Richardson

DATE: 8/16/2009

<b>1. INCIDENT NAME:</b> Yuba Fire	<b>2. OPERATIONAL DATE:</b> 08/17/2009	<b>SUNRISE:</b> 06:20	<b>SUNSET:</b> 19:56
<b>3. REMARKS</b> Safety Notes: Flight-Hazards, Other Hazards, Air Operations, and Special Equipment, etc.): Powerlines, Frequency management, Diverts, etc. Safety is the #1 concern, get clearance prior to entering a FTA.  Vineyard IP: N 39 19.832 W 121 14.046  Order FW/RW Aircraft through Operations to ATGS / HLCO. Sling load orders placed through the Communications Unit no later than 14:00 to ensure delivery.  Helibase(s) Name: Brownsville HB (F25) Lat./Long: N 39 27.233 W 121 17.375 Richard HB Lat. Long: N 39 18.959 W 121 14 .611		<b>4. AIR RESCUE AIRCRAFT:</b> C404  Activation Instructions: Request placed through ATGS	
		<b>5. TFR/91.137:</b>  Radius: 6 NM Altitude: 8,000 MSL Center Point: Latitude: 39 20.31 Longitude: 121 12.13	

<b>3a. Water Points:</b> Francis Dip N39 21.74 W121 12.26				<b>3b. Helispots:</b>				
6. PERSONNEL	Name	Telephone	Cellular	Pager	Fax	7. FREQUENCY	AM	FM
AOBD	John Richardson		805-903-3418			AIR TACTICS:		166.2750
ASGS	Travis Alexander		951-575-5513			AIR/AIR RW:	126.075	
						AIR/GROUND:		168.5375
ATGS	John Messina @ CIC	530 891-2911				COMMAND:	CDF CMD 5 Tone 5	
ATGS (Relief)	Kurt Chamberlin @ GOO	530 272-4952				COMMAND RPT:		
HEBM	Matt Stanford		951-545-8205			DECK:		163.1000
HLCO	Scott Upton		707 889-4375			TLOC:	132.675	
HLCO	Randy Rapp		530 200-2512			AIR/AIR Briefing	123.625	
AGENCY AIRCRAFT DISPATCH OFFICE	Grass Valley (Jennifer)	530 477-0641 137						
CIC ATB	ATBM	530 891-2911			530 895-6029			
GOO ATB	ATBM	530 272-4952			530 272-1112			
MCC VLAT ATB	ATS Perri Hall	951 368-4972			916 561-3354			
AGENCY AVIATION MILITARY LIAISON	Frank Podesta @ MHR		949 648-4548		916 843-3931			

**8. PERSONNEL ON ORDER:** ASGS-HEBM-ATGS-CWN Manager

**SEE INCIDENT RADIO COMMUNICATIONS PLAN (205) FOR ALL OTHER FREQUENCIES!**

9. FIXED WING:	Identifier	Base	10. ROTOR WING:	Identifier	Base
Air Attack(s): 2	AA210, AA230	210-Chico, 230-Grass Valley	Type		
Leadplane(s):			Helitanker(s):		
Tanker(s): 4			I: 6	5CH, 803,804,820,830,831	Redding Airport / Mt. Gate
I:			II: 3	C404, 5PJ, 7PJ	Benton/Hat Creek / Sugar Pine
II:			III: 2	38SH, 3185A	Benton/Hat Creek / Sugar Pine
III: 4			IV:		
VLAT Available upon Request	T88, T89, remainder TBD	Grass Valley			

**11. SPECIAL ASSIGNED EQUIPMENT:**  
**AIRCRAFT RESCUE FIRE FIGHTERS** , on site at helibase(s).  
**Helibase dust abatement Water Tender(s)**

**12. EQUIPMENT ON ORDER:** Crash Rescue, additional water tender

**13. TASKS/MISSION ASSIGNMENT** (Type/Function includes: Air Tactical, Helicopter Coordinator, Fixed Wing: Retardant, Rotor Wing: Helitanker: Retardant/Foam, Rotor Wing: Retardant and or Foam, Personnel & Cargo Transport, Dip Site Locations and Names, Initial Attack and Air Rescue Helicopters, and Other.

TYPE/FUNCTION	NAME OF PERSONNEL AND/OR CARGO INCLUDING INSTRUCTIONS FOR TACTICAL AIRCRAFT	MISSION START	FLY FROM	FLY TO
<b>Air Tactical</b>	Available from Chico AAB AA210	0800		
	Available from Grass Valley AA230	1000		
<b>Helicopter Coordinator</b>	Order from HB	0800		
<b>Fixed Wing: Retardant</b>	Order through ATGS Other resources DC-10 @ MCC	0800		
<b>Helitanker: Retardant/Foam</b>				
<b>Rotor Wing: Retardant/Foam</b>	Available from Brownsville Helibase, order through ATGS	0800		
<b>Recon/Plans</b>	Available @ Brownsville Helibase. Schedule through AOBD / ASGS. Plan for 09:00 / 11:00 / 13:00 / 15:00.			
<b>Personnel Transport</b>				
<b>Cargo Transport</b>	Helispots must be approved prior to delivery			
<b>Dip Site Names and Locations</b>	Coordinate with ATGS			
<b>Initial Attack Helicopter</b>	Order through Grass Valley Local	0800		
<b>Air Rescue Helicopter</b>	See Medical Plan			
<b>Other:</b>				



# **YUBA INCIDENT FINANCE MESSAGE MONDAY, AUGUST 17, 2009**



**FOR YOUR CONVIENENCE THE PERSONNEL & EQUIPMENT TIME UNITS ARE OPEN 0500 TO 2200.**

**THE ENTIRE FINANCE SECTION HAS MOVED TO THE WHITE TRAILERS BETWEEN FRANKLIN HALL (ICP) AND THE FEEDING AREA.**



**IF YOU ARE USING A MOTEL ARRANGED BY CAL FIRE, YOU MUST FOLLOW OUR MOTEL POLICY. EACH AND EVERY PERSON STAYING IN THE MOTEL MUST SIGN THE MOTEL ROSTER. EXAMPLE: IF THERE ARE 21 PEOPLE ON YOUR STRIKE TEAM THEN THERE NEEDS TO BE 21 INDIVIDUAL SIGNATURES, ONE PER LINE. FAILURE TO FOLLOW THE RULES WILL HELP YOU LOSE THIS VALUABLE SERVICE.**

**We are in the process of installing an internet connection so we can start using the E FC-33. Please make sure your E-Pay is showing the correct schedule. We will have E-Pay computer available near the ICP to help facilitate this.**

**Strike Team Leaders: Please use the attached FC-33 Update Sheet to assist us in updating your FC-33's.**

**Hired Equipment resources must have their shift tickets signed by the line supervisor – DIVS, BRANCH, STAGING.**

**Line Supervisors are responsible to verify accuracy on the shift tickets, CLEARLY sign & print your name, collect the shift tickets and TURN THEM IN to the Time Unit.**

**All Hired Equipment resources must come to the time unit and provide you rental agreements, etc. if you have not done so yet.**



**IF YOU HAVE ANY FINANCIAL PROBLEMS OR QUESTIONS PLEASE DO NOT HESITATE TO COME AND ASK US. EVEN LITTLE PROBLEMS ARE BEST AVIODED EARLY. IN MOST CASES WE CAN FIND A SOLUTION!**

**FC ROGER RAINES JR.  
COMMAND TEAM 10  
FINANCE SECTION CHIEF  
CELL: 951-712-1907**

Date: \_\_\_\_\_ Base/Camp Location: \_\_\_\_\_

Incident Number: \_\_\_\_\_ Req. # \_\_\_\_\_

Strike Team# or Equipment # \_\_\_\_\_

Assignment Division /Group: \_\_\_\_\_



<b>Equipment Radio #</b>						
<b>Milage</b>						
<b>Vehicle Pump</b>						
<b>Portable Pump</b>						
<b>Saw Hours</b>						
<b>Foam (Gallons)</b>						
<b>Transport Miles</b>						
<b>Dozer Hours</b>						
<b>Items not replaced from supply</b>						

\* ADVISE TIME UNIT OF ANY CHANGE IN PERSONNEL\*

# All Trainee's

---

The Training Specialists check-in has been establish in the building where Check in & Time are located.

All Trainee's & Trainer's need to check with us prior leaving for your assignment.

Our Hours will be 0600 – 1900

Please bring your Task books with you when you check-in

All Trainee's & Trainers need to check in with us at the end of each shift

Remember Training is the state of MIND

# DEMOBILIZATION PLAN YUBA FIRE CA-NEU-16856

## DEMOB PROCEDURES

- When your Name / Request number is posted on a Demob list, report to the Demobilization Unit.
- ***FOR STRIKE TEAMS: ONLY THE STRIKE TEAM LEADER NEEDS TO REPORT TO THE DEMOBILIZATION UNIT.***
- You must have your Order / Request number to begin the Demobilization process.
- Pickup Demobilization Checkout form (ICS-221) from the Demobilization Unit, and obtain the necessary Unit Leader sign-offs:
  - Supply Unit
  - Communications Unit
  - Ground Support/Vehicle Inspection(If Applicable)
  - Documentation Unit
  - Time Unit
  - Training Unit(If Applicable)
  - Accommodations(If Applicable)
- Return the completed Demobilization Checkout form (ICS-221) to the Demob Unit.



AGENCY	NAME	INCIDENT PHONE #	CELL PHONE #
Cal Fire ICT 10	Steve Negro, Liaison Officer		831-594-7934
Cal Fire ICT 10	Greg Turner, Liaison Officer (T)		909-816-7679
BLM	Jerry Martinez	(916) 941-3108	(916)212-3108
Cal EMA F&R	David Powell		916-952-5214
Ca. State Parks	Scott Elliott		(530) 525-9528
CCC	Bill Martinez	(530) 577-0850	(530) 545-0091
CDCR	Lt. Mark Micheels	(530) 265-4623	(530) 575-9422
CHP	Sgt. Scott Klocker		(530) 701-1980
Dept. Fish & Game	Sean Pirtle	(530) 749-1066	(530) 624-0848
Nevada Co. OES	Vic Ferrera	530-272-6389	530-913-0191
Nevada Co. S.O.	Lt. Shannon Moore	(530) 265-7880	(530) 913-5967
PG&E	Ken McClure		530-410-1623
PG&E	Chuck Stinnett		(209) 481-2142
Red Cross	Shelly Chernicki		(530) 330-1731
USFS, PNF	John Estes		530-394-8035
USFS, TNF	Michael Cherry	530-288-3231	530-277-6447
Yuba Co. OES	Aaron Ward		530-749-7520
Yuba Co. S.O.	Lt.. Jim Downs		530-682-8476
Yuba Co. Water	Steve Onkin	530-701-8979	530-701-8479

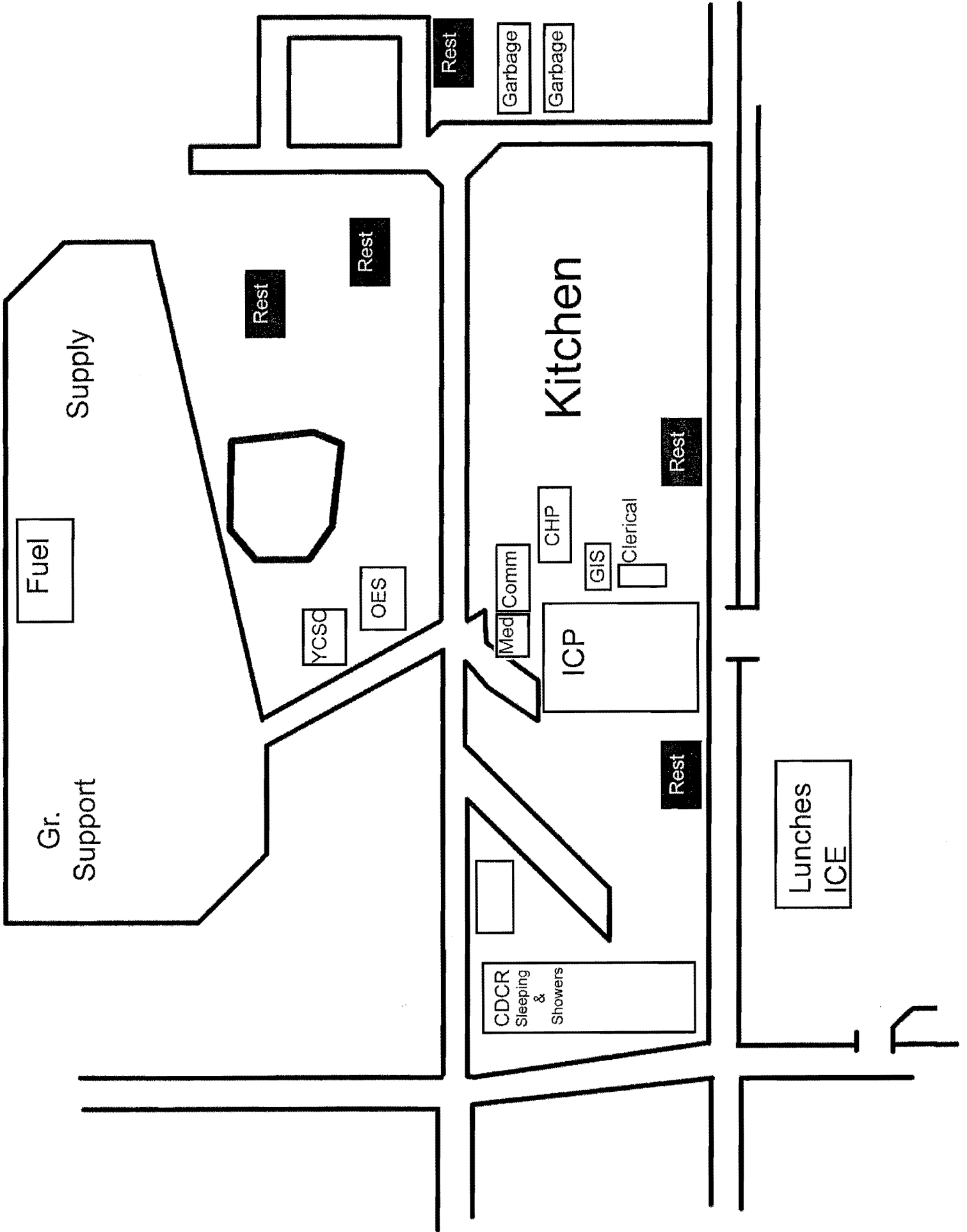

<b>UNIT LOG</b>	1. Incident Name	2. Date Prepared	3. Time Prepared
4. Unit Name/Designators	5. Unit Leader (Name and Position)		6. Operational Period
7. Personnel Roster Assigned			
<b>Name</b>	<b>ICS Position</b>		<b>Home Base</b>
8. Activity Log			
<b>Time</b>	<b>Major Events</b>		
9. Prepared by (Name and Position)			

