

# 2018 XSB JANUARY STORMS

CA-MTO-000071

## INCIDENT ACTION PLAN



### OPERATIONAL PERIOD

1/17/2018 0700

to

1/18/2018 0700



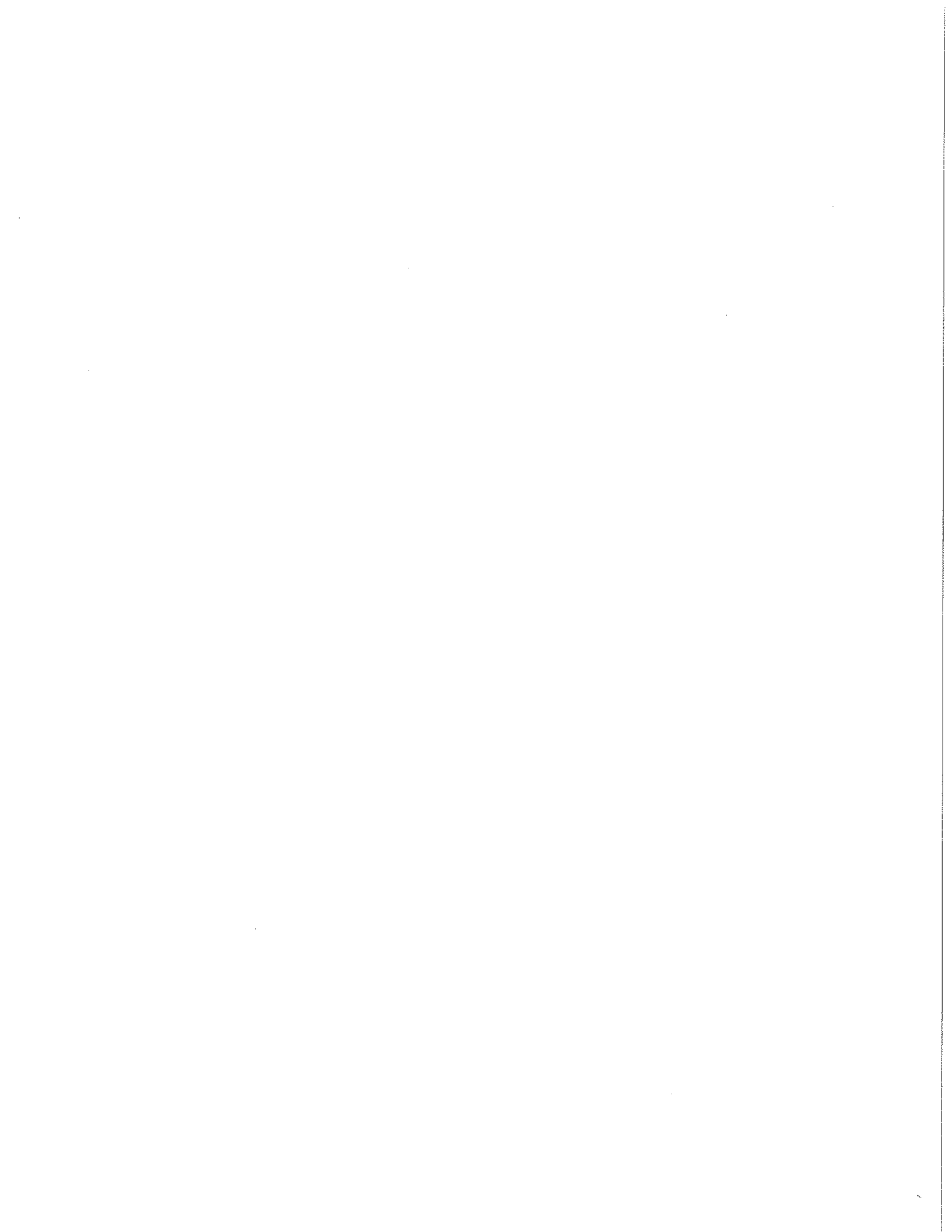

## INCIDENT OBJECTIVES (ICS 202)

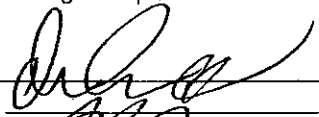
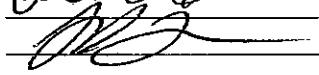
<b>1. Incident Name:</b> 2018 XSB JANUARY STORMS	<b>2. Operational Period:</b> Date From: 1/17/2018    Date To: 1/18/2018 Time From: 0700            Time To: 0700																					
<b>3. Objective(s):</b> <u>Management Objectives</u> <ul style="list-style-type: none"> <li>- Protect life, property, and the environment.</li> <li>- Provide for and maintain public and first responder safety by utilizing the incident safety analysis process.</li> <li>- Mitigate all threats to critical infrastructure and improvements, watershed, and historical assets.</li> <li>- It is the Unified Commander's Leader's Intent to ensure transparent, timely communication at all levels of the incident and to the affected communities.</li> <li>- Be financially responsible for all assigned management and debris flow/flood fight methods.</li> <li>- Foster and enhance community and political relationships.</li> <li>- All management actions and efforts will focus on serving and safeguarding the citizens and resources of Santa Barbara County.</li> </ul> <u>Control Objectives</u> <ul style="list-style-type: none"> <li>- Search for and recover victims of debris flows/flooding in the affected areas.</li> <li>- Render areas safe for restoration of essential services.</li> <li>- Enhance situational awareness in the areas impacted by the debris flows and flooding.</li> </ul>																						
<u>General Situational Awareness</u>        																						
<b>5. Site Safety Plan Required?</b> Yes <input type="checkbox"/> No <input checked="" type="checkbox"/>																						
<b>Approved Site Safety Plan(s) Located at:</b>																						
<b>6. Incident Action Plan</b> <table style="width: 100%; border: none;"> <tr> <td><input checked="" type="checkbox"/> ICS 203</td> <td><input checked="" type="checkbox"/> ICS 208</td> <td><input checked="" type="checkbox"/> Phone List</td> <td><input type="checkbox"/> Fire Suppression Repair Plan</td> </tr> <tr> <td><input checked="" type="checkbox"/> ICS 204</td> <td><input checked="" type="checkbox"/> ICS 215A</td> <td><input checked="" type="checkbox"/> Training Message</td> <td><input checked="" type="checkbox"/> CISD Message</td> </tr> <tr> <td><input checked="" type="checkbox"/> ICS 205</td> <td><input checked="" type="checkbox"/> ICS 220</td> <td><input checked="" type="checkbox"/> Travel Map</td> <td><input checked="" type="checkbox"/> Search Marking Example</td> </tr> <tr> <td><input checked="" type="checkbox"/> ICS 206</td> <td><input checked="" type="checkbox"/> Incident Map</td> <td><input checked="" type="checkbox"/> Demob Plan</td> <td></td> </tr> <tr> <td><input checked="" type="checkbox"/> ICS 206C</td> <td><input checked="" type="checkbox"/> Weather Forecast</td> <td><input checked="" type="checkbox"/> Finance Message</td> <td><input checked="" type="checkbox"/> ICS 214</td> </tr> </table>			<input checked="" type="checkbox"/> ICS 203	<input checked="" type="checkbox"/> ICS 208	<input checked="" type="checkbox"/> Phone List	<input type="checkbox"/> Fire Suppression Repair Plan	<input checked="" type="checkbox"/> ICS 204	<input checked="" type="checkbox"/> ICS 215A	<input checked="" type="checkbox"/> Training Message	<input checked="" type="checkbox"/> CISD Message	<input checked="" type="checkbox"/> ICS 205	<input checked="" type="checkbox"/> ICS 220	<input checked="" type="checkbox"/> Travel Map	<input checked="" type="checkbox"/> Search Marking Example	<input checked="" type="checkbox"/> ICS 206	<input checked="" type="checkbox"/> Incident Map	<input checked="" type="checkbox"/> Demob Plan		<input checked="" type="checkbox"/> ICS 206C	<input checked="" type="checkbox"/> Weather Forecast	<input checked="" type="checkbox"/> Finance Message	<input checked="" type="checkbox"/> ICS 214
<input checked="" type="checkbox"/> ICS 203	<input checked="" type="checkbox"/> ICS 208	<input checked="" type="checkbox"/> Phone List	<input type="checkbox"/> Fire Suppression Repair Plan																			
<input checked="" type="checkbox"/> ICS 204	<input checked="" type="checkbox"/> ICS 215A	<input checked="" type="checkbox"/> Training Message	<input checked="" type="checkbox"/> CISD Message																			
<input checked="" type="checkbox"/> ICS 205	<input checked="" type="checkbox"/> ICS 220	<input checked="" type="checkbox"/> Travel Map	<input checked="" type="checkbox"/> Search Marking Example																			
<input checked="" type="checkbox"/> ICS 206	<input checked="" type="checkbox"/> Incident Map	<input checked="" type="checkbox"/> Demob Plan																				
<input checked="" type="checkbox"/> ICS 206C	<input checked="" type="checkbox"/> Weather Forecast	<input checked="" type="checkbox"/> Finance Message	<input checked="" type="checkbox"/> ICS 214																			
<b>7. Prepared By:</b> Buddy Bloxham	Position/Title: PSC	Signature: 																				
<b>8. Approved by Deputy Incident Commander:</b> Nick Truax		Signature: 																				
<b>ICS 202</b>																						

## ORGANIZATION ASSIGNMENT LIST (ICS 203)

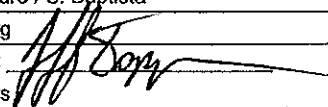
<b>1. Incident Name:</b> 2018 XSB JANUARY STORMS		<b>2. Operational Period: Date From:</b> 1/17/2018 Time From: 0700		<b>Date To:</b> 1/18/2018 <b>Time To:</b> 0700	
<b>3. Incident Commander(s) and Command Staff:</b>			<b>7. Operation Section:</b>		
IC/UC's	B. See / W. Enos / K. Taylor / K. Moore	Chief	J. Ohs / B. Olmstead / M. Farris (T)		
Deputy	N. Truax / K. Dervedde (T)	Deputy	M. Brunton / G. Belyea (T)		
Safety Officer	D. Brockman (T) / D. Baker	Night Ops	J. Roesler		
Information Officer	M. Smith / C. Elms (T)	Staging Area			
Liaison Officer	D. Carreiro / J. Adams (T) / K. Huddle	<b>Branch</b>	<b>East</b>	<b>B. Mackwood (12 hr) / T. Ederer (T) (12 hr)</b>	
LE Liaison Officer	P. Fontanetta / D. Milligan	Division/Group	Romero/Picay	M. Juarez / A. Widling (T) (both 24hr)	
		Division/Group	South	B. Paige / T. Gilliam (T) (both 12 hr)	
		Division/Group	North	J. Tieso (12 hr)	
		Division/Group			
<b>4. Agency/Organization Representatives:</b>					
Agency/Organization	Name	Division/Group			
CAL FIRE	S. Jalbert	Division/Group			
OES	J. Salvate / I. Messer / L. Collins	<b>Branch</b>	<b>West</b>	<b>J. Topoleski (12 hr)</b>	
SBCo OEM	B. Uhl / J. Gator	Division/Group	Olive	J. Dyer / M. De Ponce (T) (24 hr)	
American Red Cross	K. Russell / J. Wishan	Division/Group	Cold Springs		
Caltrans	C. Chalk	Division/Group	Hot Springs		
Southern CA Edison	T. Whitman	Division/Group			
LA County Fire	S. Hale	Division/Group			
US Coast Guard	D. Hagger	<b>Branch</b>			
CA Highway Patrol	C. Pontes	Division/Group			
CCC	W. Johnson	Division/Group			
CDCR	A. VonSavoye	Division/Group			
Ventura County FD	J. McNeil	Division/Group			
		Division/Group			
		<b>Branch</b>			
<b>5. Planning Section:</b>			Division/Group	Heavy Eq. Group	D. Neels (12 hr)
Chief	B. Bloxham	Division/Group	Hazmat Group	C. Stowe (12 hr)	
Deputy	J. Dapper (T)	Division/Group			
Resource Unit	L. Plata / S. DeBenedet / T. Henderson (T)	Division/Group			
Situation Unit	T. Tuggle / R. DeCamp / B. Glass	Division/Group			
Documentation Unit	J. Arthur	Division/Group			
Demobilization Unit	A. Klem	Division/Group			
GISS	T. Werle	Division/Group			
FBAN	J. Heggle	Division/Group			
IMET		Division/Group			
Training Tech Spec	M. Seybert (T)	Division/Group			
K9 Tech Spec	S. Swaney	<b>Air Operations Branch</b>		<b>Director:</b>	<b>M. Stanford</b>
<b>6. Logistics Section</b>			Air Support Grp Sup	C. Willson (T)	
Chief	P. Gallegos		Helibase Manager	J. Collins	
Deputy	R. Tovar				
Supply Unit	J. Ruedy (T)	<b>B. Finance/Administration Section:</b>			
Facilities Unit	S. Buris	Chief	R. Raines		
Ground Support Unit	S. Langston	Deputy	S. Hogan		
Hired Equipment Tech	A. Whitlock	Time Unit	P. Aguada / J. Orozco Jr. (T)		
Communications Unit	K. Johnson	Procurement Unit	K. Schaefer		
Medical Unit	K. Fortney	Comp/Claims Unit	P. Rotondaro / S. Baptista		
Motel Tech Spec	D. English	Cost Unit	J. Forsberg		
<b>Prepared By: Name:</b>	Jeff Dapper	<b>Position/Title:</b>	PSC	<b>Signature:</b>	
<b>ICS 203</b>		<b>Date/Time:</b>	1/16/2018 2300 hours		

## Spot Forecast for XSB January Storms

National Weather Service Los Angeles/Oxnard CA

Forecast is based on incident time of 0800 PST on January 17.

**DISCUSSION**...A ridge of high pressure will briefly build over the region Wednesday. This combined with weak offshore flow will bring minor warming and drying. Increasing west to northwesterly flow will bring some cooling Thursday with a chance of low clouds and fog during the morning hours. A weakening cold front is expected to push through the region Friday, bringing a slight chance of light showers. Rain totals, if any, will likely be a tenth of an inch or less. The larger impact could be the winds with gusty northerly winds likely reaching the hills above Montecito, with a 30 percent chance of gusty winds of around 45 mph or greater late Friday night. Gusty northerly winds in the city of Montecito itself could reach up to around 30 mph.

Travel to and from Montecito may be impacted beginning Friday. Travel over the coastal waters may become hazardous due to choppy seas from both winds and building swell. Additionally, travel may become hazardous through the I-5 corridor by Friday evening due to possibly icy/snowy driving conditions above 3000 feet and gusty northerly winds. Air travel may also be impacted due to low level wind shear and turbulence caused by the potentially gusty northerly winds late Friday into Saturday.

### WEDNESDAY...

Sky/weather.....Mostly sunny.

Chance of pcpn.....0 percent.

Max temperature.....Around 71.

Min humidity.....60 percent.

Surface winds.....Variable 2 to 4 mph becoming southwest 6 to 9 mph in the afternoon.

### WEDNESDAY NIGHT...

Sky/weather.....Partly cloudy.

Chance of pcpn.....0 percent.

Min temperature.....Around 52.

Max humidity.....85 percent.

Surface winds.....Southwest winds 5 to 10 mph in the evening becoming variable 2 to 4 mph.

### THURSDAY...

Sky/weather.....Mostly sunny, becoming partly cloudy late in the afternoon.

Chance of pcpn.....0 percent.

Max temperature.....Around 67.

Min humidity.....65 percent.

Surface winds.....Variable 2 to 4 mph becoming southwest 6 to 10 mph in the afternoon.



# CALFIRE INCIDENT MANAGEMENT TEAM 3



1. INCIDENT NAME: <b>2018 XSB January Storms</b>		2. DATE PREPARED: 1/16/2018	3. TIME PREPARED: 1800
4. PREPARED BY: David Brockman SOF1 (T)	5. LEADER NAME: David Sargenti SOF1	6. OPERATIONAL PERIOD: 1/17/2018 0700 TO 1/18/2018 0700	

# SAFETY MESSAGE

Exhaustion -a state of extreme physical or mental fatigue.

- Look out for falling rocks and debris.
- Identify and make everyone aware of escape routes.
- Multiple operations are occurring on the incident. Communicate accordingly.
- Treat ALL power lines as if energized. Beware of natural gas line hazards.
- Slow down on the roadways and help reduce the dust.
- Watch for excessive fatigue. TAKE BREAKS as needed.
- Monitor your hydration intake and keep adequate supplies.

LOOK OUTS  
COMMUNICATIONS  
ESCAPE ROUTES  
SAFETY ZONES

# SAFETY MATTERS



# INCIDENT RISK ANALYSIS ICS 215A



BRANCH	HAZARDOUS ACTIONS/ CONDITIONS	MITIGATIONS/WARNINGS/REMEDIES
ALL	DRIVING HAZARDS	<ul style="list-style-type: none"> <li>Be alert for potential muddy and slick road surfaces.</li> <li>Evaluate bridges for structural compromises.</li> <li>Slow down to reduce dust production.</li> </ul>
ALL	HAZARDOUS STRUCTURE	<ul style="list-style-type: none"> <li>Follow Structure Size Up (IRPG p.13).</li> <li>Be aware of propane tank and natural gas hazards.</li> <li>Scout areas prior to committing resources to work assignments.</li> <li>Void spaces (pools and wells) may be hidden by mud and debris.</li> </ul>
ALL	HAZARDOUS TREES	<ul style="list-style-type: none"> <li>Follow Hazard Tree Safety Guidelines (IRPG p. 22).</li> <li>Many of the trees within the inundation zone and along roadway may be compromised.</li> </ul>
ALL	FATIGUE	<ul style="list-style-type: none"> <li>Monitor incoming and outgoing resources for level of fatigue.</li> <li>Provide sufficient rest during the work cycle.</li> </ul>
ALL	HEAVY EQUIPMENT	<ul style="list-style-type: none"> <li>Review Working with Heavy Equipment (IRPG p.80)</li> <li>Stay at least 100 feet in front and 50 feet behind the equipment.</li> </ul>
ALL	TRAFFIC HAZARDS	<ul style="list-style-type: none"> <li>Watch for utility vehicles in your areas.</li> <li>Keep apprised of road closures in the area.</li> </ul>
ALL	PERSONNEL SAFETY/HYGIENE	<ul style="list-style-type: none"> <li>All personnel are responsible for their personal safety.</li> <li>Be sure to wear all required PPE while on assignment.</li> <li>Wash hands prior to eating and after using the facilities.</li> <li>Decontaminate personnel protective equipment after your shift.</li> </ul>
ALL	POWER LINES/UTILITIES	<ul style="list-style-type: none"> <li>Follow Power Line safety guidelines (IRPG pg.24)</li> <li>Treat all downed power lines as energized.</li> <li>Identify and avoid natural gas lines.</li> </ul>
ALL	HYDRATION	<ul style="list-style-type: none"> <li>Drink water before, during and after each shift.</li> <li>Be alert for signs of heat stress in yourself and others.</li> </ul>
ALL	COMMUNICATIONS	<ul style="list-style-type: none"> <li>Check the communication plan for frequency assignments.</li> </ul>
ALL	BRIEFINGS	<ul style="list-style-type: none"> <li>Make sure <b>everyone</b> gets a briefing on the plan for the day.</li> <li>Document this on your ICS 214.</li> </ul>
ALL	LCES	<ul style="list-style-type: none"> <li>Ensure that LCES is being utilized.</li> </ul>
ALL	AIRCRAFT AWARENESS	<ul style="list-style-type: none"> <li>Understand that hazard trees may react to helicopters overhead.</li> <li>Monitor assigned aircraft frequencies.</li> </ul>
ALL	DEBRIS FLOWS	<ul style="list-style-type: none"> <li>Work within your current training and qualifications.</li> <li>Watch for shifting material.</li> </ul>
ALL	SEARCH and RECOVERY OPERATIONS	<ul style="list-style-type: none"> <li>Do not get complacent.</li> <li>Pace yourself and your crew for the work assignment.</li> <li>Watch your footing, be cautious of slips, trips and falls.</li> </ul>
<b>Incident Name:</b> <b>2018 XSB January Storms</b>		<b>Date Prepared:</b> 1/16/2018 <b>Prepared by:</b> David Brockman  SOF1 (T)
		<b>Operational Period:</b> 1/17/2018 –1/18/2018 0700-0700

*In readiness is all*

# ASSIGNMENT LIST (ICS 204)

CONTROLLED UNCLASSIFIED  
INFORMATION/BASIC

<b>1. Incident Name:</b> 2018 XSB JANUARY STORMS CA-MTO-000071		<b>2. Operational Period:</b> Date From: 01/17/18    Date To: 01/18/18 Time From: 0700    Time To: 0700			<b>3.</b>  Branch: <b>East</b>  Div/Group: <b>Romero/Picay</b>		
<b>4. Operations Personnel:</b> Operations Section Chief: <b>J. Ohs / B. Olmstead / M. Farris (T)    Night Ops: J. Roesler</b> Branch Director: <b>B. Mackwood (12 hr) / T. Ederer (T) (1 Branch Safety: S. Tavalero</b> Division/Group Supervisor: <b>M. Juarez / A. Widling (T) (both 24hr) (12 hr) / W. Fisher (12 hr)</b>							
<b>5. Resources Assigned:</b> ** Resources Below in Bold are 12 Hour **							
Resource Identifier	Leader	Personnel	Request #	Reporting Location, Special Equipment, Remarks, Notes, and Information Time                      Location			
STC OES6 6848C	Paredes, Andre	22	E-18	0700-0700	DP 2		
STC OES 1880C	<b>Frelinger, David P</b>	<b>22</b>	<b>E-14</b>	<b>0700-1900</b>	<b>DP 2</b>		
TF MTO 1	<b>Briner, Aaron</b>			<b>0700-1900</b>	<b>DP 2</b>		
STG BDU 9358G	<b>Hatch, Joe</b>	<b>33</b>	<b>C-71012</b>	<b>0700-1900</b>	<b>DP 2</b>		
W/T OES 62	Dave Loop	2	E-71069	0700-0700	DP 2		
<b>FEMP BLACK O-60</b>	<b>Black, Marcus</b>	<b>1</b>	<b>O-60</b>	<b>0700-1900</b>	<b>DP 2</b>		
<b>FEMP JOHNSON O-61</b>	<b>Johnson, Darnell</b>	<b>1</b>	<b>O-61</b>	<b>0700-1900</b>	<b>DP 2</b>		
<b>6. Work Assignments:</b> Complete searches in debris flow areas. Mitigate hazards. Provide access.							
<b>7. Special Instructions:</b> Coordinate with utility companies working in the area.							
<b>8. Communications</b> (radio and/or phone contact numbers needed for this assignment):							
Name	Ch	Function	Rx Freq	Rx Tone	Tx Freq	Tx Tone	Notes
SBC C2	1	COMMAND	153.9050 N	110.9	154.9950 N	127.3	SB CO COMMAND 2
VTAC 11	8	TACTICAL	151.1375 N	156.7	151.1375 N	156.7	
CDF T14	14	A/G	159.2250 N	192.8	159.2250 N	192.8	AIR TO GROUND
CALCORD	15	MEDICAL	156.0750 N	156.7	156.0750 N	156.7	MEDICAL COORDINATION
GUARD 12	20	AIR GUARD	168.6250 N	0	168.6250 N	110.9	EMERGENCY USE ONLY
<b>9. Prepared by: Name:</b> Leonel Plata                      Pos/Title:    RESL							
ICS 204		Date/Time: 1/16/2018    2300 hours		Signature:			







## ASSIGNMENT LIST (ICS 204)

CONTROLLED UNCLASSIFIED  
INFORMATION//BASIC

<b>1. Incident Name:</b> 2018 XSB JANUARY STORMS CA-MTO-000071		<b>2. Operational Period:</b> Date From: 01/17/18    Date To: 01/18/18 Time From: 0700    Time To: 0700			<b>3.</b>  Branch: <b>West</b>  Div/Group: <b>Olive</b>  <b>Page 1 of 2</b>		
<b>4. Operations Personnel:</b> Operations Section Chief: <b>J. Ohs / B. Olmstead / M. Farris (T)</b> Night Ops: <b>J. Roesler</b> Branch Director: <b>J. Topoleski (12 hr)</b> Branch Safety: <b>M. Klusyk (12 hr)</b> Division/Group Supervisor: <b>J. Dyer / M. De Ponce (T) (24 hr)</b>							
<b>5. Resources Assigned:</b>		<b>** Resources Below in Bold are 12 Hour **</b>			Reporting Location, Special Equipment, Remarks, Notes, and Information Time                      Location		
Resource Identifier	Leader	Personnel	Request #	Time	Location		
STC TUU 9410C	Turner, Andy	16	E-70010	0700-0700	Vons Staging		
STC VNC 1588C	Arce, Tomas E	19	E-71060	0700-1900	Vons Staging		
STC OES1 1870C	Brookhyser, David M	22	E-5	0700-1900	Vons Staging		
T/F SBC 1	Mercado, Robert	19	E-32	0700-1900	Vons Staging		
STG RRU 9315G	Salas, Anthony S	30	C-71010	0700-1900	Vons Staging		
STG RRU 9314G	Grewal, Lakhdev Dave	33	C-71009	0700-1900	Vons Staging		
STG TCU 9444G	Bishop, James	33	C-71002	0700-1900	Vons Staging		
STG TUU 9413G	Ballen, Steve	34	C-71006	0700-1900	Vons Staging		
CRW LAC CREW 2	Gaylor, Robert	19	C-71001	0700-1900	Vons Staging		
RTF XBC 12	Ryan, Larry	30	E-3	0700-1900	Vons Staging		
RTF XLE 2	Capelle, Vincent	30	O-111	0700-1900	Vons Staging		
RTF LAC 8	Wells, Bryan	30	O-109	0700-1900	Vons Staging		
RTF BDC 6	Viloria, Donny	30	O-115	0700-1900	Vons Staging		
W/T MRA 209	Slovacek, Jakub	1	E-71062	0700-0700	Vons Staging		
LEO		1		0700-1900	Vons Staging		
LEO		1		0700-1900	Vons Staging		
LEO		1		0700-1900	Vons Staging		
LEO		1		0700-1900	Vons Staging		
<b>6. Work Assignments:</b> Complete searches in debris flow areas. Mitigate hazards. Provide access.							
<b>7. Special Instructions:</b> Coordinate with utility companies working in the area.							
<b>8. Communications</b> (radio and/or phone contact numbers needed for this assignment):							
Name	Ch	Function	Rx Freq	Rx Tone	Tx Freq	Tx Tone	Notes
SBC C2	1	COMMAND	153.9050 N	110.9	154.9950 N	127.3	SB CO COMMAND 2
VFIRE 24	5	TACTICAL	154.2725 N	156.7	154.2725 N	156.7	
CDF T14	14	A/G	159.2250 N	192.8	159.2250 N	192.8	AIR TO GROUND
CALCORD	15	MEDICAL	156.0750 N	156.7	156.0750 N	156.7	MEDICAL COORDINATION
GUARD 12	20	AIR GUARD	168.6250 N	0	168.6250 N	110.9	EMERGENCY USE ONLY
<b>9. Prepared by: Name:</b> Leonel Plata		<b>Pos/Title:</b> RESL		<b>Signature:</b>			
ICS 204		<b>Date/Time:</b> 1/16/2018 2300 hours					







## ASSIGNMENT LIST (ICS 204)

CONTROLLED UNCLASSIFIED  
INFORMATION//BASIC

<b>1. Incident Name:</b> 2018 XSB JANUARY STORMS CA-MTO-000071		<b>2. Operational Period:</b> Date From: 01/17/18      Date To: 01/18/18 Time From: 0700      Time To: 0700			<b>3.</b>  Branch:  Div/Group: <b>Heavy Eq. Group</b>		
<b>4. Operations Personnel:</b> Operations Section Chief: J. Ohs / B. Olmstead / M. Farris (T)    Night Ops: J. Roesler Branch Director: Division/Group Supervisor: <b>D. Neels (12 hr)</b>					Page 1 of 2		
<b>5. Resources Assigned:</b>		<b>** Resources Below in Bold are 12 Hour **</b>			Reporting Location, Special Equipment, Remarks, Notes, and Information Time                      Location		
Resource Identifier	Leader	Personnel	Request #				
STL KRN 9360L	<b>Grisedale, Michael L</b>	<b>5</b>	<b>E-28</b>	<b>0700-1900</b>	<b>ICP</b>		
DOZ ORC 1	<b>Dave Hahn</b>	<b>2</b>	<b>E-25</b>	<b>0700-1900</b>	<b>ICP</b>		
DOZ BDC DZ2	<b>Glaze, Shane Michael</b>	<b>2</b>	<b>E-27</b>	<b>0700-1900</b>	<b>ICP</b>		
DOZ SBC 1	<b>Gavlak, Joseph M</b>	<b>2</b>	<b>E-44</b>	<b>0700-1900</b>	<b>ICP</b>		
EXC PVT VARIAN	<b>Varian, Greg</b>	<b>1</b>	<b>E-71076</b>	<b>0700-1900</b>	<b>ICP</b>		
EXC LAC 25	<b>Ferris, Charlie M</b>	<b>1</b>	<b>E-71003</b>	<b>0700-1900</b>	<b>ICP</b>		
EXC VNC 1	<b>Winchester, Ryan</b>	<b>2</b>	<b>E-35</b>	<b>0700-1900</b>	<b>ICP</b>		
EXC SBC	<b>Linane, Mark</b>	<b>2</b>	<b>E-46</b>	<b>0700-1900</b>	<b>ICP</b>		
EXC PVT COAST GRADING	<b>Stalder, William</b>	<b>1</b>	<b>E-71075</b>	<b>0700-1900</b>	<b>ICP</b>		
EXC PVT J R BACKHOE	<b>Ricker, John</b>	<b>1</b>	<b>E-71077</b>	<b>0700-1900</b>	<b>ICP</b>		
BKH VNC 1	<b>Berry , Christopher</b>	<b>2</b>	<b>E-34</b>	<b>0700-1900</b>	<b>ICP</b>		
FRL PVT CECIL LOGGING	<b>Cecil, Ray</b>	<b>1</b>	<b>E-71081</b>	<b>0700-1900</b>	<b>ICP</b>		
FRL ORC SKID STEER 1	<b>Hahn, David</b>	<b>1</b>	<b>E-71002</b>	<b>0700-1900</b>	<b>ICP</b>		
FRL SBC LOADER	<b>Moniot, Jeffrey D</b>	<b>1</b>	<b>E-49</b>	<b>0700-1900</b>	<b>ICP</b>		
FRL LAC 11	<b>Wright,dave</b>	<b>1</b>	<b>E-71004</b>	<b>0700-1900</b>	<b>ICP</b>		
FRL VNC 1 LOADER	<b>Price, Scott</b>	<b>2</b>	<b>E-36</b>	<b>0700-1900</b>	<b>ICP</b>		
GRD SBC	<b>Hill, Kyle D</b>	<b>1</b>	<b>E-48</b>	<b>0700-1900</b>	<b>ICP</b>		
HEQB HUTCHINSON O-70073	<b>Hutchinson, Thomas</b>	<b>1</b>	<b>O-70073</b>	<b>0700-1900</b>	<b>ICP</b>		
HEQB HERMAN O-124	<b>Herman, Blake C</b>	<b>1</b>	<b>O-124</b>	<b>0700-1900</b>	<b>ICP</b>		
<b>6. Work Assignments:</b> Provide access. Assist with recovery operations as needed.							
<b>7. Special Instructions:</b>							
<b>8. Communications</b> (radio and/or phone contact numbers needed for this assignment):							
Name	Ch	Function	Rx Freq	Rx Tone	Tx Freq	Tx Tone	Notes
SBC C2	1	COMMAND	153.9050 N	110.9	154.9950 N	127.3	SB CO COMMAND 2
VTAC 13	10	TACTICAL	158.7375 N	156.7	158.7375 N	156.7	
CDF T14	14	A/G	159.2250 N	192.8	159.2250 N	192.8	AIR TO GROUND
CALCORD	15	MEDICAL	156.0750 N	156.7	156.0750 N	156.7	MEDICAL COORDINATION
GUARD 12	20	AIR GUARD	168.6250 N	0	168.6250 N	110.9	EMERGENCY USE ONLY
<b>9. Prepared by: Name:</b> Leonel Plata		<b>Pos/Title:</b> RESL		<b>Signature:</b>			
<b>ICS 204</b>		<b>Date/Time:</b> 1/16/2018 2300 hours					







# AIR OPERATIONS SUMMARY

OPERATIONAL PERIOD DATE: 1/17/2018 to 1/18/2018 START: 0800 END: 0800 SUNRISE: 7:04 SUNSET: 17:13

1. INCIDENT NAME: STORM  
 2. PREPARED BY: C. WILLSON  
 3. # OF COPIES NEEDED: \_\_\_\_\_  
 PREPARED DATE/TIME: 1/16/18 1800

4. REMARKS (Safety Notes, Hazards, Air Operations Special Equipment, etc.):  
 Ensure your load calcs reflect the temperatures.  
 GPS settings: hddd'mm.mmm' with WGS 84 selected as the map datum.

5. TFR:  
 Center: **FDC 8/3887**  
 Latitude: SEE FAA WEBSITE  
 Longitude: Polygon  
 Altitude: 2500'

6. PERSONNEL		7. FREQUENCIES			8. FIXED WING	
	Phone	AIR/AIR FW:	AIR/AIR RW:	AM	FM	# Avail / Type/ Make-Model / FAA N# / Base(s)
AOBD Matt Stanford	951.545.8205		122.900			AIRTANKERS
ASGS Chris Willson	530.448.2408	AIR BRIEFING				LEADPLANES
HEBM Jared Collins	858.353.6261	AIR/GROUND TACTICAL				AIR TACTICAL PLATFORMS
		DECK:				TFR Freqs. 122.900
		TOLC:				AVAILABLE ON REQUEST
		COMMAND:		See IAP Comm Plan		
		Air Guard		168.625 Tone 1		PILOT MAP:

9. HELICOPTERS (Use Additional Sheets as Necessary)

FAA N#	TY	MAKE/MODEL	BASE	AVAIL	START	REMARKS	FAA N#	TY	MAKE/MODEL	BASE	AVAIL	START	REMARKS
COPTER 4	2	BELL 212		0800	0800	Base - Santa Ynez							

10. TASK/MISSION/ASSIGNMENT (Use ICS-220a if additional space needed; Type/Function includes: Air Tactical, Retardant, Recon, Personnel Transport, Water Dropping, etc.)

TYPE/FUNCTION	NAME OF PERSONNEL OR CARGO (if applicable) OR INSTRUCTIONS FOR TACTICAL AIRCRAFT	MISSION START	FLY FROM	FLY TO
Recon				
Water Drops/Retard.				
Personnel Transport				
Logistics	March, San Felipe 1/16/2018			
Priorities				
Rescue				

# ICS 205 - INCIDENT RADIO COMMUNICATIONS PLAN

<b>1. Incident Name:</b> 2018 XSB January Storms	<b>2. Date/Time Prepared:</b> Date: 1/16/2018 Time: 1530	<b>3. Operational Period:</b> Date From: 1/17/2018 Date To: 1/18/2018 Time From: 0700 Time To: 0700
---	--	---

Controlled Unclassified Information//Basic									
Ch#	Function	Name	Assigned To	Rx Freq	Rx Tone	Tx Freq	Tx Tone	Mode A, D or M	Notes
1	COMMAND	SBC C2	ALL DIVISIONS	153.9050 N	110.9	154.9950 N	127.3	A	SB CO COMMAND 2
2									
3									
4	TACTICAL	VFIRE 23	HOT/COLD SPR. DIV.	154.2950 N	156.7	154.2950 N	156.7	A	
5	TACTICAL	VFIRE 24	OLIVE DIV.	154.2725 N	156.7	154.2725 N	156.7	A	
6	TACTICAL	VFIRE 25	NORTH DIV.	154.2875 N	156.7	154.2875 N	156.7	A	
7	TACTICAL	VFIRE 26	SOUTH DIV.	154.3025 N	156.7	154.3025 N	156.7	A	
8	TACTICAL	VTAC 11	ROMERO/PICAY DIV	151.1375 N	156.7	151.1375 N	156.7	A	
9									
10	TACTICAL	VTAC 13	HEAVY EQUIP.	158.7375 N	156.7	158.7375 N	156.7	A	
11	TACTICAL	CDF T26	HAZMAT GRP.	159.2925 N	192.8	159.2925 N	192.8	A	
12									
13									
14	A/G	CDF T14	ALL DIVISIONS	159.2250 N	192.8	159.2250 N	192.8	A	AIR TO GROUND
15	MEDICAL	CALCORD	MEDICAL	156.0750 N	156.7	156.0750 N	156.7	A	MEDICAL COORDINATION
16	AIR GUARD	GUARD 12	ALL DIVISIONS	168.6250 N	0.0	168.6250 N	110.9	A	EMERGENCY USE ONLY
17									
18									
19									
20	AIR GUARD	GUARD 12	ALL DIVISIONS	168.6250 N	0.0	168.6250 N	110.9	A	EMERGENCY USE ONLY

**5. Special Instructions**  
 Controlled Unclassified Information//Basic

Use the ICS 205 to reference and to correlate with the ICS 204's depending on your work assignments

<b>6. Prepared by (Communications Unit Leader):</b> Name: Kyle Johnson, COML IMT #3	Signature: 
Date/Time: 1/16/18 1530	

### COMMUNICATIONS LIST (ICS 205A)

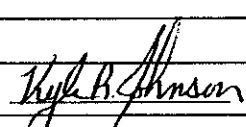
<b>1. Incident Name:</b> 2018 XSB January Storms		<b>2. Operational Period:</b> Date From: 01/17/18 Date To: 01/18/18 Time From: 0700 Time To: 0700	
<b>3. Basic Local Communications Information:</b>			
Incident Assigned Position	Name	Contact Number	
SAFETY OFFICER	DAVE BROCKMAN	(530) 682-2522	
	DAVE BAKER	(805) 448-3048	
LIAISON OFFICER	JEFF ADAMS	(714) 323-2061	
	DENNIS CARREIRO	(831) 594-8612	
INFORMATION OFFICER	MIKE SMITH	(951) 232-4049	
INFORMATION LINE MEDIA		(805) 996-0579	
PUBLIC INFORMATION LINE		(805) 696-1188	
AIR OPS BRANCH DIRECTOR	MATT STANFORD	(951) 545-8205	
PLANS SECTION CHIEF	BUDDY BLOXHAM	(831) 236-5659	
FINANCE SECTION CHIEF	ROGER RAINES	(559) 281-4315	
LOGISTICS SECTION CHIEF	RICHARD TOVAR	(951) 850-2619	
SUPPLY UNIT LEADER	JOHN RUEDY	(805) 559-2005	
TRAINING TECH SPEC	MATT SEYBERT	(714) 875-4040	
GROUND SUPPORT UNIT LDR	STEVE LANGSTON	(661) 301-7352	
G/S MECHANIC	KEVIN COX	(805) 903-3430	
MEDICAL UNIT LEADER	KEVIN FORTNEY	(951) 264-9340	
	DEVIN LAWRENCE	(661) 301-7143	
COMMUNICATIONS	STORM COMM. LINE 1	(805) 903-3489	
	STORM COMM. LINE 2	(805) 903-3497	
	STORM COMM. LINE 3	(805) 903-3498	
K-9 TECH/SPEC	STEVE SWANEY	(619) 922-4977	
CREW TECH/SPEC	ELI BAKKELA	(760) 594-4351	
<b>4. Prepared by:</b> Name: <u>K. JOHNSON</u> Position/Title: <u>COML IMT #3</u> Signature: 			
ICS 205A	Date/Time: <u>01/16/2018 14:00</u>		



# MEDICAL PLAN

1. INCIDENT NAME <b>2018 XSB January Storms CA-MTO-000071</b>	2. DATE PREPARED <b>01/16/2018</b>	3. TIME PREPARED <b>1800 HOURS</b>	4. OPERATIONAL PERIOD <b>01/17/2018-01/18/2018 0700-0700 (24hr)</b>
--	---------------------------------------	---------------------------------------	--

### 5. INCIDENT MEDICAL AID STATIONS

MEDICAL AID STATIONS Medical Unit	LOCATION ICP	PARAMEDICS	
		YES	NO
		XX	

### 6. TRANSPORTATION

#### A. Air Ambulances

NAME	ADDRESS	PHONE	PARAMEDICS	
			YES	NO
SBC Copter 4 NVG/Hoist	Santa Barbara Municipal Airport	805-692-5723	XX	

#### B. Ground Ambulances

AMR Santa Barbara Medic 43	Vons Staging	805-692-5723	XX	
			XX	
			XX	

NAME	ADDRESS	TRAVEL TIME		PHONE	HELIPAD		BURN CENTER	
		AIR	GRND		YES	NO	YES	NO
Santa Barbara Cottage Hospital Level I Trauma	400 W. Pueblo Santa Barbara, CA, 93111 N 34° 25.80 X W 119° 43.44	15 Min	30 Min	805-682-7111	X			X
Ventura County Medical Center Level II Trauma	3291 Loma Vista Rd. Ventura, CA 93003 N 34° 16.57 X W 119° 15.08	30 Min	45 Min	805-652-6168	X			X
West Hills Medical Center	7325 Medical Center Dr. West Hills, CA 91307 N 34° 12.20 X W 118° 37.75	1 Hr.	2.5 Hrs.	818-676-4199	X		X	

### 8. MEDICAL EMERGENCY PROCEDURES

**LINE EMERGENCY:** Crew Supervisor to contact Division Supervisor with patient complaint/condition and location.

- Division Supervisor contacts:
  - Line EMT / PM
  - Communications Unit
- Communication Unit will clear command channel for emergency traffic as needed for Major/Minor incident
- Communications will switch all emergency traffic to **CALCORD** as required for Emergency
- Communications Unit contacts:
  - Medical Unit
  - Safety
  - Operations
- Division Supervisor will run medical emergency on **CALCORD/ Assigned Command.**
- Medical Unit will:
  1. Dispatch air/ground ambulance to as appropriate.
  2. If necessary, after patient pickup, dispatch ambulance to helibase for transportation
  3. Notify receiving hospital of injury status.

**CAMP EMERGENCY:** Contact Medical Unit with patient complaint/condition and location. Medical Staff will respond to stabilize incident:

#### INJURY REPORTING PROCEDURES

NATURE OF INJURY \_\_\_\_\_

LOCATION OF PATIENT \_\_\_\_\_

TRANSPORTATION REQUESTED BY: AIR \_\_\_ GROUND \_\_\_

POINT OF PICKUP \_\_\_\_\_

LAT \_\_\_\_\_ LONG \_\_\_\_\_

PATIENT UNIT ID \_\_\_\_\_

IS AN EMT WITH PATIENT: YES \_\_\_ NO \_\_\_

AGE \_\_\_\_\_

SEX: MALE \_\_\_ FEMALE \_\_\_

**ALL EMERGENCIES---Secure the area and identify witnesses for later investigation. Keep an accurate log of events.**

Medical Unit (951) 264-9340

ICS 206 8-78

9. PREPARED BY (MEDICAL UNIT LEADER)  
Kevin Fortney MEDL

10. REVIEWED BY (SAFETY OFFICER)  
David Sargenti SOFT



## INCIDENT MANAGEMENT TEAM 3



# TRAINING MESSAGE

## Make Your Training Count

The Incident Training Specialist is located behind the Check-In table;  
Hours of operation are 0630 to 2000 hours.

***It is not necessary to wait until you are in the Demob process!***

Please bring the following to the 'exit interview':

- A completed/signed ICS 225 Performance Evaluation\*
- Your Position Task Book with completed Evaluation Page

*\*forms are available from the TNSP*

*If you have any questions please call me:*

Matt Seybert TNSP (T) 714-875-4040

*In readiness is all*



# INCIDENT MANAGEMENT TEAM 3



## DEMOBILIZATION MESSAGE 2018 January Storms CA-MTO-000071

We appreciate your efforts during this incident and want to make sure that we get you to your next destination safely and efficiently. When we begin demobilization, a Tentative Demobilization List will be posted in several places around base camp, including the briefing area and the eating area. If you are on this list, please adhere to the following:

### SHOW UP AT THE DESIGNATED TIME

- Show up at the designated time.
- Do not show up early.
- Do not show up late.

A demobilization schedule has been prepared in careful coordination with all essential demobilization functions. Not following the demobilization schedule can have significant negative impacts on the Demobilization Unit staff and all other resources scheduled for demobilization. We do not want you or any other resources to have unnecessary delays. Please adhere to your scheduled demobilization time.

### BE PREPARED FOR A RE-ASSIGNMENT

There may be other incidents in the state that are in need of resources. There is a possibility that some of the resources released from this incident will be immediately assigned to another one. Please make sure you are properly supplied, rested, and nourished while waiting for your designated demobilization time.

### BE THOROUGH AND EFFICIENT

Demobilization begins and ends at the Demobilization Unit. Please follow the instructions given to you when starting the demobilization process. Returning to the Demobilization Unit with a complete and accurate Demobilization Check-Out (ICS-221) form will help prevent any unnecessary delays and ensure you are shown as available for future assignments. Unforeseen delays can occur during the demobilization process, such as mechanical issues discovered while at Ground Support. Plan to visit the Time Unit towards the end of the demobilization process in order to provide an accurate accounting of your time.



# PUBLIC INFORMATION SECTION

Incident Information Line: (833) 688-5551  
Via Text Messaging: (805) 699-0165  
Incident Media Line: (805) 996-0579

STATUS	
Incident Start Date: 01/09/2018	Incident Start Time: 02:00 AM
Incident Type: Winter Storm	Cause: Heavy Winter Rain
Incident Location: Montecito	Total Personnel:
Area: 30 Square Miles	Containment: N/A



Updates



409.5

**MEDIA** – The California State Penal Code Section 409.5(d) allows the news media to enter scenes of disaster, riot or civil disturbance. Properly identified members of the news media should not be restricted from entering locations specified within the code. However, this does not include crime scenes, private property and does not imply that the news media may interfere with incident operations while they are in the areas of concern. More information can be found [here](#).

**CAL FIRE SOCIAL MEDIA POLICY** – When assigned to a CAL FIRE incident, you will adhere to the CAL FIRE Social Media Policy, Section 0691. You can find further information about the CAL FIRE Social Media Policy [here](#).



Social Media

**PHOTOGRAPHS AND VIDEOS OF INCIDENT** – We are in a new era of media. Media no longer means news/broadcast industry, but now refers to anyone that has the capability to shoot video, photographs and post them onto social media sites in a matter of minutes. Unfortunately, we have seen some instances of photographs or videos that have depicted unsafe, unprofessional or embarrassing circumstances which are a serious breach of ethics. When this happens, it reflects poorly on all that are attached to this incident. Posting an inappropriate video, photo or blog comment could expose oneself to unwanted ramifications. It may be unsafe to shoot photos or video and a firefighter who is concentrating on a camera loses their situational awareness.

The Public Information Office would like copies of the video and pictures that you safely took while not in an emergency situation, fire suppression activity or in an overhead assignment. Bring your video and pictures to the Public Information trailer; they will be reviewed and possibly uploaded to our many CAL FIRE social media sites. Remember, we don't want photographs or videos that depict unsafe, unprofessional or embarrassing circumstances, which are a serious breach of ethics.

**LOST AND FOUND** – The Information Section will manage lost and found items for the incident. If you have lost an item please leave your contact information and what you have lost at the Information Section. If you have found an item on the incident, bring the item to the Information Section with your contact information as well.

**MAIL SERVICE** – The Information Section can assist you with sending and receiving mail.

*In readiness is all*





## FINANCE SECTION MESSAGE



**All Local Government Resources need to check in with the CAL OES Representative in Warren Hall.**

**Please make sure all injuries, no matter how minor, to the Comp Claims Unit and Medical Unit.**

**Please make sure hired equipment shift tickets are completed for all private vendors and dropped off in the Time Unit.**

**Shift tickets need to be completed by agency personnel / line supervisors only.**

**Absolutely no off site feeding or purchases charged to the incident. These will be approved on a case-by-case basis by the Logistics and Finance Section Chief's.**

**All Finance functions are located in Warren Hall.**

**Roger F. Raines Jr., FSC1, IMT3**

**Shawn Hogan, Deputy FSC1**



# INCIDENT MANAGEMENT TEAM 3

## Finance Section



### Shift Ticket Examples

#### 24hr Line Resource – 2 Operator

EMERGENCY SHIFT TICKET and EVALUATION FORM The responsible Government Officer will complete this form each shift.						Contractor Name <b>THE BEST DOZERS LLC</b>											
Incident or Project Name <b>2018 XSB JAN STORMS</b>		Incident Number <b>CA-MTO-000071</b>		Request Number <b>E-444</b>		Operator #1 <b>FIRST &amp; LAST</b>	Operator #2 <b>FIRST &amp; LAST</b>										
Agreement Number <b>MMU-0000015953</b>						Operator Furnished By: <input checked="" type="checkbox"/> Contractor <input type="checkbox"/> Government											
Equipment Make <b>1999 PETERBILT 379</b>			Equipment Model / Type <b>TRANSPORT 18 WHEEL</b>			Operating Supplies Furnished By: <input checked="" type="checkbox"/> Contractor <input type="checkbox"/> Government											
Serial Number <b>COMPLETE VIN#</b>			License Number <b>12345A1</b>			Equipment Status Inspected <input type="checkbox"/> <input checked="" type="checkbox"/> Under Agreement											
Equipment Use (Circle) <b>Hours</b> / Days / Miles						Released by Government Withdrawn by Contractor											
Date Mo / Day	Start	Stop	Work	Assignment		Remarks/Comments** <b>2 OPERATORS</b>  <b>NO DAMAGE / NO CLAIM</b>											
<b>9/5</b>	<b>0701</b>	<b>2400</b>	<b>17</b>	<b>DIV X</b>													
<b>9/6</b>	<b>0001</b>	<b>0700</b>	<b>7</b>	<b>DIV X</b>													
Vendor Rating						Govt. Rep. Name and Position – PRINT											
<table border="1" style="width: 100%; border-collapse: collapse;"> <tr> <th>Poor*</th> <th>Avg.</th> <th>Good</th> <th>Exc.</th> <th>N/A</th> </tr> <tr> <td style="text-align: center;"> </td> <td style="text-align: center;"> </td> <td style="text-align: center;"> </td> <td style="text-align: center;"> </td> <td style="text-align: center;"> </td> </tr> </table>						Poor*	Avg.	Good	Exc.	N/A						<b>Print Your Name</b>	
Poor*	Avg.	Good	Exc.	N/A													
Met Performance Expectations						Govt. Rep. Signature											
Equipment in Safe Working Condition						<i>Your Signature</i>											
Operator Skill Level						Contractor Signature											
Operates Safely						<i>John Smith</i>											
Operator's Cooperation Level						Date	Time										
Overall Performance						<b>9/6/17</b>	<b>0700</b>										
* NOTE: any rating of POOR requires an explanation in Comment Section. ** Final evaluation or for more documentation, use a CALFIRE Form 230 or equivalent.						CAL FIRE 297 (Rev 3-2011)											

#### 12hr Line Resource – 1 Operator

EMERGENCY SHIFT TICKET and EVALUATION FORM The responsible Government Officer will complete this form each shift.						Contractor Name <b>THE BEST DOZERS LLC</b>											
Incident or Project Name <b>2018 XSB JAN STORMS</b>		Incident Number <b>CA-MTO-000071</b>		Request Number <b>E-555</b>		Operator #1 <b>FIRST NAME</b>	Operator #2 <b>-</b>										
Agreement Number <b>MMU-0000015953</b>						Operator Furnished By: <input checked="" type="checkbox"/> Contractor <input type="checkbox"/> Government											
Equipment Make <b>2004 CAT</b>			Equipment Model / Type <b>D6N / TYPE II E</b>			Operating Supplies Furnished By: <input checked="" type="checkbox"/> Contractor <input type="checkbox"/> Government											
Serial Number <b>COMPLETE VIN#</b>			License Number <b>-</b>			Equipment Status Inspected <input type="checkbox"/> <input checked="" type="checkbox"/> Under Agreement											
Equipment Use (Circle) <b>Hours</b> / Days / Miles						Released by Government Withdrawn by Contractor											
Date Mo / Day	Start	Stop	Work	Assignment		Remarks/Comments** <b>1 OPERATOR</b>  <b>NO DAMAGE / NO CLAIM</b>											
<b>9/5</b>	<b>0001</b>	<b>0700</b>	<b>7</b>	<b>OFF SHIFT</b>													
<b>9/5</b>	<b>0701</b>	<b>1900</b>	<b>12</b>	<b>DIV X</b>													
<b>9/5</b>	<b>1901</b>	<b>2400</b>	<b>5</b>	<b>OFF SHIFT</b>													
Vendor Rating						Govt. Rep. Name and Position – PRINT											
<table border="1" style="width: 100%; border-collapse: collapse;"> <tr> <th>Poor*</th> <th>Avg.</th> <th>Good</th> <th>Exc.</th> <th>N/A</th> </tr> <tr> <td style="text-align: center;"> </td> <td style="text-align: center;"> </td> <td style="text-align: center;"> </td> <td style="text-align: center;"> </td> <td style="text-align: center;"> </td> </tr> </table>						Poor*	Avg.	Good	Exc.	N/A						<b>Print Your Name</b>	
Poor*	Avg.	Good	Exc.	N/A													
Met Performance Expectations						Govt. Rep. Signature											
Equipment in Safe Working Condition						<i>Your Signature</i>											
Operator Skill Level						Contractor Signature											
Operates Safely						<i>John Smith</i>											
Operator's Cooperation Level						Date	Time										
Overall Performance						<b>9/5/17</b>	<b>1900</b>										
* NOTE: any rating of POOR requires an explanation in Comment Section. ** Final evaluation or for more documentation, use a CALFIRE Form 230 or equivalent.						CAL FIRE 297 (Rev 3-2011)											

*In readiness is all*

## Peer Support

We are all experiencing a devastating crisis.

Local state and federal cooperators.

We are many agencies: Law Enforcement, Fire, EMS, Private Contractors, and Military.

There are many kinds of trauma, grief and losses present. We are all human and these things can have impact on all of us, no matter who you are or what your background. These include:

- Some of us live here, and may know somebody that has suffered a loss.
- The effects from this current incident as well as recent incidents.
- Dealing with multiple evacuations and rescues in high intensity environments.
- The large magnitude and destruction of residences, commercial buildings, critical infrastructure and community landmarks.
- Extensive media presence.
- Dealing with fatalities and ongoing search for missing persons.
- Repopulation and the anguish we witness from the community.
- Providing emotional support for the community and each other.
- The time spent away from our families.

All of these stressors and more can pile up. The cumulative effect of these stressors, along with the stresses of normal daily life can feel overwhelming.

We all need to stick together, take care of ourselves and each other. Talking about your experiences with a Peer is a great way to lessen the impact.

We know how to watch out for each other on the fire line for our physical safety. The same is necessary for our emotional and psychological safety.

Come by the Peer Support Tent, we are on the grass adjacent to the briefing area.

## Critical Incident Stress Management (CISM)

### Information Sheet

Stress is a normal part of every significant job. At different times during your career with the Department, your level of stress may reach a significant or critical point. An acute stress reaction is frequently related to a specific unusual event (death of a co-worker, multi-casualty incident, severe dismemberment or disfigurement of a victim, death of a child, personally knowing or relating to the victim, etc.) A delayed reaction may happen days, weeks, and/or years after an event. This typically occurs after you are re-exposed or "triggered" by a similar sight, sound, smell, taste, touch, or situation. Cumulative stress is the buildup of stress over time and/or when you are experiencing significant amounts of stress simultaneously in your life. This buildup may eventually reach a critical mass resulting in a stress reaction.

A stress reaction is an important signal - it is your body's way of coping with the temporary state of being overwhelmed by a situation. The duration of symptoms (hours, days, weeks or months) depends on your personal circumstance. However, once properly addressed, most acute stress reaction will significantly lessen within 24-72 hours and a thoughtful combination of stress management strategies will lessen the impact of most situations.

Some common signs and symptoms of a stress reaction are:

<u>Physical</u>	<u>Cognitive</u>	<u>Emotional</u>	<u>Behavioral</u>
<ul style="list-style-type: none"> <li>• Rapid Heart Rate</li> <li>• Elevated BP</li> <li>• Increased Respirations</li> <li>• Profuse Sweating</li> <li>• Nausea</li> <li>• Dizziness</li> <li>• Muscle Tremors</li> <li>• Twitches</li> <li>• Head Aches</li> <li>• Thirst</li> <li>• Chills</li> <li>• Fatigue</li> <li>• Muscle Weakness</li> <li>• Grinding of teeth</li> <li>• Fainting</li> <li>• *Chest Pain</li> <li>• *Difficulty Breathing</li> <li>• *Shock Symptoms</li> </ul> <p><i>*Needs Immediate Medical Attention</i></p>	<ul style="list-style-type: none"> <li>• Poor and/or impaired               <ul style="list-style-type: none"> <li>○ Concentration</li> <li>○ Problem Solving</li> <li>○ Attention</li> <li>○ Decision Making</li> <li>○ Abstract Thinking</li> </ul> </li> <li>• Memory Problems</li> <li>• Confusion</li> <li>• Heightened Awareness</li> <li>• Heightened &amp;/or Lowered Awareness</li> <li>• Difficulty identifying familiar objects or people.</li> <li>• Loss or time, place, or person orientation.</li> <li>• Disturbed Thinking</li> <li>• Morbid Thinking</li> <li>• Nightmares</li> <li>• Intrusive Images, Ect.</li> </ul>	<ul style="list-style-type: none"> <li>• Shocked, Numb</li> <li>• Indifference/cut off</li> <li>• Denial</li> <li>• Feeling overwhelmed</li> <li>• "inappropriate" emotional response</li> <li>• Indecisiveness</li> <li>• Loss of Control</li> <li>• Intense anger/rage</li> <li>• Blame (self &amp;/or other)</li> <li>• Guilt</li> <li>• Hate</li> <li>• Irritability</li> <li>• Agitation</li> <li>• Anxiety</li> <li>• Apprehensive</li> <li>• Fear</li> <li>• Grief</li> <li>• Extreme Sadness</li> <li>• Depression</li> </ul>	<ul style="list-style-type: none"> <li>• Increased and/or Decreased:               <ul style="list-style-type: none"> <li>○ Appetite</li> <li>○ Sleep</li> <li>○ Sex Drive</li> <li>○ Drug/Alcohol cravings</li> <li>○ Energy Level</li> </ul> </li> <li>• Change in activity</li> <li>• Change in speech</li> <li>• Change in usual communications</li> <li>• Emotional outburst</li> <li>• Withdrawal</li> <li>• Crying</li> <li>• Non-specific bodily complaints</li> <li>• Somatization</li> <li>• Internalization</li> <li>• Intensified startle reflex</li> <li>• Hyper alert to environment</li> <li>• Inability to rest</li> <li>• Pacing</li> </ul>

Date & time that  
task force exited

**8 SEPT 03**  
**0030 HR**

Task force  
identifier

**AZ-1**

**BIO**  
**HAZ**

Personal  
hazards

**2 LIVE**

Number of live and  
dead victims still inside

Crossing slash made  
as task force exits

First slash made  
when entering

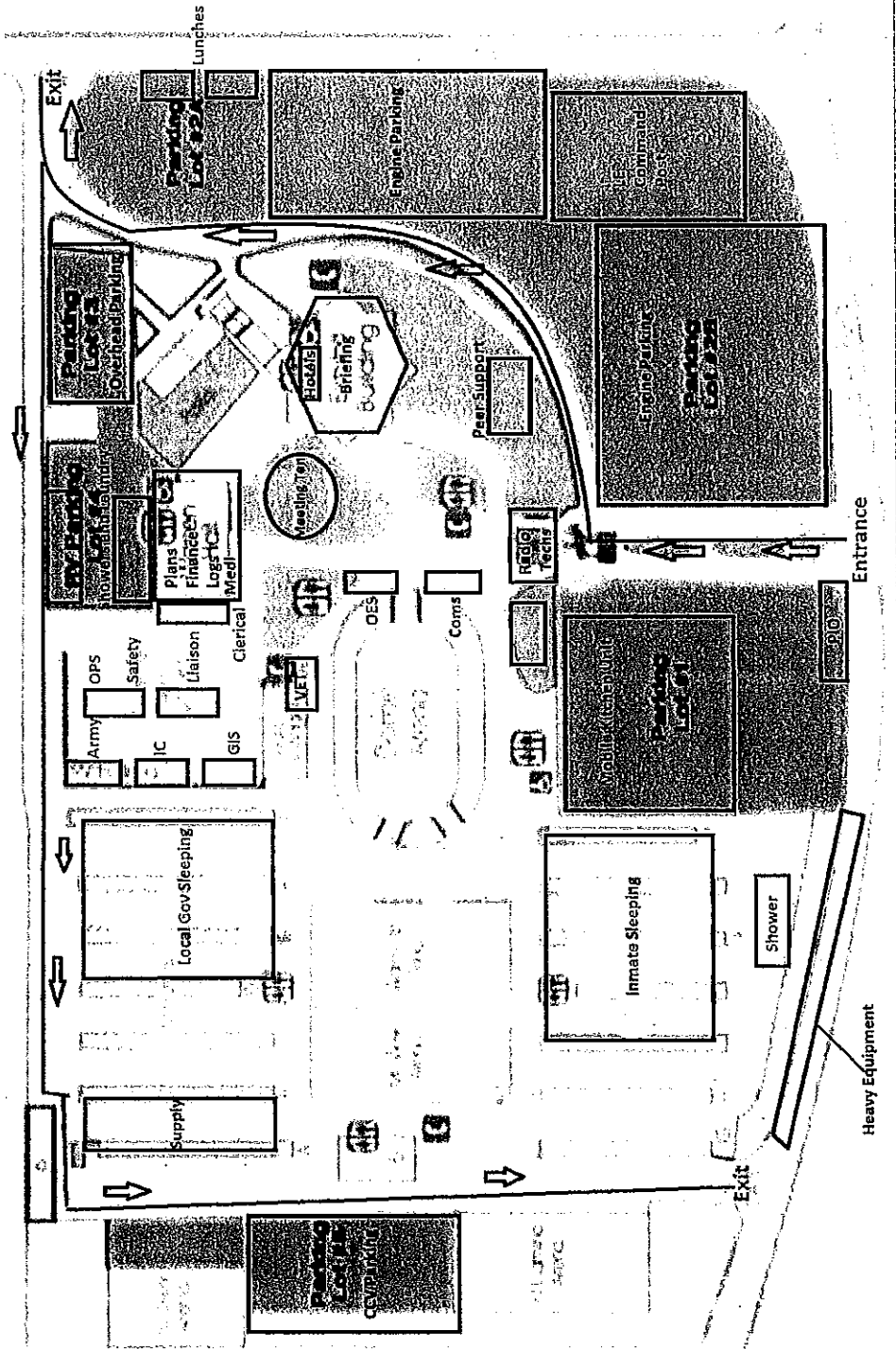

2018 XSB January Storms CA-MTO-000071  
**Logistics Map**

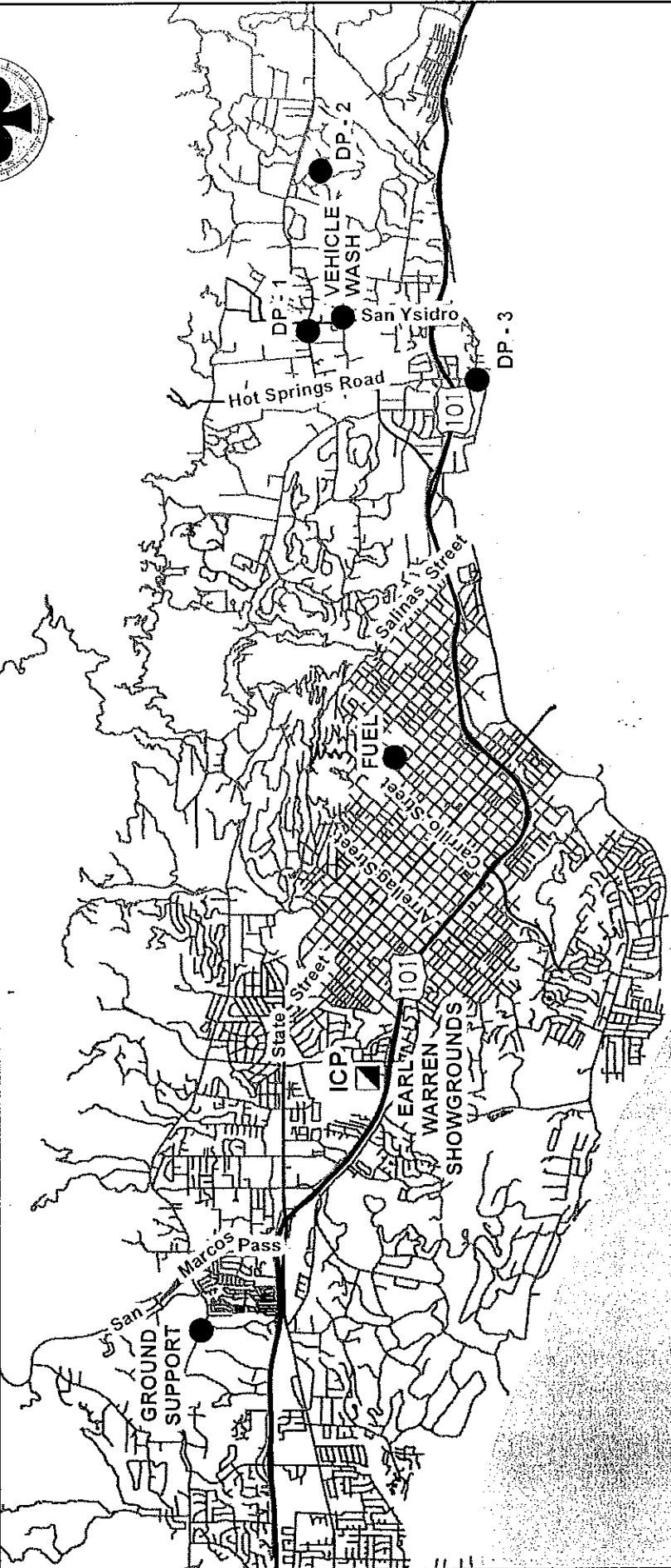

- Locations of:
- ICP  
Earl Warren Showgrounds  
3400 Calle Real, Santa Barbara
  - GROUND SUPPORT  
4415 Cathedra! Oaks Road, Goleta
  - FUEL  
805 North Quarantina Street, Santa Barbara
  - VEHICLE WASH STATION  
Manning Park  
449 San Ysidro Rd, Montecito
  - Drop Point - 1  
Vons Market Parking Lot  
1476 Coast Village Rd, Santa Barbara
  - Drop Point - 2  
Birnam Wood Golf Course  
2031 Packing House Rd, Montecito
  - Drop Point - 3  
1304 Bonnymede Dr, Montecito









