

INCIDENT ACTION PLAN

SILVERADO / BLUE RIDGE

CA-ORC-121364 / CA-ORC-121612

Sunday



OPERATIONAL PERIOD

11/1/2020 0700

to

11/2/2020 0700



INFORMANT REPORT

STEVENS & BURRIDGE

CA 010-151864-111-01-1101

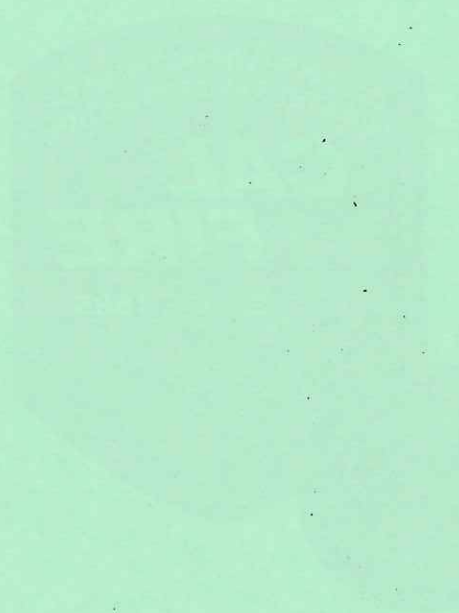

RECEIVED

OFFICIAL REPORT

STATE OF CALIFORNIA

DEPARTMENT OF JUSTICE

CRIMINAL DIVISION

ORGANIZATION ASSIGNMENT LIST (ICS 203)

1. Incident Name: Silverado / Blue Ridge		2. Operational Period: Date From: 11/1/2020 Time From: 0700		Date To: 11/2/2020 Time To: 0700	
3. Incident Commander(s) and Command Staff:			7. Operation Section:		
IC/UC's	J. Veik / M. Petro / N. Cooke		Operations	S. Lanzas / S. Lane (T)	
Deputy	D. Martin (T) / M. Marcucci (T)		Deputy Operations	T. Ernst	
Safety Officer	B. Carter / J. Novak (T) / A. Kibby (T)		Night Ops	J. McGough	
Information Officer	E. Smith / R. Lubben (T)		Staging Area	R. Preston	
Liaison Officer	S. Black / R. Roberts (T) / D. Irion (T)				
4. Agency/Organization Representatives:			Branch	Silverado	D. Esades (12)
Agency/Organization	Name		Division/Group	A	A. Estabrook (T)
Cal OES	D. Stone		Division/Group	L	J. Lopez (12) / N. Ordille (T) (12)
SCE	S. Brown		Division/Group	M / Z	K. McNally (12)
CHP	M. Harris		Division/Group	Silverado FSR	D. Erickson (12)
CDCR	L.T. Sloat		Branch	Blue Ridge	M. Martinez (12)
CALTRANS	D. Brown		Division/Group	BB	D. Schmidt
OC Parks	J. Gannaway		Division/Group	DD	R. Gaylor / R. Perry (T)
OCSO	B. Burk		Division/Group	MM	S. Frederick (12)
CAL FIRE BDU/RRU	S. Littlefield		Division/Group	XX	T. Adams (T) (12)
So Cal Gas	M. Contreras		Division/Group	Blue Ridge FSR	I. McBride (12)
WEROC	V. Osborn		Division/Group		
Irvine PD	F. Jahid		Staging Area	ICP Staging	R. Preston
CAL FIRE RRU	B. Weiser		Division/Group		
City of Yorba Linda	G. Spencer		Division/Group		
City of Irvine	C. Gnad		Division/Group		
Moon Montauk Energy	B. Lawrence		Division/Group		
OCWR	J. Young		Division/Group		
CA State Parks	K. Kietzer		Division/Group		
			Division/Group		
			Division/Group		
5. Planning Section:			Division/Group		
Chief	G. Garcia / D. Scheurich (T)		Division/Group		
Deputy	S. DeBenedet / S. Sherwood (T)		Division/Group		
Resource Unit	J. Heald / J. Anderson / J. Worden (T) / M. Thomas (T)		Division/Group		
Situation Unit	J. Day / I. Crossley (T)		Division/Group		
Demobilization Unit	T. Shevenell / F. Horn (T)		Division/Group		
GISS	T. Knecht / T. Meyer		Division/Group		
FBAN	S. Volmer		Division/Group		
IMET	R. Thompson		Air Operations Branch:		Director: B. Kremensky
Training Tech Spec	S. Vargas		Air Support Group Supervisor		C. Inwood
6. Logistics Section:			Air Tactical Group Supervisor		
Chief	S. Dohman (T)		Helibase Manager		R. Johnson
Deputy Chief	J. Warden (T)				
Supply Unit	P. Lee / D. Zumkeller (T)		8. Finance/Administration Section:		
Facilities Unit	B. Luiz		Chief	S. Hogan	
Ground Support Unit	J. Luckenbach / J. Christofferson (T)		Deputy Chief	G. Belk	
Communications Unit	J. Brooks / C. Johns		Time Unit	J. Navarro	
Medical Unit	J. Segura / J. Staley		Procurement Unit	J. Andrade	
Motel Unit	B. Brewer		Comp/Claims Unit	B. Stirton	
			Cost Unit	J. Tapia	
Prepared By: Name: Gabe Garcia		Position/Title: PSC		Signature: 	
ICS 203		Date/Time: 10/31/2020 2300 hours		NIMS IAP	



INCIDENT Weather Forecast



FORECAST NO: 5
PREDICTION FOR: 24 hour SHIFT
SHIFT DATE: 11/1/20-11/2/20 (0700-0700)
TIME AND DATE
FORECAST ISSUED: 10/31/20 @ 1930

NAME OF FIRE: Silverado/Blue Ridge

UNIT: OCFA/CalFire

SIGNED:

Rich Thompson

Incident Meteorologist

WEATHER DISCUSSION: Weak Santa Ana winds will continue across the area this morning with peak gusts of 20-30 MPH expected. The northeast winds will diminish this afternoon and will shift to a southwesterly and upvalley direction in some areas. For tonight, expect the winds to shift back to the northeast, but winds will be weaker. Warm and dry conditions can be expected today with poor humidity recovery tonight.

On Monday, even slightly warmer and drier conditions are expected with weak Santa Ana winds in the morning. For Tuesday and Wednesday, conditions will be cooler as onshore flow returns to the area.

WEATHER FORECAST:

WEATHER: Partly cloudy.

TEMPERATURES: Maximum: 82-92.
 Minimum: 55-64.

HUMIDITY: Minimum: 8-15%.
 Maximum: 15-30%.

20 FT WINDS:
RIDGETOP -
 0700-1300: Northeast to east 8-15 MPH Gust 20-30 MPH.
 1300-1600: Northeast to east 5-10 MPH Gust 15-20 MPH.
 1600-2000: West to northwest 5-10 MPH Gust 15 MPH.
 2000-0700: Northeast to east 6-12 MPH Gust 15-20 MPH.

SLOPE/VALLEY -
 0700-1200: Northeast 6-12 MPH Gust 15-25 MPH.
 1200-2000: Southwest/upvalley 5-10 MPH Gust 15 MPH.
 2000-0400: Northeast 3-6 MPH Gust 10 MPH.
 0400-0700: Northeast 4-8 MPH Gust 10-15 MPH.

OUTLOOK FOR MONDAY THROUGH WEDNESDAY:

Monday: Partly cloudy. Highs: 84-94. Lows: 56-66. Min RH: 6-12%. Max RH: 15-30%.
 Wind: Northeast 6-12 MPH Gust 20-25 MPH, becoming southwest/upvalley 5-10 MPH Gust 12-15 MPH in the afternoon.

Tuesday: Mostly clear. Highs: 78-88. Lows: 55-65. Min RH: 15-25%. Max RH: 30-50%.
 Wind: Northeast 5-10 MPH Gust 15 MPH, becoming southwest/upvalley 6-12 MPH Gusts 15-20 MPH in the afternoon.

Wednesday: Mostly clear. Highs: 80-90. Lows: 55-65. Min RH: 15-25%. Max RH: 35-55%.
 Wind: Northeast 3-6 MPH Gust 10 MPH, becoming southwest/upvalley 6-12 MPH Gust 15-20 MPH in the afternoon.

FIRE BEHAVIOR FORECAST

FORECAST NUMBER: 5	TYPE OF FIRE: WILDFIRE
FIRE NAME: SILVERADO/BLUE RIDGE	OPERATIONAL PERIOD: 11/1-11/2 0700-0700
DATE ISSUED: 10/31/20	TIME ISSUED: 2000
UNIT: Orange County Fire Authority	SIGNED:  Typed/printed: Stephen Volmer FBAN

INPUTS

WEATHER SUMMARY: Maximum temperatures will be in the high 80s with Relative Humidity in the low teens and single digits. Day time winds 8-15mph from the Northeast with gusts up to 30mph, shifting at 16:00 to West-Northwest 5-10 with gusts to 15mph, then returning to Northeasterly after 20:00 with 6-12mph. Expect poor overnight humidity recovery across both fires. but drop back down throughout the night. Warm and dry conditions with weak Santa Ana winds surfacing. Onshore flow returns Tuesday.

OUTPUTS

FIRE BEHAVIOR

FUEL MODEL	RATE OF SPREAD FT/MIN	FLAME LENGTH FT	SPOTTING DISTANCE	PROBABILITY OF IGNITION
GRASS	157	9	.40	77%
GRASS/SHRUB	99	10	.50	77%
BRUSH	135	23	.80	77%

GENERAL: The annual grasses have cured out completely and will remain extremely dry and able to ignite easily. The brush in the area is below critical levels with the chamise at 60% and the Black Sage at 48%. The Energy Release Component (ERC) has climbed above the 90th percentile, and is expected to continue to rise over the next few days. New fires will become established quickly. Expect spotting if the fire enters the large dense brush fields.

SPECIFIC:

Blue Ridge... Smoldering of heavy materials will continue. The cured grasses and light brush will be a receptive fuel bed for any new ignition or spot to become well established easily. Be alert for canyons that run Southwest to Northeast, as they will be in alignment with the expected shifting wind patterns (Telegraph, Soquel, and Carbon Canyons).

Silverado... Smoldering of heavy materials will continue. The cured grasses and light brush will be a receptive fuel bed for any new ignition or spot to become well established easily. East of El Torro Rd/Santiago Canyon Rd has large areas of dense brush with no fire history. Fire activity will be greatly increased in those areas.

****FORECAST IS VALID FOR ANY NEW IGNITIONS IN SURROUNDING THE AREA****

AIR OPERATIONS: Partly cloudy. Gusty conditions will be present over the ridgetops. Have a secondary plan as aircraft may be committed on other incidents or delayed. Aerial drops will drift heavily in the wind, be alert and be out of the way.

Sunset 16:57 Sunrise 06:12

SAFETY

- Winds increasing and changing direction. Weather getting hotter and dryer.
- Be alert will during suppression repair activities. Rock strikes will be able to ignite new fires.
- Watch for deep seated heat remaining in stump holes and heavy materials.
- Trees in the fire areas, and communities will be stressed again, and have a high potential for release.



SLIVERADO / BLUE RIDGE HEALTH AND SAFETY MESSAGE



Maintain Situational Awareness!!!

INCIDENT: Silverado/Blue Ridge
CA-ORC-121364 / CA-ORC-121612

DATE: November 1, 2020 **TIME:** 0700-0700

Major Hazards and Risks:

COVID - TERRAIN - RECEPTIVE FUELS - DRIVING - FATIGUE -

Situational Awareness: Access your current situation constantly, maintain radio communication with your division, adjacent divisions, and monitor air-to-ground frequencies to understand what is always happening around you. Pay attention to any changes in weather and fire behavior.

Steep slopes/rolling material: Watch your footing while hiking in steep terrain. Be careful of loose rolling debris.

COVID: Wear a mask and practice social distancing. Report any symptoms to immediate supervisor.

Driving: Keep your speeds down on all roads. Be alert for civilian traffic in the fire areas. There are many narrow roads. Park apparatus off the roadway and follow traffic plans. Wear your seatbelts!

Fatigue: Take frequent nutrition and hydration breaks throughout the day. Hydrate with a 3 water to 1 electrolyte drink ratio on hot dry days. Monitor Personnel for fatigue.

Potential Fire Behavior: Be prepared for new fires to start. Fuels are receptive to fire. Consider P.A.C.E and know your L.C.E.S.

Lookouts, Communication, Escape routes, Safety zones

TAILGATE SAFETY

- **Accountability:** Supervisors know where their crews are at all times
- **Hydration and Nutrition:** Monitor each other for proper hydration and nutrition
- **Communication:** Everyone knows the comm plan and follows it.
- **Briefing:** Leaders intent is fully communicated, and safety briefing is provided
- **Safety gear:** Everyone has the appropriate PPE and is using it
- **LCES:** They are clear and made known to everyone

Planning For Medical Emergencies

Supervisors and all firefighters need to Review your ICS 206 ask and be able to answer the following questions:

What are we going to do if someone gets hurt?

- Is there personnel and equipment available to assist?

How will we get them out of here?

- What is your best extraction and transport method? Road, helispot, hoist? Primary plan and contingency plan in place?

How long will it take to get them to the hospital?

- Will you request air or ground resources?
- Are helicopters able to fly?

Prepared by: B.Carter-SOF1

J.Novak SOF1(T)

Date/Time : October 31, 2020 1800

1. Incident Name: Silverado / Blue Ridge		2. Incident Number: CA-ORC-121364 / 121612	
3. Incident Area	4. Hazards/Risks	5. Mitigations	
DIV	HAZARDOUS ACTIONS/CONDITIONS	MITIGATIONS / WARNINGS / REMEDIES	
ALL	COVID 19, ILLNESS, & HYGIENE	Adhere to local, state, federal and CDC health guidelines. Maintain social distancing when applicable. Wear a mask for yourself/others. Report any symptoms immediately to a supervisor. Hygiene, hand washing, and disinfecting of surfaces & handles often. Review ICS206 & IWI procedures.	
ALL	FATIGUE, HEAT, & DEHYDRATION	Don't underestimate the task at hand. Adhere to work/rest cycle for all task(s). Drink water before, during and after shifts, up to 1.5 gal. per shift. Review Heat Related Emergencies (IRPG Pg. 109). Seek shade when you can. Watch for stack-effect of fatigue and exhaustion; REST & Plan operations.	
ALL	COMPLACENCY	Be alert for signs of fatigue and distractions; remain engaged. Know your LCES and maintain situational awareness. Have the right radio clone. Know your adjoining forces and FREQUENCIES. Know your mission and objectives; communicate. Follow a plan. Primary, Alternate, Contingency, Emergency on all new assignments.	
SUPPRESSION REPAIR	FIRELINE SUPPRESSION REPAIR & DOZER SAFETY	Watch for rolling material; Monitor safe working distances. Avoid working below dozer. Utilize communication with the operator (radio or hand signals).	
ALL	FIRE WEATHER	WATCH weather for WIND REVERSAL. Caution to Erratic Winds and Funneling with Drainages and Canyons Watch alignment and rates of spread; no frontal assaults. Expect low humidity. Park into the wind; prevent injury or damage with door control. Calculate tree fall and branch release; project down-wind falling.	
ALL	STEEP TERRAIN / ROLLING DEBRIS	Watch your footing while hiking in steep terrain. Be careful of loose rolling debris. Maintain Situational Awareness . Know Tree Hazards in the work area. Dangerous Mountain Roads – SLOW Defensive Driving.	
ALL	MOP UP, HAZARD TREES, & STUMP HOLES	Identify and isolate the area to provide for the safety of others. Maintain all appropriate PPE for the operation and potential conditions. Do not fall trees out of your certification level. Evaluate wind and lean prior to making cuts. Monitor footing; evaluate work area and routes; tool control is essential.	
ALL	DRIVING HAZARDS	SLOW DOWN! Do 360's before moving vehicles. Utilize Chocks. Drive with headlights and seatbelts on; drive defensively. Watch for residents that have re-populated. Travel distances add additional fatigue; monitor our people. Utilize spotters and backers; when in doubt, scout it out. Assess Road Conditions; Flag hazard if you cannot mitigate, report.	
BLUE RIDGE	POWER POLE PLACEMENT	Look Up, Look Down, Look Around. Be aware of helo and aerial crane operations. Listen to Edison traffic control personnel.	
ALL	DEMOB & PPE	Follow Demob Safety Messaging. Ensure your PPE is in-service. Repair/Replace as needed.	
6. Prepared by: Baraka Carter SOF1 / Jason Nevak SOF1(T)			
ICS 215-A		Operational Period 11/01-02 /2020	Time: 0700 - 0700

ASSIGNMENT LIST (ICS 204 WF)

CONTROLLED UNCLASSIFIED
INFORMATION//BASIC

1. Incident Name: Silverado / Blue Ridge	2. Operational Period: Date From: 11/01/20 Date To: 11/02/20 Time From: 0700 Time To: 0700	3. Branch Division Silverado L Page 1 of 1 Lima
---	---	--

4. Operations Personnel:	
Operations Section Chief: S. Lanzas / S. Lane (T)	Night Ops: J. McGough
Branch Director: D. Esades (12)	Branch Safety: M. Marquardt
Division/Group Supervisor: J. Lopez (12) / N. Ordille (T) (12)	Air Attack:

5. Resources Assigned:		** Resources Below in Bold are 12 Hour **					
Resource Identifier	ALS	S/B	Leader	Personnel	Request #	Hours	Reporting Location
STA XSD 6840A	X	S	G. Mann	22	E-115	0700-0700	ICP

6. Work Assignments:
 Mop up 300' in from control line.
 Backhaul all trash and hose.
 Identify suppression repair needs.

7. Special Instructions:

8. Communications

Name	Ch	Function	Rx Freq	Rx Tone	Tx Freq	Tx Tone	Notes
FIRE OC	1	COMMAND	151.0100N	123.0 (T2)	154.9650N	123.0 (T2)	SIMULCAST SYSTEM
CDF T28	6	TACTICAL	151.1825N	192.8 (T16)	151.1825N	192.8 (T16)	SILVERADO BR
CDF T20	13	AIR TO GROUND	159.3750N	192.8 (T16)	159.3750N	192.8 (T16)	
CALCORD	15	MEDICAL	156.0750N	156.7 (T6)	156.0750N	156.7 (T6)	
GUARD 28	16	EMERGENCY	168.6250N		168.6250N	110.9 (T1)	EMERGENCY USE ONLY

9. Prepared by: Name: Jamie Heald RESL 24 Hr Shift: 22
 Signature: 12 Hr Shift: 0
 ICS 204 Date/Time: 10/31/2020 2200 Total: 22

ASSIGNMENT LIST (ICS 204 WF)

CONTROLLED UNCLASSIFIED
INFORMATION/BASIC

1. Incident Name: Silverado / Blue Ridge	2. Operational Period: Date From: 11/01/20 Date To: 11/02/20 Time From: 0700 Time To: 0700	3. Branch Division Silverado M / Z
		Page 1 of 1

4. Operations Personnel:		Night Ops: J. McGough
Operations Section Chief: S. Lanzas / S. Lane (T)		Branch Safety: M. Marquardt
Branch Director: D. Esades (12)		Air Attack:
Division/Group Supervisor: K. McNally (12)		

5. Resources Assigned:		** Resources Below in Bold are 12 Hour **				Hours	Reporting Location
Resource Identifier	ALS	S/B	Leader	Personnel	Request #		
STC XOR 1400C	X	S	E. Miranda	20	E-7	0700-1900	ICP
SOFR STORNETTA		S	M. Stornetta	1	O-189	0700-1900	ICP

6. Work Assignments:
 Mop up 300' in from control line.
 Backhaul all trash and hose.
 Identify suppression repair needs.

7. Special Instructions:

8. Communications							
Name	Ch	Function	Rx Freq	Rx Tone	Tx Freq	Tx Tone	Notes
FIRE OC	1	COMMAND	151.0100N	123.0 (T2)	154.9650N	123.0 (T2)	SIMULCAST SYSTEM
VFIRE 25	7	TACTICAL	154.2875N	156.7 (T6)	154.2875N	156.7 (T6)	SILVERADO BR
CDF T20	13	AIR TO GROUND	159.3750N	192.8 (T16)	159.3750N	192.8 (T16)	
CALCORD	15	MEDICAL	156.0750N	156.7 (T6)	156.0750N	156.7 (T6)	
GUARD 28	16	EMERGENCY	168.6250N		168.6250N	110.9 (T1)	EMERGENCY USE ONLY

9. Prepared by: Name:	Jamie Heald	RESL	24 Hr Shift: 0
	Signature:		12 Hr Shift: 21
ICS 204	Date/Time: 10/31/2020 2200		Total: 21

ASSIGNMENT LIST (ICS 204 WF)

CONTROLLED UNCLASSIFIED
INFORMATION//BASIC

1. Incident Name: Silverado / Blue Ridge	2. Operational Period: Date From: 11/01/20 Date To: 11/02/20 Time From: 0700 Time To: 0700	3. Branch Division Silverado Silverado FSR
4. Operations Personnel:		Page 1 of 1

Operations Section Chief: S. Lanzas / S. Lane (T)	Night Ops: J. McGough
Branch Director: D. Esades (12)	Branch Safety: M. Marquardt
Division/Group Supervisor: D. Erickson (12)	Air Attack:

5. Resources Assigned:	** Resources Below in Bold are 12 Hour **							
Resource Identifier	ALS	S/B	Leader	Personnel	Request #	Hours	Reporting Location	
STF XSJ 4189F		B	C. Allen	16	E-96	0700-1900	ICP	
STG TUU 9413G (CDC)		S	D. Avila	34	C-9	0700-1900	ICP	
STG BDU 9350G (CDC)		S	J. Hatch	32	C-1	0700-1900	ICP	
DOZ PVT E-74		S	B. Restad	1	E-74	0700-1900	ICP	
DOZ PVT E-77		S	R. Francis	1	E-77	0700-1900	ICP	
DOZ PVT E-79		S	M. Richenberg	2	E-79	0700-1900	ICP	
DOZ PVT E-80		S	G. Gates	1	E-80	0700-1900	ICP	
DOZ ORC 1		S	D. Brown	1	E-282	0700-1900	ICP	
W/T PVT E-266		S	J. Corley	2	E-266	0700-1900	ICP	
W/T PVT E-268		S	D. Cleer	1	E-268	0700-1900	ICP	
EXC ORC EXCAVATOR		S	A. Perault	1	E-290	0700-1900	ICP	
GRD ORC GRADER 1		S	D. Hahn	1	E-291	0700-1900	ICP	
FSRS GNADT		S	C. Gnad	1	O-253	0700-1900	ICP	
HEQB NEWELL		S	D. Newell	1	O-357	0700-1900	ICP	
HEQB CELIS (T)		S	J. Celis	1	O-359	0700-1900	ICP	

6. Work Assignments:
Identify suppression repair needs.
Coordinate suppression repair efforts.

7. Special Instructions:

8. Communications

Name	Ch	Function	Rx Freq	Rx Tone	Tx Freq	Tx Tone	Notes
FIRE OC	1	COMMAND	151.0100N	123.0 (T2)	154.9650N	123.0 (T2)	SIMULCAST SYSTEM
VFIRE 23	8	TACTICAL	154.2950N	156.7 (T6)	154.2950N	156.7 (T6)	
CDF T20	13	AIR TO GROUND	159.3750N	192.8 (T16)	159.3750N	192.8 (T16)	
CALCORD	15	MEDICAL	156.0750N	156.7 (T6)	156.0750N	156.7 (T6)	
GUARD 28	16	EMERGENCY	168.6250N		168.6250N	110.9 (T1)	EMERGENCY USE ONLY

9. Prepared by: Name:	Jamie Heald	RESL	24 Hr Shift: 0
	Signature:		12 Hr Shift: 96
ICS 204	Date/Time: 10/31/2020 2200		Total: 96

ASSIGNMENT LIST (ICS 204 WF)

CONTROLLED UNCLASSIFIED
INFORMATION//BASIC

1. Incident Name: Silverado / Blue Ridge	2. Operational Period: Date From: 11/01/20 Date To: 11/02/20 Time From: 0700 Time To: 0700	3. Branch Division Blue Ridge BB
---	---	---

4. Operations Personnel:		
Operations Section Chief: S. Lanzas / S. Lane (T)	Night Ops: J. McGough	Page 1 of 1 Bravo-Bravo
Branch Director: M. Martinez (12)	Branch Safety: D. Balao	
Division/Group Supervisor: D. Schmidt	Air Attack:	

5. Resources Assigned:	** Resources Below in Bold are 12 Hour **					Hours	Reporting Location
Resource Identifier	ALS	S / B	Leader	Personnel	Request #		
STA ORC 1406A	X	B	C. Ashby	21	E-53	0700-1900	ICP
STC TCU 9441C		S	J. Fredrick	16	E-65	0700-0700	ICP
STC TCU 9440C		S	K. Bohall	16	E-15	0700-1900	ICP
SOFR BISCAILUZ (T)		S	J. Biscailuz	1	O-80	0700-1900	ICP

6. Work Assignments:
Tactical Patrol.

7. Special Instructions:

8. Communications							
Name	Ch	Function	Rx Freq	Rx Tone	Tx Freq	Tx Tone	Notes
FIRE OC	1	COMMAND	151.0100N	123.0 (T2)	154.9650N	123.0 (T2)	SIMULCAST SYSTEM
CDF T29	9	TACTICAL	151.3475N	192.8 (T16)	151.3475N	192.8 (T16)	BLUE RIDGE BR
CDF T25	14	AIR TO GROUND	159.2775N	192.8 (T16)	159.2775N	192.8 (T16)	
CALCORD	15	MEDICAL	156.0750N	156.7 (T6)	156.0750N	156.7 (T6)	
GUARD 28	16	EMERGENCY	168.6250N		168.6250N	110.9 (T1)	EMERGENCY USE ONLY

9. Prepared by: Name: Jamie Heald RESL 24 Hr Shift: 16
 Signature: 12 Hr Shift: 38
 Date/Time: 10/31/2020 2200 Total: 54

ICS 204

ASSIGNMENT LIST (ICS 204 WF)

CONTROLLED UNCLASSIFIED
INFORMATION/BASIC

1. Incident Name: Silverado / Blue Ridge		2. Operational Period: Date From: 11/01/20 Date To: 11/02/20 Time From: 0700 Time To: 0700		3. Branch Blue Ridge	Division DD
4. Operations Personnel:				Page 1 of 1	Delta-Delta

Operations Section Chief: S. Lanzas / S. Lane (T)	Night Ops: J. McGough
Branch Director: M. Martinez (12)	Branch Safety: D. Balao
Division/Group Supervisor: R. Gaylor / R. Perry (T)	Air Attack:

5. Resources Assigned:	** Resources Below in Bold are 12 Hour **						
Resource Identifier	ALS	S / B	Leader	Personnel	Request #	Hours	Reporting Location
STC SLU 9340C		S	J. Heinbach	16	E-58	0700-0700	ICP
STC FKU 9430C		S	M. Bowman	16	E-5	0700-1900	ICP

6. Work Assignments: Tactical Patrol.

7. Special Instructions:

8. Communications							
Name	Ch	Function	Rx Freq	Rx Tone	Tx Freq	Tx Tone	Notes
FIRE OC	1	COMMAND	151.0100N	123.0 (T2)	154.9650N	123.0 (T2)	SIMULCAST SYSTEM
CDF T31	10	TACTICAL	159.3825N	192.8 (T16)	159.3825N	192.8 (T16)	BLUE RIDGE BR
CDF T25	14	AIR TO GROUND	159.2775N	192.8 (T16)	159.2775N	192.8 (T16)	
CALCORD	15	MEDICAL	156.0750N	156.7 (T6)	156.0750N	156.7 (T6)	
GUARD 28	16	EMERGENCY	168.6250N		168.6250N	110.9 (T1)	EMERGENCY USE ONLY

9. Prepared by: Name: Jamie Heald	RESL	24 Hr Shift: 16
Signature: <i>J Heald</i>		12 Hr Shift: 16
ICS 204	Date/Time: 10/31/2020 2200	Total: 32

ASSIGNMENT LIST (ICS 204 WF)

CONTROLLED UNCLASSIFIED
INFORMATION//BASIC

1. Incident Name: Silverado / Blue Ridge	2. Operational Period: Date From: 11/01/20 Date To: 11/02/20 Time From: 0700 Time To: 0700	3. Branch Staging ICP Staging
4. Operations Personnel:		Page 1 of 1

Operations Section Chief: S. Lanzas / S. Lane (T)	Night Ops: J. McGough
Branch Director:	Branch Safety:
Division/Group Supervisor: R. Preston	Air Attack:

5. Resources Assigned:		** Resources Below in Bold are 12 Hour **					
Resource Identifier	ALS	S / B	Leader	Personnel	Request #	Hours	Reporting Location
STC MMU 9421C		S	J. Slate	16	E-66	0700-1900	ICP
STA XOR 1431A	X	S	T. Sandifer	21	E-21	0700-1900	ICP
FALM O-373		S	J. Laan	2	O-373	0700-1900	ICP

6. Work Assignments:
 Maintain 3 minute response time.
 Monitor command frequencies.

7. Special Instructions:

8. Communications

Name	Ch	Function	Rx Freq	Rx Tone	Tx Freq	Tx Tone	Notes
FIRE OC	1	COMMAND	151.0100N	123.0 (T2)	154.9650N	123.0 (T2)	SIMULCAST SYSTEM
CALCORD	15	MEDICAL	156.0750N	156.7 (T6)	156.0750N	156.7 (T6)	
GUARD 28	16	EMERGENCY	168.6250N		168.6250N	110.9 (T1)	EMERGENCY USE ONLY

9. Prepared by: Name: Jamie Heald RESL 24 Hr Shift: 0
 Signature: 12 Hr Shift: 39
 ICS 204 Date/Time: 10/31/2020 2200 Total: 39

MEDICAL PLAN (ICS 206)

1. Incident Name: SILVERADO / BLUE RIDGE		2. Operational Period: Date From: 11/1/20 Date To: 11/2/20					
		Time From: 0700 Time To: 0700					
3. Medical Aid Stations:							
Name	Location	Contact Number/Freq	Physician				
MERT	Prado Camp	Orange Communications	<input type="checkbox"/> No				
CAL-MAT	Silverado ICP	Orange Communicatons	Yes				
4. Transportation (indicate air or ground):							
Ambulance Service	Location	Contact Number	Level of Service				
Care Ambulance XRay 1	Silverado ICP	Orange Communications	BLS				
ORC (Hoist)	Fullerton	Orange Communications	ALS				
Mercy Air	Fullerton	Orange Communications	ALS				
5. Hospitals:							
Hospital Name	Address,	Contact Number(s)/ Frequency	Travel Time		Trauma Center	Burn Center	Helipad
	Lat & Long Helipad		Air	Ground			
Mission Hospital	27700 Medical Center Rd. N 33' 33.63' W 117' 39.92'	(949) 364-1181	5	14	Level 2	<input type="checkbox"/>	<input checked="" type="checkbox"/>
UCI	101 The City Dr, Orange N 33' 78.73 W 117' 88.83"	(714) 456-7890	5	35	Level 2	<input checked="" type="checkbox"/>	<input checked="" type="checkbox"/>
Placentia Linda	1301 N. Rose Dr. Placentia	(714) 993-2000	N/A	14	EDAT	<input type="checkbox"/>	<input type="checkbox"/>
6. Special Medical Emergency Procedures							
Line Emergency Crew Supervisor will contact Division Supervisor with patient complaint/condition and location. - Division Group Supervisor Contacts: 1. Closest EMS resource 2. Communications Unit - Communications Unit Contacts: 1. Ground or Air ambulance as requested. 2. Operations 3. Safety 4. Medical Unit - Division Supervisor or designee will serve as point of contact and run medical emergency on assigned channel. 1. A pre-assigned tactical frequency (i.e. CALCORD) should be used for IWI and only for duration of the emergency. - Communications Unit will clear the Command channel for emergency traffic as needed for duration of the need. Direct all medical issues to the MERT.				Injury Reporting Procedures Nature of Injury: _____ Location of Patient: _____ Point of Contact: _____ Transportation Requested by: Air ___ Ground ___ Point of Pick-Up: _____ Lat: _____ Long: _____ Patient Unit ID: _____ Is an EMT with Patient: Yes ___ No ___ Age: _____ Sex: Male ___ Female ___			
Camp Emergency - Medical Unit contacts 1. Communications 2. Safety 3. Logistics 4. Operations 5. Crew Supervisor 6. Comp/Claims				ALL EMERGENCIES—Secure the area and identify witnesses for later investigation. Keep an accurate log of events. **IN CAMP EMERGENCY** (619)818-8437			
<input type="checkbox"/> Check box if aviation assets are utilized for rescue. If assets are used, coordinate with Air Operations.							
7. Prepared by (Medical Unit Leader): J. Segura J. Staley				Signature: _____			
8. Approved by (Safety Officer): B. Carter J. Novak				Signature: _____			
ICS 206		NIMS IAP		Date/Time:		10/31/20 1800	

ICS 205 - INCIDENT RADIO COMMUNICATIONS PLAN

CONTROLLED UNCLASSIFIED
INFORMATION//BASIC

1. Incident Name: Silverado / Blue Ridge		2. Date/Time Prepared Date: 10/31/2020 Time: 1600		3. Operational Period: Date From: 11/01/20 Time From: 0700		Date To: 11/02/20 Time To: 0700		
4. Communications								
Ch#	Function	Name	Assigned To	Rx Freq	Rx Tone	Tx Freq	Tx Tone	Notes
1	COMMAND	FIRE OC	ALL ZONES	151.0100N	123.0 (T2)	154.9650N	123.0 (T2)	SIMULCAST SYSTEM
2								
3								
4								
5	TACTICAL	CDF T26	DIV A	159.2925N	192.8 (T16)	159.2925N	192.8 (T16)	SILVERADO BR
6	TACTICAL	CDF T28	DIV L	151.1825N	192.8 (T16)	151.1825N	192.8 (T16)	SILVERADO BR
7	TACTICAL	VFIRE 25	DIV M / Z	154.2875N	156.7 (T6)	154.2875N	156.7 (T6)	SILVERADO BR
8	TACTICAL	VFIRE 23	BLUE RIDGE FSR & SILVERADO FSR	154.2950N	156.7 (T6)	154.2950N	156.7 (T6)	BLUE RIDGE FSR & SILVERADO FSR
9	TACTICAL	CDF T29	DIV BB	151.3475N	192.8 (T16)	151.3475N	192.8 (T16)	BLUE RIDGE BR
10	TACTICAL	CDF T31	DIV DD	159.3825N	192.8 (T16)	159.3825N	192.8 (T16)	BLUE RIDGE BR
11	TACTICAL	VTAC13	DIV MM	158.7375N	156.7 (T6)	158.7375N	156.7 (T6)	BLUE RIDGE BR
12	TACTICAL	VTAC14	DIV XX	159.4725N	156.7 (T6)	159.4725N	156.7 (T6)	BLUE RIDGE BR
13	AIR TO GROUND	CDF T20	SILVERADO BR	159.3750N	192.8 (T16)	159.3750N	192.8 (T16)	
14	AIR TO GROUND	CDF T25	BLUE RIDGE BR	159.2775N	192.8 (T16)	159.2775N	192.8 (T16)	
15	MEDICAL	CALCORD	ALL ZONES	156.0750N	156.7 (T6)	156.0750N	156.7 (T6)	
16	EMERGENCY	GUARD 28	ALL ZONES	168.6250N		168.6250N	110.9 (T1)	EMERGENCY USE ONLY
17								
18								
19								
20	EMERGENCY	GUARD 28	ALL ZONES	168.6250N		168.6250N	110.9 (T1)	EMERGENCY USE ONLY
5. Special Instructions								
<p style="text-align: center;">TO CONFIRM YOU HAVE THE MOST CURRENT CLONE, ENSURE YOUR DISPLAY OF CHANNEL 16 OR 20 MATCHES CHANNEL 16 OR 20 OF THE 205 - HEIGHT AND POWER ARE KEY WHEN USING RADIOS; BE AT A HIGH POINT, USE A MOBILE IF POSSIBLE, AND USE RADIO RELAYS WHEN NEEDED</p>								
6. Prepared by (Communications Unit Leader): Name: J. Brooks / C. Johns				Signature: 		Date/Time: 10/31/20 1600		
ICS 205 - CONTROLLED UNCLASSIFIED INFORMATION//BASIC								

TRAINING MESSAGE

*****Training will be closing out at 1500 hours tomorrow. You must see Training prior to this time to receive a Validated Training Assignment.**

TRAINERS

- **Complete the PTB Evaluation Record prior to Demob**
- **Complete an ICS 225 (Personal Performance Record) prior to Demob**
- **Complete the Final Evaluator's Verification page in the PTB if you are recommending them for qualification**

TRAINEES

- **Ensure you have the above-mentioned documents completed and signed by your Trainer prior to Demob**
- **You do not have to wait for your assigned Demob time to close out with the Training Specialist**

**Any questions please contact the
Training Specialist:
Shane Vargas (530) 410-4225**



CAL FIRE INCIDENT MANAGEMENT TEAM 6

Jeff Veik- INCIDENT COMMANDER



SILVERADO / BLUE RIDGE CA-ORC-121364 / CA-ORC-121612 DEMOBILIZATION PLAN - SUMMARY

GENERAL INFORMATION

The Demobilization Plan is developed to facilitate the orderly removal and checkout of resources on the incident. Surplus Personnel are available for release if they have rested for a minimum of 8 hours, are cleaned up, outfitted and have a vehicle ready to depart to their next destination.

GENERAL GUIDELINES

- **NO RESOURCES WILL LEAVE THE INCIDENT UNTIL AUTHORIZED TO DO SO BY THE DEMOB UNIT.**
- Efforts will be made to ensure that all released personnel arrive at their destination prior to 2200 hours.
- All Resources will arrive at the Demobilizations Unit at their scheduled time Only.
- All government and hired vehicles leaving the incident will have a safety inspection. If a vehicle is within 1,000 miles of a "B" service, it is recommended of the resource to contact Ground Support and have an oil change prior to their scheduled demobilization time.
- **All Rental Vehicles will receive a safety inspection prior to leaving the incident.**
- All trainees are to keep their time up to date and report to the Training Specialist with their task books and evaluations prior to completion of the demobilization process.
- All strike team leaders are responsible to call **South Ops at 1-800-237-3703** immediately upon being released from the incident

RESPONSIBILITIES

Unit Leaders will declare resources excess to their **Section Chief**. **Section Chiefs** will declare excess resources to the Planning Section Chief through the **Resource Unit Leader**. This should be done 36 hours in advance of anticipated release. **Use the Declaration of Excess Resources sheet or General Message Form (ICS-213) to list all excess resources.** Include the resource name, request number, name of person, date and time of declared excess, and time in which the resource will be eligible to leave. Send to the **RESOURCE UNIT** where the resource will be determined to be surplus to the incident. Surplus resources will then be able to report to the **DEMOB UNIT**, receive a Demobilization Checkout Form (ICS 221), get the appropriate ICS 221 signatures, and then return the completed ICS 221 to the **DEMOB UNIT** prior to final release or reassignment. Resources are not to contact **South Ops** or the expanded dispatch center unless instructed to do so by the Demobilization Unit.

RELEASE PRIORITIES

1. **Organized fire departments**
2. **OES engines**
3. **Hired personnel and equipment**
4. **Other agencies (USFS, BLM, etc.)**
5. **Out of region CAL FIRE forces**
6. **Within Region CAL FIRE Forces**
7. **Unit CAL FIRE Forces**

TRAVEL INFORMATION

All resources will meet agency specific requirements on hours of travel per day. For CAL FIRE hand crews, a full 24 hour reset period shall be adhered to before departing from the incident. After a crew's last operational period they shall begin the demobilization release procedure during their 24-hour off shift. In addition, they must use the following complete 24-hour period as reset time before they depart from the incident.



FINANCE MESSAGE



CAL FIRE TIME UNIT (Personnel and Hired Equipment)

- **CAL FIRE PERSONNEL** – make sure you have started your eFC-33's and update after each shift. Please make sure E-pay schedules are up to date.
- **HIRED EQUIPMENT SUPPLIERS** – Check in with the Time Unit and drop off your agreements.
- **SHIFT TICKET BOOKS** – available for agency line supervisors only and are in the Time Unit.

DIVISION / GROUP - LINE SUPERVISORS

- Please make sure to turn in hired equipment shift tickets at the end of each shift.

COMP / CLAIMS

- **WATER SOURCE WORKSHEET:** Use QR Code Below
- **Damage Claims (suppression, property, vehicle)**
 - ICS-213 - We will need location, description of damages, and your contact information.

FEDERAL TIME:

- E-mail all time documents concerning federal resources to the following:

R5.calfire.support@firenet.gov

Silverado P-Number PNNP0C 1522
Blue Ridge P-Number P54MP0P 0502

CAL OES REPRESENTATIVE

- Located near TIME UNIT

No off-site feeding is permitted!

WATER SOURCE WORKSHEET QR CODE





CAL FIRE INCIDENT MANAGEMENT TEAM 6



Established 1994

Toll Road Waiver Request

If you drove on toll roads during your assignment on the Blue Ridge or Silverado Fires, and you would like to request a toll waiver, please complete the Google form.



<https://forms.gle/tS3o3b6boEJDdgn38>

SHIFT TICKET EXAMPLE

EMERGENCY SHIFT TICKET and EVALUATION FORM					Contractor Name DOZER DUDE		
Incident or Project Name SILVERADO		Incident Number CAORC 121364		Request Number E#		Operator #1 BOB SMITH	
Agreement Number XXX - 000000 - 00						Operator #2 TOM SMITH	
Equipment Make CAT		Equipment Model / Type D6XM		Operator Furnished By: <input checked="" type="checkbox"/> Contractor <input type="checkbox"/> Government			
Serial Number 111111		Licence Number 111111		Operating Supplies Furnished By: <input checked="" type="checkbox"/> Contractor <input type="checkbox"/> Government			
				Equipment Status <input checked="" type="checkbox"/> Inspected <input checked="" type="checkbox"/> Under Agreement			
				Released by Government <input type="checkbox"/>			
				Withdrawn by Contractor <input type="checkbox"/>			
Equipment Use (Circle) Hours Days / Miles					Remarks/Comments **		
Date Mo / Day	Start	Stop	Work	Assignment		NO DAMAGE/ NO CLAIMS	
10/27	0700	2400	17	DIV M			
10/28	0001	0700	7	DIV M			
Vendor Rating					Govt. Rep. Name and Position - PRINT		
		Poor*	Avg.	Good	Exc.	N/A	Mike Weber
Met Performance Expectations		Vendor Rating must be done.				Govt. Rep. Signature <i>Mike Weber</i>	
Equipment in Safe Working Condition						Contractor Signature <i>Bob Smith</i>	
Operator Skill Level						Date 08/18/20	
Operates Safely						Time 0800	
Operator's Cooperation Level						Calfire 297 (Rev 3-2011)	
Overall Performance							
* NOTE: Any rating of POOR requires an explanation in Comment Section.							
**Final evaluation or for more documentation, use an ICS Form 230 or equivalent.							
Pink - Finance		Blue - Home Unit HE Coordinator		Yellow - Vendor		White - Govt Representative	

EMERGENCY SHIFT TICKET and EVALUATION FORM					Contractor Name DUDE TRANSPORT		
The responsible Government Officer will complete this form each shift							
Incident or Project Name SILVERADO		Incident Number CAORC 121364		Request Number E # Here		Operator #1 BOB SMITH	
Agreement Number XXX - 000000 - 00						Operator #2 TOM SMITH	
Equipment Make TRANSPORT/ KENWORTH		Equipment Model / Type COZAD TRAILER /26 WHEELS		Operator Furnished By: <input checked="" type="checkbox"/> Contractor <input type="checkbox"/> Government			
Serial Number 1XP3ESMP14239012		Licence Number 9999999		Operating Supplies Furnished By: <input checked="" type="checkbox"/> Contractor <input type="checkbox"/> Government			
				Equipment Status <input checked="" type="checkbox"/> Inspected <input checked="" type="checkbox"/> Under Agreement			
				Released by Government <input type="checkbox"/>			
				Withdrawn by Contractor <input type="checkbox"/>			
Equipment Use (Circle) Hours Days / Miles					Remarks/Comments **		
Date Mo / Day	Start	Stop	Work	Assignment		NO DAMAGE/ NO CLAIMS	
10/27	0700	2400	17	DIV M			
10/28	0001	0700	7	DIV M			
Vendor Rating					Govt. Rep. Name and Position - PRINT		
		Poor*	Avg.	Good	Exc.	N/A	Mike Weber
Met Performance Expectations		Vendor Rating must be done.				Govt. Rep. Signature <i>Mike Weber</i>	
Equipment in Safe Working Condition						Contractor Signature <i>Bob Smith</i>	
Operator Skill Level						Date 08/18/20	
Operates Safely						Time 0800	
Operator's Cooperation Level						Calfire 297 (Rev 3-2011)	
Overall Performance							
* NOTE: Any rating of POOR requires an explanation in Comment Section.							
**Final evaluation or for more documentation, use an ICS Form 230 or equivalent.							
Pink - Finance		Blue - Home Unit HE Coordinator		Yellow - Vendor		White - Govt Representative	

Turn shift tickets into Time Unit.

PUBLIC INFORMATION



OFFICIAL SOURCES OF PUBLIC INFORMATION

Incident Information Line: 714-628-7085
Incident Media Line: 949-396-3998 or 949-573-5703
Incident Website: www.fire.ca.gov
Email Signup: <https://tinyurl.com/CALFIREMEDIA>



EMAIL SIGN-UP



EVACUATION MAPS

CURRENT STATUS

Incident Start Date/Time: October 26, 2020 6:47 AM		Incident Start Date/Time: October 26, 2020 12:56 PM	
Silverado		Blue Ridge	
Acreage:	Containment:	Acreage:	Containment:
Cause: Under Investigation		Total Personnel:	

Media Law

The California State Penal Code Section 409.5(d) allows the news media to enter scenes of disaster, riot, or civil disturbance. Properly identified members of the news media should not be restricted from entering locations specified within the code. However, this does not include crime scenes, and does not imply that the news media may interfere with incident operations while they are in the areas of concern. If entering such a location that is hazardous, they should be advised; media access cannot be prevented for safety reasons unless their presence would impede CAL FIRE's mitigation of the incident or the disturbing of evidence. When working around the media, remember:

- Media **is not permitted** on private property without the property owner's permission.
- If approached and questioned by the media and/or the public, talk about your assignment or task at hand. Remember to wear all the appropriate PPE.
- If needed call for an incident PIO through the chain of command.
- Never speculate, give opinions or speak for others.
- There is no such thing as an "off the record" comment.

CAL FIRE Social Media Policy (Social Media 0691)

Social Media is increasingly being used by public agencies, the media as well as the public. This form of communication continues to grow rapidly in order to supply the instant gratification needs of society. Therefore, when on a CAL FIRE incident, you will adhere to the CAL FIRE Social Media Policy, 0691. You can get further information about the CAL FIRE Social Media Policy from the incident Public Information Officer. While assigned to the incident, there will be no posting of:

- Inappropriate information or materials, no opinions, no endorsements, inappropriate pictures or videos

Lost and Found

The Information Section will manage Lost and Found items for the incident. If you have lost an item leave your contact information and what you have lost at the Information Section. If you have found an item on the incident, bring the item to the Information Section with your contact information as well.

Incident Base Camp Mailing Address

c/o Public Information Office/Trailer
163 Pusan Way
Irvine CA 92618



INCIDENT PEER SUPPORT:



Team members are available on the incident for any peer support related needs. The best way to get a hold of them is to call them directly or stop by the ESS Trailer

In addition, there is an onsite clinician available to meet on an individual and/or group basis

Jeremy Sanders 916-281-6472

Mike Deleo 916-661-0724

or

CAL FIRE 24 Hr. Peer Support/Helpline

916-445-4337

Below are other Team Members not on the incident who can also be contacted directly:

Tony Howard 916-224-1543

Mike Aiello 916-584-0548

Warren Parrish 916-823-6641

Nikole Schutz 916-709-0434

Amber Henderson 805-794-1690

Chris Lomanto 916-247-6974

Connie Quarisa 916-213-8697

Noelle BahnMiller 916-661-0011

Krissy Shaefer 619-592-6337

Shawna Powell 530-717-0667

Amy Head 916-956-3277

Watch for the signs and symptoms of stress in yourself and the people around you. Try and stay positive and get much needed rest when you can. We can do this, together!

A message to our firefighters from **ASHLEY IVERSON**.



Stay Healthy, Stay Alert and Stay Strong!

FIRE SUPPRESSION REPAIR PLAN: SILVERADO / BLUE RIDGE

Fire Suppression Repair is the repair of damage caused directly from fire suppression activities. It is not the repair of infrastructure or rehabilitation of burned areas that happened as a result of the fire itself.

Damaged facilities will be returned to functional status in order to prevent further damage. Projects too large or complex to be completed by the Fire Suppression Repair Group shall be transferred to the Comp/Claims Unit or the local Unit. Repair work shall only occur in locations authorized by the Operations Section and where fire suppression activities are complete. Fire Suppression Repair Group resources shall evaluate all Divisions for appropriate repair needs. This includes areas inside and outside the fire perimeter, provided the damage was caused by official fire suppression activities. Extra care will be exercised and equipment will be monitored when operating in locations where new fire starts are more likely to occur, such as rocky areas in dry grass. New fires will be reported following the instructions in the radio call plan.

Examples of items that may be repaired include, but are not limited to:

Infrastructure Damage	Natural Resource Damage
Fences and gates	Soil erosion
Culverts, bridges, and other watercourse crossings	Adverse impacts to air and water quality
Water sources	Adverse impacts to protected species of plants and animals
Utility distribution lines (above or below ground)	
Road barriers removed for fire access	Adverse impacts to cultural or archaeological sites
Trash, debris, and supplies left by fire suppression resources	
Miscellaneous damage to residential property	

Dozer Line Repair

Dozers construct both fire and contingency lines. Dozer line width varies greatly. The following measures shall be implemented for constructed dozer line:

- Berms and push-piles shall be spread out to the extent feasible. This may be accomplished by back-blading and/or using ripper shanks or grapples. Debris piled against trees or perched above watercourses is especially important to remove or disperse.
- Waterbreaks shall be constructed at a 30-45 degree angle and shall be a minimum depth of 12 inches from the bottom of the cut to the top of the berm. Where feasible, the discharge from waterbreaks shall be directed into vegetated or rockied areas.
- Where slopes exceed the range at which a tractor can effectively work, waterbreaks shall be constructed with hand tools.
- Roads used in fire suppression activities shall be left in the same condition they were found or better. Gravel and soil-surfaced roads shall be watered to prevent excessive dust. Where fire suppression activities have damaged or rendered road drainage facilities non-functional, waterbreaks or drivable dips shall be installed for drainage.
- Where fire suppression activities have filled in or damaged inside ditches, the ditches shall be cleaned and left unobstructed.
- Spacing of waterbreaks shall be as follows:

Prevailing gradient	Maximum waterbreak spacing
0-10%	200 feet
11-25%	150 feet
26-50%	100 feet
>50%	75 feet

Spacing criteria is a general guide. Actual location of waterbreaks should be tailored to the topography and placement suited to the best dispersal of water flow.

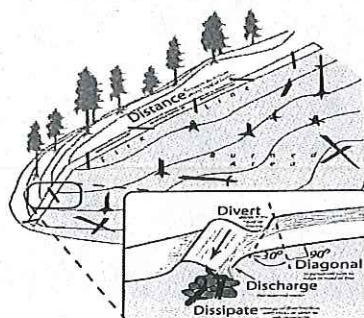



CAL FIRE INCIDENT MANAGEMENT TEAM 6



Base Camp Map

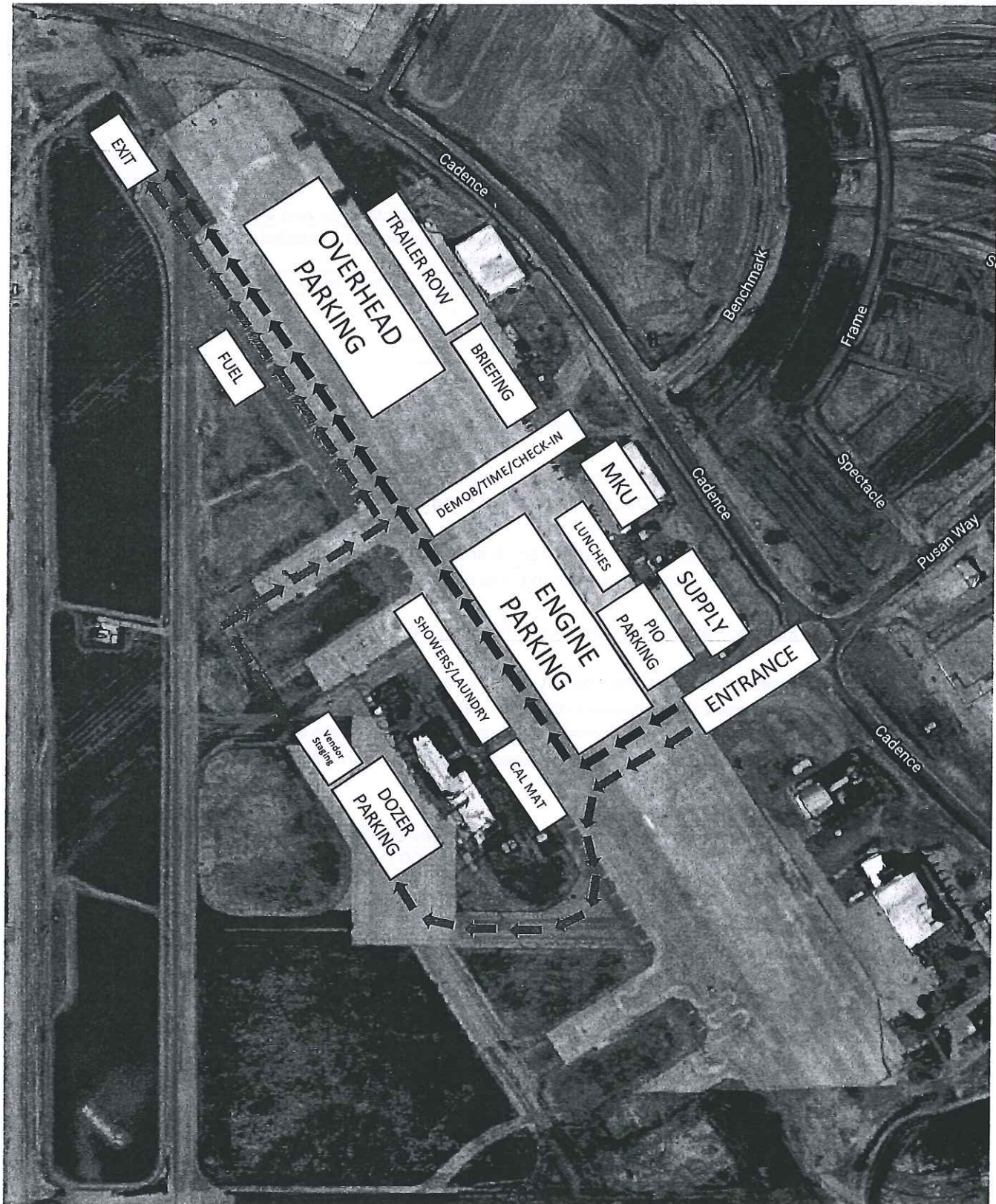



CAL FIRE INCIDENT MANAGEMENT TEAM 6



Silverado Fire Ground Support Map

Irvine Regional Park
1 Irvine Park Rd.
Orange, CA 92869

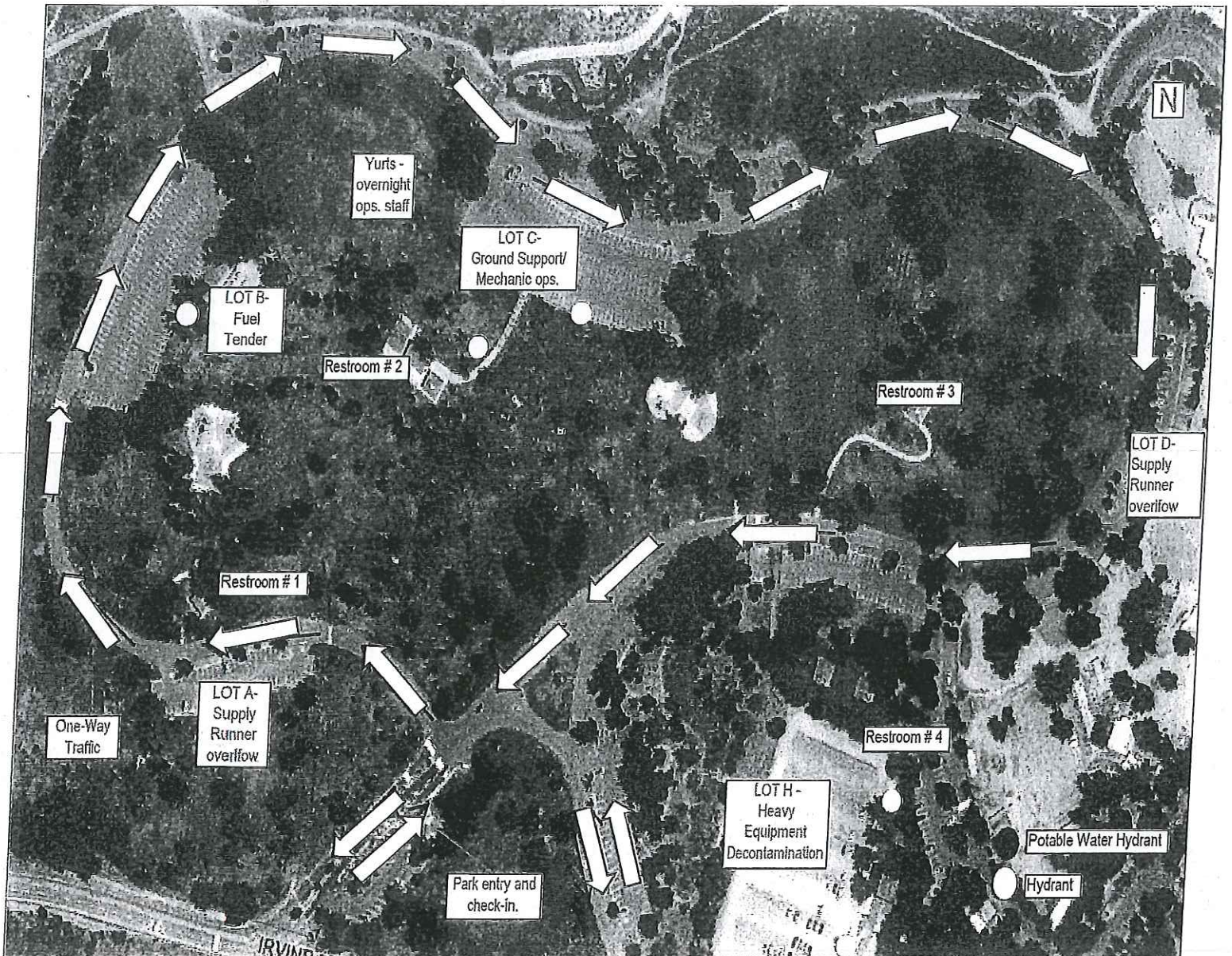



TRAVEL MAP

BLUE RIDGE INCIDENT - SILVERADO INCIDENT

CA ORC 121612 - CA ORC 121364

NOVEMBER 1, 2020

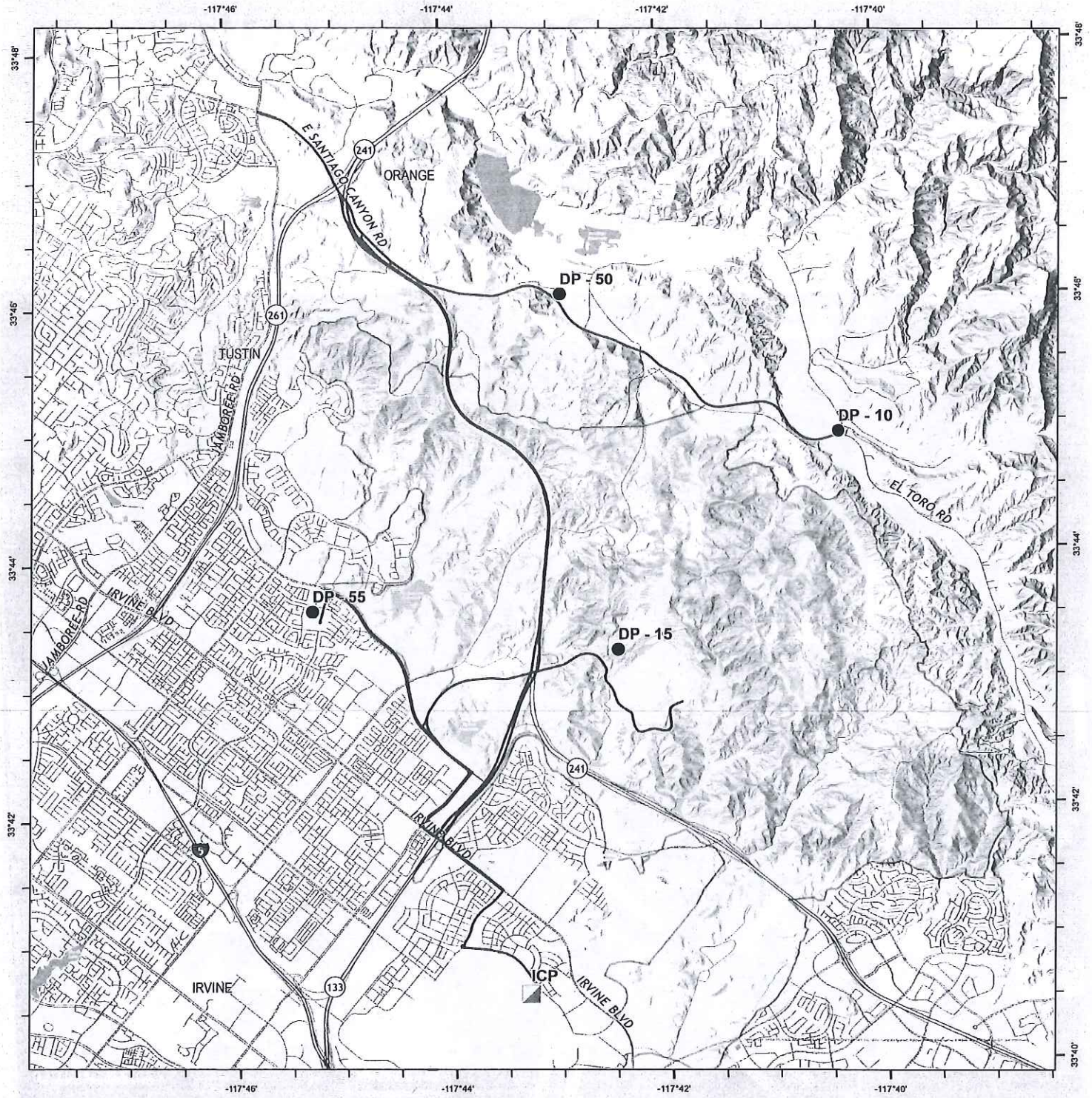

0 0.75 1.5 3 Miles

- Drop Point
- ▲ Incident Command Post
- Drop Point Routes

CAL FIRE - INCIDENT MANAGEMENT TEAM 6

Established 30 1994

IMT 6 GISS
10/31/2020
1804 Hours
NAD 83 Teale Albers

DISCLAIMER:
This document is a work product of the Incident Management Team 6 and is not intended to be used for any other purpose. The information contained herein is for informational purposes only and does not constitute a contract or any other legal document. The information is provided as is and without any warranty, express or implied, including but not limited to accuracy, completeness, or timeliness.

