

* CORRECTED *

PREPARED 8/15/2020
19:30

INCIDENT ACTION PLAN

Update 08/16/2020
0720

LAKE FIRE

CA-ANF-003273

P5NE2V

Saturday / Sunday



NIGHT SHIFT

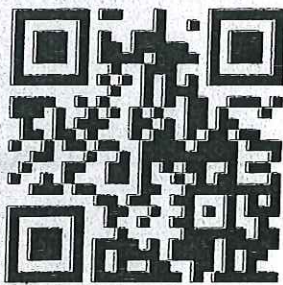

1800 8/15/2020

TO

0600 8/16/2020

FOR PUBLIC INQUIRIES REGARDING LAKE FIRE
INFORMATION, DIRECT THEM TO CALL (626) 574-5208

INCIDENT OBJECTIVES (ICS 202)

1. Incident Name: <p style="text-align: center;">LAKE FIRE</p>	2. Operational Period:	Date From: 8/15/2020 Time From: 1800	Date To: 8/16/2020 Time To: 0600
--	-------------------------------	---	-------------------------------------

3. Objective(s):

Management Objectives

- Ensure that strategies and tactics provide for firefighter and public safety through the application of sound risk management principles.
- Minimize the threat of exposure to COVID-19 by adhering CDC COVID-19 Guidelines.
- Minimize the threat to private property, critical infrastructure and heritage resources.
- Establish and strengthen cooperators, partners, and stakeholder relationships.
- Minimize the cost of the incident by employing tactics that have the highest probability of success while minimizing firefighter exposure.

Control Objectives

- Keep the fire North of Castaic Lake
- Keep the fire South of Hwy 138
- Keep the fire East of Red Rock Mtn.
- Keep the fire West of Tule Ridge

General Situational Awareness:

Steep and rugged terrain, critically dry and receptive fuel beds, active area for fire history and drought stressed trees.

In the COVID-19 environment, high density populations or large groups are particularly at risk. To help protect yourself, your family and to ensure all employees return home safely, make sure to practice social distancing.

Enhanced hygiene (especially handwashing), PPE & monitoring practices help limit the infection rate of first responders.

5. Site Safety Plan Required?

Yes No

Approved Site Safety Plan(s) Located at:

6. Incident Action Plan

- | | | | |
|---|--|--|--|
| <input checked="" type="checkbox"/> ICS 203 | <input checked="" type="checkbox"/> ICS 215A | <input type="checkbox"/> ICS 205 A | <input type="checkbox"/> |
| <input checked="" type="checkbox"/> ICS 204 | <input checked="" type="checkbox"/> ICS 220 | <input checked="" type="checkbox"/> Training Message | <input type="checkbox"/> |
| <input checked="" type="checkbox"/> ICS 205 | <input checked="" type="checkbox"/> Facility Maps | <input type="checkbox"/> Travel Map | <input type="checkbox"/> |
| <input checked="" type="checkbox"/> ICS 206 | <input checked="" type="checkbox"/> Weather Forecast | <input type="checkbox"/> Demob Plan | <input type="checkbox"/> County Health Message |
| <input checked="" type="checkbox"/> ICS 208 | <input checked="" type="checkbox"/> Fire Behavior | <input checked="" type="checkbox"/> Finance Message | <input checked="" type="checkbox"/> ICS 214 |

7. Prepared By: R. Leuck, R. Ashby(T)

Position/Title: PSC1

Signature:

8. Approved by Incident Commander:

D. Mueller

Signature:

ORGANIZATION ASSIGNMENT LIST (ICS 203)

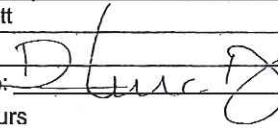
1. Incident Name: LAKE FIRE		2. Operational Period: Date From: 8/15/2020 Time From: 1800		Date To: 8/16/2020 Time To: 0600	
3. Incident Commander(s) and Command Staff:			7. Operation Section:		
IC/UC's	R. Young, V. Pena, T. Ewald(T), D. Mueller	Operations	R. Wills, D. Freguila (T)		
Deputy	C. Joseph	Night Ops	C. Rose(T)		
Safety Officer	B. Savage, D. Welch	Planning Ops	A. McBath, J. Eichamer(T), D. Breshears(T)		
Information Officer	M. Savage, K. Haskett, N. Judy(T)				
Liaison Officer	R. Alpert, C. Henson, D. Laub(T)	Branch	I	D. Forsyth	
HRSP	A. Cabida	Division/Group	A/B	I. Solomon	
4. Agency/Organization Representatives:			Division/Group	C	UNSTAFFED
Agency/Organization	Name	Division/Group	F	Wickizer	
USFS	Robert Garcia	Division/Group	G	Valazquez / J. Mitchell(T)	
LAC	David Richardson	Division/Group			
CalFire	Tony Jones	Division/Group			
LASD	Capt. Ron Shaffer	Division/Group			
OES	Dave Stone	Division/Group			
Edison	Troy Whitman	Division/Group			
CHP	Sgt. Kevin Pack	Division/Group			
READ	L. Gassaway	Branch	V	J. Ohs	
LA County Public Health	Michael Rogers	Division/Group	I	Halverson	
LA County OEM	Jeremy Harriss	Division/Group	S/T	Gilson	
CCC	Ben Herbert	Division/Group	3 Point Structure	R. White, R. Chavez (T)	
		Division/Group			
		Division/Group			
		Branch	VII		
		Division/Group	X/Z	UNSTAFFED	
		Division/Group			
5. Planning Section:			Division/Group		
Chief	J. Schilinger, R. Leuck, R. Ashby(T)	Division/Group			
Deputy		Division/Group			
Resource Unit	R. Resnick, J. Padilla, H. Kelmonson(T), I. Gates(T)	Branch			
SCKN	M. Carlson	Division/Group			
Situation Unit	T. Morelock	Division/Group			
Demobilization Unit	J. Roberts	Division/Group			
GISS	M. Yanez, R. Rametta, D. Hutchinson	Division/Group			
FBAN	M. Brown	Division/Group			
IMET	M. Mehle	Air Operations Branch	Director:	J. Keesee	
ITSS	J. Youngblood, J. LeMay, J. Hawkins	Air Support Group Supervisor		D. Carrera(T)	
Training Tech Spec	C. Souza	Air Tactical Group Supervisor			
DINS	S. Barkley, M. Nunez(T)	Helibase Manager			
6. Logistics Section:			8. Finance/Administration Section:		
Chief	K. Kumpe, J. Eckroth, B. Schurr, R. Crowther(T), B. Romo(T)	Chief	T. Fork, T. Hasert, P. D'Souza		
Ordering	K. Morris, T. Hanna	Time Unit	M. Prochazka		
Ground Support Unit	J. Hart, L. Campbell(T)	Procurement Unit			
Communications Unit	K. Throop	Comp/Claims Unit	E. Downing		
Medical Unit	J. Carlon, R. Russel, A. Reyes	Cost Unit	R. Siemers		
Food Unit	J. Junette	Equipment Time	C. Hamlett		
Supply Unit	M. Bufford				
Prepared By: Name:	R. Ashby	Position/Title:	PSC2 (T)	Signature:	
ICS 203		Date/Time:	8/14/2020 2300 hours		

FIRE BEHAVIOR FORECAST

FORECAST NUMBER: 003	TYPE OF FIRE: Wildfire Full Suppression
FIRE NAME: Lake	OPERATIONAL PERIOD: 8-15-20 Night Shift
DATE ISSUED: 8-15-20	TIME ISSUED: 1200
UNIT: CA-ANF	SIGNED: <i>Matt Brown</i> 
Typed/printed: Matt Brown FBAN(t)	

INPUTS

WEATHER SUMMARY: Expect evening temperatures to be higher today, reaching low 100's at the upper elevations with RH in the low 20's in the same locations. Winds will be SW early in the evening then switching to WNW 3-6 with gusts to 15 mph at the 20 ft level.

Poor recoveries and warm overnight temperatures will continue the burn period longer into the evening than yesterday. Increasing instability after midnight as a wave moves through.

OUTPUTS

FIRE BEHAVIOR

GENERAL:

The fire will experience another evening with a very unstable atmosphere parked over the top. Tonight we may see visual indicators of the instability such as cumulus build up and may begin the shift with a pyrocumulus in the area. This layer can enhance burning through convection or a type of "chimney" effect". Due to the decedent dry fuels and lack of fire history, expect long rang and increased spotting. This heavier fuel layer has sufficient size and duration to produce the type of ember cast that can be lofted up in the column and cause fires over a mile away from the main fire.

Live fuels are at critical and burning index extreme. ERC is forecasted to set a record today.

SPECIFIC:

Divisions toward the head of the fire will experience a change in fuels and topography. Although winds can increase on the lee side of the slopes adjacent to the desert communities, choice of barriers and lighter grass type fuels typically respond to favorably suppression efforts.

Divisions on the right flank of the fire will experience faster rates of spread, but the recent fire history has reduced the fuel loading; therefore, increasing chances of success using direct tactics when conditions allow. Some threats remain to the line in drainages requiring extensive mop-up where fuels are heavy.

Divisions on the left flank of the fire will experience the most challenging fire behavior. Spotting is expected to exceed a mile. The probability of ignition will be 100% at the start of night shift. The shrub type fuel is not only tall but has a 100 year-old dead component under the canopy. Conifer type fuels will produce brands that can effectively produce spots. Aerial retardant application may slow the fire for a brief period of time but will be mostly ineffective in stopping spread without close ground follow up. The fire will continue to flank out and run in aligned drainages and slopes. Structures along Pine Mountain road will continue to be threatened by spots and runs that are produced in aligned drainages.

Head Fire Estimates BEHAVE Plus 5.0.5

Fuel Type	ROS	FL	PIG
Shrub SH7	100-120 ch/hr 80-100 ch/hr after 2300 hrs	20-30 ft. 15-20 ft after 2300 hours	100% 50% after sunset

AIR OPERATIONS:

Transport winds will carry most of the smoke to the east overnight. Air Operations should experience good visibility early in the operational period.

SAFETY

In the heavier fuels spot fires can grow and spread rapidly and with great flame lengths. Consider your escape route and overall effectiveness based on fire behavior before engaging. Pyrocumulus collapse rarely produces significant outflow winds directly over a fire, but the chance of a down draft should be considered when planning work assignments. There is a chance of thunderstorms after midnight. Safety plans should consider outflows from these storms as well.

FIRE DANGER – High Country Forecast Zone

Maximum, Average, and 97th Percentile, based on 10 years data

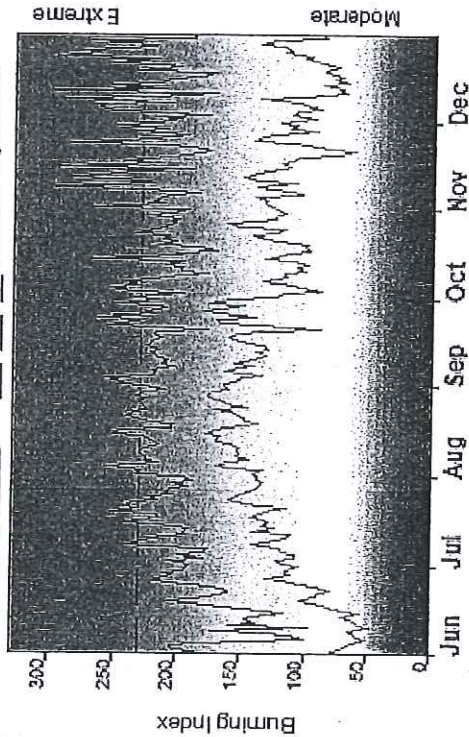

Years to Remember: 2009 2016

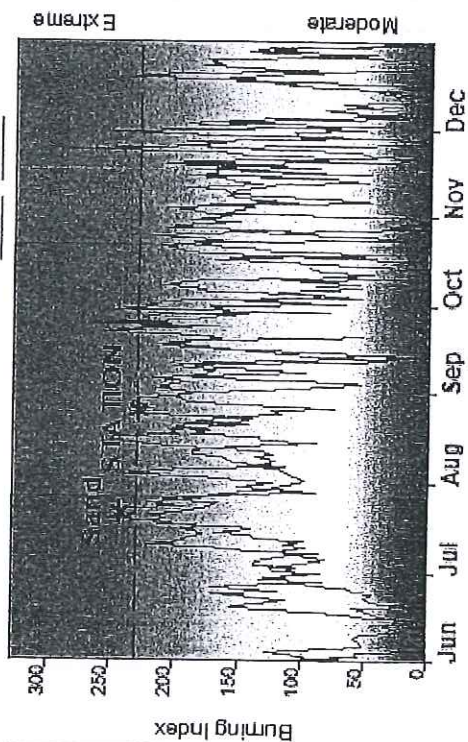

Fuel Model: B - California Chaparral

Fire Danger Area:

- ◆ High Country Fire Danger
- ◆ High Country Zone
- ◆ SIG High Country WX
- * Meets NWCG Wx Station Standards



Fire Danger Interpretation:

- EXTREME – Use extreme caution
- High – Watch for change
- Moderate – Lower Potential, but always be aware

Maximum – Highest Burning Index by day for 2009 - 2018

Average – shows peak fire season over 10 years (2110 observations)
97th Percentile – 3% of the 2110 days from 2009 - 2018 had an Burning Index above 228

Local Thresholds - Watch out:

Combinations of any of these factors can greatly increase fire behavior:
20+ Wind Speed over 0 mph, RH less than 1%,
Temperature over 1, Burning Index over 0

Remember what Fire Danger tells you:

- ✓ Burning Index gives day-to-day fluctuations calculated from 2 pm temperature, humidity, wind, daily temperature & rh ranges, and precip duration.
- ✓ Wind is part of BI calculation.
- ✓ Watch local conditions and variations across the landscape – Fuel, Weather, Topography.
- ✓ Listen to weather forecasts – especially WIND.

Past Experience:

- Wind Driven Fires Can Produce:
- Rates of Spread > 80 c/hr
- Spotting up to .5 - 1 mile ahead of fire front
- Eye Level Winds > 7 MPH
- Live Fuel Moistures < 75%
- Fine Fuel Moistures < 5%
- Active Night Burning Conditions with RH < 25%
- Non-Wind Driven Fires: Mature fuel beds 20+ years of growth identify the alignment of wind, slope and solar pre heating

Responsible Agency: LA County

FF+5.0 build 20191211 06:01/2020-14:52 (C:\Users\Garett... \High County 2019_10 Years)

Design by NWCG Fire Danger Working Team



Fire Weather Forecast



FORECAST NO: 3

NAME OF FIRE: Lake Fire

PREDICTION FOR: 1800 Sat - 0600 Sun

UNIT: CA-ANF

SHIFT DATE: 08/15

SIGNED: *Matt Mehle*

TIME AND DATE

Incident Meteorologist - Matt Mehle

FORECAST ISSUED: 1200 08/15/20

...Excessive Heat Warning valid through Monday Evening...

WEATHER DISCUSSION: Lingering monsoon moisture will produce cumulus clouds in the afternoon/evening with a possibility for thunderstorms through early Sunday. Dry lightning and gusty outflows would be the greatest threat with developed storms. An unstable atmosphere will remain allowing for vertical plume growth in the afternoon and evening hours. Little relief is expected Saturday night with mild low temperatures and poor relative recoveries. Very hot and dry conditions will persist into early next week.

WEATHER FORECAST FOR SATURDAY NIGHT:

WEATHER: A slight chance for showers and thunderstorms. Thunderstorms most likely during the evening, but a few are still possible overnight. Otherwise, partly cloudy overnight.

TEMPERATURES: Min 75-80 F...above 2000' 70-75 F. **24 HR Trend:** Little Change.

HUMIDITY: Max 35-45%...above 2000' 30-40%. **24 HR Trend:** Little Change.

20-FOOT WIND: Southwest 4-8 mph with gusts to 15 mph in the evening becoming West to Northwest 3-6 mph overnight.

Chance of Wetting Rain (0.10"): <10% **LAL:2**

WEATHER FORECAST FOR SUNDAY:

WEATHER: Mostly Sunny. Slight chance for afternoon showers and possibly thunderstorms.

TEMPERATURES: Max 99-105 F...above 2000' 93-97 F **24 HR Trend:** 3 degrees cooler.

HUMIDITY: Min 20-30% ...above 2000' 25-35% **24 HR Trend:** 5% wetter.

20-FOOT WIND: West to northwest 3-6 mph in the morning. Southwest 5-15 mph in the afternoon gusts 20-25 mph.

Chance of Wetting Rain (0.10"): <10% **LAL:2 in the afternoon**

EXTENDED FORECAST:

MONDAY... Mostly sunny. Max temps 97-102 F above 2000' 90-95 F. Min RH 15-30%. Southwest 6-12 mph with gusts 20-25 mph in the afternoon.

WEATHER SAFETY MESSAGE

- Dangerous Heat – Stay hydrated.
- Thunderstorms with dry lightning and gusty outflow winds.
- Plume dominated fire possible. Use LCES.
 - Collapsing plumes create gusty and erratic winds

ASSIGNMENT LIST (ICS 204 WF)

CONTROLLED UNCLASSIFIED
INFORMATION//BASIC

1. Incident Name:	2. Operational Period:	3. Branch	Division
LAKE FIRE	Date From: 08/15/20 Date To: 08/16/20 Time From: 1800 Time To: 0600	I	F
4. Operations Personnel:		Page 1 of 1	Foxtrot

Operations Section Chief: R. Wills, D. Freguila (T)	*Night Ops: C. Rose(T)
Branch Director: D. Forsyth	Branch Safety:
Division/Group Supervisor: Wickizer	Air Attack:

5. Resources Assigned:		** Resources Below in Bold are 24 Hour **					
Resource Identifier	ALS	LWD	Leader	Personnel	Request #	Hours	Reporting Location
ENG T3 E-5673						1800 - 0600	
Cherokee IHC							
S/T ENG T3 XLA 2004c							
ENG T3 ANF E310							
ENG T3 ANF E333							
WT T-1 LAC 128							

6. Work Assignments:
 Task: Assess and advance preparation of indirect line from intersection of Burnt Peak Rd and Leibre Sawmill Rd west to Leibre Mtn. Provide point protection of Burnt Peak infrastructure if fire behavior allows.
 Purpose: Limit fire spread to the North to Pine Canyon Road to minimize spread to the community along Pine Canyon and 3 Point community.
 End State: Fire spread will be confined to Pine Canyon Ridge.

7. Special Instructions:
 Provide structure protection as needed.
 Provide point protection for Burnt Peak.
 USE LAC V-13D FOR RADIO BRIEFING
 *** SOFR Goudchaux and SOFR(T) Adamo assigned to all Divisions***

8. Communications							
Name	Ch	Function	Rx Freq	Rx Tone	Tx Freq	Tx Tone	Notes
ANF 10	1	COMMAND	172.3750		164.9375	107.2	
ANF 14	2	COMMAND	172.375		164.9375	151.4	
ANF 15	3	COMMAND	172.375		164.9375	162.2	
NIFC T5	6	TACTICAL	166.7250N	CSQ	166.7250N	131.8	
A/G TAC	14	A/G TAC	169.2875		169.2875		
CALCORD	13	MEDICAL	156.0750N	T6 - 156.7	156.0750N	T6 - 156.7	
AIRGUARD	16	EMERGENCY	168.6250N	CSQ	168.6250N	T1 - 110.9	

9. Prepared by: Name: R. Resnick, J. Padilla, H. Kelsonson(T), I. Gates(T) RESL
 Signature:  Personnel Count: 0

Date/Time: 8/14/2020 2200

ASSIGNMENT LIST (ICS 204 WF)

CONTROLLED UNCLASSIFIED
INFORMATION//BASIC

1. Incident Name: <p style="text-align: center;">LAKE FIRE</p>	2. Operational Period: Date From: 08/15/20 Date To: 08/16/20 Time From: 1800 Time To: 0600	3. Branch Division <p style="text-align: center;">I G</p>
4. Operations Personnel:		Page 1 of 1 Golf

Operations Section Chief: R. Wills, D. Freguila (T)	Night Ops: C. Rose (T)
Branch Director: D. Forsyth	Branch Safety:
Division/Group Supervisor: Valazquez, J. Mitchell (T)	Air Attack:

5. Resources Assigned:		** Resources Below in Bold are 24 Hour **					
Resource Identifier	ALS	LWD	Leader	Personnel	Request #	Hours	Reporting Location
F Cherokee IHC			Ballestero	21	C-58	1800-0600	ICP
G Truckee IHC				22	C-13	1800-0600	ICP
S/T CRW T1 XNA 9495G No Show			Robert Castillo	30	C-59	0600-0600	ICP
CRW T2IA PVT Fire Storm 18 Day				22		0600-0600	ICP
G CRW T2IA PVT Fire Storm 19				22		0600-0600	ICP
F S/T ENG T3 XAL 2004C				16		0600-0600	ICP
F S/T ENG T3 CHV 6430C				16		0600-0600	ICP
F ENG T3 ANF E-310				3		1800-0600	ICP
F ENG T3 ANF E-333				3		1800-0600	ICP
S/T DOZ T1 9348L				5	E-30003	0600-0600	ICP
DOZ T1 KCF DZ9				2	E-88	0600-0600	ICP
WFF T1 OES 51 No Show		8/27	Padilla	2	E-51	0600-0600	ICP
WFF T1 BDU WF No Show				2	E-72	0600-0600	ICP
S/T ENG T3 6074C			Staley		E-223	1800-0600	
S/T Doz 9467L SBC							

6. Work Assignments:
 Task: Assess and implement control line from Pine Canyon Rd. to Sawmill Ridge Rd. Continue line prep along Sawmill Ridge Rd. from black edge at Pine Canyon Rd. west to Liebre Mtn. Assist 3 Point Structure Group as needed to defend structures along and North of Pine Canyon Rd. Continue firing as directed by Branch 1 to protect values of risk along Pine Canyon Rd. Provide point protection for Burnt Peak infrastructure if fire behavior allows.
 Purpose: Limit fire spread to the North to Pine Canyon Road to minimize spread to the community along Pine Canyon and 3 Point community
 End State: Fire spread will be confined to Pine Canyon Ridge.

7. Special Instructions:
 USE LAC V-13D FOR RADIO BRIEFING
 *** SOFR Goudchaux and SOFR(T) Adamo assigned to all Divisions***

8. Communications							
Name	Ch	Function	Rx Freq	Rx Tone	Tx Freq	Tx Tone	Notes
ANF 10	1	COMMAND	172.3750		164.9375	107.2	
ANF 14	2	COMMAND	172.375		164.9375	151.4	
ANF 15	3	COMMAND	172.375		164.9375	162.2	
VFIRE 24	10	TACTICAL	154.2725N	T6 - 156.7	154.2725N	T6 - 156.7	
A/G TAC	14	A/G TAC	169.2875		169.2875		
CALCORD	13	MEDICAL	156.0750N	T6 - 156.7	156.0750N	T6 - 156.7	
AIRGUARD	16	EMERGENCY	168.6250N	CSQ	168.6250N	T1 - 110.9	

9. Prepared by: Name:	R. Resnick, J. Padilla, H. Kelmonson(T), I. Gates(T)	RESL	Signature:
ICS 204	Date/Time: 8/14/2020 2200		Personnel Count: 166

ASSIGNMENT LIST (ICS 204 WF)

CONTROLLED UNCLASSIFIED
INFORMATION//BASIC

1. Incident Name: LAKE FIRE	2. Operational Period: Date From: 08/15/20 Date To: 08/16/20 Time From: 1800 Time To: 0600	3. Branch Division V I
4. Operations Personnel:		Page 1 of 1 India

Operations Section Chief: R. Wills, D. Freguila (T)	Night Ops: C. Rose(T)
Branch Director: J. Ohs	Branch Safety:
Division/Group Supervisor: Halverson Gilson / Barra	Air Attack:

5. Resources Assigned:		** Resources Below in Bold are 24 Hour **						
Resource Identifier	ALS	LWD	Leader	Personnel	Request #	Hours	Reporting Location	
S/T ENG T1 XLA 1075A			Khail	22		0600-0600	ICP	
S/T ENG T3 XOR 1421A			Kevin Stewart	22	E-25	0600-0600	ICP	
S/T ENG T3 CNT 2310C			Kempel	22	E-69	0600-0600	ICP	
S/T ENG T3 BDU 9351C			Ramirez	22 17	E-37	0600-0600	ICP	
S/T ENG T3 RED 6828C				16		0600-0600	ICP	
S/T ENG T3 XSN 2399C			Thomas	10 19		0600-0600	ICP	
S/T DOZ T1 LAC 9318L				5		0600-0600	ICP	
S/T DOZ T1 KRN 9360L				5		0600-0600	ICP	
S/T DOZ T1 LAC 9428L				5		0600-0600	ICP	
S/T DOZ T1 LAC 9464L				5		0600-0600	ICP	
S/T DOZ T1 BEU 9643L				5		0600-0600	ICP	
WTT T WT141				2	E-82	0600-0600	ICP	
WTT T LAC WT128				2		0600-0600	ICP	
TFLD Livingston			Livington	1	O-10020	1800-0600	ICP	
EMTF Fredrickson			Fredrickson	1	O-146	1800-0600	ICP	
EMTF Turner			Turner	1	O-147	1800-0600	ICP	
EMTF Moore			C. Moore	1	O-10056	1800-0600	ICP	
EMTF Brodbeck			Brodbeck	1	O-150	1800-0600	ICP	

6. Work Assignments: *S/T ENG T3 6415C Tim E-225*
CRW VISTA GRAND
 Task: Advance perimeter control from Pine Canyon Road north to Lancaster Road utilizing both direct and indirect as feasible. Prep Pine Canyon Road from black edge west to intersection with Three Points Rd. Mop up and patrol structures within the existing burn area to minimize damage. *WTT WT101 NICK E-54*
 Purpose: Stop forward spread of fire.
 End State: Confine the fire between Pine Canyon Road to the junction 195th St. West and Aquaduct Road.

7. Special Instructions:
 Provide for structure protection as needed.
 USE LAC V-13D FOR RADIO BRIEFING
 *** SOFR Goudchaux and SOFR(T) Adamo assigned to all Divisions***

8. Communications							
Name	Ch	Function	Rx Freq	Rx Tone	Tx Freq	Tx Tone	Notes
ANF 10	1	COMMAND	172.3750		164.9375	107.2	
ANF 14	2	COMMAND	172.375		164.9375	151.4	
ANF 15	3	COMMAND	172.375		164.9375	162.2	
NIFC T6	7	TACTICAL	166.7750N	CSQ	166.7750N	131.8	
A/G TAC	14	A/G TAC	169.2875		169.2875		
CALCORD	13	MEDICAL	156.0750N	T6 - 156.7	156.0750N	T6 - 156.7	
AIRGUARD	16	EMERGENCY	168.6250N	CSQ	168.6250N	T1 - 110.9	

9. Prepared by: Name: R. Resnick, J. Padilla, H. Kelmonson(T), I. Gates(T) RESL

Signature:

ICS 204 Date/Time: 8/14/2020 2200 Personnel Count: 154

ASSIGNMENT LIST (ICS 204 WF)

CONTROLLED UNCLASSIFIED
INFORMATION/BASIC

1. Incident Name: <p style="text-align: center; font-weight: bold;">LAKE FIRE</p>	2. Operational Period: Date From: 08/15/20 Date To: 08/16/20 Time From: 1800 Time To: 0600	3. Branch Division <p style="text-align: center; font-size: 2em; font-weight: bold;">V S/T</p>
---	---	--

4. Operations Personnel:		Page 1 of 1 Sierra/Tango
Operations Section Chief: R. Wills, D. Freguila (T)	Night Ops: C. Rose(T)	
Branch Director: J. Ohs	Branch Safety:	
Division/Group Supervisor: Gilson	Air Attack:	

5. Resources Assigned:		** Resources Below in Bold are 24 Hour **					
Resource Identifier	ALS	LWD	Leader	Personnel	Request #	Hours	Reporting Location
S/T ENG T1 LAC 1103A			Haris/Dejoeb (t)	22	E-4	1800-0600	ICP
S/T ENG T1 LAC 1120A			Jimenez/Aldana (t)	22	E-49	1800-0600	ICP
S/T ENG T3 KCF 8904G				17	E-63	1800-0600	ICP
S/T ENG T3 ORC 9328C				22		1800-0600	ICP
S/T ENG T3 HAY 2870C			Jason Livermore	22		1800-0600	ICP
S/T ENG T3 OES 6848C					E-30017	1800-0600	ICP
S/T ENG T3 SLU 9340C					E-30010	1800-0600	ICP
S/T ENG T6 LAC 1146F			Robertson/Chorhani <i>Lutz/Cooper</i>		E-31	1800-0600	ICP
S/T DOZ T1 9447L						1800-0600	ICP
DOZ MVU 9334L						1800-0600	ICP
S/T DZR T1 GDF 9446L			Shain Braziel		E-30005	1800-0600	ICP
S/T DZR T2 BDU 9363L			Mike Breese			1800-0600	ICP
WTT T1 LAC WF 32				1		1800-0600	ICP
GDF WFE-130			Greg Bartlett		E-130	1800-0600	ICP
WJK Water Tender					E-79	1800-0600	ICP
<i>PAB WT37</i>							
<i>SLO S/T 9340C</i>							

6. Work Assignments:
 Task: Advance permieter control lines from Lancaster road east and south to Pine Canyon Rd. to protect the Lake Hughes area. Mop up and patrol around structures within the existing burn area to minimize damage.
 Purpose: Stop forward spread of fire.
 End State: Confine the fire between 195th St./Aquaduct Road and Pine Canyon Road.

7. Special Instructions:
 Provide for structure protection as needed.
 USE LAC V-13D FOR RADIO BRIEFING

*** SOFR Goudchaux and SOFR(T) Adamo assigned to all Divisions***

8. Communications							
Name	Ch	Function	Rx Freq	Rx Tone	Tx Freq	Tx Tone	Notes
ANF 10	1	COMMAND	172.3750		164.9375	107.2	
ANF 14	2	COMMAND	172.375		164.9375	151.4	
ANF 15	3	COMMAND	172.375		164.9375	162.2	
VFIRE 22	8	TACTICAL	154.2650N	T6 - 156.7	154.2650N	T6 - 156.7	
A/G TAC	14	A/G TAC	169.2875		169.2875		
CALCORD	13	MEDICAL	156.0750N	T6 - 156.7	156.0750N	T6 - 156.7	
AIRGUARD	16	EMERGENCY	168.6250N	CSQ	168.6250N	T1 - 110.9	

9. Prepared by: Name:	R. Resnick, J. Padilla, H. Kelmonson(T), I. Gates(T)	RESL	Signature:
------------------------------	---	------	------------

ICS 204	Date/Time: 8/14/2020 2200	Personnel Count: 106
----------------	---------------------------	----------------------

ASSIGNMENT LIST (ICS 204 WF)

CONTROLLED UNCLASSIFIED
INFORMATION/BASIC

1. Incident Name: <p style="text-align: center;">LAKE FIRE</p>	2. Operational Period: Date From: 08/15/20 Date To: 08/16/20 Time From: 1800 Time To: 0600	3. Branch Division <p style="text-align: center;">V</p> 3 Point Structure
4. Operations Personnel:		Page 1 of 1

Operations Section Chief: R. Wills, D. Freguila (T)	Night Ops: C. Rose(T)
Branch Director: J. Ohs	Branch Safety:
Division/Group Supervisor: R. White, R. Chavez (T)	Air Attack:

5. Resources Assigned:	** Resources Below in Bold are 24 Hour **					
Resource Identifier	ALS	LWD	Leader	Personnel	Request #	Hours Reporting Location
S/T ENG T1 6001A				22	E-21	0600-1800
S/T ENG T1 LFD 1001A					E-29	0600-0600
S/T ENG T1 XSB 1501A				22		0600-1800
S/T ENG T3 XMY 2175C					E-65	0600-0600
S/T ENG T3 LAC 1151C			Delaney/Perry			0600-0600
S/T ENG T1 XBO 6230A						0600-0600
S/T ENG T3 XNA 2200C					E-59	0600-0600
S/T ENG T3 6220C				22	E-68	0600-1800
S/T T3 STB 1521C			Mike Deponce		E-30018	0600-0600
S/T T3 NOV 2140C			Robert LaCroix			0600-0600
VCF WT62			Joe Basinski	2	E-84	0600-0600
NCC WT42			Zach Witter	2	E-85	0600-0600
PAS WT 37			Robert Sepulveda	2	E-50	0600-1800
PVT WT Lang 127 WT L&L			Harold Lang	2	E-126 127	0600-0600

6. Work Assignments:
Identify structure defense needs. Prep structures and construct or improve defensible space if feasible to defend structures from fire damage and limit spread to adjacent structures.

7. Special Instructions:
USE LAC V-13D FOR RADIO BRIEFING

*** SOFR Goudchaux and SOFR(T) Adamo assigned to all Divisions***

8. Communications							
Name	Ch	Function	Rx Freq	Rx Tone	Tx Freq	Tx Tone	Notes
ANF 10	1	COMMAND	172.3750		164.9375	107.2	
ANF 14	2	COMMAND	172.375		164.9375	151.4	
ANF 15	3	COMMAND	172.375		164.9375	162.2	
FCA V-2D	12	TACTICAL	155.4000	T6 - 156.7	155.4000	T6 - 156.7	
A/G TAC	14	A/G TAC	169.2875		169.2875		
CALCORD	13	MEDICAL	156.0750N	T6 - 156.7	156.0750N	T6 - 156.7	
AIRGUARD	16	EMERGENCY	168.6250N	CSQ	168.6250N	T1 - 110.9	

9. Prepared by: Name:	R. Resnick, J. Padilla, H. Kelmonson(T), I. Gates(T)	RESL	Signature:
ICS 204	Date/Time: 8/14/2020 2200		Personnel Count: 72

SAFETY MESSAGE

LAKE FIRE CA-ANF-003273 Night Shift: 8/15/20 1600 hrs. to 0600hrs.

- Maintain LCES and continually re-evaluate. Assure that all personnel have good communications. If you aren't in position to see the fire, who is your lookout???
- Ensure your LCES is adequate for worst- case fire behavior.
- Maintain accountability of all personnel on the fire. No assumptions-Communicate
- Does EVERYONE know the plan if the fire gets up and moves big today?

FIRE BEHAVIOR: This fire has the potential for very large growth. Spotting is common and will continue. Very likely to have cumulus cloud built up with large fire growth, which can result in increased fire behavior due to column collapse and downdrafts.

HAZARD TREES: Snags are an issue, in the green and in the black. Perform hazard tree assessments and risk analysis at your location. Are you parking your vehicle in a safe spot? Wear your hard hat at all times when outside of vehicles & follow Hazard Tree Safety Guidelines.

POWER LINES: Always consider downed power lines energized. Even if Edison shuts down supply circuits, power lines always have the potential to be back-fed and live though properties with solar panels.

HYDRATE: We'll have extremely high temperatures today. Hydrate early and often. Keep an eye on all of your crewmembers. Look for the subtle signs that they might show if they're starting to have issues with the heat. It's important to keep ahead of it and catch issues early.

DRIVING ISSUES: Narrow, windy, roads throughout the fire area. Beware of the potential for large rocks and debris to fall onto the roadways. Drive defensively, keep your speeds down. Don't text and drive. WEAR YOUR SEATBELT!



6. INSTRUCTIONS AND ASSIGNMENTS NOT CLEAR

Symptoms & Signs of Heat Illness

Heat Exhaustion: Victim will have cool, clammy skin; pale coloring; feel weak, dizzy and/or nauseous.

Treatment : Have individual sit in shade or cool area; administer fluids; loosen clothing and assure rest.

Heat Stroke: This is a medical emergency!! Victim will hot, dry, red skin and possible convulsions. These symptoms can progress to unconsciousness and death!

Treatment – Immediately cool individual's body by pouring water over them, especially the head and upper body. Contact the medical unit. Monitor the victim and provide whatever medical

Safety Officers – Brian Savage- SOF1, Dave Welch- SOF1

INCIDENT RISK ANALYSIS

LAKE FIRE

(ICS 215a) Night Shift

BR/ DIV	HAZARDOUS ACTIONS / CONDITIONS	MITIGATIONS / WARNINGS / REMEDIES
ALL	WEATHER	<ul style="list-style-type: none"> • Be aware of changing weather conditions. • Watch out for increasing heat, winds, and instability. • Anticipate increased fire behavior conditions. • Communicate any observed changes in weather and fire behavior. • "Base all actions on current and expected behavior of the fire."
ALL	FIRE BEHAVIOR	<ul style="list-style-type: none"> • Conduct thorough assessments before starting work. • Ensure LCES is in place. • Provide additional briefing on drought related fire behavior and areas of high concentration of hazard trees. • Increase the level of SA. • Provide additional briefing for new resources and maintain communications..
ALL	LINE CONSTRUCTION	<ul style="list-style-type: none"> • Follow the line construction protocols and safety precautions for direct and indirect line construction. • Watch footing and spacing between firefighters, especially those working below. • Make sure LCES is in place. • Follow the "Downhill Line Construction Checklist" on IRPG page 9. • Do not work above any personnel. • Evaluate necessity to send personnel in areas with limited access.
ALL	TRAFFIC HAZARDS AND DRIVING	<ul style="list-style-type: none"> • Practice "Defensive Driving" techniques. Traffic volume is high. • Use spotters when backing. • Always use headlights. • Use warning lights when working on roads or traveling in smoke. • Observe posted speed limits. • Use chock blocks and turn wheels into the hill. • Watch for rolling rocks and debris from hillsides.
ALL	COMMUNICATIONS	<ul style="list-style-type: none"> • Share your Situational Awareness (hazards, changes, etc.) to those who also have a need. • Radio Communications may be poor in some areas: use human repeaters as needed. • Ensure all personnel are familiar with the incident and the IAP communications plans. • Make sure all resources have radios cloned appropriately. • Ensure that non-agency resources understand radio use and procedures.
ALL	FATIGUE / COMPLACENCY	<ul style="list-style-type: none"> • Be alert for signs of heat stress and fatigue, take breaks as necessary. • HYDRATE before, during and after your shift. • Monitor ALL resources for level of fatigue. • Recognize the symptoms of heat stress and fatigue, and take action as necessary to provide rest and recovery. • Repeated assignments in the same area can lead to complacency making personnel more vulnerable to accidents. • Take steps (switching of assignments, training opportunities during slow periods, etc.) to maintain situational awareness for the duration of the incident
ALL	AIR OPERATIONS	<ul style="list-style-type: none"> • Do not plan on air resources for tactical support or medical transportation. • Refer to page 58, IRPG for directing bucket drops. • Ensure positive communication with all air resources.
ALL	HEAVY EQUIPMENT OPERATIONS	<ul style="list-style-type: none"> • Ensure communications are established with operators. • Ensure ground personnel have safety illumination, with light-sticks being the minimum. • Maintain a 50'-100' exclusion area around equipment. • In timber increase safety distance to 2 ½ times canopy height.
ALL	HAZARD / DANGER TREES	<ul style="list-style-type: none"> • Follow Hazard Tree Safety Guidelines (IRPG p.22-23). • Limit number of personnel around snags and their exposure time; fallers must be qualified for the trees being felled. • Be especially alert around snags during wind events. Large green trees can also be dangerous.
ALL	FIRING OPERATIONS	<ul style="list-style-type: none"> • Only personnel trained in the use of each device will be authorized to use firing equipment. • Ensure all personnel are aware of firing operation that may affect them. • Wear appropriate PPE. • Ensure aerial/ground ignition plans have been adequately developed and personnel are briefed.
ALL	ENVIRONMENTAL HAZARDS	<ul style="list-style-type: none"> • Keep alert for wildlife, deer, rattlesnakes, bees, and plants. Watch footing and hand placement around rocks. Use caution around gas and power lines. • Personal hygiene is #1 when it comes to Poison Oak Prevention. • Watch for agitated buffalo and cattle that may charge. • Follow all CDC and Agency COVID 19 protocols.

INCIDENT NAME:

LAKE FIRE

Operational Period: 1800-0600
August 15, 2020

DATE AND TIME PREPARED:

August 15, 2020 1600 hours



LAKE INCIDENT COVID-19 Symptom Tracking Form



LACoFD is concerned about the potential spread of COVID-19 during a wildland incident.

If you have any symptoms consistent with COVID-19, complete this form and report to the Medical Unit Leader.

Symptom Monitoring Form

Name *

Contact Phone *

First

Last

Home Agency

Unit Number

Incident Supervisor

Incident Supervisor Phone

Symptoms Tracking

1

Date

Time

AM or PM

8/13/2020



2:36 AM



AM PM

Cough?

Yes No

Do you have a fever or do you feel feverish?

Yes No

Runny nose?

Yes No

Sore Throat?

Yes No

Difficulty Breathing or Shortness of Breath?

Yes No

Muscle Aches or Headache?

Yes No

Loss of Taste or Smell?

Yes No

Abdominal Discomfort?

Yes No

Vomiting?

Yes No

Diarrhea?

Yes No

INCIDENT RADIO COMMUNICATIONS PLAN		Incident Name	LAKE		Date/Time Prepared	Operational Period	Date/Time						
Utilization of any frequency other than those listed on this form are prohibited, subject to fines by the FCC and demobilization from the incident.													
Zh Ch	Function	Channel Name/Trunked Radio System Talkgroup	Assignment	RX Freq	N or W	RX Tone/NAC	TX Freq	N or W	TX Tone/NAC	Dev	Pwr	Mode	Remarks
1	COMMAND	ANF 10	OPERATIONS	172.3750		CSQ	164.9375		107.2	N	H	A	
2	COMMAND	ANF 14	OPERATIONS	172.3750		CSQ	164.9375		151.4	N	H	A	
3	COMMAND	ANF 15	OPERATIONS	172.3750		CSQ	164.9375		162.2	N	H	A	
4	TACTICAL	NIFC T-1	DIV A/B	168.0500		CSQ	168.0500		131.8	N	L	A	
5	TACTICAL	NIFC T-3	DIV C	168.6000		CSQ	168.6000		131.8	N	L	A	
6	TACTICAL	NIFC T-5	DIV F	166.7250		CSQ	166.7250		131.8	N	L	A	
7	TACTICAL	NIFC T-6	DIV I	166.7750		CSQ	166.7750		131.8	N	L	A	
8	TACTICAL	VFIRE22	DIV S/T	154.2650		Tone 6 156.7	154.2650		Tone 6 156.7	N	L	A	
9	TACTICAL	VFIRE23	DIV X	154.2950		Tone 6 156.7	154.2950		Tone 6 156.7	N	L	A	
10	TACTICAL	VFIRE24	DIV G, DIV Z	154.2725		Tone 6 156.7	154.2725		Tone 6 156.7	N	L	A	
11	TACTICAL	FCA V-1D	CONTINGENCY	155.3250		Tone 6 156.7	155.3250		Tone 6 156.7	N	H	A	
12	TACTICAL	FCA V-2D	3 PT STRUCTURE	155.4000		Tone 6 156.7	155.4000		Tone 6 156.7	N	H	A	
13	TACTICAL	CALCORD	MEDICAL TAC	156.0750		Tone 6 156.7	156.0750		Tone 6 156.7	N	H	A	
14/18	AIR TO GROUND	A/G TAC	AIR TO GROUND TAC	169.2875		CSQ	169.2875		CSQ	N	L	A	
15/19	AIR TO GROUND	A/G CMD	AIR TO GROUND CMD	167.9500		CSQ	167.9500		CSQ	N	L	A	
16/20	EMERGENCY	AIR GUARD	EMERGENCY	168.6250		CSQ	168.6250		Tone 1 110.9	N	L	A	
Prepared By (Communications Unit Leader)								Incident Location					
Kevin Throop COM1(t) 303-229-3246								CASTAIC LOWER LAKE ICP, CASTAIC, CA					
								County: LAC State: CA		Latitude: N		Longitude: W	

The convention calls for frequency lists to show four digits after the decimal place (five digits for 700 MHz frequencies). The letter "U", "N", or "W" in the deviation (Dev) column reflects whether the frequency is ultranarrow (6.25 kHz), narrow (12.5 kHz), or wide band (25 kHz). Mode refers to either "A" indicating Analog, "D" indicating Digital (e.g. Project 25) or "M" indicating Mixed Mode. All channels are shown as if programmed in a control station, mobile or portable radio. Repeaters (and depending on use, base stations) must be programmed with the Rx and Tx reversed.

MEDICAL PLAN	1. INCIDENT NAME: Lake	2. DATE PREPARED: August 15, 2020	3. TIME PREPARED: 1130	4. OPERATIONAL PERIOD 08/15/20- 8/16/20 1800-0600
---------------------	---------------------------	--------------------------------------	---------------------------	--

5. INCIDENT MEDICAL AID STATIONS		
MEDICAL AID STATIONS	LOCATION	ALS
LA Co. Squad 4124	ICP	YES NO
LA Co. Squad 4135	LA Co FS 78 17021 Elizabeth Lake Rd. Lake Hughes, Ca. 93532	X X

6. TRANSPORTATION			
A. Ambulance Services			
NAME	LOCATION	PHONE	ALS
AMR	ICP		YES NO
AMR	LA Co FS 78 17021 Elizabeth Lake Rd. Lake Hughes, Ca. 93532		X X

B. AIR AMBULANCE			
NAME	LOCATION	PHONE	ALS
LA County Fire, Hoist capable	LACO Dispatch (323) 881-6183		YES NO
			XX

7. HOSPITALS										
NAME	ADDRESS	TRAVEL TIME		PHONE	TRAUMA		HELIPAD		BURN CENTER	
		AIR	GRND		Yes	No	Yes	NO	YES	NO
Henry Mayo N34 23.94 W118 33.11	23845 W. McBean Pkwy Valencia, Ca. 91355	5	15	(661) 200-1601	L-II		XX			XX
Antelope Valley Hospital N34 41.283 W118 9.5166	1600 W. Ave. J Lancaster, Ca. 93534	10	45	(661) 949-5000	L-II		XX			XX
West Hills Hospital N34 12.18 W118 37.75	7300 Medical Center Dr. West Hills, Ca. 91307	20	45	(818) 676-4598		XX	XX		XX	
LAC+USC Med Center N34 03.345 W118 12.48	1200 N. State Street Los Angeles, CA 90033	45	1.75 Hr.	(323) 226-2622	L-I		XX		XX	

8. MEDICAL EMERGENCY PROCEDURES

LINE "MEDICAL-EMERGENCY" PLAN:

- Crew Supervisor to contact Division Supervisor/Operations with:
 - Patient Complaint, Condition and Location via Tactical or Command frequency. Priority 1/Red & 2/Yellow Patients trigger Incident within Incident (IWI).
- Division Supervisor/Operation contacts Lake Communications:
 - Division Supervisor or POC* will run "Medical -Emergency" on the Command frequency.
 - Division Supervisor of POC* to use "Medical Incident Report" worksheet on page 118-119 of the IRPG.

POC* (Point of Contact) and/or Operations

LINE "NON-EMERGENCY INCIDENT" PLAN:

- Crew Supervisor to contact Division Supervisor with:
 - Patient Complaint, Condition and Location via Tactical or Command frequency. Priority 3/Green Patients do not trigger Incident within Incident (IWI).
- Division Supervisor contacts Apple Communications:
 - Division Supervisor or POC* will run "Non-Emergency Incident" on the Command frequency.
 - Division Supervisor or POC* will use "Medical Incident Report" worksheet on page 118 -119 of the IRPG.

IN-CAMP – 24 HOUR MEDICAL

- Contact Lake Communications with:
 - Patient Complaint, Condition and Location via LOGS net or Command frequency

9. PREPARED BY Jeff Carlon - MEDL	10. REVIEWED BY SOFI
--------------------------------------	-------------------------

Human Resource Message

Hello

As the Human Resource Specialist assigned to this incident, my role is to facilitate a positive work environment, which begins with "Hello"! A simple hello goes a long way toward establishing our human connection and how we relate to others.

My role is to be a focal point for informal resolution of issues and concerns to ensure a positive work environment. You may come to me with any question or concern about any aspect of your work environment while assigned to the incident. I am particularly committed to help assure resolution of issues as they arise, rather than waiting until after the incident is demobilized. High priority is given to resolving issues informally with mutual respect as a priority. If you are aware of inappropriate conduct, you have the right and the obligation to do something about it.

Come see me any time you have questions or concerns.

A sense of humor is part of the art of leadership, of getting along with people, of getting things done. Dwight D. Eisenhower

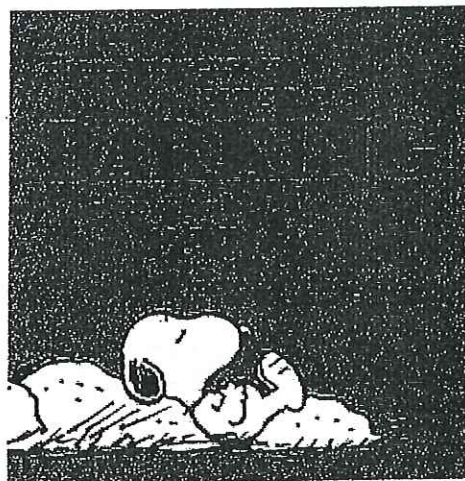

Andrea Cabida
Human Resource Specialist
707-330-9939

TRAINING SPECIALIST MESSAGE

A Training Specialist is now on the incident.

ALL ASSIGNED TRAINEES

working on position task books will need to register with the Incident Training Specialist in order to receive proper credit for your assignment.

The Training Specialist is available immediately following the morning Operations Briefing.

TRAINING SPECIALIST

**Claudia Soiza
Cell-(949)632-7813**

**Incident Trainee/Trainer Data Form
Lake Fire CA-ANF-003273**

Training Specialist: Claudia Soiza 949.632.7813

- All Incident trainees, including those on Firefighting Modules at your earliest opportunity complete this form and see the Training Specialist.
- Prior to or as you process through DEMOB, remember to close your training package. To close your training package, bring: 1) A performance rating from your trainer. (ICS 225)
2) Your task book that has as many entries as possible by your Trainer.

Trainee Data

Trainee Name: _____ ICS Trainee Position: _____

Request # (A,C,E, or O): _____ Agency Designator (Ex. CA-RRU): _____

Ordered as Trainee? Y N Priority Trainee ___ Local Forest Trainee ___ IMT Trainee

Date Assigned: _____ Cell / Contact # While on Incident: _____

Training Records Mailed To: (Fire Chief, Training Officer):

Name: _____ Title _____

Name of Agency/Unit: _____

Agency/Unit Address: _____

City: _____ State: _____ Zip Code: _____ Phone: _____

Trainee Prerequisites

1. Possesses valid Qualification Card or agency certification card? ___Yes ___No

2. Trainee has current position task book issued by home unit? ___Yes ___No

Current Task Book Progress (Circle) 0% 25% 50% 75% 90%

Priority Open Task in PTB (What do you need to accomplish on this incident?)

Trainer/Evaluator Data

Trainer / Evaluator Name: _____ ICS position on fire: _____

Home Unit: _____ Agency Designator (Ex CA-RRU): _____

Request # (A,C,E,O): _____

Work Address: _____

City: _____ State: _____ Zip Code: _____

Cell / Contact While on Incident: _____

LINE ORDER FORM

ORDER #	DATE & TIME ORDERED Received from the Line	WHO PLACED ORDER DIVS, OPS, etc...	DELIVER to (DIV, Helispot, DP, etc.) Division, Heli-Spot, Drop Point, etc.	MODE of DEVIVERY Drive, Helo, pick-up

Order Received in Communications By:	TIME:
Communications Relayed/Placed the Order To:	TIME:
Order Shipped to the Line By (Name):	TIME:

ITEM#	DESCRIPTION	AMOUNT
1	1,000 Foot Hose Lay: Includes the following 10 lengths, 1 1/2" x 100' Hose. 10 lengths, 1" x 100' Hose. 10ea. 1 1/2" Gated Wyes. 10ea. 1 1/2" to 1" Reducers. 10ea. 1" Nozzles.	
2	2,000 Foot Hose Lay: Includes the following 20 lengths, 1 1/2" x 100' Hose. 20 lengths, 1" x 100' Hose. 20ea. 1 1/2" Gated Wyes. 20ea. 1 1/2" to 1" Reducers. 20ea. 1" Nozzles.	
3	3,000 Foot Hose Lay: Includes the following 30 lengths, 1 1/2" x 100' Hose. 30 lengths, 1" x 100' Hose. 30ea. 1 1/2" Gated Wyes. 30ea. 1 1/2" to 1" Reducers. 30ea. 1" Nozzles.	

ITEM#	REQUESTED ITEM	NFES#	AMOUNT	ITEM#	REQUESTED ITEM	NFES#	AMOUNT
4	Backpack Pump, 5 gallon	1149		26	Batteries, "AA", (package)	0030	
5	Foam, 5 gallon	1145		27	Gasoline, Unleaded (gallon)		
6	Hose, 3/4 inch, 50 ft. length	1016		28	Oil, 2 Cycle Mix (quart)	0341	
7	Hose, 1 inch, 100 ft. length	0966		29	Diesel, straight (gallon)		
8	Hose, 1 1/2 inch, 100 ft. length	0967		30	Oil, Bar & Chain (gallon)	1880	
9	Increaser, 3/4" to 1"	2235		31	Fusees (box)	0105	
10	Increaser, 1" to 1 1/2"	0416		32	Torch, Drip Torch ea.	0241	
11	Nozzle, Garden 3/4 inch	0136		33	Mix, Drip Torch 3-1, 5 gal.		
12	Nozzle, Forester, 1"	0024		34	Flagging, Ribbon, Color/Roll		
13	Nozzle, KK Type, 1"	1081		35	Washcloth, Waterless	0206	
14	Nozzle, KK Type, 1 1/2"	1082		36	Water, Cubi, 5 gallon ea.	0048	
15	Reducer, 1" to 3/4"	0733		37	Water, Bottled, (case)		
16	Reducer, 1 1/2" to 1"	0009		38	Sports Drink, Gatorade (case)		
17	Tee, Hoseline, 1"x1"x 3/4"	1809		39	Food, MRE's (12 per Box)	1842	
18	Tee, Hoseline, 1"x1"x 1"	2240		40	Pump Kit, High Pressure	0870	
19	Tee, Hoseline, 1 1/2" x 1 1/2" x 1"	0230		41	Pump, High Pressure	0148	
20	Wye, Gated, 3/4" inch	0904		42	Pump Kit, Light Weight	0670	
21	Wye, Gated, 1"	0259		43	Sprinkler Kit	1048	
22	Wye, Gated, 1 1/2"	0231		44	Pump Kit, Volume	6041	
23	Tank, Collapsible. Capacity Gallons?			45	Mop-Up Kit	0772	
24	Tank, Folding/Frame. Capacity ??						
25	Wrap, Structure (roll)	0881					

Date and Time Needed: _____ Point of Contact at Delivery Location: _____

OTHER / NOTES:

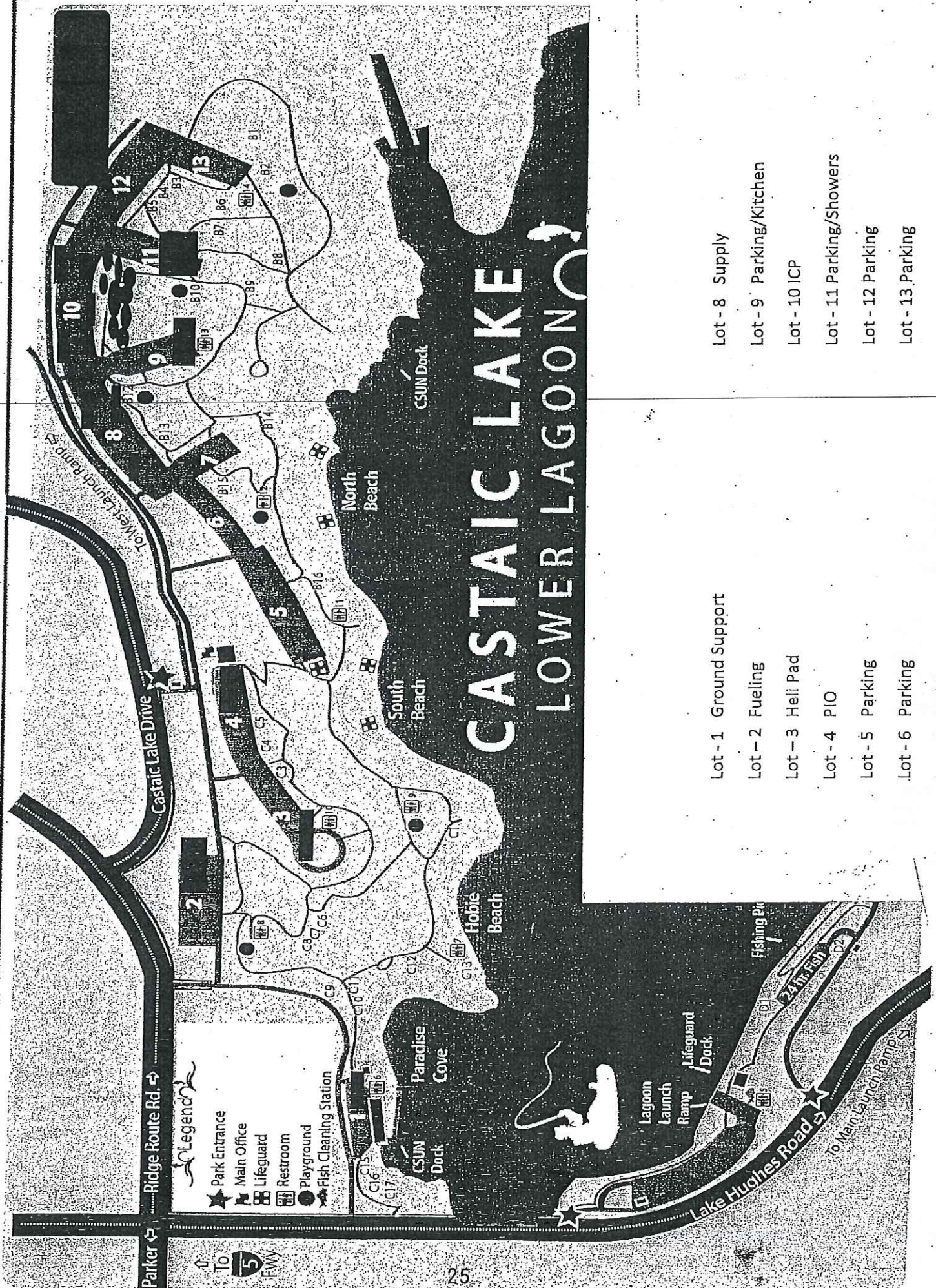

- Legend**
- ★ Park Entrance
 - ☑ Main Office
 - ☑ Lifeguard
 - ☑ Restroom
 - ☑ Playground
 - ☑ Fish Cleaning Station

CASTAIC LAKE LOWER LAGOON

- Lot - 1 Ground Support
- Lot - 2 Fueling
- Lot - 3 Heli Pad
- Lot - 4 PIO
- Lot - 5 Parking
- Lot - 6 Parking
- Lot - 7 Parking

- Lot - 8 Supply
- Lot - 9 Parking/Kitchen
- Lot - 10 ICP
- Lot - 11 Parking/Showers
- Lot - 12 Parking
- Lot - 13 Parking

Lake Fire ICP

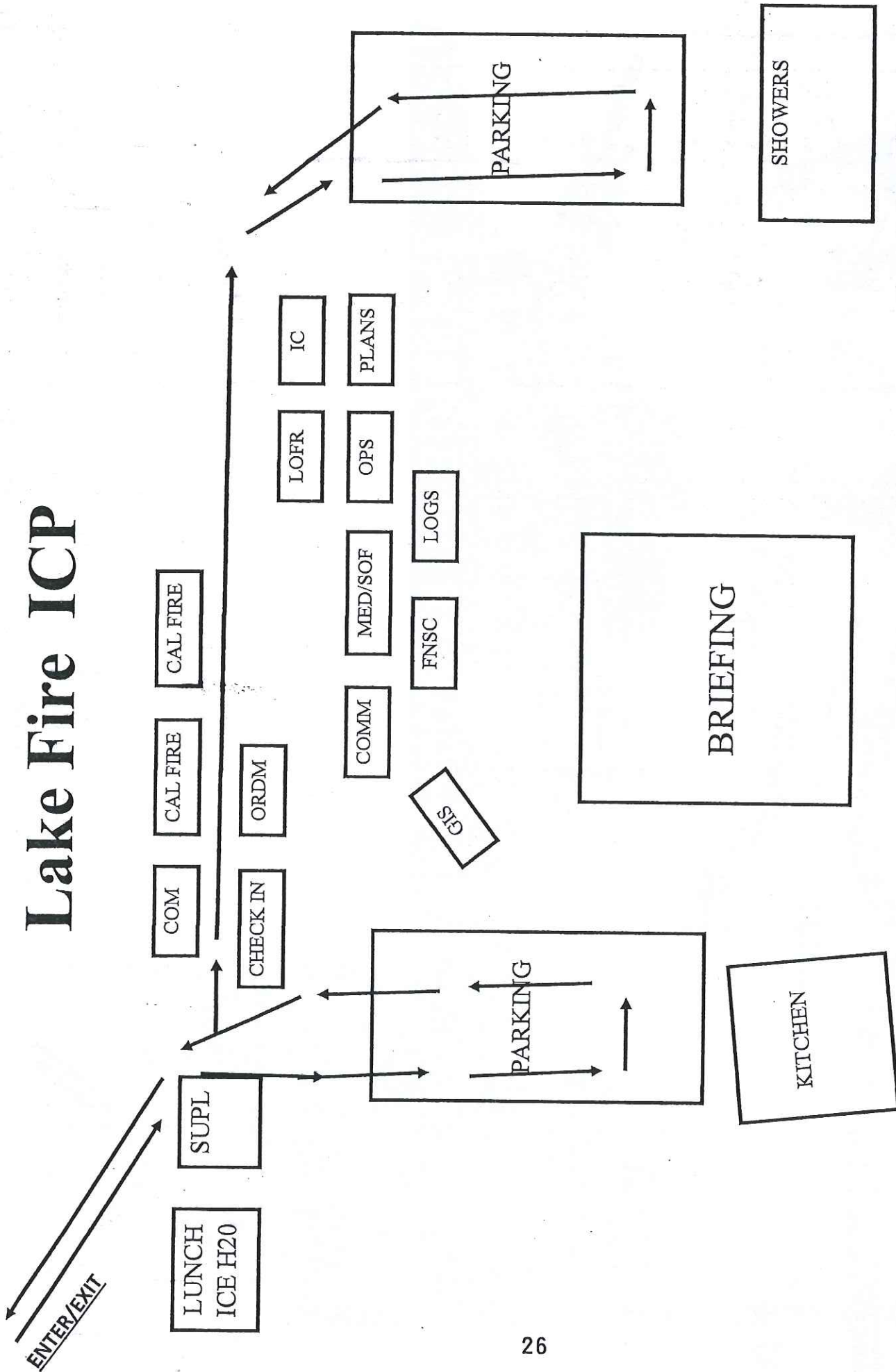

Medical Incident Report

FOR A **NON-EMERGENCY INCIDENT**: WORK THROUGH CHAIN OF COMMAND TO REPORT AND TRANSPORT INJURED PERSONNEL AS NECESSARY.

FOR A **MEDICAL EMERGENCY**: IDENTIFY ON SCENE INCIDENT COMMANDER BY NAME AND POSITION AND ANNOUNCE "MEDICAL EMERGENCY" TO INITIATE RESPONSE FROM COMMUNICATIONS

Use the following items to communicate situation to communications/dispatch.

- 1. CONTACT COMMUNICATIONS / DISPATCH** (Verify correct frequency prior to starting report)
Ex: "Communications, Div. Alpha. Stand-by for Emergency Traffic."
- 2. INCIDENT STATUS:** Provide incident summary (including number of patients) and command structure.
Ex: "Communications, I have a Red priority patient, unconscious, struck by a falling tree. Requesting air ambulance to Forest Road 1 at (Lat./Long.)
"This will be the Trout Meadow Medical Incident, IC is TFLD Jones. EMT Smith is providing medical care."

Severity of Emergency AND Transport Priority (priority 1, 2, 3)	<input type="checkbox"/> RED / PRIORITY 1 Life or limb threatening injury or illness. Evacuation need is IMMEDIATE Ex: Unconscious, difficulty breathing, bleeding severely, 2 ^o - 3 ^o burns more than 4 palm sizes, heat stroke, disoriented.	
	<input type="checkbox"/> YELLOW / PRIORITY 2 Serious Injury or illness. Evacuation may be DELAYED if necessary. Ex: Significant trauma, unable to walk, 2 ^o - 3 ^o burns not more than 1-3 palm sizes.	
	<input type="checkbox"/> GREEN / PRIORITY 3 Minor Injury or illness. Non-Emergency transport Ex: Sprains, strains, minor heat-related illness.	
Nature of Injury or Illness & Mechanism of Injury		Brief Summary of Injury or Illness (Ex: Unconscious, Struck by Falling Tree)
Transport Request		Air Ambulance / Short Haul/Hoist Ground Ambulance / Other
Patient Location		Descriptive Location & Lat. / Long. (WGS84)
Incident Name		Geographic Name + "Medical" (Ex: Trout Meadow Medical)
On-Scene Incident Commander		Name of on-scene IC of Incident within an Incident (Ex: TFLD Jones)
Crew Patient Care		Name of Care Provider (Ex: EMT Smith)

3. INITIAL PATIENT ASSESSMENT: Complete this section for each patient as applicable (start with the most severe patient)

Agency Affiliation: (NO PATIENT NAMES) Federal Contractor Local Government

Patient Assessment: Age: Weight: Chief Complaint:

(If pertinent to Injury) Skin Signs: (color/moisture/temp) Level of Consciousness: BP: HR: Respirations:

Treatment:

4. TRANSPORT PLAN:

Evacuation Location (drop point, intersection, helispot, Lat. / Long, hazards) Patient's ETA to Location:

5. ADDITIONAL RESOURCES / EQUIPMENT NEEDS:

Paramedic / EMT - Crews - Immobilization Devices - AED - Oxygen - Trauma Bag - IV/Fluid(s) - Splints - Rope rescue - Wheeled litter - HAZMAT - Extrication

6. COMMUNICATIONS: Identify State Air/Ground EMS Frequencies and Hospital Contacts as applicable

Function	Channel Name/Number	Receive (RX)	Tone/NAC *	Transmit (TX)	Tone/NAC*
COMMAND	Operations	172.3750	Tone 8, 103.5	164.9375	Tone 14, 151.4
AIR-TO-GRND	Lake A/G	169.2875	CSQ	169.2875	CSQ
Med TACTICAL	Calcord	156.0750	Tone 6, 156.7	156.0750	Tone 6, 156.7

7. CONTINGENCY: Considerations: If primary options fail, what actions can be implemented in conjunction with primary evacuation method?
Be thinking ahead.

8. ADDITIONAL INFORMATION: Updates/Changes, etc.

REMEMBER: Confirm ETA's of resources ordered. Act according to your level of training
Be Alert - Keep Calm - Think Clearly - Act Decisively

*** Follow up with MEDL upon return to ICP ***