

Incident Action Plan  
For The  
**Zaca Fire**  
**Richardson Zone**

*Day*  
*Operational Period*  
*Monday*  
*August 20, 2007*  
*0600-1800*

CA-LPF-001087  
P5DP4U



California Interagency Incident Management Team 5

<b>INCIDENT OBJECTIVES</b>	1. Incident Name <b>ZACA</b>	2. Date Prepared 8/19/07	3. Time 2200															
4. Operational Period <b>DAY August 20, 2007 0600-1800</b>																		
5. Core Values-All Incidents, All the time ★ Safety is a core value and is to be integrated into all incident activities.																		
6. General Control Objectives for the Incident (include alternatives) <b>Operational Objectives:</b> <ul style="list-style-type: none"> <li>• Keep Fire: <ul style="list-style-type: none"> <li>★ North of Catway Rd. (Zaca ridge Rd) and the line running from Drop Point 12 south east to Buckhorn Road to Divide Peak</li> <li>★ West of the Matilija Wilderness to Potrero Seco to Hwy 33</li> <li>★ South of Sierra Madre Ridge roads</li> <li>★ East of Peak Mountain to Bald Mountain to Figueroa Mountain Peaks.</li> </ul> </li> <li>• Minimize loss of property and infrastructure</li> <li>• Coordinate Contingency Efforts with Front Country Zone</li> <li>• Utilize the full range of suppression strategies as weather, fuels and terrain permit</li> </ul> <b>Management Objectives</b> <ul style="list-style-type: none"> <li>★ Fiscal: Ensure activities are cost effective and reflect jurisdictional responsibilities. Provide for proactive Community, Tribal, and Public/Media Relations</li> <li>★ Identify and mitigate impacts to cultural and natural resources</li> </ul>																		
7. <b>Priorities</b> <ul style="list-style-type: none"> <li>★ <b>Live Oak Zone:</b> Division VV, ZZ, UU</li> <li>★ <b>Richardson Zone:</b> Divisions GG, FF, DD, AA / BB</li> </ul>																		
8. <b>General Safety Message</b> SEE HEALTH AND SAFETY MESSAGE																		
8. Attachments (mark if attached) <table border="0" style="width: 100%;"> <tr> <td><input checked="" type="checkbox"/> Incident Weather Forecast</td> <td><input checked="" type="checkbox"/> Health and Safety Message</td> <td><input checked="" type="checkbox"/> Incident Phone List</td> </tr> <tr> <td><input checked="" type="checkbox"/> Fire Behavior Forecast</td> <td><input checked="" type="checkbox"/> Incident Action Plan Safety Analysis – ICS 215a</td> <td><input checked="" type="checkbox"/> Base Camp Map</td> </tr> <tr> <td><input checked="" type="checkbox"/> Organization Assignment List - ICS 203</td> <td><input checked="" type="checkbox"/> Incident Radio Communication Plan – ICS 205</td> <td><input checked="" type="checkbox"/> Unit Log – ICS 214</td> </tr> <tr> <td><input checked="" type="checkbox"/> Division Assignment Lists – ICS 204</td> <td><input checked="" type="checkbox"/> Medical Plan - ICS 206</td> <td><input type="checkbox"/></td> </tr> <tr> <td><input checked="" type="checkbox"/> Air Operations Summary – ICS 220</td> <td><input type="checkbox"/> Training Message</td> <td><input type="checkbox"/></td> </tr> </table>				<input checked="" type="checkbox"/> Incident Weather Forecast	<input checked="" type="checkbox"/> Health and Safety Message	<input checked="" type="checkbox"/> Incident Phone List	<input checked="" type="checkbox"/> Fire Behavior Forecast	<input checked="" type="checkbox"/> Incident Action Plan Safety Analysis – ICS 215a	<input checked="" type="checkbox"/> Base Camp Map	<input checked="" type="checkbox"/> Organization Assignment List - ICS 203	<input checked="" type="checkbox"/> Incident Radio Communication Plan – ICS 205	<input checked="" type="checkbox"/> Unit Log – ICS 214	<input checked="" type="checkbox"/> Division Assignment Lists – ICS 204	<input checked="" type="checkbox"/> Medical Plan - ICS 206	<input type="checkbox"/>	<input checked="" type="checkbox"/> Air Operations Summary – ICS 220	<input type="checkbox"/> Training Message	<input type="checkbox"/>
<input checked="" type="checkbox"/> Incident Weather Forecast	<input checked="" type="checkbox"/> Health and Safety Message	<input checked="" type="checkbox"/> Incident Phone List																
<input checked="" type="checkbox"/> Fire Behavior Forecast	<input checked="" type="checkbox"/> Incident Action Plan Safety Analysis – ICS 215a	<input checked="" type="checkbox"/> Base Camp Map																
<input checked="" type="checkbox"/> Organization Assignment List - ICS 203	<input checked="" type="checkbox"/> Incident Radio Communication Plan – ICS 205	<input checked="" type="checkbox"/> Unit Log – ICS 214																
<input checked="" type="checkbox"/> Division Assignment Lists – ICS 204	<input checked="" type="checkbox"/> Medical Plan - ICS 206	<input type="checkbox"/>																
<input checked="" type="checkbox"/> Air Operations Summary – ICS 220	<input type="checkbox"/> Training Message	<input type="checkbox"/>																
9. Prepared by (Planning Section Chief)		10. Approved by (Incident Commander)																

ORGANIZATION ASSIGNMENT LIST		9. Operations Section		
<b>1. Incident Name</b> Zaca Fire – Richardson Zone		Operations Chief	Don Will	
<b>2. Date</b> 8/19/2007	<b>3. Time</b> 2100			
<b>4. Operational Period</b> DAY August 20, 2007 0600-1800		Planning Ops.	Don Smith / Tom Hatcher	
<b>5. Incident Commander &amp; Staff</b>		<b>a. Branch XXV</b>		
Incident Commander	Mike Dietrich	Branch Director	Bobby Shindelar / Randy Unkovich (T)	
Deputy IC	Tim Sexton	Division	AA	Unstaffed
Information Officers	Leona Roderick / Sue Exline	Division	BB	Brian Savage
Human Resource Specialist	Diane Simpson / Tim Sexton	Division	CC	Scott Brown / Pedro Henrich / Ray Valenzuela (T)
Safety Officer	Marty Hamel / Dave Morton	Division	DD	Sam Wilbanks / Mark German
Liaison Officer	Randy Graham	Division	EE	Ruth Johnson / Jeff Ohs / Tom Shevenell (T)
		Group	FIRING	Sam Marouk
<b>6. Agency Representatives</b>		<b>b. Branch XXVII</b>		
<b>Agency</b>	<b>Name</b>	Branch Director	Keith Gurrola	
USFS	Tom Kuekes / John Bridgewater	Division	North FF	Robert Doyle
SBC	Craig Thomas	Division	South FF	Kenny Ellyson
OES	David Powell / Ish Messer	Division	GG	Sean Ferrell / Tony Tyler (T)
CAL FIRE	Greg Pisano / Byron Darrington (T)	Division	HH	Steve Mueller / James Turner (T)
KRN Fire	Bob Kleinhoff	Group	CAFS	Dennis King
VNC Fire	Rod Megli			
SB SO	Joe Smith / Paul Weirum	Group	Roads	Don Hill / Greg Gates
VNC SO	Bruce Norris			
CHP VNC	Bob Granzert	<b>c. Branch Contingency</b>		
CHP Santa Maria	Mat Olsen	Branch Director	Spike Newby	
CALTRANS VNC	Mike Tallbot	Division	Ozena	Kim Olson
CALTRANS Cuyama	Frank Sulland	Division	Hwy 33	Craig Forsythe / Dane Mumford (T)
BLM	Debbie Santiago	Division		
CCC	Jim Teegardin	<b>d. Branch</b>		
<b>7. Planning Section</b>		<b>e. Air Operations Branch</b>		
Chief	Tim Baal	Air Operations Branch Director		Belinda McCandliss
Deputy	Roy Dull			
Computer Specialist	Dave Camp	Helibase Manager		Curt Warner
Situation Unit	Dan Ochocki / Keiji Seta (T)	Air Attack Supervisor		Boyd Turner
Resource Unit	Gary Thompson / Heather Wood (T) / Michael Murphy (T)	Air Support Supervisor		John Keesee
Meteorologist	Cindy Bean	Helicopter Coordinator		
Fire Behavior Analyst	Kelly Martin	<b>10. Finance Section</b>		
Demobilization Unit		Chief	Teresa Fork	
Documentation Unit	Gary Thompson	Time Unit	Maggie Prochazka	
Training Specialist	Rick Alpert / Clay Smith (T)	Procurement Unit	Byron Brown	
Resource Advisor	Melody Fountain, LPF John Madden, LPF	Compensation/Claims	Elaine Downing / Liz Roberts	
		Cost Unit	Mary Glenn	
<b>8. Logistics Section</b>				
Chief	Dana Simpson			
Deputy	Hern Crane			
Supply Unit Leader	Mike Bradford			
Facilities Unit	Bill Fouts			
Ground Support Unit	Gary Roglin / Mike Nelson			
Communications Unit	Hern Crane	<b>Prepared by (Resource Unit Leader)</b>  Heather Wood		
Medical Unit	Robert Russell			
Food Unit	Bruce Ungari / Richard Rivers / Jose Sanchez (T)			
Security	Clint Robbins			

## ***Incident Weather Forecast***

**FORECAST NO:** 13 D

**NAME OF INCIDENT:** Zaca 2 - Richardson Zone

**PREDICTION FOR:** Monday – Day Shift

**UNIT:** LPF

**SHIFT DATE:** Aug 20, 2007

**SIGNED:**

**TIME AND DATE** 1655 PDT Sunday

**FORECAST ISSUED:** August 19, 2007

**Cindy Bean**  
**Incident Meteorologist**  
**Zaca 2**

---

### **WEATHER DISCUSSION:**

#### **...Fire Weather Watch Today through Tuesday Evening for Very Low Relative Humidity...**

A ridge of high pressure will build over the area today. The stubborn and persistent inversion will keep smoke locked in between 7,000 and 10,000 ft once the peak burning cycle begins (1300 PDT). A gradual warming trend will continue through Wednesday with several hours of single digit RH's in the morning and afternoon. However sufficient smoke over the fire area will tend to moderate temperatures and RH's during the afternoon.

---

### **WEATHER FORECAST:**

**WEATHER:** Sunny, slightly warmer and drier...becoming smoky in the afternoon.

**MAX TEMPS:**

**Ridgetops/Upper Slopes:** 88 – 93

**Lower Slopes/Drainage:** 90 – 97

**HUMIDITY:** 30-40% at 0600...falling to 5-14% by 0900 and remaining within that range through 1500 PDT then rising slightly as smoke cover the area.

**20 FT WINDS:**

**RIDGETOP -** 0600-1300 PDT...Northeast to East 4 - 8 mph.  
1300-1900 PDT...Southwest to Northwest 4 - 8 mph with gusts to 14 mph.

**SLOPE/VALLEY -** Till 1200 PDT.....East or Downslope/Down valley 4-6 mph.  
1200-1900 PDT....Southwest to Northwest or Upslope 4-6 mph  
Stronger afternoon westerly gusts to 12-16 mph  
in alignment.

**MIXING HEIGHT:** 1st Inversion around 6000 ft...2<sup>nd</sup> and stronger inversion  
around 8,000 ft. Mixing height near 10,000 ft.

**TRANSPORT WIND:** Southwest to west 5 to 10 mph between 7000 and 10,000. Southwest  
8 to 12 mph above 10,000 ft.

---

### **Tuesday:**

Sunny, Hot and Dry. Highs 89-95 ridges...93-99 lower slopes. Minimum Relative Humidity 6 -12%. Ridge Winds...Northwest to North 3-6 mph...gusts 12 mph. Slope / Drainage winds...west or upslope 4-8 mph with higher gusts to 14 mph along west to east orientated terrain.

---

**Wednesday:** Sunny...continued hot and dry. Highs 88-94 upper slopes...92-97 mid and lower slopes. Min RH: 6-12%...Max: 28-34%. Lows 58-66. Ridge winds: Northeast 4-7 mph night and morning. Southwest to northwest 3-5 mph with gusts 10 mph in the afternoon. Slope winds: upslope or west 5-8 mph...gusts 12 mph in alignment.

**Thursday:** Sunny and slightly cooler. Highs 85-93. Min RH 16-24%. Night and Morning winds east northeast or Downslope 4-7 mph. Daytime winds North Northwest 4-7 mph.

**Friday:** Sunny and warmer. Highs 87-94. Min RH 14-22%. Night and morning winds east northeast or downslope 4-7 mph. Daytime winds North Northwest 4-7 mph.

# FIRE BEHAVIOR FORECAST

<b>FORECAST NUMBER:</b> 20	<b>TYPE OF FIRE:</b> SURFACE
<b>FIRE NAME:</b> ZACA – Richardson Zone	<b>OPERATIONAL PERIOD:</b> 8/20/2007
<b>DATE ISSUED:</b> 8/19/07	<b>TIME ISSUED:</b> 2000h
<b>UNIT:</b> SANTA BARBARA COUNTY /LOS PADRES NF	<b>SIGNED:</b> <i>Isl Kelly Close</i>

## INPUTS

### **WEATHER SUMMARY:** *See attached Fire Weather Forecast*

A re-building of a high-pressure ridge will continue to bring warmer and drier conditions, with a persistent inversion that will limit vertical column development over actively burning area. Smoke accumulating over the fire area will provide partial shading in the afternoon, moderating the temps and RH slightly.

**PROBABILITY OF IGNITION** = 70-80% at lower elevations, 80-90% at upper elevations

Live Fuel Moistures are below critical levels - about 49% at Reyes Creek/Ozena, taken August 1

## FIRE BEHAVIOR

**GENERAL:** Continued low RH, warm temperatures, exceptionally dry, heavy fuels, and alignment with wind and slope will produce intense fire behavior. Fuel conditions are volatile. Erratic fire behavior, such as firewhirls and spotting, has been observed daily and should be expected today. Spotting distances of up to 1,000-2,000 ft. are possible. Enhanced solar heating of fuels will favor earlier fire activity, rapid fire growth and intense burning conditions. A shift in winds to westerly/southwesterly in the early afternoon will impact firing operations and holding on multiple Divisions.

### **SPECIFIC:**

#### **Branch XXV:**

**Division BB** – The fire moved slowly but steadily farther down the Sisquoc drainage yesterday. Runs in Forester's Leap Cyn. and other smaller drainages to the north are likely where alignment is favorable. Be prepared for easterly/down-valley winds again in the morning. Conditions may become more favorable for firing operations when winds switch to W and SW, but winds and fire spread may be erratic in the bottom of the main drainage. Crews should continually assess their location relative to active fire, monitor fire behavior and movement, and changes in weather and fire behavior.

**Division CC and DD** – With the RH dropping earlier in the morning, firing operations in light fuels should carry well along the dozerline after about 0900h. Sun exposure of fuels through early afternoon may help overcome the effects of improved higher RH recovery at night. Down canyon/valley winds may be favorable for firing operations earlier, but with the stronger westerly winds later in the afternoon, there is potential for firing to spot over the line. A more westerly wind could also align with upper portions of the drainages below the Sierra Madre, increasing fire activity and promoting intense uphill runs. With the warming and drying trend in place, firing operations will have a wider window of opportunity, starting after 0900h and continuing later into the early evening. Shading from smoke in the afternoon may limit effectiveness of firing operations later in the day.

**Division EE** – Firing operations will be most effective in the late morning to mid-afternoon with the forecast RH and winds. Westerly winds will again challenge holding resources; watch for spots crossing the line with forecasted winds. Late in the day, shading from smoke and RH >25% may limit effectiveness of firing operations.

#### **Branch XXVIII:**

**Division FF (North and South)** – Expect winds similar to yesterday; E and NE winds earlier in the day will be favorable for firing operations, and expect a shift to stronger and more westerly winds earlier, by about 1300h. A persistent inversion will limit vertical column development and cause smoke to accumulate in the afternoon.

**Division GG** – Downslope winds should be favorable for firing and holding in the morning. Drainages will be in alignment with westerly winds in the afternoon, and short, intense runs with spotting are likely in unburned fuels. Westerly winds will also challenge holding actions and short-range spotting is still likely.

**Division HH and Live Oak Div. KK** – Easterly winds through mid-afternoon will help with holding actions. Watch for flare-ups of remaining hot spots with the shift to westerly winds in the afternoon.

**AIR OPERATIONS:** Expect good visibility around Richardson Helibase and the retardant base. Visibility will be poor in the Sisquoc River in the morning, and accumulation of smoke under the inversion in the afternoon will limit visibility on the eastern portion of the fire.

## SAFETY

- All fuelbeds are carrying fire very well – don't expect drainages/riparian vegetation to check fire spread.
- Fire activity should start early due to early drops in RH in the morning, with active burning by 0900h.
- As firing progress, it is important to be continually aware of the fire's status and location, your location in relation to drainages/canyons and the fire, and how fire behavior and weather are changing.



<b>DIVISION ASSIGNMENT LIST</b>		1. Branch <b>XXV</b>		2. Division/Group <b>AA</b>			
3. Incident Name <b>Zaca Fire – Richardson Zone</b>		4. Operational Period Day Shift Date: 08/20/2007 Time: 0600 - 1800					
5. Operations Personnel							
Operations Chief	<b>Don Will</b>		Division/Group Supervisor		<b>Unstaffed</b>		
Branch Director	<b>B.Shindelar / R.Unkovich (T)</b>		Air Attack Supervisor No.		<b>Boyd Turner</b>		
6. Resources Assigned This Period							
Strike Team/Task Force/ Resource Designator	Leader	Number Persons	Trans Needed	Drop Off PT/Time	Pick Up PT/Time		
UNSTAFFED							
7. Control Operations							
UNSTAFFED							
8. Special Instructions							
<b>Return all 5 gallon burn mix fuel containers to Drop Points for backhaul, or return them to Supply at Richardson ICP.</b>							
Backhaul all trash and refuse daily.							
Sites marked with blue plus red and white striped flagging together should be avoided by dozer.							
Sierra Madre Ridge is a nationally important archaeological area. Please do not pick up artifacts or disturb the rocks at known or found sites. NO Graffiti.							
The Sisquoc River is habitat for endangered steelhead trout. Avoid using or causing contamination of the water.							
9. Division/Group Communication Summary							
Function	Frequency	System	Channel	Function	Frequency	System	Channel
<b>Command</b>	<b>Rx 168.1000 N Tx 170.4500 N Tone 123.0</b>	<b>NIFC C-2 RPT</b>	<b>2</b>				
<b>Tactical</b>	<b>173.9875 N</b>	<b>R5-TAC-6</b>	<b>5</b>	<b>Air to Ground</b>	<b>172.8125 N</b>	<b>AIR GND 1</b>	<b>6</b>
Prepared By (Resource Unit Leader)		Approved By (Planning Sect. Ch.)		Date		Time	
Heather Wood		Tim Baal		08/19/2007		2130	

<b>[DIVISION ASSIGNMENT LIST</b>				1. Branch <b>XXV</b>		2. Division/Group <b>BB</b>	
3. Incident Name <b>Zaca Fire – Richardson Zone</b>				4. Operational Period Day Shift Date: 08/20/2007 Time: 0600 - 1800			
5. Operations Personnel							
Operations Chief		<b>Don Will</b>		Division/Group Supervisor		<b>Brian Savage</b>	
Branch Director		<b>B.Shindelar / R.Unkovich (T)</b>		Air Attack Supervisor No.		<b>Boyd Turner</b>	
6. Resources Assigned This Period							
Strike Team/Task Force/ Resource Designator		Leader	Number Persons	Trans Needed	Drop Off PT/Time	Pick Up PT/Time	
CRW1 Democrat		Randy Griffin	15	N	Pine Spike / 0700	Pine Spike per DIVS	
CRW2 Rincon		Jon Carothers	20	N	Pine Spike / 0700	Pine Spike per DIVS	
CRW2 Highlander		Don Brown	22	N	Pine Spike / 0700	Pine Spike per DIVS	
ENG3 LPF E-70		Rob Moreno	6	N	Pine Spike / 0700	Pine Spike per DIVS	
DOZ1 24 hr Price (E-10228)		Gil Robledo	1	N	Pine Spike / 0700	Pine Spike per DIVS	
LOWB Brokus (E-10055)		Jordan Simpson	1	N	Pine Spike / 0700	Pine Spike per DIVS	
DOZ2 24 hr AG Const (E-10012)		Tom Brady	1	N	Pine Spike / 0700	Pine Spike per DIVS	
LOWB Stevens (E-10054)		Greg Mallcus	1	N	Pine Spike / 0700	Pine Spike per DIVS	
WT2 Peterson (E-10056)		Jack Hunt	1	N	Pine Spike / 0700	Pine Spike per DIVS	
WT2 Aqua Express #3 (E-10299)		Mike Barrett	1	N	Pine Spike / 0700	Pine Spike per DIVS	
WT2 Bennett (E-10016)		Sam Bennett	1	N	Pine Spike / 0700	Pine Spike per DIVS	
DOZB		John White	1	N	Pine Spike / 0700	Pine Spike per DIVS	
DOZB		Hal Luedtke	1	N	Pine Spike / 0700	Pine Spike per DIVS	
DOZB (T)		Byron Alcantara	1	N	Pine Spike / 0700	Pine Spike per DIVS	
ARCH		Sally Zaraqosa	1	N	Pine Spike / 0700	Pine Spike per DIVS	
ARCH		Phillip Kaiser	1	N	Pine Spike / 0700	Pine Spike per DIVS	
INCS		Molon Rodriquez	1	N	Pine Spike / 0700	Pine Spike per DIVS	
READ		Joel Schultz	1	N	Pine Spike / 0700	Pine Spike per DIVS	
READ		Tim Williams	1	N	Pine Spike / 0700	Pine Spike per DIVS	
7. Control Operations Prep BB / CC break West along Sierra Madre Ridge, construct safety zones and install water handling equipment as necessary.							
8. Special Instructions <b>Return all 5 gallon burn mix fuel containers to Drop Points for backhaul, or return them to Supply at Richardson ICP.</b> Backhaul all trash and refuse daily. Sites marked with blue plus red and white striped flagging together should be avoided by dozer. CAFS apparatus: avoid using foam on and adjacent to rock outcrops and rock monoliths. Sierra Madre Ridge is a nationally important archaeological area. Please do not pick up artifacts or disturb the rocks at known or found sites. NO Graffiti. The Sisquoc River is habitat for endangered steelhead trout. Avoid using or causing contamination of the water.							
9. Division/Group Communication Summary							
Function	Frequency	System	Channel	Function	Frequency	System	Channel
<b>Command</b>	<b>Rx 168.1000 N Tx 170.4500 N Tone 123.0</b>	<b>NIFC C-2 RPT</b>	<b>2</b>				
<b>Tactical</b>	<b>173.9875 N</b>	<b>R5-TAC-6</b>	<b>5</b>	Air to Ground	<b>172.8125 N</b>	<b>AIR GND 1</b>	<b>6</b>
Prepared By (Resource Unit Leader)		Approved By (Planning Sect. Ch.)		Date		Time	
Michael P. Murphy		Tim Baal		08/19/2007		2130	



<b>DIVISION ASSIGNMENT LIST</b>				1. Branch <b>XXV</b>		2. Division/Group <b>CC</b>	
3. Incident Name <b>Zaca Fire – Richardson Zone</b>				4. Operational Period Day Shift Date: 08/20/2007 Time: 0600 - 1800			
5. Operations Personnel							
Operations Chief		<b>Don Will</b>		Division/Group Supervisor		<b>Scott Brown / Pedro Henrich / Ray Valenzuela (T)</b>	
Branch Director		<b>B.Shindelar / R.Unkovich (T)</b>		Air Attack Supervisor No.		<b>Boyd Turner</b>	
6. Resources Assigned This Period							
Strike Team/Task Force/ Resource Designator		Leader	Number Persons	Trans Needed	Drop Off PT/Time	Pick Up PT/Time	
CRW2 Black Eagles 3		D.Hoban/J.Gibb (T)	21	N	ICP / 0600	ICP per DIVS	
ENG3 S/T 2175C		P. Pilotte B. Hillary (T)	18	N	ICP / 0600	ICP per DIVS	
WT2 24 hr Kurz Trkg (E-10059)		Jeff Kurz	1	N	ICP / 0600	ICP per DIVS	
WT2 24 hr Bogan (E-10085)		Sonny Bogan	1	N	ICP / 0600	ICP per DIVS	
WT2 24hr Cool Mule (E-10218)		Norm Pope	1	N	ICP / 0600	ICP per DIVS	
EMTP		Ian Thrall	1	N	ICP / 0600	ICP per DIVS	
EMTB		Danny Naylor	1	N	ICP / 0600	ICP per DIVS	
SOF2 (Covering CC / DD / EE)		John Warren	1	N	ICP / 0600	ICP per DIVS	
SOF2 (T) (Covering CC / DD / EE)		Mark Kaib	1	N	ICP / 0600	ICP per DIVS	
7. Control Operations							
Hold and monitor line. Assist adjoining Divisions with firing operations.							
8. Special Instructions							
Return all 5 gallon burn mix fuel containers to Drop Points for backhaul, or return them to Supply at Richardson ICP. Backhaul all trash and refuse daily. Sites marked with blue plus red and white striped flagging together should be avoided by dozer. CAFS apparatus: avoid using foam on and adjacent to rock outcrops and rock monoliths. Areas accessed by Buckhorn and Sierra Madre Ridge Roads have sensitive cultural values. Do not disturb artifacts or climb on rock formations. The Sisquoc River is habitat for endangered steelhead trout. Avoid using or causing contamination of the water.							
<b>Safety Officers will be covering Division CC, Division DD, and Division EE.</b>							
9. Division/Group Communication Summary							
Function	Frequency	System	Channel	Function	Frequency	System	Channel
Command	<b>Rx 168.1000 N Tx 170.4500 N Tone 123.0</b>	<b>NIFC C-2 RPT</b>	<b>2</b>				
Tactical	<b>173.9125 N</b>	<b>R5 TAC 4</b>	<b>3</b>	Air to Ground	<b>172.8125 N</b>	<b>AIR GND 1</b>	<b>6</b>
Prepared By (Resource Unit Leader)			Approved By (Planning Sect. Ch.)		Date		Time
Michael P. Murphy			Tim Baal		08/19/2007		2130

DIVISION ASSIGNMENT LIST		1. Branch <b>XXV</b>		2. Division/Group <b>DD</b>			
3. Incident Name <b>Zaca Fire – Richardson Zone</b>		4. Operational Period Day Shift Date: 08/20/2007 Time: 0600 - 1800					
5. Operations Personnel							
Operations Chief	<b>Don Will</b>	Division/Group Supervisor		<b>Sam Wilbanks / Mark German</b>			
Branch Director	<b>B.Shindelar / R.Unkovich (T)</b>	Air Attack Supervisor No.		<b>Boyd Turner</b>			
6. Resources Assigned This Period							
Strike Team/Task Force/ Resource Designator	Leader	Number Persons	Trans Needed	Drop Off PT/Time	Pick Up PT/Time		
CRW2 Cobras 1	Bruce Runningcrane	20	N	ICP / 0600	ICP per DIVS		
ENG3 E-43 LPF	Rob Thibault	5	N	ICP / 0600	ICP per DIVS		
WT2 24hr South Valley (E-10057)	Gary Bettis	1	N	ICP / 0600	ICP per DIVS		
WT2 24hr Santana (E-10019)	Frank Svestka	1	N	ICP / 0600	ICP per DIVS		
WT2 Bennett (E-10018)	Richard Paul	1	N	ICP / 0600	ICP per DIVS		
EMTB	Kyle Colonna	1	N	ICP / 0600	ICP per DIVS		
EMTB	Jim Clark	1	N	ICP / 0600	ICP per DIVS		
EMTP	Matt Cobb	1	N	ICP / 0600	ICP per DIVS		
SOF2 (Covering CC / DD / EE)	John Warren	1	N	ICP / 0600	ICP per DIVS		
SOF2(T) (Covering CC / DD / EE)	Mark Kaib	1	N	ICP / 0600	ICP per DIVS		
7. Control Operations							
Hold and monitor line.							
8. Special Instructions							
<p><b>Return all 5 gallon burn mix fuel containers to Drop Points for backhaul, or return them to Supply at Richardson ICP.</b> Backhaul all trash and refuse daily. Sites marked with blue plus red and white striped flagging together should be avoided by dozer.</p> <p>CAFS apparatus: avoid using foam on and adjacent to rock outcrops and rock monoliths.</p> <p>Areas accessed by Buckhorn and Sierra Madre Ridge Roads have sensitive cultural values. Do not disturb artifacts or climb on rock formations.</p> <p><b>Safety Officers will be covering Division CC, Division DD, and Division EE.</b></p>							
9. Division/Group Communication Summary							
Function	Frequency	System	Channel	Function	Frequency	System	Channel
<b>Command</b>	<b>Rx 168.1000 N Tx 170.4500 N Tone 123.0</b>	<b>NIFC C-2 RPT</b>	<b>2</b>				
<b>Tactical</b>	<b>173.9625 N</b>	<b>R5 TAC 5</b>	<b>4</b>	<b>Air to Ground</b>	<b>172.8125 N</b>	<b>AIR GND 1</b>	<b>6</b>
Prepared By (Resource Unit Leader) Michael P. Murphy		Approved By (Planning Sect. Ch.) Tim Baal		Date 08/19/2007		Time 2130	

ICS 204

NFES 1328

DIVISION ASSIGNMENT LIST				1. Branch <b>XXV</b>		2. Division/Group <b>EE</b>			
3. Incident Name <b>Zaca Fire – Richardson Zone</b>				4. Operational Period Day Shift Date: 08/20/2007 Time: 0600 - 1800					
5. Operations Personnel									
Operations Chief		<b>Don Will</b>		Division/Group Supervisor		<b>Ruth Johnson / Jeff Ohs / Tom Shevenell (T)</b>			
Branch Director		<b>B.Shindelar / R.Unkovich (T)</b>		Air Attack Supervisor No.		<b>Boyd Turner</b>			
6. Resources Assigned This Period									
Strike Team/Task Force/ Resource Designator		Leader		Number Persons	Trans Needed	Drop Off PT/Time	Pick Up PT/Time		
CRW1 Modoc HS		Bob Beebe		19	N	ICP / 0600	ICP per DIVS		
CRW1 Klamath HS		Johnny Clem		21	N	ICP / 0600	ICP per DIVS		
CRW2 Cobra 5		Eddie Chapman / Michael Bray (T)		20	N	ICP / 0600	ICP per DIVS		
ENG S/T 2175C		Mike Urquides		18	N	ICP / 0600	ICP per DIVS		
DOZ2 24 hr Johnson (E-10178)		Tony Burford		1	N	ICP / 0600	ICP per DIVS		
LOWB Pacific Star (E-10185)		Scott Thorton		1	N	ICP / 0600	ICP per DIVS		
WT1 Ventana Ranch (E-10116)		Bruce Nason		1	N	ICP / 0600	ICP per DIVS		
WT1 Jardines (E-10117)		Paul Herman		1	N	ICP / 0600	ICP per DIVS		
WT2 OConnell WT616 (E-10119)		Mark O'Connell		1	N	ICP / 0600	ICP per DIVS		
WT2 24hr Holt Water (E-10217)		Larry Miller		1	N	ICP / 0600	ICP per DIVS		
EMTB		John Godwin		1	N	ICP / 0600	ICP per DIVS		
EMTB		Tim Edgmon		1	N	ICP / 0600	ICP per DIVS		
FOBS		Patrick Heuer		1	N	ICP / 0600	ICP per DIVS		
FOBS (T)		Shannon Wolfe		1	N	ICP / 0600	ICP per DIVS		
SOF2 (Covering CC / DD / EE)		John Warren		1	N	ICP / 0600	ICP per DIVS		
SOF2 (T) (Covering CC / DD / EE)		Mark Kaib		1	N	ICP / 0600	ICP per DIVS		
7. Control Operations									
Hold and monitor line. Mop up 100 feet.									
8. Special Instructions									
<b>Return all 5 gallon burn mix fuel containers to Drop Points for backhaul, or return them to Supply at Richardson ICP.</b>									
Backhaul all trash and refuse daily.									
Sites marked with blue plus red and white striped flagging together should be avoided by dozer.									
CAFS apparatus: avoid using foam on and adjacent to rock outcrops and rock monoliths.									
<b>Safety Officers will be covering Division CC, Division DD, and Division EE.</b>									
9. Division/Group Communication Summary									
Function		Frequency		System	Channel	Function	Frequency	System	Channel
<b>Command</b>		<b>Rx 168.1000 N Tx 170.4500 N Tone 123.0</b>		<b>NIFC C-2 RPT</b>	<b>2</b>				
<b>Tactical</b>		<b>173.9875 N</b>		<b>R5 TAC 6</b>	<b>5</b>	Air to Ground	<b>172.8125 N</b>	<b>AIR GND 1</b>	<b>6</b>
Prepared By (Resource Unit Leader)				Approved By (Planning Sect. Ch.)		Date		Time	
Michael P. Murphy				Tim Baal		08/19/2007		2130	



DIVISION ASSIGNMENT LIST				1. Branch <b>XXVII</b>		2. Division/Group <b>North FF</b>	
3. Incident Name <b>Zaca Fire – Richardson Zone</b>				4. Operational Period Day Shift Date: 08/20/2007 Time: 0600 - 1800			
5. Operations Personnel							
Operations Chief		<b>Don Will</b>		Division/Group Supervisor		<b>Robert Doyle</b>	
Branch Director		<b>Keith Gurrola</b>		Air Attack Supervisor No.		<b>Boyd Turner</b>	
6. Resources Assigned This Period							
Strike Team/Task Force/ Resource Designator	Leader	Number Persons	Trans Needed	Drop Off PT/Time	Pick Up PT/Time		
CRW1 Golden Eagle HS	Ray Ruiz	22	N	DP-104 / 0700	Per DIVS		
CRW2 Mojave 2	Bill Crews	20	N	DP-104 / 0700	Per DIVS		
CRW2 Boundary Peak	Ron Riise	20	N	DP-104 / 0700	Per DIVS		
CRW1 Scorpions #2	Jose Caldera	20	N	DP-104 / 0700	Per DIVS		
ENG S/T 3600C	Aaron Schuh	26	N	DP-104 / 0700	Per DIVS		
<b>CAFS Task Force 1</b>	Pete Jensen Kevin Fildes (T)	23	N	DP-104 / 0700	Per DIVS		
DOZ2 24 hr Foley (E-10132)	Frank Foley	1	N	DP-104 / 0700	Per DIVS		
LOWB Foley (E-10133)	Frank Foley	1	N	DP-104 / 0700	Per DIVS		
WT2 Bennett (E-10017)	Marcos Castro	1	N	DP-104 / 0700	Per DIVS		
WT2 Holt (E-10084)	Greg Holt	1	N	DP-104 / 0700	Per DIVS		
SOF2 (Covering North FF / South FF)	Sam Lobese	1	N	DP-104 / 0700	Per DIVS		
SOF2 (T) (Covering North FF / South FF)	Joe Pastone	1	N	DP-104 / 0700	Per DIVS		
7. Control Operations							
Conduct firing operations from DP-104 to DP-106, coordinate with Firing Group.							
8. Special Instructions							
<b>Return all 5 gallon burn mix fuel containers to Drop Points for backhaul, or return them to Supply at Richardson ICP.</b>							
Backhaul all trash and refuse daily.							
Sites marked with blue plus red and white striped flagging together should be avoided by dozer.							
CAFS apparatus: avoid using foam on and adjacent to rock outcrops and rock monoliths.							
<b>Safety Officers will be covering Division North FF and South FF.</b>							
9. Division/Group Communication Summary							
Function	Frequency	System	Channel	Function	Frequency	System	Channel
<b>Command</b>	<b>Rx 166.6125 N Tx 168.4000 N Tone 123.0</b>	<b>NIFC C-4</b>	<b>1</b>				
<b>Tactical</b>	<b>173.9125 N</b>	<b>R5 TAC 4</b>	<b>3</b>	<b>Air to Ground</b>	<b>172.8125 N</b>	<b>AIR GND 1</b>	<b>6</b>
Prepared By (Resource Unit Leader)		Approved By (Planning Sect. Ch.)		Date		Time	
Heather Wood		Tim Baal		08/19/2007		2130	

DIVISION ASSIGNMENT LIST				1. Branch <b>XXVII</b>		2. Division/Group <b>South FF</b>	
3. Incident Name <b>Zaca Fire – Richardson Zone</b>				4. Operational Period Day Shift Date: 08/20/2007 Time: 0600 - 1800			
5. Operations Personnel							
Operations Chief		<b>Don Will</b>		Division/Group Supervisor		<b>Kenny Ellyson</b>	
Branch Director		<b>Keith Gurrola</b>		Air Attack Supervisor No.		<b>Boyd Turner</b>	
6. Resources Assigned This Period							
Strike Team/Task Force/ Resource Designator	Leader	Number Persons	Trans Needed	Drop Off PT/Time	Pick Up PT/Time		
CRW1 Horseshoe Meadow	Joe Gonzales	20	N	DP-106 / 0700	Per DIVS		
CRW1 Laguna HS	Jim Huston	22	N	DP-106 / 0700	Per DIVS		
CRW2 Monterey	Dan O'Keefe	20	N	DP-106 / 0700	Per DIVS		
CRW2 Scorpions #1	Liz Kurpies	20	N	DP-106 / 0700	Per DIVS		
<b>CAFS Task Force 2</b>	Mark Acevedo	23	N	DP-106 / 0700	Per DIVS		
DOZ2 Bennett (E-10011)	Sam Bennett	1	N	DP-106 / 0700	Per DIVS		
DOZ2 SNF2 (E-10231)	Jeff Corwell	1	N	DP-106 / 0700	Per DIVS		
WT2 Alexander Bros (E-10373)	Ed Koekebaker	1	N	DP-106 / 0700	Per DIVS		
WT2 Pierce (E-10261)	Mike Lawrance	1	N	DP-106 / 0700	Per DIVS		
WT3 Sweetwater (E-10301)	Gerhard Haas	1	N	DP-106 / 0700	Per DIVS		
EMTP	Wes Daum	1	N	DP-106 / 0700	Per DIVS		
EMTP	Nathan Foster	1	N	DP-106 / 0700	Per DIVS		
SOF2 (Covering North FF / South FF)	Sam Lobese	1	N	DP-106 / 0700	Per DIVS		
SOF2 (T) (Covering North FF / South FF)	Joe Pastone	1	N	DP-106 / 0700	Per DIVS		
7. Control Operations							
Conduct firing operations from Pine Mountain Summit to Ozena, continue to DP-106 as conditions allow. Coordinate with Firing Group.							
8. Special Instructions							
<p><b>Return all 5 gallon burn mix fuel containers to Drop Points for backhaul, or return them to Supply at Richardson ICP.</b></p> <p>Backhaul all trash and refuse daily.</p> <p>Sites marked with blue plus red and white striped flagging together should be avoided by dozer.</p> <p>CAFS apparatus: avoid using foam on and adjacent to rock outcrops and rock monoliths.</p> <p><b>Safety Officers will be covering Division North FF and South FF.</b></p>							
9. Division/Group Communication Summary							
Function	Frequency	System	Channel	Function	Frequency	System	Channel
<b>Command</b>	<b>Rx 166.6125 N Tx 168.4000 N Tone 123.0</b>	<b>NIFC C-4</b>	<b>1</b>				
<b>Tactical</b>	<b>173.9625 N</b>	<b>R5 TAC 5</b>	<b>4</b>	<b>Air to Ground</b>	<b>172.8125 N</b>	<b>AIR GND 1</b>	<b>6</b>
Prepared By (Resource Unit Leader)		Approved By (Planning Sect. Ch.)		Date		Time	
Heather Wood		Tim Baal		08/19/2007		2130	

<b>DIVISION ASSIGNMENT LIST</b>				1. Branch <b>XXVII</b>		2. Division/Group <b>GG</b>	
3. Incident Name <b>Zaca Fire – Richardson Zone</b>				4. Operational Period Day Shift Date: 08/20/2007 Time: 0600 - 1800			
5. Operations Personnel							
Operations Chief		<b>Don Will</b>		Division/Group Supervisor		<b>Sean Ferrell / Tony Tyler (T)</b>	
Branch Director		<b>Keith Gurrola</b>		Air Attack Supervisor No.		<b>Boyd Turner</b>	
6. Resources Assigned This Period							
Strike Team/Task Force/ Resource Designator	Leader	Number Persons	Trans Needed	Drop Off PT/Time	Pick Up PT/Time		
CRW1 EI-Tejon HS	Cameron Reeder	14	N	DP-111 / 0700	Ozena Spike per DIVS		
CRW1 VNC CC 1-2	Chad Cook	18	N	DP-111 / 0700	Ozena Spike per DIVS		
ENG3 S/T 1605C	Larry Hill	21	N	DP-111 / 0700	Ozena Spike per DIVS		
DOZ2 SHF 29 (E-10230)	David Brown	1	N	DP-111 / 0700	Ozena Spike per DIVS		
DOZ2 24hr Blatnick (E-10234)	John Blatnick	1	N	DP-111 / 0700	Ozena Spike per DIVS		
WT2 Aqua Express (E-638)	Keril Keiser	1	N	DP-111 / 0700	Ozena Spike per DIVS		
WT2 Martin (E-10122)	Chris Martin	1	N	DP-111 / 0700	Ozena Spike per DIVS		
WT2 24 hr King (E-10086)	Bryan Wand	1	N	DP-111 / 0700	Ozena Spike per DIVS		
WT2 24 hr ANF 22 (E-10215)	Brandon Burril	1	N	DP-111 / 0700	Ozena Spike per DIVS		
WT2 24 hr CNF 4 (E-10262)	Norman Odorico	1	N	DP-111 / 0700	Ozena Spike per DIVS		
EMTP	Ben Frasca	1	N	DP-111 / 0700	Ozena Spike per DIVS		
EMTB	Tony Vierra	1	N	DP-111 / 0700	Ozena Spike per DIVS		
FOBS	James Yazloff	1	N	DP-111 / 0700	Ozena Spike per DIVS		
FOBS	Mike Watt	1	N	DP-111 / 0700	Ozena Spike per DIVS		
SOFR	Robert Weaver	1	N	DP-111 / 0700	Ozena Spike per DIVS		
SOFR (T)	Anthony Stornetta	1	N	DP-111 / 0700	Ozena Spike per DIVS		
7. Control Operations							
Complete firing operations from DP-112 to DP-111. Hold and monitor line, mop-up 100 feet.							
8. Special Instructions							
Return all 5 gallon burn mix fuel containers to Drop Points for backhaul, or return them to Supply at Richardson ICP. Division needs for archeologists or Resource Advisors will be coordinated through Contingency Group. Backhaul all trash and refuse daily. Sites marked with blue plus red and white striped flagging together should be avoided by dozer. CAFS apparatus: avoid using foam on and adjacent to rock outcrops and rock monoliths. Some archeological sites are located on the Don Victor Jeep Road. At those identified sites, avoid dozer use, but brushing and masticator use OK.							
9. Division/Group Communication Summary							
Function	Frequency	System	Channel	Function	Frequency	System	Channel
<b>Command South</b>	<b>Rx 173.0375 N Tx 167.3250 N Tone 123.0</b>	<b>NIFC C-12</b>	<b>7</b>				
<b>Tactical</b>	<b>168.0500 N</b>	<b>TAC 1</b>	<b>8</b>	<b>Air to Ground</b>	<b>172.8125 N</b>	<b>AIR GND 1</b>	<b>6</b>
Prepared By (Resource Unit Leader)		Approved By (Planning Sect. Ch.)		Date		Time	
Michael P. Murphy		Tim Baal		08/19/2007		2130	

<b>DIVISION ASSIGNMENT LIST</b>		1. Branch <b>XXVII</b>		2. Division/Group <b>HH</b>			
3. Incident Name <b>Zaca Fire – Richardson Zone</b>		4. Operational Period Day Shift Date: 08/20/2007 Time: 0600 - 1800					
5. Operations Personnel							
Operations Chief	<b>Don Will</b>	Division/Group Supervisor		<b>Steve Mueller / James Turner (T)</b>			
Branch Director	<b>Keith Gurrola</b>	Air Attack Supervisor No.		<b>Boyd Turner</b>			
6. Resources Assigned This Period							
Strike Team/Task Force/ Resource Designator	Leader	Number Persons	Trans Needed	Drop Off PT/Time	Pick Up PT/Time		
CRW2 Road Runners	Tom Guzman	24	N	DP-112 / 0700	Ozena Spike per DIVS		
CRW2 OC 23	Curt Lindstrand	21	N	DP-112 / 0700	Ozena Spike per DIVS		
ENG3 IAR E5 (E-10027)	Bill Sainsbury	4	N	DP-112 / 0700	Ozena Spike per DIVS		
ENG3 IAR E9 (E-10026)	Ron Dumont	4	N	DP-112 / 0700	Ozena Spike per DIVS		
WT2 24hr Water Co (E-10216)	Jerald Dean	1	N	DP-112 / 0700	Ozena Spike per DIVS		
WT2 24hr Dick Allen (E-10214)	Rockie Smith	1	N	DP-112 / 0700	Ozena Spike per DIVS		
SOF2	Don Kearney	1	N	DP-112 / 0700	Ozena Spike per DIVS		
7. Control Operations							
Patrol and monitor from DP-113 to DP-112, mop-up 100 feet.							
8. Special Instructions							
<p>Backhaul all trash and refuse daily. Sites marked with blue plus red and white striped flagging together should be avoided by dozer. CAFS apparatus: avoid using foam on and adjacent to rock outcrops and rock monoliths. Some archeological sites are located on the Don Victor Jeep Road. At those identified sites, avoid dozer use, but brushing and masticator use OK.</p> <p><b>Maintain communications with and coordinate operations with Live Oak Branch IX Division TT.</b></p>							
9. Division/Group Communication Summary							
Function	Frequency	System	Channel	Function	Frequency	System	Channel
<b>Command South</b>	<b>Rx 173.0375 N Tx 167.3250 N Tone 123.0</b>	<b>NIFC C-12</b>	<b>7</b>				
<b>Tactical</b>	<b>168.0500 N</b>	<b>TAC 1</b>	<b>8</b>	<b>Air to Ground</b>	<b>172.8125 N</b>	<b>AIR GND 1</b>	<b>6</b>
Prepared By (Resource Unit Leader) Gary Thompson		Approved By (Planning Sect. Ch.) Tim Baal		Date 08/19/2007	Time 2130		





<b>DIVISION ASSIGNMENT LIST</b>		1. Branch		2. Division/Group <b>ROADS</b>			
3. Incident Name <b>Zaca Fire – Richardson Zone</b>		4. Operational Period Date: 08/20/2007 Time: <b>0600-1800</b>					
5. Operations Personnel							
Operations Chief	<b>Don Will</b>	Division/Group Supervisor		<b>Don Hill / Greg Gates</b>			
Branch Director		Air Attack Supervisor No.					
6. Resources Assigned This Period							
Strike Team/Task Force/ Resource Designator	Leader	Number Persons	Trans Needed	Drop Off PT/Time	Pick Up PT/Time		
WT2 24 hr Rinaldo (E-10264)	Ryan Rinaldo	1	N	ICP / 0600	Per Water Tender Coordinator		
WT2 24 hr Pearson (E-10268)	Ryan Pearson	1	N	ICP / 0600	Per Water Tender Coordinator		
WT2 24 hr Aqua Lady (E-10267)	Mona Mordoff	1	N	ICP / 0600	Per Water Tender Coordinator		
WT2 24 hr Michelle's (E-10266)	Acie Avila	1	N	ICP / 0600	Per Water Tender Coordinator		
WT2 24 hr A&P (E-10265)	Pete Troxell	1	N	ICP / 0600	Per Water Tender Coordinator		
WT2 24 hr Alan's (E-10300)	Alan Wharffs	1	N	ICP / 0600	Per Water Tender Coordinator		
WT2 King (E-10298)	Charlie King	1	N	ICP / 0600	Per Water Tender Coordinator		
7. Control Operations							
Water roads per direction from Water Tender Coordinator.							
8. Special Instructions							
Backhaul all trash and refuse daily.							
<b>Radio frequencies will be determined by location of work.</b>							
9. Division/Group Communication Summary							
Function	Frequency	System	Channel	Function	Frequency	System	Channel
<b>Command East</b>	<b>Rx 166.6125 N Tx 168.4000 N Tone 123.0</b>	<b>NIFC C-4</b>	<b>1</b>	<b>Command South</b>	<b>Rx 173.0375 N Tx 167.3250 N Tone 123.0</b>	<b>NIFC C-12</b>	<b>7</b>
<b>Command West</b>	<b>Rx 168.1000 N Tx 170.4500 N Tone 123.0</b>	<b>NIFC C-2 RPT</b>	<b>2</b>	<b>Air to Ground</b>	<b>172.8125 N</b>	<b>AIR GND 1</b>	<b>6</b>
Prepared By (Resource Unit Leader)		Approved By (Planning Sect. Ch.)		Date	Time		
Gary Thompson		Tim Baal		08/19/2007	2130		

<b>DIVISION ASSIGNMENT LIST</b>				1. Branch <b>Contingency</b>		2. Division/Group <b>Ozena</b>	
3. Incident Name <b>Zaca Fire – Richardson Zone</b>				4. Operational Period Day Shift Date: 08/20/2007 Time: 0600 - 1800			
5. Operations Personnel							
Operations Chief		<b>Don Will</b>		Division/Group Supervisor		<b>Kim Olson</b>	
Branch Director		<b>Spike Newby</b>		Air Attack Supervisor No.		<b>Boyd Turner</b>	
6. Resources Assigned This Period							
Strike Team/Task Force/ Resource Designator		Leader	Number Persons	Trans Needed	Drop Off PT/Time	Pick Up PT/Time	
DOZ2 AG Const. (E-10177)		Fred Nehrig	1	N	Ozena Spike / 0700	Ozena Spike per DIVS	
LOWB Brockus (E-10180)		Steve Bockus	1	N	Ozena Spike / 0700	Ozena Spike per DIVS	
DOZ2 24 hr Gratzl Equip (E-10153)		Justin Rodriguez	1	N	Ozena Spike / 0700	Ozena Spike per DIVS	
LOWB Brown Bulk (E-10154)		Don Teter	1	N	Ozena Spike / 0700	Ozena Spike per DIVS	
DOZ2 24 hr CFC D7755 (E-10232)		Terry Bishop	1	N	Ozena Spike / 0700	Ozena Spike per DIVS	
DOZ2 24 hr CFC D7756 (E-10233)		Tim Koester	1	N	Ozena Spike / 0700	Ozena Spike per DIVS	
DOZ2 S@K (E-10014)		Kirk McKenney	1	N	Ozena Spike / 0700	Ozena Spike per DIVS	
LOWB S@K (E-10067)		Charles Smith	1	N	Ozena Spike / 0700	Ozena Spike per DIVS	
WT2 Ventana (E-10297)		Cara Nason	1	N	Ozena Spike / 0700	Ozena Spike per DIVS	
WT2 24hr Schlitz (E-10213)		Frank Schlitz	1	N	Ozena Spike / 0700	Ozena Spike per DIVS	
GRAD Bennett (E-10060)		Sam Bennett	1	N	Ozena Spike / 0700	Ozena Spike per DIVS	
DOZB		Albert Pena	1	N	Ozena Spike / 0700	Ozena Spike per DIVS	
DOZB		Tyler Gilliam	1	N	Ozena Spike / 0700	Ozena Spike per DIVS	
DOZB		Tom Haus	1	N	Ozena Spike / 0700	Ozena Spike per DIVS	
DOZB (T)		Ben Dempsey	1	N	Ozena Spike / 0700	Ozena Spike per DIVS	
DOZB (T)		Robert Goodwin	1	N	Ozena Spike / 0700	Ozena Spike per DIVS	
7. Control Operations Construct dozer contingency lines in identified areas as directed by DIVS.							
8. Special Instructions Return all 5 gallon burn mix fuel containers to Drop Points for backhaul, or return them to Supply at Richardson ICP. Backhaul all trash and refuse daily. Sites marked with blue plus red and white striped flagging together should be avoided by dozer. CAFS apparatus: avoid using foam on and adjacent to rock outcrops and rock monoliths.							
9. Division/Group Communication Summary							
Function	Frequency	System	Channel	Function	Frequency	System	Channel
<b>Command</b>	<b>Rx 166.6125 N Tx 168.4000 N Tone 123.0</b>	<b>NIFC C-4</b>	<b>1</b>				
<b>Tactical</b>	<b>173.9125 N</b>	<b>TAC-4</b>	<b>3</b>	Air to Ground	<b>172.8125 N</b>	<b>AIR GND 1</b>	<b>6</b>
Prepared By (Resource Unit Leader)		Approved By (Planning Sect. Ch.)		Date		Time	
Heather Wood		Tim Baal		08/19/2007		2130	

<b>DIVISION ASSIGNMENT LIST</b>				1. Branch <b>Contingency</b>		2. Division/Group <b>Hwy 33</b>	
3. Incident Name <b>Zaca Fire – Richardson Zone</b>				4. Operational Period Day Shift Date: 08/20/2007 Time: 0600 - 1800			
5. Operations Personnel							
Operations Chief		<b>Don Will</b>		Division/Group Supervisor		<b>Craig Forsythe / Dane Mumford (T)</b>	
Branch Director		<b>Spike Newby</b>		Air Attack Supervisor No.		<b>Boyd Turner</b>	
6. Resources Assigned This Period							
Strike Team/Task Force/ Resource Designator		Leader	Number Persons	Trans Needed	Drop Off PT/Time	Pick Up PT/Time	
CRW1 Crane Valley HS		Chuck Berner	20	N	ICP / 0600	ICP per DIVS	
<b>S/T ZACA 101</b>		Bob Myers	27	N	ICP / 0600	ICP per DIVS	
STEN (T)		Mark Karr	1	N	ICP / 0600	ICP per DIVS	
<b>S/T ZACA 102</b>		Wayne Ferber	26	N	ICP / 0600	ICP per DIVS	
STEN (T)		Joe Young	1	N	ICP / 0600	ICP per DIVS	
7. Control Operations							
Assess point protection for perimeter control.							
8. Special Instructions							
Return all 5 gallon burn mix fuel containers to Drop Points for backhaul, or return them to Supply at Richardson ICP. Backhaul all trash and refuse daily. Sites marked with blue plus red and white striped flagging together should be avoided by dozer. CAFS apparatus: avoid using foam on and adjacent to rock outcrops and rock monoliths.							
9. Division/Group Communication Summary							
Function	Frequency	System	Channel	Function	Frequency	System	Channel
<b>Command</b>	<b>Rx 166.6125 N Tx 168.4000 N Tone 123.0</b>	<b>NIFC C-4</b>	<b>1</b>				
<b>Tactical</b>	<b>173.9625 N</b>	<b>R5-TAC-5</b>	<b>4</b>	Air to Ground	<b>172.8125 N</b>	<b>AIR GND 1</b>	<b>6</b>
Prepared By (Resource Unit Leader)		Approved By (Planning Sect. Ch.)		Date		Time	
Heather Wood		Tim Baal		08/19/2007		2130	

**AIR OPERATIONS SUMMARY** OPERATIONAL PERIOD DATE: 8/20/07 START: 0600 END: 2030 SUNRISE: 0619 SUNSET: 1942

1. INCIDENT NAME: Zaca Fire	2. PREPARED BY: Wes Shook	PREPARED DATE/TIME: 8/19/07 2000	3. # OF COPIES NEEDED:
<b>4. REMARKS (Safety Notes, Hazards, Air Operations Special Equipment, etc.): MEDEVAC A/C: SBC-308</b> Ensure transponders are on 1255 and altitude reporting is on. GPS settings: hddd°mm.mmm' with WGS 84 selected as the map datum. RETARDANT PLANT UP AND AVAILABLE AT CASITAS & RANCHO HELIBASES ALTIMETER SETTINGS TO BE GIVEN BY SMX ATB PRIOR TO 0730 MEETING. CALLED INTO HELIBASES AND F/W BASES <b>Helicopter Managers &amp; ATGS Track where loads are dropped, which Divisions and Amounts.</b>			<b>5. TFR: 7/3838</b> During Daylight 12,000 MSL and below. Night down to 10,000 MSL. Contract FREQ is 136.325

6. PERSONNEL		7. FREQUENCIES		8. FIXED WING	
	Phone		AM	FM	# Avail / Type/ Make-Model / FAA N# / Base(s)
AOBD Live Oak: Wes Shook AOBD Richardson: Belinda McCandliss	805-964-8465 559-288-9276	AIR/AIR FW:		151.2725	AIRTANKERS 4 Seat's 10 Airtankers on Order T-07 / P2V T-55 / P2V
ASGS Live Oak: Darlene Hall ASGS Richardson: John Keese	530-310-3557 805-551-6422	A/A RW South:	136.125		LEADPLANES ASM 31W B5
		A/A RW North:	134.875		
ATGS South: Joel Lane ATGS South: Mike White	559-310-0774 619-672-1638	AIR BRIEFING	136.325		AIR TACTICAL PLATFORMS AA-07, A-29 AA-1ZJ, A-224 AA-13R, A-203 ATGS – Determine if FOX is closer to Incident then Santa Maria
ATGS North: Gus Johnson ATGS North: Boyd Turner ATGS Relief: Kent Haskins	559-708-3570 530-640-0616 661-330-0133	AIR/ GROUND: Live Oak	171.1375		
HEBM Rancho: Steadman, Stratton Helibase Rancho:	760-207-4325	AIR/GROUND: Richardson	172.8125		Santa Maria Air Attack Base Sheryl Woods 805-937-5059 Ext 204 Cell 805-455-5917.
HEBM Richardson: Wayne Cannon/Ramiriz(T)	661-965-8679	DECK Rancho Tac DECK Rancho Log DECK Richardson	163.100 168.550 163.100		
HEBM Heavy Casitas: N34°25.319 x W119°21.020 FAX:	805-649-8918 805-649-8917	DECK Heavy	168.350		Special Instruction Victorville 760-246-3127
ICP Air Fax Dispatch	805-967-2137 805-961-5727	TOLC Rancho TOLC Richardson TOLC Casitas	136.075		
HLCO: Tony Duprey HLCO: Stan Kubota		COMMAND:	See IAP Communications Plan		Web address for Aviation Map <a href="ftp://ftp.nifc.gov/Incident_Specific_Data/CALIF_S/2007/2007_Zaca/GIS/PRODUCTS">ftp://ftp.nifc.gov/Incident_Specific_Data/CALIF_S/2007/2007_Zaca/GIS/PRODUCTS</a> Click on Incident Date: ie 20070820
TORCH BASE – Bill Lambert,	530-598-4128	Air Guard	168.6250		

**9. HELICOPTERS (Use Additional Sheets as Necessary)**

FAA N#	TY	MAKE/MODEL	BASE	AVAIL	START	REMARKS	FAA N#	TY	MAKE/MODEL	BASE	AVAIL	START	REMARKS
HT-762	I	S-61 Tanked	Heavy	0700	0730	USFS / A-14	H-69J	I	Bell 214 - Tanked	Heavy	0700	0730	
H-43T	I	S-61 Bucket	Heavy	0700	0730	USFS / A-17	H-821	I	UH-60 Bucket	Heavy	0700	0730	CNG / A-271
H-4CH	I	B-107 Bucket	Heavy	0700	0730	USFS / A-11	H-835	I	UH-60 Bucket	Heavy	0700	0730	CNG / A-333

H-308	II	Bell 205	Rancho	0700	0730	SBC / A-21	H-527	II	Bell 212	Rancho	0700	0730	USFS /A-23
H-502	II	Bell 212	Rancho	0700	0730	USFS / A-247	H-528	II	Bell 212 HP	Rancho	0700	0730	USFS / A-88
H-517	II	Bell 212	Rancho	0700	0730	USFS A-322	H-538	II	Bell 212 HP	Rancho	0700	0730	USFS / A-126
H-1109	III	LAMA	Rancho	0700	0730	CWN / A-160	H-507	III	Cobra HLCO	Rancho	0700	0730	USFS / A-364
H-68X	III	Bell B-3	Rancho	0700	0730	CWN / A-275	H-509	III	Cobra IR	Rancho	0700	0730	USFS / A-10,000
H-2EA	III	Bell B-3 IR	Rancho	0730	0730	CWN / A-57							
<b>RICHARDSON HELIBASE</b>													
H-917	I	S-61 Bucket	Richard	0800	0830	A-13	H-553	III	Bell B-3	Richard	0700	0730	CWN / A-268
H-554	II	Bell 205	Richard	0700	0730	BLM / A-237	H-525	III	A-Star B-3	Richard	0700	0730	USFS / A-259
H-530	II	Bell 212	Richard	0700	0730	USFS / A-24	H-88B	III	Bell 206L4	Richard	0700	0730	CWN / A-204

**10. TASK/MISSION/ASSIGNMENT (Use ICS-220a if additional space needed; Type/Function includes: Air Tactical, Retardant, Recon, Personnel Transport, Water Dropping, etc.)**

TYPE/FUNCTION	NAME OF PERSONNEL OR CARGO (if applicable) OR INSTRUCTIONS FOR TACTICAL AIRCRAFT	MISSION START	FLY FROM	FLY TO
<b>LIVE OAK</b>				
<b>Recon</b>	Please request missions thru Helibase	0900	RANCHO	
<b>Water drops/Retard.</b>	Priorities Division VV / Division ZZ / Division UU     3 Type 1's Available for Burn Support	0700	CASITAS	
<b>Helispot Construction</b>				
<b>Firing</b>	Under direction of firing group. The use of VNC Ship for Helitorch	0630	ROMERO	
<b>Rappel</b>				
<b>Logistics</b>				
<b>Personnel Transport</b>	Fly crews into Olgivy Ranch / SB County Crews / Total – 4 Crews 80+	0800	RANCO	OLGIVY

<b>RICHARDSON</b>				
<b>Recon</b>	Recons as requested and HLCO			
<b>Water Drops/Retard.</b>	As requested and in support of Firing operations			
<b>Helispot Construction</b>				
<b>Firing</b>	PSD /Helitorch Operations			
<b>Personnel Transport</b>				
<b>Logistics</b>				

All aviation modules/resources are to check in with the Planning Section and Time Unit Leader when assigned to the incident. Crew Time Reports are to be completed daily and signed by the appropriate supervisor. Aviation modules shall ensure that all personnel not assigned to positions in the aviation organization or required for module management are readily available for line assignment. Trainees for either aviation or line positions shall be identified to the Air Support Group Supervisor to maximize training opportunities on the incident.

Upon full activation of the Incident Base Camp, Aviation Modules shall use government provided facilities, when travel does not exceed travel local in nature [standard shall be 30 minutes travel time, aviation facility to Base Camp]. The procurement of motel rooms or meals is not authorized by the government as stated in the travel regulations unless prior approval is requested in writing and signed by the Incident Commander. The use of government travel cards to procure such services is illegal.

Full compliance of established safety standards as outlined in the variety of agency aviation guides shall be adhered to by aviation personnel.

INCIDENT RADIO COMMUNICATIONS PLAN  <u>GROUP 13</u>			Incident Name  <b>ZACA RICHARDSON ZONE</b>			Date/Time Prepared <b>AUG 19, 2007 21:00</b>			Operational Period Date/Time <b>AUGUST 20, 2007 0600-1800</b>		
Ch #	Function	Channel Name/Trunked Radio System Talkgroup	Assignment	RX Freq N or W	RX Tone	TX Freq N or W	Tx Tone	Mode	Remarks		
1	COMMAND	NIFC C-4	Richardson Zone EAST	166.6125 N		168.4000 N	123.0	A	NORTHEAST SIDE CUYAMA PK TONE ON TX 123.00		
2	COMMAND	NIFC C-2	Richardson Zone WEST	168.1000 N		170.4500 N	123.0	A	WEST SIDE McPherson Pk		
3	TACTICAL	R5-TAC-4	DIV CC, FF North, Ozena Group	173.9125 N		173.9125 N		A			
4	TACTICAL	R5-TAC-5	DIV DD, FF South, HWY 33	173.9625 N		173.9625 N		A			
5	TACTICAL	R5-TAC-6	DIV AA, BB, EE	173.9875 N		173.9875 N		A			
6	AIR GROUND 1	AIR GND 1	Richardson Zone	172.8125 N		172.8125 N		A			
7	COMMAND	NIFC C-12	Richardson Zone SOUTH	173.0375 N		167.3250N	123.0	A	SOUTHEAST SIDE MONTE ARIDO PEAK - TONE 123.0 TX		
8	TACTICAL	TAC 1	DIV HH, GG	168.0500 N		168.0500 N		A			
9	TACTICAL	BURN TAC	FIRING OPS	172.2750 N		172.2750 N		A	<b>FIRING OPS</b>		
10	AIR GROUND BURN	BURN A/G	FIRING OPS	172.6125 N		172.6125 N		A	<b>FIRING OPS</b>		
11	COMMAND	NIFC C-9	Richardson Zone REYES	170.0125 N		165.2500 N	123.0	A	EAST SIDE REYES PEAK		
12											
13	EMS TAC	CALCORD	ALL DIVISIONS	156.0750 W		156.0750 W		A	As needed.		
14	EMERGENCY	AIR GUARD	ALL DIVISIONS	168.6250 N		168.6250 N	110.9	A	Urgent Aircraft Contact (14CH.HT)		
15	EMS TAC	CALCORD	ALL DIVISIONS	156.0750 W		156.0750 W		A	As needed.		
16	EMERGENCY	AIR GUARD	ALL DIVISIONS	168.6250 N		168.6250 N	110.9	A	Urgent Aircraft Contact (16CH.HT)		
5. Prepared by (Communications Unit) Hern Crane, COML											

<b>MEDICAL PLAN</b>	1. INCIDENT NAME	2. DATE PREPARED	3. TIME PREPARED	4. OPERATIONAL PERIOD
	<b>Zaca Richardson Zone</b>	8/19/2007	2100	8/20 Day 0600-1800

5. INCIDENT MEDICAL AID STATIONS			
MEDICAL AID STATIONS	LOCATION	PARAMEDICS	
		YES	NO
Richardson ICP	HWY 166 New Cuyama	XX	

6. TRANSPORTATION				
NAME	ADDRESS	PHONE	PARAMEDICS	
			YES	NO
AMR Ambulance Medic 49 Incident Ambulance (1fire line qualified EMT)	Reyes Ranch/ Santa Barbara Canyon	661-766-2192 805-692-5723	XX	
Life Line Medic 504	Ozena Spike Camp	661-766-2192	XX	
AMR Ambulance Medic 493	Richardson ICP	661-766-2192	XX	
Santa Barbara Co H-308 ALS, Hoist, Night Vision	Rancho Helibase-Day Figueroa Fire Station- Night	805-967-6832 805-692-5723	XX	
Ventura County Air Squad 9 ALS, Hoist Closest to Branch XXVII, Ozena Camp	Camarillo Airport	805-388-4294	XX	
Cal Star Air Ambulance	Santa Maria Airport	805-546-1915	XX	
Kern County Fire H-408 BLS, Hoist, Night Vision	Keene	661-861-2521		XX
CHP H-70 ALS, Hoist	San Louis Obispo	805-593-3344	XX	

7. HOSPITALS								
NAME	ADDRESS	TRAVEL TIME		PHONE	HELIPAD		BURN CENTER	
		AIR	GRND		YES	NO	YES	NO
<b>Marian Medical Center</b>	1400 E Church Santa Maria	35 min	1.5hrs	805-739-3200	XX			XX
<b>Kern Medical Center (Level 2 Trauma Center)</b>	1830 Flower Bakersfield	35 min	1.5 hrs	661-326-5154	XX			XX
<b>Grossman Burn Center</b>	4929 Van Nuys Blvd Sherman Oaks	1.5 hrs	3 hrs	818-907-4580	XX		XX	
<b>Ventura County Medical Center</b>	3291 Loma Vista Ventura	50 min	2 hrs	805-652-6165	XX			XX

8. MEDICAL EMERGENCY PROCEDURES	
<ul style="list-style-type: none"> <li>In the event of a line medical incident, initiate care with available resources and notify Division Supervisor.</li> <li>The Division Supervisor and/or Line SOF shall determine if the injury can be handled with available resources and recommend the most appropriate method of transportation (Air/Ground).</li> <li>For serious or life threatening injuries, the Division Supervisor and or Branch Director shall contact the communications unit to advise the nature and location of the incident and request appropriate additional resources.</li> <li>The communications unit shall limit all non essential traffic on command by declaring a "Medical Emergency" and shall then notify the Medical Unit, Safety Officer, and Operations Section Chief of the incident.</li> <li>The Division Supervisor shall coordinate the incident and direct necessary actions.</li> </ul>	<p>√</p> <p><input type="checkbox"/> Patient 1 of _____</p> <p><input type="checkbox"/> Emergency _____ Non Emergency _____</p> <p><input type="checkbox"/> Is a helicopter required for transportation? Yes _____ No _____</p> <p><input type="checkbox"/> Location _____</p> <p>Lat _____ Long _____</p> <p><input type="checkbox"/> Age _____ Sex _____ Weight _____</p> <p><input type="checkbox"/> Severity: Minor _____ Delayed _____</p> <p>Immediate _____</p> <p><input type="checkbox"/> Chief Complaint _____</p> <p><input type="checkbox"/> Any additional resources required _____</p>

<b>ICS 206</b>	9. PREPARED BY (MEDICAL UNIT LEADER) <b>Robert Russell MEDL</b>	10. REVIEWED BY (SAFETY OFFICER) <b>Marty Hamel SOF1</b>
----------------	--	---





# **ZACA – ROBERTSON ZONE SAFETY MESSAGE August 20, 2007**

## **ON THE ZACA INCIDENT EVERYONE IS EXPECTED TO.....**

- \* Obey ALL standard fire fighting orders!
- \* Use ALL personal protective equipment appropriate to your job!
- \* Rest 1 hour (off shift) for every 2 hours of work!
- \* Report unsafe or unhealthy work conditions to your supervisor!

...AND follow these L.C.E.S. practices:

### **LOOKOUTS**

- Lookout for unsafe work conditions...continue work only when the hazard has been eliminated, minimized or avoided.
- Division Supervisors must assure retardant and water drop zones are clear of firefighters and heavy equipment.
- All drivers must drive with headlights on and use a lookout when backing!!!!

### **COMMUNICATIONS**

- Supervisors must know, and be known by, their immediate subordinates, including contractors.
- Supervisors must brief subordinates prior to beginning work each shift. Review job site hazards (including driving to/from work site) and identify actions to eliminate, minimize or avoid hazards. Additional safety briefings are suggested when significant work conditions change, an unforeseen hazard becomes known, or a significant "close-call" occurs.
- All fireline overhead (crew bosses and above) shall have an incident radio {minimum of one incident radio per crew (two incident radios are preferred)}. Radio contact must be assured and maintained for all fireline operations!

### **ESCAPE ROUTES**

- Fireline Supervisors: Assure escape routes are identified, accessible and known to those who may need them.
- ALL Drivers: Yield a full lane to on-coming traffic; keep vehicle windshields clean and mirrors adjusted.
- ALL Drivers: Obey speed limits; switch drivers or take a 5 minute break every hour; park vehicles for easy access and escape.

### **SAFETY ZONES**

- Fireline supervisors must assure safety zones are identified, clear of hazards and marked for those who may need them.
- Falling Bosses, Sawyers and Fireline Supervisors must assure tree felling operations are conducted a minimum of 2 1/2 tree lengths from other workers (swamper is allowed to accompany faller).
- In addition to hardhat, leather gloves and boots, nomex clothing, safety eyewear and fire shelter, Sawyers must wear hearing protection and full length sawing chaps .... Pump/Engine Operators must wear hearing protection!
- All drivers are to: 1) Keep vehicle operator space clean and vehicle beds tidy; 2) Secure loose items that could harm people; and 3) "Chock" vehicle wheel when parking on an incline.
- Always be ALERT to "changing or changed conditions" and PLAN for "unexpected events"!!

INCIDENT ACTION PLAN SAFETY ANALYSIS				Incident: ZACA (RICHARDSON)				Day Shift 08/20/2007 0600 - 1800								
LCES Analysis of Tactical Operations Lookouts, Communications, Escape Routes, Safety Zones								OTHER RISK ANALYSIS								
Division Group	Indirect Fireline	Downhill Line	Anchor Point	Areal Ignition	Extreme Fire Behavior	Firing operations	Slope-wind Alignment	Unburned Area	LCES Mitigations	Masticator / Chipper	Driving Hazards	Communications	Structure Protection	Hydration	Multiple Aircraft	Other Risk Mitigations
Branch XXV BB	X	X	X		X			X	Thorough briefings, situational awareness, establish LCES, follow 10 Std, mitigate 18, down-hill checklist, monitor WX & indicators of extreme fire behavior,		X			X	X	Establish positive commo, aircraft safety, foot travel & driving safety, hydration, crew accountability, stay clear of dozers,
CC DD	X			X	X		X	X	Thorough briefings, situational awareness, establish LCES, follow 10 Std, mitigate 18, monitor WX & indicators of extreme fire behavior, follow lighting plan		X			X	X	Establish positive commo, aircraft safety, foot travel & driving safety, hydration, crew accountability, keep ground personnel away from aerial ignitions,
CAFS Grp Firing Grp	X				X	X		X	Thorough briefings, situational awareness, establish LCES, follow 10 Std, mitigate 18, monitor WX & indicators of extreme fire behavior, follow lighting plan		X			X	X	Establish positive commo, aircraft safety, foot travel & driving safety, hydration, crew accountability, stay clear of dozers,
EE	X			X	X		X	X	Thorough briefings, situational awareness, establish LCES, follow 10 Std, mitigate 18, monitor WX, fire behavior, & indicators of severe fire behavior, firing,		X			X	X	Establish positive commo, foot travel & driving safety, hydration, crew accountability, keep ground personnel away from aerial ignitions,
Contingency Branch																
Hwy33Grp OzenaGrp					X		X	X	Thorough briefings, situational awareness, establish LCES, follow 10 Std, mitigate 18, monitor WX, fire behavior, & indicators of extreme fire behavior		X	X	X	X		Establish positive commo, aircraft safety, foot travel & driving safety, hydration, crew accountability, utilize Structure Assessment Checklist (IRPG p.14), follow Structure Protection Guidelines (IRPG p. 16). Review Hazmat Checklist (IRPG p. 26),
Branch XXVII FF North	X			X	X	X		X	Thorough briefings, situational awareness, establish LCES, follow 10 Std, mitigate 18, monitor WX, fire behavior, & indicators of extreme fire behavior, follow firing plan,		X	X		X	X	Establish positive commo, foot travel & driving safety, hydration, crew accountability, stay clear of dozers, keep ground personnel away from aerial ignitions,
FF South	X			X	X				Thorough briefings, situational awareness, establish LCES, follow 10 Std, mitigate 18, monitor WX, fire behavior, & indicators of extreme fire behavior, follow firing plan,		X	X			X	Establish positive commo, foot travel & driving safety, hydration, crew accountability, stay clear of dozers, keep ground personnel away from aerial ignitions,
GG HH	X	X		X	X	X	X	X	Thorough briefings, situational awareness, establish LCES, follow 10 Std, mitigate 18, monitor WX, fire behavior, & indicators of extreme fire behavior, follow firing plan,		X	X		X	X	Establish positive commo, foot travel & driving safety, hydration, crew accountability, stay clear of dozers

Prepared By: **Marty Hamel, Safety Officer**

Date and Time: **08/19/2007, 1700**



## Human Resource Message

Zaca II 08202007

Hi! My name is Diane Simpson, and I am the Human Resource Specialist (HRSP) assigned to this incident. I am here to help ensure a positive work environment for everyone involved with this incident.

I will be available at the ICP daily between 1200 and 2100 and am willing to listen to any concern or comment you may have. If I am unable to help.....I will do my best to find someone who can. If you need to speak with an HRSP outside of these times please see Tim Sexton, Deputy IC or call me on my cell phone at 618-534-2111.

I am located in the trailer across from Check-In.

If there is anything I can assist you with, please do not hesitate to contact me.



Incident Human Resource Specialist is: Diane Simpson, Tim Sexton  
Location: Trailer across from Check-in

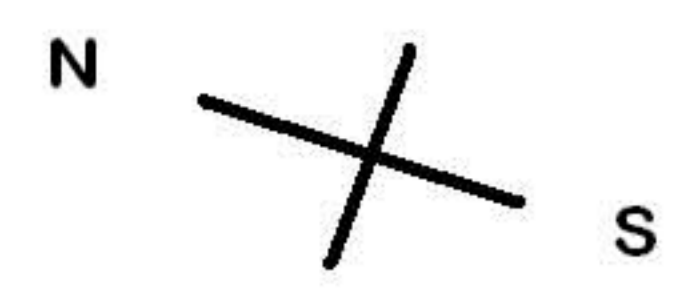

# OZENA SPIKE CAMP

8-18-07

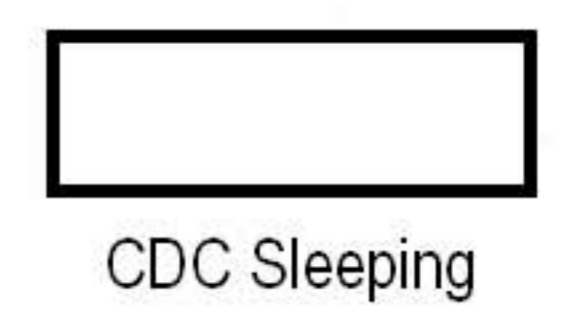

Sleeping Area

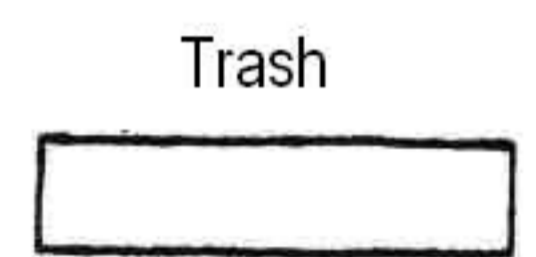
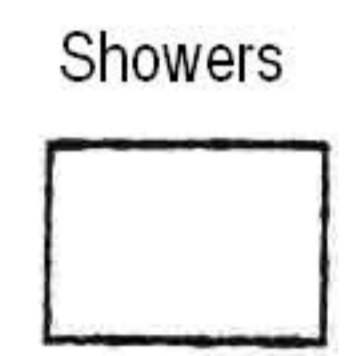
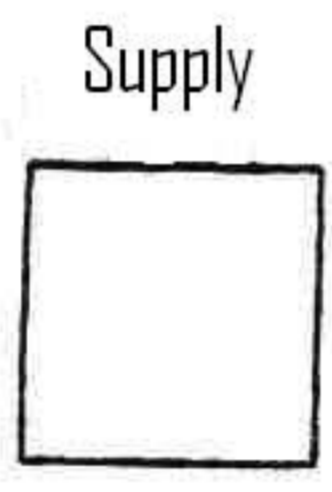
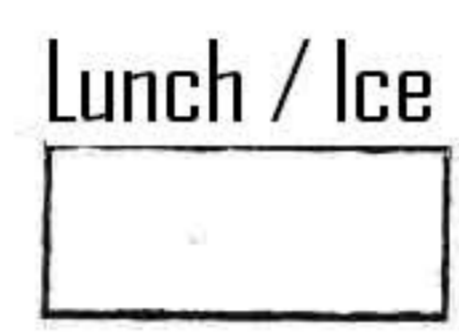

Parking

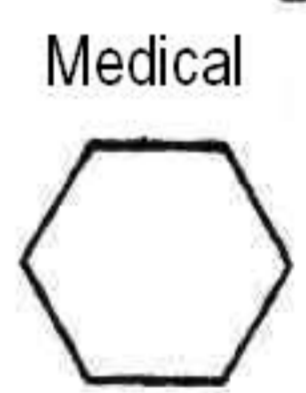
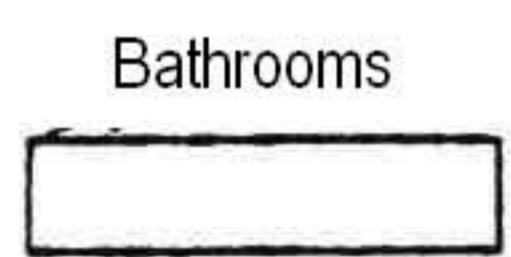

Dining Area

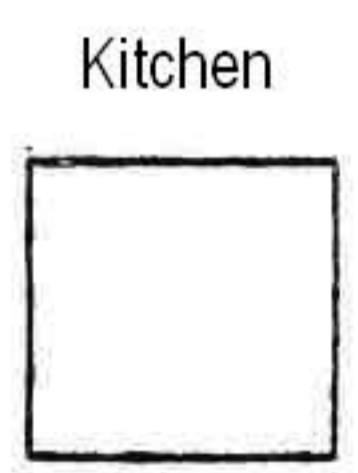

Facilities Map  
Not to Scale  
8-18-07

EXIT

ENTRANCE



Do Not Enter

← 166

Hwy 33

Ventura →

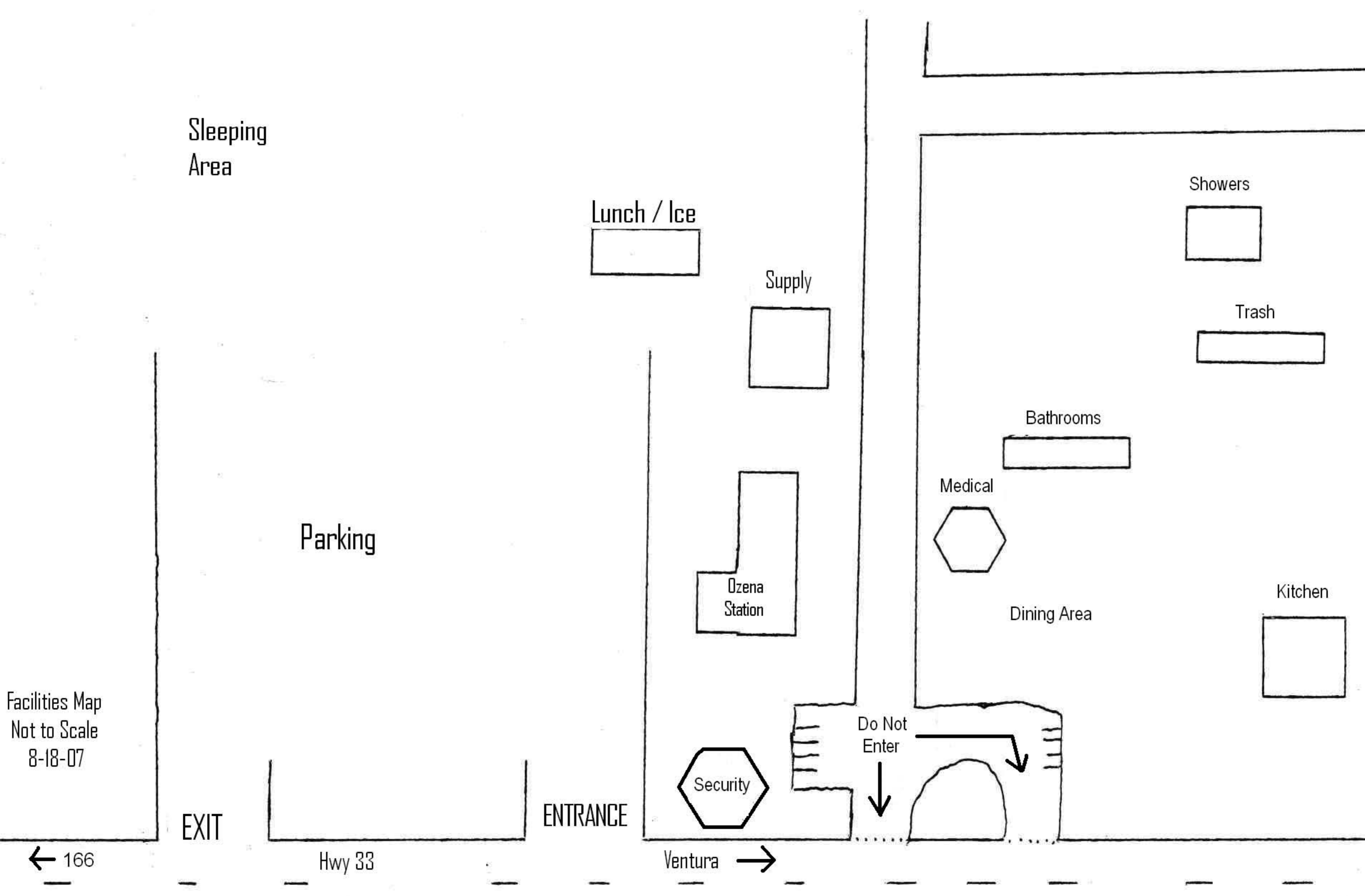

# ZACA II BASE CAMP

HWY 166

MAIN  
ENTRANCE

GROUND  
SUPPORT

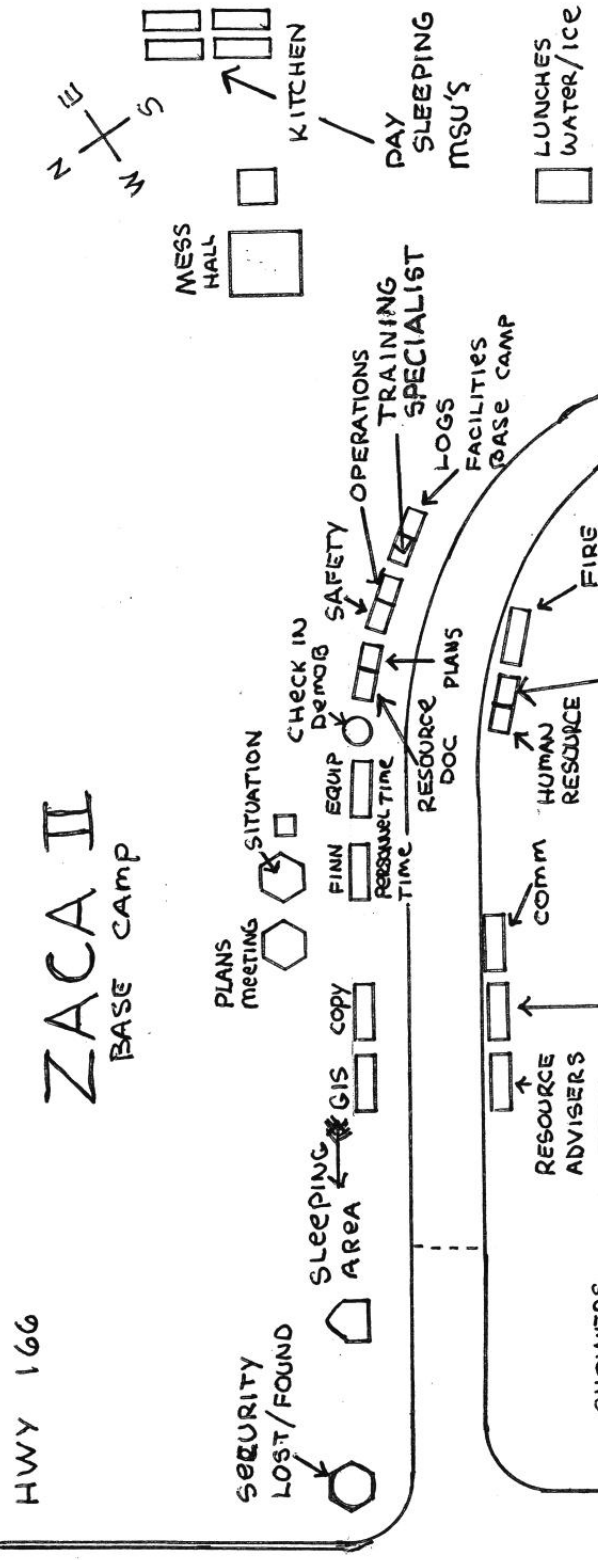

FACILITIES MAP  
NOT TO SCALE  
YURT TENT  
JLP 8-12-07

ENTRANCE

FUEL DEPOT

N 34° 56' 48.0"  
W 119° 41' 05.4"

# ZACA II

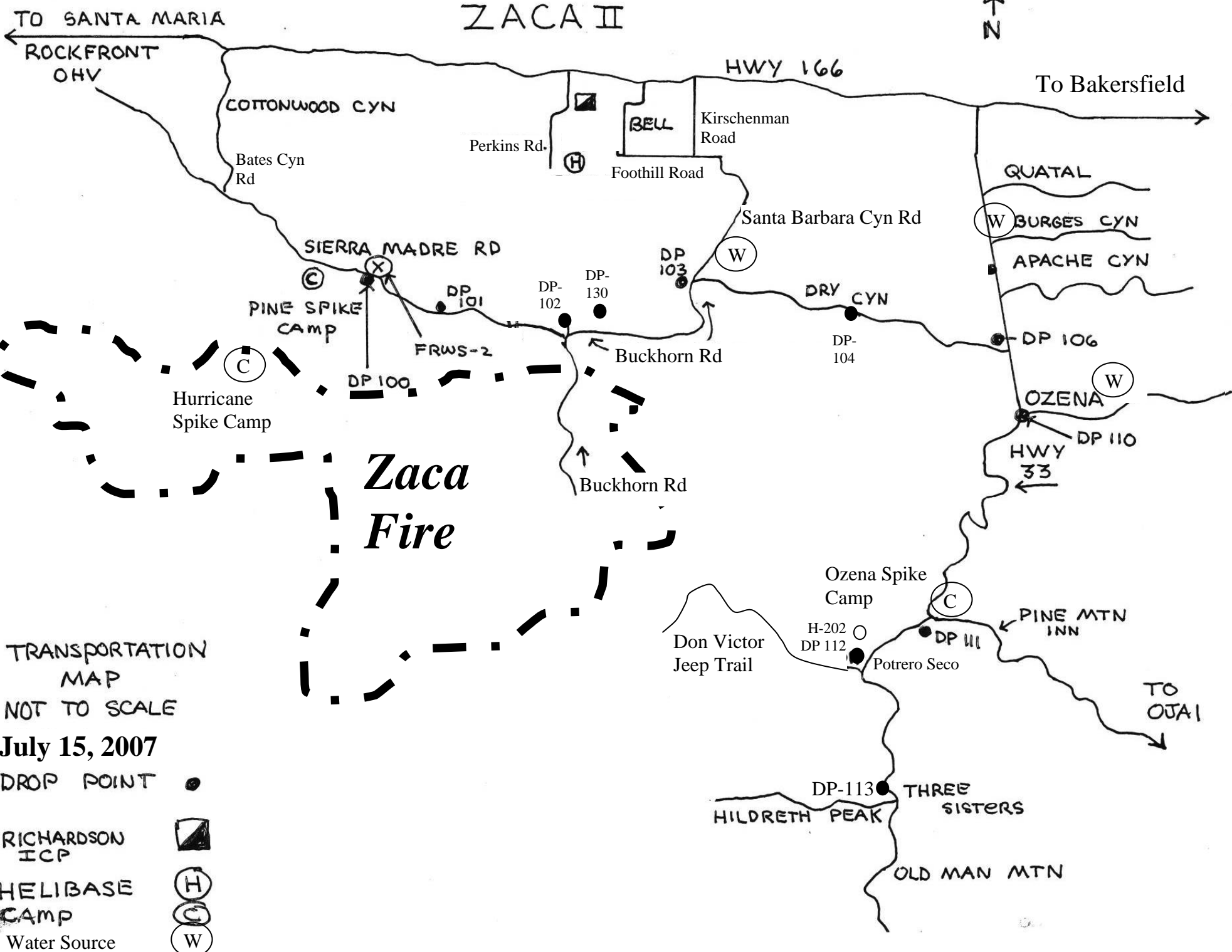

TRANSPORTATION  
MAP  
NOT TO SCALE

July 15, 2007

- DROP POINT ●
- RICHARDSON ICP
- HELIBASE CAMP
- Water Source

**Zaca Fire Richardson Camp Phone List  
as of 08/18/2007 at 2023**

<b>IC</b> Mike Dietrich (IC) Tim Sexton (DPIC)	<b>661-766-2026</b> c909-228-5241 c208-861-5043	<b>Demob</b> Demob Fax Robert Hawkins	<b>661-766-2728</b> <b>661-766-2718</b>
<b>Operations</b> Don Will (OSC1) Tom Hatcher (OSC1) Les Curtis (NOPS) Bobby Shindelar (OPBD) Keith Gurrola (OPBD) Don Forsyth (OPBD) Don Smith (OPBD T) Sam Wilbanks (DIVS) Kenny Ellyson (DIVS) Sam Marouk (DIVS) Kim Olson (DIVS) Brian Savage (DIVS) Belinda McCandliss (AOBD) John Keesee (ASGS) Boyd Turner (ATGS)	<b>661-766-2781</b> c530-277-1843 c530-949-4319 c530-310-3506 c209-768-2827 c805-377-1491 c714-504-2632 c909-373-7765 c530-906-2253 c661-878-5313 c559-301-2954 c209-607-5195 c925-519-6338 c559-288-9276 c805-551-6422 c530-640-0616	<b>Situation</b> Glenn Serins (SITL) Ed Lamas (GISS) Kelly Close (FBAN) Jeff Tonkin (IMET) Melody Fountian (READ)	<b>925-519-6301</b> c714-225-6792 c970-222-2634 c240-778-5316 c805-720-5685
<b>Safety</b> Marty Hammel (SOF1) Dave Morton (SOF2)	<b>661-766-2789</b> c661-965-3137 c530-228-7828	<b>Finance</b> Personnel Time Finance Fax Teresa Fork (FSC1) Mary Glenn (COST) Maggie Prochazka (TIME)	<b>661-766-2027</b> <b>661-766-2182</b> <b>661-766-2186</b> c530-941-4226 661-766-2027
<b>Logistics</b> Dana Simpson (LSC1) Hern Crane (Deputy LSC) David Marion (LSC2) William Fouts (FACL) Bruce Ungari (FUDL) Donald Hill (GSUL) Mike Esperanza (EQPM)	<b>661-766-2760</b> c925-519-6326 c760-937-7930 c530-318-9566 c530-410-1776 c530-919-1994 c916-591-9001 c925-872-8574	<b>Cost</b> Procurement/EQTR Byron Brown (PROC)	<b>661-766-2594</b> <b>661-766-2181</b>
<b>Ordering</b> Wallace Grogan (ORDM)	<b>661-766-2648</b> c661-496-7235	<b>Training</b> Rick Alpert (TNSP T)	<b>661-766-2743</b> c213-247-8520
<b>Supply</b> Michael Bradford (SPUL)	<b>661-766-2617</b> c916-759-0191	<b>PIO</b> Leona Rodreick (PIO1 T)	<b>661-766-2906</b> <b>661-766-2908</b> <b>661-766-2910</b> c530-310-3505
<b>Supply Fax</b>	<b>661-766-2627</b>	<b>Medical</b> Robert Russell (MEDL)	<b>661-766-2904</b> c909-855-2855
<b>Plans</b> Tim Baal (PSC1) Roy Dulls (PSC2) Gary Thompson (RESL) David Camp (CTSP)	<b>661-766-2726</b> c805-896-6986 c661-433-0096 c707-980-8079 c661-766-2726	<b>HR</b> Gary Samaha (HRSP)	<b>661-766-2979</b> c404-357-1516
		<b>USFS Union Rep.</b> Dave Crow	c805-748-4434
		<b>OES</b>	<b>661-766-2814</b>
		<b>Law Enforcement</b>	<b>661-766-2863</b>
		<b>Communications Unit</b> Comm. Radios Hern Crane	<b>661-766-2172</b> <b>661-766-2192</b> c760-937-7930
		<b>Comp/Claims</b> Elaine Downing (COMP)	<b>661-766-2730</b>
		<b>Motel</b>	<b>661-766-2613</b>
		<b>Michelle's Copy Service</b> Fax	<b>661-766-2030</b>
		<b>Ozena Fire Station</b>	<b>805-841-0171</b>





**ZACA FIRE**

**LIVE OAK ZONE**

**IAP PARTS**



<b>Division Assignment List</b>			1. Branch <b>IX</b>		2. Division/Group <b>TT</b>		
3. Incident Name <b>ZACATWO</b>			4. Operational Period <b>08/19/07 Sunday 24 Hour Shift 0600 - 0600</b>				
5. <b>Operations Personnel</b>							
Operations Chief		<b>GARY HART</b>		Division/Group Supervisor		<b>BRUCE FOSDIKE / MARK FRITS(t)</b>	
Operations Chief		<b>MARK CHAMBERS</b>		Air Attack Supervisor		<b>WESTLEY SHOOK</b>	
Branch Director		<b>KEN MAFFEI</b>		Safety Officer		<b>BRIAN BULGER</b>	
6. <b>Resources Assigned this Period</b>							
Strike Team/Task Force/ Resource Designator		Leader		Num of Pers.	Trans. Y/N	Drop Off PT./Time	Pick Up PT./Time
HCS4 - BDU S/T 9384G		KEVIN MILLER		38	N	PENDOLA	PENDOLA
HCS4 - BDU S/T 9389G		JOE SHRADER		37	N	"	"
OAK S/T #2		DON WASHINGTON		25	N	"	"
STEN(t)		SHAWN C COMPTON (t)		1	N	"	"
LMP ENGINE 311						"	"
SMR ENGINE 33						"	"
SQF ENGINE 32						"	"
SQF ENGINE 43						"	"
LPF ENGINE 73						"	"
ES3 - XSB S/T 1521C		JOHN AHLMAN / C.MAILES (t)		21	N	"	"
ES3 - XSD S/T 6419C		RICHARD MINNICK		19	N	"	"
SOF2		DONALD STUKEY		1	N	"	"
SOF2		RICHARD LILLARD (t)		1	N	"	"
EMTP		ISRAEL ESTARES		1	N	"	"
EMTB		DAVID MAZAIKA		1	N	"	"
7. Control Operations							
Hold and mop-up on Monte Arido fuel break from Three Sisters to Pendola Jeepway.							
8. Special Instructions							
Crews need to retrun all fuel cans, cargo nets, and swivels.							
9. <b>Division/Group Communications Summary</b>							
Function	Frequency - RX	Frequency - TX	Tone	System	Channel	System	Channel
Command	162.9625N	171.7875N		NIFC	5		La Cumbra Pk.
Tactical Div/Group	170.3625N	170.3625N		NIFC	7		
Logistics							
Air to Ground	171.1375N	171.1375N		NIFC	11		
Prepared by (Resource Unit Leader) Janelle Walker / James Whiteside / Jennifer de Jung			Approved by (Planning Section Chief) Phil Cocker / Nick Dually(t)			Date Prepared 08/18/07	Time Prepared 2205

<b>MEDICAL PLAN</b>		1. INCIDENT NAME <b>ZACA LIVEOAK ZONE</b>		2. DATE PREPARED 8/19/07		3. TIME PREPARED 19:00		4. OPERATIONAL PERIOD 8/20/07 0600-0600					
5. INCIDENT MEDICAL AID STATIONS													
MEDICAL AID STATIONS				LOCATION				PARAMEDICS					
								YES NO					
MEDICAL UNIT				ICP @ LIVE OAK CAMP (805) 967-6430				X					
6. TRANSPORTATION													
A. AMBULANCE SERVICES													
NAME			ADDRESS			PHONE		PARAMEDICS					
								YES NO					
AMR			ZACA ICP			DISPATCH THRU MEDICAL UNIT		X					
SBC H-308 Hoist Capable/ Night Vision/ALS -24/7			Rancho Helibase-Day Gibraltar Dam-Night			(805)692-5723		X					
CAL STAR			Santa Maria Airport			(805)546-1915		X					
7. HOSPITALS													
NAME		ADDRESS		TRAVEL TIME		PHONE		Trauma		HELIPAD		BURN CENTER	
				AIR GRND				Yes No		YES NO		YES NO	
Santa Barbara Cottage Hospital		Pueblo at Bath, in Santa Barbara (Level II Trauma Ctr.)		N/A 25		(805)682-7111		X		X		X	
Goleta Valley Hospital		351 S. Patterson Ave. Goleta LAT: 34.26.02 LONG: 119.48.31 (Level III Trauma Ctr.)		10 25		(805)967-3411		X		X		X	
Marian Medical Center		1400 E. Church, Santa Maria LAT: 35.0.6 LONG: 120.17.9		15 1 HR		(805)739-3200		X		X		X	
Santa Ynez Valley Hospital		700 Alamo Pintado Solvang		30		(805)686-3989		X		X		X	
Buellton Medical Clinic		185 West Hwy 246 #102 Buellton		30		(805)686-8555		X		X		X	
Grossman Burn Center		4929 Van Nuys Blvd. Sherman Oaks		1 HR		(805)907-4580		X		X		X	
8. MEDICAL EMERGENCY PROCEDURES													
<b>LINE EMERGENCY:</b> Crew Supervisor to contact DIVS with patient complaint/condition and location. 1) DIVS contacts: • Line EMT • Communications Unit • Operations / Branch 2) On scene EMT or Medical Unit Leader decides mode of transportation required. 3) Communications Unit contacts: • Helibase for AIR EVAC only • Medical Unit • Safety 4) Helibase makes decision for type of helicopter needed for AIR EVAC 5) Operations will manage medical emergency with input from Medical Unit				<b>CAMP EMERGENCY:</b> Contact Medical Unit with patient complaint/condition and location. Medical Staff will respond to stabilize incident: • Medical Unit contacts: • Communications • Safety • Logistics • Operations • Crew Supervisor				<b>TRIAGE CONSIDERATIONS (S.T.A.R.T)</b>  Respirations: Over 30/ Under 12 = <b>Immediate</b>  Capillary Refill Over 2 seconds = <b>Immediate</b>  Mental Status Disoriented = <b>Immediate</b>  <b>Immediate = Air Evac if possible</b>					
9. PREPARED BY (MEDICAL UNIT LEADER) Eric Williams MEDL							10. REVIEWED BY (SAFETY OFFICER) Brian Bulger SOF1						

