

Bureau of Land Management, Esri, Garmin, GEBCO, IGN, Intermap, Inc., Swire, NOAA, USGS, FEMA

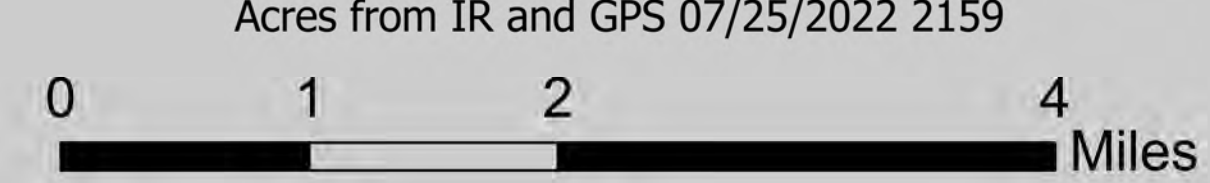

**1773 est. acres**  
Acres from IR and GPS 07/25/2022 2159



Point	Value at Risk
Drop Point	Needs Approval
Camp	Unchecked
Lookout	Proposed
Fire Cache	Other
Shelter	Other
Contaminated Area	Other
Wildlife Only Site	Other

