

Incident	Point Type	Label	Latitude	Longitude
Trail Creek Dip Site	Dip Site		45° 37.282' N	113° 57.968' W
Trail Creek Dip Site	Dip Site		45° 33.122' N	113° 48.296' W
Trail Creek Dip Site	Dip Site		45° 33.669' N	113° 52.024' W
Trail Creek Dip Site	Dip Site	Hansen Dip	45° 37.567' N	113° 58.017' W
Trail Creek Drop Point	Drop Point	31	45° 37.404' N	113° 40.761' W
Trail Creek Drop Point	Drop Point	32	45° 36.242' N	113° 41.013' W
Trail Creek Drop Point	Drop Point	33	45° 35.835' N	113° 40.912' W
Trail Creek Drop Point	Drop Point	34	45° 33.162' N	113° 43.387' W
Trail Creek Drop Point	Drop Point	41	45° 38.611' N	113° 39.192' W
Trail Creek Drop Point	Drop Point	44	45° 29.373' N	113° 58.149' W
Trail Creek Drop Point	Drop Point	48	45° 33.831' N	113° 51.254' W
Trail Creek Drop Point	Drop Point	51	45° 41.896' N	113° 54.158' W
Trail Creek Drop Point	Drop Point	52	45° 40.313' N	113° 55.840' W
Trail Creek Drop Point	Drop Point	53	45° 37.381' N	113° 54.350' W
Trail Creek Drop Point	Drop Point	56	45° 32.975' N	113° 55.724' W
Trail Creek Drop Point	Drop Point	57	45° 32.852' N	113° 55.841' W
Trail Creek Drop Point	Drop Point	67	45° 32.609' N	113° 44.741' W
Trail Creek Drop Point	Drop Point	T30	45° 38.253' N	113° 40.794' W
Trail Creek Drop Point	Drop Point	T40	45° 38.437' N	113° 38.614' W
Trail Creek Drop Point	Drop Point	T50	45° 40.868' N	113° 50.051' W
Trail Creek Hazard	Hazard		45° 32.169' N	113° 56.043' W
Trail Creek Hazard	Hazard	Hornet Hive	45° 38.932' N	113° 54.099' W
Trail Creek Helispot	Helispot	1	45° 42.848' N	113° 52.553' W
Trail Creek Helispot	Helispot	2	45° 40.783' N	113° 49.968' W
Trail Creek Helispot	Helispot	3	45° 39.866' N	113° 49.191' W
Trail Creek Helispot	Helispot	30	45° 36.712' N	113° 49.839' W
Trail Creek Helispot	Helispot	31	45° 36.602' N	113° 50.044' W
Trail Creek Helispot	Helispot	32	45° 36.740' N	113° 50.583' W
Trail Creek Helispot	Helispot	33	45° 35.523' N	113° 41.382' W
Trail Creek Helispot	Helispot	36	45° 32.894' N	113° 43.971' W
Trail Creek Helispot	Helispot	4	45° 39.050' N	113° 46.981' W
Trail Creek Helispot	Helispot	41	45° 40.753' N	113° 38.650' W
Trail Creek Helispot	Helispot	5	45° 41.477' N	113° 57.157' W
Trail Creek Helispot	Helispot	53	45° 36.741' N	113° 55.946' W
Trail Creek Helispot	Helispot	54	45° 35.859' N	113° 56.369' W
Trail Creek Helispot	Helispot	6	45° 38.544' N	113° 49.410' W
Trail Creek Helispot	Helispot	7	45° 37.287' N	113° 51.437' W
Trail Creek Helispot	Helispot	8	45° 40.286' N	113° 52.043' W
Trail Creek Helispot	Helispot	9	45° 41.294' N	113° 56.150' W
Trail Creek Helispot	Helispot	T10	45° 39.376' N	113° 54.851' W
Trail Creek Lookout	Lookout		45° 41.165' N	113° 45.416' W
Trail Creek Lookout	Lookout		45° 36.740' N	113° 41.464' W
Trail Creek Lookout	Lookout		45° 33.910' N	113° 50.020' W
Trail Creek Lookout	Lookout		45° 36.816' N	113° 39.644' W
Trail Creek Lookout	Lookout		45° 32.009' N	113° 49.652' W
Trail Creek Repeater	Repeater		45° 37.593' N	113° 42.493' W
Trail Creek Repeater	Repeater	CMD 10	45° 32.990' N	113° 58.817' W
Trail Creek Repeater	Repeater	CMD 9	45° 42.222' N	113° 58.158' W
Trail Creek Repeater	Repeater	Stein Mountain	45° 27.545' N	113° 52.841' W
Trail Creek Repeater	Repeater	Teepee Point	45° 55.995' N	113° 44.484' W
Trail Creek Repeater	Repeater	Tie Creek	45° 42.540' N	113° 44.322' W
Trail Creek Sling Site	Sling Site		45° 37.340' N	113° 52.092' W
Trail Creek Water Source	Water Source		45° 36.319' N	113° 41.108' W

Alder Creek, Trail Creek, Christensen, Black Mountain Transportation Map
 Alder Creek 14,066 Acres
 Christensen 11,089 Acres
 Trail Creek 39,243 Acres
 Black Mountain 1,042 Acres
 NAD 1983 UTM Zone 12N
 Map Created 8/25/2021 11:51 by MR Team 5
 Day Operational Period 8/24/2021

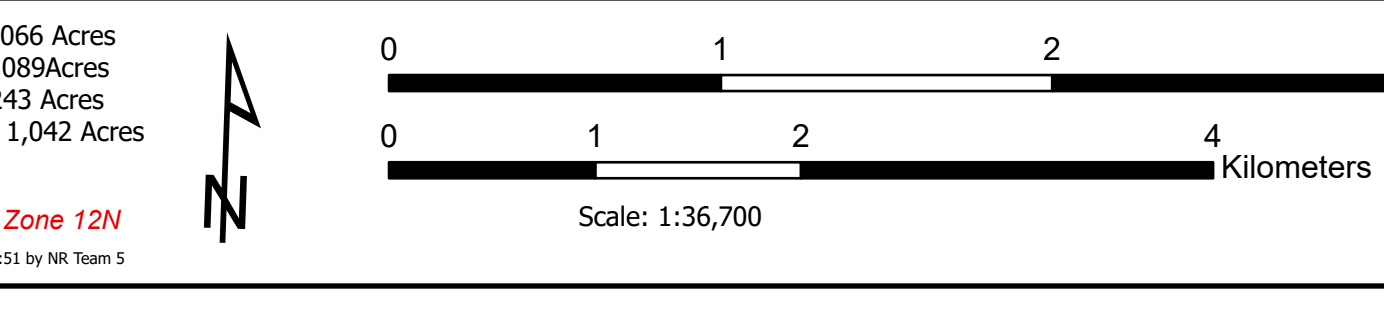

- Helispot
- Division Break
- Drop Point
- Camp
- Staging Area
- Lookout
- Gate
- Fire Station
- Bridge
- Mobile Weather Unit
- Repeater
- Water Source
- Fire Edge
- Contained Line
- Other
- Wildfire Daily Fire Perimeter
- State Boundary

