

Line Type	Repair Status (miles)				TOTAL	Percent Complete
	Completed - Inspected	In Progress	Repair Needed	Unknown		
Access or Improved Road	6.13		0.57		6.70	91%
Completed Dozer Line	2.99		7.95		10.94	27%
Completed Fuel Break	17.32		12.08	0.09	29.49	59%
Completed Hand Line	5.47		10.35	0.12	15.93	34%
Completed Mixed Construction Line			1.00	0.55	1.56	0%
Completed Road as Line	0.35		5.90	0.06	6.32	6%
Fence	0.59		1.64		2.24	27%
Repair Line	0.36		8.06	0.43	8.85	4%
Road Repair	0.03	2.15	7.37	4.01	13.57	0%
<b>Grand Total</b>	<b>33.25</b>	<b>2.15</b>	<b>54.93</b>	<b>5.27</b>	<b>95.60</b>	<b>35%</b>

# SUPPRESSION REPAIR

10/2/2021

**Trail Creek**  
**MTBDF-006272**  
 Trail Creek GIS Area 01, 980  
 09/30/2021 2:25Z MDJ  
 Acres from TR

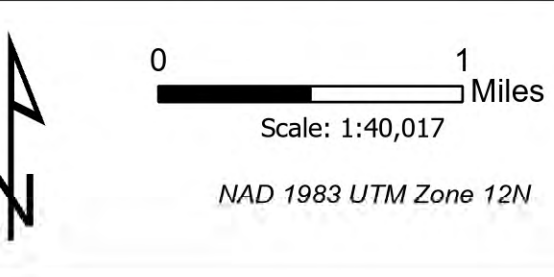

- Dip Site
- Camp
- Bridge
- Landing or Log Deck
- Water Source
- Helispot
- Staging Area
- Water Development or Draft Site
- Completed Dozer Line
- Sling Site
- Stream Crossing
- Culvert
- Fence - Cut/Damaged
- Completed Fuel Break
- Unimproved Landing Area
- Other
- Road Repair
- Clean Up Area
- Safety Zone
- Gate
- Repair Point
- H - Completed Hand Line
- M - Completed Mixed Construction Line
- R - Completed Road as Line
- Repair Status Line
- Access or Improved Road
- Completed - Inspected
- In Progress
- Repair Needed
- Unknown

