

# Branch I

Div Z

Div T

KOONENAI NATIONAL FOREST

Government

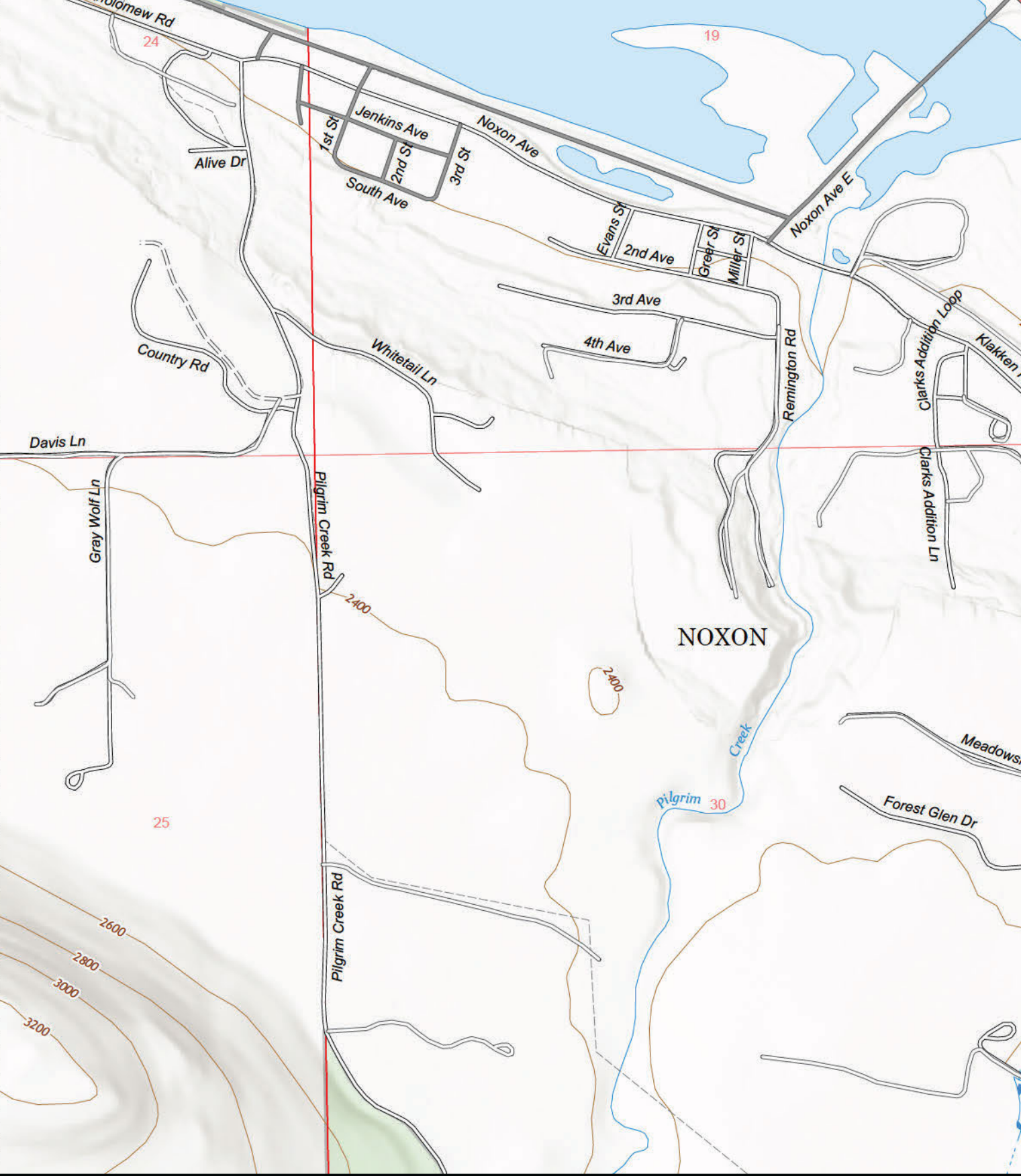

- |                         |                         |                    |                     |
|-------------------------|-------------------------|--------------------|---------------------|
| Helispot                | IR Scattered Heat       | Uncontained        | Wildfire Perimeter  |
| Division Break          | Completed Dozer Line    | Federal Wilderness | Forest Service Land |
| Drop Point              | Completed Fuel Break    | Gravel Road        | Dirt Road           |
| Staging Area            | Completed Hand Line     | Unimproved Road    | USFS Roads Closed   |
| Lookout                 | Planned Dozer Line      | Planned Fuel Break | State Primary Route |
| Other                   | Access or Improved Road | Other              |                     |
| Gate                    |                         |                    |                     |
| Bridge                  |                         |                    |                     |
| Mobile Weather Unit     |                         |                    |                     |
| Repeater                |                         |                    |                     |
| Hazard                  |                         |                    |                     |
| Water Source            |                         |                    |                     |
| IR Isolated Heat Source |                         |                    |                     |
| IR 1957 20220919        |                         |                    |                     |

**Operations**  
 Government  
 MTKNF-002240  
 9/20/2022  
 2,470 acres

Fire perimeter updated from  
 IR on 9/19/2022 @ 1957



NR Team 2  
 9/20/2022 1147  
 North American 1983 Datum, Lat/Long Grid

Operations