

COLT FIRE

Incident Action Plan

August 6, 2023

Operational Period



0600 to 2200



MT-SWS-200549

PNQD24 (1522)

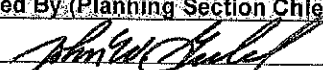
903164

INCIDENT OBJECTIVES	1. Incident Name Colt Fire	2. Date Prepared 8/5/23	3. Time Prepared 2100
	4. Operational Period Sunday, August 6, 2023 DAY SHIFT		
Intent, Objectives			
<p>Commander's Intent Success is defined as prioritizing fire fighter safety, minimizing potential impacts/threats to human populations, private land, infrastructure and other identified values; this is achieved by effective risk management and enhanced coordination.</p> <p>Ensure that all incident actions reflect a commitment to aviation, responder, and public safety through using the risk management process outlined in the IRPG, adherence to the 10 Standard Firefighting Orders, mitigation of the 18 Situations That Shout Watch Out and LCES. If you cannot mitigate a tactical hazard to an acceptable level of risk, do not implement the corresponding tactical action until such time as the risk can be satisfactorily mitigated before re-engaging. Ensure this Commander's Intent is clearly communicated and understood by all resources.</p>			
<p>Operational Objectives <i>Implementation of the following operational objectives is to be applied and accomplished only through managing risk to best assure firefighter safety.</i></p> <ol style="list-style-type: none"> 1. Execute full suppression, full perimeter control action strategies utilizing direct and indirect tactics to minimize impacts to values at risk and firefighter exposure. 2. Prevent or minimize fire impacts to these prioritized values: State Highway 83, private property and infrastructure. 3. Provide Initial Attack within TFR (Temporary Flight Restriction). 4. Consider operational strategies and tactics that minimize smoke impacts to sensitive areas and receptors. Follow guidance in State Smoke Management Plans and coordinate with State and local Air Quality Regulators. 			
<p>Management Objectives</p> <ol style="list-style-type: none"> 1. Provide timely and accurate dissemination of information to residents of Seeley Lake, Condon, fire-adjacent residences and the jurisdictional agencies. Keep these entities informed of management goals, objectives, successes and challenges on the incident. 2. Protect and/or mitigate impacts to the identified values at risk as prioritized by the jurisdictional agencies. Operations personnel should coordinate with appropriate READ(s) to document; and, if necessary, coordinate mitigation measures related to threatened and endangered species, cultural sites, and minimize introduction and spread of noxious/exotic weeds and aquatic species. 			
<p>Additional Commander's Intent Communicate and coordinate incident management activities to ensure they are aligned with the overall goals of the requesting and cooperating agencies.</p> <p>Treat all Incident Management personnel, cooperators, contractors and the local public with dignity and respect creating a "no tolerance" atmosphere for harassment, discrimination, alcohol, or federally prohibited substances.</p>			
8. ATTACHMENTS (X IF ATTACHED)			
<input checked="" type="checkbox"/> ICS 203 <input checked="" type="checkbox"/> ICS 204 <input checked="" type="checkbox"/> ICS 205 <input checked="" type="checkbox"/> ICS 206 <input checked="" type="checkbox"/> ICS 220		<input checked="" type="checkbox"/> Weather Forecast/Fire Behavior Analysis <input checked="" type="checkbox"/> Safety Message <input checked="" type="checkbox"/> Weather Forecast/Fire Behavior Analysis <input checked="" type="checkbox"/> 8 Line – Medical Incident Report	
9. Prepared By (Planning Section Chief)		10. Approved By (Incident Commander)	
ICS 202 			

ORGANIZATION ASSIGNMENT LIST				Operations Section	
1. Incident Name		Colt Fire		Line Operations	Kevin Smith: (406) 491-0202
2. Date Prepared	8/5/2023	3. Time Prepared	2100	Planning Operations	Chad Pickering: (406) 360-4656 Greg Schenk (T): (406) 691-0371
4. Operational Period		August 6, 2023, 0600 to 2200		Strategic Operations	Paul Diaz (T): (406) 531-3906
				Structure Protection	
Incident Commander and Staff				Branch	
Incident Commander	Joe Sampson			Division Alpha	Robert Spence: (406) 840-0810
Information Officer	Christopher Ziegler; Alex Kozub			Division Echo	J.T. Gillman: (406) 800-3330; Scott Drake (T): (406) 459-8579
Liaison Officer	Jason Snellman; Bryan Donner			Division Kilo	Tom McLeod: (208) 451-5050; Trent Sohr (T)
				Division Tango	Ashton Ferruzzi: (406) 670-8183
Agency/Representative				Structure/Initial Attack	Zac Thompson: (701) 280-2875
USFS – Lolo	Quinn Carver			Staging	
USFS – Flathead	Chris Dowling			Security Group	Kenny White 406-531-9222
DNRC – Swan Unit	Dave Marks				
DNRC – Clearwater Unit	Kristen Baker-Dickinson				
FWP R2 Supervisor	Randy Arnold			Air Operations Branch	
Safety/Medical				Air Operations Branch Director	Steve Croy: (540) 230-2568
Safety Officer	Adam Carr; Leroy Holguin; Matt Nelson (T)			Air Support Group Supervisor	Jeff Polack: (208) 816-3447
Medical Unit	Rosemary Myers; Connie Weeks			Air Tactical Group Supervisor	Chris Lorass 406-370-4160
Planning Section				Finance Section	
Section Chief	Julie Shea; Jim Stiteler; John Gubel; Mark Glos (V)			Section Chief	Wendy McCartney; Biddy Simet
Situation Unit	Brett Gore; Matthew Reed (T); JT Allen (T)			Time Unit	Tammy Petersen
Demobilization Unit	Jeff DeMattels			Equipment Time	
Resources Unit Leader	Patty Bates			Personnel Time	Karen Sargeant
SOPL	John Cataldo			Cost Unit	Terry Groesbeck (T)
Fire Behavior Analyst	Michael Locke; Ashley Sites (V); Gary McLendon (T)			Procurement Unit Leader	Vickie Anderson
Long-Term Analyst	Jon Rieck; Todd Erdody			Comps / Claims	
REAF	Geoff Bogie Daphne Kampinga (T) Autumn Keller Aric Burt (T)				
Air Resource Advisor	Tod Johnson; Adam Friedman (T)				
Meteorologist	Shawn Smith				
GIS Specialist	Jesse Monroe				
Computer Specialist	Michael Harper				
Human Resource	Debby Hassel (V)				
Logistics Section					
Section Chief	Russ Riebe; Peter Pappas; Kimberly Burch, Jeremiah Greene				
Ordering Manager	Meghan Carosella; Darcy Wheeler (V)				
Supply Unit	Tray Hall (T)				
Receiving Distribution					
Facilities Unit	Jon Kautt; Pat Nelson (T)				
Base Camp Manager					
Ground Support Unit	Jason Noble				
Communications Unit	(208) 891-7380				
COML	Todd Orr				
INCM					
Food Unit	Mary Naylor				
Equipment Manager					
				Prepared by:	Patty Bates - RESL



INCIDENT Weather Forecast



Forecast No: 15
 Prediction For: Sunday
 Shift Date: August 06, 2023
 Forecast Issued: August 05, 2023 at 1800

Name of Incident: Colt
 Unit: MT-SWS / Nrn Rockies Team 5
 Incident Meteorologist: Shawn Smith
 (240) 778-5293

Discussion: Low pressure to our west will continue to interact with moisture ahead of a stationary front today bringing another day of showers and possible thunderstorms with cool temperatures and cloudy conditions. The best chance of thunderstorms will come near pockets of sun and could bring heavy downpours, lightning, and outflow winds. Additional rainfall will be likely tonight and Monday as the low pressure area transits west to east across the fire area. The best chances of thunderstorms on Monday will be during the afternoon. Relative humidity will remain high with the moist conditions.

Forecast for Today:

Sky/Weather:

Mostly Cloudy; Showers with Possible Thunderstorms.

	<u>ICP 4,200'</u>		<u>East End 4,600'</u>		<u>West End 6,600'</u>		
Max Temperature:	75		75		65		°F
Min RH:	50		50		70		%
Wind (20 FT):	Outflow winds with Hvy Shws/Tstrms 35-45 mph.						
...	ESE	5	SE	5	NE	7	mph
...	Gusts:	8	Gusts:	8	Gusts:	13	mph
Haines Index:	2		2		2		
LAL:	3		3		3		
Chance of Precipitation:	80		80		85		%
Tonight's Min Temperature:	44		45		48		°F
Tonight's Max RH:	100		100		85		%
Tonight's Wind (20 FT):							
...	NNE	5	NE	1	ESE	2	mph
...	Gusts:	8	Gusts:	3	Gusts:	5	mph
Tonight's Haines Index:	2		2		2		
Tonight's LAL:	3		3		3		
Tonight's Chnc of Precip:	70		75		80		%

Forecast for Monday:

Sky/Weather:

Partly to Mostly Cloudy; Showers and Possible Thunderstorms

	<u>ICP 4,200'</u>		<u>East End 4,600'</u>		<u>West End 6,600'</u>		
Max / Min Temperature:	75	45	75	45	65	48	°F
Min / Max RH:	45	100	50	100	70	85	%
Wind (20 FT):	Outflow winds in heavy showers/thunderstorms 35-45 mph.						
...	SW	5	SW	5	WSW	5	mph
...	Gusts:	8	Gusts:	8	Gusts:	8	mph
Haines Index:	2		LAL:	3	Precip Chance:	70	

Extended Outlook: Additional showers and slight chance of thunderstorms on Tuesday. Decreasing clouds and a drying trend mid to late week. Temperatures remaining below normal.

		<u>Max T</u>	<u>Min T</u>	<u>Min RH</u>	<u>Max RH</u>	<u>Ridge Winds @ 1500</u>	<u>Weather</u>
East End 4,600'	Tue:	70	44	45	95	W @ 8 G15	Shwr/Chc Tstrm
	Wed:	75	43	35	95	W @ 11 G18	Mostly Cloudy
	Thu:	75	43	35	95	W @ 13 G23	Partly Cloudy

FIRE BEHAVIOR FORECAST

FORECAST NUMBER: 15

FIRE NAME: Colt

DATE ISSUED: 8/5/2023

UNIT: Montana DNRC / Lolo National Forest

TYPE OF FIRE: Wildfire

OPERATIONAL PERIOD: 8/6/2023 Day

TIME ISSUED: 1900

SIGNED: *Ashley Sitas* *Siban*
Gary McLondon *Siban(C)*

WEATHER:

***** Moist Conditions Continue *****

See Fire Weather Forecast for Details

Local Weather Thresholds that shout WATCH OUT (per Lolo DNRC East pocket card)
Temperatures above 80°, Relative Humidity below 20%, 20' winds above 20 mph

FUELS:

The fire area is dominated by stands of mixed conifer with grass and brush on the surface. Heavy loads of dead and down material as well as concentrations of standing dead subalpine fir in the "gray needled phase" is prevalent. A special fuel of concern is the moss hanging from the timber, often called "Old Mans Beard" or "Goats Beard". This ladder fuel allows fire to easily transition from the surface to the crown. The fuels are considered unseasonably dry for this time of the year. The current ERC-Y is above average the 80th percentile. 100 -hr and 1000 -hr fuel moisture contents are currently both at 9%. At this stage, these fuels will contribute to fire intensity and consumption will occur. Live fuel moistures in the brush fuels are still high enough to keep the fire behavior to a minimum. However, they are being stressed by the warm and dry conditions (notice the red and light green color) these areas may begin to contribute to fire behavior.

Today's Forecasted Fine Dead Fuel Moisture:
8% unshaded, 11 % shaded

FIRE BEHAVIOR:

Cool and moist conditions will continue to keep fire movement at minimum. Fire behavior should be limited to creeping and smoldering in surface fuels. Heavy dead and down will continue to burn due to low fuel moistures.

AIR OPERATIONS

Downdrafts from thunderstorms may interfere with air operations today.

SAFETY:

At all times maintain your situational awareness so you can provide for your safety & safety of your coworkers.



Safety Message

<p>!!MANAGE FATIGUE!! REMEMBER FATIGUE IS CUMULATIVE!!! <input type="checkbox"/> Adequate Rest? <input type="checkbox"/> Overwhelmed (in over your head)? <input type="checkbox"/> Proper Nutrition? <input type="checkbox"/> Driving too far? <input type="checkbox"/> Personal Hygiene? <input type="checkbox"/> Been out way too many days? <i>Complete the checklist for yourself. Be honest, Make sure all systems are GO today.</i></p>	<p>Driving There are narrow roads on the incident. Drive at or below the speed limit with your headlights and seat belts on (Day and Night). Drive defensively. When in doubt, yield the right of way to the other vehicle.</p>	<p>Individual Health Wash hands often to prevent the spread of any contagious diseases. Use mole skin prior to developing blisters. Drink plenty of fluids, primarily water. Monitor each other for signs of dehydration. Encourage snacking throughout the work shifts. Ensure firefighters hydrate before, during, and after work shifts.</p>
---	--	---

Risk Assessment Tool (Real-Time Risk Management)			
1. Do you know the risk associated with your task today? 2. Do you understand why you're doing this task and what the end state looks like?		<input type="checkbox"/> Yes <input type="checkbox"/> No	<input type="checkbox"/> No <input type="checkbox"/> No
3. Determine whether the benefit of meeting your objective exceeds the degree of risk that will entail (<i>Amount of gain in meeting objectives</i>)	<input type="checkbox"/> Low Gain	<input type="checkbox"/> Moderate Gain	<input type="checkbox"/> High Gain
4. Determine the probability of success in completing your assigned mission. (<i>Probability of success in meeting objectives</i>)	<input type="checkbox"/> Low P.O.S.	<input type="checkbox"/> Medium P.O.S.	<input type="checkbox"/> High P.O.S.
5. RISK ELEMENTS - THESE SIX ELEMENTS ARE IDENTIFIED AS CONTRIBUTING TO A LARGE PORTION OF RISK ON PROJECTS / WORK ACTIVITIES. (RATE EACH ELEMENT 1 THROUGH 10)		SCORE Element Rating	Total risk element scores for GAR risk
Supervision - Leadership is actively engaged, good communication, organized, qualifications, experience levels, clear chain of command. (<i>1=Very competent; 10=Terrible organization</i>)			Total Score = 6-23 GREEN (Low Risk)
Planning - Thoroughly planned, risk assessment, resources match the job, timeline appropriate, emergency contingency in place. (<i>1=Organized & well thought out; 10=No planning, ill-prepared</i>)			
Leader's Intent - Clear task, purpose, and end state; adequate briefings; safety first (<i>1=Same page, objectives addressed; 10=Vague, instructions and assignments not understood</i>)			Total Score = 24-44 AMBER (Medium Risk)
Team Fitness - physical/mental fitness, good morale, mindful, high level of situational awareness, experience, cohesiveness. (<i>1=Strong body & mind; 10=Physically/mentally struggling</i>)			
Environment - Weather & environment conditions, rugged terrain, remoteness, hazards -snags, wildlife, manmade hazards, etc. (<i>1=limited, low risk hazards; 10=numerous, high-risk hazards</i>)			Total Score = 45-60 RED (High Risk)
Duration/Complexity - task duration, repetitive, overextended, air support or logistics dependent (<i>1=Short term project, few moving parts; 10=Long-term project, many moving parts</i>)			
6. DOES THE GAIN WARRANT THE RISK?	< GAIN VS RISK >		Discuss results with team members

Safety is your Responsibility!

Northern Rockies Complex Incident Management Team

DIVISION ASSIGNMENT LIST		Branch	Division/Group
Incident Name			Alpha
Colt		Operational Period	
		Date 8/5/2023	Time 0600 - 2200
Operations Personnel			
Safety Officer	Adam Carr; Leroy Holguin; Matt Nelson (T)	Line Operations	Kevin Smith: (406) 491-0202
Division/ Group Supervisor	Robert Spence: (406) 640-0810	Planning Operations	Chad Pickering: (406) 360-4556 Greg Schenk (T): (406) 691-0371
		Strategic Operations	Paul Diaz (T): (406) 531-9906

Resources Assigned This Period

Strike Team/Task Force/ Resource Designator	Req#	Last Shift	Leader	# Persons	Drop Off Point /Time	Pick Up Point / Time
TFLD	O-41	8/7	Matt Huber	1	Fawn Creek 0600	Fawn Creek 2100
TFLD (T)	O-37	8/6	Donovan Suko	1	Fawn Creek 0600	Fawn Creek 2100
TFLD (T)	C-15.20	8/7	Rogue Swenson	1	Fawn Creek 0600	Fawn Creek 2100
HEQB	O-49	8/6	Jim VanNice	1	Fawn Creek 0600	Fawn Creek 2100
TFLD (T)	O-132	8/9	Nathan Seitz	1	Fawn Creek 0600	Fawn Creek 2100
HC2 CSR Enterprise	C-16	8/9	Chris Cassady	20	Fawn Creek 0600	Fawn Creek 2100
T2IA Diamond 11A	C-8	8/11	Jonathan Alvarez	20	Fawn Creek 0600	Fawn Creek 2100
HC2 PNW Fire LLC	C-17	8/10	Miguel Esquivel	20	Fawn Creek 0600	Fawn Creek 2100
ENG3 Wildland Fire Services	E-93	8/7	Dennis Gates	3	Fawn Creek 0600	Fawn Creek 2100
ENG6 Brockway Construct	E-94	8/6	Kyle Colton	2	Fawn Creek 0600	Fawn Creek 2100
ENG6 East Missoula VFD	E-95	8/8	Tanner Ferguson	2	Fawn Creek 0600	Fawn Creek 2100
WTS2 PHR Enterprise	E-104	8/15	Mike Grezchowiak	2	Fawn Creek 0600	Fawn Creek 2100
ENG6 MLSA City FD	E-152	8/16	Jeff Kroll	3	Fawn Creek 0600	Fawn Creek 2100
ENG6 Wolf Pack	E-153	8/16	Ken Spacht	3	Fawn Creek 0600	Fawn Creek 2100
ENG6 C & C Cougar	E-107	8/8	Jim Reilly	3	Fawn Creek 0600	Fawn Creek 2100
ENG6 Brockway Construct	E-108	8/8	Alan Brockway	3	Fawn Creek 0600	Fawn Creek 2100
SKG2 24/7	E-65	8/7	Dave Alderdice	2	Fawn Creek 0600	Fawn Creek 2100
WTS2 Rainmakers Irrig.	E-82	8/7	Maryann Smith	1	Fawn Creek 0600	Fawn Creek 2100
WTS2 Stan Billingsley Trkng	E-84	8/7	Stan Billingsley	1	Fawn Creek 0600	Fawn Creek 2100
SAFETY/MEDICAL						
SOFR	O-63	8/8	Rick Jones	1	Fawn Creek 0600	Fawn Creek 2100
EMPF	O-88	8/10	Kate Batten	1	Fawn Creek 0600	Fawn Creek 2100
EMPF	O-90	8/8	Jeff Childers	1	Fawn Creek 0600	Fawn Creek 2100
EMPF	O-93	8/8	Ethan Biederman	1	Fawn Creek 0600	Fawn Creek 2100
EMTF	O-95	8/9	Mike Dowd	1	Fawn Creek 0600	Fawn Creek 2100
AMBO1 Missoula City FD	E-77	8/6	Matt Kerns	2	Fawn Creek 0600	Fawn Creek 2100

Work Assignments

TASK: Continue mop up operations securing fire edge from H22 to DP16. Secure fire edge with direct line from Colt to Beaver Lake.

PURPOSE: To have control features in place that have the highest probability of success to protect critical values at risk. Maintain positive relationships with cooperators and private landowners during suppression operations.

END STATE: The fire is contained at the established control features with minimal impacts to timber sale units, the local economy and the Hwy 83 corridor including homes, powerlines, closures, campgrounds and infrastructure from Beaver Creek Rd to the town of Seeley Lake and from Pierce Lake to Lindbergh Lake.

Special Instructions

Prioritization of all control or containment actions taken during the operational period in this Division will be at the discretion of the DIVS. Actions may have to be taken by the DIVS that are not enumerated in today's IAP. These actions would be a result of a significant change in actual or expected fire behavior over and above that anticipated at the time the IAP was prepared. These actions will be coordinated with and approved by the OSC whenever possible.
To request Law Enforcement support, use assigned CMD frequency.

Division/Group Communication Summary

Function	Channel	Frequency RX	Tone RX	Frequency TX	Tone TX	Function	Channel	Frequency RX	Frequency TX
CMD	8	169.7500	146.2	167.1000	146.2	A/G CMD	13	168.4000	168.4000
CMD	9	170.4125	146.2	165.9625	146.2	A/G Buckets	14	166.8250	166.8250
CMD	10	170.0125	146.2	165.2500	146.2				
TAC1	1	166.7750	146.2	166.7750	146.2				
Prepared by RESL Patty Bates		Approved by PSC John Gubel 				Date 8/5/2023		Time 1900	

DIVISION ASSIGNMENT LIST	Branch	Division/Group
Incident Name		Echo
Colt	Operational Period	
	Date 8/6/2023	Time 0600 - 2200

Operations Personnel		
Safety Officer	Adam Carr; Leroy Holguin; Matt Nelson (T)	Line Operations Kevin Smith: (406) 491-0202
Division / Group Supervisor	J.T. Gilman: (406) 600-3330; Scott Drake (T): (406) 459-8579	Planning Operations Chad Pickering: (406) 360-4556 Greg Schenk (T): (406) 691-0371
		Strategic Operations Paul Diaz (T): (406) 531-9906

Resources Assigned This Period						
Strike Team/Task Force/ Resource Designator	Req#	Last Shift	Leader	# Persons	Drop Off Point /Time	Pick Up Point / Time
TFLD (I)	O-132	8/9	Nathan Seitz	1	Fawn Creek 0600	Fawn Creek 2100
HC1 Springville	C-6	8/6	Robert Nevarez	20	Alva CG 0600	Alva CG 2100
HC1 Valermo	C-7	8/6	Simeon Hagens	23	Alva CG 0600	Alva CG 2100
HC1 Lolo	C-15	8/7	Shawn Faiella	21	Alva CG 0600	Alva CG 2100
FMOD Westlope Forest	O-179	8/16	Dustin Streissguth	2	Fawn Creek 0600	Fawn Creek 2100
DOZ2 JG Enterprise	E-76	8/13	Tyler Reichle	2	Fawn Creek 0600	Fawn Creek 2100
WTS2 PHR Enterprise	E-104	8/15	Mike Grezchowiak	2	Fawn Creek 0600	Fawn Creek 2100
WTS2 I Know Jack	E-105	8/11	Alex Ronning	1	Fawn Creek 0600	Fawn Creek 2100
SKG2 Hart Ventures	E-66	8/6	Rich Beaudin	2	Fawn Creek 0600	Fawn Creek 2100
SKG2 Only a Mile	E-67	8/9	Guy Clatterbuck	2	Fawn Creek 0600	Fawn Creek 2100
SAFETY/MEDICAL						
SOFR	O-62	8/13	Don Foco 231-268-9899	1	Fawn Creek 0600	Fawn Creek 2100
EMTF	O-97	8/7	Kodi Smith 509-953-6653	1	Fawn Creek 0600	Fawn Creek 2100
REMS1	O-118	8/10	John Keys 520-395-6832	4	Fawn Creek 0600	Fawn Creek 2100

Work Assignments

TASK: Continue handline construction above West Fork Clearwater west to the E/K break. Scout points of engagement to continue with direct line from 4354 road to Sunset Peak.

PURPOSE: To have control features in place that have the highest probability of success to protect critical values at risk. Maintain positive relationships with cooperators and private landowners during suppression operations.

END STATE: The fire is contained at the established control features with minimal impacts to the Hwy 83 corridor including homes, powerlines, closures and infrastructure from the A/E break to the E/K break.

Special Instructions

Prioritization of all control or containment actions taken during the operational period in this Division will be at the discretion of the DIVS. Actions may have to be taken by the DIVS that are not enumerated in today's IAP. These actions would be a result of a significant change in actual or expected fire behavior over and above that anticipated at the time the IAP was prepared. These actions will be coordinated with and approved by the OSC whenever possible.

To request Law Enforcement support, use assigned CMD frequency.

Division/Group Communication Summary									
Function	Channel	Frequency RX	TONE RX	Frequency TX	TONE TX	Function	Channel	Frequency RX	Frequency TX
CMD	8	169.7500	146.2	167.1000	146.2	A/G CMD	13	168.4000	168.4000
CMD	9	170.4125	146.2	165.9625	146.2	A/G Buckets	14	166.8250	166.8250
CMD	10	170.0125	146.2	165.2500	146.2				
TAC2	2	168.2000	146.2	168.2000	146.2				

Prepared by RESL Patty Bates	Approved By PSC John Gubel	Date 8/5/2023	Time 1900
---------------------------------	-------------------------------	------------------	--------------

DIVISION ASSIGNMENT LIST		Branch	Division/Group
Incident Name			Kilo
Colt		Operational Period	
		Date 8/6/2023	Time 0600 - 2200
Operations Personnel			
Safety Officer	Adam Carr; Leroy Holguin; Matt Nelson (T)	Line Operations	Kevin Smith: (406) 491-0202
Division / Group Supervisor	Tom McLeod: (208) 451-5050; Trent Sohr (T)	Planning Operations	Chad Pickering: (406) 380-4558 Greg Schenk (T): (406) 691-0371
		Strategic Operations	Paul Diaz (T): (406) 531-9906

Resources Assigned This Period

Strike Team/Task Force/ Resource Designator	Req#	Last Shift	Leader	# Persons	Drop Off Point /Time	Pick Up Point / Time
TFLD (T)	O-68	8/6	Adam Alessi	1	Fawn Creek 0600	Fawn Creek 2100
HEQB (T)	O-113	8/9	Jack Nerison	1	Fawn Creek 0600	Fawn Creek 2100
HC2 Iron Mountain	C-19	8/10	Jesse Chiprez	20	Fawn Creek 0600	Fawn Creek 2100
FMOD Miller Creek	O-133	8/10	Nic Jones	2	Fawn Creek 0600	Fawn Creek 2100
FMOD Miller Creek #3	O-180	8/16	Pete Clifford	2	Fawn Creek 0600	Fawn Creek 2100
HETF Peterson Inc.	E-121	8/14	Bob McCarty	12	Fawn Creek 0600	Fawn Creek 2100
HETF Bull Creek Forestry	E-147	8/15	Leelyn Cahoon	5	Fawn Creek 0600	Fawn Creek 2100
DOZ2 Meadow Creek	E-145	8/15	Dylan Gull	2	Fawn Creek 0600	Fawn Creek 2100
DOZ3 Equip. Tech. Fire	E-146	8/15	Brian Crawley	2	Fawn Creek 0600	Fawn Creek 2100
WTS2 Wildland Contract.	E-154	8/16	Paul Offerman	2	Fawn Creek 0600	Fawn Creek 2100
WTS2 Mountain West Fire	E-155	8/17	Mike Grzechowiack	1	Fawn Creek 0600	Fawn Creek 2100
EXC2 Bosworth Tools	E-115	8/9	Gary Guillot	2	Fawn Creek 0600	Fawn Creek 2100
HETF Intermountain	E-47	8/6	Ben Anderson	11	Fawn Creek 0600	Fawn Creek 2100
REAF (I)	O-190	8/13	Daphne Kampinga	1	Fawn Creek 0600	Fawn Creek 2100
SAFETY/MEDICAL			+ ETS DOZR	1		
EMTF	O-99	8/8	Stephen Rotella 973-690-8773	1	Fawn Creek 0600	Fawn Creek 2100
AMBO3 Best Practice	E-78	8/8	Taylor Morrissey 559-720-9217	2	Fawn Creek 0600	Fawn Creek 2100

Work Assignments

TASK: Scout control line opportunities utilizing the road system directly west of DP63 with the intention to connect into Sunset Ridge. Coordinate with DIV E to identify control line opportunities to hold fire progression north of Sunset Ridge in the area west of Sunset Peak.

PURPOSE: To find favorable terrain that have the highest probability of success with the least amount of risk to incident resources.

END STATE: Control features are constructed ensuring minimal impacts to values at risk.

Special Instructions

Prioritization of all control or containment actions taken during the operational period in this Division will be at the discretion of the DIVS. Actions may have to be taken by the DIVS that are not enumerated in today's IAP. These actions would be a result of a significant change in actual or expected fire behavior over and above that anticipated at the time the IAP was prepared. These actions will be coordinated with and approved by the OSC whenever possible.

To request Law Enforcement support, use assigned CMD frequency.

Division/Group Communication Summary

Function	Channel	Frequency RX	Tone RX	Frequency TX	Tone TX	Function	Channel	Frequency RX	Frequency TX
CMD	8	169.7500	146.2	167.1000	146.2	A/G CMD	13	168.4000	168.4000
CMD	9	170.4125	146.2	165.9625	146.2	A/G Buckets	14	166.8250	166.8250
CMD	10	170.0125	146.2	165.2500	146.2				
TACS	3	168.0500	146.2	168.0500	146.2				

Prepared by RESL Patty Bates	Approved By PSC John Gubel	Date 8/5/2023	Time 1900
---------------------------------	-------------------------------	------------------	--------------



DIVISION ASSIGNMENT LIST		Branch	Division/Group
Incident Name			Tango
Colt		Operational Period	
		Date 8/8/2023	Time 0600 - 2200
Operations Personnel			
Safety Officer	Adam Carr; Leroy Holguin; Matt Nelson (T)	Line Operations	Kevin Smith: (406) 491-0202
Division / Group Supervisor	Ashton Ferruzzi: (406) 570-6163	Planning Operations	Chad Pickering: (406) 380-4556 Greg Schenk (T): (406) 691-0371
		Strategic Operations	Paul Diaz (T): (406) 531-9906

Resources Assigned This Period

Strike Team/Task Force/ Resource Designator	Req#	Last Shift	Leader	# Persons	Drop Off Point /Time	Pick Up Point / Time
TFLD	O-42	8/7	Charles Davis	1	Fawn Creek 0600	Fawn Creek 2100
TFLD	O-40	8/9	Gordon Amundson	1	Fawn Creek 0600	Fawn Creek 2100
TFLD (t)	O-112	8/10	Dillion Michael	1	Fawn Creek 0600	Fawn Creek 2100
HEQB	O-43	8/6	Andrew Jenkins	1	Fawn Creek 0600	Fawn Creek 2100
HEQB	O-45	8/8	Camaron Greenlund	1	Fawn Creek 0600	Fawn Creek 2100
HEQB (t)	O-46	8/6	Calvin Anderson	1	Fawn Creek 0600	Fawn Creek 2100
HC1 Helena	C-22	8/15	Tighe Stoyanoff	21	Alva CG 0600	Alva CG 2100
HC2 Diamond 11B	C-9	8/11	Lary Eckelman	20	Fawn Creek 0600	Fawn Creek 2100
HC2 Alta Pacific	C-12	8/6	Jose Torres	20	Fawn Creek 0600	Fawn Creek 2100
HC2 NF Reforester Inc	C-23	8/17	Rafael Cisneros	20	Fawn Creek 0600	Fawn Creek 2100
HC2 Forest Mgmt. Spec.	C-13	8/6	Logan Buckner	10	Fawn Creek 0600	Fawn Creek 2100
EXC2 Bosworth Tools	E-115	8/9	Gary Guillot	2	Fawn Creek 0600	Fawn Creek 2100
ENG6 Caye Wildfire	E-106	8/8	Pierre Malapare	4	Fawn Creek 0600	Fawn Creek 2100
ENG6 FNF E613		8/17	Paul Anderson	3	Fawn Creek 0600	Fawn Creek 2100
ENG6 St. Regis VFD	E-11	8/11	Brian Posey	2	Fawn Creek 0600	Fawn Creek 2100
ENG6 LNF Nine Mile	E-91	8/9	Will Reed	3	Fawn Creek 0600	Fawn Creek 2100
WTS2 Hart Ventures	E-80	8/6	Nathaniel Prince	1	Fawn Creek 0600	Fawn Creek 2100
WTS2 Luke Burnham	E-81	8/12	Richard Hensley	1	Fawn Creek 0600	Fawn Creek 2100
WTS2 Petersen Inc.	E-85	8/7	Vinny Gugliuzza	1	Fawn Creek 0600	Fawn Creek 2100
WTS2 Curlew Waterwx	E-122	8/17	Zach Stammers	1	Fawn Creek 0600	Fawn Creek 2100
WTS2 4 x 4 Fire Svs.	E-156	8/16	Paige Carney	1	Fawn Creek 0600	Fawn Creek 2100
WTS2 Nathan Smith	E-86	8/9	Curtis Smith	1	Fawn Creek 0600	Fawn Creek 2100
WTS2 St. Regis VFD	E-88	8/7	Steven Ahern	1	Fawn Creek 0600	Fawn Creek 2100
SKG2 Pitman Resources	E-165	8/19	Dan Johnson	1	Fawn Creek 0600	Fawn Creek 2100
DOZ2 RT Logging	E-74	8/6	Josh Gerlach	1	Fawn Creek 0600	Fawn Creek 2100
DOZ2 Nathan Smith	E-75	8/6	Joquin Liberty to DIV K	1	Fawn Creek 0600	Fawn Creek 2100
SKG1 Spencer Logging	E-68	8/14	Shane Whitmarsh	1	Fawn Creek 0600	Fawn Creek 2100
REAF	O-127	8/10	Autumn Keller	1	Fawn Creek 0600	Fawn Creek 2100
SAFETY/MEDICAL						
SOFR	O-64	8/8	Guy Blom	1	Fawn Creek 0600	Fawn Creek 2100
SOFR	O-65	8/8	Buren Fulmer	1	Fawn Creek 0600	Fawn Creek 2100
EMPF	O-91	8/13	Aaron Beard	1	Fawn Creek 0600	Fawn Creek 2100
EMPF	O-92	8/13	Ayala Rahm	1	Fawn Creek 0600	Fawn Creek 2100
EMTF	O-98	8/8	Elise Adams	1	Fawn Creek 0600	Fawn Creek 2100
REMS2	O-139	8/14	Tyler Olson	4	Fawn Creek 0600	Fawn Creek 2100
AMBO2 Vitalogy	E-79	8/7	Michael Bedick	2	Fawn Creek 0600	Fawn Creek 2100

Work Assignments

TASK: Mop up fire edge from 91226 road to Beaver Lake. Utilize crews to prep dozer line from 91162 road to 9658 road. Prep mechanical line from DP61 to DP62 for planned firing operation in coordination with DIV K. Prep road east of DP61 for planned firing operation. Assist DIV K with scouting and line construction.

PURPOSE: To have control features in place that have the highest probability of success with the least amount of risk to incident resources. Maintain positive relationships with private landowners and cooperators during suppression operations.

END STATE: The fire is contained at the established control features with minimal impacts to private property, natural resources and values at risk. Local relationships are strengthened through timely communication, cooperation and coordination.

Special Instructions

Prioritization of all control or containment actions taken during the operational period in this Division will be at the discretion of the DIVS. Actions may have to be taken by the DIVS that are not enumerated in today's IAP. These actions would be a result of a significant change in actual or expected fire behavior over and above that anticipated at the time the IAP was prepared. These actions will be coordinated with and approved by the OSC whenever possible. To request Law Enforcement support, use assigned CMD frequency.

Division/Group Communication Summary

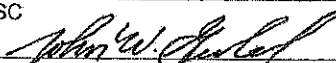
Function	Channel	Frequency RX	Tone RX	Frequency TX	Tone TX	Function	Channel	Frequency RX	Frequency TX
CMD	8	169.7500	146.2	167.1000	146.2	A/G CMD	13	168.4000	168.4000
CMD	9	170.4125	146.2	165.9625	146.2	A/G Buckets	14	166.8250	166.8250
CMD	10	170.0125	146.2	165.2500	146.2				
TAC4	4	166.7250	146.2	166.7250	146.2				
Prepared by RESL Patty Bates		Approved by PSC John Gubel 				Date 8/5/2023		Time 1900	

DIVISION ASSIGNMENT LIST		Branch	Division/Group
Incident Name		Structure Group/Initial Attack	
Colt		Operational Period	
		Date 8/6/2023	Time 0600 - 2200
Operations Personnel			
SAFETY OFFICER	Adam Carr; Leroy Holguin; Matt Nelson (T)	Line Operations	Kevin Smith: (406) 491-0202
		Planning Operations	Chad Pickering: (406) 360-4556 Greg Schenk (T): (406) 691-0371
DIVISION/GROUP SUPERVISOR	Zac Thompson: (701) 260-2875	Strategic Operations	Paul Diaz (T): (406) 531-9906

Resources Assigned This Period						
Strike Team/Task Force/ Resource Designator	Req#	8/7	Alec Carr	# Persons	Drop Off Point /Time	Pick Up Point / Time
ENG6 Kootenai NF	E-92	8/10	Greg Webster	6	Fawn Creek 0600	Fawn Creek 2100
ENG6 Buffalo Bird 2	E-124	8/14	Robert Dillon	3	Fawn Creek 0600	Fawn Creek 2100
ENG6 Robert Dillon Tree	E-143			3	Fawn Creek 0600	Fawn Creek 2100
SAFETY/MEDICAL		8/14	Stephen Proceso			
EMTF	O-152	8/7	Chris Olson	1	Fawn Creek 0600	Fawn Creek 2100
EMTF	O-96			1	Fawn Creek 0600	Fawn Creek 2100

Work Assignments

TASK: Prep values at risk in all closure areas and evacuation types from Lindbergh Lake to Lake Inez as directed by Operations. Continue to patrol and scout the Hwy 83 corridor for any new fire activity. Respond to initial attack within the TFR as requested.

PURPOSE: To be prepared to implement structure protection tactics in the event fire becomes established in residential areas. Maintain positive relationships with cooperators and private landowners during suppression operations.

END STATE: Actions taken by incident responders result in minimal impacts to homes, campgrounds and Hwy 83 infrastructure associated with the Colt Fire perimeter.

Special Instructions

Prioritization of all control or containment actions taken during the operational period in this Division will be at the discretion of the DIVS. Actions may have to be taken by the DIVS that are not enumerated in today's IAP. These actions would be a result of a significant change in actual or expected fire behavior over and above that anticipated at the time the IAP was prepared. These actions will be coordinated with and approved by the OSC whenever possible.

To request Law Enforcement support, use assigned CMD frequency.

Division/Group Communication Summary											
Function	Channel	169.7500	146.2	Frequency TX	146.2	TONE TX	Function	Channel	Frequency RX	Frequency TX	
CMD	8	170.4125	146.2	167.1000	146.2	A/G CMD	13	168.4000	168.4000		
CMD	9	170.0125	146.2	165.9625	146.2	A/G Buckets	14	166.8250	166.8250		
CMD	10	168.5250	146.2	165.2500	146.2						
TACT	7	Date	Time	168.5250	146.2						
Prepared by RESL Patty Bates		Approved By PSC John Gubel						8/5/2023		1900	
								8/5/2023		1900	

DIVISION ASSIGNMENT LIST			Branch			Division/Group			
Incident Name						Staging			
Colt			Operational Period						
			Date 8/6/2023			Time 0600 - 2200			
Operations Personnel									
SAFETY OFFICER	Adam Carr; Leroy Holguin; Matt Nelson (T)		Line Operations			Kevin Smith: (406) 491-0202			
			Planning Operations			Chad Pickering: (406) 360-4556 Greg Schenk (T): (406) 691-0371			
DIVISION/GROUP SUPERVISOR			Strategic Operations			Paul Diaz (T): (406) 531-9906			
Resources Assigned This Period									
Strike Team/Task Force/ Resource Designator	Req#	8/20	Leader	# Persons	Drop Off Point /Time	Pick Up Point / Time			
WTS2 Jerad Lewis Trucking	E-161	8/20	Carroll Lewis	1	Fawn Creek 0600	Fawn Creek 2100			
WTS2 Jerad Lewis Trucking	E-162	8/20		1	Fawn Creek 0600	Fawn Creek 2100			
WTS2 Mike Wirth Construction	E-163	8/20		1	Fawn Creek 0600	Fawn Creek 2100			
WTS2 Charlie Watson	E-164	8/20		1	Fawn Creek 0600	Fawn Creek 2100			
WTS2 Pitman Resources	E-165			1	Fawn Creek 0600	Fawn Creek 2100			
SKG 2	E-167		Greg Sikes						
SKG 2 12 gauge	E-166								
Work Assignments									
Special Instructions									
Division/Group Communication Summary									
Function	Channel	169.7500	TONE RX	Frequency TX	TONE TX	Function	Channel	Frequency RX	Frequency TX
CMD	8	170.4125	146.2	167.1000	146.2	A/G CMD	13	168.4000	168.4000
CMD	9	170.0125	146.2	165.9625	146.2	A/G Buckets	14	166.8250	166.8250
CMD	10		146.2	165.2500	146.2				
		Date							
Prepared by RESL Patty Bates		Approved by PSC John Gubel			8/5/2023			Time 1900	
					8/5/2023				

AIR OPERATIONS SUMMARY 220 Prepared By: Steve Croy Prepared: **08/5/2023** Prepared Time: 19:00 hrs.

1. INCIDENT NAME: Colt Fire **2. OPERATIONAL PERIOD** **08/6/2023** **START TIME:** 0600 **END TIME:** 2100 **SUNRISE:** 0619 **SUNSET:** 2102

3. REMARKS (Safety Notes, Hazards, Air Operations Special Equipment, etc.):

1. Smoky conditions & low ceiling can hamper our aviation operations adhere to visibility limitations. DO NOT be pressured into accepting a mission that you know or feels unsafe!
 2. Ensure visibility and winds are adequate to safely conduct flight operations.
 3. If you see a UAV (drone) on your division report it up the chain of command to Air Operations!
 4. Pilot always has final say on conducting any mission.
 5. And always remember: if you see something out of the ordinary, say something!!!

4. READY ALERT AIRCRAFT:

1)H-407RL
 With Litter Kit
 2) H-933CH

Initial Attack Aircraft:
 H-933CH

5. TFR:

Colt Fire 3/8178
 Elevation: 11,500 MSL
 HOURS: 0800-2200 Daily
 Freq: 118.2250

6. PERSONNEL	NAME	PHONE #	7. FREQUENCIES	AM	FM	8. FIXED-WING Avail/ Type/ Make-Model/N#/ Base
A0BD	Steve Croy	540-230-2568	A/A TFR	118.2250		<i>AIRTANKERS:</i> ORDER THRU Air Ops or MSO DISPATCH IF AIR ATTACK IS NOT UP
ASGS	Jeff Polack	208-816-3447	A/A Rotor/Linked	126.3250		
HEBM	Brandon Spencer	406-861-5298	A/G Command		168.4000	
HEBM (T)	Brian Bogdanoff	406-369-8502	A/G Buckets		166.8250	
			A/G Discreet		167.9500	ATGS Platforms: Order through Air Ops or MSO Dispatch.
			Deck		163.1000	
HLCO	Casey Jones	559-832-0192	East Command/Morrel Forest Repeater		151.2350 159.4200 (141.3 TT)	Order will be placed daily to ensure that coverage is on order for the operational shift as outlined by Colt Fire Operations.
ATGS			Tan: Life Flight A/G		155.340 (156.7 TT)	Email daily Aviation costs to: 2023.colt.finance@firenet.gov
MSO Air Desk MSO Tanker Base		406.829.7060 406.829.7328	White: Ambulance to Hospital, Use if agency transport		155.2800 (156.7 TT)	Extraction: Order thru Air Ops, Air attack, or MSO Dispatch Shorthaul aircraft located: Sandpoint, ID; Grangeville, ID; Mammoth, WY HOist: order thru Air Ops, Air attack, or Missoula Dispatch, Two Bear Air @GPI (Kalispell) 1 hr arrival
Lolo NF FAO Flathead NF FAO	Josh Klare Michael Bentley	406.360.0875 307.760.5428	Air Guard		168.6250 (110.9 TT)	

FOREST, REGIONAL AIRCRAFT FOR LEND/LEASE

FAA N#	TY	MAKE/ MODEL	BASE	START	AVAIL	REMARKS	FAA N#	TY	MAKE/ MODEL	BASE	START	AVAIL	REMARKS
HT-115	1	Blackhawk S-60	MSO	0900	0930	Buckets	H-47KT	3	Bell 407HP	MSO	0800	0830	HLCO
HT-116	1	Blackhawk S-60	MSO	0900	0930	Buckets							
HT-624CK	1	Silkorsky S-61	MSO	0900	0930	Buckets							
H-933CH	2	Bell 205A1	S04	0800	0830	Buckets/Cargo							
H-407RL	3	Bell 407HP	S04	0800	0830	Recon/PSD							

10. TASK/ MISSION/ ASSIGNMENT (Type/ function includes: Air Tactical, Retardant, Recon, Personnel Transport, Bucket Operations, SAR, etc.)			
TYPE/FUNCTION	PRIORITY	NAME OF PERSONNEL OR CARGO (if applicable) or instructions for tactical aircraft	FLY TO
Buckets	1	As assigned	Fire
Recon/PSD	2	As assigned	Fire
Slings	3	As assigned	Fire
MISSION START			
		As requested	Helibase
		As requested	Helibase
		As requested	Helibase

Helibase, Dip Sites, Pick Up Sites, etc.	
<p>Condon Helibase 47° 32.378 X 113° 43.293 (S04) For Complete List of Dip sites see Pilot and Air Ops Maps</p>	<p>***AIS WARNING PLEASE READ*** When moving between Chain lakes Placid, Seely, Inez, Alva etc. to Lindbergh Lake or other bodies of water NOT in the chain of lakes buckets will need cleaned. No cross contamination from Lindbergh or any lake not associated with the Chain Lakes Dispatch T1 Rotor from MSO Dispatch with courtesy call from Manager or Helibase ***ALL Aircraft Flight Follow with MSO or Kalispell Dispatch as appropriate until in Colt TFR and commo is established with HLB or ATGS, then closeout with MSO or have Helibase close out for you!***</p>
H-1 47° 22.362 X 113° 39.711 T2 approved 460' (north side of fire)	
H-2 47° 21.054 X 113° 36.849 T3 only, power takeoff 4300' (east side of fire northwest of Rainy Lake)	
Lindbergh Lake 47° 22.874 X 113° 44.333 Scoopers Primary	
Placid Lake 47° 7.144 X 113° 31.558 4100' Scoopers Secondary	
Alva Lake 47° 18.804 X 113° 35.968 4100'	
Summit Lake 47° 22.573 X 113° 37.590 4200'	
Rainy Lake 47° 20.391 X 113° 35.687 4100'	
Lake Inez 47° 16.702 X 113° 33.876 4100'	

Other Assigned Support Equipment

Merle Hoerner 406.390.1689	E-89	Lincoln VFD
Patricia Miles 406.214.4945	E-90	Grizzly Fire Support
406-540-1886	S-182	Outback Firefighting, Inc (Hot-C)



REMEMBER!!
 A flight risk assessment (GAR) needs to be completed prior to daily missions.

Region 1 CWN Helicopter GAR

Wind Restrictions

Flights above ground level	Flight Permitted in Winds Less than / Maximum Gust Spread	
More than 500' AGL	Type 1 Helicopters <50kts / Gusts: N/A	Type 2 Helicopters <50kts / Gusts: N/A
Less than 500' AGL	<40kts / Max Gust Spread: 15kts	<30kts / Max Gust Spread: 15kts
	Type 3 Helicopters <50kts / Gusts: N/A	<30kts / Max Gust Spread: 15kts

Approved by: /s/ Steven E. Chay AOBDD

INCIDENT RADIO COMMUNICATIONS PLAN (ICS 205)

1. Incident Name:		2. Date/Time Prepared:		3. Operational Period:		Date/Time to:				
COLT FIRE		08/05/2023 1800		08/06/2023		08/07/2023-0600				
4. Basic Radio Channel Use:										
Zone Group	Ch #	Function	Channel Name/Trunked Radio	Assignment	RX Freq	RX Tone/NAC	TX Freq	TX Tone/NAC	Mode (A, D, or M)	Remarks
	1	TACTICAL	TAC 1	DIV A	166.7750	146.2	166.7750	146.2	A	DIVISION ASSIGNMENT- ALPHA
	2	TACTICAL	TAC 2	DIV E	168.2000	146.2	168.2000	146.2	A	DIVISION ASSIGNMENT- ECHO
	3	TACTICAL	TAC 3	DIV K	168.0500	146.2	168.0500	146.2	A	DIVISION ASSIGNMENT- KILO
	4	TACTICAL	TAC 4	DIV T	166.7250	146.2	166.7250	146.2	A	DIVISION ASSIGNMENT-TANGO
	5	TACTICAL	TAC 5		166.7750	107.2	166.7750	107.2	A	
	6	TACTICAL	TAC 6		168.2500	146.2	168.2500	146.2	A	
	7	TACTICAL	TAC 7	STRUCTURE	168.5250	146.2	168.5250	146.2	A	DIVISION ASSIGNMENT-STRUCTURE
	8	COMMAND	CMD 8	ALL DIVISIONS	169.7500	146.2	167.1000	146.2	A	RICHMOND PEAK
	9	COMMAND	CMD 9	ALL DIVISIONS	170.4125	146.2	165.9625	146.2	A	MORRELL MTN
	10	COMMAND	CMD 10	ALL DIVISIONS	170.0125	146.2	165.2500	146.2	A	BEAVER EVAC ZONE
	11	TACTICAL			168.6000	146.2	168.6000	146.2	A	
	12	TACTICAL			168.6000	107.2	168.6000	107.2	A	
	13	AIR TO GROUND	A/G CMD	AIR TO GROUND	168.4000	0.0	168.4000	0.0	A	AIR TO GROUND CMD
	14	AIR TO GROUND	BUCKETS	AIR TO GROUND	166.8250	0.0	166.8250	0.0	A	AIR TO GROUND BUCKETS
	15	MEDICAL	TAN	AIR AMBULANCE	155.3400	0.0	155.3400	156.7	A	MEDICAL - EMERGENCY ONLY
	16	AIR GUARD	AIR GRD	AIR GUARD	168.6250	0.0	168.6250	110.9	A	AIR GUARD - EMERGENCY ONLY
5. Special Instructions:										
Controlled Unclassified Frequency Information/Basic										
6. Prepared by (Communications Unit Leader)				Signature:						
ICS 205				Name: Todd Orr 208-891-7380				Date/Time: 08/05/2023-1500		
				IAP Page						

Colt Fire

Resource Advisory

Invasive Species Prevention

- If you are demobing today, please remember to go through the weed wash station. You will need to have a signed receipt for checkout.
- If you have a drafting hose, please go through the aquatic invasive species (AIS) station:
 1. soak drafting hose and foot valve in water with quat at least 10 minutes to decontaminate
 2. rinse in second tank and make sure the foot valve is not leaking
 3. dry your drafting hose and foot valve in the hot sun until completely dry to the touch before you switch incidents
- Decontaminating your drafting hose and foot valve prevents the spread of invasive species such as zebra mussel into other bodies of water

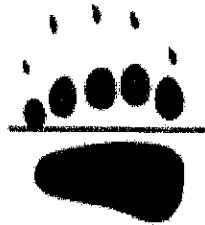

Grizzly bear



Black bear

Bear Safety

- Please be BEAR AWARE – There have been reports of bears on the line
- Do not keep anything smelly in your tent
- The Flathead and Lolo National Forests are under a food storage order
- All food either needs to be locked in a bear proof cooler or inside a locked vehicle at nighttime
- Toiletries need to be in a locked vehicle with windows rolled up
- There is bear spray available at supply

If you have any questions, please contact your Resource Advisors:

Geoff Bogie – Lead Resource Advisor – 406-214-9515

Autumn Keller – 406-720-3977

Aric Burt (t) – 406-493-5442

Anthony Butterfield (t) – 406-210-7960

FINANCE MESSAGE

- **All resources will turn in HARD COPY CTRs & Shift Tickets.** Shift Tickets & CTRs (and any finance-related documents) can be turned into a Finance drop box at Base Camp) located near the briefing area.
- **Extended Shifts** – Shifts exceeding 16 hours must be documented in the remarks of the CTR and/or Shift Ticket. Mitigation should also be documented in the remarks.
 - **Extended Shift EX.** “Extended shift on 7/20/23 due to critical firing operations on DIV A. Will return to 2:1 as soon as possible”.
 - **Mitigation Ex.** “Mitigated 1 hour on 8/01/23 from extended shift on 7/30/23”
- **Lunch Breaks!** Either show a lunch break or write a justification as to why you did not take one. (*MT DNRC/MT EFFs /MT Local Gov't resources are excluded*).
 - **EX.** “Unable to break for lunch due to ongoing firing operations”.

SHIFT TICKET CHECKLIST:

- **Signatures** – Shift Tickets require 2 signatures. Contractor/Cooperator AND Supervisor.
- **Transport Mileage** – If you have equipment with a transport, please write your mileage in the remarks of your shift ticket, even if the transport did not move.
- **Lunch Breaks** – Equipment on a daily rate must still show hours on the shift ticket. Include “1/2 hour lunch break” written in the remarks or special column.
- **Resource Order #** - Make sure your resource order number is written at the top-right corner of your shift ticket.
- **Incident Replacement for non-consumable items** – Requires a completed Northern Rockies property loss and damage form.

FINANCE CONTACTS

Incident E-mail: 2023.colt.finance@firenet.gov

FirstNet Phone #: 208-891-7423

UPCOMING DEMOBS

If you see an error on this list, or if an operator swap is planned, please ask your incident supervisor to get in touch with the Demob or Resource Unit.

DEMOB DATE	REQ #	RESOURCE NAME	KIND	TRV
08/06/2023	C-12	ALTA PACIFIC	CRW2	POV
08/06/2023	E-47	HETF - HETF INTERMOUNTAIN FOREST TECHN.	TASK	
08/06/2023	O-48	BACHE, WADE BENJAMIN	HEQB	AOV
08/07/2023	C-13	CRW2 - FOREST MANAGEMENT SPECIALIST LLC.	CRW2	POV
08/07/2023	C-6	CRW1 - SPRINGVILLE	CRW1	AOV
08/07/2023	C-7	VALYERMO IHC	CRW1	AOV
08/07/2023	E-74	DZR2 - RT LOGGING LLC - N02324	DZR2	POV
08/07/2023	E-75	DZR2 - NATHAN SMITH - W01328	DZR2	POV
08/07/2023	E-94	BROCKWAY ENGINE	ENG6	POV
08/07/2023	O-126	BURT, ARIC B	READ	AOV
08/07/2023	O-37	SUKO, DONOVAN D	TFLD	AOV
08/07/2023	O-39	SOHR, TRENT DANIEL	TFLD	AOV
08/07/2023	O-43	JENKINS, ANDREW W	HEQB	OTH
08/07/2023	O-46	ANDERSON, CALVIN OSMUND	HEQB	OTH
08/07/2023	O-47	BENSON, COLE	HEQB	AOV
08/07/2023	O-49	VANNICE, JAMES HAROLD JOSEPH	HEQB	AOV
08/07/2023	O-68	ALESSI, ADAM W	TFLD	AOV
08/07/2024	O-125	BUTTERFIELD, ANTHONY F	REAF	AOV
08/08/2023	C-10	CRWC - ANACONDA - CREW #4 - MOB # 1	CRWC	BUS
08/08/2023	C-15	CRW1 - LOLO IHC	CRW1	AOV
08/08/2023	E-103	GWT2 - BROWN SEPTIC, INC. - 383545	GWT2	POV
08/08/2023	E-60	PUP1 - JACK RINCK -	PUP1	AOV
08/08/2023	E-61	PUP1 - HENRY DELUCA	PUP1	AOV
08/08/2023	E-65	SKG2 - 24/7 LLC - 09-CAC	SKG2	POV
08/08/2023	E-82	WTS2 - RAINMAKERS IRRIGATION L.L.C. - 036068	WTS2	POV
08/08/2023	E-84	WTS2 - BILLINGSLEY, STAN TRUCKING - 83865P	WTS2	POV
08/08/2023	E-85	WTS2 - PETERSEN, INC. - 010202	WTS2	POV
08/08/2023	E-87	WTS2 - WILLISON, RANDALL B - 890246	WTS2	POV
08/08/2023	E-88	WTS2 - T2 - ST REGIS VFD - T-7 - Y96345	WTS2	AOV
08/08/2023	E-89	WTS2 - LINCOLN RURAL FIRE DISTRICT -	WTS2	AOV
08/08/2023	E-92	ENG6 - FSD1 - 611	ENG6	AOV
08/08/2023	E-93	ENG4 - WILDLAND FIRE SERVICES LLC - 661843	ENG4	POV
08/08/2023	O-102	ELANTRI, ALEXANDER JAMES	RADO	
08/08/2023	O-35	REED, MICHAEL	BCMG	
08/08/2023	O-41	HUBER, MATT	TFLD	AR
08/08/2023	O-42	DAVIS, CHARLES ROBERT	TFLD	AR
08/08/2023	O-51	BLATNEY, BRIAN ROBERT	EQPM	AR
08/08/2023	O-55	COVEY, OLIVA CHARLOTTE	RADO	AR
08/08/2023	O-63	JONES, RICK	SOFR	
08/08/2023	O-81	BYRD, DAVID CARL	GISS	AOV
08/08/2023	O-82	STARR, RONNA L	PTRC	



HUMAN RESOURCE MESSAGE

There is zero tolerance for harassment, alcohol, or federally prohibited substances on this fire incident.

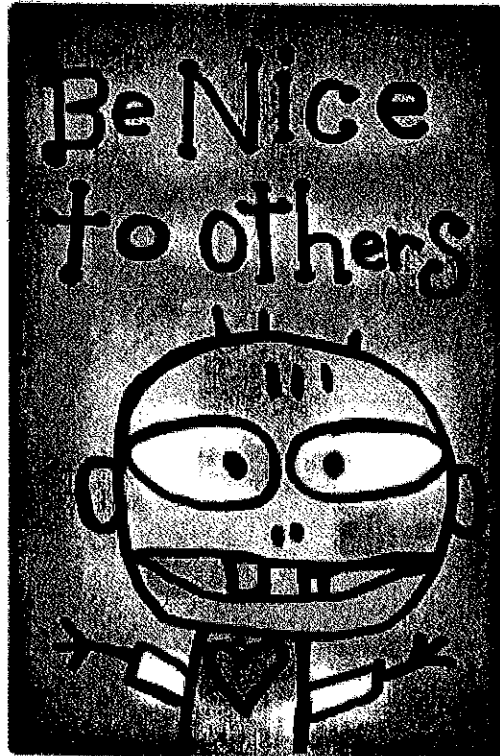

Hello!

I am Debby Hassel and I will be your HRSP on this fire.

If you have any issues, problems, or just want to talk, please call, text, or email me. I will be glad to talk with you or come and meet with you!

And remember...***Be nice to others!***

Debby Hassel, HRSP (979) 255-5513

hrspfire@gmail.com

Division Supply Order Colt Fire MT-SWS-200549

Order Number:		Date:		Division:	
Order taken in Communications by:				RADO or COML confirmation:	
DIVS Supervisor:				Date & Time Needed:	
Delivery Contact:				Delivery Location:	
Cell Phone #:				UTM	
Radio Channel Number:				Lat: Long:	
Mode of Delivery (Circle Means):		Ground Support		DP/LZ:	
Division will pick up		Deliver to Helibase		Other:	
SPUL Confirmation can be filled as needed (Circle): Yes or No - Requiring at least 24 hours to fill.					
Item	Description:	Quantity	Comments		
	Hose Lay Kit , 1000 Feet = (10) 1 1/2" Hose, and 5 Each of: 1" Hose, 1 1/2" Wyes, 1 1/2" to 1" Reducers, and 1" Forester Nozzles				
1		1000 Feet	4	4000 Feet	
2		2000 Feet	5	5000 Feet	
3		3000 Feet	6	6000 Feet	
	Garden Hose Kit , 500 Feet = (10) 3/4" Hose, and (5 Each): 3/4" Wye, 3/4" Shutoff, 3/4" Nozzle, 1" Wye, and 1" to 3/4" Reducers				
7		500 Feet	10	3000 Feet	
8		1000 Feet	11	4000 Feet	
9		2000 Feet	12	5000 Feet	
Water Handling Equipment:			Item #	Description	Quantity
13	Hose: 1/2" (100')	LG		Line Tools	
14	1" (100')	LG	40	Pulaski	EA
15	3/4" (50' Toy/Garden)	LG	41	Combi	EA
16	Gated Wye: 1 1/2"	EA	42	McCloud	EA
17	1"	EA	43	Shovel	EA
18	3/4"	EA	44	Water Cubies	EA
19	Reducer: 1 1/2" X 1"	EA	45	Bottled	CS
20	1" X 3/4"	EA	46	Gatorade	CS
21	Nozzle: 1" Forester	EA	47	MRE's	BX
22	1" Mystery (KK)	EA	48	Flagging: Lime Green	RO
23	1 1/2" Red Barrel	EA	49	Pink	RO
24	3/4" Brass	EA	50	Orange	RO
25	Shutoff Values: 3/4"	EA	51	Killer Tree	RO
26	Pumpkin or Porta-Tank, 1800 gal.	EA	52	Wrap, Structural	RO
27	Blivets, Slingable 55 Gal	EA	53	Other:	
28	Mopup Kits 3 Person	EA	54		
29	Backpack Pumps	EA	55		
30	Sprinkler Kits	EA	56		
31	Foam (5 GALS)	PL	57		
32	Mark III Kits	KT	58		
33	Drip Torch	EA	59		
34	Fusees (72/Case)	CS	60		
35	Chainsaw Kit	KT	61	Bar Oil	Gal
36	Fuel, 5 gallons:	Gas	Can	Diesel, 5 gallon	Can
37	Mark III (20:1)		Can		QT
38	Chainsaw (50:1)	Mixed	Can	Not Mixed	2.6 oz/ Gal
					12.8 oz/ 5 Gal
39	Drip Torch (3:2)		Can		BT

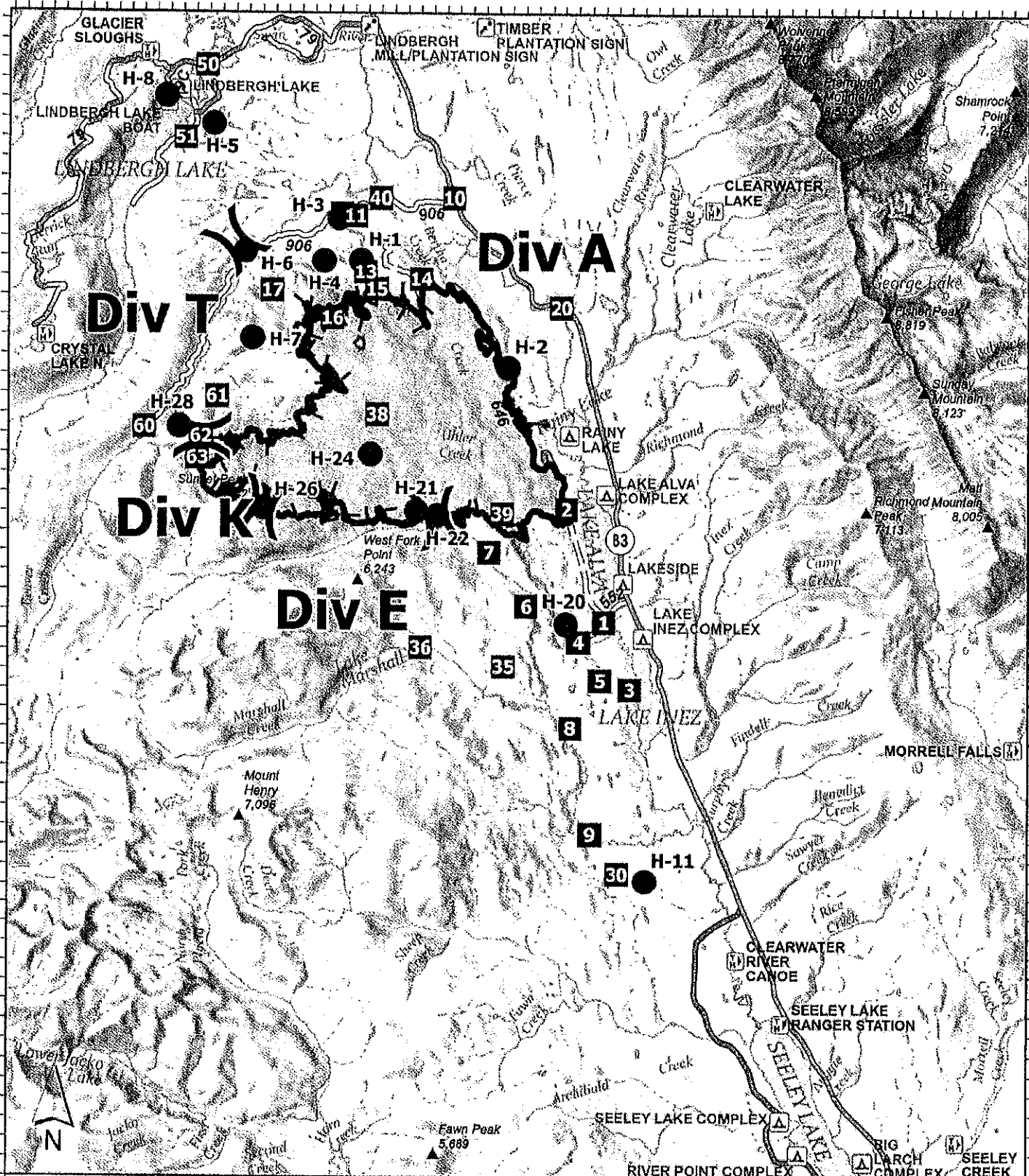

Transportation

Colt
 MT-SWS-200549
 7,179 acres

8/6/2023

Fire perimeter updated from
 IR on 8/3/2023 @ 2105hrs

- Label Point
- Drop Point
- ▭ Wildfire Daily Fire Perimeter
- ⚡ Dirt Road
- Helispot
- ▭ Contained
- ⚡ Paved
- ⚡ Unimproved Road
- ⊥ Division Break
- ▭ Uncontained
- ⚡ Gravel Road



NRI IIMT 1
 05/2023 1941
 North American 1983 Datum
 Lat,Long GCS

Fawn Fire Camp

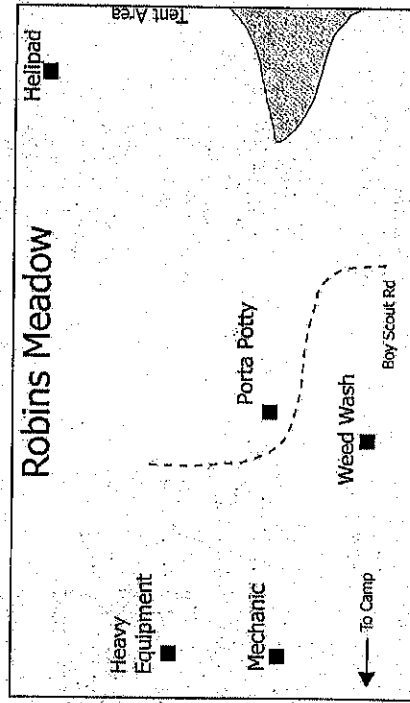
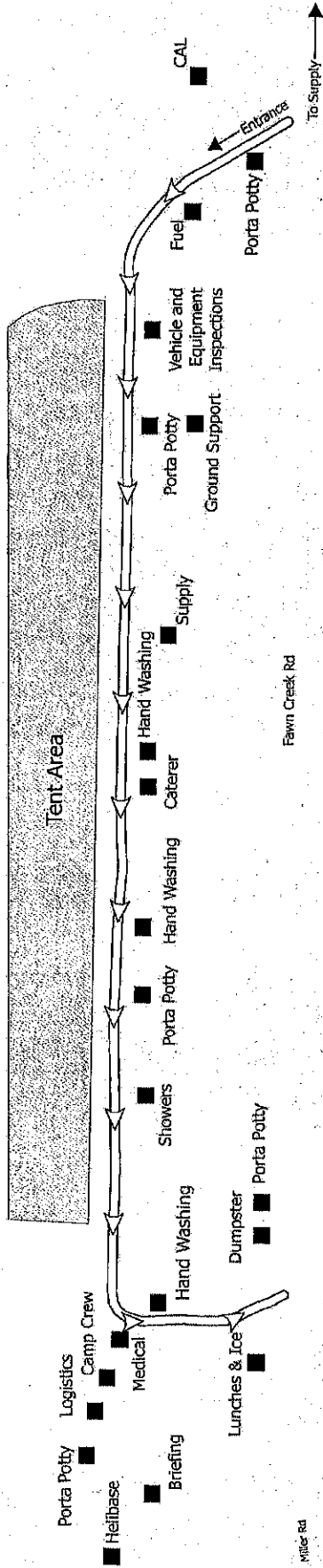

Seeley Elementary Map

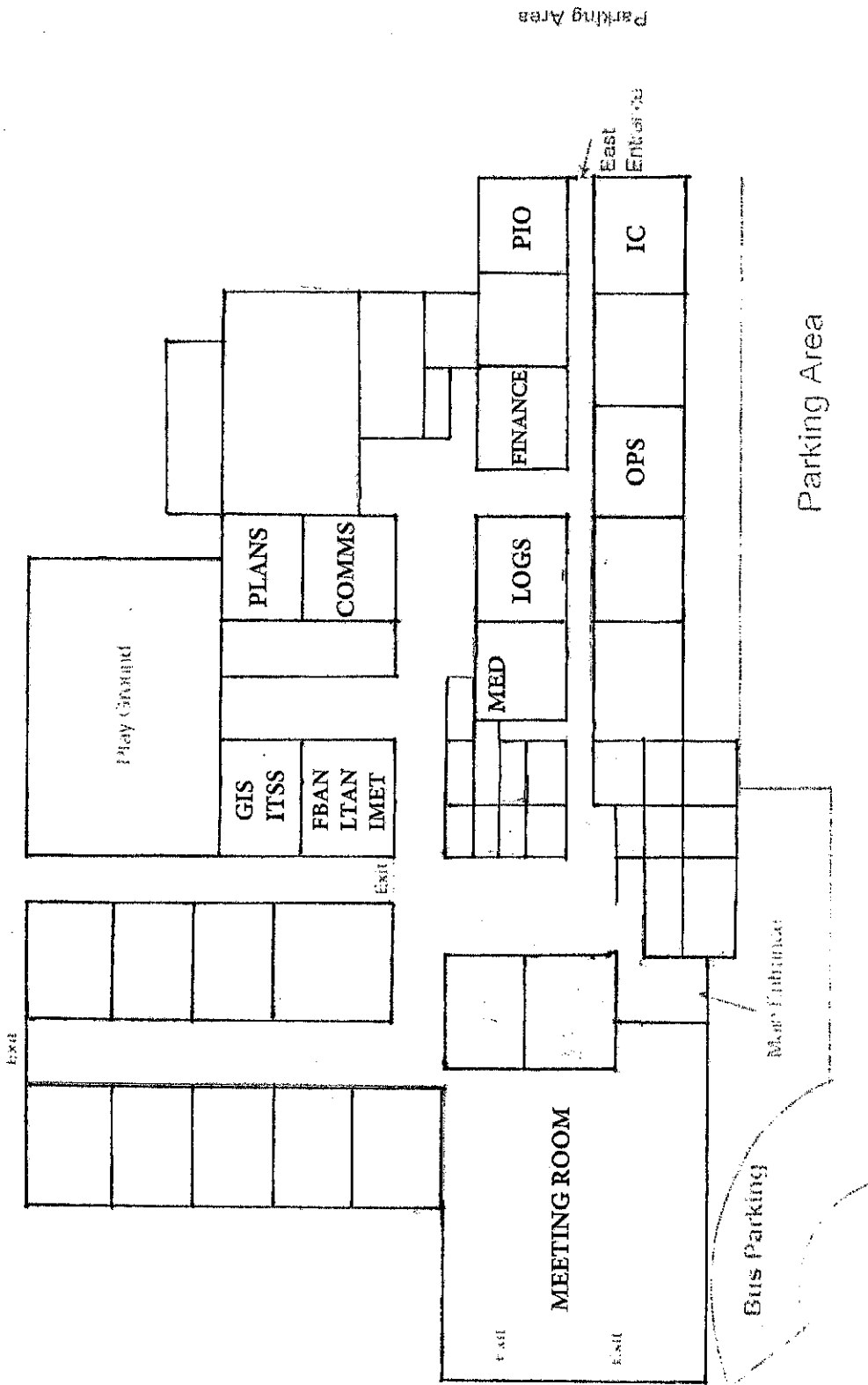

1. Incident/Project Name		2. Operational Period						
Colt Fire		Date/Time 08/06/2023						
3. Ambulance Services								
Ambulance	Complete Address	Phone & EMS Frequency	Advanced Life Support (ALS) Yes No					
Seeley Lake	200 Firehouse Rd Seeley Lake, MT	911/ MIDC	NO					
Missoula EMS	2680 Palmer St Missoula, MT	911/ MIDC	Yes					
4. Air Ambulance Services								
Name	Phone	Type of Aircraft & Capability						
Life Flight Network	911 or thru MIDC	Paramedics / Flight Nurse						
Two Bear Air	Flathead (406) 758-5610	Hoist capable, SAR, Paramedics, Flight nurses						
Alert	Kalispell (406) 752-9797	Paramedics / Flight Nurse						
5. Hospitals								
Name Complete Address	GPS Datum – WGS 84 Coordinate Standard Degrees Decimal Minutes DD° MM.MMM' N - Lat DD° MM.MMM' W - Long		Travel Time Air Gnd		Phone	Helipad Yes No		Level of Care Facility
	Lat:	Long:						
Logan Medical 32 Sunny View Lane, Kalispell, MT 59901	48 12.888 N	-114 19.4220 W	15	75	406-752-1733 (E.D.) Fax: 406-756-4717	yes		Level 2/3 will stabilize and fly to Level 1 or Burn Center as Appropriate. Will accommodate 2 aircraft
	VHF: 155.280 (White)							
Partnership Health Center 3050 Highway 83 Seeley Lake Montana 59868	47 9.8717 N	-113 28.4967 W	min	min	406-677-2277	<input checked="" type="checkbox"/>	<input type="checkbox"/>	Limited – CTF Clinic
	VHF:							
St. Patrick's Hospital 500 West Broadway Missoula, MT	46 52.528 N	-113 59.984 W	30	1 hr	(406) 543-7271 For Helipad: (406) 329-2620	<input checked="" type="checkbox"/>	<input type="checkbox"/>	Level 2 – RTC
	VHF: 155.280 Tone Tx 156.7							
Community Medical Fort Missoula Rd Missoula MT	46 50.9081 N	-112 02.8664 W	30	min	406-327-4171	<input checked="" type="checkbox"/>	<input type="checkbox"/>	Level 3
	VHF:							
Harborview Medical Seattle, WA	46 00.5407 N	-112 32.6620 W	4 hr	8 hr	206-744-3074 ER	<input checked="" type="checkbox"/>	<input type="checkbox"/>	Burn Center
	VHF:							
6. Division Branch Group	Area Location Capability							
Colt Fire ICP	EMS Responders & Capability:		MEDL- Levi Clymer MEDL- Seth Kirk MEDLT- Andi Colson					
	Fawn Helibase		Local 911 Response Ambo 4- BLS 4x4: Dave Lane 406-210-6354 Command 8					
Div A	EMS Responders		Ambo 1- ALS, 4x4: Matt Kerns EMPF, Parker Vaculik EMPF Medic Biederman- EMPF Medic Childers- EMPF EMT Dowd- EMTF Medic Batten- EMPF					
	Medical Emergency Channel		Command 8, TAC 1					
Div E	EMS Responders		EMT Smith- EMTF Back Country REMS- REMS					
	Medical Emergency Channel		Command 8, Tac 2					
Div K	EMS Responders		Ambo 3- ALS, 4x4: Taylor Morrissey EMPF, Misty Bauer EMTF EMT Rotella- EMTF					
	Medical Emergency Channel		Command 8, TAC 3					

Div T	EMS Responders	Ambo 2- ALS, 4x4 Michael Bedick AEMTF, Damaris Hagge EMPF EMT Adams- EMTF Medic Rahm- EMPF Minuteman REMS- REMS Medic Beard- EMPF
	Medical Emergency Channel	Command 8, TAC 5
Structure/IA X6 Water Tenders	EMS Responders	EMT Olson- EMTF EMT Procato- EMTF
	Medical Emergency Channel	COMMAND 8, TAC 7

7. Name & Location	Remote Camp Location(s)		
8. Prepared By (Medical Unit Leader)	9. Date/Time	10. Reviewed By (Safety Officer)	11. Date/Time
Jo-Anne Riley MEDLt	08/05/23	Leroy Holguin SOFC	08/05/23

Medical Incident Report – 8 Line

FOR A NON-EMERGENCY INCIDENT, WORK THROUGH CHAIN OF COMMAND TO REPORT AND TRANSPORT INJURED PERSONNEL AS NECESSARY.

FOR A MEDICAL EMERGENCY: IDENTIFY ON SCENE INCIDENT COMMANDER BY NAME AND POSITION AND ANNOUNCE "MEDICAL EMERGENCY" TO INITIATE RESPONSE FROM IMT COMMUNICATIONS/DISPATCH.

Use the following items to communicate situation to communications/dispatch.

1. CONTACT COMMUNICATIONS / DISPATCH (Verify correct frequency prior to starting report)

Ex: "Communications, Div. Alpha, Stand-by for Emergency Traffic."

2. INCIDENT STATUS: Provide incident summary (including number of patients) and command structure.

Ex: "Communications, I have a Red priority patient, unconscious, struck by a falling tree. Requesting air ambulance to Forest Road 1 at (Lat./Long.) This will be the Trout Meadow Medical, IC is TFLD Jones. EMT Smith is providing medical care."

Severity of Emergency / Transport Priority	<input type="checkbox"/> RED / PRIORITY 1 Life or limb threatening injury or illness. Evacuation need is IMMEDIATE Ex: Unconscious, difficulty breathing, bleeding severely, 2° – 3° burns more than 4 palm sizes, heat stroke, disoriented. <input type="checkbox"/> YELLOW / PRIORITY 2 Serious Injury or illness. Evacuation may be DELAYED if necessary. Ex: Significant trauma, unable to walk, 2° – 3° burns not more than 1-3 palm sizes. <input type="checkbox"/> GREEN / PRIORITY 3 Minor Injury or illness. Non-Emergency transport Ex: Sprains, strains, minor heat-related illness.	
Nature of Injury or Illness & Mechanism of Injury		Brief Summary of Injury or Illness (Ex: Unconscious, Struck by Falling Tree)
Transport Request		Air Ambulance / Short Haul/Hoist Ground Ambulance / Other
Patient Location		Descriptive Location & Lat. / Long. (WGS84)
Incident Name		Geographic Name + "Medical" (Ex: Trout Meadow Medical)
On-Scene Incident Commander		Name of on-scene IC of Incident within an Incident (Ex: TFLD Jones)
Patient Care		Name of Care Provider (Ex: EMT Smith)

3. INITIAL PATIENT ASSESSMENT: Complete this section for each patient as applicable (start with the most severe patient)

Patient Assessment:
See IRPG page 108

Treatment:

4. TRANSPORT PLAN:

Evacuation Location (if different): (Descriptive Location (drop point, intersection, etc.) or Lat. / Long.) Patient's ETA to Evacuation Location:

Helispot / Extraction Site Size and Hazards:

5. ADDITIONAL RESOURCES / EQUIPMENT NEEDS:

Example: Paramedic/EMT, Crews, Immobilization Devices, AED, Oxygen, Trauma Bag, IV/Fluid(s), Splints, Rope rescue, Wheeled litter, HAZMAT, Extrication

6. COMMUNICATIONS: Identify State Air/Ground EMS Frequencies and Hospital Contacts as applicable

Function	Channel Name/Number	Receive (RX)	Tone/NAC *	Transmit (TX)	Tone/NAC *
COMMAND					
AIR-TO-GRND					
TACTICAL					

7. CONTINGENCY: Considerations: If primary options fail, what actions can be implemented in conjunction with primary evacuation method? Be thinking ahead.

8. ADDITIONAL INFORMATION: Updates/Changes, etc.

REMEMBER: Confirm ETA's of resources ordered. Act according to your level of training. Be Alert. Keep Calm. Think Clearly. Act Decisively.

ACTIVITY LOG (ICS 214)

1. Incident Name: _____	2. Operational Period: Date From: _____ Date To: _____ Time From: _____ Time To: _____	
3. Name: _____	4. ICS Position: _____	5. Home Agency (and Unit): _____
6. Resources Assigned:		
Name	ICS Position	Home Agency (and Unit)
7. Activity Log:		
Date/Time	Notable Activities	
8. Prepared by: Name: _____ Position/Title: _____ Signature: _____		
ICS 214, Page 1		Date/Time: _____

