

INCIDENT ACTION PLAN

Ridge Fire

MT-FNF-000518

P1QGT5 (0110)



Sunday

OPERATIONAL PERIOD

08/13/23

0600 – 1800



INTENTIONALLY LEFT BLANK

INCIDENT OBJECTIVES (ICS 202)

| | | | |
|--|-------------------------------|---|-------------------------------------|
| 1. Incident Name: <p style="text-align: center;">RIDGE FIRE</p> | 2. Operational Period: | Date From: 8/13/2023 Time From: 0600 | Date To: 8/14/2023 Time To: 0600 |
|--|-------------------------------|---|-------------------------------------|

3. Objective(s):

- Management Objectives**
- Manage risk to responders by ensuring hazards are identified, assessed, and mitigated.
 - Minimize impact to economy, property, and infrastructure.
 - Minimize impact to natural, cultural, wildlife and heritage resources.
 - Mitigate or eliminate environmental resource impacts as a result of fire suppression efforts.
 - Ensure coordinated, timely and accurate release of public information.
 - Foster and maintain relationships with all cooperators and stakeholders.
 - Maintain fiscal accountability and keep costs commensurate with values at risk.

- Control Objectives**
- North of Fire Service Road 38
 - South of Great Bear Wilderness
 - East of the communities along Highway 2
 - West of Tiger Creek

- Command Emphasis**
- Continue safe coordinated operations.

- General Safety Message**
- If everyone is moving forward together then success takes care of itself.

5. Site Safety Plan Required? Yes No

Approved Site Safety Plan(s) Located at:

- 6. Incident Action Plan**
- | | | | |
|---|--|--|--|
| <input checked="" type="checkbox"/> ICS 203 | <input checked="" type="checkbox"/> ICS 214 | <input checked="" type="checkbox"/> HR Message | <input checked="" type="checkbox"/> Bear Information |
| <input checked="" type="checkbox"/> ICS 204 | <input checked="" type="checkbox"/> ICS 215A | <input checked="" type="checkbox"/> Finance Message | <input type="checkbox"/> |
| <input checked="" type="checkbox"/> ICS 205 | <input checked="" type="checkbox"/> ICS 220 | <input checked="" type="checkbox"/> Public Information | <input type="checkbox"/> |
| <input checked="" type="checkbox"/> ICS 206 | <input checked="" type="checkbox"/> Weather Forecast | <input checked="" type="checkbox"/> Training Message | <input type="checkbox"/> |
| <input checked="" type="checkbox"/> ICS 208 | <input checked="" type="checkbox"/> Fire Behavior | <input checked="" type="checkbox"/> Demob Message | <input checked="" type="checkbox"/> Base Camp Map |

| | | |
|---|-------------------------------|-------------------|
| 7. Prepared By: Jeremy Camacho (T) | Position/Title: PSC | Signature: |
| 8. Approved by Incident Commander: | Rocky W. Opliger / Jake Cagle | Signature: ICS 1 |

ORGANIZATION ASSIGNMENT LIST (ICS 203)

| | | | | | |
|--|---|---|---|--|--|
| 1. Incident Name: RIDGE FIRE | | 2. Operational Period: Date From: 8/13/2023 Time From: 0600 | | Date To: 8/13/2023 Time To: 1800 | |
| 3. Incident Commander(s) and Command Staff: | | | 7. Operation Section: | | |
| IC/UC's | Rocky W. Opliger / Jake Cagle(T) | Operations | David Pereira / Kyle Jacobson / Drew Graham / Kerri Williamson(T) | | |
| Deputy | Mike Nobles | Deputy Operations | | | |
| Safety Officer | Michael Alforque / Mike Huneke(T) | Night Ops | | | |
| Information Officer | Sean Collins / Stephanie Bishop / Darren McMillin / Derek Tisinger / Sonny Saghera / Thanh Nguyen | Staging Area | | | |
| Liaison Officer | Jason Collier / Sam Wilbanks | Branch | | | |
| HRSP | Adam Alvarez | Division/Group | A | Ryan Regelin / Mike Greer(T) | |
| 4. Agency/Organization Representatives: | | Division/Group | G | Grahm Rice / Steve Houser(T) | |
| Agency/Organization | Name | Division/Group | M | Todd Ruzicka | |
| MT-FNF AA | Rob Davies | Division/Group | W | Unstaffed | |
| MT-FNF AA (T) | Bill Mullholland (Primary) | Division/Group | STRUCTURE | Carrie Thaler / Nathan Basford(T) | |
| IBA MT-FNF | Biddy Simet | Division/Group | CONTINGENCY | Adam Booth | |
| Flathead County Sheriff | Bian Heino | Division/Group | | | |
| NPS Glacier | David Roemer | Division/Group | | | |
| IARR | Matt Dillon | Branch | | | |
| IARR | Dan Anerino | Division/Group | | | |
| Coram Experimental Forest | David Wright | Division/Group | | | |
| CCC AREP | Miguel Diaz | Division/Group | | | |
| | | Division/Group | | | |
| | | Branch | | | |
| | | Division/Group | | | |
| | | Division/Group | | | |
| | | Division/Group | | | |
| 5. Planning Section: | | Division/Group | | | |
| Chief | Joe Scuri / Jeremy Camacho(T) | Division/Group | | | |
| Deputy | Thomas Reaves(T) | Branch | | | |
| Resource Unit | Sergio Arjonilla / Ryan Da Rosa(T) / Dwayne Preston(T) / Jeff Oliver(T) | Division/Group | | | |
| Situation Unit | Michael Hoose / Damian Guilliani / Jan Hamer / Daniel Eiszele | Division/Group | | | |
| Lead READ | Chris Hoge | Division/Group | | | |
| Documentation Unit | Emil Picchi (Virtual) | Division/Group | | | |
| Demobilization Unit | Jeffrey Ferguson | Air Operations Branch | Director: | Staci Dickson | |
| GISS | Matthew Eister / Erin Opliger / Travis Coughlin / Chris Barrett | Air Support Group Supervisor | | Rita Clipperton / Roger Caballero(T) | |
| FBAN | Diondray Wiley | Air Tactical Group Supervisor | | Jay Walter | |
| IMET | Bob Hoenisch | | | | |
| Training Tech Spec | Emil Picchi (Virtual) | | | | |
| SCKN | Bob Bundy(T) / Ben Turcea(T) | | | | |
| 6. Logistics Section | | | | | |
| Chief | Cheryl Raines / Jennifer Wells(T) | | | | |
| Supply Unit | Jennifer Armstrong | 8. Finance/Administration Section: | | | |
| Facilities Unit | Martie Hale / Adam Briggs(T) | Chief | Judy Reynolds / Vicki Wilson | | |
| Ground Support Unit | Jeff Burch / Ronald Brewer | Time Unit | Sheila Miner | | |
| Communications Unit | Salvador Bonilla Jr. / Kevin Janes | Procurement Unit | Craig Ericson | | |
| Medical Unit | Erick Williams / Nick Arnett / Jeffrey Brooks(T) / Samuel Crenshaw(T) | Comp/Claims Unit | Scott Parsons | | |
| Security Manager | Kevin Arnold | Cost Unit | Tami Monahan | | |
| RCDM | Aron Levin | EQTR | Loni Holt / Evelyn Trujillo (Virtual) | | |
| Prepared By: Name: | Ryan Da Rosa | Position/Title: | RESL(T) | Signature: <i>Ryan Da Rosa</i> | |
| ICS 203 | | Date/Time: | 8/12/2023 2300 hours | | |



Ridge Fire Weather Forecast

FORECAST NO: 5
PREDICTION FOR: Sunday
SHIFT DATE: 08/13/23
FORECAST ISSUED: 08/12/23 at 2000 MDT

NAME OF FIRE: Ridge
UNIT: MT-FHA
SIGNED: Bob Hoenisch - Incident Meteorologist
text/email obs: 406-899-4112/robert.hoenisch@noaa.gov

WEATHER DISCUSSION: A strong ridge of high pressure building across the Pacific Northwest will continue the gradual warming and drying trend today with more significant heat and dryness developing Monday. Temperatures today will be up 3-5 degrees from yesterday and humidity down 3-5% with humidity recovery tonight not as good as recent days at mid-upper slope locations. Winds over ridgetops will be from the north today with generally light terrain-driven winds prevailing across lower slopes and drainages.

TODAY:

SKY/WEATHER: Mostly sunny.
Max Temperature: 83-88 lower elevations (below 4500 ft) and 78-83 mid-slopes to ridges.
Min RH: 18-23% lower elevations (below 4500 ft) and 23-28% mid-slopes to ridges.
20 ft WINDS: Slope/Valley - Becoming upslope/up-drainage 4-9 mph by 1200.
Ridgetop - North 5-10 mph with a few afternoon gusts to 20 mph.
LAL: 1 **Chance of Wetting Rain (0.10"):** Zero **HAINES INDEX: 3 (Very Low)**

TONIGHT:

SKY/WEATHER: Mainly clear.
Min Temperature: 49 to 54.
Max RH: 65-75% valleys and drainage bottoms, 55-65% mid-slopes to ridgetops.
20 ft WINDS: Slope/Valley - Becoming downslope/down-drainage 3-8 mph by 2000.
Ridgetop - North 6-12 mph.
LAL: 1 **Chance of Wetting Rain (0.10"):** Zero

Outlook for MONDAY:

SKY/WEATHER: Mostly sunny.
Max Temperature: 90-95 lower elevations (below 4500 ft) and 84-89 mid-slopes to ridges.
Min RH: 16-21% lower elevations (below 4500 ft) and 21-26% mid-slopes to ridges.
20 ft WINDS: Slope/Valley - Becoming upslope/up-drainage 4-9 mph by 1200.
Ridgetop - West 6-12 mph with a few afternoon gusts to 20 mph.

Extended Forecast Discussion: Very warm and dry conditions develop Monday and persist through at least Wednesday with Tuesday likely having the hottest temperatures and lowest humidity and only moderate to poor overnight humidity recovery. Elevated to critical fire weather conditions are possible Tuesday with the potential for gusty ridgetop winds.

| 8/12/2023 observations thru 2000 | Min Temp | Max RH | Max Temp | Min RH | Peak Wind | Precipitation |
|----------------------------------|----------|--------|----------|--------|-----------|---------------|
| Spotted Bear LO (7202') | 51 | 58% | 65 | 39% | SW 23 mph | 0.00" |
| Fielding RAWS (4641') | 49 | 77% | 76 | 29% | W 20 mph | 0.00" |
| West Glacier RAWS (3165') | 46 | 99% | 82 | 32% | W 12 mph | 0.00" |
| Hungry Horse RAWS (3123') | 48 | 94% | 83 | 25% | W 17 mph | 0.00" |

FIRE BEHAVIOR FORECAST

| | |
|---|--|
| FORECAST NUMBER: 5 | TYPE OF FIRE Wildfire |
| FIRE NAME: Ridge | OPERATIONAL PERIOD Sunday August 13, 2023 |
| DATE ISSUED Saturday August 12, 2023 | TIME ISSUED 2100 |
| UNIT MT-Flathead National Forest | SIGNED Diondray Wiley, Fire Behavior Analyst (FBAN) |

INPUTS

WEATHER SUMMARY

WEATHER: Mostly Sunny

MAX TEMP: Below 4500ft 83-88° mid-slope and ridge tops 78-83°.

Humidity: Below 4500ft 18-23% mid-slope and ridge tops 23-28%.

20 FOOT WINDS: Valleys/Lower Slope: Becoming upslope/up-drainage 4-9 mph by 1200

Ridge/Upper slope: North 5-10 mph with a few afternoon gust to 20 mph

Haines 3 LAL 1

FUELS: The major fuel types, found in and around the fire area include compact timber stands, timber Understory, brush and heavy down and dead.

Ignition Receptiveness: ERC: 34= 90th percentile. Burn Index: 27 just below the 90th percentile.

Probability of Ignition: 87-89% **Spotting distance:** Ridge top timber .4 mile, brush .2 mile

Dryness: Dead and down fuel moistures: 1 hour – 3% 10 hour-17%, 100 hour -16%, 1000 hour-17%.

FIRE BEHAVIOR

Today's fire environment will be like the previous days operational period. The potential continually exists for fire activity to increase. Note the new development in the probability of ignition, heavy equipment can ignite a new start. In the absents of active fire behavior, be mindful of the numerous environmental hazards at your work location (soft shoulders on highly traveled roads, snags, animals etc.).

SPECIFIC FIRE BEHAVIOR:

Division A: Minimal fire activity, backing, interior smoldering and creeping. Possible flare-ups and roll-out within indirect lines.

Division G: Minimal fire activity, interior smoldering and creeping. Potential for roll-out and flare-ups. Backing with slow rate of spread.

Division M: Minimal fire activity, interior smoldering and creeping. Backing with slow rate of spread.

Division W: (unstaffed) Minimal fire activity, interior smoldering and creeping. Backing with slow rate of spread.

Aviation Safety/ Watchout:

Is there pressure to complete a mission at all costs.

Safety Message/ Watch Out Situations:

Terrain and fuels make escape to safety zones difficult!

ASSIGNMENT LIST (ICS 204 WF)

CONTROLLED UNCLASSIFIED
INFORMATION//BASIC

| | | |
|--|---|---|
| 1. Incident Name: <p style="text-align: center;">RIDGE FIRE</p> | 2. Operational Period: Date From: 08/13/23 Date To: 08/13/23 Time From: 0600 Time To: 1800 | 3. Branch Division <p style="text-align: center;">A</p> |
|--|---|---|

| | |
|---|---|
| 4. Operations Personnel: Operations Section Chief: David Pereira / Kyle Jacobson / Drew Graham / Kerri Williamson(T) Branch Director: Division/Group Supervisor: Ryan Regelin / Mike Greer(T) | Night Ops: Branch Safety: Air Attack: Jay Walter |
|---|---|

| 5. Resources Assigned: | | ** Resources Below in Bold are 12 Hour ** | | | | | |
|------------------------|-----|---|--------------------------|-----------|--------------|------------------|--------------------|
| Resource Identifier | ALS | LWD | Leader | Personnel | Request # | Hours | Reporting Location |
| CRW1 ALTA IHC | | 8/21 | BOGDANOFF, BRYAN | 22 | C-11 | 0600-1800 | River Ranch ICP |
| CRW2IA KEYSTONE | | 8/20 | NOVITSKY, JACOB | 21 | C-7 | 0600-1800 | River Ranch ICP |
| CRW2IA GREAT NORTHERN | | 8/14 | CUMMINGS, SAMUEL | 18 | C-1 | 0600-1800 | River Ranch ICP |
| CRW2 MARLETTE PEAK | | 8/26 | FOSTER, JASON | 23 | C-9 | 0600-1800 | River Ranch ICP |
| CRW2 R&R 3 | | 8/16 | CASTRO, JOSE | 20 | C-3 | 0600-1800 | River Ranch ICP |
| CRW2 R&R 2 | | 8/16 | CISNEROS, BERNABE | 20 | C-2 | 0600-1800 | River Ranch ICP |
| ENG3 SOLOMON | | 8/23 | SOLOMON, TODD | 3 | E-97 | 0600-1800 | River Ranch ICP |
| *ENG4 MT-FNF-E462 | | | BARCLAY | 3 | | 0600-1800 | River Ranch ICP |
| ENG6 - MOMTF E611 | | 8/20 | CORTES, BRANDON | 3 | E-120 | 0600-1800 | River Ranch ICP |
| *ENG6 MT-FNF-E671 | | | SIROIS | 3 | | 0600-1800 | River Ranch ICP |
| ENG6 - WHITEFISH | | 8/20 | HARTMAN, GLEN | 2 | E-121 | 0600-1800 | River Ranch ICP |
| ENG6 UTASF E611 | | 8/19 | BELGE, ZACHARY | 5 | E-41 | 0600-1800 | River Ranch ICP |
| WTT2 WEBER FD | | 8/20 | SEXTON, THOMAS | 2 | E-56 | 0600-1800 | River Ranch ICP |
| WTT2 UCON FD | | 8/23 | NORMAN, KENDALL | 2 | E-99 | 0600-1800 | River Ranch ICP |
| WTS2 WALKING Y4 | | 8/16 | MUTCHLER, CHRIS | 1 | E-27 | 0600-1800 | River Ranch ICP |
| DOZ2 SIKES | | 8/24 | SIKES, GREG | 2 | E-107 | 0600-1800 | River Ranch ICP |
| SKG2 DENNISON | | 8/23 | DENNISON, LARRIK | 2 | E-90 | 0600-1800 | River Ranch ICP |
| SKG3 SCHLEGEL | | 8/22 | HUNT, NATHAN | 2 | E-89 | 0600-1800 | River Ranch ICP |

6. Work Assignments:
Construct direct line from Emery Creek to the 590E road.
Mop-up and secure control lines to the extent necessary to keep the fire in its current footprint.

7. Special Instructions:
Before doing work in the Coram Experimental Forest, Coordinate with the READ, David Wright (406) 531-0980.
REAFs will be working throughout all divisions.
REAFs and READs will contact division when they enter and exit divisions.
*Denotates local lent resource.

8. Communications

| Name | Ch | Function | Rx Freq | Rx Tone | Tx Freq | Tx Tone | Mode | Notes |
|-----------|----|----------------|-----------|-------------|-----------|-------------|------|------------------------|
| CMD RPT | 6 | COMMAND | 167.2500N | (T10) 107.2 | 162.2625N | (T10) 107.2 | A | RIDGE COMMAND REPEATER |
| TAC 1 | 1 | TACTICAL | 172.2250N | (T10) 107.2 | 172.2250N | (T10) 107.2 | A | |
| RIDGE A/G | 10 | A/G | 173.8375N | 0.0 | 173.8375N | (T2) 123.0 | A | RIDGE A/G PRIMARY |
| TAN | 15 | MT MEDICAL A/G | 155.3400N | 0.0 | 155.3400N | (T6) 156.7 | A | LOCAL MEDICAL A/G |
| AIRGUARD | 16 | AIRGUARD | 168.6250 | 0.0 | 168.6250 | (T1) 110.9 | A | EMERGENCY CONTACT |

9. Prepared by: Name: Sergio Arjonilla / Ryan Da Rosa(T) / Dwayne Preston(T) / Jeff Oliver(T) RESL Signature: _____

ICS 204 Date/Time: 8/12/2023 2200 Personnel Count: 148

ASSIGNMENT LIST (ICS 204 WF)

CONTROLLED UNCLASSIFIED
INFORMATION//BASIC

| | | | | | | | | | | |
|--|-----|---|--|-------------------|--------------|---|------------------------|------------------------|--|--|
| 1. Incident Name: | | 2. Operational Period: | | | | 3. Branch | | Division | | |
| RIDGE FIRE | | Date From: 08/13/23 | | Date To: 08/13/23 | | G | | Golf | | |
| | | Time From: 0600 | | Time To: 1800 | | | | | | |
| 4. Operations Personnel: | | | | | | Page 1 of 1 | | | | |
| Operations Section Chief: David Pereira / Kyle Jacobson / Drew Graham / Kerri Williamson(T) Branch Director: Division/Group Supervisor: Grahm Rice / Steve Houser(T) | | | | | | Night Ops: Branch Safety: Air Attack: Jay Walter | | | | |
| 5. Resources Assigned: | | | ** Resources Below in Bold are 12 Hour ** | | | | | | | |
| Resource Identifier | ALS | LWD | Leader | Personnel | Request # | Hours | Reporting Location | | | |
| CRW1 PLUMAS IHC | | 8/20 | SHERMAN, MIKE | 19 | C-10 | 0600-1800 | RIVER RANCH ICP | | | |
| CRW1 LEWIS & CLARK IHC | | 8/24 | WYDRA, NICHOLAS | 22 | C-14 | 0600-1800 | RIVER RANCH ICP | | | |
| CRW1 SMITH RIVER IHC | | 8/24 | DENLINGER, DOUGLAS | 21 | C-15 | 0600-1800 | RIVER RANCH ICP | | | |
| CRW2IA TETON IHC | | 8/21 | KULLA, TYLER | 22 | C-8 | 0600-1800 | RIVER RANCH ICP | | | |
| CRW2IA - MIDEWIN | | 8/25 | HOFFMAN, JERRY | 19 | C-16 | 0600-1800 | RIVER RANCH ICP | | | |
| ENG3 SHERIDAN | | 8/25 | SHERIDAN, BOB | 4 | E-110 | 0600-1800 | RIVER RANCH ICP | | | |
| ENG3 AAA FORESTRY | | 8/25 | MIX-CATRON, JEFF | 3 | E-112 | 0600-1800 | RIVER RANCH ICP | | | |
| ENG3 CASTLE MOUNTAIN | | 8/25 | TILLER, JOHN | 3 | E-111 | 0600-1800 | RIVER RANCH ICP | | | |
| ENG3 LL MEADOW WILDFIRE | | 8/25 | GRACIE, REED | 3 | E-109 | 0600-1800 | RIVER RANCH ICP | | | |
| WTS2 ROCKY MOUNTAIN | | 8/19 | LODGE, CRAIG | 1 | E-63 | 0600-1800 | RIVER RANCH ICP | | | |
| WTS2 R2K ENTERPRISES | | 8/15 | BIRD, HIRAM | 1 | E-26 | 0600-1800 | RIVER RANCH ICP | | | |
| WTS2 MARTIN CITY | | 8/13 | TORPIN, TOM | 2 | E-61 | 0600-1800 | RIVER RANCH ICP | | | |
| EMPF SCHMIDT | | 8/24 | SCHMIDT, RODNEY | 1 | O-96 | 0600-1800 | RIVER RANCH ICP | | | |
| EMTF GRIFFITH | | 8/25 | GRIFFITH, HAYDEN | 1 | O-116 | 0600-1800 | RIVER RANCH ICP | | | |
| MEDV UTV MEDICS | | 8/21 | GREGOR, RYAN | 3 | O-63 | 0600-1800 | RIVER RANCH ICP | | | |
| 6. Work Assignments: | | | | | | | | | | |
| Construct direct line on the West side of the fire to Emery Ridge. | | | | | | | | | | |
| Mop-up and secure control lines to the extent necessary to keep the fire in its current footprint. | | | | | | | | | | |
| 7. Special Instructions: | | | | | | | | | | |
| Before doing work in the Coram Experimental Forest, Coordinate with the READ, David Wright (406) 531-0980. | | | | | | | | | | |
| REAFs will be working throughout all divisions. | | | | | | | | | | |
| REAFs and READs will contact division when they enter and exit divisions. | | | | | | | | | | |
| 8. Communications | | | | | | | | | | |
| Name | Ch | Function | Rx Freq | Rx Tone | Tx Freq | Tx Tone | Mode | Notes | | |
| CMD RPT | 6 | COMMAND | 167.2500N | (T10) 107.2 | 162.2625N | (T10) 107.2 | A | RIDGE COMMAND REPEATER | | |
| TAC 2 | 2 | TACTICAL | 172.3750N | (T10) 107.2 | 172.3750N | (T10) 107.2 | A | | | |
| RIDGE A/G | 10 | A/G | 173.8375N | 0.0 | 173.8375N | (T2) 123.0 | A | RIDGE A/G PRIMARY | | |
| TAN | 15 | MT MEDICAL A/G | 155.3400N | 0.0 | 155.3400N | (T6) 156.7 | A | LOCAL MEDICAL A/G | | |
| AIRGUARD | 16 | AIRGUARD | 168.6250 | 0.0 | 168.6250 | (T1) 110.9 | A | EMERGENCY CONTACT | | |
| 9. Prepared by: Name: | | Sergio Arjonilla / Ryan Da Rosa(T) / Dwayne Preston(T) / Jeff Oliver(T) | | | | RESL | | | | |
| | | | | | | Signature: _____ | | | | |
| ICS 204 | | Date/Time: 8/12/2023 2200 | | | | Personnel Count: 120 | | | | |

ASSIGNMENT LIST (ICS 204 WF)

CONTROLLED UNCLASSIFIED
INFORMATION//BASIC

| | | | | | | | | | |
|--|-----|-------------------------------|--|-------------------|-------------------------------|---------------------|--------------------|------------------------|--|
| 1. Incident Name: | | 2. Operational Period: | | | | 3. Branch | | Division | |
| RIDGE FIRE | | Date From: 08/13/23 | | Date To: 08/13/23 | | CONTINGENCY | | Page 1 of 2 | |
| | | Time From: 0600 | | Time To: 1800 | | | | | |
| 4. Operations Personnel: | | | | | | | | | |
| Operations Section Chief: David Pereira / Kyle Jacobson / Drew Graham / Kerri Williamson(T) | | | | | Night Ops: | | | | |
| Branch Director: | | | | | Branch Safety: | | | | |
| Division/Group Supervisor: Adam Booth | | | | | Air Attack: Jay Walter | | | | |
| 5. Resources Assigned: | | | ** Resources Below in Bold are 12 Hour ** | | | | | | |
| Resource Identifier | ALS | LWD | Leader | Personnel | Request # | Hours | Reporting Location | | |
| ENG6 BRENTESON RANCH | | 8/23 | RIPHENBURG, SHAUN | 3 | E-95 | 0600-1800 | RIVER RANCH ICP | | |
| DOZ2 SIDERIUS | | 8/14 | SIDERIUS, DAN | 2 | E-1 | 0600-1800 | RIVER RANCH ICP | | |
| SKG3 ROCKY MOUNTAIN | | 8/21 | MEYER, JUELLA | 2 | E-67 | 0600-1800 | RIVER RANCH ICP | | |
| MAST2 J3 CONTRACTING | | 8/21 | GRANT, WILLIAM | 2 | E-84 | 0600-1800 | RIVER RANCH ICP | | |
| FEL1 TAMARACK TIMBER | | 8/18 | GEORGE, SHELBY | 1 | E-21 | 0600-1800 | RIVER RANCH ICP | | |
| FEL2 GRIZZLY LOGGING | | 8/22 | GLAIZER, HAROLD | 2 | E-100 | 0600-1800 | RIVER RANCH ICP | | |
| HETF EQUIPMENT TECH | | 8/24 | MAYO, MATT | 8 | E-101 | 0600-1800 | RIVER RANCH ICP | | |
| HETF SIDERIUS | | 8/14 | SIDERIUS, DAN | 7 | E-2 | 0600-1800 | RIVER RANCH ICP | | |
| HETF TOUGH GO | | 8/18 | MILLER, RUSS | 6 | E-50 | 0600-1800 | RIVER RANCH ICP | | |
| LOGL BAZCO | | 8/23 | REIBER, BRANDON | 2 | E-92 | 0600-1800 | RIVER RANCH ICP | | |
| LOGL BAZCO #1 | | 8/23 | HAYNES, COLTON | 2 | E-93 | 0600-1800 | RIVER RANCH ICP | | |
| LOGL SLACK | | 8/18 | SLACK, JAMIE | 1 | E-34 | 0600-1800 | RIVER RANCH ICP | | |
| LOGL SIDERIUS | | 8/17 | CLOUSE, BRANDON | 1 | E-35 | 0600-1800 | RIVER RANCH ICP | | |
| TFLD BUSSEY | | 8/14 | BUSSEY, NOLAN | 1 | O-28 | 0600-1800 | RIVER RANCH ICP | | |
| TFLD KOZICKY | | 8/17 | KOZICKY, YURI | 1 | O-16 | 0600-1800 | RIVER RANCH ICP | | |
| TFLD HAMILTON (T) | | 8/15 | HAMILTON, CASEY | 1 | O-3 | 0600-1800 | RIVER RANCH ICP | | |
| HEQB GANSBERG | | 8/16 | GANSBERG, ISAAC | 1 | O-2 | 0600-1800 | RIVER RANCH ICP | | |
| 6. Work Assignments: | | | | | | | | | |
| Continue implementation of contingency control lines from DP 18 to Highway 2. | | | | | | | | | |
| 7. Special Instructions: | | | | | | | | | |
| 8. Communications | | | | | | | | | |
| Name | Ch | Function | Rx Freq | Rx Tone | Tx Freq | Tx Tone | Mode | Notes | |
| CMD RPT | 6 | COMMAND | 167.2500N | (T10) 107.2 | 162.2625N | (T10) 107.2 | A | RIDGE COMMAND REPEATER | |
| TAC 3 | 3 | TACTICAL | 154.3025N | (T10) 107.2 | 154.3025N | (T10) 107.2 | A | | |
| RIDGE A/G | 10 | A/G | 173.8375N | 0.0 | 173.8375N | (T2) 123.0 | A | RIDGE A/G PRIMARY | |
| TAN | 15 | MT MEDICAL A/G | 155.3400N | 0.0 | 155.3400N | (T6) 156.7 | A | LOCAL MEDICAL A/G | |
| AIRGUARD | 16 | AIRGUARD | 168.6250 | 0.0 | 168.6250 | (T1) 110.9 | A | EMERGENCY CONTACT | |
| 9. Prepared by: Name: | | | | | | | | | |
| Sergio Arjonilla / Ryan Da Rosa(T) / Dwayne Preston(T) / Jeff Oliver(T) | | | | | RESL | | | | |
| Signature: _____ | | | | | | | | | |
| ICS 204 | | Date/Time: 8/12/2023 2200 | | | | Personnel Count: 43 | | | |

INTENTIONALLY LEFT BLANK

ICS 205 - INCIDENT RADIO COMMUNICATIONS PLAN

| | | | | | | | |
|---|--|--|--|---|--|------------------------------------|--|
| 1. Incident Name: RIDGE FIRE Incident Channels | | 2. Date/Time Prepared Date: 08/12/2023 Time: 1930 | | 3. Operational Period: Date From: 08/13/23 Time From: 0600 | | Date To: 08/13/23 Time To: 1800 | |
|---|--|--|--|---|--|------------------------------------|--|

| 4. Communications | | | | | | | | | |
|-------------------|----------------|-----------|--------------------|-----------|-------------|-----------|-------------|------|------------------------|
| Ch# | Function | Name | Assigned To | Rx Freq | Rx Tone | Tx Freq | Tx Tone | Mode | Notes |
| 1 | TACTICAL | TAC 1 | DIV A | 172.2250N | (T10) 107.2 | 172.2250N | (T10) 107.2 | A | |
| 2 | TACTICAL | TAC 2 | DIV G,W | 172.3750N | (T10) 107.2 | 172.3750N | (T10) 107.2 | A | |
| 3 | TACTICAL | TAC 3 | CONTINGENCY | 154.3025N | (T10) 107.2 | 154.3025N | (T10) 107.2 | A | |
| 4 | TACTICAL | FNF WRK 1 | STR. GROUP, DIV M | 168.1625N | 0.0 | 168.1625N | (T7) 167.9 | A | STRUCTURE GROUP, DIV M |
| 5 | COMMAND | CMD DIR | RIDGE COMMAND DIR | 167.2500N | (T10) 107.2 | 167.2500N | (T10) 107.2 | A | RIDGE COMMAND DIRECT |
| 6 | COMMAND | CMD RPT | RIDGE CMD RPT | 167.2500N | (T10) 107.2 | 162.2625N | (T10) 107.2 | A | RIDGE COMMAND REPEATER |
| 7 | FOREST DIR | FNF DIR | FOREST DIRECT | 173.1125N | 0.0 | 173.1125N | (T2) 123.0 | A | FNF DIRECT |
| 8 | FOREST RPT | DESERT | FOREST REPEATER | 173.1125N | 0.0 | 164.3750N | (T10) 107.2 | A | KALISPELL DISPATCH |
| 9 | A/G | FNF A/G | FOREST A/G | 169.1250N | 0.0 | 169.1250N | (T7) 167.9 | A | FOREST AIR TO GROUND |
| 10 | A/G | RIDGE A/G | ALL DIVS | 173.8375N | 0.0 | 173.8375N | (T2) 123.0 | A | RIDGE A/G PRIMARY |
| 11 | A/G | AREA A/G | 3 A/G52 | 168.3875N | 0.0 | 168.3875N | (T2) 123.0 | A | AREA A/G 3RD |
| 12 | MT MUTUAL A/G | YELLOW | MT MUTUAL A/G PRI | 151.2200N | 0.0 | 151.2200N | (T6) 156.7 | A | MT MUTUAL A/G PRIMARY |
| 13 | MT MUTUAL A/G | ORANGE | MT MUTUAL A/G 2ND | 151.4000N | 0.0 | 151.4000N | (T6) 156.7 | A | MT MUTUAL A/G 2ND |
| 14 | MT MUTUAL TAC | RED | MT MUTUAL FIRE TAC | 154.0700N | 0.0 | 154.0700N | (T6) 156.7 | A | LOCAL FD TAC |
| 15 | MT MEDICAL A/G | TAN | MT MEDICAL A/G | 155.3400N | 0.0 | 155.3400N | (T6) 156.7 | A | LOCAL MEDICAL A/G |
| 16 | AIRGUARD | AIRGUARD | ALL DIVS | 168.6250 | 0.0 | 168.6250 | (T1) 110.9 | A | EMERGENCY CONTACT |
| 17 | | | | | | | | | |
| 18 | | | | | | | | | |
| 19 | | | | | | | | | |
| 20 | AIRGUARD | AIRGUARD | ALL DIVS | 168.6250 | 0.0 | 168.6250 | (T1) 110.9 | A | EMERGENCY CONTACT |

5. Special Instructions
* LAST CLONE 8/5/23

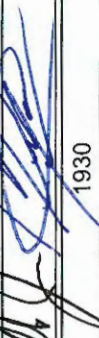
| | | | |
|---|--|--|--|
| 6. Prepared by (Communications Unit Leader): Name: Sal Bonilla Jr. / Kevin Janes | | Signature:  | |
| ICS 205 - CONTROLLED UNCLASSIFIED INFORMATION//BASIC | | Date/Time: 08/12/23 1930 | |

AIR OPERATIONS SUMMARY ICS-220

| | | | | | | | | | | | | | | | | | | | |
|--|--|--|--|----------------------|--|------------------------|--|------------------------|--|------------------------------|--|---|--|-------------------------------------|--|------------------------|--|---------------------|--|
| Incident Name / Number RIDGE FIRE / MT-FNF-000518 | | Sunrise 6:25 | | Start 6:55 | | Cutoff 20:26 | | Sunset 20:56 | | Time Prepared 1600 | | Date Prepared Saturday, August 12, 2023 | | Prepared By Staci Dickson | | | | | |
| Shutdown 21:26 | | Operational Period - Date Sunday August 13, 2023 | | | | | | | | | | Operational Period - Time 0700-2100 | | | | | | | |
| General Remarks, Safety Notes, Hazards, Air Operations Special Equipment, etc. | | | | | | | | | | | | Rescue Ship Information | | | | | | | |
| What is the record for the farthest paper airplane flight? Most Aircraft listed below are prepositioned in the area and may be available as needed. Back Country Air Traffic Freq: 122.9 | | | | | | | | | | | | Hoist | | Short Haul | | | | | |
| Helibase Information | | | | | | | | | | | | Name | | Phone | | | | | |
| Name KOA Latitude 48 27.734N Longitude 113 59.416W | | | | | | | | | | | | Request # | | Two Bear | | CMH ShortHaul | | | |
| Name | | | | | | | | | | | | Phone | | -911 | | Dispatch | | | |
| Latitude | | | | | | | | | | | | Make/Model | | Bell 429 | | H-125 | | | |
| Longitude | | | | | | | | | | | | Location | | GPI | | S27 | | | |
| (use page 2 if needed) | | | | | | | | | | | | Request Procedure for These Aircraft: | | | | | | | |
| Position | | | | | | | | | | | | Incident Communications | | | | | | | |
| AOBD | | | | | | | | | | | | See Medical Plan For Additional Info | | | | | | | |
| ASGS | | | | | | | | | | | | Name | | Phone | | Trainee | | Phone | |
| HEBM | | | | | | | | | | | | Staci Dickson | | 530-277-5153 | | | | | |
| AM | | | | | | | | | | | | Rita Clipperton | | 530-575-9906 | | Roger Caballero | | 530-277-6804 | |
| AM | | | | | | | | | | | | Jay Walter | | (623) 696-8532 | | | | | |
| FM | | | | | | | | | | | | Jordan Black | | (865) 250-3128 | | | | | |
| FM | | | | | | | | | | | | | | | | | | | |
| FM | | | | | | | | | | | | | | | | | | | |
| FM | | | | | | | | | | | | | | | | | | | |
| FM | | | | | | | | | | | | | | | | | | | |

HELICOPTERS

| FAA # | Type | Make/Model | Helibase | Avail | Start | Remarks |
|-------|------|------------|----------|-------|-------|---------------------|
| 234BH | 3 | AS 350 B3 | KOA | | 0800 | Assigned Short Haul |
| 950CH | 1 | CH47D | GPI | | 0800 | Tanked |
| 17FH | 1 | UH60A | HHH | | 0800 | Bucketed |
| 301HP | 2 | UH1H | HHH | | 0800 | Day Off |
| 114NS | 3 | AS 350 B3 | HHH | | 0800 | EU Forest Ship |
| 350HQ | 3 | H-125 | S27 | | 0800 | Short Haul |

FIXED WING

| FAA # | Type | Make/Model | Base | Avail | Start | Remarks |
|-------|------|------------|------|-------|-------|---------|
| 281 | | CL-415BAE | GPI | | 900 | |
| 282 | | CL-415BAE | GPI | | 900 | |
| 284 | | CL-415BAE | GPI | | 900 | |
| 285 | | CL-415BAE | GPI | | 900 | |

Notes:

 Staci Dickson AOB

Ridge Fire – Safety Message

INCIDENT #MT-FNF-000518

DATE: 8/13/2023 TIME: 0600-1800 Day Shift

Situational Awareness

In the wildland fire environment, "SA" is a requirement

- Driving: Maintain safe driving practices
- Trees: Gravity always wins. Look up, down and around
- Steep Terrain: Look for rolling material
- Fatigue: Monitor your health and that of those around you
- Concentrate: Stay focused on the task at hand
- Communications: Be clear, be concise, be accurate
- Smoke: Recognize the effects of long-term smoke exposure and mitigate

Hazard Mitigation Through Risk Management

Situational Awareness – Obtain information, scout the fire, identify hazards

Hazard Assessment – Assess hazards to determine risks

Hazard Control – Determine the best approach to mitigate or control the risk

Decision Point – Are controls in place? Are tactics appropriate? Are instructions given and understood?

Evaluation – Ensure controls are implemented and accomplished to standards.

End of assignment watch outs

- Not mentally engaged in the task at hand
- Your driver is driving faster than when you got here
- Not giving good, thorough briefings
- Your hardhat and web gear are still on the truck
- Assuming all is good because you worked this piece of ground yesterday
- All the conversations are about what you are going to do when you get home
- You and your folks are tripping and stumbling more than usual
- It is taking you longer to get out of camp and out to the line
- No AAR after each shift

Individual Accountability

- Know where your crewmembers are at all times.
- Have crewmembers work in pairs.
- Inform Division or your Supervisor of changing locations.
- Review radio procedures, and ensure your radio is properly cloned.
- Check IN and OUT with Branch or Division if not assigned to that location and are passing through.
- Check OUT with your supervisor (or Division) at the end of shift.

Prepared by:

CIIMT 4 Safety Group



INCIDENT RISK ANALYSIS

ICS (215A) 24 HOUR SHIFT

| BR/DV | HAZARDOUS ACTIONS – CONDITIONS | MITIGATIONS – WARNINGS – REMEDIES |
|-------|--|---|
| ALL | TRAFFIC HAZARDS AND DRIVING | <ul style="list-style-type: none"> • Take extra precautions when entering or exiting the roadways. • Maintain high visibility when in the operational area and use warning lights when working on roads or traveling in smoke. • Many roads are narrow and mid-slope, with soft shoulders. Allow heavy vehicles to pass on the uphill side. Use spotters when backing or turning around. • Use warning lights when working on roads or traveling in smoke. • Be alert for wildlife. Dusk to dawn poses the greatest potential for accidents. • Be aware of and take precautions around logging truck traffic. |
| ALL | STEEP TERRAIN & ROLLING DEBRIS | <ul style="list-style-type: none"> • Maintain 8'-10' spacing when working & walking. • Do not work above any personnel. • Evaluate the necessity to send personnel into areas with limited access. |
| ALL | HAZARD / DANGER TREES | <ul style="list-style-type: none"> • Follow Hazard Tree Safety Guidelines (IRPG p.20) • Limit the number of personnel around snags and their exposure time. • Fallers must be qualified for the trees being felled. • Be alert around hazard trees during wind events, even green trees. • The hazard zone extends a minimum of 2½ tree lengths. • Avoid parking vehicles or taking breaks under or near hazard trees. |
| ALL | DIRECT/ INDIRECT FIRELINE CONSTRUCTION | <ul style="list-style-type: none"> • Establish and maintain LCES. • Utilize favorable locations when constructing control features; i.e. lighter fuels, natural or existing barriers, and ridgelines. • Watch out if there is unburned fuel between you and the fire. • Monitor weather conditions and fire behavior. |
| ALL | HEAVY EQUIPMENT OPERATIONS | <ul style="list-style-type: none"> • Ensure communications are established with operators. • Use hand signals if other communications are unavailable. • Maintain a 50'-100' exclusion area around equipment. • Use road guards as needed to control traffic. |
| ALL | FIRING OPERATIONS AND DEVICES | <ul style="list-style-type: none"> • Follow the chain of command when undertaking burning operations. • Ensure that the aerial/ground ignition plans have been well briefed including LCES and drought related fire behavior considerations. • Wear and use appropriate PPE. • Request spot weather forecasts prior to burning. • Initiate burning after ensuring the plan is authorized and understood by all. |
| ALL | PUBLIC SAFETY | <ul style="list-style-type: none"> • Have a purpose for where you drive and what you do. • During high fire activity, do not expect drivers to pull over or drive through the area slower. • Maintain high visibility when in the operational area and use warning lights when working on roads or traveling in smoke. • Be aware of public entering fire area to access social trails and camping sites. |
| ALL | AVIATION OPERATIONS | <ul style="list-style-type: none"> • Conduct thorough mission assessments before starting work. Follow the guidelines in the SHO and other aviation guidelines and reference materials. • Ensure coordination and communication are in place and understood by all resources involved in the mission. • Ensure close coordination between Air Attack, air tankers, helicopters, and ground resources. |
| ALL | COMMUNICATIONS | <ul style="list-style-type: none"> • Share your Situational Awareness (hazards, changes, etc.) with those who also have a need. • Answer questions and/or ask for intel when you do not know the plan. • Ensure all personnel are familiar with the incident and IA communications plans. |
| ALL | WILDLIFE | <ul style="list-style-type: none"> • High concentration of wildlife in the area. • Use bear-resistant garbage cans. Backhaul garbage from drop points. • Do not keep food inside your tent. • Do not feed bears or other wild animals. • Never approach bears or cubs. • If encountering a bear, make noise, travel in a group and keep members together. Do not surprise the bear. DO NOT RUN! |
| ALL | WEATHER | <ul style="list-style-type: none"> • Maintain continuous Situational Awareness based on the fire environment, observed fire behavior, hazards, and incident objectives. • Take weather throughout the shift to get timely and accurate information. • Is what we predicted what you are observing? • Request spot weather forecasts if you notice a notable change in the weather. • Communicate any weather changes with your crew and adjacent resources. |

INCIDENT NAME:

RIDGE FIRE

OPERATIONAL PERIOD: 0600 – 1800

AUGUST 13, 2023

Date/Time Prepared: 08/12/2023 – 1400





Human Resource Message

Ridge Fire

August 13, 2023

Disrespect and Bullying

Never, EVER, tolerate disrespectful people, including those who are not only disrespectful to you but also others.

Never tolerate a bully. Disrespectful people and bullies show no regard for people, laws, morality or the social norm.

If you have experienced disrespect or bullying on the job, whether towards you or somebody else, report it. Not only is it against policy, in some circumstances it's against the law. So, if you see something, say something.

Be safe ~ Have a great shift.

Feel free to call/text HRSP if you have questions, concerns, or just want to chat.
I will also arrange a meeting if necessary

Adam Alvarez – HRSP - (707) 373-8715



LINE ORDER FORM



| ORDER # | DATE & TIME ORDERED Received from the Line | WHO PLACED ORDER DIVS, OPS, etc.... | DELIVER to (DIV, Helispot, DP, etc.) Division, Heli-Spot, Drop Point, etc. | MODE of DELIVERY Drive, Helo, pick-up | | | |
|--|--|--|---|--|-------------------------------|-------|--------|
| Order Received in Communications By: | | | | TIME: | | | |
| Communications Relayed/Placed the Order To: | | | | TIME: | | | |
| Order Shipped to the Line By (Name): | | | | TIME: | | | |
| ITEM# | DESCRIPTION | | | AMOUNT | | | |
| 1 | 1,000 Foot Hose Lay: Includes the following 10 lengths, 1 1/2" x 100' Hose. 10 lengths, 1" x 100' Hose. 10ea. 1 1/2" Gated Wyes. 10ea. 1 1/2" to 1" Reducers. 10ea. 1" Nozzles. | | | | | | |
| 2 | 2,000 Foot Hose Lay: Includes the following 20 lengths, 1 1/2" x 100' Hose. 20 lengths, 1" x 100' Hose. 20ea. 1 1/2" Gated Wyes. 20ea. 1 1/2" to 1" Reducers. 20ea. 1" Nozzles. | | | | | | |
| 3 | 3,000 Foot Hose Lay: Includes the following 30 lengths, 1 1/2" x 100' Hose. 30 lengths, 1" x 100' Hose. 30ea. 1 1/2" Gated Wyes. 30ea. 1 1/2" to 1" Reducers. 30ea. 1" Nozzles. | | | | | | |
| ITEM# | REQUESTED ITEM | NFES# | AMOUNT | ITEM# | REQUESTED ITEM | NFES# | AMOUNT |
| 4 | Backpack Pump, 5 gallon | 1149 | | 26 | Batteries, "AA", (package) | 0030 | |
| 5 | Foam, 5 gallon | 1145 | | 27 | Gasoline, Unleaded (gallon) | | |
| 6 | Hose, 3/4 inch, 50 ft. length | 1016 | | 28 | Oil, 2 Cycle Mix (quart) | 0341 | |
| 7 | Hose, 1 inch, 100 ft. length | 0966 | | 29 | Diesel, straight (gallon) | | |
| 8 | Hose, 1 1/2 inch, 100 ft. length | 0967 | | 30 | Oil, Bar & Chain (gallon) | 1880 | |
| 9 | Increaser, 3/4" to 1" | 2235 | | 31 | Fusees (box) | 0105 | |
| 10 | Increaser, 1" to 1 1/2" | 0416 | | 32 | Torch, Drip Torch ea. | 0241 | |
| 11 | Nozzle, Garden 3/4 inch | 0136 | | 33 | Mix, Drip Torch 3-1, 5 gal. | | |
| 12 | Nozzle, Forester, 1" | 0024 | | 34 | Flagging, Ribbon, Color/Roll | | |
| 13 | Nozzle, KK Type, 1" | 1081 | | 35 | Washcloth, Waterless | 0206 | |
| 14 | Nozzle, KK Type, 1 1/2" | 1082 | | 36 | Water, Cubi, 5 gallon ea. | 0048 | |
| 15 | Reducer, 1" to 3/4" | 0733 | | 37 | Water, Bottled, (case) | | |
| 16 | Reducer, 1 1/2" to 1" | 0010 | | 38 | Sports Drink, Gatorade (case) | | |
| 17 | Tee, Hoseline, 1"x1"x 3/4" | 1809 | | 39 | Food, MRE's (12 per Box) | 1842 | |
| 18 | Tee, Hoseline, 1"x1"x 1" | 2240 | | 40 | Pump Kit, High Pressure | 0870 | |
| 19 | Tee, Hoseline, 1 1/2" x 1 1/2" x 1" | 0230 | | 41 | Pump, High Pressure | 0148 | |
| 20 | Wye, Gated, 3/4" inch | 0904 | | 42 | Pump Kit, Light Weight | 0670 | |
| 21 | Wye, Gated, 1" | 0259 | | 43 | Sprinkler Kit | 1048 | |
| 22 | Wye, Gated, 1 1/2" | 0231 | | 44 | Pump Kit, Volume | 6041 | |
| 23 | Tank, Collapsible. Capacity Gallons? | | | 45 | Mop-Up Kit | 0772 | |
| 24 | Tank, Folding/Frame. Capacity?? | | | 46 | Fuel (gas/diesel/mix) | | |
| 25 | Wrap, Structure (roll) | 0881 | | | | | |

Date and Time Needed: _____ Point of Contact at Delivery Location: _____

OTHER / NOTES:

Federal Finance Message

Please use the QR code on front page of IAP to submit your time to
2023.ridge.finance@firenet.gov

If you need assistance with electronic submission, there will be a Finance presence at briefing to assist those in need.

- FOR CTR SUBMISSION, PLEASE PUT CTR and RO# IN SUBJECT LINE OF EMAIL.
- FOR SHIFT TICKETS, PLEASE PUT ST AND RO# IN SUBJECT LINE OF EMAIL.
- IF TURNING IN FINAL CTR OR SHIFT TICKET, PLEASE ALSO PUT FINAL IN SUBJECT LINE.
- PLEASE MAKE EVERY EFFORT TO TURN IN ALL CTR's AND SHIFT TICKETS DAILY.
- PLEASE INCLUDE YOUR RESOURCE ORDER # ON ALL DOCUMENTATION SUBMITTED, INCLUDING RECEIPTS.
- AUTO RESPONSE IS SET UP TO LET YOU KNOW THAT DOCUMENTS WERE RECEIVED.
- FOR DEMOB: Finance will email the Draft OF-288 or OF-286 to employee for their review and approval. If everything is correct, Finance will reply with FINAL OF-288/OF-286.
- ALL RESOURCES WILL NEED TO SIGN IN PERSON OR ELECTRONICALLY.

FINANCE CHECK IN:

- PLEASE ENSURE THE BELOW DOCUMENTS ARE EMAILED TO FINANCE WITH RESOURCE ORDER NUMBER NOTED:

| Agency Equipment/Crews: | Overhead: | Contract Equipment/Contract Crews: | Cooperator: |
|---|--|--|---|
| <ul style="list-style-type: none"> • Manifest • Resource Order • CTR's | <ul style="list-style-type: none"> • Resource Order • AD Hire Form (If an AD) • CTR's | <ul style="list-style-type: none"> • Agreement/Manifest • Resource Order • Shift Ticket • Inspection Forms | <ul style="list-style-type: none"> • Cooperative Agreement • Resource Order • Shift Ticket • Inspection Forms |

EQUIPMENT-PLEASE SEE FINANCE

| RESOURCE NAME | RESOURCE ORDER# | ISSUE |
|-----------------|-----------------|---------------------------|
| Yeager | E-91 | 8/9, ST need travel miles |
| Grizzly Logging | E-100 | 8/9 ST missing |
| Slack | E-34 | Validate transport |
| Dan Siderius | E-35 | Validate transport |



NOTICE



You're in Bear Country

- DO NOT bring food, toiletries, or scented items into your tent.
- Sleep at least 100 yards away from the kitchen/food prep area.
- Secure food attractants properly in a bear resistant bin or in a secured building.
- Stay alert and look for bear activity, especially where visibility or hearing is limited (thick vegetation, streams).
- Make noise whenever possible to avoid surprising a bear, especially where visibility or hearing is limited. The human voice is the best deterrent, be loud.
- Travel in a group and keep members together.
- Never run from a bear.
- If a bear is hanging around, alert others, and from a safe place make it leave. Yell, set off car alarms, air horns, bang pots and pans, etc.
- If you experience any type of conflict with a bear or have any questions/concerns, immediately contact Bear Specialist Justine Vallieres at (406)250-1265.



PUBLIC INFORMATION



FIRE INFORMATION CONTACT – Please direct any public or media inquiries to the Information Center at: **406-998-6074** (staffed from 0800-1930) or 2023.ridge@firenet.gov

Please email/text your photos to: **406-998-6074** or 2023.ridge@firenet.gov

Remember we are all an Information Officer – here is some helpful tips:

Fire Information is Everyone’s Job

Notify chain of command and incident Public Information/ Affairs Officer (PIO/PAO) if media arrives unescorted. Provide for their safety until an escort arrives.

Media Interviews:

- Develop and deliver key factual messages; anticipate tough questions.
- Give simple answers (10-20 sec.) and avoid using jargon or acronyms.
- Stick to *your* knowledge and avoid speaking for other incident personnel.
- Never speak off the record, exaggerate, or try to be cute or funny.
- Keep quiet in between questions; if you misspeak, ask to start again.
- Be personable, professional, and presentable (remove sunglasses and hat).
- Conclude with a safety or wildfire prevention message.

Social Media – PAUSE Before Posting:

- PERCEPTION – You are representing the jurisdictional agency and your home unit.
- AUTHORITY – Be aware of federal and host agency social media policies.
- UNDERSTANDING – Know the incident objectives. Never post negative, controversial, or unsafe messages to personal accounts. Ask a PIO/PAO or supervisor for clarification.
- SAFETY – Do not compromise your safety while taking photos and always wear proper PPE. Never post photos of children, inmates, investigations, or cultural sites; be sensitive to burned structures and private information.
- EXPECTATION – Share relevant content or photos with PIOs/PAOs to help tell the incident story.

IRPG – Other References (White)

101 of 120

Shower Hours

0500-1100

1400-2200

Breakfast

0530-0830

Dinner

1800-2130

JOKE OF THE WEEK:

Time flies like an arrow. Fruit flies like a banana.

*If it's not written down
it didn't happen!*

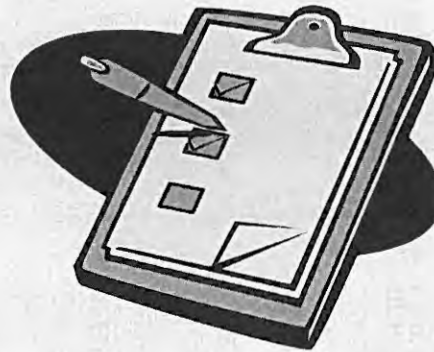

- ✓ **Do not miss out on capturing your hard work.**
- ✓ **The amount of time wasted trying to recreate the event is huge compared to the time it takes to document it immediately after the event.**
- ✓ **Please DO NOT procrastinate until tomorrow what can be done today.**
- ✓ **If you need forms or have questions, please call the Training Specialist.**



Check-IN

**Emil Picchi TNSP
(650)520-5102
TNSPEP@gmail.com**



Exit Interview

INTENTIONALLY LEFT BLANK

RIDGE FIRE DEMOB MESSAGE

TENTATIVE RELEASE FOR 8/13/23

E-30 MAST2 HULETT

TENTATIVE RELEASE FOR 8/14/23

E-61 WTS2 MARTIN CITY 1691

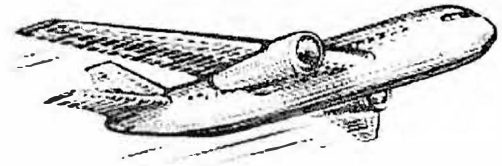

DEMOB IS LOCATED AT RIVER RANCH ICP

Resources approved for release will report to the Demob Unit to receive a checkout form. The crew leader or single resource will obtain required signatures after turning in any accountable equipment or supplies, vehicle inspections if required, completing any required documentation, and closing out with the Finance Section.

Jeff Ferguson, DMOB
916-837-7723
2023.ridge.demob@firenet.gov

VEHICLE INSPECTIONS:
WEED WASH:
Located at KOA Staging
251 Halfmoon Flats Rd., West Glacier, MT

To request a flight:

Submit your information at least 72 hours in advance

FLIGHT REQUEST FORM

| | |
|---------------------------|--|
| Request Order # | |
| Name as shown on photo ID | |
| Date of Birth | |
| Cell Phone | |
| Male or Female | |
| Email Address | |
| Last Work Date | |
| Flight Date | |
| Departure Airport Code | |
| Arrival Airport Code | |
| Rental Location | |
| Need ride to airport? | |



Incident Management Team Unit Locations

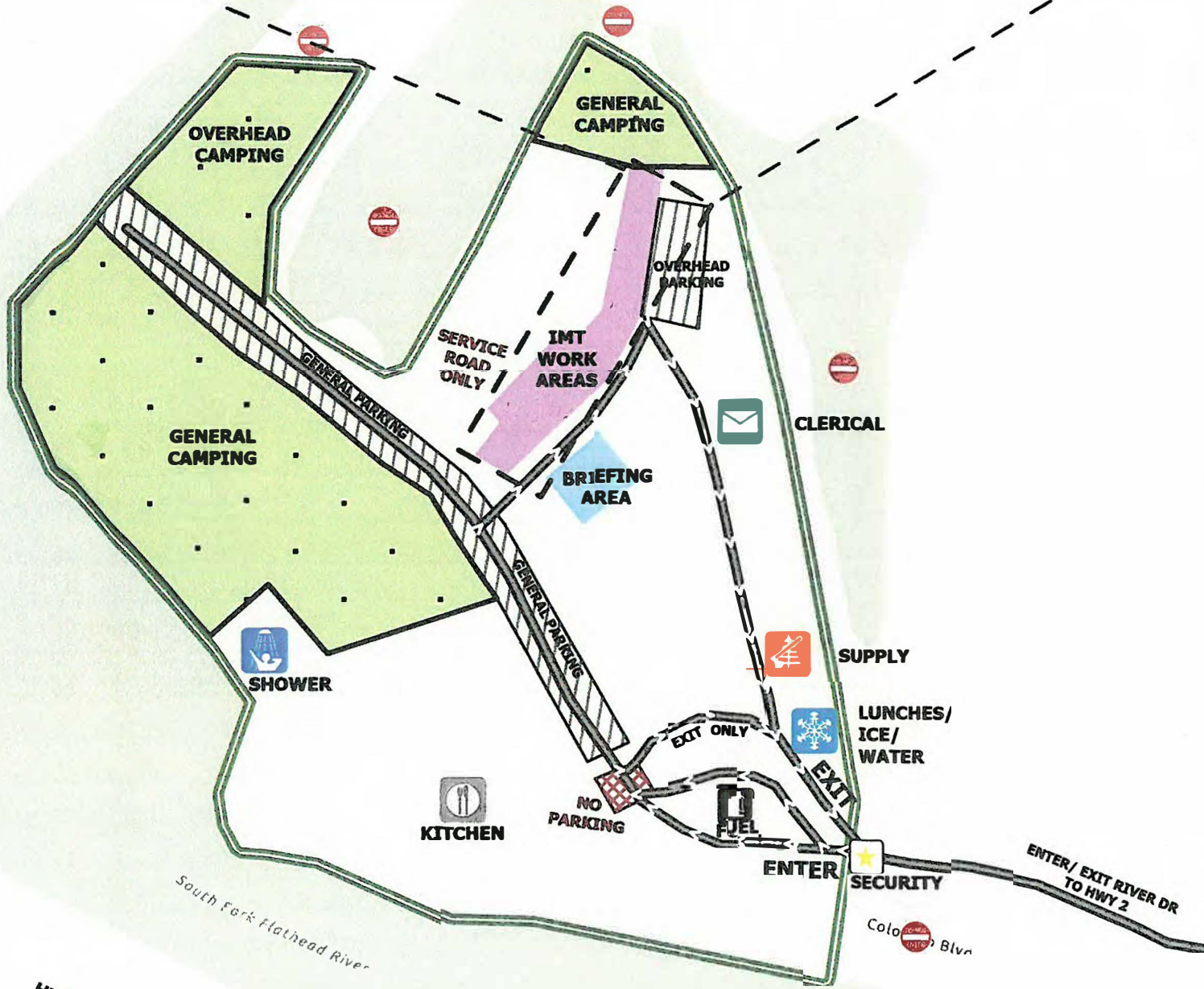
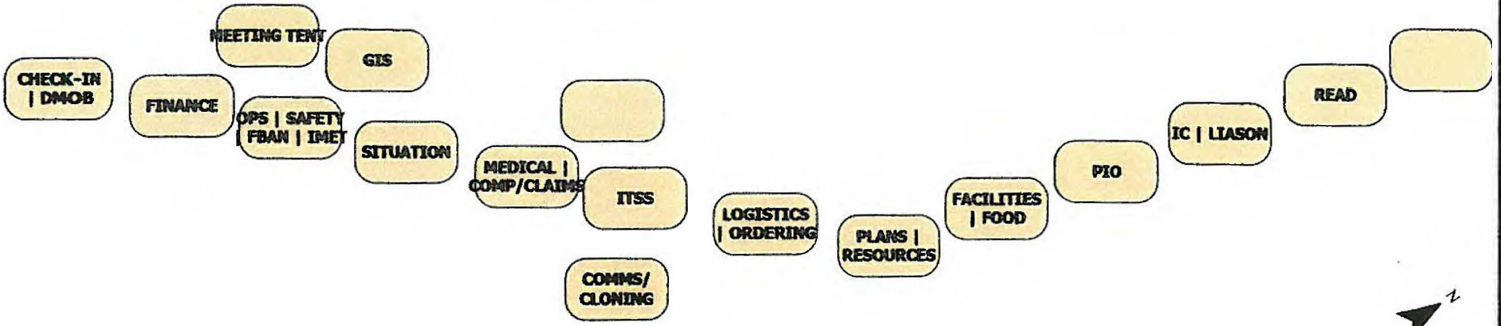



ICP MAP Ridge

MT-FNF-000518
08/12/2023
0600

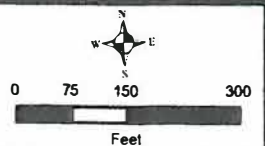

- | | | | |
|--------------|-------------------|-----------------|---------------|
| DO NOT ENTER | LUNCHES/ICE/WATER | IMT WORK SPACES | PARKING |
| CLERICAL | SHOWER | IMT WORK AREAS | NO PARKING |
| FUJEL | SUPPLY | BRIEFING AREA | CAMPING AREAS |
| KITCHEN | SECURITY | | |



| 1. Incident Name | | | | 2. Operational Period | | | | | | | |
|--|--|--|----------------|--|---|---------------------------------------|----------------|---------|----|------------------------------------|--|
| Ridge Fire Medical Plan | | | | Date/Time: 8/13/2023 (0600-1800) | | | | | | | |
| 3. Medical Aid Stations / Ambulance Services / REMS | | | | | | | | | | | |
| Name | | Location | | Contact | | Advanced Life Support (ALS) Yes No | | | | | |
| Three Rivers EMS | | 31 7 th Street W, Columbia Falls MT | | 911 OR (406)-892-4244 | | X | | | | | |
| Kalispell Fire | | Incident Ambo | | Incident Dispatch / Communications | | X | | | | | |
| Wilderness Medics | | Incident Ambo | | Incident Dispatch / Communications | | X | | | | | |
| 4. Air Rescue / Air Ambulance Services | | | | | | | | | | | |
| Name | | Location | | Type of Aircraft & Capability | | | | | | | |
| ALERT-1 | | Kalispell MT | | Bell 407 CCT Medical Transport | | | | | | | |
| Two Bear Air Rescue | | Kalispell MT | | Bell 429 Rescue / Hoist NVG | | | | | | | |
| 350 HQ | | Available Through Incident Dispatch | | H-125 Short-haul | | | | | | | |
| Trinity Air Ambulance | | Missoula MT | | Learjet 35, Fixed Wing CCT Medical Transport | | | | | | | |
| 5. Hospitals (all times estimated from incident location) | | | | | | | | | | | |
| Name & Trauma Level | | GPS Datum – WGS 84 Degrees Decimal Minutes | | Travel Time (From ICP) | | Phone | | Helipad | | Address | |
| | | | | Air | Gnd | | | Yes | No | | |
| Logan Health Whitefish Level 4 | | Lat: | N 48° 22.51' | 7 MINS | 19 MINS | 406-863-3500 | | X | | 600 Hospital Way, Whitefish MT | |
| | | Long: | W 114° 19.56' | | | | | | | | |
| Logan Health Kalispell Level 3 | | Lat: | N 48° 22.84' | 10 MINS | 33 MINS | 406-752-5111 | | X | | 310 Sunnyview Ln, Kalispell MT | |
| | | Long: | W 114° 19.88' | | | | | | | | |
| St Patrick's Med. Center Level 2 | | Lat: | N 113° 59.96' | 45 MINS | 2.5 HRS | 406-543-7271 | | X | | 500 W. Broadway Missoula MT | |
| | | Long: | W 122° 19.39' | | | | | | | | |
| Harbor View Medical Regional Burn Ctr./ Level 1 | | Lat: | N 47° 36.24' | 1.5 HRS | N/A | 206-744-3140 | | X | | 50 Medical Dr. North Seattle WA | |
| | | Long: | W 122° 19.39' | | | | | | | | |
| 6. Division / Crew Emergency Pre-Plan | | | | <i>Update and discuss with assigned resources daily.</i> | | | | | | | |
| Fireline EMT / Medic's Division / Branch Location | | | | | | | | | | | |
| Air Hoist site location site: Lat: / Long: / Elevation: | | | | | | | | | | | |
| Helispot: Lat: / Long: / Elevation: MED LZ: | | | | | | | | | | | |
| 7. Prepared By (Medical Unit Leader) | | | 8. Date/Time | | 9. Reviewed By (Safety Officer) | | 10. Date/Time | | | | |
| MEDL Eric Williams / Jeff Brooks / Sam Crenshaw (T)  | | | 8/12/2023 1600 | | SOF1 Mike Alford  | | 8/12/2023 1600 | | | | |

Medical Incident Report

FOR A **NON-EMERGENCY INCIDENT**: WORK THROUGH CHAIN OF COMMAND TO REPORT AND TRANSPORT INJURED PERSONNEL AS NECESSARY.

FOR A **MEDICAL EMERGENCY**: IDENTIFY ON SCENE INCIDENT COMMANDER BY NAME AND POSITION AND ANNOUNCE **"MEDICAL EMERGENCY"** TO INITIATE RESPONSE FROM COMMUNICATIONS

Use the following items to communicate situation to communications/dispatch.

1. CONTACT COMMUNICATIONS / DISPATCH (Verify correct frequency prior to starting report)

Ex: "Communications, Div. Alpha. Stand-by for Emergency Traffic."

2. INCIDENT STATUS: Provide incident summary (including number of patients) and command structure.

Ex: "Communications, I have a Red priority patient, unconscious, struck by a falling tree. Requesting air ambulance to Forest Road 1 at (Lat./Long.)"

"This will be the Trout Meadow Medical Incident, IC is TFLD Jones. EMT Smith is providing medical care."

| | |
|--|--|
| Severity of Emergency AND Transport Priority (priority 1, 2, 3) | <input type="checkbox"/> RED / PRIORITY 1 Life or limb threatening injury or illness. Evacuation need is IMMEDIATE <i>Ex: Unconscious, difficulty breathing, bleeding severely, 2° - 3° burns more than 4 palm sizes, heat stroke, disoriented.</i> <input type="checkbox"/> YELLOW / PRIORITY 2 Serious Injury or illness. Evacuation may be DELAYED if necessary. <i>Ex: Significant trauma, unable to walk, 2° - 3° burns not more than 1-3 palm sizes.</i> <input type="checkbox"/> GREEN / PRIORITY 3 Minor Injury or illness. Non-Emergency transport <i>Ex: Sprains, strains, minor heat-related illness.</i> |
| Nature of Injury or Illness & Mechanism of Injury | Brief Summary of Injury or Illness <i>(Ex: Unconscious, Struck by Falling Tree)</i> |
| Transport Request | <i>Air Ambulance / Short Haul/Hoist Ground Ambulance / Other</i> |
| Patient Location | <i>Descriptive Location & Lat. / Long. (WGS84)</i> |
| Incident Name | <i>Geographic Name + "Medical" (Ex: Trout Meadow Medical)</i> |
| On-Scene Incident Commander | <i>Name of on-scene IC of Incident within an Incident (Ex: TFLD Jones)</i> |
| Crew Patient Care | <i>Name of Care Provider (Ex: EMT Smith)</i> |

3. INITIAL PATIENT ASSESSMENT: Complete this section for each patient as applicable (start with the most severe patient)

Patient Assessment: Age: Weight: Chief Complaint:
(IRPG PAGE 106)

Skin Signs: (color/moisture/temp) Level of Consciousness: BP: HR: Respirations:

Treatment:

4. TRANSPORT PLAN:

Evacuation Location (*drop point, intersection, helispot, Lat. / Long, hazards*) Patient's ETA to Location:

5. ADDITIONAL RESOURCES / EQUIPMENT NEEDS:

Paramedic / EMT - Crews - Immobilization Devices - AED - Oxygen - Trauma Bag - IV/Fluid(s) - Splints - Rope rescue - Wheeled litter - HAZMAT - Extrication

6. COMMUNICATIONS: Identify State Air/Ground EMS Frequencies and Hospital Contacts as applicable

| Function | Channel Name/Number | Receive (RX) | Tone/NAC * | Transmit (TX) | Tone/NAC * |
|-------------|---------------------|--------------|------------|---------------|------------|
| COMMAND | | | | | |
| AIR-TO-GRND | | | | | |
| TACTICAL | | | | | |

7. CONTINGENCY: Considerations: If primary options fail, what actions can be implemented in conjunction with primary evacuation method?
Be thinking ahead.

8. ADDITIONAL INFORMATION: Updates/Changes, etc.

REMEMBER: Confirm ETA's of resources ordered. Act according to your level of training
Be Alert - Keep Calm - Think Clearly - Act Decisively

*** Follow up with MEDL upon return to ICP ***



