

# INCIDENT ACTION PLAN

*Ridge Fire*

MT-FNF-000518 P1 QGT5 (O110)

*Doris Point Fire*

MT-FNF-000496 P1 QJ61 (O110)

*Tin Soldier Complex*

MT-FNF-000535 P1 QGH4 (O110)

## THURSDAY, August 24, 2023

Day Operational Period: 0700-2000

FOR OFF-DUTY & AFTER HOURS ICP MEDICAL EMERGENCIES

Activate the local 9-1-1 system, then call (406) 345-5975



- IAPs
- Maps
- Check-in
- Blank CTRs
- Blank Shift Tickets
- Finance Email

### FIRE INFORMATION

Email: [2023.Ridge@firenet.gov](mailto:2023.Ridge@firenet.gov)

Phone Line: 406-998-6074

Inciweb: <https://inciweb.nwcg.gov/incident-information/mtfnf-ridge-fire>

Facebook: <https://www.facebook.com/ridge.fire.information>

YouTube: <https://www.youtube.com/@2023ridgefire>



SOUTHWEST AREA TEAM #1

Carl Schwope – Incident Commander  
Jason Clawson – Deputy Incident Commander



<b>INCIDENT OBJECTIVES</b> <small>ICS-202</small>	INCIDENT NAME	DATE PREPARED	TIME PREPARED
	<b>RIDGE AND DORIS POINT FIRES,          TIN SOLDIER COMPLEX</b>	8/23/2023	2000

OPERATIONAL PERIOD (DATE/TIME)  
**WEDNESDAY, August 24, 2023 DAY Operational Period: 0700 – 2000**

GENERAL CONTROL OBJECTIVES

**Leader's Intent**

- Effectively implement a value-driven strategy that utilizes a mix of tactics (direct, indirect, and point-protection) when and where the probability of success is high, and the risk is commensurate with the identified values. Success is defined as safely achieving objectives with the least firefighter exposure necessary while enhancing stakeholder support and adhering to the core values of **Duty, Respect and Integrity**.

**Control Objectives**

- Ridge Fire is a Full Suppression Fire. The Doris Point Fire/Tin Soldier Complex are Point Protection Fires.
- Minimize loss of our most Highly Valued Resources and Assets including private residences and infrastructure in the communities of Martin City, Hungry Horse, Coram, West Glacier, Hungry Horse Dam and other outlying private property, South Fork Abbot Creek, improvements, and infrastructure in and directly adjacent to the planning area. Additionally, minimize impacts to communication infrastructure on Desert Mountain and Firefighter Lookout.
- Unless human life is at risk, and to the extent possible, prevent retardant use in identified retardant avoidance areas.
- Provide initial attack for new wildland fire starts within the designated Temporary Flight Restriction areas. Coordinate with Kalispell Dispatch.
- Ridge Fire. Keep fire:
  - North of Forest Road 38
  - South of the Great Bear Wilderness
  - East of the communities along Highway 2
  - West of the Tiger River
- Doris Point and Tin Soldier Complex (Sullivan and Bruce Fires):
  - Keep fires west of the western side of Hungry Horse Reservoir (NFSR 895) and Meadow Creek (NFSR 2826) roads.
- Implement suppression repairs as identified in the approved Suppression Repair Plan.

**Management Objectives**

- Manage risk to incident personnel by ensuring hazards are identified, assessed and where possible mitigated. Accept only necessary risk when values threatened warrant action and the probability of achieving objectives is high.
- Create and maintain a supportive, positive, and harassment free work environment in which people are treated with respect and dignity. Create a "no tolerance" atmosphere for harassment, alcohol or illegal drug use.
- Maintain and develop relationships with stakeholders, cooperators, community leaders, tribal representatives, elected officials, private landowners, and livestock permittees. Ensure timely and accurate information and sharing coordination with local authorities.
- Effectively manage incident costs through the selection and implementation of strategies and tactics that have a high probability of success in meeting objectives.

<input checked="" type="checkbox"/> ORGANIZATION LIST (ICS 203)	<input checked="" type="checkbox"/> MEDICAL PLAN (ICS 206 & 206WF)	<input checked="" type="checkbox"/> WEATHER FORECAST
<input checked="" type="checkbox"/> ASSIGNMENT LIST (ICS 204)	<input checked="" type="checkbox"/> AIR OPS. SUMMARY (ICS 220)	<input checked="" type="checkbox"/> FIRE BEHAVIOR FORECAST
<input checked="" type="checkbox"/> COMMUNICATION PLAN (ICS 205)	<input checked="" type="checkbox"/> SAFETY MESSAGE	<input checked="" type="checkbox"/> UNIT LOG

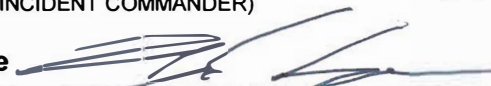
ICS 202	PREPARED BY (PLANNING SECTION CHIEF) <b>Bob Love</b> 	APPROVED BY (INCIDENT COMMANDER) <b>Carl Schwope</b> 
---------	---	---

# ORGANIZATION ASSIGNMENT LIST

ICS-203

1. INCIDENT NAME

**RIDGE/DORIS POINT/TIN SOLDIER**

2. DATE PREPARED

8/23/2023

3. TIME PREPARED

1700 hours

4. OPERATIONAL PERIOD

DATE: 8/24/2023

TIME Day 0700-2000

## 5. INCIDENT COMMANDER AND STAFF

INCIDENT COMMANDER	Carl Schwope
DEPUTY INCIDENT COMMANDER	Jason Clawson
SAFETY OFFICER	Jim Burton
SAFETY OFFICER – FIELD	Rob Martin
LIAISON OFFICER	Pete Smith/Tom Vigi
LIAISON OFFICER	Troy Waskey (t)
INFORMATION OFFICER	Katy O'Hara / Celeste Prescott
INFORMATION OFFICER	Emery Johnson (t)
HUMAN RESOURCE SPECIALIST	Ana Parada

## 9. OPERATIONS SECTION

OPERATIONS SECTION CHIEF – FIELD	Ralph Lucas / Charles Ebert (t)
OPERATIONS SECTION CHIEF – PLANNING	Caleb Finch
OPERATIONS SECTION CHIEF – PLANNING	Lindsav McElfresh (t)
OPERATIONS SECTION CHIEF – PLANNING	Brandon Woodward (t)
STRATEGIC OPERATIONS CHIEF	Jayson Coil

## 6. AGENCY/ORGANIZATION REPRESENTATIVES

AGENCY	NAME
USFS – Flathead NF Agency Admin.	Lisa Timchak
USFS – Flathead NF Agency Admin.	MJ Crandall
USFS – Flathead NF Agency Admin.	Paul Donnellon
NPS – Glacier NP	David Roemer
USFS – Flathead NF IBA	Biddy Simet
Flathead County Sheriff	Brian Heino
Coram Experimental Forest	David Wright
CCC Agency Representative	Miguel Diaz

### a. BRANCH I

BRANCH DIRECTOR	Barry Green	
DIVISION	A/M	Larry Badger
DIVISION	R	Ricky Romeo / Andre Dulac (t)
DIVISION	W	Justin Wedo
GROUP	Doris Point	Guy Wilson / Tyler Richwine (t)
GROUP	Repair	Brendon McNeil / Beau Cartwright
GROUP		
DIVISION/GROUP		
DIVISION/GROUP		

### b. BRANCH II

BRANCH DIRECTOR	TJ Lowder	
GROUP	Tin Soldier	Aaron Livinaston / A. Strobel (t)
GROUP		
DIVISION		
GROUP		

## 7. PLANNING SECTION

PLANNING SECTION CHIEF	Bob Love
PLANNING SECTION CHIEF	Dana Bagnoli
RESOURCE UNIT LEADER	Glenda Womack / Mark McEntarffer
RESOURCE UNIT LEADER	Matt Kilford (t) / Brooke Wrve*
SITUATION UNIT LEADER	S. Bliss / C. Munday / D. Lucia
FIRE BEHAVIOR ANALYST	Stewart Turner / RJ Hannah (t)
LONG TERM ANALYST	
METEOROLOGIST	Trent Smith
DEMobilIZATION UNIT LEADER	
INCIDENT TECHNOLOGY SUPPORT	Dave Kohler / Russell Virgilio
INCIDENT TECHNOLOGY SUPPORT	Gonzalo Hernandez / Mac Hetherington
DOCUMENTATION UNIT LEADER	LT Pratt
GISS	Rick Crawford / David Danker
GISS	Alex Heeren*
TRAINING SPECIALIST	Emil Picchi*
STATUS CHECK IN	Matt Kilford
AIR RESOURCE ADVISOR	Margaret Key
STATUS/CHECK-IN RECORDER	Meghan Han (t)
LEAD RESOURCE ADVISOR	Elliot Meyer

### c. BRANCH III

BRANCH DIRECTOR	
GROUP	
GROUP	
DIVISION	
DIVISION/GROUP	
DIVISION/GROUP	

### d. BRANCH

BRANCH DIRECTOR	
GROUP	
GROUP	
GROUP	

### e. BRANCH

BRANCH DIRECTOR	
GROUP	

## 8. LOGISTICS SECTION

LOGISTICS SECTION CHIEF	Sharon Taube / Ray Kingston*
LOGISTICS SECTION CHIEF	Ed Freed / Dean McAllister

### a. SUPPORT BRANCH

SUPPLY UNIT LEADER	Karen Abeita / Carlos Santillana (t)
SUPPLY UNIT LEADER	
FACILITIES UNIT LEADER	Vonnie Young
GROUND SUPPORT UNIT LEADER	Robert Gill
GROUND SUPPORT UNIT LEADER	Clyde Morace
ORDERING MANAGER	Lorean Hennings
RECEIVING MANAGER	Paul Curtis / Chris Bolen (t)

### b. SERVICE BRANCH

COMMUNICATIONS UNIT LEADER	Brent Haberer
COMMUNICATION TECHNICIAN	Brad Boyette
SECURITY MANAGER	Don Simon
FOOD UNIT LEADER	

## 10. AIR BRANCH

AIR OPERATIONS BRANCH DIR.	Sean Cox
AIR SUPPORT GROUP SUPERVISOR	Brian Knapp
AIR TACTICAL GROUP SUPV	R1 pool

## 11. FINANCE SECTION

FINANCE SECTION CHIEF	Jamie Wade
FINANCE SECTION CHIEF	Darla Quick
TIME UNIT LEADER	Karen Martinez / Barbara Hogg
COST UNIT LEADER	Scott Turner / Natalie Stewart (t)
COMPENSATION/CLAIMS UNIT LDR	Meriinda Valdez* / Gloria McCabe
COMPENSATION/CLAIMS UNIT LDR	Jennifer Hebbeler (t)
PROCUREMENT UNIT LEADER	Stephanie Archuleta
PERSONNEL TIME RECORDER	Angelita Whatley
EQUIPMENT TIME RECORDER	Beth Hartwood / Kirstin Donelson

## 12. MEDICAL SECTION

MEDICAL SECTION CHIEF	Bill Kuamo'o
MEDL – PLANNING	Brandie Smith
MEDL – ICP	Cheyenne Lane (t)
MEDL – FIELD	Mike Short (t)

PREPARED BY (PSC) Bob Love



\* Virtual Position



# Ridge/Doris Point/Tin Soldier Fire Weather Forecast



**FORECAST NO:** 16  
**PREDICTION FOR:** Thursday  
**SHIFT DATE:** 08/24/23  
**FORECAST ISSUED:** 08/23/23 at 1930 MDT

**NAMES OF FIRES:** Ridge, Doris Point, Tin Soldier  
**UNIT:** MT-Flathead National Forest  
**SIGNED:** Trent Smith- **Incident Meteorologist**  
 text/email obs: 406-360-6330/trent.smith@noaa.gov

**WEATHER DISCUSSION:** A ridge of high pressure will become the dominant feature over the fire today with the winds being mainly terrain driven. A front from the eastside of the Continental Divide will push through the fires tonight into Friday. This front will cause easterly winds, but will have little to no effect on temperatures.

### TODAY:

**SKY/WEATHER:** Mostly sunny.

**Max Temperature:** 75-80 lower elevations (below 4500 ft) and 66-71 mid-slopes to ridges.

**Min RH:** 26-31% lower elevations (below 4500 ft) and 37-42% mid-slopes to ridges

**20 ft WINDS: Slope/Valley** – Upslope/up-drainage to 8 mph.

**Doris/Ridge Ridgetop** – Northwest 5-10 mph with afternoon gusts to 15 mph.

**Tin Soldier Ridgetop** - West 5-10 mph with afternoon gusts to 15 mph.

**LAL:** 1                                      **Chance of Wetting Rain (0.10"):** 0%                                      **HAINES INDEX:** 3 (Low)

### TONIGHT:

**SKY/WEATHER:** Mostly clear.

**Min Temperature:** 43-48.

**Max RH:** 70-75% lower elevations (below 4500 ft) and 60-65% mid-slopes to ridges. .

**20 ft WINDS: Slope/Valley** – Terrain up to 7 mph, becoming northeast 3-8 mph after 2100.

**Ridgetop** – Northwest 5-10 mph turning northeast to 7-12 mph gusts to 20 mph after 2100.

**LAL:** 1                                      **Chance of Wetting Rain (0.10"):** 0%

### Outlook for FRIDAY:

**SKY/WEATHER:** Mostly sunny becoming partly cloudy in the afternoon.

**Max Temperature:** 81-86 lower elevations (below 4500 ft) and 72-77 mid-slopes to ridges.

**Min RH:** 29-34% lower elevations (below 4500 ft) and 41-46% mid-slopes to ridges

**20 ft WINDS: Slope/Valley** –East 3-8 mph.

**Ridgetop** – East 5-10 mph gusts to 20 mph.

**Extended Forecast Discussion:** The ridge of high pressure will continue to be the dominant feature over the fire this weekend into the first part of next week. A warming and drying trend will continue over the fires, with the warmest and driest conditions occurring on Monday and Tuesday. A cold front is still anticipated to impact the fire on Wednesday.

8/22/2023 observations thru 1900	Min Temp	Max RH	Max Temp	Min RH	Peak Wind	Precipitation
<b>Spotted Bear Lookout (7202')</b>	46	98	58	51	30 mph	0.01
<b>IRAWS46-Desert Mtn (6360')</b>	48	99	58	48	22 mph	0.00
<b>IRAWS45-Firefighter Mtn (5683')</b>	51	99	62	40	24 mph	0.13
<b>Spotted Bear RS (3725')</b>	53	100	70	36	15 mph	0.09
<b>West Glacier RAWs (3165')</b>	57	100	73	28	19 mph	0.00
<b>Hungry Horse RAWs (3123')</b>	58	98	73	26	29 mph	0.01

# FIRE BEHAVIOR FORECAST

<b>FORECAST NUMBER:</b> 16	<b>TYPE OF FIRE:</b> Wildland Fire
<b>FIRE NAME:</b> Tin Soldier/Ridge and Doris Point	<b>OPERATIONAL PERIOD:</b> Day Shift, August 24, 2023
<b>DATE ISSUED:</b> August 23, 2023	<b>TIME ISSUED:</b> 2000
<b>UNIT:</b> Flathead National Forest	<b>SIGNED:</b> Stewart Turner, FBAN

## INPUTS

**WEATHER SUMMARY:** Mostly sunny.

**MAX TEMP:** 75-80 lower elevations (below 5500 ft) and 66-71 mid-slopes to ridges.

**Humidity:** 26-31% lower elevations (below 4500 ft) and 37-42% mid-slopes to ridge

**20 FOOT WINDS: Valleys/Lower Slope:** Up-slope/up-drainage to 8 mph.

Doris/Ridge Ridgetop – Northwest 5-10 mph with afternoon gusts to 15 mph.

Tin Soldier Ridgetop - West 5-10 mph with afternoon gusts to 15 mph

**Haines 3 (Low) LAL 1**

**FUELS:** The major fuel types, found in and around the fire area include compact timber stands, timber, understory, brush and heavy down and dead.

**Ignition Receptiveness: ERC:** 20 well below the 90<sup>th</sup> percentile.

**Probability of Ignition:** 53% **Spotting distance:** Ridge top timber .1-mile, brush .2-mile

**Dryness:** Dead and down fuel moistures: **1 hour** – 6% **10 hour**-17 %, **100 hour** -23%, **1000 hour**–18%.

## OUTPUTS

### FIRE BEHAVIOR

**GENERAL:**

Some of the heavy fuels will continue to smolder. Expect to see more smoldering as the fuels dry. No perimeter growth is anticipated.

**SPECIFIC:**

**Sullivan Fire:** Smoldering fire behavior.

**Bruce Fire:** Some of the sheltered and protected heavies will smolder.

**Ridge Fire:** No growth is expected. Low fire behavior.

**Doris Point Fire:** Smoldering will continue in the heavy fuels. Low fire behavior with little growth.

**AIR OPERATIONS:**

No limitations to air operations.

## SAFETY

*Common Denominators of fire behavior on tragedy fires:*

- *Most incidents happen on the smaller fires or on isolated portions of larger fires.*
- *Most fires are innocent in appearance before unexpected shifts in wind direction and/or speed results in “flare-ups” or “extreme fire behavior.” In some cases, tragedies occur in the mop-up stage.*

<b>DIVISION ASSIGNMENT LIST</b> ICS-204				1. BRANCH <b>1</b>		2. DIVISION/GROUP <b>A / M</b>				
3. INCIDENT NAME <b>RIDGE</b>				4. OPERATIONAL PERIOD <b>Date: 08/24/2023</b> <b>Time: 0700-2000</b>						
OPERATIONS PERSONNEL										
PLANNING OPS: Caleb Finch / Lindsay McElfresh (T) / Brandon Woodward (T) FIELD OPS: Ralph Lucas / Charles Ebert (T) DIVISION/GROUP SUPERVISOR: Larry Badger / Nathan Bradford (T) (8/26)				BRANCH DIRECTOR: Barry Green  AIR OPERATIONS BRANCH DIRECTOR: Sean Cox						
RESOURCES ASSIGNED THIS PERIOD										
STRIKE TEAM/TASK FORCE/RESOURCE DESIGNATOR		Last Shift	LEADER	NUMBER PERSONS	DROP OFF POINT/TIME	PICK UP POINT/TIME				
TFLD (T)	O-101	8/25	Edward Rablin	1	River Ranch ICP / 0700	River Ranch ICP / 2000				
TFLD (T)	O-184.82	9/5	Dana Johnston	1	River Ranch ICP / 0700	River Ranch ICP / 2000				
HC2 MARLETTE PEAK	C-9	8/27	Jason Foster	23	River Ranch ICP / 0700	River Ranch ICP / 2000				
HC2 R&R CONTRACTING	C-30	8/30	Christobal Rocha	20	River Ranch ICP / 0700	River Ranch ICP / 2000				
HC2 IRON MOUNTAIN 6	C-19	8/29	Israel Santana	20	River Ranch ICP / 0700	River Ranch ICP / 2000				
HC2 WEST COAST 33	C-33	8/30	Luis Gonzalez	20	River Ranch ICP / 0700	River Ranch ICP / 2000				
ENG3 MISSOULA CITY	E-96	8/25	Jeremy Williams	3	River Ranch ICP / 0700	River Ranch ICP / 2000				
ENG3 AAA FORESTRY (REPAIRS)	E-112	8/25	Jeff Mix-Catron	3	River Ranch ICP / 0700	River Ranch ICP / 2000				
ENG3 LL MEADOW WILDFIRE	E-109	8/25	Reed Gracie	3	River Ranch ICP / 0700	River Ranch ICP / 2000				
ENG3 AZ-ASF E361	E-143	9/5	Katie Speraski	5	River Ranch ICP / 0700	River Ranch ICP / 2000				
ENG6 EAST MISSOULA	E-94	8/25	Tanner Ferguson	2	River Ranch ICP / 0700	River Ranch ICP / 2000				
ENG6 TORCH FIRE	E-144	9/5	Stephen Tolman	3	River Ranch ICP / 0700	River Ranch ICP / 2000				
SOFR	O-128	8/26	Matthew Martin	1	River Ranch ICP / 0700	River Ranch ICP / 2000				
MED TEAM 3	O-110	9/3	Robert Smith	2	River Ranch ICP / 0700	River Ranch ICP / 2000				
MED TEAM 4	O-109	9/2	James Fox	2	River Ranch ICP / 0700	River Ranch ICP / 2000				
AMBU 10 KALISPELL	E-114	8/25	Jessica Kinzer	2	River Ranch ICP / 0700	River Ranch ICP / 2000				
<b>CONTROL OPERATIONS:</b> Task: Secure and monitor fireline as appropriate and safe to do so from A/W division break to M/R break. Begin backhaul of water handling equipment, suppression related supplies and trash where fire line is secure enough to do so. Purpose: Keep fire within current foot print and account for and remove any unnecessary equipment from fire area. End State: Fire remains contained to current perimeter and all accountable property, supplies, and trash is removed and returned to Supply Unit.										
<b>SPECIAL INSTRUCTIONS:</b> • READS and REAFs will be operating in multiple divisions. They will check in and out with DIVS. • * Denotes local resource with IA responsibilities.										
FUNCTION		FREQUENCY Rx	FREQUENCY Tx	CHAN	FUNCTION		FREQUENCY Rx	FREQUENCY Tx	CHAN.	
COMMAND	CMD C3	170.4250 / 131.8	168.0750 / 131.8	1	AIR COMMAND	A/G PRI	173.8375	173.8375 / 123.0	13	
FOREST	RPT	173.1125	164.3750 / 107.2	10						
ROADS		151.5050	151.5050 / 94.8	12	MEDEVAC A/G	MED A/G	155.3400	154.3400 / 156.7	15	
TACTICAL	TAC 4	168.0500 / 131.8	168.050 / 131.8	4	AIRGUARD	AIRGUARD	168.6250	168.6250 / 110.9	16	
PREPARED BY (RESOURCE UNIT LEADER) Mark McEntarffer				APPROVED BY (PLANNING SECTION CHIEF) Dana Bagnoli <i>D Bagnoli PSC</i>				DATE 08/23/2023	TIME 2100	

# DIVISION ASSIGNMENT LIST

ICS-204

1. BRANCH <b>1</b>	2. DIVISION/GROUP <b>R</b>
-----------------------	-------------------------------

3. INCIDENT NAME <b>RIDGE</b>	4. OPERATIONAL PERIOD <b>Date: 08/24/2023</b> <b>Time: 0700-2000</b>
----------------------------------	--

**OPERATIONS PERSONNEL**

PLANNING OPS: Caleb Finch / Lindsay McElfresh (T) / Brandon Woodward (T) FIELD OPS: Ralph Lucas / Charles Ebert (T) DIVISION/GROUP SUPERVISOR: Ricky Romero / Andre Dulac (T) O-222	BRANCH DIRECTOR: Barry Green  AIR OPERATIONS BRANCH DIRECTOR: Sean Cox
---	--

**RESOURCES ASSIGNED THIS PERIOD**

STRIKE TEAM/TASK FORCE/RESOURCE DESIGNATOR	Last Shift	LEADER	NUMBER PERSONS	DROP OFF POINT/TIME	PICK UP POINT/TIME	
HC1 TATANKA	C-26	8/30	David Zortman	18	River Ranch ICP / 0700	River Ranch ICP / 2000
HC1 LEWIS & CLARK	C-14	8/24	Nicholas Wydra	22	River Ranch ICP / 0700	River Ranch ICP / 2000
TFLD	O-138	8/27	Bode Mecham	1	River Ranch ICP / 0700	River Ranch ICP / 2000
TFLD (T)	O-185	9/1	Patrick Zimmer	1	River Ranch ICP / 0700	River Ranch ICP / 2000
TFLD (T)	O-184.77	9/5	Brett Idol	1	River Ranch ICP / 0700	River Ranch ICP / 2000
TFLD (T)		8/30	Doug Kanaski	1	River Ranch ICP / 0700	River Ranch ICP / 2000
HC2 WEST COAST 31	C-31	8/30	Julio Olmos	20	River Ranch ICP / 0700	River Ranch ICP / 2000
HC2 PNW FIRE	C-20	8/28	Miguel Esquibel	20	River Ranch ICP / 0700	River Ranch ICP / 2000
ENG3 CASTLE MOUNTAIN	E-111	8/25	John Tiller	3	River Ranch ICP / 0700	River Ranch ICP / 2000
ENG3 SHERIDAN	E-110	8/25	Bob Sheridan	4	River Ranch ICP / 0700	River Ranch ICP / 2000
HEQB	A-15.10		Mark Troxel	1	River Ranch ICP / 0700	River Ranch ICP / 2000
HEQB (T)	A-15.2		Ben O'Connor	1	River Ranch ICP / 0700	River Ranch ICP / 2000
HEQB (T)	O-190	8/28	Kyler Knapp	1	River Ranch ICP / 0700	River Ranch ICP / 2000
HEQB (T)	O-187	9/1	Drew Czynscon	1	River Ranch ICP / 0700	River Ranch ICP / 2000
HEQB (T)	O-188	9/2	Zach Emerson	1	River Ranch ICP / 0700	River Ranch ICP / 2000
LOGL SLACK	E-34	9/1	Jamie Slack	1	River Ranch ICP / 0700	River Ranch ICP / 2000
LOGL SIDERIUS	E-35	9/1	Brandon Clouse	1	River Ranch ICP / 0700	River Ranch ICP / 2000
LOGT MATHENY LINE	E-132	8/30	Timothy Matheny	1	River Ranch ICP / 0700	River Ranch ICP / 2000
LOGT RONKOSKI TRUCKING	E-133	8/30	Ron Koski	1	River Ranch ICP / 0700	River Ranch ICP / 2000
SKG3 ROCKY MOUNTAIN	E-67	9/5	Devin Meyer	1	River Ranch ICP / 0700	River Ranch ICP / 2000
WTS2 WALKING Y4	E-27	8/31	Al Hensley	1	River Ranch ICP / 0700	River Ranch ICP / 2000
WTS2 MARTIN CITY	E-61	8/24	Tom Torpin	2	River Ranch ICP / 0700	River Ranch ICP / 2000
SOFR	O-157	8/30	Troy Maguire	1	River Ranch ICP / 0700	River Ranch ICP / 2000
MED TEAM 6	O-208	9/2	Ayala Rahm	3	River Ranch ICP / 0700	River Ranch ICP / 2000
MED TEAM 1	O-63	8/28	Ryan Gregor	2	River Ranch ICP / 0700	River Ranch ICP / 2000

**CONTROL OPERATIONS:**  
 Task: Continue indirect line construction from 5360 road north to Emery Creek while scouting for potential direct line construction opportunities. From DP 16 to R/W break, secure and monitor fire including any spot fires outside of control lines.  
 Purpose: To prevent fire from crossing established control lines and potentially impacting values at risk.  
 End State: New fire line is constructed in areas with a high probability of success to meet the purpose ensuring existing fire line is secured, fire and spot fires remain at their existing size.

**SPECIAL INSTRUCTIONS:**  
 • READS and REAFs will be operating in multiple divisions. They will check in and out with DIVS.

FUNCTION	FREQUENCY Rx / TONE	FREQUENCY Tx / TONE	CHAN	FUNCTION	FREQUENCY Rx / TONE	FREQUENCY Tx / TONE	CHAN.		
COMMAND	CMD C3	170.4250 / 131.8	168.0750 / 131.8	1	AIR COMMAND	A/G PRI	173.8375	173.8375	13
FOREST	RPT	173.1125	164.3750 / 107.2	10					
ROADS		151.5050	151.5050 / 94.8	12	MEDEVAC A/G	MED A/G	155.3400	155.3400 / 156.7	15
TACTICAL	TAC 7	166.7250 / 131.8	166.7250 / 131.8	7	AIRGUARD	AIRGUARD	168.6250	168.6250 / 110.9	16

PREPARED BY (RESOURCE UNIT LEADER) Mark McEntarffer	APPROVED BY (PLANNING SECTION CHIEF) Dana Bagnoli <i>D Bagnoli PSC</i>	DATE 08/23/2023	TIME 2100
--	---	--------------------	--------------

# DIVISION ASSIGNMENT LIST

ICS-204

1. BRANCH

1

2. DIVISION/GROUP

W

3. INCIDENT NAME

**RIDGE**

4. OPERATIONAL PERIOD

**Date: 08/24/2023**

**Time: 0700-2000**

### OPERATIONS PERSONNEL

PLANNING OPS: Caleb Finch / Lindsay McElfresh (T) / Brandon Woodward (T)

FIELD OPS: Ralph Lucas / Charles Ebert (T)

DIVISION/GROUP SUPERVISOR: Justin Wedo

BRANCH DIRECTOR: Barry Green

AIR OPERATIONS BRANCH DIRECTOR: Sean Cox

### RESOURCES ASSIGNED THIS PERIOD

STRIKE TEAM/TASK FORCE/RESOURCE DESIGNATOR		Last Shift	LEADER	NUMBER PERSONS	DROP OFF POINT/TIME	PICK UP POINT/TIME
HC2IA MIDEWIN	C-16	8/25	Jerry Hoffman	19	River Ranch ICP / 0700	River Ranch ICP / 2000
TFLD	C-22.24	8/26	Cody Forgea	1	River Ranch ICP / 0700	River Ranch ICP / 2000
TFLD (T)	C-22.10	8/26	Danielle Goodson	1	River Ranch ICP / 0700	River Ranch ICP / 2000
HC2 IRON MONTAIN	C-18	8/29	Jesse Chiprez	20	River Ranch ICP / 0700	River Ranch ICP / 2000
HC2 WEST COAST 32	C-32	8/30	Benjamin Martinez	18	River Ranch ICP / 0700	River Ranch ICP / 2000
ENG6 BIGFORK 382	E-60	8/28	Sean Reffner	4	River Ranch ICP / 0700	River Ranch ICP / 2000
SOF2	O-206	9/3	Kim Lemke	1	River Ranch ICP / 0700	River Ranch ICP / 2000
MED TEAM 7	O-96	8/31	Rodney Schmidt	2	River Ranch ICP / 0700	River Ranch ICP / 2000
MED TEAM 2	E-129	9/6	Adam Osiadacz	2	River Ranch ICP / 0700	River Ranch ICP / 2000

### CONTROL OPERATIONS:

Task: Secure and monitor fireline as appropriate from W/R division break to R/A break and begin backhaul of water handling equipment, suppression related supplies, and trash where fireline is secure enough to do so.  
 Purpose: Keep fire within current footprint and account for and remove any unnecessary equipment from fire area.  
 End State: Fire remains contained to current perimeter and all accountable property, supplies, and trash is removed and returned to Supply Unit.

### SPECIAL INSTRUCTIONS:

- READS and REAFs will be operating in multiple divisions. They will check in and out with DIVS.

FUNCTION	FREQUENCY Rx / TONE	FREQUENCY Tx / TONE	CHAN	FUNCTION	FREQUENCY Rx / TONE	FREQUENCY Tx / TONE	CHAN.		
COMMAND	CMD C3	170.4250 / 131.8	168.0750 / 131.8	1	AIR COMMAND	A/G PRI	173.8375	13	
FOREST	RPT	173.1125	164.3750 / 107.2	10					
ROADS		151.5050	151.5050 / 94.8	12	MEDEVAC A/G	MED A/G	155.3400	155.3400 / 156.7	15
TACTICAL	TAC 8	166.7750 / 131.8	166.7750 / 131.8	8	AIRGUARD	AIRGUARD	168.6250	168.6250 / 110.9	16

PREPARED BY (RESOURCE UNIT LEADER)	APPROVED BY (PLANNING SECTION CHIEF)	DATE	TIME
Mark McEntarffer	Dana Bagnoli <i>D Bagnoli PSC</i>	08/23/2023	2100



<b>DIVISION ASSIGNMENT LIST</b>					1. BRANCH		2. DIVISION/GROUP		
ICS-204					<b>1</b>		<b>DORIS POINT</b>		
3. INCIDENT NAME <b>DORIS POINT</b>					4. OPERATIONAL PERIOD <b>Date: 08/24/2023</b> <b>Time: 0700-2000</b>				
<b>OPERATIONS PERSONNEL</b>									
PLANNING OPS: Caleb Finch / Lindsay McElfresh (T) / Brandon Woodward (T)					BRANCH DIRECTOR: Barry Green				
FIELD OPS: Ralph Lucas / Charles Ebert (T)					AIR OPERATIONS BRANCH DIRECTOR: Sean Cox				
DIVISION/GROUP SUPERVISOR: Guy Wilson / Tyler Richwine (T)									
<b>RESOURCES ASSIGNED THIS PERIOD</b>									
STRIKE TEAM/TASK FORCE/RESOURCE DESIGNATOR			Last Shift	LEADER	NUMBER PERSONS	DROP OFF POINT/TIME	PICK UP POINT/TIME		
SMOD CHEROKEE O-223			9/5	Max White	3	River Ranch ICP / 0700	River Ranch ICP / 2000		
ENG6 MT-FNF 661			8/30	Forest Barclay	6	River Ranch ICP / 0700	River Ranch ICP / 2000		
ENG6 MT-CGF E6821			8/25	Greg Daniels	4	River Ranch ICP / 0700	River Ranch ICP / 2000		
MED TEAM 5			O-111	8/27	Michael Sowell	2	River Ranch ICP / 0700	River Ranch ICP / 2000	
<b>CONTROL OPERATIONS:</b> Task: Maintain confine, contain, and point protection strategy in coordination with the Flathead National Forest. Purpose: To have mitigations in place to protect values that may be impacted by the fire. End State: Values At Risk are not impacted by the current or expected fire spread.									
<b>SPECIAL INSTRUCTIONS:</b> <ul style="list-style-type: none"> <li>READS and REAFs will be operating in multiple divisions. They will check in and out with DIVS.</li> </ul>									
<b>FUNCTION</b>		<b>FREQUENCY Rx / TONE</b>	<b>FREQUENCY Tx / TONE</b>	<b>CHAN</b>	<b>FUNCTION</b>		<b>FREQUENCY Rx / TONE</b>	<b>FREQUENCY Tx / TONE</b>	<b>CHAN.</b>
COMMAND	CMD C3	170.4250 / 131.8	168.0750 / 131.8	1	AIR COMMAND	A/G PRI	173.8375	173.8375	13
FOREST		173.1125	164.3750 / 107.2	10					
ROADS		151.5050	151.5050 / 94.8	12	MEDEVAC A/G	MED A/G	155.3400	155.3400 / 156.7	15
TACTICAL	TAC 9	168.2500 / 131.8	168.2500 / 131.8	9	AIRGUARD	AIRGUARD	168.6250	168.6250 / 110.9	16
<b>PREPARED BY (RESOURCE UNIT LEADER)</b>				<b>APPROVED BY (PLANNING SECTION CHIEF)</b>				<b>DATE</b>	<b>TIME</b>
Mark McEntarffer				Dana Bagnoli <i>D Bagnoli PSC</i>				08/23/2023	2100

# DIVISION ASSIGNMENT LIST

ICS-204

1. BRANCH

1

2. DIVISION/GROUP

Repair Group

3. INCIDENT NAME

RIDGE

4. OPERATIONAL PERIOD

Date: 08/24/2023

Time: 0700-2000

### OPERATIONS PERSONNEL

PLANNING OPS: Caleb Finch / Lindsay McElfresh (T) / Brandon Woodward (T)

FIELD OPS: Ralph Lucas / Charles Ebert (T)

DIVISION/GROUP SUPERVISOR: Brendon McNeil

BRANCH DIRECTOR: Barry Green

AIR OPERATIONS BRANCH DIRECTOR: Sean Cox

### RESOURCES ASSIGNED THIS PERIOD

STRIKE TEAM/TASK FORCE/RESOURCE DESIGNATOR	Last Shift	LEADER	NUMBER PERSONS	DROP OFF POINT/TIME	PICK UP POINT/TIME
TFLD O-221	8/27	Beau Cartwright	1	River Ranch ICP / 0700	River Ranch ICP / 2000
TFLD (T) O-224	9/5	Mark Wahlberg	1	River Ranch ICP / 0700	River Ranch ICP / 2000
DOZ2 SIDERIUS E-1	9/1	Dan Siderius	1	River Ranch ICP / 0700	River Ranch ICP / 2000
SKD TAMARACK TIMBER E-126	8/27	Rob Miller	2	River Ranch ICP / 0700	River Ranch ICP / 2000

**CONTROL OPERATIONS:**  
 Task: Locate and assess fire suppression repair needs.  
 Purpose: Mitigate suppression impacts.  
 End State: All control lines are identified and plan is developed to begin suppression repair.

**SPECIAL INSTRUCTIONS:**  
 • READS and REAFs will be operating in multiple divisions. They will check in and out with DIVS.

FUNCTION	FREQUENCY Rx / TONE	FREQUENCY Tx / TONE	CHAN	FUNCTION	FREQUENCY Rx / TONE	FREQUENCY Tx / TONE	CHAN.
COMMAND CMD C3	170.4250 / 131.8	168.0750 / 131.8	1	AIR COMMAND A/G PRI	173.8375	173.8375	13
FOREST RPT	173.1125	164.3750 / 107.2	10	MEDEVAC A/G MED A/G	155.3400	155.3400 / 156.7	15
ROADS	151.5050	151.5050 / 94.8	12	AIRGUARD AIRGUARD	168.6250	168.6250 / 110.9	16
TACTICAL TAC 5	168.2000 / 131.8	168.2000 / 131.8	5				

PREPARED BY (RESOURCE UNIT LEADER) Mark McEntarffer	APPROVED BY (PLANNING SECTION CHIEF) Dana Bagnoli <i>D Bagnoli PSC</i>	DATE 08/23/2023	TIME 2100
--	---	--------------------	--------------

<b>DIVISION ASSIGNMENT LIST</b> ICS-204				1. BRANCH <b>2</b>		2. DIVISION/GROUP <b>TIN SOLDIER</b>			
3. INCIDENT NAME <b>TIN SOLDIER</b>				4. OPERATIONAL PERIOD <b>Date: 08/24/2023</b> <b>Time: 0700-2000</b>					
OPERATIONS PERSONNEL									
PLANNING OPS: Caleb Finch / Lindsay McElfresh (T) / Brandon Woodward (T) FIELD OPS: Ralph Lucas / Charles Ebert (T) DIVISION/GROUP SUPERVISOR: Aaron Livingston / Aaron Strobel (T)				BRANCH DIRECTOR: TJ Lowder AIR OPERATIONS BRANCH DIRECTOR: Sean Cox					
RESOURCES ASSIGNED THIS PERIOD									
STRIKE TEAM/TASK FORCE/RESOURCE DESIGNATOR			Last Shift	LEADER	NUMBER PERSONS	DROP OFF POINT/TIME	PICK UP POINT/TIME		
HC1 LOLO C-22			8/26	Shawn Faiella	24	Spotted Bear / 0700	Spotted Bear / 2000		
WFM SPOTTED BEAR *				Scott Reid	9	Spotted Bear / 0700	Spotted Bear / 2000		
TFLD (TASK FORCE 1) O-32			8/25	Jamie Wood	1	Spotted Bear / 0700	Spotted Bear / 2000		
TFLD (T) O-186			9/2	Coyde Fickle	1	Spotted Bear / 0700	Spotted Bear / 2000		
HC2IA ILLINOIS C-2			8/26	Rich Lewis	20	Spotted Bear / 0700	Spotted Bear / 2000		
SMOD GREAT LAKES *			9/2	Chris Loomis	18	Spotted Bear / 0700	Spotted Bear / 2000		
SMOD MI-HIF *			8/27	Deelan Shalley	6	Spotted Bear / 0700	Spotted Bear / 2000		
ENG4 BOSKET *			9/1	Steve Bailey	2	Spotted Bear / 0700	Spotted Bear / 2000		
WTS2 CONLEY *			8/26	Owen Conley	1	Spotted Bear / 0700	Spotted Bear / 2000		
TFLD (TASK FORCE 2) * O-36			8/26	Ryle Benke	1	Spotted Bear / 0700	Spotted Bear / 2000		
TFLD (T) O-2			8/24	William Ryan	1	Spotted Bear / 0700	Spotted Bear / 2000		
HETF TOUGH GO E-50			9/2	Russ Miller	6	Spotted Bear / 0700	Spotted Bear / 2000		
SOF2 O-97			8/27	Cougan Carothers	1	Spotted Bear / 0700	Spotted Bear / 2000		
MED TEAM 8 O-209			9/1	Bejone Mixon	2	Spotted Bear / 0700	Spotted Bear / 2000		
AMBU 9 E-58			8/28	Amanda Macarthur	2	Spotted Bear / 0700	Spotted Bear / 2000		
<b>CONTROL OPERATIONS:</b> Task: Assess Point Protection plans. Improve contingency lines and seek opportunities for direct attack. Continue prepping Meadow Creek Road to Tin Creek. Purpose: Prevent loss or damage to values. End State: Fire does not negatively affect structures or infrastructure as previously identified.									
<b>SPECIAL INSTRUCTIONS:</b> <ul style="list-style-type: none"> <li>* Denotes local resource on loan and have IA responsibilities.</li> <li>READs and REAFs will be operating in multiple divisions. They will check in and out with DIVS.</li> </ul>									
FUNCTION		FREQUENCY Rx / TONE	FREQUENCY Tx / TONE	CHAN	FUNCTION		FREQUENCY Rx / TONE	FREQUENCY Tx / TONE	CHAN.
COMMAND	CMD S	173.1875 / 167.9	164.3875 / 167.9	5	AIR COMMAND	A/G PRI	169.2625	169.2625 / 167.9	3
COMMAND	CMD N	168.1125 / 167.9	168.2875 / 167.9	6					
TACTICAL	TAC 1	168.0500 / 167.9	168.0500 / 167.9	1	MEDEVAC A/G	MED A/G	155.3400	155.3400 / 156.7	15
FOREST	RPT	173.1125	164.3750 / 114.8	9	AIRGUARD	AIRGUARD	168.6250	168.6250 / 110.9	16
PREPARED BY (RESOURCE UNIT LEADER) Mark McEntarffer				APPROVED BY (PLANNING SECTION CHIEF) Dana Bagnoli <i>D Bagnoli PSC</i>			DATE 08/23/2023	TIME 2100	

Controlled Unclassified Information/Basic

<b>AIR OPERATIONS SUMMARY</b>		Prepared By: Sean Cox AOB	Prepared: 08/23/2023	Prepared Time: 1700 hrs.
Ridge/Dorris Point/ Tin Soldier Complex	<b>2. OPERATIONAL PERIOD</b>	START TIME: 0700	END TIME: 2000	SUNRISE: 0642
	08/24/2023			SUNSET: 2033

ALL AIRCRAFT ARE ON PREPOSITION AND ARE NOT ASSIGNED TO ANY ONE FIRE. AS SUCH, IF THERE IS A NEED FOR ROTER WING AIRCRAFT IN THE ABSENCE OF AERIAL SUPERVISION, ORDER AIRCRAFT THROUGH AIR SUPPORT.

DO YOUR PART FOR AVIATION MISSION SUCCESS. A NUMBER OF FACTORS CAN CONTRIBUTE TO DELAYS IN AIRCRAFT ON SCENE TIMES. SOME CONTRIBUTORS TO DELAYS INCLUDE RISK ASSESSMENTS, WEATHER, UNCLEAR INTENT, OR HIGHER LOCALIZED, REGIONAL, OR NATIONAL PRIORITIES TO NAME A FEW.

MULTI-MISSION AIRCRAFT AND PRODUCTS (IR/VIDEO/MAPPING) AVAILABLE. ORDER THROUGH AIR OPERATIONS.

**AGENCY EXTRACTION ( SHORT-HAUL) H-0CH : KALISPELL AIRPORT NIGHT/COMMHOIST: TWO BEAR AIR : GLACIER PARK INT'L AIRPORT ORDER THROUGH COMMUNICATIONS**



Freq 126.8250

Freq 127.2500

6. PERSONNEL	NAME	PHONE #	7. FREQUENCIES	AM	FM	8. FIXED-WING Avail/ Type/ Make-Model/ N#/ Base
AOBD	Sean Cox	530-409-2363	CMND ALL FIRES SEE 205			AIRTANKERS/SCOOPERS: ORDER THRU AERIAL SUPERVISION
ASGS	Brian Knaop	520-591-2704			173.8375 Tx Tone 123.0	
ATGS	Matt Counts	406-270-7437	Ridge/ Dorris Point A/G		126.8250	Ridge Helibase: 48 27.734 x 113 59.416 "West Glacier KOA "
HLCO	John Harris	805-550-7903			169.6265 no tone	
			Tin Soldier A/G		127.250	Finance email: <a href="mailto:2023.ridge.finance@firenet.gov">2023.ridge.finance@firenet.gov</a> OR
KalisPELL Dispatch	Aircraft Desk	406-758-5306	Tin Soldier A/A		155.3400 Tx Tone 156.7	MS TEAMS Channel under respective fire name. Type 3 UAS module on order.
Flathead FAO	Mike Bentley	307-760-5428	Medical A/G			

FAA N#	TY	MAKE/ MODEL	BASE	START	AVAIL	REMARKS	FAA N#	TY	MAKE/ MODEL	BASE	START	AVAIL	REMARKS
	1					Order through ASGS							
	2					Order through ASGS							
	3					Order through ASGS							

# SHORT-HAUL OPERATIONS

## CAPABILITIES

- During an operational Short-Haul the helicopter is capable of inserting Short-Haulers into an area with tight canopy cover and/or technical terrain.
- Haul line lengths range from 100 feet to 350 feet.
- Short hauler and/or medical gear can be delivered to the medical scene even if extraction by short-haul is not necessary.

## ORDERING

- EMT or Medical Incident IC determines medical extraction is required.
- Follow local established procedures and/or Medical Incident Report (MIR) in the IRPG.
- Confirm aircraft type, call sign, estimated time of arrival and frequency.
- Give site selection information when ordering: hazards (i.e. ash, smoke, snags, aerial), tree height, terrain, and patient transport configuration (supine or seated position). Repeat hazards and give updated weather conditions as well as brief patient update to responding helicopter.

**PROCESS:** The helicopter will fly to the coordinates provided. They will make contact with ground personnel on scene with the patient using an identified air-to-ground frequency. The helicopter will complete a short-haul recon and size up, gather patient update information and then fly to a landing zone (LZ) to configure for short-haul operations. The helicopter will be monitoring the appropriate air-to-ground, air guard and victor frequencies. From this point, ground resources should only contact the helicopter in case of an emergency. During the insertion and extraction process ground personnel must be clear of the area.

## ON SCENE – EXPECT THE FOLLOWING

- 1 or 2 rescuers (at least one qualified as an EMT or higher)
- Backboard (if needed and not already on scene)
- All equipment necessary for patient extraction

The Patient Extraction Bag accommodates most backboards.

- A patient on a backboard, TRS, SKED or litter will be inserted into the bag.



The Seat Harness is used for patients not requiring the use of a backboard.



# SAFETY/RISK MESSAGE

<b>Incident Name:</b> Ridge / Doris Point Tin Soldier Complex	<b>Date:</b> 8/24/2023	<b>Signed:</b> <i>Jim Burton</i> SOF1
--	------------------------	---------------------------------------

## Safety Discussion

The chain of events that leads to accidents and injuries that we have the most control over is ourselves. The vigilance in which we continually assess our environment and identify hazards and threats is what makes the difference every minute of the day. This arms ourselves with the information we need to make decisions as we navigate our tasks. What is your process for identifying and communicating hazards? Do you make hazards known to those next to you? What way do you communicate these hazards?

## Significant Risks

Aviation Use Hazards	<b>Moderate Risk</b>	Is this flight necessary? What other means are available to accomplish the mission?
Driving Hazards	<b>Moderate Risk</b>	Muddy roads are improving, do your speeds increase too? Why, what's the rush? Be mindful of other traffic and eliminate distractions.
Fire Entrapment Hazards	<b>Low Risk</b>	Minimal threat. LCES can be used for many different threats.
Hit by Hazards	<b>Moderate Risk</b>	Weakened trees and rolling material will continue to be a concern. Do not lose focus on these hazards. A lapse in your awareness or momentary distraction could be the last.
Environmental Hazards	<b>Moderate Risk</b>	The bears are real and pose a threat to all incident personnel. Take the time to read the bear insert on the next page. It could save your life.

### NIOSH Heat Safety Tool



### Mission Risk Assessment (GAR 2.0)

#### Step 1: Identify, Assess, & Mitigate Risk Elements

<b>Instructions:</b> To determine the level of risk for each element below, estimate the risk level based on the Low/Medium/High scale. If your perceived rating is Medium or High, explore mitigations. Mark the element that corresponds to the mitigated risk level and document the perceived risk(s) and mitigation(s).	<b>THESE ELEMENTS ARE IDENTIFIED AS CONTRIBUTING TO A LARGE PORTION OF RISK. RATE EACH ELEMENT BELOW</b>		
<b>Planning</b> - Enough time and information for thorough planning, briefing and implementation. Consider: Completeness of mission information and on-scene details/hazards, contingency plan discussed, LCES.	<b>Complete</b> Low	<b>Partial</b> Medium	<b>None</b> High
<b>Event</b> - Refers to mission complexity. Consider: task duration, overextended, air support or logistics dependent, accessibility (remote location, access), urban interface, public evac, coordination, etc.	<b>Routine</b> Low	<b>Infrequent</b> Medium	<b>Abnormal</b> High
<b>Assets</b> - Proper number and skill set for the mission. Consider: qualifications, experience, familiarity w/ task, physical/mental state (fatigue, stress, etc.), adequate supervision (span of control), organization.	<b>Excellent</b> Low	<b>Marginal</b> Medium	<b>Poor</b> High
<b>Communications/Supervision</b> - Ability to maintain communication throughout mission. Consider: availability & quality w/command & adjoining forces, clear task - purpose - end state, backup comms, limited comms.	<b>Excellent</b> Low	<b>Partial</b> Medium	<b>None</b> High
<b>Environment</b> - Conditions surrounding mission. Consider: weather, vegetation, temperature, night/day, rugged terrain, visibility, etc.; physical hazards, road conditions, vapors, ongoing ops, snags, wildlife, etc.	<b>Ideal</b> Low	<b>Marginal</b> Medium	<b>Extreme</b> High

#### Step 2: Determine Overall Risk Level

Consider: 1) the rating for each element above, 2) the importance of the element for mission execution, 3) how elements may interact. Rate the perceived Overall Risk Level when considering this info.	Low	Medium	High
---	-----	--------	------

#### Step 3: Determine Risk vs. Gain: Do gains warrant the risk?

Step 3a. Enter the Overall Risk Level (Step 2) in the RISK box (Low, Medium, or High). Step 3b. Review the definitions for Gain below and enter the level in the GAIN box. (Low, Medium, or High).		← RISK VS. GAIN →	
<b>Low Gain</b> - Situation with unclear benefits or a low probability for providing concrete results. Examples: no threat to public safety, minor impact to livelihood, low environmental impact, minimal public interest/concern, non-urgent/time sensitive activity.			
<b>Medium Gain</b> - Situation that provides immediate and real benefits. Examples: minor threat to public safety, medium impact to livelihood, significant environmental impact, public interest/concern.			
<b>High Gain</b> - Situation that provides immediate and real benefits that if ignored could result in loss of life. Examples: significant threat to public safety or security, urgent SAR, major impact to livelihood, significant environmental impact, high public interest.			

### Incident Response Pocket Guide (IRPG)





# NOTICE



## You're in Bear Country

- DO NOT bring food, toiletries, or scented items into your tent.
- Sleep at least 100 yards away from the kitchen/food prep area.
- Secure food attractants properly in a bear resistant bin or in a secured building.
- Stay alert and look for bear activity, especially where visibility or hearing is limited (thick vegetation, streams).
- Make noise whenever possible to avoid surprising a bear, especially where visibility or hearing is limited. The human voice is the best deterrent, be loud.
- Travel in a group and keep members together.
- Never run from a bear.
- If a bear is hanging around, alert others, and from a safe place make it leave. Yell, set off car alarms, air horns, bang pots and pans, etc.
- If you experience any type of conflict with a bear or have any questions/concerns, immediately contact Bear Specialist Justine Vallieres at (406)250-1265.

INCIDENT RADIO COMMUNICATIONS PLAN		Incident Name		Date/Time Prepared		Operational Period Date/Time		
		Branch 1 - Ridge Fire		08/23/2023 1800		08/24/2023 0700 to 08/25/23 0700		
Controlled Unclassified Information//Basic								
Ch	Function	Channel Name/Trunked Radio System Talkgroup	Assignment	RX Freq	RX Tone/NAC	TX Freq	Tx Tone/NAC Mode A, D or	Remarks
1	CMD	CMD C3	All Divs	170.4250	131.8	168.0750	131.8	A Command
2	CMD	CMD C6	Future	168.4750	131.8	165.4000	131.8	A
3								A
4	TAC	TAC 4	DIV A/M	168.0500	131.8	168.0500	131.8	A DIV A/M
5	TAC	TAC 5	REPAIR	168.2000	131.8	168.2000	131.8	A Repair Group
6	TAC	TAC 6		168.6000	131.8	168.6000	131.8	A
7	TAC	TAC 7	DIV R	166.7250	131.8	166.7250	131.8	A DIV R
8	TAC	TAC 8	DIV W	166.7750	131.8	166.7750	131.8	A DIV W
9	TAC	TAC 9	Doris	168.2500	131.8	168.2500	131.8	A Doris Point Group
10	FOREST	DESERT	All Divs	173.1125		164.3750	107.2	Kalispell Dispatch
11	Mutual FD Tac	RED	Mutual FD Tac	154.0700		154.0700	156.7	A Local FD Tac
12	Roads	Roads	All Divs	151.5050		151.5050	94.8	A
13	A/G PRI	A/G PRI	All Divs	173.8375		173.8375	123.0	A
14								A DO NOT USE
15	Medical A/G	TAN	All Divs	155.3400		155.3400	156.7	A Primary Medical Evac
16	AIRGUARD	AIRGUARD	All Divs	168.6250		168.6250	110.9	A AIRGUARD
Prepared By (Communications Unit)								Last Clone Name: 08/15/2023
Brent Haberer COML / Brad Boyette COML-T								Communications Phone: 208-510-8368

After hours Medical  
406-345-5975

Use Human Repeaters when and where necessary.

Use only Channels assigned.

Controlled Unclassified Information//Basic

NFES 1330



# INCIDENT RADIO COMMUNICATIONS PLAN

Incident Name

**Branch 2 - Tin Soldier Fire**

Date/Time Prepared

**08/23/2023 @ 1800**

Operational Period Date/Time

**08/24/2023 0700 to 08/25/2023 0700**

Controlled Unclassified Information//Basic											
Ch	Function	Channel Name/Trunked Radio System Talkgroup	Assignment	RX Freq	RX Tone/NAC	TX Freq	Tx Tone/NAC	Mode A, D or	Remarks		
1	TAC	TAC 1	Tin Soldier	168.0500	167.9	168.0500	167.9	A	Tin Soldier Group		
2	TAC	TAC 2		168.2000	167.9	168.2000	167.9	A	Unassigned		
3	A/G	TIN A/G	All DIV	169.2625		169.2625	167.9	A	Tin Soldier A/G		
4	TAC	FNF WRK1		168.1625		168.1625	167.9	A			
5	CMD	CMD SOUT	Command	173.1875	167.9	164.3875	167.9	A	Spotted Bear Lookout - CMD Link		
6	CMD	CMD NORT	Command	168.1125	167.9	163.2875	167.9	A	Baptiste Lookout - CMD Link		
7	A/G	FNF A/G		169.1250		169.1250	167.9	A			
8	Forest RPT	DESERT	Backup to ICP	173.1125		164.3750	107.2	A	Hungry Horse Area - Linked		
9	Forest RPT	LOOKOUT		173.1125		164.3750	114.8	A	Spotted Bear Area - Linked		
10	Forest RPT	BAPTISTE		173.1125		164.3750	141.3	A	Middle Reservoir Area - Linked		
11	TAC	R1 TAC		167.1125		167.1125	167.9	A			
12	Mutual FD Tac	RED		154.0700		154.0700	156.7	A	Mutual FD Tac		
13	TAC	LOGGER2		151.5050	94.8	151.5050	94.8	A			
14	TAC	LOGGER1	DO NOT USE	151.9250		151.9250		A	DO NOT USE		
15	TAC	TAN / MED	All DIV	155.3400		155.3400	156.7	A	Medical A/G		
16	AIRGUARD	AIRGUARD	All DIV	168.6250		168.6250	110.9	A	AIRGUARD		
Prepared By (Communications Unit)											
Brent Haberer COML / Brad Boyette COML-T											
Last Clone Name: 08/15/2023											
Communications Phone: 208-510-8368											

After hours Medical  
406-345-5975

Use Human Repeaters when and where necessary.

Use only Channels assigned.

Controlled Unclassified Information//Basic

NFES 1330

INCIDENT RADIO COMMUNICATIONS PLAN		Incident Name		Date/Time Prepared		Operational Period Date/Time		
		Initial Attack		08/23/2023 @ 1800		08/24/2023 0700 to 08/25/2023 0700		
Controlled Unclassified Information//Basic								
Ch	Function	Channel Name/Trunked Radio System Talkgroup	Assignment	RX Freq	RX Tone/NAC	TX Freq	Tx Tone/NAC Mode A, D or	Remarks
1	TAC	TAC 1		172.2250	107.2	172.2250	107.2	A
2	TAC	TAC 2		172.3750	107.2	172.3750	107.2	A
3	TAC	TAC 3		154.3025	107.2	154.3025	107.2	A
4	TAC	FNF WORK 1		168.1625		168.1625	167.9	A
5	CMD	CMD DIR	Ridge CMD DIR	167.2500	107.2	167.2500	107.2	A Ridge Command DIR
6	CMD	CMD RPT	Ridge CMD RPT	167.2500	107.2	162.2625	107.2	A Ridge Command RPT
7	FOREST DIR	FNF DIR	Forest DIR	173.1125		173.1125	123.0	A Forest Dir
8	FOREST RPT	DESERT	Forest RPT	173.1125		164.3750	107.2	A Forest RPT
9	A/G	FNF A/G	Forest A/G	169.1250		169.1250	167.9	A Forest A/G
10	A/G	RIDGE A/G	All DIV	173.8375		173.8375	123.0	A All DIV
11	A/G	AREA A/G	3 A/G52	168.3875		168.3875	123.0	A 3 A/G52
12	Mutual FD Tac	MAROON	MutualFD Pri	154.2800		154.2800	156.7	A MutualFD Pri
13	Mutual FD Tac	SCARLET	Mutual FD Sec	154.2950		154.2950	156.7	A Mutual FD Sec
14	Mutual FD Tac	RED	Mutual FD IA	154.0700		154.0700	156.7	A Mutual FD IA
15	Medical A/G	TAN	MT Med A/G	155.3400		155.3400	156.7	A MT Med A/G
16	AIRGUARD	AIRGUARD	All DIV	168.6250		168.6250	110.9	A AIRGUARD
Prepared By (Communications Unit)								Last Clone Name: 08/15/2023
Brent Haberer COML / Brad Boyette COML-T								Communications Phone: 208-510-8368

After hours Medical  
406-345-5975

Use Human Repeaters when and where necessary.

Use only Channels assigned.

Controlled Unclassified Information//Basic

NFES 1330

# Finance Message

Please use the QR code on front page of IAP to submit your time to

[2023.ridge.finance@firenet.gov](mailto:2023.ridge.finance@firenet.gov)

If you need assistance with electronic submission, there will be a Finance presence at briefing to assist those in need.

**We now are accepting Time documents for THREE different fires:**

**RIDGE- P1QGT5**

**TIN SOLDIER-P1QGH4**

**DORIS POINT-P1QJ6J**

**Please note on CTR or Shift Ticket which fire you are working on.**

**Turn all time in through the firenet email above.**

- FOR CTR SUBMISSION, PLEASE PUT CTR and RO# IN SUBJECT LINE OF EMAIL.
- FOR SHIFT TICKETS, PLEASE PUT ST AND RO# IN SUBJECT LINE OF EMAIL.
- IF TURNING IN FINAL CTR OR SHIFT TICKET, PLEASE ALSO PUT FINAL IN SUBJECT LINE.
- PLEASE MAKE EVERY EFFORT TO TURN IN ALL CTR's AND SHIFT TICKETS DAILY.
- PLEASE INCLUDE YOUR RESOURCE ORDER # ON ALL DOCUMENTATION SUBMITTED, INCLUDING RECEIPTS.
- AUTO RESPONSE IS SET UP TO LET YOU KNOW THAT DOCUMENTS WERE RECEIVED.
- FOR DEMOB: Finance will email the Draft OF-288 or OF-286 to employee for their review and approval. If everything is correct, Finance will reply with FINAL OF-288/OF-286.
- CONTRACTORS: Be sure to get Performance Evaluation before demobilization.

### FINANCE CHECK IN:

- PLEASE ENSURE THE BELOW DOCUMENTS ARE EMAILED TO FINANCE WITH RESOURCE ORDER NUMBER NOTED:

<b>Agency Equipment/Crews:</b>	<b>Overhead:</b>	<b>Contract Equipment/Contract Crews:</b>	<b>Cooperator:</b>
<ul style="list-style-type: none"> <li>● Manifest</li> <li>● Resource Order</li> <li>● CTR's</li> </ul>	<ul style="list-style-type: none"> <li>● Resource Order</li> <li>● AD Hire Form (If an AD)</li> <li>● CTR's</li> </ul>	<ul style="list-style-type: none"> <li>● Agreement/Manifest</li> <li>● Resource Order</li> <li>● Shift Ticket</li> <li>● Inspection Forms</li> </ul>	<ul style="list-style-type: none"> <li>● Cooperative Agreement</li> <li>● Resource Order</li> <li>● Shift Ticket</li> <li>● Inspection Forms</li> </ul>

# Official Fire Information



Ridge, Doris Point, Tin Soldier Fire Information

Phone: (406)998-6074 (8:00 am to 8:00 pm)

Email: [2023.Ridge@firenet.gov](mailto:2023.Ridge@firenet.gov)

Inciweb: <https://inciweb.nwcg.gov/incident-information/mtfnf-ridge-fire>

Facebook: <https://www.facebook.com/ridge.fire.information>

YouTube: <https://www.youtube.com/@2023ridgefire>

## TALKING POINTS FOR AUGUST 23, 2023

- Ridge Fire: Crews on the western and northern area of the fire continued to address areas of heat, mop up, and back hauled excess equipment.
- Doris Point Fire: Crews are maintaining confinement.
- Tin Soldier Fire: Yesterday, crews held and secured Meadow Creek Road.
- Crews will maintain point protection strategy on the values at risk in coordination with the Flathead National Forest.
- Heavy equipment will be constructing indirect line through dense vegetation.
- Aviation will be utilized if the weather and winds allow.
- Steady rain has ended but elevated moisture lingering across the area will result in the development of showers and thunderstorms at times

### Evacuation Changes:

The Flathead County Sheriff's Office has rescinded the pre-evacuation notice from the east side of Spotted Bear Road to West Glacier. An evacuation order has been issued by the Flathead County Sheriff for Heinrude community. Visit the Flathead Sheriff's office for details <https://www.facebook.com/flatheadsheriff>

**FIRE** The Hungry Horse Reservoir is closed to all public access, including both the east and west side roads. As firefighting efforts continue on the Ridge Fire, the Tin Soldier, and other fires in the area, the closure is in place to provide for public and firefighter safety. <https://www.fs.usda.gov/alerts/flathead/alerts-notices/?aid=82283>

**CLOSURES:**

**No Drone Zone:** A temporary flight restriction is in place over the Ridge, Doris Point, Tin Soldier Fires. <https://tfr.faa.gov/tfr2/list.html>

To interact: If you have photos/videos you'd like to share for Inciweb to help tell the story of the fire and help the public understand what you're doing on the line, you can email them to [2023.Ridge@firenet.gov](mailto:2023.Ridge@firenet.gov). It's helpful to know what date the photo was taken, where and by whom.

# DEMOB MESSAGE

## TENTATIVE RELEASE FOR 8/24/23

### RIDGE

O-123 0830 REAF HEFLIN, JOSH CONNER  
 O-143 0830 FOBS KEYS, MIKE  
 O-125 0930 REAF MERCER, DERRICK L

E-105 0830 COM1 COM1 KIT CONTRACTING  
 E-123 0930 WTT1 WTT1 CEDAR CITY FD  
 E-26 1030 WTS2 WTS2 R2K ENTERPRISES  
 E-97 1030 ENG3 SOLOMON

### TIN SOLDIER

O-27 0830 WFA1 SCHACHT, STEVEN

## TENTATIVE RELEASE FOR 8/25/23

### RIDGE

C-13 0830 CRWC CRWCAMP CHICO 28  
 C-14 0830 CRW1 CRW1 LEWIS & CLARK IHC

E-61 1030 WTS2 WTS2 MARTIN CITY 1691

O-45 0800 SEC1 BOGGS, JOSEPH  
 O-78 0815 AREP DIAZ, MIGUEL  
 O-120 2000 SITL EISZELE, DANIEL

## DEMOB IS LOCATED AT RIVER RANCH ICP

Resources approved for release will report to the Demob Unit to receive a checkout form. The crew leader or single resource will obtain required signatures after turning in any accountable equipment or supplies, vehicle inspections if required, completing any required documentation, and closing out with the Finance Section.

Dana Bagnoli, DMOB  
 385-422-3351  
 2023.ridge.demob@firenet.gov

VEHICLE INSPECTIONS:  
 WEED WASH:  
 Located at KOA Staging  
 251 Halfmoon Flats Rd., West Glacier, MT

To request a flight:

Submit your  
 information at least 72  
 hours in advance

## FLIGHT REQUEST FORM

Request Order #	
Name as shown on photo ID	
Date of Birth	
Cell Phone	
Male or Female	
Email Address	
Last Work Date	
Flight Date	
Departure Airport Code	
Arrival Airport Code	
Rental Location	
Need ride to airport?	





# HUMAN RESOURCE MESSAGE

## Civility and Respect

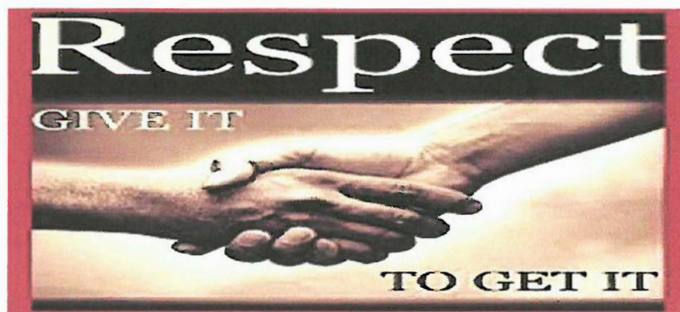

**Civility** is an essential behavior of all employees and refers to how we relate to each other, our contractors, and our stakeholders. These civil relations and interactions include the fundamental attributes of courtesy, politeness, and consideration.

**Respect** connects us at a personal level. Treating everyone with respect is one of the incident's core values. It honors all the participants in an interaction by creating a safe place to have sometimes difficult conversations and leads to an environment of honesty and mutual trust.

Because there have not been any reportable HR issues since the start of this incident, I'm assuming you all have been civil and respectful. Thank you for that, it makes my job a lot easier!

We urge you to continue acting in a manner which demonstrates respect for yourself and respect for others. Take advantage of every opportunity to be proactive in promoting civility and respect.

Feel free to reach out to me if you have any questions, concerns, or have an answer to my riddle.

**Yesterday's Riddle:** What word can be written forwards, backwards or upside down, and can still be read from left to right? **Answer: NOON**

**Today's Riddle:** Does the law allow a man to marry his widow's sister? Why?

**(REMEMBER – Please don't use the internet, use your smart brain instead!)**

Ana Parada, HRSP  
(505) 270-3457  
[ana\\_parada@firenet.gov](mailto:ana_parada@firenet.gov)



# TRAINING SPECIALIST

## RIDGE FIRE

**The Training Specialist is working remotely.**

### **Training Specialist Contact Information:**

- Emil Picchi
- Call/Text 650-520-5102
- Email: [TNSPEP@gmail.com](mailto:TNSPEP@gmail.com)

### **How to register as a Trainee**

- Use the QR code below. If you're unable to register using the QR code, please call me anytime at 650-520-5102.
- Once registered, you will receive text and email updates.

### **How to close-out your training assignment.**

1. **Trainer:** Complete an Evaluator Record in the back of the Position Task Book and make as many entries as possible within the individual tasks. Discuss this with your Trainee.
2. **Trainer:** Complete an individual performance rating (ICS 125) and go over the performance rating with your Trainee.
3. **Trainee:** Text or email a photo of your individual performance rating (ICS 225) to the Training Specialist.
4. **Trainee:** Complete the exit questions using the QR code below.
5. **Trainee:** Once 1-4 are completed, the Trainee and the Training Specialist will have a brief conversation to discuss the Task Book and assignment.
6. **Done:** except for safe travels home.



Trainee  
Check-In



Exit  
Interview



SAW PART REQUEST			
<b>CREW NAME</b>			
<b>RESOURCE #</b>		<b>REQUEST DATE</b>	
<b>CONTACT NAME</b>		<b>DIVISION</b>	
<b>PHONE #</b>		<b>NEEDED Date &amp; Time</b>	
<b>EMAIL</b>			
<b>DIVISION APPROVAL</b>			
<b>SAW INFORMATION</b>			
<b>MAKE</b>	<b>STIHL</b> _____	<b>HUSQVARNA</b> _____	<b>OTHER</b> _____
<b>MODEL</b>			
<b>BAR LENGTH</b>	20"   22"   24"   28"   30"   32"   36"		
<b>QUANTITY</b>	<b>PART NAME AND NUMBER</b>		<b>S#</b>
<b># OF DRIVERS</b>			
<b>PITCH (*)</b>	1/4" _____ 3/8" _____ .325 _____ .404 _____ 3/4" _____		
<b>GAUGE</b>	.043 _____ .050 _____ .058 _____ .063 _____		
<b>TOOTH LAYOUT</b>	FULL _____ SEMI-SKIP _____ FULL SKIP _____		
<b>TOOTH CUT</b>	CHISEL ___ MICRO CHISEL ___ SEMI CHISEL ___ CHAMFER-CHISEL ___		
<b># SPROCKET TEETH (*)</b>			
<b>DAMAGED BAR REPLACEMENT</b>	<p><b>NEED PROPERTY LOSS OR DAMAGE REPORT FORM 288/289 FULLY COMPLETED THROUGH ALL REQUIRED STATIONS. ALSO NEED DAMAGED BAR TURNED IN TO SUPPLY PRIOR TO OPENING NEW ONE. SUBJECT TO CHANGE PER IBA GUIDANCE.</b></p>		



# Incident Management Team Unit Locations

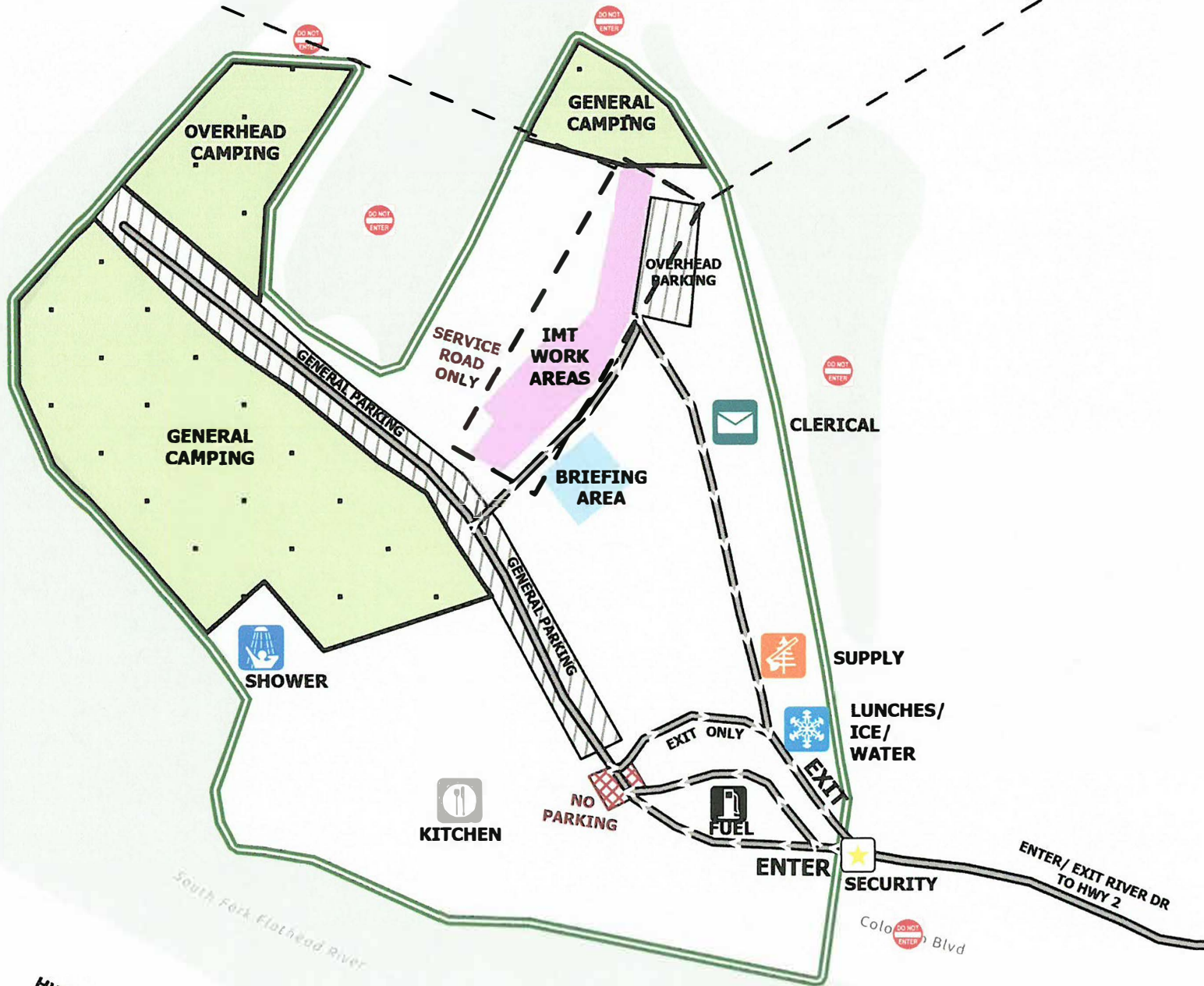
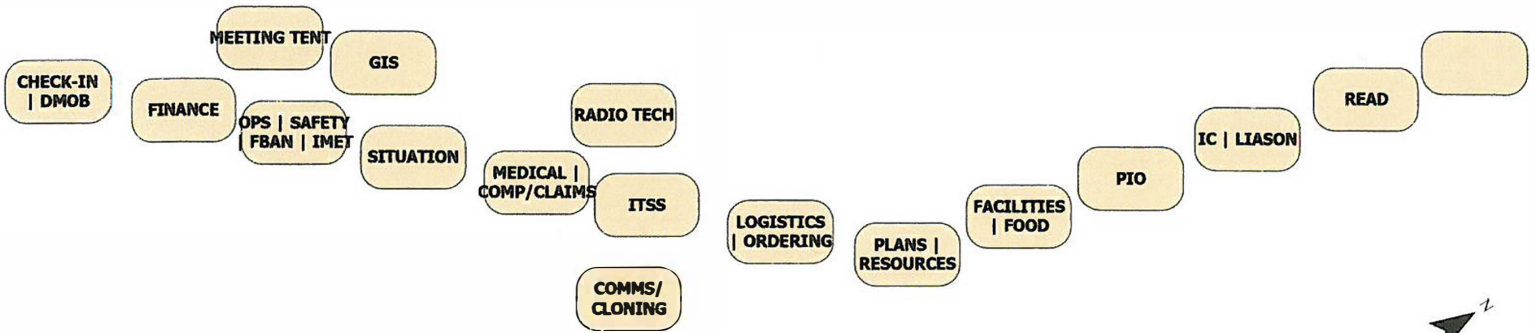

**ICP MAP**  
**Ridge Doris Point**  
 MT-FNF-000518  
 MT-FNF-000496



- |              |                   |                 |               |
|--------------|-------------------|-----------------|---------------|
| DO NOT ENTER | LUNCHES/ICE/WATER | IMT WORK SPACES | PARKING       |
| CLERICAL     | SHOWER            | IMT WORK AREAS  | NO PARKING    |
| FUEL         | SUPPLY            | BRIEFING AREA   | CAMPING AREAS |
| KITCHEN      | SECURITY          |                 |               |

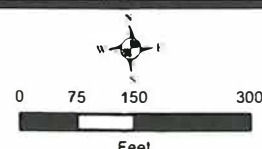

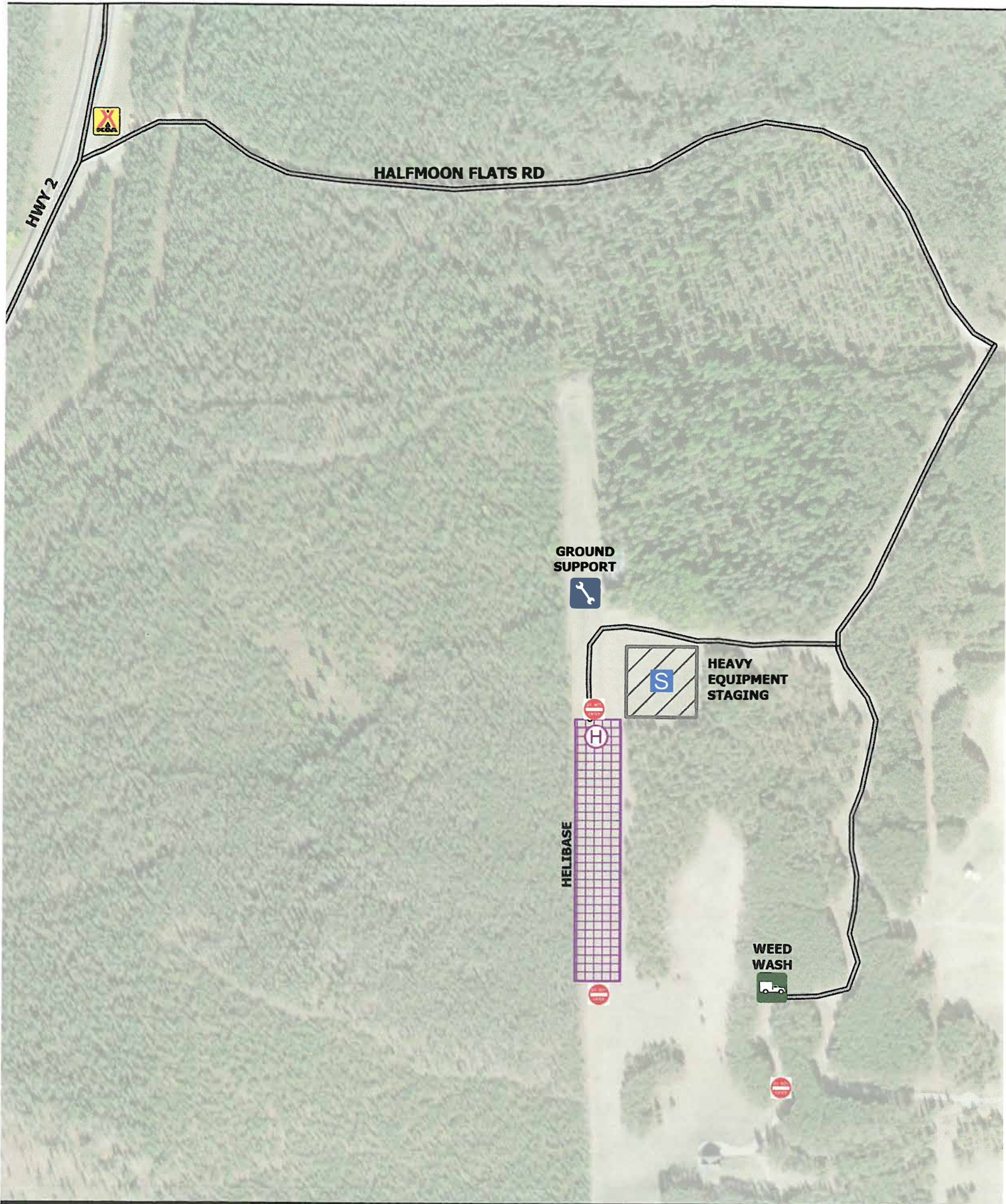







**HALFMOON CAMP**

**Ridge**

MT-FNF-000518



-  GROUND SUPPORT
-  HEAVY EQUIPMENT STAGING
-  HELIBASE
-  WEED WASH
-  DO NOT ENTER
-  HEAVY EQUIPMENT STAGING
-  HELIBASE

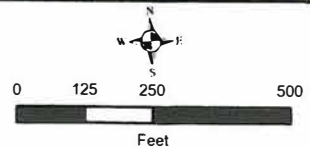

# Medical Plan

1. Incident / Project Name				2. Operational Period			
<b>Ridge, Doris Point, &amp; Tin Soldier</b>				Date/Time: 8/24/2023 (0700-2100)			
<b>3. Ambulance Services</b>							
Name	Location	Phone and Emergency Frequency			Advanced Life Support (ALS)		
		911			YES	NO	
Three Rivers EMS	31 7th Street W Columbia Falls, MT 59912	406-892-4244			X		
<b>4. Air Ambulance Services</b>							
Name	Phone	Type of Aircraft & Capability					
ALERT-1	911 866-302-9767	Bell 407 Critical Care					
Two Bear Air Resuce	911 406-758-5610	Bell 429 Rescue/ Hoist NVG					
350HQ	Kalispell Dispatch	H-125 Short-haul					
<b>5. Hospitals</b>							
Name Complete Address	Degrees Decimal Minutes	Travel Time From ICP		Phone	Helipad		Level of Care
		Air	Ground		Yes	No	
Logan Health Whitefish 1600 Hospital Way Whitefish, MT 59937	Lat: 48° 22.51' N	7 MINS	19 MINS	406-863-3500 Ask for ER	X		Level 4
	Long: 114° 19.56' W						
Logan Health Kalispell 350 Heritage Way Kalispell, MT 59901	Lat: 48° 22.84' N	10 MINS	33 MINS	406-752-5111 Ask for ER	X		Level 3
	Long: 114° 19.88' W						
St Patrick's Medical Center 500 W. Broadway Missoula, MT 59802	Lat: 113° 59.96' N	45 MINS	2.5 HRS	406-543-7271 Ask for ER	X		Level 2
	Long: 122° 19.39' W						
Harbor View Medical Center 325 9th Ave. Seattle, WA 98104	Lat: 47° 36.24' N	1.5 HRS	8.5 HRS	206-744-3140 Ask for ER	X		Level 1 Burn Center
	Long: 122° 19.39' W						
<b>Branch I</b>							
<b>DIV A/M</b>	EMS Responders & Capabilities:		<b>Med Team 3: O-110: Robert Smith EMPF: 541-285-8890 (Lead)</b> <b>Med Team 4: O-109: James Fox EMPF: 253-222-8023 (Lead)</b> <b>AMBO 10: E-114: Timothy Gaston EMPF 406-471-0146</b>				
	Equipment Available on Scene:		<b>BLS/ALS Kits; 4x4 ALS Ambulance</b>				
	Medical Emergency Channel:		<b>Command</b>		<b>A/G: TAN/MED (VFire28)</b>		
	ETA for Ambulance to Scene:		<b>All time approximate</b>				
	Air:		<b>25 min (minimum)</b>				
	Ground:		<b>15 min (minimum) to H15 Pt transfer point</b>				
	Approved Heli-spot		<b>H 15</b>				
	Lat:		<b>48° 22.894' N</b>				
Long:		<b>114° 00.283' W</b>					
<b>DIV R</b>	EMS Responders & Capabilities:		<b>Med Team 1: O-63: Ryan Gregor EMPF: 602-363-0770 (Lead)</b> <b>Med Team 6: O-208: Ayala Rahm EMPF: 520-403-8100 (Lead)</b>				
	Equipment Available on Scene:		<b>BLS/ALS Kits; UTV (Non pt transport capable)</b>				
	Medical Emergency Channel:		<b>Command</b>		<b>A/G: TAN/MED</b>		
	ETA for Ambulance to Scene:		<b>All time approximate</b>				
	Air:		<b>25 min (minimum)</b>				
	Ground:		<b>40 min (minimum) DP11 to H15 pt transfer point</b>				
	Approved Heli-spot		<b>H 8</b>		<b>H 10</b>		
	Lat:		<b>48° 21.861' N</b>		<b>48° 22.362' N</b>		
Long:		<b>113° 54.227' W</b>		<b>113° 54.227' W</b>			
<b>DIV W</b>	EMS Responders & Capabilities:		<b>Med Team 2: E-129: Adam Osiadacz EMPF: 805-477-8568 (Lead)</b> <b>Med Team 7: O-96: Rodney Schmidt EMPF: 406-261-9541 (Lead)</b>				
	Equipment Available on Scene:		<b>BLS/ALS Kits; UTV (pt transport capable)</b>				
	Medical Emergency Channel:		<b>Command</b>		<b>A/G: TAN/MED</b>		
	ETA for Ambulance to Scene:		<b>All time approximate</b>				
	Air:		<b>25 min (minimum)</b>				
	Ground:		<b>30 min (minimum) to H15 Pt transfer point</b>				
	Approved Heli-spot		<b>H 8</b>				
	Lat:		<b>48° 21.861' N</b>				
Long:		<b>113° 54.227' W</b>					

<b>DORIS POINT GROUP</b>	EMS Responders & Capabilities:	<b>AMBO 11: E-140: Aaron Henry 903-920-7692 (lead) Med Team 5: O-111: Michael Sowell EMPF: 502-593-1827 (Lead)</b>		
	Equipment Available on Scene:	<b>BLS/ALS Kits; 4x4 ALS Ambulance</b>		
	Medical Emergency Channel:	<b>Command A/G: TAN/MED</b>		
	ETA for Ambulance to Scene:	<b>All time approximate</b>		
	Air:	<b>25 min (minimum)</b>		
	Ground:	<b>20 min (minimum) to Dam Creek Pt transfer point</b>		
	Approved Heli-spot	<b>H 22</b>		
	Lat:	<b>48° 18.990' N</b>		
Long:	<b>113° 58.522' W</b>			

**Branch II**

<b>TIN SOLDIER GROUP</b>	EMS Responders & Capabilities:	<b>Med Team 8: O-209: Beione Mixon EMPF: 313-977-6319 (Lead) AMBO 9: E-58: Matt Roth EMPF: 406-214-9738 (Lead)</b>		
	Equipment Available on Scene:	<b>BLS/ALS Kits; 4x4 ALS Ambulance</b>		
	Medical Emergency Channel:	<b>Command A/G: TAN/MED</b>		
	ETA for Ambulance to Scene:	<b>All time approximate</b>		
	Air:	<b>30 min (minimum)</b>		
	Ground:	<b>1.25 hr (minimum) to East Pt transfer point</b>		
	Approved Heli-spot	<b>H 52</b>	<b>H 50</b>	<b>H 20</b>
	Lat:	<b>48° 04.720' N</b>	<b>47° 57.413' N</b>	<b>47° 55.098' N</b>
Long:	<b>113° 41.622' W</b>	<b>113° 33.496' W</b>	<b>113° 30.924' W</b>	

<b>8. Prepared By (Medical Unit Leader)</b>	<b>Date</b>	<b>Reviewed by (Safety Officer)</b>	<b>Date</b>
Cheyenne Lane MEDL(T) /s/ <i>Cheyenne Lane</i>	8/23/2023	Robert Martin SOF2 <i>Robert Martin</i>	8/23/23

**Night Time Medical Emergencies Procedures  
(2000-0700)**

**In ICP:**

1. Call 911
2. Call Medical at 406-435-5975

**In Spotted Bear Spike:**

1. Radio through Command  
with LOCATION and COMPLAINT

**For any questions or concerns please call**

**406-435-5975**

**Will Kuamo'o, MESC, 480-799-7447**

**Brandie Smith, MEDL, 719-207-1148**

**INTENTIONALLY LEFT BLANK**

**Medical Incident Report**

FOR A **NON-EMERGENCY INCIDENT**: WORK THROUGH CHAIN OF COMMAND TO REPORT AND TRANSPORT INJURED PERSONNEL AS NECESSARY.

FOR A **MEDICAL EMERGENCY**: IDENTIFY ON SCENE INCIDENT COMMANDER BY NAME AND POSITION AND ANNOUNCE "MEDICAL EMERGENCY" TO INITIATE RESPONSE FROM COMMUNICATIONS

**Use the following items to communicate situation to communications/dispatch.**

**1. CONTACT COMMUNICATIONS / DISPATCH** (Verify correct frequency prior to starting report)

*Ex: "Communications, Div. Alpha. Stand-by for Emergency Traffic."*

**2. INCIDENT STATUS:** Provide incident summary (including number of patients) and command structure.

*Ex: "Communications, I have a Red priority patient, unconscious, struck by a falling tree. Requesting air ambulance to Forest Road 1 at (Lat./Long.)"*

*"This will be the Trout Meadow Medical Incident, IC is TFLD Jones. EMT Smith is providing medical care."*

Severity of Emergency AND Transport Priority (priority 1, 2, 3)	<input type="checkbox"/> <b>RED / PRIORITY 1 Life or limb threatening Injury or illness. Evacuation need is IMMEDIATE</b> <i>Ex: Unconscious, difficulty breathing, bleeding severely, 2° – 3° burns more than 4 palm sizes, heat stroke, disoriented.</i>	
	<input type="checkbox"/> <b>YELLOW / PRIORITY 2 Serious Injury or illness. Evacuation may be DELAYED if necessary.</b> <i>Ex: Significant trauma, unable to walk, 2° – 3° burns not more than 1-3 palm sizes.</i>	
	<input type="checkbox"/> <b>GREEN / PRIORITY 3 Minor Injury or illness. Non-Emergency transport</b> <i>Ex: Sprains, strains, minor heat-related illness.</i>	
Nature of Injury or Illness & Mechanism of Injury		<i>Brief Summary of Injury or Illness (Ex: Unconscious, Struck by Falling Tree)</i>
Transport Request		<i>Air Ambulance / Short Haul/Hoist Ground Ambulance / Other</i>
Patient Location		<i>Descriptive Location &amp; Lat. / Long. (WGS84)</i>
Incident Name		<i>Geographic Name + "Medical" (Ex: Trout Meadow Medical)</i>
On-Scene Incident Commander		<i>Name of on-scene IC of Incident within an Incident (Ex: TFLD Jones)</i>
Crew Patient Care		<i>Name of Care Provider (Ex: EMT Smith)</i>

**3. INITIAL PATIENT ASSESSMENT:** Complete this section for each patient as applicable (start with the most severe patient)

Patient Assessment: (IRPG PAGE 106)	Age:	Weight:	Chief Complaint:
Skin Signs: (color/moisture/temp)	Level of Consciousness:	BP:	HR:      Respirations:
Treatment:			

**4. TRANSPORT PLAN:**

Evacuation Location ( <i>drop point, intersection, helispot, Lat. / Long, hazards</i> )	Patient's ETA to Location:
---	----------------------------

**5. ADDITIONAL RESOURCES / EQUIPMENT NEEDS:**

*Paramedic / EMT - Crews - Immobilization Devices - AED - Oxygen - Trauma Bag - IV/Fluid(s) - Splints - Rope rescue - Wheeled litter - HAZMAT - Extrication*

**6. COMMUNICATIONS: Identify State Air/Ground EMS Frequencies and Hospital Contacts as applicable**

Function	Channel Name/Number	Receive (RX)	Tone/NAC *	Transmit (TX)	Tone/NAC *
COMMAND					
AIR-TO-GRND					
TACTICAL					

**7. CONTINGENCY: Considerations:** If primary options fail, what actions can be implemented in conjunction with primary evacuation method? Be thinking ahead.

**8. ADDITIONAL INFORMATION:** Updates/Changes, etc.

**REMEMBER:** Confirm ETA's of resources ordered. Act according to your level of training  
Be Alert - Keep Calm - Think Clearly - Act Decisively

\*\*\* Follow up with MEDL upon return to ICP \*\*\*

### ACTIVITY LOG (ICS 214)

<b>1. Incident Name</b>	<b>2. Operational Period:</b> Date From: Time From:	Date To: Time To:
<b>3. Unit Name / Designator</b>	<b>4. Unit Leader (Name and Position))</b>	<b>5. Team / Agency</b>

<b>6. Personnel Roster Assigned</b>		
Name	ICS Position	Team / Agency

<b>7. Activity Log</b>	
TIME	MAJOR EVENTS

8. Prepared By: Name: _____	Position / Title: _____	Signature: _____
<b>ICS 214, Page 1</b>	(v181125)	Date / Time: _____

