

# Horse Prairie

9/7/2017

1800-0600

## Night Shift

*Incident #733114-18*

IAP Directory



Map Directory



OREGON DEPARTMENT OF FORESTRY

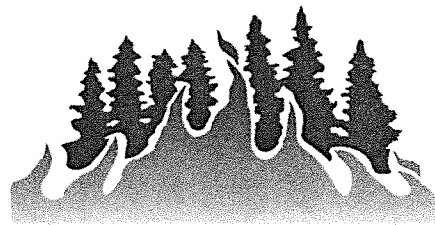

INCIDENT MANAGEMENT TEAM



<b>Incident Objectives</b>	1. Incident Name <b>Horse Prairie</b>	2. Date Prepared 9/7/2017	3. Time Prepared 1000												
4. Operational Period (Date and Time) 9/7/2017                      1800 - 0600 <b>Night Shift</b>															
5. General Control Objectives for the Incident (include Alternatives)															
<ul style="list-style-type: none"> <li>a. Fight fire aggressively and safely; maintain LCES at all times.</li> <li>b. Minimize fire size primarily through the use of direct tactics and a staffed night shift where possible.</li> <li>c. Keep fire South of Olalla Creek, West of Doe Creek, North of Middle Creek, East of Union Creek</li> <li>d. Maintain and build positive relationships with impacted landowners, public, and cooperating agencies.</li> <li>e. Maintain strict financial records and fiscal and equipment accountability.</li> <li>f. Act in a respectful and professional manner around the community.</li> <li>g. Protect tribal, cultural, archeological, and sensitive plant sites by coordinating with Resource Advisors.</li> <li>h. Provide for initial attack and assistance as requested on new and emerging incidents.</li> </ul>															
6. Weather Forecast for Period															
See attached weather forecast															
7. General Safety Message															
<ul style="list-style-type: none"> <li>*Anticipate and look for changes in weather and fire behavior</li> <li>*Initiate all actions based on current and expected fire behavior</li> <li>*Communicate hazards and mitigation measures to all personnel</li> <li>*Stay hydrated</li> </ul>															
8. Attachments (mark if attached)															
<table border="0"> <tr> <td><input checked="" type="checkbox"/> Organization List - ICS 203</td> <td><input checked="" type="checkbox"/> Fire Weather Forecast</td> <td><input type="checkbox"/> Suppression Repair Plan</td> </tr> <tr> <td><input checked="" type="checkbox"/> Div. Assignment Lists - ICS</td> <td><input type="checkbox"/> Fire Behavior Forecast</td> <td><input checked="" type="checkbox"/> Incident Maps</td> </tr> <tr> <td><input checked="" type="checkbox"/> Communications Plan - ICS</td> <td><input checked="" type="checkbox"/> Air Operations Summary - ICS 220</td> <td><input type="checkbox"/> Traffic Plan</td> </tr> <tr> <td><input checked="" type="checkbox"/> Medical Plan - ICS 206</td> <td><input type="checkbox"/> Safety Message</td> <td></td> </tr> </table>				<input checked="" type="checkbox"/> Organization List - ICS 203	<input checked="" type="checkbox"/> Fire Weather Forecast	<input type="checkbox"/> Suppression Repair Plan	<input checked="" type="checkbox"/> Div. Assignment Lists - ICS	<input type="checkbox"/> Fire Behavior Forecast	<input checked="" type="checkbox"/> Incident Maps	<input checked="" type="checkbox"/> Communications Plan - ICS	<input checked="" type="checkbox"/> Air Operations Summary - ICS 220	<input type="checkbox"/> Traffic Plan	<input checked="" type="checkbox"/> Medical Plan - ICS 206	<input type="checkbox"/> Safety Message	
<input checked="" type="checkbox"/> Organization List - ICS 203	<input checked="" type="checkbox"/> Fire Weather Forecast	<input type="checkbox"/> Suppression Repair Plan													
<input checked="" type="checkbox"/> Div. Assignment Lists - ICS	<input type="checkbox"/> Fire Behavior Forecast	<input checked="" type="checkbox"/> Incident Maps													
<input checked="" type="checkbox"/> Communications Plan - ICS	<input checked="" type="checkbox"/> Air Operations Summary - ICS 220	<input type="checkbox"/> Traffic Plan													
<input checked="" type="checkbox"/> Medical Plan - ICS 206	<input type="checkbox"/> Safety Message														
9. Prepared by                      Don Everingham - PSC		10. Approved by                      Link Smith - IC													
ICS-202															

ORGANIZATION ASSIGNMENT LIST		2. Date Prepared	3. Time Prepared
		9/7/2017	1000
1. Incident Name		4. Operational Period	
Horse Prairie		9/7/2017	1800 - 0600
Position	Name	Position	Name
<b>5. Incident Commander and Staff</b>		<b>9. Operations Section</b>	
Incident Commander	Link Smith (9/9)	Chief - Day	Matt Howard (9/9), Tyler McCarty(t) (9/9)
Deputy IC	Tom Savage (9/11)	Chief - Night	Eric Perkins (9/9)
Safety Officer	Kellie Carlsen (D) (9/9)	<b>a. Branch I - Division/Groups</b>	
Information Officer	Tom Fields (9/9)		
Liaison	Mark Prince (9/9)	Division A/M/P	Jacob Kruzyniec (9/9)
		Division Q	Chris Cook (9/9)
		Division S	John Tillotson (9/9)
		Division T/Y	George Brown (9/14)
<b>6. Agency/Landowner Representatives</b>		<b>b. Branch II - Division/Groups</b>	
DFPA AA	Pat Skrip		
BLM Roseburg	Heather Whitman, Kim Valentine		
Seneca Jones	Ted Reiss, Steve Weber		
Roseburg Resource	Scott Hoffine, Mark Wall		
Lone Rock Timber	Brennan Garrelts, Mark Kincaid		
Lead READ	Ryan Johnson		
BLM Roseburg READ	READ A / M / Y - McEnroe/Cross		
BLM Roseburg READ	READ P / S - Rogers/Roe		
BLM Roseburg READ	READ Q / T - Kehoe / Fong		
Cow Creek Tribe	Tracy DePew		
<b>7. Planning Section</b>		<b>c. Groups</b>	
Chief	Don Everingham (9/9)		
Deputy	Randy Baley (9/9)		
Resource Unit	Ryan Greco (9/9)		
Situation Unit	Mike Kroon (9/9)		
Demobilization Unit	Les Babnew (9/17)		
IMET	Mary Wister (9/13)		
FBAN	Mike Haasken (9/14)		
FOBS	Randy Smith (9/9)	<b>d. Air Operations Branch</b>	
GIS Specialist	Blake McKinley (9/9)	Air Ops Branch Director	Scott Swearingen (9/9), Greg Yates(t) (9/9)
Training Specialist		Air Support Supervisor	
		Air Attack Supervisor	Steve Wetmore (9/9)
		Helibase Manager	Kristina Sheppard (9/9)
		Air Tanker Coordinator	
<b>8. Logistics Section</b>		<b>10. Finance Section</b>	
Chief	Kristin Dodd (9/9)	Chief	Shannon Rand (9/9)
Deputy	Jay Walters	Deputy	James Short (9/9)
Service Branch Dir.	Paul Clements (9/9)	Time Unit	Stacy Fulker (9/9)
Support Branch Dir.	Jeff Hepler (9/18)	Procurement Unit	Sabrina Perez (9/9)
Supply Unit	Kevin Berry	Comp/Claims Unit	
Ground Support Unit	Jay Morey (9/9)	Cost Unit	
Communications Unit	Ryan Gantt	Crew Rep (ICPI)	Bob Arnsmeier (9/9)
Medical Unit	Mark Little		
Ordering Unit	Jennifer Weikel (9/9)		
Food Unit	Denise Berkshire (9/12)		
Prepared by:	Date	Approved By:	Date
Randall Baley (RESL)		Don Everingham (PSC)	

<b>DIVISION ASSIGNMENT LIST</b>		1. Branch I		2. Division A / M / P			
3. Incident Name <b>Horse Prairie</b>		4. Operational Period Date: 9/7/2017 Time: 1800 - 0600					
<b>5. Operations Personnel</b>							
Operations Chief		Eric Perkins (9/9)		Division/Group Supervisor		Jacob Kruzyniec	
Air Attack Supervisor		Steve Wetmore		Safety Officer		Kent Glazer / Kellie Carlsen	
<b>6. Resources Assigned this Period</b>							
Resource	Company	Name	Personnel	14th Day	Notes		
C-4 HC2	R&R Contracting	Rocha, Cristobal	20	9/10	Demob 9/9 0800		
C-5 HC2	R&R Company	Rocha, Frederico	20	9/10	Demob 9/9 0800		
C-512 HCl	Snake River	Nash, Daniel	10	9/11	Demob 9/8 1600		
C-514 HCl	Snake River	Esparaza, Rodolfo	10	9/11	Demob 9/8 1600		
C-510 HCl	Powder River	Moothart, Tyler	10	9/13	Demob 9/8 1600		
E-115 WAT2 4000gal	Don Whitaker Logging	Lemon, Pete	1	9/15			
E-958 PID	Mike Short - Team 1	Murray, Ryan/Holvec, Laura	2	9/18	Palm IR Operation		
E-959 PID	Mike Short - Team 2	Wood, Caleb/Holvec, Amber	2	9/18	Palm IR Operation		
<b>7. Control Operations</b>							
<p>*Mop spot fire 100%.            *Mop up 200' feet from perimeter.            *Initiate holding operations as line construction progresses.            *Check dozer berms for heat.</p>							
<b>8. Special Instructions</b>							
<p>*Document location and inventory of hose lays, folda-tanks, and pumps.            *Record all serial numbers and location of all Mark III pumps and provide info to Situation Unit            *Identify and mark drop points and communicate lat/long to the Situation Unit.</p>							
<b>9. Division/Group Communication Summary</b>							
Function	Branch	Frequency Rx	Tone	Frequency Tx	Tone	Channel	Remarks
Command	I	151.445		158.895	146.2	7	Command
DIV A / M / P	I	151.2350	156.7	151.2350	156.7	1	DIV A / M / P
Air to Ground	I	151.4150	156.7	151.4150	156.7	5	Air To Ground
Prepared by (RESL) Randall Baley		Approved by (PSC) Don Everingham (9/9)		Date 9/7/2017		Time 1000	

<b>DIVISION ASSIGNMENT LIST</b>			1. Branch I	2. Division Q			
3. Incident Name <b>Horse Prairie</b>			4. Operational Period Date: 9/7/2017 Time: 1800 - 0600				
<b>5. Operations Personnel</b>							
Operations Chief		Eric Perkins (9/9)		Division/Group Supervisor		Chris Cook (9/9)	
Air Attack Supervisor		Steve Wetmore		Safety Officer		Kent Glazer / Kellie Carlsen	
<b>6. Resources Assigned this Period</b>							
Resource	Company	Name	Personnel	14th Day	Notes		
O-653 HEQB(t)	North Carolina Forestry	Downs, Rufus	1	9/15	Short Shift (1800-2400)		
C-822 HC2	First Strike	Reich, James	20	9/15	Roll To Days 9/9		
O-959 STEN	WADNR	Schaffran, Andrew	1	9/15	Roll To Days 9/9		
E-622 ENG6	WADNR 76	Jensen, Derek	2	9/15	Roll To Days 9/9		
E-623 ENG6	WADNR 77	McLennan, Jeremy	2	9/15	Roll To Days 9/9		
E-624 ENG6	WADNR 78	Patton, Alex	2	9/15	Roll To Days 9/9		
E-625 ENG6	WADNR 79	Neumeier, Jed	2	9/15	Roll To Days 9/9		
E-626 ENG6	WADNR 80	Richie, Brandon	2	9/15	Roll To Days 9/9		
E-121 WAT2	Don Whitaker Logging	Simmons, Jason	1	9/14			
<b>7. Control Operations</b>							
<ul style="list-style-type: none"> <li>*Complete, improve, and hold containment lines.</li> <li>*Secure, hold, and patrol containment lines.</li> <li>*Conduct burn out operations and secure indirect line.</li> <li>*Continue to prep dozer and hand line for future burn operations.</li> <li>*Construct indirect line with equipment and hand crews for possible contingency or firing.</li> <li>*Assist structure protection resources to protect and secure structures as necessary.</li> <li>*Locate, identify, and mitigate hazard trees.</li> <li>*Identify and line large unburned islands.</li> <li>*Locate and contain spot fires</li> <li>*Mop up 50' feet in areas that are a "dirty burn".</li> <li>*Grid and patrol for spots fires.</li> </ul>							
<b>8. Special Instructions</b>							
<ul style="list-style-type: none"> <li>*Document location and inventory of hose lays, folda-tanks, and pumps.</li> <li>*Notify and coordinate burn operations with adjacent Divisions and resources.</li> <li>*Record all serial numbers and location of all Mark III pumps and provide info to Situation Unit</li> <li>*Identify and mark drop points and communicate lat/long to the Situation Unit.</li> </ul>							
<b>9. Division/Group Communication Summary</b>							
Function	Branch	Frequency Rx	Tone	Frequency Tx	Tone	Channe	Remarks
Command	I	151.445		158.895	146.2	7	Command
DIV Q	I	151.3850	156.7	151.3850	156.7	4	DIV Q
Air to Ground	I	151.4600	156.7	151.4600	156.7	6	Air To Ground
Prepared by (RESL) Randall Baley		Approved by (PSC) Don Everingham (9/9)		Date 9/7/2017		Time 1000	

<b>DIVISION ASSIGNMENT LIST</b>		1. Branch I	2. Division <b>S</b>				
3. Incident Name <b>Horse Prairie</b>		4. Operational Period Date: 9/7/2017 Time: 1800 - 0600					
<b>5. Operations Personnel</b>							
Operations Chief	Eric Perkins (9/9)	Division/Group Supervisor	John Tillotson				
Air Attack Supervisor	Steve Wetmore	Safety Officer	Kent Glazer / Kellie Carlsen				
<b>6. Resources Assigned this Period</b>							
Resource	Company	Name	Personnel	14th Day	Notes		
O-40 TFLD	ODF	Fitch, Jon	1	9/10	Identified IA Resource		
O-652 HEQB	North Carolina Forestry	Michael, Dillon	1	9/10	Short Shift (1800-2400)		
O-604 HEQB(t)	ODF	Spencer, Mitchel	1	9/10	Short Shift (1800-2400)		
C-13 HC2	Patrick	Barrett, Daniel	20	9/11	Demob 9/9 1600		
E-3 ENG6	HB Company	Morten, Kevin	2	9/10	Identified IA Resource		
E-4 ENG6	HB Company	Hartman, Justin	2	9/10	Identified IA Resource		
E-120 WAT	Don Whitaker Logging	Strong, Bob	1	9/15			
E-69 WAT2 4000gal	Charlie Yates	Jarrett, Brady	1	9/10			
E-863 WTS2 4000gal	Bruce Standley	Birch, John	1	9/12			
E-861 DOZ D5	Bruce Standley	Reid, Mike	1		Demob End Of Shift (9/8 0800)		
E-79 DOZ D7	Webber Logging	Ashdurn, Coby	1		Demob End Of Shift (9/8 0800)		
E-911 EXAC	Bruce Standley	Williams, Mike	1		Demob End Of Shift (9/8 0800)		
<b>7. Control Operations</b>							
<p>*Complete, improve, and hold containment lines.            *Secure, hold, and patrol containment lines.            *Conduct burn out operations and secure indirect line.            *Continue to prep dozer and hand line for future burn operations.            *Construct indirect line with equipment and hand crews for possible contingency or firing.            *Assist structure protection resources to protect and secure structures as necessary.            *Locate, identify, and mitigate hazard trees.            *Identify and line large unburned islands.            *Locate and contain spot fires            *Mop up 50' feet in areas that are a "dirty burn".            *Grid and patrol for spots fires.</p>							
<b>8. Special Instructions</b>							
<p>*Document location and inventory of hose lays, folda-tanks, and pumps.            *Notify and coordinate burn operations with adjacent Divisions and resources.            *Record all serial numbers and location of all Mark III pumps and provide info to Situation Unit            *Identify and mark drop points and communicate lat/long to the Situation Unit.</p>							
<b>9. Division/Group Communication Summary</b>							
Function	Branch	Frequency Rx	Tone	Frequency Tx	Tone	Channe	Remarks
Command	I	151.445		158.895	146.2	7	Command
DIV S	I	151.4750	156.7	151.4750	156.7	11	DIV S
Air to Ground	I	151.4600	156.7	151.4600	156.7	6	Air To Ground
Prepared by (RESL) Randall Baley		Approved by (PSC) Don Everingham (9/9)		Date 9/7/2017		Time 1000	

<b>DIVISION ASSIGNMENT LIST</b>		1. Branch I	2. Division T / Y				
3. Incident Name <b>Horse Prairie</b>		4. Operational Period Date: 9/7/2017				Time: 1800 - 0600	
<b>5. Operations Personnel</b>							
Operations Chief	Matt Howard (9/9), Tyler McCarty(t) (9/9)		Division/Group Supervisor		George Brown		
Air Attack Supervisor	Steve Wetmore		Safety Officer		Kent Glazer / Kellie Carlsen		
<b>6. Resources Assigned this Period</b>							
Resource	Company	Name	Personnel	14th Day	Notes		
C-513 HCI	Snake River	Gilmore, Mike	10	9/11	Demob 9/8 1600		
E-2 ENG6	Wapiti Forestry	Syfert, Dan	2	9/10	Roll To Days 9/9		
E-21 WAT2 3000gal	Mark Jones	Knighton, Chris	2	9/10			
E-860 WAT	Wyatt Timber	Hansen, Charlie	1	9/11			
E-961 PID	Mike Short - Team 4	Hunt, Theron/Moniz, Kelsey	2	9/18	Palm IR Operation		
E-960 PID	Mike Short - Team 3	Inge, Maddy/Inge, Emma Saylor, Jason	2	9/18	Palm IR Operation		
<b>7. Control Operations</b>							
<p>*Mop spot fire 100%.</p> <p>*Mop up 200' feet from perimeter.</p> <p>*Initiate holding operations as line construction progresses.</p> <p>*Check dozer berms for heat.</p>							
<b>8. Special Instructions</b>							
<p>*Document location and inventory of hose lays, folda-tanks, and pumps.</p> <p>*Notify and coordinate burn operations with adjacent Divisions and resources.</p> <p>*Record all serial numbers and location of all Mark III pumps and provide info to Situation Unit</p> <p>*Identify and mark drop points and communicate lat/long to the Situation Unit.</p>							
<b>9. Division/Group Communication Summary</b>							
Function	Branch	Frequency Rx	Tone	Frequency Tx	Tone	Channel	Remarks
Command	I	151.445		158.895	146.2	7	Command
DIV T/Y	I	151.4900	156.7	151.4900	156.7	12	DIV T/Y
Air to Ground	I	151.4150	156.7	151.4150	156.7	5	Air To Ground
Prepared by (RESL) Randall Baley		Approved by (PSC) Don Everingham (9/9)		Date 9/7/2017		Time 1000	



<b>Incident Radio Communications Plan</b>	<b>1. Incident Name:</b> Horse Prairie	<b>2. Date/Time Prepared:</b> 9/07/2017 0855	<b>3. Operational Period:</b> Night 9/7/17

**4. ICS-205 INCIDENT RADIO COMMUNICATIONS PLAN**

System/Cache	Portable Channel	Function	Frequency	Assignment	Remarks
Fire Cache Tac 1	1	Tactical	151.2350 TX/RX Tone 156.7	Div A	
Fire Cache Tac 2	2	Tactical	151.2500 TX/RX Tone 156.7	Div M	
Fire Cache Tac 3	3	Tactical	151.3550 TX/RX Tone 156.7	Div P	
Fire Cache Tac 4	4	Tactical	151.3850 TX/RX Tone 156.7	Div Q	
Fire Cache Tac 5	5	Tactical	151.4150 TX/RX Tone 156.7	Air to Ground	A / M / Y / T
Fire Cache Tac 6	6	Tactical	151.4600 TX/RX Tone 156.7	Air to Ground	P / S / Q
F/C Net 2 Repeater	7	Command 1	R151.445 T158.895 Tx Tone 146.2	Div A,M,P,Q,S,T,Y	FC Net 2 Repeater (Linked)
CMD 2	8	Command 2	R151.430 T159.450 Tx Tone 146.2	Div A,M,P,Q,S,T,Y	FC Net 2 Backup (Linked)
Red Net	9	Tactical	151.340 TX/RX Tone 156.7	Initial Attack	IA
White Net	10	Tactical	151.310 TX/RX Tone 156.7	Initial Attack	IA
Fire Cache Tac 7	11	Tactical	151.475 Tx/Rx tone 156.7	Div S	
Fire Cache Tac 8	12	Tactical	151.490 TX/RX Tone 156.7	Div T	
Fire Cache Tac 9	13	Tactical	151.1525 Tx/Rx Tone 156.7	Div Y	
Simulcast	14				Not Assigned
Air Guard	15	District	R151.160 T159.4275 Tx Tone 146.2	Initial Attack	DFPA Dispatch Repeater 4 Tone 2
	16	Emergency	168.625 TX Tone 110.9		Air Guard
<b>5. Prepared by: Ryan Gantt (COML)</b>					

# AIR OPERATIONS SUMMARY

Prepared By: Scott Swearingen      Prepared Date/Time: 9/6/2017

<b>1. INCIDENT NAME:</b> <b>Horse Prairie</b>		<b>2. OPERATIONAL PERIOD DATE:</b> 9/7/2017		<b>Start Time</b> 8:00		<b>End Time</b> 20:00		<b>Sunrise</b> 6:46		<b>Sunset</b> 19:39	
--	--	--	--	---------------------------	--	--------------------------	--	------------------------	--	------------------------	--

**3. REMARKS (Safety Notes, Hazards, Air Operations Special Equipment,, etc.):**  
 Helibase Location:  
**Myrtle Creek Airport**  
**42 59.87' 123 18.96'**

Maps:  
[http://ftp.nifc.gov/incident\\_specific\\_data/pacific.nw/2017\\_Incidents\\_Oregon/2017\\_HorsePrairie\\_OR-733S/GIS/Products/](http://ftp.nifc.gov/incident_specific_data/pacific.nw/2017_Incidents_Oregon/2017_HorsePrairie_OR-733S/GIS/Products/)



**4. MEDEVAC A/C:**  
 See Medical Plan  
 9PJ, B407 Shorthaul avail.  
 @ Oakridge HB. Order via  
 Myrtle Creek HB

**5. TFR DESCRIPTION:**  
 TFR #- 7/5220  
 Freq.- 120.15  
 LAT-42 55.00, LONG-123 33.30  
 7NM 10,000'

<b>6. PERSONNEL</b>		Phone	<b>7. FREQUENCIES</b>		AM	FM	<b>8. FIXED-WING (# Avail/Type/Make-Model/FAA N#/Bases)</b>	
AOBD	Scott Swearingen	541-580-7485	A/A Primary		120.1500		Airtankers Available on request	
AOBD	Greg Yates	828-380-0368	A/A Secondary		118.1250			
ATGS	Steve Wetmore	541-621-4104	Alt. Air/Air - PSD Mission		119.5000		Leadplanes Available on request	
ATGS	Adam Sinkey	541-670-2573	A/A IA (Zone Primary)		134.7250			
HEB1	Kristina Sheppard	541-821-2023	Unicom (MC Airport)		122.7		SEATs Available at RGB 0900. RBG Tanker Base Ramp Freq. 123.975	
HEB1	Dan Menk	541-731-4569	Div A,M,T,Y - A/G (Tac 5)		Tx/Rx T156.7	151.4150	T-882, T823	
HEB2	Kelly Foster	503-586-6944	Div P,Q,S - A/G (Tac 6)		Tx/Rx T156.7	151.4600	Other: LMXE UAS	
ABRO	Randy Jones	509-675-0292	A/G IA (ODF White Net)		Tx/Rx T156.7	151.3100	UAS	
			DECK Myrtle Creek HB			170.0000		

**9. HELICOPTERS (Use Additional Sheets As Necessary)**

FAA #	TYPE	MAKE/MODEL	BASE	AVAIL	START	REMARKS	FAA #	TYPE	MAKE/MODEL	BASE	AVAIL	START	REMARKS
301	3	B-206	MC	0830	0800	AA / Recon	24CK	1	S-61A	MC	0830	0800	Bucket
2KK	3	B-206-L	MC	0830	0800	AA / Recon							
88TA	3	B-206	MC	0830	0800	AA / Recon							
5MM	2	UH-1H	MC	1000	1000	Bucket / IA							
480	2	UH-1B+	MC	0830	0800	Unavailable							
703 (3SG)	2	UH-1H	MC	0830	0800	Bucket							
30G	2	UH-1H	MC	0830	0800	Bucket							
8EC	2	B-205A++	MC	0830	0800	Bucket							
5PT	2	B-205A1+	MC	0830	0800	Bucket							
15S	2	UH-1H	MC	0930	0800	Bucket / Helitorch							



# Fire Weather Forecast

FORECAST NO: 16  
PREDICTION FOR: Thursday Night Shift  
SHIFT DATE: September 7-8, 2017  
TIME AND DATE  
FORECAST ISSUED: 1300 September 7, 2017

NAME OF FIRE: Horse Prairie  
UNIT: Douglas Forest Protection Association  
Incident Meteorologist: Mary Wister  
Cell #: 240-778-5303

## Weather Discussion

**...Flash Flood Watch for the Burn Scar Areas through this Evening...  
...Marginal Risk of Severe Thunderstorms this Evening...**

As of 1300, showers and thunderstorms once again developed over southwest Oregon, and Horse Prairie got more rain than yesterday :) At the time of the submitted forecast, rain just began and exact rainfall amounts are unknown. There may be a few lingering showers or thunderstorms at the start of the night shift but will end around 8 PM. Clearing skies and areas of fog will occur overnight. RHs will be 100% in some areas.

## Thursday's Weather:

As of 1300...showers and thunderstorms. Moderate rain. WNW winds 3-6 mph. Temps: 60s. RH: 80-90 percent.

**\*\*\*Thunderstorms imply gusty and erratic winds\*\*\***

## Weather Forecast for Tonight:

Weather.....Mostly Cloudy. Isolated showers and thunderstorms before 2000. Areas of fog and smoke.  
Min Temperatures.....60-68.  
Max Humidity.....85-100 percent.  
Winds (20FT).....Downslope/downvalley 2-5 mph.  
Winds (Ridgetop).....North 3-8 mph.  
Haines Index.....3 (Very Low).  
CWR (> 0.25").....20% this evening. **LAL: 2...possibly 3.**

## Outlook For Friday:

Weather.....Mostly Cloudy. A slight chance of a shower.  
Max Temperatures....70-75.  
Min Humidity.....around 60 percent.  
Winds (20FT).....Upslope/Upvalley 2-5 mph. Winds East 3-6 along Cow Creek in Div S.  
Winds (Ridgetop).....Northeast 2-5 mph...becoming Northwest 4-8 mph in the afternoon.  
Haines Index.....3 (Very Low).  
CWR (>0.25").....0%. **LAL: 1**

## Extended Outlook for Saturday-Monday:

**SATURDAY**...Partly cloudy. Lows 55 to 60. Highs 75 to 80. Northwest winds 5 to 10 mph.  
**SUNDAY through MONDAY**...Mostly clear. Lows 50 to 60. Warmer with Highs in the 80s. North winds 5 to 10 mph. Gusts to 15 mph along ridgetops Sunday.

## FIRE BEHAVIOR FORECAST

<b>FORECAST NUMBER:</b> 12	<b>TYPE OF FIRE:</b> Wildland
<b>FIRE NAME:</b> Horse Prairie	<b>OPERATIONAL PERIOD:</b> Sept. 7, Night Shift
<b>DATE ISSUED:</b> Sept. 7, 2017	<b>TIME ISSUED:</b> 0900
<b>UNIT:</b> DFPA, Central Unit	<b>SIGNED:</b> <u>Mike Haasken</u> <i>MH</i>
	<b>Typed/printed:</b> Mike Haasken

### INPUTS

**WEATHER SUMMARY:** .DISCUSSION... Although rain amounts were less than 0.10" last night, some storms yesterday produced up to 0.50" in southern Oregon. The main low pressure system off the California coast will send additional surges of moisture and energy across the region today. These could develop thunderstorms capable of frequent lightning, heavy downpours, hail, and gusty outflow winds. For Horse Prairie and ICP, the thunderstorm threat will mainly occur between 1200-2000. Precipitation will taper off tonight. It will be cool with high RHs today. A warming and drying trend begins Saturday.

**TOPOGRAPHY:** Very steep ridge and valley topography with Table Mountain on the north and Cow Creek on the southeast part of the fire. Elevation ranges from 3,300' on Table Mountain to 800' in Cow Creek. Elevations increase above Cow Creek on the south end of the fire to 2,900'.

### OUTPUTS

#### FIRE BEHAVIOR

**GENERAL:** Fuels are timber ranging in age from new plantings to old growth with a brush and litter understory and also grass and brush fields. The old growth stands have numerous hazard trees. Fire Behavior during the first several days was extreme with running, crowning and spotting up to ½ mile. Some runs have been downhill with predominantly northerly winds. A rotating column with fire whirls was observed in late afternoon on the Div. T burnout several days ago. The burn period has been 24 hours. If the fire area receives a crown penetrating rain, lighter fuels will become too wet to burn, but the heavier fuels such as down logs, stumps, duff and snags will remain burnable.

**Forecasted Indices: For Late Afternoon, early evening before shift change. (Silver Butte RAWs)**

**1 hour fuel moisture:** 12% (+4); **10 hour fuel moisture:** 12% (+4); **100 hour fuel moisture:** 11% (+4); **1000 hour fuel moisture:** 10% (+1); **Live Woody Fuel Moisture:** 70(same); **Energy Release Component:** 53 (-12); **Probability of Ignition: Shaded due to smoke:** 20%; **Unshaded:** 30%

**Expected Fire Behavior:** Expect low rates of spread and flame lengths with isolated torching depending on rainfall.

**SPECIFIC:** Divisions Q,P,A,M,Y and T north: Minimal fire behavior, smoldering in heavy fuels.

**Division S & T South:** Possible active burning north end of Division along Cow Creek Road and south of Creek and in interior island in south end of Division S from recent burnout.

**AIR OPERATIONS:** Air operations may be hampered by heavy smoke and/or stormy weather. Sunset at Myrtle Creek is 7:39 PM tonight and sunrise tomorrow is 6:47 AM.

**SAFETY:** Lightning fires are started by strikes to ground that have a component called a continuing current. All positive discharges have a continuing current, and about 20% of negative discharges have one. Ignition depends on the duration of the current and the kind of fuel the lightning hits. Ignition in fuels with long and medium length needle cast, such as Ponderosa pine and Lodgepole pine, depend on the fuel moisture. Ignitions in short- needled species, such as Douglas fir depend far more on the depth of the duff layer than on the moisture. Spread of the fire after ignition usually depends on fuel moisture in all cases.

<b>MEDICAL PLAN</b>	1. INCIDENT NAME	2. DATE PREPARED	3. TIME PREPARED	4. OPERATIONAL PERIOD
	Horse Prairie	9/6/17		Night Shift 09/06/17, 09/07/17

**5. INCIDENT MEDICAL AID STATIONS**

MEDICAL AID STATIONS	LOCATION	PARAMEDICS	
		YES	NO
Fire Camp MEDL: Mark Little (EMTP), James Furbush MEDL (T)	Riddle Bypass ICP	x	
Ambulance: Medic 1 (ALS)	DP 140	x	
Line Medic: Tyler (EMTB)	DP 15		x
Line Medic: Jennel (EMTP)	DP 130	x	

**6. TRANSPORTATION**

**A. Air Ambulances**

NAME	ADDRESS	PHONE	PARAMEDICS	
			YES	NO
Reach	Roseburg, OR	911	x	
Life Flight	Cottage Grove, OR	911	x	

**B. Ground Ambulances**

Bay Cities Ambulance	Roseburg, OR	911	x	
Douglas County Fire District 2	Roseburg, OR	911	x	

**7. HOSPITALS**

NAME	ADDRESS	TRAVEL TIME		PHONE	HELIPAD		BURN CENTER	
		AIR	GRND		YES	NO	YES	NO
Mercy Medical Center LV 3	2700 NW Stewart Prkw Roseburg	10min	40min	541-677-4333	x			x
Riverbend Sacred Heart LV2	3333Riverbend DR. Springfield OR	35min	80min	541-222-7300	x			x
OHSU LV 1	3181 SW Sam Jackson Park RD. Portland OR 97239	55min	3hrs	503-494-8311	x			x
Legacy Oregon Burn Ctr. LV1	3001 N. Gantenbein, Portland, OR	55min	3hrs	503-413-4232	x		x	

**8. MEDICAL EMERGENCY PROCEDURES**

**1. LINE EMERGENCY: Crew Supervisor to contact Division Supervisor with patient complaint/condition and 2 location.**

- Division Supervisor contacts:
  - Line EMT / PM
  - Communications Unit
- Communication Unit will clear command channel for emergency traffic
- Communications Unit contacts:
  - Medical Unit
  - Safety
  - Operations
- Division Supervisor will run medical emergency on command channel
- Medical Unit will:
  - Dispatch ground ambulance to nearest drop-point for ground transport only.
  - Or after patient pickup, dispatch ambulance to Helibase for Medical AIR EVAC Flight if needed
  - Notify receiving hospital of injury status.

**1. CAMP EMERGENCY: Contact Medical Unit with patient complaint/condition and location. Medical Staff will respond to stabilize incident:**

- Medical Unit contacts:
  - Communications
  - Safety
  - Logistics
  - Operations
  - Crew Supervisor

**7. INCIDENT COMMUNICATIONS:**

- Command: Channel #7
- Air to Ground: Channel #5

**INJURY REPORTING PROCEDURES**

**2. EMERGENCY IC** \_\_\_\_\_

IS AN EMT WITH PATIENT: YES \_\_\_\_ NO \_\_\_\_

IS A PARAMEDIC WITH PATIENT: YES \_\_\_\_ NO \_\_\_\_

**3. NATURE OF INJURY** \_\_\_\_\_

AGE \_\_\_\_ WEIGHT \_\_\_\_ SEX: MALE \_\_\_\_ FEMALE \_\_\_\_

CONSCIOUS? YES \_\_\_\_ NO \_\_\_\_ BREATHING? YES \_\_\_\_ NO \_\_\_\_

PATIENT UNIT ID \_\_\_\_\_

**REMINDER: DO NOT GIVE PT NAME OVER RADIO**

**4. RED-URGENT YELLOW-PRIORITY GREEN-ROUTINE**

**5. TRANSPORTATION REQUESTED BY: AIR \_\_\_\_ GROUND \_\_\_\_**

**6. ADDITIONAL NEEDS** \_\_\_\_\_

**8. LOCATION OF PATIENT** \_\_\_\_\_

Division,

closest DP

POINT OF PICKUP \_\_\_\_\_

LAT \_\_\_\_\_ LONG \_\_\_\_\_

**9. CONTINGENCY** \_\_\_\_\_

<b>ICS 206 5-17</b>	<b>9. PREPARED BY (MEDICAL UNIT LEADER)</b> Mark Little MEDL (541)-530-1296	<b>10. REVIEWED BY (SAFETY OFFICER)</b> Kellie Carlsen
---------------------	--	---



## Today's discussion is from the Hazard Tree Category.

### Hazard Trees – Situational Awareness

Snags (dead, standing trees without leaves or needles in the crowns) and green hazard trees present a significant threat to wildland firefighter safety. Snags typically have much lower fuel moistures than live, green trees; and they burn more readily. In the process, they often throw off embers creating spot fires in advance of the main fire. Snags may burn through more quickly than green trees and can fall without warning. Live, green trees weakened by insects, disease, weather, fire, and age presents another hazard and they can also fall without notice.

- The risk of serious injuries from hazard trees may increase during the night operational period when visibility is reduced.
- While work in cooler, nighttime environments can help control efforts, it also presents an increased risk from unseen falling snags and weakened live trees. Night operations should be restricted in areas of high risk rated dead and dying trees.
- Environmental conditions that increase risk from hazard trees: Strong or gusty winds from storm cells. Air operations - water or retardant drops, rotor wash from helicopters. Steep slopes with rolling material. Erosion and undercut root systems. Diseased or bug-killed areas (Mountain Pine Beetle).
- Things to consider when assessing the potential dangers of hazard trees: Trees have been burning for an extended period. High-risk tree species (those that are known for rot and shallow root systems) in the area. Numerous downed trees/material. Broken tops and dead limbs overhead. Accumulation of downed limbs, tree decay, cavities, splits, cracks, lack of needles, bark, limbs or other indicators of overhead hazards. Roots damaged by equipment, fire or erosion create hazards.
- Mitigation measures to take: Identify and establish No-Work-Zones (NWZ) in all high-risk areas until the hazard has been mitigated. Instruct firefighters of established NWZ in briefings. Identify with flagging/signs, and show area on maps. Establish lookouts to protect NWZs. Assign only qualified sawyers and Falling Bosses. Order additional professional fallers in advance. Use heavy equipment, and blasters when appropriate. Plan a quick and safe escape routes. Do not turn your back on a falling tree or known hazard. Use lookouts to maintain secure felling areas. Maintain situational awareness.

References: [Hazard Tree Safety Web Page](#)

Have an idea? Have feedback? Share it.

ONLINE | MAIL: 6 Minutes For Safety Task Group • 3833 S. Development Ave • Boise, ID 83705 | FAX: 208-387-5250

**6 Minutes Home**



## Safety Analysis of Tactical Actions (215A)

Incident Name: Horse Prairie				Date and Time Prepared: 9/7/2017				Operational Period: Night 9/7/2017							
TACTICAL HAZARDS	A/M/P			Q	S	T	Y	LCES MITIGATION							
	Indirect Fireline				X	X	X					Establish LCES. Insure that communications between lookouts and line resources are maintained. Escape Routes are identified and reevaluated continuously.			
Downhill Fireline				X	X	X					Follow downhill line standards. Bring fire with you. Insure lookout can see entire area. Identify safety zones and escape routes before starting work. Use page 9 of Incident Response Pocket Guide. Establish LCES.				
Underslung Fireline				X	X	X					Cup trench. Post lookout that can see all areas of under slung line. Establish LCES.				
Mid-Slope Fireline				X	X	X					Insure that lookouts can see ALL area of mid slope line as well as areas upslope of mid slope line. Establish Trigger Points and reassess as fire or weather conditions change. Establish LCES.				
Frontal Assault				X	X	X					Identify thresholds for reassessment. Establish LCES.				
No Anchor Points				X	X	X					Find/construct safe, effective anchor before engaging. Establish LCES.				
Extreme Conditions (Spotting, Wind)	X			X	X	X					High potential given because of low live fuel moisture and high probability of ignition. Anticipate. Identify thresholds for reassessment, monitor weather. Establish LCES.				
Heavy Equipment				X	X	X					Do not work down slope below heavy equipment. Establish communications with operator. Post lookout for rolling debris. Be aware of loose soil and rock. Establish LCES.				
Air Ops: Multi Aircraft				X	X	X					Insure that all personnel are at least 500 feet from bucket or retardant drops. Utilize air attack. Establish LCES.				
Hazard Trees/Snags	X			X	X	X	X				Assess, Identify, Communicate, Isolate, Mitigate. Establish LCES.				
Hazardous Materials											Utilize the Incident Response Pocket Guide. Identify and isolate any suspected hazardous materials. Notify supervisor and warn others in area. Keep your distance. Establish LCES.				
Unburned Area Unknown Fires	X			X	X	X	X				High potential for re-burn in brush and conifers preheated by earlier burn. Blowdown areas keep a close eye on. Post lookouts. Watch for increase in burn activity. Monitor weather for change in RH and or wind conditions. Establish LCES.				
Transportation	X			X	X	X	X				Drive defensively with headlights on, seatbelts fastened. Stay to the right side of the road. Yield to uphill traffic and flaggers. Drive slowly and watch out for the other person. Establish LCES.				
Communication	X			X	X	X	X				Establish LCES. Insure that communications between lookouts and line resources are maintained. Escape Routes are identified and reevaluated continuously.				
Steep Terrain Gravity Hazards	X			X	X	X	X				Do not work crews above or below each other. Post lookouts for rolling material. Watch footing in loose or wet soil and rock. Do not work below heavy equipment. Establish LCES.				
Environmental Hazards	X			X	X	X	X				Bees, Snakes, Bears and other animals are in the area. Carry medical kits for those with allergic reactions, do not harass or instigate any confrontations with animals, warn others of presence. Poison Oak - Preventative measures, locate, isolate, mitigate.				
Structures						X	X				Follow page(s) 12 - 16 of Incident Pocket Response Guide. Establish LCES.				
Transfer of Command											Make sure you understand your assignment. Know who your supervisor is and who is working for you. Do not assume. Re-brief all resources.				
Span of Control				X	X	X					Adhere to Span of Control Guidelines-5:1. Ensure Overhead is sufficient for operation and identify chain of command. Ensure everyone receives a briefing. Retain control at all times.				
Falling Operations	X			X	X	X	X				Post road guards. Have a falling boss who can be in contact with crews working in the area. Use qualified Fallers.				
Power Lines					X	X					Watch for down power lines and poles. Identify, isolate and report. Notify supervisor and warn others in area. Keep your distance.				
I.A.	X			X	X	X	X				Follow the 10 and 18, LCES - before engaging, re-evaluate for each new start!				
<b>Operations Section Chiefs:</b> Perkins				<b>Date / Time:</b> 9/7/2017 1130				<b>Safety Officers:</b> Carlsen				<b>Date / Time:</b> 9/7/2017			

# HEALTH AND SAFETY MESSAGE

*SAFETY* starts with *YOU*

We are ALL accountable for SAFE behaviors

INCIDENT: Horse Prairie

DATE: September 7, 2017

Operation period: Night

## Major Hazards and Risks:

**Thunderstorm Safety**

**Shifting Winds**

**Cell Phones**

Fire Order of the Day – Keep informed on *Fire* weather conditions and forecasts

Stay Focused. Maintain your SITUATIONAL AWARENESS!! Do not become complacent.



From Lessons Learned Center: Rapid Lesson Sharing

**SPIDER BITES: 4 incidents in 10 days**

In the fall, spiders become more aggressive when they are getting ready to reproduce. Their venom is more potent. These spider bite incidents have all advanced to a serious level due to the time lapse between being bit and coming into the Medical Unit for treatment. Yes, we all know you don't want to be taken off the line working. All the more reason to get attention earlier. **DO NOT DELAY SEEKING TREATMENT!!**

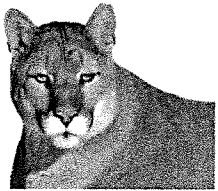

### Encountering a Cougar:

1. Stay calm and stand your ground
2. Maintain direct eye contact
3. Back away slowly
4. Do not bend down or turn your back on the Cougar
5. Do not run! Running triggers a response in Cougars which could lead to an attack
6. Raise your voice and speak firmly
7. If the Cougar seems aggressive; raise your arms to make yourself look larger and clap your hands
8. If in the very unusual event that the cougar attacks you, fight back with sticks, rocks, tools or any other available items.

Cell Phones: House Bill 2597 clarifies that anything a driver could think of doing with a cell phone while driving is illegal. If a police officer sees the white glow of the screen illuminating a driver's face, even if the officer didn't see the driver talking or fingering the keys, the officer has witnessed a violation.

### **Thunderstorm Counter-Measures**

#### 30/30 rule:

- If you see lighting and hear thunderclaps within 30 seconds take storm counter measures-below.
- Do not resume work in exposed areas until 30 minutes after storm activity has passed.
- Take shelter in a vehicle.
- Find a low spot away from tall trees, utility lines.
- Move to area of shorter trees/plantation/clearcut
- Crouch low to ground, use pack to seat on, never lay on the ground.
- Make yourself the smallest possible target and minimize your contact with the ground.
- Don't group together.
- Try to avoid ridgetops, wide open areas, ledges, rocky outcrops.
- Keep from standing near or operating machinery (pumps, water tenders)
- Do not handle flammable materials.
- Use of handheld radios and cell phones are ok.
- Remain alert to unexpected weather changes.



Incident: Horse Prairie  
Thunderstorm Safety Plan  
September 6, 2017

In the event of a significant thunderstorm event affecting the Horse Prairie Incident, the following actions will be implemented:

1. The Safety Officer will address the safety concern at shift briefings, through safety messages, and informational sharing with Section Chiefs.
2. Thunderstorm safety guidelines from the IRPG page 21 and information from 6 Minutes for Safety Thunderstorm Safety handouts will be provided in camp and on the fire line.

**The 30/30 rule will be observed: If you see lightning, and hear the thunderclaps follow in less than 30 seconds, take the following storm precautions seriously.**

- A) **Take shelter in a vehicle. No suitable buildings/yerts are located at the ICP.**
  - B) **Do not group together.**
  - C) **Avoid seeking shelter beneath a tree.**
  - D) **Do not resume work in exposed areas until 30 minutes after storm activity has passed.**
3. The IMET will monitor the development of significant thunderstorm activity in the vicinity of the incident and the ICP.
  4. The IMET will request incident communications to make a radio announcement to fire line DIVS when the thunderstorm is approximately 30-60 minutes away from the incident or the ICP.

Section Chiefs at the ICP will be responsible for insuring this information is communicated to their subordinates and assigned resources.

## Working Around Inmates

Since 1951 The Oregon Department of Forestry (ODF) has utilized inmate labor to support wildland fire suppression efforts statewide. Standards have been established to protect the public and maintain order within the inmate work program. There is an expectation that security standards will not be compromised. This expectation extends to contractors, volunteers, and other agency and non-agency staff working on ODF managed fires.

You will recognize inmates by the orange stenciling on their clothing with the words "inmate" and the name of the institution that they came from. Inmates are rigorously screened before they are eligible for the work program. Violent crimes, sexual crimes, arson, and murder will keep an inmate from qualifying. Inmates working for ODF are typically highly motivated, trained, and look forward to learning new skills and giving back to local communities. They will not be left unsupervised or unaccounted for more than 30 minutes while on the fire line. While in fire camp, inmates are continuously supervised by DOC and ODF staff. It is ok to be friendly and speak with inmate workers, but here are some things you need to know:

- Inmates are not authorized to possess anything not provided by the Oregon Department of Forestry or Department of Corrections that is required for their work activity or sustenance. **Any items not issued by ODF or DOC is considered contraband.** Examples of contraband are cigarettes, chew, drugs, alcohol, firearms, non-stenciled clothing items, matches, lighters, sticks, animals, money, cell phones, or other people's items. Providing contraband to an inmate can in some cases result in a Class C, B, or A felony.
- Inmates should not be allowed access to computers, tablets, phones, fax machines, non-issued mobile radios, vehicle keys, facility keys etc.
- Enjoy light conversation with inmates but avoid sharing deeply personal information. Also do not engage in trying to solve an inmate's personal problems. Trained correctional counselors and security staff are hired to help inmates solve their problems. Feel free to express gratitude for the hard work that they do.
- Staff, contractors, and volunteers should not provide any type of gift or do any type of favor for an inmate. This includes making phone calls, mailing letters, post cards, emails, text messages or posting Facebook messages/pictures for inmates. Remember: **NO GIFTS, NO FAVORS.**
- Be aware of the Federal Prison Rape Elimination Act (PREA). It is a violation of Federal and State law to expose yourself to an inmate, engage in voyeurism, or have any sexual contact with an inmate. Professional boundaries are expected at all times. Sexual topics of discussion or jokes around inmates is inappropriate. Dress and act appropriately around inmates.
- Reporting- when you see an inmate acting strangely or doing/saying something that is clearly inappropriate do not hesitate to speak with the nearest Corrections Officer, or Forestry Crew boss.
- If an inmate is injured during the course of his duties, respond as you would for any other person and communicate with DOC security staff immediately thereafter.

When Inmates are working for the Oregon Department of Forestry they are learning technical skills, work ethic, problem solving skills and social skills that can help them become productive citizens when they are released. Please help us maintain a secure and positive inmate program by adhering to these policies and laws.

# HORSE PRAIRIE FIRE

## MOP UP STANDARDS

September 5<sup>th</sup>, 2017

Objective: The Horse Prairie Fire is to be mopped-up to a standard which the likelihood of the fire escaping the containment lines unlikely. The standards below can be flexible and should be applied based on physical conditions present, considerations for firefighter safety, and the expertise of the Incident Management Team (IMT) as long as the objective is achieved. These standards apply to all lands within the fire perimeter.

- Grid the green out to 300 feet from the fire perimeter for two burning periods
- Mop up 100% into hard black a minimum of 200 feet
- Mop up 100% all spot fires, in addition, a route to them will be flagged and the perimeter mapped in GIS
- Line unburned islands and drainages within 500 feet of the perimeter if they are not within the designated mop up area
- Mop up to 500 feet into hard black any dirty burn areas and areas of higher fuel concentrations. The decision to mop up this far into the fire will be based on the expertise of the IMT which is to consider fuels, aspect, wind exposure and firefighter safety
- Heat detecting equipment will be used to detect for hot spots within 200 feet of the perimeter including spot fires
- Complete felling of all snags and fire damaged trees that have been identified as a safety concern, have the potential to cause spotting outside control lines or is within 300 feet of major travel corridors, structures or railroad infrastructure.

## Resource Protection on BLM Lands Horse Prairie Fire

- Avoid application of retardant, foam or other chemicals to waterways unless the fire is deemed a threat to human safety or private property.
- Avoid use of dozers in riparian areas.
- Notify Resource Advisor of location if cultural artifact items are found. Remember, removing cultural artifacts is illegal.
- Locate fire lines to minimize directing water into waterbodies or wetlands.
- There are several Spotted Owl and Marbled Murrelet Nest sites near the current fire area. When planning suppression activities in older forests work with READ's to reduce impacts.
- If drafting out of Olalla Creek, Cow Creek, Union Creek or Doe Creeks use 3/32" screens on draft intake. Screening material and zip ties can be picked up at supply.



# Finance Message

## September 6, 2017

The following resources need to see TIME to provide additional information:

- 🌲 E-826 Barnes & Associates
- 🌲 Kytola & Luscombe (multiple resource #'s)
- 🌲 Tower Timber (multiple Resource #'s)
- 🌲 Weekly Brothers (multiple Resource #'s)
- 🌲 C-11 GE Forestry
- 🌲 C-8 South Fork – Huserik
- 🌲 E-925 Heard Excavation
- 🌲 C-19 Alpine Hotshots
- 🌲 O-72 Scheeli Marian
- 🌲 O-93 Gilkison, Steve

09/08/2017

TENTATIVE RELEASE

HORSE PRAIRIE US-OR-733S-000114

**CREWS**

C-19	0600	(HC1)	CREW - T1 - ALPINE IHC
C-502	0615	(CC)	CREW - CAMP - WARNER CREEK
C-511	0615	(HCM)	CREW - MISC - TWO RIVERS #1
C-510	1600	(HCM)	CREW - MISC - PRC #1 <i>Night Resource</i>
C-512	1600	(HCM)	CREW - MISC - SRC #1 " "
C-513	1600	(HCM)	CREW - MISC - SRC #2 " "
C-514	1600	(HCM)	CREW - MISC - SRC #3 " "

**EQUIPMENT**

E-810	0630	(ENG6)	ENGINE - T6 - 17-475, 4WD (5868)
E-811	0645	(ENG4)	ENGINE - T3 - 07-282
E-26	1900	(WTT1)	LONE ROCK TIMBER TENDER

**OVERHEAD**

O-882	0300	(SOFR)	GLAZER, KENNETH J <i>Night Resource</i>
O-21	1600	(DIVS)	KURZYNIEC, JACOB " "
O-604	1600	(HEQB)	MITCHELL, SPENCER " "
O-1004	1900	(FELB)	GEIGER, TONY -- LONE ROCK
O-950	1900	(FELB)	HENRY, BOB--LONE ROCK
O-84	1900	(FAL1)	KENNEDY (LONE ROCK), BRADY
O-82	1900	(FAL1)	MENDENHALL (LONE ROCK), RICK
O-951	1900	(FELB)	PARAZOO, ERIC--LONE ROCK
O-75	1900	(FAL1)	PENA (LONE ROCK), ARTURO
O-81	1900	(FAL1)	POWELL (LONE ROCK), DAN
O-83	1900	(FAL1)	WIEGMAN (LONE ROCK),

## Logistics Service Hours

Shower	0900 – 2300
Kitchen	0430 - 0930 1630 – 2130
Fire Cache/ Ground Support	0600 – 2200
Medical <i>(Staffed After Hours)</i>	0530 – 2130

## Horse Prairie ICP Telephone List

Fire Information: 541-863-4756

Ordering: 541-863-4894

Communications: 541-863-6043

Time/Finance: 541-863-5831

Procurement: 541-863-7143

# HORSE PRAIRIE FIRE CAMP MAP

FIRE # 733114-18

SKETCH MAP  
NOT TO SCALE

PRIVATE

ONE WAY TRAFFIC

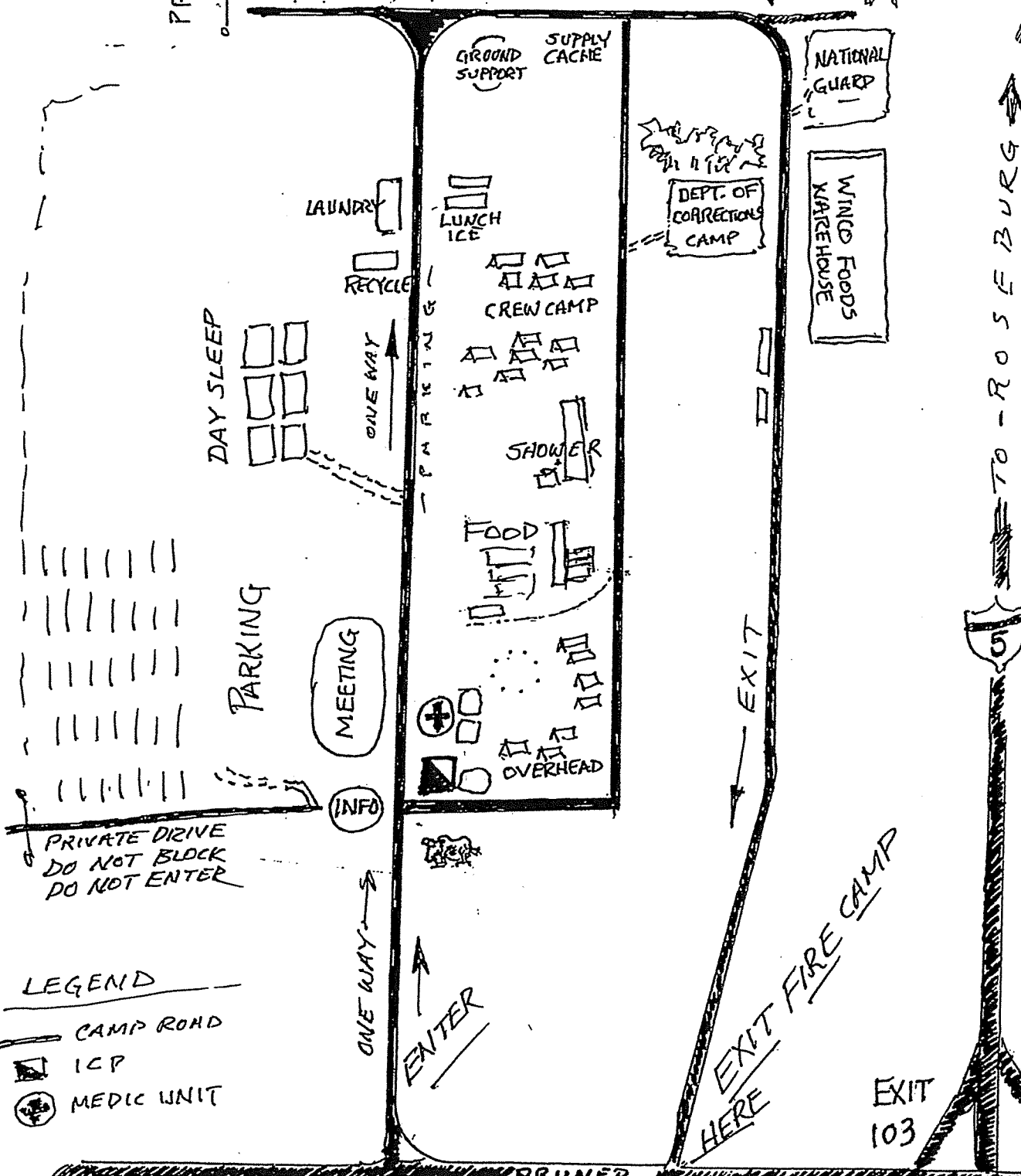

NOTES:

- ONE WAY TRAFFIC IN CAMP
- PARKING OFF THE ROAD
- BUSY INTERSECTION BE CAREFUL!

LEGEND

- CAMP ROAD
- ⊠ ICP
- ⊕ MEDIC UNIT

← TO RIDDLE, TO FIRE

EXIT 103

EXIT FIRE CAMP  
HERE

CAUTION



