

AirOps Map

Beachie Creek Fire
ORWIF-200299
09/14/2020 24hr

188,935 acres at 09/12/20 @ 2154

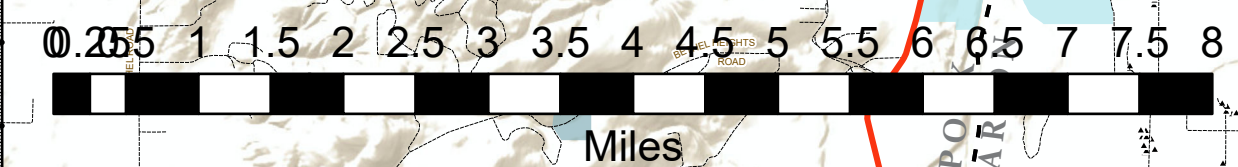

FeatureCategory	Label	LatWGS84_DDM	LongWGS84_DDM
Airstrip or Airport	Albany Airport	44° 38.320' N	123° 03.651' W
Airstrip or Airport	Salem Airport	44° 54.490' N	123° 00.121' W
Branch Break		44° 47.796' N	122° 43.797' W
Branch Break		44° 59.872' N	122° 20.496' W
Dip Site		44° 45.283' N	122° 00.188' W
Dip Site		44° 43.336' N	122° 15.203' W
Dip Site	Dunlap Lake Dip	44° 49.068' N	122° 05.734' W
Dip Site	Elk Lake Dip	44° 49.353' N	122° 07.260' W
Dip Site	Elkhorn Lake Dip	44° 49.338' N	122° 18.578' W
Dip Site	Giebeler Lake Dip	44° 48.479' N	122° 08.919' W
Dip Site	Opal Lake Dip	44° 47.594' N	122° 13.192' W
Dip Site	Tumble Lake Dip	44° 44.848' N	122° 13.581' W
Division Break		44° 45.056' N	122° 26.047' W
Division Break		44° 53.885' N	122° 34.900' W
Division Break		44° 56.391' N	122° 32.014' W
Division Break		44° 47.998' N	122° 08.353' W
Division Break		45° 01.758' N	122° 37.387' W
Drop Point	DP-10	44° 47.906' N	122° 42.142' W
Drop Point	DP-15	44° 52.572' N	122° 39.165' W
Drop Point	DP-16	44° 53.074' N	122° 37.217' W
Drop Point	DP-18	44° 55.594' N	122° 39.416' W
Drop Point	DP-20	44° 55.890' N	122° 32.761' W
Drop Point	DP-21	45° 00.892' N	122° 35.479' W
Drop Point	DP-22	45° 02.399' N	122° 39.867' W
Drop Point	DP-28	44° 53.845' N	122° 36.141' W
Drop Point	DP-29	44° 53.613' N	122° 33.446' W
Drop Point	DP-40	45° 02.621' N	122° 40.273' W
Drop Point	DP-43	45° 02.730' N	122° 31.978' W
Drop Point	DP-75	44° 41.801' N	122° 26.299' W
Drop Point	DP-77	44° 42.497' N	122° 24.276' W
Drop Point	DP-90	44° 46.752' N	122° 37.016' W
Drop Point	DP-93	44° 45.344' N	122° 28.210' W
Drop Point	DP-95	44° 45.351' N	122° 24.988' W
Helibase	Davis Strip	44° 44.760' N	122° 25.281' W
Helibase	Howell Prairie	44° 53.670' N	122° 52.201' W
Incident Command Post	Chemeketa CC	44° 58.606' N	122° 58.675' W
Water Source		44° 45.234' N	122° 30.834' W
Water Source		44° 45.117' N	122° 28.168' W
Water Source		44° 53.051' N	122° 37.213' W
Water Source		44° 52.237' N	122° 39.150' W
Water Source		44° 59.591' N	122° 37.235' W
Water Source		45° 00.269' N	122° 35.606' W
Water Source		44° 44.306' N	122° 24.999' W

- City Limits
- County Structures
- Airstrip or Airport
- Dip Site
- Drop Point
- Helibase
- Incident Command Post
- Water Source
- Division Break
- Branch Break
- Uncontrolled Fire Edge
- Completed Dozer Line
- Completed Hand Line
- Road as Completed Line
- Access or Improved Road
- Aerial Hazard
- Temporary Flight Restriction
- US Launch and Recovery Zone
- Historic Fire Perimeters
- Wildfire Daily Fire Perimeter
- Ranger District Boundaries
- Bureau of Land Management
- U.S. Forest Service
- U.S. Fish and Wildlife Service
- Other Federal
- State
- Local Government
- Private/Unknown
- Wilderness
- County Boundary
- Interstate Highway
- US Highway
- State Highway
- County Road
- BLM Road
- Federal Road
- Municipal Road
- Private Road
- Other Road
- EPA Transmission Lines
- Mine Waste Aerial Avoidance

10,000 MSL
Frequency 128.4

12,000 MSL
Frequency 119.85

12,000 MSL
Frequency 125.4

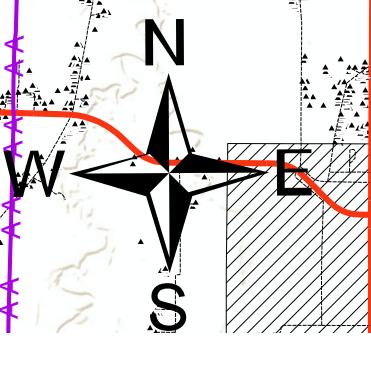

NW IMT 13 - JTH
09/14/2020 2120
Acres from IR
North American 1983 Datum, Lat/Long Grid