

Ownership	Acres	Percent
U.S. Forest Service	82,950	60.2
Private Industry Land	39,064	28.3
Bureau of Land Management	12,595	9.1
Private Rural Lands	2,856	2.1
Local Government	248	0.2
State Dept. of Forestry	112	<0.1
State Agency	40	<0.1

Riverside Incident Ownership
ORMHF-000859
Day Operational Period 9/18/2020

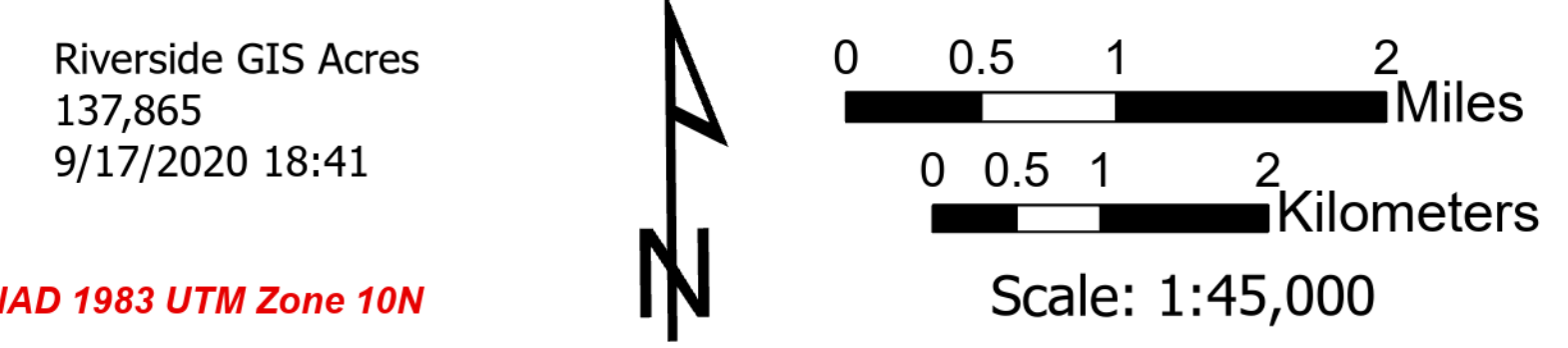

- ▬ Event Polygon
- Administrative Forest
- Wilderness
- Bureau of Land Management
- U.S. Fish and Wildlife Service
- Local Government
- State Agency
- State Dept. of Forestry
- State Dept. of Parks and Recreation
- Private Rural Lands
- Private Industry Lands
- U.S. Forest Service



Map Created 9/18/2020 by [unreadable]